



**REVIEW BY FORT BEND COUNTY
COMMISSIONERS COURT**

**Fort Bend County
Engineering Department**
301 Jackson Suite 401
Richmond, Texas 77469
281.633.7500
Permits@fortbendcountytx.gov

- Right of Way Permit
 Commercial Driveway Permit
Permit No: 2025-79826

The following "Notice of Proposed Cable, Conduit, and/or Pole Line activity in Fort Bend County" and accompanying attachments have been reviewed and the notice conforms to appropriate regulations set by Commissioner's Court of Fort Bend County, Texas.

(1) COMPLETE APPLICATION FORM:

- a. Name of road, street, and/or drainage ditch affected.
 b. Vicinity map showing course of directions
 c. Plans and specifications

(2) BOND:

- County Attorney, approval when applicable.
 : Perpetual bond currently posted. Bond No: _____ Amount: _____
 : Performance bond submitted. Bond No: _____ Amount: _____
 Cashier's Check Check No: [REDACTED] Amount: \$5,000.00

(3) DRAINAGE DISTRICT APPROVAL (WHEN APPLICABLE):

Drainage District Approval

Date

We have reviewed this project and agree it meets minimum requirements.

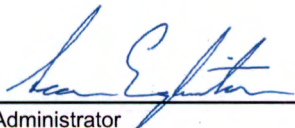

Permit Administrator

11/5/2025

Date

Notice to Purchaser - In the event that this check is lost, misplaced or stolen, a sworn statement and 90-day waiting period will be required prior to replacement. This check should be negotiated within 90 days.

Void After 90 Days

30-1/1140

Date 11/05/25 10:51:01 AM

NTX

SILVERLAKE

774 0000177 032

Pay

 **BANK OF AMERICA** **5000.00**
FIVE ZERO ZERO ZERO ZERO ZERO ZERO

****\$5,000.00****

****Five Thousand and 00/100 Dollars****

To The Order Of **FORT BEND COUNTY**

MEMO: PROJECT 2025-79826 FOR PERFORMANCE BOND

Remitter (Purchased By): **RODOLFO MARTIN LOPEZ JR**

Bank of America, N.A.
SAN ANTONIO, TX

AUTHORIZED SIGNATURE

⑈ 6 1 1 6 7 0 5 8 6 5 ⑈

00-53-3364B 06-2019

Front

Electronic Credit

Cadence Bank

Deposit Number:

Processing Date: 2025-11-25 Deposit Amount: \$ 5000.00

Customer Name: Fort Bend County

Description: 11-25-2025

Online User ID: JefCarFor2

Deposit made to: 886 CC Registry

001

12

Back

For Deposit Only
Fort Bend County
886 CC Registry
2025-11-25 13:37
Batch 500262089



Report Generated: 11-26-2025 11:20:26 AM

Order Details

Confirmation Number: 11643083
Transaction Status: Pending Processing
From Account:
Transaction Type: Contribution
Method: ACH
Amount: \$5,000.00
Internal Memo:
To Account:
To Account Name: CCM2025-79826-RODOLFO LOPEZ JR
To Fund Name: Texas CLASS
Trade Date: 11/26/2025
Settlement Date: 11/28/2025
Entered By: jeff.carter
Approved By: N/A

DEPOSIT

PERMIT #

2025-79826

STYLE:

Rodolfo Martin Lopez Jr

NAME PUT INTO TEXAS CLASS AS:

**CCM2025-79826-RODOLFO
LOPEZ JR**

TEXAS CLASS ACCOUNT NUMBER

DEPOSIT AMOUNT:

\$5,000.00

DATE RECEIVED:

11/24/2025

DATE TRANSFERRED TO TEXAS CLASS:

11/28/2025

J:\1704\1601\Fort Bend County Standards\Fort Bend County STD\DONE\FBC CONCRETE PAVEMENT DETAILS\CONCRETE_PAVEMENT_DETAILS-1of2.dwg

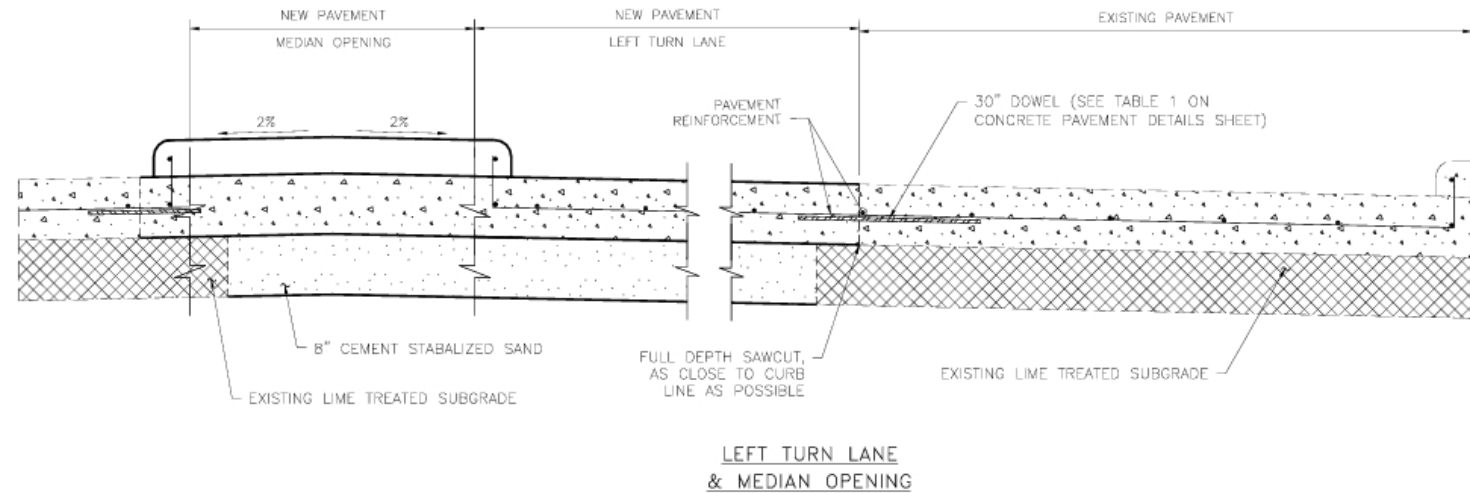
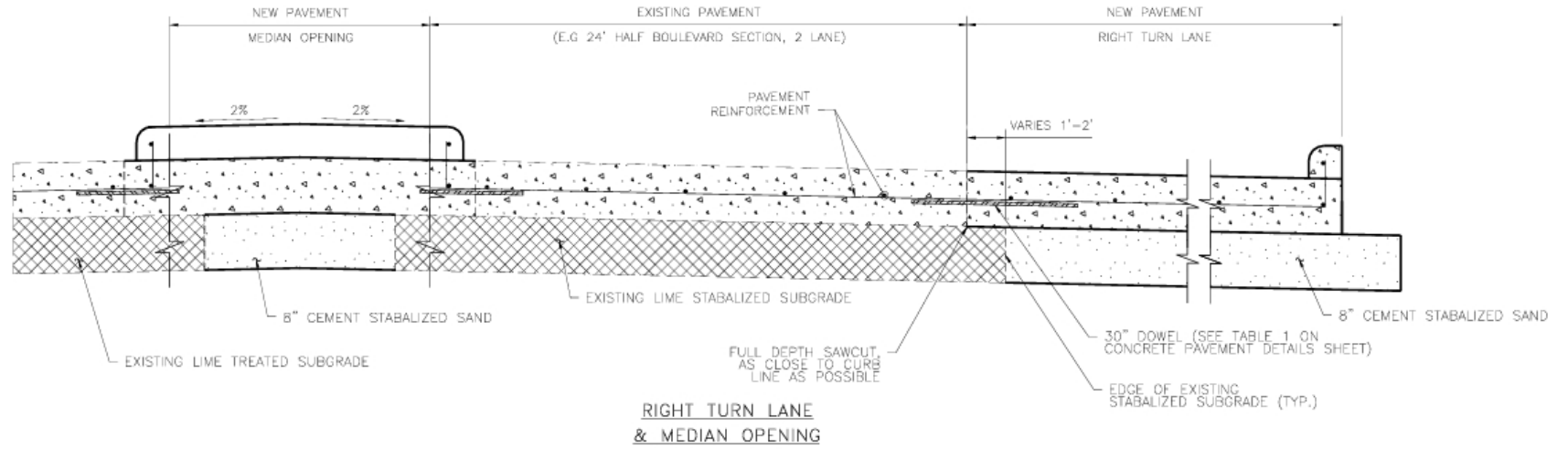
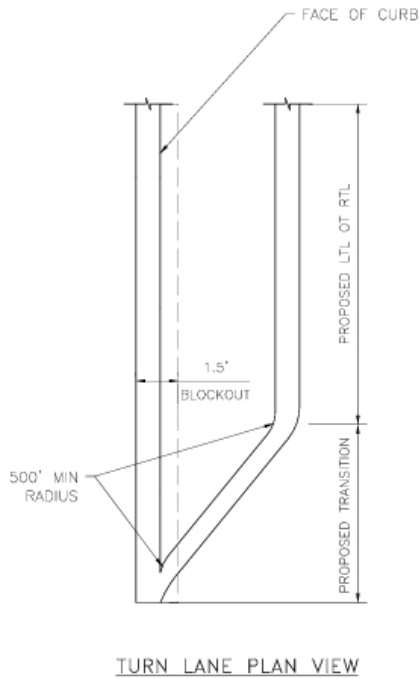

NOTES

1. FOR CONCRETE PAVEMENT REINFORCEMENT AND JOINT DETAILS, SEE CONCRETE PAVEMENT DETAILS SHEET
2. ALL TURN LANE AND MEDIAN OPENINGS SHALL HAVE THE SAME SURFACE AS THE EXISTING STREET.

NO.	REVISIONS	DATE	NAME
▲	ORIGINAL STANDARD ISSUED	3-1-22	RJS
▲	ADDED NOTE 2	10-1-24	RJS
▲			
▲			

FORT BEND COUNTY
ENGINEERING DEPARTMENT



PROJECT TITLE:		FBCD STANDARD
DRAWN BY: INIT	SHEET DESCRIPTION: TURN LANE & MEDIAN OPENING DETAIL	08
CK'D BY: INIT		SHEET NO: /
SCALE: AS NOTED	APPROVED BY:	
DATE: 10-1-24		

J:\170A\1601\Fort Bend County Standards\Fort Bend County STD\DONE\FBC CONCRETE PAVEMENT DETAILS\CONCRETE_PAVEMENT_DETAILS-1of2.dwg

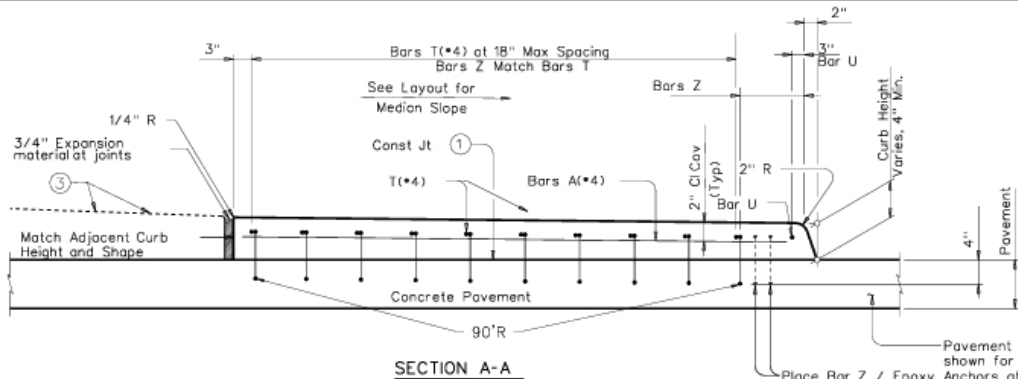

SECTION A-A

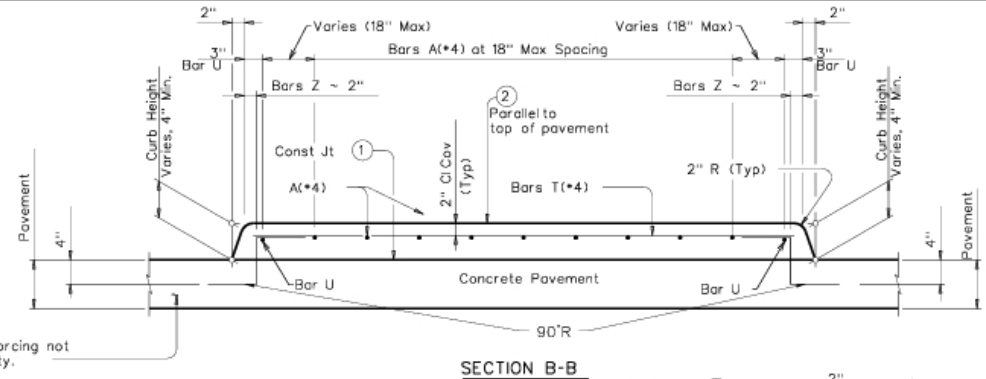

SECTION B-B

- ① Provide broom finish to top of pavement where raised median area is defined.
- ② Unless noted otherwise on the pavement details.
- ③ Unless otherwise directed, place concrete riprap over pavement or base. If not over pavement or base, place sod or seed.

Place Bar Z / Epoxy Anchors at 24" max spacing along Bar U as needed.

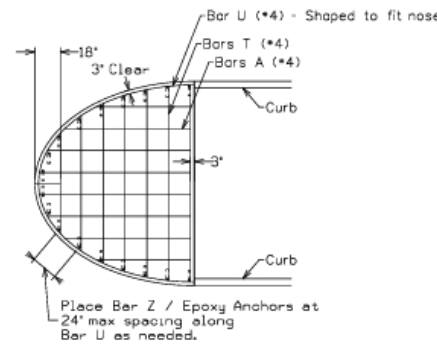

REINFORCING

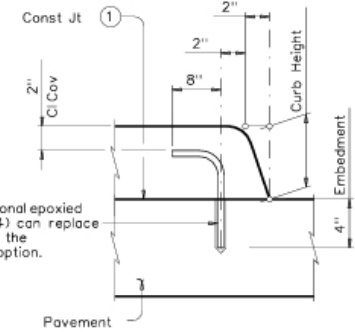

OPTIONAL EPOXY ANCHORS

Embed EA(*4) bar into concrete with a Type III (Class C) epoxy meeting the requirements of DMS-6100, "Epoxy and Adhesives". Follow manufacturer's directions for installing the epoxied anchor bars.

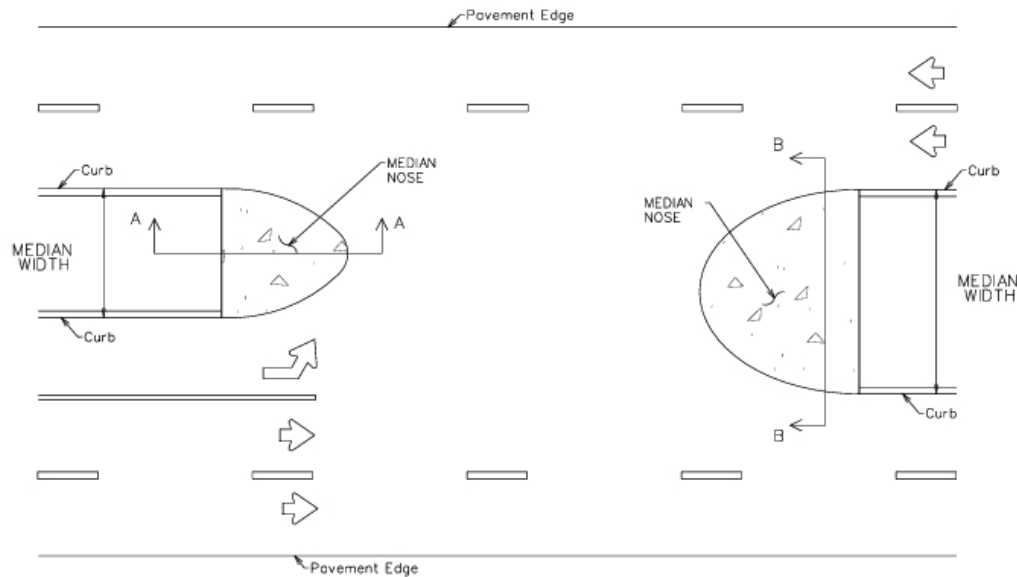

PLAN

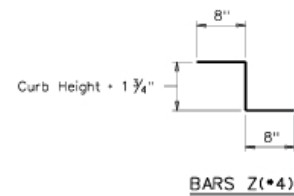

BARS Z(*4)

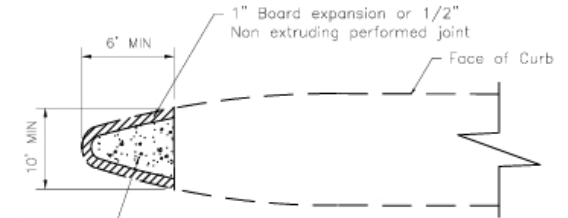

ESPLANADE NOSE

6" Reinforced concrete walk colored black on concrete pavement (uncolored on asphalt surface)

MATERIAL NOTES:

Provide Grade 60 reinforcement. Welded wire reinforcement (WWR) meeting ASTM A497 of equivalent size and spacing may be substituted for Bars A and Bars T.

Epoxy coat reinforcement if pavement reinforcement is required to be epoxy coated.

DESIGNER NOTES:

Provide Median Slope in Design Layouts.

GENERAL NOTES:

1. Medians with widths less than 6' back to back, and the first 6' from median nose, shall be paved colored block.
2. For medians with bullet nose configuration, paint curb with yellow reflectorized paint around the esplanade nose to the PT of the 90' radius. For medians without bullet nose configurations, paint curb from PC to PT and 30' back of PC/PT.
3. Median noses shall be governed by HC item 528 "Colored Concrete for Median Noes".

NO.	REVISIONS	DATE	NAME
▲	ORIGINAL STANDARD ISSUED	10-1-24	RJS
▲			
▲			
▲			

FORT BEND COUNTY
ENGINEERING DEPARTMENT



PROJECT TITLE:			FBCD STANDARD
DRAWN BY:	INIT		09
CK'D BY:	INIT	SHEET DESCRIPTION: MEDIAN NOSE DETAIL	
SCALE:	AS NOTED		SHEET NO:
DATE:	10-1-24	APPROVED BY:	/

J:\170A\1601\Fort Bend County Standards\Fort Bend County Standards\FBC DRIVEWAY DETAILS FOR MAJOR ROADWAY CONSTRUCTION\DRIVEWAY_DETAILS_FOR_MAJOR_ROADWAY_CONSTRUCTION.dwg

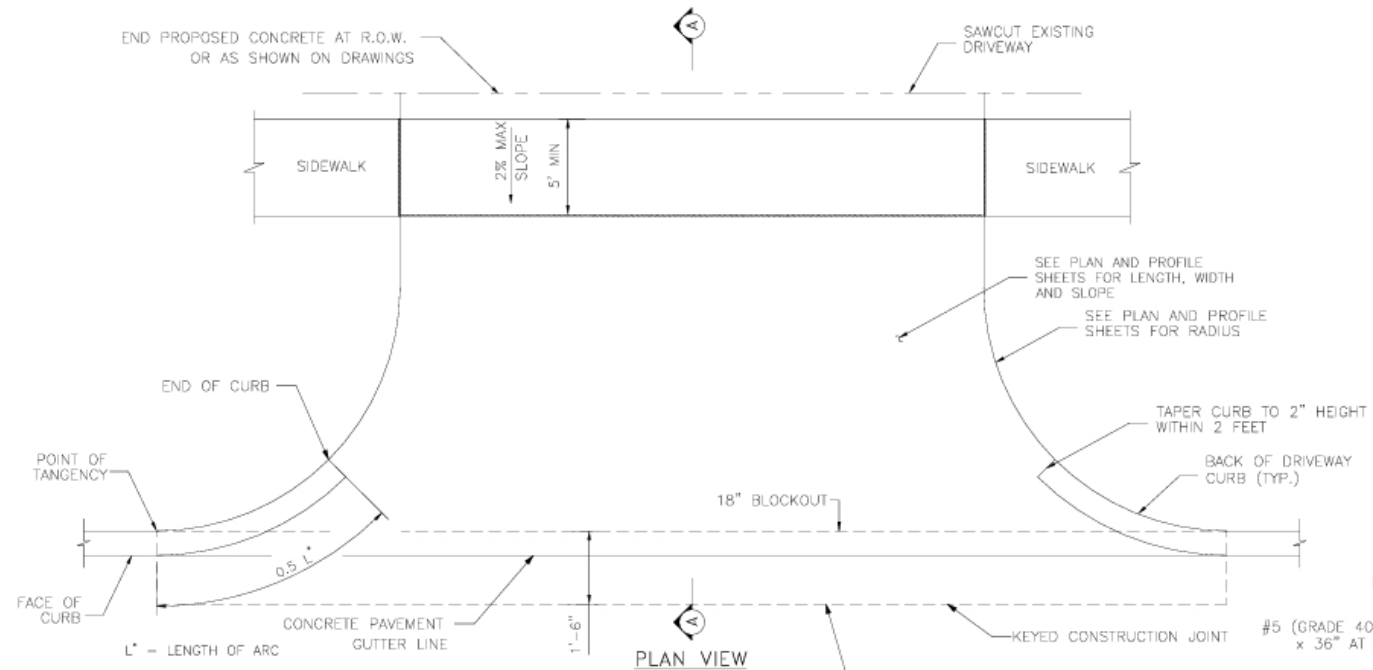

PLAN VIEW

NOTES:

1. SAWCUT EXISTING DRIVEWAY AT R.O.W. LINE OR AS SHOWN ON DRAWING AND REMOVE EXISTING DRIVEWAY TO SAWCUT LINE.
2. IF THERE IS EXISTING CURB ON DRIVEWAY, CONNECT PROPOSED CURB TO EXISTING CURB; OTHERWISE TAPER CURB HEIGHT AS SHOWN.
3. SEE PAVEMENT DETAIL SHEET FOR CONCRETE CURB REINFORCEMENT.
4. THIS DRIVEWAY INSTALLATION IS GOVERNED BY HARRIS COUNTY ITEM 360 AND 400.
5. DRIVEWAY WIDTHS ARE MEASURED AT THE ROW LINE
6. CULVERTS GREATER THAN 50' IN LENGTH REQUIRE CLEANOUT OR MANHOLE
7. ALL DRIVEWAYS CONNECTIONS SHALL HAVE THE SAME SURFACE AS THE EXISTING OR PROPOSED STREET

MINIMUM RADII REQUIREMENTS - DRIVEWAYS

	LOCAL	COLLECTOR	MAJOR
RESIDENTIAL	5'	5'	-
COMMERCIAL	10'	10'	25'

DRIVEWAY WIDTHS

	MINIMUM	MAXIMUM
RESIDENTIAL	10'	25'
COMMERCIAL	20'	40'

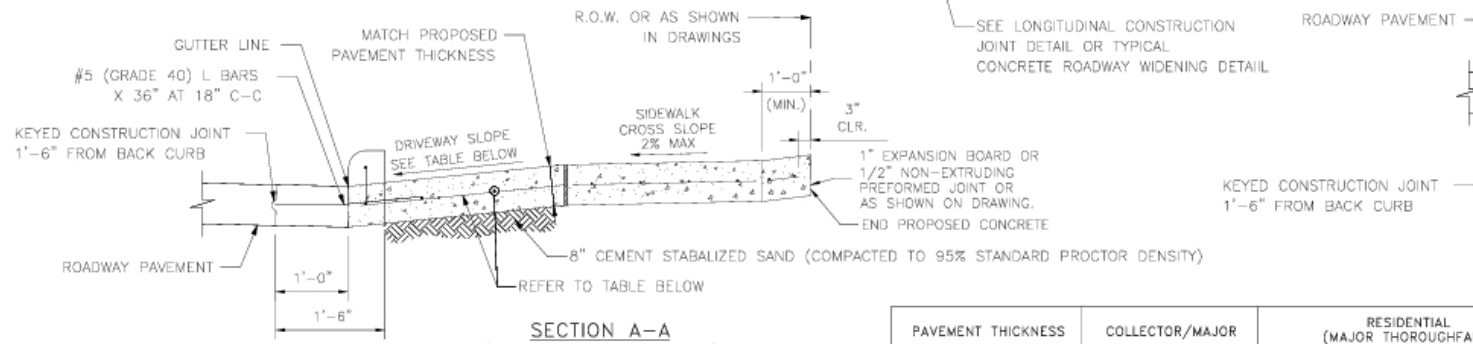

SECTION A-A
(DRIVEWAY SLOPES TO ROADWAY)

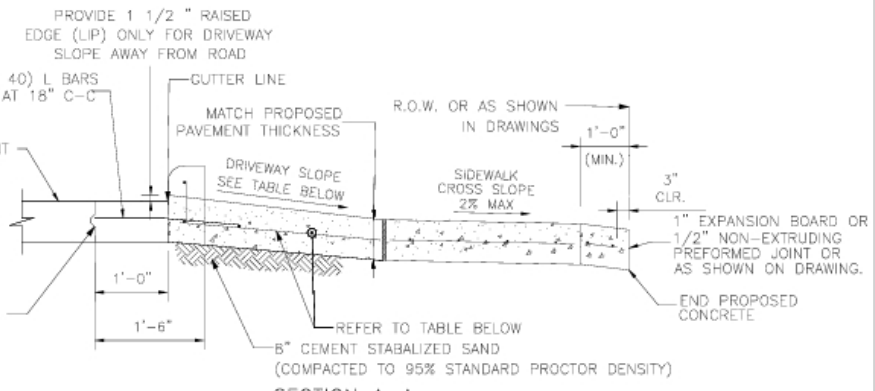

SECTION A-A
(DRIVEWAY SLOPES AWAY FROM ROADWAY)

	PAVEMENT THICKNESS	COLLECTOR/MAJOR	RESIDENTIAL (MAJOR THOROUGHFARE)	RESIDENTIAL (COLLECTORS AND LOCAL STREETS)
REINFORCEMENT	6"	#4 @ 24" O.C.E.W.	N/A	#4 @ 24" O.C.E.W.
	7"	#4 @ 24" O.C.E.W.	#4 @ 24" O.C.E.W.	#4 @ 24" O.C.E.W.
	8"	#4 @ 18" O.C.E.W.	#4 @ 18" O.C.E.W.	#4 @ 18" O.C.E.W.
	9"-10"	#5 @ 18" O.C.E.W.	#5 @ 18" O.C.E.W.	#5 @ 18" O.C.E.W.
EXPANSION DOWEL JOINT	6"	3/4" DIA. SMOOTH BAR	3/4" DIA. SMOOTH BAR	3/4" DIA. SMOOTH BAR
	7"	1" DIA. SMOOTH BAR	1" DIA. SMOOTH BAR	1" DIA. SMOOTH BAR
	8"	1" DIA. SMOOTH BAR	1" DIA. SMOOTH BAR	1" DIA. SMOOTH BAR
CONSTRUCTION JOINT DOWEL	9"-10"	1 1/4" DIA. SMOOTH BAR	1 1/4" DIA. SMOOTH BAR	1 1/4" DIA. SMOOTH BAR
	ALL	#5 REBAR	#5 REBAR	#5 REBAR
SUBGRADE	ALL	8" CEMENT-STABILIZED SAND	2" BANK SAND (DEVELOPER/PRIVATE) 8" CEMENT STABILIZED SAND (MOBILITY)	2" BANK SAND (DEVELOPER/PRIVATE) 8" CEMENT STABILIZED SAND (MOBILITY)
	DRIVEWAY SLOPE	ALL	2% TO 4%	2% TO 10%*

*10% ALLOWABLE ON PRIVATELY CONSTRUCTED PROJECTS
6% MAX ON PUBLIC PROJECTS

NO.	REVISIONS	DATE	NAME
1	ORIGINAL STANDARD ISSUED	3-1-22	RJS
2	ADDED NOTE 6 & REVISED NOTE 4	3-1-23	RJS
3	ADDED NOTE 7 & UPDATED TABLE	10-1-24	RJS

FORT BEND COUNTY
ENGINEERING DEPARTMENT



PROJECT TITLE:		FBCD STANDARD
DRAWN BY:	INIT	11
CXD BY:	INIT	SHEET NO:
SHEET DESCRIPTION:		/
SCALE:		
1"=1'-6"		
DATE:	APPROVED BY:	
10-1-24		

J:\1704\1601\Fort Bend County Standards\Fort Bend County STD\DONE\FBC SUBDIVISION DRIVEWAY DETAILS\SUBDIVISION_DRIVEWAY_DETAILS.dwg

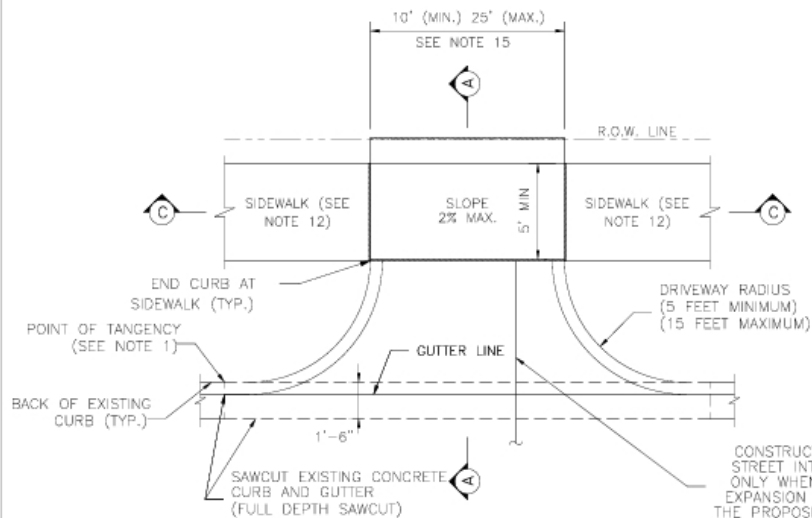

DRIVEWAY AT 6" CONCRETE CURB

SCALE: 1" = 3'-0"

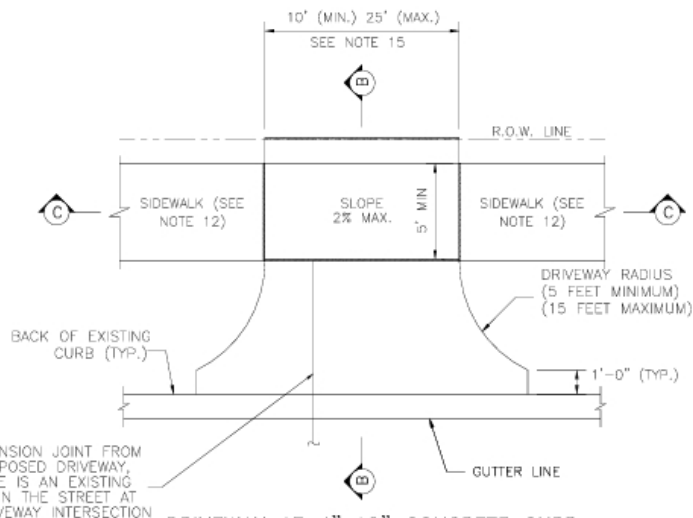

DRIVEWAY AT 4"x12" CONCRETE CURB

(IN RESIDENTIAL AREAS)
SCALE: 1" = 3'-0"

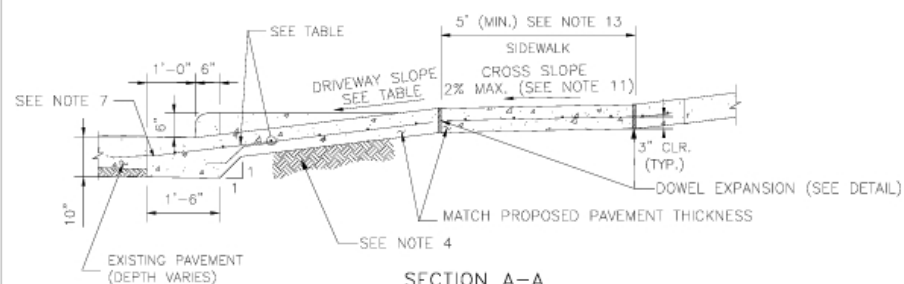

SECTION A-A

SCALE: 1" = 1'-6"

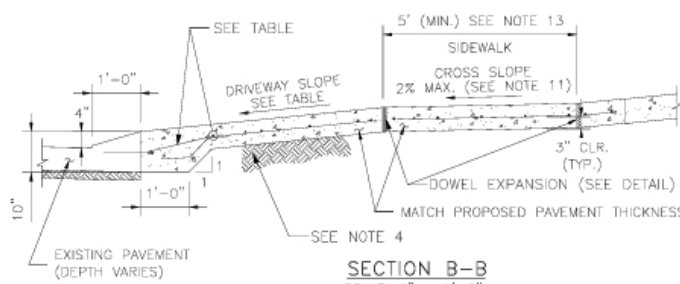

SECTION B-B

SCALE: 1" = 1'-6"

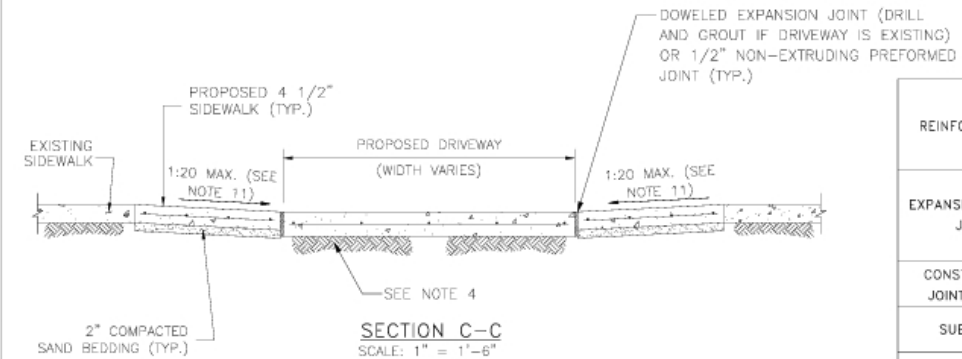

SECTION C-C

SCALE: 1" = 1'-6"

NOTES:

1. PROPOSED DRIVEWAY AT 6" CONCRETE CURB SHALL MATCH EXISTING CURB AT POINT OF TANGENCY.
2. PROPOSED DRIVEWAY SHALL BE BUILT WITH PORTLAND CEMENT CONCRETE, 5 1/2 SACK CEMENT MINIMUM PER CUBIC YARD. 3,500 PSI STRENGTH AT 28 DAYS. THIS DRIVEWAY INSTALLATION IS GOVERNED BY HARRIS COUNTY ITEM 400 AND 360.
3. COMPACTION OF SUBGRADE TO 95% OF STANDARD PROCTOR DENSITY (ASTM D698) ($\pm 2\%$ OPTIMUM MOISTURE) FOR PROPOSED DRIVEWAY CONNECTION. THE COUNTY ENGINEER RESERVES THE RIGHT TO INSPECT AND REQUIRE LABORATORY TEST TO BE CONDUCTED.
4. FOR COMMERCIAL DRIVEWAYS, USE 8" OF COMPACTED CEMENT STABILIZED SAND. FOR RESIDENTIAL DRIVEWAYS, USE 2" OF COMPACTED BANK SAND.
5. A PROPOSED DRIVEWAY TO BE BUILT ON A CORNER LOT CANNOT BE LOCATED WITHIN ANY PORTION OF THE PUBLIC STREET CURB RADIUS (THE POINTS OF TANGENCY MAY BE THE SAME POINT ALONG THE STREET CURB LINE)
6. PROPOSED DRIVEWAY REINFORCING STEEL SHALL BE TIED TO EXISTING CONCRETE PAVEMENT WITH A MINIMUM LAP OF 16 INCHES.
7. IF EXISTING STREET REBAR IS CUT OFF, THEN #4 DOWEL BARS (18" LONG) NEED TO BE INSTALLED AT 24" SPACING, EMBEDDED 9 INCHES AND EPOXIED OR MATCH EXISTING SPACING IF TIGHTER.
8. 3" NON-METALLIC CHAIRS ARE REQUIRED.
9. FOR CAPITAL IMPROVEMENT PROJECTS, THE SUBGRADE SHALL BE STABILIZED ACCORDING TO THE GEOTECHNICAL REPORT RECOMMENDATIONS. SAW AND SEAL ALL CONSTRUCTION JOINTS.
11. SIDEWALK SLOPES SHALL COMPLY WITH THE TEXAS ACCESSIBILITY STANDARDS 403.3 "SLOPE"
12. IF SIDEWALK IS EXISTING, SEE SECTION C-C.
13. SIDEWALKS MAY BE REDUCED TO 4' IN FRONT OF SINGLE-FAMILY RESIDENTIAL LOTS WHEN A 5' PASSING AREA IS PROVIDED IN THE DRIVEWAY.
14. FOR SIDEWALK DETAILS SEE SIDEWALK DETAILS SHEET
15. DRIVEWAY WIDTHS ARE MEASURED AT THE ROW LINE
16. CULVERTS GREATER THAN 50' IN LENGTH REQUIRE CLEANOUT OR MANHOLE
17. ALL DRIVEWAYS SHALL HAVE THE SAME SURFACE AS THE EXISTING OR PROPOSED STREET.

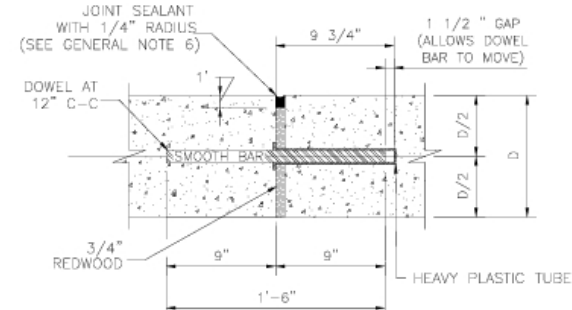

DOWEL TYPE EXPANSION JOINT

SCALE: 1" = 12"

	PAVEMENT THICKNESS	COLLECTOR/MAJOR	RESIDENTIAL (MAJOR THOROUGHFARE)	RESIDENTIAL (COLLECTORS AND LOCAL STREETS)
REINFORCEMENT	6"	#4 @ 24" O.C.E.W.	N/A	#4 @ 24" O.C.E.W.
	7"	#4 @ 24" O.C.E.W.	#4 @ 24" O.C.E.W.	#4 @ 24" O.C.E.W.
	8"	#4 @ 18" O.C.E.W.	#4 @ 18" O.C.E.W.	#4 @ 18" O.C.E.W.
	9"-10"	#5 @ 18" O.C.E.W.	#5 @ 18" O.C.E.W.	#5 @ 18" O.C.E.W.
EXPANSION DOWEL JOINT	6"	3/4" DIA. SMOOTH BAR	3/4" DIA. SMOOTH BAR	3/4" DIA. SMOOTH BAR
	7"	1" DIA. SMOOTH BAR	1" DIA. SMOOTH BAR	1" DIA. SMOOTH BAR
	8"	1" DIA. SMOOTH BAR	1" DIA. SMOOTH BAR	1" DIA. SMOOTH BAR
	9"-10"	1 1/2" DIA. SMOOTH BAR	1 1/2" DIA. SMOOTH BAR	1 1/2" DIA. SMOOTH BAR
CONSTRUCTION JOINT DOWEL	ALL	#5 REBAR	#5 REBAR	#5 REBAR
SUBGRADE	ALL	8" CEMENT-STABILIZED SAND	2" BANK SAND (DEVELOPER/PRIVATE) 8" CEMENT STABILIZED SAND (MOBILITY)	2" BANK SAND (DEVELOPER/PRIVATE) 8" CEMENT STABILIZED SAND (MOBILITY)
	DRIVEWAY SLOPE	ALL	2% TO 4%	2% TO 10%*

*10% ALLOWABLE ON PRIVATELY CONSTRUCTED PROJECTS
6% MAX ON PUBLIC PROJECTS

NO.	REVISIONS	DATE	NAME
1	ORIGINAL STANDARD ISSUED	3-1-22	RJS
2	ADDED NOTE 16 & REVISED NOTE 2	3-1-23	RJS
3	ADDED NOTE 17 & UPDATED TABLE	10-1-24	RJS

FORT BEND COUNTY
ENGINEERING DEPARTMENT



PROJECT TITLE:			FBCD STANDARD
DRAWN BY: INIT	SHEET DESCRIPTION: DRIVEWAY DETAILS FOR		
CR'D BY: INIT	AS NOTED		12
SCALE:	APPROVED BY:		SHEET NO.:
DATE: 10-1-24			/

J:\1704\1601\Fort Bend County Standards\Fort Bend County STD\DONE\FBC SUBDIVISION DRIVEWAY DETAILS\DRIVEWAY_DETAILS.dwg

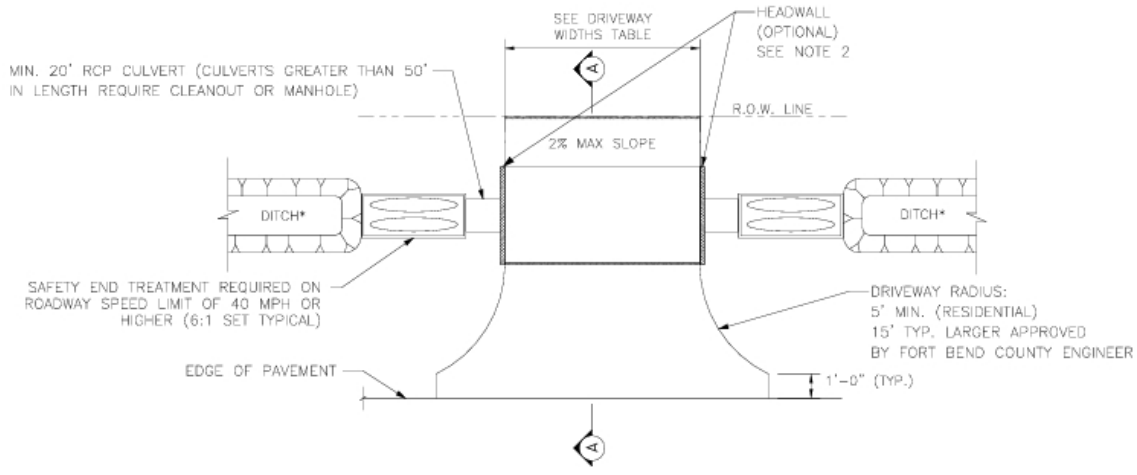

OPEN DITCH DRIVEWAY
*DITCH IS TO HAVE 4:1 SLOPE

MINIMUM RADII REQUIREMENTS - DRIVEWAYS

	LOCAL	COLLECTOR	MAJOR
RESIDENTIAL	5'	5'	-
COMMERCIAL	10'	10'	25'

DRIVEWAY WIDTHS*

	MINIMUM	MAXIMUM
RESIDENTIAL	10'	25'
COMMERCIAL	20'	40'

*DRIVEWAY WIDTHS ARE MEASURED AT THE ROW LINE

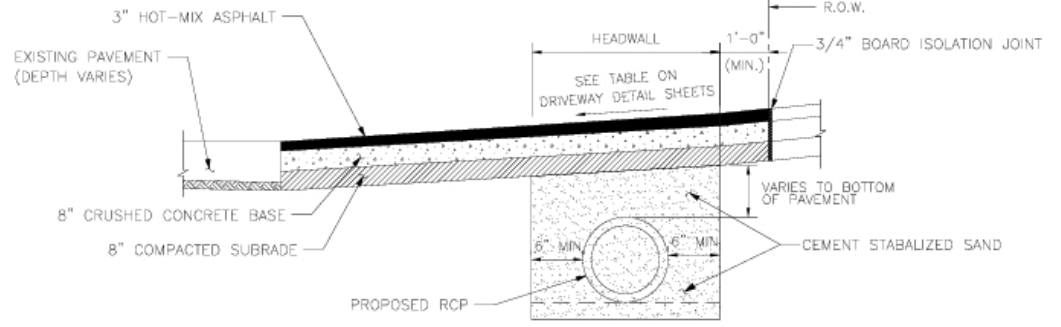

SECTION A-A FOR RESIDENTIAL DRIVEWAYS

NOTES:

1. MAINTAIN A MIN. OF 6" BETWEEN DRIVEWAY AND CULVERT
2. HEADWALLS ARE ONLY ALLOWED ON ROADWAYS WITH POSTED SPEED LIMITS OF 35 MPH OR LESS
3. ALL DRIVEWAY CONNECTIONS SHALL HAVE THE SAME SURFACE AS THE EXISTING OR PROPOSED STREET.

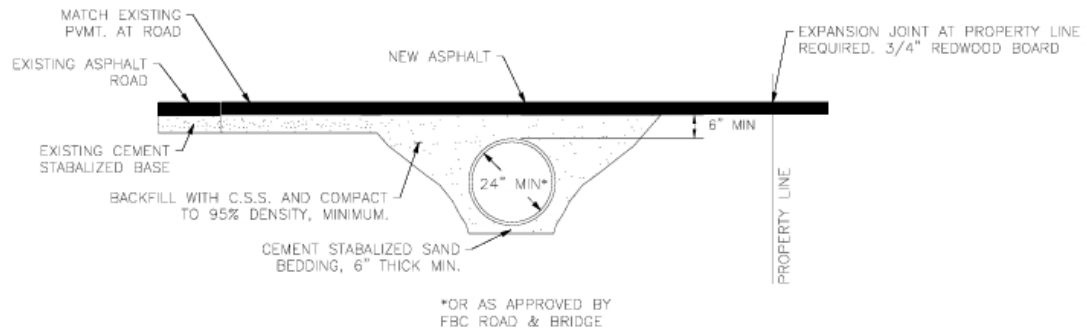

ASPHALT APRON DETAIL - DRIVEWAY PROFILE FOR CULVERT DRAINAGE

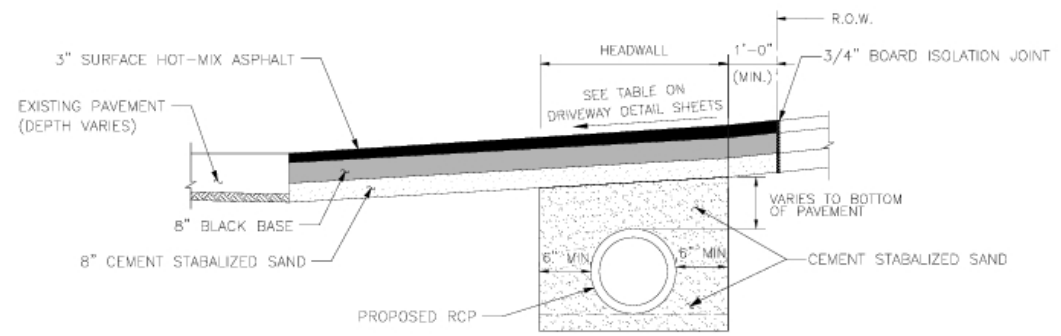

SECTION A-A FOR COMMERCIAL DRIVEWAYS

NO.	REVISIONS	DATE	NAME
1	ORIGINAL STANDARD ISSUED	3-1-22	RJS
2	UPDATED SECTION DETS. & NOTES 2 & 3	10-1-24	RJS
3			
4			

FORT BEND COUNTY
ENGINEERING DEPARTMENT



PROJECT TITLE:		FBCD STANDARD
DRAWN BY:	INIT	
CHK'D BY:	INIT	SHEET NO. /
SHEET DESCRIPTION: ASPHALT DRIVEWAY DETAILS		
SCALE:	AS NOTED	
DATE:	10-1-24	
APPROVED BY:		

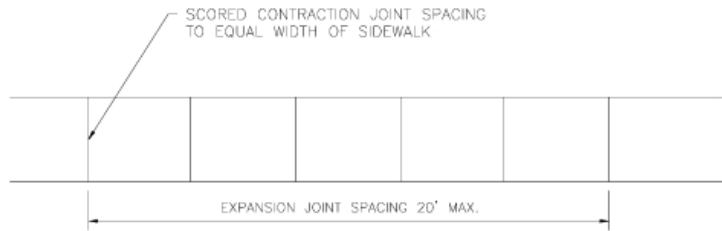

SIDEWALK JOINT DETAILS

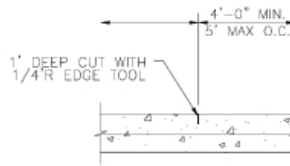
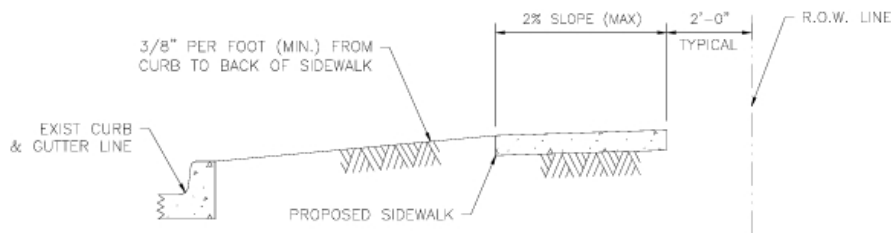

CONTRACTION JOINT SEAL

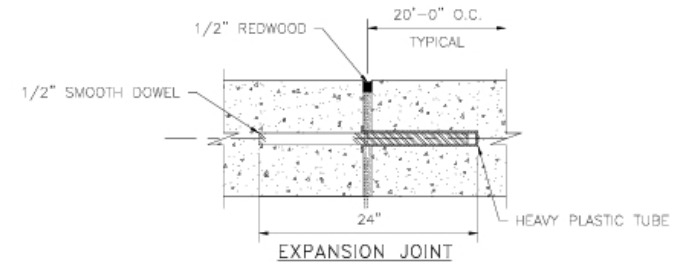

EXPANSION JOINT

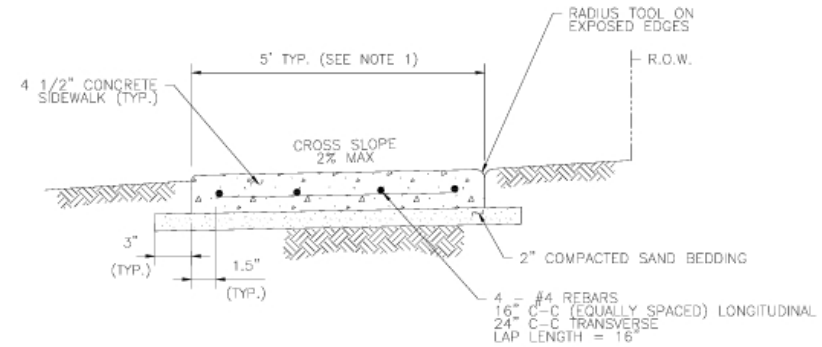

SIDEWALK CROSS SECTION

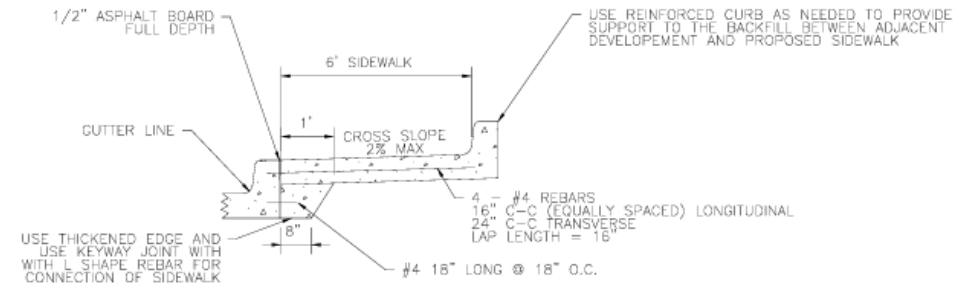

6' SIDEWALK DETAIL*

*REQUIRES PRIOR COUNTY APPROVAL

NOTES:

1. TYPICAL SIDEWALK WIDTH IS 5'. SIDEWALKS OF 4' WIDTH ARE ALLOWED IN FRONT OF SINGLE FAMILY HOMES IF ALL DRIVEWAYS PROVIDE A 5' AREA FOR PASSING. SIDEWALKS OF 4' WITH 5' X 5' PASSING ZONES MUST BE SPECIFICALLY APPROVED BY FORT BEND COUNTY.
2. THE MAXIMUM WIDTH BETWEEN EXPANSION JOINTS SHALL NOT EXCEED 20'-0"
3. EXPANSION JOINT IS TO BE 1/2" THICK CLEAR HEART REDWOOD WITH DOWELS
4. SCORED CONTRACTION JOINTS SHALL BE EVERY 5' OR EQUAL TO SIDEWALK WIDTH
5. ALL EARTHEN AREAS ARE TO BE SODED UNLESS SHOWN OTHERWISE ON DRAWINGS.
6. SIDEWALKS ARE TO BE REINFORCED CONCRETE (3500 PSI) WITH #4 BARS, 16" C-C LONGITUDINAL, AND 18" C-C TRANSVERSE. SIDEWALKS NOT 5' IN WIDTH SHALL BE CONSTRUCTED AS DIRECTED BY THE ENGINEER OF RECORD.
7. USE RADIUS TOOL ON ALL EXPOSED EDGES.
8. MEMBRANE CURING COMPOUND IS REQUIRED AS DESCRIBED IN ITEM 802 IN THE HARRIS COUNTY STANDARD SPECIFICATIONS FOR CONSTRUCTION
9. SIDEWALK EXPANSION JOINTS SHALL CONFORM TO STREET EXPANSION JOINT STANDARDS
10. 6' SIDEWALK TO BE USED WHEN SIDEWALK RUNS ALONG THE BACK OF CURB AS DESCRIBES IN THE FBC DESIGN MANUAL

NOTE:

BANK SAND IS DEFINED AS A WELL-GRADED SAND, FREE OF SILT, CLAY, LOAM, FRIABLE OR SOLUBLE MATERIALS AND ORGANIC MATTER, MEETING THE UNIFIED SOILS CLASSIFICATION SYSTEM GROUP SW CRITERIA W/ A PLASTICITY INDEX OF LESS THAN 10, AND NO MORE THAN 12% OF MATERIAL CAN PASS THE NO. 200 SIEVE.

J:\1703\Standard Sheets\DCN FORT BEND STANDARDS\Expansion Joints.dwg

NO.	REVISIONS	DATE	NAME
△	ORIGINAL STANDARD ISSUED	3-1-22	RJS
△	REVISED NOTE 6, 8, & CROSS SECTION DET.	3-1-23	RJS
△	ADD 6' SIDEWALK & REVISED SECT. DETS.	10-1-24	RJS
△			
△			

FORT BEND COUNTY
ENGINEERING DEPARTMENT



PROJECT TITLE:		
DRAWN BY:	INIT	FBCD STANDARD
DVD BY:	INIT	14
SHEET DESCRIPTION:		
SIDEWALK DETAILS		
SCALE:	AS NOTED	SHEET NO:
DATE:	10-1-24	/
APPROVED BY:		

J:\170A\1601\Fort Bend County Standards\Fort Bend County STD\DOONE\FBC STORM WATER POLLUTION PREVENTION PLAN DETAILS\FBC STORM WATER POLLUTION PREVENTION PLAN DETAILS.dwg

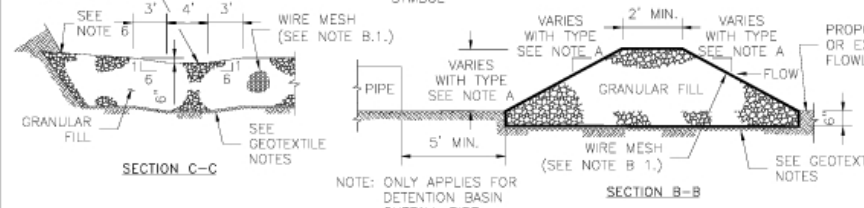
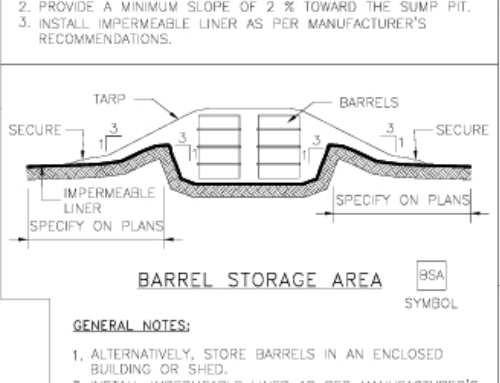
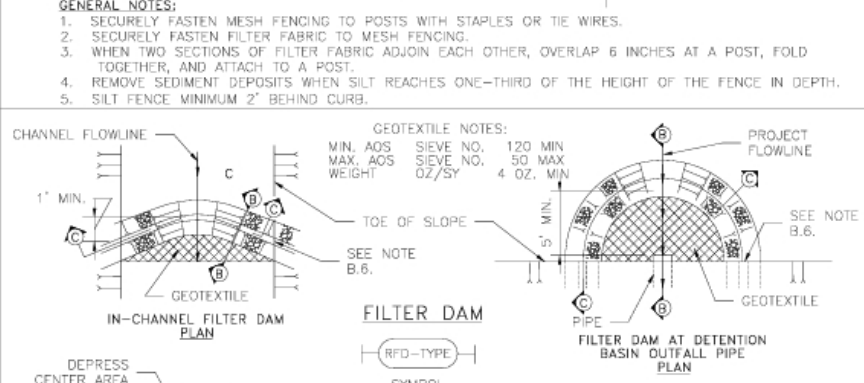
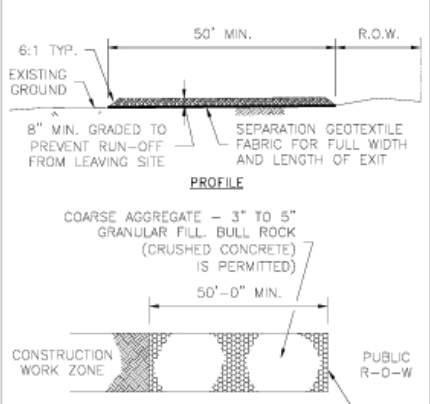
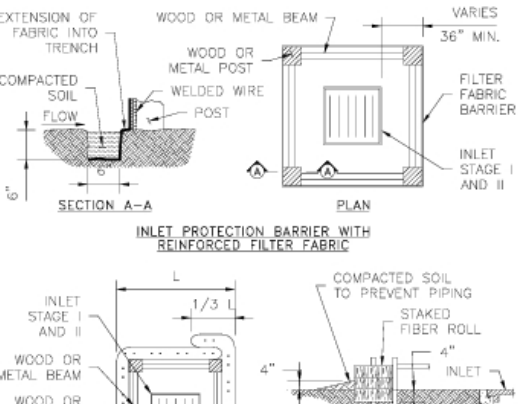
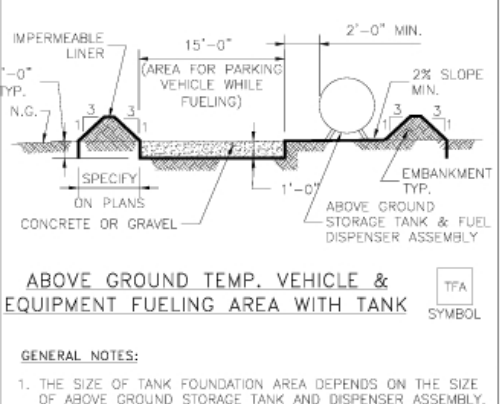
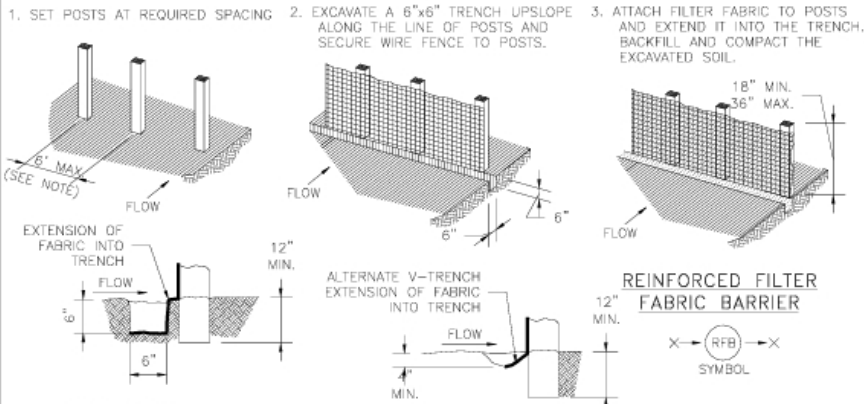

- A. TYPES OF FILTER DAMS
- TYPE 1 (NON-REINFORCED)
 - HEIGHT - 18-24 INCHES. MEASURE VERTICALLY FROM EXISTING GROUND TO TOP OF FILTER DAM.
 - TOP WIDTH - 2 FEET (MINIMUM)
 - SLOPES - 2:1 (MAXIMUM).
 - TYPE 2 (REINFORCED).
 - HEIGHT - 18-36 INCHES. MEASURE VERTICALLY FROM EXISTING GROUND TO TOP OF FILTER DAM.
 - TOP WIDTH - 2 FEET (MINIMUM).
 - SLOPES - 2:1 (MAXIMUM).
 - TYPE 3 (REINFORCED)
 - HEIGHT - 36-48 INCHES. MEASURE VERTICALLY FROM EXISTING GROUND TO TOP OF FILTER DAM.
 - TOP WIDTH - 2 FEET (MINIMUM).
 - SLOPES - 3:1 (MAXIMUM).
 - TYPE 4 (GABION)
 - HEIGHT - 30 INCHES (MINIMUM). MEASURE VERTICALLY FROM EXISTING GROUND TO TOP OF FILTER DAM.
 - TOP WIDTH - 2 FEET (MINIMUM).
 - TYPE 5. AS SHOWN ON THE PLANS.
- B. CONSTRUCT FILTER DAMS ACCORDING TO THE FOLLOWING CRITERIA UNLESS SHOWN OTHERWISE ON THE PLANS.
- TYPE 2 AND 3 FILTER DAMS: SECURE WITH 20 GAUGE GALVANIZED WOVEN WIRE MESH WITH 1 INCH DIAMETER HEXAGONAL OPENINGS.
 - PLACE GRANULAR FILL ON THE WIRE MESH TO HEIGHT AND SLOPES SHOWN ON PLANS OR AS SPECIFIED BY THE ENGINEER.
 - 3-5 INCHES FOR ROCK FILTER DAM TYPES 1, 2 AND 4.
 - 4-8 INCHES FOR ROCK FILTER DAM TYPE REFER TO GRANULAR FILL IN SPECIFICATION SECTION No. 02378 RIPRAP AND GRANULAR FILL.
 - FOLD WIRE MESH AT UPSTREAM SIDE OVER GRANULAR FILL AND TIGHTLY SECURED TO ITSELF ON THE DOWNSTREAM SIDE USING WIRE TIES OR HOG RINGS.
 - IN STREAMS: SECURE OR STAKE MESH TO STREAM BED PRIOR TO AGGREGATE PLACEMENT.
 - SEE HCFD SPECIFICATION SECTION NO. 02364-FILTER DAMS.
 - EMBED ONE FOOT MINIMUM INTO SLOPE AND RAISE ONE FOOT HIGHER THAN CENTER OF DEPRESSED AREA AT SLOPE.

NO.	REVISIONS	DATE	NAME
1	ORIGINAL STANDARD ISSUED	3-1-22	RJS
2			
3			
4			

FORT BEND COUNTY
ENGINEERING DEPARTMENT



DRAWN BY: INIT
CHK'D BY: INIT
SCALE: NONE
DATE: 3-1-22

SHEET DESCRIPTION:
STORM WATER POLLUTION
PREVENTION PLAN DETAILS

APPROVED BY:

PROJECT TITLE:		FBCD STANDARD
DRAWN BY: INIT	SHEET DESCRIPTION: STORM WATER POLLUTION PREVENTION PLAN DETAILS	60
CHK'D BY: INIT	APPROVED BY:	SHEET NO: /
SCALE: NONE		
DATE: 3-1-22		