



**PERMIT APPLICATION REVIEW FORM FOR
CABLE, CONDUIT, AND POLE LINE ACTIVITY
IN FORT BEND COUNTY**

**Fort Bend County
Engineering Department**
301 Jackson Suite 401
Richmond, Texas 77469
281.633.7500
Permits@fortbendcountytexas.gov

- ☐ Right of Way Permit
☐ Commercial Driveway Permit

Permit No: 2025-78716

Applicant: Apex Multifamily Construction LLC/Langan Engineering & Environmental Services

Job Location Site: 1500 Andado Ln, Richmond, TX 77469

Bond No. **Date of Bond:** **Amount:** \$10,000.00

The above applicant came to make use of certain Fort Bend County property subject to, "The Order Regulating the Laying, Construction, Maintenance, and Repair of Buried Cables, Conduits, and Pole Lines, In, Under, Across or Along Roads, Streets, Highways, and Drainage Ditches in Fort Bend County, Texas, Under the Jurisdiction of the Commissioners Court of Fort Bend County, Texas," as passed by the Commissioners Court of Fort Bend County, Texas, of the Minutes of the Commissioners Court of Fort Bend County, Texas, to the extent that such order is not inconsistent with Chapter 181, Vernon's Texas Statutes and Codes Annotated.

Notes:

1. Evidence of review by the Commissioners Court must be kept on the job site and failure to do so constitutes grounds for job shutdown.
2. Written notices are required, via email, for certain construction activities in County right-of-way. Contact permits@fbctx.gov for a copy of the notification procedure applicable to your project.
3. This permit expires one (1) year from date of permit if construction has not commenced.
4. This permit applies to work performed within right-of-ways owned and maintained by Fort Bend County only, and it is the responsibility of the applicant to acquire all other necessary permits and permissions.

On this 24th day of June, 2025, Upon Motion of Commissioner Meyers, seconded by Commissioner Morales, duly put and carried, it is ORDERED, ADJUDGED AND DECREED that said notice of said above purpose is hereby acknowledged by the Commissioners Court of Fort Bend County, Texas, and that said notice be placed on record according to the regulation order thereof.

Signature

Presented to Commissioners Court and approved.

By: Sean Eglinton

Date Recorded 6.24.25 Comm. Court No. 10C

County Engineer

Clerk of Commissioners Court

N/A

By:

By: Aminda Willes

Drainage District Engineer/Manager

Deputy



**REVIEW BY FORT BEND COUNTY
COMMISSIONERS COURT**

**Fort Bend County
Engineering Department**
301 Jackson Suite 401
Richmond, Texas 77469
281.633.7500
Permits@fortbendcountytexas.gov

☐

Right of Way Permit

☐

Commercial Driveway Permit

Permit No: 2025-78716

The following "Notice of Proposed Cable, Conduit, and/or Pole Line activity in Fort Bend County" and accompanying attachments have been reviewed and the notice conforms to appropriate regulations set by Commissioner's Court of Fort Bend County, Texas.

(1) COMPLETE APPLICATION FORM:

- ☒ a. Name of road, street, and/or drainage ditch affected.
☒ b. Vicinity map showing course of directions
☒ c. Plans and specifications

(2) BOND:

- ☐ County Attorney, approval when applicable.
- ☐ Perpetual bond currently posted. Bond No: _____ Amount: _____
- ☐ Performance bond submitted. Bond No: _____ Amount: _____
- ☒ Cashier's Check Check No: [REDACTED] Amount: \$10,000.00

(3) DRAINAGE DISTRICT APPROVAL (WHEN APPLICABLE):

Drainage District Approval

Date

We have reviewed this project and agree it meets minimum requirements.



Permit Administrator

6/9/2025

Date

BANK OF AMERICA

Cashier's Check

No. 6279306442

Noted to Purchaser: In the event that this check is lost, misplaced or stolen, a return statement and 90-day waiting period will be required prior to replacement. This check should be negotiated within 90 days.

Void After 90 Days

10-1-1148

Date 05/30/25 03:38:51 PM

BUCKHEAD

765

0101028

062

Pay



BANK OF AMERICA



****\$10,000.00****

****Ten Thousand and 00/100 Dollars****

To The **PORT BEND COUNTY**
Order Of

Remitter (Purchased By): **APEX MULTIFAMILY CONSTRUCTION LLC**

Bank of America, N.A.
SAN ANTONIO, TX

2025-78711

Yasinta Zeeman
AUTHORIZED SIGNATURE

⑆00000⑆ ⑆6279306442⑆ ⑆0019⑆ ⑆2518⑆

THE ORIGINAL DOCUMENT HAS A REFLECTIVE WATERMARK ON THE BACK. HOLD AT AN ANGLE TO VIEW WHEN CHECKING THE ENDORSEMENTS.

Image Report



ABA Number
Account Number 3122
Amount \$10,000.00
Deposit Date 06/25/2025

Front

BANK OF AMERICA Cashier's Check No. 6279306442

Valid After 90 Days 30-1/11-30 N/A Date 06/25/2025 3:38:51 PM

BUCKHEAD
765 0101028 062

Pay **BANK OF AMERICA** **\$10,000.00** **\$10,000.00**

Ten Thousand and 00/100 Dollars
To The FORT BEND COUNTY
Order Of

Retain (Purchased By) API X MULTIFAMILY CONSTRUCTION LLC

Bank of America N.A.
SAN ANTONIO TX
2025-1811

6279306442 00191 2568

THE ORIGINAL DOCUMENT IS A REFLECTIVE VERNIER MARK ON THE BACK. HOLD AT AN ANGLE TO VIEW VERMILION CHECK NUMBER.

Back

094888174

www.bankofamerica.com

www.bankofamerica.com

www.bankofamerica.com

www.bankofamerica.com

www.bankofamerica.com

www.bankofamerica.com

FOR DEPOSIT ONLY
FORT BEND COUNTY
06/25/2025 3:38:51 PM
Batch 179243601

06-25-2025 3:38:51 PM
FORT BEND COUNTY
06/25/2025 3:38:51 PM
Batch 179243601

Front

Electronic Credit

Cadence Bank [REDACTED] 6291

Deposit Number: [REDACTED] 3691

Processing Date: 2025-06-25 Deposit Amount: \$ 10000.00

Customer Name: Fort Bend County

Description: 06-25-2025

Online User ID: JefCarFor2

Deposit made to: 886 CC Registry

001 [REDACTED] 1278 [REDACTED] 3122 12

Back

For Deposit Only
Fort Bend County
886 CC Registry
2025-06-25 10:42
512
Batch 479243691



Report Generated: 06-26-2025 09:19:41 AM

Order Details

Confirmation Number: 10811999
Transaction Status: Pending Processing
From Account: [REDACTED] ***3122
Transaction Type: Contribution
Method: ACH
Amount: \$10,000.00
Internal Memo:
To Account: [REDACTED] -6335
To Account Name: CCM2025-78716-APEX MULTIFAMILY
To Fund Name: Texas CLASS
Trade Date: 06/26/2025
Settlement Date: 06/27/2025
Entered By: jeff.carter
Approved By: N/A

DEPOSIT

PERMIT #

2025-78716

STYLE:

**Apex Multifamily Construction
LLC/Langan Engineering &
Environmental Services**

NAME PUT INTO TEXAS CLASS AS:

**CCM2025-78716-APEX
MULTIFAMILY**

TEXAS CLASS ACCOUNT NUMBER

██████████6335

DEPOSIT AMOUNT:

\$10,000.00

DATE RECEIVED:

6/24/2025

DATE TRANSFERRED TO TEXAS CLASS:

6/27/2025

J:\1704\1601\Fort Bend County Standards\Fort Bend County STD\DONE\FBC CONCRETE PAVEMENT DETAILS\CONCRETE_PAVEMENT_DETAILS-1of2.dwg

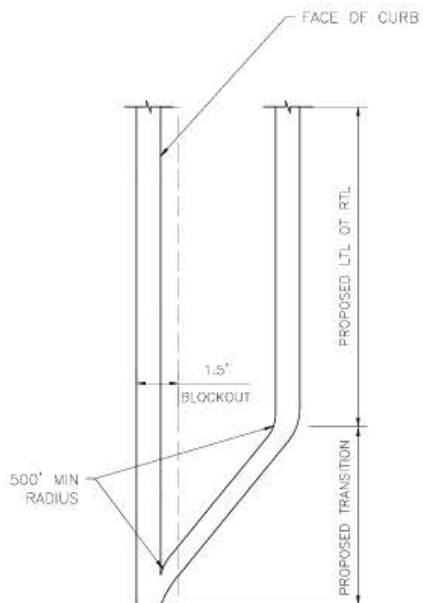

TURN LANE PLAN VIEW

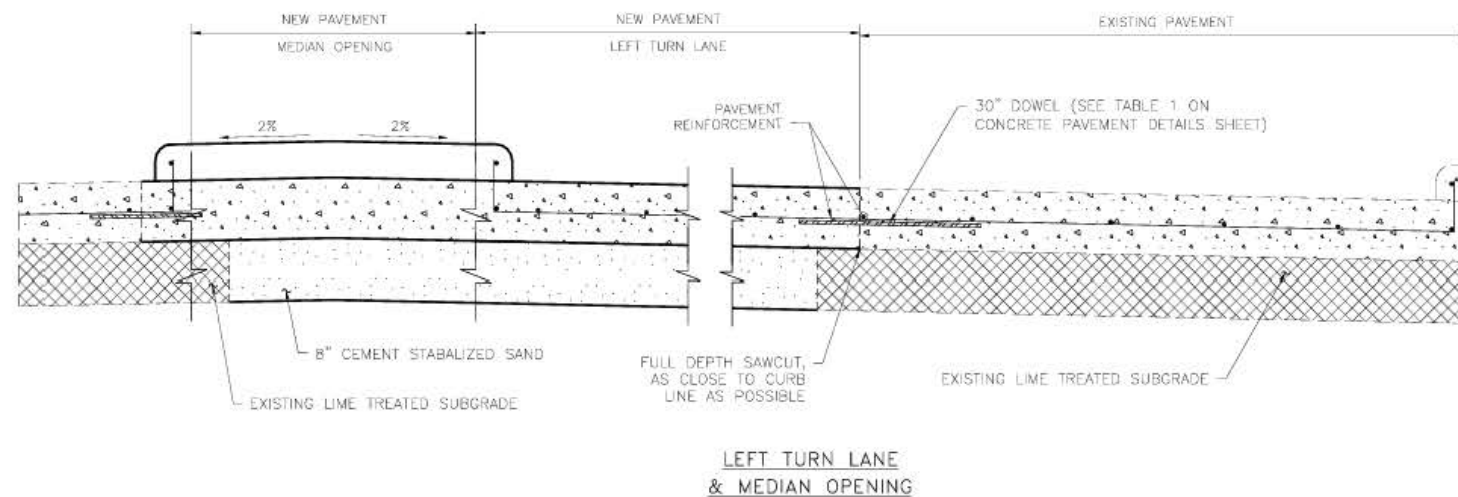
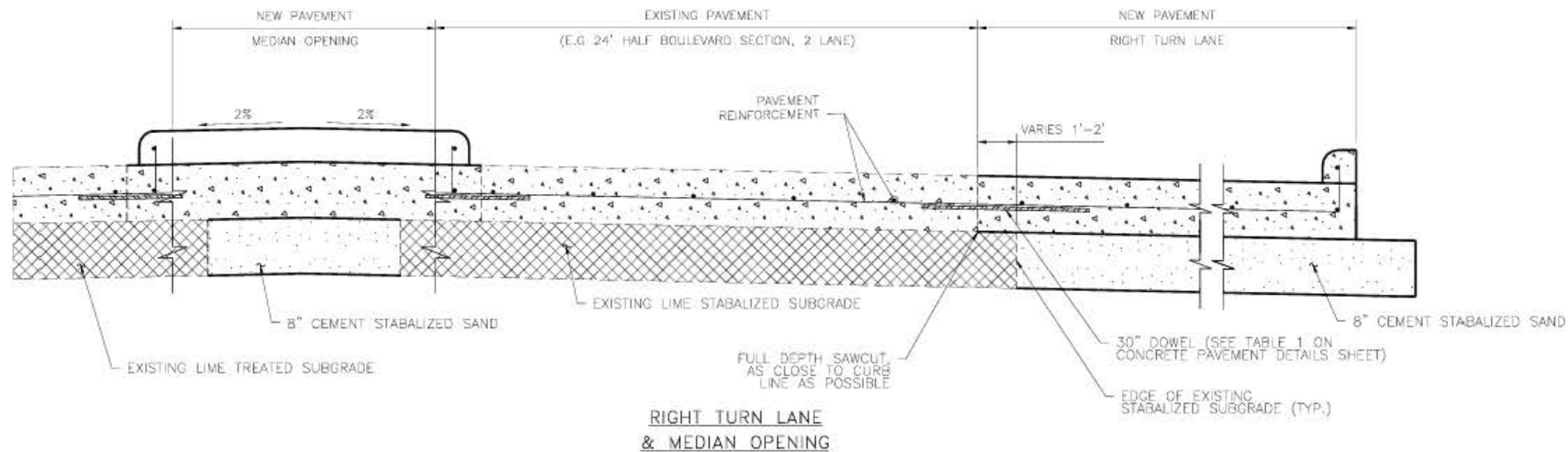

NOTES

1. FOR CONCRETE PAVEMENT REINFORCEMENT AND JOINT DETAILS, SEE CONCRETE PAVEMENT DETAILS SHEET.
2. ALL TURN LANE AND MEDIAN OPENINGS SHALL HAVE THE SAME SURFACE AS THE EXISTING STREET.

NO.	REVISIONS	DATE	NAME
1	ORIGINAL STANDARD ISSUED	3-1-22	RJS
2	ADDED NOTE 2	10-1-24	RJS
3			
4			
5			

FORT BEND COUNTY
ENGINEERING DEPARTMENT



PROJECT TITLE:			FBCD STANDARD
DRAWN BY:	INIT	SHEET DESCRIPTION: TURN LANE & MEDIAN OPENING DETAIL	08
CKD BY:	INIT		
SCALE:	AS NOTED	APPROVED BY:	SHEET NO: /
DATE:	10-1-24		

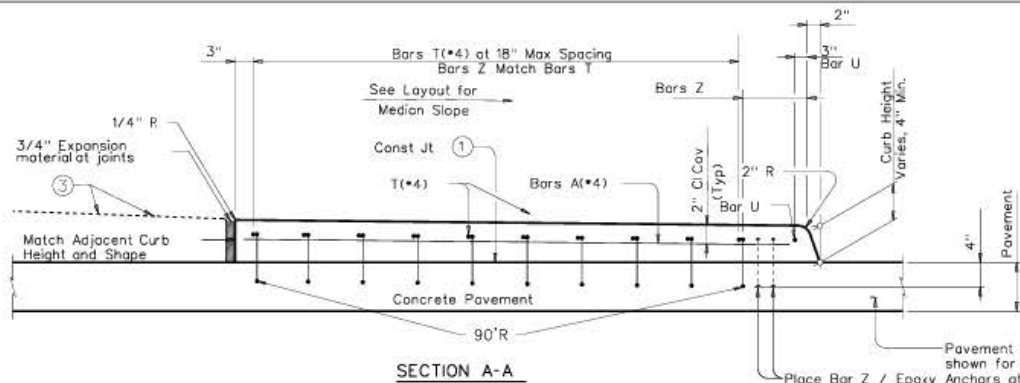

- ① Provide broom finish to top of pavement where raised median area is defined.
- ② Unless noted otherwise on the pavement details.
- ③ Unless otherwise directed, place concrete riprap over pavement or base, if not over pavement or base, place sod or seed.

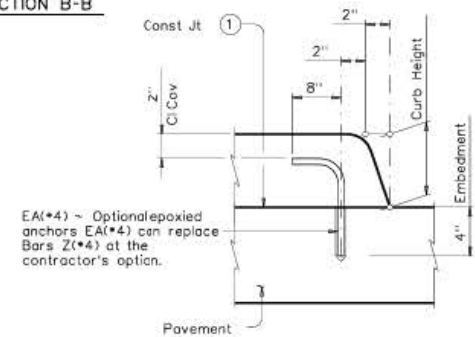
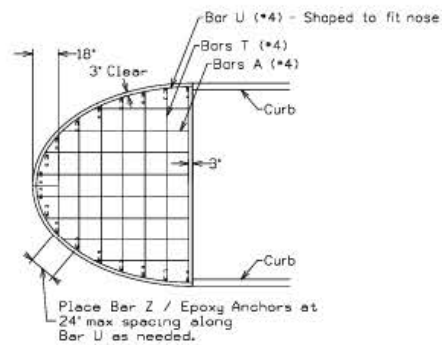
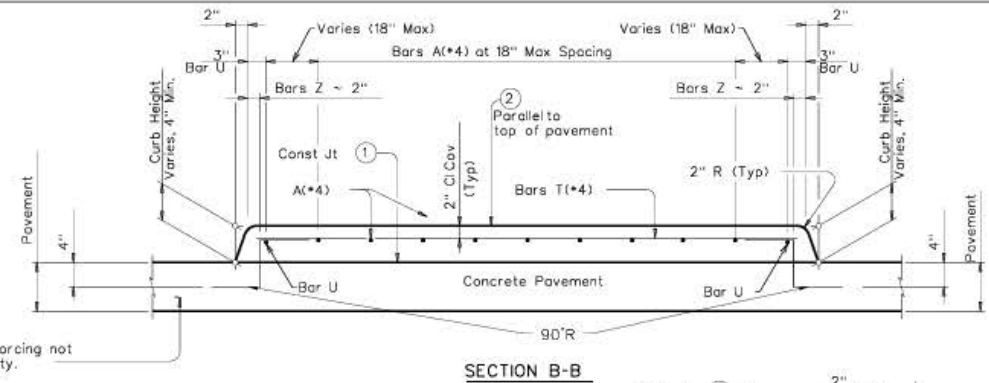

OPTIONAL EPOXY ANCHORS

Embed EA(*4) bar into concrete with a Type III (Class C) epoxy meeting the requirements of DMS-6100, "Epoxyes and Adhesives". Follow manufacturer's directions for installing the epoxied anchor bars.

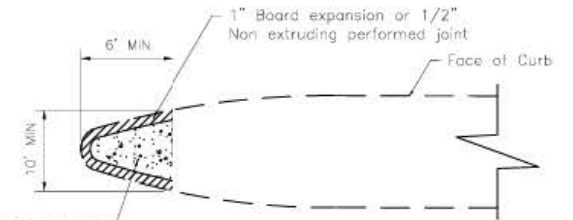

ESPLANADE NOSE

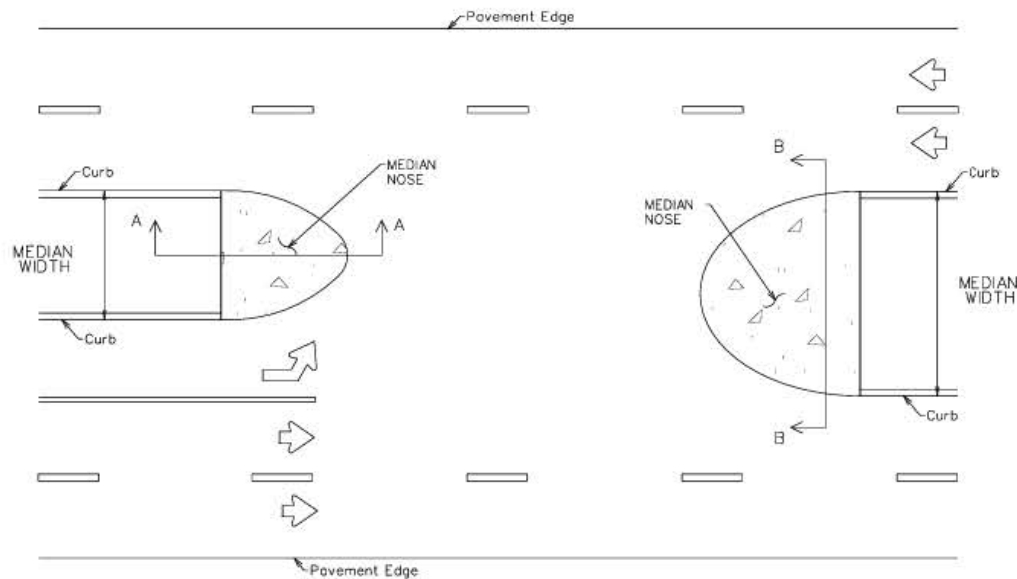

PLAN

REINFORCING

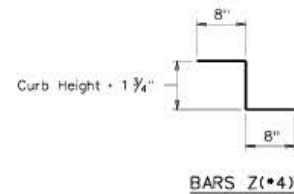

BARS Z(•4)

MATERIAL NOTES:

Provide Grade 60 reinforcement. Welded wire reinforcement (WWR) meeting ASTM A497 of equivalent size and spacing may be substituted for Bars A and Bars T.

Epoxy coat reinforcement if pavement reinforcement is required to be epoxy coated.

DESIGNER NOTES:

DESIGNER NOTES:
Provide Median Slope in Design Layouts.

NO.	REVISIONS	DATE	NAME
▲	ORIGINAL STANDARD ISSUED	10-1-24	RJS
▲			
▲			
▲			

FORT BEND COUNTY
ENGINEERING DEPARTMENT



PROJECT TITLE:			
DRAWN BY: INIT	SHEET DESCRIPTION:		FBCCD STANDARD
CK'D BY: INIT	MEDIAN NOSE DETAIL		09
SCALE: AS NOTED			SHEET NO:
DATE: 10-1-74			
APPROVED BY:			/

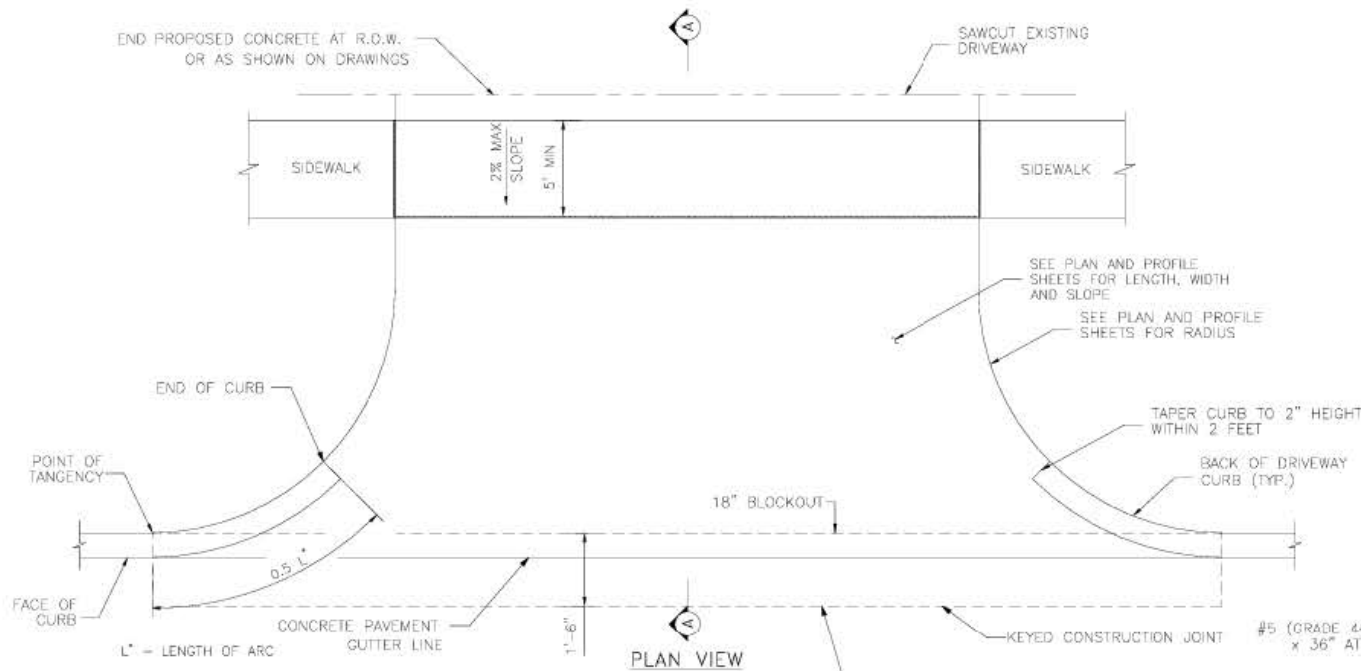

NOTES:

1. SAWCUT EXISTING DRIVEWAY AT R.O.W. LINE OR AS SHOWN ON DRAWING AND REMOVE EXISTING DRIVEWAY TO SAWCUT LINE.
2. IF THERE IS EXISTING CURB ON DRIVEWAY, CONNECT PROPOSED CURB TO EXISTING CURB; OTHERWISE TAPER CURB HEIGHT AS SHOWN.
3. SEE PAVEMENT DETAIL SHEET FOR CONCRETE CURB REINFORCEMENT.
4. THIS DRIVEWAY INSTALLATION IS GOVERNED BY HARRIS COUNTY ITEM 360 AND 400.
5. DRIVEWAY WIDTHS ARE MEASURED AT THE ROW LINE.
6. CULVERTS GREATER THAN 50' IN LENGTH REQUIRE CLEANOUT OR MANHOLE.
7. ALL DRIVEWAYS CONNECTIONS SHALL HAVE THE SAME SURFACE AS THE EXISTING OR PROPOSED STREET.

MINIMUM RADII REQUIREMENTS - DRIVEWAYS

	LOCAL	COLLECTOR	MAJOR
RESIDENTIAL	5'	5'	-
COMMERCIAL	10'	10'	25'

DRIVEWAY WIDTHS

	MINIMUM	MAXIMUM
RESIDENTIAL	10'	25'
COMMERCIAL	20'	40'

PLAN VIEW

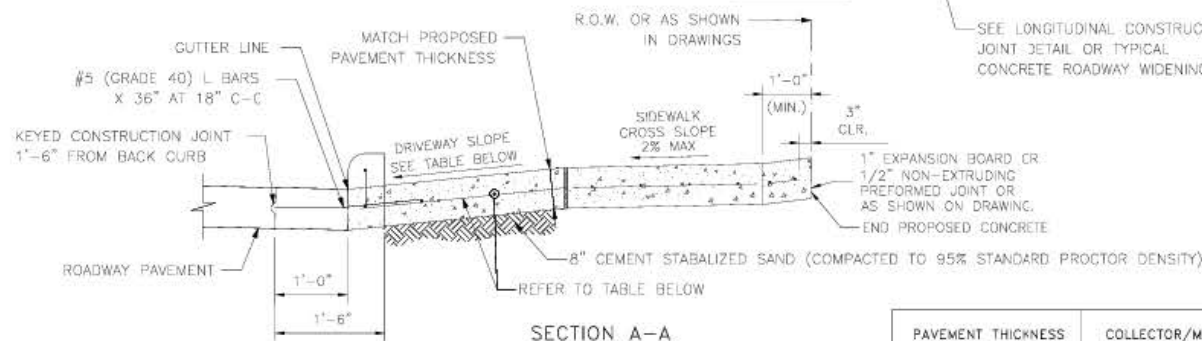

SECTION A-A
(DRIVEWAY SLOPES TO ROADWAY)

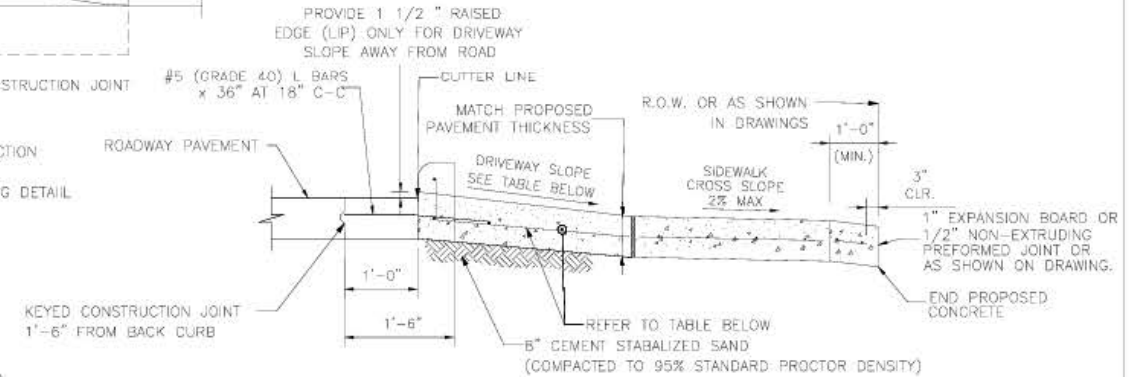

SECTION A-A
(DRIVEWAY SLOPES AWAY FROM ROADWAY)

	PAVEMENT THICKNESS	COLLECTOR/MAJOR	RESIDENTIAL (MAJOR THOROUGHFARE)	RESIDENTIAL (COLLECTORS AND LOCAL STREETS)
REINFORCEMENT	6"	#4 @ 24" O.C.E.W.	N/A	#4 @ 24" O.C.E.W.
	7"	#4 @ 24" O.C.E.W.	#4 @ 24" O.C.E.W.	#4 @ 24" O.C.E.W.
	8"	#4 @ 18" O.C.E.W.	#4 @ 18" O.C.E.W.	#4 @ 18" O.C.E.W.
	9"-10"	#5 @ 18" O.C.E.W.	#5 @ 18" O.C.E.W.	#5 @ 18" O.C.E.W.
EXPANSION DOWEL JOINT	6"	3/4" DIA. SMOOTH BAR	3/4" DIA. SMOOTH BAR	3/4" DIA. SMOOTH BAR
	7"	1" DIA. SMOOTH BAR	1" DIA. SMOOTH BAR	1" DIA. SMOOTH BAR
	8"	1" DIA. SMOOTH BAR	1" DIA. SMOOTH BAR	1" DIA. SMOOTH BAR
	9"-10"	1 1/2" DIA. SMOOTH BAR	1 1/2" DIA. SMOOTH BAR	1 1/2" DIA. SMOOTH BAR
CONSTRUCTION JOINT DOWEL	ALL	#5 REBAR	#5 REBAR	#5 REBAR
SUBGRADE	ALL	8" CEMENT-STABILIZED SAND	2" BANK SAND (DEVELOPER/PRIVATE) 8" CEMENT STABILIZED SAND (MOBILITY)	2" BANK SAND (DEVELOPER/PRIVATE) 8" CEMENT STABILIZED SAND (MOBILITY)
DRIVEWAY SLOPE	ALL	2% TO 4%	2% TO 6%	2% TO 10%*

*10% ALLOWABLE ON PRIVATELY
CONSTRUCTED PROJECTS
6% MAX ON PUBLIC PROJECTS

NO.	REVISIONS	DATE	NAME
1	ORIGINAL STANDARD ISSUED	3-1-22	RJS
2	ADDED NOTE 6 & REVISED NOTE 4	3-1-23	RJS
3	ADDED NOTE 7 & UPDATED TABLE	10-1-24	RJS
4			
5			

FORT BEND COUNTY
ENGINEERING DEPARTMENT



PROJECT TITLE:		FBCD STANDARD
DRAWN BY: INIT	SHEET DESCRIPTION: DRIVEWAY DETAILS FOR	
DATE: 10-1-24	APPROVED BY:	SHEET NO: 11

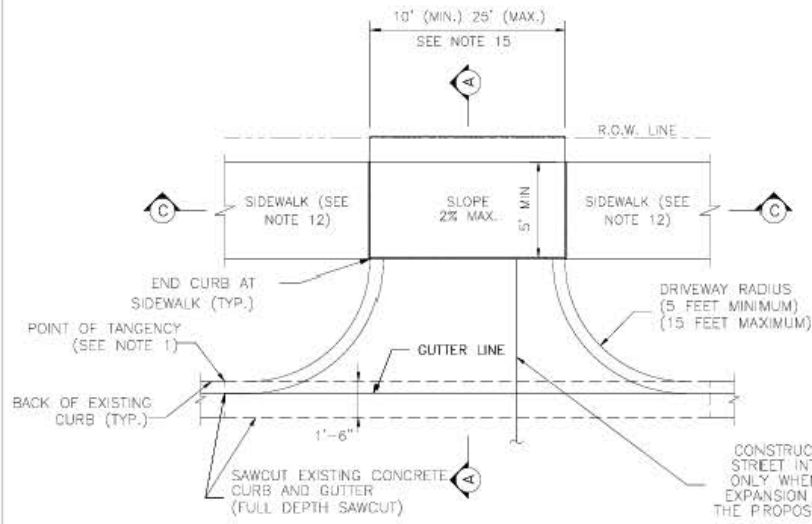

DRIVEWAY AT 6" CONCRETE CURB

SCALE: 1" = 3'-0"

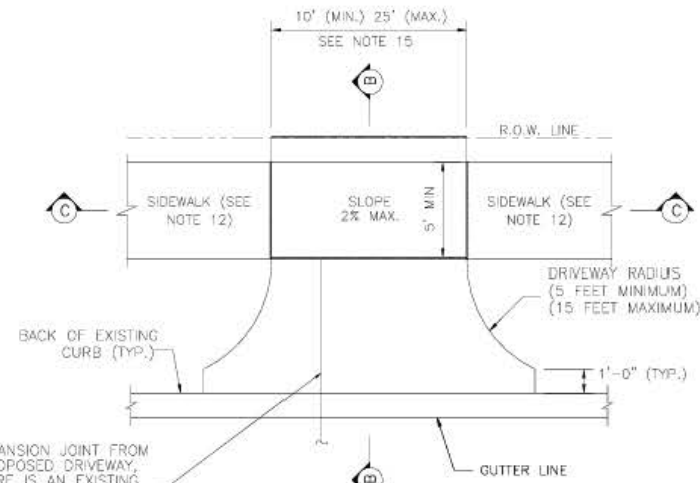

DRIVEWAY AT 4"x12" CONCRETE CURB

(IN RESIDENTIAL AREAS)

SCALE: 1" = 3'-0"

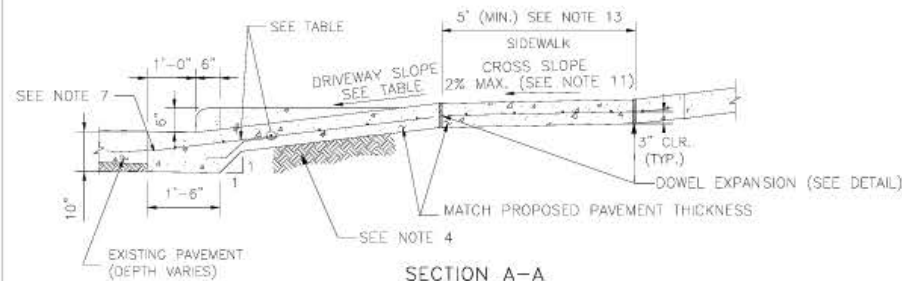

SECTION A-A

SCALE: 1" = 1'-8"

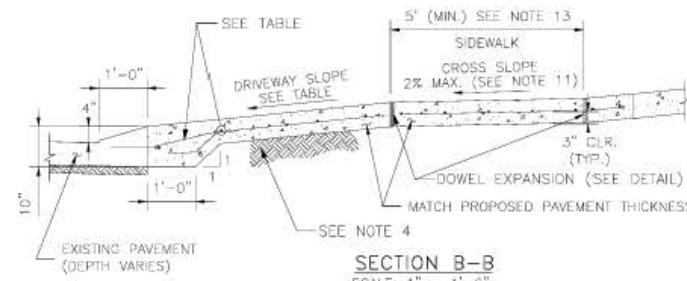

SECTION B-B

SCALE: 1" = 1'-6"

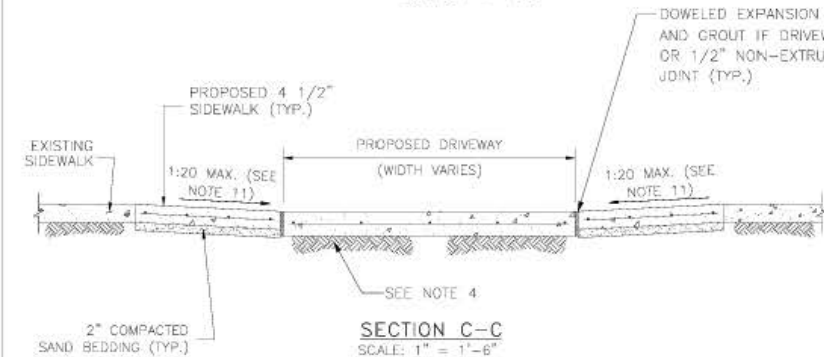

SECTION C-C

SCALE: 1" = 1'-6"

NOTES:

1. PROPOSED DRIVEWAY AT 6" CONCRETE CURB SHALL MATCH EXISTING CURB AT POINT OF TANGENCY.
2. PROPOSED DRIVEWAY SHALL BE BUILT WITH PORTLAND CEMENT CONCRETE, 5 1/2 SACK CEMENT MINIMUM PER CUBIC YARD, 3,500 PSI STRENGTH AT 28 DAYS. THIS DRIVEWAY INSTALLATION IS GOVERNED BY HARRIS COUNTY ITEM 400 AND 360.
3. COMPACTION OF SUBGRADE TO 95% OF STANDARD PROCTOR DENSITY (ASTM D698) ($\pm 2\%$ OPTIMUM MOISTURE) FOR PROPOSED DRIVEWAY CONNECTION. THE COUNTY ENGINEER RESERVES THE RIGHT TO INSPECT AND REQUIRE LABORATORY TEST TO BE CONDUCTED.
4. FOR COMMERCIAL DRIVEWAYS, USE 8" OF COMPACTED CEMENT STABILIZED SAND.
5. FOR RESIDENTIAL DRIVEWAYS, USE 2" OF COMPACTED BANK SAND.
6. A PROPOSED DRIVEWAY TO BE BUILT ON A CORNER LOT CANNOT BE LOCATED WITHIN ANY PORTION OF THE PUBLIC STREET CURB RADIUS (THE POINTS OF TANGENCY MAY BE THE SAME POINT ALONG THE STREET CURB LINE).
7. PROPOSED DRIVEWAY REINFORCING STEEL SHALL BE TIED TO EXISTING CONCRETE PAVEMENT WITH A MINIMUM LAP OF 16 INCHES.
8. IF EXISTING STREET REBAR IS CUT OFF, THEN #4 DOWEL BARS (18" LONG) NEED TO BE INSTALLED AT 24" SPACING, EMBEDDED 9 INCHES AND EPOXIED OR MATCH EXISTING SPACING IF TIGHTER.
9. 3" NON-METALLIC CHAIRS ARE REQUIRED.
10. FOR CAPITAL IMPROVEMENT PROJECTS, THE SUBGRADE SHALL BE STABILIZED ACCORDING TO THE GEOTECHNICAL REPORT RECOMMENDATIONS.
11. SAW AND SEAL ALL CONSTRUCTION JOINTS.
12. SIDEWALK SLOPES SHALL COMPLY WITH THE TEXAS ACCESSIBILITY STANDARDS 403.3 "SLOPE".
13. IF SIDEWALK IS EXISTING, SEE SECTION C-C.
14. SIDEWALKS MAY BE REDUCED TO 4' IN FRONT OF SINGLE-FAMILY RESIDENTIAL LOTS WHEN A 5' PASSING AREA IS PROVIDED IN THE DRIVEWAY.
15. FOR SIDEWALK DETAILS SEE SIDEWALK DETAILS SHEET.
16. DRIVEWAY WIDTHS ARE MEASURED AT THE ROW LINE.
17. CULVERTS GREATER THAN 50' IN LENGTH REQUIRE CLEANOUT OR MANHOLE.
18. ALL DRIVEWAYS SHALL HAVE THE SAME SURFACE AS THE EXISTING OR PROPOSED STREET.

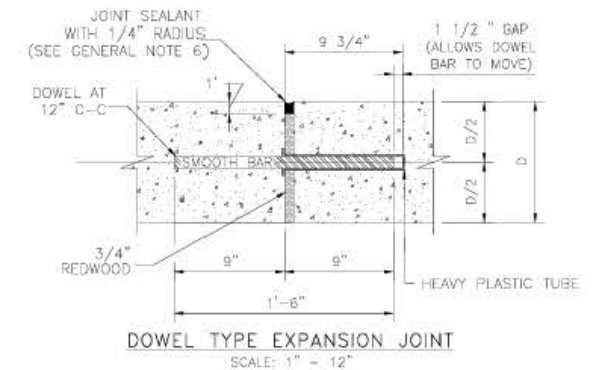

DOWEL TYPE EXPANSION JOINT

SCALE: 1" = 12"

	PAVEMENT THICKNESS	COLLECTOR/MAJOR	RESIDENTIAL (MAJOR THOROUGHFARE)	RESIDENTIAL (COLLECTORS AND LOCAL STREETS)
REINFORCEMENT	6"	#4 @ 24" O.C.E.W.	N/A	#4 @ 24" O.C.E.W.
	7"	#4 @ 24" O.C.E.W.	#4 @ 24" O.C.E.W.	#4 @ 24" O.C.E.W.
	8"	#4 @ 18" O.C.E.W.	#4 @ 18" O.C.E.W.	#4 @ 18" O.C.E.W.
	9"-10"	#5 @ 18" O.C.E.W.	#5 @ 18" O.C.E.W.	#5 @ 18" O.C.E.W.
EXPANSION DOWEL JOINT	6"	3/4" DIA. SMOOTH BAR	3/4" DIA. SMOOTH BAR	3/4" DIA. SMOOTH BAR
	7"	1" DIA. SMOOTH BAR	1" DIA. SMOOTH BAR	1" DIA. SMOOTH BAR
	8"	1" DIA. SMOOTH BAR	1" DIA. SMOOTH BAR	1" DIA. SMOOTH BAR
	9"-10"	1 1/2" DIA. SMOOTH BAR	1 1/2" DIA. SMOOTH BAR	1 1/2" DIA. SMOOTH BAR
CONSTRUCTION JOINT DOWEL	ALL	#5 REBAR	#5 REBAR	#5 REBAR
SUBGRADE	ALL	8" CEMENT-STABILIZED SAND	2" BANK SAND (DEVELOPER/PRIVATE) 8" CEMENT STABILIZED SAND (MOBILITY)	2" BANK SAND (DEVELOPER/PRIVATE) 8" CEMENT STABILIZED SAND (MOBILITY)
DRIVEWAY SLOPE	ALL	2% TO 4%	2% TO 6%	2% TO 10%*

*10% ALLOWABLE ON PRIVATELY CONSTRUCTED PROJECTS
6% MAX ON PUBLIC PROJECTS

NO.	REVISIONS	DATE	NAME
1	ORIGINAL STANDARD ISSUED	3-1-22	RJS
2	ADDED NOTE 16 & REVISED NOTE 2	3-1-23	RJS
3	ADDED NOTE 17 & UPDATED TABLE	10-1-24	RJS

FORT BEND COUNTY
ENGINEERING DEPARTMENT



PROJECT TITLE:		FBC STANDARD
DRAWN BY: INIT	SHEET DESCRIPTION: DRIVEWAY DETAILS FOR	
CK'D BY: INIT	AS NOTED	12
SCALE:	APPROVED BY:	SHEET NO.:
DATE: 10-1-24		/

J:\1704\1601\Fort Bend County Standards\Fort Bend County STD\DONE\FBC SUBDIVISION DRIVEWAY DETAILS\DRIVEWAY_DETAILS.dwg

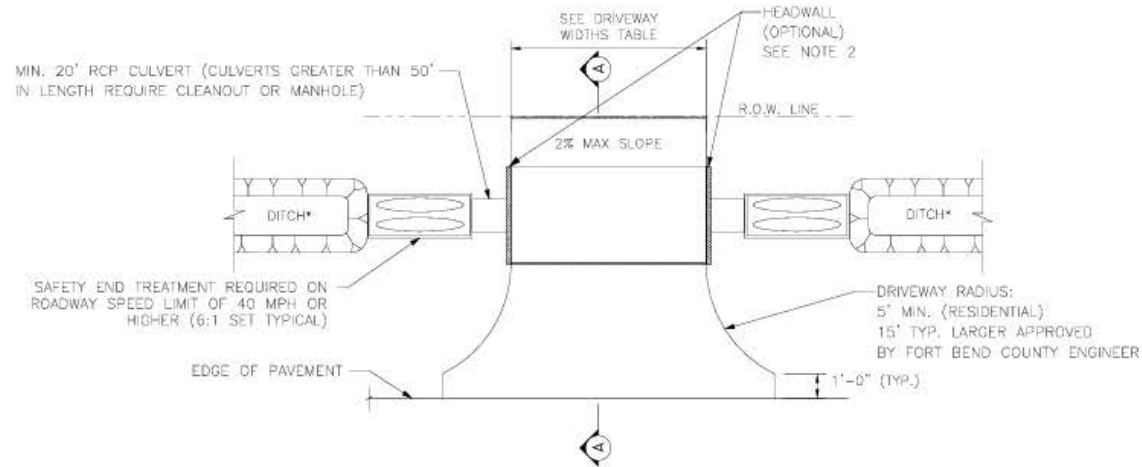

OPEN DITCH DRIVEWAY

*DITCH IS TO HAVE 4:1 SLOPE

MINIMUM RADII REQUIREMENTS - DRIVEWAYS

	LOCAL	COLLECTOR	MAJOR
RESIDENTIAL	5'	5'	-
COMMERCIAL	10'	10'	25'

DRIVEWAY WIDTHS*

	MINIMUM	MAXIMUM
RESIDENTIAL	10'	25'
COMMERCIAL	20'	40'

*DRIVEWAY WIDTHS ARE MEASURED AT THE ROW LINE

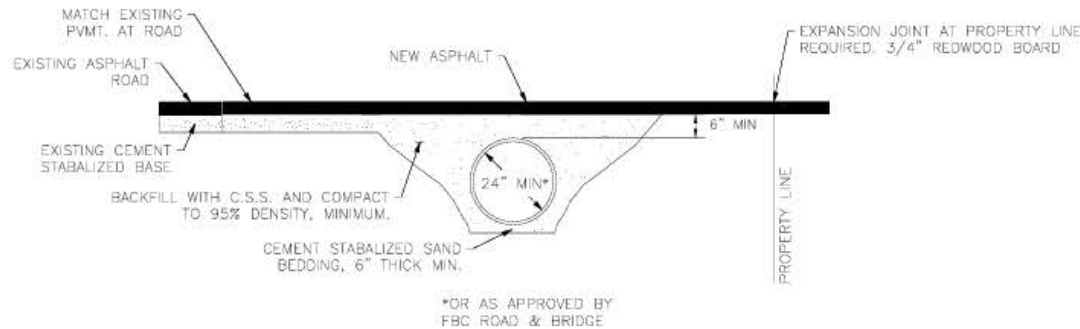

ASPHALT APRON DETAIL - DRIVEWAY PROFILE
FOR CULVERT DRAINAGE

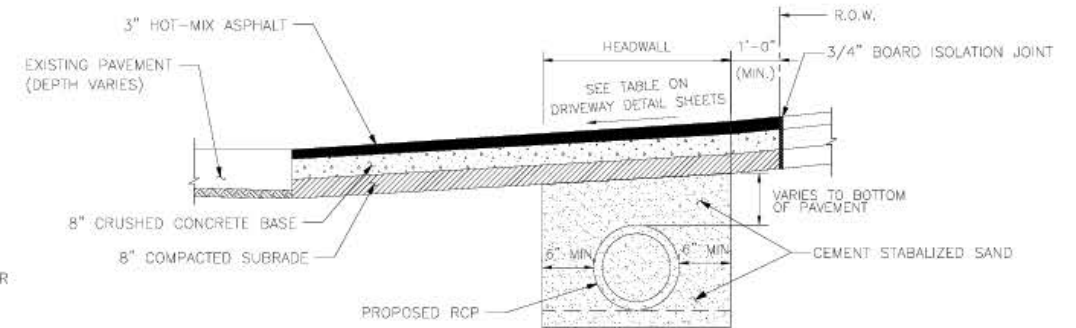

SECTION A-A FOR RESIDENTIAL DRIVEWAYS

NOTES:

1. MAINTAIN A MIN. OF 6" BETWEEN DRIVEWAY AND CULVERT
2. HEADWALLS ARE ONLY ALLOWED ON ROADWAYS WITH POSTED SPEED LIMITS OF 35 MPH OR LESS
3. ALL DRIVEWAY CONNECTIONS SHALL HAVE THE SAME SURFACE AS THE EXISTING OR PROPOSED STREET.

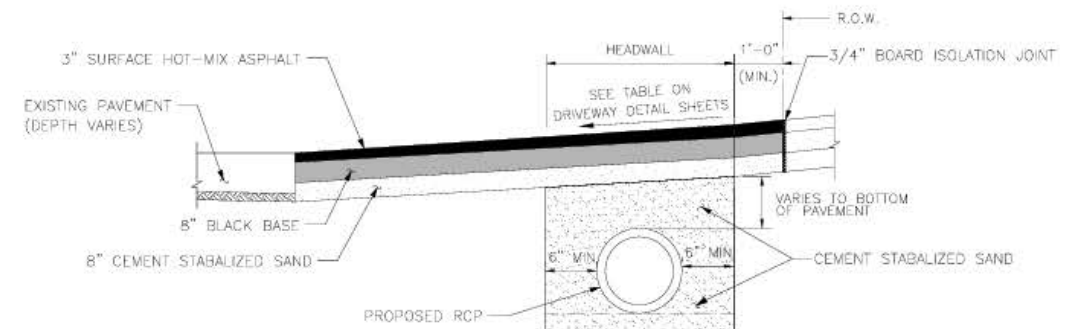

SECTION A-A FOR COMMERCIAL DRIVEWAYS

NO.	REVISIONS	DATE	NAME
1	ORIGINAL STANDARD ISSUED	3-1-22	RJS
2	UPDATED SECTION DETS. & NOTES 2 & 3	10-1-24	RJS
3			
4			
5			

FORT BEND COUNTY
ENGINEERING DEPARTMENT



PROJECT TITLE:		
DRAWN BY: INIT	SHEET DESCRIPTION: ASPHALT DRIVEWAY DETAILS	FBCD STANDARD 13
CHKD BY: INIT		SHEET NO. /
SCALE: AS NOTED		
DATE: 10-1-24	APPROVED BY:	

J:\1704\1703\Standard Sheets\DCN FORT BEND STANDARDS\Expansion Joints.dwg

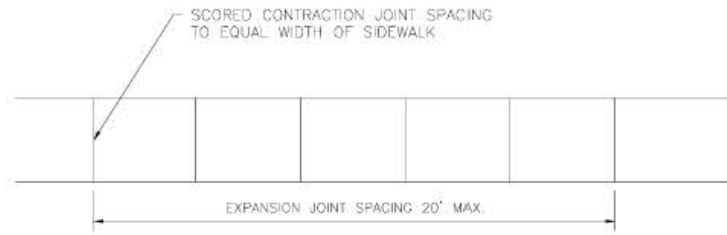

SIDEWALK JOINT DETAILS

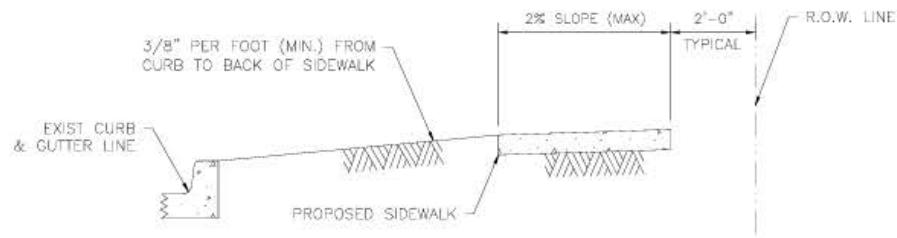

NOTES:

1. TYPICAL SIDEWALK WIDTH IS 5'. SIDEWALKS OF 4' WIDTH ARE ALLOWED IN FRONT OF SINGLE FAMILY HOMES IF ALL DRIVEWAYS PROVIDE A 5' AREA FOR PASSING. SIDEWALKS OF 4' WITH 5' X 5' PASSING ZONES MUST BE SPECIFICALLY APPROVED BY FORT BEND COUNTY.
2. THE MAXIMUM WIDTH BETWEEN EXPANSION JOINTS SHALL NOT EXCEED 20'-0"
3. EXPANSION JOINT IS TO BE 1/2" THICK CLEAR HEART REDWOOD WITH DOWELS
4. SCORED CONTRACTION JOINTS SHALL BE EVERY 5' OR EQUAL TO SIDEWALK WIDTH
5. ALL EARTHEN AREAS ARE TO BE SODDED UNLESS SHOWN OTHERWISE ON DRAWINGS.
6. SIDEWALKS ARE TO BE REINFORCED CONCRETE (3500 PSI) WITH #4 BARS, 16" C-C LONGITUDINAL AND 18" C-C TRANSVERSE. SIDEWALKS NOT 5' IN WIDTH SHALL BE CONSTRUCTED AS DIRECTED BY THE ENGINEER OF RECORD.
7. USE RADIUS TOOL ON ALL EXPOSED EDGES.
8. MEMBRANE CURING COMPOUND IS REQUIRED AS DESCRIBED IN ITEM 802 IN THE HARRIS COUNTY STANDARD SPECIFICATIONS FOR CONSTRUCTION
9. SIDEWALK EXPANSION JOINTS SHALL CONFORM TO STREET EXPANSION JOINT STANDARDS
10. 6' SIDEWALK TO BE USED WHEN SIDEWALK RUNS ALONG THE BACK OF CURB AS DESCRIBES IN THE FBC DESIGN MANUAL

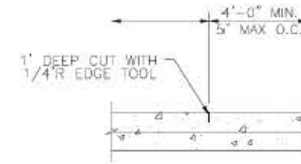

CONTRACTION JOINT SEAL

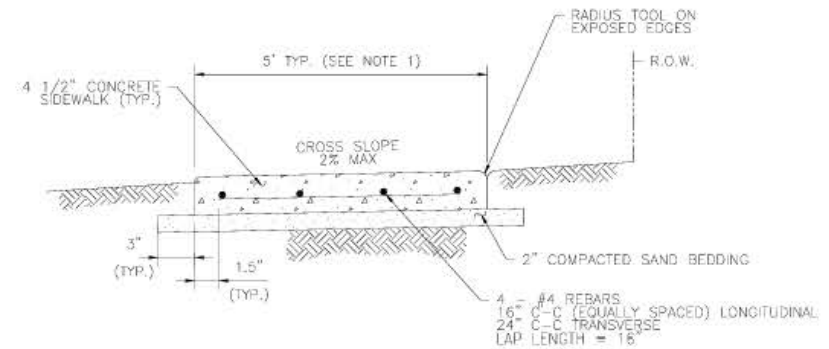
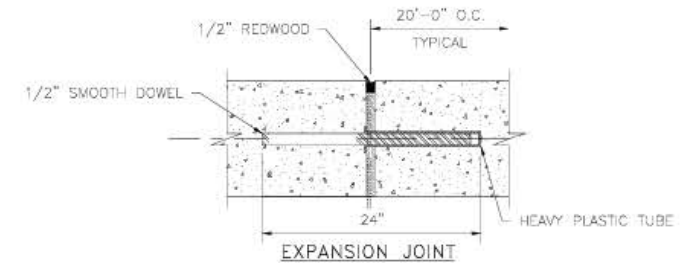

SIDEWALK CROSS SECTION

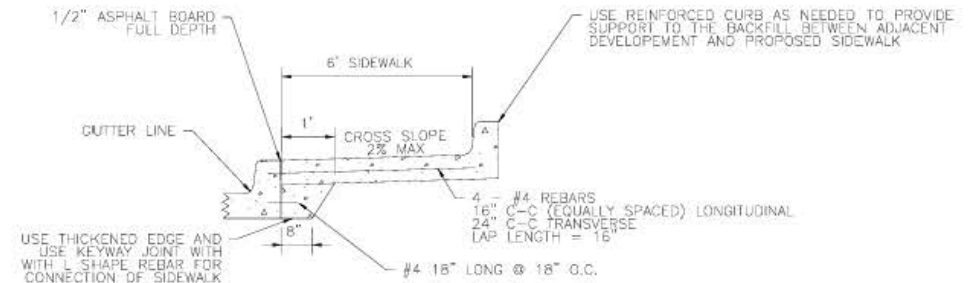

6" SIDEWALK DETAIL*

*REQUIRES PRIOR COUNTY APPROVAL

NOTE:

BANK SAND IS DEFINED AS A WELL-GRADED SAND, FREE OF SILT, CLAY, LOAM, FRIABLE OR SOLUBLE MATERIALS AND ORGANIC MATTER, MEETING THE UNIFIED SOILS CLASSIFICATION SYSTEM GROUP SW CRITERIA W/ A PLASTICITY INDEX OF LESS THAN 10, AND NO MORE THAN 12% OF MATERIAL CAN PASS THE NO. 200 SIEVE.

NO.	REVISIONS	DATE	NAME
1	ORIGINAL STANDARD ISSUED	3-1-22	RJS
2	REVISED NOTE 6, 8, & CROSS SECTION DET.	3-1-23	RJS
3	ADD 6' SIDEWALK & REVISED SECT. DETS.	10-1-24	RJS
4			
5			

FORT BEND COUNTY
ENGINEERING DEPARTMENT



PROJECT TITLE:		FBCD STANDARD 14
DRAWN BY: INIT	SHEET DESCRIPTION: SIDEWALK DETAILS	
DATE: 10-1-24	APPROVED BY:	SHEET NO: /

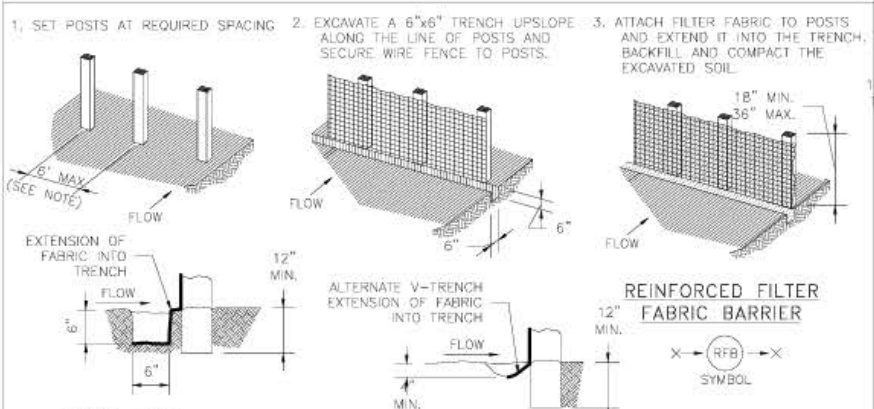

GENERAL NOTES:

1. SECURELY FASTEN MESH FENCING TO POSTS WITH STAPLES OR TIE WIRES.
2. SECURELY FASTEN FILTER FABRIC TO MESH FENCING.
3. WHEN TWO SECTIONS OF FILTER FABRIC ADJOIN EACH OTHER, OVERLAP 6 INCHES AT A POST, FOLD TOGETHER, AND ATTACH TO A POST.
4. REMOVE SEDIMENT DEPOSITS WHEN SILT REACHES ONE-THIRD OF THE HEIGHT OF THE FENCE IN DEPTH.
5. SILT FENCE MINIMUM 2' BEHIND CURB.

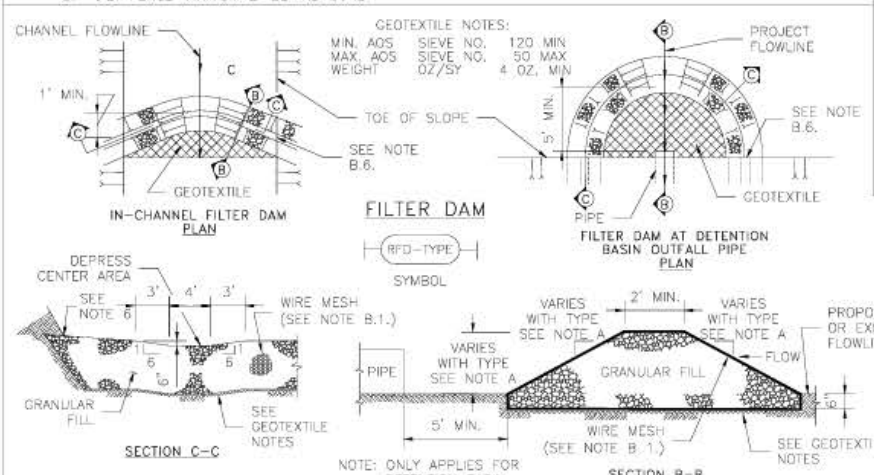

A. TYPES OF FILTER DAMS

OUTFALL PIPE PROTECTION.

1. TYPE 1 (NON-REINFORCED)
 - a. HEIGHT - 18-24 INCHES. MEASURE VERTICALLY FROM EXISTING GROUND TO TOP OF FILTER DAM.
 - b. TOP WIDTH - 2 FEET (MINIMUM)
 - c. SLOPES - 2:1 (MAXIMUM).
2. TYPE 2 (REINFORCED)
 - a. HEIGHT - 18-36 INCHES. MEASURE VERTICALLY FROM EXISTING GROUND TO TOP OF FILTER DAM.
 - b. TOP WIDTH - 2 FEET (MINIMUM)
 - c. SLOPES - 2:1 (MAXIMUM).
3. TYPE 3 (REINFORCED)
 - a. HEIGHT - 36-48 INCHES. MEASURE VERTICALLY FROM EXISTING GROUND TO TOP OF FILTER DAM.
 - b. TOP WIDTH - 2 FEET (MINIMUM).
 - c. SLOPES - 3:1 (MAXIMUM).
4. TYPE 4 (GABION)
 - a. HEIGHT - 30 INCHES (MINIMUM). MEASURE VERTICALLY FROM EXISTING GROUND TO TOP OF FILTER DAM.
 - b. TOP WIDTH - 2 FEET (MINIMUM).
5. TYPE 5. AS SHOWN ON THE PLANS.

NO.	REVISIONS	DATE	NAME
△	ORIGINAL STANDARD ISSUED	3-1-22	RJS
△			
△			
△			

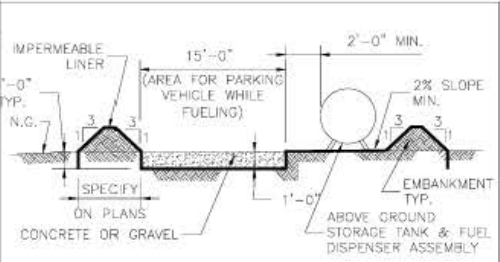

ABOVE GROUND TEMP. VEHICLE &
EQUIPMENT FUELING AREA WITH TANK

GENERAL NOTES:

1. THE SIZE OF TANK FOUNDATION AREA DEPENDS ON THE SIZE OF ABOVE GROUND STORAGE TANK AND DISPENSER ASSEMBLY.
2. PROVIDE A MINIMUM SLOPE OF 2 % TOWARD THE SUMP PIT.
3. INSTALL IMPERMEABLE LINER AS PER MANUFACTURER'S RECOMMENDATIONS.

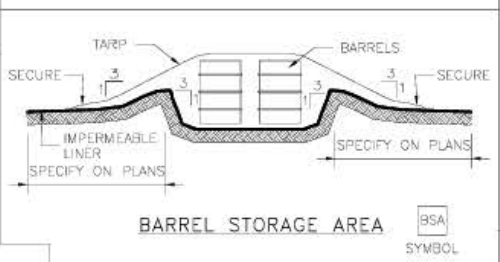

GENERAL NOTES:

1. ALTERNATIVELY, STORE BARRELS IN AN ENCLOSED BUILDING OR SHED.
2. INSTALL IMPERMEABLE LINER AS PER MANUFACTURER'S RECOMMENDATIONS, 60 mil MINIMUM.
3. CONSTRUCT BERMED AREA WITH VOLUME GREATER THAN OR EQUAL TO 110% VOLUME OF BARRELS.

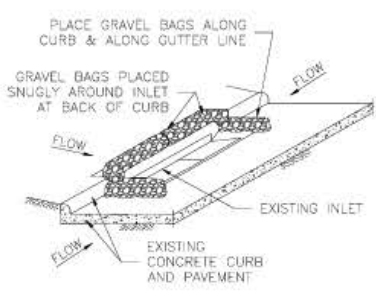

INLET PROTECTION BARRIERS FOR STAGE II INLETS	IPB-II SYMBOL
--	------------------

GENERAL NOTES:

1. REMOVE SEDIMENT DEPOSIT WHEN THE SEDIMENT HAS ACCUMULATED TO ONE-THIRD THE HEIGHT OF THE BARRIER.
2. GRAVEL BAGS SHALL NOT BLOCK THROAT OF INLET UNLESS DIRECTED BY ENGINEER.

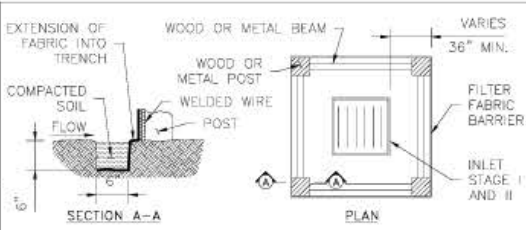

INLET PROTECTION BARRIER WITH
REINFORCED FILTER FABRIC

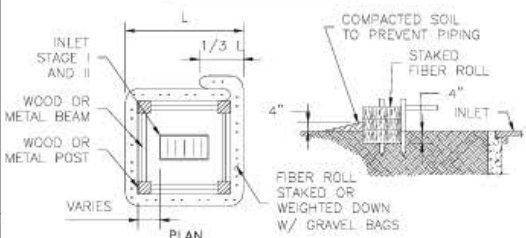

INLET PROTECTION BARRIER WITH FILTER ROLLS

GENERAL NOTES:

1. FIBER ROLLS WILL BE UTILIZED ONLY WHEN SITE CONDITIONS DO NOT PERMIT THE USE OF FILTER FABRIC BARRIER, AND AS APPROVED BY THE ENGINEER.

INLET PROTECTION BARRIERS
FOR STAGE 1 INLETS

IPB
SYMBOL

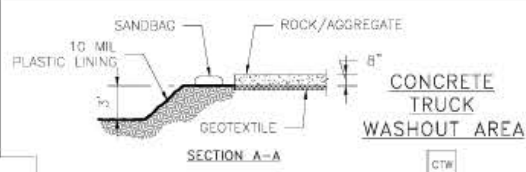

10" MIN. ORANGE SAFETY SYMBOL

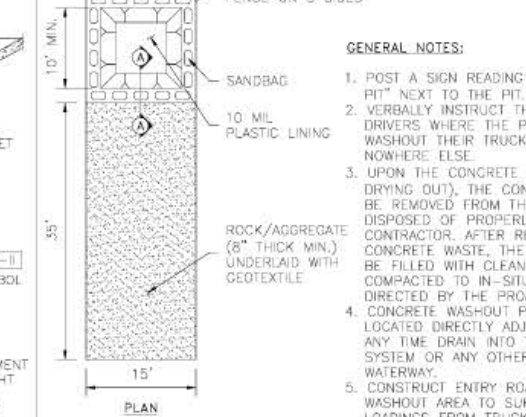

LOADINGS FROM TRUCKS

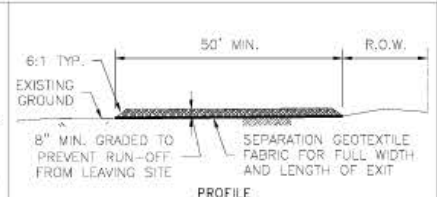

COARSE AGGREGATE = 3" TO 5"

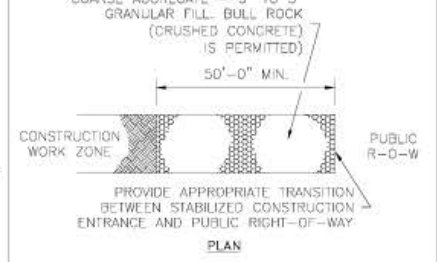

STABILIZED CONSTRUCTION ACCESS

SC-1 

SYMBOL

GENERAL NOTES:

1. MINIMUM LENGTH IS AS SHOWN ON CONSTRUCTION DRAWINGS OR 50 FEET, WHICHEVER IS MORE.
2. CONSTRUCT AND MAINTAIN CONSTRUCTION EXIT WITH CONSTANT WIDTH ACROSS ITS LENGTH, INCLUDING ALL POINTS OF INGRESS OR EGRESS.
3. UNLESS SHOWN ON THE CONSTRUCTION DRAWINGS, STABILIZATION FOR OTHER AREAS WILL HAVE THE SAME AGGREGATE THICKNESS AND WIDTH REQUIREMENTS AS THE STABILIZED CONSTRUCTION EXIT.
4. WHEN SHOWN ON THE CONSTRUCTION DRAWINGS, WHEN OR LENGTHEN STABILIZED AREA TO ACCOMMODATE A TRUCK WASHING AREA, PROVIDE OUTLET SEDIMENT TRAP FOR THE TRUCK WASHING AREA.
5. PROVIDE PERIODIC TOP DRESSING WITH ADDITIONAL COARSE AGGREGATE TO MAINTAIN THE REQUIRED DEPTH OR WHEN SURFACE BECOMES PACKED WITH MUD.
6. PERIODICALLY TURN AGGREGATE TO EXPOSE A CLEAN DRIVING SURFACE.
7. MINIMUM 14' WIDTH FOR ONE WAY TRAFFIC AND 20' WIDTH FOR TWO WAY TRAFFIC.

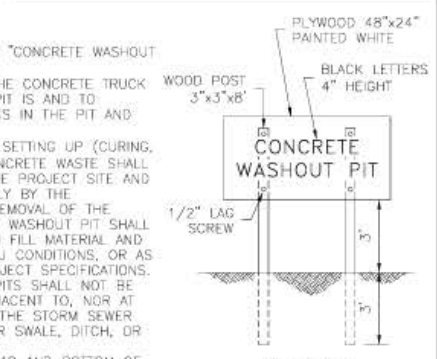

SIGN DETAIL
(OR EQUIVALENT)

GENERAL NOTES:

1. POST A SIGN READING "WASHOUT AREA" NEXT TO THE PIT.
2. VERBALLY INSTRUCT THE DRIVERS WHERE THE WASHOUT THEIR TRUCKS NOWHERE ELSE.
3. UPON THE CONCRETE DRYING OUT), THE CONCRETE SHOULD BE REMOVED FROM THE PIT AND DISPOSED OF PROPERLY. THE CONTRACTOR, AFTER HIS TRUCKS HAVE DUMPED THE CONCRETE WASTE, THEY SHOULD BE FILLED WITH CLEAN WATER AND CONTINUED TO EN-ROUTE TO BE DIRECTED BY THE PROJECT ENGINEER.
4. CONCRETE WASHOUT PITS SHOULD BE LOCATED DIRECTLY ADJACENT TO ANY TIME DRAIN INTO THE SEWER SYSTEM OR ANY OTHER POTENTIAL WATERWAY.
5. CONSTRUCT ENTRY AND EXIT WASHOUT AREA TO SUIT LOADINGS FROM TRUCKS.



PROJECT TITLE:			
DRAWN BY:	INIT		FOCED STANDARD
CDG BY:	INIT	SHEET DESCRIPTION:	60
SCALE:	NONE	STORM WATER POLLUTION	
		PREVENTION PLAN DETAILS	
DATE:	3-1-22	APPROVED BY:	SHEET NO.
			/