



SERVICE OUTLET LOCATION AND DATA STATEMENT FOR ELECTRIC SERVICE

Table with customer information: CUSTOMER (Fort Bend County - Isabel Roberts, Facilities Operation Manager), SERVICE ADDRESS (630 Charlie Roberts Lane), MAILING ADDRESS, ELECTRICIAN, DAY PHONE ((281) 642-5686), EVENING PHONE, CELL PHONE, ELECTRICIAN'S PHONE.

Dear Customer,

CenterPoint Energy Houston Electric, LLC is grateful to meet with you on, 01-16-2025 to discuss the requirements needed to provide you electric service.

Form with checkboxes for construction requirements. Includes sections for 'CenterPoint Energy Construction Required?' and 'The following steps must be complete prior to construction:'. Lists items like 'Pay any up-front contributions for non-standard service \$62,137.00', 'Clear trees along extension route', 'Easement charges \$2,200.00', 'Easement execution', 'Site Plan and Elevation Plan: Hard Copies', 'Site Plan: Electronic Copy with XY Coordinates', 'One Line Diagram', 'Load Analysis', 'Easements Required-Recorded Warranty Deed Required', 'Specifications on Modular Metering Enclosure'.

Form with YES/NO checkboxes for specific requirements: Installation of meter pole or weather head, Obtain city or county permit, CenterPoint Energy will provide an ESI ID#, Choose a Competitive Retailer.

Want to start gas service? Go to move.centerpointenergy.com/move or call 800-752-8036 To learn more about energy efficiency programs, please visit centerpointefficiency.com

CenterPoint Energy Houston Electric, LLC's target completion date to provide your construction requirements, per the working sketch, is a mutually agreed upon negotiated date by CenterPoint Energy and customer. Please be aware our ability to meet the target completion date may be affected by weather, availability of construction crews and materials, ability to secure easements, and timely completion of your requirements (see above). In addition, as a condition to this service, you agree to comply with all of CenterPoint Energy standards, the National Electrical Code, the National Safety Code, all Occupational Safety and (OSHA) requirements, the International Building code and all local governing body codes.

We appreciate the opportunity to do business with you and look forward to the successful completion of this project. Your signature below insures that both parties understand the requirements toward completion that will allow you electrical service. Thanks for your cooperation in this matter.

Sincerely,

Service Consultant

Table with service consultant information: SERVICE CONSULTANT (Enrique Ramon), PHONE NUMBER ((281) 341-4931), ADDRESS (935 Highway 90 ALT Rosenberg, Texas 77471), E-MAIL ADDRESS (enrique.ramon@centerpointenergy.com).

Table for customer signature and name: CUSTOMER'S SIGNATURE, CUSTOMER'S PRINTED NAME, DATE.

Form with YES/NO checkboxes for back-up generation and motor requirements: Will Customer have Back-up Generation?, Will Customer have Motor Greater than 250 HP?

Form titled 'APPLICABLE FORMS' with checkboxes for Power Quality, Primary Meter, Motor Start, Emergency Generation, Distributed Generation, Major UG Checklist.

<p align="center">GENERAL SERVICE</p> <p><input type="checkbox"/> 1Ø 3W 120/208</p> <p><input type="checkbox"/> 1Ø 3W 120/240</p> <p><input type="checkbox"/> 3Ø 4W Δ 240V</p> <p><input type="checkbox"/> 3Ø 4W Y 120/208V</p> <p><input type="checkbox"/> 3Ø 4W Y 277/480V* *10 X 26 PT can mounted on 480V Service?</p> <p><input type="checkbox"/> 3Ø 3W Δ 480V* *1-1/4" conduit connecting CT & PT can run?</p> <p><input checked="" type="checkbox"/> Primary Metering Job</p> <p><input type="checkbox"/> Major UG Job</p> <p><input type="checkbox"/> Other: (Explain) _____</p>	<p align="center">SERVICE TYPE</p> <p>_____ FT² <input checked="" type="checkbox"/> All Electric <input type="checkbox"/> Gas & Electric</p> <p>Size Wire Pulled _____</p> <p>Cust's Load 1 Ø _____ +3 Ø <u>570</u> = <u>570</u> Total KVA</p> <p>Fault Current: Initial _____ Ultimate _____</p> <p align="center">Amperes RMS Symmetrical at _____ Volts</p>
---	--

<p align="center">CT CAN TYPE</p> <p><input type="checkbox"/> 320 Amp (self contained)</p> <p><input type="checkbox"/> 30 X 42</p> <p><input type="checkbox"/> Bus Head Outdoor</p> <p><input type="checkbox"/> Bus Head with CT Can</p> <p><input type="checkbox"/> Stainless Steel Rack</p> <p><input type="checkbox"/> Primary Job</p>	<p align="center">CONDUITS ON POLE</p> <p align="center">Size of Conduit</p> <p align="center">_____</p> <p align="center">No. of Conduits</p> <p align="center">_____</p>	<p align="center">For Information Regarding:</p> <p align="center">CenterPoint Energy service standards visit</p> <p align="center">www.centerpointenergy.com/electricservicestandards</p> <p align="center">For approvals on AUTOMATIC TRANSFER SWITCHES</p> <p align="center">EMAIL SPECS TO</p> <p align="center">ATS.Approvals@CenterPointEnergy.com</p>
--	---	---

COMMENTS OR NOTES

Note: A third party easement is required.

Attached sketch shows the location of Proposed Primary Meter Pole (Pole #11) and customer;s receiving pole.

ILLUSTRATION

See Page 3 of 6

LEGEND

X Proposed Pole

O Existing Pole

---- Proposed Wire

⊙ Proposed Transformer

⊙ Existing Transformer

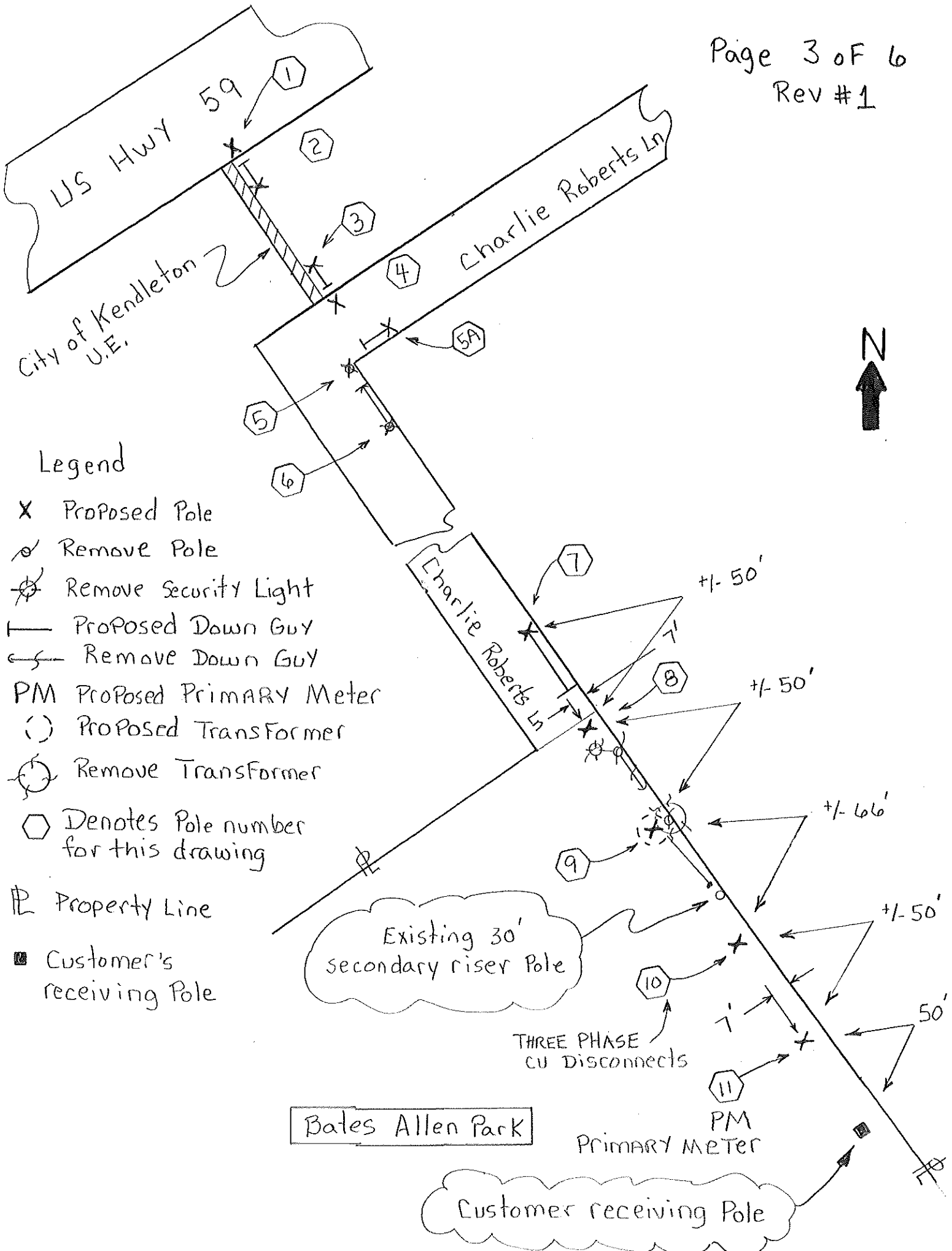

Legend

- X Proposed Pole
- ⊗ Remove Pole
- ⊗ Remove Security Light
- Proposed Down Guy
- ← Remove Down Guy
- PM Proposed PRIMARY Meter
- (○) Proposed Transformer
- ⊗ Remove Transformer
- ⬡ Denotes Pole number for this drawing
- ▬ Property Line
- Customer's receiving Pole

Bates Allen Park

Customer receiving Pole

THREE PHASE
CU Disconnects

+/- 50'

+/- 50'

+/- 66'

+/- 50'

50'

1'

PM
PRIMARY METER

Existing 30'
secondary riser Pole

US Hwy 59

Charlie Roberts Ln

City of Kendallton
U.E.



**TEXAS LAW AN ACT
TEXAS HEALTH AND SAFETY CODE TITLE 9**

CHAPTER 752 - Safety of persons engaged in activities in proximity of high voltage electric lines; restrictions

SECTION 001. DEFINITIONS

- (1) "High voltage" means more than 600 volts measured between conductors or between a conductor and the ground.
- (2) "Overhead line" means a bare or insulated electric conductor installed above ground but does not include a conductor that is de-energized and grounded or that is enclosed in a rigid metallic conduit.

SECTION 002. EXEMPTION FOR CERTAIN EMPLOYEES AND ACTIVITIES

(A) This chapter does not apply to the construction, reconstruction, operation, or maintenance by an authorized person of overhead electrical or communication circuits or conductors and their supporting structures and associated equipment that are part of a rail transportation system, an electrical generating, transmission, or distribution system or a communication system.

(B) In this section, "authorized person" means:

- (1) an employee of a light and power company, an electric cooperative, or a municipality working on his employer's electrical system;
- (2) an employee of a transportation system working on the system's electrical circuits;
- (3) an employee of a communication utility;
- (4) an employee of a state, county, or municipal agency that has authorized circuit construction on the poles or structures that belong to an electric power company, an electric cooperative, a municipal or transportation system, or a communication system;
- (5) an employee of an industrial plant who works on the plant's electrical system; or
- (6) an employee of an electrical or communications contractor who is working under the contractor's supervision.

SECTION 003. TEMPORARY CLEARANCE OF LINES

(A) A person, firm, corporation, or association responsible for temporary work or a temporary activity or function closer to a high voltage overhead line than the distances prescribed by this chapter must notify the operator of the line at least 48 hours before the work begins.

(B) A person, firm, corporation, or association may not begin the work, activity, or function under this section until the person, firm, corporation, or association responsible for the work, activity, or function and the owner or operator, or both, of the high voltage overhead line have negotiated a satisfactory mutual arrangement to provide temporary de-energization and grounding, temporary relocation or raising of the line, or temporary mechanical barriers to separate and prevent contact between the line and the material or equipment or the person performing the work, activity or function.

(C) The person, firm, corporation, or association responsible for the work, activity, or function shall pay the operator of the high voltage overhead line the actual expense incurred by the operator in providing the clearance prescribed in the agreement. The operator may require payment in advance and is not required to provide the clearance until the person, firm, corporation, or association responsible for the work, activity, or function makes the payment.

(D) If the actual expense of providing the clearance is less than the amount paid, the operator of the high voltage overhead line shall refund the surplus amount.

SECTION 004. RESTRICTION ON ALL ACTIVITIES NEAR LINES

(A) Unless a person, firm, corporation, or association effectively guards against danger by contact with the line as prescribed by Section 752.003, the person, firm, corporation, or association, either individually or through an agent or employee, may not perform a function or activity on land, a building, a highway, or other premises if at any time it is possible that the person performing the function or activity may:

- (1) move or be placed within six feet of a high voltage overhead line while performing the function or activity; or
- (2) bring any part of a tool, equipment, machine, or material within six feet of a high voltage overhead line while performing the function or activity.

(B) A person, firm, corporation, or association may not require an employee to perform a function or activity prohibited by Subsection (A).

SECTION 005. RESTRICTION ON OPERATION OF MACHINERY AND PLACEMENT OF STRUCTURES NEAR LINES

Unless a person, firm, corporation, or association effectively guards against danger by contact with the line as prescribed by Section 752.003, the person, firm, corporation, or association, either individually or through an agent or employee, may not:

- (1) erect, install, transport, or store all or any part of a house, building, or other structure within six feet of a high voltage overhead line;
- (2) install, operate, transport, handle, or store all or any part of a tool, machine, or equipment within six feet of a high voltage overhead line; or
- (3) transport, handle, or store all or any part of supplies or materials within six feet of a high voltage overhead line.

SECTION 006. RESTRICTION ON OPERATION OF CERTAIN MACHINERY OR EQUIPMENT

(A) A person, firm, corporation, or association, individually, through an agent or employee, or as an agent or employee, may not operate a crane, derrick, power shovel, drilling rig, hay loader, hay stacker, mechanical cotton picker, pile driver, hoisting equipment, or similar apparatus any part of which is capable of vertical, lateral, or swinging motion unless:

- (1) a warning sign is posted and maintained as prescribed by Subsections (B) and (C);
- (2) an insulated cage-type guard or protective device is installed about the boom or arm of the equipment, except a backhoe or dipper; and
- (3) each lifting line, if the equipment includes a lifting hook device, is equipped with an insulator link on the lift hook connection.

(B) The warning sign required by Subsection (A) (1) must be a weather-resistant sign of not less than five inches by seven inches with a yellow background and black lettering that reads: "WARNING -- UNLAWFUL TO OPERATE THIS EQUIPMENT WITHIN TEN FEET OF HIGH VOLTAGE LINES."

(C) The warning sign must be legible at 12 feet and placed:

- (1) within the equipment so that it is readily visible to the equipment operator while at the equipment controls; and
- (2) on the outside of the equipment in the number and location necessary to make it readily visible to a mechanic or other person engaged in the work.

(D) Notwithstanding the distance limitations prescribed by Sections 752.004 and 752.005, unless a person, firm, corporation, or association effectively guards against danger by contact with the line as prescribed by Section 752.003, the person, firm, corporation, or association may not operate all or any part of a machine or equipment described by this section within 10 feet of a high voltage overhead line.

SECTION 007. CRIMINAL PENALTY

(A) A person, firm, corporation, or association or an agent or employee of a person, firm, corporation, or association commits an offense if the person, firm, corporation, association, agent, or employee violates this chapter.

(B) An offense under this section is punishable by a fine of not less than \$100 or more than \$1,000, confinement in jail for not more than one year, or both.

SECTION 008. LIABILITY FOR DAMAGES

If a violation of this chapter results in physical or electrical contact with a high voltage overhead line, the person, firm, corporation, or association that committed the violation is liable to the owner or operator of the line for all damages to the facilities and for all liability that the owner or operator incurs as a result of the contact.

Acts 1989, 71st Leg., ch. 678, § 1, eff. Sept. 1, 1989

Prior Laws:

Acts 1971, 62nd Leg., p. 76, ch. 41.

Vernon's Ann. Civ. St. art. 1436c, § 7(B).

This is only a part of the entire act. The complete act is available for review.



**SERVICE OUTLET LOCATION AND DATA STATEMENT
FOR ELECTRIC SERVICE**

50F6

PERMITTING ENTITY	PHONE NUMBER	LIFE OF PERMIT	TYPE RES	TYPE GEN
City of Alvin	281-388-4271	No limit*	E/M	E
City of Arcola	281-431-0606	6 months	F	F
City of Bayou Vista	409-935-8348	No limit*	E	E
City of Baytown	281-420-6537	90 days	E/M	O
City of Beach City	281-383-3180	6 months	E	E
City of Beasley	979-387-2775	90 days	E	E
BRAZORIA COUNTY	979-864-1295	1 year	F	F
City of Bellaire	713-662-8230	90 days	E	E
City of Brookshire	281-375-5050	6 months	E	E
City of Brookside Village	281-485-3048	90 days	E/M	E
City of Bunker Hill	713-467-9762	No limit*	E	E
CHAMBERS COUNTY	409-267-8392	90 days	F	F
City of Clear Lake Shores	281-334-2799	6 months	E	E
City of Clute	409-265-2541	6 months	E	E
City of Cove	281-573-8309	1 year	E	E
City of Danbury	979-922-1551	1 year	E	E
City of Dayton	936-258-2642	6 months	E	E
City of Deer Park	281-478-7270	1 year	E	O
City of Dickinson	281-337-6259	30 days	E	E
City of El Lago	281-326-1951	1 year	E	E
City of Freeport	979-233-3526	6 months	E/F/M	E/F
FORT BEND COUNTY	281-633-7502	1 year	F	F
City of Friendswood	281-996-3200	No limit*	E	E
City of Fulshear	281-346-1796	6 months	E	E
City of Galena Park	713-672-2556	90 days	E	E
City of Galveston	409-797-3660	6 months	E	E
GALVESTON COUNTY	409-770-5549	6 months	F	F
HARRIS COUNTY	713-956-3000	1 year	F	F
City of Hedwig Village	713-465-6009	6 months	E	E
City of Hillcrest	281-756-0577	6 months	E	E
City of Hillshire Village	713-973-1779	No limit*	E	E
City of Hitchcock	409-986-5591	6 months	E	E
City of Houston	832-394-8847	6 months	E/M	E
City of Humble	281-446-3061	90 days	E/M	E/O
City of Hunters Creek	713-465-2150	No limit*	E	E
City of Iowa Colony	281-369-2471	90 days	E	E
City of Jacinto City	713-674-8424	90 days	E	E
City of Jamaica Beach	409-737-1142	1 year	E	E
City of Jersey Village	713-466-2110	1 year	E/M	E
City of Jones Creek	409-233-1826	90 days	E	E
City of Katy	281-391-4830	180 days	E	E
City of Kemah	281-334-1611	6 months	E/M	E
City of Lake Jackson	979-415-2430	180 days	E	O
City of La Marque	409-938-9204	6 months	E/M	E
City of La Porte	281-471-5020	6 months	E/M	O
City of League City	281-554-1415	90 days	E	E



**SERVICE OUTLET LOCATION AND DATA STATEMENT
FOR ELECTRIC SERVICE**

PERMITTING ENTITY	PHONE NUMBER	LIFE OF PERMIT	TYPE RES	TYPE GEN
City of Magnolia	281-356-2266	1 year	E	E
City of Manvel	281-489-0630	1 year	E/M	E
City of Meadows Place	281-983-2950	1 year	E/M	E
City of Missouri City	281-403-8600	90 days	O	O
City of Mont Belvieu	281-576-2213	90 days	O	O
MONTGOMERY COUNTY	936-539-7836	1 year	F	F
City of Morgan's Point	281-471-2171	6 months	E	E
City of Nassau Bay	281-333-2108	6 months	E	E
City of Needville	409-793-4253	90 days	E/M	E
City of Oak Ridge North	281-292-4648	6 months	E	E
City of Old River Winfree	281-385-1735	90 days	E	E
City of Orchard	979-478-6893	180 days	E/M	O
City of Oyster Creek	979-233-0243	6 months	E	E
City of Pasadena	713-477-1511	90 days	E/M	O
City of Pattison	281-375-5550	6 months	E	E
City of Pearland	281-652-1638	6 months	E/M	O
City of Piney Point Village	713-782-0271	90 days	E	E
City of Quintana	979-233-0848	90 days	E	E
City of Richmond	281-232-6871	6 months	E/M	O
City of Richwood	979-265-2082	90 days	E	E
City of Rosenberg	1-832-595-3400	90 days	E/M	O
City of Santa Fe	409-925-6412	6 months	E/M	E
City of Seabrook	281-291-5668	6 months	E	E
City of Sealy	979-885-1669	90 days	E/M	E
City of Shoreacres	281-471-2253	1 year	E	E
City of South Houston	713-947-7700	6 months	E/M	O
City of Southside Place	713-668-2341	90 days	E	E
City of Spring Valley	713-465-8308	6 months	E	E
City of Stafford	281-261-3940	6 months	E/M	O
City of Sugar Land	281-275-2270	6 months	E/M	O
Village of Surfside Beach	979-233-1531	6 months	E	E
City of Taylor Lake Village	281-326-2843	90 days	E	E
City of Texas City	409-643-5946	30 days	E/M	E
City of Tomball	281-351-5484	6 months	E/M	E
Village of Tiki Island	409-935-1427	1 year	E	E
City of Waller	936-931-1042	1 year	E	E
City of Webster	281-338-2925	90 days	E	O
City of West University Place	713-662-5833	1 year	E	E
City of Weston Lakes	281-533-0907	90 days	F	F
City of Wharton	979-532-2491	6 months	E	E

* Duration of project

CODE TYPES

- E= All new meter Installation and wiring changes.
- O= For all MVI and Name changes including Mobile Homes
- F= All new permanent and/or temporary service.
- M= Mobile Homes