



Fort Bend County Engineering
FORT BEND COUNTY, TEXAS

J. Stacy Slawinski, P.E.
County Engineer

February 27, 2024

Sienna/Johnson North LP
5005 Riverway DR
Houston, TX 77056

Re: Right-of-Entry/Temporary Construction Easement; Property ID: R264505

Dear: Sienna/Johnson North LP

Fort Bend County is developing a Project to monitor flooding within the County. Fort Bend County is contacting landowners of property that identified as camera locations. The area needed for the camera and associated equipment would be obtained as an easement.

The enclosed Right-of-Entry Agreement/Temporary Construction Easement (ROW/TCE) provides a detailed explanation of the location and work. Access and length of time on the site will be scheduled with the Grantor before entry. If you are willing to grant Fort Bend County the ROE/TCE onto your property, please follow these steps:

- Sign and date the Agreement.
- Add your comments and conditions for the right-of entry at the bottom of the Agreement.
- Make a copy for your records.
- E-mail to: rick.staigle@fbctx.gov

Please note that you are not required to grant Fort Bend County ROE/TCE, however we appreciate your consideration of this request.

If you have any questions or concerns, you may contact me rick.staigle@fbctx.gov or 281-633-7509.

Sincerely,

Rick J. Staigle, PE, PTOE
First Assistant County Engineer

Enclosures

301 Jackson St. | Richmond, TX 77469
Phone 281-633-7500



Project Name: Emergency Network Infrastructure Monitoring System – Phase 1

Project Limits: Various Locations

Mobility Project: 20001

Parcel ID: R264505

The undersigned property owner or authorized designee (Grantor) hereby grants unto Fort Bend County (County, and includes the County's consultants) a right-of-entry (ROE) and Temporary Construction Easement (TCE) upon the real property (Property) shown on the attached map (Attachment A) for the purpose of constructing improvements to monitor area flooding. (Agreement).

County has proposed to construct a Wireless Traffic Signal Communication System (Project). The Property has been identified as a location for a camera with associated equipment as shown in Attachment B. Equipment location shall be marked in the field for final approval by Grantor prior to commencing construction. After construction, the surface will be returned as closely as practicable to its original state. As built drawings will be provided to the Grantor along with final easement documents covering the area where permanent County improvements will remain.

The Grantor understands and agrees to the following terms and conditions:

- After granting the requested ROE/TCE, the Grantor, or authorized agent with signatory responsibilities reserves all rights, titles and interest in and to the Property.
- The ROE/TCE shall not prejudice the Grantor's rights to any relocation benefits for which the Grantor or Grantors would otherwise be eligible.
- The Grantor, Grantors or authorized representative with signatory authority, grants County access to perform the construction activity at its own risk and expense. Grantor shall not be liable for any destruction of, or damage to, the Project arising out of or in connection with the construction, installation, replacement, maintenance, operation, or removal of the Project. Temporary flagging or temporary markers may be used to located specific features or survey points at the Property.
- Upon completion of construction, the County will, at its sole cost and expense, restore the Property to its original condition.
- County and Grantor agree that the primary point of access to the Property shall be from Bees Passage; however, County is authorized to cross other portions of the Property in order to gain access for purposes of the Project, if necessary. County is required to provide notice to Grantor twenty-four (24) hours prior to gaining access.
- The Agreement shall be effective the date it is executed and shall remain in effect until final easement documents are approved by both Parties or one (1) year from the effective date of this Agreement, whichever is earlier.
- The Grantor may be present during the construction. Please indicate the preferred method for notification at the bottom of the form.
- County will provide at least twenty-four (24) hours notice prior to construction activities to the individuals indicated at the bottom of the form.
- The ROE/TCE, unless revoked or terminated, shall extend to and bind the signatory parties, their heirs, executors, administrators, legal representatives, successors, and assigns, including the contractors, consultants, agents and all others County has deemed necessary to share in this ROE/TCE.
- The County warrants that prior to it or any contractor or subcontractor(s) performing any construction on the Property, said contractor and or subcontractor(s) shall furnish to Grantor verification of insurance coverages for the Project. The County will add Grantor as an additional



insured for all insurance required under the construction contract for the Project, to the same extent and in the same manner as the County.

- If the Grantor is not the original individual, by signature, the undersigned authorized representative of the Grantor with signatory authority warrants and represents that he or she is duly authorized and empowered to enter into and to execute the ROE/TCE on behalf of the Grantor.
- If the Property is owned by multiple Grantors, all legal Grantors must sign this ROE/TCE Form for it to be effective.

If you have any questions about the Project, or if you have information about the Property you wish to share, please contact:

Rick J. Staigle, PE, PTOE, First Assistant County Engineer

Email address: rick.staigle@fbctx.gov

Telephone Number: 281-633-7509



Note that information, conditions, or comments concerning the Property may be described below.

This Agreement applies to the Emergency Network Infrastructure Monitoring System – Phase 1 and Parcel ID R264505 and shall be effective as of the date of signature(s) below:

Alvin San Miguel
Signature of Owner/Authorized Agent

Alvin San Miguel
Printed Name of Owner/Authorized Agent

February 27, 2024
Date

Contact Information:

281-778-7799
Telephone Number

alvins@johnsondev.com
E-Mail Address

Mailing Address

Sienna/Johnson North

5777 Sienna Parkway, suite 100

Missouri City, TX 77459

KP George
Signature of Owner/Authorized Agent

KP George
Printed Name of Owner/Authorized Agent

3.12.2024
Date

Contact Information:

281-341-8608
Telephone Number

County.Judge@fortbendcountytexas.gov
E-Mail Address

Mailing Address

401 Jackson

Richmond, TX 77469

Comment/Conditions for Right-of-Entry or Denial of Right-of-Entry
(Include contact information for advanced notification)

Alvin SanMiguel, Vice President, email: Alvins@johnsondev.com

Provide 48 hrs notice prior to entry at project commencement and provide project schedule.

Provide 48 hrs notice of final inspection and project end to confirm final site conditions.



Attachment A

Parcel ID R264505





Attachment B

Asm

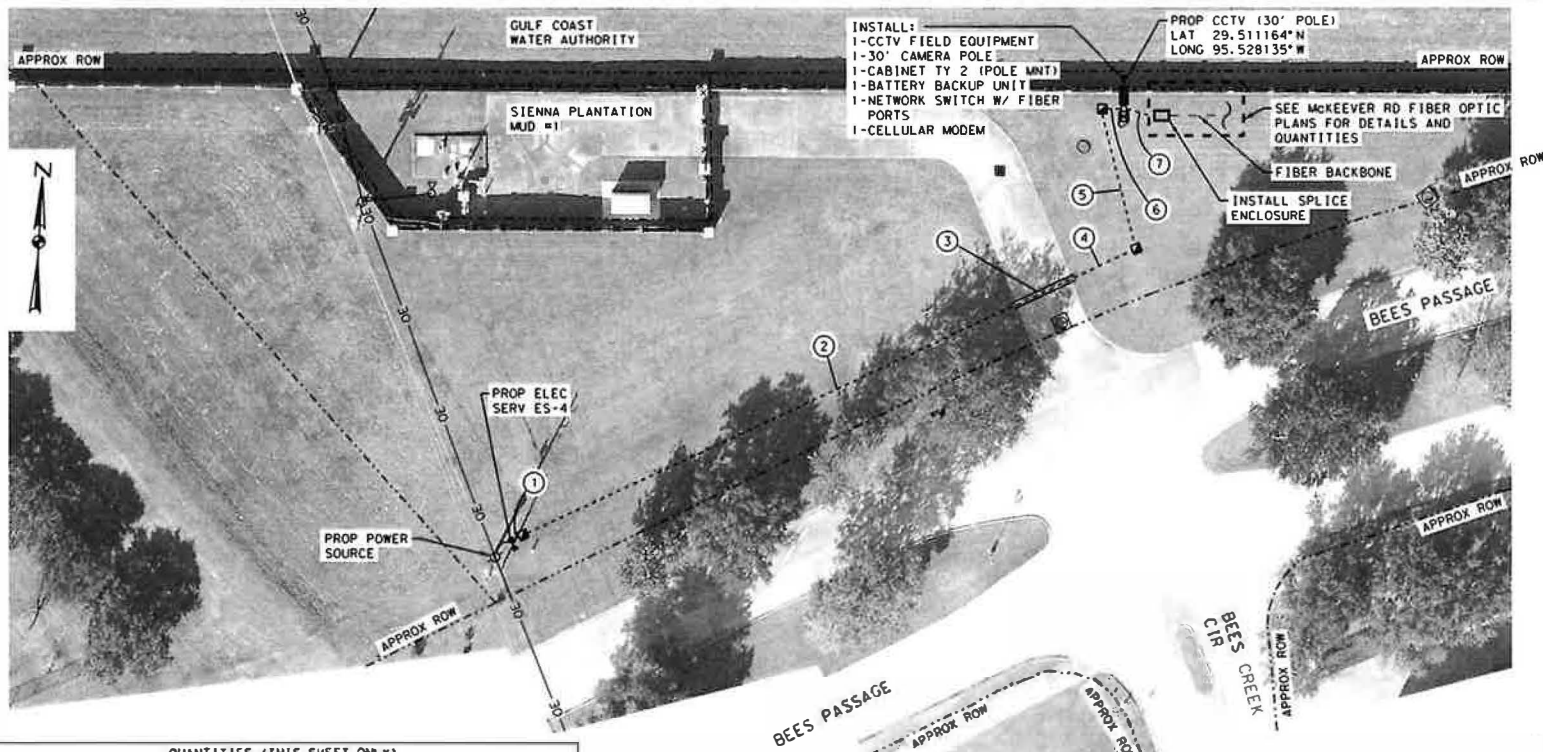

- LEGEND:**
- PROP CCTV W/ CABINET (30' POLE)
 - PROP ELECTRICAL SERVICE
 - PROP GROUND BOX TY A WITH APRON
 - PROP GROUND BOX TY I WITH APRON
 - PROP CONDUIT (TRENCH)
 - PROP CONDUIT (BORE)
 - RUN NUMBER
 - OE OVERHEAD ELECTRICAL
 - FO FIBER OPTIC
 - UT UNDERGROUND TELEPHONE
 - G GAS
 - W WATER

0 20 40
SCALE: 1"=40'

QUANTITIES (THIS SHEET ONLY)			
ITEM-CODE	DESCRIPTION	UNIT	SHEET TOTAL
416 6004	DRILL SHAFT (36 IN)	LF	18
618 6023	CONDT (PVC) (SCH 40) (12")	LF	285
618 6047	CONDT (PVC) (SCH 80) (12") (BORE)	LF	25
620 6002	ELEC CONDR (NO. 14) INSULATED	LF	15
620 6007	ELEC CONDR (NO. 8) BARE	LF	295
620 6008	ELEC CONDR (NO. 8) INSULATED	LF	590
624 6002	GROUND BOX TY A (122311)W/APRON	EA	2
628 6152	ELC SRV TY D 120/240 060INS)SS(N)SP(O)	EA	1
6007 6011	FIBER OPTIC CBL (SINGLE-MODE) (12 FIBER)	LF	40
6010 6011	CCTV FIELD EQUIP (DIGITAL) (INSTL ONLY)	EA	1
6064 6011	ITS POLE (30 FT) (110 MPH)	EA	1
6064 6088	ITS POLE MNT CAB (TY 3) (CONF 1)	EA	1
6094 6011	SPLICE ENCLOSURE	EA	1
	BATTERY BACKUP UNIT	EA	1
**	NETWORK SWITCH W/ FIBER PORTS (INSTALL ONLY)	EA	1
**	CELLULAR MODEM (INSTALL ONLY)	EA	1

UTILITY NOTES:

- THE CONTRACTOR SHALL LOCATE ALL UTILITIES PRIOR TO COMMENCING WORK. THE CONTRACTOR SHALL CONTACT PUBLIC AND PRIVATE UTILITIES FOR LOCATION OF UNDERGROUND FACILITIES AT LEAST 48 HOURS PRIOR TO ANY DRILLING, BORING, TRENCHING, OR EXCAVATING.
- THE CONTRACTOR SHALL BE FULLY RESPONSIBLE FOR ANY DAMAGE CAUSED BY THE CONTRACTOR'S FAILURE TO LOCATE AND PRESERVE THESE UTILITIES, WHETHER UNDERGROUND, ABOVE GROUND, OR OVERHEAD.

CONDUIT AND CABLE SCHEDULE													
RUN NO.	CONDUIT						CABLE						RUN LENGTH
	618 6023		618 6047		620 6002		620 6007		620 6008		6007 6011		
	CONDT (PVC) (SCHD 40) (12")	■ CONDUITS	CONDT (PVC) (SCHD 80) (12") (BORE)	■ CONDUITS	CABLE STATUS	ELEC CONDR (NO. 14) INSULATED	■ CABLES	ELEC CONDR (NO. 8) BARE	■ CABLES	ELEC CONDR (NO. 8) INSULATED	■ CABLES	FIBER OPTIC CBL (SINGLE-MODE) (12 FIBER)	
1	5	1	0		1	0		5	1	10	2	0	5
2	180	1	0		1	0		180	1	360	2	0	180
3	0		25	1	1	0		25	1	50	2	0	25
4	25	1	0		1	0		25	1	50	2	0	25
5	50	1	0		1	0		50	1	100	2	0	50
6	10	1	0		1	0		10	1	20	2	0	10
7	15	1	0		1	15	1	0	0		40	1	15
TOTAL	285		25			15		295		590		40	

STATUS: E = EXISTING; I = INSTALL

NO.	DATE	REVISION	BY

QUAN M. NGUYEN, P.E.

1/25/2023
DATE

iteris

TBPE REG F-4719

FORT BEND COUNTY

EMERGENCY NETWORK INFRASTRUCTURE MONITORING SYSTEM

CCTV SITE LAYOUT
McKEEVER ROAD AT
SIENNA PARKWAY

DESIGNED: OMV	SCALE: 1"=40'
CHECKED: PAR	DATE: 1/25/2023
APPROVED: DEN	SHEET NO: 09