



**FORT BEND GRAND PARKWAY TOLL ROAD AUTHORITY**  
**FORT BEND GRAND PARKWAY TOLL ROAD**  
**CONSTRUCTION CONTRACT CHANGE ORDER NUMBER : 03**  
**SH 99: At W. Airport**  
**PROJECT NO. 126-1002**

- 1) **CONTRACTOR:** Main Lane Industries, LTD
- 2) **CHANGE ORDER WORK STATION LIMITS:**  
 Entire Project
- 3) **DESCRIPTION OF CHANGE:**  
 1. Asphalt milling for mainlanes at Oyster Creek.  
 2. Add standard for rolling closure for construction of overhead sign. - RFI-010 (No cost difference)  
 3. Revise north side u-turn alignment and width, and move curb inlet to avoid electrical ground box - RFI-003 (No cost difference)
- 4) **NEW OR REVISED PLAN SHEET(S) / SKETCHES ARE ATTACHED AND NUMBERED:**  
 New - Sheet 82A  
 Revised plan sheets - 14, 121, 168 and 171.

CONTRACTOR: Main Lane Industries, LTD		<b>RECOMMENDED FOR EXECUTION:</b>	
	 By _____	<u>7-11-2022</u> DATE	
	Printed Name <u>Lee Hergenrather</u>		 <b>CONSTRUCTION MANAGER</b>
	Printed Title <u>Project Manager</u>		<u>1-11-2022</u> DATE
	Time Ext #: <u>N/A</u> Days added on this C.O.: <u>N/A</u>		<b>FBGPTRA REPRESENTATIVE</b> <b>DATE</b> Recommended
	Amount added by this change order: \$23,761.91		 <b>FBGPTRA REPRESENTATIVE</b> <b>DATE</b> Approved
			<u>11-Jan-2023</u>

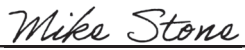

**FORT BEND GRAND PARKWAY TOLL ROAD AUTHORITY**  
**FORT BEND GRAND PARKWAY TOLL ROAD**  
**CONSTRUCTION CONTRACT CHANGE ORDER NUMBER : 03**  
**SH 99: AT PEEK RD.**  
**PROJECT NO. 126-1010**

Date: 7/8/2022



Item	Code	Description	Unit	Quantity Adjustment by This Change Order	Unit Price	Amount Adjustment by This Change Order
		FORCE ACCOUNT - ASPHALT MILLING		1.00	\$23,761.91	\$23,761.91
		AMOUNT ADDED BY THIS CHANGE ORDER=				\$23,761.91

**FORT BEND GRAND PARKWAY TOLL ROAD AUTHORITY**  
**FORT BEND GRAND PARKWAY TOLL ROAD**  
**CONSTRUCTION CONTRACT CHANGE ORDER NUMBER : 04**  
**SH 99: At W. Airport**  
**PROJECT NO. 126-1002**

- 1) **CONTRACTOR:** Main Lane Industries, LTD
- 2) **CHANGE ORDER WORK STATION LIMITS:**  
 SB Frtg Rd - Sta 1006+93.36 to 1013+51.60  
 NB Frtg Rd - Sta 1005+25.55 to 1011+21.22
- 3) **DESCRIPTION OF CHANGE:**  
 1. Remove existing curb by saw cutting pavement where existing pavement is widened.
- 4) **NEW OR REVISED PLAN SHEET(S) / SKETCHES ARE ATTACHED AND NUMBERED:**  
 Revised Sheets - 117, 119

CONTRACTOR: Main Lane Industries, LTD		11-16-2022		<b>RECOMMENDED FOR EXECUTION:</b>	
By 		<b>DATE</b>			
Printed Name <u>Lee Hergenrather</u>		CONSTRUCTION MANAGER		1-11-2023	
Printed Title <u>Project Manager</u>		FBGPTRA REPRESENTATIVE		DATE	
Time Ext #: <u>10</u> Days added on this C.O.: <u>10</u>		Recommended			
Amount added by this change order: <u>\$29,589.75</u>		FBGPTRA REPRESENTATIVE		11-Jan-2023	
		Approved			

76



- |   |  |            |  |   |  |
|---|--|------------|--|---|--|
| CONTRACTOR: Main Lane Industries, LTD   |  | 10-17-2022 |  | RECOMMENDED FOR EXECUTION:  |  |
|  |  | DATE       |  |    |  |
| By _____  |  |            |  | 1-11-2023   |  |
| Printed Name      Lee Hergenrather  |  |            |  | CONSTRUCTION MANAGER      DATE  |  |
| Printed Title      Project Manager  |  |            |  | FBGPTRA REPRESENTATIVE      DATE  |  |
| Time Ext #:      N/A      Days added on this C.O.:      N/A                       |  |            |  | Recommended   |  |
|   |  |            |  |  |  |
|   |  |            |  | 11-Jan-2023   |  |
| Amount added by this change order:      \$2,978.06                                |  |            |  | FBGPTRA REPRESENTATIVE      DATE  |  |
|   |  |            |  | Approved  |  |

**FORT BEND GRAND PARKWAY TOLL ROAD AUTHORITY**  
**FORT BEND GRAND PARKWAY TOLL ROAD**  
**CONSTRUCTION CONTRACT CHANGE ORDER NUMBER : 05**  
**SH 99: AT W. AIRPORT**  
**PROJECT NO. 126-1002**

Item	Code	New Item	Description	Unit	Quantity Adjustment by This Change Order	Unit Price	Amount Adjustment by This Change Order
529	6002		CONC CURB (TY II)	LF	595.00	\$4.00	\$2,380.00
628	6087	✓	ELC SRV TY A 240/480 100(SS)SS(E)SP(U)- CO5	EA	1.00	\$7,598.06	\$7,598.06
628	6086		ELC SRV TY A 240/480 100(SS)SS(E)SP(O)	EA	1.00	(\$7,000.00)	(\$7,000.00)
				<b>AMOUNT ADDED BY THIS CHANGE ORDER=</b>			<b>\$2,978.06</b>

**FORT BEND GRAND PARKWAY TOLL ROAD AUTHORITY**  
**FORT BEND GRAND PARKWAY TOLL ROAD**  
**CONSTRUCTION CONTRACT CHANGE ORDER NUMBER : 06**  
**SH 99: At W. Airport**  
**PROJECT NO. 126-1002**

- 1) **CONTRACTOR:** Main Lane Industries, LTD
- 2) **CHANGE ORDER WORK STATION LIMITS:**  
Sta 952+80 to 960+00
- 3) **DESCRIPTION OF CHANGE:**  
 1. Remove existing toll zone approach pavement markings that are in conflict with the ramp relocations.  
 2. Add toll zone approach pavement markings in advance of new exit ramp..  
 3. Revise sign panels on large ground mounted signs to show "Free Exit".
- 4) **NEW OR REVISED PLAN SHEET(S) / SKETCHES ARE ATTACHED AND NUMBERED:**  
 Revised Plan Sheets - Vol 1 - 106 & 193  
 New - 228A

CONTRACTOR: Main Lane Industries, LTD		<b>RECOMMENDED FOR EXECUTION:</b>	
By	 <div style="text-align: right; padding-right: 50px;">DATE</div>	 <b>CONSTRUCTION MANAGER</b>	<b>1-11-2023</b> <b>DATE</b>
Printed Name	<u>Lee Hergenrather</u>	<b>FBGPTRA REPRESENTATIVE</b>	<b>DATE</b>
Printed Title	<u>Project Manager</u>	Recommended	
Time Ext #: <u>N/A</u>	Days added on this C.O.: <u>N/A</u>	 <b>FBGPTRA REPRESENTATIVE</b>	<b>11-Jan-2023</b> <b>DATE</b>
Amount added by this change order: <u>\$16,659.08</u>		Approved	



**FORT BEND GRAND PARKWAY TOLL ROAD AUTHORITY**  
**FORT BEND GRAND PARKWAY TOLL ROAD**  
**CONSTRUCTION CONTRACT CHANGE ORDER NUMBER : 06**  
**SH 99: AT W. AIRPORT**  
**PROJECT NO. 126-1002**

Item	Code	New Item	Description	Unit	Quantity Adjustment by This Change Order	Unit Price	Amount Adjustment by This Change Order
668	6027		PREFAB PAV MRK TY B (W)(WORD)	EA	8.00	\$650.00	\$5,200.00
668	6032	✓	PREFAB PAV MRK TY B (W)(SYMBOL) - CO6	EA	4.00	\$377.00	\$1,508.00
677	6012	✓	ELIM EXT PAV MRK & MRKS (WORD) - CO6	EA	8.00	\$38.00	\$304.00
677	6017	✓	ELIM EXT PAV MRK & MRKS (SYMBOL) - CO6	EA	4.00	\$22.00	\$88.00
678	6016		PAV SURF PREP FOR MRK (WORD)	EA	8.00	\$20.00	\$160.00
678	6021	✓	PAV SURF PREP FOR MRK (SYMBOL) - CO6	EA	4.00	\$11.00	\$44.00
636	6002		ALUMINUM SIGNS (TY G)	SF	148.00	\$63.21	\$9,355.08
				<b>AMOUNT ADDED BY THIS CHANGE ORDER=</b>			<b>\$16,659.08</b>



**FORT BEND GRAND PARKWAY TOLL ROAD AUTHORITY**  
**FORT BEND GRAND PARKWAY TOLL ROAD**  
**CONSTRUCTION CONTRACT CHANGE ORDER NUMBER : 07**  
**SH 99: At W. Airport**  
**PROJECT NO. 126-1002**

- 1) **CONTRACTOR:** Main Lane Industries, LTD
- 2) **CHANGE ORDER WORK STATION LIMITS:**  
Sta 1057+31 to 1060+40 (SBRMP1)
- 3) **DESCRIPTION OF CHANGE:**  
1. Extend MBGF and replace SET past existing overhead sign column since column is in clear zone due to auxiliary lane addition.
- 4) **NEW OR REVISED PLAN SHEET(S) / SKETCHES ARE ATTACHED AND NUMBERED:**  
Revised Plan Sheets - Vol 1 - 20, 21, 103 & 122

CONTRACTOR: Main Lane Industries, LTD		1-10-2023	
 By _____		DATE	
Printed Name <u>Lee Hergenrather</u>		 CONSTRUCTION MANAGER	
Printed Title <u>Project Manager</u>		1-11-2023 DATE	
Time Ext #: <u>N/A</u> Days added on this C.O.: <u>N/A</u>		FBGPTRA REPRESENTATIVE Recommended	
Amount added by this change order: \$6,414.36		 FBGPTRA REPRESENTATIVE Approved	
		11-Jan-2023 DATE	

**FORT BEND GRAND PARKWAY TOLL ROAD AUTHORITY**  
**FORT BEND GRAND PARKWAY TOLL ROAD**  
**CONSTRUCTION CONTRACT CHANGE ORDER NUMBER : 07**  
**SH 99: AT W. AIRPORT**  
**PROJECT NO. 126-1002**

Item	Code	New Item	Description	Unit	Quantity Adjustment by This Change Order	Unit Price	Amount Adjustment by This Change Order
540	6001		MTL W-BEAM GD FEN (TIM POST)	LF	75.00	\$28.00	\$2,100.00
544	9001	✓	GUARDRAIL END TREATMENT (REMOVE & INSTALL	EA	1.00	\$4,314.36	\$4,314.36
				<b>AMOUNT ADDED BY THIS CHANGE ORDER=</b>			<b>\$6,414.36</b>

LOCATION	SUMMARY OF REMOVAL ITEMS															
	104 6001	104 6009	104 6021	104 6054	105 6018	354 6021	420 6019	496 6002	496 6007	542 6001	542 6003	544 6003	644 6076	650 6204	677 6002	677 6003
	REMOVING CONC (PAV)	REMOVING CONC (RIPRAP)	REMOVING CONC (CURB)	REMOVING CONCRETE (MOW STRIP)	REMOVING STAB BASE AND ASPH PAV (7")	PLANE ASPH CONC PAV (0" TO 2")	CL A CONC (PLUG)	REMOV STR (INLET)	REMOV STR (PIPE)	REMOVE METAL BEAM GUARD FENCE	REMOVE DOWNSTREAM ANCHOR TERMINAL	GUARDRAIL END TREATMENT (REMOVE)	REMOVE SM RD SN SUP&AM	REMOVE OVERHD SIGN SUP	ELIM EXT PAV MRK & MRKS (6")	ELIM EXT PAV MRK & MRKS (8")
	SY	SY	LF	LF	SY	SY	EA	EA	LF	LF	EA	EA	EA	EA	LF	LF
BEGIN TO STA 968+00														1	910	
STA 968+00 TO STA 980+00	5				5										144	
STA 980+00 TO STA 992+00	4036				4036				22				3	1	77	
STA 992+00 TO STA 1004+00	3559		551		2100		1	1	29				3		118	
STA 1004+00 TO STA 1016+00	409		1634										6		1399	420
STA 1016+00 TO STA 1027+00															743	
STA 1027+00 TO END															404	
BEGIN TO STA 1064+00						5						13			328	
STA 1064+00 TO STA 1076+00						48							1		1200	
STA 1076+00 TO STA 1088+00						75									2296	
STA 1088+00 TO STA 1100+00	4	89	81		75				191			1	3		2400	
STA 1100+00 TO END	4	472	13		14				20	1					358	
PROJECT TOTALS	8009	8	2746	94	6141	217	1	1	51	211	1	2	16	2	10377	420

1	11/20	REMOVE MBGF	GAO
NO.	DATE	REVISION	APPROVED
<p><b>Fort Bend Grand Parkway Toll Road Authority</b></p> <p><b>LJA Engineering, Inc.</b> </p> <p>FRN-F-1005</p> <p><b>FORT BEND GRAND PARKWAY TOLL ROAD AUTHORITY</b></p> <p><b>SUMMARY OF REMOVAL QUANTITIES</b></p> <p>SHEET 1 OF 1</p> <p>DESIGNED: CA      HORZ SCALE:</p> <p>DESIGNED: CA      VERT SCALE:</p> <p>CHECKED: JRB      DATE: 7/9/2020</p> <p>APPROVED: JRB      SHEET NO: 20</p> <p>CSJ:      SECTION</p>			

LOCATION	SUMMARY OF ROADWAY ITEMS					
	536 6002	540 6001	540 6006	540 6016	544 6001	690 6007
CONC MEDIAN		MTL W-BEAM GD FEN (TIM POST)	MTL BEAM GD FEN TRANS (THRIE-BEAM)	DOWNSTREAM ANCHOR TERMINAL SECTION	GUARDRAIL END TREATMENT (INSTALL)	REPLACE O GROUND BOXES
SY		LF	EA	EA	EA	EA
NBFR BEGIN TO STA 982+00						
NBFR STA 982+00 TO STA 994+00						
NBFR STA 994+00 TO END						
NBEXRMP BEGIN TO STA 968+00						
NBEXRMP STA 968+00 TO END						
NBENRMP BEGIN TO STA 1017+00						
NBENRMP STA 1017+00 TO END						
SB FRONTAGE RD						
NB U-TURN	1478					
SB U-TURN	996					
SB/NB ML BEGIN TO STA 1069+00		75			134	1
SB/NB ML STA 1069+00 TO STA 1081+00						
SB/NB ML STA 1081+00 TO STA 1093+00		137.5		1	1	
SB/NB ML STA STA 1093+00 TO END		62.5	1		1	
PROJECT TOTALS	2474	275	1	1	3	1

DRAWN: CA	HORIZ SCALE:
DESIGNED: CA	VERT SCALE:
CHECKED: JRB	DATE: 3/22/2021
APPROVED: JRB	SHEET NO: 21
CSJ:	SECTION

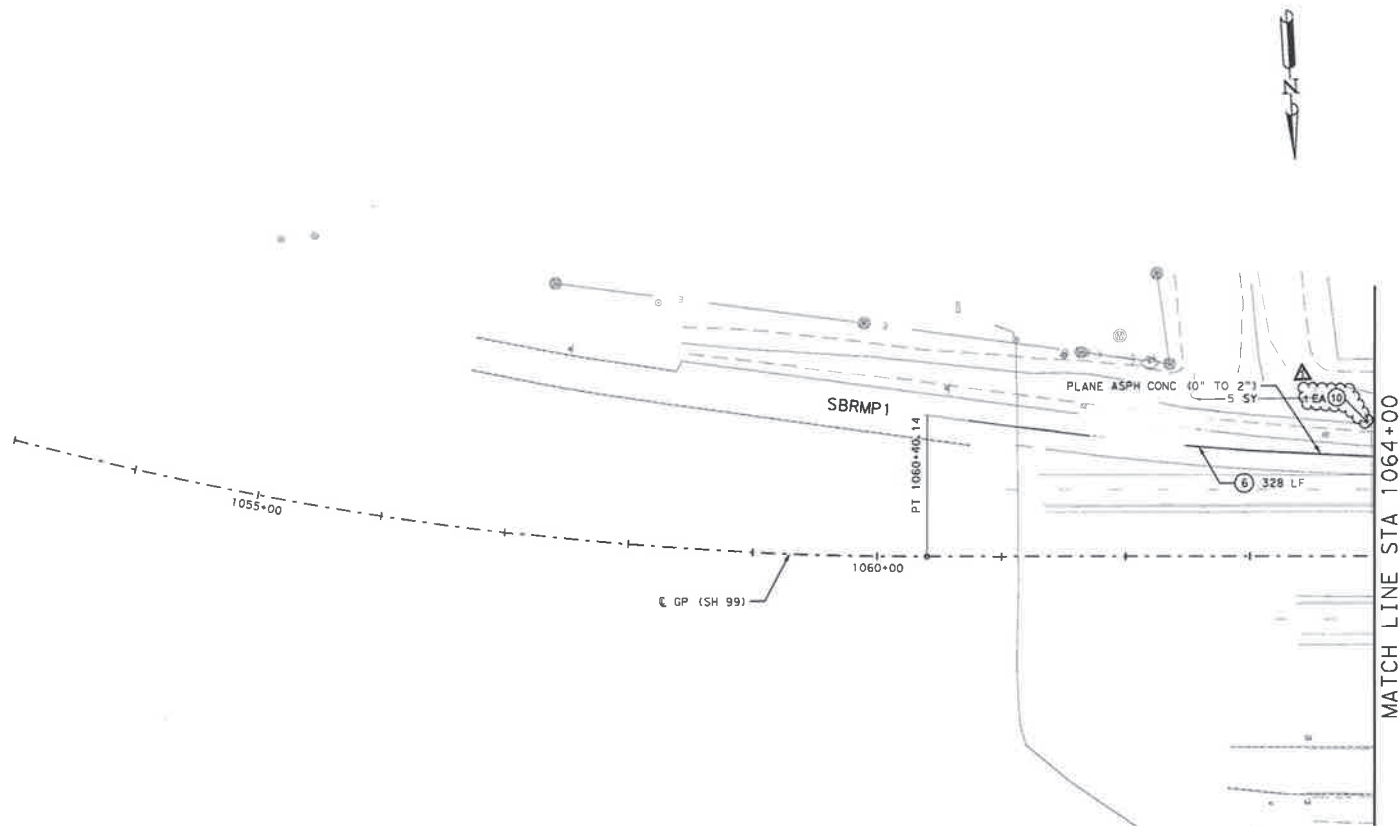

# LEGEND

- EXIST CONCRETE PAVEMENT (TO BE REMOVED)
- EXIST CONCRETE PAVEMENT AND TREATED BASE (TO BE REMOVED)
- EXIST MOWSTRIP (TO BE REMOVED)
- ① REMOVING CONC (RIPRAP)
- ② REMOVING CONC (MEDIANS)
- ③ REMOVING CONC (CURB)
- ④ REMOVING CONC (CTB)
- ⑤ REMOVE SM RD SN SUP&AM
- ⑥ ELIM EXT PAV MRK & MRKS (6")
- ⑦ ELIM EXT PAV MRK & MRKS (8")
- ⑧ ELIM EXT PAV MARK & MRKS (24")
- ⑨ REMOVING MBGF
- ⑩ REMOVE SGT
- ⑪ REMOVE DAT
- ⑫ SAWCUT

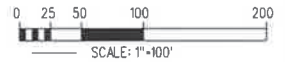

NO.	DATE	REVISION	APPROVED
1	11/22	REMOVE MBGF	GAO



7/9/2020

**Fort Bend Grand Parkway  
Toll Road Authority**

**LJA Engineering, Inc.**  
 FBN-F-1386

**FORT BEND GRAND PARKWAY TOLL  
ROAD AUTHORITY  
REMOVAL LAYOUT**

BEGIN TO STA 1064+00

SHEET 8 OF 12

DRAWN: CA	HORIZ SCALE:
DESIGNED: CA	VERT SCALE:
CHECKED: JRB	DATE: 7/9/2020
APPROVED: JRB	SHEET NO: 103
CSJ:	SECTION

THE SEAL OF GREGORY A. OFIELD, P.E., NO 64178  
 SHOWN HEREON APPLIES ONLY TO THE CHANGES  
 AND/OR MODIFICATIONS TO THE DESIGN  
 AS INDICATED BY  
 11/11/2022

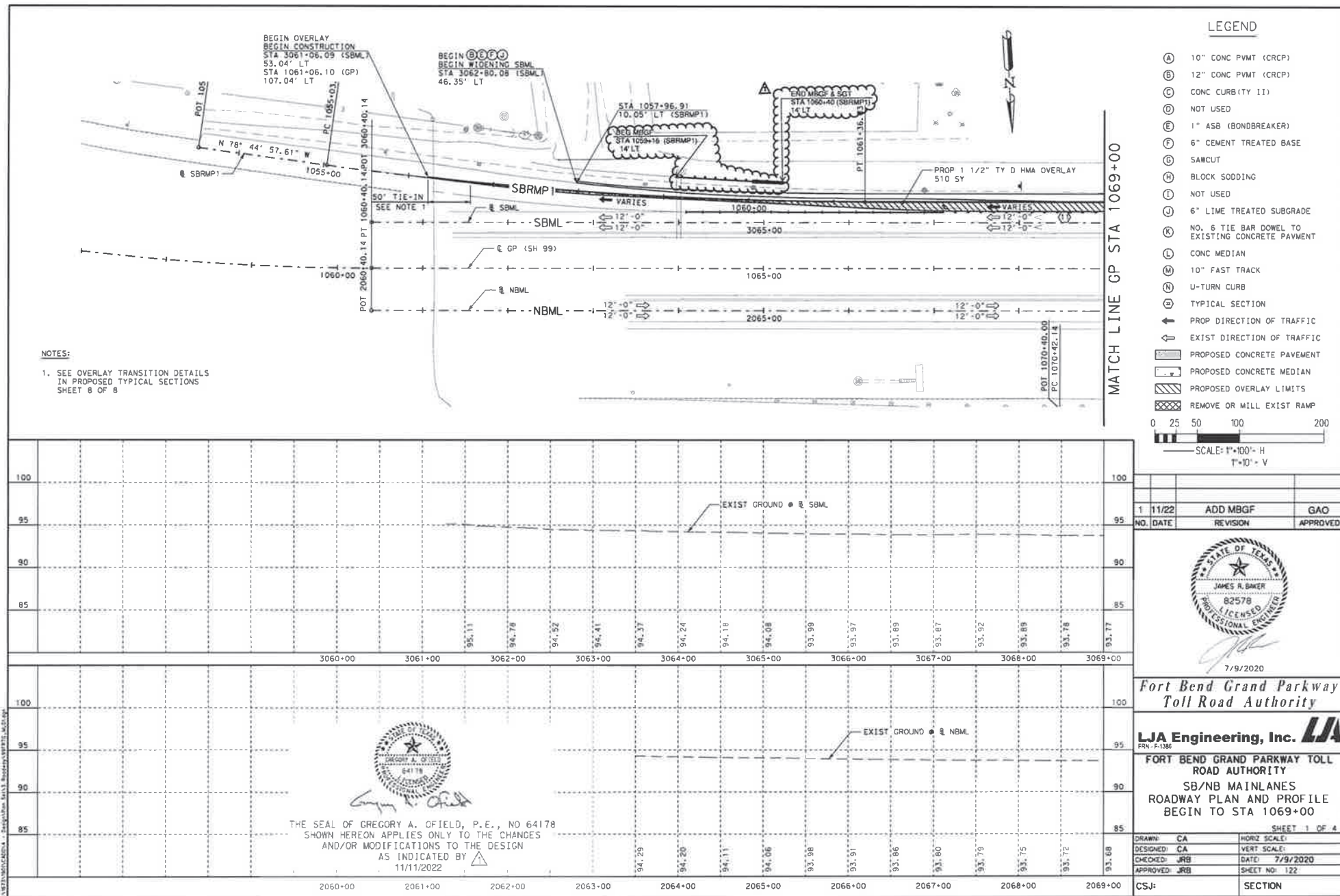



**FBGPTRA****Request for Change Order**

PROJECT#: 126-1002 FBGPTRA SH 99

28" TY Guardrail End Treatment

1

COUNTY: FORT BEND

HIGHWAY: SH-99

**LABOR**

LABORER

Qty	Days	Rate	Hours	Total
	1	\$ 16.50	10	\$ -
				<b>\$0.00</b>

**EQUIPMENT**

Qty	Days	FHWA Hourly Rate	Hours	Total
				<b>\$0.00</b>

**MATERIAL/SUPPLIES**

Unit	Qty	Price	Total
			<b>\$ -</b>

**SUBCONTRACTORS**

Willow City

Unit	Qty	Price	Total
EA	1	\$4,068.23	\$ 4,068.23
			<b>\$4,068.23</b>

Base Labor

	\$ -
Burden 55%	\$ -
Markup 25%	\$ -
Sub-Total	\$ -

Equipment

	\$ -
Markup 15%	\$ -
Sub-Total	\$ -

Materials, Supplies

	\$ -
25%	\$ -
Sub-Total	\$ -

Subcontractors

	\$ 4,068.23
5%	\$ 203.41
Sub-Total	\$ 4,271.64

Bond

Sub-Total	\$ 4,271.64
1%	\$ 42.72
Sub-Total	

**Total Price \*\*\* \$ 4,314.36****\$ 4,314.36**

WILLOW CITY SIGN & RAIL, INC.  
P.O. Box 455  
Magnolia, Texas 77353  
Cindy Rhoades, President  
Phone #281-356-6663 Fax #281-356-6387  
DBE, WBE, MBE, SBE, HUB  
TXDOT, COH, POH & METRO CERTIFIED

November 23, 2022

Main Lane Industries

ATTN: Lee Hergenrather

RE: Fort Bend Grand Parkway Toll Road Authority  
Project: SH 99  
ML Job # 210222

Subject: Added Remove & Install Guardrail End Treatment (TY I)(Old Spec - 28") (1EA)

<u>MATERIAL:</u>			<u>Unit Price</u>	<u>TOTAL</u>
1	EA	Guardrail End Treatment (TY I)	\$ 2,090.00	\$ 2,090.00
		15% Compensation		\$ 313.50
<u>LABOR:</u>				
4.5	HRS	Foreman	\$ 35.00	\$ 157.50
4.5	HRS	Common Labor	\$ 25.50	\$ 114.75
4.5	HRS	Common Labor	\$ 25.50	\$ 114.75
4.5	HRS	Common Labor	\$ 24.00	\$ 108.00
4.5	HRS	Common Labor	\$ 24.00	\$ 108.00
		55% Burden		\$ 331.65
		15% Compensation		\$ 90.45
<u>EQUIPMENT:</u>				
4.5	HRS	2019 Chevrolet 6500, SFA 4x2 Diesel	\$ 67.85	\$ 305.33
4.5	HRS	2000 Starlite 30' Trailer(Non-Tilt Deck Utility) Gooseneck	\$ 2.48	\$ 11.16
4.5	HRS	2018 Bobcat Skid Loader (S185)	\$ 48.68	\$ 219.06
4.5	HRS	Small Generator Set, 5000 W, 11 HP, Gas	\$ 4.59	\$ 20.66
		15% Compensation		\$ 83.43
			<b>TOTAL</b>	<b>\$ 4,068.23</b>

NOTE: This Quote Includes Removal/Installation Within Same Mobilization of Guardrail LF Extension  
1 Mobilization Included

NOTE: This Quote Includes Furnishing An Old Spec (28") TY I Guardrail End Treatment - MATERIAL IS NOT MASH COMPLIANT

NOTE: This Quote Does Not Include Replacement of Entire Existing Guardrail Layout (Extension to be Applied to Existing Materials Per FBGPTRA)

NOTE: This Quote Does Not Include Delivery of Any Removed Materials

NOTE: This Quote Does Not Include Any Concrete Removal and/or Repair Work

NOTE: Concrete Mow Strip, Non- Mow Strip or 2 Sack Grout is not included

NOTE: Removal of Mow Strip is not included in this quote.

NOTE: TY II CONCRETE CURB IS NOT INCLUDED IN THIS QUOTE

NOTE: THERE IS NO TRAFFIC HANDLING INCLUDED IN THIS QUOTE.

NOTE: This Quote does not include Performance or Payment Bonds.

NOTE: Night Work or Sunday is not included in this quote

NOTE: This Quote Does Not Include Railroad Safety Orientations/ or Railroad Insurance

**NOTE: THIS QUOTE IS GOOD FOR 30 DAYS FROM THIS DATE DUE TO EXTREME  
CHANGES IN STEEL MATERIAL COST.**

SUBMITTED BY: KRYSTA HADLEY





P.O. Box 938  
Round Rock, TX 78680  
(512) 388-0588  
(512) 388-0417 Fax  
www.txcorr.com

## QUOTE

Grates  
Sign Post  
Geotextiles  
Bridge Railing  
Metal Fabrication  
Safety Pipe Runners  
Corrugated Steel Pipe  
Cast Iron Rings & Covers  
Metal Beam Guard Fence

WILLOW CITY SIGN & RAIL

ATTN: KRYSTA

FORT BEND GRAND PARKWAY  
SH99 AT WEST AIRPORT  
Project: CHANGE ORDER

DESCRIPTION	UNIT	QUANTITY	PRICE	EXT
GUARDRAIL END TREATMENT (TY I)	EA	1.00	\$2,090.00	\$2,090.00

TERMS OF PAYMENT: NET 30 DAYS  
PRICES VALID FOR 30 DAYS  
SALES TAX NOT INCLUDED  
TOLERANCES: INDIVIDUAL PART:  $\pm .25"$ ; LINEAR:  $\pm 3"$  (CMP) &  
 $\pm .5"$  (RAIL, SIGN SUPPORT); ANGULAR:  $\pm 1^\circ$

DELIVERY: 2-3 WEEKS  
F.O.B. POINT: TRUCKS-CUSTOMER YARD W/  
A FULL TRUCK LOAD ORDER

Subject to being awarded the contract, we accept your proposal  
to furnish the job requirements at the unit prices quoted above

Company Name \_\_\_\_\_

Print Name \_\_\_\_\_

Signature \_\_\_\_\_ Date \_\_\_\_\_

Respectfully submitted,

TEXAS CORRUGATORS-AUSTIN DIVISION, INC

NAME: RYAN COLE

DATE: 11/22/2022



**Rental Rate Blue Book®**

November 7, 2022

**Miscellaneous 4X2 35KGW DSL**  
On-Highway Truck Tractors

Size Class:  
**33,001 - 45,000 GVW**  
Weight:  
**12609 lbs**

**Configuration for 4X2 35KGW DSL**

Axle Configuration	<b>4X2</b>	Horsepower	<b>329.0</b>
Maximum Gross Vehicle Weight	<b>35000.0 lbs</b>	Power Mode	<b>Diesel</b>

**Blue Book Rates**

\*\* FHWA Rate is equal to the monthly ownership cost divided by 176 plus the hourly estimated operating cost.

	Ownership Costs				Estimated Operating Costs	FHWA Rate**
	Monthly	Weekly	Daily	Hourly	Hourly	Hourly
Published Rates	USD \$2,710.00	USD \$760.00	USD \$190.00	USD \$29.00	USD \$52.78	USD \$68.18
<b>Adjustments</b>						
Region ( Texas: 98%)	(USD \$54.20)	(USD \$15.20)	(USD \$3.80)	(USD \$0.58)		
Model Year (2019: 99.9%)	(USD \$2.73)	(USD \$0.76)	(USD \$0.19)	(USD \$0.03)		
Adjusted Hourly Ownership Cost (100%)	-	-	-	-		
Hourly Operating Cost (100%)					-	
<b>Total:</b>	<b>USD \$2,653.07</b>	<b>USD \$744.04</b>	<b>USD \$186.01</b>	<b>USD \$28.39</b>	<b>USD \$52.78</b>	<b>USD \$67.85</b>

**Non-Active Use Rates**

	Hourly
Standby Rate	USD \$7.54
Idling Rate	USD \$55.64

**Rate Element Allocation**

Element	Percentage	Value
Depreciation (ownership)	50%	USD \$1,355.00/mo
Overhaul (ownership)	33%	USD \$894.30/mo
CFC (ownership)	4%	USD \$108.40/mo
Indirect (ownership)	13%	USD \$352.30/mo
Fuel (operating) @ USD 5.03	77%	USD \$40.57/hr

Revised Date: 4th quarter 2022

These are the most accurate rates for the selected Revision Date(s). However, due to more frequent online updates, these rates may not match Rental Rate Blue Book Print. Visit the Cost Recovery Product Guide on our Help page for more information.

The equipment represented in this report has been exclusively prepared for JOSH HOUSTON  
(houstonj@vmcmail.com)

**Rental Rate Blue Book®**

November 7, 2022

**Miscellaneous TOW 2 1 6**

Non-Tilt Deck Utility Trailers

Size Class:

All

Weight:

4500 lbs

**Configuration for TOW 2 1 6**

Capacity	6.0 t	Hitch Type	Tow
Number Of Axles	2.0	Number Of Tires	4.0
Power Mode	Manual		

**Blue Book Rates**

\*\* FHWA Rate is equal to the monthly ownership cost divided by 176 plus the hourly estimated operating cost.

	Ownership Costs				Estimated Operating Costs	FHWA Rate**
	Monthly	Weekly	Daily	Hourly	Hourly	Hourly
Published Rates	USD \$240.00	USD \$67.00	USD \$17.00	USD \$3.00	USD \$1.35	USD \$2.71
<b>Adjustments</b>						
Region ( Texas: 96.8%)	(USD \$7.68)	(USD \$2.14)	(USD \$0.54)	(USD \$0.10)		
Model Year (2000: 85.67%)	(USD \$33.28)	(USD \$9.29)	(USD \$2.36)	(USD \$0.42)		
Adjusted Hourly Ownership Cost (100%)						
Hourly Operating Cost (100%)						
<b>Total:</b>	<b>USD \$199.04</b>	<b>USD \$55.56</b>	<b>USD \$14.10</b>	<b>USD \$2.49</b>	<b>USD \$1.35</b>	<b>USD \$2.48</b>

**Non-Active Use Rates**

	Hourly
Standby Rate	USD \$0.57
Idling Rate	USD \$1.13

**Rate Element Allocation**

Element	Percentage	Value
Depreciation (ownership)	50%	USD \$120.00/mo
Overhaul (ownership)	32%	USD \$76.80/mo
CFC (ownership)	4%	USD \$9.60/mo
Indirect (ownership)	14%	USD \$33.60/mo

Fuel cost data is not available for these rates.

Revised Date: 4th quarter 2022

These are the most accurate rates for the selected Revision Date(s). However, due to more frequent online updates, these rates may not match Rental Rate Blue Book Print. Visit the Cost Recovery Product Guide on our Help page for more information.

The equipment represented in this report has been exclusively prepared for JOSH HOUSTON  
(houstonj@vmcmail.com)

**Rental Rate Blue Book®**

November 7, 2022

**Bobcat S185 (disc. 2013)**  
Skid Steer Loaders

Size Class:  
**1751 - 2200 lbs**  
Weight:  
**6220 lbs**

**Configuration for S185 (disc. 2013)**

Operator Protection      **ROPS/FOPS**      Power Mode      **Diesel**
**Blue Book Rates**

\*\* FHWA Rate is equal to the monthly ownership cost divided by 176 plus the hourly estimated operating cost.

	Ownership Costs				Estimated Operating Costs	FHWA Rate**
	Monthly	Weekly	Daily	Hourly	Hourly	Hourly
Published Rates	USD \$4,295.00	USD \$1,205.00	USD \$300.00	USD \$45.00	USD \$25.28	USD \$49.68
<b>Adjustments</b>						
Region ( Texas: 95.9%)	(USD \$176.10)	(USD \$49.40)	(USD \$12.30)	(USD \$1.85)		
Model Year (2013: 100%)	-	-	-	-		
Adjusted Hourly Ownership Cost (100%)	-	-	-	-		
Hourly Operating Cost (100%)					-	
<b>Total:</b>	<b>USD \$4,118.90</b>	<b>USD \$1,155.59</b>	<b>USD \$287.70</b>	<b>USD \$43.15</b>	<b>USD \$25.28</b>	<b>USD \$48.68</b>

**Non-Active Use Rates**

	Hourly
Standby Rate	USD \$11.70
Idling Rate	USD \$34.76

**Rate Element Allocation**

Element	Percentage	Value
Depreciation (ownership)	16%	USD \$687.20/mo
Overhaul (ownership)	68%	USD \$2,920.60/mo
CFC (ownership)	4%	USD \$171.80/mo
Indirect (ownership)	12%	USD \$515.40/mo
Fuel (operating) @ USD 5.03	45%	USD \$11.36/hr

Revised Date: 4th quarter 2022

These are the most accurate rates for the selected Revision Date(s). However, due to more frequent online updates, these rates may not match Rental Rate Blue Book Print. Visit the Cost Recovery Product Guide on our Help page for more information.

The equipment represented in this report has been exclusively prepared for JOSH HOUSTON  
(houstonj@vmcmail.com)