



2.2 All employees of Contractor shall have such knowledge and experience as will enable them to perform the duties assigned to them. Any employee of Contractor who, in the opinion of County, is incompetent or by his conduct becomes detrimental to the project shall, upon request of County, immediately be removed from association with the project.

**Section 3. Compensation and Payment**

3.1 Contractor's fees shall be calculated at the rates set forth in the attached Exhibit A. The Maximum Compensation for the performance of Services within the Scope of Services described in Exhibit A is **five hundred forty thousand dollars and 00/100 (\$540,000.00)**. In no case shall the amount paid by County under this Agreement exceed the Maximum Compensation without an approved change order.

3.2 All performance of the Scope of Services by Contractor including any changes in the Scope of Services and revision of work satisfactorily performed will be performed only when approved in advance and authorized by County.

3.3 County will pay Contractor based on the following procedures: Upon completion of the tasks identified in the Scope of Services, Contractor shall submit to County two (2) original copies of invoices showing the amounts due for services performed in a form acceptable to County. County shall review such invoices and approve them within 30 calendar days with such modifications as are consistent with this Agreement and forward same to the Auditor for processing. County shall pay each such approved invoice within thirty (30) calendar days. County reserves the right to withhold payment pending verification of satisfactory work performed.

**Section 4. Limit of Appropriation**

4.1 Contractor clearly understands and agrees, such understanding and agreement being of the absolute essence of this Agreement, that County shall have available the total maximum sum of **five hundred forty thousand dollars and 00/100 (\$540,000.00)**, specifically allocated to fully discharge any and all liabilities County may incur.

4.2 Contractor does further understand and agree, said understanding and agreement also being of the absolute essence of this Agreement, that the total maximum compensation that Contractor may become entitled to and the total maximum sum that County may become liable to pay to Contractor shall not under any conditions, circumstances, or interpretations thereof exceed **five hundred forty thousand dollars and 00/100 (\$540,000.00)**.

**Section 5. Time of Performance**

The time for performance of the Scope of Services by Contractor shall begin upon receipt of the Notice to Proceed from County and end no later than May 31, 2021. Contractor shall complete the tasks described in the Scope of Services within this time or within such additional time as may be extended by the County in writing.

**Section 6. Modifications and Waivers**

6.1 The parties may not amend or waive this Agreement, except by a written agreement executed by both parties.

6.2 No failure or delay in exercising any right or remedy or requiring the satisfaction of any condition under this Agreement, and no course of dealing between the parties, operates as a waiver or estoppel of any right, remedy, or condition.

6.3 The rights and remedies of the parties set forth in this Agreement are not exclusive of, but are cumulative to, any rights or remedies now or subsequently existing at law, in equity, or by statute.

**Section 7. Termination**

7.1 Termination for Convenience

7.1.1 County may terminate this Agreement at any time upon thirty (30) days written notice.

7.2 Termination for Default

7.2.1 County may terminate the whole or any part of this Agreement for cause in the following circumstances:

7.2.1.1 If Contractor fails to perform services within the time specified in the Scope of Services or any extension thereof granted by the County in writing;

7.2.1.2 If Contractor materially breaches any of the covenants or terms and conditions set forth in this Agreement or fails to perform any of the other provisions of this Agreement or so fails to make progress as to endanger performance of this Agreement in accordance with its terms, and in any of these circumstances does not cure such breach or fails to cure such breach to County's reasonable satisfaction within a period of ten (10) calendar days after receipt of notice from County specifying such breach or failure.

7.2.2 If, after termination, it is determined for any reason whatsoever that Contractor was not in default, or that the default was excusable, the rights and obligations of the parties shall be the same as if the termination had been issued for the convenience of the County in accordance with Section 7.1 above.

7.3 Upon termination of this Agreement, County shall compensate Contractor in accordance with Section 3, above, for those services which were provided under this Agreement prior to its termination and which have not been previously invoiced to County. Contractor's final invoice for said services will be presented to and paid by County in the same manner set forth in Section 3 above.

7.4 If County terminates this Agreement as provided in this Section, no fees of any type, other than fees due and payable at the Termination Date, shall thereafter be paid to Contractor.

**Section 8. Ownership and Reuse of Documents**

All documents, data, reports, research, graphic presentation materials, etc., developed by Contractor as a part of its work under this Agreement, shall become the property of County upon completion of this Agreement, or in the event of termination or cancellation thereof, at the time of payment under Section 3 for work performed. Contractor shall promptly furnish all such data and material to County on request.

**Section 9. Inspection of Books and Records**

Contractor will permit County, or any duly authorized agent of County, to inspect and examine the books and records of Contractor for the purpose of verifying the amount of work performed under the Scope of Services. County's right to inspect survives the termination of this Agreement for a period of four years.

**Section 10. Insurance**

10.1 Prior to commencement of the Services, Contractor shall furnish County with properly executed certificates of insurance which shall evidence all insurance required and provide that such insurance shall not be canceled, except on 30 days' prior written notice to County. Contractor shall provide certified copies of insurance endorsements and/or policies if requested by County. Contractor shall maintain such insurance coverage from the time Services commence until Services are completed and provide replacement certificates, policies and/or endorsements for any such insurance expiring prior to completion of Services. Contractor shall obtain such insurance written on an Occurrence form from such companies having Bests rating of A/VII or better, licensed or approved to transact business in the State of Texas, and shall obtain such insurance of the following types and minimum limits:

10.1.1 Workers' Compensation insurance. Substitutes to genuine Workers' Compensation Insurance will not be allowed. Employers' Liability insurance with limits of not less than \$1,000,000 per injury by accident, \$1,000,000 per injury by disease, and \$1,000,000 per bodily injury by disease.

10.1.2 Commercial general liability insurance with a limit of not less than \$1,000,000 each occurrence and \$2,000,000 in the annual aggregate. Policy shall cover liability for bodily injury, personal injury, and property damage and products/completed operations arising out of the business operations of the policyholder.

10.1.3 Business Automobile Liability insurance with a combined Bodily Injury/Property Damage limit of not less than \$1,000,000 each accident. The policy shall cover liability arising from the operation of licensed vehicles by policyholder.

10.1.4 Professional Liability may be made on a Claims Made form with insurance with limits not less than \$1,000,000.

10.2 County and the members of Commissioners Court shall be named as additional insured to all required coverage except for Workers' Compensation and Professional Liability. All Liability policies including Workers' Compensation written on behalf of Contractor, shall contain a waiver of subrogation in favor of County and members of Commissioners Court.

10.3 If required coverage is written on a claims-made basis, Contractor warrants that any retroactive date applicable to coverage under the policy precedes the effective date of the contract; and that continuous coverage will be maintained or an extended discovery period will be exercised for a period of 2 years beginning from the time that work under the Agreement is completed.

**Section 11. Indemnity**

**CONTRACTOR SHALL INDEMNIFY AND DEFEND COUNTY AGAINST ALL LOSSES, LIABILITIES, CLAIMS, CAUSES OF ACTION, AND OTHER EXPENSES, INCLUDING REASONABLE ATTORNEYS FEES, ARISING FROM ACTIVITIES OF CONTRACTOR, ITS AGENTS, SERVANTS OR EMPLOYEES, PERFORMED UNDER THIS AGREEMENT THAT RESULT FROM THE NEGLIGENT ACT, ERROR, OR OMISSION OF CONTRACTOR OR ANY OF CONTRACTOR'S AGENTS, SERVANTS OR EMPLOYEES.**

**Section 12. Confidential and Proprietary Information**

12.1 Contractor acknowledges that it and its employees or agents may, in the course of performing their responsibilities under this Agreement, be exposed to or acquire information that is confidential to County. Any and all information of any form obtained by Contractor or its employees or agents from County in the performance of this Agreement shall be deemed to be confidential information of County ("Confidential Information"). Any reports or other documents or items (including software) that result from the use of the Confidential Information by Contractor shall be treated with respect to confidentiality in the same manner as the Confidential Information. Confidential Information shall be deemed not to include information that (a) is or becomes (other than by disclosure by Contractor) publicly known or is contained in a publicly available document; (b) is rightfully in Contractor's possession without the obligation of nondisclosure prior to the time of its disclosure under this Agreement; or (c) is independently developed by employees or agents of Contractor who can be shown to have had no access to the Confidential Information.

12.2 Contractor agrees to hold Confidential Information in strict confidence, using at least the same degree of care that Contractor uses in maintaining the confidentiality of its own confidential information, and not to copy, reproduce, sell, assign, license, market, transfer or otherwise dispose of, give, or disclose Confidential Information to third parties or use Confidential Information for any purposes whatsoever other than the provision of Services to County hereunder, and to advise each of its employees and agents of their

obligations to keep Confidential Information confidential. Contractor shall use its best efforts to assist County in identifying and preventing any unauthorized use or disclosure of any Confidential Information. Without limitation of the foregoing, Contractor shall advise County immediately in the event Contractor learns or has reason to believe that any person who has had access to Confidential Information has violated or intends to violate the terms of this Agreement and Contractor will at its expense cooperate with County in seeking injunctive or other equitable relief in the name of County or Contractor against any such person. Contractor agrees that, except as directed by County, Contractor will not at any time during or after the term of this Agreement disclose, directly or indirectly, any Confidential Information to any person, and that upon termination of this Agreement or at County's request, Contractor will promptly turn over to County all documents, papers, and other matter in Contractor's possession which embody Confidential Information.

12.3 Contractor acknowledges that a breach of this Section, including disclosure of any Confidential Information, or disclosure of other information that, at law or in equity, ought to remain confidential, will give rise to irreparable injury to County that is inadequately compensable in damages. Accordingly, County may seek and obtain injunctive relief against the breach or threatened breach of the foregoing undertakings, in addition to any other legal remedies that may be available. Contractor acknowledges and agrees that the covenants contained herein are necessary for the protection of the legitimate business interest of County and are reasonable in scope and content.

12.4 Contractor in providing all services hereunder agrees to abide by the provisions of any applicable Federal or State Data Privacy Act.

12.5 Contractor expressly acknowledges that County is subject to the Texas Public Information Act, TEX. GOV'T CODE ANN. §§ 552.001 *et seq.*, as amended, and notwithstanding any provision in the Agreement to the contrary, County will make any information related to the Agreement, or otherwise, available to third parties in accordance with the Texas Public Information Act. Any proprietary or confidential information marked as such provided to County by Contractor shall not be disclosed to any third party, except as directed by the Texas Attorney General in response to a request for such under the Texas Public Information Act, which provides for notice to the owner of such marked information and the opportunity for the owner of such information to notify the Attorney General of the reasons why such information should not be disclosed. The terms and conditions of the Agreement are not proprietary or confidential information.

### **Section 13. Independent Contractor**

13.1 In the performance of work or services hereunder, Contractor shall be deemed an independent contractor, and any of its agents, employees, officers, or volunteers performing work required hereunder shall be deemed solely as employees of contractor or, where permitted, of its subcontractors.

13.2 Contractor and its agents, employees, officers, or volunteers shall not, by performing work pursuant to this Agreement, be deemed to be employees, agents, or servants of County and shall not be entitled to any of the privileges or benefits of County employment.

**Section 14.        Notices**

14.1 Each party giving any notice or making any request, demand, or other communication (each, a "Notice") pursuant to this Agreement shall do so in writing and shall use one of the following methods of delivery, each of which, for purposes of this Agreement, is a writing: personal delivery, registered or certified mail (in each case, return receipt requested and postage prepaid), or nationally recognized overnight courier (with all fees prepaid).

14.2 Each party giving a Notice shall address the Notice to the receiving party at the address listed below or to another address designated by a party in a Notice pursuant to this Section:

County:                                James Knight  
Director Facilities Management and Planning  
301 Jackson Street  
Richmond, Texas 77469

With a copy to:                        Fort Bend County  
Attn: County Judge  
401 Jackson Street, 1<sup>st</sup> Floor  
Richmond, Texas 77469

Contractor:                             Kone, Inc.  
15800 International Plaza, Suite 150  
Houston, Texas 77032

14.3 A Notice is effective only if the party giving or making the Notice has complied with subsections 14.1 and 14.2 and if the addressee has received the Notice. A Notice is deemed received as follows:

14.3.1 If the Notice is delivered in person, or sent by registered or certified mail or a nationally recognized overnight courier, upon receipt as indicated by the date on the signed receipt.

14.3.2 If the addressee rejects or otherwise refuses to accept the Notice, or if the Notice cannot be delivered because of a change in address for which no Notice was given, then upon the rejection, refusal, or inability to deliver.

**Section 15. Compliance with Laws**

Contractor shall comply with all federal, state, and local laws, statutes, ordinances, rules and regulations, and the orders and decrees of any courts or administrative bodies or tribunals in any matter affecting the performance of this Agreement, including, without limitation, Worker's Compensation laws, minimum and maximum salary and wage statutes and regulations, licensing laws and regulations. When required by County, Contractor shall furnish County with certification of compliance with said laws, statutes, ordinances, rules, regulations, orders, and decrees above specified.

**Section 16. Performance Warranty**

16.1 Contractor warrants to County that Contractor has the skill and knowledge ordinarily possessed by well-informed members of its trade or profession practicing in the greater Houston metropolitan area and Contractor will apply that skill and knowledge with care and diligence to ensure that the Services provided hereunder will be performed and delivered in accordance with the highest professional standards.

16.2 Contractor warrants to County that the Services will be free from material errors and will materially conform to all requirements and specifications contained in the attached Exhibit A.

**Section 17. Assignment**

17.1 Neither party may assign any of its rights under this Agreement, except with the prior written consent of the other party. That party shall not unreasonably withhold its consent. All assignments of rights are prohibited under this subsection, whether they are voluntarily or involuntarily, by merger, consolidation, dissolution, operation of law, or any other manner.

17.2 Neither party may delegate any performance under this Agreement.

17.3 Any purported assignment of rights or delegation of performance in violation of this Section is void.

**Section 18. Applicable Law**

The laws of the State of Texas govern all disputes arising out of or relating to this Agreement. The parties hereto acknowledge that venue is proper in Fort Bend County, Texas, for all legal actions or proceedings arising out of or relating to this Agreement and waive the right to sue or be sued elsewhere. Nothing in the Agreement shall be construed to waive the County's sovereign immunity.

**Section 19. Successors and Assigns**

County and Contractor bind themselves and their successors, executors, administrators and assigns to the other party of this Agreement and to the successors, executors, administrators and assigns of the other party, in respect to all covenants of this Agreement.

**Section 20. Third Party Beneficiaries**

This Agreement does not confer any enforceable rights or remedies upon any person other than the parties.

**Section 21. Severability**

If any provision of this Agreement is determined to be invalid, illegal, or unenforceable, the remaining provisions remain in full force, if the essential terms and conditions of this Agreement for each party remain valid, binding, and enforceable.

**Section 22. Publicity**

Contact with citizens of Fort Bend County, media outlets, or governmental agencies shall be the sole responsibility of County. Under no circumstances whatsoever, shall Contractor release any material or information developed or received in the performance of the Services hereunder without the express written permission of County, except where required to do so by law.

**Section 23. Certain State Law Requirements for Contracts:**

The contents of this Section are required by Texas Law and are included by County regardless of content.

23.1 Agreement to Not Boycott Israel Chapter 2270 Texas Government Code: By signature below, Contractor verifies Contractor does not boycott Israel and will not boycott Israel during the term of this Agreement.

23.2 Texas Government Code Section 2252.152 Acknowledgment: By signature below, Contractor represents pursuant to Section 2252.152 of the Texas Government Code, that Contractor is not listed on the website of the Comptroller of the State of Texas concerning the listing of companies that are identified under Section 806.051, Section 807.051 or Section 2253.153.

**Section 24. Human Trafficking**

By Execution of this Agreement, Contractor acknowledges that Fort Bend County is opposed to Human Trafficking and that no County funds will be used in support of services or activities that violate Human Trafficking Laws.

**Section 25.        Captions**

The section captions used in this Agreement are for convenience of reference only and do not affect the interpretation or construction of this Agreement.

**Section 26.        Conflict**

In the event there is a conflict between this Agreement and the attached Exhibit, this Agreement controls.

**Section 27.        Travel Expenses** Travel and mileage expenses incurred in the performance of required Services will be compensated only when approved in advance by County and provided that expenses comply with the County's Travel Policy, a copy of which will be provided upon request.

**Section 28.        Entire Agreement**

This instrument contains the entire Agreement between the parties hereto relating to the rights herein granted and the obligation herein assumed. Any oral representations or modifications concerning this instrument shall be of no force or effect excepting a subsequent modification in writing signed by all the parties hereto.

*{EXECUTION PAGE FOLLOWS}*

*{REMAINDER OF PAGE INTENTIONALLY LEFT BLANK}*

IN WITNESS WHEREOF, this Agreement is signed, accepted, and agreed to by all parties by and through the parties or their agents or authorized representatives. All parties hereby acknowledge that they have read and understood this Agreement and the attachments and exhibits hereto. This Agreement shall be effective upon execution of all parties.

**FORT BEND COUNTY**

  
County Judge KP George

**KP George, County Judge**

**KONE, INC.**



Authorized Agent- Signature

Trish Pritchard

Authorized Agent- Printed Name

Assistant Secretary

Title

5/20/2020

Date

**AUDITOR'S CERTIFICATE**

I hereby certify that funds are available in the amount of \$ 540,000.00 to accomplish and pay the obligation of Fort Bend County under this contract.



Robert E. Sturdivant, County Auditor

Exhibit A: KONE, Inc. Scope of Work

# EXHIBIT A

Dedicated to People Flow™ **KONE**

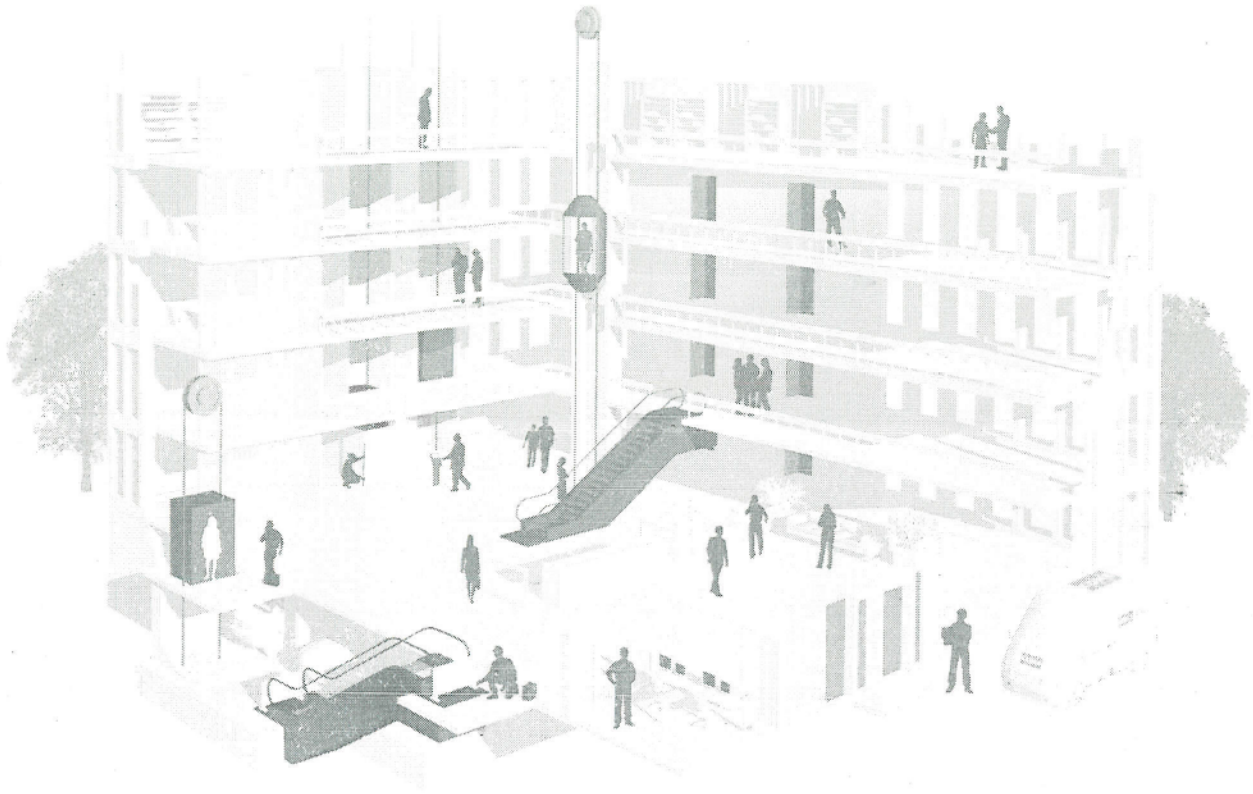

## KONE People Flow - Solution for You

- Eco-efficient
- Reliable
- Attractive



03/20/2020

**KONE Inc.**  
Elevators & Escalators

15800 International Plaza Ste  
150  
Houston, TX, 77032  
Mobile 281-802-0296  
Work 281-442-6619  
james.cline@kone.com  
www.kone.us

Dear Justin Zwahr,

We are pleased to enclose, for your review and consideration, KONE's proposal to modernize Passenger Elevators 3, 4 and 5t located at the Fort Bend County Sheriff's Office - West Tower

In addition to a quality modernization project, we would be excited to discuss KONE 24/7 Connected Services with you and the continuing benefits KONE could bring to your business. KONE is leading the industry with KONE 24/7 Connected Services using the latest intelligent elevator technology allowing us to predict issues and take action before a shutdown occurs. Predictive maintenance allows fewer shutdowns, less call-outs, and improved up-time of equipment - all leading to a better user experience! Please know that we are available to assist you in coordinating the work by others as further described in our "Bid Attachment B".

Should you have any questions or require additional information, please feel to contact me directly.

We look forward to hearing from you and working together on this project.

Yours sincerely,

Jim Cline  
Service Sales Manager  
**KONE Inc.**



# 1 Solution Specification

## Technical Equipment Data / - - Solution 1.

Equipment number	/
Address	..
Rated load	5000 lbs
Rated speed	200 fpm
Travel height	78 ft 10 in
Number of floors	6

## Offered Components

### ReNova Door Operator

A closed loop permanent magnet PWM high-performance door operator shall be provided to open and close the car and hoistway doors simultaneously. Door movement shall be cushioned at both limits of travel. An electric contact shall be provided on the car at each car entrance to prevent the operation of the elevator unless the car door is closed. The door operator shall be arranged so that, in case of interruption or failure of electric power, the doors can be readily opened by hand from within the car, in accordance with applicable code.

Emergency devices and keys for opening doors from the landing shall be provided as required by the local code. Doors shall open automatically when the car has arrived at or is leveling at the respective landings. Door shall close after a predetermined time interval or immediately upon pressing of a car button. A door open button shall be provided in the car. Momentary pressing of this button shall reopen the doors and reset the time interval. Door hangers and tracks shall be provided for each car door. Tracks shall be contoured to match the hanger sheaves. The hangers shall be designed for power operation with provisions for vertical and lateral adjustment. Hanger sheaves shall have polyurethane tires and pre-lubricated sealed-for-life bearings.

### Curtain of Light

The elevator car shall be equipped with an electronic protective device extending the full height of the car. When activated, this sensor shall prevent the doors from closing or cause them to stop and reopen if they are in the process of closing. The doors shall remain open as long as the flow of traffic continues and shall close shortly after the last person passes through the door opening.

### Resolve 400

KONE ReSolve 400 is a modular modernization solution for elevator control and electrical systems, based on the latest in control technology. This replaces outdated technology such as relays and older electronic systems, improving the levels of performance, reliability, safety and energy efficiency of your elevator. The modular structure of KONE ReSolve is designed to correctly interface with many types of existing elevator components, thus ensuring a swift, trouble-free installation for the building users.

A new microprocessor-based control system shall be provided to perform the functions of safe elevator motion. Included shall be all of the hardware required to connect, transfer and interrupt power, and to protect the motor against overloading. Each controller cabinet containing memory equipment shall be properly shielded from line pollution. The microcomputer system shall be designed to accept reprogramming with minimum system down time. All high voltage (110V or above) contact points inside the controller cabinet shall be protected from accidental contact in a situation where the controller doors are open. The microprocessor-based control system shall utilize on-board diagnostics for servicing, troubleshooting, and adjusting without requiring the use of an outside service tool.

Provide a ReSolve 400 KDM drive system to develop high starting torque with low starting current. Drive system shall be regenerative for all units. With power regeneration provided, the total harmonic distortion of regenerated power shall be less than 5% (125A) and less than 8% (220A & 250A). Means of absorbing regenerated power shall be provide by others. The drive power factor shall be 0.95 or better. Auto-transformer: Provide auto-transformer to adjust the main-line supply to the 400V required by the controller and drive.

**Hoist Motor**

A new hoist motor shall be provided. The motor will be designed to stand the loads encountered for elevator service, sufficient capacity to operate with the contract load and speed without overheating, and will be rated in accordance with the standards of the IEEE.

**Guides  
Governor**

New roller guide assemblies shall be provided.

The car safety will be activated by a new speed governor located overhead, driven by a governor rope suitably connected to the car safety. The governor will be equipped with rope grip jaws designed to clamp the governor rope so as to actuate the car safety upon a predetermined over speed downward. The governor will be set at not less than 115% of specified rated car speed and not more than the maximum governor tripping speed specified in the code for the specified rated car speed.

The rope grip jaws must be positively tripped within the permitted range of speed. The governor rope-tripping device will be so designed that no appreciable damage to or deformation of the governor rope will result from the stopping action of the device in operating the car safety. The governor over speed switches will conform to ANSI A17.1 code requirements and be so located and enclosed that excess lubricant will not enter the switch enclosure.

Upon activation of the safety switch, the switch will remain in the open position until manually reset. The governor will be accurately adjusted and sealed with tripping speed specified. Date tags indicating the test date will be applied.

**Rope Gripper**

A new rope gripper overspeed device shall be provided. The rope gripper shall prevent the car from striking the hoistway overhead structure due to a failure in the hoist motor, brake, coupling, hoistway, gearing or control system. The rope gripper will be set to detect an ascending car overspeed condition at a speed not



greater than 10% higher than the speed at which the car governor is set to actuate. The device will also detect unintended car movement away from the landing with the hoistway door not in the locked position and the car door not in the closed position. The rope gripper will be designed so that no appreciable damage to, or deformation of, the cables will result from the stopping action of the device. Once activated by unintended movement or car overspeed the device will remain activated until manually reset.

**Governor Ropes**

A new governor cable(s) compatible with the specifications for the new governor will be provided. The governor cable is to pass over the governor sheave and under a weighted tension device at the bottom of the hoist way. During normal operation of each elevator, the governor rope will run free and clear of the governor gripping jaws, cable guards and all other stationary parts. A metal tag will be attached to the top of the car-releasing carrier, giving the diameter, material of cable, and with date of cable installation.

**ReVive 500, 600**

Tags will be attached in an approved manner.

New KONE car & hall signalization shall be provided.

Mechanical Layout Engineering - Machine Room Only



**Project notes** This is a turn key project including all applicable code upgrades.

**Handover date** Mutually agreeable project schedule will be determined at time of proposal acceptance. Current delivery lead time is 11 weeks from order receipt, deposit and approval of drawings. The agreed delivery times for the project may need to be extended because of delays caused by measures undertaken to stop the spreading of the Coronavirus (2019-nCoV) epidemic, such as mandatory holiday extensions and transportation restrictions imposed by authorities in China and other countries, and the availability of personnel, logistics providers and supply chains, due to the epidemic.

**Downtime period** 9 weeks per unit

**Price Overview**

Proposal pricing is based on the scope of work as defined herein. Any additional work required will be performed only upon purchaser's approval of a mutually agreeable change proposal. Any other deficiencies revealed in the progress of the work will be promptly reported to the purchaser with recommendations and cost for corrective action.

**Total Sales Price (excl. sales tax)** \$540,000.00

**Pricing Conditions** This offer is valid for 90 days.

**Maintenance** Maintenance price to be discounted by 20% for 12 months after final acceptance.

**Component Overview**

**Equipment number**

ReNova Door Equipment  
Curtain of Light  
ReSolve 400  
Hoist Motor

Guide shoes  
Governor  
Rope Gripper  
Governor Ropes  
ReVive 500/600

---

**Sales price** **\$ 177,000.00**

**Component Overview**

**Equipment number**

ReNova Door Equipment  
Curtain of Light  
ReSolve 400  
Hoist Motor



Guide shoes  
Governor  
Rope Gripper  
Governor Ropes  
Traction Ropes  
ReVive 500/600

---

**Sales price** **\$ 186,000.00**

**Component Overview**

**Equipment number**

ReNova Door Equipment  
Curtain of Light  
ReSolve 400  
Hoist Motor

Guide shoes  
Governor  
Rope Gripper  
Governor Ropes  
ReVive 500/600

---

**Sales price** **\$ 177,000.00**

**Total Sales Price, excl. sales tax** **\$ 540,000.00**



### 3 Tender Approval

**Receiver:**

KONE Inc.  
Jim Cline  
15800 International Plaza Ste 150  
Houston, TX, 77032  
james.cline@kone.com

**Sender:**

Justin Zwahr  
FORT BEND COUNTY  
301 JACKSON ST  
Texas, RICHMOND, 77469  
KONE Contract - 41671938  
US Communities - EV2516

Submitted by:

Jim Cline  
Service Sales Manager  
03/20/2020

We accept the offer constituted by this proposal (total sales price of \$540,000.00, excl. sales tax) and agree to the conditions contained therein.

**Approved by KONE Corporate Officer**

**Approved by Purchaser**

Signature: \_\_\_\_\_

Signature: \_\_\_\_\_

Printed Name:

Printed Name:

Title:

Title:

Date:

Company Name:

Date:

### Clarifications

- Contract terms between KONE Inc. and Purchaser shall be based on our Proposal and Attachments. (See Attachment "A" and "B")
- All new elevator equipment provided shall meet applicable ASME A17.1 code requirements. Any provisions of codes applicable to out-of-scope items shall be the Purchaser's responsibility. Cost of any future code changes adopted prior to permitting and completion are excluded.
- The existing cab and entrance dimensions, which may not meet current ADA or stretcher access rules, will be retained as is.
- Our proposal includes inspections and testing as required by the AHJ. However, any re-testing required due to other trades' failures to complete their work or tests in a timely manner will be billed at our regular billing rates.
- No costs for preventive maintenance services are included in this capital improvement pricing.
- The ASME code limits changes to the empty car weight + capacity of each elevator to 5% of the originally installed value. If past or proposed changes result in a change to the weight or system pressure (for hydraulic) greater than 5% above the original design values, the cost of any engineering and of any required modifications to the elevator system or structure shall be extra to this proposal scope and pricing. If this situation is discovered during the engineering process, KONE will notify purchaser and recommend an alternate design or other changes.
- In order to provide best pricing, proposal excludes any extra demobilizations and remobilizations. If we must demobilize from the jobsite for any reason outside our control, we shall be compensated at our regular billing rates.
- Proposal pricing is based on the scope of work as defined herein. Any additional work required will be performed only upon Purchaser's approval of a mutually agreeable change proposal. Any other deficiencies revealed in the progress of the work will be promptly reported to purchaser with recommendations and cost for corrective action.
- Asbestos: Notwithstanding anything contained to the contrary within this bid or contract, KONE's work shall not include any abatement or disturbance of asbestos containing material (ACM) or presumed asbestos containing materials (PACM). Any work in a regulated area as defined by Section 1910 or 1926 of the Federal OSHA regulations is excluded from KONE's scope of work without an applicable change order to reflect the additional costs and time. In accordance with OSHA requirements, the Customer shall inform KONE and its employees who will perform work activities in areas which contain ACM and/or PACM of the presence and location of ACM and/or PACM in such areas which may be contacted during work before entering the area. Other than as expressly disclosed in writing, Customer warrants that KONE's work area at all times meets applicable OSHA permissible exposure limits (PELs). KONE shall have the right to discontinue its work in any location where suspected ACM or PACM is encountered or disturbed. Any asbestos removal or abatement, or delays caused by such, required in order for KONE to perform its work shall be the Customer's sole responsibility and expense. After any removal or abatement, customer shall provide documentation that the asbestos has been abated from the KONE work area and air clearance reports shall be made available upon request prior to the start of KONE's work.
- Purchaser shall provide any security, escort or other building service support personnel required during demolition, installation, testing, and inspections.
- For hydraulic elevators, we can assume no responsibility for unusual conditions such as hole cave in and complete hydraulic cylinder assembly embedded in concrete. The excavation of the hole to accommodate the new hydraulic cylinder assembly is based on encountering soil free of rocks, boulders, building construction members, sand, water, quicksand, underground caves and/or any other obstructions or unusual conditions. Should such obstructions or unusual conditions be encountered, additional time above or beyond the working days estimated to complete this project may be required. We will proceed with this portion of the project on a time and material basis, based on our normal billing rates.



## Bid Attachment "A" / KONE Inc. General Terms and Conditions (Modernization)

### **1. APPLICATION OF THESE TERMS**

The parties agree to be bound by the terms and conditions contained in the Bid Letter, this Bid Attachment A and Bid Attachment B, including the documents incorporated herein by reference (collectively, the "Proposal").

### **2. SPECIAL PURCHASING REQUIREMENTS**

This Proposal is made without regard to compliance with any special sourcing and/or manufacturing requirements including, but not limited to, Buy America, Buy American, U.S. Steel, FAR clauses, minority / disadvantaged supplier requirements or similar federal and/or state procurement laws. Should such requirements be applicable to this Project, KONE reserves the right to modify and/or withdraw its Proposal.

### **3. PROPOSAL CONDITIONS**

The Proposal shall be open for acceptance within the period stated in the Bid Letter or, when no period is stated, for a period of 30 days from the date of the Bid Letter. Prior to commencing manufacture of the equipment described in the Bid Letter ("Equipment"), KONE must have (i) a fully executed contract; (ii) a schedule acceptable to KONE identifying the Equipment installation start date, or alternatively, KONE's letter specifying the ship date ("Ship Date Letter") signed by Customer, which, as applicable, is incorporated by reference herein; (iii) the first payment in Section 4 herein; and (iv) fully approved KONE layouts.

### **4. PAYMENT TERMS**

Payment of the total Price is due within 30 days from invoice date, based on benchmarks as follows:

- 30% of the Price for engineering, site management, and overhead, billable and due upon execution of this Proposal or receipt of the subcontract;
- 50% of the Price for material and shipping, billable and due upon delivery of material to the jobsite or KONE Distribution Center;
- 20% of the Price for Equipment installation, billable and due at the billing cycle following the start of installation.

KONE reserves the right to delay, suspend, or stop the work, including manufacturing, delivery, installation and/or Equipment turnover, for non-payment, without liability to KONE or being held in default. Simple interest at 1.5% per month shall be charged on amounts not paid when due. Payments to KONE are not contingent on any third party payments to Customer. Customer shall reimburse KONE for all costs of collection, including courts costs and reasonable attorneys' fees.

Prior to turnover, KONE must be paid in full, less 10% maximum retention, the Price including all change orders. Retention shall be due and payable within 30 days of execution of the Uniform Final Acceptance or Equipment turnover, whichever occurs first.

If certified payroll reporting is required, KONE will submit the requested reporting in the format of the U.S. Department of Labor form WH 347 & WH 348. The Price does not include Textura or any other special billing requirements, which can be added via change order at a rate of 0.3% of the Price.

### **5. INSTALLATION**



Customer shall be responsible for procurement and cost of all permits, except permits related to installation of the Equipment. Where KONE's scope of work or other responsibilities include the obligation to utilize materials and/or finishes resembling or identical to those pre-existing in the building, KONE shall use reasonable efforts to procure such materials and Customer acknowledges and accepts that the materials and/or finishes reasonably available may not be in all respects identical to those pre-existing in the building. This Proposal is conditioned upon KONE using its standard installation method. The installation of the Equipment shall start after Customer has completed all work set forth in Bid Attachment B and any other documents describing site requirements ("Site Requirements"), all of which are incorporated by reference herein. Within two (2) weeks prior to the scheduled delivery date for KONE's materials, KONE shall conduct a standard visual site survey to verify that the Site Requirements are complete and notify Customer if there are outstanding deficiencies preventing KONE from beginning installation. KONE's site survey may include, but is not limited to, inspection of site access, working and safety conditions on site, wear and tear of any existing structures or surfaces, and planning of any dismantling or removal of existing equipment, components and materials, where applicable. KONE shall not be deemed to have surveyed any hidden structures, latent defects, subsurface conditions, or other non-visible matters, including but not limited to searching for hazardous substances and/or materials, which shall be subject to Section 16. If KONE's site survey reveals any deficiencies, KONE shall be entitled to delay the start of installation and Customer shall be responsible for all additional costs incurred by KONE, including without limitation, costs associated with: labor reallocation, re-directing materials to and storage in a KONE Distribution Center, additional labor for double handling of materials, and additional trucking, freight and insurance. Once the Site Requirements are completed, the start of installation shall be subject to the availability of labor and the delivery of material, if applicable.

KONE's work shall be performed during regular union working hours of regular working days, Monday to Friday, statutory holidays excluded. If overtime is mutually agreed upon and performed, the additional costs for such work shall be added to the Price at KONE's standard overtime rates. If the installation cannot be performed in an uninterrupted manner for any reason beyond KONE's control, Customer shall store the Equipment at Customer's cost and compensate KONE for any costs caused by such delay including, but not limited to, double handling of Equipment and demobilization.

KONE shall not be required to perform overtime or any Customer directed change to its work ("Extra Work") without an executed change order. No action by KONE, including but not limited to, performing Extra Work without an executed change order, shall be a waiver of KONE's right to seek payment for Extra Work performed. KONE shall be entitled to an extension of time and an equitable adjustment in the Price, including but not limited to, any increased costs of labor, including overtime, resulting from any change of schedule, re-direction of KONE personnel to another work area, acceleration, or out of sequence work.

KONE shall take reasonable methods to protect its work-in-place while KONE is actively on site and until execution of a KONE Uniform Final Acceptance, which is incorporated by reference herein. Should damage occur to KONE property, material or work-in-place by fire, water, theft or vandalism, Customer shall compensate KONE for said damages. Additionally, the Customer is solely responsible for ensuring that the equipment maintenance contractor, if not KONE, does not disturb, delay or interfere with KONE's work. KONE shall abide by Customer's safety policies and procedures to the extent such policies and procedures are not in conflict with KONE's Safety Policy. Testing and/or security features of Equipment must be completed before Equipment turnover. KONE is not responsible for damages, either to Equipment or the building, or for any personal injury or death, arising out of or resulting from any code required safety tests performed on Equipment or hoistway access granted by Customer to other trades.

## 6. TEMPORARY USE



Temporary use of certain types of Equipment may be permitted, provided the use period allows adequate time for Equipment restoration for final turnover and Customer executes KONE's Temporary Use Agreement. Temporary use shall be invoiced separately and subject to payment terms in Section 4 herein. At the end of temporary use, Customer shall return the Equipment to KONE in "like new" condition.

## **7. HAZARDOUS MATERIALS**

Notwithstanding anything contained to the contrary within this Subcontract, KONE's work shall not include any abatement or disturbance of asbestos containing material (ACM), presumed asbestos containing materials (PACM), or other hazardous materials (i.e. lead, PCBs) (collectively "HazMat"). Any work in the affected area where reasonable precautions will be inadequate to prevent foreseeable bodily injury or death to persons resulting from the HazMat is excluded from KONE's scope of work without an applicable change order to reflect the additional costs and time. In accordance with OSHA requirements, the Customer shall inform KONE and its employees who will perform work activities in areas which contain HazMat of the presence and location of HazMat in such areas which may be contacted during work before entering the area. Other than as expressly disclosed in writing, Customer warrants that KONE's work area at all times meets applicable OSHA permissible exposure limits (PELs). KONE shall have the right to discontinue its work in any location where suspected HazMat is encountered or disturbed. Any HazMat removal or abatement, or delays caused by such, required in order for KONE to perform its work shall be the Customer's sole responsibility and expense. After any removal or abatement, Customer shall provide documentation that the HazMat has been abated from the KONE work area and air clearance reports shall be made available upon request prior to the start of KONE's work.

## **8. TITLE AND RISK TO EQUIPMENT**

Title to and ownership of all Equipment intended for incorporation in KONE's work, whether installed or stored on or off site, shall remain with KONE until final payment is made and, in the case of suspension or termination for non-payment, the parties agree that KONE may retake possession and remove any or all of KONE's works, Equipment or apparatus without material damage to the property and irrespective of the manner in which the same is attached or affixed. Risk of loss in KONE's work and Equipment passes to Customer upon delivery to the site or off-site storage.

Any tools, devices, or other equipment that KONE uses to perform its work or monitor the Equipment remains the sole property of KONE. If this Proposal terminates or expires for any reason, Customer will give KONE access to the premises to remove such tools, devices or equipment at KONE's expense.

## **9. TURNOVER**

Prior to turnover, KONE must receive a final punchlist. Upon turnover, KONE requires a signed Uniform Final Acceptance. KONE shall provide its standard electronic O&M manuals with CD-ROMs in electronic format, if applicable, upon execution of the Uniform Final Acceptance. Standard KONE samples shall be provided upon request. No mock-ups or video training are included in the Price.

## **10. DELAY**

KONE shall not be liable for any loss, damage, claim, or delay due to any cause beyond KONE's control, including, but not limited to, acts of government (including a change in law), strikes, lockouts, work interruption or other labor disturbance, delays caused by others, fire, explosion, theft, floods,



inclement weather, riot, civil commotion, war, malicious mischief, or acts of God. In the event of such delays,

KONE shall be entitled to an extension in time equal to the length of such delay and an equitable adjustment in the Price. Customer shall compensate KONE for labor and material cost escalations resulting from Project delays not caused by KONE, which extend completion of KONE's work beyond the end of the current calendar year. Customer is on notice that IUEC labor rates increase annually.

#### **11. LIMITED WARRANTY**

For one (1) year after the acceptance date set forth in the signed Uniform Final Acceptance, date of Equipment turnover, or date of Customer's use of Equipment (unless such use is pursuant to the Temporary Use Agreement), whichever occurs first, KONE warrants Equipment against defect in workmanship and material. The warranty excludes remedy for damage or defect caused by abuse, misuse, vandalism, neglect; repairs, alteration or modifications not executed by KONE; improper or insufficient maintenance, improper operation, characteristics of the building such as electrical power or security features, natural or other catastrophe such as flood, fire, or storm, or normal wear and tear and normal usage. The warranty excludes training or instruction in the proper operation or maintenance of Equipment. Specific noise ratings and energy efficiencies cannot be guaranteed due to different building characteristics and ambient noise levels. Customer's remedy is limited to repair or replacement of a defective part, in KONE's sole discretion, and excludes labor. KONE DISCLAIMS ANY OTHER WARRANTY OF ANY KIND, EITHER EXPRESSED OR IMPLIED, INCLUDING WITHOUT LIMITATION, THE IMPLIED WARRANTIES OF MERCHANTABILITY OR FITNESS FOR A PARTICULAR PURPOSE, OR NON- INFRINGEMENT.

#### **12. IDEMNIFICATION**

KONE shall only indemnify and hold Customer harmless for claims, damages, losses or expenses, but excluding loss of use ("Claims") due to bodily injury, including death, or tangible property damage (other than the Project or KONE's work itself) to the extent caused by KONE's negligent acts or omissions. KONE shall not indemnify Customer for any other Claims. Customer agrees to indemnify and hold KONE harmless from any Claim for bodily injury, including death, or tangible property damage in connection with the use or operation of the Equipment. Each party shall defend itself in the event of a Claim.

#### **13. INTELLECTUAL PROPERTY**

KONE shall retain title and ownership of all intellectual property rights relating (directly or indirectly) to the Equipment provided by KONE, including but not limited to software or firmware (whether in the form of source code, object code or other), drawings, technical documentation, or other technical information delivered under the Proposal. KONE grants Customer a non-exclusive and non-transferable license and right to use the software and firmware in connection with the use and maintenance of the Equipment. Customer shall not use any drawings, technical documentation or other technical information supplied by or on behalf of KONE for any purposes other than those directly related to the Proposal or to the use and maintenance of the Equipment. Customer shall not in any form copy, modify or reverse engineer the software, or give access to the software for such use to any third party without KONE's prior written consent. KONE shall not provide any information such as KONE's internal manuals, manufacturing drawings, source codes, or other proprietary and confidential information, all of which are excluded from the Proposal.

#### **14. INSURANCE**

In lieu of any Customer insurance requirements, KONE shall provide its standard certificate of



insurance, which shall be deemed to satisfy all insurance requirements for this Project. KONE shall not provide loss runs, insurance rate information, copies of its insurance policies or any other information which KONE considers confidential. KONE shall not provide coverage for professional (E&O) liability, pollution liability, data privacy/security, or no-fault medical payments. If the Project is covered by a Wrap Up Insurance Program, KONE agrees to participate provided there is no cost to KONE, no reduction in the Price, and subject to KONE's review of the proposed program. The insurance requirements contained in the wrap up insurance program's manual shall govern as the only insurance requirements for this Project. In the event that the wrap up insurance program is terminated before completion of KONE's Work, KONE will provide its standard insurance certificates which shall satisfy the insurance requirements for this Project. This shall apply to the project specific Wrap Up Insurance Program's Manual and any applicable enrollment documents. If KONE's primary limits are sufficient to satisfy insurance coverage requirements, excess/umbrella liability will not be required or if excess/umbrella is required, KONE's excess coverage does not follow form although typically provides broader coverage than KONE's primary policies. The excess coverage is not AM Best Rated nor licensed to do business within the jurisdiction although the carrier has strong Standard & Poor's and Moody's financial ratings that may be evidenced upon request.

#### **15. LIMITATION OF LIABILITY**

In no event shall either party be liable to the other party for any consequential, special, punitive, exemplary, liquidated, incidental, or indirect damages (including, but not limited to, loss of profits or revenue, loss of goodwill, loss of use, increase in financing costs) (collectively, "Consequential Damages") that arise out of or relate to this Proposal even if such party has been advised of the possibility of such Consequential Damages. The limitation set forth in this section shall apply whether the claim is based on contract, tort or other theory.

#### **16. CONCEALED OR UNKNOWN CONDITIONS**

If during the course of its work, KONE encounters conditions at the site that are subsurface, differ materially from what is represented in the contract documents, or otherwise concealed physical conditions, KONE shall be entitled to an extension of time and additional costs for the performance of its work, which shall not be subject to any payment conditions or contingencies.

#### **17. TECHNICAL SURVEY**

KONE's Price and obligations under this Proposal are subject to a technical survey to be performed on Customer's existing units within 90-days of the effective contract start date. If a safety hazard or code violation is identified during KONE's technical survey, Customer shall immediately remove the unit from service until repairs are performed. KONE is not obligated to perform tests, correct outstanding violations or deficiencies that were not addressed by the prior service provider and/or the owner, or make related necessary repairs or component replacements on the unit. If additional work is necessary, KONE shall provide a separate proposal or recommendation for such work. Customer agrees to indemnify, defend, and hold KONE harmless for any claims arising out of Customer's failure to comply with KONE's recommendations and proposal, and any obligation on the part of KONE to indemnify or defend Customer with regard to such claim shall be null and void. If Customer does not immediately approve KONE's proposal or recommendation, KONE reserves the right to terminate this Proposal/contract without penalty.

#### **18. TERMINATION**

If a party materially breaches this Proposal, the other party shall provide written notice of the breach and a reasonable time to cure the breach, but in no event less than 30 days. If the breaching party fails to cure the breach within the specified time period, the non-breaching party may terminate the



Proposal upon 15 days written notice to the other party. If KONE notifies Customer of a material breach pursuant to this paragraph, KONE may temporarily suspend its work without liability.

#### **19. GOVERNING LAW AND DISPUTE RESOLUTION**

The parties agree that this Proposal shall be governed by the laws of the state where the Project is located, and venue for disputes shall be located in that state. KONE does not agree to participate in arbitration proceedings.

#### **20. PRICE ADJUSTMENT**

KONE shall be entitled to an equitable adjustment in the Price, including but not limited to, any increased costs of materials, resulting from any change in law (by legislation, executive order, treaty or other similar means), or a change in law that imposes tariffs on raw materials or finished goods.

#### **21. MISCELLANEOUS**

This Proposal, including the documents incorporated herein by reference, constitutes the entire agreement of the parties and supersedes all prior negotiations, understandings, and representations whether written or oral in relation to the subject matter hereof. Where a conflict or ambiguity exists between this Proposal and any other contract document (including but not limited to, Customer's drawings and specifications), the terms and conditions of this Proposal shall control. This Proposal may be amended only in writing by the duly authorized representative of both parties. This Proposal may be executed in one or more counterparts. Each counterpart shall be considered an original and all of the counterparts shall constitute a single agreement binding all the parties as if all had signed a single document. For purposes of executing this Proposal, a document signed by electronic means is to be treated as an original document. The failure of either party to insist upon performance or strict performance of any of the terms or conditions of this Proposal shall not be deemed a waiver of any rights or remedies that such party may have or a waiver of any subsequent breach or default under this Proposal. Neither party may assign or transfer the benefit or burden of this Proposal without prior written consent of the other party.



**Bid Attachment "B" / Site Requirements & Work by Other Trades (Incl. in Proposal)**

**Equipment:** 3 Traction Elevators    6 Stops    Penthouse Machine Room

**NOTES:**

- *No phone line work is in this proposal other than providing conduit for an existing phone line to new controller.*
- *Elevator Service Company to utilize portable barricades for hoistway door openings. Thus, no OSHA barricades are in this proposal.*
- *No major alteration is being done to the pits. Thus, no sump pump or waterproofing work is in this proposal.*

1) **Fire Alarm System:**

- a) Provide cab flash and shunt relays for elevator.
- b) Relocate smokes in lobby to within 10' of elevator openings.
- c) Provide heat detectors within 24" of sprinkler heads in machine room.
- d) Provide heat detectors within 24" of sprinkler heads in pit and at top of hoistway.
- e) Provide boxes/conduit/wiring for new devices. Provide conduit/wiring from relay assemblies to new passenger elevator controller.
- f) Program all elevator fire system devices into existing fire panel.
- g) Provide pre-test and final of elevator fire system.

2) **Hoistway and Pit:**

- a) Patch behind call and directional assemblies on front walls of hoistways.
- b) Provide protected lights in pit.
- c) Relocate pit light switches to proper height above sill plate.
- d) Install GFCI's in pit as required.
- e) Provide single outlet for existing pump in pit.
- f) Fabricate and install new pit ladders.

3) **Machine Room and Machinery Spaces:**

- a) Patch and seal machine enclosure.
- b) Provide new main line disconnects with shunt trip power supply.

# CERTIFICATE OF INTERESTED PARTIES

FORM 1295

1 of 1

Complete Nos. 1 - 4 and 6 if there are interested parties.  
 Complete Nos. 1, 2, 3, 5, and 6 if there are no interested parties.

**OFFICE USE ONLY  
 CERTIFICATION OF FILING**

**1 Name of business entity filing form, and the city, state and country of the business entity's place of business.**  
 KONE Elevators  
 Houston, TX United States

**Certificate Number:**  
 2020-617559

**Date Filed:**  
 05/11/2020

**2 Name of governmental entity or state agency that is a party to the contract for which the form is being filed.**  
 Fort Bend County

**Date Acknowledged:**  
 06/02/2020

**3 Provide the identification number used by the governmental entity or state agency to track or identify the contract, and provide a description of the services, goods, or other property to be provided under the contract.**  
 21468  
 Elevator Modernization Omnia Contract EV 2516

4	Name of Interested Party	City, State, Country (place of business)	Nature of interest (check applicable)	
			Controlling	Intermediary

**5 Check only if there is NO Interested Party.**

**6 UNSWORN DECLARATION**

My name is \_\_\_\_\_, and my date of birth is \_\_\_\_\_.

My address is \_\_\_\_\_, \_\_\_\_\_, \_\_\_\_\_, \_\_\_\_\_, \_\_\_\_\_  
(street) (city) (state) (zip code) (country)

I declare under penalty of perjury that the foregoing is true and correct.

Executed in \_\_\_\_\_ County, State of \_\_\_\_\_, on the \_\_\_\_\_ day of \_\_\_\_\_, 20\_\_\_\_.  
(month) (year)

\_\_\_\_\_  
 Signature of authorized agent of contracting business entity  
 (Declarant)