

PLAT RECORDING SHEET

PLAT NAME: Grand Aliana Business Park

PLAT NO: _____

ACREAGE: 10.0001

LEAGUE: Andrew M. Clopper

ABSTRACT NUMBER: A-151

NUMBER OF BLOCKS: 1

NUMBER OF LOTS: 0

NUMBER OF RESERVES: 1

OWNERS: Grand Aliana Business Park, L.P., Texas Limited Liability Partnership,

A Texas Limited Liability Company

(DEPUTY CLERK)

STATE OF TEXAS
COUNTY OF FORT BEND COUNTY

I, PATRICK PATEL BEING AN OFFICER OF GRAND ALIANA BUSINESS PARK, L.P., A TEXAS LIMITED PARTNERSHIP, OWNER, HEREBY REFERRED TO AS OWNER OF THE 10.0001 ACRE TRACT DESCRIBED IN THE ABOVE AND FOREGOING MAP OF GRAND ALIANA BUSINESS PARK, DO HEREBY MAKE AND ESTABLISH SAID SUBDIVISION AND DEVELOPMENT PLAN OF SAID PROPERTY ACCORDING TO ALL LINES, DESIGNATIONS, RESTRICTIONS, AND NOTATIONS ON SAID MAPS OR PLAT AND HEREBY DEDICATE TO THE USE OF THE PUBLIC FOREVER, ALL STREETS (EXCEPT THOSE STREETS DESIGNATED AS PRIVATE STREETS, OR PERMANENT ACCESS EASEMENTS), ALLEYS, PARKS, WATER COURSES, DRAINS, EASEMENTS AND PUBLIC PLACES SHOWN THEREON FOR THE PURPOSES AND CONSIDERATIONS THEREIN EXPRESSED; AND DO HEREBY BIND OURSELVES, OUR HEIRS, SUCCESSORS AND ASSIGNS TO WARRANT AND FOREVER DEFEND THE TITLE ON THE LAND SO DEDICATED.

FURTHER, OWNERS HAVE DEDICATED AND BY THESE PRESENTS DO DEDICATE TO THE USE OF THE PUBLIC FOR PUBLIC UTILITY PURPOSE FOREVER UNOBSTRUCTED AERIAL EASEMENTS, THE AERIAL EASEMENTS SHALL EXTEND HORIZONTALLY AN ADDITIONAL ELEVEN FEET, SIX INCHES (11' 6") FOR TEN FEET (10' 0") PERIMETER GROUND EASEMENTS OR SEVEN FEET, SIX INCHES (7' 6") FOR FOURTEEN FEET (14' 0") PERIMETER GROUND EASEMENTS OR FIVE FEET, SIX INCHES (5' 6") FOR SIXTEEN FEET (16' 0") PERIMETER GROUND EASEMENTS, FROM A PLANE SIXTEEN FEET (16' 0") ABOVE THE GROUND LEVEL UPWARD, LOCATED ADJACENT TO AND ADJOINING SAID PUBLIC UTILITY EASEMENTS THAT ARE DESIGNATED WITH AERIAL EASEMENTS (U.E. AND A.E.) AS INDICATED AND DEPICTED HEREON, WHEREBY THE AERIAL EASEMENT TOTALS TWENTY ONE FEET, SIX INCHES (21' 6") IN WIDTH.

FURTHER, OWNERS HAVE DEDICATED AND BY THESE PRESENTS DO DEDICATE TO THE USE OF THE PUBLIC FOR PUBLIC UTILITY PURPOSE FOREVER UNOBSTRUCTED AERIAL EASEMENTS, THE AERIAL EASEMENTS SHALL EXTEND HORIZONTALLY AN ADDITIONAL TEN FEET (10' 0") FOR TEN FEET (10' 0") BACK-TO-BACK GROUND EASEMENTS, OR EIGHT FEET (8' 0") FOR FOURTEEN FEET (14' 0") BACK-TO-BACK GROUND EASEMENTS OR SEVEN FEET (7' 0") FOR SIXTEEN FEET (16' 0") BACK-TO-BACK GROUND EASEMENTS, FROM A PLANE SIXTEEN FEET (16' 0") ABOVE GROUND LEVEL UPWARD, LOCATED ADJACENT TO BOTH SIDES AND ADJOINING SAID PUBLIC UTILITY EASEMENTS THAT ARE DESIGNATED WITH AERIAL EASEMENTS (U.E. AND A.E.) AS INDICATED AND DEPICTED HEREON, WHEREBY THE AERIAL EASEMENT TOTALS THIRTY FEET (30' 0") IN WIDTH.

FURTHER, OWNERS DO HEREBY COVENANT AND AGREE THAT ALL OF THE PROPERTY WITHIN THE BOUNDARIES OF THIS PLAT IS HEREBY RESTRICTED TO PREVENT THE DRAINAGE OF ANY SEPTIC TANKS INTO ANY PUBLIC OR PRIVATE STREET, PERMANENT ACCESS EASEMENT, ROAD OR ALLEY, OR ANY DRAINAGE DITCH, EITHER DIRECTLY OR INDIRECTLY.

FURTHER, OWNERS DO HEREBY DEDICATE TO THE PUBLIC A STRIP OF LAND TWENTY (20) FEET WIDE ON EACH SIDE OF THE CENTER LINE OF ANY AND ALL BAYOUS, CREEKS, GULLIES, RAVINES, DRAWS AND DRAINAGE DITCHES LOCATED IN SAID SUBDIVISION, AS EASEMENTS FOR DRAINAGE PURPOSES, FORT BEND COUNTY OR ANY OTHER GOVERNMENTAL AGENCY SHALL HAVE THE RIGHT TO ENTER UPON SAID EASEMENT AT ANY AND ALL TIMES FOR THE PURPOSES OF CONSTRUCTION AND MAINTENANCE OF DRAINAGE FACILITIES AND STRUCTURES.

FURTHER, OWNERS DO HEREBY COVENANT AND AGREE THAT ALL OF THE PROPERTY WITHIN THE BOUNDARIES OF THIS SUBDIVISION AND ADJACENT TO ANY DRAINAGE EASEMENT, DITCH, GULLY, CREEK OR NATURAL DRAINAGE WAY SHALL HEREBY BE RESTRICTED TO KEEP SUCH DRAINAGE WAYS AND EASEMENTS CLEAR OF FENCES, BUILDINGS, EXCESSIVE VEGETATION AND OTHER OBSTRUCTIONS TO THE OPERATIONS AND MAINTENANCE OF THE DRAINAGE FACILITY AND THAT SUCH ABUTTING PROPERTY SHALL NOT BE PERMITTED TO DRAIN DIRECTLY INTO THIS EASEMENT EXCEPT BY MEANS OF AN APPROVED DRAINAGE STRUCTURE.

FURTHER, OWNERS DO HEREBY ACKNOWLEDGE THE RECEIPT OF THE "ORDERS FOR REGULATION OF OUTDOOR LIGHTING IN THE UNINCORPORATED AREAS OF FORT BEND COUNTY, TEXAS"; AND DO HEREBY COVENANT AND AGREE AND SHALL COMPLY WITH THIS ORDER AS ADOPTED BY FORT BEND COUNTY COMMISSIONER'S COURT ON MARCH 23, 2004, AND ANY SUBSEQUENT AMENDMENTS.

IN TESTIMONY WHEREOF, GRAND ALIANA BUSINESS PARK, L.P., A TEXAS LIMITED PARTNERSHIP, HAS CAUSED THESE PRESENTS TO BE SIGNED BY ITS MANAGER, PATRICK PATEL, AND ITS COMMON SEAL HERETO AUTHORIZED, THIS _____ DAY OF _____, 2019.

GRAND ALIANA BUSINESS PARK, L.P., A TEXAS LIMITED PARTNERSHIP

BY: _____
PATRICK PATEL, MANAGER

STATE OF TEXAS
COUNTY OF FORT BEND

BEFORE ME, THE UNDERSIGNED AUTHORITY, ON THIS DAY PERSONALLY APPEARED PATRICK PATEL, OWNER, KNOWN TO ME TO BE THE PERSON WHOSE NAME IS SUBSCRIBED TO THE FOREGOING INSTRUMENT AND ACKNOWLEDGED TO ME THAT HE EXECUTED THE SAME FOR THE PURPOSES AND CONSIDERATIONS THEREIN EXPRESSED AND IN THE CAPACITY THEREIN AND HEREIN SET OUT, AND AS THE ACT AND DEED OF SAID LIMITED LIABILITY COMPANY.

GIVEN UNDER MY HAND AND SEAL OF OFFICE, THIS _____ DAY OF _____, 2019.

PRINTED NAME: _____
NOTARY PUBLIC IN AND FOR THE STATE OF TEXAS
MY COMMISSION EXPIRES: _____

LEGEND

- B.L. BUILDING LINE
- U.E. UTILITY EASEMENT
- S.S.E. SANITARY SEWER EASEMENT
- STM. S.E. STORM SEWER EASEMENT
- W.L.E. WATER LINE EASEMENT
- A.E. AERIAL EASEMENT
- D.E. DRAINAGE EASEMENT
- L.E. LANDSCAPE EASEMENT
- ESMT. EASEMENT
- I.R.C. CAPPED IRON ROD
- R.O.W. RIGHT-OF-WAY
- VOL. VOLUME
- PR. PAGE
- NO. NUMBER
- F.B.C.D.R. FORT BEND COUNTY DEED RECORDS
- F.B.C.C.F. FORT BEND COUNTY CLERK'S FILE
- F.B.C.P.R. FORT BEND COUNTY PLAT RECORDS
- O.P.R.O.R.P. OFFICIAL PUBLIC RECORDS OF REAL PROPERTY

CALLED 179.997 ACRES
MADDEN ROAD LANDFILL
LIMITED PARTNERSHIP
(F.N. 200409691, F.B.C.O.P.R.)

CALLED 22.6212
AGOP Y. BEDKIAN, ET UX
(VOL. 1714, PG. 529, F.B.C.D.R.)

SET 5/8" IRC
N:13803759.47
E:3015642.50

SET 5/8"IRC
N:13803778.21
E:3016053.74

P.O.B.
FND 1/2" IP
N:13802702.78
E:3015692.57

FND 5/8" IR
N:13802721.52
E:3016103.81

| RESERVE TABLE | | | |
|---------------|------------|---------|---------|
| RESERVE | TYPE | ACREAGE | SQ.FT. |
| A | COMMERCIAL | 10.0001 | 435,603 |
| TOTAL | | 10.0001 | 435,603 |

MADHAVI TALLURI, P.E.
TEXAS REGISTRATION NO. 113329

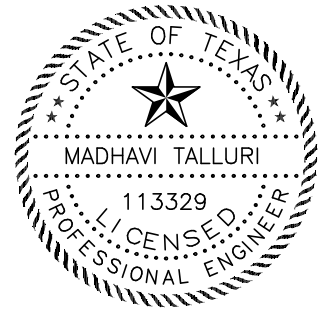

THIS IS TO CERTIFY THAT THE PLANNING COMMISSION OF THE CITY OF HOUSTON, TEXAS, HAS APPROVED THIS PLAT AND SUBDIVISION OF GRAND ALIANA BUSINESS PARK IN CONFORMANCE WITH THE LAWS OF THE STATE OF TEXAS AND THE ORDINANCES OF THE CITY OF HOUSTON, AS SHOWN HEREON, AND

AUTHORIZED THE RECORDING OF THIS PLAT THIS _____ DAY OF _____, 2019.

BY: _____ OR _____
MARGARET WALLACE BROWN, SECRETARY

NOTES:

- THE BEARINGS AND OTHER POINTS OF REFERENCE HAVE BEEN MARKED WITH IRON (OR OTHER OBJECTS OF A PERMANENT NATURE) PIPES OR RODS HAVING AN OUTSIDE DIAMETER OF NOT LESS THAN FIVE EIGHTHS (5/8) INCH AND A LENGTH OF NOT LESS THAN THREE (3) FEET; AND THAT THE PLAT BOUNDARY CORNERS HAVE BEEN TIED TO THE TEXAS COORDINATE SYSTEM OF 1983, SOUTH CENTRAL ZONE.
- THE BEARINGS SHOWN HEREON ARE BASED ON THE TEXAS COORDINATE SYSTEM, SOUTH CENTRAL ZONE, NAD'83.
- THE COORDINATES SHOWN HEREON ARE TEXAS SOUTH CENTRAL ZONE NO. 4204 STATE PLANE GRID COORDINATES (NAD'83) AND MAY BE BROUGHT TO SURFACE BY APPLYING THE FOLLOWING COMBINED SCALE FACTOR 1.00013.
- THIS PROPERTY LIES IN UNSHADED ZONE "X" AS PER FLOOD INSURANCE RATE MAP COMMUNITY PANEL NO. 48157C0140L, EFFECTIVE DATE APRIL 2, 2014.
- THE DRAINAGE SYSTEM FOR THIS SUBDIVISION SHALL BE DESIGNED TO MEET THE REQUIREMENTS OF THE FORT BEND COUNTY DRAINAGE CRITERIA MANUAL, WHICH ALLOWS STREET PONDING WITH INTENSE RAINFALL EVENTS.
- ALL DRAINAGE EASEMENTS TO BE KEPT CLEAR OF FENCES, BUILDINGS, VEGETATION AND OTHER OBSTRUCTIONS TO THE OPERATION AND MAINTENANCE OF THE DRAINAGE FACILITY.
- ALL PROPERTY TO DRAIN INTO DRAINAGE EASEMENT ONLY THROUGH AN APPROVED DRAINAGE STRUCTURE.
- EXISTING SHEET FLOW DRAINAGE PATTERNS WITHIN THIS SUBDIVISION SHALL NOT BE IMPEDED BY BUILDERS.
- THE TOP OF ALL FLOOR SLAB ELEVATIONS SHALL BE MINIMUM OF 93.75 FEET ABOVE MEAN SEA LEVEL. THE TOP OF SLAB ELEVATION AT ANY POINT ON THE PERIMETER OF THE SLAB SHALL NOT BE LESS THAN EIGHTEEN (18) INCHES ABOVE NATURAL GROUND.
- LOCAL BENCHMARK: BOX CUT ON THE NORTHWEST CORNER OF A CURB INLET IN THE NORTH R.O.W. OF MADDEN ROAD APPROXIMATELY 240 FEET EAST OF THE INTERSECTION OF GLENCOSE AVE. & MADDEN ROAD. ELEV.= 90.31 (NAV'88, 2001 ADJUSTMENT)
- LOCAL BENCHMARK: BOX CUT ON THE NORTHWEST CORNER OF A CURB INLET IN THE NORTH R.O.W. OF MADDEN ROAD APPROXIMATELY 240 FEET EAST OF THE INTERSECTION OF GLENCOSE AVE. & MADDEN ROAD. ELEV.= 90.31 (NAV'88, 2001 ADJUSTMENT)
- UNLESS OTHERWISE INDICATED, THE BUILDING LINE (B.L.), WHETHER ONE OR MORE, SHOWN ON THIS SUBDIVISION PLAT ARE ESTABLISHED TO EVIDENCE COMPLIANCE WITH THE APPLICABLE PROVISIONS OF CHAPTER 42, CODE OF ORDINANCES, CITY OF HOUSTON, TEXAS, IN EFFECT AT THE TIME THIS PLAT WAS APPROVED, WHICH MAY BE AMENDED FROM TIME TO TIME.
- THERE ARE NO PIPELINES OR PIPELINE EASEMENTS WITHIN THE PLATTED AREA SHOWN HEREON.

- SITE PLANS SHALL BE SUBMITTED TO FORT BEND COUNTY AND ANY OTHER APPLICABLE JURISDICTION FOR REVIEW AND APPROVAL. DEVELOPMENT PERMITS AND ALL OTHER APPLICABLE PERMITS SHALL BE OBTAINED FROM FORT BEND COUNTY PRIOR TO BEGINNING CONSTRUCTION.
- THIS PROPERTY IS IN THE FORT BEND COUNTY LIGHTING ORDINANCE ZONE "L23".
- SIDEWALKS SHALL BE BUILT OR CAUSED TO BE BUILT NOT LESS THAN FIVE FEET IN WIDTH ON BOTH SIDES OF ALL DEDICATED RIGHTS-OF-WAY WITHIN SAID PLAT AND ON THE CONTIGUOUS RIGHT-OF-WAY OF ALL PERIMETER ROADS SURROUNDING SAID PLAT, IN ACCORDANCE WITH THE A.D.A.
- ABSENT WRITTEN AUTHORIZATION BY THE AFFECTED UTILITIES, ALL UTILITY AND AERIAL EASEMENTS MUST BE KEPT UNOBSTRUCTED FROM ANY NON-UTILITY IMPROVEMENTS OR OBSTRUCTIONS BY THE PROPERTY OWNERS, ANY UNAUTHORIZED IMPROVEMENTS OR OBSTRUCTIONS MAY BE REMOVED BY ANY PUBLIC UTILITY AT THE PROPERTY OWNER'S EXPENSE. WHILE WOODEN POSTS AND PANELED WOODEN FENCES ALONG THE PERIMETER AND BACK TO BACK EASEMENTS AND ALONGSIDE REAR LOTS LINES ARE PERMITTED THEY TOO MAY BE REMOVED BY PUBLIC UTILITIES AT THE PROPERTY OWNER'S EXPENSE SHOULD THEY BE AN OBSTRUCTION. PUBLIC UTILITIES MAY PUT SAID WOODEN POSTS AND PANELED WOODEN FENCED BACK UP, BUT GENERALLY WILL NOT REPLACE WITH NEW FENCING.
- THIS PLAT WAS PREPARED TO MEET CITY OF HOUSTON AND FORT BEND COUNTY REQUIREMENTS.
- ALL PROPERTY LOCATED ON THE ABOVE AND FOREGOING PLAT IS ENTIRELY WITHIN THE EXTRATERRITORIAL JURISDICTION OF THE CITY OF HOUSTON, FORT BEND COUNTY, FORT BEND DRAINAGE DISTRICT, FORT BEND COUNTY EMERGENCY SERVICE DISTRICT NO. 5, AND FORT BEND INDEPENDENT SCHOOL DISTRICT.
- B.L. INDICATES BUILDING LINE, U.E. INDICATES UTILITY EASEMENT, S.S.E. INDICATES SANITARY SEWER EASEMENT, W.L.E. INDICATES WATER LINE EASEMENT, STM. S.E. INDICATES STORM SEWER EASEMENT, A.E. INDICATES AERIAL EASEMENT, D.E. INDICATES DRAINAGE EASEMENT, L.E. INDICATES LANDSCAPE EASEMENT, ESMT INDICATES EASEMENT.
- ALL PROPERTY OF RESERVE "A" SHALL BE RESPONSIBLE FOR MAINTENANCE OF DETENTION AND ALL DRAINAGE EASEMENTS WHICH FALL WITHIN THE LIMITS OF THEIR RESPECTIVE RESERVE. HOWEVER, FORT BEND COUNTY RESERVES THE RIGHT TO MAINTAIN THESE DRAINAGE EASEMENTS AT THEIR DISCRETION.
- THIS PROPERTY IS SUBJECT TO A DECLARATION OF MAINTENANCE COVENANT AND EASEMENT FOR STORM WATER CONTROL FACILITIES AS RECORDED IN F.B.C.C. FILE NO. 2019072284.

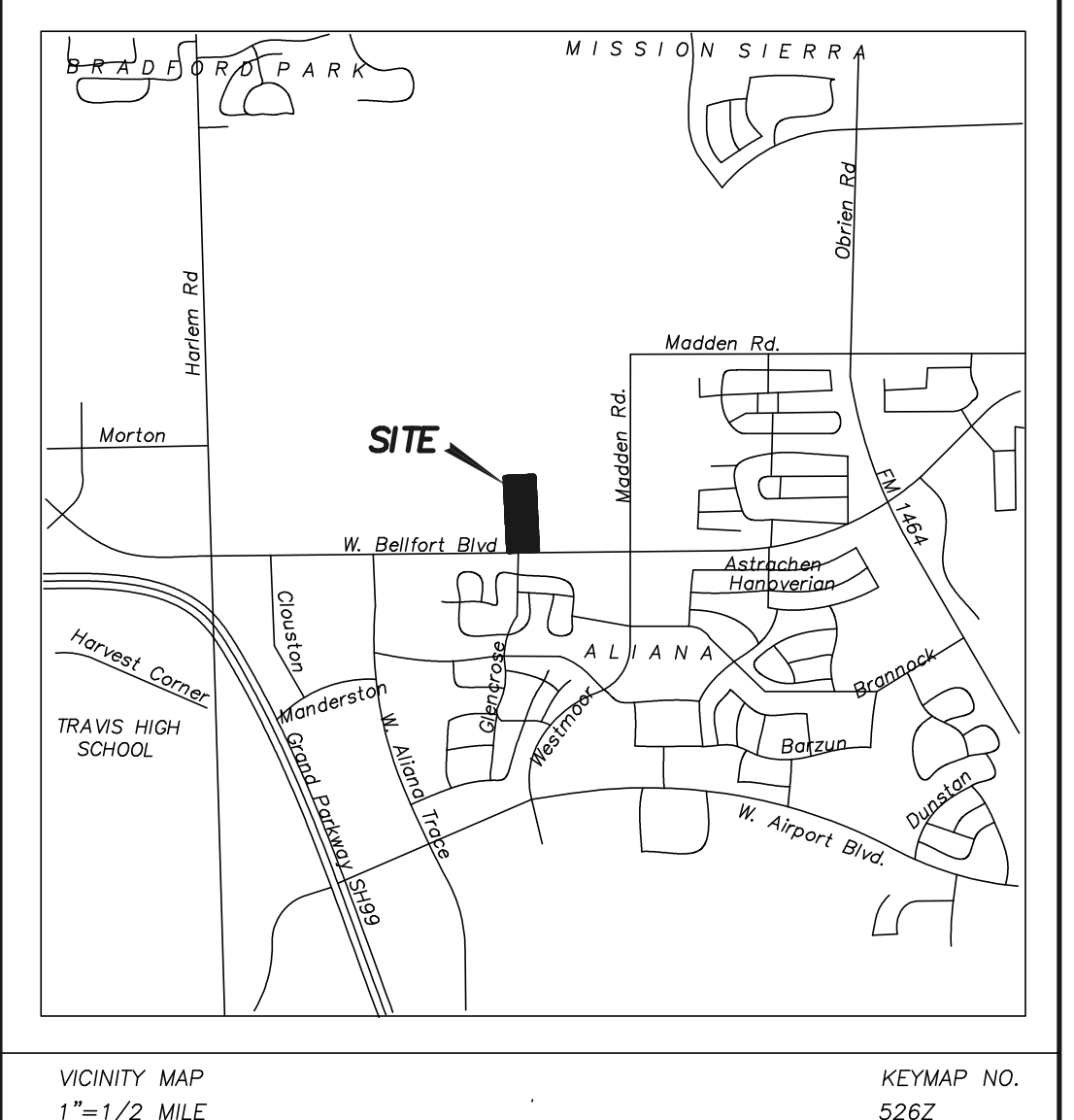
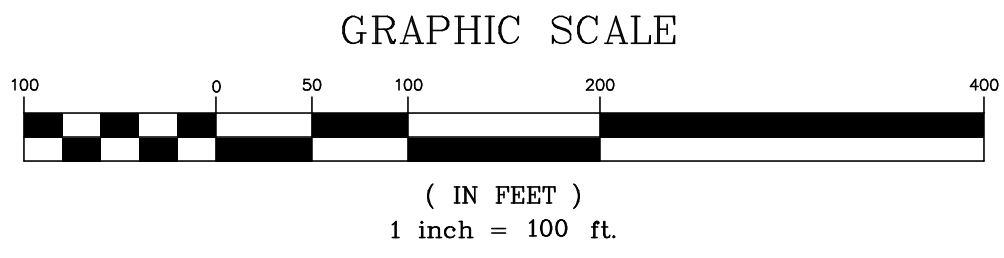

I, J. STACY SLAWINSKI, P.E., FORT BEND COUNTY ENGINEER, DO HEREBY CERTIFY THAT THE PLAT OF THIS SUBDIVISION COMPLIES WITH ALL OF THE EXISTING RULES AND REGULATIONS OF THIS OFFICE AS ADOPTED BY THE FORT BEND COUNTY COMMISSIONER'S COURT. HOWEVER, NO CERTIFICATION IS HEREBY GIVEN AS TO THE EFFECT OF DRAINAGE FROM THIS SUBDIVISION ON THE INTERCEPTING DRAINAGE ARTERY OR PARENT STREAM OR ON ANY OTHER AREA OR SUBDIVISION WITHIN THE WATERSHED.

J. STACY SLAWINSKI, P.E.
INTERIM FORT BEND COUNTY ENGINEER

APPROVED BY THE COMMISSIONER'S COURT OF FORT BEND COUNTY, TEXAS,
THIS _____ DAY OF _____, 20____

BY: _____
VINCENT M. MORALES, JR.
COMMISSIONER, PRECINCT 1

BY: _____
KIP GEORGE
COUNTY JUDGE

BY: _____
W.A. "ANDY" MEYERS
COMMISSIONER, PRECINCT 3

BY: _____
GRADY PRESTAGE
COMMISSIONER, PRECINCT 2

BY: _____
KEN R. DEMERCHANT
COMMISSIONER, PRECINCT 4

I, LAURA RICHARD, COUNTY CLERK IN AND FOR FORT BEND COUNTY, DO HEREBY CERTIFY THAT THE FOREGOING INSTRUMENT WITH ITS CERTIFICATE OF AUTHENTICATION WAS FILED FOR RECORDATION IN MY OFFICE ON _____ AT _____ O'CLOCK _____ M., IN PLAT NO. _____ OF THE PLAT RECORDS OF SAID COUNTY.

WITNESS MY HAND AND SEAL OF OFFICE, AT RICHMOND, TEXAS, THE DAY AND DATE LAST ABOVE WRITTEN.

BY: _____
LAURA RICHARD, COUNTY CLERK
FORT BEND COUNTY, TEXAS

BY: _____
DEPUTY

GRAND ALIANA BUSINESS PARK

A SUBDIVISION OF 10.0001 ACRES
IN THE ANDREW M. CLOPPER LEAGUE, A-151
FORT BEND COUNTY, TEXAS

1 BLOCK 1 RESERVE
JULY 22, 2019

OWNER:

GRAND ALIANA BUSINESS PARK, L.P.
TEXAS LIMITED LIABILITY PARTNERSHIP
A TEXAS LIMITED LIABILITY COMPANY,
PATRICK PATEL, MANAGER
2731 HORIZON BAY LAKE
KATY, TX 77494-3268
(832) 483-4286

ENGINEER: _____ SURVEYOR: _____
CATALYST TECHNICAL GROUP, INC. TEJAS SURVEYING, INC.
FIRM NO. 15775 FIRM NO. 10031300
MADHAVI TALLURI, P.E. RANDY S. MCCLENDON, RPLS
440 COBIA DR., SUITE 1503 1810 FIRST OAKS STREET, SUITE 220
KATY, TX 77494 RICHMOND, TEXAS 77406
(832) 913-1888 (JOB# 14444191P
(281) 240-9099