

PO # 166735^{34L}
AMS

**FORT BEND COUNTY
ENGINEERING**

**CHANGE
ORDER**

- Distribution:
- FBC Engineering
 - FBC Judge
 - FBC Purchasing
 - Contractor
 - Consultant

Address: 301 Jackson Street
Richmond, Texas 77469

Phone: 281-633-7500

Fax: 281-342-7366

Web site: www.FortBendCountyTx.gov

PROJECT:
Crossover Road Improvement Project
From FM 1463 to Katy Flewellen Road
(Spring Green Boulevard)

CHANGE ORDER NUMBER 002

DATE 03/11/2019

PROJECT NUMBER 13307

CONTRACT FOR \$2,461,370.34

CONTRACT DATE 01/31/2018

FBC PURCHASE ORDER NO 166735

CONTRACTOR:
Allgood Construction Company Inc.

The contract is changed as follows:
Due to the additional work, the contractor could not complete the Project by the current completion date of January 28, 2019. The contractor requested to increase the contract by 29 days. The new completion date as of this Change Order is March 01, 2019. Change Order will add \$ 13,139.78 and 29 calendar days, to the current construction contract. Revised Sheet 20 and 21 are incorporated into the contract plans. Further information and documentation is attached.

Not valid until signed by Fort Bend County and Contractor.

The Original (Contract Sum)	\$	2,461,370.34 ✓
Net change by previously authorized Change Orders	\$	0
The (Contract Sum) Prior to this Change Order was	\$	2,461,370.34 ✓
The (Contract Sum) will be <input checked="" type="checkbox"/> increased or <input type="checkbox"/> decreased or <input type="checkbox"/> unchanged by this Change Order in the amount of		
	\$	13,139.78
The new (Contract Sum) including this Change Order will be	\$	2,474,510.12 ✓

The Contract Time will be increased **or** decreased **or** unchanged by **29** days.
The Date of Substantial Completion as of this Change Order therefore is
 changed **or** unchanged to **03/01/2019**.

Authorized:

Fort Bend County Engineering
J Stacy Slawinski, P.E.
301 Jackson
Richmond, Texas 77469

By: *J. Slawinski*
(signature)

DATE: 04/03/19

CONTRACTOR

By: *Michael Boenig*
(signature)

DATE: 3-29-19

Fort Bend County Judge
Honorable KP George
301 Jackson St., #719
Richmond, Texas 77469

By: *KP George*
(signature)

DATE: 4-23-2019

The contract is changed as follow:

Item 7: Remove and Dispose of Existing Concrete or Metal Pipe (All Sizes)

Quantity: 68 LF Unit Price: \$10.80 Item Total Price: \$734.40

Details: Overrun due to plan error, the original plan called for the removal of 350 LF concrete pipe, during construction, the contractor removed an additional 68 LF of concrete pipe.

Item 42: CSB1(10) Barrier (Furnish & Install)

Quantity: 15 LF Unit Price: \$60.48 Item Total Price: \$907.20

Details: Overrun due to barriers coming in at 30 FT increments

Item 44: CSB1(10) Barrier & Absorb-16 (Remove)

Quantity: 15 LF Unit Price: \$10.80 Item Total Price: \$162.00

Details: Overrun due to barriers coming in at 30 FT increments

Item 45: Aluminum Signs (Ground Mounted)- Furnish & Install

Quantity: 5 EA Unit Price: \$307.80 Item Total Price: \$1,539.00

Details: Fort Bend County Representatives requested to add 2 Speed Signs, 2 warning light ahead sign, and 1 curve suggested speed sign.

Item 48: Reflectorized Pavement Markings Type I (Thermoplastic) 8" White/Solid W/TY II C-R Marker Button (W)- Furnish & Applied

Quantity: 391 LF Unit Price: \$2.27 Item Total Price: \$887.57

Details: The plans called for 6" striping at the Crossover Road - FM 1463 left turn lane. 8" striping was used as per County request

Item 51: Reflectorized Pavement Markings Type I (Thermoplastic) 24" White/Solid - Furnish & Applied

Quantity: 29 LF Unit Price: \$5.02 Item Total Price: \$145.58

Details: Overrun due to Stop Bar at FM 1463 was omitted in the plans.

Item 106: Reinforced Filter Fabric Barrier (60% of unit cost for furnish and installation and 40% of unit cost for removal)

Quantity: 28 LF Unit Price: \$1.35 Item Total Price: \$37.80

Details: Overrun due to Filter fence added to the 2 additional inlets mentioned in RFI 03.

Item 128: Work Zone Pavement Markings 4" White/Solid (DBL)(Removable) Furnished -Applied & Removed

Quantity: 500LF Unit Price: \$1.75 Item Total Price: \$875.00

Details: The plans called for 6" solid with buttons. Per County request, buttons were replaced with 4" double buttons for future removal and striping.

RFI 01 (09-12-18): Wavetronics Radar Detector

The original contract plan showed to install 4 Econolite Presence Radar and 2 Econolite Advanced Radar Detectors for the Traffic Signal at FM 1463 and Crossover Intersection. The above-mentioned signal is inside TXDOT's ROW and it is TXDOT's responsibility to maintain the traffic signal at intersection. TXDOT has requested to use Wavetronics and not Econolite. The associated cost with changing out the radars is detailed below:

Item 94: Radar Presence Detector (Item Removed)

Quantity: (-4) EA Unit Price: \$6,825.00 Item Total Price: **(\$27,300.00)**

Item 95: Radar Advanced Detection Device (Item Removed)

Quantity: (-2) EA Unit Price: \$7,140.00 Item Total Price: **(\$14,280.00)**

Item 113: Wavetronic Radars (Item Added)
Quantity: 1 LS Unit Price: \$45,704.62 Item Total Price: \$45,704.62

RFI 01 Subtotal Cost: (-\$27,300.00) + (-\$14,280.00) + \$45,704.62 = \$4,124.62

RFI 02 (10-01-18): Type C Modified Inlet replaced with Type BB Modified Inlet.

Proposed Inlet #13 (Type C Modified Inlet) at Sta. 17+84 WB conflicted with an existing gas line. The Contractor proposed to use a Type BB Modified Inlet in place of Type C Modified Inlet to provide a 30-inch clearance between proposed inlet and existing gas line and was approved by David Kermany (Design Engineer). The associated cost of switching the Inlet is detailed below:

Item 36: Type C Modified Inlet (1 Qty Subtracted from Original Quantity)
Quantity: (-1) EA Unit Price: \$1,344.60 Item Total Price: **(\$1,344.60)**

Item 114: Type BB Modified Inlet (New Item)
Quantity: 1 EA Unit Price: \$1,895.00 Item Total Price: \$1,895.00

RFI 02 Subtotal Cost: **(\$1,344.60)** + \$ 1,895.00 = \$550.40

RFI 03 (10-09-18): Drainage Conflict with Proposed Pavement and Installation of Two New Inlets.

The Spring Green Boulevard Expansion Project (Project No. 13318) plan sheet 21 and 22 proposed to install 24" and 36" RCPs with SETs to provide temporary drainage in the area prior to Crossover Road construction and should be removed during the construction of Crossover Road Project. However, the temporary storm sewer was not shown on Crossover Road original plan, which caused conflict with the new proposed Crossover Road roadway (sheet 20 and 21). To resolve this issue the design engineer proposed to remove the installed temporary storm sewer, along with four (4) SETs, three (3) Manholes, and 460 LF of RCP see revised sheet 20 and 21 (attachment).

A manhole at Station 34+48.50 and a 4'X2' RCB trunk line was also installed as part of the Spring Green Extension Project temporary storm sewer system, both are located inside the Crossover Road proposed median and not in conflict with the proposed roadway. The design engineer proposed to keep the 4'x2' trunk line, modify an existing 36" RCP from this manhole to connect to a Modify Type C Inlet #25 at Station 34+24, 40 RT, and modify the manhole to add 50 LF of proposed 24" RCP to connect this manhole to a proposed Modified Type C inlet #24 at Station 34+24, 40 LT, see revised plan sheet 20 and 21 (attachment). The cost for additional work is summarized below:

Item 26: Reinforced Concrete Pipe, Class III, Rubber Gasquet 24" (Quantity Overrun)
Quantity: 50 LF Unit Price: \$55.61 Item Total Price: \$2,780.50

Item 36: Standard Type "C" (MOD) Inlet, 4" Slope Paving Included (Quantity Overrun)
Quantity: 2 EA Unit Price: \$1,344.60 Item Total Price: \$2,689.20

Item 38: Tie to Exist. Manhole (Quantity Overrun)
Quantity: 1 EA Unit Price: \$378.00 Item Total Price: \$378.00

Item 115: Mobilization of Utility and Equipment (New Item)
Quantity: 1 EA Unit Price: \$2,500.00 Item Total Price: \$2,500.00

Item 116: Remove and Dispose of Existing Concrete or Metal Pipe (All Sizes) (Quantity Overrun)
Quantity: 460 LF Unit Price: \$ 20.00 Item Total Price: \$ 9,200.00
Description: Original bid unit price of \$ 10.80 was for removing drainage below driveways or removing existing RCP and replacing with new RCP within the same trench to be backfilled. Additional cost is for backfilling the trench in lifts rather than replacing the RCP and a deeper trench was necessary.

Item 117: 36" SET Removal (New Item)
Quantity: 2 EA Unit Price: \$ 750.00 Item Total Price: \$ 1,500.00

Item 118: 24" SET Removal (New Item)
Quantity: 2 EA Unit Price: \$ 500.00 Item Total Price: \$ 1,000.00

Item 119: Remove Existing Manhole (New Item)
Quantity: 3 EA Unit Price: \$ 500.0 Item Total Price: \$ 1,500.00

RFI 03 Subtotal Cost: \$2,780.50 + \$2,689.20 + \$378.00 + \$2,500.00 + \$9,200.00 + \$1,500.00 + \$1,000 + \$1,500 = \$21,547.70

RFI 06 (12-11-2018): Skybridge – Crossover Intersection steep slope from proposed tie-in.

Skybridge Point Lane intersects Crossover Road at approximately Station 27+40, plan sheet 19. The elevation difference between the proposed Crossover Road gutter line and the original proposed tie-in (30 feet from the Crossover gutter line) at Skybridge Point Lane was about 2 feet, creating a steep slope at that intersection. The Contractor proposed to remove the existing pavement on Skybridge and move the tie-in location back approximately 87 feet from the Crossover Road gutter line to lessen the slope and a smoother transition. This tie-in is 57 feet longer than originally designed. Fort Bend County Representative approved the new roadway tie-in location and requested that the sidewalks running parallel to Skybridge Point Lane tie into two Type 5 Pedestrian Ramps. The tie-in for the parallel sidewalks was moved back approximately 87 feet from the Crossover Road gutter line to be ADA compliant. The cost for additional work is summarized below:

Item 17: Reinforced Concrete Pavement – 8" Depth (Quantity Overrun)
Quantity: 177.34 SY Unit Price: \$ 42.25 Item Total Price: \$ 7,492.61

Item 20: 6" Reinforced Concrete Curb (Quantity Overrun)
Quantity: 114.00 SY Unit Price: \$ 2.38 Item Total Price: \$ 271.32

Item 103: Sodding for Erosion Control (Quantity Overrun)
Quantity: 545.00 SY Unit Price: \$ 3.51 Item Total Price: \$ 1,912.95

Item 121: Removal of Concrete Pavement (New Item)
Quantity: 177.34 SY Unit Price: \$ 6.61 Item Total Price: \$ 1,172.22

Item 122: Removal of 6" Concrete Curb (New Item)
Quantity: 114.00 SY Unit Price: \$ 3.63 Item Total Price: \$ 413.82

Item 123: Cement Stabilized Sand for Subgrade 8"-depth (New Item)
Quantity: 177.34 SY Unit Price: \$ 12.98 Item Total Price: \$ 2,301.87

Item 124: Type 5 – Pedestrian Ramp (New Item)
Quantity: 2.00 EA Unit Price: \$ 1,653.11 Item Total Price: \$ 3,306.22

Item 125: Remove existing Sidewalk (New Item)
Quantity: 125.00 EA Unit Price: \$ 3.45 Item Total Price: \$ 431.25

Item 126: Install 5 feet wide Sidewalk
Quantity: 125.00 EA Unit Price: \$ 52.35 Item Total Price: \$ 6,543.75

Item 127: Regrade from Back of Curb to ROW
Quantity: Lump Sum Unit Price: \$ 2,500.00 Item Total Price: \$ 2,500.00

RFI 06 Subtotal Cost: \$7,492.61 + \$271.32 + \$1,053.00 + \$1,172.22 + \$413.82 + \$2,301.87 + \$3,306.22
+ \$431.25 + \$6,543.75 + \$2,500.00 = \$25,486.06

Additional Items below are to be credited back to the County:

Item 4: Earthen Swale
Quantity: (-345 LF) Unit Price: \$ 3.78 Item Total Price: **(\$1,304.10)**

Item 9: Remove and Dispose Existing Fence
Quantity: (-260 LF) Unit Price: \$ 2.16 Item Total Price: **(\$561.60)**

Item 12: Hydrated Lime (Slurry) or Commercial Lime Slurry (3% by Dry Weight)
Quantity: (-70.73 Ton) Unit Price: \$ 171.72 Item Total Price: **(\$12,145.76)**

Item 14: Fly Ash for Stabilization (8% by Dry Weight)
Quantity: (-188.40 Ton) Unit Price: \$ 86.40 Item Total Price: **(\$16,277.76)**

Item 22: 7" Thick Reinforced Concrete Driveway
Quantity: (-10.00 SY) Unit Price: \$ 64.80 Item Total Price: **(\$648.00)**

Item 39: Work Zone Pavement Markings 24" White/Solid (Removable) Furnished-Applied and Remove
Quantity: (-24.00 LF) Unit Price: \$ 3.24 Item Total Price: **(\$77.76)**

Item 40: Work Zone Pavement Markings 4" Yellow/Solid (DBL)(Removable) Furnished -Applied &
Removed
Quantity: (-4,913 LF) Unit Price: \$ 1.13 Item Total Price: **(\$5,551.69)**

Item 41: Work Zone Pavement Markings 4" White/Solid (Removable) Furnished - Applied & Removed
Quantity: (-5,366 LF) Unit Price: \$ 0.54 Item Total Price: **(\$2,897.64)**

Item 49: Reflectorized Pavement Markings Type I (Thermoplastic) 6" White/Solid - Furnish & Applied
Quantity: (-560 LF) Unit Price: \$ 0.76 Item Total Price: **(\$425.60)**

Item 50: Reflectorized Pavement Markings Type I (Thermoplastic) 12" White/Solid - Furnish & Applied
Quantity: (-80 LF) Unit Price: \$ 2.43 Item Total Price: **(\$194.40)**

Item 52: Reflectorized Pavement Markings Type I (Thermoplastic) 12" Yellow/Solid - Furnish & Applied
Quantity: (-810 LF) Unit Price: \$ 2.16 Item Total Price: **(\$1,749.60)**

Item 109: Stabilized Construction Access (Type 1-Rock; 60% of unit cost for furnish and installation, and
40% of unit cost for removal)
Quantity: (-267 SY) Unit Price: \$ 10.80 Item Total Price: **(\$2,883.60)**

The Contractor's proposed prices for the new items are similar to previous Fort Bend County projects. These prices are also similar to November 30, 2018, TxDOT 3 Months Moving Average Low Bid Unit Price. These prices have been determined to be fair and reasonable for the work involved. Due to the additional work, the contractor could not complete the Project by January 28, 2019; the Current Completion Date. The contractor requested to increase the contract by 29 days. The completion date as of this Change Order is March 11, 2019.

Project Name: Crossover Road Improvement Project From FM 1463 to Spring Green Blvd.
Project No: 13307
Contractor: Allgood Construction Company Inc.
Request: Final Quantity Adjustment

Contract Amount	\$2,461,370.34
Previous Approved CO 01	\$0.00
Amount this CO 02	\$13,139.78
New Contract Amount	<u>\$2,474,510.12</u>

Item No.	Item Description	Unit	Bid Quantity	Bid Cost	Bid Total	New Quantity	Item Price	New Item Total	Total Change in Price
Overrun									
7	Remove and Dispose of Existing Concrete or Metal Pipe (All Sizes)	LF	350.00	\$10.80	\$3,780.00	418.00	\$10.80	\$4,514.40	\$734.40
17	Reinforced Concrete Pavement – 8" Depth	SY	19516.00	\$42.25	\$824,551.00	19693.34	\$42.25	\$832,043.62	\$7,492.61
20	6" Reinforced Concrete Curb	LF	13380.00	\$2.38	\$31,844.40	13494.00	\$2.38	\$32,115.72	\$271.32
26	Reinforced Concrete Pipe, Class III, Rubber Gasquet 24"	LF	1025.00	\$55.61	\$57,000.25	1075.00	\$55.61	\$59,780.75	\$2,780.50
36	Standard Type "C" (MOD) Inlet, 4" Slope Paving Included	EA	6.00	\$1,344.60	\$8,067.60	7.00	\$1,344.60	\$9,412.20	\$1,344.60
38	Tie to Exist. Manhole	EA	1.00	\$378.00	\$378.00	2.00	\$378.00	\$756.00	\$378.00
42	CSB1(10) Barrier (Furnish & Install)	LF	165.00	\$60.48	\$9,979.20	180.00	\$60.48	\$10,886.40	\$907.20
44	CSB1(10) Barrier & Absorb-16 (Remove)	LF	165.00	\$10.80	\$1,782.00	180.00	\$10.80	\$1,944.00	\$162.00
45	Aluminum Signs (Ground Mounted)- Furnish & Install	EA	6.00	\$307.80	\$1,846.80	11.00	\$307.80	\$3,385.80	\$1,539.00
48	ReflectORIZED Pavement Markings Type I (Thermoplastic) 8" White/Solid W/TY II C-R Marker Button (W)- Furnish & Applied	LF	300.00	\$2.27	\$681.00	691.00	\$2.27	\$1,568.57	\$887.57
51	ReflectORIZED Pavement Markings Type I (Thermoplastic) 24" White/Solid - Furnish & Applied	LF	90.00	\$5.02	\$451.80	119.00	\$5.02	\$597.38	\$145.58
103	Sodding for Erosion Control	SY	1985.00	\$3.51	\$6,967.35	2530.00	\$3.51	\$8,880.30	\$1,912.95
106	Reinforced Filter Fabric Barrier (60% of unit cost for furnish and installation and 40% of unit cost for removal)	LF	200.00	\$1.35	\$270.00	228.00	\$1.35	\$307.80	\$37.80
Overrun Subtotal									\$18,593.54

Item No.	Item Description	Unit	Bid Quantity	Bid Cost	Bid Total	New Quantity	Item Price	New Item Total	Total Change in Price
New Items									
113	Wavetronic Radars	LS	0.00	\$0.00	\$0.00	1.00	\$45,704.62	\$45,704.62	\$45,704.62
114	Type BB Modified Inlet	EA	0.00	\$0.00	\$0.00	1.00	\$1,895.00	\$1,895.00	\$1,895.00
115	Mobilization of Utility and Equipment	LS	0.00	\$0.00	\$0.00	1.00	\$2,500.00	\$2,500.00	\$2,500.00
116	Remove and Dispose of Existing Concrete or Metal Pipe	LF	0.00	\$0.00	\$0.00	460.00	\$20.00	\$9,200.00	\$9,200.00
117	36" SET Removal	EA	0.00	\$0.00	\$0.00	2.00	\$750.00	\$1,500.00	\$1,500.00
118	24" SET Removal	EA	0.00	\$0.00	\$0.00	2.00	\$500.00	\$1,000.00	\$1,000.00
119	Remove Existing Manhole	EA	0.00	\$0.00	\$0.00	3.00	\$500.00	\$1,500.00	\$1,500.00
121	Removal of Concrete Pavement	SY	0.00	\$0.00	\$0.00	177.34	\$6.61	\$1,172.22	\$1,172.22
122	Removal of 6" Concrete Curb	LF	0.00	\$0.00	\$0.00	114.00	\$3.63	\$413.82	\$413.82
123	Cement Stabilized Sand for Subgrade 8"-depth	SY	0.00	\$0.00	\$0.00	177.34	\$12.98	\$2,301.87	\$2,301.87
124	Type 5 – Pedestrian Ramp	EA	0.00	\$0.00	\$0.00	2.00	\$1,653.11	\$3,306.22	\$3,306.22
125	Remove existing Sidewalk	SY	0.00	\$0.00	\$0.00	125.00	\$3.45	\$431.25	\$431.25
126	Install 5 feet wide Sidewalk	SY	0.00	\$0.00	\$0.00	125.00	\$52.35	\$6,543.75	\$6,543.75
127	Regrade from Back of Curb to ROW	LS	0.00	\$0.00	\$0.00	1.00	\$2,500.00	\$2,500.00	\$2,500.00
128	Work Zone Pavement Markings 4" White/Solid (DBL)(Removable) Furnished - Applied & Removed	LF	0.00	\$0.00	\$0.00	500.00	\$1.75	\$875.00	\$875.00
New Item Subtotal								\$80,843.75	

Item No.	Item Description	Unit	Bid Quantity	Bid Cost	Bid Total	New Quantity	Item Price	New Item Total	Total Change in Price
Deduct									
4	Earthen Swale	LF	2472.00	\$3.78	\$9,344.16	2127.00	\$3.78	\$8,040.06	(\$1,304.10)
9	Remove and Dispose Existing Fence	LF	260.00	\$2.16	\$561.60	0.00	\$2.16	\$0.00	(\$561.60)
12	Hydrated Lime (Slurry) or Commercial Lime Slurry (3% by Dry Weight)	TON	290.00	\$171.72	\$49,798.80	219.27	\$171.72	\$37,653.04	(\$12,145.76)
14	Fly Ash for Stabilization (8% by Dry Weight)	TON	772.00	\$86.40	\$66,700.80	583.60	\$86.40	\$50,423.04	(\$16,277.76)
22	7" THICK REINFORCED CONCRE DRIVEWAY	SY	112.00	\$64.80	\$7,257.60	102.00	\$64.80	\$6,609.60	(\$648.00)
39	Work Zone Pavement Markings 24" White/Solid (Removable) Furnished- Applied & Removed	LF	24.00	\$3.24	\$77.76	0.00	\$3.24	\$0.00	(\$77.76)
40	Work Zone Pavement Markings 4" Yellow/Solid (DBL)(Removable) Furnished - Applied & Removed	LF	4913.00	\$1.13	\$5,551.69	0.00	\$1.13	\$0.00	(\$5,551.69)
41	Work Zone Pavement Markings 4" White/Solid (Removable) Furnished - Applied & Removed	LF	5366.00	\$0.54	\$2,897.64	0.00	\$0.54	\$0.00	(\$2,897.64)
49	Reflectorized Pavement Markings Type I (Thermoplastic) 6" White/Solid - Furnish & Applied	LF	560.00	\$0.76	\$425.60	0.00	\$0.76	\$0.00	(\$425.60)
50	Reflectorized Pavement Markings Type I (Thermoplastic) 12" White/Solid - Furnish & Applied	LF	80.00	\$2.43	\$194.40	0.00	\$2.43	\$0.00	(\$194.40)
52	Reflectorized Pavement Markings Type I (Thermoplastic) 12" Yellow/Solid - Furnish & Applied	LF	810.00	\$2.16	\$1,749.60	0.00	\$2.16	\$0.00	(\$1,749.60)
94	Radar Presence Detector	EA	4.00	\$6,825.00	\$27,300.00	0.00	\$6,825.00	\$0.00	(\$27,300.00)
95	Radar Advanced Detection Device	EA	2.00	\$7,140.00	\$14,280.00	0.00	\$7,140.00	\$0.00	(\$14,280.00)
109	Stabilized Construction Access (Type 1-Rock; 60% of unit cost for furnish and installation, and 40% of unit cost for removal)	SY	267.00	\$10.80	\$2,883.60	0.00	\$10.80	\$0.00	(\$2,883.60)
Deduct Subtotal									(\$86,297.51)

Change Order 02 Total	\$13,139.78
------------------------------	--------------------

FULL-SIZE (22"x34") 1" = 20' H, 1" = 2' V
 HALF-SIZE (11"x17") 1" = 40' H, 1" = 4' V

CURVE	RADIUS	LENGTH	CHORD	DELTA
C-1	1000.00'	737.35'	1071.01'	81° 1' 20.76"

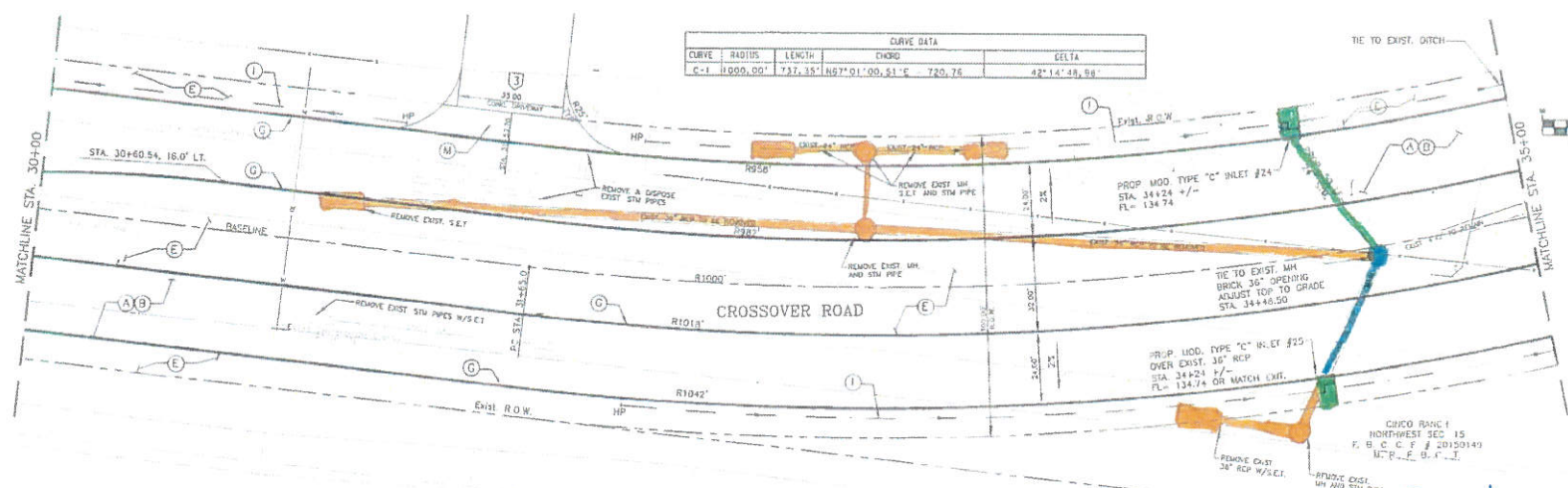

- CONSTRUCTION NOTES**
- (A) 8" CONCRETE PAVEMENT
 - (B) 8" LIME FLY-ASH SUBGRADE
 - (C) 2.5" HMAc (HOT MIXED ASPHALTIC CONC.)
 - (D) 8" BLACK BASE OVER 8" STABILIZED SUBGRADE
 - (E) HYDRO-MULCH SEEDING W/16" BLOCK SODDING BEHIND CURB
 - (F) 12" SAW CUT
 - (G) 6" CONCRETE CURB
 - (H) REMOVE AND DISPOSE EXISTING ASPHALT
 - (I) EARTHEN SWALE
 - (J) CONC. CURB RAMP (1Y) (NOT USED)
 - (K) 18" CONC. CURB & GUTTER (NOT USED)
 - (L) 4" CONC. SLOPE PAVING (INCIDENTAL)
 - (M) PROP. CONC. DRIVEWAY

- LEGEND**
- ECF EDGE OF PAVEMENT
 - BCR BEGIN CURB RETURN
 - ECR END CURB RETURN
 - MOD. MODIFIED
 - STM. STORM
 - R.O.W. RIGHT-OF-WAY

To be Removed
Proposed
To be Modified

CROSSOVER RD.

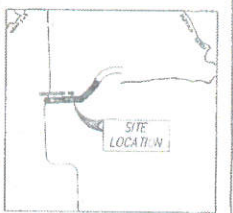
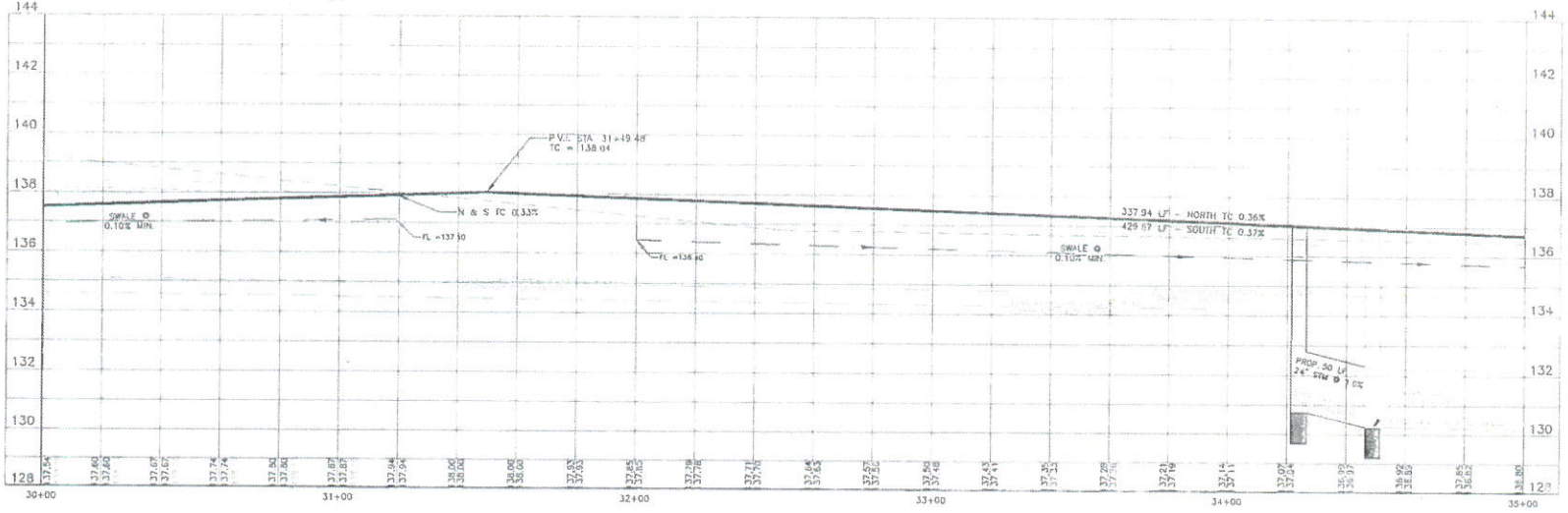

UTILITY ONE CALL

1-800-4-A-SHIELD
 1-800-4-ASHIELD
 1-800-4-ASHIELD
 1-800-4-ASHIELD

TO ADVANCE FOR LINES TO BE TURNED OFF OR MOVED, CALL CENTERPHONE AT 781.257.1222.
 PRIVATE UTILITY LINES SHOWN AS LOCATED BY PRIVATE RECORD EXAMINATION OR GROUND SURVEY. ENGINEERS CALL THE LIGHT SITE NOTIFICATION 713-221-1227

NO.	DATE	REVISIONS	BY

TRW ENGINEERS, INC.
 1072 SHANGHAI ROAD
 HOUSTON, TEXAS 77059
 PHONE: 713.284.7777
 TEXAS REGISTERED FIRM #114128

CROSSOVER ROAD IMPROVEMENT PROJECT
 FORT BEND COUNTY, TX

PLAN & PROFILE
 STA 30+00 TO
 STA 35+00



FORT BEND COUNTY
 ENGINEERING DEPARTMENT

FILE NO	
DRAWING CODE	
HORIZ :	
VERT :	
SHEET NO:	20 OF 99

K:\171002 CROSSOVER-FT. BEND\DWG\SHEETS\ROADWAY\PART7_CROSSOVER.DWG, NOV. 13, 2018-7:56am, CLAUDIO/RLWAY

K:\172902_CROSSOVER-FT. BEND\DWG_SHEETS\ROADWAY\6488_CROSSOVER.DWG 13_2018-7-25am D:\VIGRENIARY

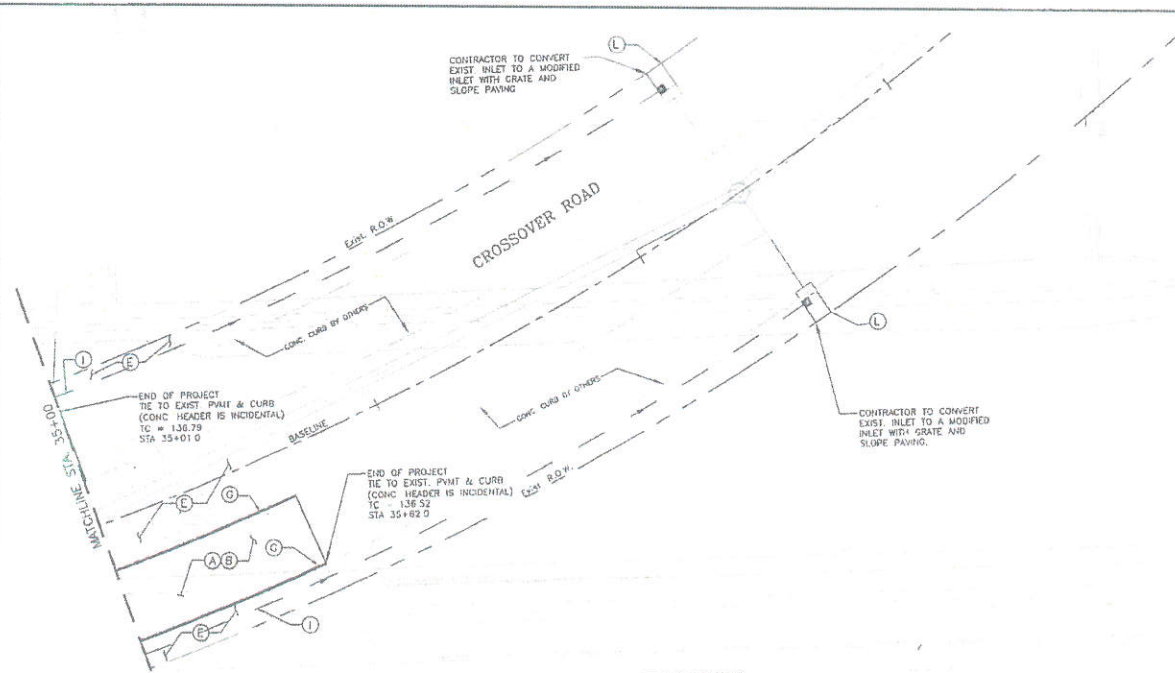

EXISTING ASPHALT TO BE REMOVED BY OTHERS

CROSSOVER RD.

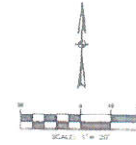
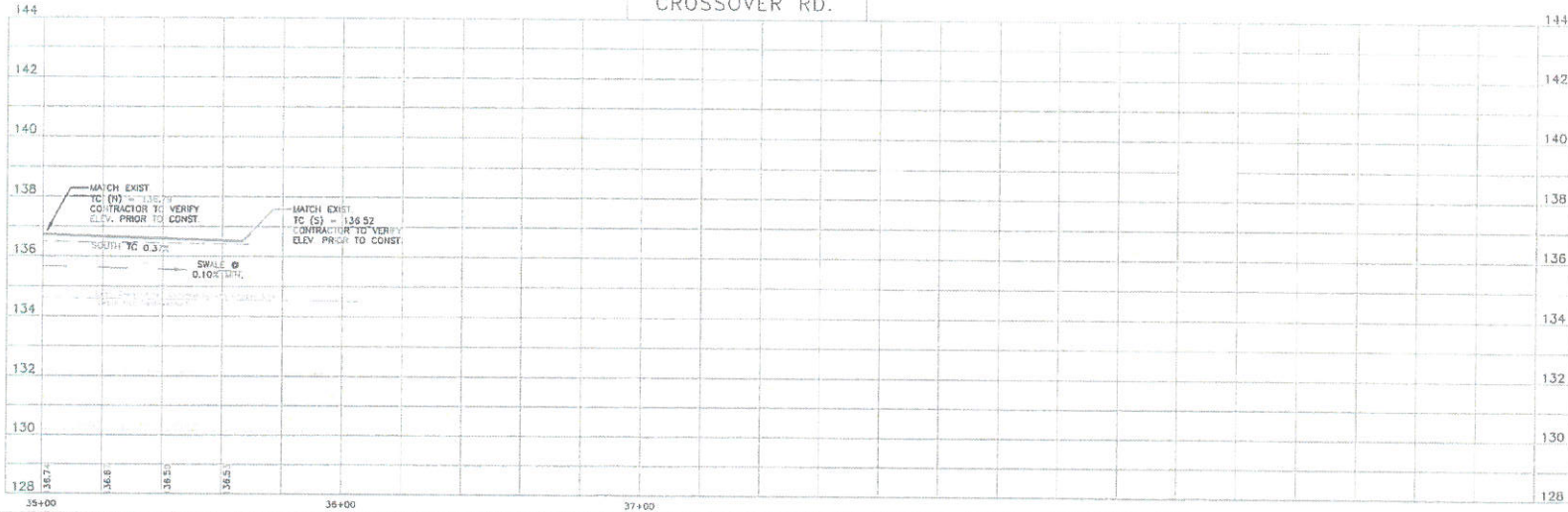

FULL-SIZE (22"X34") 1" = 20' H. 1" = 2' V
 HALF-SIZE (11"X17") 1" = 40' H. 1" = 4' V

- CONSTRUCTION NOTES**
- (A) 6" CONCRETE PAVEMENT
 - (B) 8" LIME FLY-ASH SUBGRADE
 - (C) 2.5" 11MAG (HOT MIXED ASPHALTIC CONC)
 - (D) 4" BLACK BASE OVER B" STABILIZED SUBGRADE
 - (E) HYDRO-MULCH SEEDING W/16" BLOCK SOODING BEHIND CURB
 - (F) 12" SAW CUT
 - (G) 6" CONCRETE CURB
 - (H) REMOVE AND DISPOSE EXISTING ASPHALT
 - (I) CANTHREN SWALE
 - (J) CONC CURB RAMP (TY 7) (NOT USED)
 - (K) 18" CONC CURB & GUTTER (NOT USED)
 - (L) 4" CONC. SLOPE PAVING (INCIDENTAL)

- LEGEND**
- EOP EDGE OF PAVEMENT
 - BCR BEGIN CURB RETURN
 - EGR END CURB RETURN
 - MOD MODIFIED
 - STM STORM
 - R.O.W. RIGHT-OF-WAY

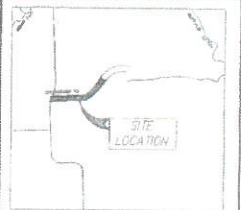

VICINITY MAP
R.T.S



TO AVOID FUR LINES TO BE TURNED OFF OR MOVED CALL
 800-451-3333
 PRIVATE UTILITY LINES SHOWN
 DO NOT EXCEED 48 HOURS BEFORE EXCAVATION IN STREET R.O.W. OR
 EXEMPTIONS CALL THE LINE 5584 NOTIFICATION 713-221-1581

NO	DATE	REVISIONS	BY

TRW ENGINEERS, INC.
 10700 SHAWLEY ROAD
 HOUSTON, TEXAS 77099
 PHONE: 713-284-1729
 TEXAS REGISTERED FIRM F-13128

CROSSOVER ROAD
 IMPROVEMENT PROJECT
 FORT BEND COUNTY, TX

PLAN & PROFILE
 STA 35+00 TO END



FORT BEND COUNTY
 ENGINEERING DEPARTMENT

FILE NO:	
DRAWING SCALE:	
HORIZ VERT:	
SHEET No:	21 of 99

CERTIFICATE OF INTERESTED PARTIES

FORM 1295

1 of 1

Complete Nos. 1 - 4 and 6 if there are interested parties.
Complete Nos. 1, 2, 3, 5, and 6 if there are no interested parties.

OFFICE USE ONLY CERTIFICATION OF FILING

1 Name of business entity filing form, and the city, state and country of the business entity's place of business.

Allgood Construction Company, Inc.
Richmond, TX United States

Certificate Number:
2019-464137

Date Filed:
03/15/2019

2 Name of governmental entity or state agency that is a party to the contract for which the form is being filed.

Fort Bend County Purchasing Department

Date Acknowledged:
04/23/2019

3 Provide the identification number used by the governmental entity or state agency to track or identify the contract, and provide a description of the services, goods, or other property to be provided under the contract.

18-070

Construction of Crossover Road Improvement Project from FM 1463 to Katy Flewellen Road (Spring Green Boulevard)- Change order No.2

4	Name of Interested Party	City, State, Country (place of business)	Nature of interest (check applicable)	
			Controlling	Intermediary

5 Check only if there is NO Interested Party.

6 UNSWORN DECLARATION

My name is _____, and my date of birth is _____.

My address is _____, _____, _____, _____, _____.
(street) (city) (state) (zip code) (country)

I declare under penalty of perjury that the foregoing is true and correct.

Executed in _____ County, State of _____, on the _____ day of _____, 20____.
(month) (year)

Signature of authorized agent of contracting business entity
(Declarant)