

PO # 166567
DMS

32R

CHANGE ORDER

FORT BEND COUNTY ENGINEERING

- Distribution:
- FBC Engineering
 - FBC Judge
 - FBC Purchasing
 - Contractor
 - Consultant

Address: 301 Jackson Street
Richmond, Texas 77469

Phone: 281-633-7500

Fax: 281-342-7366

Web site: www.FortBendCountyTx.gov

PROJECT:
Beechnut Street Pavement & Drainage
Improvements (FM1464 to Lobera Drive)

CHANGE ORDER NUMBER	1
DATE	3/05/2019
PROJECT NUMBER	13201
CONTRACT FOR	\$2,324,888.89 ✓
CONTRACT DATE	6/05/2018
FBC PURCHASE ORDER NO	166567

CONTRACTOR:
Allgood Construction Co. Inc.
1702 Settegast Ranch Rd.
Richmond, Texas 77406

The contract is changed as follows:
Add replacement of the Beechnut and Clodine Intersection including traffic control, traffic devices, and removal and replacement of approximately 1,442 SY of Reinforced Concrete Pavement.

Not valid until signed by Fort Bend County and Contractor.

The Original (Contract Sum)	\$	2,324,888.89 ✓
Net change by previously authorized Change Orders	\$	0.00
The (Contract Sum) Prior to this Change Order was	\$	2,324,888.89 ✓
The (Contract Sum) will be <input checked="" type="checkbox"/> increased or <input type="checkbox"/> decreased or <input type="checkbox"/> unchanged by this Change Order in the amount of		
	\$	174,298.40
The new (Contract Sum) including this Change Order will be	\$	2,499,187.29 ✓

The Contract Time will be increased **or** decreased **or** unchanged by 0 days.
The Date of Substantial Completion as of this Change Order therefore is
 changed **or** unchanged to 6/03/2019.

Authorized:

Fort Bend County Engineering
Stacy Slawinski, P.E.
301 Jackson
Richmond, Texas 77469

CONTRACTOR

Fort Bend County Judge
Honorable KP George
301 Jackson St., #719
Richmond, Texas 77469

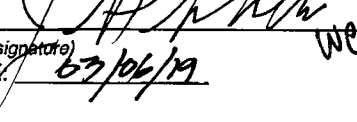
By: 
(signature) WE
DATE: 6/3/19

By: 
(signature)
DATE: 03/05/2019

By: 
(signature)
DATE: 3.26.2019



*Clodine Rd./Beechnut St.
Intersection Replacement*

ATTN:

Robert Baker

Othon Inc.,

11111 Wilcrest Dr.

Houston, TX 77042

The following described is the proposed pricing for the removal and replacement of the intersection at Beechnut St. and Clodine Rd. under the contract for FBC Mobility Project #13201.

CLODINE INTERSECTION

ITEM	DESCRIPTION	UNIT	QUANTITY	UNIT COST	TOTAL COST
1	Traffic Control and Barricades (Nighttime Closure, Barricades, Flagmen, Temp. Signage, Temp. Pavement Markings, & Plating)	EA	4.00	\$ 2,325.00	\$ 9,300.00
2	Sawcut Existing Pavement (Full Depth)	LF	500.00	\$ 10.00	\$ 5,000.00
3	Demo/Remove Existing Pavement	SY	1442.00	\$ 3.16	\$ 4,556.72
4	Roadway Excavation	CY	108.00	\$ 8.63	\$ 932.04
5	Hot Mix Asphaltic Concrete Base Course (Black-Base)	TON	78.00	\$ 138.00	\$ 10,764.00
6	11" Reinforced Concrete Pavement (7 Sack HES - Expedited Delivery)	SY	1442.00	\$ 96.66	\$ 139,383.72
7	Remove Asphaltic Base Course	SY	162.00	\$ 3.16	\$ 511.92
8	Modify Existing Inlet	EA	1.00	\$ 2,250.00	\$ 2,250.00
9	Subcontractor Trucking Expense	EA	4.00	\$ 400.00	\$ 1,600.00

\$ 174,298.40

Cameron Moore,
Project Manager

March 4, 2019

DATE: 1/29/2018 TIME: 14:53:37 PM FILE: C:\DIA-TC\3095E.dgn PROJECT: 3095 OFFICE: HDU 04-1823

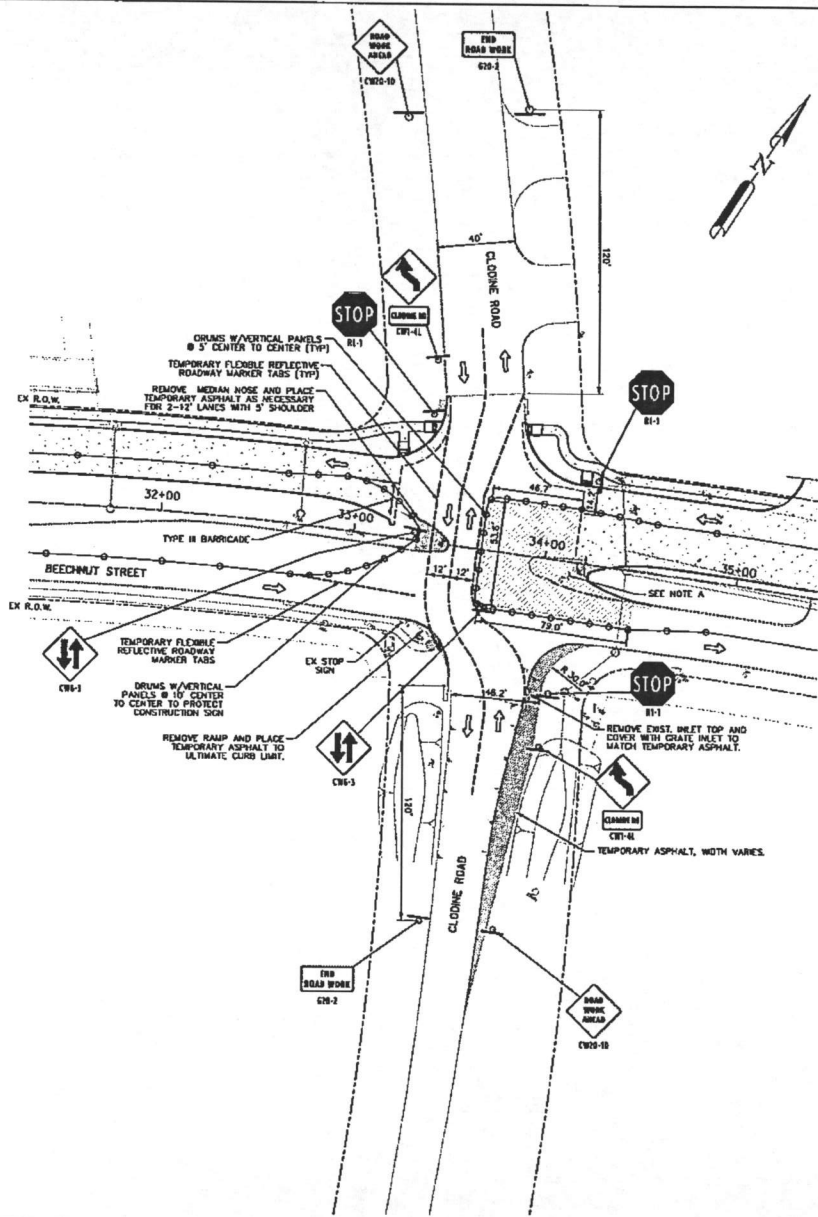

LEGEND

- PROP PAVEMENT (THIS PHASE)
- COMPLETED PAVEMENT
- TEMPORARY ASPHALT
- TYPE II BARRICADE
- CONSTRUCTION SIGN
- DIRECTION OF TRAVEL
- CTB (BARRIER)
- CHANNELIZING DEVICES

- NOTES:**
- A. PROPOSED PAVEMENT ON EAST SIDE OF CLOVINE ROAD (THIS SHEET) MUST BE CONSTRUCTED AND OPEN TO TRAFFIC PRIOR TO STARTING CONSTRUCTION ON WEST SIDE OF INTERSECTION (SHEET 65A).
 - B. THIS PORTION OF THE TOP PHASE 2 NOT DESIGNED FOR 80-40 OR LARGER VEHICLES.
 - C. TO AVOID BUS TRAFFIC DURING CONSTRUCTION, THIS INTERSECTION WORK MUST BE DONE DURING NON-PEAK HOURS (I.E. OVERNIGHT) OR ON WEEKENDS.
 - D. ALL INTERSECTION CONCRETE SHALL BE 11" FAST-TRACK PAVEMENT. TRAFFIC MUST RE-OPEN IN APPROXIMATELY 8 HOURS (WHEN MINIMUM 1800 PSI IS ACHIEVED).

No.	Date	Revisions	App.

- TRAFFIC NOTES**
1. CONTRACTOR SHALL PROVIDE AND INSTALL TRAFFIC CONTROL DEVICES IN CONFORMANCE WITH PART VIII OF TEXAS MANUAL ON UNIFORM TRAFFIC CONTROL DEVICES (LATEST EDITION WITH REVISIONS) DURING CONSTRUCTION.
 2. APPROVED COPIES OF "TRAFFIC CONTROL PLANS" SHALL BE AVAILABLE FOR INSPECTION AT ALL TIMES.
 3. CONTRACTOR SHALL REMOVE EXISTING PAVEMENT MARKINGS AND SIGNS IN CONFLICT W/TRAFFIC CONTROL PLANS.
 4. TRAFFIC LANES SHOULD ONLY BE BLOCKED ON CROSS STREETS WHEN NECESSARY TO CONSTRUCT CURB RAMPS. REFER TO CURB RAMP DETAILS SHEET.
 5. THE PROPOSED PAVEMENT LIMITS AND STATIONING SHOWN IN THE TRAFFIC CONTROL PLANS ARE APPROXIMATE. REFER TO PLAN AND PROFILE SHEETS FOR HORIZONTAL GEOMETRY DETAILS.
 6. CONTRACTOR TO COORDINATE WITH PROPERTY OWNER FOR DRYWELL CONSTRUCTION PHASING.

EXISTING STREET SPEED LIMITS

STREET NAME	SPEED LIMIT
FM 1464	50
BEECHNUT STREET (EAST OF CLOVINE RD)	35
BEECHNUT STREET (WEST OF CLOVINE RD)	30
CLOVINE ROAD	30

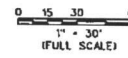

PRELIMINARY
FOR INTERIM REVIEW ONLY

THIS DOCUMENT IS UNCLASSIFIED AND IS NOT TO BE REPRODUCED OR TRANSMITTED IN ANY FORM OR BY ANY MEANS, ELECTRONIC OR MECHANICAL, INCLUDING PHOTOCOPYING, RECORDING, OR BY ANY INFORMATION STORAGE AND RETRIEVAL SYSTEM.

SURVEYED BY: HALFF ASSOCIATES, INC.



BEECHNUT STREET
PAVING AND DRAINAGE
IMPROVEMENTS

COUNTY OF FORT BEND, TX

TRAFFIC CONTROL PLAN
PHASE 2 A

SHEET 65A OF 95

SCALE: 1"=40'	DRAIN BY: INC. L.D.W.
DATE: 1/29/2018	APP. BY: MB
	COUNTY: FORT BEND

TRAFFIC SIGNING LEGEND

- S1-1
- S1-2
- S1-3
- S1-4

DATE: 1/29/2019 TIME: 11:02:13 PM FILE: C:\HD-TC\30955.DGN PROJECT: 30955 OFFICE: HOU 029283

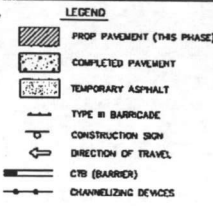
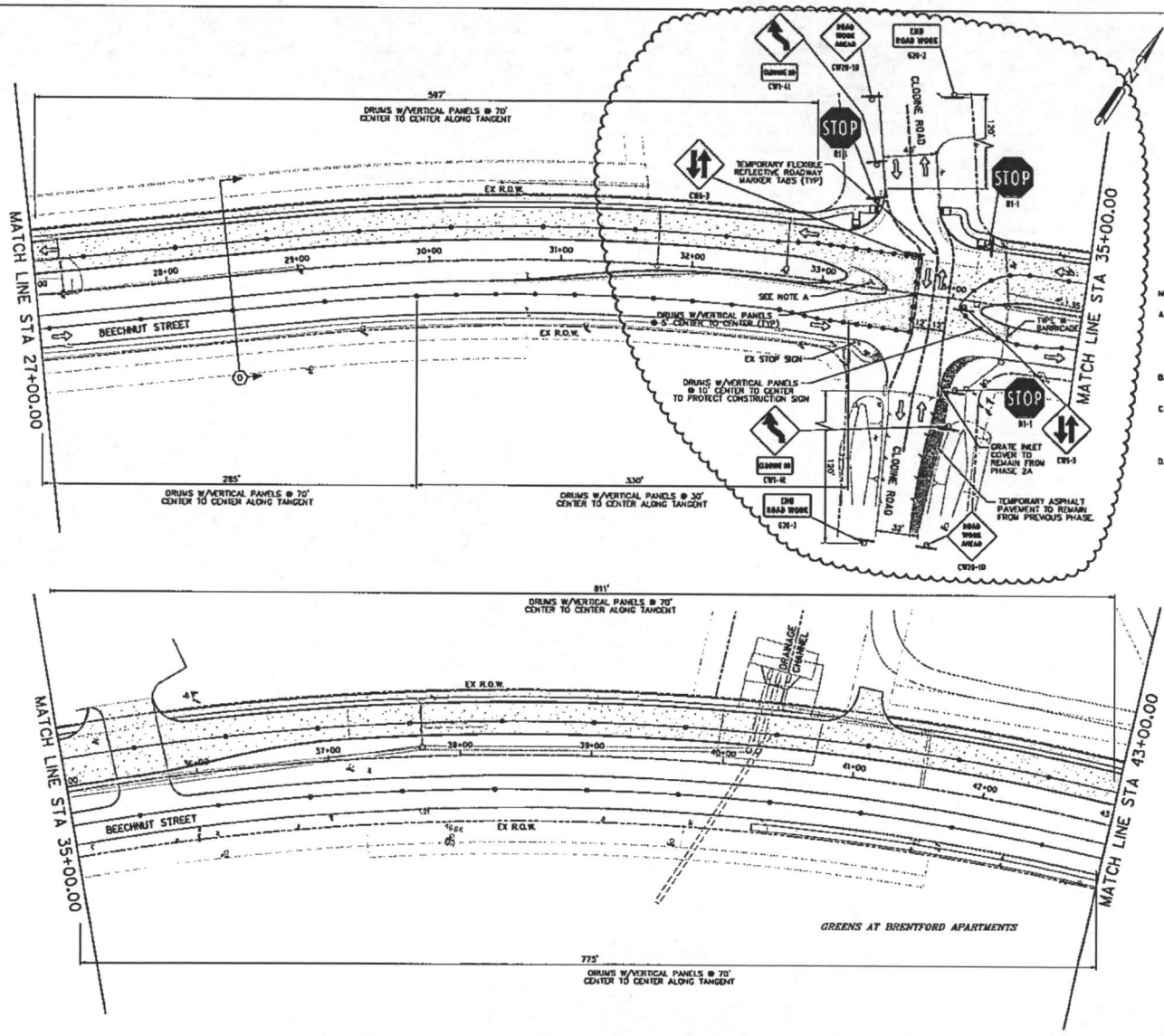

- NOTES**
- A. PROPOSED PAVEMENT ON EAST SIDE OF CLOVORNE ROAD IS SHOWN IN THIS SHEET. CONSTRUCTION AND OPEN TO TRAFFIC PRIOR TO STARTING CONSTRUCTION ON WEST SIDE OF INTERSECTION (THIS SHEET).
 - B. THIS PORTION OF THE TOP PHASE 2 NOT DESIGNED FOR 18'-10" OR LARGER VEHICLES.
 - C. TO AVOID BUS TRAFFIC DURING CONSTRUCTION, THIS INTERSECTION WORK MUST BE DONE DURING NON-PEAK HOURS (I.E. OVERNIGHT) OR ON WEEKENDS.
 - D. ALL INTERSECTION CONCRETE SHALL BE 11" FAST-TRACK PAVEMENT. TRAFFIC MUST RE-OPEN IN APPROXIMATELY 8 HOURS WHEN MINIMUM 1800 PSI IS ACHIEVED.

- TRAFFIC NOTES**
1. CONTRACTOR SHALL PROVIDE AND INSTALL TRAFFIC CONTROL DEVICES IN CONFORMANCE WITH PART VII OF TEXAS MANUAL ON UNIFORM TRAFFIC CONTROL DEVICES LATEST EDITION WITH REVISIONS DURING CONSTRUCTION.
 2. APPROVED COPIES OF TRAFFIC CONTROL PLANS SHALL BE AVAILABLE FOR INSPECTION AT ALL TIMES.
 3. CONTRACTOR SHALL REMOVE EXISTING PAYMENT MARKINGS AND SIGNS IN CONFLICT WITH TRAFFIC CONTROL PLANS.
 4. TRAFFIC LANES SHOULD ONLY BE BLOCKED ON CROSS STREETS WHEN NECESSARY TO CONSTRUCT CURB RAMP. REFER TO CURB RAMP DETAILS SHEET.
 5. THE PROPOSED PAVEMENT LIMITS AND STATIONING SHOWN IN THE TRAFFIC CONTROL PLANS ARE APPROXIMATE. REFER TO PLAN AND PROFILE SHEETS FOR HORIZONTAL GEOMETRY DETAILS.
 6. CONTRACTOR TO COORDINATE WITH PROPERTY OWNER FOR DEVERWAY CONSTRUCTION PHASING.

EXISTING STREET SPEED LIMITS

STREET NAME	SPEED LIMIT
FM 1464	50
BEECHNUT STREET (EAST OF CLOVORNE RD)	35
BEECHNUT STREET (WEST OF CLOVORNE RD)	30
CLOVORNE ROAD	30

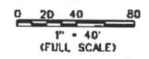

PRELIMINARY
FOR INTERIM REVIEW ONLY

SURVEYED BY:
HALFF ASSOCIATES, INC.



**BEECHNUT STREET
PAVING AND DRAINAGE
IMPROVEMENTS**
COUNTY OF FORT BEND, TX

**TRAFFIC CONTROL PLAN
PHASE 2**

SHEET 65 OF 95

SCALE: 1"=40'	DRAWN BY: MC LOW
DATE: 1/29/2019	APP. BY: MB
	COUNTY: FORT BEND

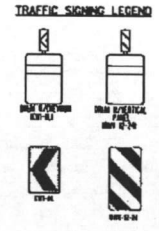

DATE: 1/23/2019
 TIME: 10:52 AM
 FILE: C:\ACT\30515.DWG
 PROJECT: 30515
 OFFICE: HOU
 SHEET: 69

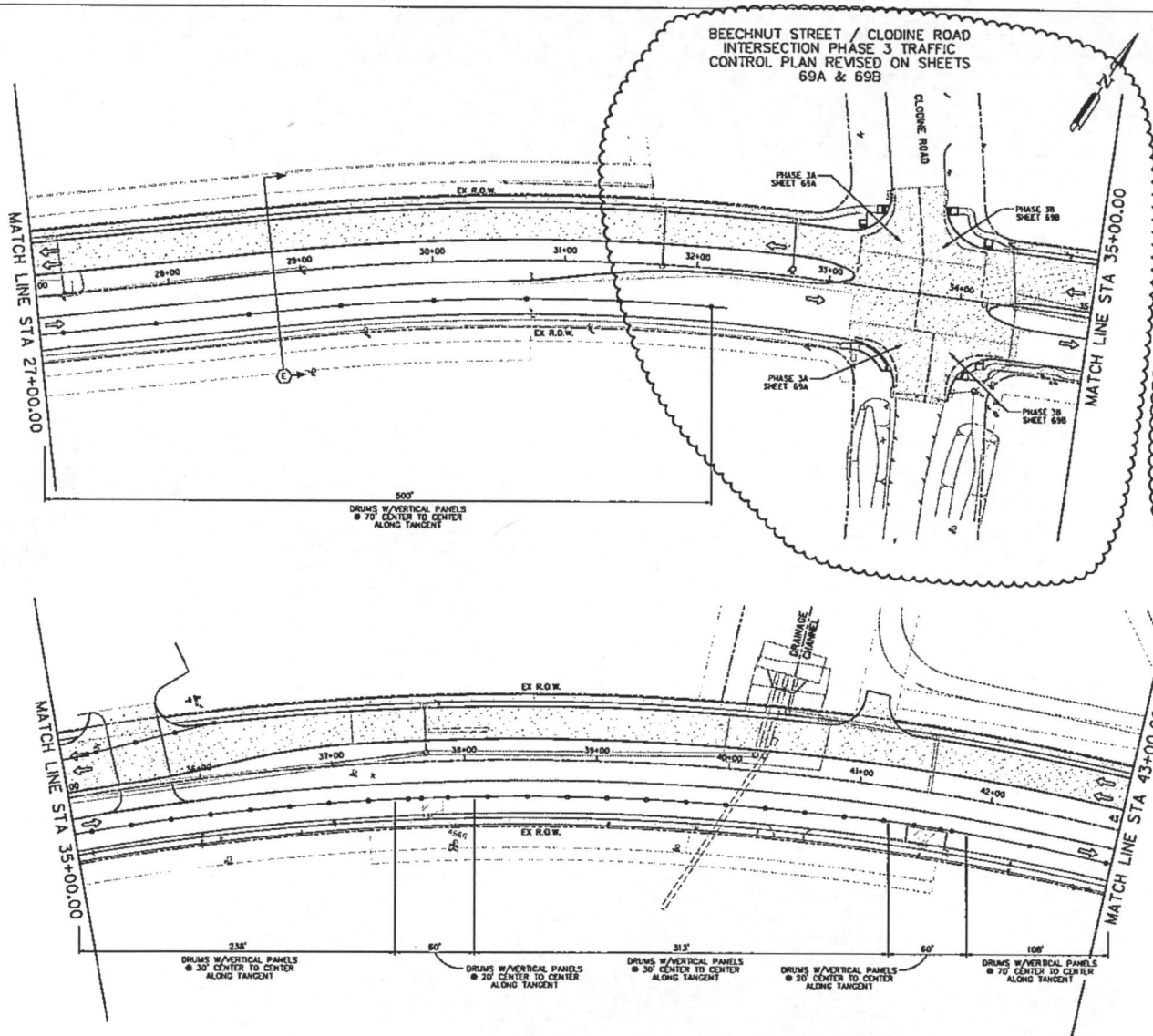

**BEECHNUT STREET / CLODINE ROAD
 INTERSECTION PHASE 3 TRAFFIC
 CONTROL PLAN REVISED ON SHEETS
 69A & 69B**

- LEGEND**
- PROPOSED PAVEMENT (THIS PHASE)
 - COMPLETED PAVEMENT
 - TEMPORARY ASPHALT
 - TYPE III BARRICADE
 - CONSTRUCTION SIGN
 - DIRECTION OF TRAVEL
 - CTB (BARRIER)
 - CHANNELIZING DEVICES

- NOTES:**
- A. PROPOSED PAVEMENT ON WEST SIDE OF CLODINE ROAD ISHEET 69A MUST BE CONSTRUCTED AND OPEN TO TRAFFIC PRIOR TO STARTING CONSTRUCTION ON EAST SIDE OF INTERSECTION (SHEET 69B).
 - B. THIS PORTION OF THE TOP PHASE 3 NOT DESIGNED FOR 18-40 OR LARGER VEHICLES.
 - C. TO AVOID BUS TRAFFIC DURING CONSTRUCTION, THIS INTERSECTION WORK MUST BE DONE DURING NON-PEAK HOURS (I.E. OVERTIME) OR ON WEEKENDS.
 - D. ALL INTERSECTION CONCRETE SHALL BE 11" FAST-TRACK PAVEMENT. TRAFFIC MUST RE-OPEN IN APPROXIMATELY 8 HOURS (WHEN MINIMUM 1800 PSI IS ACHIEVED).

No.	Date	Revisions	App.

- TRAFFIC NOTES**
1. CONTRACTOR SHALL PROVIDE AND INSTALL TRAFFIC CONTROL DEVICES IN CONFORMANCE WITH PART 1107 TEXAS MANUAL ON UNIFORM TRAFFIC CONTROL DEVICES (LATEST EDITION WITH REVISIONS) DURING CONSTRUCTION.
 2. APPROVED COPIES OF "TRAFFIC CONTROL PLANS" SHALL BE AVAILABLE FOR INSPECTION AT ALL TIMES.
 3. CONTRACTOR SHALL REMOVE EXISTING PAVEMENT MARKINGS AND SIGNS IN CONFLICT W/TRAFFIC CONTROL PLANS.
 4. TRAFFIC LANES SHOULD ONLY BE BLOCKED ON CROSS STREETS WHEN NECESSARY TO CONSTRUCT CURB RAMP. REFER TO CURB RAMP DETAILS SHEET.
 5. THE PROPOSED PAVEMENT LIMITS AND STATIONING SHOWN IN THE TRAFFIC CONTROL PLANS ARE APPROXIMATE. REFER TO PLAN AND PROFILE SHEETS FOR HORIZONTAL GEOMETRY DETAILS.
 6. CONTRACTOR TO COORDINATE WITH PROPERTY OWNER FOR DRIVEWAY CONSTRUCTION PHASING.

EXISTING STREET SPEED LIMITS

STREET NAME	SPEED LIMIT
FM 1464	50
BEECHNUT STREET (EAST OF CLODINE RD)	35
BEECHNUT STREET (WEST OF CLODINE RD)	30
CLODINE ROAD	30

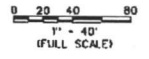

PRELIMINARY
 FOR INTERIM REVIEW ONLY

DESIGNED BY: [Signature]
 CHECKED BY: [Signature]
 SURVEYED BY: HALFF ASSOCIATES, INC.
 DATE: 1/23/2019



**BEECHNUT STREET
 PAVING AND DRAINAGE
 IMPROVEMENTS**

COUNTY OF FORT BEND, TX

**TRAFFIC CONTROL PLAN
 PHASE 3**

SHEET 69 OF 95

SCALE: 1"=40'	DRAWN BY: JC, LDW
DATE: 1/23/2019	APP. BY: JMB
	COUNTY: FORT BEND

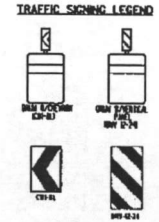

042823

OFFICE: HOU

PROJECT: 3095

FILE: 6414-TC-3095.dwg

TNG: 1/23/2019 PM

DATE: 1/23/2019

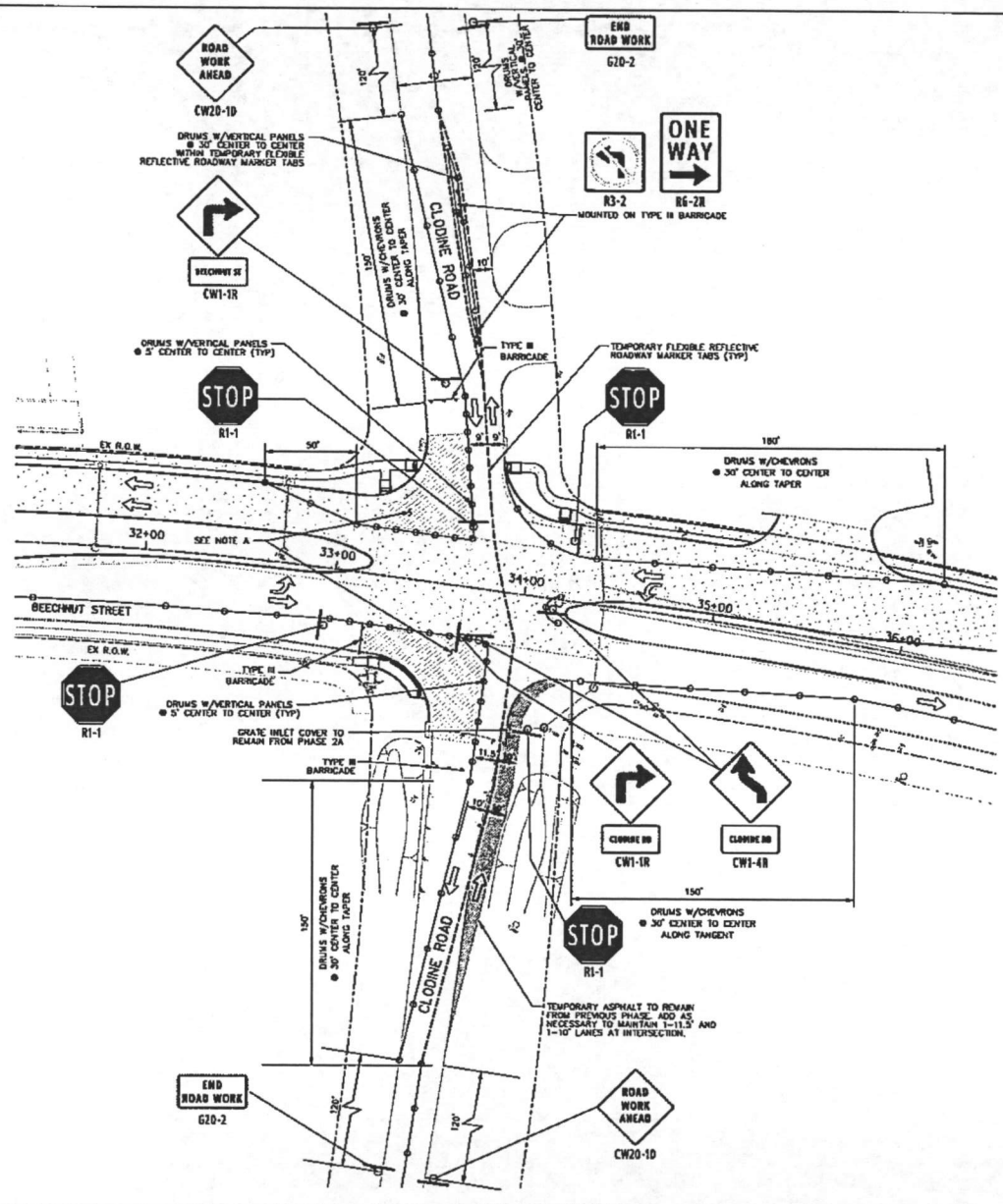

- LEGEND**
- PROP PAVEMENT (BAS PHASE)
 - COMPLETED PAVEMENT
 - TEMPORARY ASPHALT
 - TYPE III BARRICADE
 - CONSTRUCTION SIGN
 - DIRECTION OF TRAVEL
 - CTB (BARRIER)
 - CHANNELIZING DEVICES



- NOTES:**
- A. PROPOSED PAVEMENT ON WEST SIDE OF CLOODINE ROAD (THIS SHEET) MUST BE CONSTRUCTED AND OPEN TO TRAFFIC PRIOR TO STARTING CONSTRUCTION ON EAST SIDE OF INTERSECTION (SHEET 636).
 - B. THIS PORTION OF THE TYP PHASE 3 NOT DESIGNED FOR WB-40 OR LARGER VEHICLES.
 - C. TO AVOID BUS TRAFFIC DURING CONSTRUCTION, THIS INTERSECTION WORK MUST BE DONE DURING NON-PEAK HOURS (I.E. OVERNIGHT) OR ON WEEKENDS.
 - D. ALL INTERSECTION CONCRETE SHALL BE 11" FAST-TRACK PAVEMENT. TRAFFIC MUST RE-OPEN IN APPROXIMATELY 8 HOURS (TYP) UNLESS 1800 PSI IS ACHIEVED.

No.	Date	Revisions	App.

- TRAFFIC NOTES**
1. CONTRACTOR SHALL PROVIDE AND INSTALL TRAFFIC CONTROL DEVICES IN CONFORMANCE WITH PART VIII TEXAS MANUAL ON UNIFORM TRAFFIC CONTROL DEVICES (LATEST EDITION WITH REVISIONS) DURING CONSTRUCTION.
 2. APPROVED COPIES OF TRAFFIC CONTROL PLANS SHALL BE AVAILABLE FOR INSPECTION AT ALL TIMES.
 3. CONTRACTOR SHALL REMOVE EXISTING PAVEMENT MARKINGS AND SIGNS IN CONFLICT W/TRAFFIC CONTROL PLANS.
 4. TRAFFIC LANES SHOULD ONLY BE BLOCKED ON CROSS STREETS WHEN NECESSARY TO CONSTRUCT CURB RAMPS. REFER TO CURB RAMP DETAILS SHEET.
 5. THE PROPOSED PAVEMENT LIMITS AND STATIONING SHOWN IN THE TRAFFIC CONTROL PLANS ARE APPROXIMATE. REFER TO PLAN AND PROFILE SHEETS FOR HORIZONTAL GEOMETRY DETAILS.
 6. CONTRACTOR TO COORDINATE WITH PROPERTY OWNER FOR DRIVEWAY CONSTRUCTION PHASING.

EXISTING STREET SPEED LIMITS

STREET NAME	SPEED LIMIT
FM 1464	50
BEECHNUT STREET (EAST OF CLOODINE RD)	35
BEECHNUT STREET (WEST OF CLOODINE ROAD)	30
CLOODINE ROAD	30

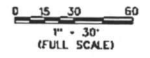

PRELIMINARY

FOR INTERIM REVIEW ONLY
THIS PRELIMINARY PLAN AND SPECIFICATIONS ARE NOT TO BE USED FOR CONSTRUCTION. THE CONTRACTOR SHALL BE RESPONSIBLE FOR VERIFYING ALL DIMENSIONS AND CONDITIONS IN THE FIELD. THE CONTRACTOR SHALL BE RESPONSIBLE FOR OBTAINING ALL NECESSARY PERMITS AND APPROVALS FROM THE APPROPRIATE AGENCIES. THE CONTRACTOR SHALL BE RESPONSIBLE FOR OBTAINING ALL NECESSARY PERMITS AND APPROVALS FROM THE APPROPRIATE AGENCIES.

SURVEYED BY:
 HALFF ASSOCIATES, INC.



**BEECHNUT STREET
 PAVING AND DRAINAGE
 IMPROVEMENTS**

COUNTY OF FORT BEND, TX

**TRAFFIC CONTROL PLAN
 PHASE 3 A**

SHEET 69A OF 95

SCALE: 1"=40'	DRAWN BY: MC, LOW
DATE: 1/23/2019	APP. BY: MB
	COUNTY: FORT BEND

00-2813

OFFICE: HOU

PROJECT: 300PS

FILE: 246B-TC-300PS.dwg

TIME: 11:24:10 PM

DATE: 1/29/2018

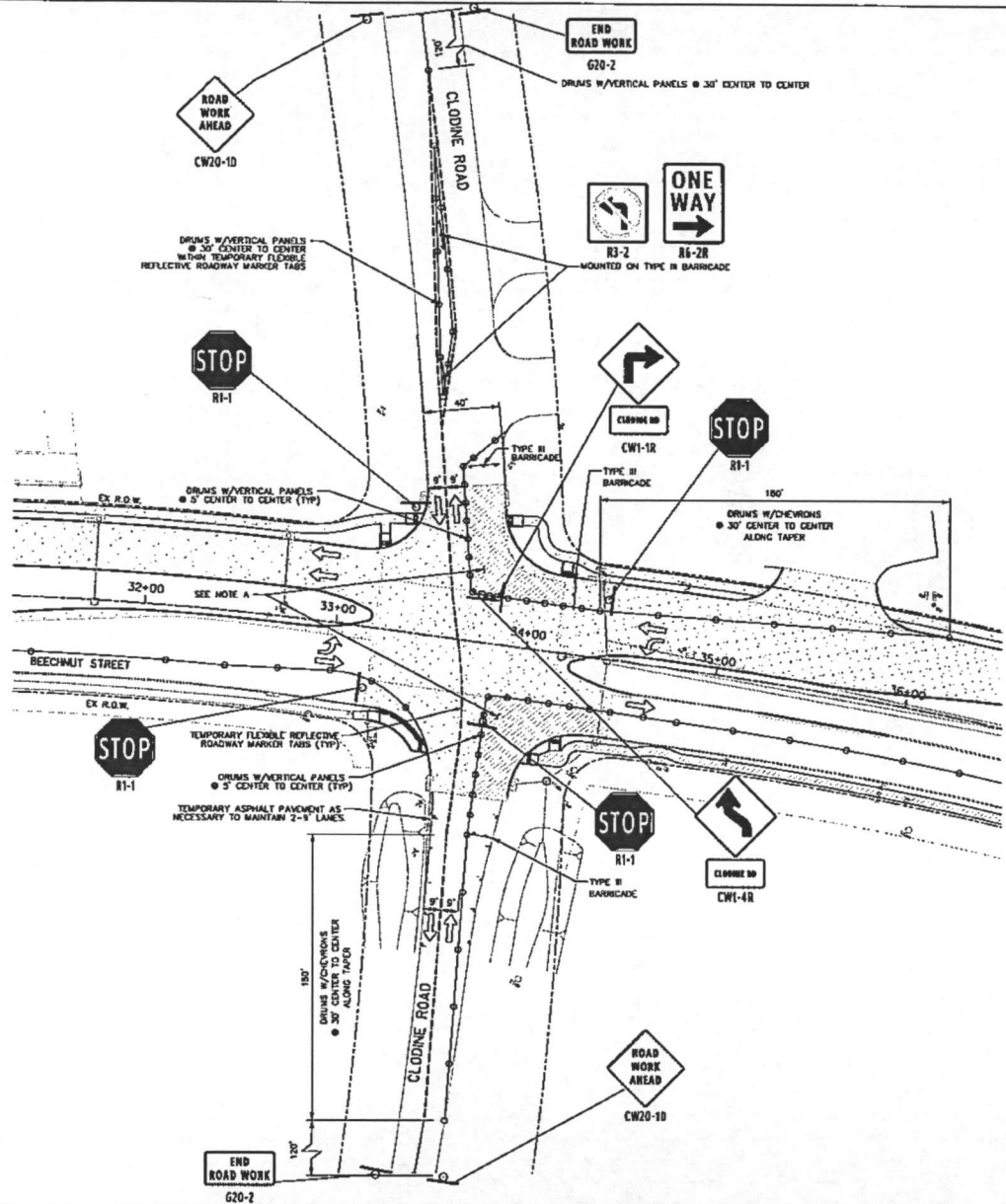

LEGEND

- PROPOSED PAVEMENT (THIS PHASE)
- COMPLETED PAVEMENT
- TEMPORARY ASPHALT
- TYPE III BARRICADE
- CONSTRUCTION SIGN
- DIRECTION OF TRAVEL
- CTB (BARRIER)
- CHANNELIZING DEVICES

No.	Date	Revisions	App.

- TRAFFIC NOTES**
- CONTRACTOR SHALL PROVIDE AND INSTALL TRAFFIC CONTROL DEVICES IN CONFORMANCE WITH PART 1107 TEXAS MANUAL ON UNIFORM TRAFFIC CONTROL DEVICES (LATEST EDITION WITH REVISIONS) DURING CONSTRUCTION.
 - APPROVED COPIES OF TRAFFIC CONTROL PLANS SHALL BE AVAILABLE FOR INSPECTION AT ALL TIMES.
 - CONTRACTOR SHALL REMOVE EXISTING PAVEMENT MARKINGS AND SIGNS IN CONFLICT W/TRAFFIC CONTROL PLANS.
 - TRAFFIC LANES SHOULD ONLY BE BLOCKED ON CROSS STREETS WHEN NECESSARY TO CONSTRUCT CURB RAMPS. REFER TO CURB RAMP DETAILS SHEET.
 - THE PROPOSED PAVEMENT LIMITS AND STATIONING SHOWN IN THE TRAFFIC CONTROL PLANS ARE APPROXIMATE. REFER TO PLAN AND PROFILE SHEETS FOR HORIZONTAL GEOMETRY DETAILS.
 - CONTRACTOR TO COORDINATE WITH PROPERTY OWNER FOR DRIVEWAY CONSTRUCTION PHASING.

- NOTES:**
- PROPOSED PAVEMENT ON WEST SIDE OF CLODINE ROAD SHEET 69A MUST BE CONSTRUCTED AND OPEN TO TRAFFIC PRIOR TO STARTING CONSTRUCTION ON EAST SIDE OF INTERSECTION (THIS SHEET).
 - THIS PORTION OF THE TOP PHASE IS NOT DESIGNED FOR RB-40 ON LARGER VEHICLES.
 - TO AVOID BUS TRAFFIC DURING CONSTRUCTION, THIS INTERSECTION WORK MUST BE DONE DURING NON-PEAK HOURS (I.E. OVERNIGHT) ON WEEKENDS.
 - ALL INTERSECTION CONCRETE SHALL BE 11' FAST-TRACK PAVEMENT, TRAFFIC MUST RE-OPEN IN APPROXIMATELY 8 HOURS UNLESS MINIMUM 1800 PSI IS ACHIEVED.

EXISTING STREET SPEED LIMITS

STREET NAME	SPEED LIMIT
FM 1484	50
BEECHNUT STREET EAST OF CLODINE RD	35
BEECHNUT STREET WEST OF CLODINE RD	30
CLODINE ROAD	30

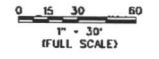

PRELIMINARY
FOR INTERNAL REVIEW ONLY

DESIGNED BY: *[Signature]*
DATE: 1/29/2018

SURVEYED BY: HALFF ASSOCIATES, INC.
DATE: 1/29/2018



BEECHNUT STREET PAVING AND DRAINAGE IMPROVEMENTS
COUNTY OF FORT BEND, TX

TRAFFIC CONTROL PLAN PHASE 3 B

SHEET 69B OF 95

SCALE: 1"=40'	DRAWN BY: NC, LDW
DATE: 1/29/2018	APP. BY: MB
	COUNTY: FORT BEND

TRAFFIC SIGNING LEGEND

- ROAD WORK AHEAD (W1-42)
- ROAD WORK AHEAD (W1-43)
- STOP (R1-1)
- ONE WAY (R1-2R)
- CLODINE RD (CW1-1R)
- CLODINE RD (CW1-4R)

CERTIFICATE OF INTERESTED PARTIES

FORM 1295

1 of 1

Complete Nos. 1 - 4 and 6 if there are interested parties.
 Complete Nos. 1, 2, 3, 5, and 6 if there are no interested parties.

OFFICE USE ONLY CERTIFICATION OF FILING

1 Name of business entity filing form, and the city, state and country of the business entity's place of business.

Allgood Construction Company, Inc.
 Richmond, TX United States

Certificate Number:
 2019-460177

Date Filed:
 03/05/2019

2 Name of governmental entity or state agency that is a party to the contract for which the form is being filed.

Fort Bend County Purchasing Department

Date Acknowledged:
 03/26/2019

3 Provide the identification number used by the governmental entity or state agency to track or identify the contract, and provide a description of the services, goods, or other property to be provided under the contract.

18-063
 Construction of Beechnut Street Pavement and Drainage Improvements From FM 1464 to Lobera Drive (Change Order No.1)

4	Name of Interested Party	City, State, Country (place of business)	Nature of interest (check applicable)	
			Controlling	Intermediary

5 Check only if there is NO Interested Party.

6 UNSWORN DECLARATION

My name is _____, and my date of birth is _____.

My address is _____, _____, _____, _____, _____.
(street) (city) (state) (zip code) (country)

I declare under penalty of perjury that the foregoing is true and correct.

Executed in _____ County, State of _____, on the _____ day of _____, 20____.
(month) (year)

 Signature of authorized agent of contracting business entity
 (Declarant)