

STANDARD UTILITY AGREEMENT

U-0026: **Comcast**
 County: Fort Bend
 Highway: FM 1093 Westpark Extension Phase II

This Agreement by and between the County of Fort Bend, Texas, ("**County**"), and Comcast, ("**Utility**"), acting by and through its duly authorized representative, shall be effective on the date of approval and execution by and on behalf of the **County**.

WHEREAS, the **County** has deemed it necessary to make certain highway improvements as designated by the **County** and approved by the Federal Highway Administration within the limits of the highway as indicated above;

WHEREAS, the proposed highway improvements will necessitate the adjustment, removal, and/or relocation of certain facilities of **Utility** as indicated in the following statement of work: relocation of assets (underground fiber optic cable and overhead lines) into a predetermined corridor according to the following schedule :

Start Date – 04/13/2018
 Completion Date – 07/13/2018

and more specifically shown in **Utility's** Plans and Specifications, Estimated Costs, and Schedule which are attached hereto as Exhibits "A," "B" and "C."

WHEREAS, Subchapter E of Chapter 203 of the Texas Transportation Code regarding the relocation of utilities does not apply to this Project, but the County wishes to negotiate in good faith and enter into agreements with all affected utility companies for the participation in the costs of the adjustment, removal, and/or relocation of certain facilities as authorized under such subchapter.

WHEREAS, the **County**, upon receipt of evidence it deems sufficient, acknowledges **Utility's** interest in certain lands and/or facilities and determined it is appropriate to enter an agreement with **Utility** to govern the terms for participation in the costs of the adjustment, removal, and relocation of certain of its facilities located upon the lands as indicated in the statement of work above.

NOW, THEREFORE, BE IT AGREED:

The **County** will pay to **Utility** fifty percent (50%) of the documented actual costs incurred for relocation of the utility in adjustment, removal, and/or relocation of **Utility's** facilities up to the amount said costs may be eligible for **County** participation.

All conduct under this agreement, including but not limited to the adjustment, removal and relocation of the facility, the development and reimbursement of costs, any environmental requirements, and retention of records will be in accordance with all applicable federal and state laws, rules and regulations, including, without limitation, the Federal Uniform Relocation Assistance and Real Property Acquisition Policies Act, 42 U.S.C. §§ 4601, et seq., the National Environmental Policy Act, 42 U.S.C. §§ 4231, et seq., the Buy America provisions of 23 U.S.C. § 313 and 23 CFR 635.410, the Utility Relocations, Adjustments, and Reimbursements provisions of 23 CFR 645, Subpart A, and with the Utility Accommodation provisions of 23 CFR 645, Subpart B. **Utility** shall supply, upon request by the **County**, proof of compliance with the aforementioned laws, rules and regulations prior to the commencement of construction.

The **Utility** agrees to develop relocation or adjustment costs by accumulating actual direct and related indirect costs in accordance with a work order accounting procedure prescribed by **County**, or may, with the **County's** approval, accumulate actual direct and related indirect costs in accordance with an established accounting procedure developed by **Utility**. Bills for work hereunder will be submitted to **County** not later than 90 days after completion of the work.

 9/17/18
 Date
 Fort Bend County

 6/28/18
 Initial Date
 Comcast

When requested, the **County** will make intermediate payments at not less than monthly intervals to **Utility** when properly billed and such payments will not exceed 90 percent (90%) of the eligible cost as shown in each such billing. Intermediate payments shall not be construed as final payment for any items included in the intermediate payment.

Upon execution of this agreement by both parties hereto, the **County** will, by written notice, authorize the **Utility** to perform such work diligently, and to conclude said adjustment, removal, or relocation by the stated completion date. The completion date shall be extended for delays caused by events outside **Utility's** control, including an event of Force Majeure, which shall include a strike, war or act of war (whether an actual declaration of war is made or not), insurrection, riot, act of public enemy, accident, fire, flood or other act of God, sabotage, or other events, interference by the **County** or any other party with **Utility's** ability to proceed with the relocation, or any other event in which **Utility** has exercised all due care in the prevention thereof so that the causes or other events are beyond the control and without the fault or negligence of **Utility**.

However, for any failure by **Utility** to conclude said adjustment, removal, or relocation by the stated completion date not caused by events outside **Utility's** control, the **County** may elect to: (1) reduce the reimbursement to **Utility** by one percent (1%) each day delayed; or (2) relocate the facility at the sole cost and expense of **Utility**.

The **County** will, upon satisfactory completion of the relocation or adjustment and upon receipt of final billing prepared in an approved form and manner, make payment in the amount of 90 percent (90%) of the eligible costs as shown in the final billing prior to audit and after such audit shall make an additional final payment totaling the reimbursement amount found eligible for **County** reimbursement.

Unless an item below is stricken and initialed by the **County** and **Utility**, this agreement in its entirety consists of the following:

1. Standard Utility Agreement;
2. Plans & Specifications (Attachment "A");
3. Utility Construction Cost Estimate (Attachment "B");
4. Utility's Schedule of Work and Estimated Date of Completion (Attachment "C").

All attachments are included herein as if fully set forth. In the event it is determined that a substantial change from the statement of work contained in this agreement is required, reimbursement therefore shall be limited to costs covered by a modification or amendment of this agreement or a written change or extra work order approved by the **County** and **Utility**.

This agreement is subject to cancellation by the **County** at any time up to the date that work under this agreement has been authorized and that such cancellation will not create any liability on the part of the **County**. However, the **County** will review and reimburse the **Utility** for eligible costs incurred by the **Utility** in preparation of this Agreement.

The **Utility** acknowledges to and for the benefit of the **County** and State of Texas that it understands the project under this Agreement is eligible for Federal-aid highway funds and as such, requires all of the iron, steel, and manufactured goods used in the project be produced in the United States ("Buy American Requirements") including iron, steel, and manufactured goods provided by the **Utility** pursuant to this Agreement.

The State Auditor may conduct an audit or investigation of any entity receiving funds from the **County** directly under this contract or indirectly through a subcontract under this contract. Acceptance of funds directly under this contract or indirectly through a subcontract under this contract acts as acceptance of the authority of the State Auditor, under the direction of the Legislative Audit Committee, to conduct an audit or investigation in connection with those funds. An entity that is the subject of an audit or investigation must provide the state auditor with access to any information the state auditor considers relevant to the investigation or audit.

The **Utility** by execution of this agreement does not waive any of the rights which **Utility** may have within the limits of the law.

Date 9/17/18
Fort Bend County

Date 6/28/18
Comcast

It is expressly understood that the **Utility** conducts the adjustment, removal, or relocation at its own risk, and that Fort Bend County, Texas makes no warranties or representations regarding the existence or location of utilities currently within its right of way.

The signatories to this agreement warrant that each has the authority to enter into this agreement on behalf of the party represented.

UTILITY

Utility: Comcast
Name of Utility

By: 
Authorized Signature

Shawn Sunderman
Print or Type Name

Title: Director of Construction

Date: 6/28/18

 9/17/18
Date
Fort Bend County

 6/28/18
Initial Date
Comcast

EXECUTION RECOMMENDED:

COUNTY

By:

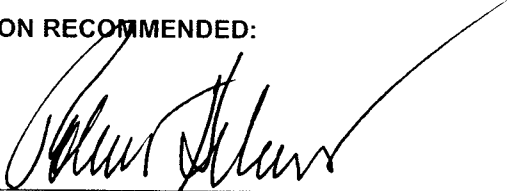

Robert E. Hebert, County Judge

Date:

9-25-2018

ATTEST:

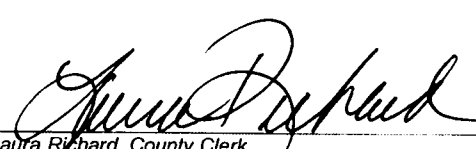
By:

Laura Richard, County Clerk

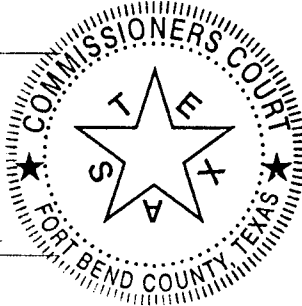

APPROVED:

By:

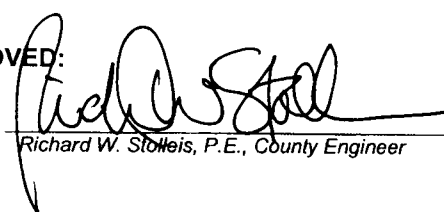
Richard W. Stolleis, P.E., County Engineer

APPROVED AS TO LEGAL FORM:

By:



Marcus D. Spencer, First Assistant County Attorney

AUDITOR'S CERTIFICATE

I hereby certify that funds are available in the amount of \$229,432.75 to accomplish and pay the obligation of Fort Bend County under this contract.

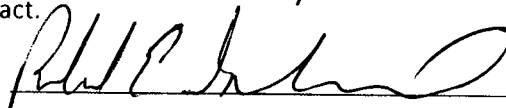
Robert Ed Sturdivant, County Auditor



 9/17/18
Date
Fort Bend County



 6/28/18
Initial Date
Comcast

Exhibit A

Plans & Specifications

(14 Pages that Follow)

 9/17/14
Date
Fort Bend County

 6/28/15
Date
Comcast

DRAWN BY: CM	SCALE: N. Y. S.
CHECKED BY: JCM	
APPROVED BY: WDK	
SHEET: 1 OF	

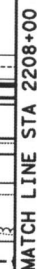
$$\frac{1}{2}x^2 + bx + \frac{1}{2}b^2$$

***NOTE:**

EXISTING COMCAST FACILITY LOCATIONS ARE APPROXIMATE BASED ON RECORD DRAWINGS. EXISTING DEPTH INFORMATION NOT AVAILABLE. COMCAST CONTRACTOR SHALL VERIFY EXACT LOCATION PRIOR TO START OF CONSTRUCTION.

PROPOSED CENTERPOINT POLES (BY OTHERS LOCATIONS ARE APPROXIMATE. COMCAST CONTRACTOR SHALL COORDINATE WITH CENTERPOINT ENERGY ELECTRIC PRIOR TO START OF CONSTRUCTION FOR FINAL POLE LOCATIONS. AERIAL CABLES SHALL BE INSTALLED PER TEXAS ADMINISTRATIVE CODE (TAC) REQUIREMENTS.

COMCAST FACILITIES (THIS SHEET):

AERIAL FIBER OPTIC CABLE
EXISTING: 900 LF (1-72, 2-48)
PROPOSED: 824 LF (1-72, 2-48)

UNDERGROUND FIBER OPTIC CABLE
EXISTING: N/A
PROPOSED: N/A

UNDERGROUND 2- 2" DUCTS
EXISTING: N/A
PROPOSED: N/A

SPLICE POINT/ SLACK LOOP
EXISTING: N/A
PROPOSED: N/A

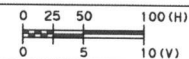

Doug Krause 03-16-18

REV NO	DESCRIPTION	APP'D	DATE
--------	-------------	-------	------



Jier, LLC Firm Registration No 9397

**RELOCATION DESIGN FOR
PROP. FM 1093
WESTPARK EXTENSION PHASE II-A**

DRAWN BY: CM	SCALE: HORIZ: 1"=100'
CHECKED BY: JCM	VERT: 1"=10'
APPROVED BY: WOK	SHEET: 2 OF 14

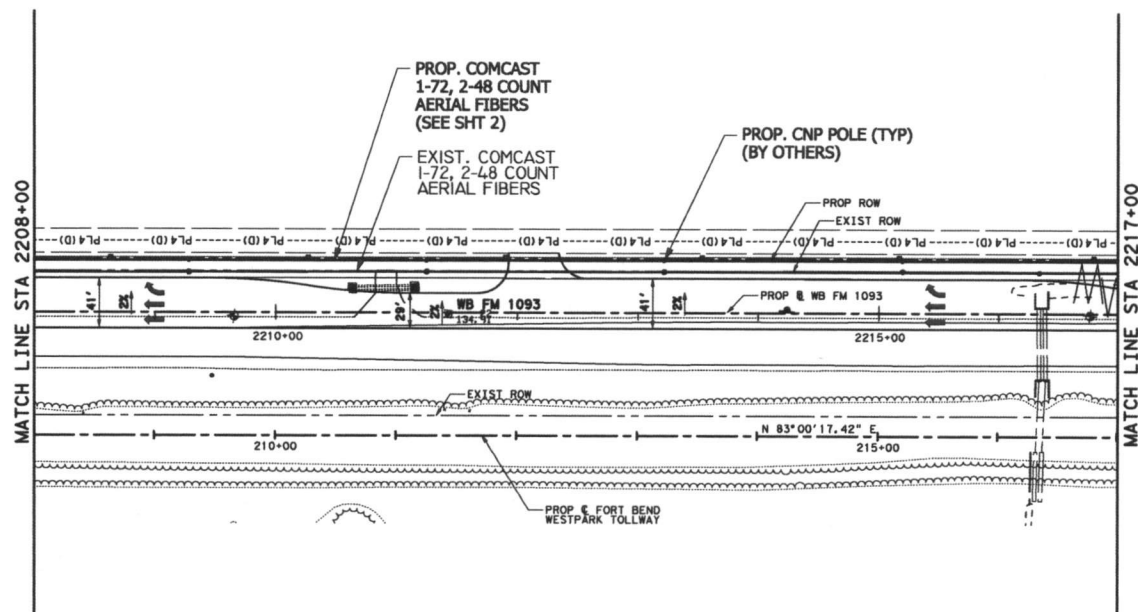

NOTE:

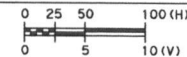

Doug Krause 03-16-18

REV	DESCRIPTION	APP'D	DATE



Jier, LLC Firm Registration No 9397

**RELOCATION DESIGN FOR
PROP. FM 1093
WESTPARK EXTENSION PHASE II-A**

DRAWN BY: CM	SCALE: HORIZ: 1"=10'
CHECKED BY: JCM	VERT: 1"=10'
APPROVED BY: WDK	SHEET: 1 OF 14

FILE: J:\Projects\03-2210-12-1540-Westpark Tollway Extension Phase II-A\Comcast\03-2210-12-1540-Westpark Tollway Extension Phase II-A\Comcast.dwg, 3/12/2008 10:46:18 AM
T:\007\p07.dwg

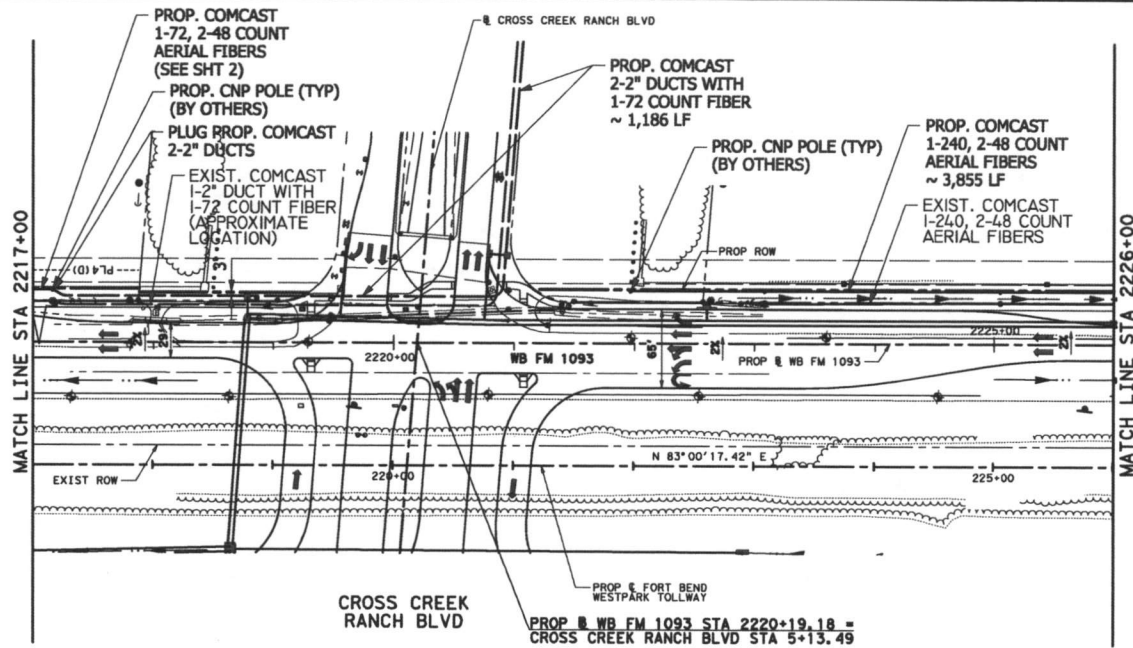

***NOTE:**
EXISTING COMCAST FACILITY LOCATIONS ARE APPROXIMATE BASED ON RECORD DRAWINGS. EXISTING DEPTH INFORMATION NOT AVAILABLE. COMCAST CONTRACTOR SHALL VERIFY EXACT LOCATION PRIOR TO START OF CONSTRUCTION.
PROPOSED CENTERPOINT POLES (BY OTHERS) LOCATIONS ARE APPROXIMATE. COMCAST CONTRACTOR SHALL COORDINATE WITH CENTERPOINT ENERGY ELECTRIC PRIOR TO START OF CONSTRUCTION FOR FINAL POLE LOCATIONS. AERIAL CABLES SHALL BE INSTALLED PER TEXAS ADMINISTRATIVE CODE (TAC) REQUIREMENTS.

COMCAST FACILITIES (THIS SHEET):
AERIAL FIBER OPTIC CABLE
EXISTING: 16LF (72, 2-48), 403LF (240, 2-48)
PROPOSED: 16LF (72, 2-48), 403LF (240, 2-48)
UNDERGROUND FIBER OPTIC CABLE
EXISTING: 1186 LF (1-72)
PROPOSED: 1186 LF (1-72)
UNDERGROUND 2- 2" DUCTS
EXISTING: 1186 LF EA
PROPOSED: 1186 LF EA
SPlice POINT/ SLACK LOOP
EXISTING: N/A
PROPOSED: STA 2217+16 (100 LF (1-72))

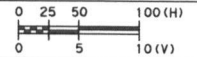

REV NO	DESCRIPTION	APP'D	DATE

Comcast

Jier, LLC Firm Registration No 9397

**RELOCATION DESIGN FOR
PROP. FM 1093
WESTPARK EXTENSION PHASE II-A**

DRAWN BY: CM
CHECKED BY: JCM
APPROVED BY: JCM
SCALE: HORIZ: 1"=100'
VERT: 1"=10'
SHEET 4 OF 13

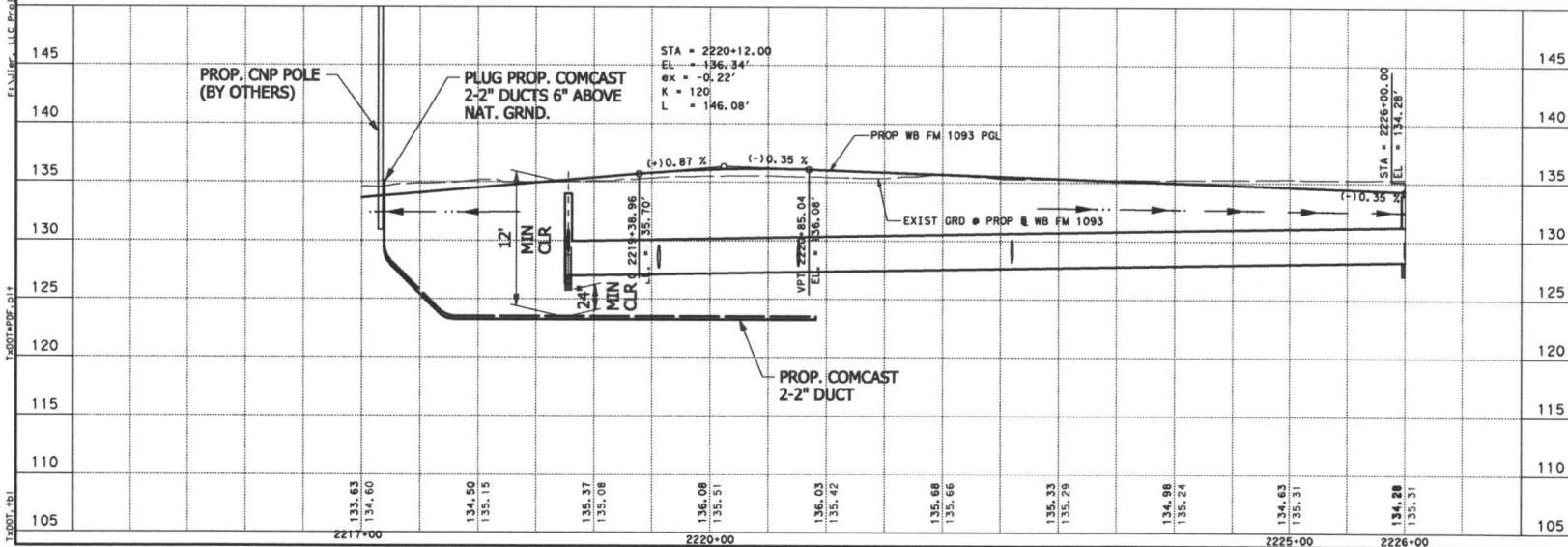

PLAN: Jier, LLC Project 003, 2210+02, 1560 Westpark Tollway Extension (Phase II) CAD Phase II-AV-Comcast-APP04.dgn, 3/15/2018 09:18:00
TODOT.tbl
TODOT.dwg

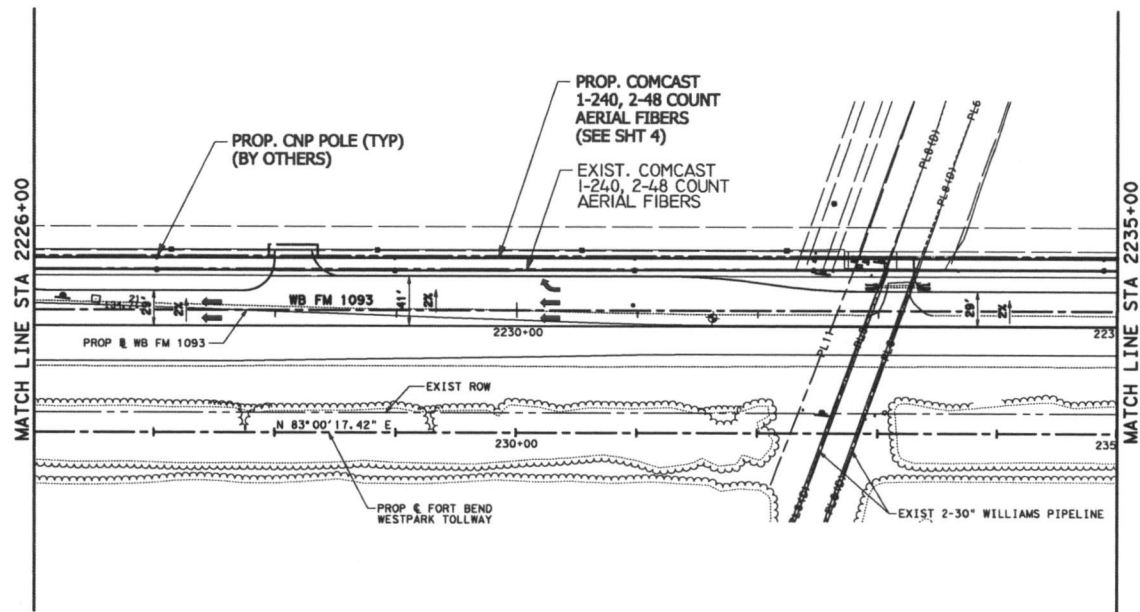

NOTE:

EXISTING COMCAST FACILITY LOCATIONS ARE APPROXIMATE BASED ON RECORD DRAWINGS. EXISTING DEPTH INFORMATION NOT AVAILABLE. COMCAST CONTRACTOR SHALL VERIFY EXACT LOCATION PRIOR TO START OF CONSTRUCTION.

PROPOSED CENTERPOINT POLES (BY OTHERS) LOCATIONS ARE APPROXIMATE. COMCAST CONTRACTOR SHALL COORDINATE WITH CENTERPOINT ENERGY ELECTRIC PRIOR TO START OF CONSTRUCTION FOR FINAL POLE LOCATIONS. AERIAL CABLES SHALL BE INSTALLED PER TEXAS ADMINISTRATIVE CODE (TAC) REQUIREMENTS.

COMCAST FACILITIES (THIS SHEET):

AERIAL FIBER OPTIC CABLE
EXISTING: 900 LF (1-240, 2-48)
PROPOSED: 900 LF (1-240, 2-48)

UNDERGROUND FIBER OPTIC CABLE
EXISTING: N/A
PROPOSED: N/A

UNDERGROUND 2- 2" DUCTS
EXISTING: N/A
PROPOSED: N/A

SPlice POINT/ SLACK LOOP
EXISTING: N/A
PROPOSED: N/A

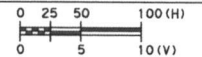

Doug Krause 03-16-18

REV NO	DESCRIPTION	APP'D	DATE
--------	-------------	-------	------

Comcast

Jier, LLC Firm Registration No 9397

RELOCATION DESIGN FOR
PROP. FM 1093
WESTPARK EXTENSION PHASE II-A

DRAWN BY: CM	SCALE: HORIZ: 1"=100'
CHECKED BY: JCM	VERT: 1"=10'
APPROVED BY: JCM	SHEET 3 OF 14

PROFILE INTENTIONALLY BLANK

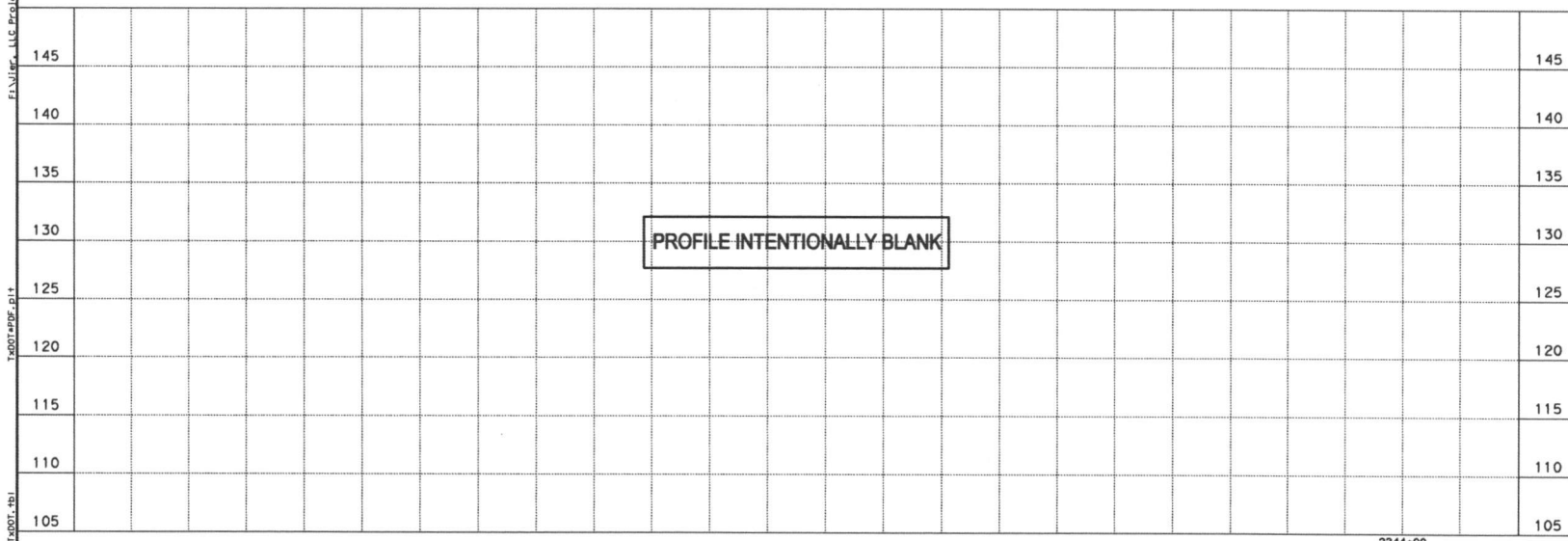
$\mathbf{f} \times \mathbf{DOT}, +b!$ 

DRAWN BY: CM	SCALE: HORIZ: 1"=10'
CHECKED BY: JCM	VERT: 1"=10'
APPROVED BY: WOK	SHEET: 6 OF 14

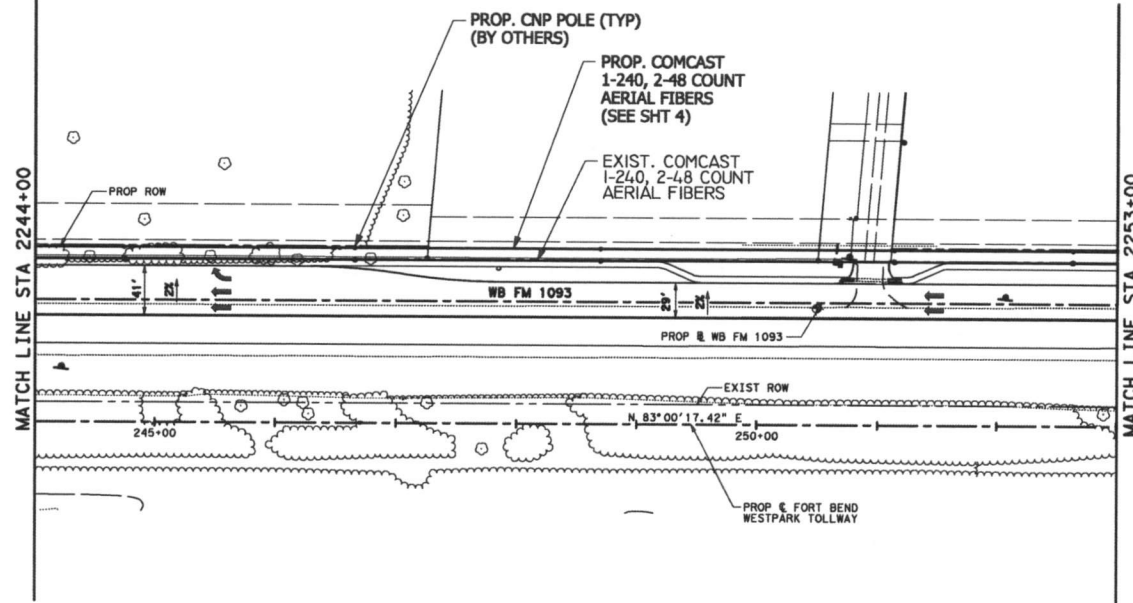

***NOTE:**

PROFILE INTENTIONALLY BLANK

2244+00

2253+00

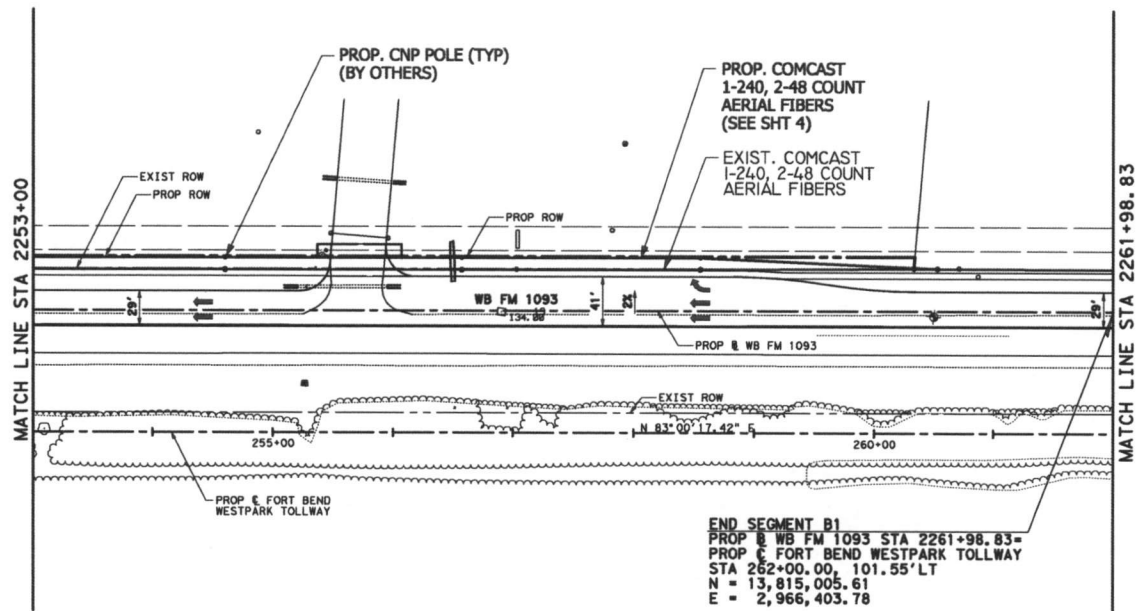

***NOTE:**

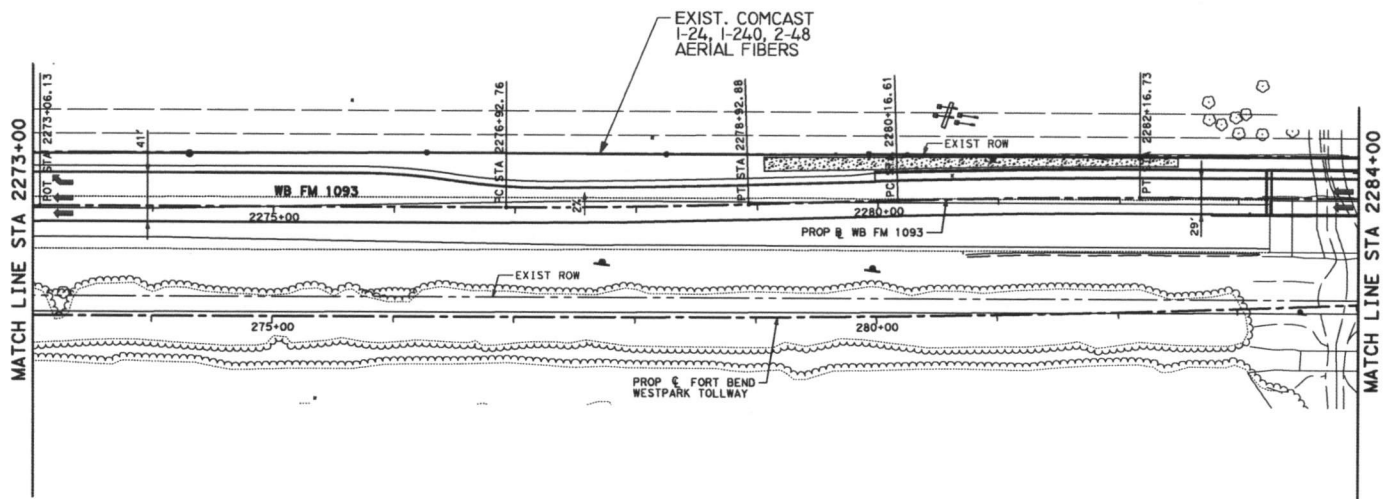

NOTE:

FLUJER, LLC Project: 003, 2210+02, 150+ Westpark Tollway Extension (Phase II) CAD Phase II - A/C Comcast+PPI 10, 000, 3/15/2009 RBB/MB/KS/DOH

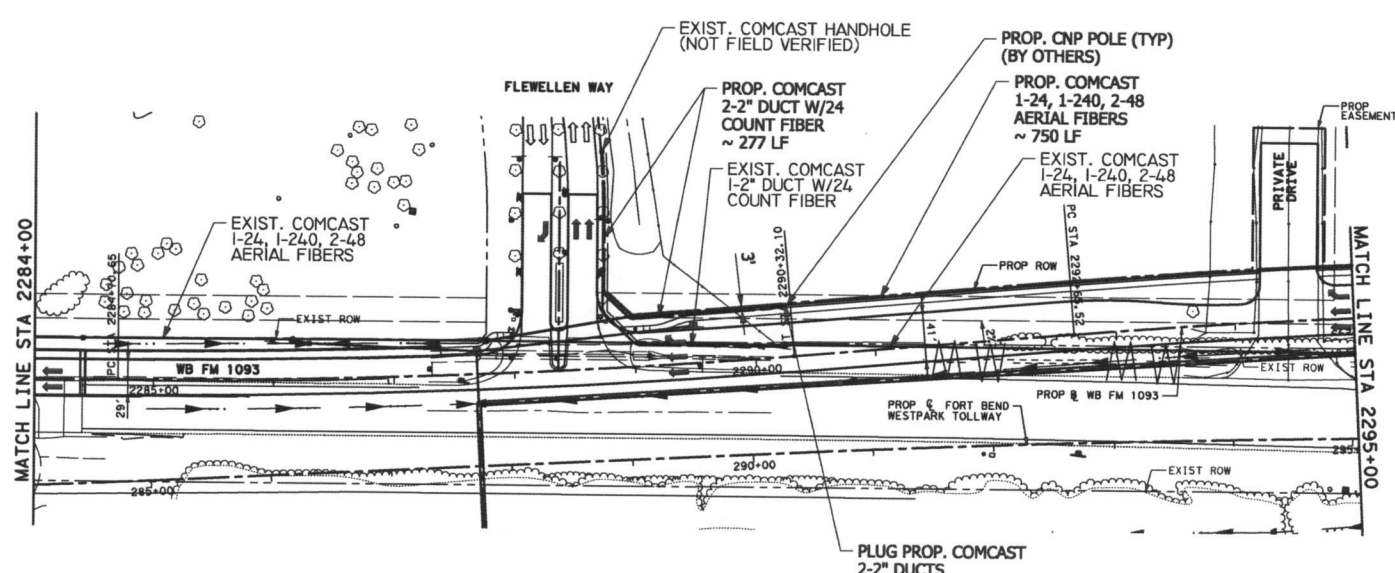

***NOTE:**
EXISTING COMCAST FACILITY LOCATIONS ARE APPROXIMATE BASED ON RECORD DRAWINGS. EXISTING DEPTH INFORMATION NOT AVAILABLE. COMCAST CONTRACTOR SHALL VERIFY EXACT LOCATION PRIOR TO START OF CONSTRUCTION.
PROPOSED CENTERPOINT POLES (BY OTHERS) LOCATIONS ARE APPROXIMATE. COMCAST CONTRACTOR SHALL COORDINATE WITH CENTERPOINT ENERGY ELECTRIC PRIOR TO START OF CONSTRUCTION FOR FINAL POLE LOCATIONS. AERIAL CABLES SHALL BE INSTALLED PER TEXAS ADMINISTRATIVE CODE (TAC) REQUIREMENTS.

COMCAST FACILITIES (THIS SHEET):
AERIAL FIBER OPTIC CABLE
EXISTING: 1100 LF (24, 240, 2-48)
PROPOSED: 724 LF (24, 240, 2-48)
UNDERGROUND FIBER OPTIC CABLE
EXISTING: 277 LF (24)
PROPOSED: 277 LF (24)
UNDERGROUND 2-2\"/>



Doug Krause 03-16-18

REV NO	DESCRIPTION	APP'D	DATE
--------	-------------	-------	------



Jier, LLC Firm Registration No. 9397

**RELOCATION DESIGN FOR
PROP. FM 1093
WESTPARK EXTENSION PHASE II-A**

DRAWN BY: CM SCALE: HORIZ: 1\"/>

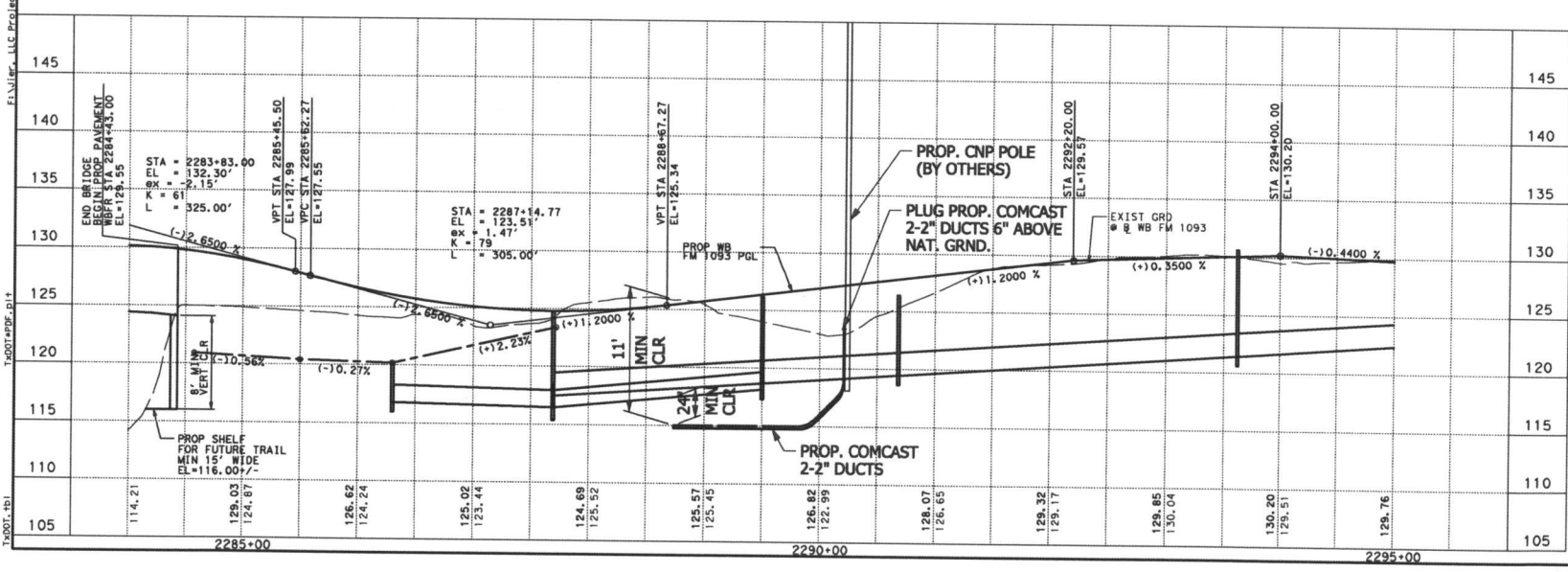

FL:\Jier, LLC\Projects\003\2310\2310-150-Westpark Tollway Extension (Phase II)\CADD\Phase II-A\Comcast\app12.dgn 3/15/2006 10:41:18 AM

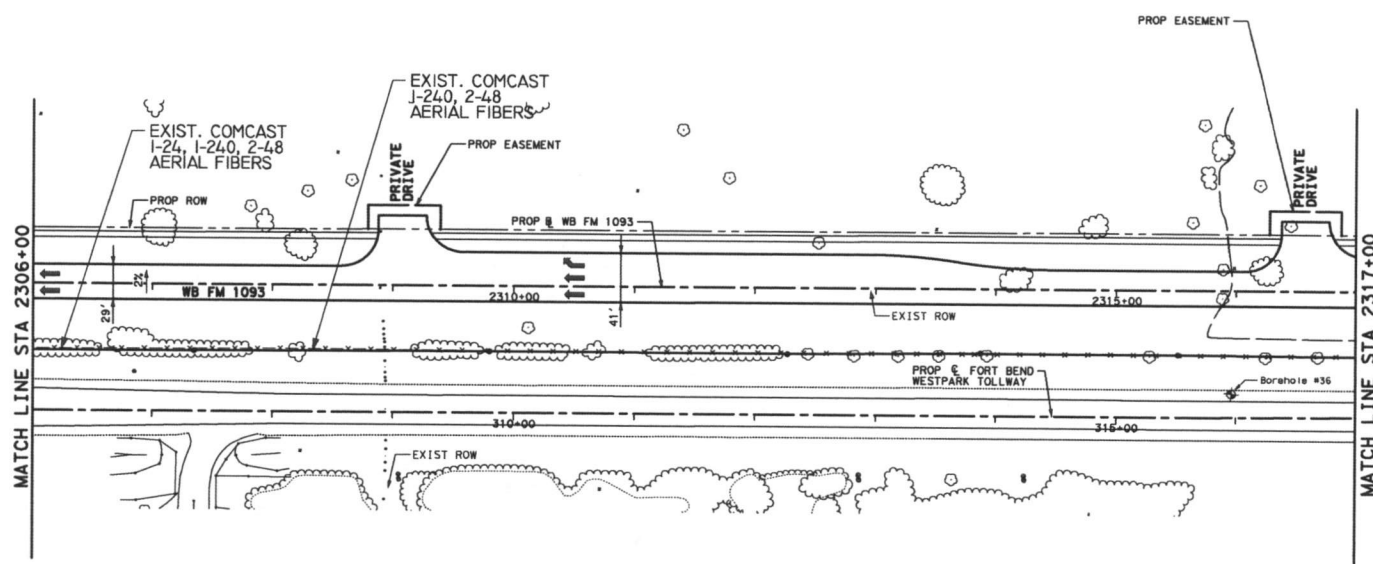

NOTE:
EXISTING COMCAST FACILITY LOCATIONS ARE APPROXIMATE BASED ON RECORD DRAWINGS. EXISTING DEPTH INFORMATION NOT AVAILABLE. COMCAST CONTRACTOR SHALL VERIFY EXACT LOCATION PRIOR TO START OF CONSTRUCTION.

PROPOSED CENTERPOINT POLES (BY OTHERS) LOCATIONS ARE APPROXIMATE. COMCAST CONTRACTOR SHALL COORDINATE WITH CENTERPOINT ENERGY ELECTRIC PRIOR TO START OF CONSTRUCTION FOR FINAL POLE LOCATIONS. AERIAL CABLES SHALL BE INSTALLED PER TEXAS ADMINISTRATIVE CODE (TAC) REQUIREMENTS.

COMCAST FACILITIES (THIS SHEET):

AERIAL FIBER OPTIC CABLE
EXISTING: 1100 LF (24, 240, 2-48)
PROPOSED: N/A

UNDERGROUND FIBER OPTIC CABLE
EXISTING: N/A
PROPOSED: N/A

UNDERGROUND 2- 2' DUCTS
EXISTING: N/A
PROPOSED: N/A

SPLICE POINT/ SLACK LOOP
EXISTING: N/A
PROPOSED: N/A

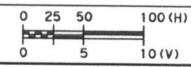

Doug Krause 03-16-18

REV	NO	DESCRIPTION	APP'D	DATE



Jier, LLC Firm Registration No. 8997

**RELOCATION DESIGN FOR
PROP. FM 1093
WESTPARK EXTENSION PHASE II-A**

DRAWN BY: CM
CHECKED BY: JCM
APPROVED BY: JCM
SCALE: HORIZ: 1"=100'
VERT: 1"=10'
DATE: 12-06-18

PROFILE INTENTIONALLY BLANK

FL:\Jier, LLC Projects\003_2210+00_1560+Westpark Tollway Extension Phase II\A-C\comcast\p13.dgn 3/15/2018 10:46:18 AM

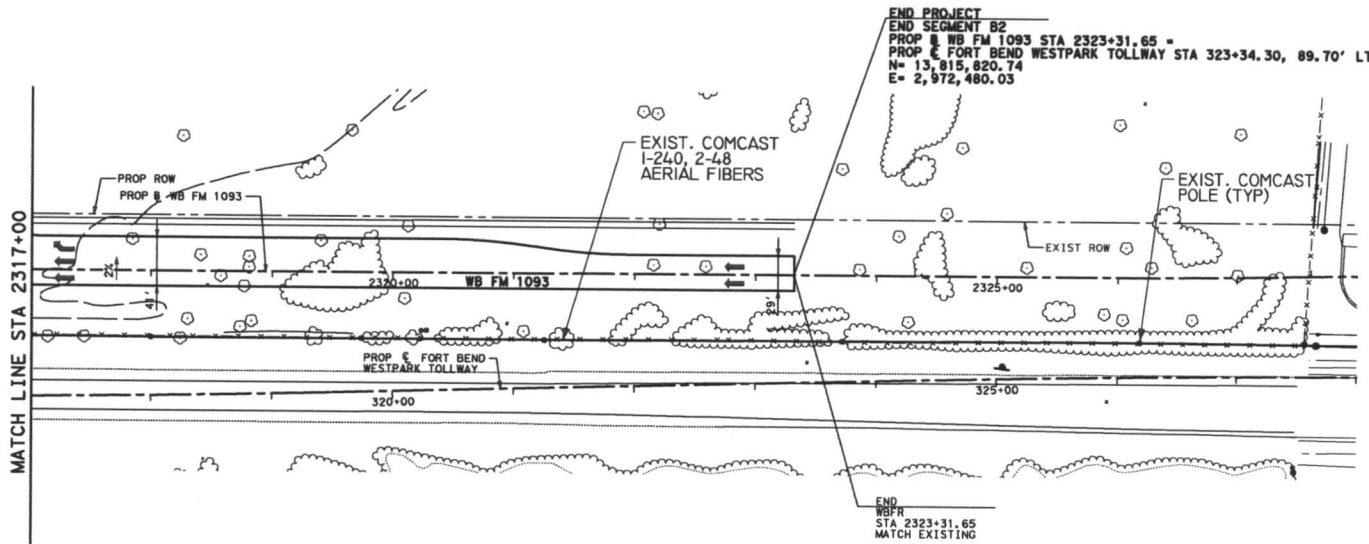

NOTE:

EXISTING COMCAST FACILITY LOCATIONS ARE APPROXIMATE BASED ON RECORD DRAWINGS. EXISTING DEPTH INFORMATION NOT AVAILABLE. COMCAST CONTRACTOR SHALL VERIFY EXACT LOCATION PRIOR TO START OF CONSTRUCTION.

PROPOSED CENTERPOINT POLES (BY OTHERS) LOCATIONS ARE APPROXIMATE. COMCAST CONTRACTOR SHALL COORDINATE WITH CENTERPOINT ENERGY ELECTRIC PRIOR TO START OF CONSTRUCTION FOR FINAL POLE LOCATIONS. AERIAL CABLES SHALL BE INSTALLED PER TEXAS ADMINISTRATIVE CODE (TAC) REQUIREMENTS.

COMCAST FACILITIES (THIS SHEET):

AERIAL FIBER OPTIC CABLE
EXISTING: 632 LF (240, 2-48)
PROPOSED: N/A

UNDERGROUND FIBER OPTIC CABLE
EXISTING: N/A
PROPOSED: N/A

UNDERGROUND 2- 2" DUCTS
EXISTING: N/A
PROPOSED: N/A

SPLICE POINT/ SLACK LOOP
EXISTING: N/A
PROPOSED: N/A

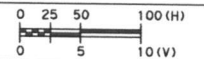

Doug Krause 03-16-18

REV NO	DESCRIPTION	APP'D	DATE
--------	-------------	-------	------

Comcast

Jier, LLC Firm Registration No 9397

RELOCATION DESIGN FOR
PROP. FM 1093
WESTPARK EXTENSION PHASE II-A

DRAWN BY: JCH
CHECKED BY: JCH
APPROVED BY: JCH
SCALE: HORIZ: 1"=100'
VERT: 1"=10'
SHEET: 14 OF 14

PROFILE INTENTIONALLY BLANK

Exhibit B

\$458,865.49
Construction Cost Estimate

(6 Pages That Follow)

 9/17/18
Date
Fort Bend County

 6/28/18
Initial Date
Comcast

Prepared by
 Supervisor Name
 System Name
 Project ID
 Resource Category
 Activity ID
 Job Name
 Oracle Job Number
 Joint Trench? (Enter yes or no)
 Functional Area Number (FA#)
 Estimated Start Date
 Estimated Completion Date

Margie Blackwell
 Scott Westerman
 Houston
 N/A
 Relo
 Westpark Phase II
 No
 ASAP
 ASAP

Total Aerial Cost	\$143,208.87
Total UG Cost	\$171,721.42
Total Job Cost	\$458,865.49

		Contract Labor	Material	In House Labor	Total
Design - Aerial	A00				\$0.00
Design - U/G	U00		\$0.00		\$0.00
Material Allowed Variance 0%	A01		\$0.00		\$0.00
Make Ready - U/G	U01		\$0.00		\$0.00
Strand, Hardware, Peds - Aerial	A02	\$16,489.20	\$4,641.17		\$21,130.37
Strand, Hardware, Peds - U/G	U02	\$0.00	\$322.67		\$322.67
Fiber Cable - Aerial	A07		\$19,825.50		\$19,825.50
Fiber Cable - U/G (No Materials)	U07	\$146,616.12			\$146,616.12
Coax Cable - Aerial	A05	\$11,588.20	\$0.00		\$11,588.20
Coax Cable - U/G	U05		\$0.00		\$0.00
RF Elect./Conn - Aerial	A03	\$0.00	\$118.50		\$118.50
RF Elect./Conn - U/G	U03	\$0.00	\$6,549.60		\$6,549.60
Fiber Electronics - Aerial	A04	\$89,463.80	\$1,082.50		\$90,546.30
Fiber Electronics - U/G	U04	\$4,317.35	\$13,915.68		\$18,233.03
Standby Power (U03)	STDBY	\$0.00	\$0.00		\$0.00
In-House Cap Labor	CAP			\$16,335.20	\$16,335.20
Engineering & Design Cost	MISC	\$0.00		\$127,600.00	\$127,600.00
Total Dollars	\$	\$268,474.67	\$46,455.62	\$143,935.20	\$458,865.49

Approval Signatures	Title	Date
	Project Coordinator	
	Support Supervisor	
	Construction Manager	
	Director of Construction	
	V.P. Engineering	
	Project Analyst	

COMCAST CABLE ORIGINAL LABOR - REVISED 03/10/2010

Project ID
Activity ID
Job Name

N/A

Margie Blackwell

0

Westpark Phase II

		Qty	Cost	Ext Cost	Res
U001	HAND DIG 24"		\$ 2.85	\$ -	SC
U002	HAND DIG 36"	400	\$ 3.17	\$ 1,268.00	U05
U008	DIRECTIONAL BORING PULLING 1 - 4" PIPE MAXIMUM DEPTH 5'		\$ 35.00	\$ -	U05
U008	DIRECTIONAL BORING PULLING 2 PIPES OR 1 PIPE DEEPER THAN 5'	1,493	\$ 95.00	\$ 138,985.00	U05
U010	R & R ASPHALT		\$ 15.00	\$ -	U05
U011	RODDING AND ROPING		\$ 0.69	\$ -	U05
U012	DIG-UP	6	\$ 125.00	\$ 750.00	U05
U015	PLACE COAX IN NEW CONDUIT		\$ 0.50	\$ -	U05
U016	PLACE COAX IN EXISTING CONDUIT		\$ 0.55	\$ -	U05
U017	NEW SPLICING AND ACTIVATION U/G		\$ 0.35	\$ -	U05
U018	STANDBY POWER SUPPLY WITH BATTERIES		\$ 1,350.00	\$ -	U03
U019	WRECK OUT POWER SUPPLY WITH RESTORATION		\$ 125.00	\$ -	U03
U020	PLACE PEDESTALS TAP, SPLITTER, DC		\$ 7.45	\$ -	U02
U021	PLACE PEDESTALS LE, FNB, AMP		\$ 18.75	\$ -	U02
U022	PLACE PEDESTALS NODE		\$ 71.30	\$ -	U02
U023	SET PULL BOX		\$ 12.40	\$ -	U02
U024	SET 24x36x24 VAULTS		\$ 141.60	\$ -	U02
U025	SET 30x48x36 Poly Concrete VAULTS	6	\$ 310.52	\$ 1,863.12	U05
U030	COMPOSITE TRENCH 36"		\$ 2.90	\$ -	U05
U031	PULL LOCATE WIRE		\$ 0.47	\$ -	U05
U032	COMPOSITE UNDERGROUND SPAN REPLACEMENT		\$ 2.65	\$ -	U05
UNDERGROUND TOTAL				\$ 142,866.12	

2 00

Aerial Construction

A001	STRAND	22,285	\$ 0.30	\$ 6,685.50	A02
A002	CABLE (S) - INCLUDES THE INSTALLATION OF EXPRESS AND/OR FEEDER		\$ 0.52	\$ -	A05
A003	ADDITIONAL CABLE - INSTALLATION OF CABLE IN EXCESS OF 3 CABLES		\$ 0.07	\$ -	A05
A004	OVERLASH CABLE		\$ 0.43	\$ -	A05
A005	EACH ADDITIONAL OVERLASH CABLE IN EXCESS OF TWO		\$ 0.07	\$ -	A05
A006	DELASH / RELASH	22,285	\$ 0.52	\$ 11,588.20	A05
A007	TREE TRIMMING		\$ 0.35	\$ -	A02
A008	WRECK OUT & DISPOSAL	22,285	\$ 0.30	\$ 6,685.50	A02
A009	NEW SPLICING & ACTIVATION AERIAL		\$ 0.55	\$ -	A05
A010	POLE TRANSFER	25	\$ 29.00	\$ 725.00	A02
A011	INSTALL 8M DOWN GUY	11	\$ 15.16	\$ 166.76	A02
A012	DOWN GUY REMOVAL (ALL SIZES)	11	\$ 15.00	\$ 165.00	A02
A013	PLACE OVERHEAD GUY (ALL SIZES)		\$ 22.39	\$ -	A02
A014	REMOVE AND REPLACE GUY GUARD		\$ 15.00	\$ -	A02
A015	PLACE BOND NOT INCLUDED		\$ 3.90	\$ -	A02
A016	PLACE VERTICAL GROUND & MOLDING (DIRT)		\$ 25.50	\$ -	A02
A017	PLACE VERTICAL GROUND & MOLDING (CONCRETE)		\$ 36.30	\$ -	A02
A018	REMOVE AND REPLACE U-GUARD		\$ 22.00	\$ -	A02
A019	RESAG CABLE		\$ 0.22	\$ -	A02
A020	PLACE TREE GUARD		\$ 6.25	\$ -	A02
A021	SIDEWALK GUY		\$ 21.55	\$ -	A02
A022	INSTALL ANCHOR	11	\$ 22.00	\$ 242.00	A02
A023	INSTALL DOWN GUY WITH GUARD	11	\$ 17.50	\$ 192.50	A02
A024	INSTALL EXTENSION ARM OR STANDOFF		\$ 13.50	\$ -	A02
A025	INSTALL RISER & RISER GUARD (WOOD POLE)	12	\$ 29.72	\$ 356.64	A02
A026	INSTALL RISER & RISER GUARD (CONCRETE POLE)		\$ 28.60	\$ -	A02
A027	RESAG STRAND	2,258	\$ 0.35	\$ 790.30	A02
A028	RISER TRANSFER TO NEW POLES	4	\$ 75.00	\$ 300.00	A02
A029	WRECK OUT ANCHOR & DOWN GUY	8	\$ 22.50	\$ 180.00	A02
A030	TOP WOODEN POLE		\$ 29.00	\$ -	A02
A031	SET POLE CLASS 3 POLES		\$ 350.00	\$ -	A02
	DROP WIRE WORK		\$ 12.44	\$ -	A02
A032	MAKE DROP ATTACHMENT AT MID SPAN		\$ 20.00	\$ -	A02
A033	MAKE DROP ATTACHMENT AT POLE		\$ 10.00	\$ -	A02
A034	RESAG DROP WIRE (PER)		\$ 5.00	\$ -	A02
A035	RELOCATE DROP AT THE POLE		\$ 8.32	\$ -	A02
A036	POLE PROFILE		\$ 5.00	\$ -	A02
AERIAL TOTAL				\$ 28,077.40	

Margie Blackwell

		Qty	Cost	Ext Cost	Res
4 00	Fiber Placement				SC
F001	LASH FIBER TO BARE STRAND - LASH UP TO TWO FIBER CABLES AND TAG	22,285	\$ 0.68	\$ 15,153.80	A04
F002	EACH ADDITIONAL FIBER ON NEW STRAND	7,485	\$ 0.20		
F003	OVERLASH FIBER UP TO TWO FIBER CABLES		\$ 0.56	\$ -	A04
F004	EACH ADDITIONAL OVERLASH FIBER		\$ 0.15	\$ -	A04
F005	SPLICE FIBER (PER FUSION)	2,352	\$ 30.00	\$ 70,560.00	A04
F006	SPLICE FIBER (PER MASS BURN 12 FIBER)		\$ 135.00	\$ -	A04
F007	FIBER MID ENTRY		\$ 140.30	\$ -	U04
F008	RE-ENTER SPLICE ENCLOSURE		\$ 136.55	\$ -	U04
F009	LASH STORAGE LOOPS AERIAL	25	\$ 150.00	\$ 3,750.00	A04
F010	STORAGE LOOPS UNDERGROUND	5	\$ 100.00	\$ 500.00	U04
F011	FIBER RE-ARRANGEMENT		\$ 0.75	\$ -	U04
F012	PULL INNERDUCT OR FIBER CABLE IN NEW CONDUIT	4,491	\$ 0.85	\$ 3,817.35	U04
F013	PULL INNERDUCT OR FIBER CABLE IN EXISTING CONDUIT		\$ 0.92	\$ -	U04
FIBER PLACEMENT TOTAL			\$	93,781.15	

Miscellaneous

ITEM	DESCRIPTION	UNIT	QUANTITY	UNIT PRICE	TOTAL PRICE	REMARKS
M001U	UNDERGROUND SET-UP FEE			\$ 78.00	\$ -	U05
M001A	AERIAL SET-UP FEE			\$ 78.00	\$ -	A05
M002	TRIP CHARGE			\$ 70.00	\$ -	U05
M003	FACE PLATE CHANGE OUT			\$ 10.00	\$ -	U05
M004	WRECK OUT UNDERGROUND PEDESTALS AND RESTORE AREA			\$ 9.03	\$ -	U05
M005	EMERGENCY CALL-OUT MOBILIZATION FOR AFTER HOURS			\$ 320.00	\$ -	U05
M006	EMERGENCY CALL-OUT MOBILIZATION FOR DURING HOURS			\$ 100.00	\$ -	U05
M007	CORE DRILL CONCRETE SLAB INCLUDES X-RAY			\$ 25.00	\$ -	U05
M008	ATTACH CONDUIT TO BRIDGE			\$ 23.50	\$ -	U05
M009	SOFT DIG - MUST HAVE PRE APPROVAL			\$ 87.60	\$ -	U05
M010	INSTALL/REPLACE LOCK BOX (SET-UP FEES DO NOT APPLY)			\$ 36.24	\$ -	U02
M011	PLACEMENT OF SNOWSHOES & REPAIR STORAGE LOOP			\$ 100.00	\$ -	U02
M012	REMOUNT OF FIBER SPLICE ENCLOSURE			\$ 100.00	\$ -	U04
M013	FORWARD AND RETURN SWEEP			\$ 0.17	\$ -	U05
M014	PLANT CERTIFICATION			\$ 0.11	\$ -	U05
M015	FIELD SURVEY			\$ 75.00	\$ -	U05
M016	INSTALL CHARACTER GENERATOR			\$ 78.00	\$ -	U05
M017	INSTALL MODULATOR			\$ 36.00	\$ -	U05
M018	MATCH LEVELS - BALANCE SIGNAL			\$ 36.00	\$ -	U05
M019	REMOVE AND REPLACE SYSTEM AMP			\$ 75.00	\$ -	U03
M020	REMOVE AND REPLACE LINE EXTENDER			\$ 65.00	\$ -	U03
M023	SUPERVISOR			\$ 55.00	\$ -	U03
M024	FOREMAN			\$ 45.50	\$ -	U05
M025	LINE PERSON WITH BUCKET TRUCK			\$ 75.00	\$ -	U05
M026	SPLICER WITH BUCKET TRUCK		25	\$ 150.00	\$ 3,750.00	U05
M028	PURCHASE AND INSTALL PLENUM DUCT			\$ 4.05	\$ -	U05
	PERMITS			\$ 1,700.00	\$ -	
	MISCELLANEOUS TOTAL			\$	\$ 3,750.00	

GRAND TOTAL MAXIMUM PERMITTED RATE

\$	268,474.67
----	------------

CONTRACTOR PROPOSED DISCOUNT

JOB BID SUBMITTED

\$	268,474.67
----	------------

16,489.20	A02
0.00	U02
0.00	A03
0.00	U03
89,463.80	A04
4,317.35	U04
11,588.20	A05
146,616.12	U05
0.00	STNBY
<u>288,474.67</u>	

E-mail address:

Contact

Authorized Signatory

MTF #(To be filled out by whse)

Oracle Job Number

Category

Source Project Number

Source Task

Expenditure Type/Acct #

Job Name

0

Relo

W3715BT13 ForcedRelo

16112

Westpark Phase II

Entry Date

Tech Name American

Tech # 13007

Puller

Issued By

Received By

Prepared By: Margie Blackwell

Oracle Part #	Category	Description	BOM QTY	Issued QTY	Amount
1070	A02	Bolt, Thimble Eye Straight 5/8 x 16"	20		\$71.00
110138	A02	Nut, Thimbleye 5/8"	20		\$39.60
1244	A02	Guard, 8' Yellow Guy	22		\$77.00
110003	A02	Screw, 6" Anchor	22		\$347.82
110009	A02	Attachment, Guy, Down Strap (pig ear)	22		\$36.96
1187	A02	Grip, Dead-end 5/16" Prefomed	25		\$53.00
1197	A02	Strap, U-Guard 2-hole 3-3/16"	32		\$27.30
1086	A02	Bolt, Machine 5/8 x 18"	100		\$165.00
1227	A02	Clamp, Suspension Bolt, 3 Bolt Straight	100		\$259.00
1196	A02	Two hole strap 2 3/16" Galv Steel for 2" Steel Cable Guard	192		\$64.90
110196	A02	Clamp, Bonding K-1 Weaver	200		\$336.00
110053	A02	Clamp, D-lashing Wire	200		\$65.40
4114	A02	Spacer, 1/2" Saddle Bell	400		\$20.00
129134	A02	Strap, Lashed Cable Zinc 10"	600		\$88.20
4567	A02	Strand, 1/4" Galvanized	23,000		\$2,990.00
48090	A03	Tag, Aerial Fiber With LOGO	500		\$118.50
5183	A04	Loop Fiber Storage 16IN Alum w/Hardware (144-240 count)	25		\$1,082.50
3364	U02	Tape, 3/4" x 60' Vinyl	20		\$74.58
1200	U02	Wire, Bare Copper, #6	315		\$176.09
1580	U02	Washer, Square 2" x 2"	400		\$72.00
110355	U03	Yard Pea Gravel	6		\$374.28
110731	U03	30" x 48" x 36 ' Polymer Concrete Hand Holes	6		\$5,866.08
110737	U03	4" x 36" Long Radius Sweeps w/ 4" couplers	12		\$309.24
115330	U04	Splice Closure, Mid Pak w/2 Trays (up to 96 count)	8		\$2,291.20
5304	U04	Tray Fiber Splice FOSC-ACC-D-36	10		\$208.20
144813	U04	Encl FOSC 450-D6	12		\$3,883.92
4201	U04	Splice Closure, Fiber Pak Plus (above 96 count)	12		\$5,463.36
114790	U04	Splice Tray, Fiber Pak Plus	30		\$340.50

MTF #(To be filled out by whse)

Oracle Job Number

Category

Source Project Number

Source Task

Expenditure Type/Acct #

Job Name

0

Relo

W3715BT13 ForcedRelo

16112

Westpark Phase II

Entry Date

Tech Name American

Tech # 13007

Puller

Issued By

Received By

Prepared By: Margie Blackwell

Oracle Part #	Category	Description	BOM QTY	Issued QTY	Amount
11769	U04	Heat Shrink Sleeve for Fiber	2,500		\$1,728.50
				SUBTOTAL	\$26,630.12
				Headend Optics	\$0.00
				FIBER	\$19,825.50
				SNAP LOCK	\$0.00
				Tax & Freight	\$0.00
				TOTAL	\$46,455.62

MTF #(To be filled out by whse)

Oracle Job Number

Category

Source Project Number

Source Task

Expenditure Type/Acct #

Job Name

Joint Trench Project

CAR Number

Functional Area #

0

Relo

000

16112

Westpark Phase II

No

0

Entry Date

Tech Name American

Tech # 13007

Puller

Issued By

Received By

Prepared By: Margie Blackwell

CIFA #	Category	Description	BOM QTY	Issued QTY	Amount
7313	A07	Fiber 24 Count Armored (Prysmian, Gel-Free, No TW label)	2,000		\$566.00
6263	A07	Fiber 48 Count Armored (Prysmian, Gel-Free, No TW label)	16,000		\$5,888.00
6267	A07	Fiber 72 Count Armored (Prysmian, Gel-Free, No TW label)	3,500		\$2,551.50
6283	A07	Fiber 240 Count Armored (Prysmian, Gel-Free, No TW label)	10,000		\$10,820.00
				SUBTOTAL	\$19,825.50

Exhibit C

Schedule of Work and Estimated Dates of Completion.

(As Shown Below)

Construction Schedule:

Begin Construction: 04/13/2018

Complete Construction: 07/13/2018

 9/17/18
Date
Fort Bend County

 6/28/18
Initial Date
Comcast