



Fort Bend County Engineering
FORT BEND COUNTY, TEXAS

5B 1

Richard W. Stolleis, P.E.
County Engineer

May 30, 2018

Commissioner W. A. "Andy" Meyers
Fort Bend County Precinct 3
22333 Grand Corner Drive
Katy, Texas 77494

RE: Churchill Farms Subdivision – “No Thru Trucks” Signs

Dear Commissioner Meyers:

Fort Bend County Engineering Department has evaluated the request for No Thru Truck signs at the following locations within the Churchill Farms subdivision:

- Westbound Churchill Farms Boulevard, west of FM 1463
- Southbound Winston Ridge Lane, south of FM 1463
- Eastbound Satton Ranch Lane, east of the Fulshear City Limit

Through truck traffic currently cutting through the Churchill Farms subdivision will be adequately served by remaining on major thoroughfares in the area.

The attached Traffic Control Plan (TCP) shows the proposed locations for the “No Thru Trucks” signs.

The attached Commissioners Court Order establishes the thru truck restriction and imposes a criminal penalty for its violation.

If we can be of further assistance please do not hesitate to contact me at 281-633-7528 or chris.debaillon@fortbendcountytexas.gov.

Sincerely,

A handwritten signature in blue ink, appearing to read "Chris Debaillon".

Chris Debaillon, PE, PTOE
Assistant County Engineer - Traffic

CDD/mjs

cc: Judge Robert E. Hebert, County Judge
Marc Grant - FBC Road & Bridge
Brian Fields - Signage Department
File

301 Jackson St., Suite 401, Richmond, TX 77469
Phone 281-633-7500

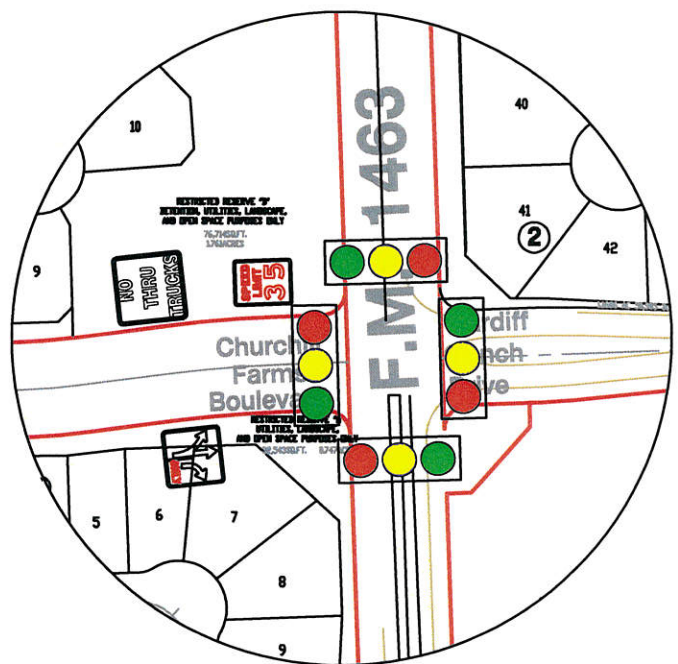
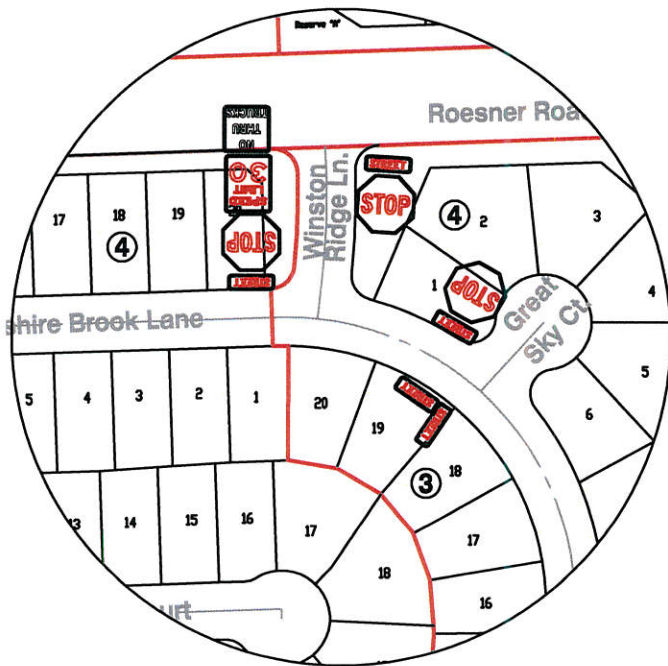
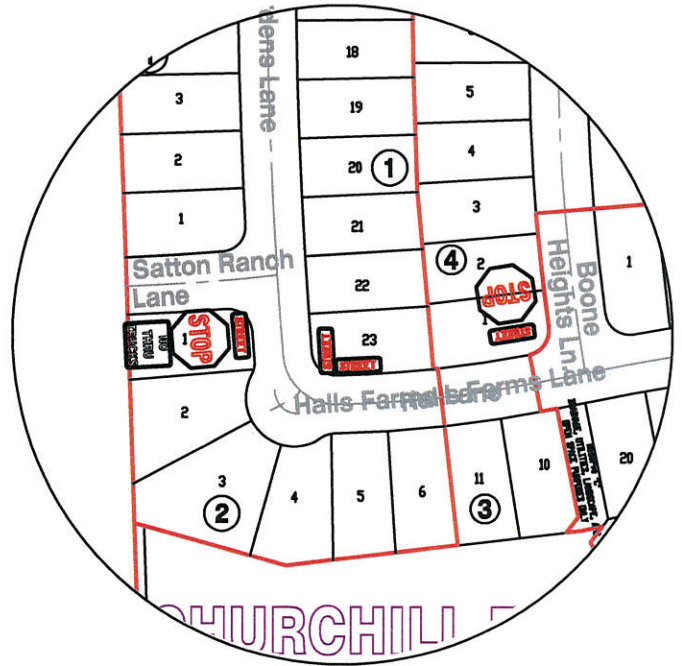

Note:

The purpose of this traffic control plan is to revise traffic control for Churchill Farms Subdivision with the addition of "No Thru Trucks" (R5-2) as indicated on the drawing.

Drawn By: L. Brdecka

Date: 5-21-18

Approved By: Chris Deballion, PE PTOE

Date: 5/25/18

Scale
1" = 200'-0"

**Churchill Farms Subdivision
(Revised) Control Map and
Traffic Sign Layout**

Fort Bend County Engineering Dept.
301 Jackson Street
Richmond, Texas 77469