



**PERMIT APPLICATION REVIEW FORM FOR
CABLE, CONDUIT, AND POLE LINE ACTIVITY
IN FORT BEND COUNTY**

**Fort Bend County
Engineering Department**
301 Jackson Suite 401
Richmond, Texas 77469
281.633.7500
Permits@fortbendcountytx.gov

- ☒ Right of Way Permit
☐ Commercial Driveway Permit

Permit No: 2018-19280

The following "Notice of Proposed Cable, Conduit, and/or Pole Line activity in Fort Bend County" and accompanying attachments have been reviewed and the notice conforms to appropriate regulations set by Commissioner's Court of Fort Bend County, Texas.

(1) COMPLETE APPLICATION FORM:

- ☒ a. Name of road, street, and/or drainage ditch affected.
☒ b. Vicinity map showing course of directions
☒ c. Plans and specifications

(2) BOND:

- ☐ County Attorney, approval when applicable.
- ☒ Perpetual bond currently posted. Bond No: [REDACTED] Amount: \$50,000.00
- ☐ Performance bond submitted. Bond No: _____ Amount: _____
- ☐ Cashier's Check Check No: _____ Amount: _____

(3) DRAINAGE DISTRICT APPROVAL (WHEN APPLICABLE):

Drainage District Approval

Date

We have reviewed this project and agree it meets minimum requirements.

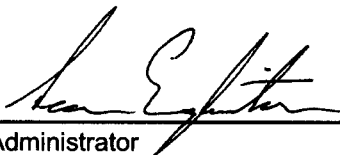

Permit Administrator

6/26/2018

Date



PROJECT
LOCATION

AREA MAP
NOT TO SCALE



at&t

PROJECT NAME: FIBER OPTIC PLACEMENT
PROJECT ADDRESS: 1022 SQUIRREL RD. RICHMOND, TX 77469
PROJECT TYPE: FIBER NETWORK CONSTRUCTION PACKAGE
COORDINATES: LAT: 29.595574°, LONG: -95.769145°

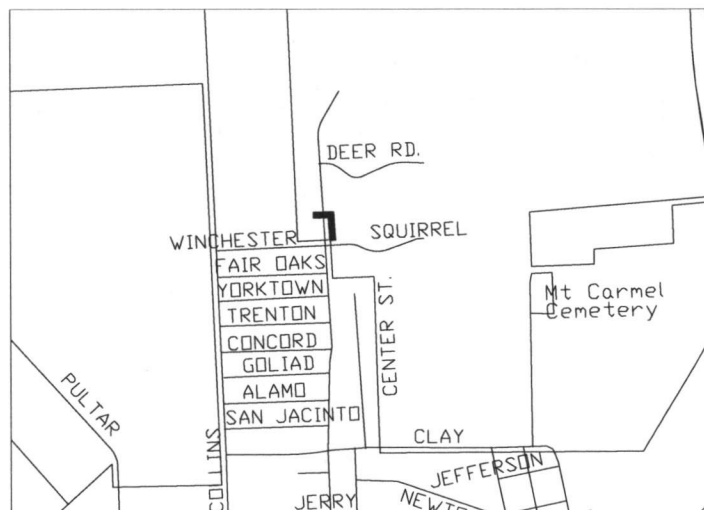

VICINITY MAP
NOT TO SCALE

KEY MAP NO. 565X
GIMS MAP NO. -
ZIP CODE 77469

NOTE:

- NO PROPOSED STORM SEWER, WASTEWATER, OR WATER WORK IS SHOWN ON THIS PLAN SET, NOR INCLUDED IN THIS WORK SCOPE.
- NO PROPOSED WASTEWATER WORK IS SHOWN ON NOR INVOLVED IN THIS PLAN SET'S PROPOSED WORK SCOPE.
- NO PROPOSED STORM SEWER OR DRAINAGE WORK IS SHOWN ON NOR INVOLVED IN THIS PLAN SET'S PROPOSED WORK SCOPE.

CAUTION

FORBIDDEN UTILITY LOCATIONS ARE APPROXIMATE.
CONTACT THE LOCAL ONE CALL AGENCY 48 HOURS
PRIOR TO CONSTRUCTION FOR EXACT UTILITY
LOCATIONS AT: TEXAS 811 1-800-344-8377



811 OR
713-223-4567 (IN HOUSTON)
OR
(1-800-344-8377)
CALL BEFORE
YOU DIG

CAUTION

CONTRACTOR SHALL NOTIFY THE CITY OF HOUSTON,
DEPARTMENT OF PUBLIC WORKS AND ENGINEERING,
OFFICE OF THE CITY ENGINEER, 48 HOURS BEFORE
STARTING WORK ON THIS PROJECT.
TELEPHONE NO. (HIS) 304-8088

INDEX

DESCRIPTION	SHEET NUMBER
COVER	01
CONTACTS, MATERIAL TOTALS	02
GENERAL NOTES & SPECIFICATIONS	03
CONSTRUCTION DRAWINGS	04
TRAFFIC CONTROL PLAN	05



634 N. BALLARD
WYLIE, TX 75098
OFFICE: 972-442-7005
FAX: 972-442-7087

TEO
ENGINEERING ORGANIZATION, LLC
5510 COMMUNITY DR
HOUSTON, TX 77055
281-536-5123 OFFICE
713-668-6334 FAX
TEOLLCC@GMAIL.COM
TX FIRM NO. F-5978

THIS DOCUMENT IS RELEASED
FOR INTERVIEW REVIEW ONLY
UNDER THE AUTHORITY OF
E. GALVAN
P.E. SERIAL NO.: 05328
ON: DECEMBER 18, 2017
IT IS NOT TO BE USED FOR CONSTRUCTION,
BIDDING, OR PERMIT PURPOSES.

NOTE: CITY SIGNATURES VALID FOR ONE YEAR ONLY
AFTER DATE OF SIGNATURES

CITY OF HOUSTON
DEPARTMENT OF PUBLIC WORKS AND ENGINEERING

WATER

WASTEWATER

STORM WATER

STREET & BRIDGE

CITY ENGINEER DATE

DIRECTOR OF PUBLIC WORKS AND ENGINEERING DATE

SHEET TOTAL SHEET

01 05

TRAFFIC AND TRANSPORTATION

STORM WATER QUALITY

FACILITIES

FOR CITY OF HOUSTON USE ONLY

ILMS NO. -

LOG NO. -

CITY OF HOUSTON, TX
FORT BEND COUNTY

MATERIAL TOTALS

DESCRIPTION	QUANTITY	UNIT
PLACE 3'x4'x2' HH	0	EA.
DIR. BORE 1-2" CONDUIT POWER	118	FT.
12AWG PRO-TRACE HDD-CCS PE45	0	FT.
PLACE XXX FOC	0	FT.

UTILITIES

MCI UTILITY LOCATE	1-800-624-9675
TEXAS ONE CALL SYSTEM (UTILITY LOCATE)	1-800-245-4545
NEW STATE WIDE UTILITY LOCATES	1-800-545-6005
CITY OF HOUSTON UTILITY LOCATE	1-713-223-4567
UNDERGROUND GAS FACILITIES	1-800-669-8344
CENTERPOINT ENERGY PIPELINE	1-713-967-8037
CENTERPOINT ENERGY ELECTRIC	1-713-207-7777

CONTACTS

NAME/ COMPANY	EMAIL	PHONE
RONNIE TEAFF - TDC2	RTEAFF@TDC2.COM	(214) 893-4658



THIS DRAWING IS COPYRIGHTED AND IS THE SOLE PROPERTY OF AT&T. IT IS PRODUCED SOLELY FOR USE BY AT&T AND ITS AFFILIATES. REPRODUCTION OR USE OF THIS DRAWING AND/OR THE INFORMATION CONTAINED IN IT IS FORBIDDEN WITHOUT THE WRITTEN PERMISSION OF AT&T.

REV	DATE	DESCRIPTION	BY
A	01/29/18	FOR CON REVIEW	TDC2

REVISIONS



634 N. BALLARD
WYLIE, TX 75098
OFFICE: 972-442-7005
FAX: 972-442-7087

TEO
ENGINEERING ORGANIZATION, LLC
5010 COMMUNITY DR
HOUSTON, TX 77055
281-636-5123 OFFICE
713-668-6334 FAX
TEO.LLC@GMAIL.COM
TX FIRM NO: F-8878

THIS DOCUMENT IS RELEASED
FOR INTERIM REVIEW ONLY
UNDER THE AUTHORITY OF
E. SALVENDY
P.E. SERIAL NO.: 24558L
ON: JANUARY 29, 2008
IT IS NOT TO BE USED FOR CONSTRUCTION,
BIDDING, OR PERMIT PURPOSES.

SITE NAME

CRAN_RSTX_HSTNW_010

SITE ADDRESS

1022 SQUIRREL RD.
RICHMOND, TX
FORT BEND CO, USA

NOTE: CITY SIGNATURES VALID FOR ONE YEAR ONLY
AFTER DATE OF SIGNATURES

CITY OF HOUSTON
DEPARTMENT OF PUBLIC WORKS AND ENGINEERING

DESIGNED BY:

TDC2

DRAWN BY:

TDC2

SCALE:

SHEET:

02

TOTAL SHEET:

05

ILMS NO. -

LOG NO. -

GENERAL NOTES & SPECIFICATIONS

NOTES:

- THE INFORMATION SHOWN ON THESE DRAWINGS WAS OBTAINED FROM FIELD SURVEYS AND THE CITY OF HOUSTON PUBLIC WORKS AND ENGINEERING DEPT. ALL INFORMATION CONCERNING TYPE AND LOCATION OF UNDERGROUND UTILITIES IS NOT GUARANTEED TO BE ACCURATE OR ALL INCLUSIVE. THE CONTRACTOR IS RESPONSIBLE FOR MAKING HIS OWN DETERMINATIONS AS TO TYPE AND LOCATION OF UNDERGROUND UTILITIES AS MAY BE NECESSARY TO VOID DAMAGE THEREOF. THE CONTRACTOR SHALL VERIFY LOCATION OF UNDERGROUND PRELINES, CONDITIONS AND STRUCTURES BY CONTACTING OWNERS OF UNDERGROUND UTILITIES OR BY EXCAVATING IN ADVANCE OF CONSTRUCTION.
- THE CONTRACTOR IS RESPONSIBLE FOR DETERMINING THE EXACT LOCATION OF ALL UTILITIES WHEN AND WHERE THEY FALL IN THE PATH OF CONSTRUCTION.
- THE CONTRACTOR IS ALSO RESPONSIBLE FOR CONTACTING THE UTILITY COORDINATING COMMITTEE @ (713) 22-4850 AND TEXAS ONE CALL @ (800) 344-8377, FORTY-EIGHT (48) HOURS PRIOR TO ANY CONSTRUCTION.
- ALL PROPOSED FACILITIES SHALL MAINTAIN 12" CLEAR FROM ALL PUBLIC AND PRIVATE UTILITIES.

GENERAL CONSTRUCTION NOTES:

- WASTEWATER COLLECTION SYSTEMS, WATER LINES, STORM DRAINAGE AND STREET PAVING ARE DESIGNED IN ACCORDANCE WITH THE LATEST EDITION OF THE DOCUMENTS "STANDARD CONSTRUCTION SPECIFICATIONS FOR WASTEWATER COLLECTION SYSTEMS, WATER LINES, STORM DRAINAGE AND STREET PAVING", "STANDARD CONSTRUCTION DETAILS FOR WASTEWATER COLLECTION SYSTEMS, WATER LINES, STORM DRAINAGE AND STREET PAVING" AND THE "INFRASTRUCTURE DESIGN MANUAL" PUBLISHED BY THE CITY OF HOUSTON, DEPARTMENT OF PUBLIC WORKS AND ENGINEERING (OCTOBER 2002).
- ALL UTILITIES PRESENTED ON THESE DRAWINGS ARE SHOWN BASED ON THE BEST AVAILABLE INFORMATION. CONTRACTOR SHALL VERIFY IN THE FIELD THE EXACT LOCATIONS PRIOR TO COMMENCING CONSTRUCTION. CONTRACTOR SHALL NOTIFY TEXAS ONE CALL AT (800) 344-8377 AT LEAST 48 HOURS BEFORE PROCEEDING WITH ANY EXCAVATION.
- THE CONTRACTOR SHALL BE FULLY RESPONSIBLE FOR ANY DAMAGES TO EXISTING WATER, WASTEWATER, STORM WATER LINES AND TRAFFIC CONTROL DEVICES. ALL DAMAGES SHALL BE REPAIRED IN ACCORDANCE WITH THE CITY OF HOUSTON, DEPARTMENT OF PUBLIC WORKS AND ENGINEERING'S "STANDARD CONSTRUCTION SPECIFICATIONS" REFERENCED ABOVE. AT NO COST TO THE CITY OF HOUSTON, CONTRACTOR SHALL NOTIFY THE CITY OF HOUSTON, DEPARTMENT OF PUBLIC WORKS AND ENGINEERING, OFFICE OF THE CITY ENGINEER, 48 HOURS BEFORE STARTING WORK ON THIS PROJECT. TELEPHONE NO. 832-384-6066.
- ADEQUATE DRAINAGE SHALL BE MAINTAINED AT ALL TIMES DURING CONSTRUCTION AND ANY DRAINAGE DITCH OR STRUCTURE DISTURBED DURING CONSTRUCTION SHALL BE RESTORED TO THE SATISFACTION OF THE OWNING AUTHORITY. CONTRACTOR SHALL TAKE NECESSARY PRECAUTIONS TO PROTECT ROOT SYSTEMS OF SHRUBS, PLANTS AND TREES ALONG THE AREA OF EXCAVATION.
- THE CONTRACTOR SHALL COMPLY WITH THE LATEST EDITION OF OSHA REGULATIONS AND THE STATE OF TEXAS LAWS CONCERNING EXCAVATION.
- IF THE CONSTRUCTION DOES NOT BEGIN WITHIN A YEAR AFTER THE PLANS HAVE BEEN SIGNED, NEW SIGNATURES MUST BE OBTAINED AND LETTERS OF AVAILABILITY MUST BE UPDATED.
- CONTRACTOR SHALL PREPARE A SET OF "AS-BUILT" DRAWINGS SHOWING ANY FIELD CHANGES MADE TO THE APPROVED ENGINEERING PLANS AND SUBMIT TO THE DESIGN CONSULTANT FOR SUBMISSION TO THE CITY ENGINEER.
- THE PROJECT IS SUBJECT TO THE CITY OF HOUSTON STREET CURE ORDINANCE.
- THE CONTRACTOR SHALL CONTACT ROBERT TAUBE (DIRECTOR OF ENGINEERING & CONSTRUCTION, THE LIFTOUR HOUSTON DISTRICT - ONE HOUR BEFORE STARTING WORK ON THIS PROJECT. TELEPHONE NO. (713) 621-2011.

CITY OF HOUSTON DEPARTMENT OF TRAFFIC CONTROL DIVISION

- CONTRACTOR SHALL PROVIDE AND INSTALL TRAFFIC CONTROL DEVICES IN CONFORMANCE WITH PART VI OF THE TEXAS MANUAL ON UNIFORM TRAFFIC CONTROL DEVICES (TRANS MUTCD) MOST RECENT EDITION WITH REVISIONS) DURING CONSTRUCTION.
- NO TRAFFIC LINES SHALL BE CLOSED DURING THE HOURS OF 7:00AM TO 7:00PM MONDAY THRU FRIDAY IN DOWNSTREAM DIRECTION AREA.
- NO TRAFFIC LINES SHALL BE CLOSED DURING THE HOURS OF 7:00AM TO 9:00PM AND 4:00PM TO 6:00PM MONDAY THRU FRIDAY.
- NO TRAFFIC LINES SHALL BE CLOSED IN ALL RESIDENTIAL AREAS FROM 7:00PM TO 7:00AM.
- CONTRACTOR SHALL MAINTAIN ONE LANE OF TRAFFIC IN EACH DIRECTION DURING WORKING HOURS.
- CONTRACTOR SHALL COVER OPEN EXCAVATIONS WITH STEEL PLATES ANCHORED PROPERLY DURING NON-WORKING HOURS, AND OPEN THE LANES FOR NORMAL TRAFFIC FLOW.
- OFF-DUTY UNIFORMED POLICE OFFICERS (FLADGERS) (NARS REQUIRED) TO DIRECT TRAFFIC WHEN LANES ARE CLOSED.
- IN THE EVENT THAT NO "TRAFFIC CONTROL PLANS" EXIST AS A PART OF CONTRACT DRAWINGS, CONTRACTOR MAY PREPARE PLANS AND SUBMIT TO PLAN REVIEW SECTION FOR APPROVAL TEN DAYS PRIOR TO IMPLEMENTATION.
- IF THE CONTRACTOR CHOOSES TO USE A DIFFERENT METHOD OF "TRAFFIC CONTROL PLANS" DURING THE CONSTRUCTION THAN WHAT IS OUTLINED IN THE CONTRACT DRAWINGS, RESIDE SHALL BE RESPONSIBLE FOR PREPARING AND SUBMITTING AN ALTERNATE SET OF PLANS TO THE PLAN REVIEW SECTION FOR APPROVAL TEN WORKING DAYS PRIOR TO IMPLEMENTATION.
- APPROVED COPIES OF "TRAFFIC CONTROL PLANS" AND LANE/BIKEWAY CLOSURE PERMITS SHALL BE AVAILABLE FOR INSPECTION AT THE JOB SITE AT ALL TIMES. THE CONTRACTOR MUST SECURE "LANE/BIKEWAY CLOSURE PERMITS" FROM THE CITY'S TRAFFIC DIVISION BEFORE CLOSING A LANE/BIKEWAY. THE REQUEST MUST BE MADE AT LEAST TEN BUSINESS DAYS PRIOR TO THE DATE FOR WHICH THE CLOSURE IS SOUGHT. NOTE THAT WORKING HOURS MAY BE RESTRICTED OR THE REQUEST MAY BE DENIED. CALL 832-365-3020 FOR AN APPLICATION.

*THESE PLANS SHALL BE DRAWN TO SCALE ON REPRODUCIBLE MYLAR AND SEALED BY A LICENSED ENGINEER IN THE STATE OF TEXAS. PLANS WILL BECOME A PART OF THE CONTRACT DRAWINGS.

GENERAL CONSTRUCTION NOTES FOR THE STORM WATER POLLUTION PREVENTION PLAN

- STORM WATER POLLUTION PREVENTION PLAN (SWPPP) AND STORM WATER QUALITY MANAGEMENT PLAN (SWQMP) COMPLIANCE NOTES FOR AREAS LESS THAN 1 ACRE.
- IF AREA IS DISTURBED (CLEARING AND GRUBBING AND/OR EXCAVATION INVOLVED): PROVIDE BARRIERS TO PREVENT ANY RUNOFF INTO THE CITY'S MSA.
 - PROVIDE SWPPP NOTES FOR CONSTRUCTION PLANS.
 - ANY CONSTRUCTION SITE RUNOFF INTO THE CITY'S MSA IS A VIOLATION OF THE CITY STORM WATER ORDINANCE.

SWPPP COMPLIANCE NOTES:

- CONTRACTOR SHALL IMPLEMENT INLET PROTECTION DEVICES AND REINFORCED FILTER FABRICS DURING ALL ROADWAY AND SITE PREPARATION WORK. THE TYPICAL STORM WATER POLLUTION PREVENTION (SWPPP) PLANS TO KEEP SILT AND/OR EXCAVATED MATERIALS FROM ENTERING INTO THE STORM WATER INLETS AND DITCHES EVENTUALLY POLLUTING THE RECEIVING STORM.
- DURING THE EXCAVATION PHASE OF THE PROJECT, CONTRACTOR SHALL SCHEDULE THE WORK IN SHORT SEGMENTS SO THAT EXCAVATED MATERIAL CAN BE QUICKLY HAULED AWAY FROM THE SITE AND TO PREVENT IT FROM STAYING UNCOLLECTED ON THE EXISTING PAVEMENT. ANY LOOSE EXCAVATED MATERIAL WHICH FALLS ON PAVEMENTS OR DRIVEWAYS SHALL BE SWEEP BACK INTO THE EXCAVATED AREA.
- CONTRACTOR SHALL CLEAN UP THE EXISTING STREET INTERSECTIONS AND DRIVEWAYS ONLY, AS NECESSARY, TO REMOVE ANY EXCESS MUD, SILT OR ROCK TRACKER FROM THE EXCAVATED AREA.
- CONTRACTOR SHALL FOLLOW GOOD HOUSEKEEPING PRACTICES DURING THE CONSTRUCTION OF THE PROJECT. ALWAYS CLEANING UP DIRT AND LOOSE MATERIAL AS CONSTRUCTION PROGRESSES.
- CONTRACTOR TO INSPECT AND MAINTAIN THE AREAS LISTED BELOW AT LEAST ONCE EVERY FOURTEEN (14) CALENDAR DAYS AND WITHIN 24 HOURS OF THE END OF A STORM EVENT OF 0.5 INCHES OR GREATER.

- DISTURBED AREAS OF THE CONSTRUCTION SITE THAT HAVE NOT BEEN FINALLY STABILIZED, AREAS USED FOR STORAGE OF MATERIALS THAT ARE EXPOSED TO PRECIPITATION.
- STRUCTURAL CONTROL MEASURES.
- LOCATIONS WHERE VEHICLES ENTER OR EXIT THE SITE.

- CONTRACTOR IS TO BE RESPONSIBLE TO MAINTAIN EXISTING DITCHES AND/OR CULVERTS FOR UNSTRUCTURED DRAINAGE AT ALL TIMES. WHERE DRAINAGE IS DISTURBED BY EXCAVATION ON BACKFILL OPERATIONS, SUCH AREAS SHALL BE REPLACED BY BEDDING OR SODDING. SLOPES 4:1 OR STEEPER SHALL BE REPLACED BY BLOCK SODDING.

STORM SEWER CONSTRUCTION NOTES

- STORM SEWERS SHALL BE REINFORCED CONCRETE PIPE (RCP) CLASS II, 18" AND SHALL BE INSTALLED, BEDDED, AND BACKFILLED IN ACCORDANCE WITH THE CITY OF HOUSTON DRAWING NOS. 0217-02, 0217-03, 0217-05, 0217-06, 0217-08, AND 0217-09/CT 2002 AS APPLICABLE UNLESS OTHERWISE SHOWN ON THE DRAWINGS.
- ALL STORM SEWER CONSTRUCTION IN SLOPE/ EASEMENT SHALL BE R.C.P. (C-76/CASS) AND SHALL BE BEDDED IN ACCORDANCE WITH THE CITY OF HOUSTON DRAWING NOS. 0217-06, 0217-08, 0217-09, 0217-06, AND 0217-09/CT 2002 AS APPLICABLE.
- ALL SEWER UNDER PROPOSED OR FUTURE PAVEMENT AND TO A POINT ONE (1) FOOT BACK OF ALL PROPOSED OR FUTURE CURBS SHALL BE BACKFILLED WITH 1/2 BAG BACKFILL. 1" STABILIZED SAND TO WITHIN ONE FOOT OF SURFACE. THE REMAINING DEPTH OF THE TRENCH SHALL BE BACKFILLED WITH SUITABLE EARTH MATERIAL.
- ALL TRENCH BACKFILLS SHALL BE 8" LIFTS, WITH TESTS TAKEN AT 100 FOOT INTERVALS ON EACH LIFT, AND MECHANICALLY COMPACTED TO A DENSITY OF NOT LESS THAN 96% OF THE MAXIMUM DRY DENSITY AS DETERMINED BY THE STANDARD PROCTOR COMPACTION TEST (ASTM D-1558/ASTM 99).
- CIRCULAR AND ELLIPTICAL REINFORCED CONCRETE PIPE SHALL BE INSTALLED USING RUBBER GASKET JOINTS CONFORMING TO ASTM C440 AND ASTM C754 RESPECTIVELY.
- ALL STORM SEWER PIPES AND INLET LEADS SHALL BE 24-INCH AND LARGER R.C.P. (C-76, CLASS II).
- ALL PROPOSED PIPE STUB-OUTS FROM MANHOLES AND INLETS ARE TO BE PLUGGED WITH 8" BRICK WALLS UNLESS OTHERWISE NOTED.
- CONTRACTOR SHALL PROVIDE 18" MINIMUM VERTICAL & 48" HORIZONTAL CLEARANCE AT STORM SEWER AND WATER LINE CROSSINGS.
- ADJUST MANHOLE COVERS TO GRADE CONFORMING TO REQUIREMENTS OF SECTION 028-ADJUSTING MANHOLES, INLETS AND VALVE BOXES TO GRADE.
- THE CONTRACTOR SHALL BE RESPONSIBLE FOR PROTECTING, MAINTAINING, AND RESTORING ANY BACK SLOPE DRAINAGE SYSTEM DISTURBED AS A RESULT OF HIS WORK.
- ALL DITCHES SHALL BE REGRADED TO PROPOSED ELEVATIONS TO INSURE PROPER DRAINAGE. ALL DITCHES SHALL BE PROPERLY BACKFILLED AND COMPACTED ALL DISTURBED AREA SHALL BE REGRADED, SEEDING AND FERTILIZED.
- ALL DRIVEWAYS WILL BE LOCATED TO AVOID EXISTING CURB INLET STRUCTURES.

CITY OF HOUSTON STREET BRIDGE & R.O.W.

- DEPARTMENT OF PUBLIC WORKS AND ENGINEERING'S "STANDARD CONSTRUCTION SPECIFICATIONS" AND STANDARD CONSTRUCTION DETAILS FOR WASTEWATER COLLECTION SYSTEMS, WATER LINES, STORM DRAINAGE, AND STREET PAVING UNLESS OTHERWISE NOTED AND APPROVED ON THESE PLANS. THE DESIGN IS CONSISTENT WITH THE MINIMUM STANDARDS ESTABLISHED IN THE "INFRASTRUCTURE DESIGN MANUAL," REFERENCED AT [http://documents.publicworks.houston.tx.gov/documents-center/engineering-and-construction/index.htm](#).
- FILL AREAS ON PLANS SHALL BE FILLED IN LAYERS NOT EXCEEDING 8" IN DEPTH AND EACH COMPACTED TO NOT LESS THAN 96% STANDARD PROCTOR DENSITY PRIOR TO INSTALLATION OF WATER LINE AND FILL AREA SHALL BE BEDDED AND FERTILIZED WITH 1/2 BAG BACKFILL.
- UTILITY CONTRACTOR SHALL PROVIDE TEMPORARY SILT BARRIER FENCE ON ALL NON-CURB INLETS WHICH WILL REMAIN IN PLACE AFTER UNDERGROUND CONTRACT IS COMPLETE.
- CONTRACTOR SHALL PROVIDE SILT BARRIER FENCE ON ALL STAGE 1 CURB INLETS.
- EXISTING PAVEMENTS, CURBS, DRIVEWAYS, AND SIDEWALKS, DAMAGED OR REMOVED DURING CONSTRUCTION SHALL BE REPLACED TO CITY OF HOUSTON STANDARDS, WITH LATEST ADDENDUM AND AMENDMENTS THEREOF.
- CONDITION OF THE ROAD AND/OR RIGHT-OF-WAY UPON COMPLETION OF JOB SHALL BE AS GOOD AS OR BETTER THAN PRIOR TO STARTING WORK.
- ADEQUATE DRAINAGE SHALL BE MAINTAINED AT ALL TIMES DURING CONSTRUCTION AND ANY DRAINAGE DITCH OR STRUCTURE DISTURBED DURING CONSTRUCTION SHALL BE RESTORED TO SATISFACTION OF THE OWNING AUTHORITY.
- EXPOSED 12" OF REINFORCING STEEL AT PROPOSED SLOPED JAWED, JOINT, IF NO REINFORCING STEEL EXISTS, USE HORIZONTAL DOWELS. HORIZONTAL DOWELS SHALL BE 8 BARS, 24" LONG, 3/4" C.C. DRILLED AND EMBEDDED 8" INTO THE CENTER OF THE EXISTING SLAB WITH "90 DEGREE" OR EQUAL.
- CONTRACTOR TO TAKE NECESSARY PRECAUTIONS TO PROTECT ROOT SYSTEMS OF SHRUBS, PLANTS AND TREES ALONG AREAS OF EXCAVATION.
- CONTRACTOR SHALL COMPLY WITH OSHA REGULATIONS AND STATE OF TEXAS LAW CONCERNING EXCAVATION, TRENCHING AND SHIELDING AS SPECIFIED IN CITY OF HOUSTON

ORDINANCE 97-1487

- WHEEL CHAIR RAMPS SHALL BE INSTALLED IN ACCORDANCE WITH CITY OF HOUSTON ORDINANCE 97-1487 AT ALL INTERSECTIONS AND LOCATIONS WHERE THE EXISTING CURB OR SIDEWALK IS DAMAGED OR REMOVED DURING CONSTRUCTION.
- WASTEWATER COLLECTION SYSTEM, WATER LINES, STORM DRAINAGE AND STREET PAVING SHALL BE CONSTRUCTED IN ACCORDANCE WITH THE CITY OF HOUSTON, DEPARTMENT OF PUBLIC WORKS AND ENGINEERING'S "STANDARD CONSTRUCTION SPECIFICATIONS" AND "STANDARD CONSTRUCTION DETAILS FOR WASTEWATER COLLECTION SYSTEMS, WATER LINES, STORM DRAINAGE AND STREET PAVING" UNLESS OTHERWISE NOTED AND APPROVED ON THESE PLANS. THE DESIGN SHOULD BE CONSISTENT WITH THE MINIMUM STANDARD ESTABLISHED IN THE "DESIGN MANUAL FOR WASTEWATER COLLECTION SYSTEMS, WATER LINES, STORM DRAINAGE AND STREET PAVING".
- THE CONTRACTOR SHALL BE FULLY RESPONSIBLE FOR ANY DAMAGES TO EXISTING WATER, WASTEWATER, STORM SEWER AND TRAFFIC SIGNALS, CONDUITS, ALL DAMAGES SHALL BE REPAIRED IN ACCORDANCE WITH THE CITY OF HOUSTON, DEPT. OF PUBLIC WORKS AND ENGINEERING "STANDARD CONSTRUCTION SPECIFICATIONS" WITH LATEST ADDENDUM AND AMENDMENTS THEREOF, AT NO COST TO THE CITY OF HOUSTON.
- PRIOR TO STREET CONSTRUCTION, THE CONTRACTOR SHALL CONTACT THE DEPARTMENT OF PUBLIC WORKS AND ENGINEERING AT 832-384-6066 OR 832-384-6067 AND COMPLY WITH ALL REQUIREMENTS FOR THE ISSUANCE OF NECESSARY PERMIT/WORK ORDERS FOR STREET CONSTRUCTION.
- DOUBLE REFLECTORIZED BLUE TRAFFIC MARKERS SHALL BE PLACED KNOCHES OFFSET OF THE CENTERLINE OF ALL FIRE HYDRANT LOCATIONS BY THE PAVING CONTRACTOR. HYDRANTS LOCATED AT INTERSECTIONS SHALL HAVE A BUTTON PLACED ON EACH STREET.

AT&T TEXAS/SWBT FACILITIES

- THE LOCATIONS OF AT&T TELECOMMUNICATIONS FACILITIES ARE SHOWN IN AN APPROXIMATE MANNER ONLY. THE CONTRACTOR SHALL DETERMINE THE EXACT LOCATION BEFORE COMMENCING WORK. HE AGREES TO BE FULLY RESPONSIBLE FOR ANY AND ALL DAMAGES WHICH MIGHT BE OCCASIONED BY THIS FAILURE TO EXACTLY LOCATE AND PRESERVE THESE UNDERGROUND UTILITIES.
- THE CONTRACTOR SHALL CALL (800) 344-8377 A MINIMUM OF 48 HOURS PRIOR TO CONSTRUCTION TO HAVE UNDERGROUND LINES FIELD LOCATED.
- WHEN EXCAVATING WITHIN EIGHTEEN (18") OF THE INDICATED LOCATION OF AT&T TELECOMMUNICATIONS FACILITIES, ALL EXCAVATION MUST BE ACCOMPANIED USING NON-MECHANIZED EXCAVATION PROCEDURES. WHEN BORING, THE CONTRACTOR SHALL EXPOSE THE AT&T TELECOMMUNICATIONS FACILITIES.
- WHEN AT&T TELECOMMUNICATIONS FACILITIES ARE EXPOSED, THE CONTRACTOR WILL PROVIDE SUPPORT TO PREVENT DAMAGE TO THE CONDUIT DUCTS OR CABLES. WHEN EXCAVATING HOW TELEPHONE POLES AND THE CONTRACTOR SHALL BRACE THE POLE FOR SUPPORT.
- THE PRESENCE OR ABSENCE OF AT&T TELECOMMUNICATIONS UNDERGROUND CONDUIT FACILITIES OR EXPOSED CABLE FACILITIES SHOWN ON THESE PLANS DOES NOT MEAN THAT THERE ARE NO DIRECT BURIED CABLES OR OTHER CABLES IN CONDUIT IN THE AREA.
- PLEASE CONTACT THE AT&T TEXAS DRAINAGE PREVENTION MANAGER MR. ROOSEVELT LEE JR. AT (713) 567-4552 OR E-MAIL mrlee@att.com. IF THERE ARE QUESTIONS ABOUT BORING OR EXCAVATING NEAR OUR AT&T TELECOMMUNICATIONS FACILITIES.

CAUTION-UNDERGROUND GAS FACILITIES

- LOCATIONS OF CENTERPOINT ENERGY MAIN LINES (TO INCLUDE CENTERPOINT ENERGY INTRASTATE PIPELINE, LUG WHERE APPLICABLE) ARE SHOWN IN AN APPROXIMATE LOCATION ONLY. SERVICE LINES ARE USUALLY NOT SHOWN. OUR SIGNATURE ON THESE PLACES ONLY INDICATES THAT OUR FACILITIES ARE SHOWN IN APPROXIMATE LOCATION. IT DOES NOT IMPLY THAT A CONFIDENT ANALYSIS HAS BEEN MADE. THE CONTRACTOR SHALL CONTACT THE UTILITY COORDINATION COMMITTEE AT (713) 223-2657 OR (800) 688-8344 A MINIMUM OF 48 HOURS PRIOR TO CONSTRUCTION TO HAVE MAIN AND SERVICE LINES FIELD LOCATED.
- WHEN CENTERPOINT ENERGY PIPE LINE MARKINGS ARE NOT VISIBLE, CALL (713) 967-8337 (7:00 AM TO 4:14 PM) FOR STATUS OF LINE LOCATION REQUEST BEFORE EXCAVATION BEGINS.
 - WHEN EXCAVATING WITHIN 12" OF THE INDICATED LOCATION OF CENTERPOINT ENERGY FACILITIES, ALL EXCAVATION MUST BE ACCOMPANIED USING NON-MECHANIZED EXCAVATION PROCEDURES.
 - WHEN CENTERPOINT ENERGY FACILITIES ARE EXPOSED, SUFFICIENT SUPPORT MUST BE PROVIDED TO THE FACILITIES TO PREVENT EXCESSIVE STRESS ON THE PIPES.

THE CONTRACTOR IS FULLY RESPONSIBLE FOR ANY DAMAGES CAUSED BY HIS FAILURE TO EXACTLY LOCATE AND PRESERVE THESE UNDERGROUND FACILITIES.

WARNING-OVERHEAD ELECTRICAL FACILITIES

OVERHEAD LINES MAY EXIST ON THE PROPERTY. WE HAVE NOT ATTEMPTED TO MARK THOSE LINES SINCE THEY ARE CLEARLY VISIBLE. BUT YOU SHOULD LOCATE THEM PRIOR TO BEGINNING ANY CONSTRUCTION. TEXAS LAW SECTION 792. HEALTH & SAFETY CODE, FORBIDS ALL ACTIVITIES IN WHICH PERSONS OR THINGS MAY COME WITHIN SIX (6) FEET OF LIVE OVERHEAD HIGH VOLTAGE LINES. PARTIES RESPONSIBLE FOR THE WORK, INCLUDING CONTRACTORS, ARE LEGALLY RESPONSIBLE FOR THE SAFETY OF CONSTRUCTION WORKS UNDER THIS LAW. THIS LAW CARRIES BOTH CRIMINAL AND CIVIL LIABILITY TO ARRANGE FOR LINES TO BE TURNED OFF OR REMOVED CALL CENTERPOINT ENERGY AT (713) 207-2222.

WATER

WORK NEAR LARGE DIAMETER WATER LINES (24-INCH AND LARGER)

- PERFORM CRITICAL LOCATION OF WATER LINE IN ACCORDANCE WITH COH SPECIFICATION 02317 USING A NON-PROBING, NON-WATER JETTING METHOD OF VACUUM EXCAVATION.
- FOR UTILITIES PARALLEL TO LARGE DIAMETER WATER LINES PROVIDE A MINIMUM HORIZONTAL CLEARANCE EQUAL TO THE ONE INCH DIAMETER OF THE WATER LINE (FOUR FEET MINIMUM) BETWEEN THE OUTSIDE OF THE WATER LINE AND THE PROPOSED.
- FOR UTILITIES CROSSING LARGE DIAMETER WATER LINES BORES SHALL BE DRY-BORE CONSTRUCTION, WITH NET BORING NOT ALLOWED WITHIN ONE PIPE DIAMETER OF WATER LINE (FOUR FOOT MINIMUM).
- WHEN UTILIZING BORE CONSTRUCTION, PROVIDE A MINIMUM FOUR FEET (ABOVE) VERTICAL CLEARANCE BETWEEN THE OUTSIDE OF THE WATER LINE AND THE PROPOSED UTILITY, IF BELOW LARGE WL.
- WHEN UTILIZING OPEN-OUT CONSTRUCTION, PROVIDE A MINIMUM OF TWO FEET VERTICAL CLEARANCE BETWEEN THE OUTSIDE OF THE WATER LINE AND THE ABOVE PROPOSED UTILITY. CONTRACTOR IS LIMITED TO HAND EXCAVATION WITHIN FOUR FEET VERTICALLY AND HORIZONTALLY OF THE WATER LINE, 14" OF BELOW LARGE WL.
- NO CONSTRUCTION RELATED ACTIVITIES INCLUDING, BUT NOT LIMITED TO, LOADING OF DUMP TRUCKS AND MATERIAL STAGING OR STORAGE ARE TO BE PERFORMED ON TOP OF EXISTING LARGE DIAMETER WATER LINES.

Texas 811
811 OR
(1-800-344-8377)
CALL 811 OR (1-800-344-8377) TO REPORT
POTENTIAL PROBLEMS TO 24 HOURS
SET PLANT SCALE 1 TO 1
SET PLANT SCALE 1 TO 1



THIS DRAWING IS COPYRIGHTED AND IS THE SOLE PROPERTY OF AT&T. IT IS PRODUCED SOLELY FOR USE BY AT&T AND ITS AFFILIATES. REPRODUCTION OR USE OF THIS DRAWING AND/OR THE INFORMATION CONTAINED IN IT IS FORBIDDEN WITHOUT THE WRITTEN PERMISSION OF AT&T.

REV	DATE	DESCRIPTION	BY

REVISIONS



634 N. BALLARD
WYLLIE, TX 75098
OFFICE: 972-442-7005
FAX: 972-442-7087

TEO ENGINEERING ORGANIZATION, LLC 5910 COMMUNITY DR. HOUSTON, TX 77055 281-536-5123 OFFICE 713-668-6234 FAX TEOLL@GMAIL.COM TX FIRM NO. F-6978	THIS DOCUMENT IS RELEASED FOR INTERVIEW ONLY UNDER THE AUTHORITY OF E. GALVAN P.E. SERIAL NO. 55208 ON: JANUARY 29, 2008 IT IS NOT TO BE USED FOR CONSTRUCTION, BIDDING, OR PERMIT PURPOSES.
---	--

SITE NAME

CRAN_RSTX_HSTNW_010

SITE ADDRESS

1022 SQUIRREL RD.
RICHMOND, TX
FORT BEND CO, USA

NOTE: CITY SIGNATURES VALID FOR ONE YEAR ONLY
AFTER DATE OF SIGNATURES

CITY OF HOUSTON DEPARTMENT OF PUBLIC WORKS AND ENGINEERING	
WATER	TRAFFIC AND TRANSPORTATION
WASTEWATER	STORM AND WATER QUALITY
STORM	FACILITIES

DESIGNED BY:	FOR CITY OF HOUSTON USE ONLY
DRAWN BY:	
SCALE:	

SHEET:	TOTAL SHEETS:
03	05

HOUSTON, TX
FORT BEND COUNTY

KEY MAP NO: 565X

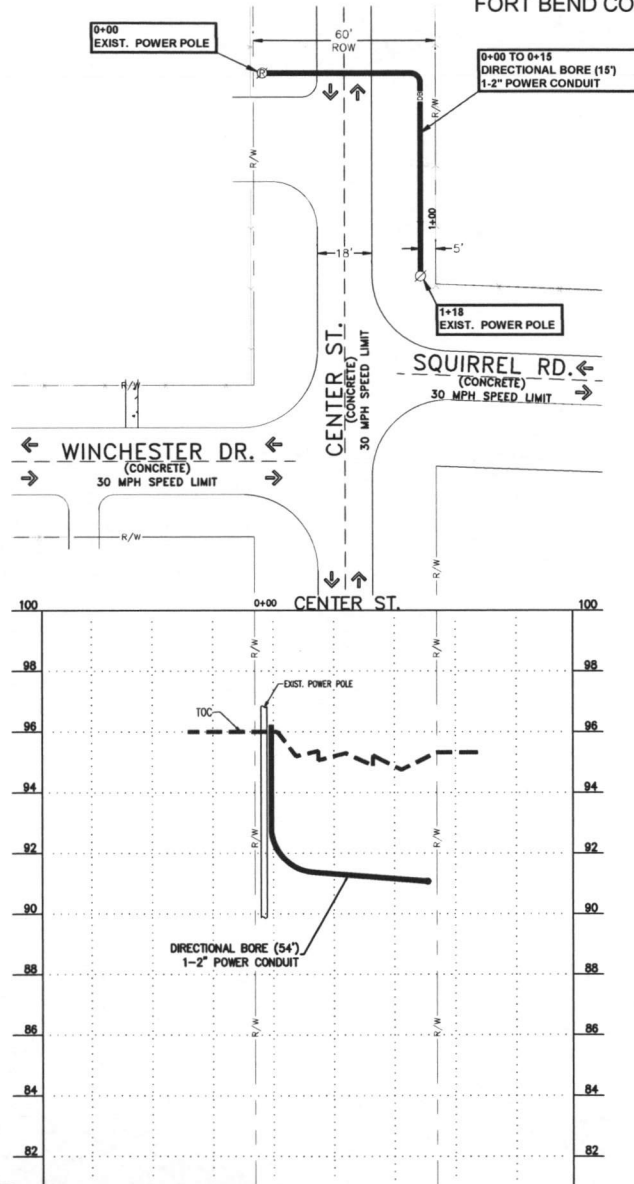

MATERIAL TOTALS	
DESCRIPTION	QTY
PLACE 24X24 HH	0.67
DIR BORE 2.1 2510 HIDE	0.67
12AWG PRO TRACE HDQ CCS PE45	0.67
PLACE XXXX FOC	0.67
XXXX FOC SLACK COIL	0.67
PLACE MARKER	0.67
PLACE SPLICE CASE	0.67
PLACE POWER CONDUIT	118.67
CORE BORE	0.67

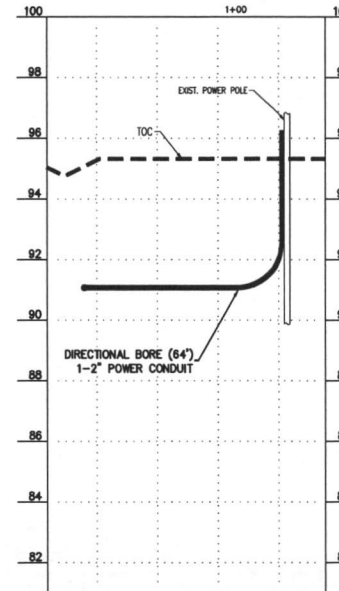

UTILITY & S.W. REPRESENTED ON PLANS ARE BASED ON RECORDS INFORMATION NOT BASED ON EXISTING SURVEY & FIELD EXPOSURES.

ALL UTILITIES MUST BE VERIFIED BY POTENTIAL CONTRACTOR TO LOCATE & VERIFY ALL EXISTING UTILITIES PRIOR TO CONSTRUCTION.

CAUTION: CONTRACTOR TO LOCATE & VERIFY ALL EXISTING UTILITIES PRIOR TO CONSTRUCTION.

FOR ALL INSTALLATION REFER TO LAST TYPICAL IN PACKAGE.



		<p>811 OR (1-800-344-8377)</p> <p>CALL 811 PRIOR TO ANY DIGITALLY SCALED TO 1:1 HARD COPY FROM 811 TO 11417 SET PLOT SCALE 1 TO 1</p>	<p>NORTH</p>								
		<p>THIS DRAWING IS COPYRIGHTED AND IS THE SOLE PROPERTY OF AT&T. IT IS PRODUCED SOLELY FOR USE BY AT&T AND ITS AFFILIATES. REPRODUCTION OR USE OF THIS DRAWING AND/OR THE INFORMATION CONTAINED HEREIN IS FORBIDDEN WITHOUT THE WRITTEN PERMISSION OF AT&T.</p>									
<table border="1"> <tr> <th>REV</th> <th>DATE</th> <th>DESCRIPTION</th> <th>BY</th> </tr> <tr> <td> </td> <td> </td> <td> </td> <td> </td> </tr> </table>		REV	DATE	DESCRIPTION	BY					<p>REVISIONS</p>	
REV	DATE	DESCRIPTION	BY								
<p>TDC2</p> <p>634 N. BALLARD WYLLIE, TX 75098 OFFICE: 972-442-7005 FAX: 972-442-7087</p>											
<p>TEO ENGINEERING ORGANIZATION LLC 5510 COMMUNITY DR. HOUSTON, TX 77055 281-536-5123 OFFICE 713-666-6334 FAX TEO@TEOENGINEERING.COM TX FIRM NO. F-8878</p>		<p>THIS DOCUMENT IS RELEASED FOR REVIEW ONLY UNDER THE AUTHORITY OF E. GALVAN P.E. SERIAL NO. 35526 ON JANUARY 28, 2018 IT IS NOT TO BE USED FOR CONSTRUCTION, RECORDING, OR PERMIT PURPOSES.</p>									
<p>SITE NAME</p> <p>CRAN_RSTX_HSTNW_010</p>											
<p>SITE ADDRESS</p> <p>1022 SQUIRREL RD. RICHMOND, TX FORT BEND CO, USA</p>											
<p>NOTE: CITY SIGNATURES VALID FOR ONE YEAR ONLY AFTER DATE OF SIGNATURES</p>											
<p>CITY OF HOUSTON DEPARTMENT OF PUBLIC WORKS AND ENGINEERING</p>											
<p>WATER</p>		<p>TRAFFIC AND TRANSPORTATION</p>									
<p>WASTEWATER</p>		<p>STORM AND WATER QUALITY</p>									
<p>STORM</p>		<p>FACILITIES</p>									
<p>DESIGNED BY: TDC2</p>		<p>FOR CITY OF HOUSTON USE ONLY</p>									
<p>DRAWN BY: TDC2</p>		<p>SCALE: 1" = 2' HORIZ 1" = 20' VERT</p>									
<p>SHEET: 04</p>		<p>TOTAL SHEETS: 05</p>									

ILMS NO. -

LOG NO. -

CITY OF HOUSTON
DEPARTMENT OF PUBLIC WORKS AND ENGINEERING
CAPITAL PROJECT DIVISION

- CONTRACTOR SHALL PROVIDE AND INSTALL TRAFFIC CONTROL DEVICES IN CONFORMANCE WITH PART VI OF THE TEXAS MANUAL ON UNIFORM TRAFFIC CONTROL DEVICES (TEXAS M.U.T.C.D.), MOST RECENT EDITION WITH REVISIONS DURING CONSTRUCTION.
- NO LANES SHALL BE CLOSED DURING THE HOURS OF 5:30 AM AND 7:00 PM, MONDAY THRU FRIDAY IN DOWNTOWN/MIDTOWN AREAS.
- NO WORK ON RESIDENTIAL STREETS FROM 7:00 PM TO 7:00 AM, SEVEN DAYS A WEEK.
- CONTRACTOR SHALL COVER OPEN EXCAVATIONS WITH STEEL PLATES ANCHORED PROPERLY DURING NON-WORKING HOUR AND OPEN LANES FOR NORMAL TRAFFIC FLOW.
- OFF DUTY UNIFORM POLICE OFFICER(S)/CERTIFIED FLAGGER(S) IS/ARE REQUIRED TO DIRECT TRAFFIC WHEN LANES ARE BLOCKED.
- IF THE CONTRACTOR CHOOSES TO USE A DIFFERENT METHOD OF "TRAFFIC CONTROL PLANS" DURING THE CONSTRUCTION THAN WHAT IS OUTLINED IN THE CONTRACT DRAWINGS, HE/SHE SHALL BE RESPONSIBLE TO PREPARE AND SUBMIT AN ALTERNATIVE SET OF PLANS TO PLAN REVIEW SECTION FOR APPROVAL TEN WORKING DAYS PRIOR TO IMPLEMENTATION.
 *THESE PLANS SHALL BE DRAWN TO SCALE ON REPRODUCIBLE MYLARS AND SEALED BY A REGISTERED PROFESSIONAL ENGINEER IN THE STATE OF TEXAS. PLANS WILL BECOME A PART OF THE CONTRACT DRAWINGS.
- ALL TRAFFIC CONTROL DEVICES USED AT NIGHT SHALL BE REFLECTORIZED OR ILLUMINATED.
- CONTRACTOR SHALL MAINTAIN LOCAL DRIVEWAY ACCESS TO RESIDENTIAL AND COMMERCIAL PROPERTIES ADJACENT TO WORK AREA AT ALL TIMES.
- CONTRACTOR SHALL NOTIFY FIRE, POLICE, METROPOLITAN TRANSIT AUTHORITY, AND SCHOOLS FIVE WORKING DAYS PRIOR TO IMPLEMENTATION FOR TRAFFIC CONTROLS.
- APPROVED COPIES OF THE TRAFFIC CONTROL PLANS AND LANE CLOSURE PERMITS* SHALL BE AVAILABLE FOR INSPECTION AT JOB SITE AT ALL TIMES.

*CONTRACTOR MUST SECURE "LANESIDE/SIDEWALK CLOSURE PERMITS" FROM CITY'S "TRAFFIC MANAGEMENT AND MAINTENANCE BRANCH" BEFORE CLOSING A LANE/SIDEWALK. THE REQUEST MUST BE MADE AT LEAST 10 BUSINESS DAYS PRIOR TO THE DATE WHICH THE CLOSURE IS SOUGHT. NOTE THAT THE WORKING HOURS MAY BE REGISTERED OR REQUEST MAY BE DENIED. CALL 832-365-3020 FOR AN APPLICATION.

NOTE: WORK ZONE SET-UP WILL NOT REQUIRE LANE CLOSURE AS ALL WORK CAN BE PERFORMED SAFELY BEHIND THE CURB.

CONTRACTOR NOTE:
 NIGHTS AND SUNDAY WORK ONLY.

NOTE:
 CONTRACTOR TO MAINTAIN ACCESS TO ADJACENT PROPERTIES AT ALL TIMES.

- LEGEND**
- SIGN
 - FLAGGER
 - APPROVED CHANNELIZATION DEVICE
 - TRAFFIC FLOW
 - BARRICADE
 - CONSTRUCTION AREA

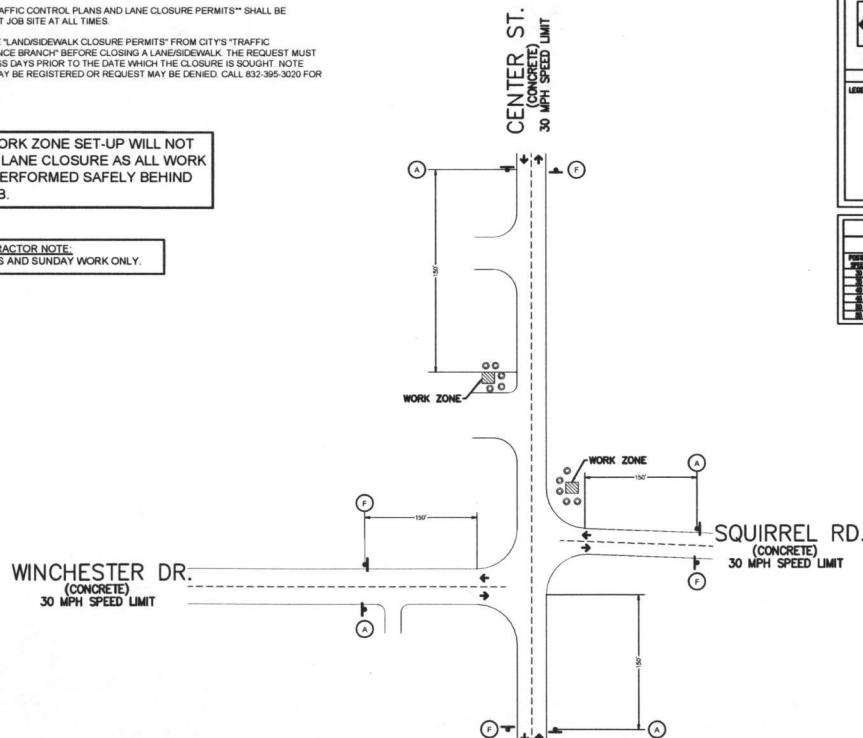
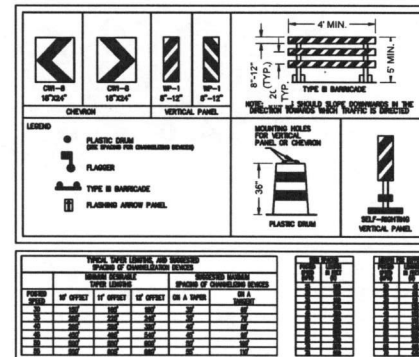
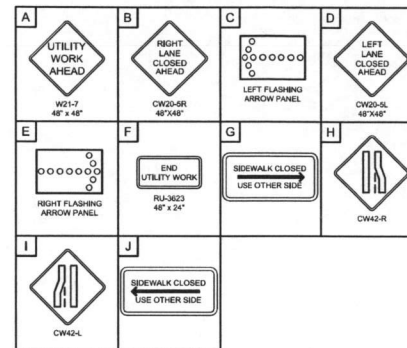
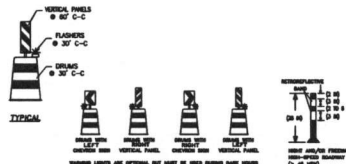

811 OR (1-800-344-8377) FULL SIZE PAPER SIZE TO 2500 SET PLAT SCALE 3 TO 1 HALF SIZE PAPER SIZE TO 11x17 SET PLAT SCALE 1 TO 1											
THIS DRAWING IS COPYRIGHTED AND IS THE SOLE PROPERTY OF AT&T. IT IS PRODUCED SOLELY FOR USE BY AT&T AND ITS AFFILIATES. REPRODUCTION OR USE OF THIS DRAWING AND/OR THE INFORMATION CONTAINED IN IT IS FORBIDDEN WITHOUT THE WRITTEN PERMISSION OF AT&T.											
<table border="1"> <tr> <th>REV</th> <th>DATE</th> <th>DESCRIPTION</th> <th>BY</th> </tr> <tr> <td>A</td> <td>01/28/19</td> <td>FOR CON REVIEW</td> <td>TDC2</td> </tr> </table>				REV	DATE	DESCRIPTION	BY	A	01/28/19	FOR CON REVIEW	TDC2
REV	DATE	DESCRIPTION	BY								
A	01/28/19	FOR CON REVIEW	TDC2								
REVISIONS											
634 N. BALLARD WYLLIE, TX 75098 OFFICE: 972-442-7005 FAX: 972-442-7087											
TEO ENGINEERING ORGANIZATION, LLC 5510 COMMUNITY DR HOUSTON, TX 77055 281-536-5123 OFFICE, 713-668-6234 FAX TEO@GMAIL.COM TX FIRM NO. F-8978		THIS DOCUMENT IS RELEASED FOR INTERIM REVIEW ONLY UNDER THE AUTHORITY OF E. GALVAN P.E. SERIAL NO. 23328 ON JANUARY 23, 2018 IT IS NOT TO BE USED FOR CONSTRUCTION, BIDDING, OR PERMIT PURPOSES.									
SITE NAME											
CRAN_RSTX_HSTNW_010											
SITE ADDRESS											
1022 SQUIRREL RD. RICHMOND, TX FORT BEND CO, USA											
NOTE: CITY SIGNATURES VALID FOR ONE YEAR ONLY AFTER DATE OF SIGNATURES											
CITY OF HOUSTON DEPARTMENT OF PUBLIC WORKS AND ENGINEERING											
WATER	TRAFFIC AND TRANSPORTATION										
WASTEWATER	STORM AND WATER QUALITY										
STORM	FACILITIES										
STREET AND BRIDGE											
DESIGNED BY: TDC2		FOR CITY OF HOUSTON USE ONLY									
DRAWN BY: TDC2											
SCALE: N 1/2 N 1/2											
SHEET: 05	TOTAL SHEET: 05										

ILMS NO. -

LOG NO. -