



**REVIEW BY FORT BEND COUNTY
COMMISSIONERS COURT**

**Fort Bend County
Engineering Department**
301 Jackson Suite 401
Richmond, Texas 77469
281.633.7500
Permits@fortbendcountytexas.gov



Right of Way Permit



Commercial Driveway Permit

Permit No: 2018-20337

Applicant: Crown Castle NG Central LLC

Job Location Site: 17600 W Bellfort Street, Richmond, TX 77407

Bond No. **Date of Bond:** 5/12/2014 **Amount:** \$50,000.00

The above applicant came to make use of certain Fort Bend County property subject to, "The Order Regulating the Laying, Construction, Maintenance, and Repair of Buried Cables, Conduits, and Pole Lines, In, Under, Across or Along Roads, Streets, Highways, and Drainage Ditches in Fort Bend County, Texas, Under the Jurisdiction of the Commissioners Court of Fort Bend County, Texas," as passed by the Commissioners Court of Fort Bend County, Texas, of the Minutes of the Commissioners Court of Fort Bend County, Texas, to the extent that such order is not inconsistent with Chapter 181, Vernon's Texas Statutes and Codes Annotated.

Notes:

1. Evidence of review by the Commissioners Court must be kept on the job site and failure to do so constitutes grounds for job shutdown.
2. Written notices are required:
 - a. 48 hours in advance of construction start up, and
 - b. When construction is completed and ready for final inspection, submit notification to Permit Administrator thru MyGovernmentOnline.org portal.
3. This permit expires one (1) year from date of permit if construction has not commenced.

On this 22nd day of May, 2018, Upon Motion of Commissioner Moyers, seconded by Commissioner Mokales, duly put and carried, it is ORDERED, ADJUDGED AND DECREED that said notice of said above purpose is hereby acknowledged by the Commissioners Court of Fort Bend County, Texas, and that said notice be placed on record according to the regulation order thereof.

Signature

Presented to Commissioners Court and approved.

By: Sean Eglinton

County Engineer

Date Recorded 5-25-2018 Comm. Court No. 13M

N/A

Clerk of Commissioners Court

By:

Drainage District Engineer/Manager

By: Ronda Wilks

Deputy

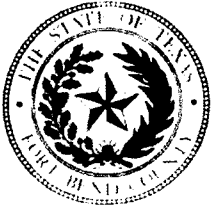

**PERMIT APPLICATION REVIEW FORM FOR
CABLE, CONDUIT, AND POLE LINE ACTIVITY
IN FORT BEND COUNTY**

**Fort Bend County
Engineering Department**
301 Jackson Suite 401
Richmond, Texas 77469
281.633.7500
Permits@fortbendcountytexas.gov

- ☒ Right of Way Permit
☐ Commercial Driveway Permit

Permit No: 2018-20337

The following "Notice of Proposed Cable, Conduit, and/or Pole Line activity in Fort Bend County" and accompanying attachments have been reviewed and the notice conforms to appropriate regulations set by Commissioner's Court of Fort Bend County, Texas.

(1) COMPLETE APPLICATION FORM:

- ☒ a. Name of road, street, and/or drainage ditch affected.
☒ b. Vicinity map showing course of directions
☒ c. Plans and specifications

(2) BOND:

- ☐ County Attorney, approval when applicable.
- ☒ Perpetual bond currently posted. Bond No: [REDACTED] Amount: \$50,000.00
- ☐ Performance bond submitted. Bond No: _____ Amount: _____
- ☐ Cashier's Check Check No: _____ Amount: _____

(3) DRAINAGE DISTRICT APPROVAL (WHEN APPLICABLE):

Drainage District Approval

Date

We have reviewed this project and agree it meets minimum requirements.

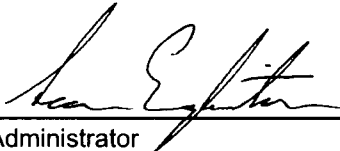

Permit Administrator

5/14/2018

Date

Fort Bend County

Notice of Construction in Right-of-Way

Cluster 55 - W. Belfort St.

**PROPOSED BORED HDPE INNERDUCT AND FIBER TO BE PLACED
ALONG THE SOUTH R.O.W. OF W. BELLFORT ST. FROM FM 1464 TO
S. GRAND PKWY. W.**

Cluster 55

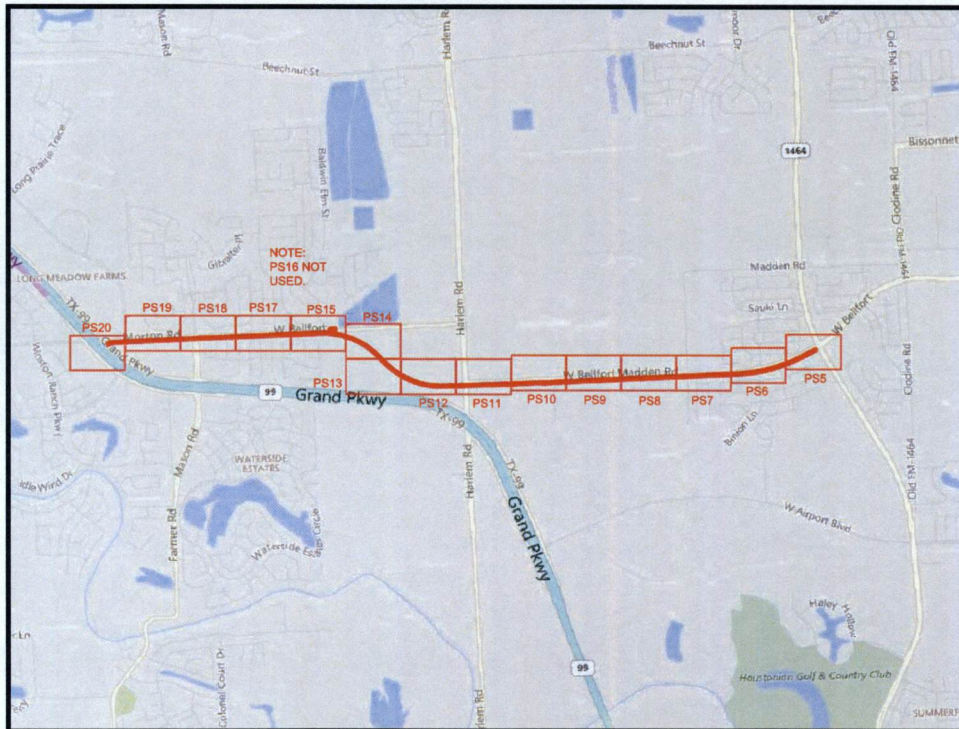

SITE LOCATION

KEY MAP: 526 W, X, Y & Z & 527 W & X

PERMITS REQUIRED /CONTACTS

FORT BEND COUNTY

CARMEN ESCOBAR, CFM
PERMIT ADMINISTRATOR
FORT BEND COUNTY ENGINEERING
281-633-7503

WRITTEN NOTICES ARE REQUIRED:

1. 48 HOURS IN ADVANCE OF START OF CONSTRUCTION.

2. WHEN CONSTRUCTION IS COMPLETE AND READY FOR FINAL INSPECTION, MAIL TO:

PERMIT ADMINISTRATOR/FORT BEND COUNTY ENGINEERING,
P.O. BOX 1449, ROSENBERG, TX 77471

DRAWING LIST

1. COVER SHEET
2. GENERAL NOTES
3. LEGEND
4. PROJECT SHEET 5
5. PROJECT SHEET 6
6. PROJECT SHEET 7
7. PROJECT SHEET 8
8. PROJECT SHEET 9
9. PROJECT SHEET 10
10. PROJECT SHEET 11
11. PROJECT SHEET 12
12. PROJECT SHEET 13
13. PROJECT SHEET 14
14. PROJECT SHEET 15
15. PROJECT SHEET 17 (PS 16 NOT UTILIZED)
16. PROJECT SHEET 18
17. PROJECT SHEET 19
18. PROJECT SHEET 20
19. PROJECT SHEET 20A (AERIAL IMAGE)
20. PROFILE SHEET 1
21. PROFILE SHEET 2
22. PROFILE SHEET 3
23. PROFILE SHEET 4
24. PROFILE SHEET 5
25. PROFILE SHEET 6

DESIGN CONTRACTOR:

Design Co: FiberCom Services, LLC
Designer: Larry Anderson
Phone#: 713-726-1928

CONTRACTOR NOTE

PRIOR TO STARTING THE PROJECT THE CONTRACTOR WILL MEET WITH THE PROJECT MANAGER AT CROWN CASTLE FIBER OFFICE TO GO OVER THE PROJECT DETAILS FOR CONSTRUCTION. THE CONTRACTOR WILL MAKE UP A SET OF DRAWINGS TO ENSURE BOTH THE PROJECT MANAGER AND THE CONTRACTOR HAVE A CLEAR UNDERSTANDING AS TO WHAT IS EXPECTED OF THE CONTRACTOR TO COMPLETE. CONTRACTOR WILL IMMEDIATELY NOTIFY THE PROJECT MANAGER PRIOR TO ANY CHANGES, REQUESTS FROM OTHER AGENCIES AND ALL UNINTENTIONAL INCIDENTALS AND WILL ALSO FOLLOW-UP WITH AN EMAIL STATEMENT REGARDING THE REQUEST.

IT IS THE RESPONSIBILITY OF THE CONTRACTOR TO HAVE A FULL SET OF DRAWINGS, ALL REQUIRED PERMITS AND THE REQUIRED SAFETY ITEMS AT ALL PROJECT LOCATIONS.

IT IS THE RESPONSIBILITY OF THE CONTRACTOR TO SUBMIT A COMPLETE SET OF AS-BUILT DRAWINGS IMMEDIATELY FOLLOWING ALL PERFORMED WORK PRIOR TO INVOICING. ALL AS-BUILT DRAWINGS MUST INCLUDE PICTURES OF ALL PHASES OF PERFORMED WORK. ALL LINE ITEMS THAT REQUIRE PICTURING WILL HAVE PICTURES AS BACKUP, TO THE PERFORMED WORK AREA.

48 HOURS PRIOR TO CONSTRUCTION CONTACT CROWN CASTLE FIBER MANAGEMENT TEAM BY EMAIL NOTIFICATION.

TITLE: CLUSTER 55 - FORT BEND PERMIT
W. BELLFORT FROM FM 1464 TO W. GRAND PKWY. S.

LOC: FORT BEND COUNTY

PMOIR/TGT BUILDING ID: N/A

PLI: KRONK SHORTAGE 54-208-8092

DWG: Fort Bend - W. Belfort St - Cluster 55.dwg

DRAWING DATE ENG DESIGN

ORIGINAL 04/13/18 FCS

Rev'd N/A N/A

AS-BUILT N/A N/A

PAGE: 1

OF: 25

PROPRIETARY INFORMATION OF CROWN CASTLE FIBER



GENERAL NOTES

GENERAL NOTES:

1. CONTRACTOR MUST OBTAIN LOCATES PRIOR TO DISTURBING THE GROUND.
2. THE CONTRACTOR SHALL CONTACT A MEMBER OF TEXAS ONE CALL SYSTEM A MIN. OF 48 HOURS BEFORE DIGGING. YOU ONLY NEED TO CONTACT ONE CENTER. THAT CENTER WILL RELAY THE INFORMATION TO THE OTHER TWO CENTERS.
 - TEXAS ONE CALL 713-223-4567 OR 1-800-245-4545
 - TESS (TEXAS EXCAVATION SAFETY SYSTEM) 811
 - LONE STAR NOTIFICATION SYSTEM 800-669-8344 OR 713-223-4567
 - REMINDER : ANY UNDERGROUND FACILITY OWNERS WHO ARE NOT MEMBERS OF TEXAS ONE CALL, TESS OR LONESTAR
3. NOTIFICATION CENTERS IN THE STATE OF TEXAS, MUST BE CONTACTED DIRECTLY BY THE ORIGINATOR OF THE LOCATION REQUEST.
4. CONTRACTOR MUST HAVE A COPY OF THE APPROVED PERMIT FROM THE APPROPRIATE AGENCY ON THE JOBSITE AT ALL TIMES.
5. THE CONTRACTOR SHALL VERIFY THE ROAD R.O.W. AND EASEMENTS PRIOR TO COMMENCING WORK. NO FACILITIES SHOULD BE PLACED ON PRIVATE PROPERTY UNLESS OTHERWISE SPECIFIED.
6. THE CONTRACTOR SHALL DETERMINE THE EXACT LOCATION OF ALL UNDERGROUND FACILITIES BEFORE COMMENCING WORK AND AGREE TO BE FULLY RESPONSIBLE FOR ALL DAMAGES CAUSED BY HIS FAILURE TO EXACTLY LOCATE AND PRESERVE ALL UNDERGROUND FACILITIES.
7. CONTRACTOR SHALL BE RESPONSIBLE FOR DAMAGES TO EXISTING WATER, WASTEWATER AND STORM DRAINAGE LINES. DAMAGES SHALL BE REPAIRED IN ACCORDANCE WITH THE MUNICIPALITY AGENCY (STATE, COUNTY, OR CITY), DEPARTMENT OF PUBLIC WORKS AND ENGINEERING'S STANDARD CONSTRUCTION SPECIFICATIONS FOR WASTEWATER COLLECTION SYSTEMS, WATER LINES, STORM DRAINAGE, AND STREET PAVING AND STANDARD CONSTRUCTION DETAILS FOR WASTEWATER COLLECTION S SYSTEMS, WATER LINES, STORM DRAINAGE, AND STREET PAVING REFERENCED ABOVE, AT NO ADDITIONAL COST.
8. ALL CABLE WILL BE PLACED AT STANDARD MINIMUM DEPTH. (CROWN CASTLE FIBER STANDARD IS 48" DEEP UNLESS OTHERWISE DIRECTED BY A CROWN CASTLE FIBER REPRESENTATIVE OR SPECIFIED ON THE DRAWING.)
9. NO MORE TRENCH OPENED AT ONE TIME THAN CAN BE BACKFILLED AND COMPACTED IN 10" LIFTS AT THE END OF EACH DAY. (NO TRENCH LEFT OPENED OVERNIGHT)
10. ALL EXCESS EXCAVATION TO BE REMOVED FROM THE ROAD RIGHT-OF-WAY AT THE END OF EACH DAY.
11. ADEQUATE DRAINAGE SHALL BE MAINTAINED AT ALL TIMES DURING CONSTRUCTION AND ANY DRAINAGE DITCH OR STRUCTURE DISTURBED DURING CONSTRUCTION SHALL BE RESTORED TO EXISTING CONDITIONS OR BETTER.
12. ROAD MUST BE KEPT OPEN TO TRAFFIC AND CONTRACTOR MUST PROVIDE ADEQUATE FLAGMEN, SIGNALS, ETC., TO PROVIDE COMPLETE SAFETY TO THE PUBLIC. IF IT BECOMES NECESSARY FOR EQUIPMENT TO OPERATE ON A PORTION OF THE PAVEMENT, PRECAUTIONS MUST BE TAKEN TO PREVENT ANY DAMAGE WHATSOEVER TO THE PAVEMENT.
13. CONDITION OF ROAD UPON COMPLETION OF JOB SHALL BE AS GOOD OR BETTER THAN PRIOR TO STARTING
14. CONTRACTOR SHALL COMPLY WITH LATEST EDITION OF OSHA REGULATIONS AND THE STATE OF TEXAS LAWS CONCERNING EXCAVATION.
15. CONTRACTOR SHALL TAKE NECESSARY PRECAUTIONS TO PROTECT ROOT SYSTEMS OF SHRUBS, PLANTS, AND TREES ALONG THE AREA OF EXCAVATION.
16. NO CONSTRUCTION ON PRIVATE PROPERTY WILL COMMENCE UNTIL RIGHT OF ENTRY OR EASEMENT IS GRANTED.
17. CONTRACTOR SHALL NOT EXCEED THE PURCHASE ORDER VALUE WITHOUT AUTHORIZATION IN WRITING FROM THE APPROPRIATE CROWN CASTLE FIBER REPRESENTATIVE ANY LANDSCAPING WILL BE REPLACED TO EQUAL OR BETTER THAN THAT WHICH EXISTED PRIOR TO WORK.
18. PROJECT SITE WILL BE PROPERLY SECURED PRIOR TO THE END OF EACH DAY.
19. ALL WORK IS TO BE IN ACCORDANCE WITH THE STANDARDS OF ALL AUTHORITIES HAVING JURISDICTION IN THE WORK ZONE.
20. CONTRACTORS ARE ADVISED TO CONTACT CROWN CASTLE FIBER FOR ANY ADDITIONAL INFORMATION OR CLARIFICATION CONCERNING SCOPE OF WORK OR THE REQUIREMENTS NECESSARY FOR PROJECT COMPLETION.
21. CONTRACTOR SHALL FIELD VERIFY ALL DIMENSIONS, QUANTITIES AND EXISTING CONDITIONS PRIOR TO CONSTRUCTION. IF A SIGNIFICANT CHANGE TO THE RUNNING LINE IS NEEDED, PLEASE CONTACT YOUR CROWN CASTLE FIBER REPRESENTATIVE BEFORE PROCEEDING.
22. BEFORE CONSTRUCTION BEGINS, CONTRACTOR SHALL TAKE APPROPRIATE PRECAUTIONS TO AVOID ANY POTENTIAL OBSTRUCTIONS PRIOR TO PROCEEDING WITH WORK.
23. CONTRACTOR SHALL TAKE NECESSARY PRECAUTIONS TO PROTECT ROOT SYSTEMS OF SHRUBS, PLANTS, AND TREES ALONG THE AREA OF EXCAVATION.
24. CONTRACTOR WILL COMPLETE ALL WORK PER "CROWN CASTLE FIBER" CONSTRUCTION SPECIFICATIONS.
25. CONTRACTOR SHALL MAINTAIN A SET OF REDLINE DRAWINGS RECORDING AS-BUILT CONDITIONS DURING CONSTRUCTION. THESE REDLINE MARKED UP DRAWINGS WILL BE SUBMITTED TO THE DESIGN CONSULTANT WHO WILL MAKE THE CHANGES ON THE AS-BUILT RECORD DRAWINGS.
26. RIGHT-OF-WAY WILL BE RESTORED TO EQUAL OR BETTER CONDITION WHEN CONSTRUCTION IS COMPLETE.

ABBR.	DESCRIPTION
B.O.	BUILDING OWNED
B.O.C.	BUILDING OWNED CONDUIT
EOC	EDGE OF CURB
EMT	ELECTRIC METALLIC TUBING
EOP	EDGE OF PAVEMENT
FDP	FIBER DISTRIBUTION PANEL
FF	FINISHED FLOOR
FMC	FLEXIBLE METALLIC CONDUIT
GRC	GALVANIZED RIGID CONDUIT
HDPE	HIGH DENSITY POLYETHYLENE
HH	HANDHOLE
JB	JUNCTION BOX
MH	MANHOLE
PB	PULLBOX
PL	PROPERTY LINE
PVC	POLYVINYL CHLORIDE
ROW	RIGHT OF WAY
SP	SPLICE PANEL
STA.	STATION
S/W	SIDEWALK

APWA STANDARD

COLOR CODE FOR TEMPORARY MARKING OF UNDERGROUND FACILITIES:

RED = ELECTRIC POWERLINES, CABLES, CONDUIT, AND LIGHTING CABLES
YELLOW = GAS, OIL, STEAM, PETROLEUM, OR GASEOUS MATERIAL
ORANGE = COMMUNICATION, ALARM, OR SIGNAL LINES, CABLES, OR CONDUIT
BLUE = POTABLE WATER
GREEN = SEWER AND DRAIN LINES
PURPLE = RECLAIMED WATER, IRRIGATION, AND SLURRY
PINK = TEMPORARY SURVEY MARKINGS
WHITE = PROPOSED EXCAVATION



Know what's below.
Call before you dig.

TITLE: CLUSTER 55 - FORT BEND PERMIT			
W. BELFORT FROM FM 1484 TO W. GRAND PKWY. S.			
LOC:			
FORT BEND COUNTY			
PMO# / TGT BUILDING ID: N/A			
PM: RONNIE SHORTHOSE 348-208-5092			
DWG: Fort Bend - W Belfort St - Cluster 55.dwg			
DRAWING	DATE	ENG DESIGN	
ORIGINAL	04/13/18	RCS	
Revit	N/A	N/A	
AS-BUILT	N/A	N/A	
CROWN FIBER CASTLE			PAGE: 2
PROPRIETARY INFORMATION OF CROWN CASTLE FIBER			OF: 25

LEGEND



BOND



JOINT USE POLE



JOINT USE POLE
W/ TRANSFORMER



POWER POLE



POWER POLE W/
TRANSFORMER



STEEL POLE



CONCRETE POLE



TELCO POLE



PROPOSED
TELCO POLE



EXISTING RISER



PROPOSED RISER



EXISTING DOWN
GUY & ANCHOR



PROPOSED DOWN
GUY & ANCHOR



EXISTING DOWN
GUY



PROPOSED
DOWN GUY



EXISTING S/W
GUY & ANCHOR



PROPOSED S/W
GUY & ANCHOR



EXISTING S/W
GUY



PROPOSED S/W
GUY



EXISTING EXTENDED
MESSENGER



PROPOSED EXTENDED
MESSENGER



OVERHEAD GUY
EXISTING



OVERHEAD GUY
PROPOSED

POLE NO. 1
ATTACHMENT 00'-00"

POLE ATTACHMENT
EXISTING

POLE NO. 1
ATTACHMENT 00'-00"

POLE ATTACHMENT
PROPOSED

P-P= FTG

STRAND FTG. EXISTING

P-P= FTG

STRAND FTG. PROPOSED

MH

0+00
OWNER
MANHOLE
SIZE

MANHOLE
EXISTING

MH

0+00
CC FIBER
MANHOLE
SIZE

MANHOLE
PROPOSED

MH

0+00
OWNER
HANDHOLE
SIZE

HANDHOLE
EXISTING

MH

0+00
CC FIBER
HANDHOLE
SIZE

HANDHOLE
PROPOSED

PB

0+00
OWNER
SIZE

PULLBOX
EXISTING

PB

0+00
CC FIBER
SIZE

PULLBOX
PROPOSED

H-H= FTG
3-1.25"

CONDUIT / INNER-DUCT
FTG. EXISTING

H-H= FTG
3-1.25"

CONDUIT / INNER-DUCT
FTG. PROPOSED

0+00
OWNER
OS-5
COTT

MARKER - EXISTING

0+00
CC FIBER
OS-5
COTT

MARKER - PROPOSED

EXIST LOCATION
SIZE

FDP - EXISTING

EXIST LOCATION
SIZE

FDP - PROPOSED

FF-FF= FTG
1-1.25"

ISP DUCT FTG. EXISTING

FF-FF= FTG
1-1.25"

ISP DUCT FTG. PROPOSED

PB

0+00
OWNER
SIZE

PULLBOX
EXISTING

PB

0+00
CC FIBER
SIZE

PULLBOX
PROPOSED

SIZE

CABLE SIZE
EXISTING

SIZE

CABLE SIZE
PROPOSED

FTG

SLACK LOOP AERIAL
EXISTING

FTG

SLACK LOOP AERIAL
PROPOSED

FTG

SLACK LOOP UG
EXISTING

FTG

SLACK UG
PROPOSED

FTG

SPLICE CASE
EXISTING

FTG

SPLICE CASE
PROPOSED

00 IN
OUT:

FIBER SIZE
IN-OUT SEQUENTIAL

00 IN
TAIL:

FIBER SIZE
IN-TAIL SEQUENTIAL

00 TAIL
OUT:

FIBER SIZE
TAIL-OUT SEQUENTIAL

LAT:
LONG:

LATITUDE &
LONGITUDE

① CONDUIT OWNER: CC FIBER
CONDUIT LENGTH: LENGTH
CONDUIT QUANTITY: QUANTITY
CONDUIT SIZE: SIZE
CONDUIT TYPE: TYPE
NOTE:

① CONDUIT OWNER: CC FIBER
CONDUIT LENGTH: LENGTH
CONDUIT QUANTITY: QUANTITY
CONDUIT SIZE: SIZE
CONDUIT TYPE: TYPE
INNER-DUCT QUANTITY: QUANTITY
INNER-DUCT SIZE: SIZE
INNER-DUCT TYPE: TYPE
NOTE:

① INNER-DUCT OWNER: CC FIBER
INNER-DUCT LENGTH: LENGTH
INNER-DUCT QUANTITY: QUANTITY
INNER-DUCT SIZE: SIZE
INNER-DUCT TYPE: TYPE
NOTE:

① STRAND SIZE: SIZE
STRAND LENGTH: LENGTH
NOTE:

① CABLE FIBERS: FIBERS
CABLE OWNER: CC FIBER
CABLE LENGTH: FTG
NOTES:

① CONDUIT OWNER: CC FIBER
CONDUIT LENGTH: LENGTH
CONDUIT QUANTITY: QUANTITY
CONDUIT SIZE: SIZE
CONDUIT TYPE: TYPE
NOTE:

① CONDUIT OWNER: CC FIBER
CONDUIT LENGTH: LENGTH
CONDUIT QUANTITY: QUANTITY
CONDUIT SIZE: SIZE
CONDUIT TYPE: TYPE
INNER-DUCT QUANTITY: QUANTITY
INNER-DUCT SIZE: SIZE
INNER-DUCT TYPE: TYPE
NOTE:

① INNER-DUCT OWNER: CC FIBER
INNER-DUCT LENGTH: LENGTH
INNER-DUCT QUANTITY: QUANTITY
INNER-DUCT SIZE: SIZE
INNER-DUCT TYPE: TYPE
NOTE:

① STRAND SIZE: SIZE
STRAND LENGTH: LENGTH
NOTE:

① CABLE FIBERS: FIBERS
CABLE OWNER: CC FIBER
CABLE LENGTH: FTG
NOTES:

LINETYPES

EOC	EOC	CIVIL - EDGE OF CURB
EOP	EOP	CIVIL - EDGE OF PAVEMENT
PL	PL	CIVIL - PROPERTY LINE
		CIVIL - RAILROAD TRACKS
R/W	R/W	CIVIL - RIGHT OF WAY
A	A	P - FIBER - AERIAL - EXISTING
A	A	P - FIBER - AERIAL - PROPOSED
		P - FIBER - ISP - EXISTING
		P - FIBER - ISP - PROPOSED
ABAN	ABAN	P - FIBER ABANDON
FX	FX	P - FIBER REMOVE
		P - STRAND EXISTING
		P - STRAND PROPOSED
*	*	P - STRAND-DEMO
		P - DUCT ISP EXISTING
		P - DUCT ISP PROPOSED
B	B	P - FIBER - BURIED - EXISTING
B	B	P - FIBER - BURIED - PROPOSED
		P - DUCT EXISTING
		P - DUCT PROPOSED
G	G	UTILITIES - GAS
SS	SS	UTILITIES - SANITARY SEWER
SL	SL	UTILITIES - STORM
W	W	UTILITIES - WATER



Know what's below.
Call before you dig.

TITLE: CLUSTER 55 - FORT BEND PERMIT			
W. BELLEFORT FROM FM 1464 TO W. GRAND PKWY. S.			
LOC:			
FORT BEND COUNTY			
PMGR / TGT BUILDING ID: N/A			
PM: RONNIE SHORTHORSE 346-208-5052			
DWG: Fort Bend - W. Bellfort St - Cluster 55.dwg			
DRAWING	DATE	ENG DESIGN	
ORIGINAL	04/13/18	FCS	
Rev#1	N/A	N/A	
AS-BUILT	N/A	N/A	
CROWN FIBER		PAGE:	3
CROWN CASTLE		OF:	25
PROPRIETARY INFORMATION OF CROWN CASTLE FIBER			

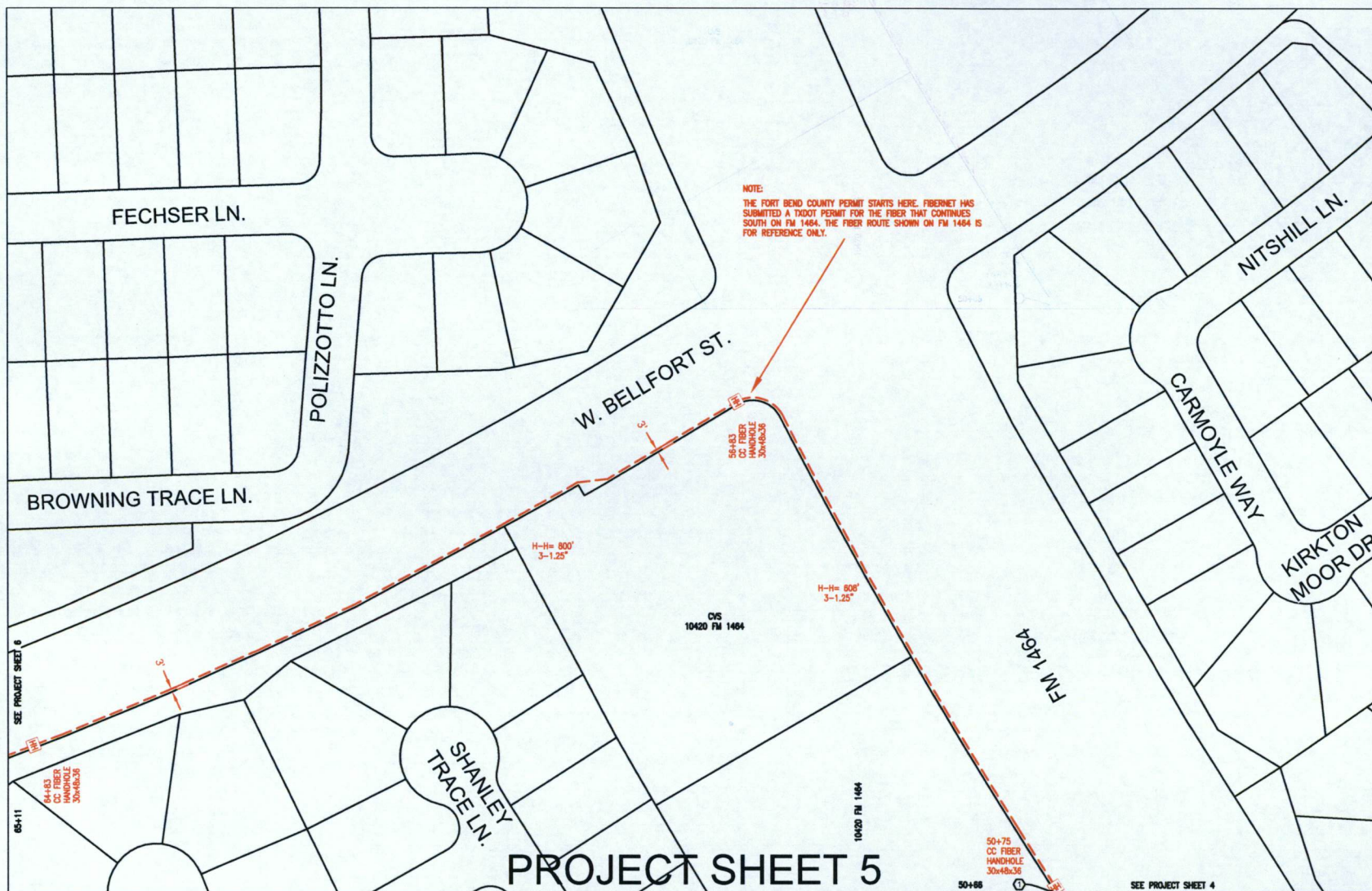

CONSTRUCTION NOTES

FORT BEND COUNTY
 CARMEN ESCOBAR, CFM
 PERMIT ADMINISTRATOR
 FORT BEND COUNTY ENGINEERING
 281-433-7503
 WRITTEN NOTICES ARE REQUIRED:
 1. 48 HOURS IN ADVANCE OF START OF CONSTRUCTION.
 2. WHEN CONSTRUCTION IS COMPLETE AND READY FOR FINAL INSPECTION, MAIL TO:
 PERMIT ADMINISTRATOR/FORT BEND COUNTY ENGINEERING
 P.O. BOX 1449, ROSENBERG, TX 77471

- PROJECT CONSTRUCTION NOTES:
1. ALL PROPOSED U/G CONSTRUCTION SHOWN IN RED ON THIS PLAT WILL INDICATE BORING THREE 1" X 1" HOPE INDUCTS AND ONE FIBER CABLE.
 2. FIBER OPTIC SHOULD BE MINIMUM 48-INCHES UNDER NATURAL GROUND AND UNDER PAVEMENT (INCLUDING ALL PUBLIC CROSS STREETS).
 3. ALL PROPOSED HAND HOLES ARE 30"x48"x36" WITH 100' OF FIBER SLACK LOOP, UNLESS OTHERWISE INDICATED.

PROJECT SHEET 5

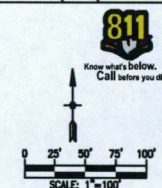

TITLE: CLUSTER 55 - FORT BEND PERMIT			
W. BELLFORT FROM FM 1464 TO W. GRAND PKWY. S.			
LOC: FORT BEND COUNTY			
PMO# / TGT BUILDING ID: N/A			
PM: RONNIE SHORTHORSE 348-208-5092			
DWG: Fort Bend - W. Bellfort St. - Cluster 55.dwg			
DRAWING	DATE	ENG DESIGN	
ORIGINAL	04/13/18	FCS	
Rev#1	N/A	N/A	
AS-BUILT	N/A	N/A	
CROWN CASTLE FIBER			PAGE: 4
PROPRIETARY INFORMATION OF CROWN CASTLE FIBER			OF: 25

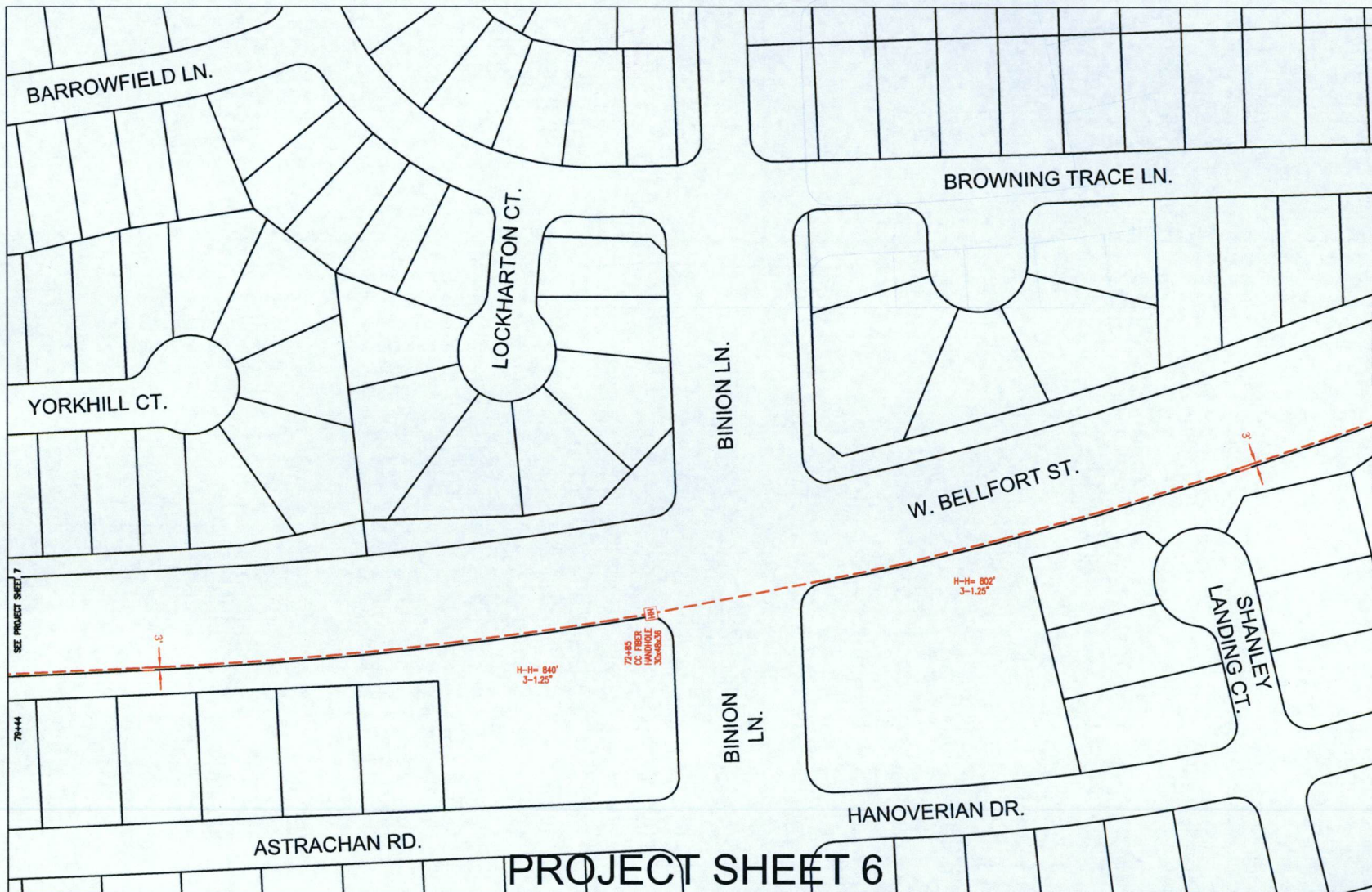

CONSTRUCTION NOTES

FORT BEND COUNTY
 CARMEN ESCOBAR, CFM
 PERMIT ADMINISTRATOR
 FORT BEND COUNTY ENGINEERING
 281-633-7503
 WRITTEN NOTICES ARE REQUIRED:
 1. 48 HOURS IN ADVANCE OF START OF CONSTRUCTION.
 2. WHEN CONSTRUCTION IS COMPLETE AND READY FOR FINAL INSPECTION, MAIL TO:
 PERMIT ADMINISTRATOR/FORT BEND COUNTY ENGINEERING
 P.O. BOX 1448, ROSENBERG, TX 77471

- PROJECT CONSTRUCTION NOTES:
1. ALL PROPOSED U/G CONSTRUCTION SHOWN IN RED ON THIS PLAN WILL INDICATE BORING THREE 1" X" HOPE INNERDUCTS AND ONE FIBER CABLE.
 2. FIBER OPTIC SHOULD BE MINIMUM 48-INCHES UNDER NATURAL GROUND AND UNDER PAVEMENT (INCLUDING ALL PUBLIC CROSS STREETS).
 3. ALL PROPOSED HAND HOLES ARE 30"x48"x36" WITH 100' OF FIBER SLACK LOOP, UNLESS OTHERWISE INDICATED.

SEE PROJECT SHEET 5

65+11

PROJECT SHEET 6

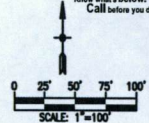

TITLE: CLUSTER 55 - FORT BEND PERMIT			
W. BELLFORT FROM FM 1484 TO W. GRAND PKWY. S.			
LOC:			
FORT BEND COUNTY			
PMO# / TGT BUILDING ID: N/A			
PM: ROBBIE SHORTHORSE 345-208-5082			
DWG: Fort Bend - W. Bellfort St - Cluster 55.dwg			
DRAWING	DATE	ENG DESIGN	
ORIGINAL	04/13/18	FCS	
Revised	N/A	N/A	
AS-BUILT	N/A	N/A	
CROWN FIBER CASTLE			PAGE: 5
PROPRIETARY INFORMATION OF CROWN CASTLE FIBER			OF: 25

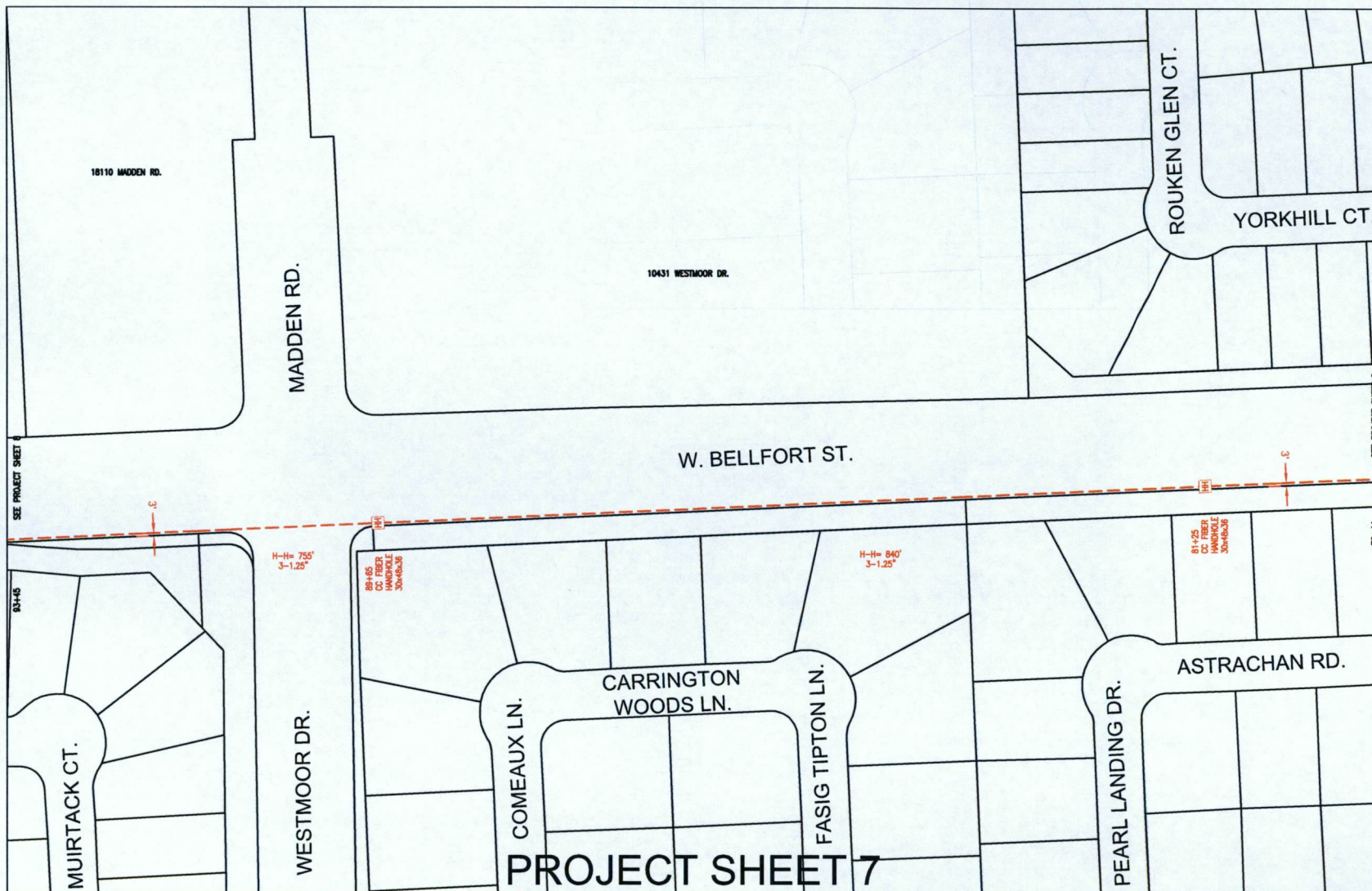

CONSTRUCTION NOTES

FORT BEND COUNTY
CARMEN ESCOBAR, CFM
PERMIT ADMINISTRATOR
FORT BEND COUNTY ENGINEERING
281-633-7503

WRITTEN NOTICES ARE REQUIRED:

1. 48 HOURS IN ADVANCE OF START OF CONSTRUCTION.
2. WHEN CONSTRUCTION IS COMPLETE AND READY FOR FINAL INSPECTION, MAIL TO:

PERMIT ADMINISTRATOR FORT BEND COUNTY ENGINEERING
P.O. BOX 1448, ROSENBERG, TX 77471

PROJECT CONSTRUCTION NOTES:

1. ALL PROPOSED U/G CONSTRUCTION SHOWN IN RED ON THIS PLAT WILL INDICATE BORING THREE (3) 1/2" HOPE INNERDUCTS AND ONE FIBER CABLE.
2. FIBER OPTIC SHOULD BE MINIMUM 48-INCHES UNDER NATURAL GROUND AND UNDER PAVEMENT (INCLUDING ALL PUBLIC CROSS STREETS).
3. ALL PROPOSED HAND HOLES ARE 30"x48"x36" WITH 100' OF FIBER SLACK LOOP, UNLESS OTHERWISE INDICATED.

PROJECT SHEET 7

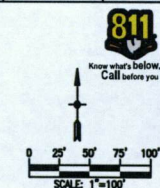

TITLE: CLUSTER 55 - FORT BEND PERMIT			
W. BELLFORT FROM FM 1484 TO W. GRAND PKWY. S.			
LOC: FORT BEND COUNTY			
PMO# / TGT BUILDING ID: N/A			
PMC: RONNIE SHORTHORSE 348-208-5082			
DWG: Fort Bend - W. Bellfort St - Cluster 55.dwg			
DRAWING	DATE	ENG DESIGN	
ORIGINAL	04/13/18	FCS	
Rev#1	N/A	N/A	
AS-BUILT	N/A	N/A	
CROWN FIBER CASTLE			PAGE: 6
PROPRIETARY INFORMATION OF CROWN CASTLE FIBER			OF: 25

CONSTRUCTION NOTES

FORT BEND COUNTY
CARMEN ESCOBAR, CFM
PERMIT ADMINISTRATOR
FORT BEND COUNTY ENGINEERING
281-633-7503

WRITTEN NOTICES ARE REQUIRED:

1. 48 HOURS IN ADVANCE OF START OF CONSTRUCTION.
2. WHEN CONSTRUCTION IS COMPLETE AND READY FOR FINAL INSPECTION, MAIL TO:

PERMIT ADMINISTRATOR/FORT BEND COUNTY ENGINEERING
P.O. BOX 1449, ROSENBERG, TX 77471

PROJECT CONSTRUCTION NOTES:

1. ALL PROPOSED U/G CONSTRUCTION SHOWN IN RED ON THIS PLAT WILL INDICATE BORING THREE 1" N" HDPE INNERDUCTS AND ONE FIBER CABLE.
2. FIBER OPTIC SHOULD BE MINIMUM 48-INCHES UNDER NATURAL GROUND AND UNDER PAVEMENT (INCLUDING ALL PUBLIC CROSS STREETS).
3. ALL PROPOSED HAND HOLES ARE 30"x48"x36" WITH 100' OF FIBER SLACK LOOP, UNLESS OTHERWISE INDICATED.

W. BELLFORT ST.

GLENCORSE AVE.

NISBET XING

WITTET CT.

BATTENROCK CT.

DAFTY PATH

PROJECT SHEET 8



Know what's below.
Call before you dig.

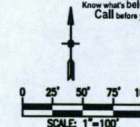

TITLE: CLUSTER 55 - FORT BEND PERMIT
W. BELLFORT FROM FM 1484 TO W. GRAND PKWY. S.

W. BELLFORT FROM FM 1484 TO W. GRAND PKWY. S		
LOC: FORT BEND COUNTY		
PMO# / TGT BUILDING ID: N/A		
PM: RONNIE SHORTHORSE 348-208-5092		
DWG: Fort Bend - W. Bellfort St - Cluster 55.dwg		
DRAWING	DATE	ENG DESIGN
ORIGINAL	04/13/18	FCS
Rev#1	N/A	N/A
AS-BUILT	N/A	N/A

PAGE: 7
OF: 25
CROWN FIBER CASTLE
PROPRIETARY INFORMATION OF CROWN CASTLE FIBER

CONSTRUCTION NOTES

FORT BEND COUNTY
CARMEN ESCOBAR, CFM
PERMIT ADMINISTRATOR
FORT BEND COUNTY ENGINEERING
281-633-7503
WRITTEN NOTICES ARE REQUIRED:
1. 48 HOURS IN ADVANCE OF START OF CONSTRUCTION.
2. WHEN CONSTRUCTION IS COMPLETE AND READY FOR FINAL INSPECTION, MAIL TO:
PERMIT ADMINISTRATOR/FORT BEND COUNTY ENGINEERING
P.O. BOX 1449, ROSENBERG, TX 77471

- PROJECT CONSTRUCTION NOTES:
1. ALL PROPOSED U/G CONSTRUCTION SHOWN IN RED ON THIS PLAT WILL INDICATE BORING THREE 1 1/2" HDPE INNERDUCTS AND ONE FIBER CABLE.
 2. FIBER OPTIC SHOULD BE MINIMUM 48-INCHES UNDER NATURAL GROUND AND UNDER PAVEMENT (INCLUDING ALL PUBLIC CROSS STREETS).
 3. ALL PROPOSED HAND HOLES ARE 30"x48"x36" WITH 100' OF FIBER SLACK LOOP, UNLESS OTHERWISE INDICATED.

W. BELLFORT ST.

H-H= 985'
3-1.25"

114x40
CC FIBER
HANDHOLE
30x48x36

PROJECT SHEET 9

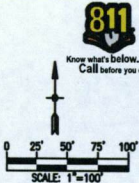

TITLE: CLUSTER 55 - FORT BEND PERMIT			
W. BELLFORT FROM FM 1484 TO W. GRAND PKWY. S.			
LOC: FORT BEND COUNTY			
PMO# / TGT BUILDING ID: N/A			
PM: RONNIE SHORTHORSE 348-206-5092			
DWG: Fort Bend - W. Bellfort St - Cluster 55.dwg			
DRAWING	DATE	ENG DESIGN	
ORIGINAL	04/13/18	FCS	
Rev#1	N/A	N/A	
AS-BUILT	N/A	N/A	
CC CROWN CASTLE FIBER			PAGE: 8
PROPRIETARY INFORMATION OF CROWN CASTLE FIBER			OF: 25

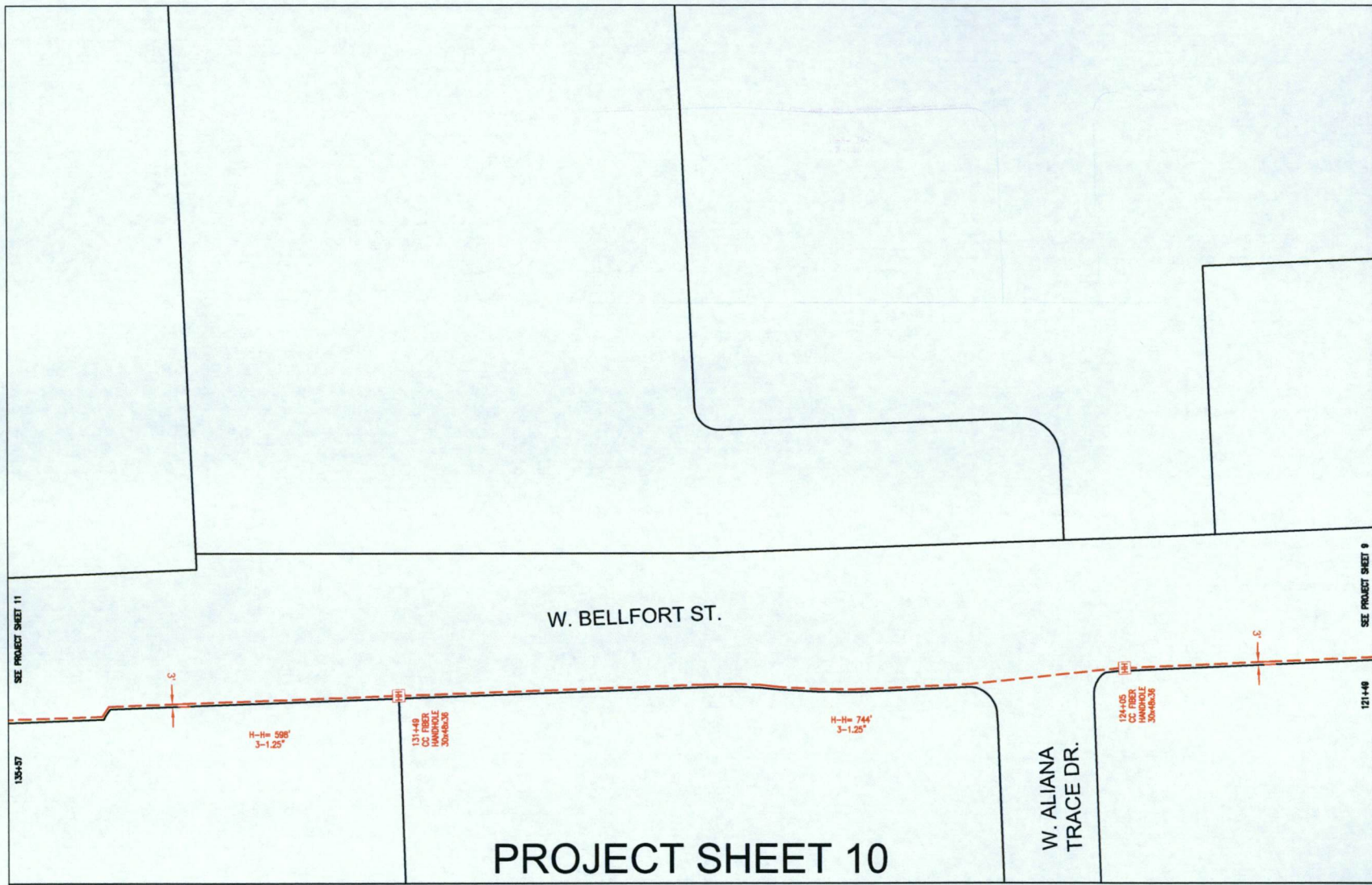

PROJECT SHEET 10

CONSTRUCTION NOTES

FORT BEND COUNTY
 CARMEN ESCOBAR, CFM
 PERMIT ADMINISTER
 FORT BEND COUNTY ENGINEERING
 281-633-7503
 WRITTEN NOTICES ARE REQUIRED:
 1. 48 HOURS IN ADVANCE OF START OF CONSTRUCTION.
 2. WHEN CONSTRUCTION IS COMPLETE AND READY FOR FINAL INSPECTION, MAIL TO:
 PERMIT ADMINISTRATOR/FORT BEND COUNTY ENGINEERING
 P.O. BOX 1448, ROSENBERG, TX 77471

PROJECT CONSTRUCTION NOTES:

1. ALL PROPOSED U/G CONSTRUCTION SHOWN IN RED ON THIS PLAT WILL INDICATE BORING THREE (3) 1/2" HDPE INNERDUCTS AND ONE FIBER CABLE.
2. FIBER OPTIC SHOULD BE MINIMUM 48-INCHES UNDER NATURAL GROUND AND UNDER PAVEMENT (INCLUDING ALL PUBLIC CROSS STREETS).
3. ALL PROPOSED HAND HOLES ARE 30"x48"x36" WITH 100' OF FIBER SLACK LOOP, UNLESS OTHERWISE INDICATED.

SEE PROJECT SHEET 11

SEE PROJECT SHEET 9

135+37

121+48

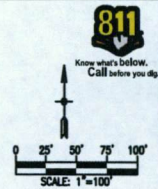

TITLE: CLUSTER 55 - FORT BEND PERMIT			
W. BELLFORT FROM FM 1464 TO W. GRAND PKWY. S.			
LOC: FORT BEND COUNTY			
PMO# / TGT BUILDING ID: N/A			
PRJ. ROOKIE SHORTHOSE: 044-208-5082			
DWG: Fort Bend - W Bellfort St - Cluster 55.dwg			
DRAWING	DATE	ENG DESIGN	
ORIGINAL	04/13/18	FCS	
Revised	N/A	N/A	
AS-BUILT	N/A	N/A	
CROWN CASTLE FIBER			PAGE: 9
PROPRIETARY INFORMATION OF CROWN CASTLE FIBER			OF: 25

SEE PROJECT SHEET 32

152+80

HARLEM RD.

H-H= 750'
3-1.25"147+89
CC FIBER
HANDHOLE
30"x48"x36"

NOTE:

THIS FORT BEND COUNTY PERMIT CONTINUES WEST. FIBERNET DIRECT WILL SUBMIT ANOTHER FORT BEND PERMIT FOR THE FIBER SHOWN CONTINUING NORTH ON HARLEM RD. THE FIBER ROUTE SHOWN CONTINUING UNDER W. BELLFORT ST. AND ON HARLEM RD. IS FOR REFERENCE ONLY.

H-H= 236'
3-1.25"145+53
CC FIBER
HANDHOLE
30"x48"x36"H-H= 734'
3-1.25"H-H= 806'
3-1.25"

W. BELLFORT ST.

CLOUSTON AVE.

HEB
10161 W. GRAND PKWY.

CONSTRUCTION NOTES

FORT BEND COUNTY

CARMEN ESCOBAR, CFM
PERMIT ADMINISTRATOR
FORT BEND COUNTY ENGINEERING
281-633-7503

WRITTEN NOTICES ARE REQUIRED:

1. 48 HOURS IN ADVANCE OF START OF CONSTRUCTION.
2. WHEN CONSTRUCTION IS COMPLETE AND READY FOR FINAL INSPECTION, MAIL TO:

PERMIT ADMINISTRATOR/FORT BEND COUNTY ENGINEERING
P.O. BOX 1449, ROSENBERG, TX 77471

PROJECT CONSTRUCTION NOTES:

1. ALL PROPOSED U/G CONSTRUCTION SHOWN IN RED ON THIS PLAN WILL INDICATE BORING THREE 1" X" HDPE INNERDUCTS AND ONE FIBER CABLE.
2. FIBER OPTIC SHOULD BE MINIMUM 48-INCHES UNDER NATURAL GROUND AND UNDER PAVEMENT (INCLUDING ALL PUBLIC CROSS STREETS).
3. ALL PROPOSED HAND HOLES ARE 30"x48"x36" WITH 100' OF FIBER SLACK LOOP, UNLESS OTHERWISE INDICATED.

SEE PROJECT SHEET 12

146+58

SEE PROJECT SHEET 10

135+57

PROJECT SHEET 11

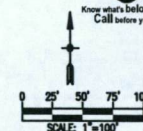

TITLE: CLUSTER 55 - FORT BEND PERMIT			
W. BELLFORT FROM FM 1464 TO W. GRAND PKWY. S.			
LOC:			
FORT BEND COUNTY			
PMOW / TGT BUILDING ID: N/A			
PM: RONNIE SHORTHORSE 344-200-5092			
DWG: Fort Bend - W Bellfort St - Cluster 55.dwg			
DRAWING	DATE	ENG DESIGN	
ORIGINAL	04/13/18	FCS	
Rev#1	N/A	N/A	
AS-BUILT	N/A	N/A	
CROWN CASTLE FIBER			PAGE: 10
PROPRIETARY INFORMATION OF CROWN CASTLE FIBER			OF: 25

SEE PROJECT SHEET 32

CONSTRUCTION NOTES

FORT BEND COUNTY

CARMEN ESCOBAR, CFM
 PERMIT ADMINISTER
 FORT BEND COUNTY ENGINEERING
 281-633-7503

WRITTEN NOTICES ARE REQUIRED:

1. 48 HOURS IN ADVANCE OF START OF CONSTRUCTION.
2. WHEN CONSTRUCTION IS COMPLETE AND READY FOR FINAL INSPECTION, MAIL TO:

PERMIT ADMINISTER/FORT BEND COUNTY ENGINEERING
 P.O. BOX 1449, ROSENBERG, TX 77471

PROJECT CONSTRUCTION NOTES:

1. ALL PROPOSED U/D CONSTRUCTION SHOWN IN RED ON THIS PLAT WILL INDICATE BORING THREE 1 1/4" HDPE INNERDUCTS AND ONE FIBER CABLE.
2. FIBER OPTIC SHOULD BE MINIMUM 48-INCHES UNDER NATURAL GROUND AND UNDER PAVEMENT (INCLUDING ALL PUBLIC CROSS STREETS).
3. ALL PROPOSED HAND HOLES ARE 30"x48"x36" WITH 100' OF FIBER SLACK LOOP, UNLESS OTHERWISE INDICATED.

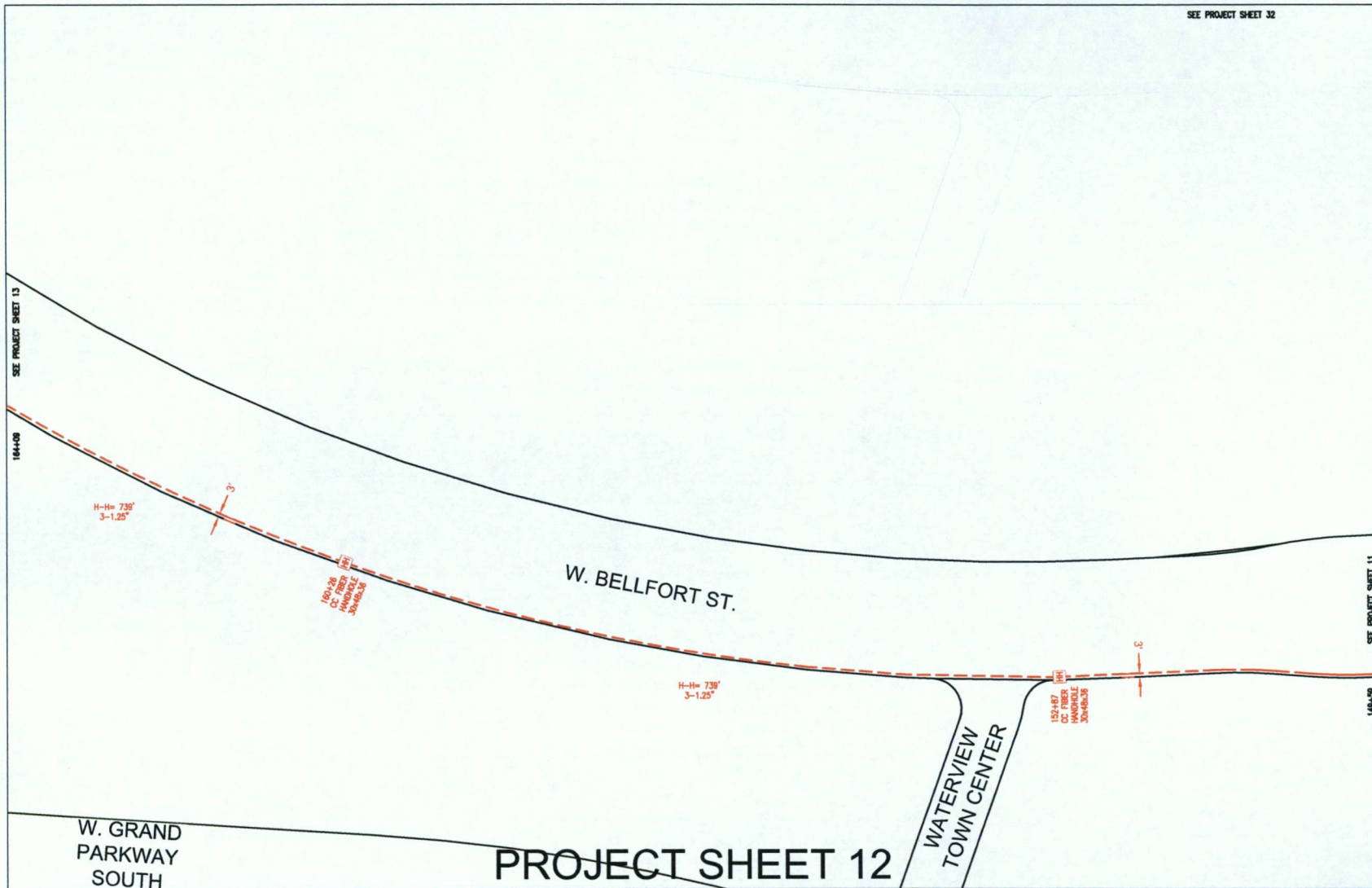

PROJECT SHEET 12

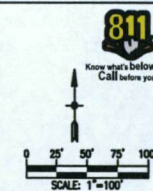
WATERVIEW
TOWN CENTERW. GRAND
PARKWAY
SOUTH

TITLE: CLUSTER 55 - FORT BEND PERMIT			
W. BELLFORT FROM FM 1464 TO W. GRAND PKWY. S.			
LOC: FORT BEND COUNTY			
PMO# / TGT BUILDING ID: N/A			
PME RONNIE SHORTHOUSE 348-208-5092			
DWG: Fort Bend - W Bellfort St - Cluster 55.dwg			
DRAWING	DATE	ENG DESIGN	
ORIGINAL	04/13/18	PCS	
Rev#1	N/A	N/A	
AS-BUILT	N/A	N/A	
CROWN CASTLE FIBER			PAGE: 11
PROPRIETARY INFORMATION OF CROWN CASTLE FIBER			OF: 25

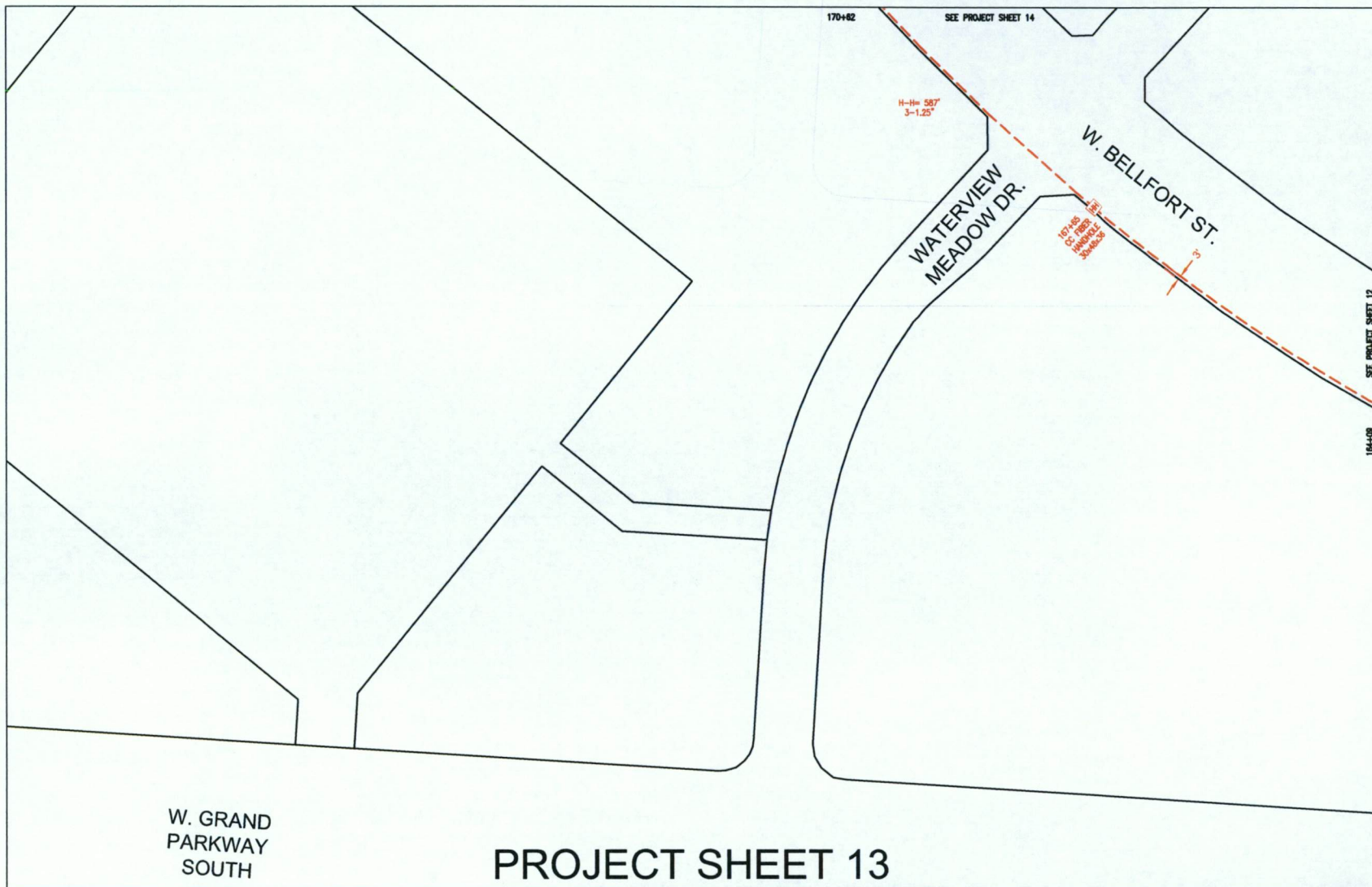

PROJECT SHEET 13

CONSTRUCTION NOTES

FORT BEND COUNTY
 CARMEN ESCOBAR, CFM
 PERMIT ADMINISTRATOR
 FORT BEND COUNTY ENGINEERING
 281-633-7503
 WRITTEN NOTICES ARE REQUIRED:
 1. 48 HOURS IN ADVANCE OF START OF CONSTRUCTION.
 2. WHEN CONSTRUCTION IS COMPLETE AND READY FOR FINAL INSPECTION, MAIL TO:
 PERMIT ADMINISTRATOR/FORT BEND COUNTY ENGINEERING
 P.O. BOX 1449, ROSENBERG, TX 77471

PROJECT CONSTRUCTION NOTES:

1. ALL PROPOSED U/G CONSTRUCTION SHOWN IN RED ON THIS PLAT WILL INDICATE BORING THREE 1 1/2" HDPE INNERDUCTS AND ONE FIBER CABLE.
2. FIBER OPTIC SHOULD BE MINIMUM 48-INCHES UNDER NATURAL GROUND AND UNDER PAVEMENT (INCLUDING ALL PUBLIC CROSS STREETS).
3. ALL PROPOSED HAND HOLES ARE 30"x48"x36" WITH 100' OF FIBER SLACK LOOP, UNLESS OTHERWISE INDICATED.

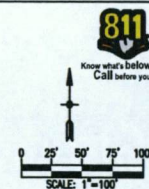

TITLE: CLUSTER 55 - FORT BEND PERMIT			
W. BELLFORT FROM FM 1464 TO W. GRAND PKWY. S.			
LOC: FORT BEND COUNTY			
PMO# / TGT BUILDING ID: N/A			
PM: RONNIE SHORTHORSE 348-200-5092			
DWG: Fort Bend - W Bellfort St - Cluster 55.dwg			
DRAWING	DATE	ENG DESIGN	
ORIGINAL	04/13/18	PES	
Rev'd	N/A	N/A	
AS-BUILT	N/A	N/A	
CROWN CASTLE FIBER			PAGE: 12
PROPRIETARY INFORMATION OF CROWN CASTLE FIBER			OF: 25

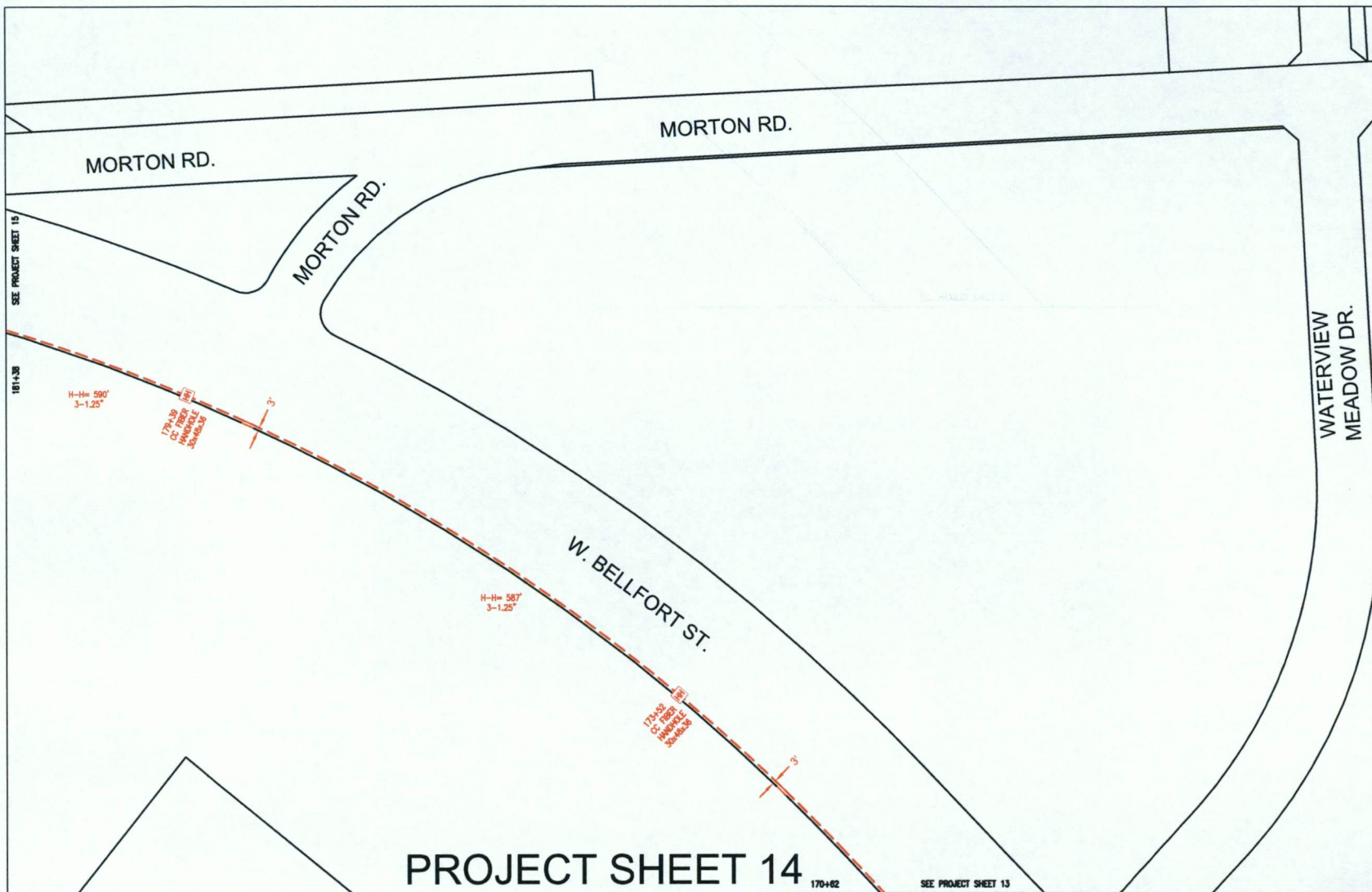

CONSTRUCTION NOTES

FORT BEND COUNTY
 CARMEN ESCOBAR, CFM
 PERMIT ADMINISTER
 FORT BEND COUNTY ENGINEERING
 281-433-7503
 WRITTEN NOTICES ARE REQUIRED:
 1. 48 HOURS IN ADVANCE OF START OF CONSTRUCTION.
 2. WHEN CONSTRUCTION IS COMPLETE AND READY FOR FINAL INSPECTION, MAIL TO:
 PERMIT ADMINISTOR/FORT BEND COUNTY ENGINEERING
 P.O. BOX 1449, ROSENBERG, TX 77471

PROJECT CONSTRUCTION NOTES:

1. ALL PROPOSED U/D CONSTRUCTION SHOWN IN RED ON THIS PLAN WILL INDICATE BORING THREE 1" A" HDPE INNERDUCTS AND ONE FIBER CABLE.
2. FIBER OPTIC SHOULD BE MINIMUM 48-INCHES UNDER NATURAL GROUND AND UNDER PAVEMENT (INCLUDING ALL PUBLIC CROSS STREETS).
3. ALL PROPOSED HAND HOLES ARE 30"x48"x36" WITH 100' OF FIBER SLACK LOOP, UNLESS OTHERWISE INDICATED.

PROJECT SHEET 14

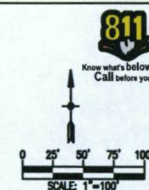

TITLE: CLUSTER 55 - FORT BEND PERMIT			
W. BELFORT FROM FM 1484 TO W. GRAND PKWY. S.			
LOC:			
FORT BEND COUNTY			
PMOW/ TGT BUILDING ID: N/A			
PM: ROANNE SHORRHOES YD-208-5082			
DWG: Fort Bend - W Belfort St - Cluster 55.dwg			
DRAWING	DATE	ENG DESIGN	
ORIGINAL	04/15/18	FCS	
Rev#1	N/A	N/A	
AS-BUILT	N/A	N/A	
CROWN CASTLE FIBER			PAGE: 13
PROPRIETARY INFORMATION OF CROWN CASTLE FIBER			OF: 25

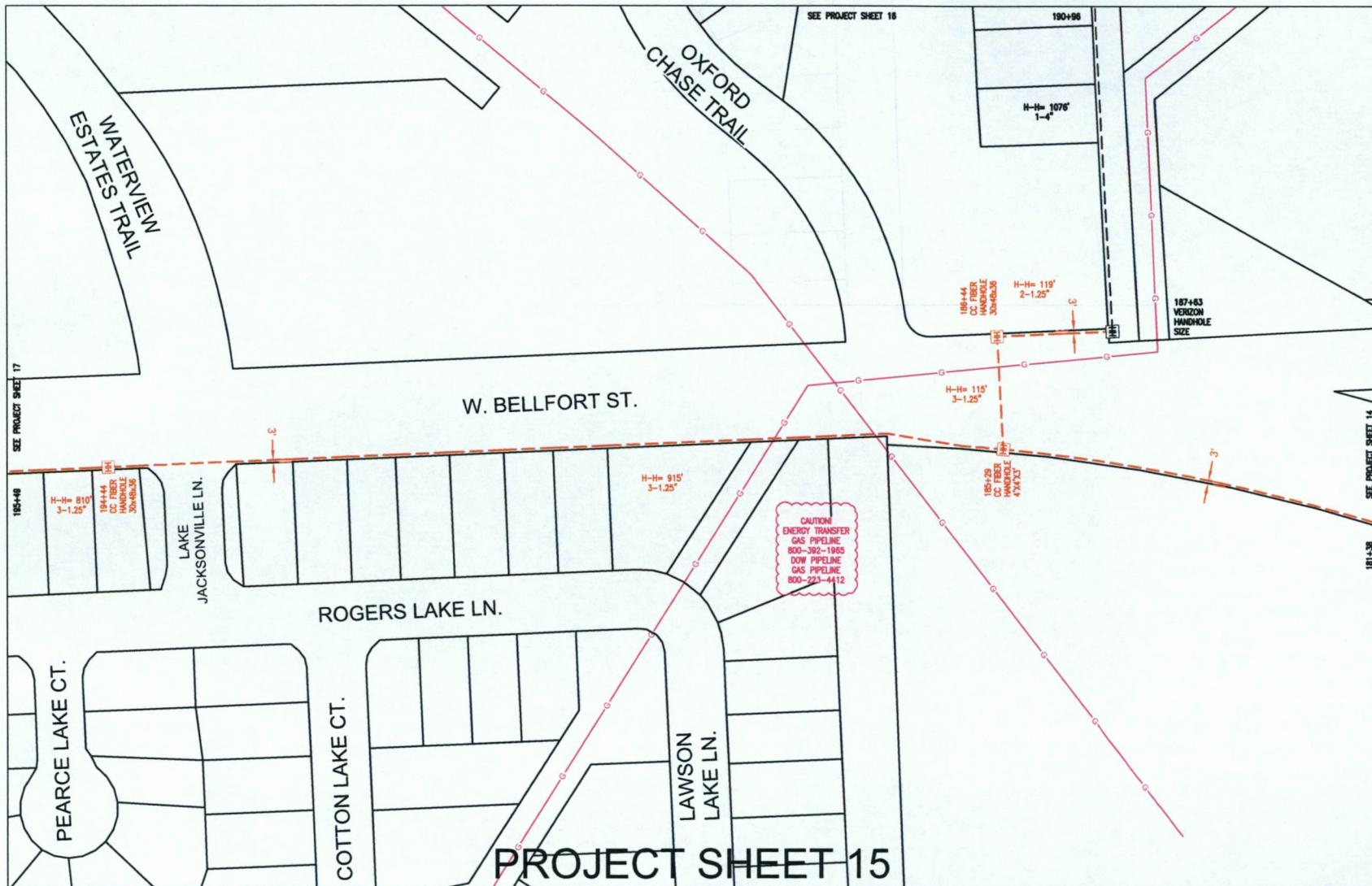

CONSTRUCTION NOTES

FORT BEND COUNTY

CARMEN ESCOBAR, CFM
PERMIT ADMINISTRATOR
FORT BEND COUNTY ENGINEERING
281-653-7503

WRITTEN NOTICES ARE REQUIRED:

1. 48 HOURS IN ADVANCE OF START OF CONSTRUCTION.
2. WHEN CONSTRUCTION IS COMPLETE AND READY FOR FINAL INSPECTION, MAIL TO:

PERMIT ADMINISTRATOR/FORT BEND COUNTY ENGINEERING
P.O. BOX 1449, ROSENBERG, TX 77471

PROJECT CONSTRUCTION NOTES:

1. ALL PROPOSED U/G CONSTRUCTION SHOWN IN RED ON THIS PLAN WILL INDICATE BORING THREE 1" X" HDPE INNERDUCTS AND ONE FIBER CABLE.
2. FIBER OPTIC SHOULD BE MINIMUM 48-INCHES UNDER NATURAL GROUND AND UNDER PAVEMENT (INCLUDING ALL PUBLIC CROSS STREETS).
3. ALL PROPOSED HAND HOLES ARE 30"x48"x36" WITH 100' OF FIBER SLACK LOOP, UNLESS OTHERWISE INDICATED.

CAUTION
ENERGY TRANSFER
GAS PIPELINE
800-392-1965
DOW PIPELINE
GAS PIPELINE
800-221-4412

PROJECT SHEET 15

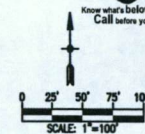

TITLE: CLUSTER 55 - FORT BEND PERMIT			
W. BELLFORT FROM FM 1464 TO W. GRAND PKWY. S.			
LOC: FORT BEND COUNTY			
PMO# / TGT BUILDING ID: N/A			
PM: RONNIE SHORTHOUSE 348-208-5092			
DWS: Fort Bend - W. Bellfort St - Cluster 55.dwg			
DRAWING	DATE	ENG DESIGN	
ORIGINAL	04/13/18	FCS	
Rev#1	N/A	N/A	
AS-BUILT	N/A	N/A	
CROWN CASTLE FIBER			PAGE: 14
PROPRIETARY INFORMATION OF CROWN CASTLE FIBER			OF: 25

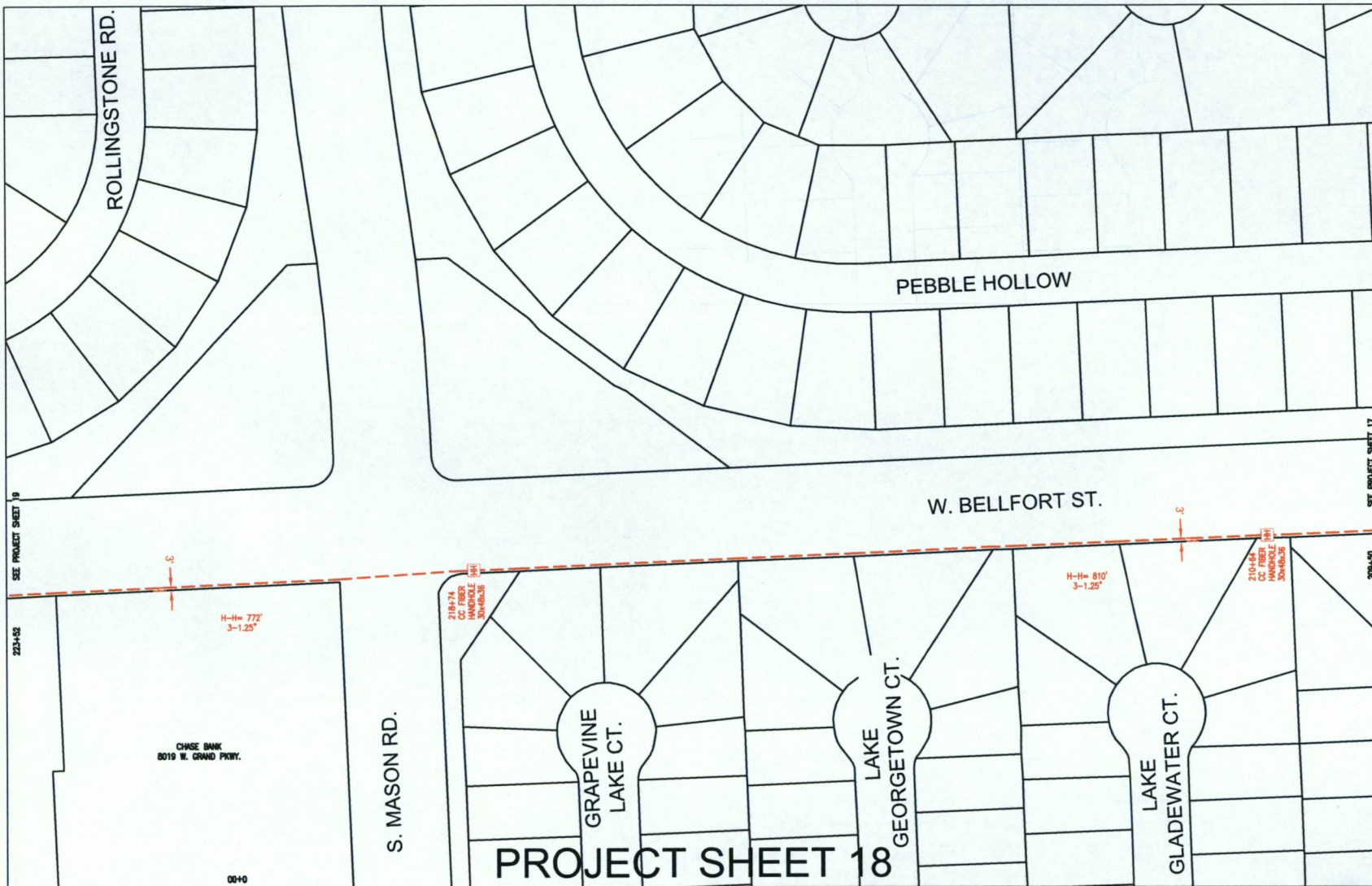

CONSTRUCTION NOTES

FORT BEND COUNTY
 CARMEN ESCOBAR, CFM
 PERMIT ADMINISTER
 FORT BEND COUNTY ENGINEERING
 281-633-7503
 WRITTEN NOTICES ARE REQUIRED:
 1. 48 HOURS IN ADVANCE OF START OF CONSTRUCTION.
 2. WHEN CONSTRUCTION IS COMPLETE AND READY FOR FINAL INSPECTION, MAIL TO:
 PERMIT ADMINISTRATION/FORT BEND COUNTY ENGINEERING
 P.O. BOX 1449, ROSENBERG, TX 77471

- PROJECT CONSTRUCTION NOTES:
1. ALL PROPOSED U/G CONSTRUCTION SHOWN IN RED ON THIS PLAN WILL INDICATE BORING THREE 1 1/2" HDPE INNERDUCTS AND ONE FIBER CABLE.
 2. FIBER OPTIC SHOULD BE MINIMUM 48-INCHES UNDER NATURAL GROUND AND UNDER PAVEMENT (INCLUDING ALL PUBLIC CROSS STREETS).
 3. ALL PROPOSED HAND HOLES ARE 30"x48"x36" WITH 100' OF FIBER SLACK LOOP, UNLESS OTHERWISE INDICATED.

SEE PROJECT SHEET 19

SEE PROJECT SHEET 17

223+42

208+40

CHASE BANK
 8019 W. GRAND PKWY.

00+0

S. MASON RD.

PROJECT SHEET 18

GRAPEVINE
 LAKE CT.

LAKE
 GEORGETOWN CT.

LAKE
 GLADE WATER CT.

W. BELLFORT ST.

H-H= 810'
 3-1.25"

210+44
 CC FIBER
 HANDHOLE
 30"x48"x36"



Know what's below.
 Call before you dig.

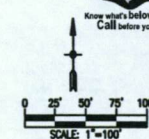

TITLE: CLUSTER 55 - FORT BEND PERMIT			
W. BELLFORT FROM FM 1484 TO W. GRAND PKWY. S.			
LOC: FORT BEND COUNTY			
PMO# / TGT BUILDING ID: N/A			
PLOT NUMBER: SHORTHORSE 340-208-5092			
DWG#: Fort Bend - W Bellfort St - Cluster 55.dwg			
DRAWING	DATE	ENG DESIGN	
ORIGINAL	04/13/18	FCS	
Rev#1	N/A	N/A	
AS-BUILT	N/A	N/A	
CROWN CASTLE FIBER			PAGE: 16
PROPRIETARY INFORMATION OF CROWN CASTLE FIBER			OF: 23

CONSTRUCTION NOTES

FORT BEND COUNTY

CARMEN ESCOBAR, CFM
PERMIT ADMINISTRATOR
FORT BEND COUNTY ENGINEERING
281-633-7503

WRITTEN NOTICES ARE REQUIRED:

1. 48 HOURS IN ADVANCE OF START OF CONSTRUCTION.
2. WHEN CONSTRUCTION IS COMPLETE AND READY FOR FINAL INSPECTION, MAIL TO:

PERMIT ADMINISTRATOR/FORT BEND COUNTY ENGINEERING
P.O. BOX 1449, ROSENBERG, TX 77471

PROJECT CONSTRUCTION NOTES:

1. ALL PROPOSED U/G CONSTRUCTION SHOWN IN RED ON THIS PLAT WILL INDICATE BORING THREE 1/2" HDPE INNERDUCTS AND ONE FIBER CABLE.
2. FIBER OPTIC SHOULD BE MINIMUM 48-INCHES UNDER NATURAL GROUND AND UNDER PAVEMENT (INCLUDING ALL PUBLIC CROSS STREETS).
3. ALL PROPOSED HAND HOLES ARE 30"x48"x36" WITH 100' OF FIBER SLACK LOOP, UNLESS OTHERWISE INDICATED.

W. BELLFORT ST.

PROJECT SHEET 19

KROGER MARKETPLACE
8011 W. GRAND PKWY.

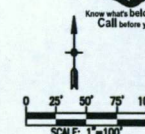

TITLE: CLUSTER 55 - FORT BEND PERMIT			
W. BELLFORT FROM FM 1464 TO W. GRAND PKWY. S.			
LOC: FORT BEND COUNTY			
PMO# / TGT BUILDING ID: N/A			
PM: RONNIE SHORTRIDGE 146-208-5092			
DWG: Fort Bend - W Bellfort St - Cluster 55.dwg			
DRAWING	DATE	ENG DESIGN	
ORIGINAL	04/13/18	FCS	
Rev#1	N/A	N/A	
AS-BUILT	N/A	N/A	
CROWN CASTLE FIBER			PAGE: 17
PROPRIETARY INFORMATION OF CROWN CASTLE FIBER			OF: 25

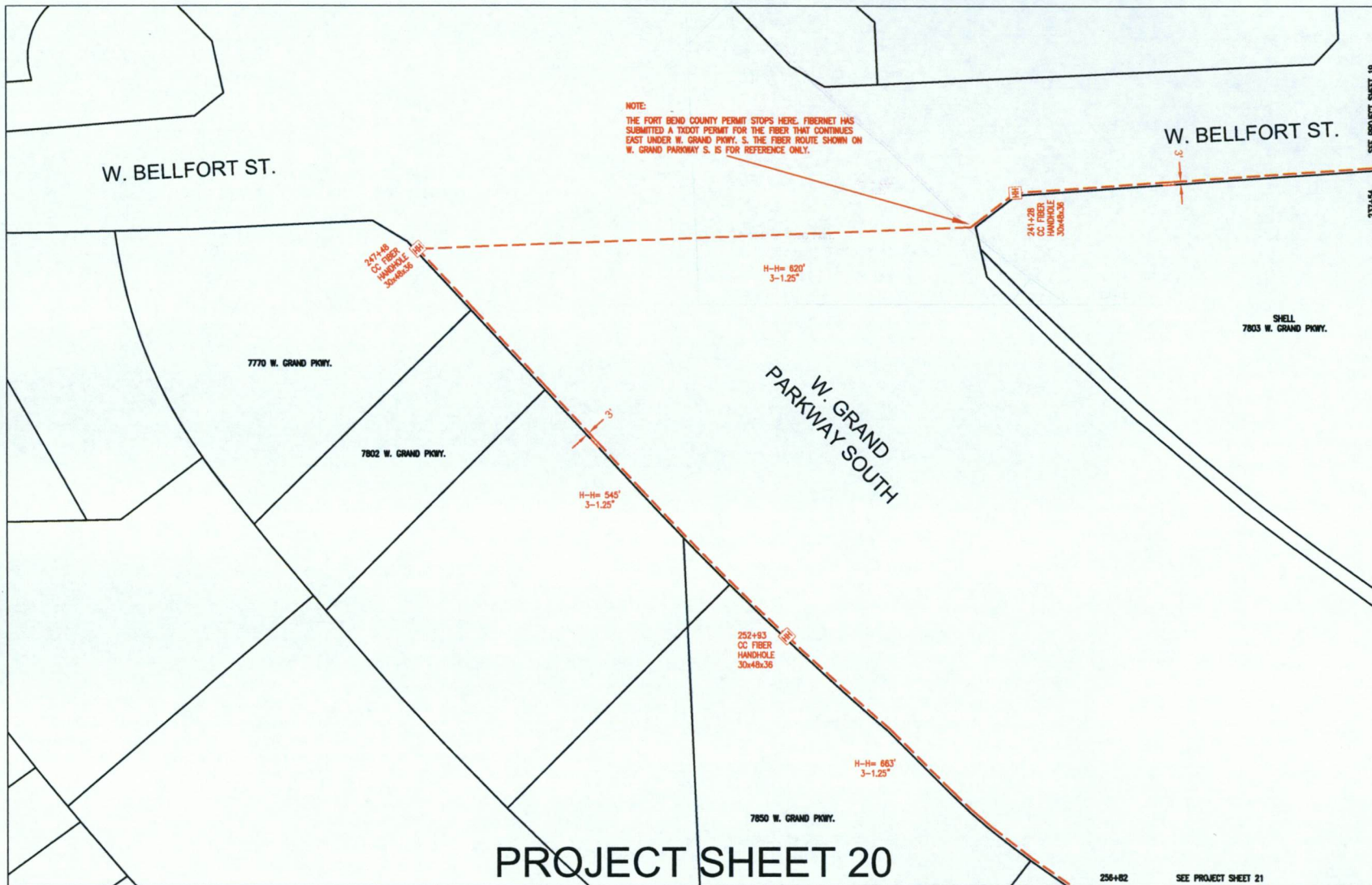

CONSTRUCTION NOTES

FORT BEND COUNTY
CARMEN ESCOBAR, CFM
PERMIT ADMINISTRATOR
FORT BEND COUNTY ENGINEERING
281-633-7503

WRITTEN NOTICES ARE REQUIRED:

1. 48 HOURS IN ADVANCE OF START OF CONSTRUCTION.
2. WHEN CONSTRUCTION IS COMPLETE AND READY FOR FINAL INSPECTION, MAIL TO:

PERMIT ADMINISTRATOR FORT BEND COUNTY ENGINEERING
P.O. BOX 1449, ROSENBERG, TX 77471

PROJECT CONSTRUCTION NOTES:

1. ALL PROPOSED U/G CONSTRUCTION SHOWN IN RED ON THIS PLAN WILL INDICATE BORING THREE 1 1/2" HDPE INNERDUCTS AND ONE FIBER CABLE.
2. FIBER OPTIC SHOULD BE MINIMUM 48-INCHES UNDER NATURAL GROUND AND UNDER PAVEMENT (INCLUDING ALL PUBLIC CROSS STREETS).
3. ALL PROPOSED HAND HOLES ARE 30"x48"x36" WITH 100' OF FIBER SLACK LOOP, UNLESS OTHERWISE INDICATED.



Know what's below.
Call before you dig.

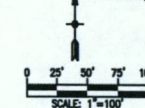

TITLE: CLUSTER 55 - FORT BEND PERMIT
W. BELLFORT FROM FM 1484 TO W. GRAND PKWY. S.

LOC:	FORT BEND COUNTY
PMOR / TGT BUILDING ID:	N/A
PM:	RONNIE SHORTHORSE 348-208-8092
DWG:	Fort Bend - W. Bellfort St. - Cluster 55.dwg
DRAWING:	DATE: 04/13/18
ORIGINAL:	DATE: 04/13/18
Rev#1:	N/A
AS-BUILT:	N/A

CC CROWN CASTLE FIBER

PROPRIETARY INFORMATION OF CROWN CASTLE FIBER

PAGE: 18
OF: 25



CONSTRUCTION NOTES

FORT BEND COUNTY
 CARMEN ESCOBAR, CFM
 PERMIT ADMINISTRATOR
 FORT BEND COUNTY ENGINEERING
 261-633-7503

WRITTEN NOTICES ARE REQUIRED:

1. 48 HOURS IN ADVANCE OF START OF CONSTRUCTION.
2. WHEN CONSTRUCTION IS COMPLETE AND READY FOR FINAL INSPECTION, MAIL TO:

PERMIT ADMINISTRATOR FORT BEND COUNTY ENGINEERING
 P.O. BOX 1440, ROSENBERG, TX 77471

- PROJECT CONSTRUCTION NOTES:
1. ALL PROPOSED U/G CONSTRUCTION SHOWN IN RED ON THIS PLAT WILL INDICATE BORING THREE 1 1/2" HDPE INNERDUCTS AND ONE FIBER CABLE.
 2. FIBER OPTIC SHOULD BE MINIMUM 48-INCHES UNDER NATURAL GROUND AND UNDER PAVEMENT (INCLUDING ALL PUBLIC CROSS STREETS).
 3. ALL PROPOSED HAND HOLES ARE 30"x48"x36" WITH 100' OF FIBER SLOPP LOOP, UNLESS OTHERWISE INDICATED.

NOTE:
 EXISTING PARCELS & RIGHT OF WAY ARE BASED ON F.B.C.A.D. GIS MAP. AERIAL IMAGES ARE FROM BING MAPS. THE AERIAL IMAGE WITH THE DESIGN IS FOR REFERENCE ONLY. THE CONTRACTOR SHALL VERIFY THE ROAD RIGHT OF WAY AND EASEMENTS PRIOR TO COMMENCING WORK.

PROJECT SHEET 20A - AERIAL IMAGE FOR REFERENCE ONLY

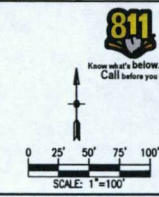

TITLE: CLUSTER 55 - FORT BEND PERMIT			
W. BELLFORT FROM FM 1464 TO W. GRAND PKWY. S.			
LOC: FORT BEND COUNTY			
PMO# / TGT BUILDING ID: N/A			
PM RONNIE SHORTHORSE 348-206-5092			
DWG: Fort Bend - W Bellfort St - Cluster 55.dwg			
DRAWING	DATE	ENG DESIGN	
ORIGINAL	04/13/18	FCS	
Rev#1	N/A	N/A	
AS-BUILT	N/A	N/A	
CROWN CASTLE FIBER			PAGE: 19
PROPRIETARY INFORMATION OF CROWN CASTLE FIBER			OF: 25

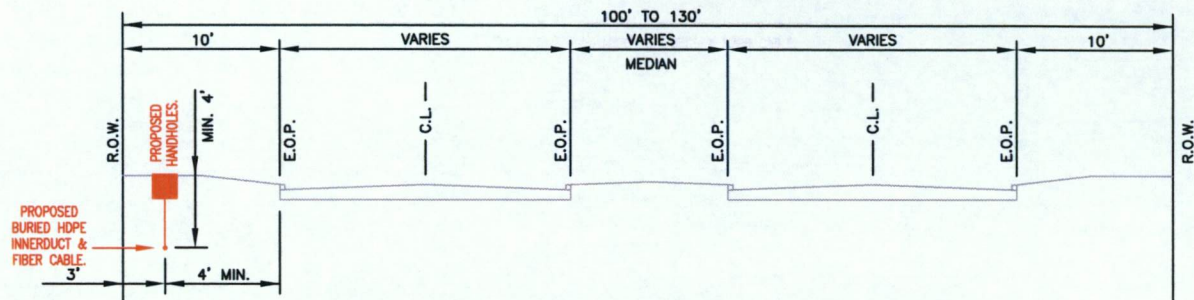

W. BELLFORT ST. FROM FM 1464 TO W. GRAND PKWY. S.
LOOKING WEST

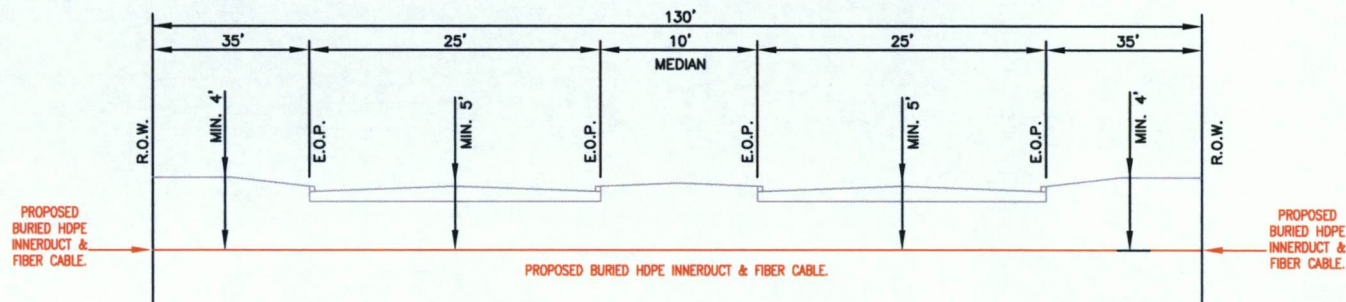

BINION LN. @ W. BELLFORT ST.
LOOKING SOUTH

PROFILE SHEET 1

TITLE: CLUSTER 55 - FORT BEND PERMIT			
W. BELLFORT FROM FM 1464 TO W. GRAND PKWY. S.			
LOC: FORT BEND COUNTY			
PMO# / TGT BUILDING ID: N/A			
PME RONNIE SHORTHORSE 348-208-5092			
DWG: Fort Bend - W. Bellfort St - Cluster 55.dwg			
DRAWING	DATE	ENG DESIGN	
ORIGINAL	04/13/18	FCS	
Rev#1	N/A	N/A	
AS-BUILT	N/A	N/A	
CROWN CASTLE FIBER		PAGE: 20	OF: 25
PROPRIETARY INFORMATION OF CROWN CASTLE FIBER			

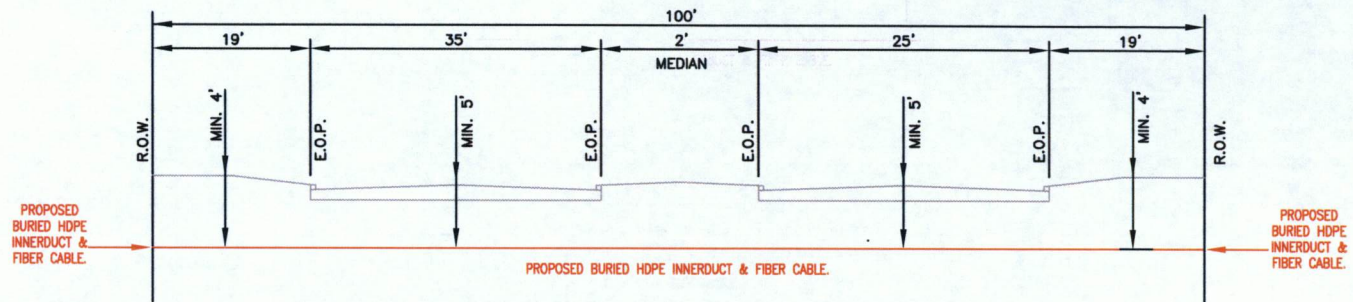

WESTMOOR DR. @ W. BELLFORT ST.
LOOKING SOUTH

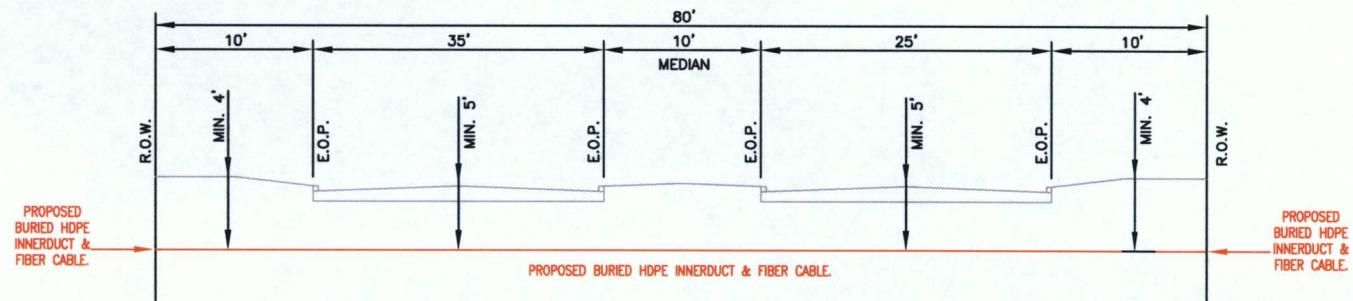

GLENCORSE AVE. @ W. BELLFORT ST.
LOOKING SOUTH

PROFILE SHEET 2

TITLE: CLUSTER 55 - FORT BEND PERMIT			
W. BELLFORT FROM FM 1484 TO W. GRAND PKWY. S.			
LOC:			
FORT BEND COUNTY			
PMO# / TGT BUILDING ID: N/A			
PM: RONNIE SHORTHORSE 348-208-5092			
DWG: Fort Bend - W. Bellfort St - Cluster 55.dwg			
DRAWING	DATE	ENG DESIGN	
ORIGINAL	04/13/18	PCS	
Rev#1	N/A	N/A	
AS-BUILT	N/A	N/A	
			PAGE: 21
			OF: 25
PROPRIETARY INFORMATION OF CROWN CASTLE FIBER			

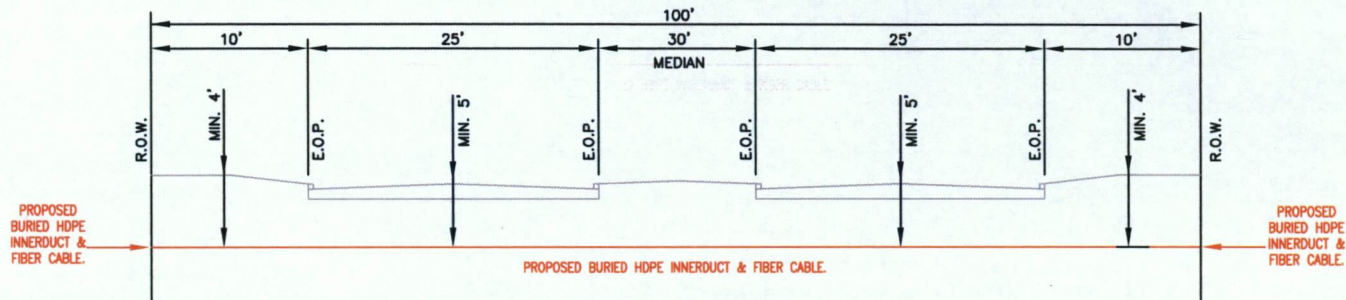

W. ALIANA TRACE DR. @ W. BELLFORT ST.
LOOKING SOUTH

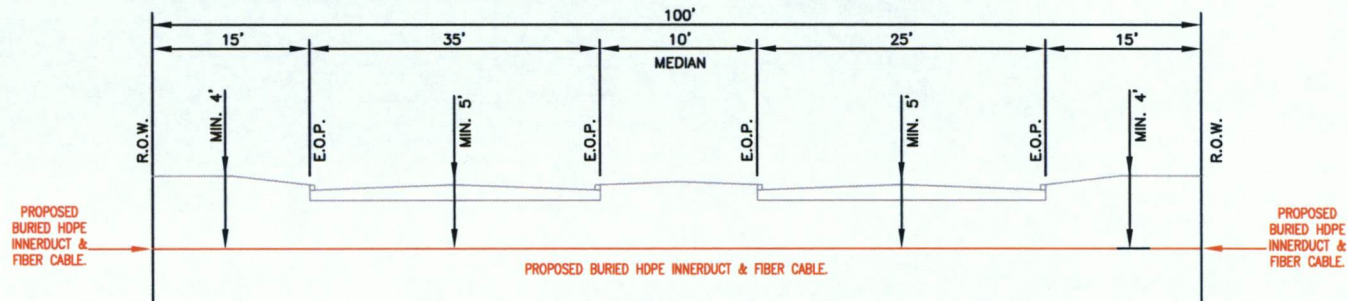

CLOUSTON AVE. @ W. BELLFORT ST.
LOOKING SOUTH

PROFILE SHEET 3

TITLE: CLUSTER 55 - FORT BEND PERMIT			
W. BELLFORT FROM FM 1464 TO W. GRAND PKWY. S.			
LOC: FORT BEND COUNTY			
PMO# / TGT BUILDING ID: N/A			
PM: RONNIE SHORTHORSE 348-208-5082			
DWG: Fort Bend - W. Bellfort St - Cluster 55.dwg			
DRAWING	DATE	ENG DESIGN	
ORIGINAL	04/13/18	PCS	
Rev#1	N/A	N/A	
AS-BUILT	N/A	N/A	
CROWN CASTLE FIBER			PAGE: 22
PROPRIETARY INFORMATION OF CROWN CASTLE FIBER			OF: 25

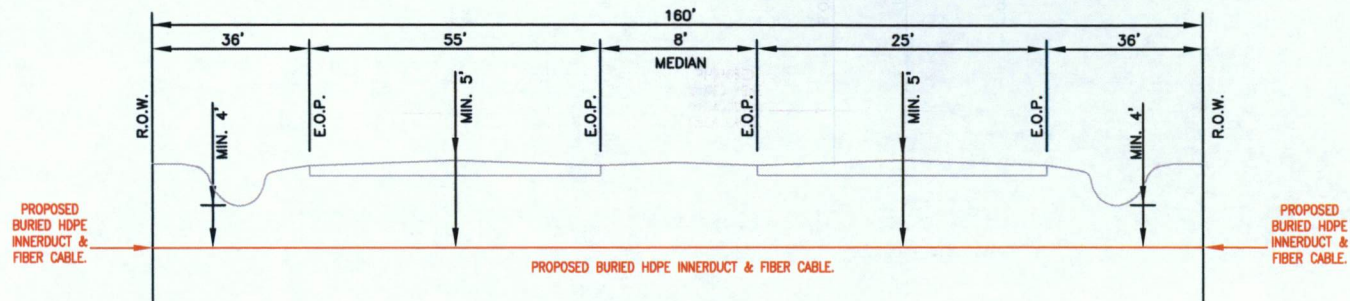

HARLEM RD. @ W. BELLFORT ST.
LOOKING SOUTH

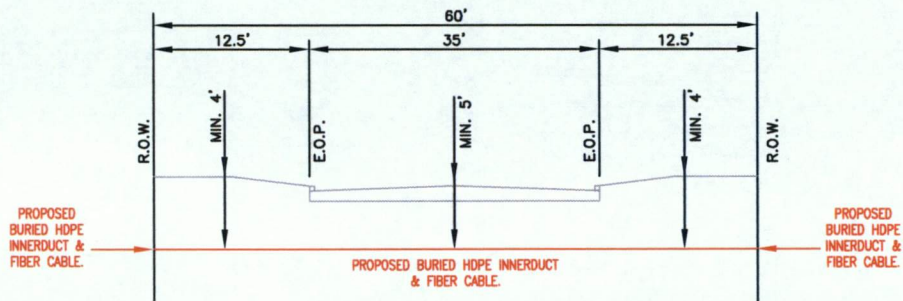

WATERVIEW TOWN CENTER @ W. BELLFORT ST.
LOOKING SOUTH

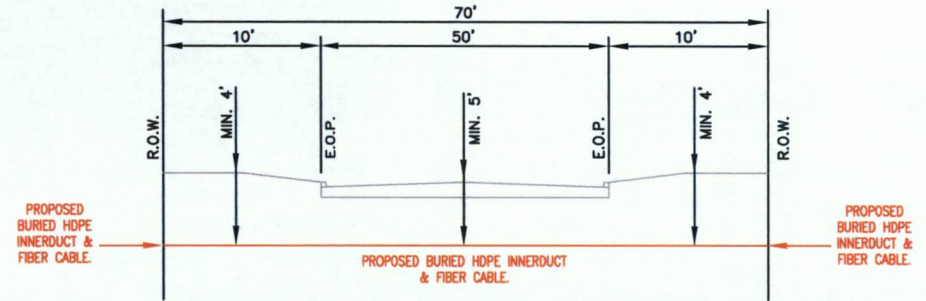

WATERVIEW MEADOW DR. @ W. BELLFORT ST.
LOOKING SOUTH

PROFILE SHEET 4

TITLE: CLUSTER 55 - FORT BEND PERMIT			
W. BELLFORT FROM FM 1484 TO W. GRAND PKWY. S.			
LOC: FORT BEND COUNTY			
PMOR / TGT BUILDING ID: N/A			
PM: RONNIE SHORTHORSE 348-208-5092			
DWG: Fort Bend - W Bellfort St - Cluster 55.dwg			
DRAWING	DATE	ENG DESIGN	FCS
ORIGINAL	04/13/18		
Rev#1	N/A		N/A
AS-BUILT	N/A		N/A
CROWN CASTLE FIBER			PAGE: 23
PROPRIETARY INFORMATION OF CROWN CASTLE FIBER			OF: 25

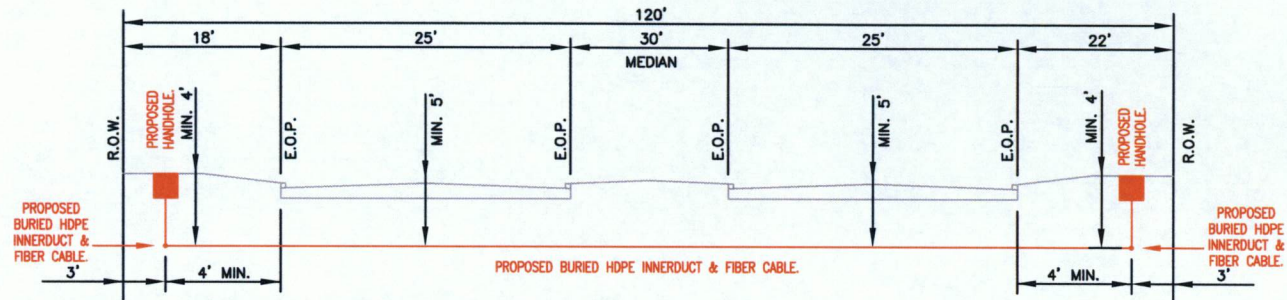

W. BELLFORT ST. @ 120 FT. EAST OF CENTERLINE
OF OXFORD CHASE TRAIL
LOOKING WEST

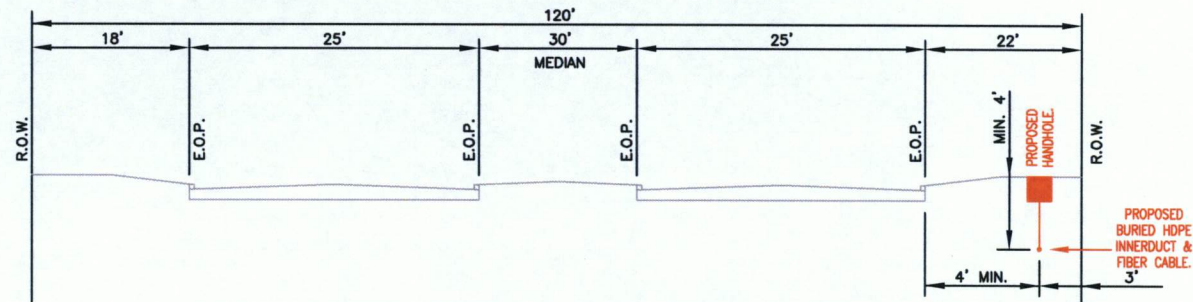

W. BELLFORT ST. FROM 120 FT. EAST OF CENTERLINE
OF OXFORD CHASE TRAIL TO 119 FT. TO THE EAST
LOOKING WEST

PROFILE SHEET 5

TITLE: CLUSTER 55 - FORT BEND PERMIT			
W. BELLFORT FROM FM 1484 TO W. GRAND PKWY. S.			
LOC: FORT BEND COUNTY			
PMO# / TGT BUILDING ID: N/A			
PM: RONNIE SHORTHORSE 348-208-5082			
DWG: Fort Bend - W. Bellfort St - Cluster 55.dwg			
DRAWING	DATE	ENG DESIGN	
ORIGINAL	04/13/18	PCS	
Rev#1	N/A	N/A	
AS-BUILT	N/A	N/A	
CROWN CASTLE FIBER			PAGE: 24
PROPRIETARY INFORMATION OF CROWN CASTLE FIBER			OF: 25

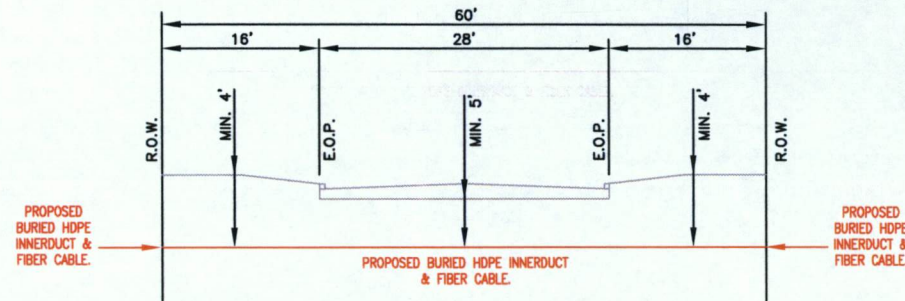

LAKE JACKSON LN. @ W. BELLFORT ST.
LOOKING SOUTH

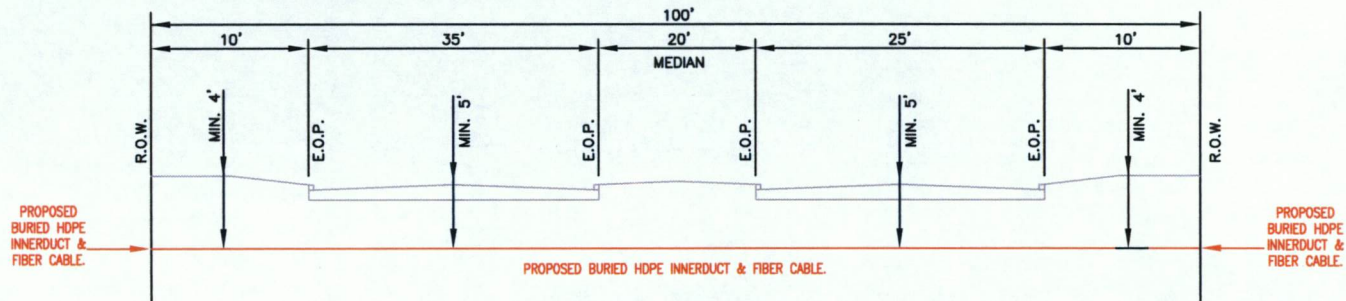

S. MASON RD. @ W. BELLFORT ST.
LOOKING SOUTH

PROFILE SHEET 6

TITLE: CLUSTER 55 - FORT BEND PERMIT			
W. BELLFORT FROM FM 1484 TO W. GRAND PKWY. S.			
LOC: FORT BEND COUNTY			
PMO/ TGT BUILDING ID: N/A			
PLZ KONINK SHORTAGES: 140-208-5092			
DWG: Fort Bend - W Belfort St - Cluster 55.dwg			
DRAWING	DATE	ENG DESIGN	
ORIGINAL	04/13/18	FCS	
Rev#1	N/A	N/A	
AS-BUILT	N/A	N/A	
			PAGE: 25
			OF: 25
PROPRIETARY INFORMATION OF CROWN CASTLE FIBER			

**Notes for Figure 6H-1—Typical Application 1
Work Beyond the Shoulder**

Guidance:

1. *If the work space is in the median of a divided highway, an advance warning sign should also be placed on the left side of the directional roadway.*

Option:

2. The ROAD WORK AHEAD sign may be replaced with other appropriate signs such as the SHOULDER WORK sign. The SHOULDER WORK sign may be used for work adjacent to the shoulder.
3. The ROAD WORK AHEAD sign may be omitted where the work space is behind a barrier, more than 24 inches behind the curb, or 15 feet or more from the edge of any roadway.
4. For short-term, short duration or mobile operation, all signs and channelizing devices may be eliminated if a vehicle with activated high-intensity rotating, flashing, oscillating, or strobe lights is used.
5. Vehicle hazard warning signals may be used to supplement high-intensity rotating, flashing, oscillating, or strobe lights.

Standard:

6. **Vehicle hazard warning signals shall not be used instead of the vehicle's high-intensity rotating, flashing, oscillating, or strobe lights.**

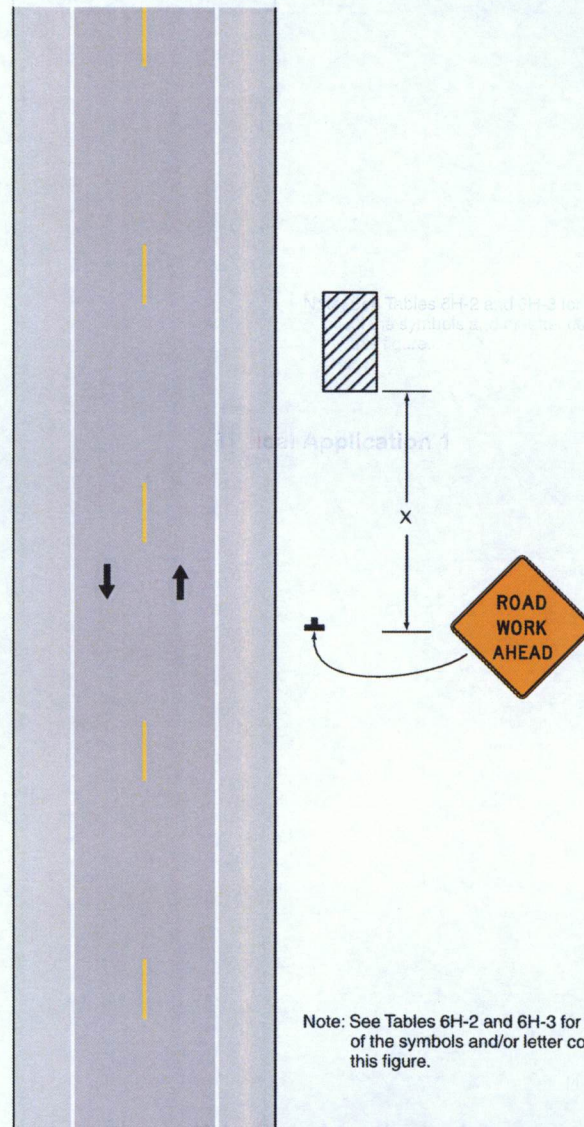

Figure 6H-1. Work Beyond the Shoulder (TA-1)

Note: See Tables 6H-2 and 6H-3 for the meaning of the symbols and/or letter codes used in this figure.

Typical Application 1

Notes for Figure 6H-3—Typical Application 3
Work on the Shoulders

Guidance:

1. A *SHOULDER WORK* sign should be placed on the left side of the roadway for a divided or one-way street only if the left shoulder is affected.

Option:

2. The Workers symbol signs may be used instead of *SHOULDER WORK* signs.
3. The *SHOULDER WORK AHEAD* sign on an intersecting roadway may be omitted where drivers emerging from that roadway will encounter another advance warning sign prior to this activity area.
4. For short duration operations of 60 minutes or less, all signs and channelizing devices may be eliminated if a vehicle with activated high-intensity rotating, flashing, oscillating, or strobe lights is used.
5. Vehicle hazard warning signals may be used to supplement high-intensity rotating, flashing, oscillating, or strobe lights.

Standard:

6. Vehicle hazard warning signals shall not be used instead of the vehicle's high-intensity rotating, flashing, oscillating, or strobe lights.
7. When paved shoulders having a width of 8 feet or more are closed, at least one advance warning sign shall be used. In addition, channelizing devices shall be used to close the shoulder in advance to delineate the beginning of the work space and direct vehicular traffic to remain within the traveled way.



Figure 6H-1, Work Beyond the Shoulder (TA-1)

Figure 6H-3. Work on the Shoulders (TA-3)

