

**REVIEW BY FORT BEND COUNTY
COMMISSIONERS COURT**

**Fort Bend County
Engineering Department**
301 Jackson Suite 401
Richmond, Texas 77469
281.633.7500
Permits@fortbendcountytexas.gov

☒

Right of Way Permit

☐

Commercial Driveway Permit

Permit No: 2018-20399

Applicant: Comcast of Houston, LLC/Binkley & Barfield, Inc.

Job Location Site: Katy Flewellen Road, Katy, TX 77494

Bond No. **Date of Bond:** 7/24/2007 **Amount:** \$100,000.00

The above applicant came to make use of certain Fort Bend County property subject to, "The Order Regulating the Laying, Construction, Maintenance, and Repair of Buried Cables, Conduits, and Pole Lines, In, Under, Across or Along Roads, Streets, Highways, and Drainage Ditches in Fort Bend County, Texas, Under the Jurisdiction of the Commissioners Court of Fort Bend County, Texas," as passed by the Commissioners Court of Fort Bend County, Texas, of the Minutes of the Commissioners Court of Fort Bend County, Texas, to the extent that such order is not inconsistent with Chapter 181, Vernon's Texas Statutes and Codes Annotated.

Notes:

1. Evidence of review by the Commissioners Court must be kept on the job site and failure to do so constitutes grounds for job shutdown.
2. Written notices are required:
 - a. 48 hours in advance of construction start up, and
 - b. When construction is completed and ready for final inspection, submit notification to Permit Administrator thru MyGovernmentOnline.org portal.
3. This permit expires one (1) year from date of permit if construction has not commenced.

On this 8th day of May, 2018, Upon Motion of Commissioner Mayer, seconded by Commissioner Morales, duly put and carried, it is ORDERED, ADJUDGED AND DECREED that said notice of said above purpose is hereby acknowledged by the Commissioners Court of Fort Bend County, Texas, and that said notice be placed on record according to the regulation order thereof.

Signature

Presented to Commissioners Court and approved.

By:

Rick J. Staigle, PE, PTOE
County Engineer

Date Recorded 5-10-2018 Comm. Court No. 12A

N/A

Clerk of Commissioners Court

By:

Drainage District Engineer/Manager

By:

Konda Willis
Deputy

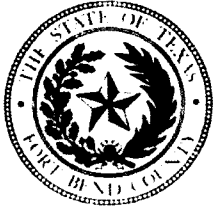

**PERMIT APPLICATION REVIEW FORM FOR
CABLE, CONDUIT, AND POLE LINE ACTIVITY
IN FORT BEND COUNTY**

**Fort Bend County
Engineering Department**
301 Jackson Suite 401
Richmond, Texas 77469
281.633.7500
Permits@fortbendcountytexas.gov

- ☒ Right of Way Permit
☐ Commercial Driveway Permit

Permit No: 2018-20399

The following "Notice of Proposed Cable, Conduit, and/or Pole Line activity in Fort Bend County" and accompanying attachments have been reviewed and the notice conforms to appropriate regulations set by Commissioner's Court of Fort Bend County, Texas.

(1) COMPLETE APPLICATION FORM:

- ☒ a. Name of road, street, and/or drainage ditch affected.
☒ b. Vicinity map showing course of directions
☒ c. Plans and specifications

(2) BOND:

- ☐ County Attorney, approval when applicable.
- ☒ Perpetual bond currently posted. Bond No: [REDACTED] Amount: \$100,000.00
- ☐ Performance bond submitted. Bond No: _____ Amount: _____
- ☐ Cashier's Check Check No: _____ Amount: _____

(3) DRAINAGE DISTRICT APPROVAL (WHEN APPLICABLE):

Drainage District Approval

Date

We have reviewed this project and agree it meets minimum requirements.

Rick J. Staigle, PE, PTOE

Permit Administrator

5/1/2018

Date

SHEET INDEX

- 1 COVER SHEET
- 2 CONSTRUCTION NOTES & DETAILS SHEET 1
- 3 CONSTRUCTION NOTES & DETAILS SHEET 2
- 4 EXHIBIT PLAN
- 5 EXHIBIT PLAN
- 6 EXHIBIT PLAN
- 7 EXHIBIT PLAN
- 8 TRAFFIC PLAN



FORT BEND COUNTY ENGINEERING DEPARTMENT PLANS FOR CONSTRUCTION OF IMPROVEMENTS TO KATY FLEWELLEN ROAD FROM SPRING GREEN BOULEVARD TO CELL TOWER HARRIS COUNTY, TEXAS



LOCATION MAP

Not To Scale

KEY MAP No. 484-J & N
ZIP CODE 77494

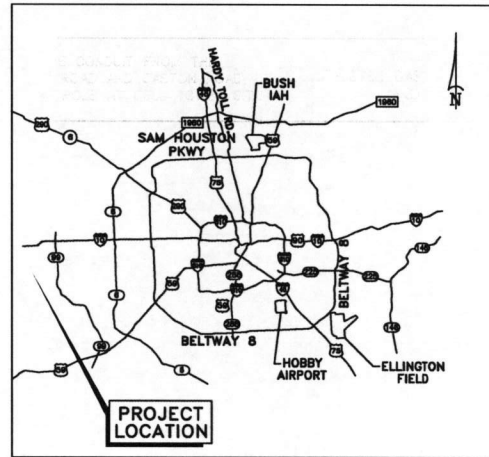

VICINITY MAP

Not To Scale

FIRM
FLOOD INSURANCE RATE MAP
PANEL(100) OF (576)
MAP# 481570100L
MAP REVISED APRIL 02, 2014
THE SITE IN UNSHADED ZONE X, IS OUTSIDE 0.2% CHANCE FLOODPLAIN

I, EDWARD L. MAGDOSS, HEREBY ACKNOWLEDGE THAT
I HAVE REVIEWED THE FLOOD HAZARD RECOVERY
DATA AND USED THE MOST RESTRICTIVE INFORMATION
FOR THE DESIGN OF THIS PROJECT.

Contractor shall comply with City
of Houston Street Cut Ordinance.

Contractor shall notify the City of Houston, Houston Public Works and
Engineering, Office of the City Engineer, 48 hours before starting work on
this project. Phone No. 832-3844-8088

ONE-CALL NOTIFICATION SYSTEM
CALL BEFORE YOU DIG!!!
877-837-8377 (IN HOUSTON)
OR 800-837-8377 (OUTSIDE HOUSTON)

* NEITHER PROPOSED WASTEWATER, WATER
USE STORM SEWER IS SHOWN ON
MAP IS PART OF THIS PLAN SET/
PROJECT'S PROPOSED WORK SCOPE

48 Hour Notice: Contractor shall notify Harris County prior
to commencing construction and/or backfilling any utilities.
Contractor(s) to contact Public Review Department @
(713-274-3891) or
PublicReview@hcid.org

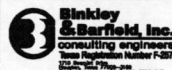

COMCAST SHALL INSTALL 1-2" H.D.P.E. CONDUIT FROM THE
INTERSECTION OF KATY FLEWELLEN ROAD AND GASTON ROAD
TO APPROXIMATELY 1,403' TO PROP. POLE AT CELL TOWER SITE

EXHIBIT
JT-66768 GASTON RD AT FLEWELLEN RD
FORT BEND COUNTY

DESIGNED BY: BBI
DRAWN BY: PN
DWG. NO.

LAMBERT: BBI
DATE: 04/23/2018
KEY MAP: 484J-N

DRAWING SCALE
VERT: NONE
HORIZ: NONE
SHEET NO. 1 OF 8

ORIGINAL SCALE IN INCHES
FOR REDUCED PLANS

GENERAL CONSTRUCTION NOTES

1. If existing buried cable is exposed during trenching operations, coordinate temporary support and protection of buried cable while placing cable in the same trench as conduit.
2. Coordinate temporary support and protection of underground conduit with construction and maintenance forces.
3. Coordinate temporary support and/or final rereading of cables in proposed rebuilt manholes with the construction and maintenance.
4. Stop existing cables in existing manhole(s) at the beginning and end of each work day. If an air leak is detected, notify Telephone Company personnel immediately.
5. The Contractor is responsible for attending meetings and the coordination of all work with customers and governmental entities.
6. Plug all ducts in all manholes --- see BSP 622--220--901 for material and installation specifications.
7. "C" PVC ducts are to be mandated in accordance with BSP 622--220--901.
8. The location of existing underground utilities are shown in an approximate way only and have not been independently verified by the owner or its representative. The contractor shall determine the exact location of all existing utilities before commencing work, and agree to be fully responsible for any and all damages which might be occasioned by the contractor's failure to exactly locate and preserve any and all underground utilities. Contractor shall call Texas One-Call at 1-800-545-6005 or One-Call Notification System at 713-223-4567 (in Houston) 48 hours prior to construction.
9. The information shown on this drawing concerning type and location of underground utilities is not guaranteed to be accurate or all inclusive. The contractor is responsible for making his own determinations as to type and location of underground utilities as may be necessary to avoid damage thereto. The contractor shall verify location of underground pipelines, conduits and structures by contacting owners of underground utilities or by excavation in advance of construction.
10. Contractor shall notify Texas Excavation Safety System (TESS), 48 hours prior to working in or near any and all pipelines at 1-800-344-6377.
11. Contractor must comply with OSHA Specifications and Best Safety Practices (622-020-901, Sec. 11 & 12) on trenching, back filling, excavation and shoring requirements.
12. Contractor shall provide verification statement to Conduit Engineer that existing utilities have been identified, located and marked by Fort Bend County's Department of Public Works, City of Houston's Traffic Signal Section, and Texas Excavation Safety System (TESS).
13. The Construction Contractor shall also be solely responsible for the means, methods, sequence, procedures, techniques or scheduling of portions of the work of construction in accordance with the contract documents. The Construction Contractor shall also be solely responsible for safety in or about the job site in accordance with any health, safety precautions, regulations, standards or codes required by OSHA or any other regulatory agency.
14. Contractor will be responsible for replacing and maintaining traffic signs and pavement markings which include centerline, barrier lines, lane lines and related pavement markings.
15. Contractor to coordinate and be responsible for removal, adjustment, or replacement of CenterPoint Energy Electric, CenterPoint Energy Gas or other utility facilities and for any cost incurred for this work.
16. Contractor to contact owner(s) of all pole/aerial facilities within project area prior to construction to determine the proper procedures for maintaining the integrity of the pole/aerial facilities during construction. All associated costs with this will be the responsibility of the contractor.
17. Maintain existing ditches and/or culverts for unobstructed drainage at all times and shall provide least all barriers and all barriers to control ground and surface water.
18. If it becomes necessary to operate machinery on a portion of the pavement, precautions must be taken to prevent any damage whatsoever to the pavement.
19. Contractor to take necessary precautions to protect root systems of shrubs, plants and trees along the area of excavation.
20. No more trench opened at one time than can be backfilled and compacted in 6" lifts at the end of each work period; no trench left open overnight.
21. Tunnel and/or hand dig all concrete curbs.
22. Contractor to provide a minimum of 18" of clearance at all crossings of sanitary sewers, storm sewers, water lines and roads.
23. Change less than 1" vertically and 3" horizontally due to field conditions do not constitute a change in the scope of work. Contractor shall obtain approval from inspector prior to varying from design shown on plans and submit a set of modified up plans to the Manager of Engineering Design.
24. Contractor shall commence work only after permits are obtained and copies are kept on site.
25. Contractor shall abide by AT&T/SWBT's Standard Construction Manual, latest edition.
26. Contractor shall have sufficient equipment and manpower on the job site to complete the work on or before the completion date.
27. The contractor shall notify the appropriate governmental agencies forty-eight hours prior to beginning work and get appropriate approval for lane closures.
28. Contractor shall construct horizontal directional drill in accordance with ASTM F 1662, "Standard Guide for use of Horizontal Directional Drilling for Placement of Polyethylene Pipes or Conduits Under Obstacles, Including River Crossings."
29. Contractor shall be responsible for determining actual bore pit locations and dimensions. Bore pit locations and dimensions shown on plans are the engineer's opinion.
30. The geodetic position of the manholes shown hereon was obtained using rapid static GPS techniques. The latitude and longitude position reported is based on NAD83. The information obtained was post-processed to obtain a positional accuracy of one (1) meter.
31. Provide 4' Minimum parallel horizontal clearance between the outside of all existing wastewater lines (and their appurtenances) [whether shown on plans or not] and the proposed three/conduit bank/manhole/ vaults, etc., wherever that it is physically possible to do so.

STORM CONSTRUCTION NOTES

1. Minimum horizontal clearance between any storm pipe and box shall be at least 48--inches from exterior of the storm pipe or box to the exterior of the existing or proposed public or private utility and other appurtenances. Minimum vertical clearance between any storm pipe shall be at least 18--inches from exterior of the storm pipe or box to the exterior of the existing or proposed or private utility and other appurtenances.
2. The contractor shall be responsible for protecting, maintaining, and restoring any back slope drainage system disturbed as a result of this work.

CAUTION: CATV Buried cable in construction area. Contractor to be responsible for any damage whatsoever.

CAUTION: Existing underground street light cable in construction area. Verify exact location & depth prior to any digging and/or boring.

CAUTION: Existing AT&T Texas/SWBT facilities in construction area. Verify exact location & depth prior to any digging and/or boring.

CAUTION: Existing CenterPoint Energy Electric facilities in construction area, contact CenterPoint Energy Electric 48 hours prior to any digging and/or boring.

CAUTION: Existing CenterPoint Energy Gas facilities in construction area, contact CenterPoint Energy Gas 48 hours prior to any digging and/or boring.

GENERAL BACKFILL & ENCASEMENT SPECIFICATIONS

1. TYPE "C" BACKFILL -- CEMENT STABILIZED SAND (2 BAGS PER TON OR MEET LATEST Fort Bend County Specifications).
2. TYPE "A" BACKFILL -- ORIGINAL MATERIAL, FREE OF DEBRIS MATERIAL, COMPACTED 90--95% PROCTOR IN 6" LIFTS.
3. CONDUIT FORMATIONS: MINIMUMS OF NUMBER OF DUCTS, SHALL MAINTAIN THE SAME MINIMUM CLEARANCES BETWEEN DUCT AND TRENCH WALL, AS SHOWN IN TYPICAL FORMATIONS HEREON.
4. FORMATIONS OVER FOUR DUCTS MUST REQUIRE 4" SEPARATION AFTER EVERY FOURTH TIER OF DUCTS.
5. ALL DUCTS TO BE ENCASED WITH CEMENT STABILIZED SAND UNLESS OTHERWISE SPECIFIED OR REQUIRED.
6. CONCRETE ENCASE DUCTS WITHIN AREAS OF GRADE CHANGES MORE THAN 20" (1' 8") AND BENDS HAVING RADIUS OF LESS THAN 80 FEET.

AT&T TEXAS/SWBT FACILITIES NOTES:

1. The locations of AT&T Texas/SWBT facilities are shown in an approximate way only. The contractor shall determine the exact location of these facilities before commencing work. The contractor shall be fully responsible for any and all damages which might be occasioned by this failure to locate these facilities and preserve these underground utilities.
2. The contractor shall call 1-800-344-6377 a minimum of 48 hours prior to construction to verify the location of these facilities.
3. When excavating within eighteen inches (18") of the indicated location of AT&T Texas/SWBT facilities, all excavations must be accomplished using non-mechanized excavation procedures. When boring, the contractor shall expose the AT&T Texas/SWBT facilities.
4. When AT&T Texas/SWBT facilities are exposed, the contractor will provide support to prevent damage to the ducts and/or cables. When excavating near telephone poles the contractor shall brace the pole for support.
5. The presence of AT&T Texas/SWBT underground conduit facilities or buried cable facilities shown on these plans does not mean that there are no other cables or other cables in conduit in the area.
6. For emergency reporting see line 622-020-901 or (713) 223-4567 or e-mail him at f72596@att.com. If there are questions about boring or excavating near AT&T Texas/SWBT facilities.

CENTERPOINT ENERGY GAS AND ELECTRIC FACILITIES NOTES:

CAUTION: UNDERGROUND GAS FACILITIES

Locations of CenterPoint Energy gas lines (to include CenterPoint Energy Intrastate Pipelines, LLC, where applicable) are shown in an approximate location only. Service lines are usually not shown. For signature on these plans only indicate that our facilities are shown in approximate location. It does not imply that a conflict analysis has been made. The contractor shall contact the Utility Coordinating Committee at (713) 223-4567 or 1-800-888-8344 a minimum of 48 hours prior to construction to have maps and service lines located.

- * When CenterPoint Energy gas line markings are not visible, call (713) 945-9038 or (713) 945-9037 (7:00 a.m. to 4:30 p.m.) for status of the location request before excavation begins.
- * When excavating within eighteen inches (18") of the indicated location of CenterPoint Energy facilities, all excavations must be accomplished using non-mechanized excavation procedures.
- * When CenterPoint Energy facilities are exposed, sufficient support must be provided to the facilities to prevent excessive stress on the piping.
- * For emergency reporting see line 622-020-901 or (713) 223-4567 or (713) 223-4567.

The contractor is fully responsible for any damages caused by his failure to exactly locate and preserve these underground facilities.

WARNING: OVERHEAD ELECTRICAL LINES

Overhead lines may exist on the property. The location of overhead lines has not been shown on these drawings as the lines are clearly visible, but you should locate them prior to making any construction. Texas law, Section 782, Health & Safety Code forbids activities that occur in close proximity to high voltage lines, specifically:

- * Any activity where person or things may come within six(6) feet of the overhead high voltage lines;
- * Operating a crane, derrick, power shovel, drilling rig, pile driver, hoisting equipment, or similar apparatus within 10 feet of the overhead high voltage lines.

Further responsible for the work, including contractors are legally responsible for the safety of construction workers under this law. This law carries both criminal and civil liability. To arrange for lines to be turned off or removed call CenterPoint Energy at (713) 223-4567.

Activities on or across CenterPoint Energy fee or easement property is given. If you need to use CenterPoint property, please contact our Surveying & Right of Way Division at (713) 223-4567 or (713) 223-4567.

STREET AND BRIDGE NOTES:

1. Department of public works and engineering's "Standard Construction Specifications" and "Standard Construction Details for Wastewater Collection Systems, Water Lines, Storm Drainage, and Street Paving" rules otherwise noted and approved on these plans. The design is consistent with the minimum standards established in Fort Bend County design standards.
2. Fill areas on plans shall be filled in layers not exceeding 12" in depth and each compacted to not less than 95% standard proctor density prior to installation of water line and fill area shall be sealed and finished with 10 milting days.
3. Utility contractor shall provide temporary all barrier fence at all non-work areas which will remain in place after underground contract is complete.
4. Contractor shall provide all barrier fence on all slope 1 inch high.
5. Existing pavements, curbs, drainage, and sidewalks damaged or removed during construction shall be replaced to Fort Bend County standards, with latest addendum's and amendments thereto.
6. Condition of the road and/or right-of-way upon completion of job, shall be as good as or better than prior to starting work.
7. Adequate drainage shall be maintained at all times during construction and any drainage ditch or structure disturbed during construction shall be restored to substantially of the existing authority.
8. Exposed 12" of reinforcing steel at proposed road joint, if no reinforcing steel exists, use horizontal dowels. Horizontal dowels shall be #8 bars 24" long 24" O-C and embedded 12" into the center of the existing slab with 70 MCCI or equal.
9. Contractor to take necessary precautions to protect root systems of shrubs, plants and trees along areas of excavation.
10. Contractor shall comply with OSHA regulations and standards of Texas for excavating, shoring, trenching and shoring as specified in Fort Bend County addendum 622-020-901.
11. Road slope range shall be installed in accordance with Fort Bend County standards at all intersections where sidewalk exists and the existing curb or sidewalk is damaged or removed during construction.
12. "Standard Construction Specifications" and "Standard Construction Details for Wastewater Collection Systems, Water Lines, Storm Drainage and Street Paving" rules otherwise noted and approved on these plans. The design shall be consistent with the minimum standards established in the "Design Manual for Wastewater Collection Systems, Water Lines, Storm Drainage and Street Paving."
13. The contractor shall be fully responsible for any damages to existing water, wastewater, storm sewer and traffic signal conduits. All damages shall be repaired in accordance with the Fort Bend County Dept. of Public Works and Engineering's "Standard Construction Specifications" with latest addendum and amendments thereto, at no cost to the Fort Bend County.
14. Prior to street closure, the contractor shall contact the Department of Public Works and Engineering at 635-384-8678 and comply with all requirements for the issuance of necessary permits/work orders for street construction.
15. Double reinforced concrete traffic barriers shall be placed 18--inches offset of the centerline of all the highway locations by the paving contractor. Hydrants located at intersections shall have a 6--inches placed on each street.

TRAFFIC NOTES

1. CONTRACTOR SHALL PROVIDE AND INSTALL TRAFFIC CONTROL DEVICES IN CONFORMANCE WITH PART 16 OF THE TEXAS MANUAL ON UNIFORM TRAFFIC CONTROL DEVICES (TEXAS MUTCD, MOST RECENT EDITION WITH REVISIONS) DURING CONSTRUCTION.
2. NO LANES SHALL BE CLOSED DURING THE HOURS OF 6:30AM TO 7:00PM AND 4:00 PM TO 6:00 PM MONDAY THRU FRIDAY IN DOWNTOWN/AUTOWAY AREA.
3. NO LANES ON MAJOR THROUGHWAYS MAY BE CLOSED FROM 8:00AM TO 6:00PM AND 4:00PM TO 7:00PM UNLESS OUTLINED IN THE MOBILITY PERMIT.
4. NO TRAFFIC LANES SHALL BE CLOSED IN RESIDENTIAL AREAS FROM 7:00AM TO 7:00PM.
5. CONTRACTOR SHALL MAINTAIN ONE LANE OF TRAFFIC IN EACH DIRECTION DURING WORKING HOURS.
6. CONTRACTOR SHALL COVER OPEN EXCAVATIONS WITH STEEL PLATES ANCHORED PROPERLY DURING NON-WORKING HOURS, AND OPEN THE LANES FOR NORMAL TRAFFIC FLOW.
7. OFF-DUTY UNIFORM POLICE OFFICER(S) PLACED ON DUTY SHALL BE REQUIRED TO DIRECT TRAFFIC WHEN LANES ARE CLOSED.
8. IN THE EVENT THAT NO TRAFFIC CONTROL PLANS EXIST AS A PART OF CONTRACT DRAWINGS, CONTRACTOR MUST PREPARE PLANS AND SUBMIT TO PLAN REVIEW SECTION FOR APPROVAL TEN DAYS PRIOR TO IMPLEMENTATION.
9. IF THE CONTRACTOR CHOOSES TO USE A DIFFERENT METHOD OF "TRAFFIC CONTROL PLANS" DURING THE CONSTRUCTION THAN WHAT IS OUTLINED IN THE CONTRACT DRAWINGS, HE/SHE SHALL BE RESPONSIBLE FOR PREPARING AND SUBMITTING AN ALTERNATE SET OF PLANS TO THE PLAN REVIEW SECTION FOR APPROVAL TEN WORKING DAYS PRIOR TO IMPLEMENTATION.
10. APPROVED COPIES OF TRAFFIC CONTROL PLANS AND MOBILITY PERMITS SHALL BE MADE AVAILABLE FOR INSPECTION AT THE JOB SITE AT ALL TIMES.
11. CONTRACTOR MUST SECURE MOBILITY PERMITS FROM THE CITY'S TRAFFIC MANAGEMENT AND MAINTENANCE BUREAU BEFORE CLOSING A LANE/ROADWAY.
12. THE REQUEST MUST BE MADE AT LEAST 10 DAYS IN ADVANCE OF THE CLOSING. NOTE THAT WORKING HOURS MAY BE RESTRICTED ON THE REQUEST MAY BE DENIED.
13. THESE PLANS SHALL BE DRAWN TO SCALE ON REPRODUCIBLE MYLAR AND SEALED BY A LICENSED ENGINEER IN THE STATE OF TEXAS. PLANS WILL BECOME A PART OF THE CONTRACT DRAWINGS.

SWPPP CONSTRUCTION NOTES

1. Contractor shall implement protection devices and Refracted Filter Fabric barrier along road and side ditches at locations shown on the typical Storm Water Pollution Prevention (SWPP) plans to keep dirt and/or excavated material from entering into the storm water hole and ditches eventually polluting the receiving stream.
 2. During the excavation phase of the project, Contractor shall schedule the work in short segments so that excavated material can be quickly hauled away from the site and to prevent it from staying uncollected on the existing pavement. Any loose excavated material which falls on pavements or driveways shall be swept back into the excavated area.
 3. Contractor shall clean up the existing street intersections and driveway edges, as necessary, to remove any excess mud, dirt or rock tracked from the excavated area.
 4. Contractor shall follow good housekeeping practices during construction of the project, always cleaning up dirt and loose material as construction progresses.
 5. Contractor to inspect and maintain areas listed below at least once every fourteen (14) calendar days and within 24 hours of the end of a storm event of 0.8 inches or greater.
- Disturbed areas of the construction site that have not been finally stabilized. Areas used for storage of materials that are exposed to precipitation. Structural control measures. Locations where vehicles enter or exit the site.
6. Contractor to be responsible for maintaining existing ditches and/or culverts for unobstructed drainage at all times. Where adding is disturbed by excavation on building operations, such areas shall be replaced by seeding or sloping. Slopes 4:1 or steeper shall be replaced by block sloping.

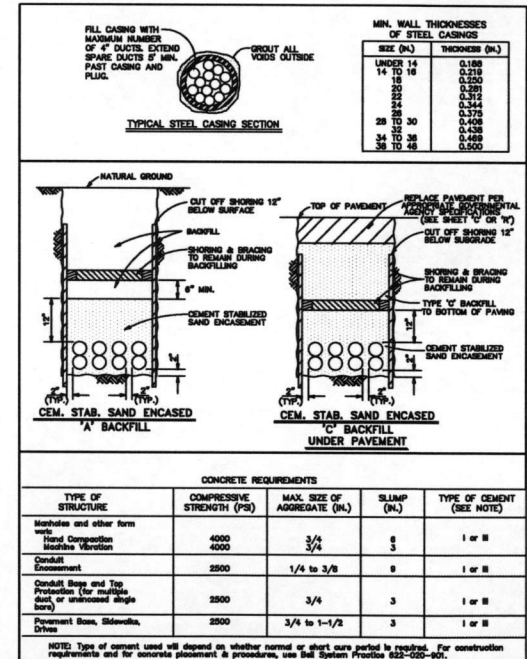

Comcast
7033 AIRPORT BLVD.
HOUSTON, TX 77061-3912

23123 Stearns Junction St., Suite 117-004
771-382-2465
Jier, LLC
FIRM #9357

Binkley & Barfield, Inc.
consulting engineers
New Houston, Texas 75567
281-291-1234 FAX 281-291-1235

COMCAST SHALL INSTALL 1-2" H.D.P.E. CONDUIT FROM THE INTERSECTION OF KATY FLEWELLEN ROAD AND GASTON ROAD TO APPROXIMATELY 1,403' TO PROP. POLE AT CELL TOWER SITE

EXHIBIT
JT-66768 GASTON RD AT FLEWELLEN RD
FORT BEND COUNTY

DESIGNED BY: BBI
DRAWN BY: PN
DWG. NO.
LAMBERT: BBI
DATE: 04/23/2018
KEY MAP: 484J-N

DRAWING SCALE
VERT: NONE
HORIZ: 1"=20' (22X34)
HORIZ: 1"=40' (11X17)
SHEET NO. 2 OF 8

ORIGINAL SCALE IN INCHES

ORIGINAL SCALE IN INCHES
FOR REDUCED PLANS

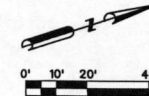

ORIGINAL SCALE IN INCHES
FOR REDUCED PLANS

Curve PROBL_KF-1
 P.I. Station 100+49.59
 Delta 2° 10' 40.03" (LT)
 Degree 2° 11' 45.01"
 Tangent 49.5950
 Length 99.1780
 Radius 2,609.2928
 External 0.4713
 Long Chord 99.1720
 Mid. Ord. 0.4712
 P.C. Station 100+00.00
 P.T. Station 100+99.18

Curve PROBL_KF-2
 P.I. Station 101+94.57
 Delta 10° 53' 51.79" (LT)
 Degree 5° 43' 46.48"
 Tangent 95.3883
 Length 190.2011
 Radius 1,000.0000
 External 4.5392
 Long Chord 189.9145
 Mid. Ord. 4.5187
 P.C. Station 100+99.18
 P.T. Station 102+89.38

Curve PROBL_KF-3
 P.I. Station 103+49.06
 Delta 3° 25' 08.05" (RT)
 Degree 2° 51' 53.24"
 Tangent 59.6791
 Length 119.3228
 Radius 2,000.0000
 External 0.8902
 Long Chord 119.3052
 Mid. Ord. 0.8898
 P.C. Station 102+89.38
 P.T. Station 104+08.70

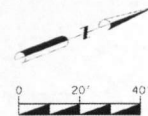
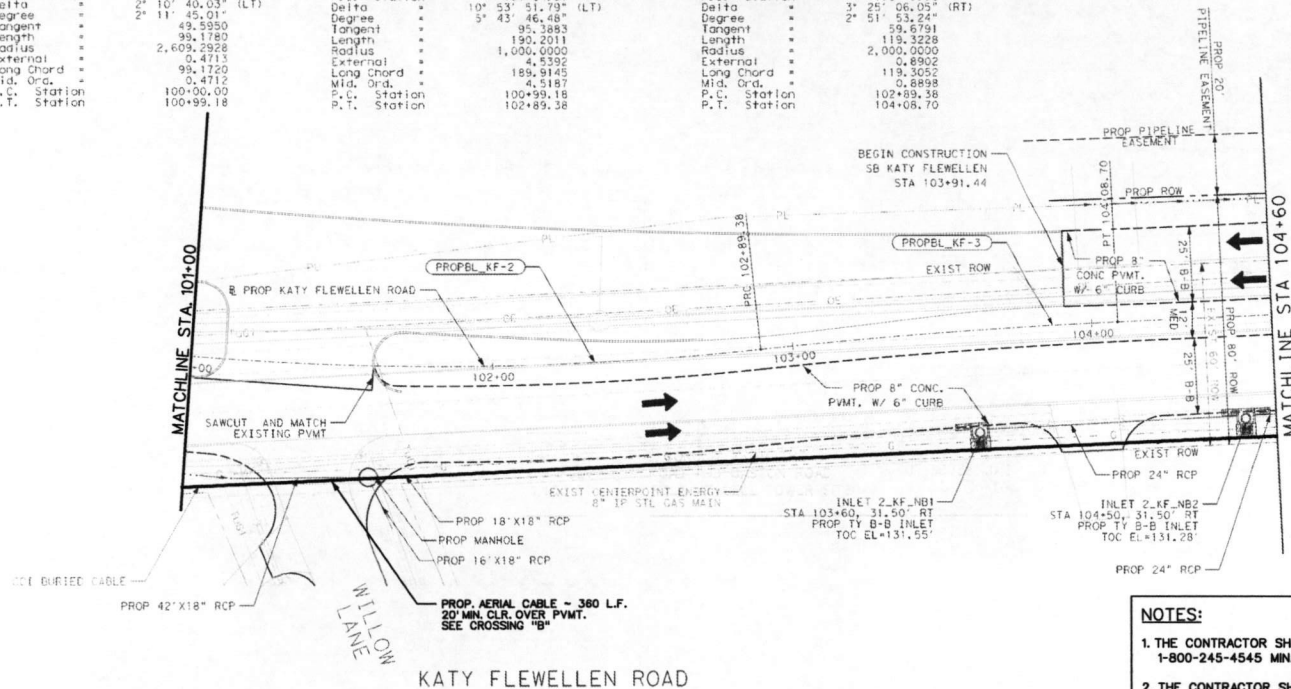

NOTES:

1. THE CONTRACTOR SHALL CONTACT TEXAS ONE CALL SYSTEM AT 1-800-245-4545 MIN. 48 HOURS BEFORE DIGGING.
2. THE CONTRACTOR SHALL DETERMINE THE EXACT LOCATION OF ALL UNDERGROUND FACILITIES BEFORE COMMENCING WORK AND AGREE TO BE FULLY RESPONSIBLE FOR ALL DAMAGES CAUSED BY HIS FAILURE TO EXACTLY LOCATE AND PRESERVE ALL UNDERGROUND FACILITIES.
3. NO MORE TRENCH OPENED AT ONE TIME THAN CAN BE BACKFILLED AND COMPACTED IN 10" LIFTS AT THE END OF EACH DAY. (NO TRENCH LEFT OPENED OVERNIGHT)
4. ALL EXCESS EXCAVATION TO BE REMOVED FROM THE ROAD RIGHT-OF-WAY AT THE END OF THE DAY.
5. DITCHES TO BE OPENED AT THE END OF EACH DAY TO ASSURE ADEQUATE DRAINAGE.
6. ROAD MUST BE KEPT OPEN TO TRAFFIC AND CONTRACTOR MUST PROVIDE ADEQUATE FLAGMEN, SIGNALS, ETC., TO PROVIDE COMPLETE SAFETY TO THE PUBLIC.
7. IF IT BECOMES NECESSARY FOR EQUIPMENT TO OPERATE ON A PORTION OF THE PAVEMENT, PRECAUTIONS MUST BE TAKEN TO PREVENT ANY DAMAGE WHATSOEVER TO THE PAVEMENT.
8. CONDITION OF ROAD UPON COMPLETION OF JOB SHALL BE AS GOOD OR BETTER THAN PRIOR TO STARTING.
9. CONTRACTOR SHALL COMPLY WITH ALL APPLICABLE NATIONAL ELECTRICAL SAFETY CODE (NEC) REQUIREMENTS, CENTERPOINT ENERGY ELECTRIC POLE ATTACHMENT GUIDELINES & PROCEDURES AND ALL APPLICABLE LOCAL REQUIREMENTS AND REGULATIONS FOR PLACEMENT OF AERIAL CABLE FACILITIES. 18" MIN. VERTICAL CLEARANCE.

Comcast
 7033 AIRPORT BLVD.
 HOUSTON, TX 77061-3012

22133 Blumenshine Road, Suite 100, TX 77064
Jier, LLC
 FIRM #93597

3 Binkley & Barfield, Inc.
 consulting engineers
 Texas Registration Number P-287
 10100 Katy Road, Suite 100
 Houston, TX 77054

COMCAST SHALL INSTALL 1-2" H.D.P.E. CONDUIT FROM THE INTERSECTION OF KATY FLEWELLEN ROAD AND GASTON ROAD TO APPROXIMATELY 1,403' TO PROP. POLE AT CELL TOWER SITE

EXHIBIT
 JT-66768 GASTON RD AT FLEWELLEN RD
 FORT BEND COUNTY

DESIGNED BY: BBI
 DRAWN BY: PN
 DWG. NO.

LAMBERT: BBI
 DATE: 04/23/2018
 KEY MAP: 484J-N

DRAWING SCALE
 VERT.: NONE
 HORIZ.: 1"=20' (22X34)
 HORIZ.: 1"=40' (11X17)
 SHEET NO. 8 OF 8

ORIGINAL SCALE IN INCHES
 FOR REDUCED PLANS

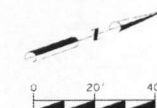
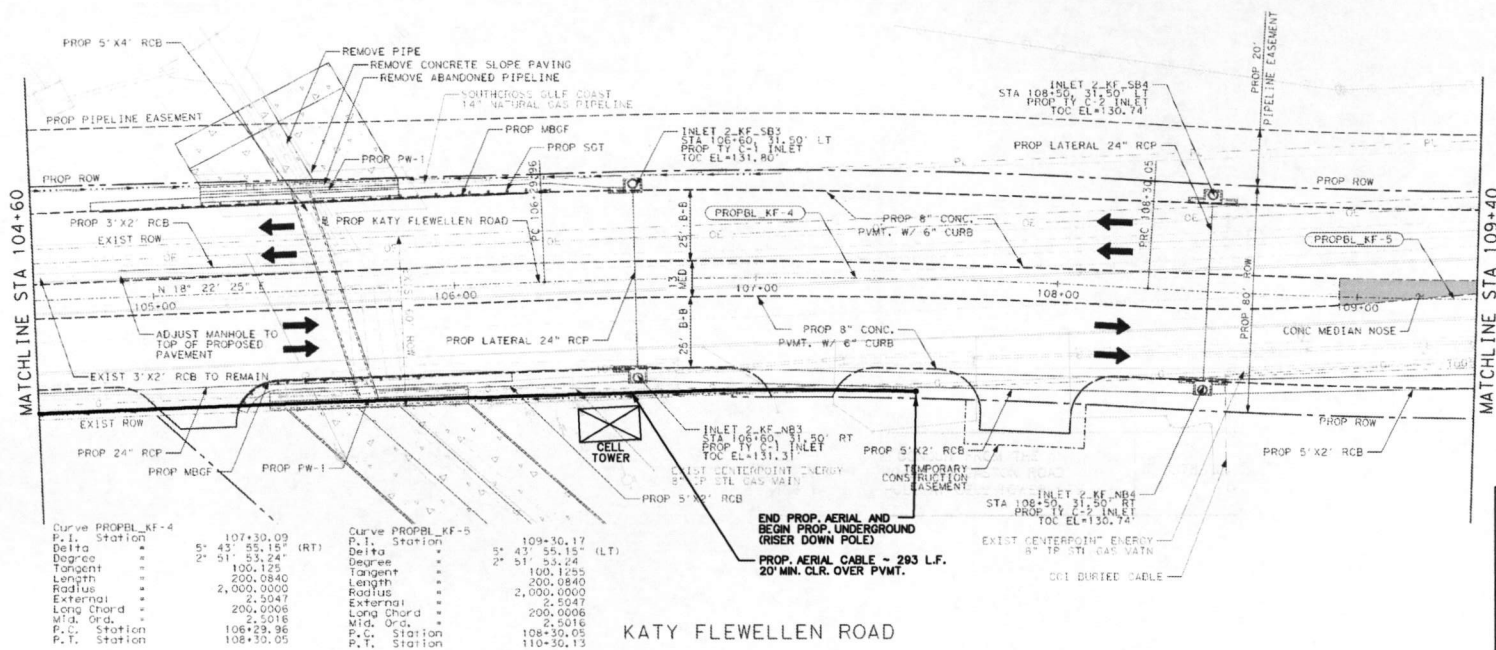

DETAIL OF POLE

CONTRACTOR TO BRACE & SUPPORT ELEC. POLE AS NECESSARY.

NOTES:

1. THE CONTRACTOR SHALL CONTACT TEXAS ONE CALL SYSTEM AT 1-800-245-4545 MIN. 48 HOURS BEFORE DIGGING.
2. THE CONTRACTOR SHALL DETERMINE THE EXACT LOCATION OF ALL UNDERGROUND FACILITIES BEFORE COMMENCING WORK AND AGREE TO BE FULLY RESPONSIBLE FOR ALL DAMAGES CAUSED BY HIS FAILURE TO EXACTLY LOCATE AND PRESERVE ALL UNDERGROUND FACILITIES.
3. NO MORE TRENCH OPENED AT ONE TIME THAN CAN BE BACKFILLED AND COMPACTED IN 10" LIFTS AT THE END OF EACH DAY. NO TRENCH LEFT OPENED OVERNIGHT.
4. ALL EXCESS EXCAVATION TO BE REMOVED FROM THE ROAD RIGHT-OF-WAY AT THE END OF THE DAY.
5. DITCHES TO BE OPENED AT THE END OF EACH DAY TO ASSURE ADEQUATE DRAINAGE.
6. ROAD MUST BE KEPT OPEN TO TRAFFIC AND CONTRACTOR MUST PROVIDE ADEQUATE FLAGMEN, SIGNALS, ETC., TO PROVIDE COMPLETE SAFETY TO THE PUBLIC.
7. IF IT BECOMES NECESSARY FOR EQUIPMENT TO OPERATE ON A PORTION OF THE PAVEMENT, PRECAUTIONS MUST BE TAKEN TO PREVENT ANY DAMAGE WHATSOEVER TO THE PAVEMENT.
8. CONDITION OF ROAD UPON COMPLETION OF JOB SHALL BE AS GOOD OR BETTER THAN PRIOR TO STARTING.
9. CONTRACTOR SHALL COMPLY WITH ALL APPLICABLE NATIONAL ELECTRICAL SAFETY CODE (NESC) REQUIREMENTS, CENTERPOINT ENERGY ELECTRIC POLE ATTACHMENT GUIDELINES & PROCEDURES AND ALL APPLICABLE LOCAL REQUIREMENTS AND REGULATIONS FOR PLACEMENT OF AERIAL CABLE FACILITIES. 18' MIN. VERTICAL CLEARANCE.

Comcast
7033 AIRPORT BLVD.
HOUSTON, TX 77061-3012

22125 Shuman Road, Q. 604, TX 77404
Jier, LLC
FIRM #03507

Stinkley & Garfield, Inc.
consulting engineers
State Registration Number F-87
1000 West 17th Street
P.O. Box 2000
Fort Worth, Texas 76101

COMCAST SHALL INSTALL 1-2" H.D.P.E. CONDUIT FROM THE INTERSECTION OF KATY FLEWELLEN ROAD AND GASTON ROAD TO APPROXIMATELY 1,403' TO PROP. POLE AT CELL TOWER SITE

EXHIBIT
JT-66768 GASTON RD AT FLEWELLEN RD
FORT BEND COUNTY

DESIGNED BY: BBI
DRAWN BY: PN
DWG. NO.

LAMBERT: BBI
DATE: 04/23/2018
KEY MAP: 484J-N

DRAWING SCALE
VERT.: NONE
HORIZ.: 1"=20' (22X34)
HORIZ.: 1"=40' (11X17)
SHEET NO. 7 OF 8

