



**REVIEW BY FORT BEND COUNTY
COMMISSIONERS COURT**

**Fort Bend County
Engineering Department**

301 Jackson Suite 401
Richmond, Texas 77469
281.633.7500

Permits@fortbendcountytexas.gov



Right of Way Permit



Commercial Driveway Permit

Permit No: 2018-20076

Applicant: Comcast of Houston, LLC/Binkley & Barfield, Inc.

Job Location Site: Gaston Road, Katy, TX 77494

Bond No. **Date of Bond:** 7/24/2007 **Amount:** \$100,000.00

The above applicant came to make use of certain Fort Bend County property subject to, "The Order Regulating the Laying, Construction, Maintenance, and Repair of Buried Cables, Conduits, and Pole Lines, In, Under, Across or Along Roads, Streets, Highways, and Drainage Ditches in Fort Bend County, Texas, Under the Jurisdiction of the Commissioners Court of Fort Bend County, Texas," as passed by the Commissioners Court of Fort Bend County, Texas, of the Minutes of the Commissioners Court of Fort Bend County, Texas, to the extent that such order is not inconsistent with Chapter 181, Vernon's Texas Statutes and Codes Annotated.

Notes:

1. Evidence of review by the Commissioners Court must be kept on the job site and failure to do so constitutes grounds for job shutdown.
2. Written notices are required:
 - a. 48 hours in advance of construction start up, and
 - b. When construction is completed and ready for final inspection, submit notification to Permit Administrator thru MyGovernmentOnline.org portal.
3. This permit expires one (1) year from date of permit if construction has not commenced.

On this 24th day of April, 2018, Upon Motion of Commissioner Meyers, seconded by Commissioner Morales, duly put and carried, it is ORDERED, ADJUDGED AND DECREED that said notice of said above purpose is hereby acknowledged by the Commissioners Court of Fort Bend County, Texas, and that said notice be placed on record according to the regulation order thereof.

Signature

Presented to Commissioners Court and approved.

By:

Rick J. Staigle, PE, PTOE
County Engineer

Date Recorded 4-30-18 Comm. Court No. 13E

N/A

Clerk of Commissioners Court

By:

Drainage District Engineer/Manager

By:

Andrea Williams
Deputy



**PERMIT APPLICATION REVIEW FORM FOR
CABLE, CONDUIT, AND POLE LINE ACTIVITY
IN FORT BEND COUNTY**

**Fort Bend County
Engineering Department**
301 Jackson Suite 401
Richmond, Texas 77469
281.633.7500
Permits@fortbendcountytexas.gov

- ☒ **Right of Way Permit**
☐ **Commercial Driveway Permit**

Permit No: 2018-20076

The following "Notice of Proposed Cable, Conduit, and/or Pole Line activity in Fort Bend County" and accompanying attachments have been reviewed and the notice conforms to appropriate regulations set by Commissioner's Court of Fort Bend County, Texas.

(1) COMPLETE APPLICATION FORM:

- | | |
|-------------------------------------|--|
| <input checked="" type="checkbox"/> | a. Name of road, street, and/or drainage ditch affected. |
| <input checked="" type="checkbox"/> | b. Vicinity map showing course of directions |
| <input checked="" type="checkbox"/> | c. Plans and specifications |

(2) BOND:

- | | | | |
|-------------------------------------|--|---------------------|----------------------|
| <input type="checkbox"/> | County Attorney, approval when applicable. | | |
| <input checked="" type="checkbox"/> | Perpetual bond currently posted. | Bond No: [REDACTED] | Amount: \$100,000.00 |
| <input type="checkbox"/> | Performance bond submitted. | Bond No: _____ | Amount: _____ |
| <input type="checkbox"/> | Cashier's Check | Check No: _____ | Amount: _____ |

(3) DRAINAGE DISTRICT APPROVAL (WHEN APPLICABLE):

Drainage District Approval

Date

We have reviewed this project and agree it meets minimum requirements.

Rick J. Staigle, PE, PTOE

Permit Administrator

4/16/2018

Date

SHEET INDEX

| | | |
|----|-----------------|-------------------------|
| 1 | COVER SHEET | NOTES & DETAILS SHEET 1 |
| 2 | CONSTRUCTION | NOTES & DETAILS SHEET 2 |
| 3 | EXHIBIT OVERALL | |
| 4 | EXHIBIT PLAN | |
| 5 | EXHIBIT PLAN | |
| 6 | EXHIBIT PLAN | |
| 7 | EXHIBIT PLAN | |
| 8 | EXHIBIT PLAN | |
| 9 | EXHIBIT PLAN | |
| 10 | EXHIBIT PLAN | |
| 11 | EXHIBIT PLAN | |
| 12 | EXHIBIT PLAN | |
| 13 | TRAFFIC PLAN | |



FORT BEND COUNTY ENGINEERING DEPARTMENT PLANS FOR CONSTRUCTION OF IMPROVEMENTS TO GASTON ROAD FROM KATY FLENWELLEN ROAD TO GREENBUSCH ROAD HARRIS COUNTY, TEXAS

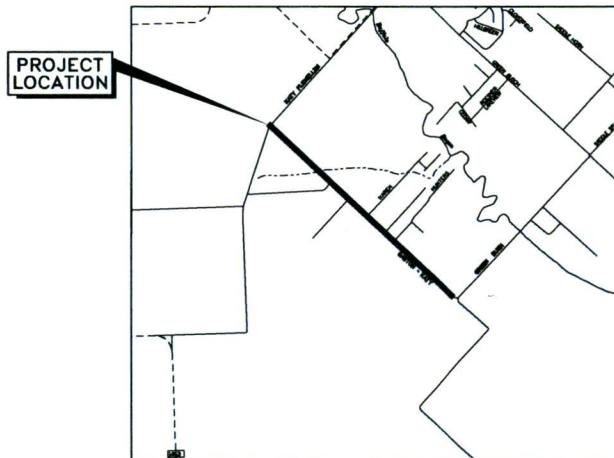

LOCATION MAP

Not To Scale

KEY MAP No. 484-J, K, P, Q & U
ZIP CODE 77494

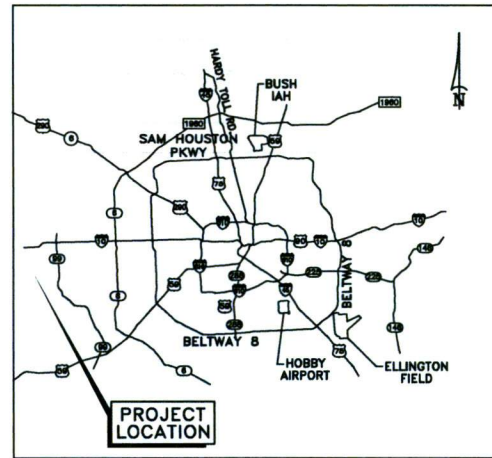

VICINITY MAP

Not To Scale

FIRM
FLOOD INSURANCE RATE MAP
FIRM#1010 OF (575)
MAP# 481570010
MAP REVISED APRIL 02, 2014
THE SITE IS UNSHADED ZONE X, IS OUTSIDE 0.2% CHANCE FLOODPLAIN

I, EDWARD L. MAGORING, HEREBY ACKNOWLEDGE THAT
I HAVE REVIEWED THE FLOOD HAZARD RECOVERY
DATA AND USED THE MOST RESTRICTIVE INFORMATION
FOR THE DESIGN OF THIS PROJECT.

Contractor shall comply with City
of Houston Street, Out, Ordinance.

Contractor shall notify the City of Houston, Department of Public Works and
Engineering, Office of the City Engineer, 48 hours before starting work on
this project. Phone No. 832-394-9098

ONE-CALL NOTIFICATION SYSTEM
CALL BEFORE YOU DIG!!!
(713) 251-8877 OR (713) 251-8877
(NEW STATEWIDE NUMBER OUTSIDE HOUSTON)
1-800-345-5877

* NEITHER PROPOSED WASTEWATER, WATER
NOR STORM SEWER IS SHOWN ON
THIS MAP. IT IS PART OF THIS PLAN SET/
PROJECT'S PROPOSED WORK SCOPE

48 Hour Notice: Contractor shall notify Harris County prior
to commencing construction and/or installing any utilities.
Contractor(s) to contact Public Review Department @
(713)-274-3023 or
PublicReview@haptx.org

Comcast
7033 AIRPORT BLVD.
HOUSTON, TX 77061-3912

22123 Western Mariner Dr., Katy, TX 77494
281-355-3340
Jier, LLC
FIRM #9397

Binkley & Barfield, Inc.
consulting engineers
Three Bayberry Haller F-287
10315 Katy Fwy., Suite 200
Houston, TX 77024
(713) 265-2525 FAX (713) 265-2526

COMCAST SHALL INSTALL 1-2" H.D.P.E. CONDUIT FROM THE
INTERSECTION OF KATY FLEWELLEN ROAD AND GASTON ROAD
TO APPROXIMATELY 2,130' EAST OF THE INTERSECTION OF KAREN
LANE AND GASTON ROAD

EXHIBIT
JT-70734-CIN-FORT BEND COUNTY
GASTON ROAD UTILITY RELOCATION

DESIGNED BY: BBI
DRAWN BY: PN
DWG. NO.

LAMBERT: BBI
DATE: 04/05/2018
KEY MAP: 332J-K-N-P

DRAWING SCALE
VERT: NONE
HORIZ: NONE
HORIZ: NONE
SHEET NO. 1 OF 13

GENERAL CONSTRUCTION NOTES

- If existing buried cable is exposed during trenching operations, coordinate temporary support and protection of buried cable while placing cable in the same trench as conduit.
- Coordinate temporary support and protection of underground conduit with construction and maintenance for force main.
- Coordinate temporary support and/or final reworking of cables in proposed rebuilt manholes with the construction and maintenance.
- Seal existing cables in existing manhole(s) at the beginning and end of each work day. If an air lock is detected, notify Telephone Company personnel immediately.
- The Contractor is responsible for attending meetings and the coordination of all work with customers and governmental entities.
- Plug all ducts in all manholes—see BSR 828-220-901 for material and installation specifications.
- 7" PVC ducts are to be installed in accordance with BSR 822-340-201.
- The location of existing underground utilities are shown in an approximate way only and have not been independently verified by the owner or its representative. The contractor shall determine the exact location of all existing utilities before commencing work, and agrees to be fully responsible for any and all damages which might be occasioned by the contractor's failure to exactly locate and preserve any and all underground utilities. Contractor shall call Texas One-Call at 1-800-540-8000 or One-Call Notification System at 713-223-4567 (in Houston) 48 hours prior to construction.
- The information shown on this drawing concerning type and location of underground utilities is not guaranteed to be accurate or all inclusive. The contractor is responsible for making his own determinations as to type and location of underground utilities as may be necessary to avoid damage thereto. The contractor shall verify location of underground pipelines, conduits and structures by contacting owners of underground utilities or by excavation in advance of construction.
- Contractor shall notify Texas Excavation Safety System (TESS), 48 hours prior to working in or near any and all pipelines at 1-800-344-8377.
- Contractor must comply with OSHA Specifications and Best System Practices (822-020-901, Sec. 11 & 12) on trenching, back filling, excavation and shoring requirements.
- Contractor shall provide verification statement to Conduit Engineer that existing utilities have been identified, located and marked by Fort Bend County's Department of Public Works, City of Houston's Traffic Signal Section, and Texas Excavation Safety System (TESS).
- The Construction Contractor shall also be solely responsible for the means, methods, sequence, procedures, techniques or scheduling all portions of the work of construction in accordance with the contract documents. The Construction Contractor shall also be solely responsible for safety in or about the job site in accordance with any health or safety precautions, regulations, standards or codes required by OSHA or any other regulatory agency.
- Contractor will be responsible for replacing and maintaining traffic signs and pavement markings which include centerline, barrier lines, lane lines and related pavement markings.
- Contractor to coordinate and be responsible for removal, adjustment, or replacement of CenterPoint Energy Electric, CenterPoint Energy Gas or other utilities facilities and for any cost incurred for this work.
- Contractor to contact owner(s) of all pole/aerial facilities within project area prior to construction to determine the proper procedures for maintaining the integrity of the pole/aerial facilities during construction. All associated costs with this will be the responsibility of the contractor.
- Maintain existing ditches and/or culverts for unobstructed drainage at all times and shall provide inlet barriers and exit barriers to control ground and surface water.
- If it becomes necessary to operate machinery on a portion of the pavement, precautions must be taken to prevent any damage whatsoever to the pavement.
- Contractor to take necessary precautions to protect root systems of shrubs, plants and trees along the area of excavation.
- No more trench opened at one time than can be backfilled and compacted in 6" lifts at the end of each work period; no trench left open overnight.
- Tunnel and/or hand dig all concrete curbs.
- Contractor to provide a minimum of 18" of clearance at all crossings of sanitary sewers, storm sewers, water lines and leads.
- Changes less than 1" vertically and 3" horizontally due to field conditions do not constitute a change in the scope of work. Contractor shall obtain approval from Inspector prior to varying from design shown on plans and submit a set of marked up plans to the Manager of Engineering.
- Contractor shall commence work only after permits are obtained and copies are kept on site.
- Contractor shall abide by AT&T/SWBT's Standard Practices manual latest edition.
- Contractor shall have sufficient equipment and manpower to complete the job site to complete the work on or before the completion date.
- The contractor shall notify the appropriate governmental agencies forty-eight hours prior to beginning work and get appropriate approval for lane closures.
- Contractor shall construct horizontal directional drill in accordance with ASTM F 1082, "Standard Guide for use of Mini-Horizontal Directional Drilling for Placement of Polyethylene Pipe or Conduit Under Obstacles, Including River Crossings."
- Contractor shall be responsible for determining actual bore pit locations and dimensions. Bore pit locations and dimensions shown on plans are the engineer's opinion.
- The geodetic position of the manholes shown hereon was obtained using rapid static GPS techniques. The latitude and longitude position reported is based on NAD83. The information obtained was post-processed to obtain a positional accuracy of one (1) meter.
- Provide 4' Minimum parallel horizontal clearance between the outside of: all existing wastewater lines (and their appurtenances) [whether shown on plans or not] and the proposed lines/conduit banks/manholes/ vaults, etc., wherever that it is physically possible to do so.

STORM CONSTRUCTION NOTES

- Minimum horizontal clearance between any storm pipe and box shall be at least 48-inches from exterior of the storm pipe or box to the exterior of the existing or proposed public or private utility and other appurtenances. Minimum vertical clearance between any storm pipe shall be at least 18-inches from exterior of the storm pipe or box to the exterior of the existing or proposed or private utility and other appurtenances.
- The contractor shall be responsible for protecting, maintaining, and restoring any back slope drainage system disturbed as a result of this work.

CAUTION: DUTY Buried cable in construction area. Contractor to be responsible for any damage whatsoever.

CAUTION: Existing underground street light cable in construction area. Verify exact location & depth prior to any digging and/or boring.

CAUTION: Existing AT&T Texas/SWBT facilities in construction area. Verify exact location & depth prior to any digging and/or boring.

CAUTION: Existing CenterPoint Energy Electric facilities in construction area, contact CenterPoint Energy Electric 48 hours prior to any digging and/or boring.

CAUTION: Existing CenterPoint Energy Gas facilities in construction area, contact CenterPoint Energy Gas 48 hours prior to any digging and/or boring.

GENERAL BACKFILL & ENCASEMENT SPECIFICATIONS

- TYPE 'X' BACKFILL - GENTLY STABILIZED SAND (3 BAGS PER TON OR MEET LATEST FORT BEND COUNTY SPECIFICATIONS).
- TYPE 'Y' BACKFILL - ORIGINAL MATERIAL, FREE OF DETRIMENTAL MATERIAL, COMPACTED 80-85% PROCTOR IN 6" LIFTS.
- CONDUIT FORMATIONS, REGARDLESS OF NUMBER OF DUCTS, SHALL MAINTAIN THE SAME MINIMUM CLEARANCES BETWEEN DUCT AND TRENCH WALL, AS SHOWN IN TYPICAL FORMATIONS HEREON.
- FORMATIONS OVER FOUR DUCTS HIGH REQUIRE 2" SEPARATION AFTER EVERY FOURTH TIER OF DUCTS.
- ALL DUCTS TO BE ENCASED WITH GENTLY STABILIZED SAND UNLESS OTHERWISE SPECIFIED OR REQUIRED.
- CONCRETE ENCLOSURE DUCTS WITHIN AREAS OF GRADE CHANGES MORE THAN 20% (1' IN 5') AND BENDS HAVING RADIUS OF LESS THAN 80 FEET.

AT&T TEXAS/SWBT FACILITIES NOTES:

- The location of AT&T Texas/SWBT facilities are shown in an approximate way only. The contractor shall determine the exact location before commencing work. He agrees to be fully responsible for any and all damages which might be occasioned by his failure to exactly locate and preserve these underground utilities.
- The contractor shall call 1-800-344-8377 a minimum of 48 hours prior to construction to have underground lines field located.
- When excavating within eighteen inches (18") of the indicated location of AT&T TEXAS/SWBT facilities, all excavations must be accomplished using non-mechanized excavation procedures. When boring, the contractor shall expose the AT&T TEXAS/SWBT facilities.
- When AT&T TEXAS/SWBT facilities are exposed, the contractor will provide support to prevent damage to the conduit ducts or cables. When excavating near telephone poles the contractor shall brace the poles for support.
- The presence or absence of AT&T TEXAS/SWBT underground conduit facilities or buried cable facilities shown on these plans does not mean that there are no other cables or other facilities in the area.
- Please contact the AT&T Texas Damage Prevention Manager Mr. Roosevelt Lee Jr. at (713) 867-4502 or e-mail him at r72000@att.com. If there are questions about boring or excavating near any AT&T TEXAS/SWBT facilities.

CENTERPOINT ENERGY GAS AND ELECTRIC FACILITIES NOTES:

CAUTION: UNDERGROUND GAS FACILITIES

Locations of CenterPoint Energy gas lines (to include CenterPoint Energy Intrastate Pipelines, LLC, where applicable) are shown in an approximate location only. Bore pits are not to be used for any and all damages which might be occasioned by his failure to exactly locate and preserve these underground utilities. It does not imply that a conduit analysis has been made. The contractor shall contact the Utility Coordinating Committee at (713) 833-6877 or 1-800-666-8344 a minimum of 48 hours prior to construction to have main and service lines field located.

- When CenterPoint Energy pipe markings are not visible, call (713) 845-8038 or (713) 845-8037 (7:00 a.m. to 4:30 p.m.) for status of the location request before excavation begins.
- When excavating within eighteen inches (18") of the indicated location of CenterPoint Energy facilities, all excavations must be accomplished using non-mechanized excavation procedures.
- When AT&T TEXAS/SWBT facilities are exposed, sufficient support must be provided to the facilities to prevent excessive stress on the pipes.
- For emergencies regarding gas lines call (713) 868-3502 or (713) 307-6200.

The contractor is fully responsible for any damages caused by his failure to exactly locate and preserve these underground facilities.

WARNING: OVERHEAD ELECTRICAL LINES

Overhead lines may exist on the property. The location of overhead lines has not been shown on these drawings as the lines are clearly visible, but you should locate them prior to beginning any construction. Texas law, Section 751, Health & Safety Code forbids activities that occur in close proximity to high voltage lines, specifically:

- Any activity where person or things may come within six (6) feet of the overhead high voltage lines;
- Operating a crane, aerial, power shov, drilling rig, pile driver, hoisting equipment, or similar apparatus within 10 feet of the overhead high voltage lines.

Parties responsible for the work, including contractors are legally responsible for the safety of construction workers under this law. This law carries both criminal and civil liability. To arrange for lines to be turned off or removed call CenterPoint Energy at (713) 307-2222.

ACTIVITIES ON OR ACROSS CENTERPOINT ENERGY GAS OR ELECTRIC PROPERTY
No approval in use, access or crossing CenterPoint Gas or electric property be given. If you need to use CenterPoint property, please contact our Surveying & Right of Way Division at (713) 207-8248 or (713) 207-8788.

STREET AND BRIDGE NOTES:

- Department of public works and engineering's "Standard Construction Specifications" and "Standard Construction Details for Wastewater Collection Systems, Water Lines, Storm Drainage, and Street Paving" unless otherwise noted and approved on these plans. The design is consistent with the minimum standards established in Fort Bend County design standards.
- Fill areas on plans shall be filled in layers not exceeding 6" in depth and each compacted to not less than 95% standard proctor density prior to installation of water line and fill area shall be sealed and fertilized with 10 working days.
- Utility contractor shall provide temporary soil barrier fence on all non-work inside which will remain in place after underground construction is complete.
- Contractor shall provide soil barrier fence on all stages 1 earth fills.
- Existing manholes, vaults, ditches, and structures damaged or removed during construction shall be replaced to Fort Bend County standards, with latest editions and amendments thereto.
- Condition of the road and/or right-of-way upon completion of job, shall be as good as or better than prior to starting work.
- Adequate drainage shall be maintained at all times during construction and any drainage ditch or structure disturbed during construction shall be restored to condition of the road and/or right-of-way upon completion of job, shall be as good as or better than prior to starting work.
- Exposed 12" of reinforcing steel at proposed street joint, if any reinforcing steel exists, use horizontal dowels. Horizontal dowels shall be (6) bars 24" long 24" O-C placed and embedded 8" into the center of the existing slab with "10 ROD" or equal.
- Contractor to take necessary precautions to protect root systems of shrubs, plants and trees along areas of excavation.
- Contractor shall comply with OSHA regulations and state of Texas law concerning excavation, trenching and shoring as specified in Fort Bend County ordinances 867-1107.
- Wheel chair ramps shall be installed in accordance with Fort Bend County standards at all intersections where sidewalk exists and the existing curb or sidewalk is damaged or removed during construction.
- Wastewater collection systems, water lines, storm drainage and street paving shall be constructed in accordance with the Fort Bend County department of public works and engineering's "Standard Construction Specifications" and "Standard Construction Details for Wastewater Collection Systems, Water Lines, Storm Drainage and Street Paving" unless otherwise noted and approved on these plans. The design shall be consistent with the minimum standards established in the "Design Manual for Wastewater Collection Systems" Water Lines, Storm Drainage and Street Paving.
- The contractor shall be fully responsible for any damages to existing water, wastewater, storm sewer and traffic signal conduits. All damages shall be repaired in accordance with the Fort Bend County Dept. of Public Works and Engineering "Standard Construction Specifications" with latest editions and amendments thereto, at no cost to the Fort Bend County.
- Prior to street construction, the contractor shall contact the Department of Public Works and Engineering at 832-384-9578 and comply with all requirements for the issuance of necessary permits/permits orders for street construction.
- Double reinforced blue traffic markers shall be placed 8-inches offset of the centerline of all the hydrant locations by the paving contractor. Hydrants located at intersections shall have a button placed on each side.

TRAFFIC NOTES

AT LEAST 48 HOURS BEFORE EXCAVATING IN STREET R.O.W. OR EASEMENTS CALL UTILITY COORDINATING COMMITTEE.
1-800-245-4549

- CONTRACTOR SHALL PROVIDE AND INSTALL TRAFFIC CONTROL DEVICES IN CONFORMANCE WITH PART IV OF THE TEXAS MANUAL ON UNIFORM TRAFFIC CONTROL DEVICES (TEXAS MUTCD), MOST RECENT EDITION WITH REVISIONS) DURING CONSTRUCTION.
- NO LANES SHALL BE CLOSED DURING THE HOURS OF 8:00 AM TO 7:00 PM AND 4:00 PM TO 8:00 PM MONDAY THRU FRIDAY IN DOWNTOWN/DISTRICT AREA.
- NO LANES OR MAJOR THOROUGHFARES MAY BE CLOSED FROM 8:00 AM TO 8:00 PM AND 4:00 PM TO 7:00 PM UNLESS ADVISED IN THE MOBILITY PLAN.
- NO TRAFFIC LANES SHALL BE CLOSED IN RESIDENTIAL AREA FROM 7:00 AM TO 7:00 PM.
- CONTRACTOR SHALL MAINTAIN ONE LANE OF TRAFFIC IN EACH DIRECTION DURING WORKING HOURS.
- CONTRACTOR SHALL COVER OPEN EXCAVATIONS WITH STEEL PLATES ANCHORED PROPERLY DURING NON-WORKING HOURS, AND OPEN THE LANES FOR NORMAL TRAFFIC FLOW.
- OFF-DUTY UNIFORMED POLICE OFFICER(S)/PLANNERS) MAY BE REQUIRED TO DIRECT TRAFFIC WHEN LANES ARE CLOSED.
- IN THE EVENT THAT NO TRAFFIC CONTROL PLAN EXIST AS A PART OF CONTRACT DRAWINGS, CONTRACTOR MAY PREPARE PLANS AND SUBMIT TO PLAN REVIEW SECTION FOR APPROVAL TEN DAYS PRIOR TO IMPLEMENTATION.
- IF THE CONTRACTOR CHOOSES TO USE A DIFFERENT METHOD OF TRAFFIC CONTROL PLANS DURING THE CONSTRUCTION THAN WHAT IS OUTLINED IN THE CONTRACT DRAWINGS, HE/SHE SHALL BE RESPONSIBLE FOR PREPARING AND SUBMITTING AN ALTERNATE SET OF PLANS TO THE PLAN REVIEW SECTION FOR APPROVAL TEN WORKING DAYS PRIOR TO IMPLEMENTATION.
- APPROVED COPIES OF TRAFFIC CONTROL PLANS AND MOBILITY PERMITS SHALL BE MADE AVAILABLE FOR INSPECTION AT THE JOB SITE AT ALL TIMES. CONTRACTOR MUST SECURE MOBILITY PERMITS FROM THE CITY'S TRAFFIC MANAGEMENT AND MAINTENANCE BRANCH BEFORE CLOSING A LAKE/SIDEWALK. THE REQUEST MUST BE MADE AT LEAST 10 DAYS IN ADVANCE OF THE CLOSURE. NOTE THAT WORKING HOURS MAY BE RESTRICTED OR THE REQUEST MAY BE DENIED.
- THESE PLANS SHALL BE DRAWN TO SCALE ON REPRODUCIBLE MYLAR AND SEALED BY A LICENSED ENGINEER IN THE STATE OF TEXAS. PLANS WILL BECOME A PART OF THE CONTRACT DRAWINGS.

SWPPP CONSTRUCTION NOTES

- Contractor shall implement protection ditches and Reinforced Filter Fabric barrier along road and side ditches at locations shown on the Typical Storm Water Pollution Prevention (SWPPP) plans to keep silt and/or associated materials from entering into the storm water ditches and ditches eventually polluting the receiving stream.
- During the excavation phase of the project, Contractor shall schedule the work in short segments so that associated material can be quickly loaded off from the site and to prevent it from staying uncollected on the existing pavement. Any loose associated material which falls on pavements or ditches shall be swept back into the associated area.
- Contractor shall clean up the existing street intersections and driveways daily, as necessary, to remove any excess mud, silt or rock tracked from the associated area.
- Contractor shall follow good housekeeping practices during construction of the project, always clearing up dirt and loose material as construction progresses.
- Contractor to inspect and maintain areas located below at least once every fourteen (14) calendar days and within 24 hours of the end of a storm event of 0.5 inches or greater.
- Disturbed areas of the construction site that have not been fully stabilized. Areas used for storage of materials that are exposed to precipitation. Structural control measures. Locations where vehicles enter or exit the site.
- Contractor to be responsible to maintain existing ditches and/or culverts for unobstructed drainage at all times. Where existing is disturbed by excavation or backfilling operations, such areas shall be replaced by trenching or adding. Slopes 4:1 or steeper shall be replaced by block masonry.

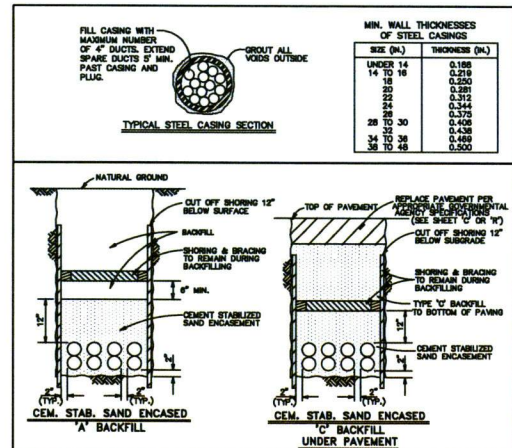

Comcast

22123 Brown Street, D. City, TX 77064
281-352-3460

Jier, LLC
FIRM #8397

Binkley & Barfield, Inc.
consulting engineers
1015 West Loop West, Suite 1000
Houston, Texas 77060
(713) 867-1107

COMCAST SHALL INSTALL 1-2" H.D.P.E. CONDUIT FROM THE INTERSECTION OF KATY FLEWELLEN ROAD AND GASTON ROAD TO APPROXIMATELY 2,130' EAST OF THE INTERSECTION OF KAREN LANE AND GASTON ROAD

EXHIBIT
JT-70734-CIN-FORT BEND COUNTY
GASTON ROAD UTILITY RELOCATION

DESIGNED BY: BBI
DRAWN BY: PNI
DWG. NO.

LAMBERT: BBI
DATE: 04/05/2018
KEY MAP: 332J-K-N-P

DRAWING SCALE
VERT: NONE
HORIZ: 1"=20' (22x34)
HORIZ: 1"=40' (11x17)
SHEET NO. 2 OF 13

A. GENERAL CONDITIONS

- The following general conditions apply to excavations.
- The contractor shall at all times take proper precautions and be responsible for the protection of existing street and alley surfaces, driveway curbs, street intersection curbs or aprons, irrigation systems, mail boxes, fire hydrants, approaches, curbs, gutters, and sidewalks and all other identifiable installations that may be encountered during the work.
- The contractor shall take proper precautions for the protection of existing utilities, the presence of which are known or can be determined by field locations of the utility companies.
- Existing improvements to adjacent property such as landscaping, fencing, utility services, driveway surfaces, etc., that are not to be removed shall be protected from injury or damage resulting from the contractor's work.
- The contractor shall keep photographs of the site prior to commencement of work to provide a record of preexisting conditions.
- The contractor shall at all times take proper precautions for the protection of property plus/owners and survey control monuments encountered during construction. A registered land surveyor at the contractor's expense shall replace any damaged or disturbed survey markers.
- The repair of any damaged improvements as described above shall be the responsibility of the contractor.
- The contractor shall make adequate provisions to ensure that traffic and adjacent property owners experience no more than a minimum of inconvenience.
- Temporary Surfaces Required**
Where a temporary surface is required, the temporary installation and maintenance thereof shall be the responsibility of the contractor until the permanent surface is completed and accepted. The surface shall be either a hot mix or cold mix paving material or steel plate. Temporary surfaces shall be compacted, rolled smooth and sealed to prevent degradation of the repair and existing structures during the temporary period. Steel plating may be utilized for a period not to exceed 4 days unless specified differently as part of the permit.
- Work to be Done in Expedient Manner
All work shall be done in an expedient manner. Repairs shall be made as rapidly as is consistent with high quality workmanship and materials. Use of fast setting concrete and similar techniques are encouraged whenever possible without sacrificing the quality of repair. Completion of the work including replacement of pavement and cleanup shall normally be accomplished within 14 days after the repair work or activity involving the cut is commenced. Extension of time for completions shall be with the written approval of the City Engineer and noted on the permit. If the repairs are not completed in the allotted time, the City has the right to repair the street at the contractor's expense, as provided in Section 40-156 of the Ordinance.
- STREET RESTORATION**
All restoration shall be performed in compliance with provisions of the Fort Bend County Department of Public Works and Engineering Design Manual.
- TRAFFIC SIGNALS**
Whenever any restoration is to be performed within 500 feet of a signalized intersection, special care and coordination must be exercised to the maximum extent possible. In addition to the standard traffic signals, the contractor may be required to provide modified traffic signal timing parameters, at its cost, by a Licensed Professional Engineer. The contractor is responsible to repair or replace at its own expense any damage to the traffic control resources, including but not limited to vehicle loops, home-run, sub-station, and other equipment. The contractor must hire experienced and qualified personnel and restore the signal to its original operational function. All materials, labor, and procedures must be according to the specifications of the City's Traffic Management and Maintenance Branch. Should the proposed scope of work conflict with the existing traffic signals (signals, detectors, etc.), the contractor is responsible for identifying and implementing any and all temporary measures (outside the contractor's box) required to continue traffic control operations during construction in accordance with the Texas Manual on Uniform Traffic Control Devices and the City's Traffic Engineering Guidelines. These measures as well as the traffic management plan are to be approved by the City's Traffic Engineer.
- TRAFFIC MARKINGS**
Traffic markings that were removed or damaged during the excavation process must be replaced with the same product or current city standard that is existing on the road. In addition, new markings must be installed prior to and beyond the excavation area to provide the proper constant visibility to the material. These boundaries may extend to the nearest intersection on both sides of the excavated site. Temporary markings must be in place at all times when the site is open to traffic. The permanent markings must be replaced immediately after the excavation is completely restored. The contractor must hire a firm specializing in the application of traffic markings, and all materials, labor and procedure must be according to the standard specifications of the City's Traffic Management and Maintenance Branch. The contractor is responsible for all costs.

WASTEWATER NOTES

- Sanitary sewers shall be built according to Fort Bend County specifications and/or all applicable building codes.
- Manholes shall be built in accordance with Fort Bend County drawing No. 02801-02C for sewers 6" to 24" or drawing No. 02801-03C for sewers 27" to 60". All manholes must be precast, with the base slab reinforced with No. 5 bars at 8" on center, each way. Brick manholes are not allowed.
- All sanitary sewer pipe and fittings, unless labeled in the plans as ductile iron (D.I.P.), shall be P.V.C. and shall conform to ASTM D-2241. P.V.C. pipe material shall conform to ASTM D-1784 with a resin class classification of 12454-B (PVC 1120). P.V.C. pipe shall have elastomeric joints conforming to ASTM D-3338 and gaskets conforming to ASTM D-477. All 6" & 10" gravity sanitary sewers shall be constructed using SDR 26 PVC or 400 DR 18" pipe unless otherwise specified. P.V.C. force main shall meet or exceed the requirements for SDR 21 (PR 200) pipe. Ductile iron pipe shall be in conformance with AWWA C-151 and AWWA C-111, standard class 350, with bell and spigot push-on joints. D.I.P. shall have an interior of 40 MLS polyethylene, and an exterior of 8 MLS polyethylene wrap.
- All P.V.C. sanitary sewer pipe shall have bedding and backfill as shown on Fort Bend County drawing No. 02317-08. No separate pay.
- Sanitary sewers located under or within one-foot of proposed or future paving shall be backfilled with cement stabilized sand (1-1/2 sack/cubic yard) to within an foot of pavement as shown on Fort Bend County drawing No. 02801-04 and 02227-01C. No separate pay. (Lab verification will be required prior to placement of pavement).
- All sewer lines that require dewatering for installation shall be batted and installed in general conformance with Fort Bend County Standards.
- All sewer lines 18 inch or greater in depth (as measured from the manhole rim to the bottom of the pipe) shall be batted and videotaped by the contractor in the presence of the engineer. Tapes shall be made in the VHS format, in color, and two complete copies shall be provided to the owner.
- All sanitary sewer manhole rims shall be set 3" to 5" above surrounding finished grade, with sloped fill added for storm water drainage away from the manhole rim. Where specified in the plans, sanitary manholes below the 100-YEAR FLOOD PLAIN (or where otherwise required) shall have the rim set flush with the finished grade. The rim shall be waterproofed using a neoprene gasket. Only stainless steel screws or nuts & bolts can be used to hold down the cover.
- All 6" sanitary service leads shall be laid with a minimum grade of 1.0%.
- Deflection tests shall be performed on all flexible and semi-rigid pipe, except service leads. The test shall be conducted after the final backfill has been in place at least 30 days. No pipe shall exceed a deflection of 5%. The test is to be run using a mandrel having an outside diameter equal to 95% of the average inside diameter of the pipe. The mandrel shall have a minimum of 9 runners, with the contact length of each runner equal to or greater than the pipe's nominal diameter. The test shall be performed without mechanical pulling devices.
- All sanitary sewer manhole rims shall be set 3" to 5" above surrounding finished grade, with sloped fill added for storm water drainage away from the manhole rim.
- Sanitary sewer lines parallel to water lines shall be installed with at least a 9-foot clearance and in separate trenches.
- Sanitary lines crossing below water lines must have a full length joint (20' nominal) centered at the crossing with a minimum separation distance of two-feet.
- Sanitary sewer force mains shall be brown or green and shall be labeled every two feet, "NON POTABLE WATER."
- All sanitary service leads shall be labeled every two feet, "NON POTABLE WATER."
- All gravity sanitary sewers shall be air tested per specifications.

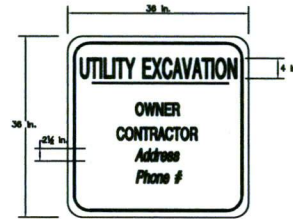

The contractor to place signs prior to beginning construction at the beginning and end of the project limits and at the intersections. The signs are to remain up 24 hours a day until the utility construction and the pavement restoration is complete.

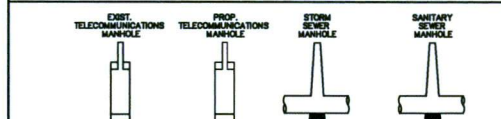
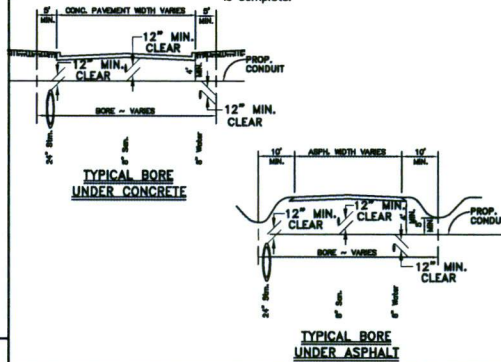

| ABBREVIATIONS | |
|------------------------------|---------------------------------|
| Asph. Asphalt | H.R. Hand Room |
| B.S. Back to Back | L.T. Lift Station |
| B.M. Benchmark | M.H. Manhole |
| B.L.R. Back to Back | N.L. Not Found in Field |
| C.M. Cement | O.D. Offset |
| C.L.R. Centerline | P.O. Potentiometer |
| C. of Fort Bend County | P.O.D. Potentiometer |
| Conc. Concrete | P.L. or P. Property Line |
| Condu. Conduit | PROP. Proposed |
| Const. Construction | R.C.P. Reinforced Concrete Pipe |
| C.A.P. Corrugated Metal Pipe | R.C.P. Reinforced Concrete Pipe |
| Cul. Culvert | R.O.W. Right-of-Way |
| Elav. Elevation | S.E.P. Sanitary Sewer Easement |
| Elav. Electric or Electronic | S.E.P. Sanitary Sewer Easement |
| Elav. Elevation | S.H. Street |
| F.B. Fort Bend County | S.W. Sewer |
| F.H. Fire Hydrant | |
| F.P. Future | |
| F.C.D. Fort Bend County | |
| H.C.F.D. Central District | |

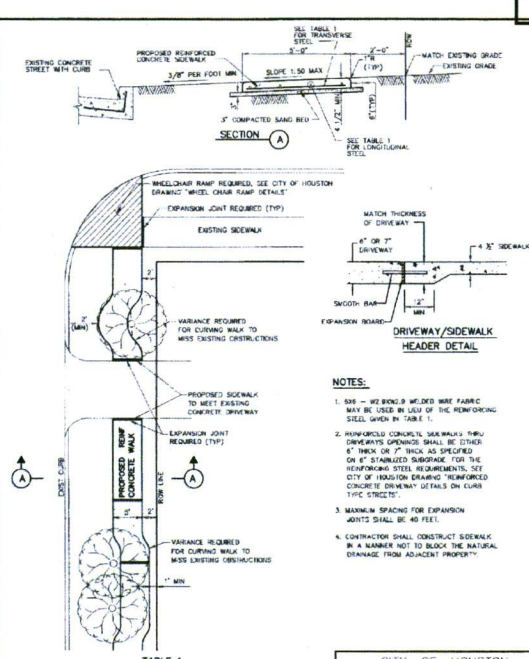

| | | | | | | |
|---|---|--|----|------------------------------------|--|---|
| REINFORCING STEEL INFORMATION FOR 4" x 8" THICK SIDEWALKS ELEVATION JOINT SPACING = 40 FT $\Delta = 3.006$ PSI AND $\Delta = 63.000$ PSI | | | | | DEPARTMENT OF PUBLIC WORKS AND ENGINEERING | |
| CONCRETE SIDEWALK DETAILS FOR STREETS WITH CURBS | | | | | | |
| SIDEWALK THICKNESS (IN) | | SIDEWALK BULKHEAD (IN) | | # 3 BARS NUMBER OF BARS | SPACING IN (IN) SPACING IN (IN) | TRANSVERSE STEEL # 3 BARS SPACING IN (IN) |
| 4.5 | 5 | 2 | 2 | 48 | 48 | 48 |
| 4.5 | 6 | 4 | 22 | 3 | 48 | |
| APPROVED:  STEVE CHAVALER | | DIRECTOR OF PUBLIC WORKS AND ENGINEERING | | DT DATE JUL-01-2010 DT NO 02775-01 | | |

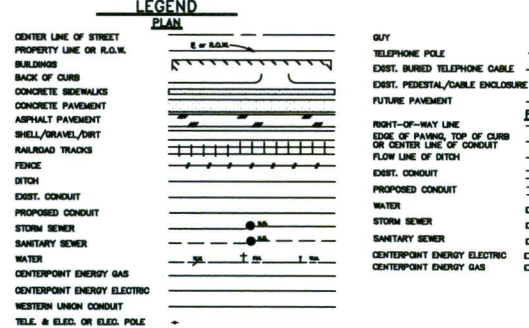

Comcast
7033 AIRPORT BLVD.
HOUSTON, TX 77061-3912

22123 Brown Street, G. Kelly, TX 77064
Jier, LLC
FIRM #9397

3 **Stinkley & Barfield, Inc.**
consulting engineers
10315 Katy Road, Suite 100
Houston, TX 77058-1000
Tel: 281-461-1000
Fax: 281-461-1001

COMCAST SHALL INSTALL 1-2" H.D.P.E. CONDUIT FROM THE INTERSECTION OF KATY FLEWELLEN ROAD AND GASTON ROAD TO APPROXIMATELY 2,130' EAST OF THE INTERSECTION OF KAREN LANE AND GASTON ROAD

EXHIBIT
JT-70734-CIN-FORT BEND COUNTY
GASTON ROAD UTILITY RELOCATION

DESIGNED BY: BBI
DRAWN BY: BP
DWG. NO.
DATE: 04/05/2018
KEY MAP: 332J-K-N-P

LAMBERT: BBI
SHEET NO. 3 OF 13

AT LEAST 48 HOURS BEFORE EXCAVATING IN STREET R.O.W. OR EASEMENTS CALL UTILITY COORDINATING COMMITTEE.
1-800-243-4343

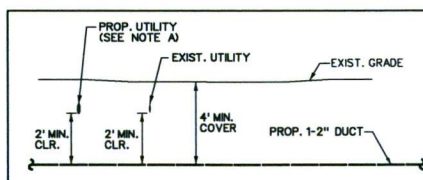
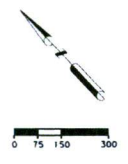
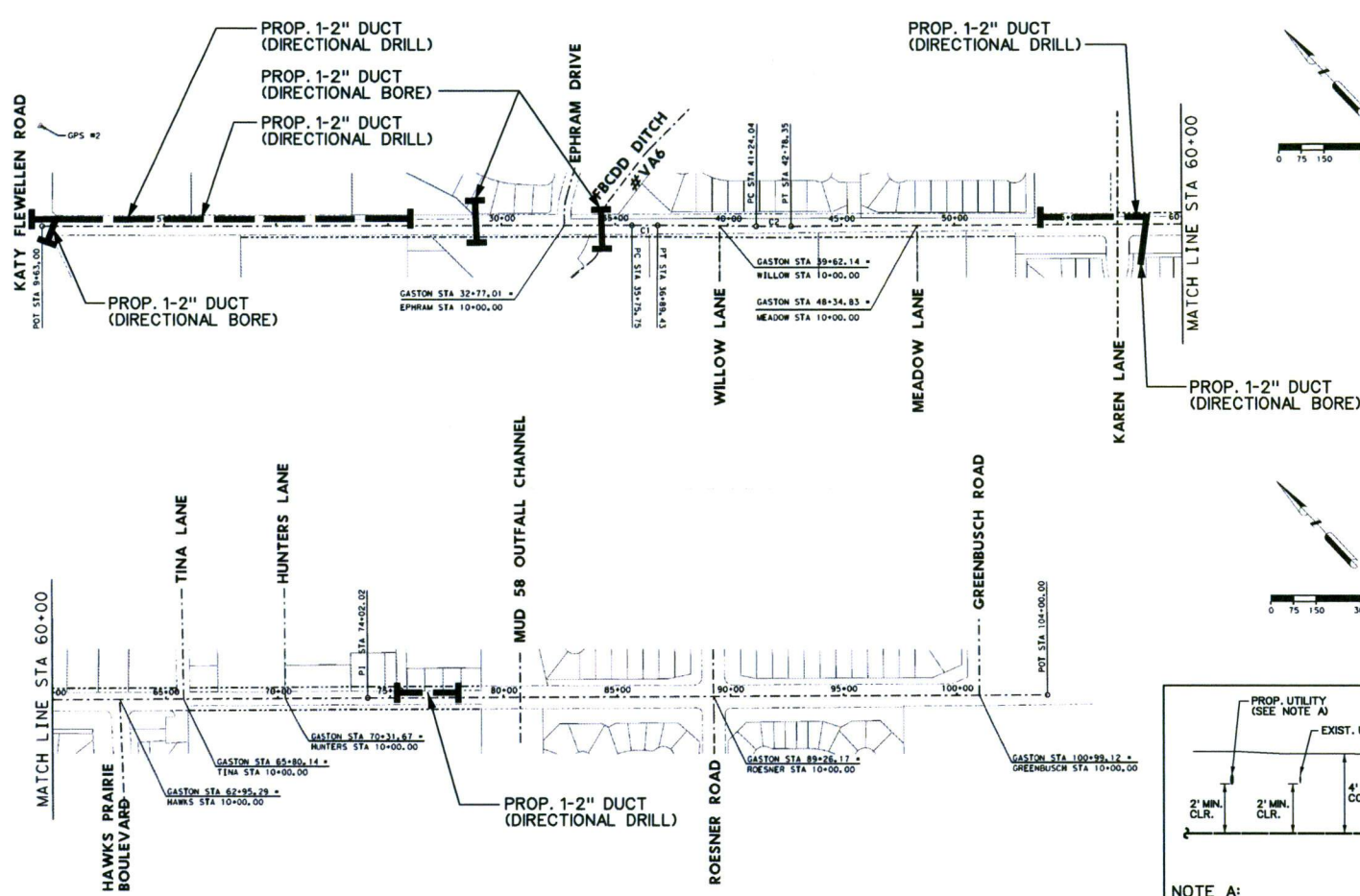

NOTE A:
SEE FORT BEND COUNTY ENGINEERING DEPARTMENT PLANS FOR CONSTRUCTION OF IMPROVEMENTS FROM KATY FLEWELLEN ROAD TO GREENBUSCH ROAD PLAN AND PROFILE DRAWING FOR PROPOSED UTILITY LOCATIONS AND DEPTHS.

TYPICAL CONSTRUCTION DETAIL

COMCAST DUCT LAYOUT

| | | | | | | | |
|--|--|--|--|--|---|--|--|
| <p>7033 AIRPORT BLVD. HOUSTON, TX 77061-3812</p> | <p>22123 Houston, TX 77044 817-893-3400</p> <p>Jier, LLC Firm #9357</p> | <p>Binkley & Barfield, Inc. consulting engineers Texas Registration Number F-287 1000 West 17th Street P.O. Box 2020 Fort Worth, TX 76101</p> | <p>COMCAST SHALL INSTALL 1-2" H.D.P.E. CONDUIT FROM THE INTERSECTION OF KATY FLEWELLEN ROAD AND GASTON ROAD TO APPROXIMATELY 2,130' EAST OF THE INTERSECTION OF KAREN LANE AND GASTON ROAD</p> | <p>EXHIBIT JT-70734-CIN-FORT BEND COUNTY GASTON ROAD UTILITY RELOCATION</p> | <p>DESIGNED BY: BBI DRAWN BY: PN DWG. NO.</p> | <p>LAMBERT: BBI DATE: 04/05/2018 KEY MAP: 332J-K-N-P</p> | <p>DRAWING SCALE VERT: NONE HORIZ: 1"=20' (22X34) HORIZ: 1"=40' (11X17) SHEET NO. 4 OF 13</p> |
|--|--|--|--|--|---|--|--|

DIRECTIONAL DRILL

AT LEAST 48 HOURS BEFORE EXCAVATING IN STREET R.O.W. OR EASEMENTS CALL UTILITY COORDINATING COMMITTEE.
1-800-245-4545

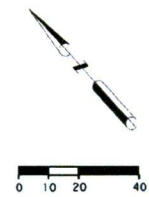
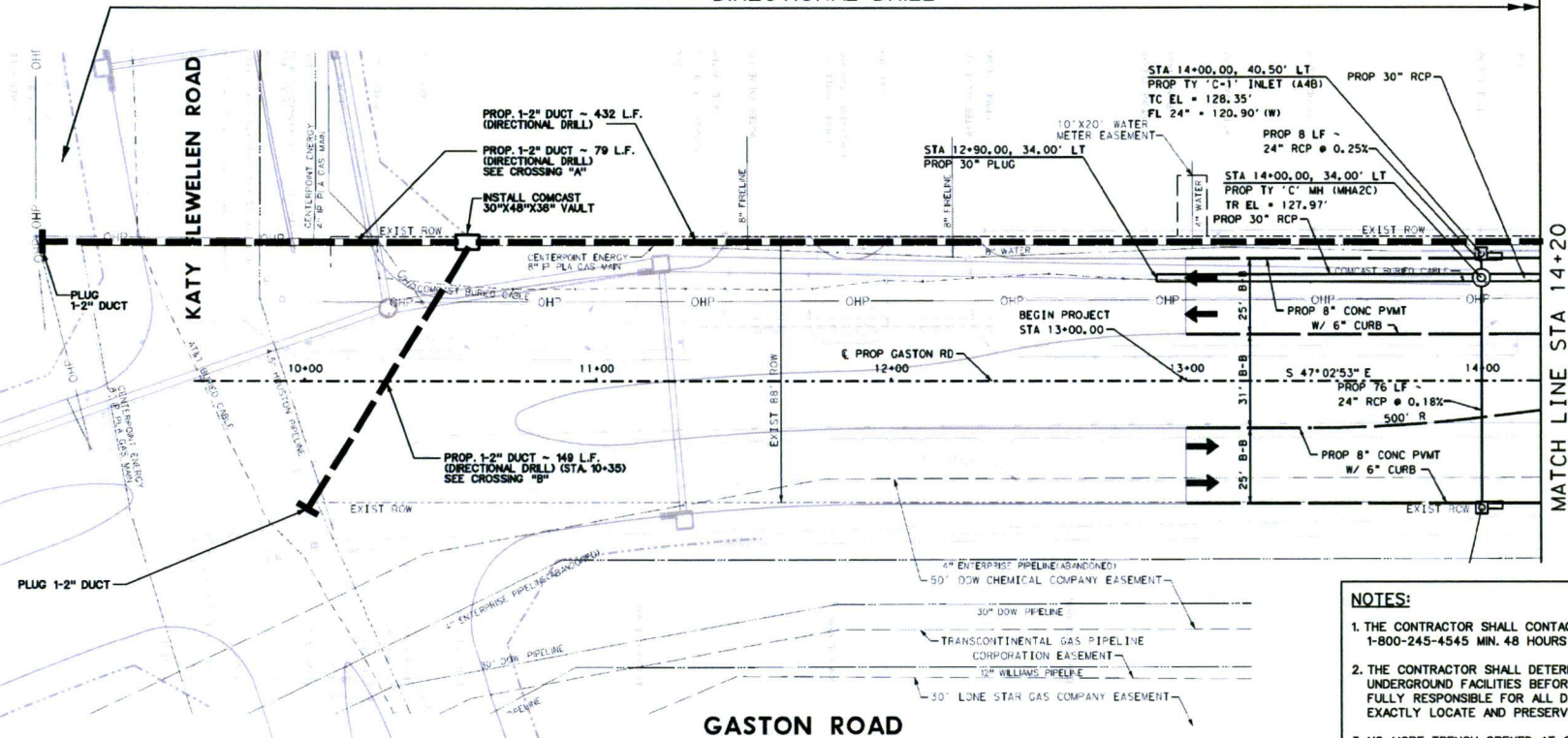

NOTES:

1. THE CONTRACTOR SHALL CONTACT TEXAS ONE CALL SYSTEM AT 1-800-245-4545 MIN. 48 HOURS BEFORE DIGGING.
2. THE CONTRACTOR SHALL DETERMINE THE EXACT LOCATION OF ALL UNDERGROUND FACILITIES BEFORE COMMENCING WORK AND AGREE TO BE FULLY RESPONSIBLE FOR ALL DAMAGES CAUSED BY HIS FAILURE TO EXACTLY LOCATE AND PRESERVE ALL UNDERGROUND FACILITIES.
3. NO MORE TRENCH OPENED AT ONE TIME THAN CAN BE BACKFILLED AND COMPACTED IN 10" LIFTS AT THE END OF EACH DAY. (NO TRENCH LEFT OPENED OVERNIGHT)
4. ALL EXCESS EXCAVATION TO BE REMOVED FROM THE ROAD RIGHT-OF-WAY AT THE END OF THE DAY.
5. DITCHES TO BE OPENED AT THE END OF EACH DAY TO ASSURE ADEQUATE DRAINAGE.
6. ROAD MUST BE KEPT OPEN TO TRAFFIC AND CONTRACTOR MUST PROVIDE ADEQUATE FLAGMEN, SIGNALS, ETC., TO PROVIDE COMPLETE SAFETY TO THE PUBLIC.
7. IF IT BECOMES NECESSARY FOR EQUIPMENT TO OPERATE ON A PORTION OF THE PAVEMENT, PRECAUTIONS MUST BE TAKEN TO PREVENT ANY DAMAGE WHATSOEVER TO THE PAVEMENT.
8. CONDITION OF ROAD UPON COMPLETION OF JOB SHALL BE AS GOOD OR BETTER THAN PRIOR TO STARTING.
9. CONTRACTOR SHALL COMPLY WITH ALL APPLICABLE NATIONAL ELECTRICAL SAFETY CODE (NEC) REQUIREMENTS, CENTERPOINT ENERGY ELECTRIC POLE ATTACHMENT GUIDELINES & PROCEDURES AND ALL APPLICABLE LOCAL REQUIREMENTS AND REGULATIONS FOR PLACEMENT OF AERIAL CABLE FACILITIES. 18' MIN. VERTICAL CLEARANCE.

NOTES: CONTRACTOR SHALL BORE ALL DRIVEWAYS.

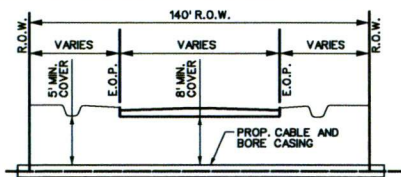

KATY FLEWELLEN RD
(FACING NORTHWEST)
CROSSING "A"

NOTES: CONTRACTOR SHALL BORE ALL DRIVEWAYS.

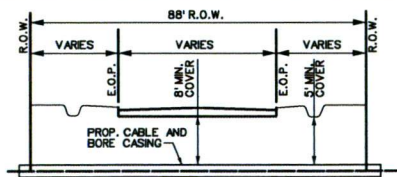

GASTON RD
(FACING SOUTHWEST)
CROSSING "B"

NOTES: CONTRACTOR SHALL BORE ALL DRIVEWAYS.

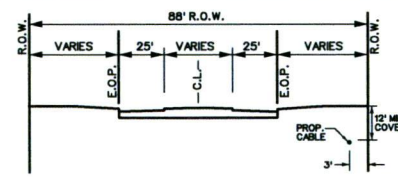

GASTON RD
(WORKING NORTHWEST)

COMCAST SHALL INSTALL 1-2" H.D.P.E. CONDUIT FROM THE INTERSECTION OF KATY FLEWELLEN ROAD AND GASTON ROAD TO APPROXIMATELY 2,130' EAST OF THE INTERSECTION OF KAREN LANE AND GASTON ROAD

EXHIBIT
JT-70734-CIN-FORT BEND COUNTY
GASTON ROAD UTILITY RELOCATION

DESIGNED BY: BBI
DRAWN BY: PN
DWG. NO.

LAMBERT: BBI
DATE: 04/05/2018
KEY MAP: 332J-K-N-P

DRAWING SCALE
VERT: NONE
HORIZ: 1"=20' (22X34)
HORIZ: 1"=40' (11X17)
SHEET NO. 5 OF 13

Comcast
7033 AIRPORT BLVD.
HOUSTON, TX 77061-3812

22123 Houston, Texas, Co. Katy, TX 77064
817-493-3300
Jier, LLC
FIRM #93597

Binkley & Barfield, Inc.
consulting engineers
Texas Registration Number F-287
1000 West 17th Street
P.O. Box 5050 Houston, TX 77245



NOTES: CONTRACTOR SHALL
BORE ALL DRIVEWAYS.

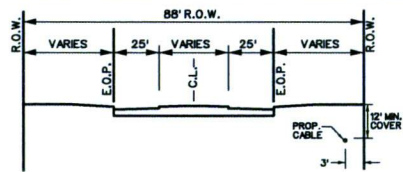

GASTON RD
(WORKING NORTHWEST)

Binkley & Barfield, Inc.
consulting engineers
Team Registration Number F-287
1705 New York Dr., Suite 200
(713) 582-3433 (713) 582-6702 FAX

EXHIBIT
JT-70734-CIN-FORT BEND COUNTY
GASTON ROAD UTILITY RELOCATION

LAMBERT: BBI
DATE: 04/05/2018
KEY MAP: 332J-K-N-P

| | |
|-----------------------|--|
| DRAWING SCALE | |
| VERT.: NONE | |
| HORIZ: 1"=20' (22X34) | |
| HORIZ: 1"=40' (11X17) | |
| SHEET NO. 6 OF 13 | |

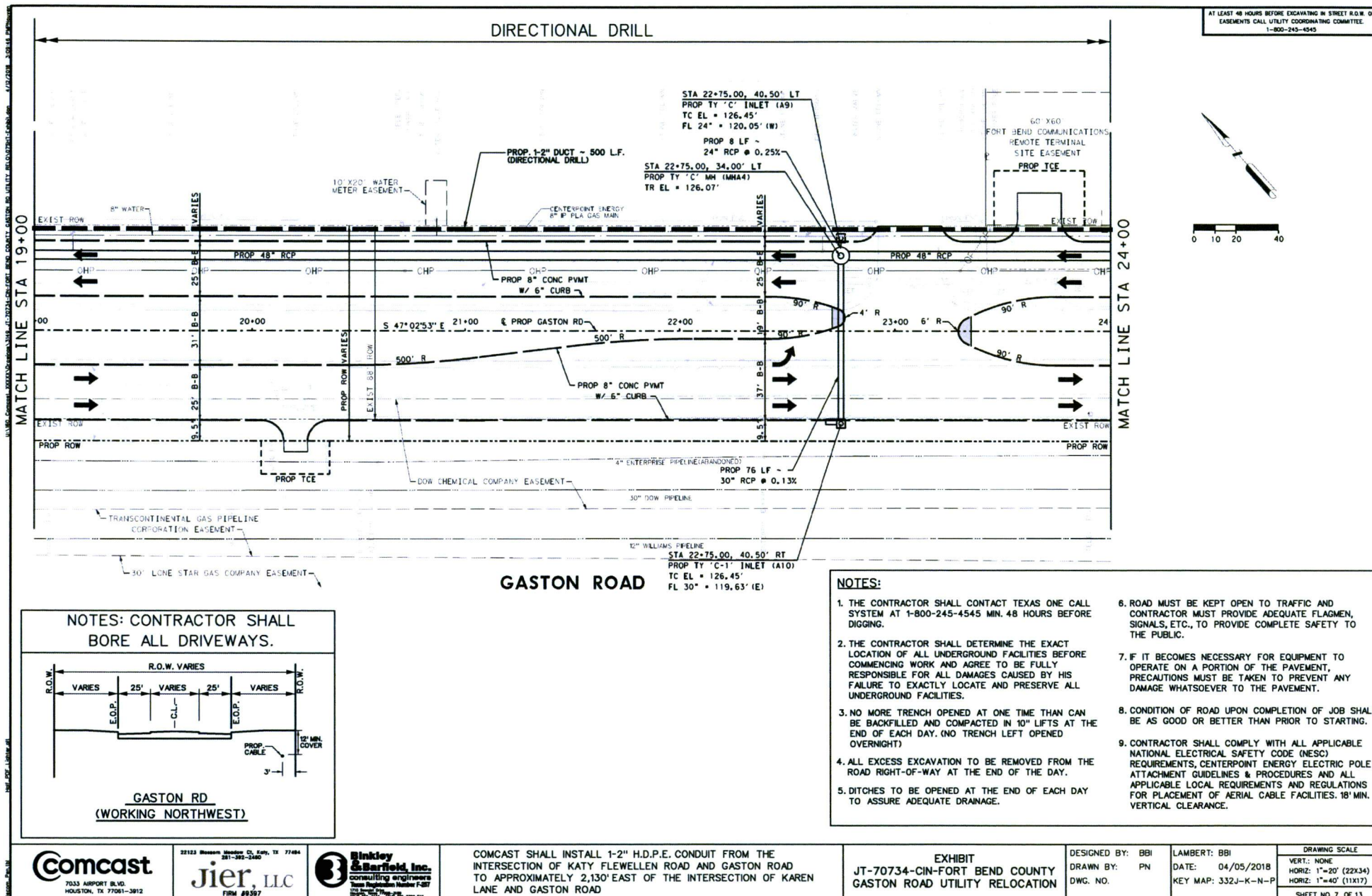

DIRECTIONAL DRILL

AT LEAST 48 HOURS BEFORE EXCAVATING IN STREET R.O.W. OR EASEMENTS CALL UTILITY COORDINATING COMMITTEE.
1-800-245-4545

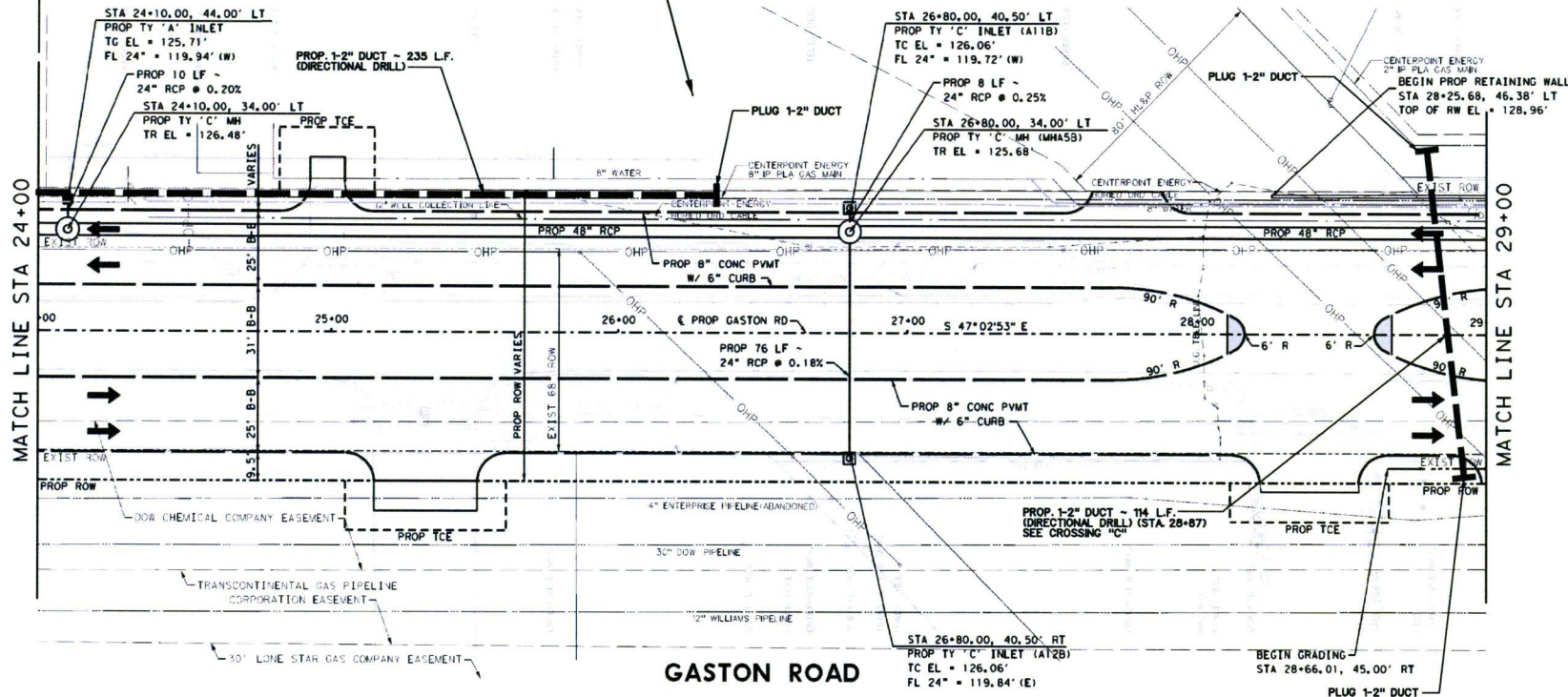

NOTES: CONTRACTOR SHALL BORE ALL DRIVEWAYS.

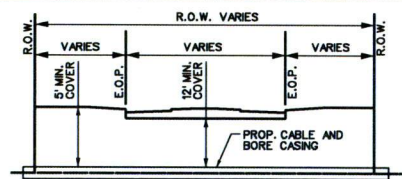

GASTON RD
(FACING NORTHEAST)
CROSSING "C"

NOTES: CONTRACTOR SHALL BORE ALL DRIVEWAYS.

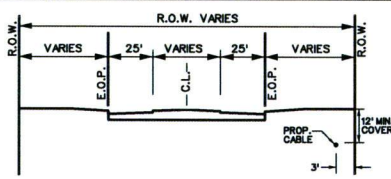

GASTON RD
(WORKING NORTHWEST)

NOTES:

1. THE CONTRACTOR SHALL CONTACT TEXAS ONE CALL SYSTEM AT 1-800-245-4545 MIN. 48 HOURS BEFORE DIGGING.
2. THE CONTRACTOR SHALL DETERMINE THE EXACT LOCATION OF ALL UNDERGROUND FACILITIES BEFORE COMMENCING WORK AND AGREE TO BE FULLY RESPONSIBLE FOR ALL DAMAGES CAUSED BY HIS FAILURE TO EXACTLY LOCATE AND PRESERVE ALL UNDERGROUND FACILITIES.
3. NO MORE TRENCH OPENED AT ONE TIME THAN CAN BE BACKFILLED AND COMPACTED IN 10" LIFTS AT THE END OF EACH DAY. (NO TRENCH LEFT OPENED OVERNIGHT)
4. ALL EXCESS EXCAVATION TO BE REMOVED FROM THE ROAD RIGHT-OF-WAY AT THE END OF THE DAY.
5. DITCHES TO BE OPENED AT THE END OF EACH DAY TO ASSURE ADEQUATE DRAINAGE.
6. ROAD MUST BE KEPT OPEN TO TRAFFIC AND CONTRACTOR MUST PROVIDE ADEQUATE FLAGMEN, SIGNALS, ETC., TO PROVIDE COMPLETE SAFETY TO THE PUBLIC.
7. IF IT BECOMES NECESSARY FOR EQUIPMENT TO OPERATE ON A PORTION OF THE PAVEMENT, PRECAUTIONS MUST BE TAKEN TO PREVENT ANY DAMAGE WHATSOEVER TO THE PAVEMENT.
8. CONDITION OF ROAD UPON COMPLETION OF JOB SHALL BE AS GOOD OR BETTER THAN PRIOR TO STARTING.
9. CONTRACTOR SHALL COMPLY WITH ALL APPLICABLE NATIONAL ELECTRICAL SAFETY CODE (NEC) REQUIREMENTS, CENTERPOINT ENERGY ELECTRIC POLE ATTACHMENT GUIDELINES & PROCEDURES AND ALL APPLICABLE LOCAL REQUIREMENTS AND REGULATIONS FOR PLACEMENT OF AERIAL CABLE FACILITIES. 18" MIN. VERTICAL CLEARANCE.

Comcast
7033 AIRPORT BLVD.
HOUSTON, TX 77061-3812

22123 Houston, TX 77044
Jier, LLC
FORM #3597

Stinkley & Barfield, Inc.
consulting engineers
Texas Registration Number F-287
703 261-7777
TX REG. NO. 261-7777

COMCAST SHALL INSTALL 1-2" H.D.P.E. CONDUIT FROM THE INTERSECTION OF KATY FLEWELLEN ROAD AND GASTON ROAD TO APPROXIMATELY 2,130' EAST OF THE INTERSECTION OF KAREN LANE AND GASTON ROAD

EXHIBIT
JT-70734-CIN-FORT BEND COUNTY
GASTON ROAD UTILITY RELOCATION

DESIGNED BY: BBI
DRAWN BY: PN
DWG. NO.

LAMBERT: BBI
DATE: 04/05/2018
KEY MAP: 332J-K-N-P

DRAWING SCALE
VERT: NONE
HORIZ: 1"=20' (22X34)
HORIZ: 1"=40' (11X17)
SHEET NO. 8 OF 13

AT LEAST 48 HOURS BEFORE EXCAVATING IN STREET R.O.W. OR EASEMENTS CALL UTILITY COORDINATING COMMITTEE.
1-800-243-4545

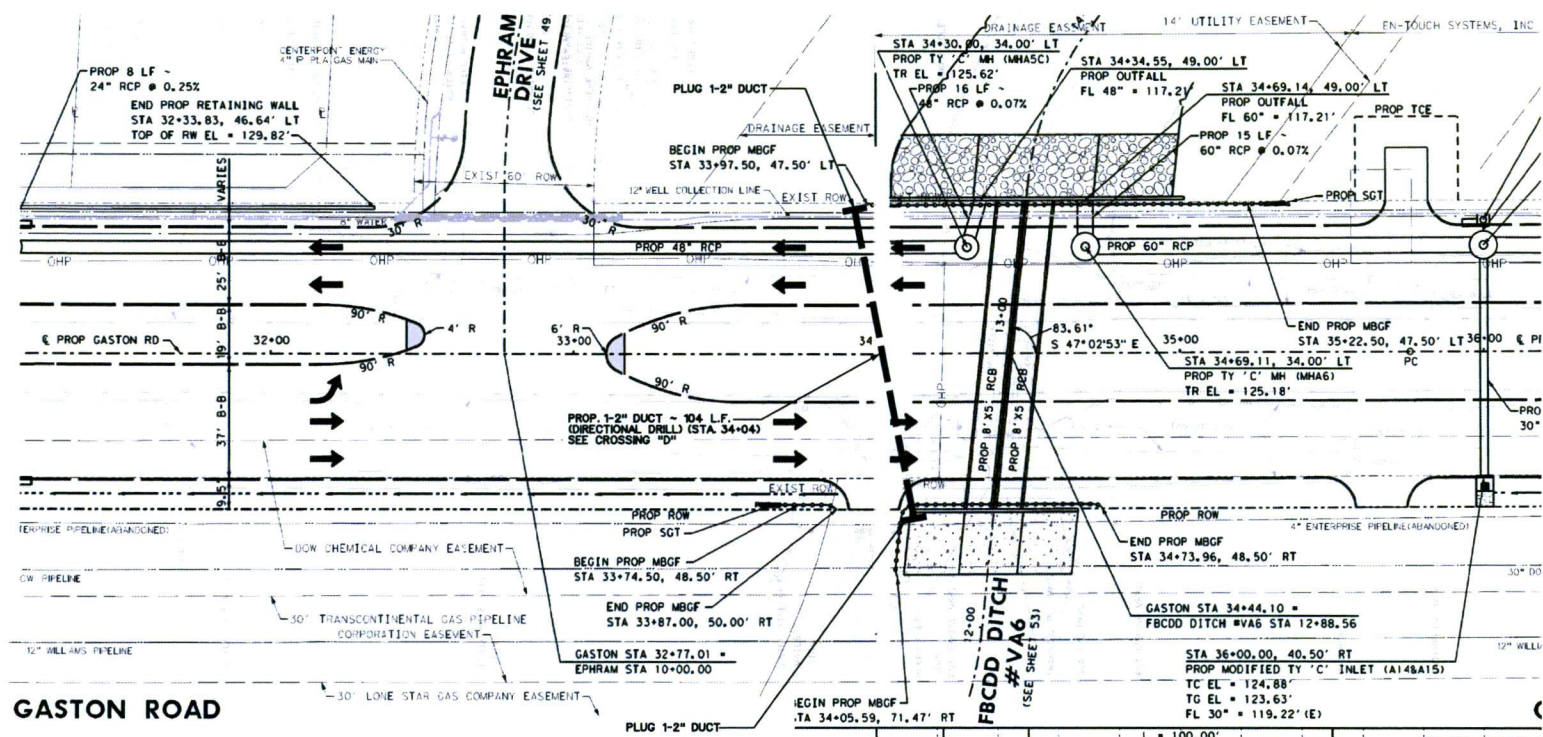

GASTON ROAD

NOTES: CONTRACTOR SHALL BORE ALL DRIVEWAYS.

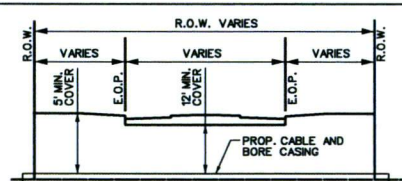

**GASTON RD
(FACING NORTHEAST)
CROSSING "D"**

NOTES:

1. THE CONTRACTOR SHALL CONTACT TEXAS ONE CALL SYSTEM AT 1-800-245-4545 MIN. 48 HOURS BEFORE DIGGING.
2. THE CONTRACTOR SHALL DETERMINE THE EXACT LOCATION OF ALL UNDERGROUND FACILITIES BEFORE COMMENCING WORK AND AGREE TO BE FULLY RESPONSIBLE FOR ALL DAMAGES CAUSED BY HIS FAILURE TO EXACTLY LOCATE AND PRESERVE ALL UNDERGROUND FACILITIES.
3. NO MORE TRENCH OPENED AT ONE TIME THAN CAN BE BACKFILLED AND COMPACTED IN 10" LIFTS AT THE END OF EACH DAY. (NO TRENCH LEFT OPENED OVERNIGHT)
4. ALL EXCESS EXCAVATION TO BE REMOVED FROM THE ROAD RIGHT-OF-WAY AT THE END OF THE DAY.
5. DITCHES TO BE OPENED AT THE END OF EACH DAY TO ASSURE ADEQUATE DRAINAGE.
6. ROAD MUST BE KEPT OPEN TO TRAFFIC AND CONTRACTOR MUST PROVIDE ADEQUATE FLAGMEN, SIGNALS, ETC., TO PROVIDE COMPLETE SAFETY TO THE PUBLIC.
7. IF IT BECOMES NECESSARY FOR EQUIPMENT TO OPERATE ON A PORTION OF THE PAVEMENT, PRECAUTIONS MUST BE TAKEN TO PREVENT ANY DAMAGE WHATSOEVER TO THE PAVEMENT.
8. CONDITION OF ROAD UPON COMPLETION OF JOB SHALL BE AS GOOD OR BETTER THAN PRIOR TO STARTING.
9. CONTRACTOR SHALL COMPLY WITH ALL APPLICABLE NATIONAL ELECTRICAL SAFETY CODE (NEC) REQUIREMENTS, CENTERPOINT ENERGY ELECTRIC POLE ATTACHMENT GUIDELINES & PROCEDURES AND ALL APPLICABLE LOCAL REQUIREMENTS AND REGULATIONS FOR PLACEMENT OF AERIAL CABLE FACILITIES. 18' MIN. VERTICAL CLEARANCE.



COMCAST SHALL INSTALL 1-2" H.D.P.E. CONDUIT FROM THE INTERSECTION OF KATY FLEWELLEN ROAD AND GASTON ROAD TO APPROXIMATELY 2,130' EAST OF THE INTERSECTION OF KAREN LANE AND GASTON ROAD

**EXHIBIT
JT-70734-CIN-FORT BEND COUNTY
GASTON ROAD UTILITY RELOCATION**

DESIGNED BY: BBI
DRAWN BY: PN
DWG. NO.

LAMBERT: BBI
DATE: 04/05/2018
KEY MAP: 332J-K-N-P

DRAWING SCALE
VERT: NONE
HORIZ: 1"=20' (22X34)
HORIZ: 1"=40' (11X17)
SHEET NO. 9 OF 13

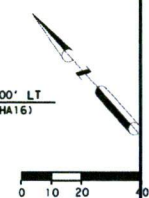

| | |
|-----------------------|--|
| DRAWING SCALE | |
| VERT.: NONE | |
| HORIZ: 1"=20' (22X34) | |
| HORIZ: 1"=40' (11X17) | |
| SHEET NO. 11 OF 13 | |

AT LEAST 48 HOURS BEFORE EXCAVATING IN STREET R.O.W. OR
EASEMENTS CALL UTILITY COORDINATING COMMITTEE.
1-800-245-4545



1. THE CONTRACTOR SHALL CONTACT TEXAS ONE CALL SYSTEM AT 1-800-245-4545 MIN. 48 HOURS BEFORE DIGGING.
2. THE CONTRACTOR SHALL DETERMINE THE EXACT LOCATION OF ALL UNDERGROUND FACILITIES BEFORE COMMENCING WORK AND AGREE TO BE FULLY RESPONSIBLE FOR ALL DAMAGES CAUSED BY HIS FAILURE TO EXACTLY LOCATE AND PRESERVE ALL UNDERGROUND FACILITIES.
3. NO MORE TRENCH OPENED AT ONE TIME THAN CAN BE BACKFILLED AND COMPACTED IN 10" LIFTS AT THE END OF EACH DAY. (NO TRENCH LEFT OPENED OVERNIGHT)
4. ALL EXCESS EXCAVATION TO BE REMOVED FROM THE ROAD RIGHT-OF-WAY AT THE END OF THE DAY.
5. DITCHES TO BE OPENED AT THE END OF EACH DAY TO ASSURE ADEQUATE DRAINAGE.
6. ROAD MUST BE KEPT OPEN TO TRAFFIC AND CONTRACTOR MUST PROVIDE ADEQUATE FLAGMEN, SIGNALS, ETC., TO PROVIDE COMPLETE SAFETY TO THE PUBLIC.
7. IF IT BECOMES NECESSARY FOR EQUIPMENT TO OPERATE ON A PORTION OF THE PAVEMENT, PRECAUTIONS MUST BE TAKEN TO PREVENT ANY DAMAGE WHATSOEVER TO THE PAVEMENT.
8. CONDITION OF ROAD UPON COMPLETION OF JOB SHALL BE AS GOOD OR BETTER THAN PRIOR TO STARTING.
9. CONTRACTOR SHALL COMPLY WITH ALL APPLICABLE NATIONAL ELECTRICAL SAFETY CODE (NESC) REQUIREMENTS, CENTERPOINT ENERGY ELECTRIC POLE ATTACHMENT GUIDELINES & PROCEDURES AND ALL APPLICABLE LOCAL REQUIREMENTS AND REGULATIONS FOR PLACEMENT OF AERIAL CABLE FACILITIES. 18" MIN. VERTICAL CLEARANCE.

GASTON RD
(WORKING NORTHWEST)

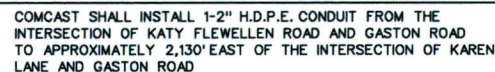

| | |
|------------------|---------------------|
| DESIGNED BY: BBI | LAMBERT: BBI |
| DRAWN BY: PN | DATE: 04/05/2018 |
| DWG. NO. | KEY MAP: 332J-K-N-P |

| |
|-----------------------|
| DRAWING SCALE |
| VERT.: NONE |
| HORIZ: 1"=20' (22X34) |
| HORIZ: 1"=40' (11X17) |
| SHEET NO. 12 OF 13 |

