

**REVIEW BY FORT BEND COUNTY  
COMMISSIONERS COURT**

**Fort Bend County  
Engineering Department**  
301 Jackson Suite 401  
Richmond, Texas 77469  
281.633.7500  
Permits@fortbendcountytx.gov

Right of Way Permit  
 Commercial Driveway Permit  
Permit No: 2017-14015

**Applicant:** PS Light Wave, Inc.

**Job Location Site:** 1100 W. Sycamore Road, Fresno, TX 77545

**Bond No.**                      **Date of Bond:** 12/13/2016 **Amount:** \$50,000.00

The above applicant came to make use of certain Fort Bend County property subject to, "The Order Regulating the Laying, Construction, Maintenance, and Repair of Buried Cables, Conduits, and Pole Lines, In, Under, Across or Along Roads, Streets, Highways, and Drainage Ditches in Fort Bend County, Texas, Under the Jurisdiction of the Commissioners Court of Fort Bend County, Texas," as passed by the Commissioners Court of Fort Bend County, Texas, of the Minutes of the Commissioners Court of Fort Bend County, Texas, to the extent that such order is not inconsistent with Chapter 181, Vernon's Texas Statutes and Codes Annotated.

**Notes:**

1. Evidence of review by the Commissioners Court must be kept on the job site and failure to do so constitutes grounds for job shutdown.
2. Written notices are required:
  - a. 48 hours in advance of construction start up, and
  - b. When construction is completed and ready for final inspection, submit notification to Permit Administrator thru MyGovernmentOnline.org portal.
3. This permit expires one (1) year from date of permit if construction has not commenced.

On this 26th day of September, 2017, Upon Motion of Commissioner Meyers, seconded by Commissioner Patterson, duly put and carried, it is ORDERED, ADJUDGED AND DECREED that said notice of said above purpose is hereby acknowledged by the Commissioners Court of Fort Bend County, Texas, and that said notice be placed on record according to the regulation order thereof.

**Signature**

Presented to Commissioners Court and approved.

By: Charles O. Ay  
County Engineer

Date Recorded 10-6-2017 Comm. Court No. 16B

By: N/A  
Drainage District Engineer/Manager

Clerk of Commissioners Court  
By: Jinda Wilks  
Deputy





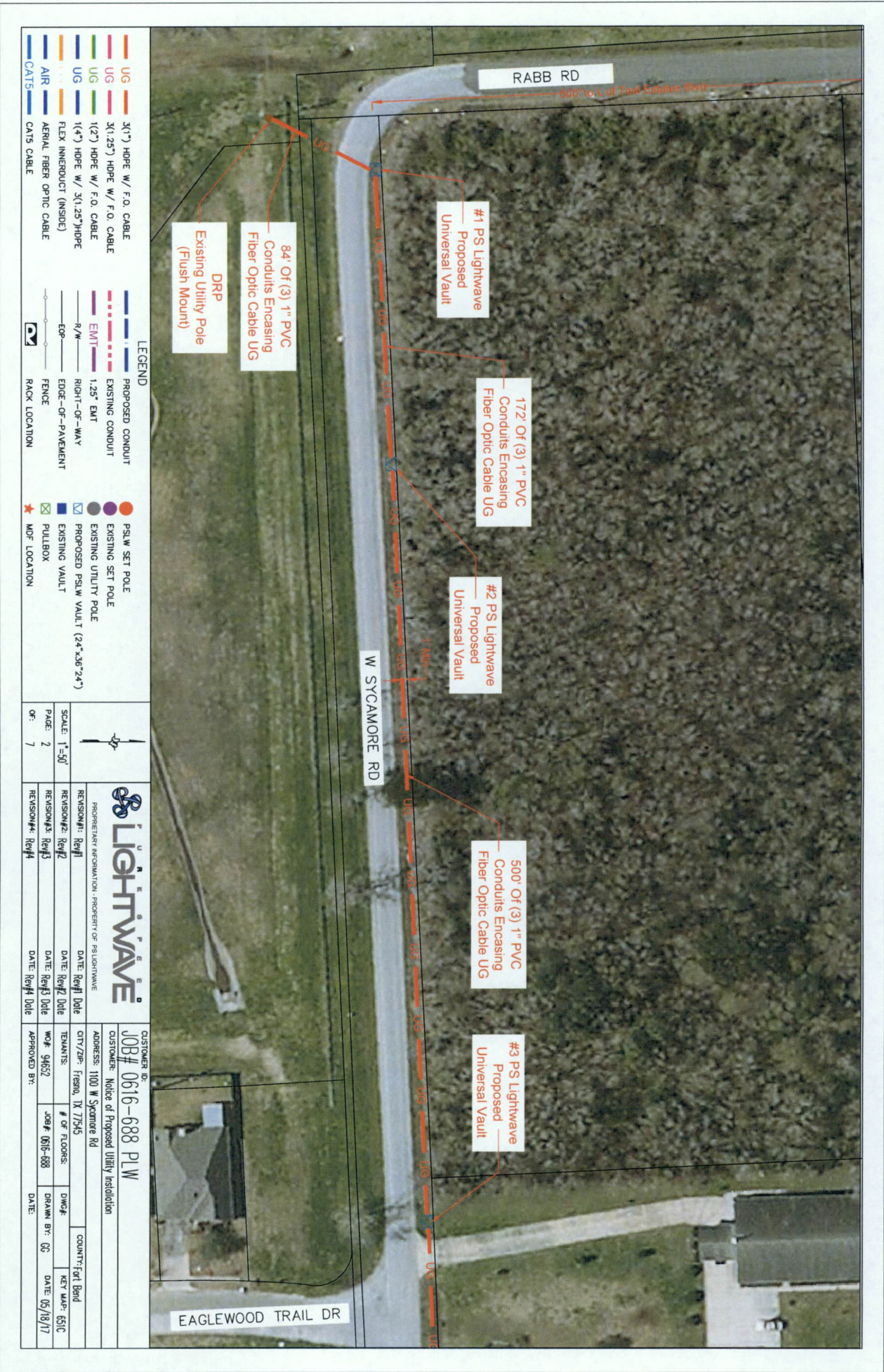

**LEGEND**

	UG	3(1") HDPE W/ F.O. CABLE		PROPOSED CONDUIT
	UG	3(1.25") HDPE W/ F.O. CABLE		EXISTING CONDUIT
	UG	1(2") HDPE W/ F.O. CABLE		1.25" EMT
	UG	1(4") HDPE W/ 3(1.25") HDPE		R/W
	UG	FLEX INNERDUCT (INSIDE)		RIGHT-OF-WAY
	AIR	AERIAL FIBER OPTIC CABLE		EDGE-OF-PAVEMENT
	CAT5	CAT5 CABLE		FENCE
				RACK LOCATION
				MDF LOCATION

	SCALE: 1"=50'
PAGE: 2	OF: 7

<b>PROPRIETARY REGISTRATION, PROPERTY OF LIGHTWAVE</b>	
<b>REVISION#1: Rev#1</b>	DATE: Rev#1 Date
<b>REVISION#2: Rev#2</b>	DATE: Rev#2 Date
<b>REVISION#3: Rev#3</b>	DATE: Rev#3 Date
<b>REVISION#4: Rev#4</b>	DATE: Rev#4 Date

<b>CUSTOMER ID:</b>	<b>JOB# 0616-688 PLW</b>
<b>CUSTOMER:</b>	Notice of Proposed Utility Installation
<b>ADDRESS:</b>	100 W Sycamore Rd
<b>CITY/ZIP:</b>	Fresno, TX 77545
<b>TENANTS:</b>	
<b>WQ#:</b>	94652
<b>APPROVED BY:</b>	
<b>DATE:</b>	05/18/17
<b>COUNTY:</b>	Ft. Bend
<b>KEY MAP:</b>	651C

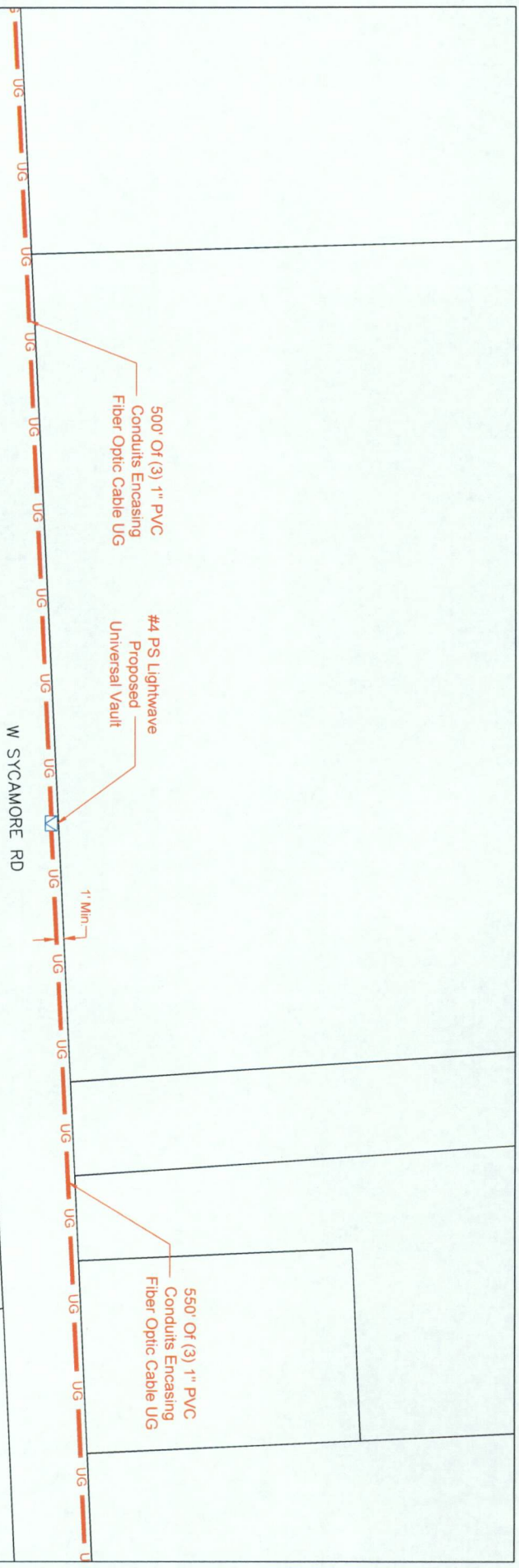

**LEGEND**

	UG	3x(1") HOPE W/ F.O. CABLE		PROPOSED CONDUIT
	UG	3x(1.25") HOPE W/ F.O. CABLE		EXISTING CONDUIT
	UG	1(2") HOPE W/ F.O. CABLE		1.25" EMT
	UG	1(4") HOPE W/ 3x(1.25")HOPE		R/W
	UG	FLEX INNERDUCT (INSIDE)		EDGE-OF-PAVEMENT
	AIR	AERIAL FIBER OPTIC CABLE		FENCE
	CATS	CATS CABLE		RACK LOCATION

	SCALE: 1"=50'
REVISION#1: Rev#1	DATE: Rev#1 Date
REVISION#2: Rev#2	DATE: Rev#2 Date
REVISION#3: Rev#3	DATE: Rev#3 Date
REVISION#4: Rev#4	DATE: Rev#4 Date

**PSLV SET POLE**  
 EXISTING SET POLE  
 PROPOSED PSLV VAULT (24'x36'x4')

**EXISTING UTILITY POLE**  
 EXISTING UTILITY POLE  
 PROPOSED PULLBOX  
 MDF LOCATION

**LIGHTWAVE**  
 PROPRIETARY INFORMATION - PROPERTY OF LIGHTWAVE

**CUSTOMER ID:** JOB# 0616-688 PLW

**CUSTOMER:** Notice of Proposed Utility Installation

**ADDRESS:** 1100 W Sycamore Rd

**CITY/ZIP:** Fresno, TX 77345

**WOP#:** 94632

**JOB#:** 0616-688

**APPROVED BY:**

**DATE:**

**KEY MAP:** 651C

**DATE:** 05/18/17

PAGE 3 OF 7



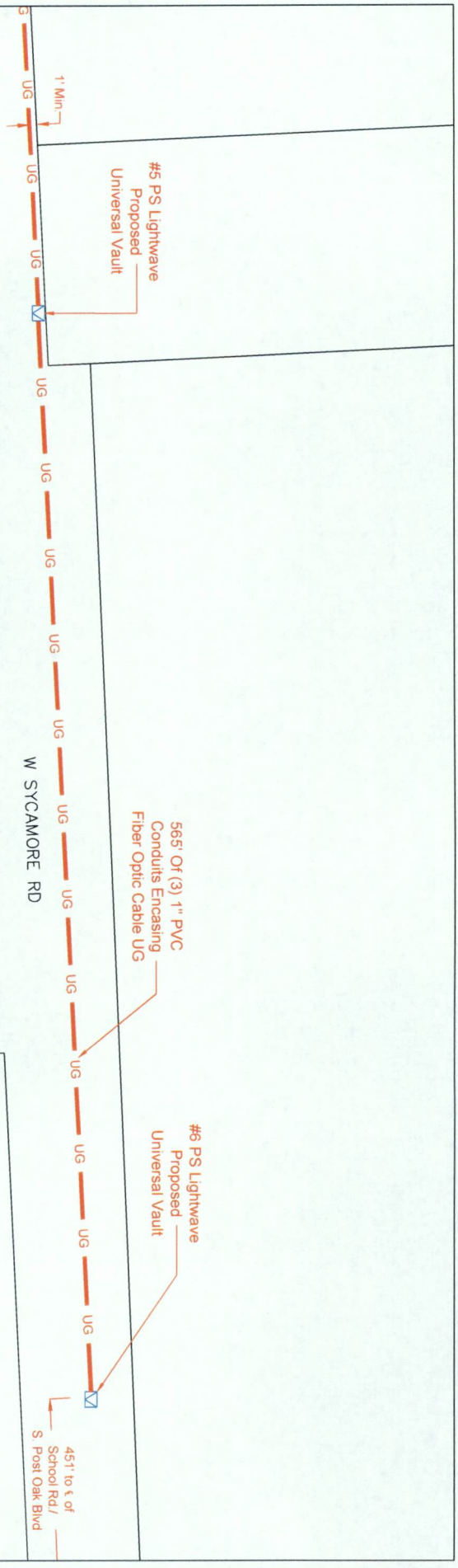

**LEGEND**

	UG	3x(1") HOPE W/ F.O. CABLE		PROPOSED CONDUIT
	UG	3x(1.25") HOPE W/ F.O. CABLE		EXISTING CONDUIT
	UG	1(2") HOPE W/ F.O. CABLE		1.25" EMT
	UG	1(4") HOPE W/ 3x(1.25")HOPE		R/W
	UG	FLEX INNERDUCT (INSIDE)		EDGE-OF-PAVEMENT
	AIR	AERIAL FIBER OPTIC CABLE		FENCE
	CATS	CATS CABLE		RACK LOCATION

	PSLW SET POLE		EXISTING UTILITY POLE
	EXISTING SET POLE		PROPOSED PSLW VAULT (24'x36'x24')
	EXISTING UTILITY POLE		EXISTING VAULT
	PROPOSED PSLW VAULT		PULLBOX
	MDF LOCATION		

SCALE: 1"=50'	
PAGE: 5	
OF: 7	

		PROPRIETARY INFORMATION - PROPERTY OF LIGHTWAVE	
REVISION#1: Rev#1	DATE: Rev#1 Date	CUSTOMER ID:	JOB# 0616-688 PLW
REVISION#2: Rev#2	DATE: Rev#2 Date	CUSTOMER:	Notice of Proposed Utility Installation
REVISION#3: Rev#3	DATE: Rev#3 Date	ADDRESS:	1100 W Sycamore Rd
REVISION#4: Rev#4	DATE: Rev#4 Date	CITY/ZIP:	Fresno, TX 77345
		TENANTS:	
		JOB#:	0616-688
		DWG#:	
		DRAWN BY:	CS
		DATE:	05/18/17
		APPROVED BY:	



- UG 3x(1") HOPE W/ F.O. CABLE
- UG 3x(1.25") HOPE W/ F.O. CABLE
- UG 1(2") HOPE W/ F.O. CABLE
- UG 1(4") HOPE W/ 3x(1.25")HOPE
- UG FLEX INNERDUCT (INSIDE)
- AIR AERIAL FIBER OPTIC CABLE
- CATS CATS CABLE

- LEGEND**
- Proposed Conduit
  - Existing Conduit
  - 1.25" EMT
  - Right-of-Way
  - Edge-of-Pavement
  - Fence
  - Rack Location
  - PSLW Set Pole
  - Existing Set Pole
  - Existing Utility Pole
  - Proposed PSLW Vault (24'x36'x4')
  - Existing Vault
  - Pullbox
  - MDF Location

PROHIBITARY INCORPORATION: PROPERTY OF LIGHTWAVE

REVISION#	REV#	DATE	REV#	DATE
REVISION#1	REV#1	DATE	REV#2	DATE
REVISION#2	REV#2	DATE	REV#3	DATE
REVISION#3	REV#3	DATE	REV#4	DATE

CUSTOMER ID:  
**JOB# 0616-688 PLW**

Customer: Notice of Proposed Utility Installation  
Address: 1100 W Sycamore Rd

QTY/ZIP	TENANTS	# OF FLOORS	DWG#	COUNTY	Port Band
94652	Fresno, IX 7745			OC	KEY MAP: 651C

DATE: 05/18/17

**General Notes:**

- 1) Surface to be restored to its original condition in compliance with Fort Bend County Standards.
- 2) Contractors shall provide and install traffic control devices in conformance with part VI of Texas manual on Uniform Traffic Control Devices (TMUTCD—Latest Edition with Revisions) during construction.
- 3) No Lanes shall be blocked 7am–9am and 4pm–6:30pm Monday thru Friday.

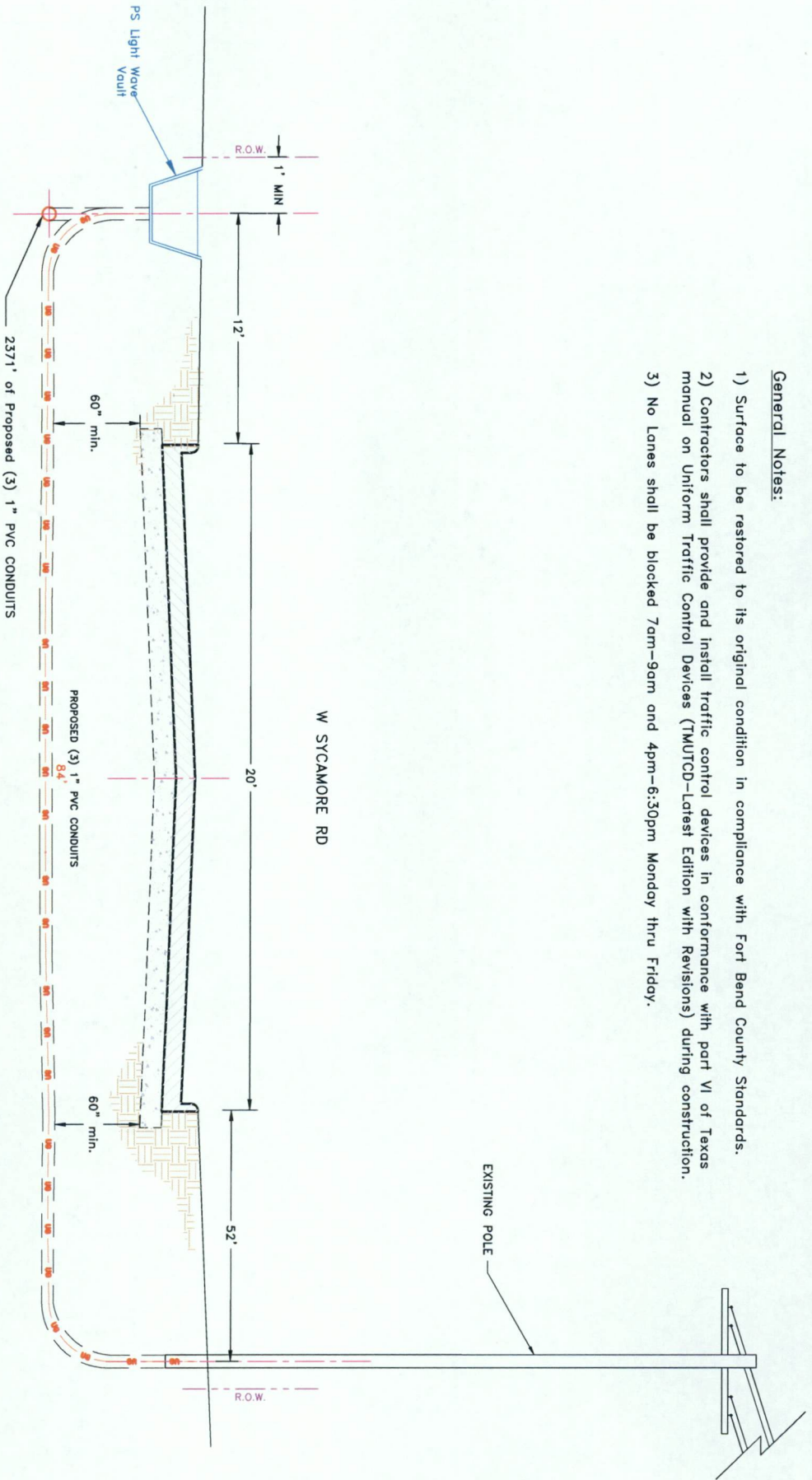

**LEGEND**

	UG	3(1") HDPE W/ F.O. CABLE		PROPOSED CONDUIT		PSLW SET POLE
	UG	3(1.25") HDPE W/ F.O. CABLE		EXISTING CONDUIT		EXISTING SET POLE
	UG	1(2") HDPE W/ F.O. CABLE		EMT 1.25" EMT		EXISTING UTILITY POLE
	UG	1(4") HDPE W/ 3(1.25") HDPE		R/W RIGHT-OF-WAY		PROPOSED PSLW VAULT (24'x36'x24')
	AIR	FLEX INNERDUCT		EDGE-OF-PAVEMENT		EXISTING VAULT
	AIR	AERIAL FIBER OPTIC CABLE		FENCE		PULLBOX
	CATS	CATS CABLE		RACK LOCATION		MDF LOCATION

PROPRIETARY INFORMATION - PROPERTY OF PSLIGHTWAVE			
REVISION#1: Rev#1	DATE: Rev#1 Date	CITY/Zip: Fresno, TX 77545	Job# 0616-688 PLW
REVISION#2: Rev#2	DATE: Rev#2 Date	Address: 1100 W Sycamore Rd	Description: Notice of Proposed Utility Installation
REVISION#3: Rev#3	DATE: Rev#3 Date	TENANTS:	COUNTY: Fort Bend
REVISION#4: Rev#4	DATE: Rev#4 Date	WO# 94652	KEY MAP: 631C
DATE: Rev#4 Date	DATE: Rev#4 Date	Job# 0616-688	DATE: 05/08/17
APPROVED BY:	DATE:	DWG#:	DATE:



