

**REVIEW BY FORT BEND COUNTY  
COMMISSIONERS COURT**

**Fort Bend County  
Engineering Department**  
301 Jackson Suite 401  
Richmond, Texas 77469  
281.633.7500  
Permits@fortbendcountytx.gov

- Right of Way Permit  
 Commercial Driveway Permit

Permit No: 2017-14795

**Applicant:** Drymall Construction Company, Inc./VLK Architects

**Job Location Site:** 8500 A Meyers Road, Rosenberg, TX 77471

**Bond No.**                      **Date of Bond:** 6/18/1999 **Amount:** \$50,000.00

The above applicant came to make use of certain Fort Bend County property subject to, "The Order Regulating the Laying, Construction, Maintenance, and Repair of Buried Cables, Conduits, and Pole Lines, In, Under, Across or Along Roads, Streets, Highways, and Drainage Ditches in Fort Bend County, Texas, Under the Jurisdiction of the Commissioners Court of Fort Bend County, Texas," as passed by the Commissioners Court of Fort Bend County, Texas, of the Minutes of the Commissioners Court of Fort Bend County, Texas, to the extent that such order is not inconsistent with Chapter 181, Vernon's Texas Statutes and Codes Annotated.

**Notes:**

1. Evidence of review by the Commissioners Court must be kept on the job site and failure to do so constitutes grounds for job shutdown.
2. Written notices are required:
  - a. 48 hours in advance of construction start up, and
  - b. When construction is completed and ready for final inspection, submit notification to Permit Administrator thru MyGovernmentOnline.org portal.
3. This permit expires one (1) year from date of permit if construction has not commenced.

On this 26th day of September, 2017, Upon Motion of Commissioner Meyers, seconded by Commissioner Patterson, duly put and carried, it is ORDERED, ADJUDGED AND DECREED that said notice of said above purpose is hereby acknowledged by the Commissioners Court of Fort Bend County, Texas, and that said notice be placed on record according to the regulation order thereof.

**Signature**

Presented to Commissioners Court and approved.

By: Charles O. Ay  
County Engineer

Date Recorded 10-6-2017 Comm. Court No. 16A

By: N/A  
Drainage District Engineer/Manager

Clerk of Commissioners Court  
By: Jonda Willis  
Deputy

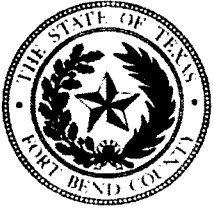

**PERMIT APPLICATION REVIEW FORM FOR  
CABLE, CONDUIT, AND POLE LINE ACTIVITY  
IN FORT BEND COUNTY**

**Fort Bend County  
Engineering Department**  
301 Jackson Suite 401  
Richmond, Texas 77469  
281.633.7500  
Permits@fortbendcountytx.gov

- Right of Way Permit  
 Commercial Driveway Permit

Permit No: 2017-14795

The following "Notice of Proposed Cable, Conduit, and/or Pole Line activity in Fort Bend County" and accompanying attachments have been reviewed and the notice conforms to appropriate regulations set by Commissioner's Court of Fort Bend County, Texas.

**(1) COMPLETE APPLICATION FORM:**

- a. Name of road, street, and/or drainage ditch affected.  
 b. Vicinity map showing course of directions  
 c. Plans and specifications

**(2) BOND:**

- County Attorney, approval when applicable.
- Perpetual bond currently posted.      Bond No: [REDACTED]      Amount: \$50,000.00
- Performance bond submitted.      Bond No: \_\_\_\_\_      Amount: \_\_\_\_\_
- Cashier's Check      Check No: \_\_\_\_\_      Amount: \_\_\_\_\_

**(3) DRAINAGE DISTRICT APPROVAL (WHEN APPLICABLE):**

\_\_\_\_\_  
Drainage District Approval

\_\_\_\_\_  
Date

We have reviewed this project and agree it meets minimum requirements.

*Charles O. Ay*

\_\_\_\_\_  
Permit Administrator

*9/18/17*

\_\_\_\_\_  
Date

CONSTRUCTION PLANS FOR  
**LAMAR CONSOLIDATED I.S.D.**  
**DON CARTER ELEMENTARY**  
 FORT BEND COUNTY, TEXAS

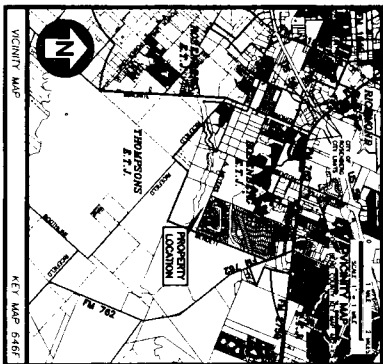

CONSTRUCTION PLANS - SHEET INDEX

SHEET NO.	DESCRIPTION
CS 01	EXISTING CONDITIONS
CS 02	PAVING & CURBING PLAN
CS 03	FOUNDATION PLAN
CS 04	FOUNDATION CALCULATIONS
CS 05	FLOOR & SLABWORK PLAN
CS 06	EROSION CONTROL PLAN
CS 07	CONSTRUCTION DETAILS
CS 08	CONSTRUCTION DETAILS
CS 09	CONSTRUCTION DETAILS

**ENGINEER**  
**KELLY R. KALUZA & ASSOCIATES, INC.**  
 CONSULTING ENGINEERS AND SURVEYORS  
 3014 AVENUE I  
 ROSENBERG, TEXAS 77471  
 (281) 341-0808  
 JUNE 2017



**FORT BEND COUNTY ENGINEER**

ENGINEER: Kelly R. Kaluza, P.E.

DATE: 6/27/17

NAME: Kelly R. Kaluza, P.E.

ADDRESS: 3014 AVENUE I, ROSENBERG, TEXAS 77471

APPROVED: [Signature]

DATE: 6/27/17





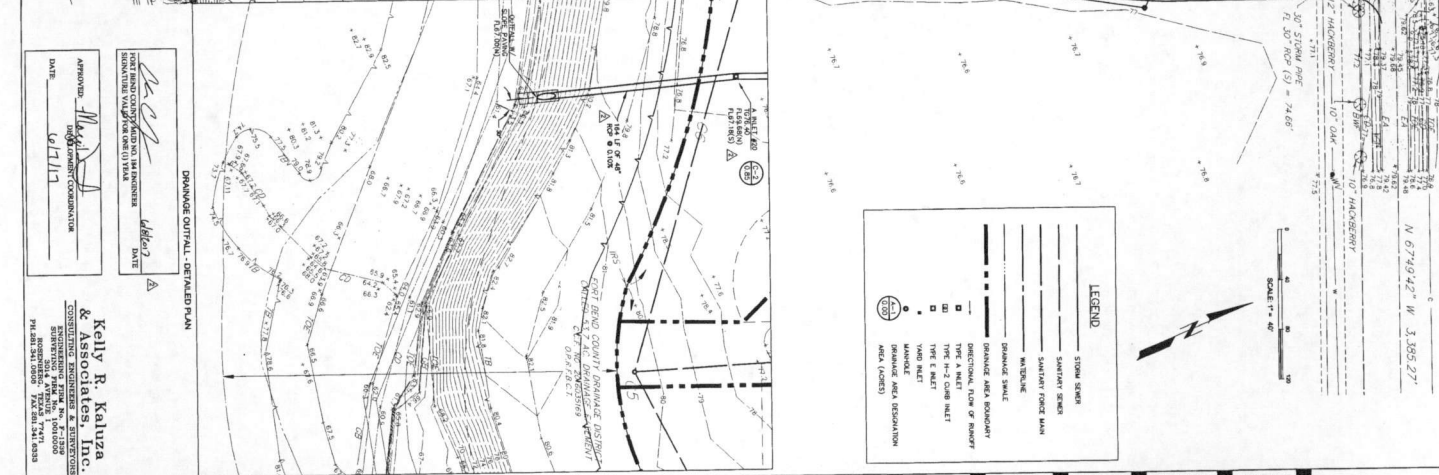
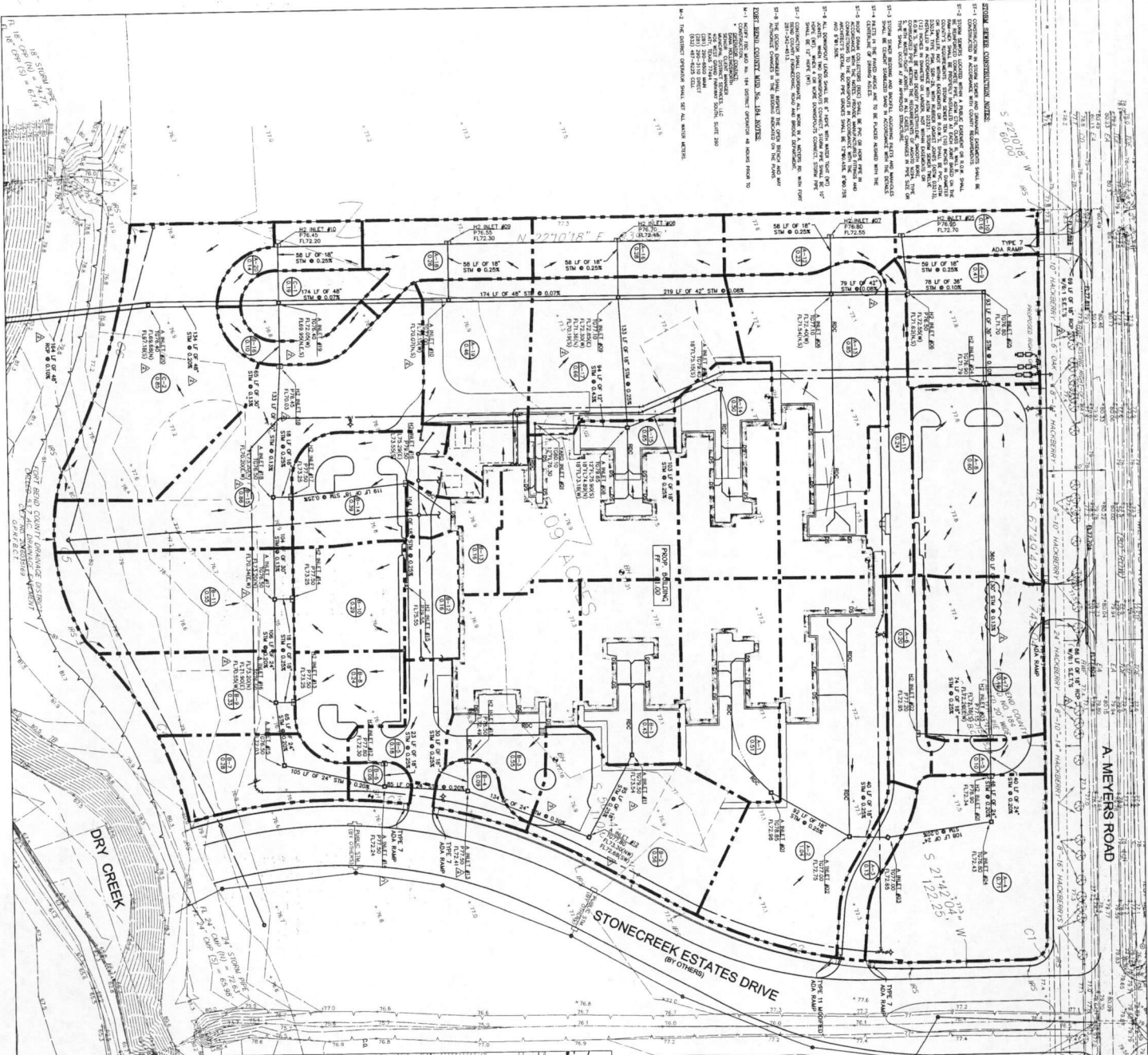

**APPROVED:** [Signature] PROJECT ENGINEER  
DATE: 05/11/17

**DESIGNED BY:** Kelly R. Kaluza & Associates, Inc.  
10000 Katy Road, Suite 1000  
Houston, TX 77059  
P: 281.541.0500 F: 281.541.0533

**PROJECT NO:** 1623.00

**SHEET TITLE:** DRAINAGE PLAN

**SHEET NO:** C2.01

**REVISIONS:**

NO.	DATE	DESCRIPTION
1	05/11/17	Final Design

**LEGEND:**

- STORM SEWER
- SANITARY SEWER
- WATER MAIN
- TYPE H-2 CURB
- TYPE E BUILT
- LANDSCAPE
- RESERVATION AREA (LAKES)

**REGISTERED:** VLA ARCHITECTS, INC.  
10000 Katy Road, Suite 1000  
Houston, TX 77059  
P: 281.541.0500 F: 281.541.0533

**REGISTERED:** Kelly R. Kaluza & Associates, Inc.  
10000 Katy Road, Suite 1000  
Houston, TX 77059  
P: 281.541.0500 F: 281.541.0533

A MEYERS ROAD

STONECREEK ESTATES DRIVE (BY OTHERS)

N 271018' E

N 674942' W 3355.27'

SCALE 1" = 40'

VLA ARCHITECTS

Lamar Consolidated Independent School District  
ROSENBERG, TX





- EROSION AND SEDIMENT CONTROL PLAN NOTES:**
- 1-1 EROSION CONTROL SHALL BE MAINTAINED THROUGHOUT THE CONSTRUCTION PERIOD AND SHALL BE MAINTAINED THROUGHOUT THE CONSTRUCTION PERIOD.
  - 1-2 CONSTRUCTION SHALL BE SCHEDULED TO AVOID THE WET SEASON.
  - 1-3 CONSTRUCTION SHALL BE SCHEDULED TO AVOID THE WET SEASON.
  - 1-4 CONSTRUCTION SHALL BE SCHEDULED TO AVOID THE WET SEASON.
  - 1-5 CONSTRUCTION SHALL BE SCHEDULED TO AVOID THE WET SEASON.
  - 1-6 CONSTRUCTION SHALL BE SCHEDULED TO AVOID THE WET SEASON.
  - 1-7 CONSTRUCTION SHALL BE SCHEDULED TO AVOID THE WET SEASON.

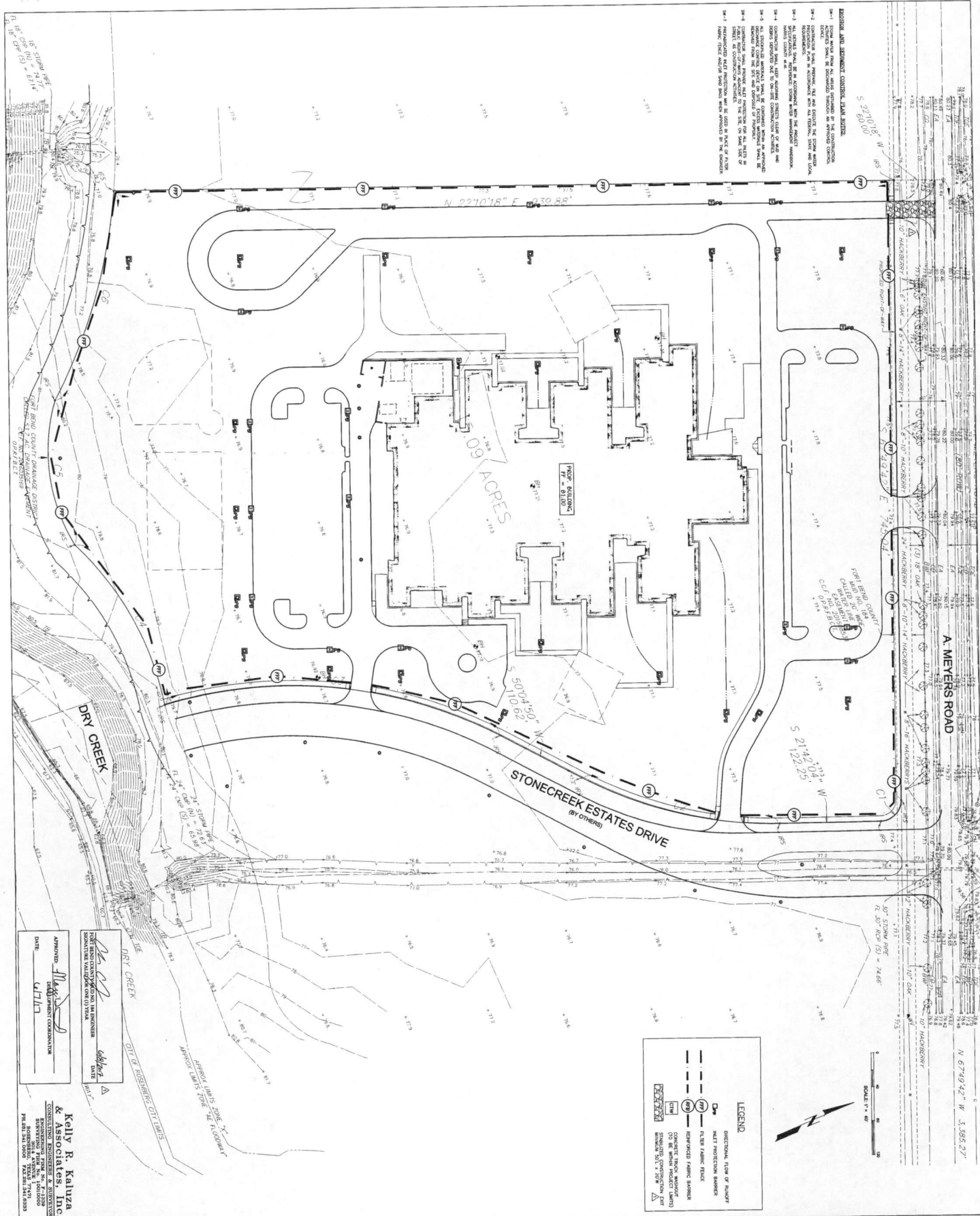

**LEGEND**

- DIRECTIONAL FLOW OF RAINFALL
- SILT PROTECTION BARRIER
- FILTER FABRIC FENCE
- SEDIMENT BASIN
- CHECK DAM
- CONCRETE TRAP STRUCTURE
- CONCRETE TRAP STRUCTURE (TO BE WITHIN PROJECT LIMITS)
- EROSION CONTROL STRUCTURE



APPROVED: *[Signature]*  
 DATE: 4/17/17

**Kelly R. Kaluza & Associates, Inc.**  
 CONSULTING ENGINEERS & SURVEYORS  
 1700 W. WILSON ROAD, SUITE 100  
 ROSENBERG, TEXAS 77471-3333

**PROJECT NO:** 1623.00  
**SHEET TITLE:** EROSION CONTROL PLAN  
**SHEET NO:** C4.01

**DESIGNED BY:** Designer  
**CHECKED BY:** Quality Control  
**DATE:** 02/04/2017

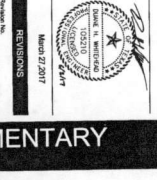

**REVISIONS:**  
 1. 02/04/2017

**LANDSCAPE:**  
 1. 02/04/2017

**STRUCTURAL ENGINEERS:**  
 Kelly R. Kaluza & Associates, Inc.  
 1700 W. Wilson Road, Suite 100  
 Rosenberg, Texas 77471-3333

**MEP ENGINEER:**  
 Kelly R. Kaluza & Associates, Inc.  
 1700 W. Wilson Road, Suite 100  
 Rosenberg, Texas 77471-3333

**ARCHITECT:**  
 VIK ARCHITECTS  
 1700 W. Wilson Road, Suite 100  
 Rosenberg, Texas 77471-3333

**CLIENT:**  
 LAMAR CONSOLIDATED INDEPENDENT SCHOOL DISTRICT  
 ROSENBERG, TX

**PROJECT NO:** 1623.00  
**SHEET TITLE:** EROSION CONTROL PLAN  
**SHEET NO:** C4.01

**DATE:** 02/04/2017

**SCALE:** 1" = 40'

**PROJECT LOCATION:** DON CARTER ELEMENTARY, ROSENBERG, TX

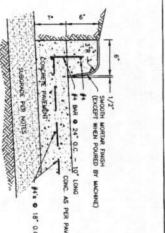

**CONCRETE CURB AND PAVEMENT 1**

GENERAL NOTES FOR CONCRETE CURB AND PAVEMENT:

1. CURB SHALL BE CAST IN PLACE WITH PAVEMENT.
2. CURB SHALL BE CAST WITH A MINIMUM OF 4\"/>

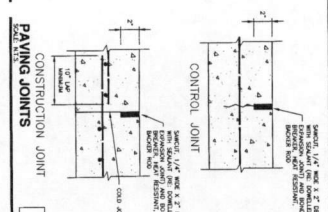

**CONSTRUCTION JOINT 2**

GENERAL NOTES FOR CONSTRUCTION JOINT:

1. JOINT SHALL BE CAST WITH A MINIMUM OF 4\"/>

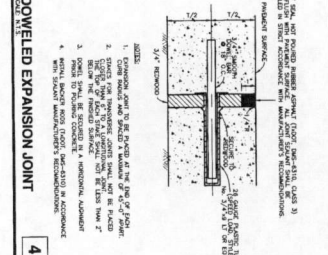

**DOWELED EXPANSION JOINT 3**

GENERAL NOTES FOR DOWELED EXPANSION JOINT:

1. JOINT SHALL BE CAST WITH A MINIMUM OF 4\"/>

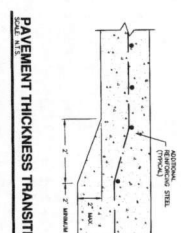

**PAVING THICKNESS TRANSITION 4**

GENERAL NOTES FOR PAVING THICKNESS TRANSITION:

1. TRANSITION SHALL BE CAST WITH A MINIMUM OF 4\"/>

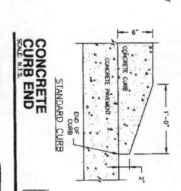

**CONCRETE CURB END 5**

GENERAL NOTES FOR CONCRETE CURB END:

1. CURB SHALL BE CAST WITH A MINIMUM OF 4\"/>

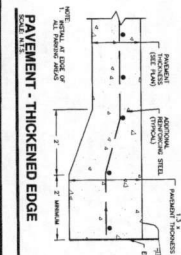

**PAVEMENT - THICKENED EDGE 6**

GENERAL NOTES FOR PAVEMENT - THICKENED EDGE:

1. THICKENED EDGE SHALL BE CAST WITH A MINIMUM OF 4\"/>

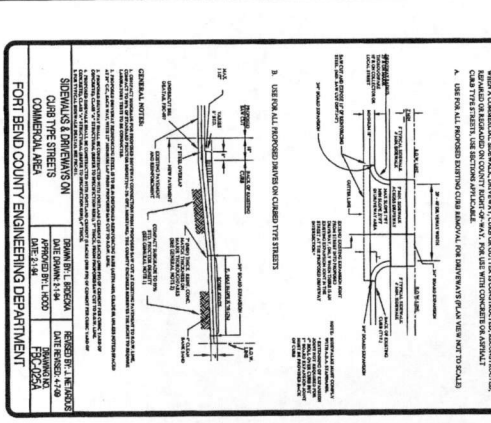

**GENERAL NOTES FOR SIDEWALKS AND DRIVEWAYS 7**

GENERAL NOTES FOR SIDEWALKS AND DRIVEWAYS:

1. SIDEWALKS AND DRIVEWAYS SHALL BE CAST WITH A MINIMUM OF 4\"/>

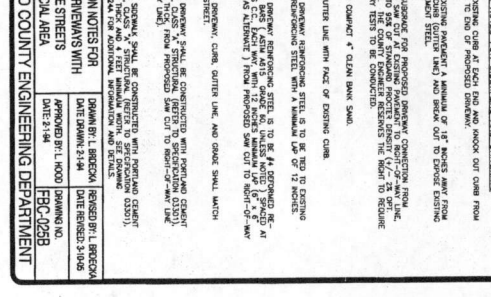

**CONSTRUCTION JOINT FOR SIDEWALKS AND DRIVEWAYS 8**

GENERAL NOTES FOR CONSTRUCTION JOINT FOR SIDEWALKS AND DRIVEWAYS:

1. JOINT SHALL BE CAST WITH A MINIMUM OF 4\"/>

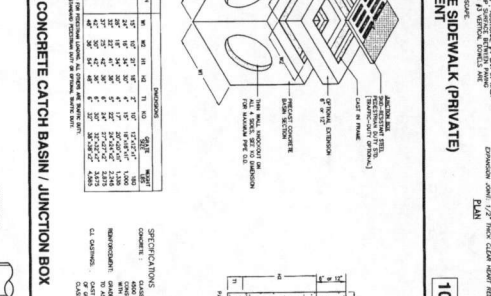

**PAVEMENT - THICKENED EDGE FOR SIDEWALKS AND DRIVEWAYS 9**

GENERAL NOTES FOR PAVEMENT - THICKENED EDGE FOR SIDEWALKS AND DRIVEWAYS:

1. THICKENED EDGE SHALL BE CAST WITH A MINIMUM OF 4\"/>

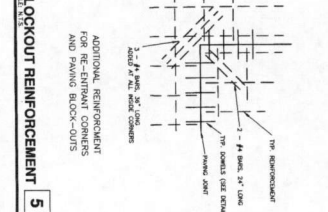

**ADDITIONAL REINFORCEMENT FOR RE-ENTRANT CORNERS AND PAVING BLOCK-CUTS 10**

GENERAL NOTES FOR ADDITIONAL REINFORCEMENT FOR RE-ENTRANT CORNERS AND PAVING BLOCK-CUTS:

1. REINFORCEMENT SHALL BE CAST WITH A MINIMUM OF 4\"/>

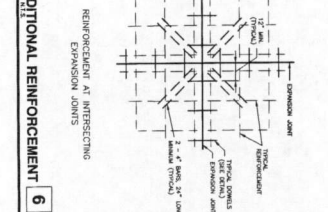

**ADDITIONAL REINFORCEMENT AT INTERSECTIONS 11**

GENERAL NOTES FOR ADDITIONAL REINFORCEMENT AT INTERSECTIONS:

1. REINFORCEMENT SHALL BE CAST WITH A MINIMUM OF 4\"/>

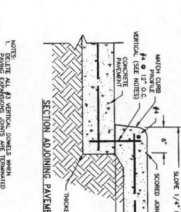

**BLOCKOUT REINFORCEMENT 12**

GENERAL NOTES FOR BLOCKOUT REINFORCEMENT:

1. REINFORCEMENT SHALL BE CAST WITH A MINIMUM OF 4\"/>

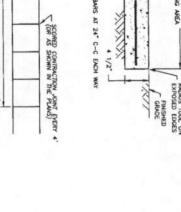

**ADDITIONAL REINFORCEMENT AT INTERSECTIONS 13**

GENERAL NOTES FOR ADDITIONAL REINFORCEMENT AT INTERSECTIONS:

1. REINFORCEMENT SHALL BE CAST WITH A MINIMUM OF 4\"/>

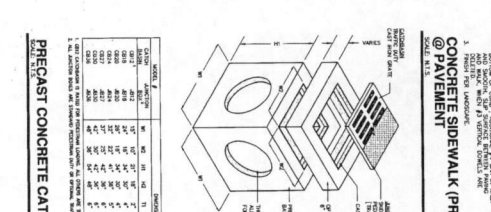

**PRECAST CONCRETE CATCH BASIN / JUNCTION BOX 14**

GENERAL NOTES FOR PRECAST CONCRETE CATCH BASIN / JUNCTION BOX:

1. CATCH BASIN SHALL BE CAST WITH A MINIMUM OF 4\"/>

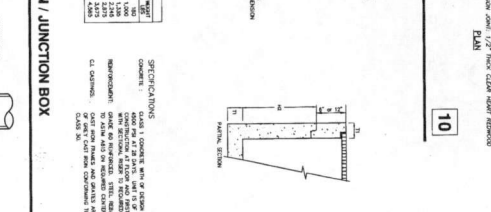

**HANDICAP CURB RAMP - FLARED 15**

GENERAL NOTES FOR HANDICAP CURB RAMP - FLARED:

1. RAMP SHALL BE CAST WITH A MINIMUM OF 4\"/>

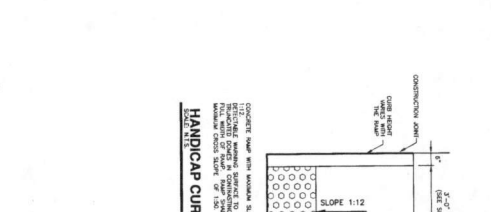

**HANDICAP CURB RAMP 16**

GENERAL NOTES FOR HANDICAP CURB RAMP:

1. RAMP SHALL BE CAST WITH A MINIMUM OF 4\"/>

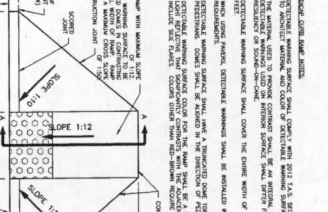

**HANDICAP CURB RAMP - FLARED 17**

GENERAL NOTES FOR HANDICAP CURB RAMP - FLARED:

1. RAMP SHALL BE CAST WITH A MINIMUM OF 4\"/>

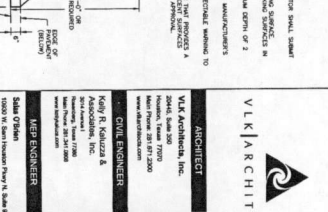

**HANDICAP CURB RAMP 18**

GENERAL NOTES FOR HANDICAP CURB RAMP:

1. RAMP SHALL BE CAST WITH A MINIMUM OF 4\"/>

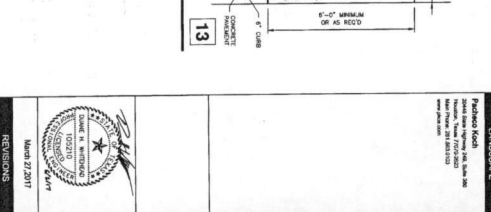

**HANDICAP CURB RAMP 19**

GENERAL NOTES FOR HANDICAP CURB RAMP:

1. RAMP SHALL BE CAST WITH A MINIMUM OF 4\"/>

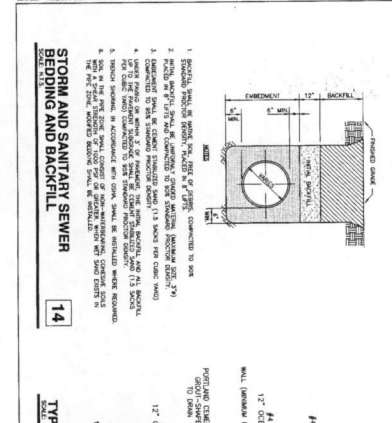

**STORM AND SANITARY SEWER BEDDING AND BACKFILL 20**

GENERAL NOTES FOR STORM AND SANITARY SEWER BEDDING AND BACKFILL:

1. BEDDING SHALL BE CAST WITH A MINIMUM OF 4\"/>

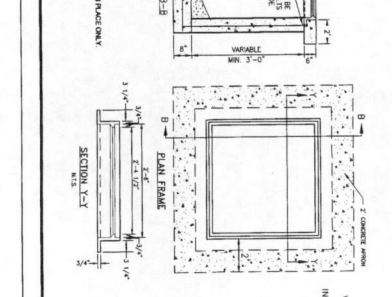

**TYPE 'A' INLET 21**

GENERAL NOTES FOR TYPE 'A' INLET:

1. INLET SHALL BE CAST WITH A MINIMUM OF 4\"/>

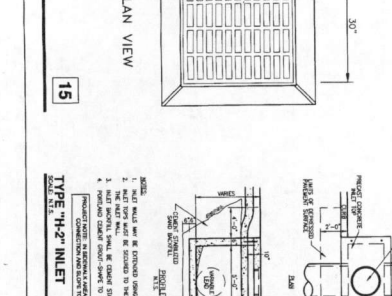

**TYPE 'A' INLET 22**

GENERAL NOTES FOR TYPE 'A' INLET:

1. INLET SHALL BE CAST WITH A MINIMUM OF 4\"/>

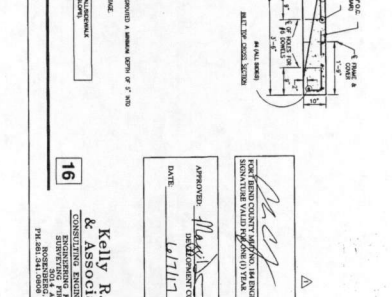

**TYPE 'B' INLET 23**

GENERAL NOTES FOR TYPE 'B' INLET:

1. INLET SHALL BE CAST WITH A MINIMUM OF 4\"/>

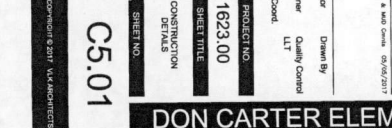

**TYPE 'B' INLET 24**

GENERAL NOTES FOR TYPE 'B' INLET:

1. INLET SHALL BE CAST WITH A MINIMUM OF 4\"/>

**VLK ARCHITECTS**

ARCHITECT

VLK Architects, Inc.  
10000 W. 16th Avenue, Suite 100  
Denver, CO 80202  
Tel: 303.755.1100  
Fax: 303.755.1101  
www.vlk.com

**STRUCTURAL ENGINEER**

Mark Stovall, P.E.  
10000 W. 16th Avenue, Suite 100  
Denver, CO 80202  
Tel: 303.755.1100  
Fax: 303.755.1101  
www.vlk.com

**LANDSCAPE**

Patrick O'Brien, P.E.  
10000 W. 16th Avenue, Suite 100  
Denver, CO 80202  
Tel: 303.755.1100  
Fax: 303.755.1101  
www.vlk.com

**FOOD SERVICE**

John Smith, P.E.  
10000 W. 16th Avenue, Suite 100  
Denver, CO 80202  
Tel: 303.755.1100  
Fax: 303.755.1101  
www.vlk.com

**CONCRETE ENGINEER**

John Smith, P.E.  
10000 W. 16th Avenue, Suite 100  
Denver, CO 80202  
Tel: 303.755.1100  
Fax: 303.755.1101  
www.vlk.com



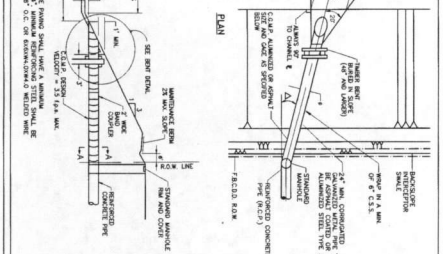
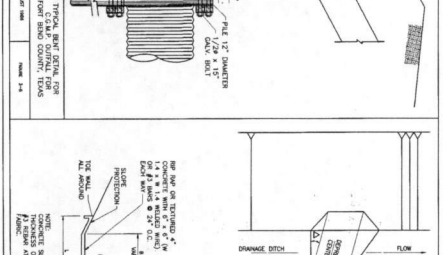
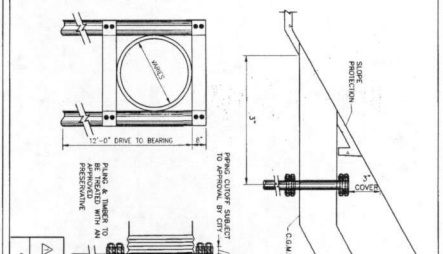
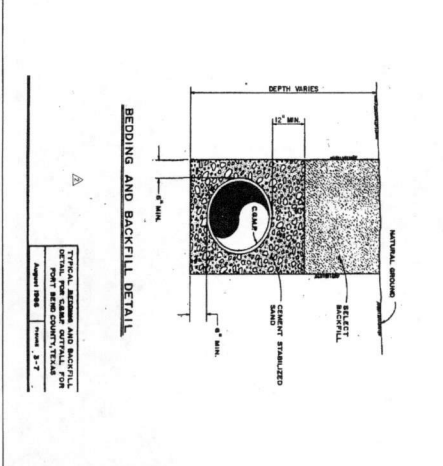

NO.	DESCRIPTION	QTY	UNIT	AMOUNT
1	12" CONCRETE CURB	100	LINEAL FEET	100
2	6" CONCRETE CURB	50	LINEAL FEET	50
3	12" CONCRETE DRIVE	100	SQUARE FEET	100
4	6" CONCRETE DRIVE	50	SQUARE FEET	50
5	12" CONCRETE DRIVE	100	SQUARE FEET	100
6	6" CONCRETE DRIVE	50	SQUARE FEET	50
7	12" CONCRETE DRIVE	100	SQUARE FEET	100
8	6" CONCRETE DRIVE	50	SQUARE FEET	50
9	12" CONCRETE DRIVE	100	SQUARE FEET	100
10	6" CONCRETE DRIVE	50	SQUARE FEET	50
11	12" CONCRETE DRIVE	100	SQUARE FEET	100
12	6" CONCRETE DRIVE	50	SQUARE FEET	50
13	12" CONCRETE DRIVE	100	SQUARE FEET	100
14	6" CONCRETE DRIVE	50	SQUARE FEET	50
15	12" CONCRETE DRIVE	100	SQUARE FEET	100
16	6" CONCRETE DRIVE	50	SQUARE FEET	50
17	12" CONCRETE DRIVE	100	SQUARE FEET	100
18	6" CONCRETE DRIVE	50	SQUARE FEET	50
19	12" CONCRETE DRIVE	100	SQUARE FEET	100
20	6" CONCRETE DRIVE	50	SQUARE FEET	50

APPROVED: *[Signature]*  
 DATE: 02/17/17  
 Kelly R. Kaluza & Associates, Inc.  
 CONSULTING ENGINEERS & SURVEYORS  
 1111 W. 14TH STREET, SUITE 100  
 DENVER, CO 80202  
 PHONE: 303.733.1111  
 FAX: 303.733.1112

**GENERAL NOTES:**

1. ALL WORK SHALL BE IN ACCORDANCE WITH THE STANDARD SPECIFICATIONS FOR PUBLIC WORKS, LATEST EDITION, AS ADOPTED BY THE BOARD OF COUNTY COMMISSIONERS.
2. THE CONTRACTOR SHALL BE RESPONSIBLE FOR OBTAINING ALL NECESSARY PERMITS AND APPROVALS FROM THE APPROPRIATE AGENCIES.
3. THE CONTRACTOR SHALL MAINTAIN ACCESS TO ALL ADJACENT PROPERTIES AND UTILITIES AT ALL TIMES.
4. ALL MATERIALS AND WORKMANSHIP SHALL BE SUBJECT TO INSPECTION AND APPROVAL BY THE ENGINEER.
5. THE CONTRACTOR SHALL BE RESPONSIBLE FOR PROTECTING ALL EXISTING UTILITIES AND STRUCTURES.
6. ALL DIMENSIONS SHALL BE AS SHOWN UNLESS OTHERWISE NOTED.
7. THE CONTRACTOR SHALL MAINTAIN ADEQUATE DRAINAGE THROUGHOUT THE PROJECT.
8. ALL CURBS SHALL BE CONCRETE UNLESS OTHERWISE NOTED.
9. THE CONTRACTOR SHALL BE RESPONSIBLE FOR THE PROTECTION OF ALL ADJACENT PROPERTIES AND UTILITIES.
10. ALL MATERIALS SHALL BE OF THE QUALITY AND TYPE SPECIFIED.
11. THE CONTRACTOR SHALL MAINTAIN ADEQUATE ACCESS TO ALL ADJACENT PROPERTIES AND UTILITIES.
12. ALL DIMENSIONS SHALL BE AS SHOWN UNLESS OTHERWISE NOTED.
13. THE CONTRACTOR SHALL MAINTAIN ADEQUATE DRAINAGE THROUGHOUT THE PROJECT.
14. ALL CURBS SHALL BE CONCRETE UNLESS OTHERWISE NOTED.
15. THE CONTRACTOR SHALL BE RESPONSIBLE FOR THE PROTECTION OF ALL ADJACENT PROPERTIES AND UTILITIES.
16. ALL MATERIALS SHALL BE OF THE QUALITY AND TYPE SPECIFIED.
17. THE CONTRACTOR SHALL MAINTAIN ADEQUATE ACCESS TO ALL ADJACENT PROPERTIES AND UTILITIES.
18. ALL DIMENSIONS SHALL BE AS SHOWN UNLESS OTHERWISE NOTED.
19. THE CONTRACTOR SHALL MAINTAIN ADEQUATE DRAINAGE THROUGHOUT THE PROJECT.
20. ALL CURBS SHALL BE CONCRETE UNLESS OTHERWISE NOTED.

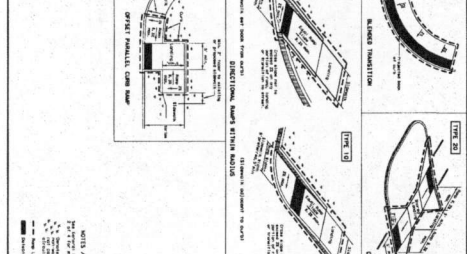
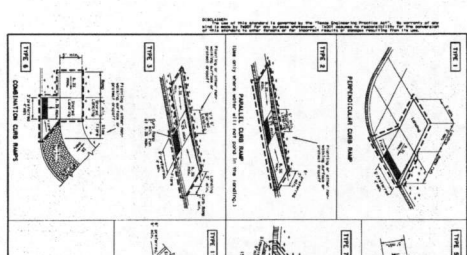
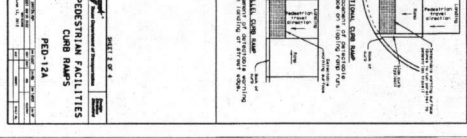
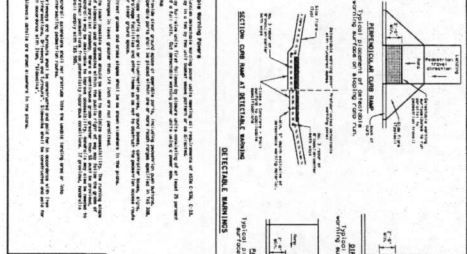

NO.	DESCRIPTION	QTY	UNIT	AMOUNT
1	12" CONCRETE CURB	100	LINEAL FEET	100
2	6" CONCRETE CURB	50	LINEAL FEET	50
3	12" CONCRETE DRIVE	100	SQUARE FEET	100
4	6" CONCRETE DRIVE	50	SQUARE FEET	50
5	12" CONCRETE DRIVE	100	SQUARE FEET	100
6	6" CONCRETE DRIVE	50	SQUARE FEET	50
7	12" CONCRETE DRIVE	100	SQUARE FEET	100
8	6" CONCRETE DRIVE	50	SQUARE FEET	50
9	12" CONCRETE DRIVE	100	SQUARE FEET	100
10	6" CONCRETE DRIVE	50	SQUARE FEET	50
11	12" CONCRETE DRIVE	100	SQUARE FEET	100
12	6" CONCRETE DRIVE	50	SQUARE FEET	50
13	12" CONCRETE DRIVE	100	SQUARE FEET	100
14	6" CONCRETE DRIVE	50	SQUARE FEET	50
15	12" CONCRETE DRIVE	100	SQUARE FEET	100
16	6" CONCRETE DRIVE	50	SQUARE FEET	50
17	12" CONCRETE DRIVE	100	SQUARE FEET	100
18	6" CONCRETE DRIVE	50	SQUARE FEET	50
19	12" CONCRETE DRIVE	100	SQUARE FEET	100
20	6" CONCRETE DRIVE	50	SQUARE FEET	50

APPROVED: *[Signature]*  
 DATE: 02/17/17  
 Kelly R. Kaluza & Associates, Inc.  
 CONSULTING ENGINEERS & SURVEYORS  
 1111 W. 14TH STREET, SUITE 100  
 DENVER, CO 80202  
 PHONE: 303.733.1111  
 FAX: 303.733.1112

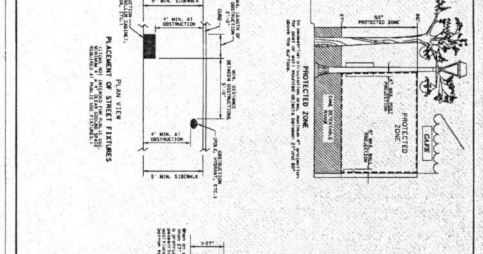
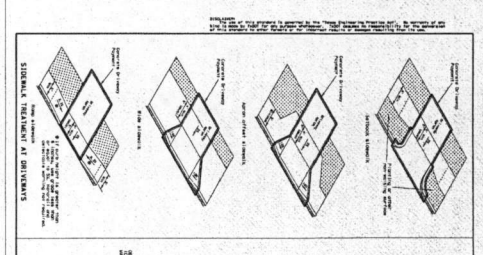
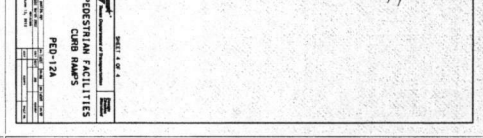
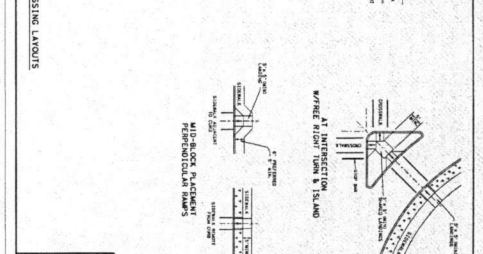
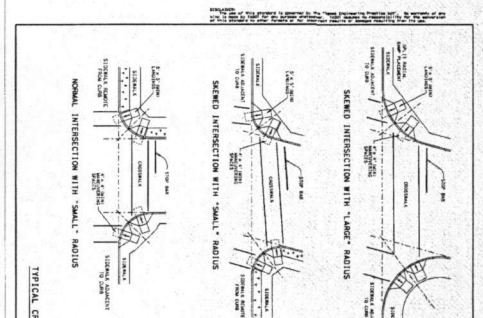

NO.	DESCRIPTION	QTY	UNIT	AMOUNT
1	12" CONCRETE CURB	100	LINEAL FEET	100
2	6" CONCRETE CURB	50	LINEAL FEET	50
3	12" CONCRETE DRIVE	100	SQUARE FEET	100
4	6" CONCRETE DRIVE	50	SQUARE FEET	50
5	12" CONCRETE DRIVE	100	SQUARE FEET	100
6	6" CONCRETE DRIVE	50	SQUARE FEET	50
7	12" CONCRETE DRIVE	100	SQUARE FEET	100
8	6" CONCRETE DRIVE	50	SQUARE FEET	50
9	12" CONCRETE DRIVE	100	SQUARE FEET	100
10	6" CONCRETE DRIVE	50	SQUARE FEET	50
11	12" CONCRETE DRIVE	100	SQUARE FEET	100
12	6" CONCRETE DRIVE	50	SQUARE FEET	50
13	12" CONCRETE DRIVE	100	SQUARE FEET	100
14	6" CONCRETE DRIVE	50	SQUARE FEET	50
15	12" CONCRETE DRIVE	100	SQUARE FEET	100
16	6" CONCRETE DRIVE	50	SQUARE FEET	50
17	12" CONCRETE DRIVE	100	SQUARE FEET	100
18	6" CONCRETE DRIVE	50	SQUARE FEET	50
19	12" CONCRETE DRIVE	100	SQUARE FEET	100
20	6" CONCRETE DRIVE	50	SQUARE FEET	50

APPROVED: *[Signature]*  
 DATE: 02/17/17  
 Kelly R. Kaluza & Associates, Inc.  
 CONSULTING ENGINEERS & SURVEYORS  
 1111 W. 14TH STREET, SUITE 100  
 DENVER, CO 80202  
 PHONE: 303.733.1111  
 FAX: 303.733.1112

**ARCHITECT:** VLA ARCHITECTS, INC. 3040 E. 17TH AVENUE, SUITE 100, DENVER, CO 80202  
**ARCHITECT:** VLA ARCHITECTS, INC. 3040 E. 17TH AVENUE, SUITE 100, DENVER, CO 80202  
**CIVIL ENGINEER:** KELLY R. KALUZA & ASSOCIATES, INC. 1111 W. 14TH STREET, SUITE 100, DENVER, CO 80202  
**MEP ENGINEER:** KELLY R. KALUZA & ASSOCIATES, INC. 1111 W. 14TH STREET, SUITE 100, DENVER, CO 80202  
**STRUCTURAL ENGINEER:** KELLY R. KALUZA & ASSOCIATES, INC. 1111 W. 14TH STREET, SUITE 100, DENVER, CO 80202  
**FOOD SERVICE:** KELLY R. KALUZA & ASSOCIATES, INC. 1111 W. 14TH STREET, SUITE 100, DENVER, CO 80202  
**LANDSCAPE ARCHITECT:** KELLY R. KALUZA & ASSOCIATES, INC. 1111 W. 14TH STREET, SUITE 100, DENVER, CO 80202  
**PROJECT NO.:** 1623.00  
**SHEET TITLE:** CONSTRUCTION DETAILS  
**DATE:** 02/17/17  
**DESIGNER:** LKH  
**DRAWN BY:** LKH  
**CHECKED BY:** LKH  
**DATE:** 02/17/17  
**PROJECT NO.:** 1623.00  
**SHEET TITLE:** CONSTRUCTION DETAILS  
**DATE:** 02/17/17  
**DESIGNER:** LKH  
**DRAWN BY:** LKH  
**CHECKED BY:** LKH  
**DATE:** 02/17/17

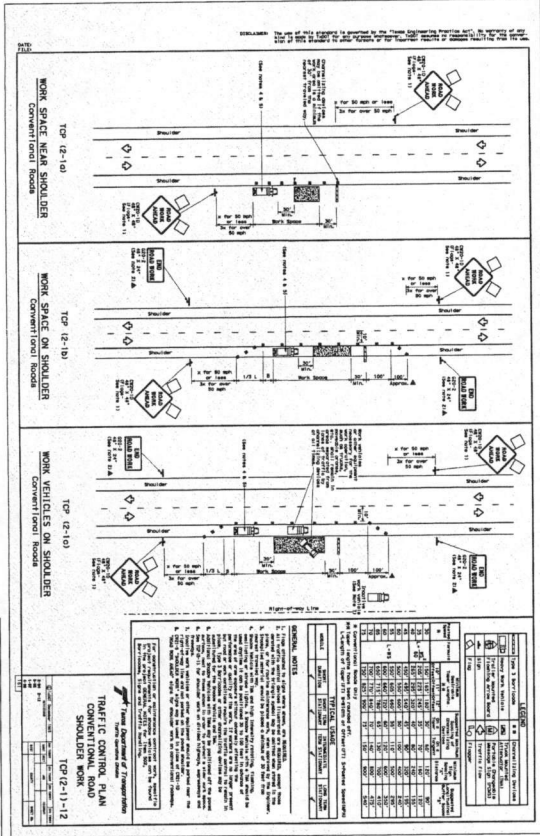

APPROVED: *[Signature]*  
 DATE: 6/17/17  
 PROJECT NO. 1623.00  
 SHEET TITLE: CONSTRUCTION PLAN  
 SHEET NO. C5.04

**Kaly R. Kaluza & Associates, Inc.**  
 CONSULTING ENGINEERS & SURVEYORS  
 5100 W. SAM HOUSTON BLVD., SUITE 100  
 HOUSTON, TEXAS 77056  
 PHONE: 281.416.1333  
 FAX: 281.416.1333



**ARCHITECT**  
**VLK Architects, Inc.**  
 5100 W. SAM HOUSTON BLVD., SUITE 100  
 HOUSTON, TEXAS 77056  
 PHONE: 281.416.1333  
 FAX: 281.416.1333

**CIVIL ENGINEER**  
**Kaly R. Kaluza & Associates, Inc.**  
 5100 W. SAM HOUSTON BLVD., SUITE 100  
 HOUSTON, TEXAS 77056  
 PHONE: 281.416.1333  
 FAX: 281.416.1333

**MEP ENGINEER**  
**Shah Othman**  
 5100 W. SAM HOUSTON BLVD., SUITE 100  
 HOUSTON, TEXAS 77056  
 PHONE: 281.416.1333  
 FAX: 281.416.1333

**STRUCTURAL ENGINEER**  
**Metric Structural Engineers**  
 9177 Rockwood Ave., Suite 400  
 Houston, Texas 77036  
 PHONE: 281.416.1333  
 FAX: 281.416.1333

**FOOD SERVICE**  
**ESP**  
 2625 Oak Ridge Dr.  
 Houston, Texas 77025  
 PHONE: 281.200.2233  
 FAX: 281.200.2233

**LANDSCAPE**  
**Proscopia Farms**  
 3200 West Loop South, Suite 300  
 Houston, Texas 77026  
 PHONE: 281.403.1133  
 FAX: 281.403.1133

**REVISIONS**  
 DATE: 06/20/2017  
 BY: KALY

**DESIGNED BY**  
 Designer: Kaly  
 Designer: Quality Control  
 Designer: Pkg. Control

**PROJECT NO.**  
 1623.00

**SHEET TITLE**  
 CONSTRUCTION PLAN

**SHEET NO.**  
 C5.04

**DATE**  
 06/17/17

**PROJECT NO.**  
 1623.00

**SHEET TITLE**  
 CONSTRUCTION PLAN

**SHEET NO.**  
 C5.04

**DATE**  
 06/17/17

**PROJECT NO.**  
 1623.00

**SHEET TITLE**  
 CONSTRUCTION PLAN

**SHEET NO.**  
 C5.04

**DATE**  
 06/17/17

**PROJECT NO.**  
 1623.00

**SHEET TITLE**  
 CONSTRUCTION PLAN

**SHEET NO.**  
 C5.04

**DATE**  
 06/17/17

**PROJECT NO.**  
 1623.00

**SHEET TITLE**  
 CONSTRUCTION PLAN

**SHEET NO.**  
 C5.04

**DATE**  
 06/17/17

**PROJECT NO.**  
 1623.00