

**REVIEW BY FORT BEND COUNTY
COMMISSIONERS COURT**

**Fort Bend County
Engineering Department**
301 Jackson Suite 401
Richmond, Texas 77469
281.633.7500
Permits@fortbendcountytexas.gov

☐ Right of Way Permit
☒ Commercial Driveway Permit

Permit No: 2017-13938

Applicant: Urban Area

Job Location Site: 9303 Highway 6, Missouri City, TX 77459

Bond [REDACTED] **Date of Bond:** 5/19/2017 **Amount:** \$5,000.00

The above applicant came to make use of certain Fort Bend County property subject to, "The Order Regulating the Laying, Construction, Maintenance, and Repair of Buried Cables, Conduits, and Pole Lines, In, Under, Across or Along Roads, Streets, Highways, and Drainage Ditches in Fort Bend County, Texas, Under the Jurisdiction of the Commissioners Court of Fort Bend County, Texas," as passed by the Commissioners Court of Fort Bend County, Texas, of the Minutes of the Commissioners Court of Fort Bend County, Texas, to the extent that such order is not inconsistent with Chapter 181, Vernon's Texas Statutes and Codes Annotated.

Notes:

1. Evidence of review by the Commissioners Court must be kept on the job site and failure to do so constitutes grounds for job shutdown.
2. Written notices are required:
 - a. 48 hours in advance of construction start up, and
 - b. When construction is completed and ready for final inspection, submit notification to Permit Administrator thru MyGovernmentOnline.org portal.
3. This permit expires one (1) year from date of permit if construction has not commenced.

On this 11th day of July, 2017, Upon Motion of Commissioner Meyers, seconded by Commissioner Morales, duly put and carried, it is ORDERED, ADJUDGED AND DECREED that said notice of said above purpose is hereby acknowledged by the Commissioners Court of Fort Bend County, Texas, and that said notice be placed on record according to the regulation order thereof.

Signature

Presented to Commissioners Court and approved.

By: Charles O. Ay
for County Engineer

Date Recorded 7-24-2017 Comm. Court No. 19J

By: N/A
Drainage District Engineer/Manager

Clerk of Commissioners Court
By: Ronita Willis
Deputy

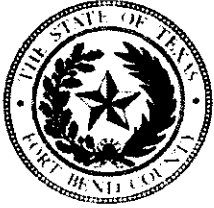

**PERMIT APPLICATION REVIEW FORM FOR
CABLE, CONDUIT, AND POLE LINE ACTIVITY
IN FORT BEND COUNTY**

**Fort Bend County
Engineering Department**
301 Jackson Suite 401
Richmond, Texas 77469
281.633.7500
Permits@fortbendcountytexas.gov

- ☐ Right of Way Permit
☒ Commercial Driveway Permit

Permit No: 2017-13938

The following "Notice of Proposed Cable, Conduit, and/or Pole Line activity in Fort Bend County" and accompanying attachments have been reviewed and the notice conforms to appropriate regulations set by Commissioner's Court of Fort Bend County, Texas.

(1) COMPLETE APPLICATION FORM:

- ☒ a. Name of road, street, and/or drainage ditch affected.
☒ b. Vicinity map showing course of directions
☒ c. Plans and specifications

(2) BOND:

- ☐ County Attorney, approval when applicable.
- ☐ Perpetual bond currently posted. Bond No: _____ Amount: _____
- ☒ Performance bond submitted. Bo [REDACTED] Amount: \$5,000.00
- ☐ Cashier's Check Check No: _____ Amount: _____

(3) DRAINAGE DISTRICT APPROVAL (WHEN APPLICABLE):

Drainage District Approval

Date

We have reviewed this project and agree it meets minimum requirements.

Charles O. Ay

Permit Administrator

6/29/17

Date



**PERFORMANCE BOND COVERING ALL CABLE, CONDUIT AND/OR POLE LINE
ACTIVITY IN, UNDER, ACROSS OR ALONG FORT BEND COUNTY ROAD,
COMMERCIAL DRIVEWAY AND MEDIAN OPENINGS OR MODIFICATIONS
(AUTHORIZED)**

BOND NO. [REDACTED]

THE STATE OF TEXAS §

KNOW ALL MEN BY THESE PRESENTS:

COUNTY OF FORT BEND §

THAT WE, Sovereign Builders, Inc. dba Construction LTD whose (address, phone) is 1825 Upland Drive, Houston, TX 77043, (832) 203-6819 Texas, hereinafter called the Principal, and Berkley Insurance Company, a Corporation existing under and by virtue of the laws of the state of Delaware and authorized to do an indemnifying business in the state of Texas, and whose principal office is located at (name/address/phone) 475 Steamboat Road, Greenwich, CT, 06830, (203) 629-3000 whose officer residing in the State of Texas, authorized to accept service in all suits and actions brought whining said state is Timothy Miller and whose address is 12400 Coit Road, Suite 625, Dallas, TX 75251, hereinafter called the Surety, and held and firmly bound unto, Robert E. Hebert, County Judge of Fort Bend County, Texas, or his successors in office, in the full sum of Five Thousand and No/100 Dollars (\$5,000.00) current, lawful money of the United States of America, to be paid to said Robert E. Hebert, County Judge of Fort Bend County, Texas, or his successors in office, to which payment well and truly to be made and done, we, the undersigned, bind ourselves and each of us, our heirs, executors, administrators, successors, assigns, and legal representatives, jointly and severally, by these presents.

THE CONDITION OF THIS BOND IS SUCH THAT, WHEREAS, the above bounden principal contemplates laying, constructing, maintaining and/or repairing one or more cables, conduits, and/or pole lines in, under, across and/or along roads, streets and highways, commercial driveway and median openings or modifications in the County of Fort Bend, and the State of Texas, under the jurisdiction of the Commissioners' Court of Fort Bend County, Texas, pursuant to the Commissioners' Court order adopted on the 1st day of December, A.D. 1980, recorded in Volume 13, of the Commissioners' Court Minutes of Fort Bend County, Texas, regulating same, which Commissioners' Court order is hereby referred to and made a part hereof for all purposes as though fully set out herein;

AND WHEREAS, the principal desires to provide Fort Bend County with a performance bond covering all such cable, conduit and/or pole line activity, commercial driveway and median openings or modifications;

NOW, THEREFORE, if the above bounden principal shall faithfully perform all its cable, conduit and/or pole line activity (including, but not limited to the laying, construction, maintenance and/or repair of cables, conduits and/or pole lines) in, under, across and/or along roads, streets and highways, commercial driveway and median openings or modifications in the County of Fort Bend and State of Texas, under the jurisdiction of the Commissioners Court of Fort Bend County, Texas, pursuant to and in accordance with minimum requirements and conditions of the above mentioned Commissioners' Court order set forth and specified to be by said principal done and performed, at the time and in the manner therein specified, and shall pay over and make good and reimburse Fort Bend County, all loss and damages which Fort Bend County may sustain by reason of any failure or default on the part of said principal, then this obligation shall be null and void, otherwise to remain in full force and effect.

This bond is payable at the County Courthouse in the County of Fort Bend and State of Texas.

It is understood that at any time Fort Bend County deems itself insecure under this bond, it may require further and/or additional bonds of the principal.

EXECUTED this 19th day of May, 2017.

Sovereign Builders, Inc. dba Construction LTD
PRINCIPAL

BY

Berkley Insurance Company
SURETY

BY

Gloria M. Villa, Attorney-in-Fact

CCM 7-11-17 #195
Fort Bend County Clerk
Return Admin Serv Coord BAC

POWER OF ATTORNEY
BERKLEY INSURANCE COMPANY
 WILMINGTON, DELAWARE

NOTICE: The warning found elsewhere in this Power of Attorney affects the validity thereof. Please review carefully.

KNOW ALL MEN BY THESE PRESENTS, that BERKLEY INSURANCE COMPANY (the "Company"), a corporation duly organized and existing under the laws of the State of Delaware, having its principal office in Greenwich, CT, has made, constituted and appointed, and does by these presents make, constitute and appoint: *Roxanne G. Brune; David R. Groppell; Beverly A. Ireland; Sharen R. Groppell; Francine M. Hay; Kurt A. Risk; Sharon J. Cavanaugh; Stephanie Sue Kohler; or Gloria M. Villa of Marsh & McLennan Agency LLC – Southwest of Houston, TX* its true and lawful Attorney-in-Fact, to sign its name as surety only as delineated below and to execute, seal, acknowledge and deliver any and all bonds and undertakings, with the exception of Financial Guaranty Insurance, providing that no single obligation shall exceed **Fifty Million and 00/100 U.S. Dollars (U.S.\$50,000,000.00)**, to the same extent as if such bonds had been duly executed and acknowledged by the regularly elected officers of the Company at its principal office in their own proper persons.

This Power of Attorney shall be construed and enforced in accordance with, and governed by, the laws of the State of Delaware, without giving effect to the principles of conflicts of laws thereof. This Power of Attorney is granted pursuant to the following resolutions which were duly and validly adopted at a meeting of the Board of Directors of the Company held on January 25, 2010:

RESOLVED, that, with respect to the Surety business written by Berkley Surety Group, the Chairman of the Board, Chief Executive Officer, President or any Vice President of the Company, in conjunction with the Secretary or any Assistant Secretary are hereby authorized to execute powers of attorney authorizing and qualifying the attorney-in-fact named therein to execute bonds, undertakings, recognizances, or other suretyship obligations on behalf of the Company, and to affix the corporate seal of the Company to powers of attorney executed pursuant hereto; and said officers may remove any such attorney-in-fact and revoke any power of attorney previously granted; and further

RESOLVED, that such power of attorney limits the acts of those named therein to the bonds, undertakings, recognizances, or other suretyship obligations specifically named therein, and they have no authority to bind the Company except in the manner and to the extent therein stated; and further

RESOLVED, that such power of attorney revokes all previous powers issued on behalf of the attorney-in-fact named; and further

RESOLVED, that the signature of any authorized officer and the seal of the Company may be affixed by facsimile to any power of attorney or certification thereof authorizing the execution and delivery of any bond, undertaking, recognizance, or other suretyship obligation of the Company; and such signature and seal when so used shall have the same force and effect as though manually affixed. The Company may continue to use for the purposes herein stated the facsimile signature of any person or persons who shall have been such officer or officers of the Company, notwithstanding the fact that they may have ceased to be such at the time when such instruments shall be issued.

IN WITNESS WHEREOF, the Company has caused these presents to be signed and attested by its appropriate officers and its corporate seal hereunto affixed this 13th day of May, 2016.

Attest:
 (Seal) By Ira S. Lederman
 Ira S. Lederman
 Senior Vice President & Secretary

Berkley Insurance Company
 By Jeffrey M. Hafter
 Jeffrey M. Hafter
 Senior Vice President

WARNING: THIS POWER INVALID IF NOT PRINTED ON BLUE "BERKLEY" SECURITY PAPER.

STATE OF CONNECTICUT)

) ss:

COUNTY OF FAIRFIELD)

Sworn to before me, a Notary Public in the State of Connecticut, this 13th day of May, 2016, by Ira S. Lederman and Jeffrey M. Hafter who are sworn to me to be the Senior Vice President and Secretary, and the Senior Vice President, respectively, of Berkley Insurance Company.

MARIA C. RUNDBAKEN
 NOTARY PUBLIC
 MY COMMISSION EXPIRES
 APRIL 30, 2019

Maria C. Rundbaken
 Notary Public, State of Connecticut

CERTIFICATE

I, the undersigned, Assistant Secretary of BERKLEY INSURANCE COMPANY, DO HEREBY CERTIFY that the foregoing is a true, correct and complete copy of the original Power of Attorney; that said Power of Attorney has not been revoked or rescinded and that the authority of the Attorney-in-Fact set forth therein, who executed the bond or undertaking to which this Power of Attorney is attached, is in full force and effect as of this date.

Given under my hand and seal of the Company, this 19th day of May, 2017.

(Seal)

Vincent P. Forte
 Vincent P. Forte

WARNING - Any unauthorized reproduction or alteration of this document is prohibited. This power of attorney is void unless seals are readable and the certification seal at the bottom is embossed. The background imprint, warning and verification instructions (on reverse) must be in blue ink.

Please **verify the authenticity** of the instrument attached to this Power by:

Toll-Free Telephone: (800) 456-5486; or

Electronic Mail: BSGInquiry@berkleysurety.com

Any written notices, inquiries, claims or demands to the Surety on the bond attached to this Power should be directed to:

Berkley Surety Group
412 Mount Kemble Ave.
Suite 310N
Morristown, NJ 07960
Attention: Surety Claims Department

Or

Email: BSGClaim@berkleysurety.com

Please include with all communications the bond number and the name of the principal on the bond. Where a claim is being asserted, please set forth generally the basis of the claim. In the case of a payment or performance bond, please also identify the project to which the bond pertains.

Berkley Surety Group is an operating unit of W. R. Berkley Corporation that underwrites surety business on behalf of Berkley Insurance Company, Berkley Regional Insurance Company and Carolina Casualty Insurance Company.

IMPORTANT NOTICE

To obtain information or make a complaint:

You may call Berkley Surety Group's toll-free telephone number for information or to make a complaint at:

1-866-245-1973

You may also write to Berkley Surety Group at:

Berkley Surety Group, Inc.
412 Mt. Kemble Avenue
Suite 310N
Morristown, NJ 07960
Attention: Surety Claims Department

OR

E-mail: BSGClaim@wrbcurety.com

You may contact the Texas Department of Insurance to obtain information on companies, coverages, rights or complaints at:

1-800-252-3439

You may write the Texas Department of Insurance:

P.O. Box 149104
Austin, TX 78714-9104
Fax: (512) 475-1771
Web: <http://www.tdi.state.tx.us>
E-mail: ConsumerProtection@tdi.state.tx.us

PREMIUM OR CLAIM DISPUTES:

Should you have a dispute concerning your premium or about a claim you should contact the company. If the dispute is not resolved, you may contact the Texas Department of Insurance.

ATTACH THIS NOTICE TO YOUR POLICY:

This notice is for information only and does not become a part or condition of the attached document.

AVISO IMPORTANTE

Para obtener informacion o para someter una queja:

Usted puede llamar al numero de telefono gratis de Berkley Surety Group's para informacion o para someter una queja al:

1-866-245-1973

Usted tambien puede escribir a Berkley Surety Group:

Berkley Surety Group, Inc.
412 Mt. Kemble Avenue
Suite 310N
Morristown, NJ 07960
Attention: Surety Claims Department

OR

E-mail: BSGClaim@wrbcurety.com

Puede comunicarse con el Departamento de Seguros de Texas para obtener informacion acerca de companias, coberturas, derechos o quejas al:

1-800-252-3439

Puede escribir al Departamento de Seguros de Texas:

P.O. Box 149104
Austin, TX 78714-9104
Fax: (512) 475-1771
Web: <http://www.tdi.state.tx.us>
E-mail: ConsumerProtection@tdi.state.tx.us

DISPUTAS SOBRE PRIMAS O RECLAMOS:

Si tiene una disputa concerniente a su prima o a un reclamo, debe comunicarse con el la compania primero. Si no se resuelve la disputa, puede entonces comunicarse con el departamento (TDI).

UNA ESTE AVISO A SU POLIZA: Este aviso es solo para proposito de informacion y no se convierte en parte o condicion del documento adjunto.

FILED AND RECORDED
OFFICIAL PUBLIC RECORDS

Laura Richard

Laura Richard, County Clerk
Fort Bend County, Texas

July 17, 2017 04:06:05 PM

FEE: \$0.00 RMM
BOND

2017079223



SYSTEM, AND PAVING



LOCATION MAP

VICINITY MAP
N.T.S.

SHEET INDEX

NO.	DESCRIPTION
C1	CONCRETE SHEET
C2	CONCRETE CONSTRUCTION DETAILS 1 0'x2' (MC-1-15)
C3	GENERAL CONSTRUCTION DETAILS 2 0'x2' (MC-2-15)
C4	CONCRETE CONSTRUCTION DETAILS 3 0'x2' (MC-3-15)
C5	CONSTRUCTION CONTROL & PAVING PLAN 1 0'x2'
C6	CONCRETE CONSTRUCTION DETAILS 4 0'x2' (MC-4-15)
C7	TRAFFIC CONTROL PLAN - PHASE 2 (AT RITTY HOLLOW PARK, PA.)
C8	TRAFFIC CONTROL PLAN - PHASE 3 (AT RITTY HOLLOW PARK, PA.)
C9	GENERAL CONSTRUCTION DETAILS 5 0'x2' (MC-5-15)
C10	GENERAL CONSTRUCTION DETAILS 6 0'x2' (MC-6-15)
C11	GENERAL CONSTRUCTION DETAILS 7 0'x2' (MC-7-15)
C12	GENERAL CONSTRUCTION DETAILS 8 0'x2' (MC-8-15)
C13	GENERAL CONSTRUCTION DETAILS 9 0'x2' (MC-9-15)
C14	GENERAL CONSTRUCTION DETAILS 10 0'x2' (MC-10-15)
C15	GENERAL CONSTRUCTION DETAILS 11 0'x2' (MC-11-15)
C16	GENERAL CONSTRUCTION DETAILS 12 0'x2' (MC-12-15)
C17	GENERAL CONSTRUCTION DETAILS 13 0'x2' (MC-13-15)
C18	GENERAL CONSTRUCTION DETAILS 14 0'x2' (MC-14-15)
C19	GENERAL CONSTRUCTION DETAILS 15 0'x2' (MC-15-15)
C20	GENERAL CONSTRUCTION DETAILS 16 0'x2' (MC-16-15)
C21	GENERAL CONSTRUCTION DETAILS 17 0'x2' (MC-17-15)
C22	GENERAL CONSTRUCTION DETAILS 18 0'x2' (MC-18-15)
C23	GENERAL CONSTRUCTION DETAILS 19 0'x2' (MC-19-15)
C24	GENERAL CONSTRUCTION DETAILS 20 0'x2' (MC-20-15)
C25	GENERAL CONSTRUCTION DETAILS 21 0'x2' (MC-21-15)
C26	GENERAL CONSTRUCTION DETAILS 22 0'x2' (MC-22-15)
C27	GENERAL CONSTRUCTION DETAILS 23 0'x2' (MC-23-15)
C28	GENERAL CONSTRUCTION DETAILS 24 0'x2' (MC-24-15)
C29	GENERAL CONSTRUCTION DETAILS 25 0'x2' (MC-25-15)
C30	GENERAL CONSTRUCTION DETAILS 26 0'x2' (MC-26-15)
C31	GENERAL CONSTRUCTION DETAILS 27 0'x2' (MC-27-15)
C32	GENERAL CONSTRUCTION DETAILS 28 0'x2' (MC-28-15)
C33	GENERAL CONSTRUCTION DETAILS 29 0'x2' (MC-29-15)
C34	GENERAL CONSTRUCTION DETAILS 30 0'x2' (MC-30-15)
C35	GENERAL CONSTRUCTION DETAILS 31 0'x2' (MC-31-15)
C36	GENERAL CONSTRUCTION DETAILS 32 0'x2' (MC-32-15)
C37	GENERAL CONSTRUCTION DETAILS 33 0'x2' (MC-33-15)
C38	GENERAL CONSTRUCTION DETAILS 34 0'x2' (MC-34-15)
C39	GENERAL CONSTRUCTION DETAILS 35 0'x2' (MC-35-15)
C40	GENERAL CONSTRUCTION DETAILS 36 0'x2' (MC-36-15)
C41	GENERAL CONSTRUCTION DETAILS 37 0'x2' (MC-37-15)
C42	GENERAL CONSTRUCTION DETAILS 38 0'x2' (MC-38-15)
C43	GENERAL CONSTRUCTION DETAILS 39 0'x2' (MC-39-15)
C44	GENERAL CONSTRUCTION DETAILS 40 0'x2' (MC-40-15)
C45	GENERAL CONSTRUCTION DETAILS 41 0'x2' (MC-41-15)
C46	GENERAL CONSTRUCTION DETAILS 42 0'x2' (MC-42-15)
C47	GENERAL CONSTRUCTION DETAILS 43 0'x2' (MC-43-15)
C48	GENERAL CONSTRUCTION DETAILS 44 0'x2' (MC-44-15)
C49	GENERAL CONSTRUCTION DETAILS 45 0'x2' (MC-45-15)
C50	GENERAL CONSTRUCTION DETAILS 46 0'x2' (MC-46-15)
C51	GENERAL CONSTRUCTION DETAILS 47 0'x2' (MC-47-15)
C52	GENERAL CONSTRUCTION DETAILS 48 0'x2' (MC-48-15)
C53	GENERAL CONSTRUCTION DETAILS 49 0'x2' (MC-49-15)
C54	GENERAL CONSTRUCTION DETAILS 50 0'x2' (MC-50-15)
C55	GENERAL CONSTRUCTION DETAILS 51 0'x2' (MC-51-15)
C56	GENERAL CONSTRUCTION DETAILS 52 0'x2' (MC-52-15)
C57	GENERAL CONSTRUCTION DETAILS 53 0'x2' (MC-53-15)
C58	GENERAL CONSTRUCTION DETAILS 54 0'x2' (MC-54-15)
C59	GENERAL CONSTRUCTION DETAILS 55 0'x2' (MC-55-15)
C60	GENERAL CONSTRUCTION DETAILS 56 0'x2' (MC-56-15)
C61	GENERAL CONSTRUCTION DETAILS 57 0'x2' (MC-57-15)
C62	GENERAL CONSTRUCTION DETAILS 58 0'x2' (MC-58-15)
C63	GENERAL CONSTRUCTION DETAILS 59 0'x2' (MC-59-15)
C64	GENERAL CONSTRUCTION DETAILS 60 0'x2' (MC-60-15)
C65	GENERAL CONSTRUCTION DETAILS 61 0'x2' (MC-61-15)
C66	GENERAL CONSTRUCTION DETAILS 62 0'x2' (MC-62-15)
C67	GENERAL CONSTRUCTION DETAILS 63 0'x2' (MC-63-15)
C68	GENERAL CONSTRUCTION DETAILS 64 0'x2' (MC-64-15)
C69	GENERAL CONSTRUCTION DETAILS 65 0'x2' (MC-65-15)
C70	GENERAL CONSTRUCTION DETAILS 66 0'x2' (MC-66-15)
C71	GENERAL CONSTRUCTION DETAILS 67 0'x2' (MC-67-15)
C72	GENERAL CONSTRUCTION DETAILS 68 0'x2' (MC-68-15)
C73	GENERAL CONSTRUCTION DETAILS 69 0'x2' (MC-69-15)
C74	GENERAL CONSTRUCTION DETAILS 70 0'x2' (MC-70-15)
C75	GENERAL CONSTRUCTION DETAILS 71 0'x2' (MC-71-15)
C76	GENERAL CONSTRUCTION DETAILS 72 0'x2' (MC-72-15)
C77	GENERAL CONSTRUCTION DETAILS 73 0'x2' (MC-73-15)
C78	GENERAL CONSTRUCTION DETAILS 74 0'x2' (MC-74-15)
C79	GENERAL CONSTRUCTION DETAILS 75 0'x2' (MC-75-15)
C80	GENERAL CONSTRUCTION DETAILS 76 0'x2' (MC-76-15)
C81	GENERAL CONSTRUCTION DETAILS 77 0'x2' (MC-77-15)
C82	GENERAL CONSTRUCTION DETAILS 78 0'x2' (MC-78-15)
C83	GENERAL CONSTRUCTION DETAILS 79 0'x2' (MC-79-15)
C84	GENERAL CONSTRUCTION DETAILS 80 0'x2' (MC-80-15)
C85	GENERAL CONSTRUCTION DETAILS 81 0'x2' (MC-81-15)
C86	GENERAL CONSTRUCTION DETAILS 82 0'x2' (MC-82-15)
C87	GENERAL CONSTRUCTION DETAILS 83 0'x2' (MC-83-15)
C88	GENERAL CONSTRUCTION DETAILS 84 0'x2' (MC-84-15)
C89	GENERAL CONSTRUCTION DETAILS 85 0'x2' (MC-85-15)
C90	GENERAL CONSTRUCTION DETAILS 86 0'x2' (MC-86-15)
C91	GENERAL CONSTRUCTION DETAILS 87 0'x2' (MC-87-15)
C92	GENERAL CONSTRUCTION DETAILS 88 0'x2' (MC-88-15)
C93	GENERAL CONSTRUCTION DETAILS 89 0'x2' (MC-89-15)
C94	GENERAL CONSTRUCTION DETAILS 90 0'x2' (MC-90-15)
C95	GENERAL CONSTRUCTION DETAILS 91 0'x2' (MC-91-15)
C96	GENERAL CONSTRUCTION DETAILS 92 0'x2' (MC-92-15)
C97	GENERAL CONSTRUCTION DETAILS 93 0'x2' (MC-93-15)
C98	GENERAL CONSTRUCTION DETAILS 94 0'x2' (

ACCORDING TO FEMA FLOOD INSURANCE RATE MAP (FIRM) NO. 44181C0391L, MAP REVISED APRIL 2, 2004, THE SOUTHWEST TRACT LIES IN ZONE "X" UNINSURED, DENIED BY FEMA AS AREAS DETERMINED TO BE OUTSIDE THE 0.2% ANNUAL CHANCE FLOODPLAIN.

**ONE-CALL NOTIFICATION SYSTEM
CALL BEFORE YOU DIG!!**
(713) 225-4567 (In Houston)
(Mem Houston Area Office Outside Houston)
1-800-545-8605

POST-BOND COMPANY EMPLOYEES
ENGINEER: W. B. Smith, Jr., M.O.E.
for W. B. Smith, Jr., M.O.E.
DATE: 5/8/17

THESE SIGNATURES ARE VOID IF COUNTERFEITING
HAS NOT COMMENCED IN (1) YEAR FROM DATE
OF APPROVAL

APPROVED: [Signature]
Time Inspection Completed
DATE: 5/8/17

THE USE OF FUEL OIL AND LSA DEWASERS IS AUTHORIZED AND DERIVED SOLELY FROM THE PURCHASE OF THIS SPECIFIC FUELSHEET AND LSA CARD. NO OTHER COMBUSTION OR LSA FOR ANY OTHER MODEL.	
SHEET NUMBER C1	
SHEET TITLE COVER SHEET	
BURN BY: V.M.	CHECK BY: J.S.A.
DATA PROJECT NUMBER: 018-06-003	

12-14-77

COMM

DEPT. OF JUSTICE

FEDERAL BUREAU OF INVESTIGATION

U. S. DEPARTMENT OF JUSTICE

PROJECT NAME:

**SHOPPES AT SIENNA
PLANTATION**
9129 & 9303 STATE HIGHWAY 6 AT KITTY
HOLLOW PARK DRIVE
MISSOURI CITY, TX 77459

REP/DATE	16925 Parkway Oaks Ct. Houston, Texas 77055 Tel: (281) 281-8324 Mobile (832) 671-5689	DESCRIPTION	
12-08-16		ISSUE FOR REPAIR	
05-04-17		ISSUED FOR COUNTRY COUNCIL	



Quail Valley Business Park
 1306 E.H. 1092, Suite 303
 Missouri City, Texas 77459-1564
 Tel: (713) 562-6100

ASPHALTIC MATERIAL AND WORKMANSHIP SHALL COMPLY WITH ASTM C 33, ASTM C 131, ASTM C 136, AND TIGHT STANDARD SPECIFICATIONS FOR CONSTRUCTION OF HIGHWAYS, STREETS AND BRIDGES (1983) AND ITS LATEST REVISIONS. ASPHALT SHALL BE TYPE D-100 UNLESS SPECIFICALLY NOTED AND APPROVED BY CITY OF MISSOURI CITY ENGINEER.

- [illegible]

STORM SEWERS SHALL BE DESIGNED AND CONSTRUCTED WITH CITY OF MISSOURI CITY INFRASTRUCTURE DESIGN MANUAL AND IN ACCORDANCE WITH CITY OF MISSOURI CITY STANDARD CONSTRUCTION DETAILS.

- [illegible]

SANITARY SEWERS, FORCE MAINS, MANHOLES, LIFT STATIONS AND WASTEWATER TREATMENT PLANTS SHALL BE DESIGNED AND CONSTRUCTED AS PER THE REQUIREMENTS OF THE CITY OF MISSOURI CITY INFRASTRUCTURE STANDARDS AND CORRESPONDING STANDARD CONSTRUCTION DETAILS SHEETS AND AS PER THE REQUIREMENTS OF THE TEXAS COMMISSION ON

- [illegible]

AND CONSTRUCTED AS PER REQUIREMENTS OF THE CITY OF MESQUITE CITY INFRASTRUCTURE DESIGN MANUAL AND CORRESPONDING STANDARD CONSTRUCTION DETAILS SHEETS AND AS PER THE REQUIREMENTS OF THE IDEAS COMMISSION ON ENVIRONMENTAL QUALITY. SHOULD A CONFLICT ARISE BETWEEN INFORMATION PROVIDED ON APPROVED CONSTRUCTION DRAWINGS

- [illegible]

Fort Bend County
Construction - General Trades

[illegible][illegible]

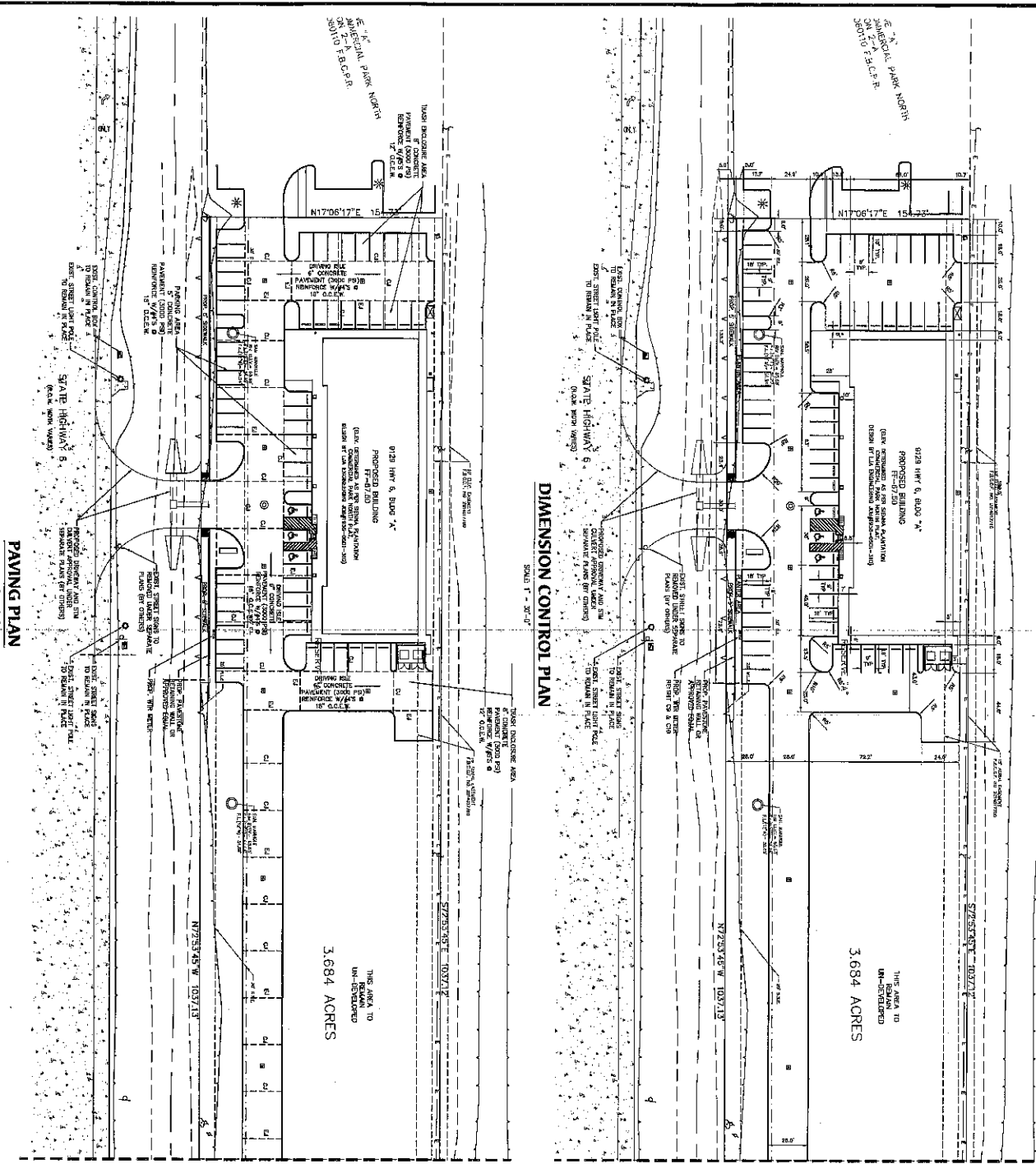

Point #	Maximum Discharge	Suggested Maximum
Speed	Formule	Flow
< 30	$10^3 \frac{m^3}{s}$	On 5
30	$10^3 \frac{m^3}{s}$	On 5
40	$10^3 \frac{m^3}{s}$	On 5
45	$10^3 \frac{m^3}{s}$	On 5
50	$10^3 \frac{m^3}{s}$	On 5
55	$10^3 \frac{m^3}{s}$	On 5
60	$10^3 \frac{m^3}{s}$	On 5
65	$10^3 \frac{m^3}{s}$	On 5
150°	166°	180°
205°	225°	246°
285°	285°	320°
460°	493°	540°
500°	535°	600°
550°	656°	85°
600°	660°	720°
650°	716°	768°
		95°
		130-175°

- * 85th Percentile Speed may be used on roads where traffic speeds normally exceed the posted speed limit.
- ** Taper lengths have been rounded off.

SPEED LIMIT



2. NO LATES SHALL BE DEDUCTED FROM 7 A.M. TO 4 P.M. AND 1 P.M. TO 6 P.M. MONDAY THROUGH FRIDAY.
3. NO WORK SHALL BE DONE ON SATURDAY.
4. A CONTRACTOR SHALL OBTAIN THE FOLLOWING WITHIN 15 DAYS AFTER THE DATE OF AWARD:
 - a. A LETTER FROM THE CITY ENGINEER, RECOMMENDING THE PLANT BEING PROPOSED FOR USE.
 - b. A LETTER FROM THE CITY ENGINEER, RECOMMENDING THE PLANT BEING PROPOSED FOR USE.
 - c. A LETTER FROM THE CITY ENGINEER, RECOMMENDING THE PLANT BEING PROPOSED FOR USE.
 - d. A LETTER FROM THE CITY ENGINEER, RECOMMENDING THE PLANT BEING PROPOSED FOR USE.
 - e. A LETTER FROM THE CITY ENGINEER, RECOMMENDING THE PLANT BEING PROPOSED FOR USE.
 - f. A LETTER FROM THE CITY ENGINEER, RECOMMENDING THE PLANT BEING PROPOSED FOR USE.
 - g. A LETTER FROM THE CITY ENGINEER, RECOMMENDING THE PLANT BEING PROPOSED FOR USE.
 - h. A LETTER FROM THE CITY ENGINEER, RECOMMENDING THE PLANT BEING PROPOSED FOR USE.
 - i. A LETTER FROM THE CITY ENGINEER, RECOMMENDING THE PLANT BEING PROPOSED FOR USE.
 - j. A LETTER FROM THE CITY ENGINEER, RECOMMENDING THE PLANT BEING PROPOSED FOR USE.
 - k. A LETTER FROM THE CITY ENGINEER, RECOMMENDING THE PLANT BEING PROPOSED FOR USE.
 - l. A LETTER FROM THE CITY ENGINEER, RECOMMENDING THE PLANT BEING PROPOSED FOR USE.
 - m. A LETTER FROM THE CITY ENGINEER, RECOMMENDING THE PLANT BEING PROPOSED FOR USE.
 - n. A LETTER FROM THE CITY ENGINEER, RECOMMENDING THE PLANT BEING PROPOSED FOR USE.
 - o. A LETTER FROM THE CITY ENGINEER, RECOMMENDING THE PLANT BEING PROPOSED FOR USE.
 - p. A LETTER FROM THE CITY ENGINEER, RECOMMENDING THE PLANT BEING PROPOSED FOR USE.
 - q. A LETTER FROM THE CITY ENGINEER, RECOMMENDING THE PLANT BEING PROPOSED FOR USE.
 - r. A LETTER FROM THE CITY ENGINEER, RECOMMENDING THE PLANT BEING PROPOSED FOR USE.
 - s. A LETTER FROM THE CITY ENGINEER, RECOMMENDING THE PLANT BEING PROPOSED FOR USE.
 - t. A LETTER FROM THE CITY ENGINEER, RECOMMENDING THE PLANT BEING PROPOSED FOR USE.
 - u. A LETTER FROM THE CITY ENGINEER, RECOMMENDING THE PLANT BEING PROPOSED FOR USE.
 - v. A LETTER FROM THE CITY ENGINEER, RECOMMENDING THE PLANT BEING PROPOSED FOR USE.
 - w. A LETTER FROM THE CITY ENGINEER, RECOMMENDING THE PLANT BEING PROPOSED FOR USE.
 - x. A LETTER FROM THE CITY ENGINEER, RECOMMENDING THE PLANT BEING PROPOSED FOR USE.
 - y. A LETTER FROM THE CITY ENGINEER, RECOMMENDING THE PLANT BEING PROPOSED FOR USE.
 - z. A LETTER FROM THE CITY ENGINEER, RECOMMENDING THE PLANT BEING PROPOSED FOR USE.
5. APPROVED CHAIRS OF "STANDARD" PLANT SHALL BE AVAILABLE FOR INSPECTION AT ALL TIMES.
6. IF THE CONTRACTOR DESIRES TO USE A DIFFERENT METHOD OF PLANT CONTROL, PLANT DESIGN OR CONTROL SYSTEM, HE SHALL SUBMIT THE SAME TO THE CONTRACT AGENCIES, FOR REVIEW AND APPROVAL. THE CONTRACT AGENCIES SHALL REVIEW THE PROPOSAL AND SHALL ADVISE THE CONTRACTOR OF ANY REVISIONS REQUIRED FOR APPROVAL. THE CONTRACTOR SHALL BE RESPONSIBLE FOR ANY REVISIONS REQUIRED FOR APPROVAL.

SURVEY LEGEND:

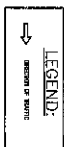

INSURANCE—THE STATE OF CALIFORNIA HAS PASSED A BILL TO REQUIRE THE INSURANCE COMPANIES OF THE STATE TO PROVIDE A DISCOUNT ON THE RATES OF LIFE AND ACCIDENT AND SICKNESS INSURANCE TO POLICYHOLDERS WHO ARE MEMBERS OF A QUALIFIED PENSION PLAN. THE BILL, CALLED SENATE BILL 1005, PROVIDES THAT IF AN INDIVIDUAL IS A MEMBER OF A QUALIFIED PENSION PLAN, HE OR SHE WILL BE ELIGIBLE FOR A 10 PERCENT DISCOUNT ON THE RATES OF LIFE AND ACCIDENT AND SICKNESS INSURANCE. THE BILL ALSO PROVIDES THAT THE DISCOUNT WILL BE APPLIED TO THE RATES OF LIFE AND ACCIDENT AND SICKNESS INSURANCE FOR THE FIRST YEAR OF THE POLICY. THE BILL ALSO PROVIDES THAT THE DISCOUNT WILL BE APPLIED TO THE RATES OF LIFE AND ACCIDENT AND SICKNESS INSURANCE FOR THE FIRST YEAR OF THE POLICY. THE BILL ALSO PROVIDES THAT THE DISCOUNT WILL BE APPLIED TO THE RATES OF LIFE AND ACCIDENT AND SICKNESS INSURANCE FOR THE FIRST YEAR OF THE POLICY.

9129 & 9303 STATE HIGHWAY 6 AT KITTY
HOLLOW PARK DRIVE
MISSOURI CITY, TX 77459

TCP- PHASE 1
AT KITTY HOLLOW

DATE: 11-11-11	OPEN
DRAWN BY: Y.M.	
GFA PROJECT NUMBER	

CONSTRUCTION WARNING	
SIGN SPACING	
Forward or Backward	Min.
85% Speed (mph)	1000
50 or less	1200
35	1500
45	2000
50	2500
55	3000
60	3500
65	4000
70	4500
75	5000
80	5500
85	6000

SUGGESTED MAXIMUM SPACING OF DEVICES	
Minimum Desired	Suggested Maximum
10' or less	12'
15'	18'
20'	24'
25'	30'
30'	36'
35'	42'
40'	48'
45'	54'
50'	60'
55'	66'
60'	72'
65'	78'
70'	84'
75'	90'
80'	96'
85'	102'
90'	108'
95'	114'
100'	120'
105'	126'
110'	132'
115'	138'
120'	144'
125'	150'
130'	156'
135'	162'
140'	168'
145'	174'
150'	180'
155'	186'
160'	192'
165'	198'
170'	204'
175'	210'
180'	216'
185'	222'
190'	228'
195'	234'
200'	240'
205'	246'
210'	252'
215'	258'
220'	264'
225'	270'
230'	276'
235'	282'
240'	288'
245'	294'
250'	300'
255'	306'
260'	312'
265'	318'
270'	324'
275'	330'
280'	336'
285'	342'
290'	348'
295'	354'
300'	360'
305'	366'
310'	372'
315'	378'
320'	384'
325'	390'
330'	396'
335'	402'
340'	408'
345'	414'
350'	420'
355'	426'
360'	432'
365'	438'
370'	444'
375'	450'
380'	456'
385'	462'
390'	468'
395'	474'
400'	480'
405'	486'
410'	492'
415'	498'
420'	504'
425'	510'
430'	516'
435'	522'
440'	528'
445'	534'
450'	540'
455'	546'
460'	552'
465'	558'
470'	564'
475'	570'
480'	576'
485'	582'
490'	588'
495'	594'
500'	600'
505'	606'
510'	612'
515'	618'
520'	624'
525'	630'
530'	636'
535'	642'
540'	648'
545'	654'
550'	660'
555'	666'
560'	672'
565'	678'
570'	684'
575'	690'
580'	696'
585'	702'
590'	708'
595'	714'
600'	720'
605'	726'
610'	732'
615'	738'
620'	744'
625'	750'
630'	756'
635'	762'
640'	768'
645'	774'
650'	780'
655'	786'
660'	792'
665'	798'
670'	804'
675'	810'
680'	816'
685'	822'
690'	828'
695'	834'
700'	840'
705'	846'
710'	852'
715'	858'
720'	864'
725'	870'
730'	876'
735'	882'
740'	888'
745'	894'
750'	900'
755'	906'
760'	912'
765'	918'
770'	924'
775'	930'
780'	936'
785'	942'
790'	948'
795'	954'
800'	960'
805'	966'
810'	972'
815'	978'
820'	984'
825'	990'
830'	996'
835'	1002'
840'	1008'
845'	1014'
850'	1020'
855'	1026'
860'	1032'
865'	1038'
870'	1044'
875'	1050'
880'	1056'
885'	1062'
890'	1068'
895'	1074'
900'	1080'
905'	1086'
910'	1092'
915'	1098'
920'	1104'
925'	1110'
930'	1116'
935'	1122'
940'	1128'
945'	1134'
950'	1140'
955'	1146'
960'	1152'
965'	1158'
970'	1164'
975'	1170'
980'	1176'
985'	1182'
990'	1188'
995'	1194'
1000'	1200'

* 85th Percentile Speed may be used on roads where traffic is predominantly composed of passenger cars.
 ** Top lengths have been rounded off.

TYPICAL TRANSITION LENGTHS AND SUGGESTED MAXIMUM SPACING OF DEVICES

LEGEND

- PLASTIC DRUM (Typical)
- OFF-DUTY UNIFORMED POLICE OFFICER
- FLASHING ARROW PANEL
- TUBULAR MARKER
- CONSTRUCTION AREA

TRAFFIC NOTES

- CONTRACTOR SHALL PROVIDE AND INSTALL TRAFFIC CONTROL DEVICES IN CONFORMANCE WITH THE TEXAS MANUAL ON HIGHWAY TRAFFIC CONTROL, LATEST EDITION.
- ALL LANE CHANGES SHALL BE BACKED UP FROM 7 A.M. TO 7 P.M. AND FROM 6 P.M. TO 6 A.M. MONDAY THROUGH FRIDAY.
- OFF-DUTY POLICE OFFICERS ARE REQUIRED TO DIRECT TRAFFIC WHEN LANE CHANGES ARE BEING MADE.
- CONTRACTOR SHALL COVER THE EXCAVATION WITH STEEL PLATES ANCHORED PROPERLY DURING NON-WORKING HOURS AND ALLOW NORMAL TRAFFIC FLOW. IF COVERING IS NOT POSSIBLE, THE CONTRACTOR SHALL PROVIDE AN ADEQUATE WARNING AND TRAFFIC CONTROL DEVICES TO ADEQUATELY PROTECT THE EXCAVATION FROM TRAFFIC.
- APPROVED COPIES OF "TRAFFIC CONTROL PLANS" SHALL BE AVAILABLE FOR INSPECTION AT ALL TIMES.
- IF THE CONTRACTOR CHOOSES TO USE A DIFFERENT METHOD OF TRAFFIC CONTROL, PLANS DURING THE CONSTRUCTION PERIOD SHALL BE OBTAINED IN THE CONTRACTOR'S OFFICE FOR REVIEW AND APPROVAL BY THE PROJECT ENGINEER. IF THE CONTRACTOR CHOOSES TO USE A DIFFERENT METHOD OF TRAFFIC CONTROL, PLANS DURING THE CONSTRUCTION PERIOD SHALL BE OBTAINED IN THE CONTRACTOR'S OFFICE FOR REVIEW AND APPROVAL BY THE PROJECT ENGINEER.
- IF THE PROJECT IS WITHIN 400 FEET FROM A SIGNALIZED INTERSECTION, THE CONTRACTOR SHALL PROVIDE TRAFFIC CONTROL DEVICES IN CONFORMANCE WITH THE TEXAS MANUAL ON HIGHWAY TRAFFIC CONTROL, LATEST EDITION, AT 200 FEET FROM THE INTERSECTION.

* THESE PLANS SHALL BE DESIGNED TO MEET OR EXCEED THE MINIMUM REQUIREMENTS SET FORTH IN THE TEXAS MANUAL ON HIGHWAY TRAFFIC CONTROL, LATEST EDITION, AND THE TEXAS MANUAL ON HIGHWAY TRAFFIC CONTROL, LATEST EDITION, AND THE TEXAS MANUAL ON HIGHWAY TRAFFIC CONTROL, LATEST EDITION.

THE CONTRACTOR SHALL BE RESPONSIBLE FOR THE DESIGN AND CONSTRUCTION OF THE TRAFFIC CONTROL DEVICES AND FOR THE MAINTENANCE OF THE TRAFFIC CONTROL DEVICES DURING THE CONSTRUCTION PERIOD.

THE CONTRACTOR SHALL BE RESPONSIBLE FOR THE DESIGN AND CONSTRUCTION OF THE TRAFFIC CONTROL DEVICES AND FOR THE MAINTENANCE OF THE TRAFFIC CONTROL DEVICES DURING THE CONSTRUCTION PERIOD.

SURVEY SYMBOLS: SURVEY LEGEND:

- 1. ELECTRIC SIGN
- 2. FLASHING SIGN
- 3. FLASHING SIGN
- 4. FLASHING SIGN
- 5. FLASHING SIGN
- 6. FLASHING SIGN
- 7. FLASHING SIGN
- 8. FLASHING SIGN
- 9. FLASHING SIGN
- 10. FLASHING SIGN
- 11. FLASHING SIGN
- 12. FLASHING SIGN
- 13. FLASHING SIGN
- 14. FLASHING SIGN
- 15. FLASHING SIGN
- 16. FLASHING SIGN
- 17. FLASHING SIGN
- 18. FLASHING SIGN
- 19. FLASHING SIGN
- 20. FLASHING SIGN
- 21. FLASHING SIGN
- 22. FLASHING SIGN
- 23. FLASHING SIGN
- 24. FLASHING SIGN
- 25. FLASHING SIGN
- 26. FLASHING SIGN
- 27. FLASHING SIGN
- 28. FLASHING SIGN
- 29. FLASHING SIGN
- 30. FLASHING SIGN
- 31. FLASHING SIGN
- 32. FLASHING SIGN
- 33. FLASHING SIGN
- 34. FLASHING SIGN
- 35. FLASHING SIGN
- 36. FLASHING SIGN
- 37. FLASHING SIGN
- 38. FLASHING SIGN
- 39. FLASHING SIGN
- 40. FLASHING SIGN
- 41. FLASHING SIGN
- 42. FLASHING SIGN
- 43. FLASHING SIGN
- 44. FLASHING SIGN
- 45. FLASHING SIGN
- 46. FLASHING SIGN
- 47. FLASHING SIGN
- 48. FLASHING SIGN
- 49. FLASHING SIGN
- 50. FLASHING SIGN
- 51. FLASHING SIGN
- 52. FLASHING SIGN
- 53. FLASHING SIGN
- 54. FLASHING SIGN
- 55. FLASHING SIGN
- 56. FLASHING SIGN
- 57. FLASHING SIGN
- 58. FLASHING SIGN
- 59. FLASHING SIGN
- 60. FLASHING SIGN
- 61. FLASHING SIGN
- 62. FLASHING SIGN
- 63. FLASHING SIGN
- 64. FLASHING SIGN
- 65. FLASHING SIGN
- 66. FLASHING SIGN
- 67. FLASHING SIGN
- 68. FLASHING SIGN
- 69. FLASHING SIGN
- 70. FLASHING SIGN
- 71. FLASHING SIGN
- 72. FLASHING SIGN
- 73. FLASHING SIGN
- 74. FLASHING SIGN
- 75. FLASHING SIGN
- 76. FLASHING SIGN
- 77. FLASHING SIGN
- 78. FLASHING SIGN
- 79. FLASHING SIGN
- 80. FLASHING SIGN
- 81. FLASHING SIGN
- 82. FLASHING SIGN
- 83. FLASHING SIGN
- 84. FLASHING SIGN
- 85. FLASHING SIGN
- 86. FLASHING SIGN
- 87. FLASHING SIGN
- 88. FLASHING SIGN
- 89. FLASHING SIGN
- 90. FLASHING SIGN
- 91. FLASHING SIGN
- 92. FLASHING SIGN
- 93. FLASHING SIGN
- 94. FLASHING SIGN
- 95. FLASHING SIGN
- 96. FLASHING SIGN
- 97. FLASHING SIGN
- 98. FLASHING SIGN
- 99. FLASHING SIGN
- 100. FLASHING SIGN

LEGEND:

SECTION OF TRAFFIC

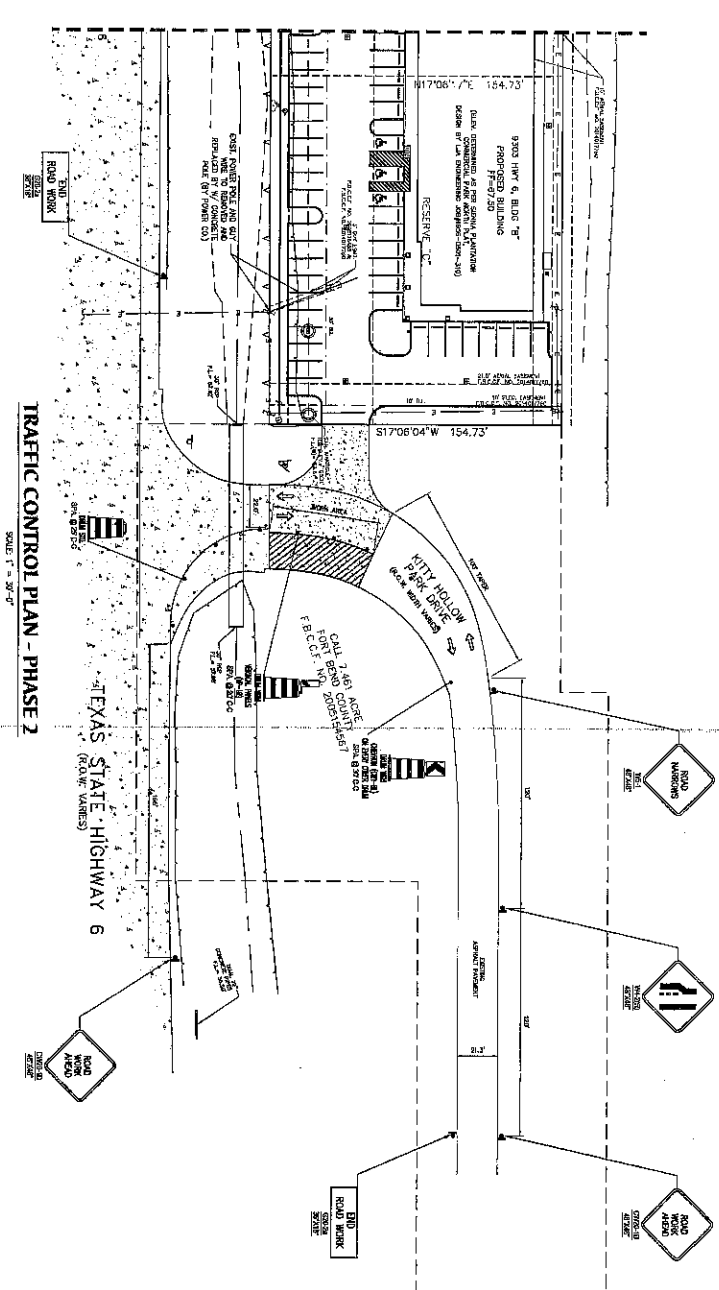

TRAFFIC CONTROL PLAN - PHASE 2

SCALE: 1" = 30'-0"

APPROVED:

DATE: 6/18/17

SHOPPES AT SIENNA PLANTATION

9129 & 9303 STATE HIGHWAY 6 AT KITTY HOLLOW PARK DRIVE

MISSOURI CITY, TX 77459

TX PUBLIC REGISTRATION NO. 15943

Qual Valley Building Park

1305 FM 1952, Suite 300

Missouri City, Texas 77459-1564

Tel: (713) 552-4180

PROJECT NAME: SHOPPES AT SIENNA PLANTATION

PROJECT NO.: 15943

DATE: 6/18/17

SCALE: 1" = 30'-0"

DATE: 6/18/17

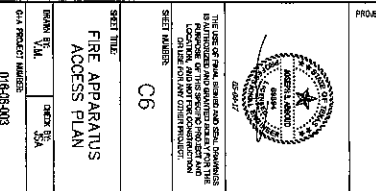

**SHOPPES AT SIENNA
PLANTATION**
9129 & 9303 STATE HIGHWAY 6 AT KITTY
HOLLOW PARK DRIVE
MISSOURI CITY, TX 77459

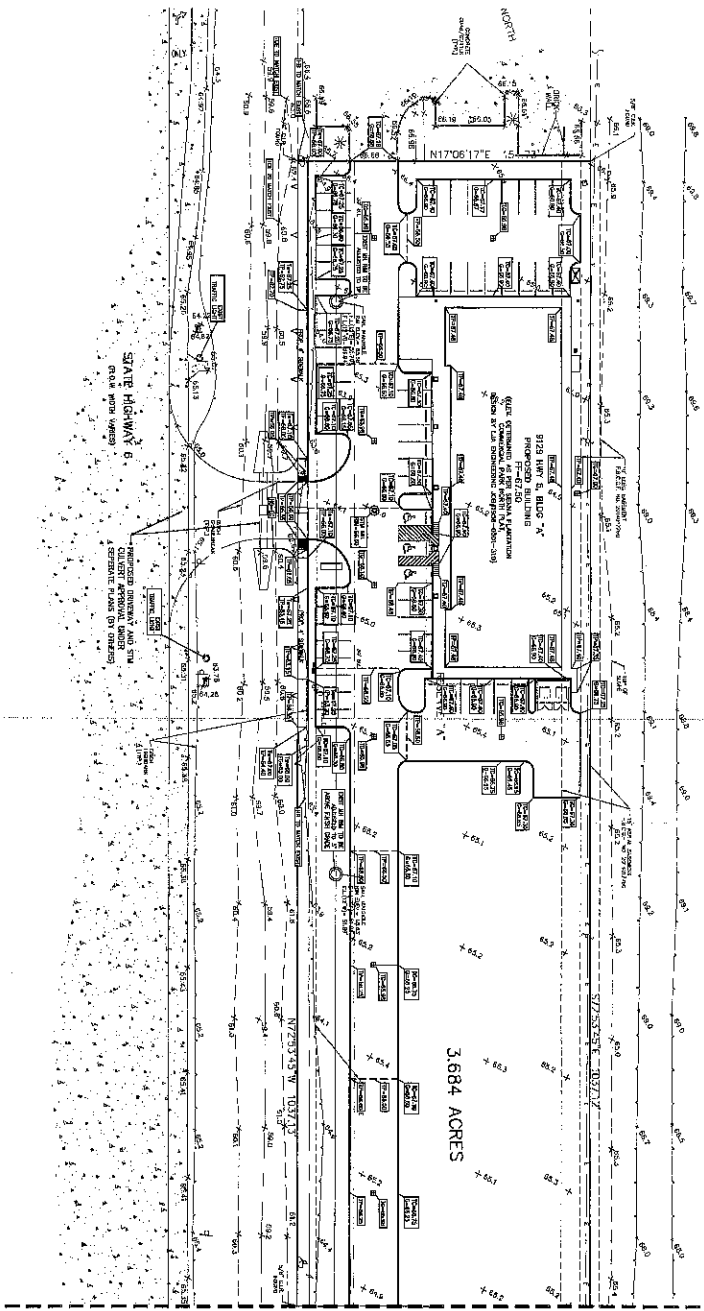

MATCH LINE - SEE SHEET C8

THE CONVEYOR SHALL HOLD THE TITLE TO THE LAND AND THE BUILDING THEREON IN TRUST FOR THE BENEFIT OF THE SHIPPERS AT SIENNA PLANTATION. THE CONVEYOR SHALL NOT BE RESPONSIBLE FOR THE ACTIONS OF THE SHIPPERS AT SIENNA PLANTATION.

NOTE: ALL BUILDING FOR THE SHIPPERS AT SIENNA PLANTATION SHALL BE CONSTRUCTED TO MEET THE REQUIREMENTS OF THE CITY OF MISSOURI CITY, TEXAS.

ONE-CALL NOTIFICATION SYSTEM SHALL BE PROVIDED TO THE SHIPPERS AT SIENNA PLANTATION.

PROPOSED LEGEND:

- BL - BUILDING LINE
- EL - ELEVATION
- FL - FLOOR LINE
- GL - GROUND LINE
- HL - HIGHWAY LINE
- IL - INTERSECTION
- KL - KIDNEY POLE
- LL - LIGHT STANDARD
- ML - MANHOLE
- NL - NORTH ARROW
- OL - OPENING
- PL - PARKING LOT
- RL - ROAD
- SL - SIDEWALK
- TL - TRAIL
- UL - UTILITY
- VL - VALVE
- WL - WATER LINE
- XL - EXISTING
- YL - YARD
- ZL - ZONE

SURVEY SYMBOLS:

- BL - BUILDING LINE
- EL - ELEVATION
- FL - FLOOR LINE
- GL - GROUND LINE
- HL - HIGHWAY LINE
- IL - INTERSECTION
- KL - KIDNEY POLE
- LL - LIGHT STANDARD
- ML - MANHOLE
- NL - NORTH ARROW
- OL - OPENING
- PL - PARKING LOT
- RL - ROAD
- SL - SIDEWALK
- TL - TRAIL
- UL - UTILITY
- VL - VALVE
- WL - WATER LINE
- XL - EXISTING
- YL - YARD
- ZL - ZONE

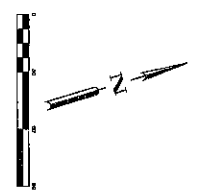

SHIPPERS AT SIENNA PLANTATION

9129 & 9303 STATE HIGHWAY 6 AT KITTY HOLLOW PARK DRIVE
MISSOURI CITY, TX 77459

10050 Highway 6, Suite 203
Missouri City, Texas 77459-1564
Tel: (281) 592-0100

10050 Highway 6, Suite 203
Missouri City, Texas 77459-1564
Tel: (281) 592-0100

SHIPPERS AT SIENNA PLANTATION NO. P-13913

10050 Highway 6, Suite 203
Missouri City, Texas 77459-1564
Tel: (281) 592-0100

PROJECT NAME: SHIPPERS AT SIENNA PLANTATION

DATE: 01-15-11

SCALE: 1" = 100'

SHEET NO.: 1 OF 2

GRADING PLAN



DATE: 01-15-11

BY: JSA

CHECKED: JSA

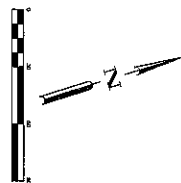
01-15-11



 05-04-17 REVENUE PER COUNTY COMPARISON	BY DATE 12-04-16 ISSUE FOR FISCAL 2017	16055 Buckle Up! Oaks Ct. Houston, Texas 77063 Tel: (281) 201-8624 Mobile: (832) 671-3409	
---	---	--	---

REV/DAT	DESCRIPTION
12-03-10	ISSUE FOR PLEBUT
03-04-17	REMOVED PER COUNTRY COMPLAINT

**ES AT SIENNA
ANTATION**
STATE HIGHWAY 6 AT KITTY
LOW PARK DRIVE
JURY CITY, TX 77459

**HOPPE'S AT SIENNA
PLANTATION**
9 & 9303 STATE HIGHWAY 6 AT KITTY
HOLLOW PARK DRIVE
MISSOURI CITY, TX 77459

FC	TOP OF CURB
TP	TOP OF PAVEMENT
TW	TOP OF WALL
ME	MATCH EXISTING
EG	EXISTING GRADE

APPROVED: Mary D. [Signature]
 Director of Commitment
 DATE: 5/8/17

SHEET NUMBER: C8

SHEET TITLE: GRADING PLAN
2 OF 2

DESIGN BY: V.M.	CHECK BY: JSA
--------------------	------------------

G-PA PROJECT NUMBER: 016-08-003

DO NOT USE FOR PUBLICATION AND SEAL CONTAINS NO INFORMATION THAT MAY BE USED IN ANY MANNER FOR THE PURPOSES OF THIS AGENCY, INCLUDING AND EXCEPTED FROM ANY OTHER INFORMATION OR DATA FOR ANY OTHER PURPOSE.

62-74-37

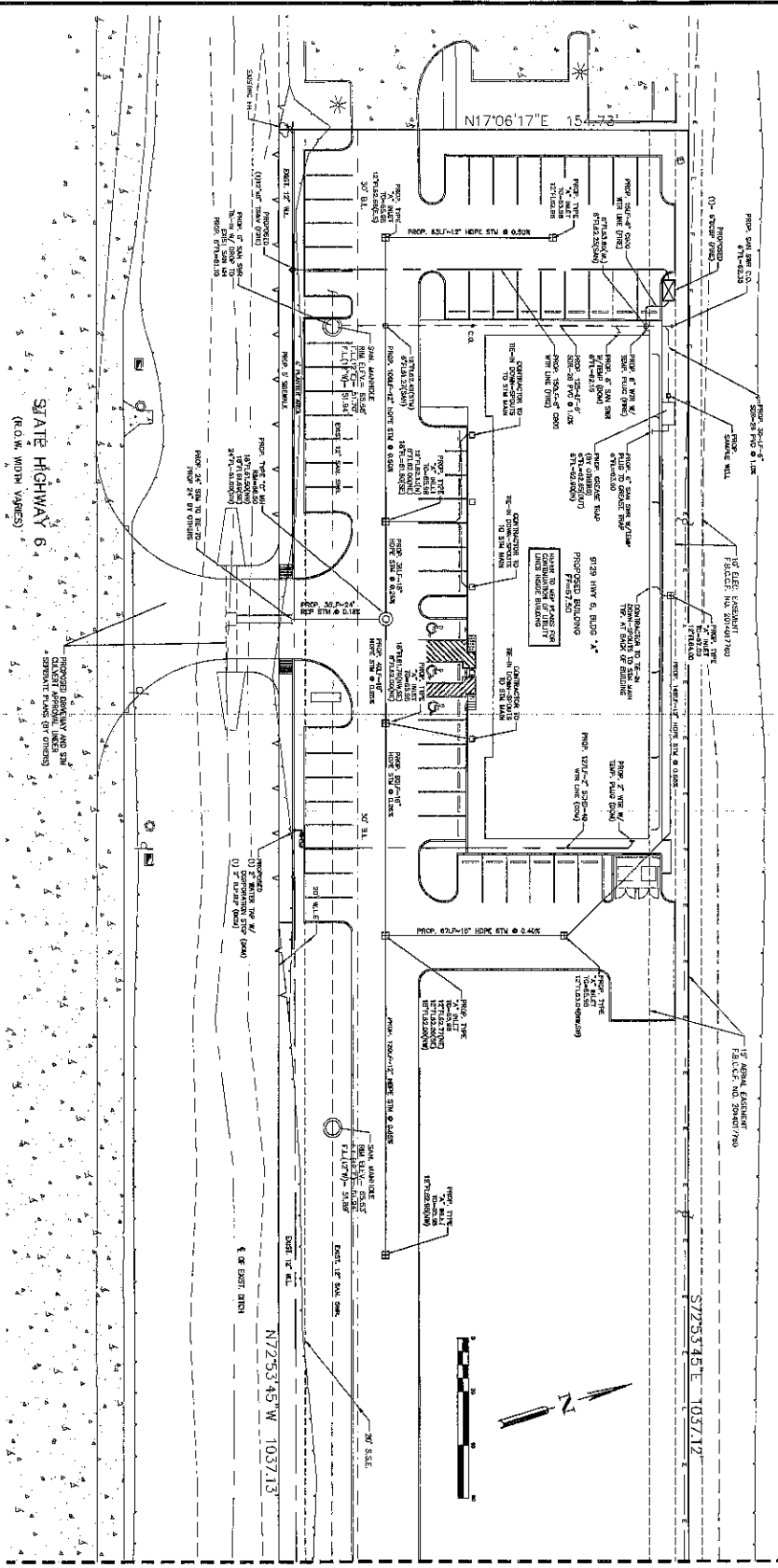

UTILITY NOTES:
 THE CONNECTION TO ANY EXISTING PUBLIC UTILITY SHALL BE MADE AT THE STREET OR AT THE CURB. THE UTILITY SHALL BE LOCATED WITHIN THE DISTRICT'S RIGHT-OF-WAY AND SHALL BE AT THE DISTRICT'S EXPENSE.
 ANY PLACEMENTS TO THE DISTRICT'S FACILITIES SHALL BE AT THE DISTRICT'S EXPENSE.
 THE DISTRICT'S OPERATOR SHALL INSPECT AND APPROVE ALL CONNECTIONS TO THE DISTRICT'S FACILITIES.

EXISTING UTILITIES:
 EXISTING UTILITIES SHOWN ON THIS PLAN ARE BASED ON RECORD DRAWINGS AND FIELD SURVEY. THE DISTRICT'S OPERATOR SHALL VERIFY THE LOCATION AND DEPTH OF ALL EXISTING UTILITIES PRIOR TO CONSTRUCTION.
 EXISTING UTILITIES TO REMAIN SHALL BE SHOWN WITH A THICK LINE. EXISTING UTILITIES TO BE REMOVED SHALL BE SHOWN WITH A DASHED LINE.
 EXISTING UTILITIES TO BE RELOCATED SHALL BE SHOWN WITH A THICK LINE AND A DASHED LINE.
 EXISTING UTILITIES TO BE DELETED SHALL BE SHOWN WITH A THICK LINE AND A DASHED LINE.
 EXISTING UTILITIES TO BE RELOCATED SHALL BE SHOWN WITH A THICK LINE AND A DASHED LINE.
 EXISTING UTILITIES TO BE DELETED SHALL BE SHOWN WITH A THICK LINE AND A DASHED LINE.

SURVEY SYMBOLS:

- 1. SURVEY POINT
- 2. SURVEY LINE
- 3. SURVEY POINT
- 4. SURVEY LINE
- 5. SURVEY POINT
- 6. SURVEY LINE
- 7. SURVEY POINT
- 8. SURVEY LINE
- 9. SURVEY POINT
- 10. SURVEY LINE
- 11. SURVEY POINT
- 12. SURVEY LINE
- 13. SURVEY POINT
- 14. SURVEY LINE
- 15. SURVEY POINT
- 16. SURVEY LINE
- 17. SURVEY POINT
- 18. SURVEY LINE
- 19. SURVEY POINT
- 20. SURVEY LINE
- 21. SURVEY POINT
- 22. SURVEY LINE
- 23. SURVEY POINT
- 24. SURVEY LINE
- 25. SURVEY POINT
- 26. SURVEY LINE
- 27. SURVEY POINT
- 28. SURVEY LINE
- 29. SURVEY POINT
- 30. SURVEY LINE
- 31. SURVEY POINT
- 32. SURVEY LINE
- 33. SURVEY POINT
- 34. SURVEY LINE
- 35. SURVEY POINT
- 36. SURVEY LINE
- 37. SURVEY POINT
- 38. SURVEY LINE
- 39. SURVEY POINT
- 40. SURVEY LINE
- 41. SURVEY POINT
- 42. SURVEY LINE
- 43. SURVEY POINT
- 44. SURVEY LINE
- 45. SURVEY POINT
- 46. SURVEY LINE
- 47. SURVEY POINT
- 48. SURVEY LINE
- 49. SURVEY POINT
- 50. SURVEY LINE
- 51. SURVEY POINT
- 52. SURVEY LINE
- 53. SURVEY POINT
- 54. SURVEY LINE
- 55. SURVEY POINT
- 56. SURVEY LINE
- 57. SURVEY POINT
- 58. SURVEY LINE
- 59. SURVEY POINT
- 60. SURVEY LINE
- 61. SURVEY POINT
- 62. SURVEY LINE
- 63. SURVEY POINT
- 64. SURVEY LINE
- 65. SURVEY POINT
- 66. SURVEY LINE
- 67. SURVEY POINT
- 68. SURVEY LINE
- 69. SURVEY POINT
- 70. SURVEY LINE
- 71. SURVEY POINT
- 72. SURVEY LINE
- 73. SURVEY POINT
- 74. SURVEY LINE
- 75. SURVEY POINT
- 76. SURVEY LINE
- 77. SURVEY POINT
- 78. SURVEY LINE
- 79. SURVEY POINT
- 80. SURVEY LINE
- 81. SURVEY POINT
- 82. SURVEY LINE
- 83. SURVEY POINT
- 84. SURVEY LINE
- 85. SURVEY POINT
- 86. SURVEY LINE
- 87. SURVEY POINT
- 88. SURVEY LINE
- 89. SURVEY POINT
- 90. SURVEY LINE
- 91. SURVEY POINT
- 92. SURVEY LINE
- 93. SURVEY POINT
- 94. SURVEY LINE
- 95. SURVEY POINT
- 96. SURVEY LINE
- 97. SURVEY POINT
- 98. SURVEY LINE
- 99. SURVEY POINT
- 100. SURVEY LINE

SURVEY LEGEND:

- 1. SURVEY POINT
- 2. SURVEY LINE
- 3. SURVEY POINT
- 4. SURVEY LINE
- 5. SURVEY POINT
- 6. SURVEY LINE
- 7. SURVEY POINT
- 8. SURVEY LINE
- 9. SURVEY POINT
- 10. SURVEY LINE
- 11. SURVEY POINT
- 12. SURVEY LINE
- 13. SURVEY POINT
- 14. SURVEY LINE
- 15. SURVEY POINT
- 16. SURVEY LINE
- 17. SURVEY POINT
- 18. SURVEY LINE
- 19. SURVEY POINT
- 20. SURVEY LINE
- 21. SURVEY POINT
- 22. SURVEY LINE
- 23. SURVEY POINT
- 24. SURVEY LINE
- 25. SURVEY POINT
- 26. SURVEY LINE
- 27. SURVEY POINT
- 28. SURVEY LINE
- 29. SURVEY POINT
- 30. SURVEY LINE
- 31. SURVEY POINT
- 32. SURVEY LINE
- 33. SURVEY POINT
- 34. SURVEY LINE
- 35. SURVEY POINT
- 36. SURVEY LINE
- 37. SURVEY POINT
- 38. SURVEY LINE
- 39. SURVEY POINT
- 40. SURVEY LINE
- 41. SURVEY POINT
- 42. SURVEY LINE
- 43. SURVEY POINT
- 44. SURVEY LINE
- 45. SURVEY POINT
- 46. SURVEY LINE
- 47. SURVEY POINT
- 48. SURVEY LINE
- 49. SURVEY POINT
- 50. SURVEY LINE
- 51. SURVEY POINT
- 52. SURVEY LINE
- 53. SURVEY POINT
- 54. SURVEY LINE
- 55. SURVEY POINT
- 56. SURVEY LINE
- 57. SURVEY POINT
- 58. SURVEY LINE
- 59. SURVEY POINT
- 60. SURVEY LINE
- 61. SURVEY POINT
- 62. SURVEY LINE
- 63. SURVEY POINT
- 64. SURVEY LINE
- 65. SURVEY POINT
- 66. SURVEY LINE
- 67. SURVEY POINT
- 68. SURVEY LINE
- 69. SURVEY POINT
- 70. SURVEY LINE
- 71. SURVEY POINT
- 72. SURVEY LINE
- 73. SURVEY POINT
- 74. SURVEY LINE
- 75. SURVEY POINT
- 76. SURVEY LINE
- 77. SURVEY POINT
- 78. SURVEY LINE
- 79. SURVEY POINT
- 80. SURVEY LINE
- 81. SURVEY POINT
- 82. SURVEY LINE
- 83. SURVEY POINT
- 84. SURVEY LINE
- 85. SURVEY POINT
- 86. SURVEY LINE
- 87. SURVEY POINT
- 88. SURVEY LINE
- 89. SURVEY POINT
- 90. SURVEY LINE
- 91. SURVEY POINT
- 92. SURVEY LINE
- 93. SURVEY POINT
- 94. SURVEY LINE
- 95. SURVEY POINT
- 96. SURVEY LINE
- 97. SURVEY POINT
- 98. SURVEY LINE
- 99. SURVEY POINT
- 100. SURVEY LINE

PROPOSED LEGEND:

- 1. WATER LINE
- 2. SANITARY SINKER LINE
- 3. SANITARY SINKER CLEAN OUT
- 4. BACKFLOW PREVENTER
- 5. WATER METER
- 6. WATER LINE VALVE
- 7. WATER LINE TEE CONNECTION
- 8. WATER LINE ELBOW CONNECTION
- 9. UTILITY LINE PLUG

THE CONTRACTOR SHALL BE RESPONSIBLE FOR THE LOCATION AND DEPTH OF ALL EXISTING UTILITIES PRIOR TO CONSTRUCTION. THE CONTRACTOR SHALL BE RESPONSIBLE FOR THE LOCATION AND DEPTH OF ALL EXISTING UTILITIES PRIOR TO CONSTRUCTION. THE CONTRACTOR SHALL BE RESPONSIBLE FOR THE LOCATION AND DEPTH OF ALL EXISTING UTILITIES PRIOR TO CONSTRUCTION.

ONE-CALL NOTIFICATION SYSTEM
 CALL BEFORE YOU DIG!
 (800) 485-5844
 (800) 485-5844
 (800) 485-5844

PROJECT NAME:
 SHEET NUMBER:
 SHEET TITLE:
 SHEET NUMBER:
 SHEET TITLE:

SHOPPES AT SIENNA PLANTATION
 9129 & 9303 STATE HIGHWAY 6 AT KITTY HOLLOW PARK DRIVE
 MISSOURI CITY, TX 77459

DATE:
 DRAWN BY:
 CHECKED BY:
 APPROVED BY:

16935 Boulevard Oaks Ct.
 Houston, Texas 77063
 Tel: (281) 291-4624
 Mobile: (832) 671-5469



Qual Valley Builders, Inc.
 1306 Dwy 1002, Suite 201
 Missouri City, Texas 77054
 Tel: (281) 291-4624
 Fax: (281) 291-4624

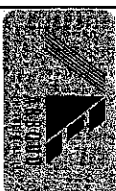

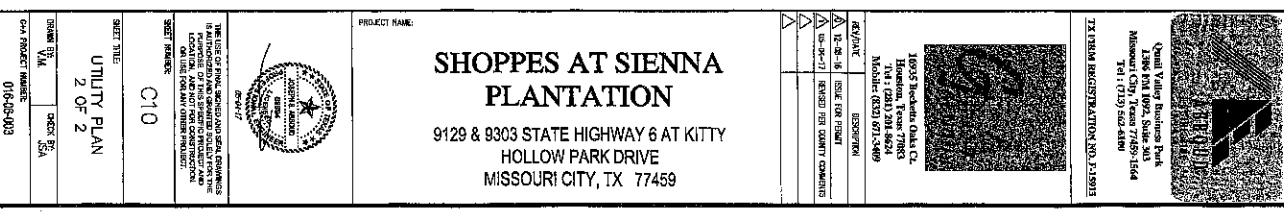

SHEET TITLE:
 SHEET NUMBER:
 SHEET TITLE:
 SHEET NUMBER:

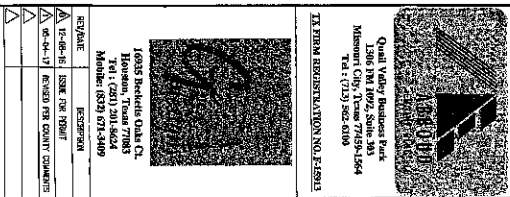



[illegible][illegible]

LEGEND :

 100 YR. SHEET FLOW

 2 YR. SHEET FLOW

 PROPOSED DRAINAGE

 AREA #

[illegible]

**SHOPPES AT SIENNA
PLANTATION**
9129 & 9303 STATE HIGHWAY 6 AT KITTY
HOLLOW PARK DRIVE
MISSOURI CITY, TX 77459

THE USE OF FINISH GRADED AND SEAL CHANNELS
IS AUTHORIZED AND ORIGINATED HEREIN FOR THE
LOCATION AND NOT FOR CONSTRUCTION
ON THE PART OF ANY OTHER PRODUCT.

SHEET NUMBER:
C11

SHEET TITLE:
DRAINAGE AREA
PLAN

DRAWN BY:
J.M.

CHECK BY:
J.S.A.

0344 PROJECT NUMBER:
016-65-0092

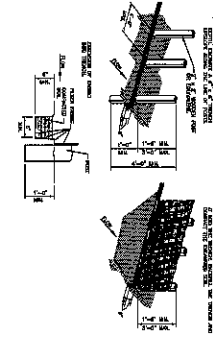
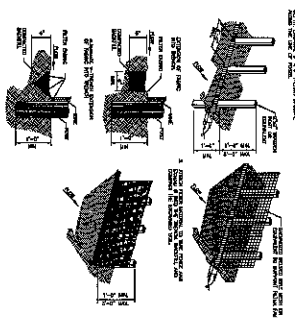
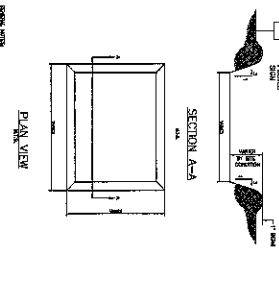
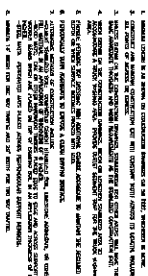
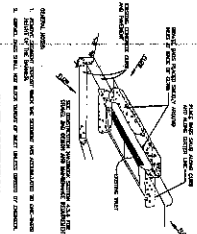
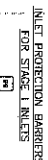
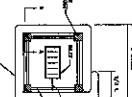
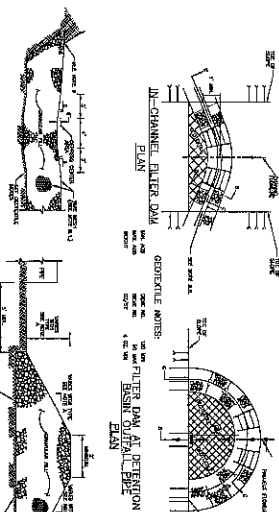
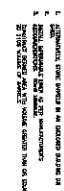
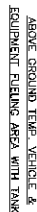

NOTE:
Special Dining Menus are expected to be served in most restaurants, hotels and resorts with limited outdoor food/beverage service in public or semi-private areas.

Quant Valley Business Park
1316 FM 1092, Suite 303
Missouri City, Texas 77459-1566
Tel : (713) 562-6108

Quinn Valley Business Park
1306 FM 1092, Suite 300
Missouri City, Texas 77459
Tel : (713) 562-6104

1-800-875-6636

10735 ROCKWELL CIRCLE
HOUSTON, TEXAS 77036
TEL: (281) 291-8624
MOBILE: (832) 671-3400

REV/DATE	DESCRIPTION
05-12-08-16	ISSUE FOR PERMIT
05-04-17	REMOVED PER COUNTY COMMENTS

**SHOPPES AT SIENNA
PLANTATION**
9129 & 9303 STATE HIGHWAY 6 AT KITT
HOLLOW PARK DRIVE
MISSOURI CITY, TX 77459

9129 & 9303 STATE HIGHWAY 6 AT KITT
HOLLOW PARK DRIVE
MISSOURI CITY, TX 77459

THE USE OF FINAL SPECIFICATIONS AND SERIAL DRAWINGS IS AUTHORIZED AND GRANTED SOLELY FOR THE PURPOSE OF THIS SPECIFIC PROJECT AND LOCATION, AND NOT FOR CONSTRUCTION OR USE FOR ANY OTHER PROJECT.

SHEET NUMBER: 013

C13

STORM WATER
POLLUTION
PREVENTION DETAILS

C&A PROJECT NUMBER:
018-08-0

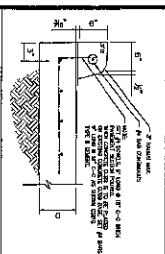

CONCRETE CURB
SCALE: 1/4" = 1'-0"

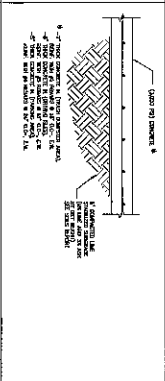

CONCRETE PAVING
SCALE: 1/4" = 1'-0"

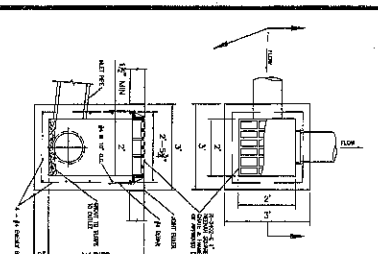

EXPANSION CONSTRUCTION JOINT
SCALE: 1/4" = 1'-0"

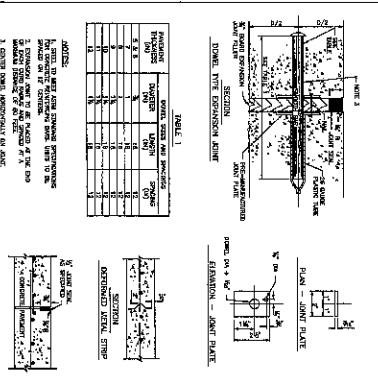

CONCRETE PAVEMENT & CURB DETAIL
SCALE: 1/4" = 1'-0"

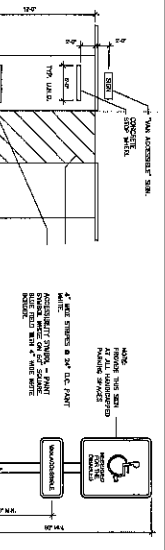

ACCESSIBLE PARKING DETAIL
SCALE: 1/4" = 1'-0"

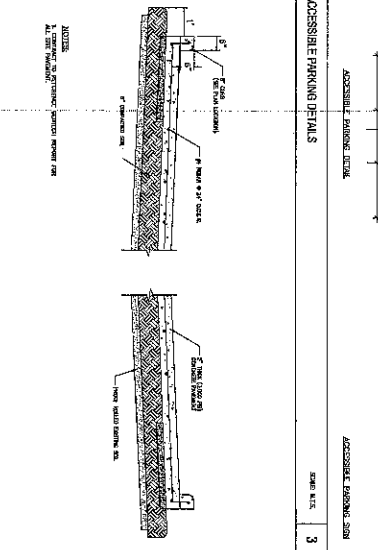

DOUBLE CHECK BACKFLOW PREVENTER - FRIE
SCALE: 1/4" = 1'-0"

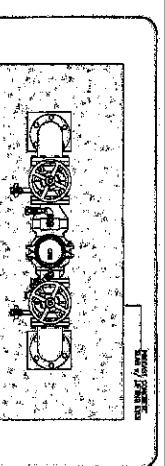

STANDARD INLET
SCALE: 1/4" = 1'-0"

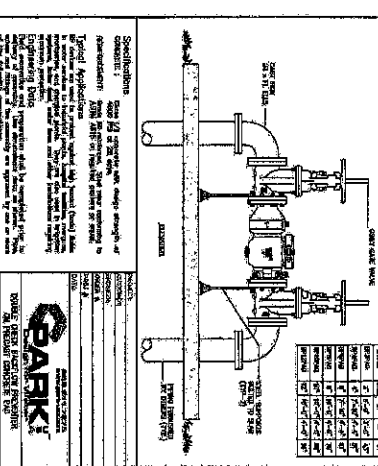

EXPANSION CONSTRUCTION JOINT
SCALE: 1/4" = 1'-0"

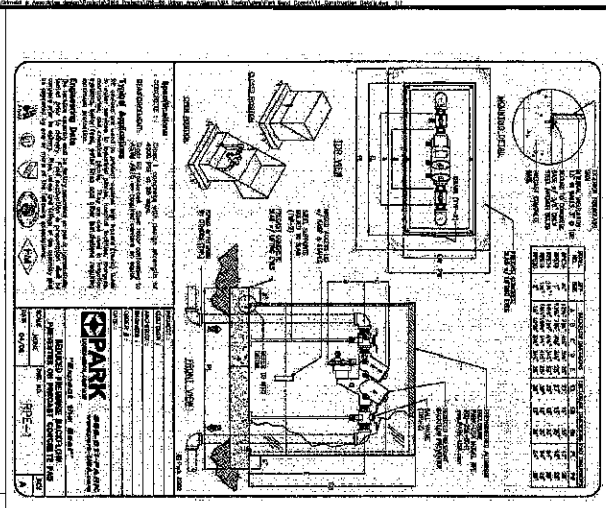

STONE RETAINING WALL
SCALE: 1/4" = 1'-0"

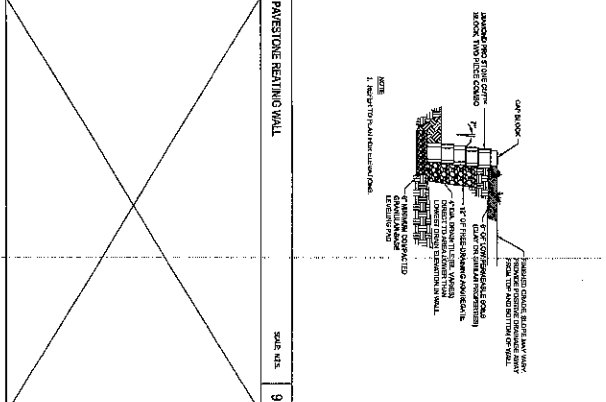

STONE RETAINING WALL
SCALE: 1/4" = 1'-0"

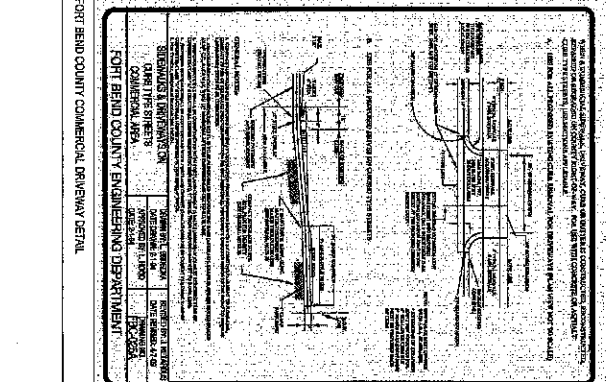

STONE RETAINING WALL
SCALE: 1/4" = 1'-0"

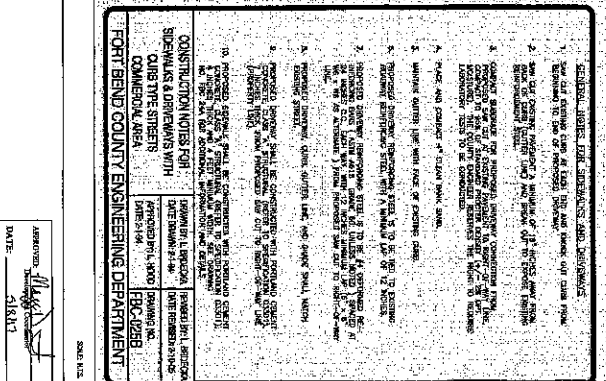

STONE RETAINING WALL
SCALE: 1/4" = 1'-0"

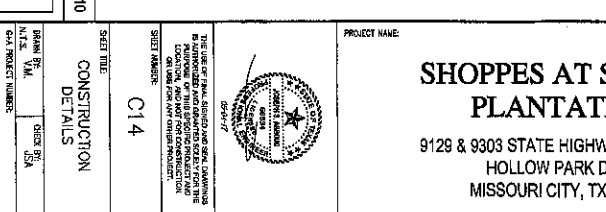

STONE RETAINING WALL
SCALE: 1/4" = 1'-0"

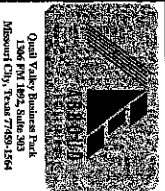

SHoppes at SIENNA PLANTATION
9128 & 9303 STATE HIGHWAY 6 AT KITTY
HOLLOW PARK DRIVE
MISSOURI CITY, TX 77459

16925 Westchase Oaks Dr.
Houston, Texas 77063
Tel: (281) 261-5624
Mobile: (832) 671-5669

TX FIRM REGISTRATION NO. E15933

Quail Valley Builders Park
1306 FM 1802, Suite 203
Houston, TX 77058-1504
Tel: (713) 565-4400

DATE: 01-08-03

PROJECT NUMBER: 016-08-03

DESIGNER: [Signature]

CHECKED BY: [Signature]

SCALE: 1/4" = 1'-0"

PROJECT NAME: SHoppes at SIENNA PLANTATION

CONSTRUCTION DETAILS

10

SANITARY SEWER MANHOLE LID

N.T.S.

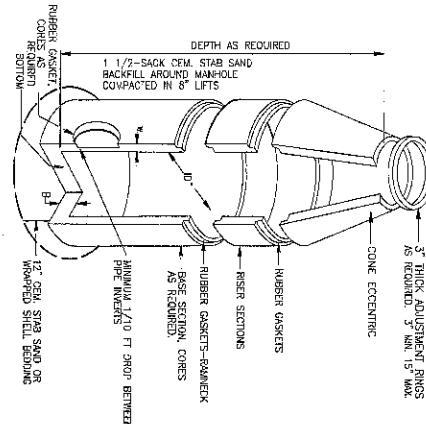
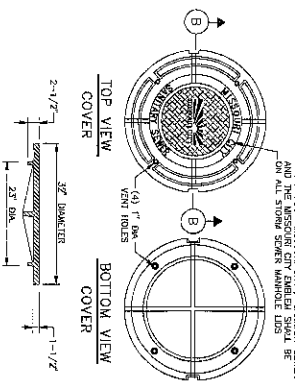

- NOTES**
1. LIFTING INSERTS AS REQUIRED.
 2. ALL JOINTS SHALL BE SEALED WITH APPROVED RUBBER GASKET/RUBBEREX ON 12\"/>
 - 3. ON 12\"/>
 - 4. C.S.S. SHALL BE BROUGHT TO WITHIN 2'-FT OF TOP OF PRECAST LID.
 - 5. PRECAST LID SHALL BE IN COMPLIANCE WITH APPROVED PRODUCT LIST.
 - 6. APPROVED LIFTING SHALL BE IN COMPLIANCE WITH APPROVED PRODUCT LIST.
 - 7. INVERTS SHALL COMPLY WITH C.O.M.C. INFRASTRUCTURE DESIGN MANUAL SPECIFICATIONS.
 - 8. REFER TO SANITARY MANHOLE LIDS, C.S.S. NOTES, 10. PRIOR TO LIFTING LIDS, GROUT ALL JOINTS TO A SMOOTH SURFACE.
 - 11. WACOM TESTING OF MANHOLE SHALL BE AFTER GROUTING PRECAST SANITARY MANHOLE.

N.T.S.

STANDARD DROP DETAIL

(SEE C.S.S. NOTES)

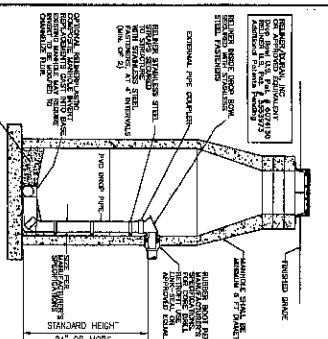

PIPING CONNECTIONS

DETAIL

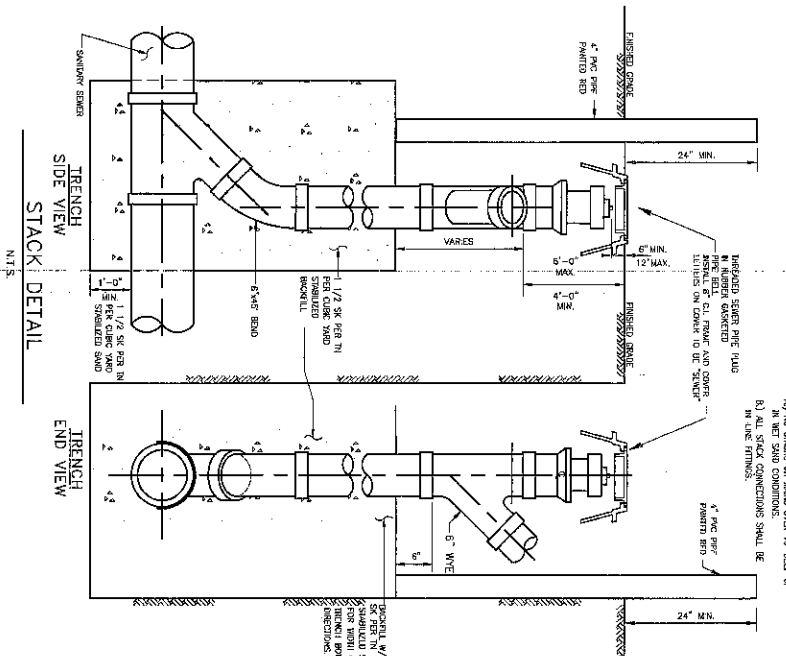
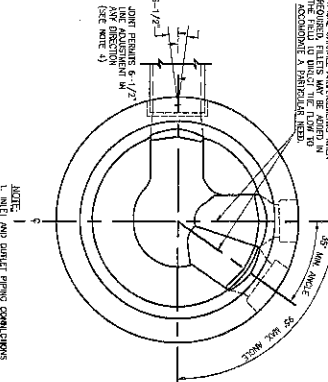

N.T.S.

N.T.S.

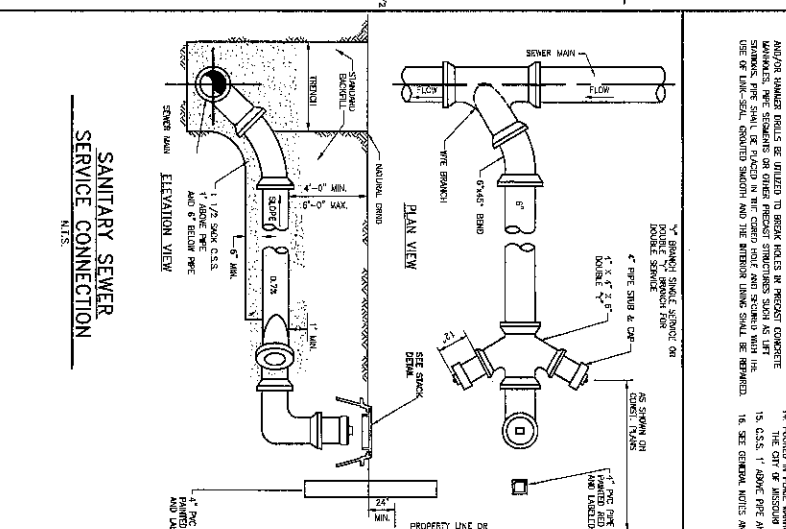

N.T.S.

MISSOURI CITY
TEXAS

CONSTRUCTION PLANS FOR:

SHOPS AT SIENNA
PLANTATION

C15

DATE: 08/25/2015

PROJECT: 11-07-20

MC-10-15

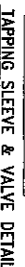
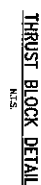
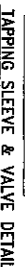
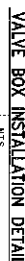
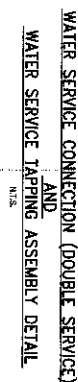
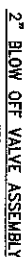
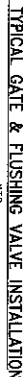

BENDS, TEES & PLUGS
FOR PIPE OF VARIOUS SIZES

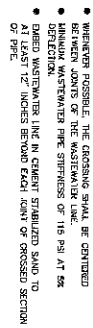

MISSOURI CITY
TEXAS

[illegible][illegible]

The diagram illustrates a vertical waterline section with the following components and dimensions:

- NEW MEASURING POINT**: Located at the top of the section.
- WATERMETER LINE**: The main vertical pipe.
- JOINT TO BE RESEALANT**: Indicated at the top and bottom of the section.
- FIELD RESTRAINT FIELD APPROVED TUNING**: Located on the right side of the pipe.
- BENDING ELBOW**: A 90-degree bend in the pipe.
- FIELD RESTRAINT FIELD APPROVED TUNING**: Located on the left side of the pipe.
- NEW VERTICAL WATERLINE SECTION**: The overall section being installed.
- 9'-0" MIN.**: Dimension for the top section.
- 9'-0" MIN.**: Dimension for the bottom section.
- 2'-0" MIN. (MINIMUM)**: Dimension for the middle section.
- NEW MEASURING POINT**: Located at the bottom of the section.

- NEW WASTELINE (WITHOUT CASING) TO BE CONSTRUCTED DUCTILE IRON WITH MECHANICAL JOINTS OR RESTRAINED JOINTS
- BOTH WASTELINE AND WASTEWATER LINE MUST PASS A PRESSURE AND LEAKAGE TEST AS SPECIFIED IN AWWA C600 STANDARDS

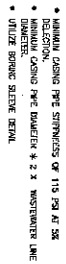

NEW POTABLE WATERLINE CROSSING NEW PRESSURE
RATED WASTEWATER LINE WITH SEGMENT LENGTHS OF
OF LESS THAN EIGHTEEN (18) FEET

CARRIER PIPE	INTERNAL CASSING ID	MIN. WALL THICKNESS (IN.)
6"	12"	0.11
8"	14"	0.15
10"	16"	0.18
12"	18"	0.20

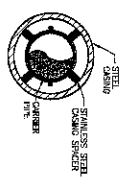

Diagram illustrating the dimensions of the new positive airway line:

- 9-FOOT MAIN SECTION
- 6-INCH ELBOW SECTION
- 6-INCH CLEARANCE FROM BOTTOMING SLEEVE
- NEW POSITIVE AIRWAY LINE
- BOTTOMING SLEEVE
- FEET BORING DETAIL

- SAME ENGAGEMENT CRITERIA AS "ALTERNATIVE B" OR NEW WATERLINE (WITHOUT CASING) TO BE CONSTRUCTED
- DUCTILE IRON WITH MECHANICAL JOINTS OR RETAINED JOINTS
- BOTH WATERLINE AND WASTEWATER LINE MUST PASS A PRESSURE AND LEAKAGE TEST AS SPECIFIED IN ANNA 0600 STANDARDS.

1. CASING SIZE AND THICKNESS SHALL CONFORM TO THE MINIMUM REQUIREMENTS AS SHOWN ON CASING SCHEDULE. OTHER FINISHES ARE REQUIRED.
2. MINIMUM 1" MINIMUM CLEARANCE BETWEEN THE MAXIMUM OUTSIDE DIAMETER OF CASING PIPE AND CASING AT ALL LOCATIONS.
3. DIMENSIONS ARE APPROPRIATE ONLY CONTRACTOR SHALL INSTALL NEGATIVELY SIZED CASING TO ACCOMMODATE THE CASING PIPE AND SPACER.
4. IF JOINTS ARE REQUIRED IN THE BORING SLICING THEN THE PAPER SHALL BE JOINT REWORKED.

- STANDARD NOTES:**
1. CONTRACTOR SHALL CONTACT CITY OF MEMPHIS FOR DETERMINATION OF "TIEUP WAYS" AT (701) 454-0470. IF TIEUP WAY OR OTHER OBSTACLE, SUCH CONDITIONS, WHEN TIEUP TIES ARE IDENTIFIED, DISCOVERED OR OBSERVED, ARE IDENTIFIED.
 2. SHOULD A CONTACT BE MADE REGARDING REPAIRS AND/OR APPROPRIATE CONSTRUCTION PERMITS AND INFORMATION INCLUDED IN PROJECT SPECIFICATIONS, CITY OF MEMPHIS CITY OF MEMPHIS CITY OF MEMPHIS CITY OF MEMPHIS SHALL COMPLY.
 3. ALL TIEUP WAYS MUST BE USED AND REMOVED WITHIN THE SPECIFIED TIME FRAME. TIEUP WAYS SHALL BE REMOVED IN CONTACTED TIEUP WAYS AND A MINIMUM OF 10 FEET FROM THE TIEUP WAYS.
 4. ALL TIEUP WAYS SHALL BE REMOVED WITHIN THE SPECIFIED TIME FRAME. TIEUP WAYS SHALL BE REMOVED IN CONTACTED TIEUP WAYS AND A MINIMUM OF 10 FEET FROM THE TIEUP WAYS.
 5. TIEUP WAYS SHALL BE REMOVED WITHIN THE SPECIFIED TIME FRAME. TIEUP WAYS SHALL BE REMOVED IN CONTACTED TIEUP WAYS AND A MINIMUM OF 10 FEET FROM THE TIEUP WAYS.
 6. WHERE EXISTING STEERING (BARRICADE) OR TIEUP WAYS ARE USED, TIEUP WAYS SHALL BE REMOVED WITHIN THE SPECIFIED TIME FRAME. TIEUP WAYS SHALL BE REMOVED IN CONTACTED TIEUP WAYS AND A MINIMUM OF 10 FEET FROM THE TIEUP WAYS.
 7. ALL TIEUP WAYS SHALL BE REMOVED WITHIN THE SPECIFIED TIME FRAME. TIEUP WAYS SHALL BE REMOVED IN CONTACTED TIEUP WAYS AND A MINIMUM OF 10 FEET FROM THE TIEUP WAYS.
 8. ALL TIEUP WAYS SHALL BE REMOVED WITHIN THE SPECIFIED TIME FRAME. TIEUP WAYS SHALL BE REMOVED IN CONTACTED TIEUP WAYS AND A MINIMUM OF 10 FEET FROM THE TIEUP WAYS.
 9. ALL TIEUP WAYS SHALL BE REMOVED WITHIN THE SPECIFIED TIME FRAME. TIEUP WAYS SHALL BE REMOVED IN CONTACTED TIEUP WAYS AND A MINIMUM OF 10 FEET FROM THE TIEUP WAYS.
 10. ALL TIEUP WAYS SHALL BE REMOVED WITHIN THE SPECIFIED TIME FRAME. TIEUP WAYS SHALL BE REMOVED IN CONTACTED TIEUP WAYS AND A MINIMUM OF 10 FEET FROM THE TIEUP WAYS.
 11. ALL TIEUP WAYS SHALL BE REMOVED WITHIN THE SPECIFIED TIME FRAME. TIEUP WAYS SHALL BE REMOVED IN CONTACTED TIEUP WAYS AND A MINIMUM OF 10 FEET FROM THE TIEUP WAYS.
 12. WHERE EXISTING STEERING (BARRICADE) OR TIEUP WAYS ARE USED, TIEUP WAYS SHALL BE REMOVED WITHIN THE SPECIFIED TIME FRAME. TIEUP WAYS SHALL BE REMOVED IN CONTACTED TIEUP WAYS AND A MINIMUM OF 10 FEET FROM THE TIEUP WAYS.
 13. IN NO SITUATION SHALL THE TIEUP WAYS BE REMOVED WITHIN 10 FEET OF A TIEUP WAYS SIGN.
 14. WHEN SIGNIFICATION DISTANCES ARE IDENTIFIED, THE TIEUP WAYS SHALL BE REMOVED WITHIN 10 FEET OF A TIEUP WAYS SIGN.
 15. TIEUP WAYS SHALL BE REMOVED WITHIN 10 FEET OF A TIEUP WAYS SIGN.



CONSTRUCTION PLANS FOR:
SHOPPES AT SIENNA
PLANTATION

C17

MC-12-15



MODIFIED
A

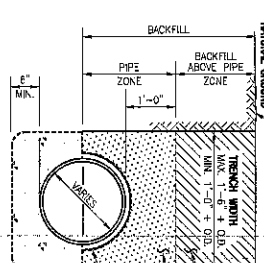

SANITARY FORCE MAIN & WATER LINE
BEDDING AND BACKFILL

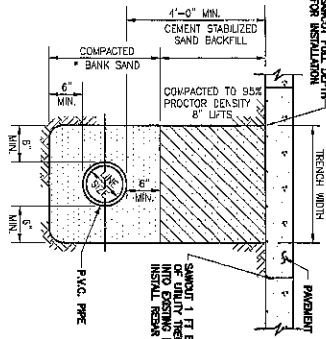

* SEE C.S.S. AND BANK SAND NOTES



OF
SUB

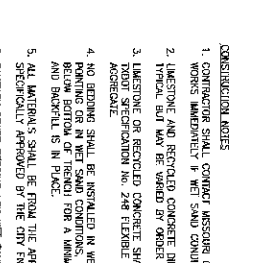

JOINT RESIN/IN FOR DUCTILE IRON PIPE AND
POLYETHYLENE WRAPPED DUCTILE IRON WATER PIPES

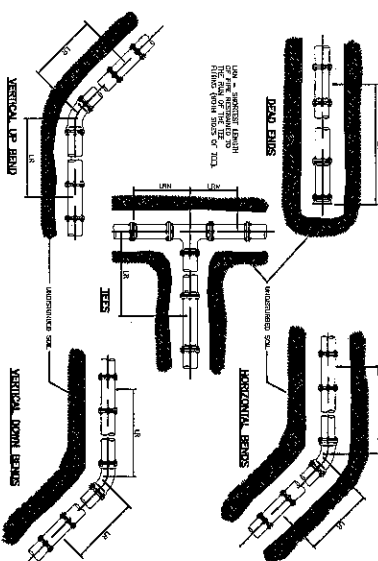

MEASUREMENTS PIPE SIZE	RESTRAINED LENGTHS, IN. FOR DUCTILE IRON PIPE									
	HORIZONTAL BENDS					VERTICAL OFFSETS				
	125°	90°	75°	60°	45°	90°	45°	30°	15°	0°
MINIMUM	10	12	15	18	22	12	10	8	6	4
MAXIMUM	15	18	22	27	33	18	15	12	9	6
MINIMUM	10	12	15	18	22	12	10	8	6	4
MAXIMUM	15	18	22	27	33	18	15	12	9	6
MINIMUM	10	12	15	18	22	12	10	8	6	4
MAXIMUM	15	18	22	27	33	18	15	12	9	6
MINIMUM	10	12	15	18	22	12	10	8	6	4
MAXIMUM	15	18	22	27	33	18	15	12	9	6
MINIMUM	10	12	15	18	22	12	10	8	6	4
MAXIMUM	15	18	22	27	33	18	15	12	9	6
MINIMUM	10	12	15	18	22	12	10	8	6	4
MAXIMUM	15	18	22	27	33	18	15	12	9	6
MINIMUM	10	12	15	18	22	12	10	8	6	4
MAXIMUM	15	18	22	27	33	18	15	12	9	6
MINIMUM	10	12	15	18	22	12	10	8	6	4
MAXIMUM	15	18	22	27	33	18	15	12	9	6
MINIMUM	10	12	15	18	22	12	10	8	6	4
MAXIMUM	15	18	22	27	33	18	15	12	9	6
MINIMUM	10	12	15	18	22	12	10	8	6	4
MAXIMUM	15	18	22	27	33	18	15	12	9	6
MINIMUM	10	12	15	18	22	12	10	8	6	4
MAXIMUM	15	18	22	27	33	18	15	12	9	6
MINIMUM	10	12	15	18	22	12	10	8	6	4
MAXIMUM	15	18	22	27	33	18	15	12	9	6
MINIMUM	10	12	15	18	22	12	10	8	6	4
MAXIMUM	15	18	22	27	33	18	15	12	9	6
MINIMUM	10	12	15	18	22	12	10	8	6	4
MAXIMUM	15	18	22	27	33	18	15	12	9	6
MINIMUM	10	12	15	18	22	12	10	8	6	4
MAXIMUM	15	18	22	27	33	18	15	12	9	6
MINIMUM	10	12	15	18	22	12	10	8	6	4
MAXIMUM	15	18	22	27	33	18	15	12	9	6
MINIMUM	10	12	15	18	22	12	10	8	6	4
MAXIMUM	15	18	22	27	33	18	15	12	9	6
MINIMUM	10	12	15	18	22	12	10	8	6	4
MAXIMUM	15	18	22	27	33	18	15	12	9	6
MINIMUM	10	12	15	18	22	12	10	8	6	4
MAXIMUM	15	18	22	27	33	18	15	12	9	6
MINIMUM	10	12	15	18	22	12	10	8	6	4
MAXIMUM	15	18	22	27	33	18	15	12	9	6
MINIMUM	10	12	15	18	22	12	10	8	6	4
MAXIMUM	15	18	22	27	33	18	15	12	9	6
MINIMUM	10	12	15	18	22	12	10	8	6	4
MAXIMUM	15	18	22	27	33	18	15	12	9	6
MINIMUM	10	12	15	18	22	12	10	8	6	4
MAXIMUM	15	18	22	27	33	18	15	12	9	6
MINIMUM	10	12	15	18	22	12	10	8	6	4
MAXIMUM	15	18	22	27	33	18	15	12	9	6
MINIMUM	10	12	15	18	22	12	10	8	6	4
MAXIMUM	15	18	22	27	33	18	15	12	9	6
MINIMUM	10	12	15	18	22	12	10	8	6	4
MAXIMUM	15	18	22	27	33	18	15	12	9	6
MINIMUM	10	12	15	18	22	12	10	8	6	4
MAXIMUM	15	18	22	27	33	18	15	12	9	6
MINIMUM	10	12	15	18	22	12	10	8	6	4
MAXIMUM	15	18	22	27	33	18	15	12	9	6
MINIMUM	10	12	15	18	22	12	10	8	6	4
MAXIMUM	15	18	22	27	33	18	15	12	9	6
MINIMUM	10	12	15	18	22	12	10	8	6	4
MAXIMUM	15	18	22	27	33	18	15	12	9	6
MINIMUM	10	12	15	18	22	12	10	8	6	4
MAXIMUM	15	18	22	27	33	18	15	12	9	6
MINIMUM	10	12	15	18	22	12	10	8	6	4
MAXIMUM	15	18	22	27	33	18	15	12	9	6
MINIMUM	10	12	15	18	22	12	10	8	6	4
MAXIMUM	15	18	22	27	33	18	15	12	9	6
MINIMUM	10	12	15	18	22	12	10	8	6	4
MAXIMUM	15	18	22	27	33	18	15	12	9	6
MINIMUM	10	12	15	18	22	12	10	8	6	4
MAXIMUM	15	18	22	27	33	18	15	12	9	6
MINIMUM	10	12	15	18	22	12	10	8	6	4
MAXIMUM	15	18	22	27	33	18	15	12	9	6
MINIMUM	10	12	15	18	22	12	10	8	6	4
MAXIMUM	15	18	22	27	33	18	15	12	9	6
MINIMUM	10	12	15	18	22	12	10	8	6	4
MAXIMUM	15	18	22	27	33	18	15	12	9	6
MINIMUM	10	12	15	18	22	12	10	8	6	4
MAXIMUM	15	18	22	27	33	18	15	12	9	6
MINIMUM	10	12	15	18	22	12	10	8	6	4
MAXIMUM	15	18	22	27	33	18	15	12	9	6
MINIMUM	10	12	15	18	22	12	10	8	6	4
MAXIMUM	15	18	22	27	33	18	15	12	9	6
MINIMUM	10	12	15	18	22	12	10	8	6	4
MAXIMUM	15	18	22	27	33	18	15	12	9	6
MINIMUM	10	12	15	18	22	12	10	8	6	4
MAXIMUM	15	18	22	27	33	18	15	12	9	6
MINIMUM	10	12	15	18	22	12	10	8	6	4
MAXIMUM	15	18	22	27	33	18	15	12	9	6
MINIMUM	10	12	15	18	22	12	10	8	6	4
MAXIMUM	15	18	22	27	33	18	15	12	9	6
MINIMUM	10	12	15	18	22	12	10	8	6	4
MAXIMUM	15	18	22	27	33	18	15	12	9	6
MINIMUM	10	12	15	18	22	12	10	8	6	4
MAXIMUM	15	18	22	27	33	18	15	12	9	6
MINIMUM	10	12	15	18	22	12	10	8	6	4
MAXIMUM	15	18	22	27	33	18	15	12	9	6
MINIMUM	10	12	15	18	22	12	10	8	6	4
MAXIMUM	15	18	22	27	33	18	15	12	9	6
MINIMUM	10	12	15	18	22	12	10	8	6	4
MAXIMUM	15	18	22	27	33	18	15	12	9	6
MINIMUM	10	12	15	18	22	12	10	8	6	4
MAXIMUM	15	18	22	27	33	18	15	12	9	6
MINIMUM	10	12	15	18	22	12	10	8	6	4
MAXIMUM	15	18	22	27	33	18	15	12	9	6
MINIMUM	10	12	15	18	22	12	10	8	6	4
MAXIMUM	15	18	22	27	33	18	15	12	9	6
MINIMUM	10	12	15	18	22	12	10	8	6	4
MAXIMUM	15	18	22	27	33	18	15	12	9	6
MINIMUM	10	12	15	18	22	12	10	8	6	4
MAXIMUM	15	18	22	27	33	18	15	12	9	6
MINIMUM	10	12	15	18	22	12	10	8	6	4
MAXIMUM	15	18	22	27	33	18	15	12	9	6
MINIMUM	10	12	15	18	22	12	10	8	6	4
MAXIMUM	15	18	22	27	33	18	15	12	9	6
MINIMUM	10	12	15	18	22	12	10	8	6	4
MAXIMUM	15	18	22	27	33	18	15	12	9	6
MINIMUM	10	12	15	18	22	12	10	8	6	4
MAXIMUM	15	18	22	27	33	18	15	12	9	6
MINIMUM	10	12	15	18	22	12	10	8	6	4
MAXIMUM	15	18	22	27	33	18	15	12	9	6
MINIMUM	10	12	15	18	22	12	10	8	6	4
MAXIMUM	15	18	22	27	33	18	15	12	9	6
MINIMUM	10	12	15	18	22	12	10	8	6	4
MAXIMUM	15	18	22	27	33	18	15	12	9	6
MINIMUM	10	12	15	18	22	12	10	8	6	4
MAXIMUM	15	18	22	27	33	18	15	12	9	6
MINIMUM	10	12	15	18	22	12	10	8	6	4
MAXIMUM	15	18	22	27	33	18	15	12	9	6
MINIMUM	10	12	15	18	22	12	10	8	6	4
MAXIMUM	15	18	22	27	33	18	15	12	9	6
MINIMUM	10	12	15	18	22	12	10	8	6	4
MAXIMUM	15	18	22	27	33	18	15	12	9	6
MINIMUM	10	12	15	18	22	12	10	8	6	4
MAXIMUM	15	18	22	27	33	18	15	12	9	6
MINIMUM	10	12	15	18	22	12	10	8	6	4
MAXIMUM	15	18	22	27	33	18	15	12	9	6
MINIMUM	10	12	15	18	22	12	10	8	6	4
MAXIMUM	15	18	22	27	33	18	15	12	9	6
MINIMUM	10	12	15	18	22	12	10	8	6	4
MAXIMUM	15	18	22	27	33	18	15	12	9	6
MINIMUM	10	12	15	18	22	12	10	8	6	4
MAXIMUM	15	18	22	27	33	18	15	12	9	6
MINIMUM	10	12	15	18	22	12	10	8	6	4
MAXIMUM	15	18	22	27	33	18	15	12	9	6
MINIMUM	10	12	15	18	22	12	10	8	6	4
MAXIMUM	15	18	22	27	33	18	15	12	9	6
MINIMUM	10	12	15	18	22	12	10	8	6	4
MAXIMUM	15	18	22	27	33	18	15	12	9	6
MINIMUM	10	12	15	18	22	12	10	8	6	4
MAXIMUM	15	18	22	27	33	18	15	12	9	6
MINIMUM	10	12	15	18	22	12	10	8	6	4
MAXIMUM	15	18	22	27	33	18	15	12	9	6
MINIMUM	10	12	15	18	22	12	10	8	6	4
MAXIMUM	15	18	22	27	33	18	15	12	9	6
MINIMUM	10	12	15	18	22	12	10	8	6	4
MAXIMUM	15	18	22	27	33	18	15			

THESE ARE MINIMAL LIMITS AND THE DESIGN ENGINEER IS TO VERIFY.
1. THE MAXIMUM TENSILE STRESS SHALL NOT EXCEED 200 PSI
2. THE MAXIMUM TENSILE STRESS SHALL NOT EXCEED 200 PSI
3. INCORPORATED LIGAMENTS MAY BE REDUCED WHEN SUPPORTED BY ENGINEERING CALCULATIONS.
4. FOR PVC WATER LINES USE THE 100 MPPH POLYETHYLENE SHAPE SHALL

CONSTRUCTION NOTES

1. CONTRACTOR SHALL CONTACT MASSDOT CITY DEPARTMENT OF PUBLIC WORKS IMMEDIATELY IF WEI SAND CONDITIONS ARE ENCOUNTERED.
2. LIMESTONE AND RECYCLED CONCRETE DIMENSIONS SHALL BE TYPICAL, BUT MAY BE VARYED BY ORDER OF CITY ENGINEER.
3. LIMESTONE OR RECYCLED CONCRETE SHALL BE IN ACCORDANCE WITH DOT SPECIFICATION NO. 240 FLEXIBLE BASE, TYPE A, GRAVE 2, ASPHALTIC.
4. NO BEDDING SHALL BE INSTALLED IN WEI CONDITIONS WHEN WELL PAVING OR IN WEI SAND CONDITIONS, MEDIUM-GRAIN WATER 1 (GT) PAVING BOTTOM OF TRENCH FOR A MINIMUM OF 24" AFTER BEDDING AND BACKFILL IS IN PLACE.
5. ALL MATERIALS SHALL BE FROM THE APPROVED PRODUCTS LIST UNLESS SPECIFICALLY APPROVED BY THE CITY ENGINEER.
6. SANDING SPREAD BEDDING FOR WEI SAND CONDITIONS SHALL BE AS PER MOVED "A" OR "A-4".
7. ALL SAND BEDDING FOR WATER LINES SHALL BE CLEAN, MECHANICALLY COMPACTED BANK SAND.
8. REPLY TO: MAHARDE DEVALS, SHERMAN, C.S., GENEVA, WATER CROSSING, WATER DISTRIBUTION DEMANDS AND NOTES.

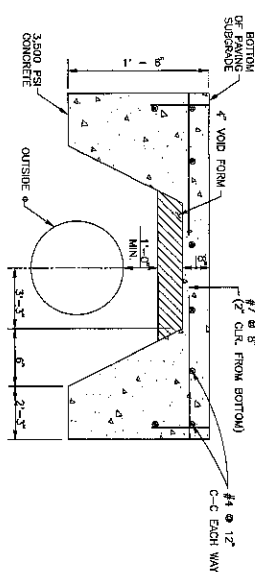

PROTECTIVE SLAB DETAIL.

ZERO LOAD TRANSFER CONCRETE SLAB

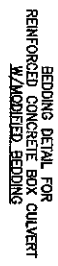
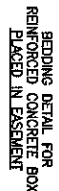
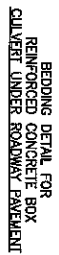
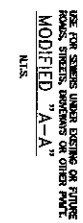
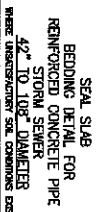
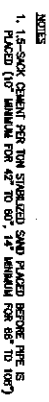
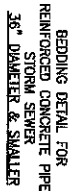

TYPE	1/2" LIFT 1/4" BARS	NO. BARS
42"	5'4"	5
48"	6'8"	6
54"	6'8"	6
60"	8'0"	7
66"	8'0"	7
72"	9'4"	8
78"	9'4"	8
84"	9'4"	8
90"	10'8"	9
96"	10'8"	9
102"	12'0"	10
108"	12'0"	10

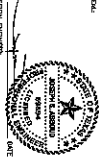
[illegible]

SHOPPES AT SIEN PLANTATION

019

MC-16-15

SCALE: AS NOTED

SUBMITTED: _____

DATE: FEBRUARY 2015

SHEET 17 OF 29

"B-B" INLET (REPLACEMENT ONLY)

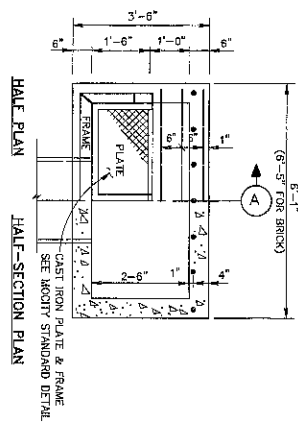

GENERAL NOTES:

- USE STD CAST IRON FRAME & PLATES. LEAD SHALL LEAVE INLET AT LOCATION AND GRADE REQUIRED. SEE DETAIL FOR DOWELS AND BRICK INLETS ARE BUILT INTO BRICKWORK. WHEN BRICK INLETS ARE BUILT, WALLS SHALL BE REINFORCED TO 8 INCHES. AND INLET BEAMS TO BE 4 INCHES LONGER.
- DIMENSION VARIES BASED ON PIPE DIAMETER AND WALL THICKNESS.
- CENTER REINFORCING IN SLAB AND WALLS. CAST INTO WALLS AS SHOWN.

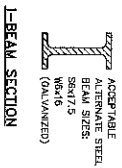
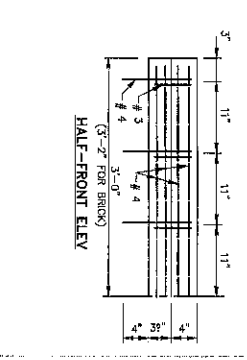
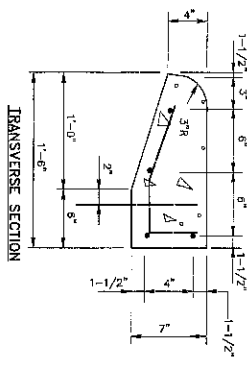
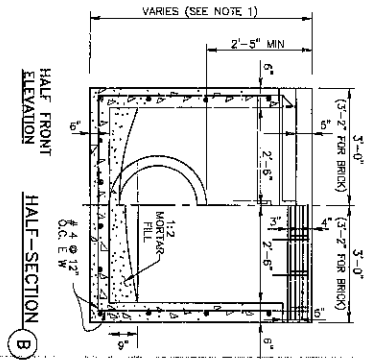
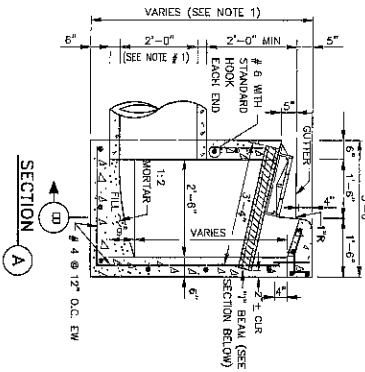

PRECAST CURB BEAM

NO	SIZE	LENGTH	SHAPE	LOC
1	4"	6'-10"	ST	HOR
2	4"	6'-10"	ST	VERT
3	4"	6'-10"	ST	VERT

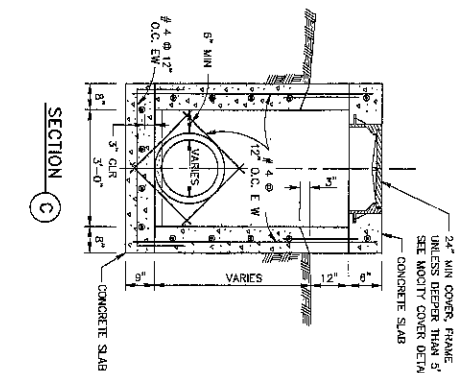
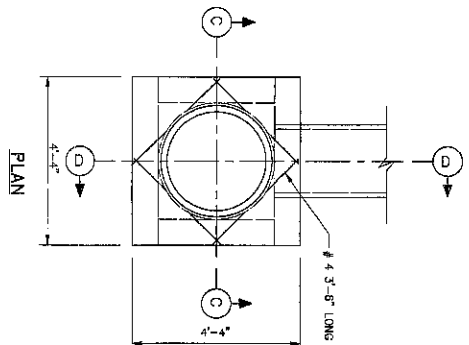

TYPE "E" INLET

N.T.S.

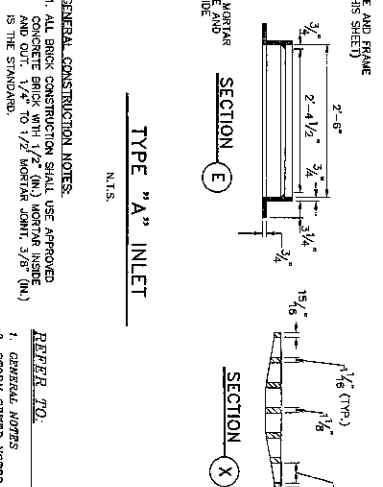
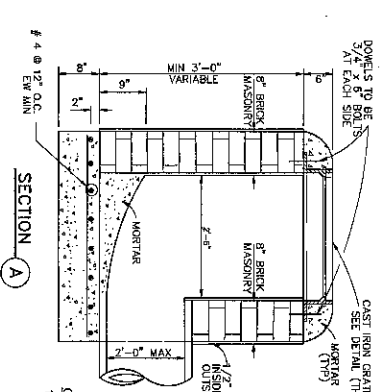
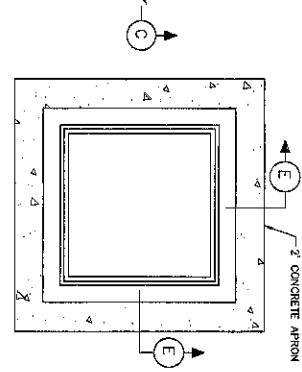
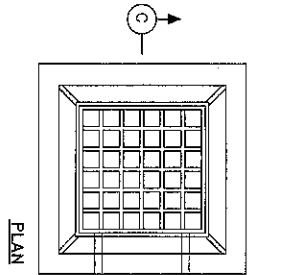

GENERAL CONSTRUCTION NOTES:

- ALL BRICK CONSTRUCTION SHALL USE APPROVED CONCRETE BRICK WITH 1/2" (IN.) MORTAR INSIDE AND OUT. 1/4" TO 1/2" MORTAR JOINT, 3/8" (IN.) IS THE STANDARD.
- SEE DETAIL FOR DOWELS AND BRICK INLETS ARE BUILT INTO BRICKWORK. WHEN BRICK INLETS ARE BUILT, WALLS SHALL BE REINFORCED TO 8 INCHES. AND INLET BEAMS TO BE 4 INCHES LONGER.

REFERENCE:

- GENERAL NOTES
- STORM SEWER NOTES

SHOPPING AT SIENNA PLANTATION

C20

MC-5-15

CONSTRUCTION PLANS FOR:

MISSOURI CITY TEXAS

STORM SEWER INLET CONSTRUCTION DETAILS

DATE: 08/20/2017

BY: [Signature]

PROJECT: [Signature]

SHEET: 3 OF 20

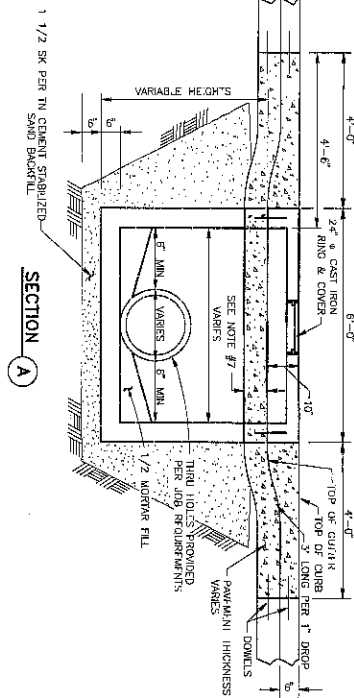
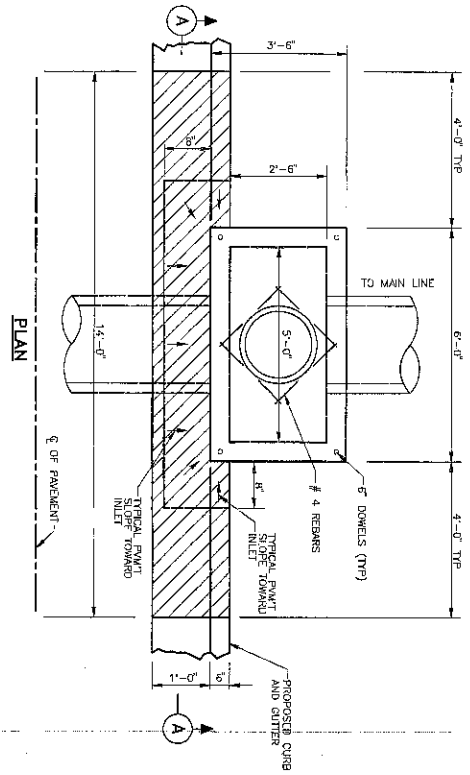

TYPE "H-2" INLET

- NOTES:
1. INLET WALLS MAY BE EXTENDED USING PRECAST RISER SECTION.
 2. INLET TOPS MUST BE SECURED TO THE INLET WALL USING #6 DOMESTS.
 3. INLET BACKFILL SHALL BE CEMENT STABILIZED SAND TO THE TOP OF INLET FIRST STAGE.
 4. ON REQUIRED CENTERS OR EQUAL, REBAR TO CONFORM TO ASTM A615.
 5. REBAR SHALL BE AS SPECIFIED TO SPECIFICATIONS.
 6. TOPS POURED-IN-PLACE REQUIRE #4 REBAR @ 12" O.C. EACH WAY.
 7. PAVEMENT DEPTH AT INLET SHALL BE EQUAL TO OR GREATER THAN REQUIRED PAVEMENT DEPTH.
 8. DEPRESS

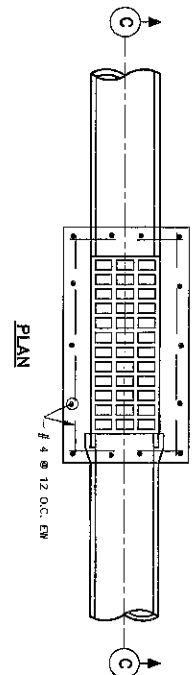

SECTION C

TYPE "D" INLET

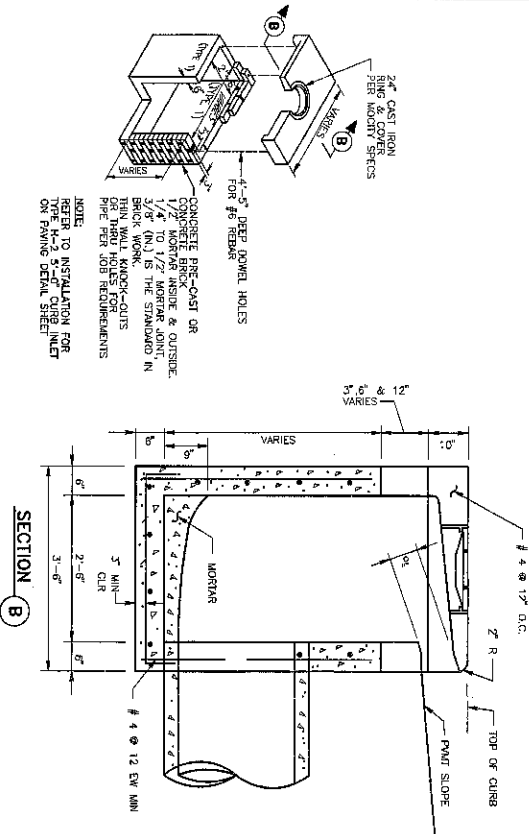

TYPE "H-2" PRECAST INLET

N.T.S.

REFER TO:

1. GENERAL NOTES
2. SEE C.S.S. PAVEMENT NOTES

JOB No.	MC-6-10
SECTION	SHEET 1 OF 27
DATE	07/20/17
DESIGNED BY	
CHECKED BY	
APPROVED BY	
CONSTRUCTION PLANS FOR:	
SHOPPES AT SIENNA PLANTATION	
C21	
MISSOURI CITY TEXAS	
5700A STREET INLET CONSTRUCTION DETAILS II	

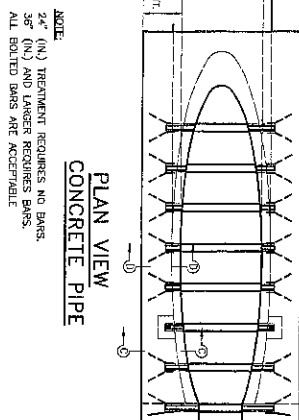

NOTE:
24" (IN) TREATMENT REQUIRES NO BARS.
36" (IN) AND LARGER REQUIRES BARS.
ALL BOLTED BARS ARE ACCEPTABLE

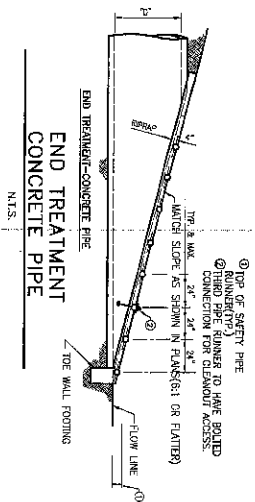

**END TREATMENT
CONCRETE PIPE**
N.T.S.

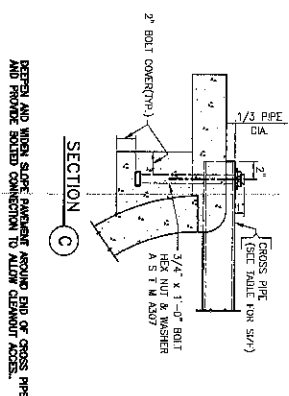

DEEPEN AND WIDEN SLOPE PAVEMENT AROUND END OF CROSS PIPE AND PROVIDE BOLTED CONNECTION TO ALLOW CLEANOUT ACCESS..

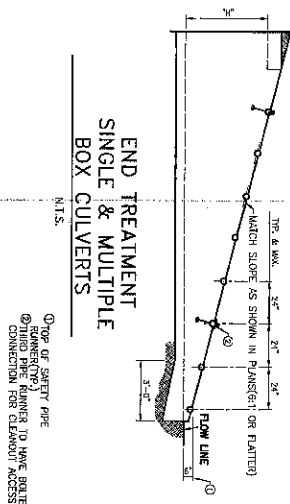

END TREATMENT
SINGLE & MULTIPLE
BOX CULVERTS

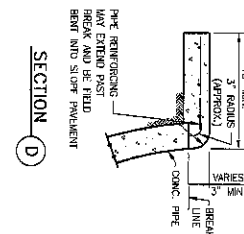

SECTION _____

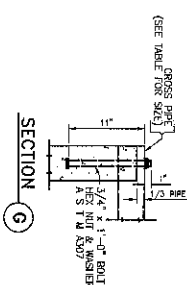

SECTION **G**

DN	WALL	C.O.	SLOPE	PIPE	LEIGH	TYPE	A	B	C	D	E	LENGTH
							1	2	3	4	5	FEET
24"	3"	30"	4:1	2'-6"	2	3	8	26	54	7'-6"	12.33	
			8:1	3'-6"	3	3	6	36	54	10'-0"	14.25	
			3:1	2'-7"	2	4	10	36	54	10'-0"	14.25	
35"	4"	44"	4:1	3'-6"	3	4	10	26	60	13'-0"	18.21	
			6:1	4'-6"	4	4	10	36	72	18'-0"	25.36	
42"	4"	51"	3:1	2'-7"	2	4	10	32	45	11'-5"	15.81	
			4:1	3'-7"	3	3	6	10	51	10'-6"	21.9	
			4:1	4'-7"	4	4	10	54	60	22'-6"	30.66	
			6:1	5'-6"	5	5	11	36	54	13'-6"	18.44	
48"	5"	58"	4:1	3'-8"	3	5	11	39	57	23'-2"	30.77	
			6:1	4'-7"	4	5	11	36	72	24'-6"	32.44	
			3:1	3'-6"	3	5	11	27	45	14'-5"	19.5	
5"	5"	63"	4:1	4'-6"	4	5	11	36	60	19'-3"	25.43	
			6:1	5'-6"	5	5	11	36	80	20'-3"	27.84	
			3:1	3'-7"	3	6	12	40	63	17'-5"	22.84	
60"	6"	72"	4:1	4'-7"	4	6	12	40	84	23'-6"	32.04	
			6:1	5'-7"	5	6	12	46	81	20'-0"	26.88	

NOTES

1. THESE DETAILS ARE TO BE USED AS A GUIDE FOR INSTALLATION OF SAFETY PIPE RUNNERS FOR CROSS-BRIDGE STRUCTURES WHERE DUE TO CONTROL VEHICLES MAY TRAVEL THE OPENING APPROXIMATELY PERPENDICULAR TO THE SAFETY PIPE RUNNER. SOME INSTALLATIONS MAY REQUIRE THE PREPARATION OF SPECIAL DETAILS. IN GENERAL, THE SPACING BETWEEN SAFETY PIPE RUNNERS SHOULD BE APPROXIMATELY 24 INCHES ON CROSS-BRIDGE STRUCTURES AT WORKMAN SPACE AND APPROXIMATELY 24 INCHES ON MAINSPAN SPACE.

SINCE ALL ALLOWED 24" (610) OR SMALLER DIAMETER PIPES ARE FEASIBLE WITHOUT PIPE RUNNERS, SINGLE OR MULTIPLE ROW COLLECTORS WITH SPANS OF 24" OR LESS ARE ALSO PERMISSIBLE WITHOUT SAFETY PIPE RUNNERS.

DESIGN SAFETY PIPE RUNNERS ARE DESIGNED FOR A TRAVELLING LOAD OF 1,200 LBS/FT². THIS LOAD IS RECOMMENDED BY RESEARCH REPORT 289-1, SAFETY INCIDENT ANALYSIS OF BRIDGES OVERHEAD STRUCTURES, ISSUED BY TRANSPORTATION INSTITUT, MARCH 1981.

2. SEE STANDARD OUTCALL DETAILS FOR SLOPE PAYMENT REQUIREMENTS.

[illegible]

SHOPPES AT SIENNA
PLANTATION

C22

MC-9-15

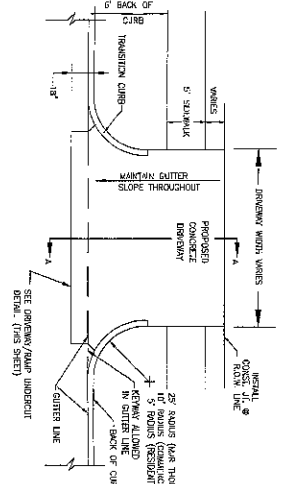

6" CONCRETE CURB
N.T.S.

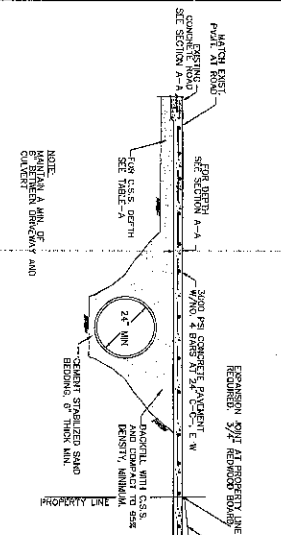

CONCRETE APRON DETAIL - DRIVEWAY PROFILE
FOR CULVERT DRAINAGE
N.T.S.

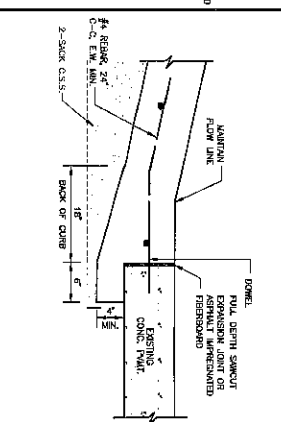

DRIVEWAY/RAMP UNDERCUT
N.T.S.

- NOTES:
- 1.) SAW CUT & REINFORCE TO A MINIMUM OF 72 HOURS FROM PROPOSED CONCRETE PLACEMENT.
 - 2.) NOTIFY MISSOURI CITY PRIOR TO CUT.
 - 3.) REINFORCE WITH 1/2" DIA. BARS.
 - 4.) REINFORCE WITH 1/2" DIA. BARS.
 - 5.) REINFORCE WITH 1/2" DIA. BARS.
 - 6.) REINFORCE WITH 1/2" DIA. BARS.
 - 7.) REINFORCE WITH 1/2" DIA. BARS.
 - 8.) REINFORCE WITH 1/2" DIA. BARS.
 - 9.) REINFORCE WITH 1/2" DIA. BARS.
 - 10.) REINFORCE WITH 1/2" DIA. BARS.
 - 11.) REINFORCE WITH 1/2" DIA. BARS.
 - 12.) REINFORCE WITH 1/2" DIA. BARS.

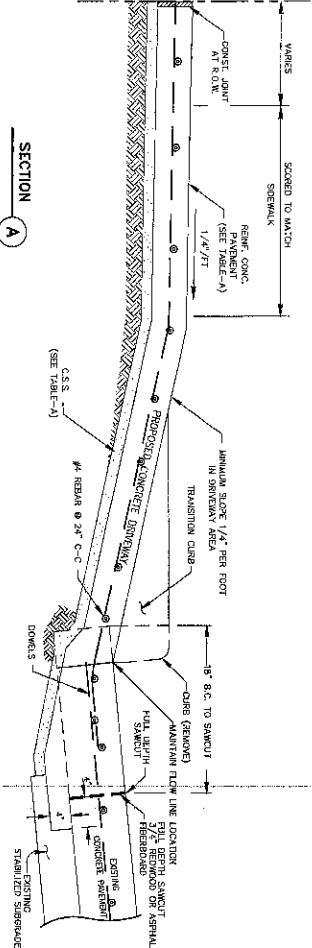

SECTION A
N.T.S.

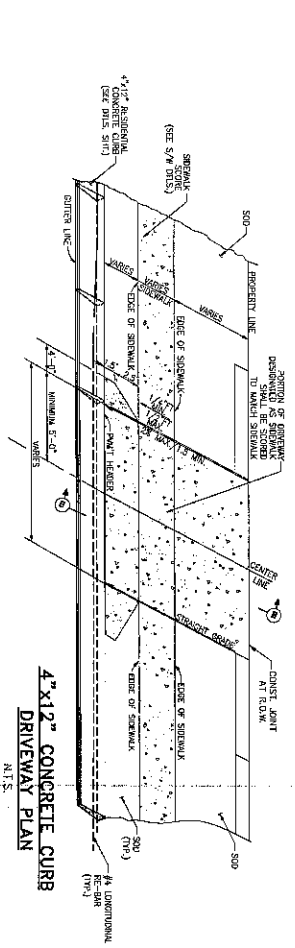

4"x12" CONCRETE CURB
N.T.S.

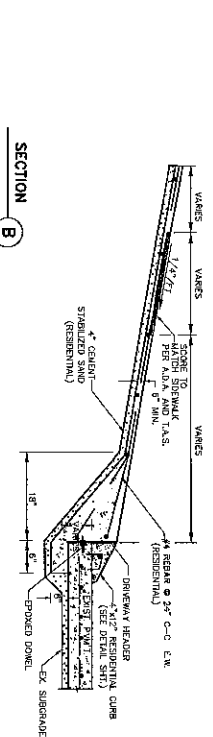

SECTION B
N.T.S.

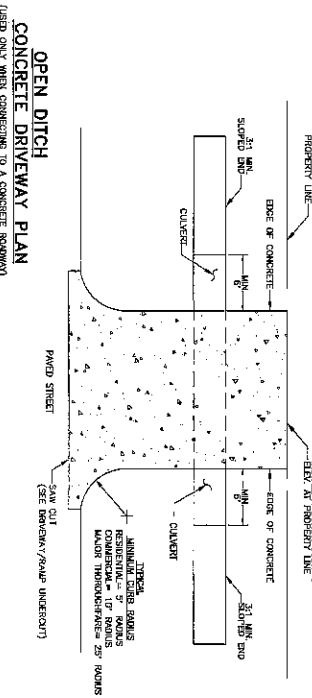

OPEN DITCH
CONCRETE DRIVEWAY PLAN
(USED ONLY WHEN CONNECTING TO A CONCRETE ROADWAY)
N.T.S.

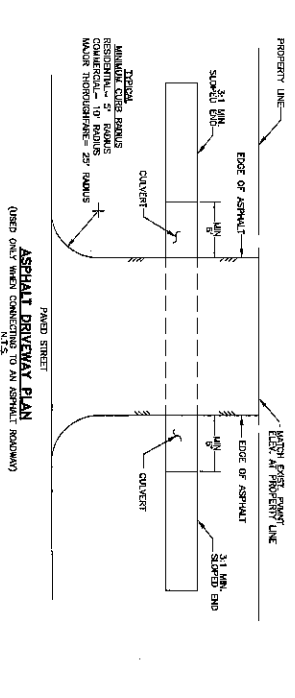

ASPHALT DRIVEWAY PLAN
(USED ONLY WHEN CONNECTING TO AN ASPHALT ROADWAY)
N.T.S.

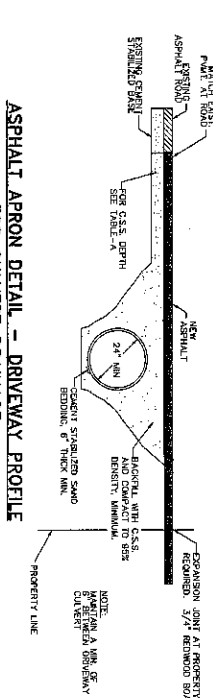

ASPHALT APRON DETAIL - DRIVEWAY PROFILE
FOR CULVERT DRAINAGE
N.T.S.

TABLE-A

CONCRETE STABILIZED SAND	1 1/2" PER FT
REINFORCED CONCRETE	4" MINIMUM
REINFORCED CONCRETE	6" MINIMUM
REINFORCED CONCRETE	8" MINIMUM
REINFORCED CONCRETE	10" MINIMUM
REINFORCED CONCRETE	12" MINIMUM
REINFORCED CONCRETE	14" MINIMUM
REINFORCED CONCRETE	16" MINIMUM
REINFORCED CONCRETE	18" MINIMUM
REINFORCED CONCRETE	20" MINIMUM
REINFORCED CONCRETE	22" MINIMUM
REINFORCED CONCRETE	24" MINIMUM
REINFORCED CONCRETE	26" MINIMUM
REINFORCED CONCRETE	28" MINIMUM
REINFORCED CONCRETE	30" MINIMUM
REINFORCED CONCRETE	32" MINIMUM
REINFORCED CONCRETE	34" MINIMUM
REINFORCED CONCRETE	36" MINIMUM
REINFORCED CONCRETE	38" MINIMUM
REINFORCED CONCRETE	40" MINIMUM
REINFORCED CONCRETE	42" MINIMUM
REINFORCED CONCRETE	44" MINIMUM
REINFORCED CONCRETE	46" MINIMUM
REINFORCED CONCRETE	48" MINIMUM
REINFORCED CONCRETE	50" MINIMUM
REINFORCED CONCRETE	52" MINIMUM
REINFORCED CONCRETE	54" MINIMUM
REINFORCED CONCRETE	56" MINIMUM
REINFORCED CONCRETE	58" MINIMUM
REINFORCED CONCRETE	60" MINIMUM
REINFORCED CONCRETE	62" MINIMUM
REINFORCED CONCRETE	64" MINIMUM
REINFORCED CONCRETE	66" MINIMUM
REINFORCED CONCRETE	68" MINIMUM
REINFORCED CONCRETE	70" MINIMUM
REINFORCED CONCRETE	72" MINIMUM
REINFORCED CONCRETE	74" MINIMUM
REINFORCED CONCRETE	76" MINIMUM
REINFORCED CONCRETE	78" MINIMUM
REINFORCED CONCRETE	80" MINIMUM
REINFORCED CONCRETE	82" MINIMUM
REINFORCED CONCRETE	84" MINIMUM
REINFORCED CONCRETE	86" MINIMUM
REINFORCED CONCRETE	88" MINIMUM
REINFORCED CONCRETE	90" MINIMUM
REINFORCED CONCRETE	92" MINIMUM
REINFORCED CONCRETE	94" MINIMUM
REINFORCED CONCRETE	96" MINIMUM
REINFORCED CONCRETE	98" MINIMUM
REINFORCED CONCRETE	100" MINIMUM

DRIVEWAY
PAYEMENT
CONSTRUCTION TABLE

CONSTRUCTION DETAILS

ITEM	DESCRIPTION	QUANTITY	UNIT	PRICE
1	DRIVEWAY		LF	
2	DRIVEWAY		LF	
3	DRIVEWAY		LF	
4	DRIVEWAY		LF	
5	DRIVEWAY		LF	
6	DRIVEWAY		LF	
7	DRIVEWAY		LF	
8	DRIVEWAY		LF	
9	DRIVEWAY		LF	
10	DRIVEWAY		LF	
11	DRIVEWAY		LF	
12	DRIVEWAY		LF	
13	DRIVEWAY		LF	
14	DRIVEWAY		LF	
15	DRIVEWAY		LF	
16	DRIVEWAY		LF	
17	DRIVEWAY		LF	
18	DRIVEWAY		LF	
19	DRIVEWAY		LF	
20	DRIVEWAY		LF	
21	DRIVEWAY		LF	
22	DRIVEWAY		LF	
23	DRIVEWAY		LF	
24	DRIVEWAY		LF	
25	DRIVEWAY		LF	
26	DRIVEWAY		LF	
27	DRIVEWAY		LF	
28	DRIVEWAY		LF	
29	DRIVEWAY		LF	
30	DRIVEWAY		LF	
31	DRIVEWAY		LF	
32	DRIVEWAY		LF	
33	DRIVEWAY		LF	
34	DRIVEWAY		LF	
35	DRIVEWAY		LF	
36	DRIVEWAY		LF	
37	DRIVEWAY		LF	
38	DRIVEWAY		LF	
39	DRIVEWAY		LF	
40	DRIVEWAY		LF	
41	DRIVEWAY		LF	
42	DRIVEWAY		LF	
43	DRIVEWAY		LF	
44	DRIVEWAY		LF	
45	DRIVEWAY		LF	
46	DRIVEWAY		LF	
47	DRIVEWAY		LF	
48	DRIVEWAY		LF	
49	DRIVEWAY		LF	
50	DRIVEWAY		LF	
51	DRIVEWAY		LF	
52	DRIVEWAY		LF	
53	DRIVEWAY		LF	
54	DRIVEWAY		LF	
55	DRIVEWAY		LF	
56	DRIVEWAY		LF	
57	DRIVEWAY		LF	
58	DRIVEWAY		LF	
59	DRIVEWAY		LF	
60	DRIVEWAY		LF	
61	DRIVEWAY		LF	
62	DRIVEWAY		LF	
63	DRIVEWAY		LF	
64	DRIVEWAY		LF	
65	DRIVEWAY		LF	
66	DRIVEWAY		LF	
67	DRIVEWAY		LF	
68	DRIVEWAY		LF	
69	DRIVEWAY		LF	
70	DRIVEWAY		LF	
71	DRIVEWAY		LF	
72	DRIVEWAY		LF	
73	DRIVEWAY		LF	
74	DRIVEWAY		LF	
75	DRIVEWAY		LF	
76	DRIVEWAY		LF	
77	DRIVEWAY		LF	
78	DRIVEWAY		LF	
79	DRIVEWAY		LF	
80	DRIVEWAY		LF	
81	DRIVEWAY		LF	
82	DRIVEWAY		LF	
83	DRIVEWAY		LF	
84	DRIVEWAY		LF	
85	DRIVEWAY		LF	
86	DRIVEWAY		LF	
87	DRIVEWAY		LF	
88	DRIVEWAY		LF	
89	DRIVEWAY		LF	
90	DRIVEWAY		LF	
91	DRIVEWAY		LF	
92	DRIVEWAY		LF	
93	DRIVEWAY		LF	
94	DRIVEWAY		LF	
95	DRIVEWAY		LF	
96	DRIVEWAY		LF	
97	DRIVEWAY		LF	
98	DRIVEWAY		LF	
99	DRIVEWAY		LF	
100	DRIVEWAY		LF	

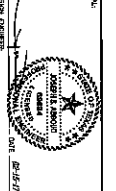

CONSTRUCTION PLANS FOR:
SHOPS AT SIENNA
PLANTATION
C23

MC-22-15
PAGE 23 OF 29

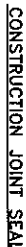
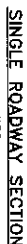
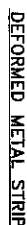
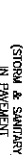
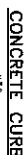
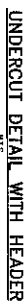
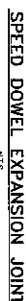
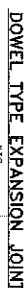
[illegible]

THE LOCATION OF CONSTRUCTION JOINTS AND DEFORMED STRIPS MAY BE VARIED, WITH THE APPROVAL OF THE DEPARTMENT OF PUBLIC WORKS, TO SUIT THE PROPOSED CONSTRUCTION METHODS OF THE CONTRACTOR. MAXIMUM SPEAKING FOR LONGITUDINAL CONTROL JOINTS IS 15'-0".

CONCRETE PAVEMENT
CONSTRUCTION DETAILS



MISSOURI CITY
TEXAS

SHOPPES AT SIENNA
PLANTATION

C24

MC-17-15

[illegible]

316 *Benjamin A. Noy*
DAVID N. Noy, VICE PRESIDENT

[illegible][illegible]

1. JAMES E. BROOKS V. A. PERSERVANT, EMPLOYED IN THE STATE OF CALIFORNIA, COUNTY OF LOS ANGELES, AND MARITIME LABOR RELATIONS NO. 1889

[illegible][illegible]

AND AUTHORIZED THE RECORDING OF THIS MATTER'S FINAL DAY OF 2005. 20

BY: 7-20-05
RON LEE, CHAIRMAN
BY: 3/24/2005

1. NAME: WILSON, ROBERT CLAYTON JR AND FOR FOST SPIN COUNTY, MISSISSIPPI, THAT THE PROBABLE FURNISHING WITH 11% CONTINGENT OR REPRESENTATION WAS TITLED FOR RECEPTION IN HIS OFFICE ON March 28, 1968.

OF SAID COURT.

AT TEST: MY HAND AND SEAL, BE OFFICE, AT MEMPHIS, TENNESSEE, THE DAY AND DATE LAST ABOVE WRITTEN.





FRANK J. CONNELLEY, CLERK OF THE COURT

Frank J. Connelley

DISPUTY
TERRY DRAKE

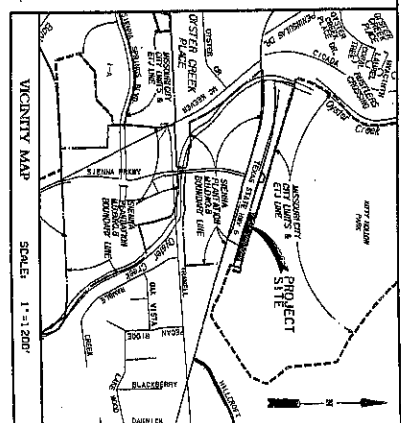
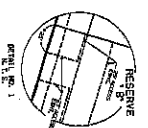
SCALE: 1"=100'

[illegible][illegible]

MAY 12, 2005
 OWNERS
 JOE NO. 1595-0501-310
 PROSPECTY CHOICE INVESTMENT, LP
 BY: PROHIBIT / PROPERTY INVESTMENT, INC., ITS GENERAL PARTNER
 6100 CORPORATE DRIVE, SUITE 500,
 DALLAS, TEXAS 75248
 PH. 714.721.980-1182
 ENGINEER
 JAMES E. BROWN, JR.
 TEXAS REGISTRATION NO. 65981
 3000 International
 Drive, Suite 700
 Dallas, Texas 75248
 LJA Engineering & Surveying, Inc. 
 P. 001 1000000
 TEXAS REGISTRATION NO. 65981
 A PLAT OF 3.84 ACRES, LOCATED IN THE EIGHTH PLAT OF
 SECTION 36, T4N, R10E, S4E, 10TH MERIDIAN, 7TH
 PROSPECTY CHOICE INVESTMENT, LP 5975 ACRES
 RECORDED IN FILE NO. 200403848 OF THE COUNTY
 PUBLIC RECORDS OF FORT BEND COUNTY,
 CITY OF MISSOURI CITY, FORT BEND COUNTY, TEXAS.
 3 RESERVES