



**REVIEW BY FORT BEND COUNTY
COMMISSIONERS COURT**

19B
**Fort Bend County
Engineering Department**
301 Jackson Suite 401
Richmond, Texas 77469
281.633.7500
Permits@fortbendcountytexas.gov

☒ Right of Way Permit
☐ Commercial Driveway Permit
Permit No: 2017-14734

Applicant: CANYON CONSTRUCTION COMPANY, INC.

Job Location Site: 3500 Briarwood Crossing Dr., Village of Pleak, TX., TX 77471

Bond No. 00010701 **Date of Bond:** 6/23/2017 **Amount:** \$34,000.00

The above applicant came to make use of certain Fort Bend County property subject to, "The Order Regulating the Laying, Construction, Maintenance, and Repair of Buried Cables, Conduits, and Pole Lines, In, Under, Across or Along Roads, Streets, Highways, and Drainage Ditches in Fort Bend County, Texas, Under the Jurisdiction of the Commissioners Court of Fort Bend County, Texas," as passed by the Commissioners Court of Fort Bend County, Texas, of the Minutes of the Commissioners Court of Fort Bend County, Texas, to the extent that such order is not inconsistent with Chapter 181, Vernon's Texas Statutes and Codes Annotated.

Notes:

1. Evidence of review by the Commissioners Court must be kept on the job site and failure to do so constitutes grounds for job shutdown.
2. Written notices are required:
 - a. 48 hours in advance of construction start up, and
 - b. When construction is completed and ready for final inspection, submit notification to Permit Administrator thru MyGovernmentOnline.org portal.
3. This permit expires one (1) year from date of permit if construction has not commenced.

On this 11th day of July, 2017, Upon Motion of Commissioner Mujero, seconded by Commissioner Morales, duly put and carried, it is ORDERED, ADJUDGED AND DECREED that said notice of said above purpose is hereby acknowledged by the Commissioners Court of Fort Bend County, Texas, and that said notice be placed on record according to the regulation order thereof.

Signature

Presented to Commissioners Court and approved.

By: Charles O. Ay
for County Engineer

Date Recorded 7-24-2017 Comm. Court No. 19B

By: N/A
Drainage District Engineer/Manager

Clerk of Commissioners Court
By: Ronda Willis
Deputy



**PERMIT APPLICATION REVIEW FORM FOR
CABLE, CONDUIT, AND POLE LINE ACTIVITY
IN FORT BEND COUNTY**

**Fort Bend County
Engineering Department**
301 Jackson Suite 401
Richmond, Texas 77469
281.633.7500
Permits@fortbendcountytx.gov

☒ Right of Way Permit
☐ Commercial Driveway Permit
Permit No: 2017-14734

The following "Notice of Proposed Cable, Conduit, and/or Pole Line activity in Fort Bend County" and accompanying attachments have been reviewed and the notice conforms to appropriate regulations set by Commissioner's Court of Fort Bend County, Texas.

(1) COMPLETE APPLICATION FORM:

- ☒ a. Name of road, street, and/or drainage ditch affected.
☒ b. Vicinity map showing course of directions
☒ c. Plans and specifications

(2) BOND:

- ☐ County Attorney, approval when applicable.
- ☐ Perpetual bond currently posted. Bond No: _____ Amount: _____
- ☒ Performance bond submitted. Bond No: XXXXXXXXXX Amount: \$34,000.00
- ☐ Cashier's Check Check No: _____ Amount: _____

(3) DRAINAGE DISTRICT APPROVAL (WHEN APPLICABLE):

Drainage District Approval

Date

We have reviewed this project and agree it meets minimum requirements.

Charles O. Ay

Permit Administrator

6/30/17

Date

42

**PERFORMANCE BOND COVERING ALL CABLE, CONDUIT AND/OR POLE LINE
ACTIVITY IN, UNDER, ACROSS OR ALONG FORT BEND COUNTY ROADS**

AUTHORIZED

BOND NO.
THE STATE OF TEXAS §
COUNTY OF FORT BEND §

KNOW ALL MEN BY THESE PRESENTS:

THAT WE, Canyon Construction Company, Inc. obo Ft. Bend County MUD #5 whose address is 3307 Redwood Grove Street, Pearland, Texas 77581, Texas, hereinafter called the Principal, and Western Surety Company, a Corporation existing under and by virtue of the laws of the State of South Dakota and authorized to do an indemnifying business in the State of Texas, and whose principal office is located at 5151 San Felipe, #1800, Houston, TX 77056, whose officer residing in the State of Texas, authorized to accept service in all suits and actions brought within said State is TX and whose address is 5151 San Felipe, #1800, Houston, TX 77056, hereinafter called the Surety, and held and firmly bound unto, Robert E. Hebert, County Judge of Fort Bend County, Texas, or his successors in office, in the full sum of Thirty Four Thousand & No/100- Dollars (\$ 34,000.00-) current, lawful money of the United States of America, to be paid to said Robert E. Hebert, County Judge of Fort Bend County, Texas, or his successors in office, to which payment well and truly to be made and done, we, the undersigned, bind ourselves and each of us, our heirs, executors, administrators, successors, assigns, and legal representatives, jointly and severally, by these presents.

THE CONDITION OF THIS BOND IS SUCH THAT, WHEREAS, the above bounden principal contemplates laying, constructing, maintaining and/or repairing one or more cables, conduits, and/or pole lines in, under, across and/or along roads, streets and highways in the County of Fort Bend, and the State of Texas, under the jurisdiction of the Commissioners' Court of Fort Bend County, Texas, pursuant to the Commissioners' Court order adopted on the 1st day of December, A.D. 1980, recorded in Volume 13, of the Commissioners' Court Minutes of Fort Bend County, Texas, regulating same, which Commissioners' Court order is hereby referred to and made a part hereof for all purposes as though fully set out herein;

AND WHEREAS, the principal desires to provide Fort Bend County with a performance bond covering all such cable, conduit and/or pole line activity;

NOW, THEREFORE, if the above bounden principal shall faithfully perform all its cable, conduit and/or pole line activity (including, but not limited to the laying, construction, maintenance and/or repair of cables, conduits and/or pole lines) in, under, across and/or along roads, streets and highways in the County of Fort Bend and State of Texas, under the jurisdiction of the Commissioners Court of Fort Bend County, Texas, pursuant to and in accordance with minimum requirements and conditions of the above mentioned Commissioners' Court order set forth and specified to be by said principal done and performed, at the time and in the manner therein specified, and shall pay over and make good and reimburse Fort Bend County, all loss and damages which Fort Bend County may sustain by reason of any failure or default on the part of said principal, then this obligation shall be null and void, otherwise to remain in full force and effect.

This bond is payable at the County Courthouse in the County of Fort Bend and State of Texas.

It is understood that at any time Fort Bend County deems itself insecure under this bond, it may require further and/or additional bonds of the principal.

EXECUTED this 23rd day of June, 2017.

Canyon Construction Company, Inc.

PRINCIPAL

BY

Western Surety Company

SURETY

BY Francine Hay, Attorney-in-Fact

CCM 7-11-17 #19B
Fort Bend County Clerk
Return Admin Serv Coord RAL

Western Surety Company

POWER OF ATTORNEY APPOINTING INDIVIDUAL ATTORNEY-IN-FACT

Know All Men By These Presents, That WESTERN SURETY COMPANY, a South Dakota corporation, is a duly organized and existing corporation having its principal office in the City of Sioux Falls, and State of South Dakota, and that it does by virtue of the signature and seal herein affixed hereby make, constitute and appoint

Sue Kohler, David R Groppell, Beverly A Ireland, Sharen Groppell, Roxanne G Brune, Sharon Cavanaugh, Kurt A Risk, Francine Hay, Gloria Villa, Individually

of Houston, TX, its true and lawful Attorney(s)-in-Fact with full power and authority hereby conferred to sign, seal and execute for and on its behalf bonds, undertakings and other obligatory instruments of similar nature

- In Unlimited Amounts -

and to bind it thereby as fully and to the same extent as if such instruments were signed by a duly authorized officer of the corporation and all the acts of said Attorney, pursuant to the authority hereby given, are hereby ratified and confirmed.

This Power of Attorney is made and executed pursuant to and by authority of the By-Law printed on the reverse hereof, duly adopted, as indicated, by the shareholders of the corporation.

In Witness Whereof, WESTERN SURETY COMPANY has caused these presents to be signed by its Vice President and its corporate seal to be hereto affixed on this 1st day of August, 2016.



WESTERN SURETY COMPANY

Paul T. Bruflat

Paul T. Bruflat, Vice President

State of South Dakota
County of Minnehaha

} ss

On this 1st day of August, 2016, before me personally came Paul T. Bruflat, to me known, who, being by me duly sworn, did depose and say: that he resides in the City of Sioux Falls, State of South Dakota; that he is the Vice President of WESTERN SURETY COMPANY described in and which executed the above instrument; that he knows the seal of said corporation; that the seal affixed to the said instrument is such corporate seal; that it was so affixed pursuant to authority given by the Board of Directors of said corporation and that he signed his name thereto pursuant to like authority, and acknowledges same to be the act and deed of said corporation.

My commission expires

June 23, 2021

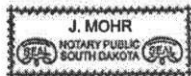

J. Mohr

J. Mohr, Notary Public

CERTIFICATE

I, L. Nelson, Assistant Secretary of WESTERN SURETY COMPANY do hereby certify that the Power of Attorney hereinabove set forth is still in force, and further certify that the By-Law of the corporation printed on the reverse hereof is still in force. In testimony whereof I have hereunto subscribed my name and affixed the seal of the said corporation this 23rd day of June, 2017.



WESTERN SURETY COMPANY

L. Nelson

L. Nelson, Assistant Secretary

Authorizing By-Law

ADOPTED BY THE SHAREHOLDERS OF WESTERN SURETY COMPANY

This Power of Attorney is made and executed pursuant to and by authority of the following By-Law duly adopted by the shareholders of the Company.

Section 7. All bonds, policies, undertakings, Powers of Attorney, or other obligations of the corporation shall be executed in the corporate name of the Company by the President, Secretary, and Assistant Secretary, Treasurer, or any Vice President, or by such other officers as the Board of Directors may authorize. The President, any Vice President, Secretary, any Assistant Secretary, or the Treasurer may appoint Attorneys in Fact or agents who shall have authority to issue bonds, policies, or undertakings in the name of the Company. The corporate seal is not necessary for the validity of any bonds, policies, undertakings, Powers of Attorney or other obligations of the corporation. The signature of any such officer and the corporate seal may be printed by facsimile.



Western Surety Company

Figure: 28 TAC §1.601(a)(3)

1 IMPORTANT NOTICE

To obtain information or make a complaint:

2 You may contact Western Surety Company at 605-336-0850.

3 You may call Western Surety Company's toll-free telephone number for information or to make a complaint at:

1-800-331-6053

4 You may also write to Western Surety Company at:

P.O. Box 5077
Sioux Falls, SD 57117-5077

5 You may contact the Texas Department of Insurance to obtain information on companies, coverages, rights or complaints at:

1-800-252-3439

6 You may write the Texas Department of Insurance:

P.O. Box 149104
Austin, TX 78714-9104
Fax: (512) 475-1771
Web: <http://www.tdi.state.tx.us>
E-Mail: ConsumerProtection@tdi.state.tx.us

7 PREMIUM OR CLAIM DISPUTES:

Should you have a dispute concerning your premium or about a claim you should contact Western Surety Company first. If the dispute is not resolved, you may contact the Texas Department of Insurance.

8 ATTACH THIS NOTICE TO YOUR POLICY:

This notice is for information only and does not become a part or condition of the attached document.

AVISO IMPORTANTE

Para obtener informacion o para someter una queja:

Puede comunicarse con Western Surety Company al 605-336-0850.

Usted puede llamar al numero de telefono gratis de Western Surety Company's para informacion o para someter una queja al:

1-800-331-6053

Usted tambien puede escribir a Western Surety Company:

P.O. Box 5077
Sioux Falls, SD 57117-5077

Puede comunicarse con el Departamento de Seguros de Texas para obtener informacion acerca de companias, coberturas, derechos o quejas al:

1-800-252-3439

Puede escribir al Departamento de Seguros de Texas:

P.O. Box 149104
Austin, TX 78714-9104
Fax: (512) 475-1771
Web: <http://www.tdi.state.tx.us>
E-Mail: ConsumerProtection@tdi.state.tx.us

DISPUTAS SOBRE PRIMAS O RECLAMOS:

Si tiene una disputa concerniente a su prima o a un reclamo, debe comunicarse con el Western Surety Company primero. Si no se resuelve la disputa, puede entonces comunicarse con el departamento (TDI).

UNA ESTE AVISO A SU POLIZA: Este aviso es solo para proposito de informacion y no se convierte en parte o condicion del documento adjunto.

FILED AND RECORDED
OFFICIAL PUBLIC RECORDS

Laura Richard

Laura Richard, County Clerk
Fort Bend County, Texas

July 17, 2017 04:06:05 PM

FEE: \$0.00 RMM
BOND

2017079228



FORT BEND COUNTY M.U.D. No. 5

FORT BEND COUNTY, TEXAS
PLANS FOR CONSTRUCTION
OF

SANITARY SEWER AND WATER LINES
TO SERVE

BRIARWOOD CROSSING COMMERCIAL TRACTS PHASE ONE

INDEX

- 1 COVER SHEET
- 2 GENERAL NOTES
- 3 UTILITY LAYOUT, SHEET INDEX, STORM WATER
POLLUTION PREVENTION PLAN
- 4 LINE "A"
- 5 STORM WATER POLLUTION PREVENTION PLAN DETAILS
- 6 WATER LINE DETAILS
- 7 SANITARY SEWER DETAILS

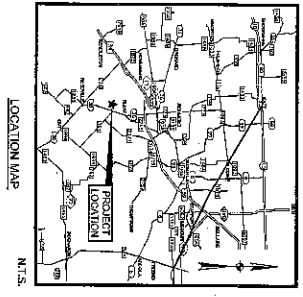

LOCATION MAP
N.T.S.

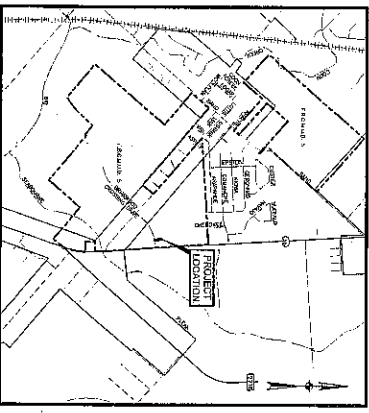

VICINITY MAP
KEY MAP # 644-L
ZIP CODE 77471
N.T.S.

PLAT NAME N/A



Handwritten signature
12/19/17

FORT BEND COUNTY ENGINEER	
ENGINEER: <i>Handwritten signature</i>	DATE: 1/24/17
THESE SIGNATURES ARE VALID IF CONSTRUCTION HAS NOT COMMENCED IN ONE (1) YEAR FROM DATE OF APPROVAL.	
ENGINEER: <i>Handwritten signature</i>	DATE: 1/24/17
SOLUTIONS CORPORATION	

APPROVED BY:
Handwritten signature
DATE: 1-18-17

VALUE OF PEAK

WATER ENGINEER:
Handwritten signature
DATE: 1-18-17

APPROVAL OF THIS PLAN EXPIRES ONE YEAR FROM DATE OF APPROVAL, IF CONSTRUCTION HAS NOT COMMENCED.

ONE-CALL NOTIFICATION SYSTEM
CALL BEFORE YOU DIG!!
1-800-344-3377

NE r.s.miller engineers
16340 Park Two Place
Suite 300
Houston, Texas 77064
(713) 401-9800
Texas P.E. Registration No. 1-487

PORTLAND COUNTY CONSTRUCTION - GENERAL NOTES

- [illegible]

F.B.I. U.S.D., INC.
P.B.I. & P.B.I. INC.

- [illegible]

1

APPROVED: M. J. D. [Signature]
DEVELOPMENT COORDINATOR

DATES: 11/3/17

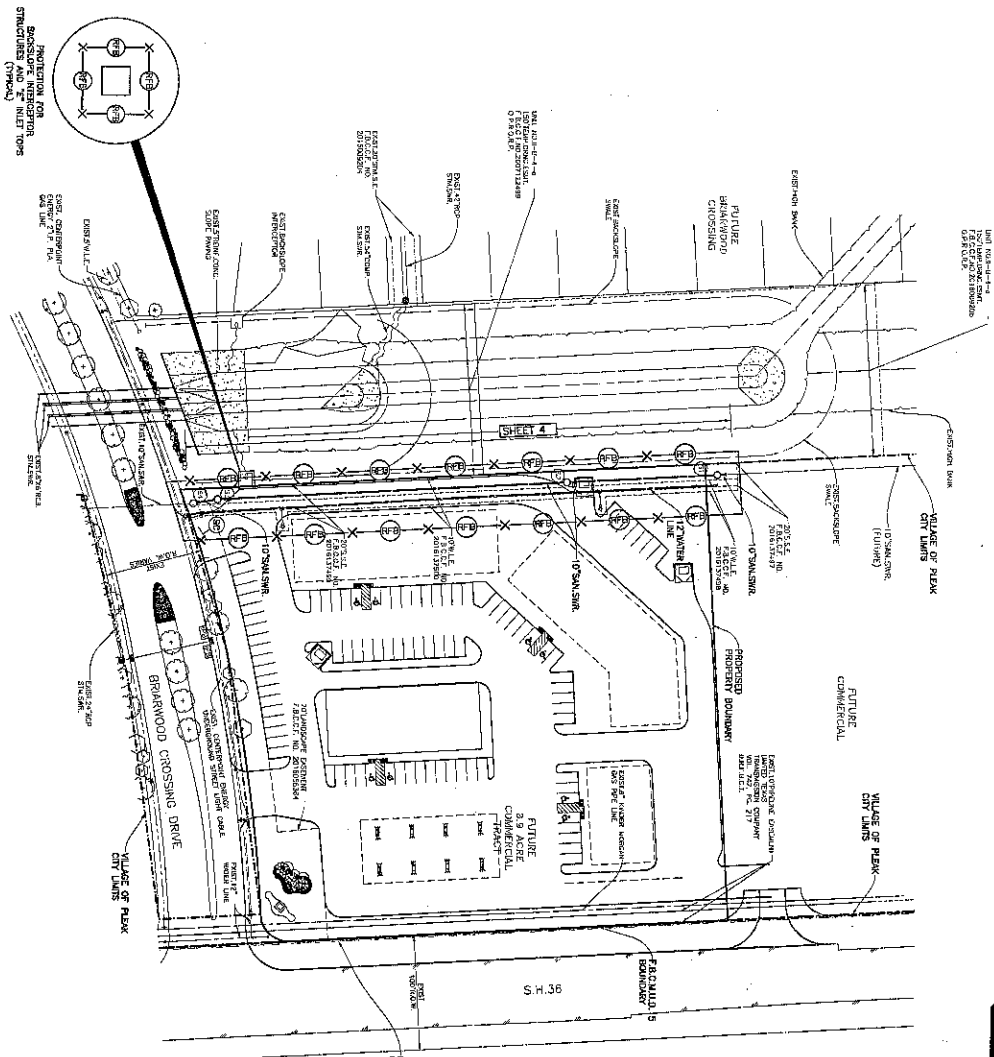

WARNING - UNDERGROUND PIPELINE

CONTRACTOR SHALL USE EXTREME CAUTION WHEN WORKING IN THE VICINITY OF UNDERGROUND PIPELINES. EXISTING AND PROPOSED UNDERGROUND PIPELINES ARE SHOWN ON ATTACHED LOCATION AND DEPTH BASED ON THE BEST INFORMATION AVAILABLE. CONTRACTOR SHALL FIELD VERIFY LOCATION OF ALL DRAINING UTILITIES PRIOR TO COMMENCING CONSTRUCTION. CONTACT WADSWORTH COUNTY REPRESENTATIVE @ (713) 399-6208 AT LEAST 72 HOURS PRIOR TO CONSTRUCTION IN THE AREA.

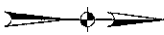

- | LEGEND | DESCRIPTION |
|--------|---------------------------|
| | SANITARY SEWER |
| | WATER LINE |
| | EXISTING STORM SEWER |
| | EXISTING WATER LINE |
| | SHEET REFERENCE |
| | SANITARY MANHOLE (BURNER) |
| | EXISTING SHEET PILE |
| | |

F.B.C.M.U.D. NO. 5
BRIARWOOD CROSSING
COMMERCIAL TRACTS
PHASE ONE

PROPOSED SANITARY SEWER
AND WATER LINES

UTILITY LAYOUT SHEET
INDEX & STORM WATER
POLLUTION PREVENTION
PLAN

TABLE "A"
LOCATED ON THE NORTH SIDE OF A
ROAD, 7'-2" MIN. WIDE, BEARING E. 80°
N. 60' - 30" SOUTHWEST OF SPOT
REVISION
BY DATE

[illegible][illegible]

WARNING - BURIED UTILITIES

CONSTRUCTION SHALL USE EXISTING COINTEL WITH
 WORKING IN THE VICINITY OF BURIED UTILITIES.
 CONSTRUCTION SHALL BE RESPONSIBLE FOR
 IDENTIFYING AND MARKING ALL UTILITIES
 BEFORE ANY EXCAVATION OR CONSTRUCTION
 BEGINS. THE SIGHTS AT JUNCTION LOCATIONS OF ALL
 UTILITIES SHALL BE MAINTAINED THROUGHOUT
 CONSTRUCTION. SEE PRIVATE UTILITY NOTES, SHEET 23

1. CONTRACTOR SHALL MAINTAIN & NECESSARY
 TO EXISTING COINTEL OR OTHER UTILITIES
 COMPLETION OF CONSTRUCTION.
2. CONTRACTOR SHALL MAINTAIN TO EXISTING
 COINTEL OR OTHER UTILITIES
 COMPLETION OF CONSTRUCTION.
3. CONTRACTOR SHALL MAINTAIN TO EXISTING
 COINTEL OR OTHER UTILITIES
 COMPLETION OF CONSTRUCTION.

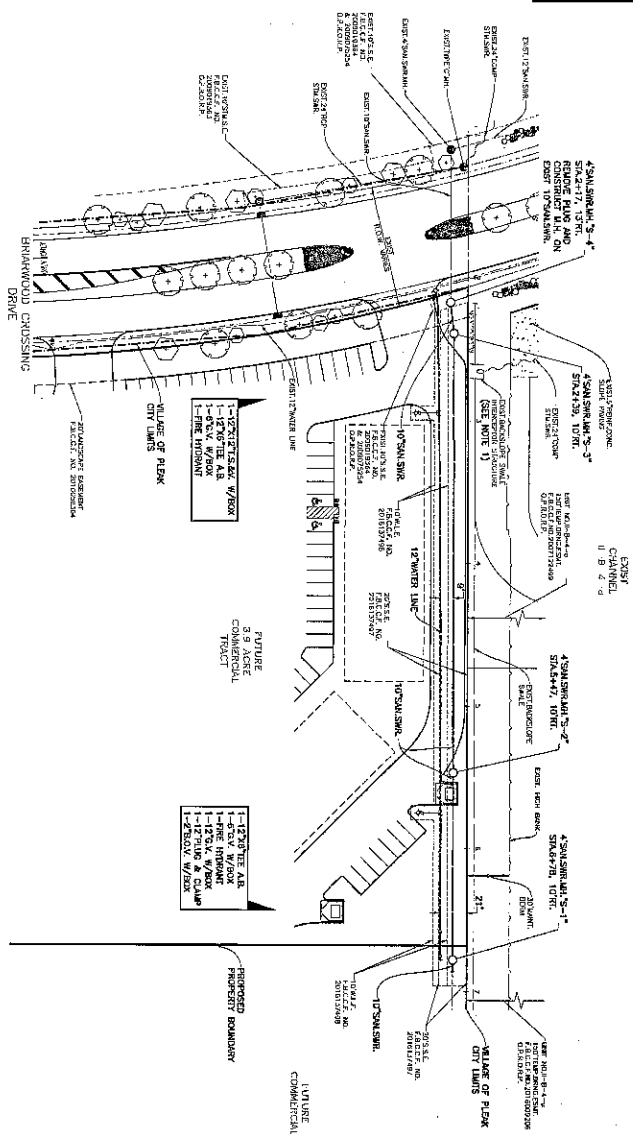

LINE "A"

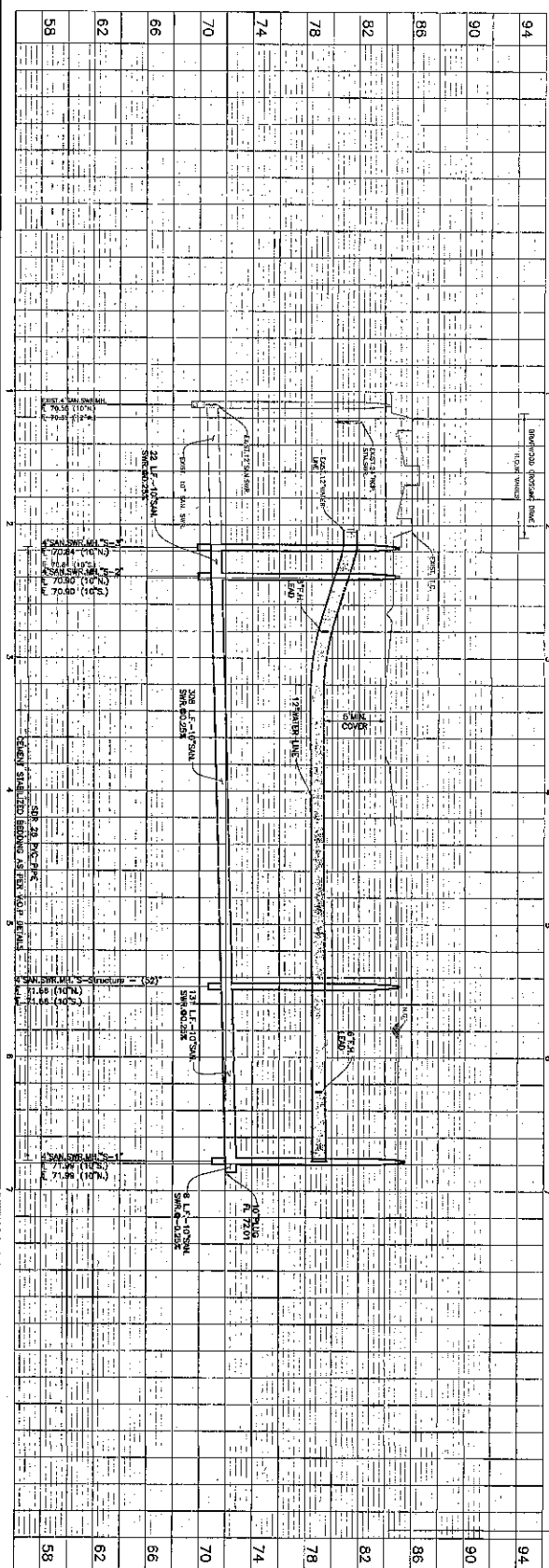

LINE "A"

PROPOSED SANITARY SEWER
 AND WATER LINES

F.B.C.M.U.D. NO. 5
 BRIARWOOD CROSSING
 COMMERCIAL TRACTS
 PHASE ONE

IG miller
 engineers

16340 Park 7th Place
 Houston, Texas 77058
 (713) 461-1000



APPROVED: *[Signature]*
 DESIGN: *[Signature]*
 DATE: 11/11/16

NO. DATE: 11/11/16
 REVISION: 1
 SCALE: 1" = 10' H, 1" = 4' V
 SHEET NO. 1 OF 2 SHEETS
 PROJECT: BRIARWOOD CROSSING COMMERCIAL TRACTS
 CITY: HOUSTON, TX

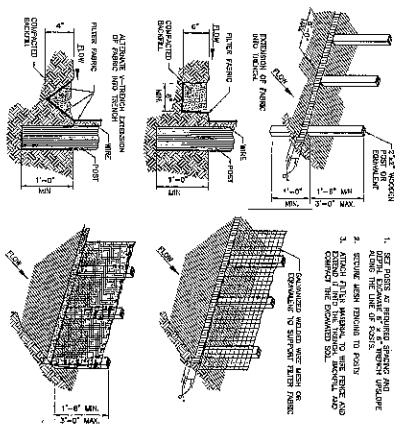

- GENERAL NOTES:
1. SECTION FABRIC MUST BE TIGHT TO FRAME WITH STAPLES OR NAILS.
 2. STAPLES MUST BE PLACED TO MATCH FRAME.
 3. WHEN TWO SECTIONS OF FABRIC MEET, THEY MUST BE OVERLAPPED BY 6 INCHES AT A MINIMUM.
 4. WHEN TWO SECTIONS OF FABRIC MEET, THEY MUST BE OVERLAPPED BY 6 INCHES AT A MINIMUM.

REINFORCED FILTER FABRIC BARRIER

1/2" (1/2")
SYMBOL

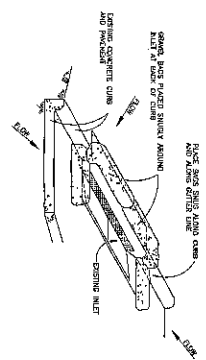

- GENERAL NOTES:
1. BARRIER MUST BE TIGHT TO FRAME WITH STAPLES OR NAILS.
 2. STAPLES MUST BE PLACED TO MATCH FRAME.
 3. WHEN TWO SECTIONS OF FABRIC MEET, THEY MUST BE OVERLAPPED BY 6 INCHES AT A MINIMUM.
 4. WHEN TWO SECTIONS OF FABRIC MEET, THEY MUST BE OVERLAPPED BY 6 INCHES AT A MINIMUM.

INLET PROTECTION BARRIERS FOR STAGE II INLETS

1/2" (1/2")
SYMBOL

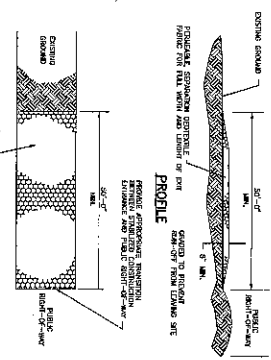

- GENERAL NOTES:
1. BARRIER MUST BE TIGHT TO FRAME WITH STAPLES OR NAILS.
 2. STAPLES MUST BE PLACED TO MATCH FRAME.
 3. WHEN TWO SECTIONS OF FABRIC MEET, THEY MUST BE OVERLAPPED BY 6 INCHES AT A MINIMUM.
 4. WHEN TWO SECTIONS OF FABRIC MEET, THEY MUST BE OVERLAPPED BY 6 INCHES AT A MINIMUM.
 5. WHEN TWO SECTIONS OF FABRIC MEET, THEY MUST BE OVERLAPPED BY 6 INCHES AT A MINIMUM.
 6. WHEN TWO SECTIONS OF FABRIC MEET, THEY MUST BE OVERLAPPED BY 6 INCHES AT A MINIMUM.
 7. WHEN TWO SECTIONS OF FABRIC MEET, THEY MUST BE OVERLAPPED BY 6 INCHES AT A MINIMUM.
 8. WHEN TWO SECTIONS OF FABRIC MEET, THEY MUST BE OVERLAPPED BY 6 INCHES AT A MINIMUM.
 9. WHEN TWO SECTIONS OF FABRIC MEET, THEY MUST BE OVERLAPPED BY 6 INCHES AT A MINIMUM.
 10. WHEN TWO SECTIONS OF FABRIC MEET, THEY MUST BE OVERLAPPED BY 6 INCHES AT A MINIMUM.

STABILIZED CONSTRUCTION ACCESS

1/2" (1/2")
SYMBOL

F.B.C.M.U.D. NO. 5
BRARWOOD CROSSING
COMMERCIAL TRACTS
PHASE ONE
PROPOSED SANITARY SEWER
AND WATER LINES

STORM WATER POLLUTION
PREVENTION PLAN
DETAILS

NO.	DATE	REVISION
1	1/31/17	REVISED

W.E. I.G. Miller
engineers

15310 Pine Tree Place
Houston, Texas 77064
(713) 461-9600

TRUCK ROAD IMPROVEMENT NO. 1-407

John Miller
12/16/16

APPROVED: *John Miller*
DATE: 1/31/17

DESIGNED BY: R.L.K.
CHECKED BY: R.L.K.
DRAWN BY: R.L.K.
SCALE: AS SHOWN
SHEET NO. 5 OF 7 SHEETS
SHEET BY: WILLY SWAMY
CITY: DALLAS, TEX.

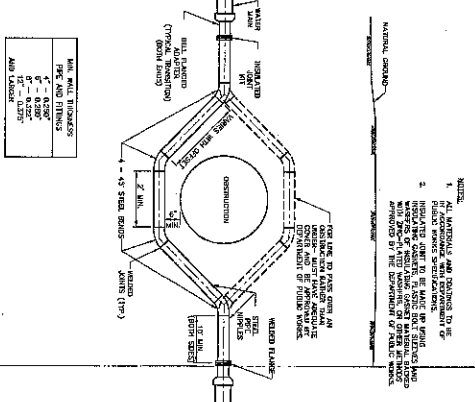
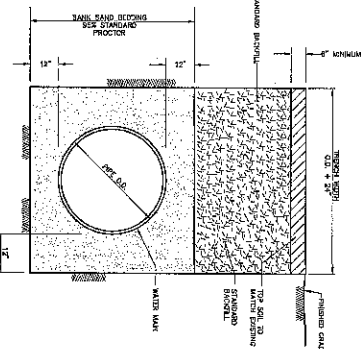
[illegible]

1. AGGREGATE SHALL BE UNIFORM SIZE, FREE OF DEBRIS, PLACED IN LIFT, 6" THICK OR LESS, COMPACTED TO SET STANDARD PROCTOR DENSITY, EXCEPT AS REQUIRED BELOW.
2. BASAL LAYER DIRTWAY AND PAVING STRUCTURE SHALL BE CLEAN GRAVULATED SAND (1.5 GRADE OF SAND) PER DRAIN YARD OF SAND) COMPACTED TO SET STANDARD PROCTOR DENSITY.
3. FINISH SHOTOL, IN ACCORDANCE WITH SPEC, SHALL BE INSTALLED AS

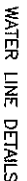

F.B.C.M.U.D. NO. 5
BRIARWOOD CROSSING
COMMERCIAL TRACTS
PHASE ONE
PROPOSED SANITARY SEWER
AND WATER LINES



r.g.miller
engineers

16340 Park Ten Place
Suite 350
Houston, Texas 77060

(713) 461-2600
TEXAS FARM REGISTRATION NO. F-4

TEXAS FARM REGISTRATION NO. F-4

[Handwritten signature]
12/9/76

APPROVED: M. J. [Signature]
DELEGATED COORDINATOR







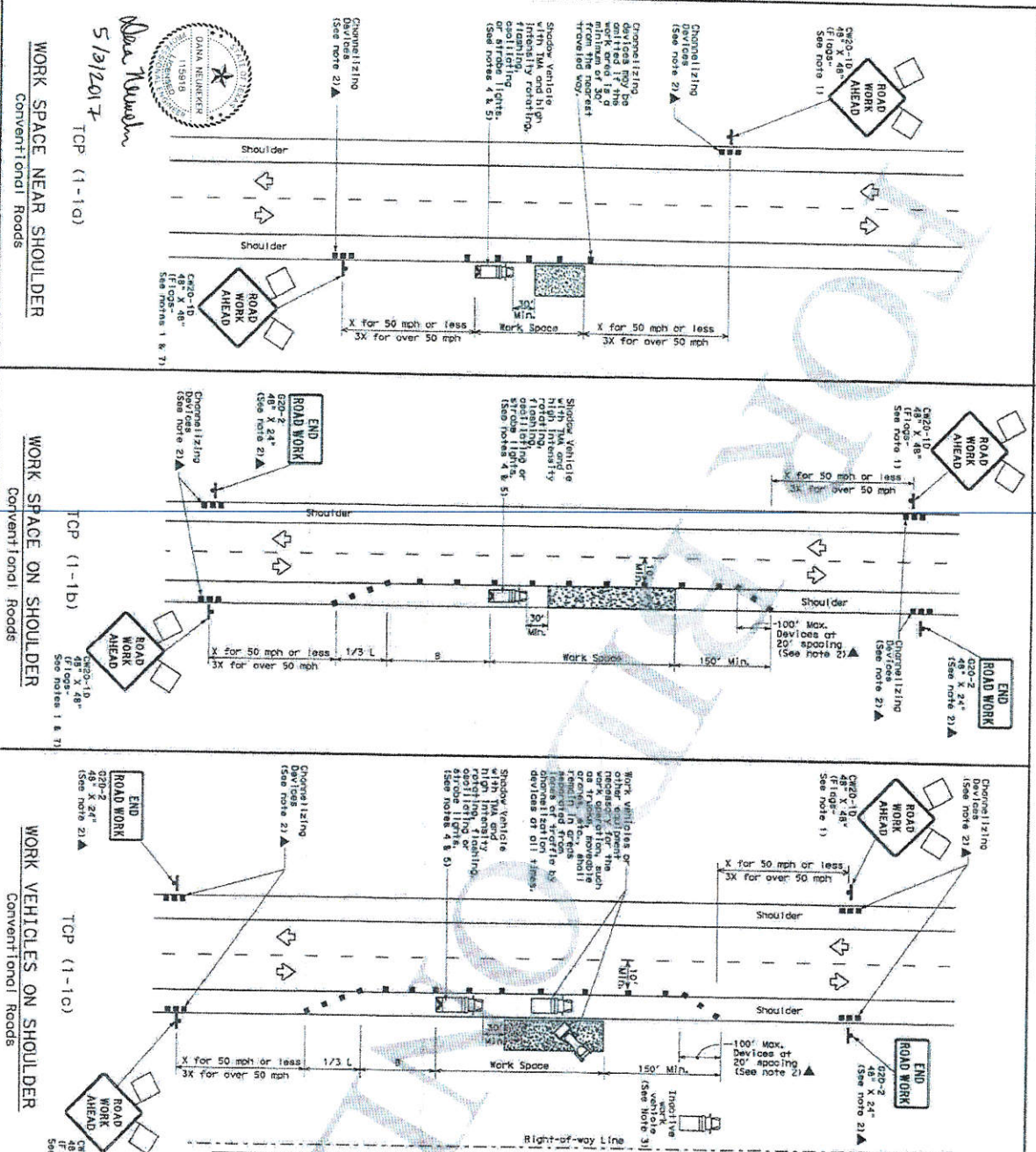

DATE: 1/31/17

SUBMITTED: SCALE: N.T.S.
DATE: SEPTEMBER 2016
SURVEY BY: MILLER SURVEY
ER NO.

DESIGNED BY: B.D.R.
DRAWN BY: B.D.R.
SHEET NO. 6 OF 7 SHEETS
CITY: LUMB NGZ

DISCLAIMER: The use of this standard is governed by the "Texas Engineering Practice Act". No warranty of any kind is made by TxDOT for any purpose whatsoever. TxDOT assumes no responsibility for the conversion of this standard to other formats or for incorrect results or damages resulting from its use.



LEGEND	
	Truck Mounted Attenuator (TMA)
	Tractor Mounted Flooding Arrow Board
	Sign
	Flag
	Truck Mounted Attenuator (TMA)
	Tractor Mounted Flooding Arrow Board
	Sign
	Flag

No.	Polymer formula	Infrared doublet ratio, $\nu_{\text{CH}_2}/\nu_{\text{CH}}$	Degree of chlorination, %		Suggested chlorine content, %	Suggested chlorine content, %	Suggested chlorine content, %
			1,2	1,3			
1	$\text{CH}_2=\text{CHCl}$	100	100	0	100	100	100
2	$\text{CH}_2=\text{CHCl}$	100	100	0	100	100	100
3	$\text{CH}_2=\text{CHCl}$	100	100	0	100	100	100
4	$\text{CH}_2=\text{CHCl}$	100	100	0	100	100	100
5	$\text{CH}_2=\text{CHCl}$	100	100	0	100	100	100
6	$\text{CH}_2=\text{CHCl}$	100	100	0	100	100	100
7	$\text{CH}_2=\text{CHCl}$	100	100	0	100	100	100
8	$\text{CH}_2=\text{CHCl}$	100	100	0	100	100	100
9	$\text{CH}_2=\text{CHCl}$	100	100	0	100	100	100
10	$\text{CH}_2=\text{CHCl}$	100	100	0	100	100	100
11	$\text{CH}_2=\text{CHCl}$	100	100	0	100	100	100
12	$\text{CH}_2=\text{CHCl}$	100	100	0	100	100	100
13	$\text{CH}_2=\text{CHCl}$	100	100	0	100	100	100
14	$\text{CH}_2=\text{CHCl}$	100	100	0	100	100	100
15	$\text{CH}_2=\text{CHCl}$	100	100	0	100	100	100
16	$\text{CH}_2=\text{CHCl}$	100	100	0	100	100	100
17	$\text{CH}_2=\text{CHCl}$	100	100	0	100	100	100
18	$\text{CH}_2=\text{CHCl}$	100	100	0	100	100	100
19	$\text{CH}_2=\text{CHCl}$	100	100	0	100	100	100
20	$\text{CH}_2=\text{CHCl}$	100	100	0	100	100	100
21	$\text{CH}_2=\text{CHCl}$	100	100	0	100	100	100
22	$\text{CH}_2=\text{CHCl}$	100	100	0	100	100	100
23	$\text{CH}_2=\text{CHCl}$	100	100	0	100	100	100
24	$\text{CH}_2=\text{CHCl}$	100	100	0	100	100	100
25	$\text{CH}_2=\text{CHCl}$	100	100	0	100	100	100
26	$\text{CH}_2=\text{CHCl}$	100	100	0	100	100	100
27	$\text{CH}_2=\text{CHCl}$	100	100	0	100	100	100
28	$\text{CH}_2=\text{CHCl}$	100	100	0	100	100	100
29	$\text{CH}_2=\text{CHCl}$	100	100	0	100	100	100
30	$\text{CH}_2=\text{CHCl}$	100	100	0	100	100	100
31	$\text{CH}_2=\text{CHCl}$	100	100	0	100	100	100
32	$\text{CH}_2=\text{CHCl}$	100	100	0	100	100	100
33	$\text{CH}_2=\text{CHCl}$	100	100	0	100	100	100
34	$\text{CH}_2=\text{CHCl}$	100	100	0	100	100	100
35	$\text{CH}_2=\text{CHCl}$	100	100	0	100	100	100
36	$\text{CH}_2=\text{CHCl}$	100	100	0	100	100	100
37	$\text{CH}_2=\text{CHCl}$	100	100	0	100	100	100
38	$\text{CH}_2=\text{CHCl}$	100	100	0	100	100	100
39	$\text{CH}_2=\text{CHCl}$	100	100	0	100	100	100
40	$\text{CH}_2=\text{CHCl}$	100	100	0	100	100	100
41	$\text{CH}_2=\text{CHCl}$	100	100	0	100	100	100
42	$\text{CH}_2=\text{CHCl}$	100	100	0	100	100	100
43	$\text{CH}_2=\text{CHCl}$	100	100	0	100	100	100
44	$\text{CH}_2=\text{CHCl}$	100	100	0	100	100	100
45	$\text{CH}_2=\text{CHCl}$	100	100	0	100	100	100

**Taper lengths have been rounded off.
L=length of Taper (FT) W=width of Offset (FT) S=Posted Speed (MPH)

TYPICAL USAGE				
MOBILE	SHORT DURATION	SHORT TERM STATIONARY	INTERMEDIATE TERM STATIONARY	LONG TERM STATIONARY
	✓	✓		

GENERAL NOTES

1. Flights attached to signs where signs are REQUIRED.
2. All traffic control devices illustrated are REQUIRED, except those in the Plans, or for existing installations, when approved by the Engineer.
3. Install any vehicles or other equipment should be parked near the right-of-way line and not parked on the paved shoulder.
4. 30 to 100 feet in advance of the stop of the device. If vehicles are no longer present but road or work conditions require the traffic control device to remain in place, 25 feet backward of the right-of-way line.
5. Additional Stoppage Vehicles with this sign to protect wider work zones or work past to those ahead in order to protect wider work zones.
6. See 12-15-1-11 shoulder work on division highways, expressways and Interstates.
7. ROAD WORK AHEAD signs for shoulder work on conventional roadways.

For construction or maintenance control work, specific project requirements for shadow vehicles can be found in the project GENERAL NOTES for Item 502, Barricades, Signs and Traffic Handling.



TRAFFIC CONTROL PLAN
CONVENTIONAL ROAD
SHOULDER WORK

TCP(1-1)-12

[illegible]