



**REVIEW BY FORT BEND COUNTY
COMMISSIONERS COURT**

**Fort Bend County
Engineering Department**
301 Jackson Suite 401
Richmond, Texas 77469
281.633.7500
Permits@fortbendcountytexas.gov

☒ Right of Way Permit
☐ Commercial Driveway Permit

Permit No: 2017-12044

Applicant: Fibernet Direct Texas LLC

Job Location Site: 630 Greenbusch Road, Katy, TX 77494

Bond ██████████ **Date of Bond:** 7/26/2016 **Amount:** \$50,000.00

The above applicant came to make use of certain Fort Bend County property subject to, "The Order Regulating the Laying, Construction, Maintenance, and Repair of Buried Cables, Conduits, and Pole Lines, In, Under, Across or Along Roads, Streets, Highways, and Drainage Ditches in Fort Bend County, Texas, Under the Jurisdiction of the Commissioners Court of Fort Bend County, Texas," as passed by the Commissioners Court of Fort Bend County, Texas, of the Minutes of the Commissioners Court of Fort Bend County, Texas, to the extent that such order is not inconsistent with Chapter 181, Vernon's Texas Statutes and Codes Annotated.

Notes:

1. Evidence of review by the Commissioners Court must be kept on the job site and failure to do so constitutes grounds for job shutdown.
2. Written notices are required:
 - a. 48 hours in advance of construction start up, and
 - b. When construction is completed and ready for final inspection, submit notification to Permit Administrator thru MyGovernmentOnline.org portal.
3. This permit expires one (1) year from date of permit if construction has not commenced.

On this 27th day of June, 2017, Upon Motion of Commissioner Morales, seconded by Commissioner Prestage, duly put and carried, it is ORDERED, ADJUDGED AND DECREED that said notice of said above purpose is hereby acknowledged by the Commissioners Court of Fort Bend County, Texas, and that said notice be placed on record according to the regulation order thereof.

Signature

Presented to Commissioners Court and approved.

By: Charles O. Ay
for County Engineer

Date Recorded 7-5-2017 Comm. Court No. 14P

By: N/A

Drainage District Engineer/Manager

Clerk of Commissioners Court

By: Kinda Willis
Deputy



**PERMIT APPLICATION REVIEW FORM FOR
CABLE, CONDUIT, AND POLE LINE ACTIVITY
IN FORT BEND COUNTY**

**Fort Bend County
Engineering Department**
301 Jackson Suite 401
Richmond, Texas 77469
281.633.7500
Permits@fortbendcountytexas.gov

- ☒ Right of Way Permit
☐ Commercial Driveway Permit

Permit No: 2017-12044

The following "Notice of Proposed Cable, Conduit, and/or Pole Line activity in Fort Bend County" and accompanying attachments have been reviewed and the notice conforms to appropriate regulations set by Commissioner's Court of Fort Bend County, Texas.

(1) COMPLETE APPLICATION FORM:

- ☒ a. Name of road, street, and/or drainage ditch affected.
☒ b. Vicinity map showing course of directions
☒ c. Plans and specifications

(2) BOND:

- ☐ County Attorney, approval when applicable.
- ☒ Perpetual bond currently posted. Bond # [REDACTED] Amount: \$50,000.00
- ☐ Performance bond submitted. Bond No: _____ Amount: _____
- ☐ Cashier's Check Check No: _____ Amount: _____

(3) DRAINAGE DISTRICT APPROVAL (WHEN APPLICABLE):

Drainage District Approval

Date

We have reviewed this project and agree it meets minimum requirements.

Charles O. Ay

Permit Administrator

6/19/17

Date

Notice of Construction in Right-of-Way

PROPOSED HDPE INNERDUCT AND FIBER TO BE BORED ALONG THE R.O.W. OF WESTHEIMER PARKWAY FROM 630' WEST OF GREENBUSH RD. TO 800' EAST OF PEEK ROAD. AND ALSO UNDER WESTENFIELD LN.

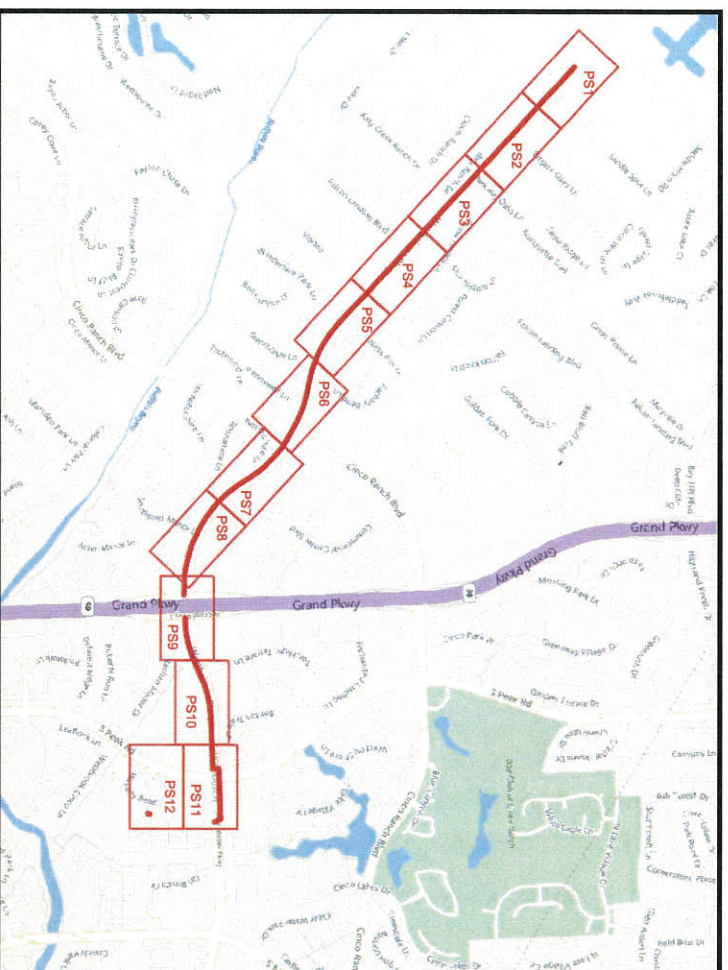

KEY MAP: 485 N, S, T & U



PERMIT ADMINISTRATOR/FORT BEND COUNTY ENGINEERING
P.O. BOX 1449, ROSENBERG, TX 77471

1. COVER SHEET
2. GENERAL NOTES
3. LEGEND
4. PROJECT SHEET 1
5. PROJECT SHEET 2
6. PROJECT SHEET 3
7. PROJECT SHEET 4
8. PROJECT SHEET 5
9. PROJECT SHEET 6
10. PROJECT SHEET 7
11. PROJECT SHEET 8
12. PROJECT SHEET 9
13. PROJECT SHEET 10
14. PROJECT SHEET 11
15. PROJECT SHEET 12
16. PROJECT SHEET 13
17. PROFILE SHEET 1
18. PROFILE SHEET 2
19. PROFILE SHEET 3
20. PROFILE SHEET 4
21. PROFILE SHEET 5
22. GROUNDWATER MONITORING PLAN SHEET
23. GROUNDWATER MONITORING PROFILE SHEET
24. GROUNDWATER MONITORING PROFILE SHEET

PRIOR TO THE PROJECT, THE CONTRACTOR MET WITH THE PROJECT MANAGER AT THE PROJECT OFFICE TO DISCUSS THE PROJECT AND CONSTRUCTION. THE CONTRACTOR WILL MAKE UP A SET OF DRAWINGS TO SUBMIT TO THE PROJECT MANAGER AND THE CONTRACTOR HAS A CLEAR UNDERSTANDING AS TO WHAT IS EXPECTED OF THE CONTRACTOR TO AVOID ANY CONFLICT. CONTRACTS WILL BE DRAFTED BY THE PROJECT MANAGER PRIOR TO ANY CHANGE REQUESTS BEING OFFERED. AGENTS AND ALL UNIDENTIFIED INCIDENTS 5 AND WILL ALSO FOLLOWED WITH AN EALY EXTENDED RECOVERING THE REQUEST.

IT IS THE RESPONSIBILITY OF THE CONTRACTOR TO HAVE A FULL SET OF DRAWINGS, ALL REQUIRED PERMITS AND THE REQUIRED SAFETY ITEMS AT ALL PROJECT LOCATIONS. IT IS THE RESPONSIBILITY OF THE CONTRACTOR TO SUBMIT A COMPLETE SET OF AS-BUILT DRAWINGS TO THE PROVIDED WORKSHEET FOR EACH PROJECT. ALL AS-BUILT DRAWINGS MUST BE IN THE PROJECT FOLDER. THE CONTRACTOR'S WORK AREA MUST BE KEPT CLEAN AND ALL MATERIALS MUST BE STORED PROPERLY. THE CONTRACTOR'S WORK AREA MUST BE KEPT CLEAR OF ALL OBSTRUCTIONS. THE CONTRACTOR'S WORK AREA MUST BE KEPT CLEAR OF ALL OBSTRUCTIONS. THE CONTRACTOR'S WORK AREA MUST BE KEPT CLEAR OF ALL OBSTRUCTIONS.

48 HOURS PRIOR TO CONSTRUCTION CONTACT FPUB@NET.MANAGEMENT TEAM BY EMAIL NOTIFICATION.

48 HOURS PRIOR TO CONSTRUCTION CONTACT SPURBURNET MANAGEMENT TEAM BY EMAIL NOTIFICATION.

TITLE: H0 01008A - SPAN 314 - FORT BEND COUNTY PERM

LOC: WESTHEIMER PARKWAY

REC'D DIRECTOR OF ARMY
FORT BEND COUNTY

PMO# / IGT BUILDING ID:
PM-RENT PERMITS 433-461-1939

DWG: Fort Bend - HO 01008A - SPAN 314.dwg

DRAWINGS	DATE	ENG DESIGN
ORIGINAL	02/03/17	ES

Rev#1	03/02/17	FGS
-------	----------	-----

AS-BUILT	N/A	N/A	PAGE:
----------	-----	-----	-------

EPFL
ÉCOLE POLYTECHNIQUE FÉDÉRALE DE LAUSANNE

OF: FIBERNET

PROPRIETARY INFORMATION OF FPL FIBERNET,LLC

GENERAL NOTES

GENERAL NOTES:

1. CONTRACTOR MUST OBTAIN LOCATES PRIOR TO DISTURBING THE GROUND.
2. THE CONTRACTOR SHALL CONTACT A MEMBER OF TEXAS ONE CALL SYSTEM A MIN. OF 48 HOURS BEFORE DIGGING. YOU ONLY NEED TO CONTACT ONE CENTER. THAT CENTER WILL RELAY THE INFORMATION TO THE OTHER TWO CENTERS.
 - TEXAS ONE CALL 713-223-4567 OR 1-800-245-4545
 - TESS (TEXAS EXCAVATION SAFETY SYSTEM) 811
 - LONE STAR NOTIFICATION SYSTEM 800-669-8344 OR 713-223-4567
- REMINDER : ANY UNDERGROUND FACILITY OWNERS WHO ARE NOT MEMBERS OF TEXAS ONE CALL, TESS OR LONESTAR
3. NOTIFICATION CENTERS IN THE STATE OF TEXAS, MUST BE CONTACTED DIRECTLY BY THE ORIGINATOR OF THE LOCATION REQUEST.
4. CONTRACTOR MUST HAVE A COPY OF THE APPROVED PERMIT FROM THE APPROPRIATE AGENCY ON THE JOBSITE AT ALL TIMES.
5. THE CONTRACTOR SHALL VERIFY THE ROAD R.O.W. AND EASEMENTS PRIOR TO COMMENCING WORK. NO FACILITIES SHOULD BE PLACED ON PRIVATE PROPERTY UNLESS OTHERWISE SPECIFIED.
6. THE CONTRACTOR SHALL DETERMINE THE EXACT LOCATION OF ALL UNDERGROUND FACILITIES BEFORE COMMENCING WORK AND AGREE TO BE FULLY RESPONSIBLE FOR ALL DAMAGES CAUSED BY HIS FAILURE TO EXACTLY LOCATE AND PRESERVE ALL UNDERGROUND FACILITIES.
7. CONTRACTOR SHALL BE RESPONSIBLE FOR DAMAGES TO EXISTING WATER, WASTEWATER AND STORM DRAINAGE LINES. DAMAGES SHALL BE REPAIRED IN ACCORDANCE WITH THE MUNICIPALITY AGENCY (STATE, COUNTY, OR CITY), DEPARTMENT OF PUBLIC WORKS AND ENGINEERING'S STANDARD CONSTRUCTION SPECIFICATIONS FOR WASTEWATER COLLECTION SYSTEMS, WATER LINES, STORM DRAINAGE, AND STREET PAVING AND STANDARD CONSTRUCTION DETAILS FOR WASTEWATER COLLECTION S SYSTEMS, WATER LINES, STORM DRAINAGE, AND STREET PAVING REFERENCED ABOVE, AT NO ADDITIONAL COST.
8. ALL CABLE WILL BE PLACED AT STANDARD MINIMUM DEPTH. (FIBERBNET STANDARD IS 48" DEEP UNLESS OTHERWISE DIRECTED BY A FIBERBNET REPRESENTATIVE.)
9. NO MORE TRENCH OPENED AT ONE TIME THAN CAN BE BACKFILLED AND COMPACTED IN 10" LIFTS AT THE END OF EACH DAY. (NO TRENCH LEFT OPENED OVERNIGHT)
10. ALL EXCESS EXCAVATION TO BE REMOVED FROM THE ROAD RIGHT-OF-WAY AT THE END OF EACH DAY.
11. ADEQUATE DRAINAGE SHALL BE MAINTAINED AT ALL TIMES DURING CONSTRUCTION AND ANY DRAINAGE DITCH OR STRUCTURE DISTURBED DURING CONSTRUCTION SHALL BE RESTORED TO EXISTING CONDITIONS OR BETTER.
12. ROAD MUST BE KEPT OPEN TO TRAFFIC AND CONTRACTOR MUST PROVIDE ADEQUATE FLAGMEN, SIGNALS, ETC., TO PROVIDE COMPLETE SAFETY TO THE PUBLIC. IF IT BECOMES NECESSARY FOR EQUIPMENT TO OPERATE ON A PORTION OF THE PAVEMENT, PRECAUTIONS MUST BE TAKEN TO PREVENT ANY DAMAGE WHATSOEVER TO THE PAVEMENT.
13. CONDITION OF ROAD UPON COMPLETION OF JOB SHALL BE AS GOOD OR BETTER THAN PRIOR TO STARTING
14. CONTRACTOR SHALL COMPLY WITH LATEST EDITION OF OSHA REGULATIONS AND THE STATE OF TEXAS LAWS CONCERNING EXCAVATION.
15. CONTRACTOR SHALL TAKE NECESSARY PRECAUTIONS TO PROTECT ROOT SYSTEMS OF SHRUBS, PLANTS, AND TREES ALONG THE AREA OF EXCAVATION.
16. NO CONSTRUCTION ON PRIVATE PROPERTY WILL COMMENCE UNTIL RIGHT OF ENTRY OR EASEMENT IS GRANTED.
17. CONTRACTOR SHALL NOT EXCEED THE PURCHASE ORDER VALUE WITHOUT AUTHORIZATION IN WRITING FROM THE APPROPRIATE FIBERBNET REPRESENTATIVE ANY LANDSCAPING WILL BE REPLACED TO EQUAL OR BETTER THAN THAT WHICH EXISTED PRIOR TO WORK.
18. PROJECT SITE WILL BE PROPERLY SECURED PRIOR TO THE END OF EACH DAY.
19. ALL WORK IS TO BE IN ACCORDANCE WITH THE STANDARDS OF ALL AUTHORITIES HAVING JURISDICTION IN THE WORK ZONE.
20. CONTRACTORS ARE ADVISED TO CONTACT FIBERBNET FOR ANY ADDITIONAL INFORMATION OR CLARIFICATION CONCERNING SCOPE OF WORK OR THE REQUIREMENTS NECESSARY FOR PROJECT COMPLETION.
21. CONTRACTOR SHALL FIELD VERIFY ALL DIMENSIONS, QUANTITIES AND EXISTING CONDITIONS PRIOR TO CONSTRUCTION. IF A SIGNIFICANT CHANGE TO THE RUNNING LINE IS NEEDED, PLEASE CONTACT YOUR FIBERBNET REPRESENTATIVE BEFORE PROCEEDING.
22. BEFORE CONSTRUCTION BEGINS, CONTRACTOR SHALL TAKE APPROPRIATE PRECAUTIONS TO AVOID ANY POTENTIAL OBSTRUCTIONS PRIOR TO PROCEEDING WITH WORK.
23. CONTRACTOR SHALL TAKE NECESSARY PRECAUTIONS TO PROTECT ROOT SYSTEMS OF SHRUBS, PLANTS, AND TREES ALONG THE AREA OF EXCAVATION.
24. CONTRACTOR WILL COMPLETE ALL WORK PER "FIBERBNET" CONSTRUCTION SPECIFICATIONS.
25. CONTRACTOR SHALL MAINTAIN A SET OF RECONSTRUCT DRAWINGS RECORDING AS-BUILT CONDITIONS DURING CONSTRUCTION. THESE RECONSTRUCT MARKED UP DRAWINGS WILL BE SUBMITTED TO THE DESIGN CONSULTANT WHO WILL MAKE THE CHANGES ON THE AS-BUILT RECORD DRAWINGS.

ABBR	DESCRIPTION
B.O.	BUILDING OWNED
B.O.C.	BUILDING OWNED CONDUIT
EOC	EDGE OF CURB
EMT	ELECTRIC METALLIC TUBING
EOP	EDGE OF PAVEMENT
FDP	FIBER DISTRIBUTION PANEL
FF	FINISHED FLOOR
FMC	FLEXIBLE METALLIC CONDUIT
GRC	GALVANIZED RIGID CONDUIT
HDPE	HIGH DENSITY POLYETHYLENE
HH	HANDHOLE
JH	JUNCTION BOX
MH	MANHOLE
PB	PULLBOX
PL	PROPERTY LINE
PVC	POLYVINYL CHLORIDE
ROW	RIGHT OF WAY
SP	SPLICE PANEL
STA	STATION
SW	SIDEWALK

APWA STANDARD

COLOR CODE FOR TEMPORARY MARKING OF UNDERGROUND FACILITIES:

RED = ELECTRIC POWERLINES, CABLES, CONDUIT, AND LIGHTING CABLES
YELLOW = GAS, OIL, STEAM, PETROLEUM, OR GASEOUS MATERIAL
ORANGE = COMMUNICATION, ALARM, OR SIGNAL LINES, CABLES, OR CONDUIT
BLUE = POTABLE WATER
GREEN = SEWER AND DRAIN LINES
PURPLE = RECLAIMED WATER, IRRIGATION, AND SLURRY
PINK = TEMPORARY SURVEY MARKINGS
WHITE = PROPOSED EXCAVATION

Know what's below.
Call before you dig.



TITLE: NO DIBOLA - SPAN 314 - FORT BEND COUNTY RESUB	
TGC: WESTHEIMER PARKWAY	
PROJECT FOR BLDG DING TO	
NO. BENT PERMITS TO DIBOLA	SPAN 314.dwg
DRAWING	END DESIGN
DATE	DATE
02/08/17	02/08/17
ASBUILT	N/A
PAGE: 2	
OF: 22	

PROPRIETARY INFORMATION OF FPL FIBERNET, LLC



		POLE NO. 1 ATTACHMENT 00.207	POLE ATTACHMENT EXISTING
		POLE NO. 1 ATTACHMENT 00.207	POLE ATTACHMENT PROPOSED
0400 RUBBO	JOINT USE POLE		STRAND FTG. EXISTING
0400 RUBBO	JOINT USE POLE W/ TRANSFORMER	P-6a FTB	STRAND FTG. PROPOSED
0400 RUBBO	POWER POLE		
0400 RUBBO	POWER POLE W/ TRANSFORMER	P-6a FTB	
0400 RUBBO	STEEL POLE		
0400 RUBBO	CONCRETE POLE		
0400 RUBBO	TELCO POLE		
0400 RUBBO	PROPOSED TELCO POLE		
0400 RUBBO	EXISTING RISER		
0400 RUBBO	PROPOSED RISER		
0400 RUBBO	EXISTING DOWN GUY & ANCHOR		
0400 RUBBO	PROPOSED DOWN GUY & ANCHOR		
0400 RUBBO	EXISTING DOWN GUY		
0400 RUBBO	PROPOSED DOWN GUY		
0400 RUBBO	EXISTING SAW GUY & ANCHOR		
0400 RUBBO	PROPOSED SAW GUY & ANCHOR		
0400 RUBBO	EXISTING SAW GUY		
0400 RUBBO	PROPOSED SAW GUY		
0400 RUBBO	EXISTING EXTENDED MESSENGER		
0400 RUBBO	PROPOSED EXTENDED MESSENGER		
0400 RUBBO	EXISTING OVERHEAD GUY		
0400 RUBBO	PROPOSED OVERHEAD GUY		

[illegible]

CAUTION!
KINDER MORGAN GAS
PIPELINE
1-800-633-0184

NOTE:
THE FIRST SECTION OF THIS PORT BEND COUNTY PERMIT STARTS
HERE. FIBERNET DIRECT HAS SUBMIT ANOTHER PORT BEND
COUNTY PERMIT TO CONTINUE NORTHWEST ON WESTHEIMER
PARKWAY. THE FIBER ROUTE SHOWN CONTINUING NORTHWEST ON
WESTHEIMER PARKWAY IS FOR REFERENCE ONLY.

NOTE:
SEE FUTURE IMPROVEMENT SHEETS (SHEET 21 & 22 OF 22) FOR PLAN
AND PROFILE OF THIS INTERSECTION PRIOR TO START OF CONSTRUCTION.

PRODUCT CONSTRUCTION NOTES:

1. ALL PROPOSED U/G CONSTRUCTION SHOWN IN RED ON THIS PLAN WILL INCLUDE BORING THREE (3) HOPE INNOVATORS AND ONE FIBER CABLE.
2. FIBER OPTIC SHOULD BE MINIMUM 48-INCHES UNDER NATURAL GROUND OR MINIMUM 60-INCHES UNDER PAVEMENT (INCLUDING ALL PUBLIC CROSS STREETS), WHICHEVER IS GREATER.
3. ALL PROPOSED HOV HOLES ARE 24"x36"x20" WITH 100' OF BEEB SLACK LOOP, UNLESS OTHERWISE INDICATED.

SEE PROJECT SHEET 2



SEE PROJECT SHEET 1

EMPIRE OAKS LN.

COFFEE BEND

CAUTION: BE SHOWN. EXACT LOCATION OF PIPELINES IS UNKNOWN. CONTACT PIPELINE COMPANIES FOR VERIFICATION PRIOR TO STARTING CONSTRUCTION.

CAUTION: BE SHOWN. EXACT LOCATION OF PIPELINES IS UNKNOWN. CONTACT PIPELINE COMPANIES FOR VERIFICATION PRIOR TO STARTING CONSTRUCTION.

SEE PROJECT SHEET 3

CELL TOWER

BETOND PARADISE
NURSERY 7 GARDEN
CENTER
25445 WESTHEIMER PARKWAY

CAUTION!
ALL PIPELINES MAY NOT BE SHOWN.
EXACT LOCATION OF PIPELINES IS
UNKNOWN. CONTACT PIPELINE
COMPANIES FOR VERIFICATION PRIOR
TO STARTING CONSTRUCTION.

SEE PROJECT SHEET 3

19+80 → HH
FIBERNET
HANDHOLE
24x36x30

 $\text{H}-\text{H} = 115^\circ$
 $\text{C}-1.25^\circ$

TITLE: NO 010004 - SPAN 314 - FORT BEND COUNTY PRUIT LOC: WESTHEIMER PARKWAY PROJECT: FORT BEND COUNTY DRAWING: FORT BEND - R32-481-0332 DWG: FORT BEND - NO 010004 - SPAN 314.dwg		DATE: 02/09/17 ORIGINAL: 03/09/17 REV#1: N/A AS-BUILT: N/A		END DESIGN: PCS PCS PCS N/A		PAGE: 5 OF: 22	
PROPRIETARY INFORMATION OF FPI FIBERNET,LLC							
							

SEE PROJECT SHEET 3

CAUTION:
ALL PIPELINES MAY NOT BE SHOWN.
EXACT LOCATION OF PIPELINES IS
UNKNOWN AND FIELD SURVEYORS
RECOMMEND CONTRACTOR
COMPANIES FOR VERIFICATION PRIOR
TO STARTING CONSTRUCTION.

CAUTION:
UNDER MICHIGAN GAS
REGULATIONS,
1-800-553-0164

RUSHWIND CT.

LAUREL CHASE LN.

BARTON MEADOW LN.

AUTUMNGLOW CT.

FALCON HILL LN.

SEE PROJECT SHEET 5

SEE PROJECT SHEET 5

[illegible]

TITLE: NO 01000A - SPAN 314 - FORT BEND COUNTY PENIT			
LOC: WESTHEIMER PARKWAY			
COUNTY: FORT BEND COUNTY			
PROJECT: FORT BEND COUNTY			
PLAN: BENT PERMITE: N32-481-1232			
DWG: P&T Brand - SPAN 314.dwg			
ORIGINAL	DATE	ENG DESIGN	
02/05/17		PSS	
RAWN	03/02/17	PSS	
ASBULL	N/A	N/A	
		PAGE: 7	
OFF:		OF: 22	
PROPRIETARY INFORMATION OF FBI FIBERNET, LLC			

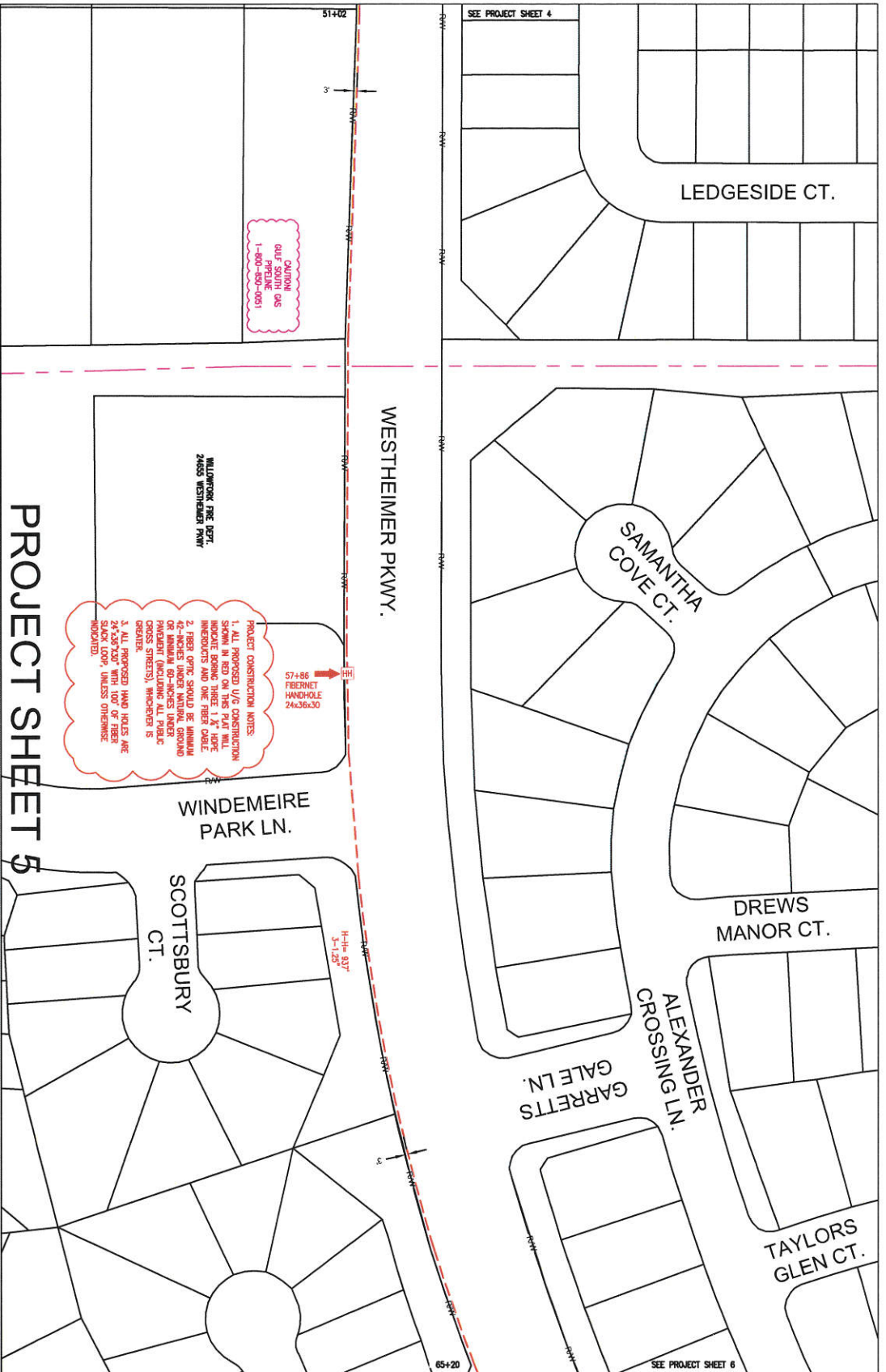

PROJECT SHEET 5

CALL FOR
GULF SOUTH GAS
PRELINE
1-800-850-0051

WILLIAMS FIRE DEPT
24655 WESTHEIMER PKWY

PROJECT CONSTRUCTION NOTES:
1. ALL PROPOSED U/G CONSTRUCTION SHALL BE 18\"/>

57+86
FIBERNET
HANDHOLE
24x36x30

WINDEMEIRE
PARK LN.

SCOTTSBURY
CT.

LEDGESIDE CT.

SAMANTHA
COVE CT.

DREWS
MANOR CT.

ALEXANDER
CROSSING LN.

GARRETT'S
GALE LN.

TAYLORS
GLEN CT.



TITLE: HO DRINKA - SPAN 314 - FORT BEND COUNTY PERMIT	
LOC: WESTHEIMER PARKWAY	
PROJECT: FORT BEND COUNTY	
DRAWING: FIBERNET 100-401-2331 SPAN 314.dwg	
DESIGNED BY	ENG. DESIGN
DATE	02/03/17
ORIGINATOR	02/03/17
ASBUILT	N/A
PAGE: 8	OF: 22



PROPRIETARY INFORMATION OF FPL FIBERNET, LLC

REDEEMER COMMUNITY
CHURCH
24201 WESTHEIMER PKWY

AUTUMN LEAVES
24024 WESTHEIMER PKWY

23600 WESTHEIMER PKIN

CAPITAL ONE BANK
23910 WESTHEIMER PKWY

CHICK-FILA
23660 WESTHEIMER PKWY

SEE PROJECT SHEET 8

1. ALL PROPOSED U/G CONSTRUCTION SHOWN IN RED ON THIS PLAY WILL INDICATE BORING THERE IS 1" HOPE INNERDOTS AND ONE FIBER CABLE.
2. FIBER OPTIC SHOULD BE MINIMUM 42-INCHES UNDER NATURAL GROUND OR MINIMUM 60-INCHES UNDER PAVEMENT (INCLUDING ALL PUBLIC CROSS STREETS), WHICHEVER IS GREATER.
3. ALL PROPOSED HAND HOLES ARE 24"x36"x20" WITH TOP OF FIBER SLACK LOOP, UNLESS OTHERWISE INDICATED.

WESTHEIMER PKWY

COMMERCIAL
CENTER BLVD.

PROJECT SHEET 7

GILFORD LN.

KINWICKE
CT.

BROWDALE
CT.

TITLE: NO 010064 - SPAN 314 - FORT BEND COUNTY PENALT	
LOC: WESTHEIMER PARKWAY	
FRT BEND COUNTY	
DRAWING NO: 010064-01-01-032	
DWG: FRT BEND - NO 010064 - SPAN 314.dwg	
DRAWING	DATE
ORIGINAL	02/03/17
Revised	02/07/17
AS-BUILT	N/A
ENG DESIGN	
FCS	
FCS	
N/A	
PAGE:	
OF:	10
22	

23802 WESTHEIMER PRIN

BROWNDAL
CT.

ALLINGHAM LN.

PROJECT SHEET 8

SOUTHFORD
MANOR LN.

WESTHEIMER PKWY

CHASE
23550 WESTHEIMER PKWY

WHITABURGER
23540 WESTHEIMER PKWY

CVS PHARMACY
3050 GRAND PAVIN

6. 12

23557 WESTHEIMER PKWY

WELLS FARGO
23525 WESTHEIMER PKWY

PRODUCT CONSTRUCTION NOTES:

1. ALL PROPOSED U/G CONSTRUCTION SHOWN IN RED ON THIS PLAN WILL INCLUDE BRICKING THREE 1" X 4" HIPS, INTERLOCKS AND ONE FIBER CABLE.
2. FIBER OPTIC SHOULD BE INSTALLED IN A DEDICATED DUCT OR CONDUIT OR UNBUILT 80-BOXES (FIBER PAYMENT) (INCLUDING ALL PLUMBING CROSS STREETS), WHICHEVER IS GREATER.
3. ALL PROPOSED HAND HOLES ARE 24"x36"x30" WITH 10" OR FIBER SLACK LOOP, UNLESS OTHERWISE INDICATED.

H-H = 10.45"
3-1.25"

100+10
FIBERNET
HANDHOLE
24x36x30

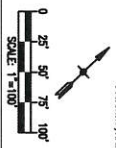
[illegible]

SH 99
(PARKWAY)

WESTHEIMER PKWY.

WESTHEIMER PKWY

SH 99
(PARKWAY)

PROJECT SHEET 9

GARDEN
COVE CT

RACHELS
MANOR DR.

GRAND WESTHEIMER
ANIMAL HOSPITAL
23245 WESTHEIMER PKWY

METRO MINI STORAGE
23250 WESTHEIMER PKWY

KOLACHE FACTORY
23240 WESTHEIMER PKWY

SEE PROJECT SHEET 10

PRODUCT CONSTRUCTION NOTES:

1. ALL PROPOSED U/G CONSTRUCTION SHOWN IN RED ON THIS PLAN WILL INDICATE BORING ONE 1 1/2" HOLES AND ONE FIBER CABLE.
2. FIBER OPTIC SHOULD BE MINIMUM 42-INCHES UNDER NATURAL GROUND FOR MINIMUM 60-INCHES UNDER PAVEMENT (INCLUDING ALL PUBLIC CROSS STREETS), WHICHEVER IS GREATER.
3. ALL PROPOSED HAD HOLES ARE 24"x36"x30" WITH TOP OF FIBER SLACK LOOP, UNLESS OTHERWISE INDICATED.

CAUTION!
ALL PIPELINES MAY NOT BE SHOWN.
EXACT LOCATION OF PIPELINES IS
UNKNOWN. CONTACT PIPELINE
COMPANIES FOR VERIFICATION PRIOR
TO STARTING CONSTRUCTION.

KINDER MORGAN GAS
PIPELINE
1-800-633-0184

**ENERGY TRANSFER GAS
PIPELINE**
1-800-392-1965

116+45
FIBERNET
HANDHOLE
24x36x30

REGIONS
23343 WESTHEIMER PKIN

110+5
FIBERN
HANDH
24x36x

NOTE: THE FIRST SECTION OF THIS FORT BEND COUNTY PERMIT STOPS HERE. FIBERNET DIRECT WILL SUBMIT A TDOOT PERMIT TO CONTINUE EAST UNDER GRAND PARKWAY(29). THE FIBER ROUTE SHOWN CONTINUING EAST UNDER GRAND PARKWAY IS FOR REFERENCE ONLY.

NOTE: THE SECOND SECTION OF THIS ROUTE BEHIND COUNTY PERMIT STANDS HERE. FIBERGLASS DIRECT WILL SUBMIT A TROUT PERMIT TO CONTINUE WEST UNDER GRAND PARKWAY(99). THE FIBER ROUTE SHOWN CONTINUING WEST UNDER GRAND PARKWAY IS FOR REFERENCE ONLY.

Call before you dig



0 25' 50' 75' 100'

SCALE: 1"=100'

TITLE: HO 0000A - SPAN 314 - PORT BEND COUNTY FERTIL	
LOC: WESTHEIMER PARKWAY	
PARCEL # 01 BLDG ID	
MATERIAL: PORT BEND COUNTY	
Pkg Brand Period: 03-49-2322	
Pkg For Brand: HO 0000A - SPAN 314.dwg	
DRAWING	DATE
ORIGINAL	02/02/17
Revised	03/02/17
AS-BUILT	N/A
	ENG DESIGN
	F/S
	N/A
PAGE: 12	
OF: 22	
	
PROPRIETARY INFORMATION OF FPR FIBERNET LLC	

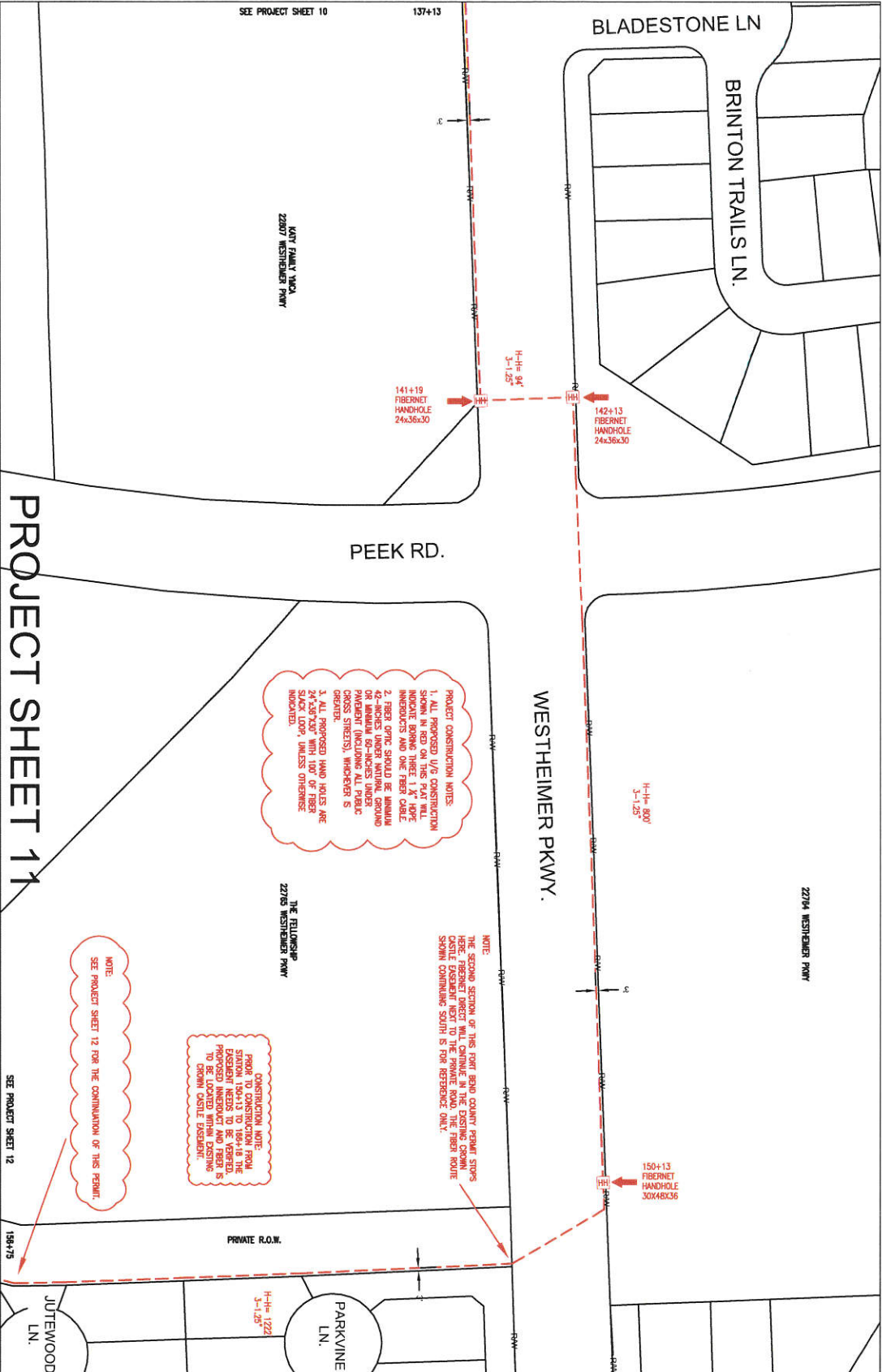

PROJECT CONSTRUCTION NOTES:

1. ALL PROPOSED U/O CONSTRUCTION SHOWN IN RED ON THIS PLAN WILL INDICATE BROWNS THREE 1 1/2" HOPE INNEBROCKS AND ONE FIBER CABLE.
2. FIBER OPTIC SHOULD BE MINIMUM 1/2" BROWNS THREE 1 1/2" HOPE INNEBROCKS AND ONE FIBER CABLE.
3. ALL PROPOSED HAND HOLES ARE 24" X 36" WITH TOP OF FIBER 24" X 36" UNLESS OTHERWISE INDICATED.

NOTE:
THE SECOND SECTION OF THIS FORT BEND COUNTY PERMIT STOPS HERE. FIBERNET DIRECT WILL CONTINUE IN THE EXISTING DROWN CASTLE EXHIBIT NEXT TO THE PRIVATE ROAD. THE FIBER ROUTE SHOWN CONTINUING SOUTH IS FOR REFERENCE ONLY.

CONSTRUCTION NOTE:
PROPOSED CONSTRUCTION FROM STATION 100+13 TO 100+18. THE EXISTING INNEBROCKS AND FIBER IS TO BE REMOVED AND REPLACED TO BROWN CASTLE EXHIBIT.

NOTE:
SEE PROJECT SHEET 12 FOR THE CONTINUATION OF THIS PERMIT.

PROJECT SHEET 11

TITLE: NO 00084 - SPAN 314 - FORT BEND COUNTY PERMIT	
LOC: WESTHEIMER PARKWAY	
PORT BEND COUNTY	
PROJECT NO: 00084	
DRAWING NO: 00084-314-001	
DATE: 07/03/17	
DESIGNER: FPL	
CHECKED: FPL	
APPROVED: FPL	
PAGE: 14	
OF: 22	



PROJECT CONSTRUCTION NOTES:

1. ALL PROPOSED V/G CONSTRUCTION SHOWN IN RED ON THIS PLAN WILL INDICATE BORING THREE 1 1/2" HOLE INTERDUGS AND ONE FIBER CABLE.

2. FIBER OPTIC SHOULD BE MINIMUM 42-INCHES UNDER NATURAL GROUND OR MINIMUM 60-INCHES UNDER PAVEMENT (INCLUDING ALL PUBLIC CROSS STREETS), WHICHEVER IS GREATER.

3. ALL PROPOSED HAND HOLES ARE 24 X 26 X 100" WITH 100' OF FIBER SLACK LOOP, UNLESS OTHERWISE INDICATED.

CONSTRUCTION NOTE:
PRIOR TO CONSTRUCTION FROM
STATION 150+13 TO 166+18 THE
EASEMENT NEEDS TO BE VERIFIED.
PROPOSED INNERDUCT AND FIBER IS
TO BE LOCATED WITHIN EXISTING
CROWN CASTLE EASEMENT.

CONSTRUCTION NOTES

PROJECT SHEET 12

NOTE:
THE THIRD AND LAST SECTION OF THIS FORT BEHIND
COUNTRY PERMIT STARTS AND STOPS HERE. THE FIBER
ROUTE SHOWN CONTINUING NORTH AND SOUTH IN
THE CROWN CASTLE EASEMENT IS FOR REFERENCE
ONLY.

PRIVATE R.O.W.

CROWNFIELD
LN.

TITLE:	NO 010084 - SPAN 314 - PORT BEND COUNTY PERMIT
LOC:	WESTHEIMER PARKWAY PORT BEND COUNTY BROOKHOLM TEXAS 78112
DWG. NO.	BRENT PERMIT - 15-491-2332
DWG. FILE #	Bend - NO 010084 - SPAN 314.dwg
DATE	02/03/17
DESIGNER	FCS
CHECKED BY	FCS
APPROVED BY	N/A
PAGE:	15 OF 22

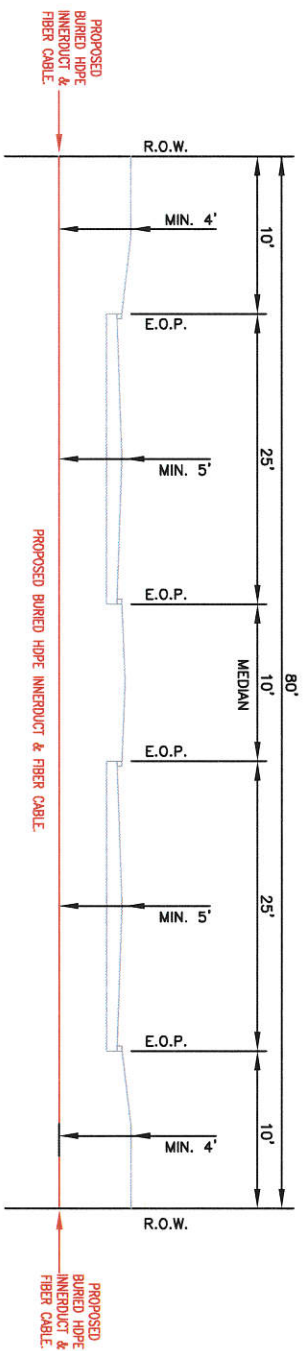
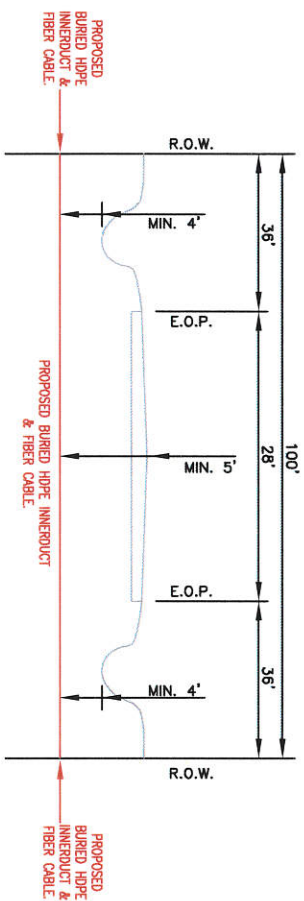
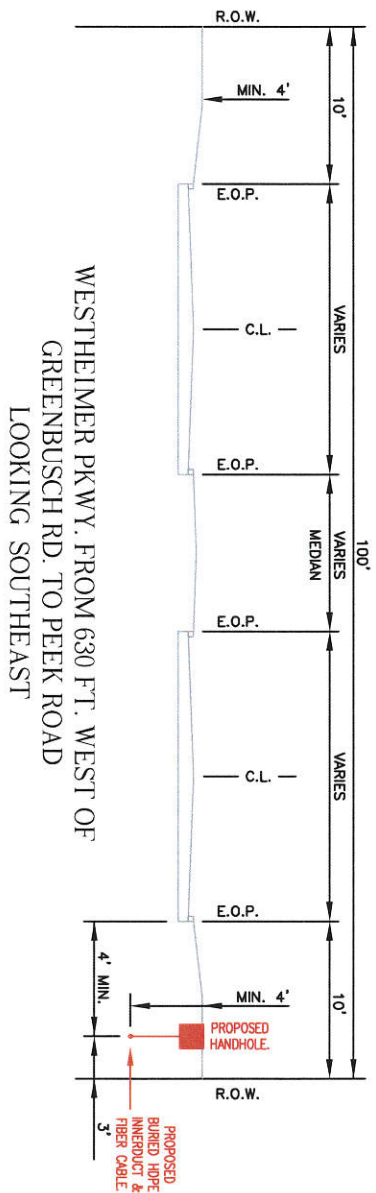

SEE FUTURE IMPROVEMENT PLAN AND
PROFILE SHEETS (SHEETS 21 & 22 OF 22),
FOR MORE INFORMATION ABOUT THE
GREENBUSH RD. INTERSECTION PRIOR TO
CONSTRUCTION.

TITLE: HO 00064 - SPAN 314 - PORT BEND COUNTY PERMIT	
LOC: WESTHERS PARKWAY MADISON COUNTY	
PROJECT: RISE BUILDING	
DWG. FIBER PERIOD: 833-491-2232	
DWG. FOR: Bend - HO 00064 - SPAN 314.dwg	
DATE: 02/05/17	ENG DESIGN
ORIGINAL	PS
REV: 01/17	PS
AS-BUILT	N/A
PAGE: 16	OF: 22

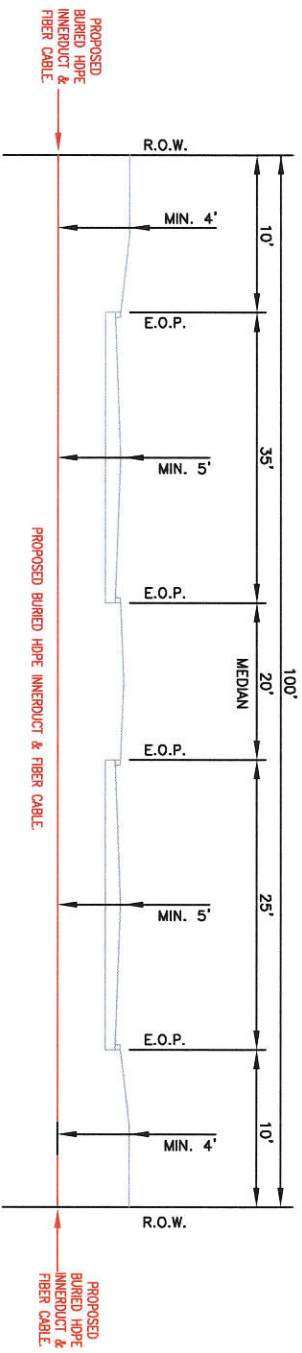

FALCON LANDING BLVD. @ WESTHEIMER PKWY.
LOOKING SOUTHWEST

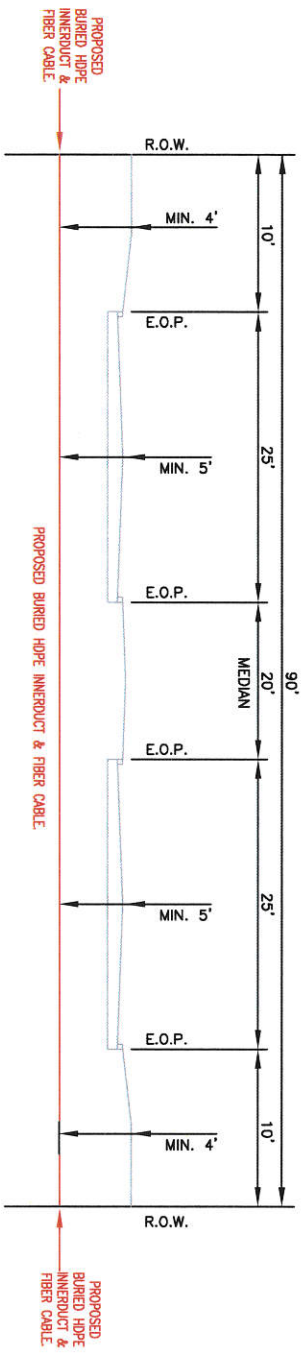

WINDEMEIRE PARK LN. @ WESTHEIMER PKWY.
LOOKING SOUTHWEST

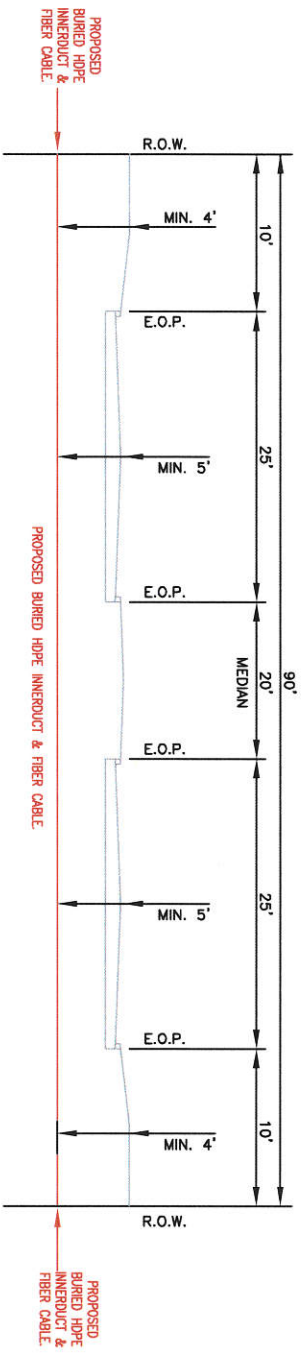

GLENTHORPE LN. @ WESTHEIMER PKWY.
LOOKING SOUTHWEST

PROFILE SHEET 2

TITLE: HO CROSS - SPAN 314 - FORT BOND COUNTY PERMIT	
LOC: WESTHEIMER PARKWAY	
PROJECT: FORT BOND COUNTY	
PROJ. NO: 2017-001-001	
PROJ. NAME: SPAN 314	
DATE: 02/07/17	END DESIGN
DESIGNER: FCS	
CLIENT: N/A	
AS-BUILT: N/A	
PAGE: 17	
OF: 22	

PROPRIETARY INFORMATION OF FPL FIBERNET, LLC

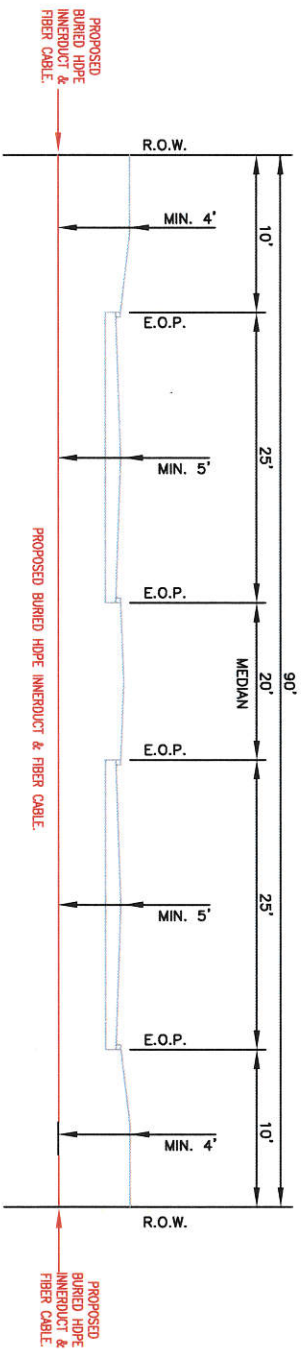
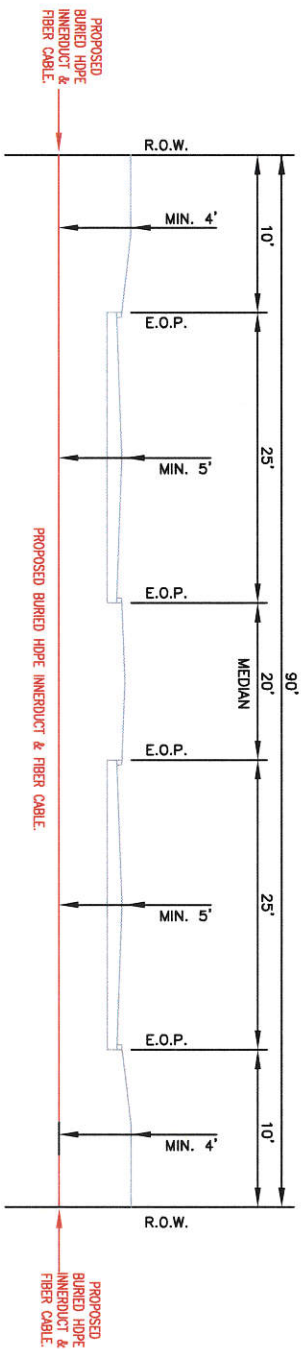
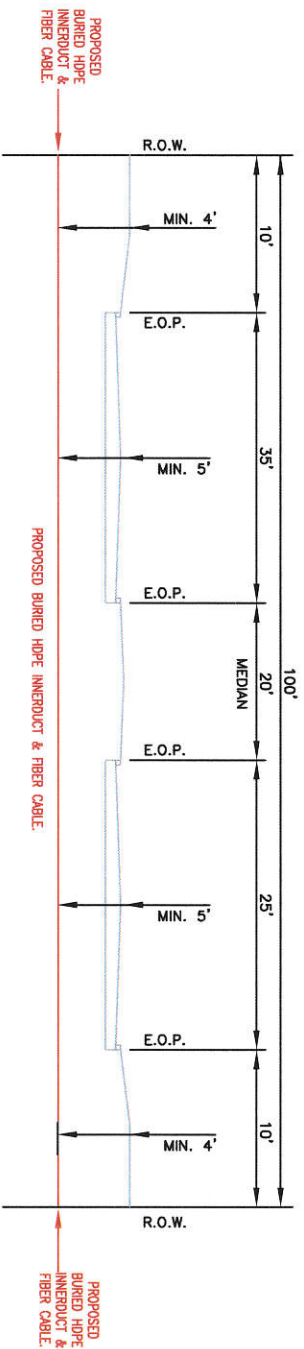

PROFILE SHEET 3

TITLE: NO DROGA - SPAN 314 - FORT BEND COUNTY PERMIT	
TDC: WESTHEIMER PARKWAY	
FORT BEND COUNTY	
PROJECT FOR BUILDING ID:	
DRAWING: PROFILE BY DATE: 02/07/17	
DRAWING: DATE: 02/07/17	
ORIGINAL: 02/07/17	
REVISION: 02/07/17	
AS-BUILT: N/A	
PAGE: 18	
OF: 22	

PROPRIETARY INFORMATION OF FPL FIBERNET, LLC

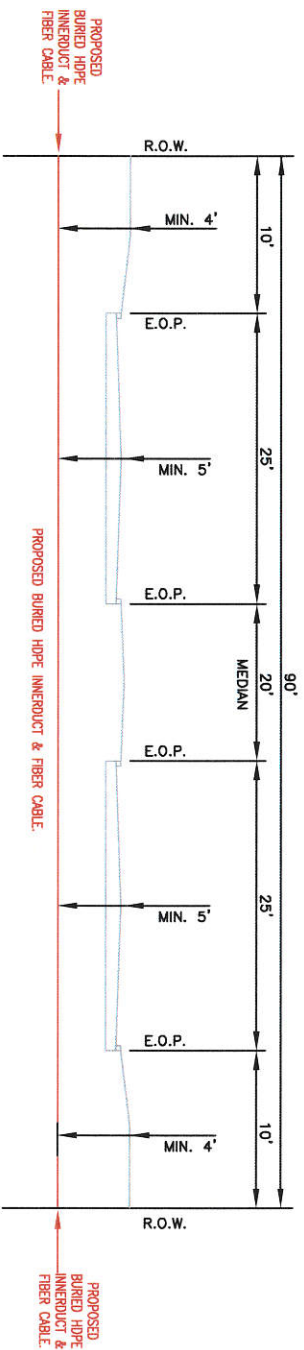

RACHELS MANOR DR. @ WESTHEIMER PKWY.
LOOKING SOUTHWEST

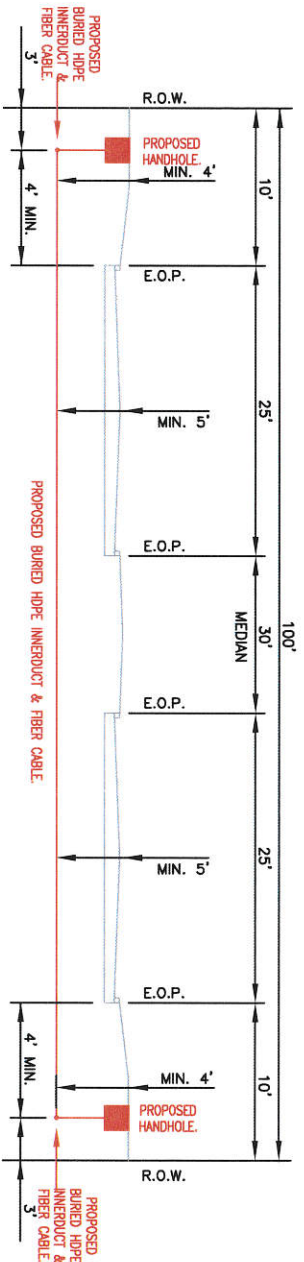

WESTHEIMER PKWY. 102 FT. WEST OF PEEK RD.
LOOKING WEST

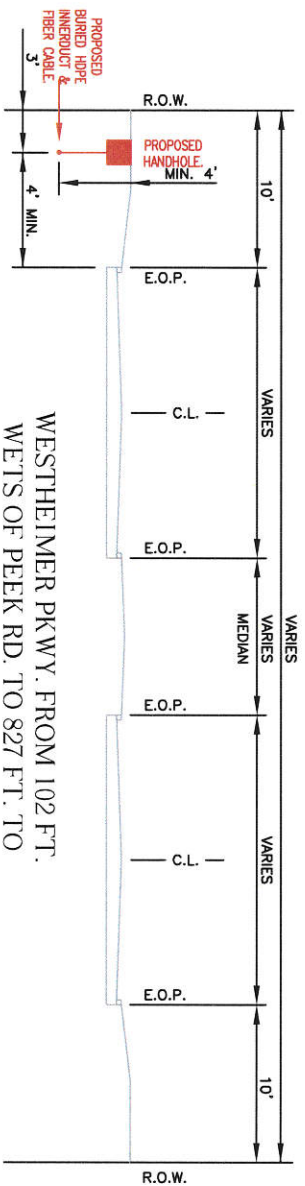

WESTHEIMER PKWY. FROM 102 FT.
WEST OF PEEK RD. TO 827 FT. TO
THE EAST
LOOKING EAST

PROFILE SHEET 4

TITLE: HO 0100A - SPAN 314 - FORT BEND COUNTY PERMIT	
LOC: WESTHEIMER PARKWAY	
DRAWN BY: J. L. B. / J. L. B.	
CHECKED BY: J. L. B. / J. L. B.	
DATE: 02/09/17	
PROJECT: HO 0100A - SPAN 314	
DESIGN: J. L. B. / J. L. B.	
CONSTRUCTION: J. L. B. / J. L. B.	
AS-BUILT: N/A	
PAGE: 19	
OF: 22	



PROFILING INFORMATION OF FIBERNET, LLC

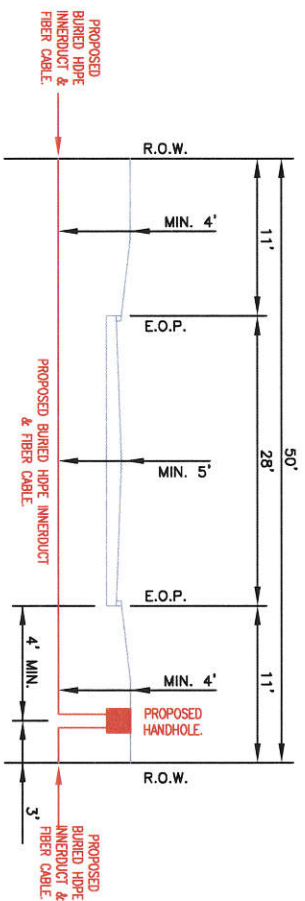
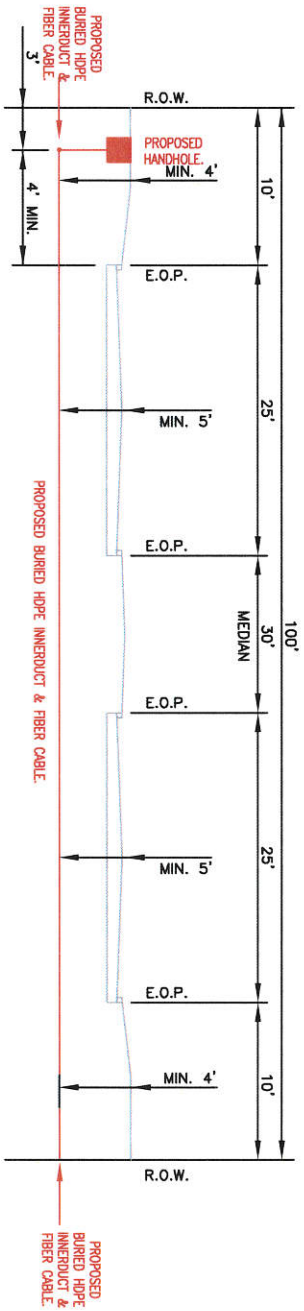
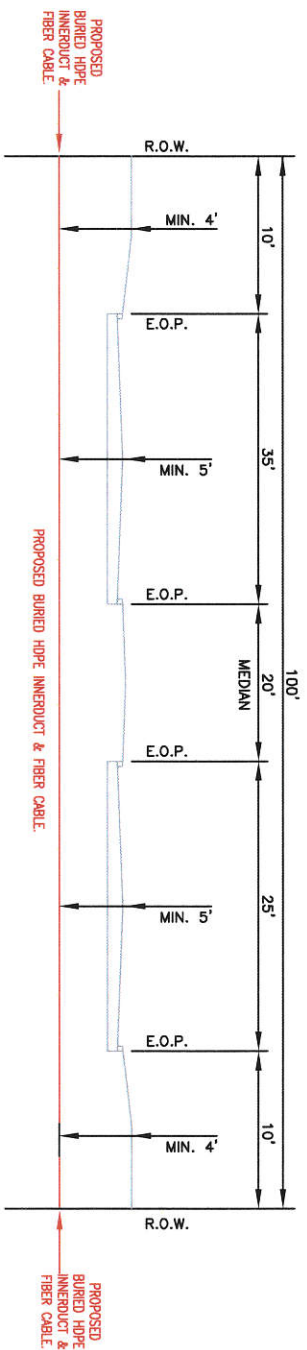

PROFILE SHEET 5

TITLE: NO 000A - SPAN 314 - FORT BEND COUNTY PERMIT	
LOC: WESTHEIMER PARKWAY	
PROJECT: FORT BEND COUNTY	
DRAWN BY: J. B. BROWN	
CHECKED BY: J. B. BROWN	
DATE: 02/08/17	
ORIGIN: SPAN 314.dwg	
DESIGN: FCS	
AS-BUILT: N/A	
PAGE: 20	
OF: 22	



PROPRIETARY INFORMATION OF FPL FIBERNET, LLC



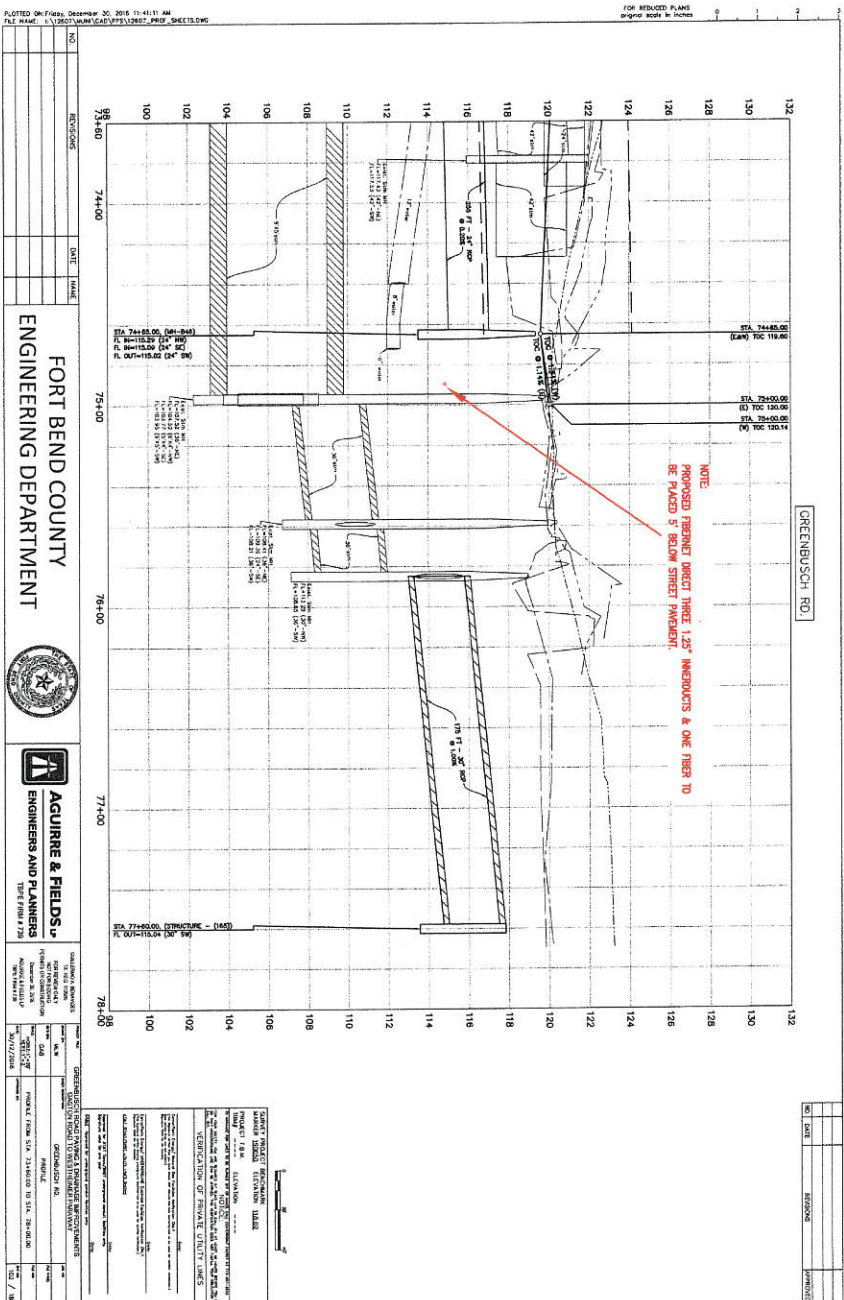

Notes for Figure 6H-1—Typical Application 1 Work Beyond the Shoulder

Guidance:

1. *If the work space is in the median of a divided highway, an advance warning sign should also be placed on the left side of the directional roadway.*

Option:

2. The ROAD WORK AHEAD sign may be replaced with other appropriate signs such as the SHOULDER WORK sign. The SHOULDER WORK sign may be used for work adjacent to the shoulder.
3. The ROAD WORK AHEAD sign may be omitted where the work space is behind a barrier, more than 24 inches behind the curb, or 15 feet or more from the edge of any roadway.
4. For short-term, short duration or mobile operation, all signs and channelizing devices may be eliminated if a vehicle with activated high-intensity rotating, flashing, oscillating, or strobe lights is used.
5. Vehicle hazard warning signals may be used to supplement high-intensity rotating, flashing, oscillating, or strobe lights.

Standard:

6. Vehicle hazard warning signals shall not be used instead of the vehicle's high-intensity rotating, flashing, oscillating, or strobe lights.

Figure 6H-1. Work Beyond the Shoulder (TA-1)

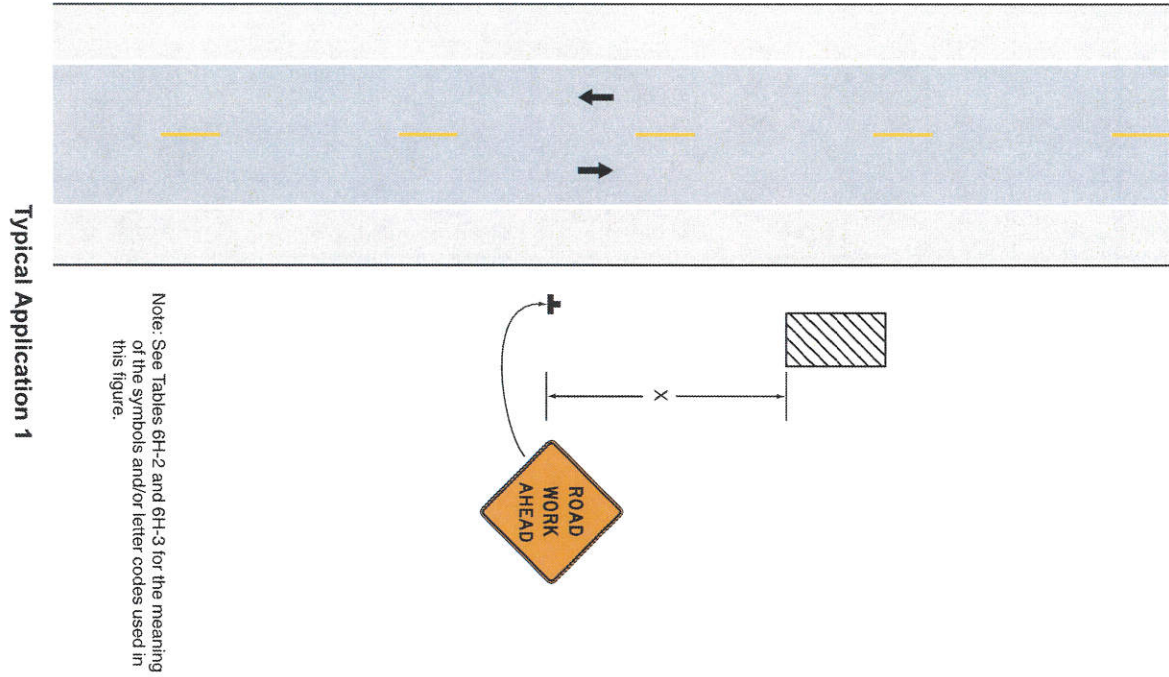

Notes for Figure 6H-3—Typical Application 3 Work on the Shoulders

Guidance:

1. *A SHOULDER WORK sign should be placed on the left side of the roadway for a divided or one-way street only if the left shoulder is affected.*

Option:

2. The Workers symbol signs may be used instead of SHOULDER WORK signs.
3. The SHOULDER WORK AHEAD sign on an intersecting roadway may be omitted where drivers emerging from that roadway will encounter another advance warning sign prior to this activity area.
4. For short duration operations of 60 minutes or less, all signs and channelizing devices may be eliminated if a vehicle with activated high-intensity rotating, flashing, oscillating, or strobe lights is used.
5. Vehicle hazard warning signals may be used to supplement high-intensity rotating, flashing, oscillating, or strobe lights.

Standard:

6. Vehicle hazard warning signals shall not be used instead of the vehicle's high-intensity rotating, flashing, oscillating, or strobe lights.
7. When paved shoulders having a width of 8 feet or more are closed, at least one advance warning sign shall be used. In addition, channelizing devices shall be used to close the shoulder in advance to delineate the beginning of the work space and direct vehicular traffic to remain within the traveled way.

Figure 6H-3. Work on the Shoulders (TA-3)

