



**REVIEW BY FORT BEND COUNTY  
COMMISSIONERS COURT**

14K  
**Fort Bend County  
Engineering Department**  
301 Jackson Suite 401  
Richmond, Texas 77469  
281.633.7500  
Permits@fortbendcountytexas.gov

- ☒ Right of Way Permit  
☐ Commercial Driveway Permit

Permit No: 2017-14194

**Applicant:** Clearwater Utilities, Inc.

**Job Location Site:** Harlem Road, Katy, TX 77406

**Bond No.**                      **Date of Bond:** 1/10/2017 **Amount:** \$50,000.00

The above applicant came to make use of certain Fort Bend County property subject to, "The Order Regulating the Laying, Construction, Maintenance, and Repair of Buried Cables, Conduits, and Pole Lines, In, Under, Across or Along Roads, Streets, Highways, and Drainage Ditches in Fort Bend County, Texas, Under the Jurisdiction of the Commissioners Court of Fort Bend County, Texas," as passed by the Commissioners Court of Fort Bend County, Texas, of the Minutes of the Commissioners Court of Fort Bend County, Texas, to the extent that such order is not inconsistent with Chapter 181, Vernon's Texas Statutes and Codes Annotated.

**Notes:**

1. Evidence of review by the Commissioners Court must be kept on the job site and failure to do so constitutes grounds for job shutdown.
2. Written notices are required:
  - a. 48 hours in advance of construction start up, and
  - b. When construction is completed and ready for final inspection, submit notification to Permit Administrator thru MyGovernmentOnline.org portal.
3. This permit expires one (1) year from date of permit if construction has not commenced.

On this 27th day of June, 2017, Upon Motion of Commissioner Morales, seconded by Commissioner Prestage, duly put and carried, it is ORDERED, ADJUDGED AND DECREED that said notice of said above purpose is hereby acknowledged by the Commissioners Court of Fort Bend County, Texas, and that said notice be placed on record according to the regulation order thereof.

**Signature**

Presented to Commissioners Court and approved.

By: Charles O. Ay  
for County Engineer

Date Recorded 7-5-2017 Comm. Court No. 14K

N/A  
By: \_\_\_\_\_  
Drainage District Engineer/Manager

Clerk of Commissioners Court  
By: Armando Willes  
Deputy



**PERMIT APPLICATION REVIEW FORM FOR  
CABLE, CONDUIT, AND POLE LINE ACTIVITY  
IN FORT BEND COUNTY**

**Fort Bend County  
Engineering Department**  
301 Jackson Suite 401  
Richmond, Texas 77469  
281.633.7500  
Permits@fortbendcountytx.gov

- ☒ Right of Way Permit  
☐ Commercial Driveway Permit

Permit No: 2017-14194

The following "Notice of Proposed Cable, Conduit, and/or Pole Line activity in Fort Bend County" and accompanying attachments have been reviewed and the notice conforms to appropriate regulations set by Commissioner's Court of Fort Bend County, Texas.

**(1) COMPLETE APPLICATION FORM:**

- ☒ a. Name of road, street, and/or drainage ditch affected.  
☒ b. Vicinity map showing course of directions  
☒ c. Plans and specifications

**(2) BOND:**

- ☐ County Attorney, approval when applicable.
- ☒ Perpetual bond currently posted.      Bond No: [REDACTED]      Amount: \$50,000.00
- ☐ Performance bond submitted.      Bond No: \_\_\_\_\_      Amount: \_\_\_\_\_
- ☐ Cashier's Check      Check No: \_\_\_\_\_      Amount: \_\_\_\_\_

**(3) DRAINAGE DISTRICT APPROVAL (WHEN APPLICABLE):**

\_\_\_\_\_  
Drainage District Approval

\_\_\_\_\_  
Date

**We have reviewed this project and agree it meets minimum requirements.**

*Charles O. Ay*

\_\_\_\_\_  
Permit Administrator

*6/19/17*

\_\_\_\_\_  
Date

**NOTES:**

These plans were prepared to meet or exceed the requirements and requirements of the City of Madison and the Madison County Planning and Zoning Commission. The Madison County Planning and Zoning Commission has approved by First Board County and has been deemed valid a construction here not subject to any other review or approval by any other agency.

Madison County and Madison County have the plan of this section is filed in the First Board County Map Records.

Construction will be completed under the supervision of a licensed engineer.

Professional JONES & CLARK, INC.

Contractor shall notify the First Board County Engineering Department of least 48 hours prior to commencement at E-MAIL:CONSTRUCTION@COUNTYTX.GOV

17-  

A Void 2, 4, 5, 1, 8, 9;  
 Revised Sheets 2A, 4A, 5A, 7A, 8A & 9A  
 Omitted Sheet 10  
 4

Christopher C. Murphy, P.E. 1/16/2008  
Date

ILMS No. 16085397  
C.O.H. LOG No. 16-1036

|                |                          |
|----------------|--------------------------|
| CITY EMPLOYER  | CITY OF HOUSTON, TEXAS   |
| STREET ADDRESS | 1000 PASTOR LUTHER DRIVE |
| CITY           | HOUSTON, TEXAS           |
| STATE          | TEXAS                    |
| ZIP CODE       | 77002                    |
| TELEPHONE      | 713-552-1000             |
| FAX            | 713-552-1000             |
| E-MAIL         | CITY@CITYOFHOUSTON.ORG   |

**JONES CARTER**  
DALLAS, TEXAS

FILE NO: 2016-0010  
 PROJECT: 2016-0010  
 SUBJECT: 2016-0010  
 DATE: 08/20/2016  
 TIME: 10:40 AM  
 BY: [REDACTED]  
 FOR: [REDACTED]  
 TO: [REDACTED]  
 FROM: [REDACTED]  
 INFO: [REDACTED]  
 COMMENTS: [REDACTED]  
 ATTACHMENTS: [REDACTED]  
 DISTRIBUTION: [REDACTED]  
 APPROVAL: [REDACTED]  
 SIGNATURE: [REDACTED]  
 TITLE: [REDACTED]  
 ORGANIZATION: [REDACTED]  
 ADDRESS: [REDACTED]  
 CITY: [REDACTED]  
 STATE: [REDACTED]  
 ZIP: [REDACTED]  
 PHONE: [REDACTED]  
 FAX: [REDACTED]  
 EMAIL: [REDACTED]  
 WEBSITE: [REDACTED]  
 SOCIAL MEDIA: [REDACTED]  
 OTHER: [REDACTED]

[illegible]

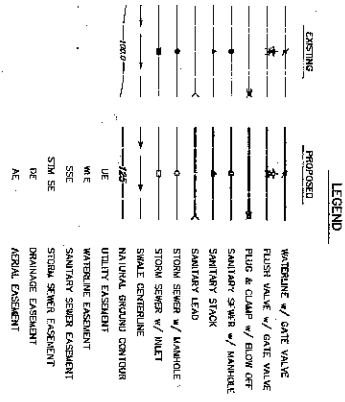

**BENCH MARK**  
2003 FORT BEND COUNTY LEAD BENCHMARK NO. 25  
7<sup>TH</sup> NW, N AERIAL, LOCATED 2.5 WEST OF  
THE FIRST NUTRILION ROAD WEST OF F.M. 2100 ON HIGHWAY  
90 - A. ELEVATION=84.09 NAVD83 (2001 ADJUSTMENT)  
NOTE: ALL ELEVATIONS SHOWN WERE DERIVED FROM  
GPS/RTK OBSERVATIONS AND UNITED DATUM2000.

|   |  |
|---|--|
| APPLICANT: <u>Morgan Construction</u><br>DATE: <u>5/10/17</u>       |  |
| PROJECT: <u>Sanitary Sewer</u><br>LOCATION: <u>Sanitary Sewer</u>   |  |
| PROJECT NO.: <u>134-E</u><br>COUNTY: <u>Fort Bend County, Texas</u> |  |
| PROJECT NAME: <u>Sanitary Sewer</u>                                 |  |
| PROJECT ADDRESS: <u>Sanitary Sewer</u>                              |  |
| PROJECT CITY: <u>Sanitary Sewer</u>                                 |  |
| PROJECT STATE: <u>Sanitary Sewer</u>                                |  |
| PROJECT ZIP: <u>Sanitary Sewer</u>                                  |  |
| PROJECT PHONE: <u>Sanitary Sewer</u>                                |  |
| PROJECT FAX: <u>Sanitary Sewer</u>                                  |  |
| PROJECT E-MAIL: <u>Sanitary Sewer</u>                               |  |
| PROJECT WEBSITE: <u>Sanitary Sewer</u>                              |  |
| PROJECT NOTES: <u>Sanitary Sewer</u>                                |  |
| PROJECT COMMENTS: <u>Sanitary Sewer</u>                             |  |
| PROJECT STATUS: <u>Sanitary Sewer</u>                               |  |
| PROJECT DATE: <u>Sanitary Sewer</u>                                 |  |
| PROJECT TIME: <u>Sanitary Sewer</u>                                 |  |
| PROJECT COST: <u>Sanitary Sewer</u>                                 |  |
| PROJECT BUDGET: <u>Sanitary Sewer</u>                               |  |
| PROJECT VENDOR: <u>Sanitary Sewer</u>                               |  |
| PROJECT CONTRACT: <u>Sanitary Sewer</u>                             |  |
| PROJECT AGREEMENT: <u>Sanitary Sewer</u>                            |  |
| PROJECT SIGNATURE: <u>Sanitary Sewer</u>                            |  |
| PROJECT DATE: <u>Sanitary Sewer</u>                                 |  |
| PROJECT TIME: <u>Sanitary Sewer</u>                                 |  |
| PROJECT COST: <u>Sanitary Sewer</u>                                 |  |
| PROJECT BUDGET: <u>Sanitary Sewer</u>                               |  |
| PROJECT VENDOR: <u>Sanitary Sewer</u>                               |  |
| PROJECT CONTRACT: <u>Sanitary Sewer</u>                             |  |
| PROJECT AGREEMENT: <u>Sanitary Sewer</u>                            |  |
| PROJECT SIGNATURE: <u>Sanitary Sewer</u>                            |  |
| PROJECT DATE: <u>Sanitary Sewer</u>                                 |  |
| PROJECT TIME: <u>Sanitary Sewer</u>                                 |  |
| PROJECT COST: <u>Sanitary Sewer</u>                                 |  |
| PROJECT BUDGET: <u>Sanitary Sewer</u>                               |  |
| PROJECT VENDOR: <u>Sanitary Sewer</u>                               |  |
| PROJECT CONTRACT: <u>Sanitary Sewer</u>                             |  |
| PROJECT AGREEMENT: <u>Sanitary Sewer</u>                            |  |
| PROJECT SIGNATURE: <u>Sanitary Sewer</u>                            |  |
| PROJECT DATE: <u>Sanitary Sewer</u>                                 |  |
| PROJECT TIME: <u>Sanitary Sewer</u>                                 |  |
| PROJECT COST: <u>Sanitary Sewer</u>                                 |  |
| PROJECT BUDGET: <u>Sanitary Sewer</u>                               |  |
| PROJECT VENDOR: <u>Sanitary Sewer</u>                               |  |
| PROJECT CONTRACT: <u>Sanitary Sewer</u>                             |  |
| PROJECT AGREEMENT: <u>Sanitary Sewer</u>                            |  |
| PROJECT SIGNATURE: <u>Sanitary Sewer</u>                            |  |
| PROJECT DATE: <u>Sanitary Sewer</u>                                 |  |
| PROJECT TIME: <u>Sanitary Sewer</u>                                 |  |
| PROJECT COST: <u>Sanitary Sewer</u>                                 |  |
| PROJECT BUDGET: <u>Sanitary Sewer</u>                               |  |
| PROJECT VENDOR: <u>Sanitary Sewer</u>                               |  |
| PROJECT CONTRACT: <u>Sanitary Sewer</u>                             |  |
| PROJECT AGREEMENT: <u>Sanitary Sewer</u>                            |  |
| PROJECT SIGNATURE: <u>Sanitary Sewer</u>                            |  |
| PROJECT DATE: <u>Sanitary Sewer</u>                                 |  |
| PROJECT TIME: <u>Sanitary Sewer</u>                                 |  |
| PROJECT COST: <u>Sanitary Sewer</u>                                 |  |
| PROJECT BUDGET: <u>Sanitary Sewer</u>                               |  |
| PROJECT VENDOR: <u>Sanitary Sewer</u>                               |  |
| PROJECT CONTRACT: <u>Sanitary Sewer</u>                             |  |
| PROJECT AGREEMENT: <u>Sanitary Sewer</u>                            |  |
| PROJECT SIGNATURE: <u>Sanitary Sewer</u>                            |  |
| PROJECT DATE: <u>Sanitary Sewer</u>                                 |  |
| PROJECT TIME: <u>Sanitary Sewer</u>                                 |  |
| PROJECT COST: <u>Sanitary Sewer</u>                                 |  |
| PROJECT BUDGET: <u>Sanitary Sewer</u>                               |  |
| PROJECT VENDOR: <u>Sanitary Sewer</u>                               |  |
| PROJECT CONTRACT: <u>Sanitary Sewer</u>                             |  |
| PROJECT AGREEMENT: <u>Sanitary Sewer</u>                            |  |
| PROJECT SIGNATURE: <u>Sanitary Sewer</u>                            |  |
| PROJECT DATE: <u>Sanitary Sewer</u>                                 |  |
| PROJECT TIME: <u>Sanitary Sewer</u>                                 |  |
| PROJECT COST: <u>Sanitary Sewer</u>                                 |  |
| PROJECT BUDGET: <u>Sanitary Sewer</u>                               |  |
| PROJECT VENDOR: <u>Sanitary Sewer</u>                               |  |
| PROJECT CONTRACT: <u>Sanitary Sewer</u>                             |  |
| PROJECT AGREEMENT: <u>Sanitary Sewer</u>                            |  |
| PROJECT SIGNATURE: <u>Sanitary Sewer</u>                            |  |
| PROJECT DATE: <u>Sanitary Sewer</u>                                 |  |
| PROJECT TIME: <u>Sanitary Sewer</u>                                 |  |
| PROJECT COST: <u>Sanitary Sewer</u>                                 |  |
| PROJECT BUDGET: <u>Sanitary Sewer</u>                               |  |
| PROJECT VENDOR: <u>Sanitary Sewer</u>                               |  |
| PROJECT CONTRACT: <u>Sanitary Sewer</u>                             |  |
| PROJECT AGREEMENT: <u>Sanitary Sewer</u>                            |  |
| PROJECT SIGNATURE: <u>Sanitary Sewer</u>                            |  |
| PROJECT DATE: <u>Sanitary Sewer</u>                                 |  |
| PROJECT TIME: <u>Sanitary Sewer</u>                                 |  |
| PROJECT COST: <u>Sanitary Sewer</u>                                 |  |
| PROJECT BUDGET: <u>Sanitary Sewer</u>                               |  |
| PROJECT VENDOR: <u>Sanitary Sewer</u>                               |  |
| PROJECT CONTRACT: <u>Sanitary Sewer</u>                             |  |
| PROJECT AGREEMENT: <u>Sanitary Sewer</u>                            |  |
| PROJECT SIGNATURE: <u>Sanitary Sewer</u>                            |  |
| PROJECT DATE: <u>Sanitary Sewer</u>                                 |  |
| PROJECT TIME: <u>Sanitary Sewer</u>                                 |  |
| PROJECT COST: <u>Sanitary Sewer</u>                                 |  |
| PROJECT BUDGET: <u>Sanitary Sewer</u>                               |  |
| PROJECT VENDOR: <u>Sanitary Sewer</u>                               |  |
| PROJECT CONTRACT: <u>Sanitary Sewer</u>                             |  |
|   |  |



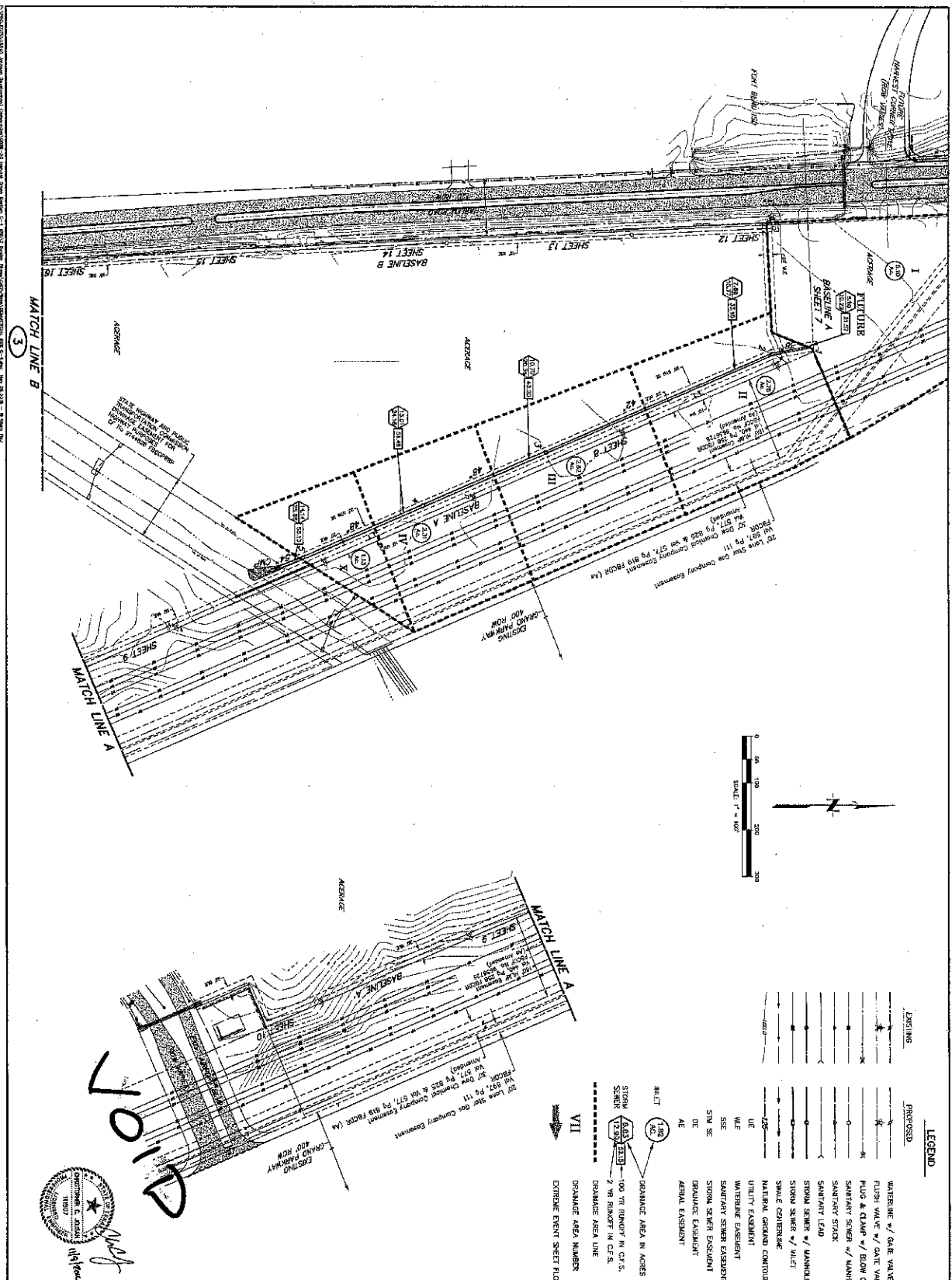

**LEGEND**

| EXISTING                   | PROPOSED                   |
|----------------------------|----------------------------|
| WATERLINE w/ DATE VALVE    | WATERLINE w/ DATE VALVE    |
| FLUSH VALVE w/ DATE VALVE  | FLUSH VALVE w/ DATE VALVE  |
| PILE & CLAMP w/ BLOW OFF   | PILE & CLAMP w/ BLOW OFF   |
| SANITARY SINKER w/ MANHOLE | SANITARY SINKER w/ MANHOLE |
| SANITARY STACK             | SANITARY STACK             |
| SANITARY LEAD              | SANITARY LEAD              |
| STORM SINKER w/ MANHOLE    | STORM SINKER w/ MANHOLE    |
| STORM SINKER w/ INLET      | STORM SINKER w/ INLET      |
| SMALL CONCRETE             | SMALL CONCRETE             |
| UTILITY EASEMENT           | UTILITY EASEMENT           |
| WATERLINE EASEMENT         | WATERLINE EASEMENT         |
| SANITARY SINKER EASEMENT   | SANITARY SINKER EASEMENT   |
| STORM SINKER EASEMENT      | STORM SINKER EASEMENT      |
| DRAINAGE EASEMENT          | DRAINAGE EASEMENT          |
| AIRIAL EASEMENT            | AIRIAL EASEMENT            |

**100-Year Flood Plain**  
 According to Map No. 481570010, of The  
 Federal Emergency Management Agency (FEMA)  
 Flood Insurance Study for the Houston  
 Area, the 100-year flood plain is shown  
 subject to be within the 100-year flood plain  
 the 500-year flood plain.  
 Note: The 100-year flood plain is shown in  
 approximately 85.0 feet on the FEMA  
 Flood Insurance Study for the Houston  
 Area, dated April 12, 2014. The 100-year flood plain  
 depth of the detention pond.

**SEWER LINES**  
 THE CITY OF HOUSTON HAS ADOPTED THE  
 1994 STANDARD SPECIFICATIONS FOR  
 THE CONSTRUCTION OF SEWER LINES  
 AND ALL EXISTING SEWER LINES SHALL  
 BE IN ACCORDANCE WITH THE 1994  
 STANDARD SPECIFICATIONS FOR THE  
 CONSTRUCTION OF SEWER LINES.

**VII**  
 DRAINAGE AREA IN ACRES  
 100 YR FLOOD IN CFS  
 2 YR FLOOD IN CFS  
 DRAINAGE AREA LINE  
 DRAINAGE AREA NUMBER  
 EXTREME EVENT SHEET FLOW

APPROVED: *[Signature]*  
 DATE: 12/15/16  
 PROJECT: FORT BEND COUNTY AND NO. 134-E  
 CITY OF HOUSTON  
 UTILITIES TO SERVE HARVEST GREEN  
 COMMERCIAL RESERVE C-4  
 GENERAL CONSTRUCTION LAYOUT  
 STORM & DRAINAGE

**CITY OF HOUSTON**  
 DEPARTMENT OF PUBLIC WORKS  
 DIVISION OF STORM DRAINAGE  
 56878

**JONES CARTER**  
 ENGINEERS  
 11111 RICHMOND AVE., SUITE 100  
 HOUSTON, TEXAS 77042  
 (713) 861-1111

**7010**

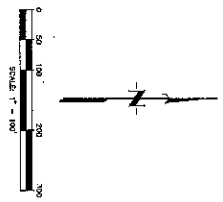

| <u>EXISTING</u> |                          | <u>PROPOSED</u> |                           | <u>LEGEND</u> |
|-----------------|--------------------------|-----------------|---------------------------|---------------|
|                 | WATERLINE w/ DATE VALVE  |                 | FISHBONE w/ DATE VALVE    |               |
|                 | PUMP & CLAMP w/ BLOW OFF |                 | SANITARY SEWER w/ MANHOLE |               |
|                 | SANITARY STACK           |                 | SANITARY STACK            |               |
|                 | STORM SEWER w/ MANHOLE   |                 | STORM SEWER w/ INLET      |               |
|                 | STORM SEWER w/ INLET     |                 | SMALL CHIMNEY             |               |
|                 | MATERIAL GROUND CONTOUR  |                 |                           |               |

**100-Year Flood Elevation**  
According to Map No. 48157D04.0 of The Federal Emergency Management Agency's Flood Insurance Rate Map (FIRM) dated April 2010, the unshaded area is within Unshaded Zone "X". Shaded Zone "X" is defined as areas within the 100-Year Flood Plain.

Note: The 100-Year flood elevation is approximately 81.0 feet on per the FEMA Insurance Rate Map for Fort Bend County, Texas Community Panel No. 48157D04.0. Dated April 2, 2014. The 100-Year Flood Right-of-Way elevation is contained in the channel mouth of the deflection pond.

**BENCH MARK**  
2000 FIRST BEED COUNTY LOOK BENCHMARK ABL 23.  
70' IN ASPHALT LOCATED 2.5' WEST OF THE  
FIRST MEDIAN ROSE WEST OF P.L. 569 ON HIGHWAY  
90-A. ELEVATION=41.08 NAVD83 (2000 ADJUSTMENT)  
NOTES: ALL ELEVATIONS SHOWN WERE DERIVED FROM  
GPS/RTK OBSERVATIONS AND UTILIZED GRIDDS.

AC

STORM SEWER

DRAINAGE AREA IN C.F.S.

8.63

32.9

100 YR RUNOFF IN C.F.S.

2 RR RUNOFF IN C.F.S.

VII

DRAINAGE AREA LINE

DRAINAGE AREA NUMBER

EXTREME EVENT SHEET FLOW

APPROVED: M. S. [Signature]  
DEVELOPMENT COORDINATOR

DATE: 5/10/17

FORT BEND COUNTY MUD No. 134-E  
FORT BEND COUNTY, TEXAS

**JONES CARTER**  
 J.C.  
 UTILITIES TO SERVE HARVEST GREEN  
 COMMERCIAL RESERVE C-4  
 GENERAL CONSTRUCTION LAYOUT  
 STORM & DRAINAGE

**CITY OF HOUSTON**  
DEPARTMENT OF PUBLIC WORKS AND ENGINEERING  
TOMMY B. STEEL/CHIEF

|        |                      |               |
|--------|----------------------|---------------|
| DATE   | 10/10/01             | STATE OF OHIO |
| COUNTY | COLUMBIA             |               |
| NAME   | ALAN B. BROWN        |               |
| STREET | 1000 1/2 S. 10TH ST. |               |
| CITY   | CHICAGO, ILL.        |               |

PL. NO.                       
 AS NO. 66978-005-03  
 DATE: APRIL 1967  
 ONE BT. PLU  
 ONE BT. AG  
 SCALE: 1"=10'

SHEET No. **4A** OF 25

FOR CITY OF HONOLULU USE ONLY  
 (PRINTING AREA)

66978  
 CITY OF HONOLULU  
 ENGINEERING DEPT.





| COMPREHENSIVE SITE/PROJECT DATA |            |                       |                    |                    |            |                  |            |                             |                    |                            |            |           |               |                        |              |                   |                           |                           |                         |                        |                       |                               |                               |                         |                          |                         |
|---------------------------------|------------|-----------------------|--------------------|--------------------|------------|------------------|------------|-----------------------------|--------------------|----------------------------|------------|-----------|---------------|------------------------|--------------|-------------------|---------------------------|---------------------------|-------------------------|------------------------|-----------------------|-------------------------------|-------------------------------|-------------------------|--------------------------|-------------------------|
| Manhole From                    | Manhole To | Sanitary Line (Acres) | Total Area (Acres) | Inflow Coefficient | Sum of C*V | Rainfall (in/hr) | Flow (MGD) | Time of Concentration (min) | Pipe Length (Feet) | Pipe Diameter or Size (in) | Slope (ft) | Slope (%) | Manning's "n" | Design Velocity (ft/s) | Fall (ft/mi) | Manhole Drop (ft) | Proposed Elevation (Feet) | Existing Elevation (Feet) | Actual Elevation (Feet) | Hydraulic Gradient (%) | Change in Head (Feet) | Elevation of Spot Grid (Feet) | Elevation of Spot Grid (Feet) | Top of Catchment (Feet) | Current Elevation (Feet) | Outlet Elevation (Feet) |
| 1                               | 2          | 5.10                  | 5.81               | 0.61               | 3.3        | 3.18             | 0.51       | 28.85                       | 81                 | 36                         | 0.11       | 0.013     | 22.12         | 3.15                   | 0.09         | 71.71             | 77.07                     | 77.07                     | 3.03                    | 0.11                   | 0.09                  | 86.50                         | 86.50                         | 86.50                   | 86.50                    | 86.50                   |
|                                 | 3          | 2.78                  | 7.88               | 0.61               | 3.1        | 3.08             | 0.66       | 13.77                       | 33.11              | 42                         | 0.09       | 0.013     | 30.16         | 3.14                   | 0.48         | 77.67             | 77.19                     | 77.19                     | 3.44                    | 0.11                   | 0.57                  | 85.41                         | 85.41                         | 85.41                   | 85.41                    | 85.41                   |
|                                 | 4          | 2.82                  | 10.79              | 0.61               | 7.6        | 2.89             | 0.51       | 38.59                       | 48.11              | 28                         | 0.08       | 0.013     | 40.02         | 3.21                   | 0.25         | 77.85             | 76.96                     | 76.96                     | 3.44                    | 0.08                   | 0.32                  | 84.86                         | 84.86                         | 84.86                   | 84.86                    | 84.86                   |
|                                 | 5          | 2.31                  | 13.01              | 0.61               | 8.5        | 2.86             | 0.69       | 24.19                       | 51.29              | 48                         | 0.11       | 0.013     | 51.79         | 4.12                   | 0.31         | 76.62             | 76.62                     | 76.62                     | 4.10                    | 0.15                   | 0.34                  | 84.58                         | 84.58                         | 84.58                   | 84.58                    | 84.58                   |
|                                 | 6          | 1.13                  | 14.14              | 0.61               | 9.2        | 2.81             | 0.50       | 25.84                       | 55.39              | 54                         | 0.36       | 0.034     | 43.84         | 3.07                   | 0.23         | 76.92             | 76.92                     | 76.92                     | 3.47                    | 0.27                   | 0.21                  | 84.38                         | 84.38                         | 84.38                   | 84.38                    | 84.38                   |
| 2                               | 3          | 2.78                  | 7.88               | 0.61               | 3.1        | 3.08             | 0.66       | 13.77                       | 33.11              | 42                         | 0.09       | 0.013     | 30.16         | 3.14                   | 0.48         | 77.67             | 77.19                     | 77.19                     | 3.44                    | 0.11                   | 0.57                  | 85.41                         | 85.41                         | 85.41                   | 85.41                    | 85.41                   |
|                                 | 4          | 2.82                  | 10.79              | 0.61               | 7.6        | 2.89             | 0.51       | 38.59                       | 48.11              | 28                         | 0.08       | 0.013     | 40.02         | 3.21                   | 0.25         | 77.85             | 76.96                     | 76.96                     | 3.44                    | 0.08                   | 0.32                  | 84.86                         | 84.86                         | 84.86                   | 84.86                    | 84.86                   |
|                                 | 5          | 2.31                  | 13.01              | 0.61               | 8.5        | 2.86             | 0.69       | 24.19                       | 51.29              | 48                         | 0.11       | 0.013     | 51.79         | 4.12                   | 0.31         | 76.62             | 76.62                     | 76.62                     | 4.10                    | 0.15                   | 0.34                  | 84.58                         | 84.58                         | 84.58                   | 84.58                    | 84.58                   |
|                                 | 6          | 1.13                  | 14.14              | 0.61               | 9.2        | 2.81             | 0.50       | 25.84                       | 55.39              | 54                         | 0.36       | 0.034     | 43.84         | 3.07                   | 0.23         | 76.92             | 76.92                     | 76.92                     | 3.47                    | 0.27                   | 0.21                  | 84.38                         | 84.38                         | 84.38                   | 84.38                    | 84.38                   |
|                                 | 7          | 0.97                  | 15.13              | 0.61               | 10.1       | 2.78             | 0.48       | 23.64                       | 59.89              | 60                         | 0.41       | 0.046     | 45.84         | 2.97                   | 0.20         | 77.17             | 77.17                     | 77.17                     | 3.47                    | 0.32                   | 0.16                  | 84.09                         | 84.09                         | 84.09                   | 84.09                    | 84.09                   |

|   |      |   |     |
|---|------|---|-----|
| APPROVED: <i>[Signature]</i>  |      | DECLARATION COORDINATOR                       |     |
| DATE: 2/10/15   |      |   |     |
| DAY   | TIME | REPORT OF: W. E. SHAW, JR.                    | NO. |
| NO. DATE  |      |   |     |
| REMARKS   |      | APPROVED                                      |     |
| FORT BEND COUNTY AUD. NO. 134-E<br>FORT BEND COUNTY, TEXAS  |      |   |     |
|  <b>JONES CARTER</b><br>Division of Professional Services Management<br>10000 Katy Freeway, Suite 1000, Houston, TX 77057<br>281.466.1000 • Fax 281.466.1001 • www.jonescarter.com |      |   |     |
| UTILITIES TO SERVE HARVEST GREEN<br>COMMERCIAL RESERVE C-4<br>STORM DRAINAGE TABLES   |      |   |     |
| NOTE: 0.17 SQUARE FEET TABLE FOR ONE "FOOT ONE" UNIT<br>SEE SHEET 02 FOR DIMENSIONS   |      |   |     |
| <b>CITY OF HOUSTON</b><br>DEPARTMENT OF PUBLIC WORKS AND ENGINEERING<br>DIVISION OF ENGINEERING   |      |   |     |
| DESIGNED BY: <i>[Signature]</i><br>CHECKED BY: <i>[Signature]</i><br>DATE: 2/10/15  |      | DRAWN BY: <i>[Signature]</i><br>DATE: 2/10/15 |     |
| SCALE: 1/8" = 1'-0"<br>SHEET NO. 5A OF 26   |      | NO. OF INCHES DEEP: 4"                        |     |

[illegible]

---

NOTE:  
Contractor to verify  
existing conditions  
before construction  
of new construction

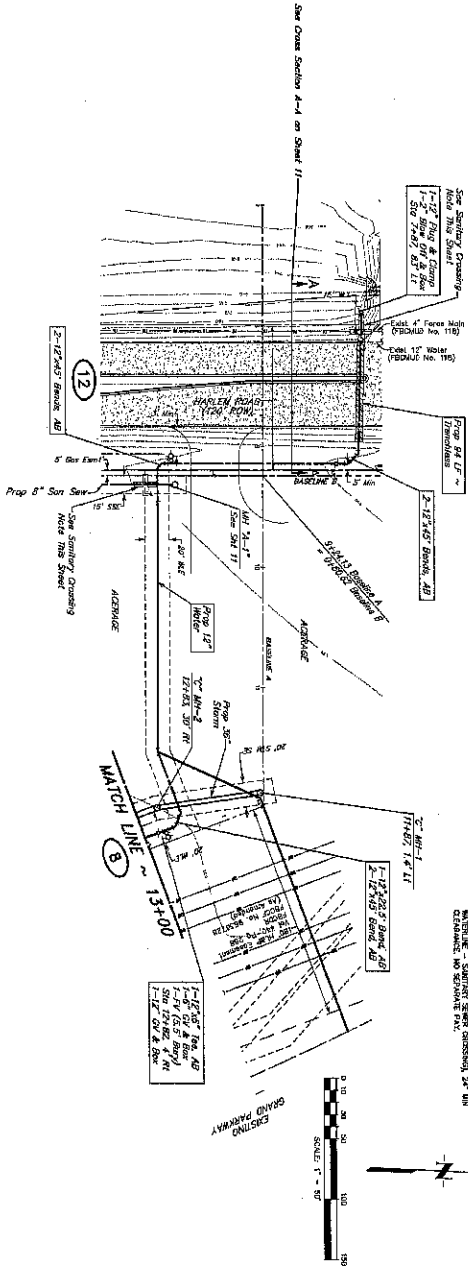

**MATCH LINE - SANITARY SEWER CROSSING**  
This drawing shows the sanitary sewer crossing under the existing road. The sewer pipe is 12 inches in diameter and is shown in plan view. The crossing is shown in section view. The sewer pipe is shown in plan view and the crossing is shown in section view. The sewer pipe is shown in plan view and the crossing is shown in section view.

**EXISTING ROAD**  
This drawing shows the existing road. The road is shown in plan view. The road is shown in plan view. The road is shown in plan view.

**100'-0\"/>**



APPROVED: *[Signature]*  
DATE: 12/15/11  
DEVELOPMENT COORDINATOR

BASELINE A

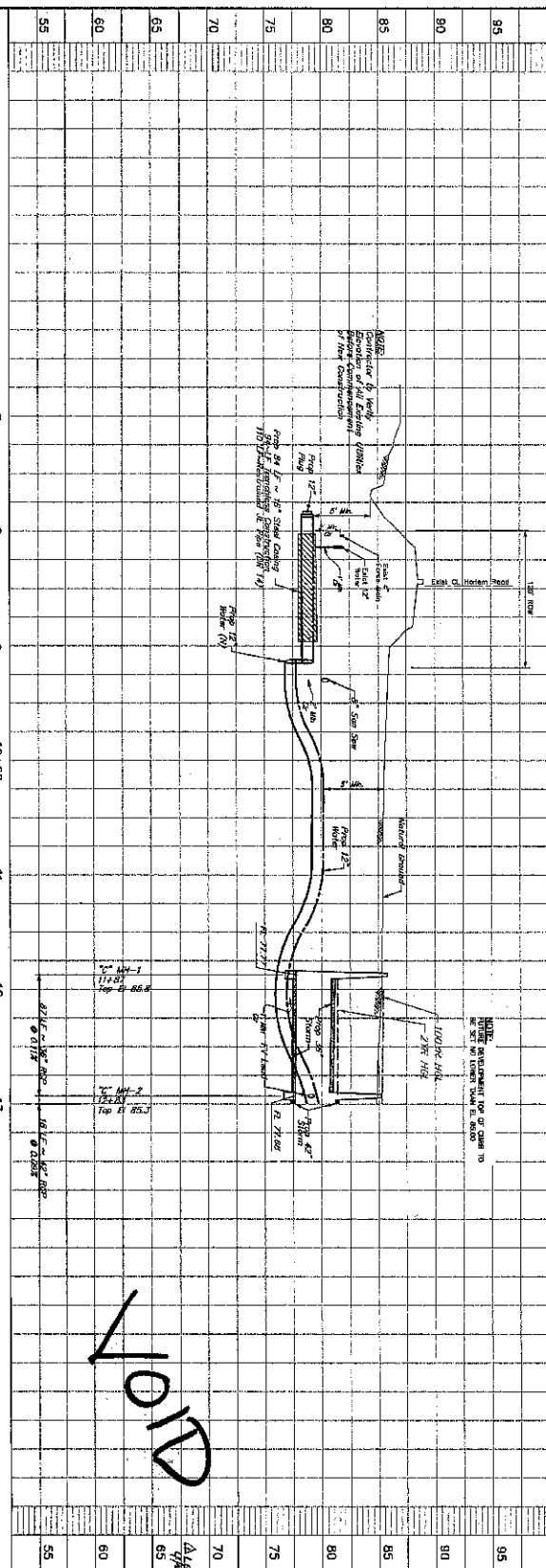

101D

|   |       |  |
|---|-------|--|
| <b>CITY OF FORT BEND</b><br>DEPARTMENT OF PUBLIC WORKS AND UTILITIES<br>10000 FORT BEND BLVD. SUITE 100<br>FORT BEND, TEXAS 78122<br>TEL: 281-335-3333<br>FAX: 281-335-3333<br>WWW.FORTBENDTX.GOV |       | <b>JONES CARTER</b><br>UTILITIES TO SERVE HARVEST GREEN<br>COMMERCIAL RESERVE 0-4<br>BASELINE A<br>7+00 TO 13+00 |
| SHEET NO. 7 OF 25   | 56978 | 12/15/11   |

NOTE:  
Contractor to verify  
location of existing utilities  
before commencement  
of new construction.

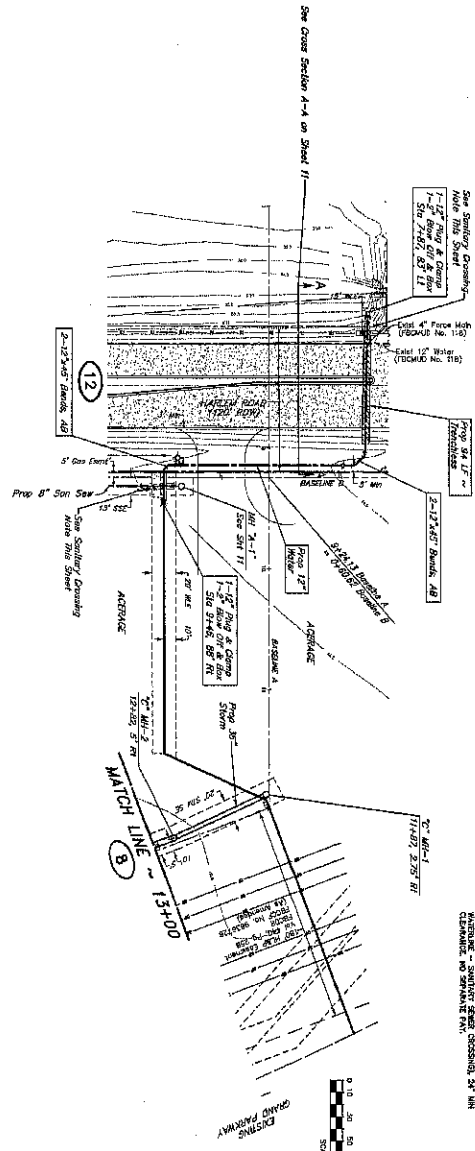

**WATER LINE-SANITARY SEWER CROSSING**  
This drawing shows the location of the existing water line and sanitary sewer lines crossing. The proposed new construction is shown in solid lines. The existing structures are shown in dashed lines. The location of the crossing is shown at station 13+00. The drawing is a plan view showing the horizontal alignment of the lines. The vertical alignment is shown in the profile view on the next sheet.

**BENCH MARK**  
The bench mark is located at station 13+00. The elevation of the bench mark is 85.0 feet. The drawing is a plan view showing the horizontal alignment of the lines. The vertical alignment is shown in the profile view on the next sheet.

**100-Year Flood Plain**  
The 100-year flood plain is shown in the drawing. The elevation of the flood plain is 85.0 feet. The drawing is a plan view showing the horizontal alignment of the lines. The vertical alignment is shown in the profile view on the next sheet.



APPROVED: *Alexander H. Carter*  
DATE: 2/10/17  
ENGINEER

# BASELINE A

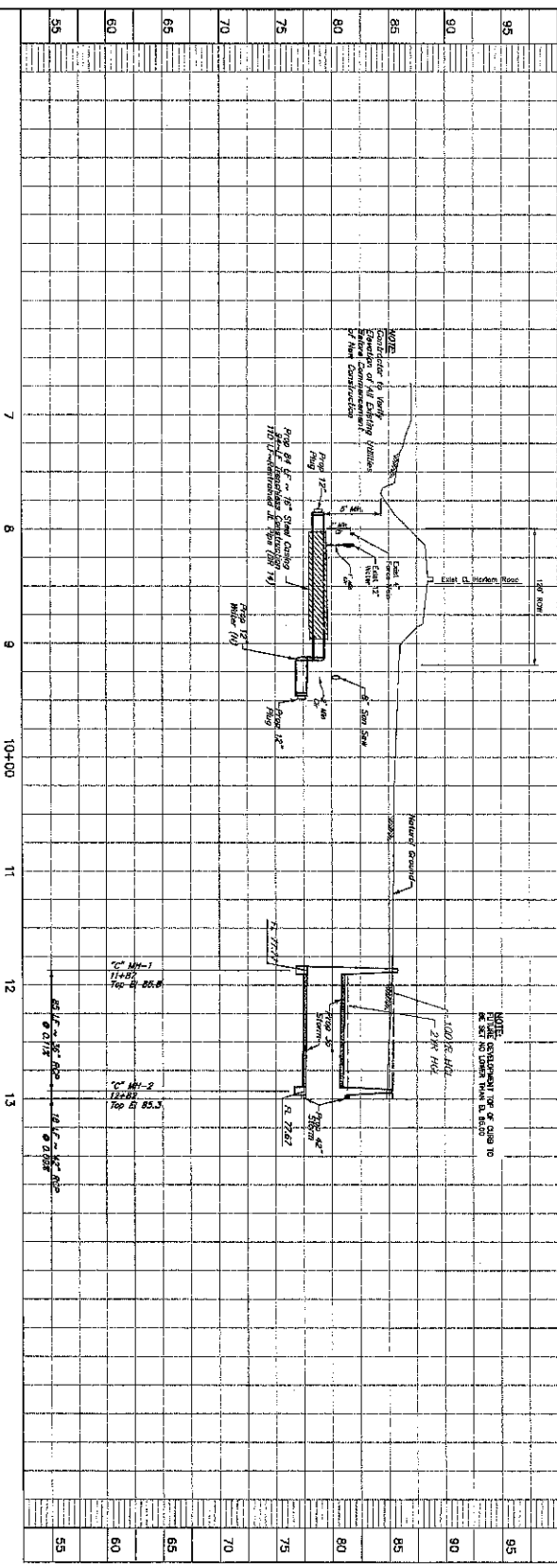

|  |  |
|--|--|
| <b>CITY OF HOUSTON</b><br>DEPARTMENT OF PUBLIC WORKS<br>DIVISION OF PUBLIC UTILITIES |  |
| PROJECT: <b>WATER LINE-SANITARY SEWER CROSSING</b><br>SHEET: <b>7A of 25</b>         | DATE: <b>2/10/17</b><br>ENGINEER: <b>Alexander H. Carter</b><br>NO. <b>44712</b> |
| PROJECT: <b>WATER LINE-SANITARY SEWER CROSSING</b><br>SHEET: <b>7A of 25</b>         | DATE: <b>2/10/17</b><br>ENGINEER: <b>Alexander H. Carter</b><br>NO. <b>44712</b> |

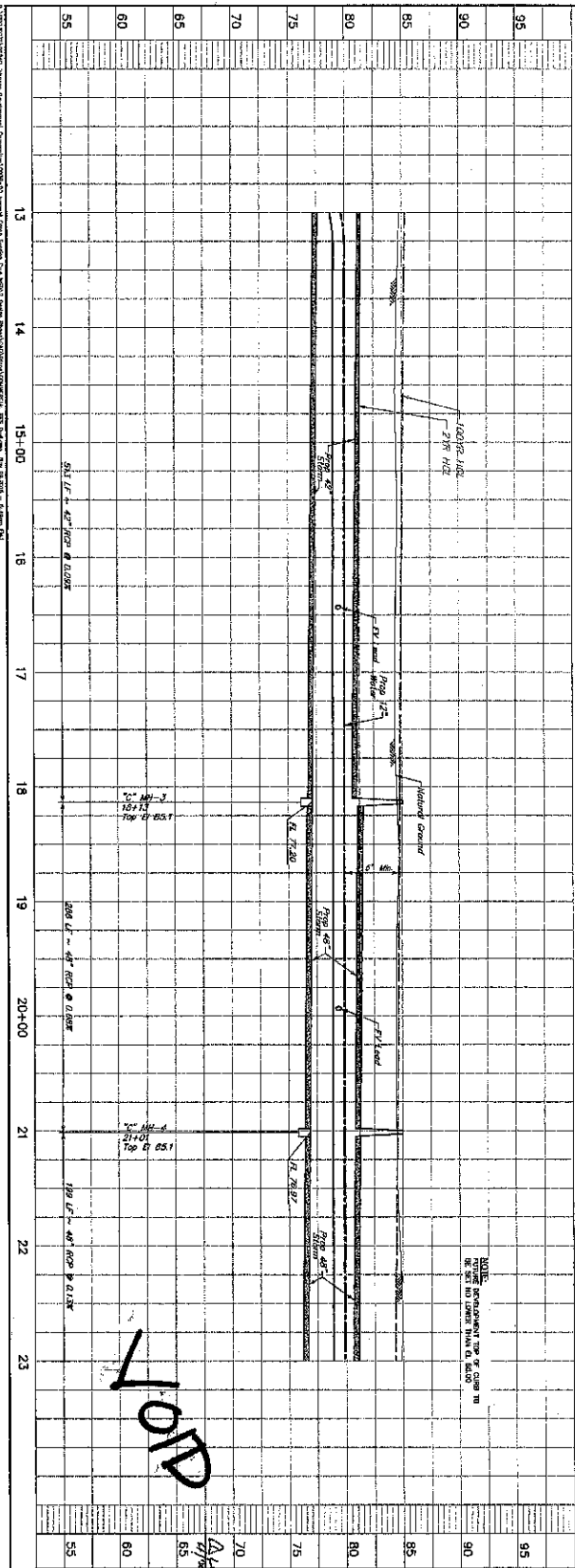

BASELINE A

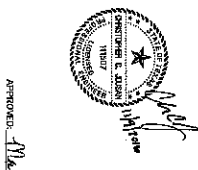
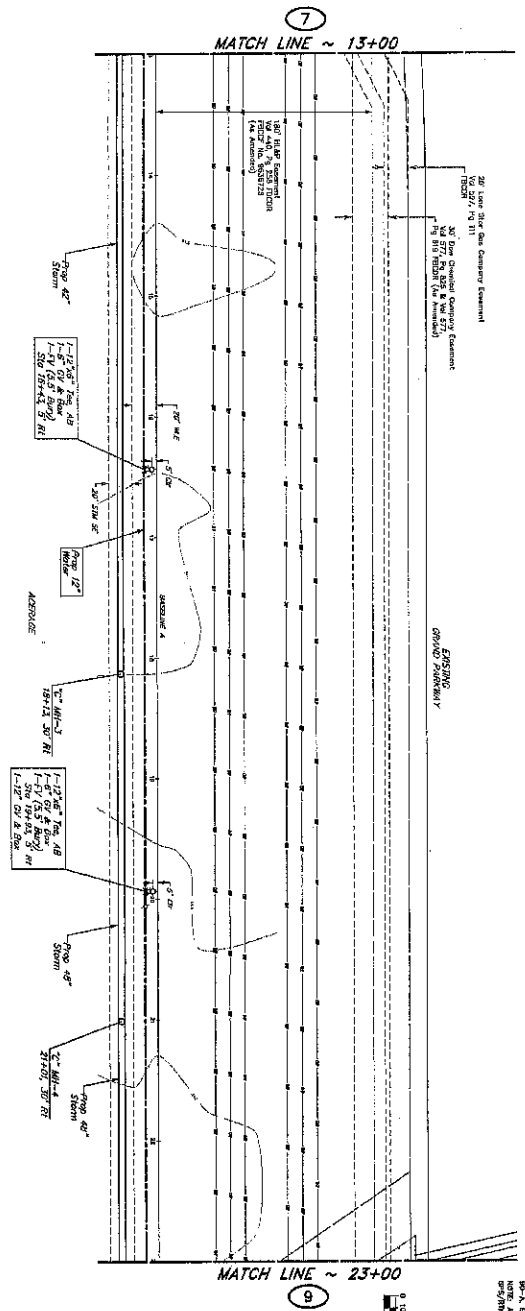

APPROVED: *[Signature]*  
DATE: 12/15/16

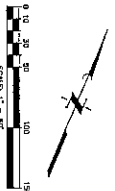

**100-Year Flood Dike**  
According to the 48th Annual Report of the Texas Department of Transportation, the 100-year flood dike is shown on the attached plan view. The dike is shown with a 10-foot wide top and a 4-foot high crest. The dike is shown with a 10-foot wide top and a 4-foot high crest. The dike is shown with a 10-foot wide top and a 4-foot high crest.

**100-Year Flood Dike**  
According to the 48th Annual Report of the Texas Department of Transportation, the 100-year flood dike is shown on the attached plan view. The dike is shown with a 10-foot wide top and a 4-foot high crest. The dike is shown with a 10-foot wide top and a 4-foot high crest. The dike is shown with a 10-foot wide top and a 4-foot high crest.

|  |  |
|--|--|
| <b>CITY OF HOUSTON</b><br>13+00 TO 23+00<br>BASELINE A                     |  |
| JONES CARTER<br>UTILITIES TO SERVE HARVEST GREEN<br>COMMERCIAL RESERVE C-4 | DATE: 12/15/16<br>APPROVED: <i>[Signature]</i> |
| SHEET NO. 8 OF 26  | DATE: 12/15/16                                 |



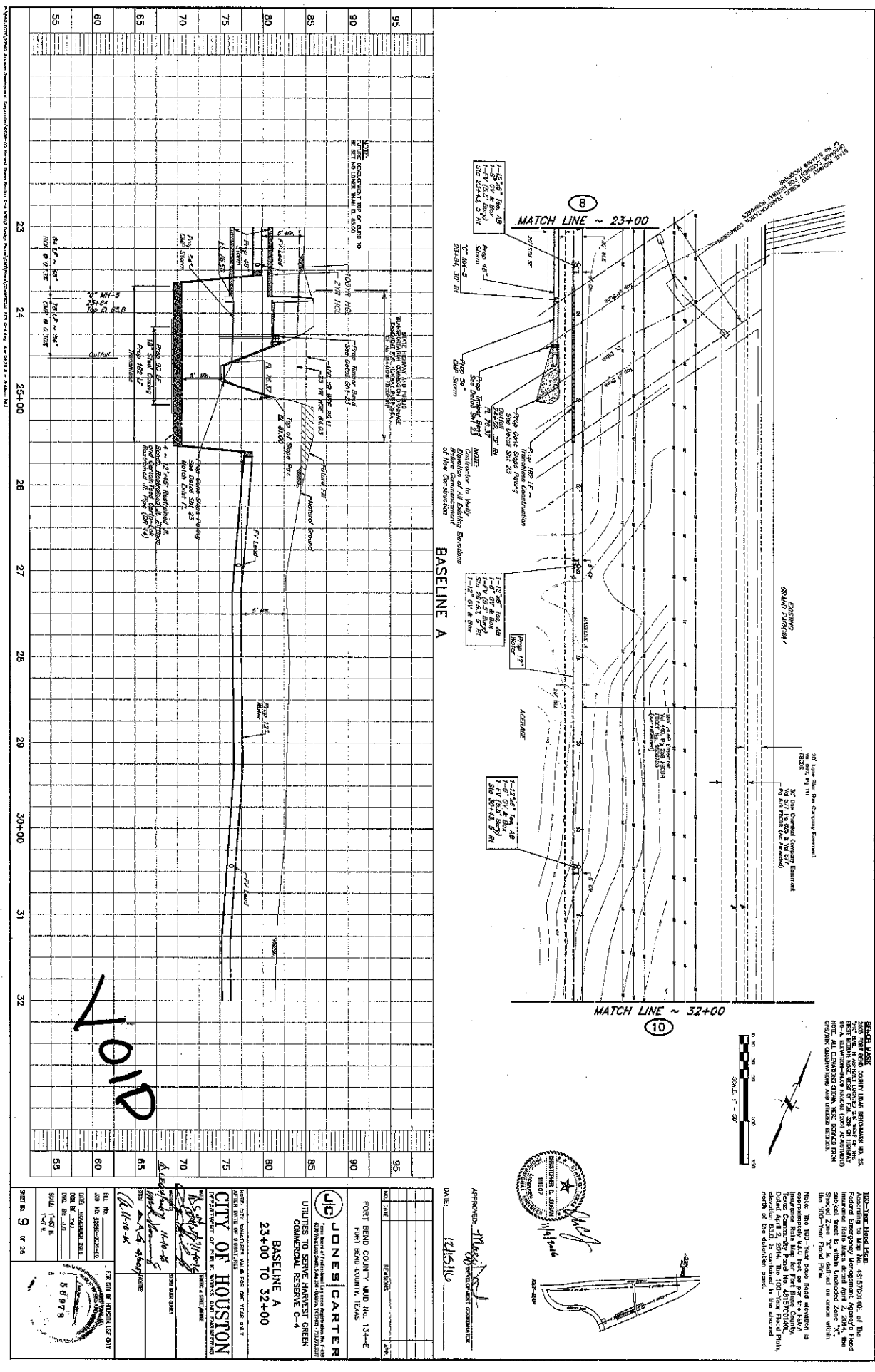



1. Surveyed by J. W. Carter, J. W. Carter & Associates, Inc. on 10/10/17. 2. Surveyed by J. W. Carter, J. W. Carter & Associates, Inc. on 10/10/17.

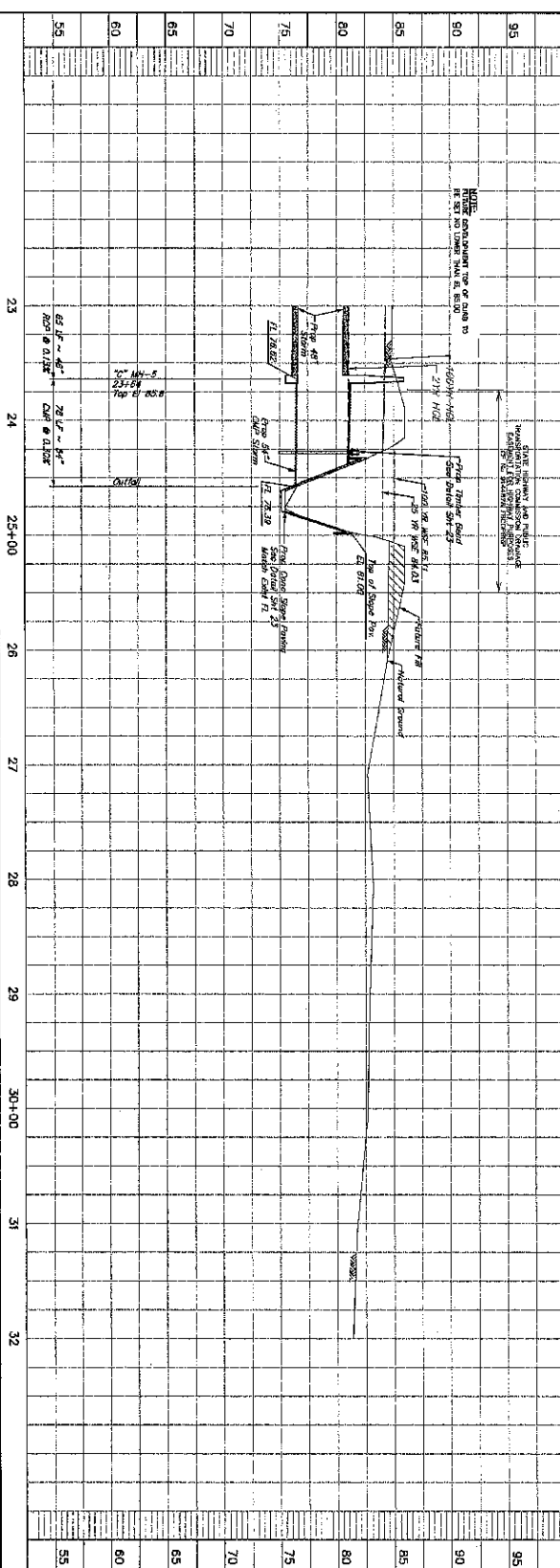

|                       |  |
|-----------------------|--|
| DATE: 10/10/17        |  |
| APPROVED: [Signature] |  |
| DESIGNED: [Signature] |  |
| CHECKED: [Signature]  |  |
| DRAWN: [Signature]    |  |
| FILE NO. 100-100-100  |  |
| DATE: 10/10/17        |  |
| BY: J. W. Carter      |  |
| SCALE: 1" = 40'       |  |
| SHEET 9A OF 26        |  |

**JONES CARTER**  
UTILITIES TO SERVE HARVEST GREEN  
COMMERCIAL RESERVE C-4  
BASELINE A  
23+00 TO 32+00

**CITY OF HOUSTON**  
DEPARTMENT OF PUBLIC WORKS AND ENGINEERING  
OFFICE OF THE CITY ENGINEER

**PORT BEND COUNTY**  
PORT BEND COUNTY, TEXAS  
FARM ROAD NO. 134-E

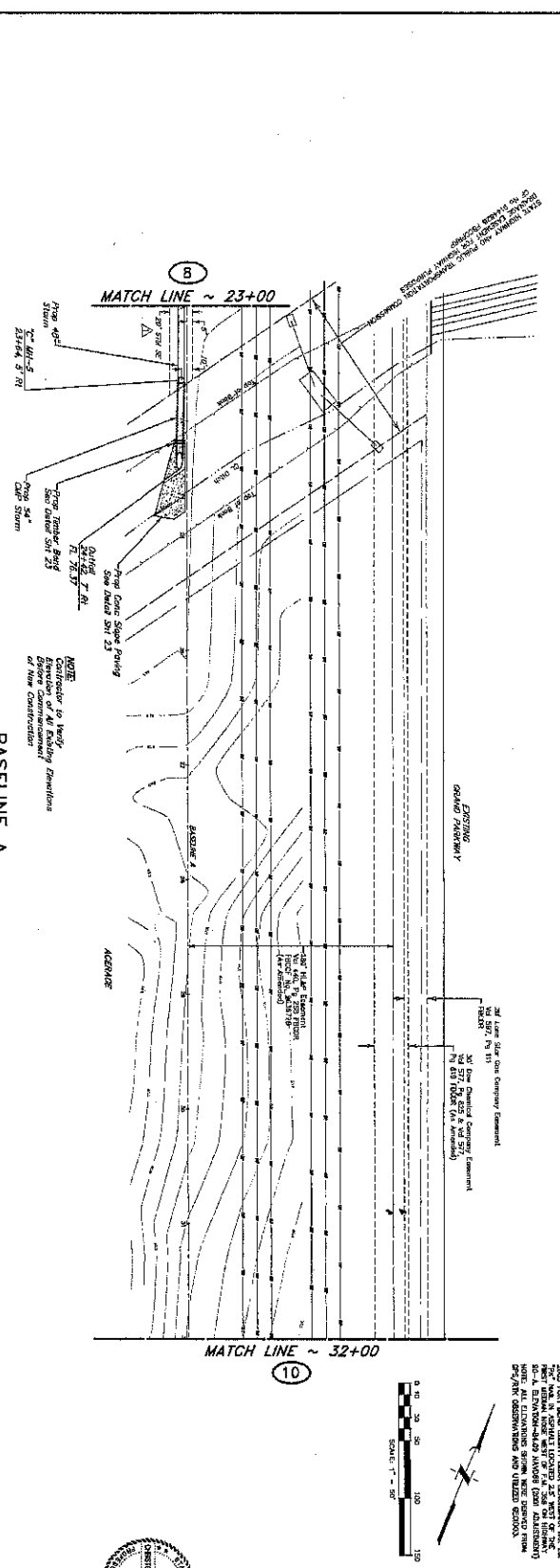

|                       |  |
|-----------------------|--|
| DATE: 10/10/17        |  |
| APPROVED: [Signature] |  |
| DESIGNED: [Signature] |  |
| CHECKED: [Signature]  |  |
| DRAWN: [Signature]    |  |
| FILE NO. 100-100-100  |  |
| DATE: 10/10/17        |  |
| BY: J. W. Carter      |  |
| SCALE: 1" = 40'       |  |
| SHEET 9A OF 26        |  |

**JONES CARTER**  
UTILITIES TO SERVE HARVEST GREEN  
COMMERCIAL RESERVE C-4  
BASELINE A  
23+00 TO 32+00

**CITY OF HOUSTON**  
DEPARTMENT OF PUBLIC WORKS AND ENGINEERING  
OFFICE OF THE CITY ENGINEER

**PORT BEND COUNTY**  
PORT BEND COUNTY, TEXAS  
FARM ROAD NO. 134-E



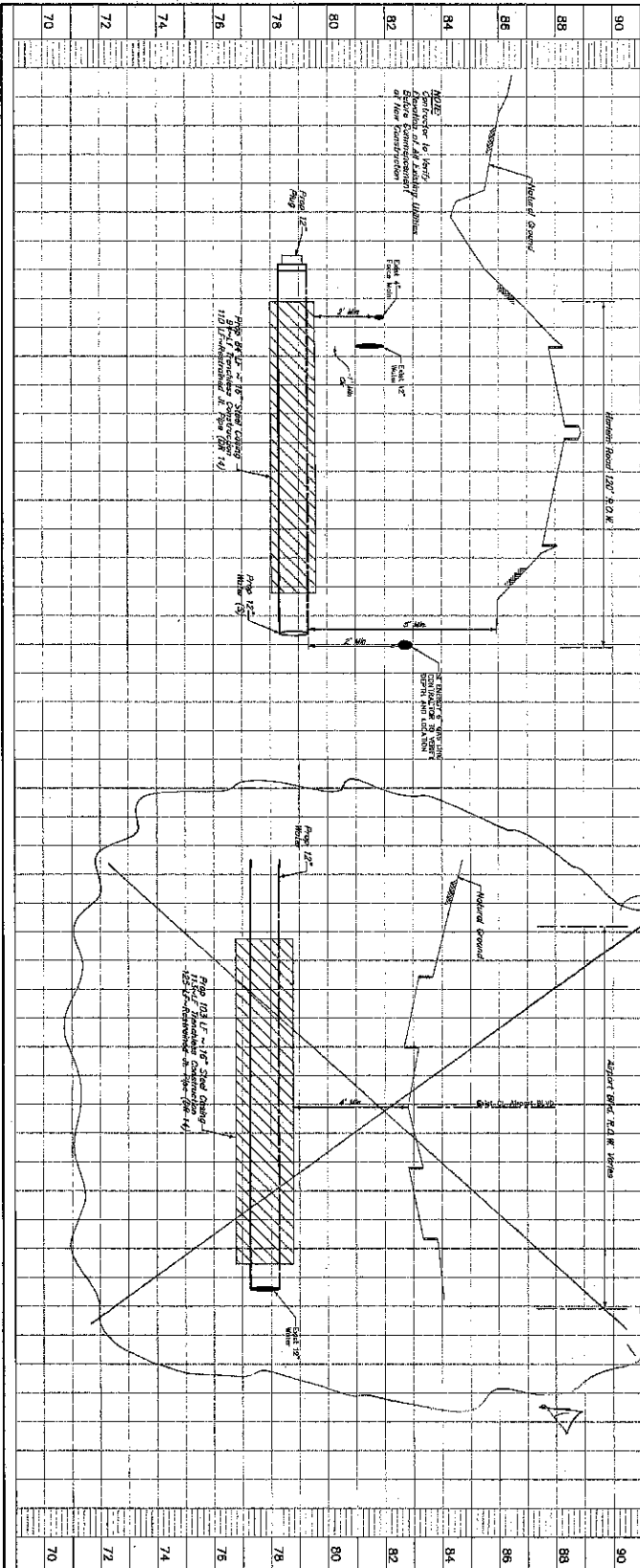
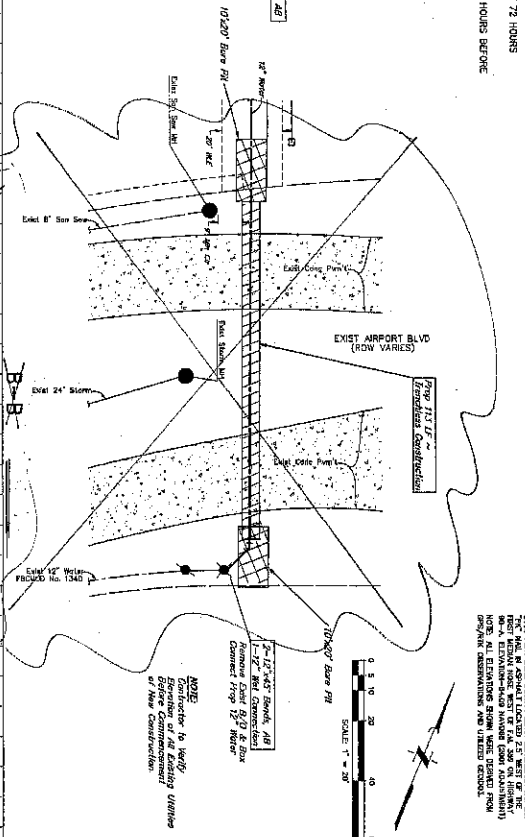
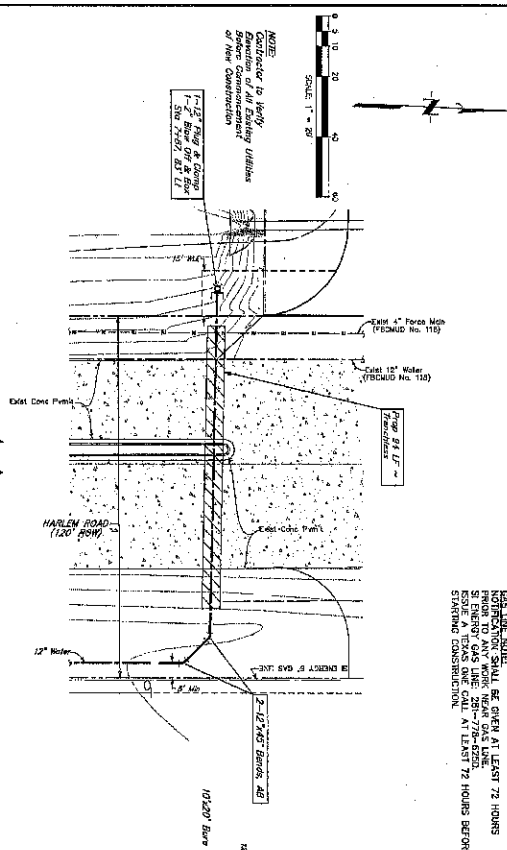

NOTIFICATION SHALL BE GIVEN AT LEAST 72 HOURS PRIOR TO ANY WORK NEAR GAS LINE.  
ST ENERGY GAS LINE: 261-778-6250.  
ISSUE A TEXAS ONE CALL AT LEAST 72 HOURS BEFORE STARTING CONSTRUCTION.

76" HAIL IN ASPHALT LOCATED 2.5" WEST OF THE  
FIRST MEDIAN NOSE WEST OF I-66 389 ON HIGHWAY  
90-A. ELEVATION-8-64-09 NAVD83 (2001 ADJUSTMENT)  
NOTE: ALL ELEVATIONS SHOWN WERE DERIVED FROM  
GPS/RIN OBSERVATIONS AND UTILIZED GROUND.

**Federal Emergency Management Agency's flood insurance data shows that April 2, 2014, the subtot total is within Uninsured Zone "X," Standard Zone "X" and areas above within the 500-Year Flood Plain.**

[illegible]

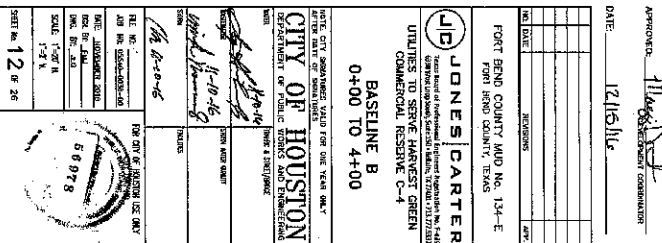
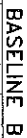

**BENCH MARK**  
2005 FORT BEND COUNTY LIBRARY BENCHMARK NO. 25,  
"THE" NAIL IN A SPURRLE LOCATED 2.2' WEST OF THE  
FIRST MEDIAN NOSE WEST OF E. FM. 350 ON HIGHWAY  
90-A, ELEVATION 484.08 NAVD83 (2004 ADJUSTMENT)

NOTE: ALL ELEVATIONS SHOWN WERE DERIVED FROM  
GPS/RINEX OBSERVATIONS AND UTILIZED GEOLINK.

**100-Year Flood Plot:** 4415270140, of The Federal Emergency Management Agency's Flood Insurance Rate Map dated April 2, 2014, the subject tract is within Unshaded Zone "X", Shaded Zone "X" is defined on areas within the 100-Year Flood Plain.

**Note:** The 100-year base flood elevation is approximately 53.0 feet as per the FEMA Insurance Rate Map for Fort Bend County, Texas Community Panel No. 4615270140, Dated April 2, 2014. The 100-Year Flood Plot, elevation 53.0, is contained in the channel mouth of the detention pond.

**WATER LINE—SANDWICH SEWER CROSSING.**  
PLACE ONE FULL SECTION OF REINFORCED JOINT WATERLINE AND SANDWICH SEWER PIPE TOGETHER AT CROSSING, LABEL SANDWICH SEWER PIPE WITH CORRECTLY STAMPED GAGE FOR THE TOTAL LENGTH OF ONE PIPE (SANDWICH PLUSE ONE FOOT MORE THAN THE LENGTH OF THE WATER LINE). THE WATER LINE PROPOSED WATERLINE IS UNDER PROTECTED SANDWICH SEWER. PROVIDE REINFORCED JOINT PERMANENTLY RATED (AND 160 PSI SANDWICH JOINT SANDWICH SEWER CONSTRUCTION) WITHIN 5' SHEET PILE PROTECTION REINFORCEMENTS AT WATERLINE—SANDWICH SEWER CROSSING. 24" MIN. CLEARANCE, NO SPOTWELD TYP.

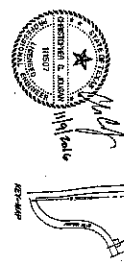

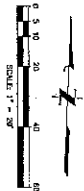

**BENCH MARK**  
2005 FORT BIRD COUNTY LAND BENCHMARK NO. 25, 7'x9" PINE, ON ASPHALT, LOCATED 2.5' WEST OF THE FIRST MEDIAN NOISE TEST OF F.W. 369 ON HIGHWAY 60-4, ELEVATION=64.08 MARCHES (2005 ADJUSTMENT)  
NOTE: ALL ELEVATIONS SHOWN WERE DERIVED FROM GPS/RTK OBSERVATIONS AND UTILIZED GEODATA.

**100-Year Flood Elevations** 4415270N40L of the Federal Emergency Management Agency's Flood Insurance Rate Maps dated April 2, 2014, the subject river is within Unshaded Zone "X". Shaded Zone "X" is defined as areas within the 500-Year Flood Plain.

Note: The 100-Year base flood elevation is reported on the Flood Insurance Rate Map as 4415270N40L. The Community Flood Map for Flood Plain District A-1, 2014, the 100-Year Flood Plain elevation is 42.0, is contained in the channel north of the diversion pond.

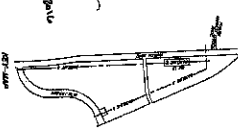

**BASELINE B**

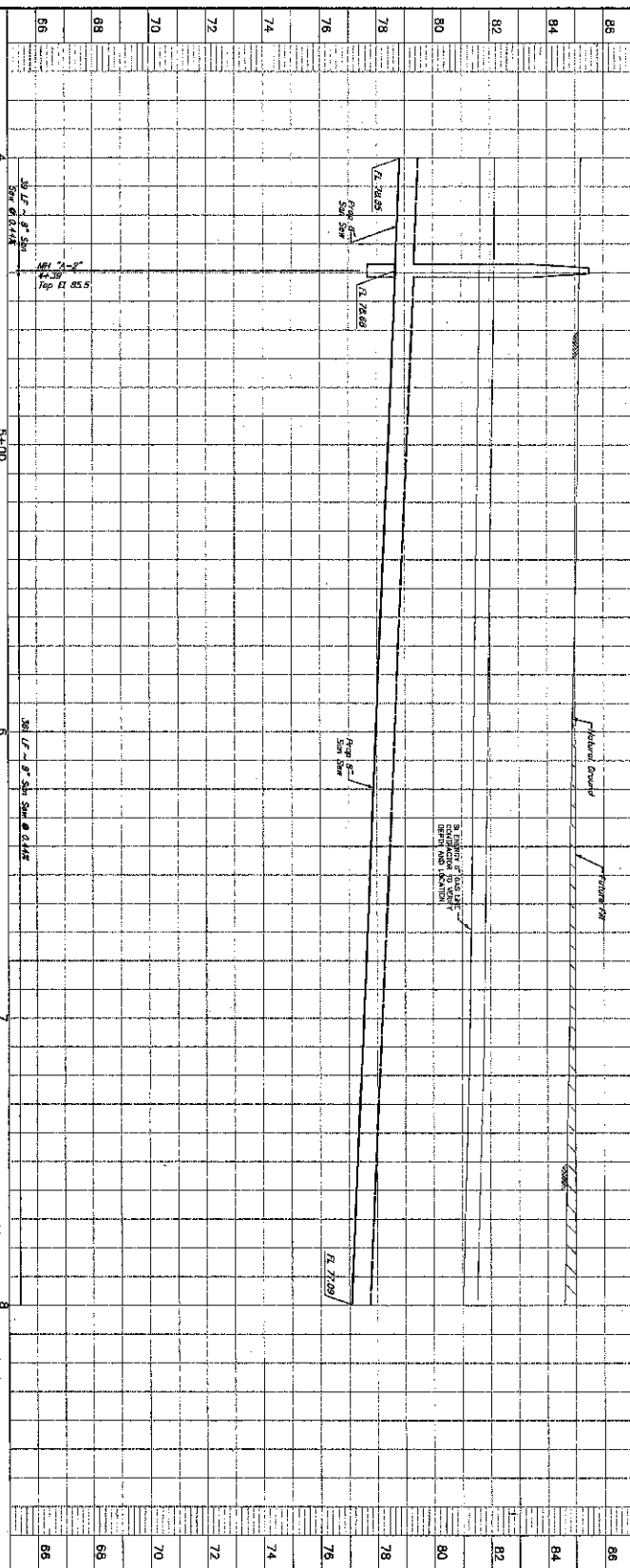

**JONES CARTER**  
 The Journal of Professional Management Analysis, Inc. is a 501(c)(3) CORPORATION, 1000 South 2nd Street, Austin, Texas 78701-1177  
 UTILITIES TO SERVE HARVEST GREEN  
 COMMERCIAL RESERVE C-4  
 BASELINE B  
 4+00 TO 8+00

NOTE: CITY SIGNATURES VALID FOR ONE YEAR ONLY.  
AFTER DATE OF SIGNATURES

**CITY OF HOUSTON**  
DEPARTMENT OF PUBLIC WORKS AND ENGINEERING

DATE: 11/11/2011  
BY: J. L. SHERIDAN

|                          |                     |
|--------------------------|---------------------|
| 11-10-16<br>Wm. J. Brown | SPRING WATER CAVITY |
| 11-10-16<br>Wm. J. Brown | SPRING WATER CAVITY |

FILE NO. \_\_\_\_\_  
 FILE NO. 65-65-105-101  
 FOR CITY OF HOUSTON USE ONLY  
 CITY OF HOUSTON  
 1001 RICE AVENUE  
 HOUSTON, TEXAS 77001

56978

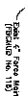

37

[illegible]

**GAS LINE NOTE:**  
NOTIFICATION SHALL BE GIVEN AT LEAST 72 HOURS PRIOR TO ANY WORK NEAR GAS LINE.  
S1 ENERGY GAS LINE: 281-778-6260.  
ISSUE A TEXAS ONE CALL AT LEAST 72 HOURS BEFORE STARTING CONSTRUCTION.

Note: The 100-Year base flood elevation is approximately 83.0 feet, as per the FEMA Insurance Rate Map for Port Beaudouin, Texas Community Panel No. 481520140, dated April 2, 2014. The 100-Year Flood Elevation 83.0, is considered in the channel section of the detention pond.

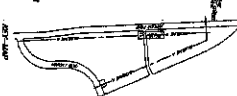









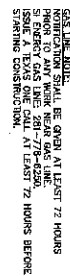

**BEDLICK MARK**  
 2008 FORD FOCUS COUNTY LEASE BEDFORDHAM, MO. 25  
 7'x11' NAIL IN ASPHALT LOCATED 2.5' WEST OF THE  
 FIRST BEDFORDHOLM HOME WEST OF Rte. 350 ON HIGHWAY  
 80-A. ELEVATION=8100 KNOWN (3500 ALTITUDE)  
 NOTE: ALL ELEVATIONS GIVEN WERE DERIVED FROM  
 GPS/RTK OBSERVATIONS AND UTILIZED GEODATA.

Note: The 100-year base flood elevation is approximately 63.6 feet as per the FEMA Flood Insurance Rate Map No. 48127C0340. The Federal Emergency Management Agency's Flood Insurance Rate Map dated April 2, 2014, shows the subject tract is within Unshaded Zone "X". Shaded Zone "X" is defined on areas within the 500-year flood plain.

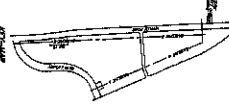

**BASLINE B**

APPROVED: Messy  
DEVELOPMENT COORDINATOR

DATE: 12/15/16

DATE: 12/15/16

FORT BEND COUNTY MUD No. 134-E  
FORT BEND COUNTY, TEXAS

**JONES CARTER**  
 UTILITIES TO SERVE HARVEST GREEN  
 COMMERCIAL RESERVE C-4

BASELINE B  
24+00 TO 27+50

**CITY OF HOUSTON**  
DEPARTMENT OF PUBLIC WORKS AND ENGINEERING

|  |      |          |           |             |      |          |           |             |
|--|------|----------|-----------|-------------|------|----------|-----------|-------------|
|  | DATE | 11-10-16 | SIGNATURE | [Signature] | DATE | 11-10-16 | SIGNATURE | [Signature] |
|  | DATE | 11-10-16 | SIGNATURE | [Signature] | DATE | 11-10-16 | SIGNATURE | [Signature] |

FOR CITY OF HOUSTON USE ONLY  
 DATE: NOVEMBER 2015  
 DOWNS: 100  
 SCALE: 1"=20' H  
 SHEET NO. 18 OF 26

Sheet No. **18** of 26

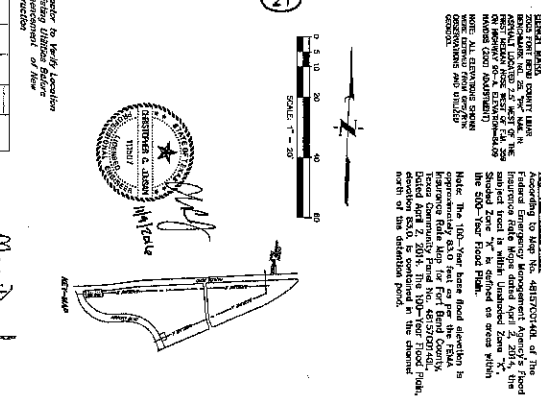

[illegible]

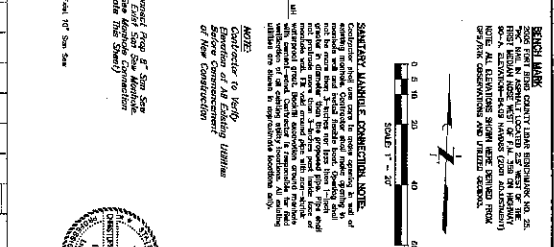

2006 FIRST BLOOD COUNTY LEASER BENJAMIN R. NO. 28  
PAC NAEL IN ASPHALT LOCATED 2.5' WEST OF THE  
FIRST MEDIAN MOORE WEST OF P.M. 3589 ON HIGHWAY  
90-A. ELEVATION-84.09 HAYDES (2006 ADJUSTMENT)

**100-Year Flood Plain.** According to Map No. 4015/2034/UL of the Federal Emergency Management Agency's Flood Insurance Rate Maps dated April 2, 2010, the subject 250' x 100' lot is situated on areas within the 500-Year Flood Plain.

Note: The 100-Year base flood elevation is approximately 83.0 feet as per the FEMA Insurance Rate Map for Fort Bend County, Texas Community Panel No. 46187/2034/UL. The subject 250' x 100' lot is situated on areas within the 500-Year Flood Plain.

The elevation 83.0 is contained in the standard north of the dedication pond.

**100-Year Flood Plain.** According to Map No. 4015/7C0410, of the Federal Emergency Management Agency, Flood Insurance Rate Maps dated April 2, 2010, the subject 250' x 100' area is located on areas within the 500-Year Flood Plain.

Note: The 100-Year base flood elevation is approximately 83.0 feet as per the FEMA Insurance Rate Map for Fort Bend County, Texas Community Panel No. 46187/0410. The elevation 83.0 is contained in the standard north of the dedication pond.

Hand-drawn sketch of a road layout. The sketch shows a main road with a side road branching off to the right. There are handwritten notes and a signature. The signature is "Jef" and the date is "11/9/2014". The sketch is labeled "A23-440" at the bottom left.

[illegible]

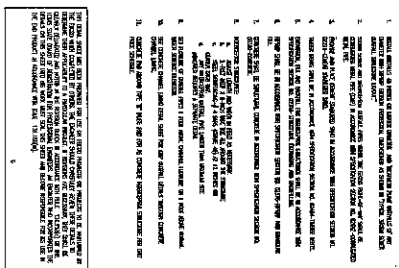

[illegible]

Technical drawing of a bridge structure, showing a plan view and a cross-section.

**Plan View:**

- Centerline
- Abutment
- Pier
- Dimensions: 100' 0" (Total Length), 50' 0" (Span Length), 10' 0" (Abutment Width), 10' 0" (Pier Width)
- Notes: "BRIDGE DECK", "ABUTMENT", "PIER", "CENTERLINE"

**Cross-Section:**

- Dimensions: 10' 0" (Total Width), 5' 0" (Deck Width), 5' 0" (Abutment/Pier Width)
- Notes: "BRIDGE DECK", "ABUTMENT", "PIER", "CENTERLINE"

**Notes:**

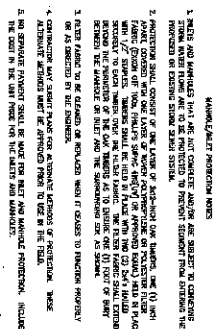
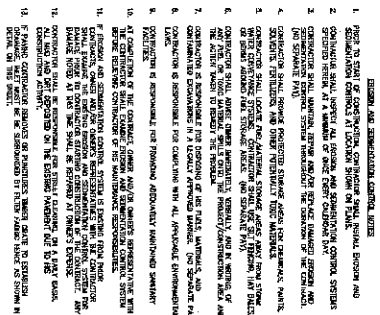

- "BRIDGE DECK"
- "ABUTMENT"
- "PIER"
- "CENTERLINE"
- "10' 0" (Total Length)"
- "50' 0" (Span Length)"
- "10' 0" (Abutment Width)"
- "10' 0" (Pier Width)"
- "5' 0" (Deck Width)"
- "5' 0" (Abutment/Pier Width)"

[illegible]



**Note:** The 100-Year Dates flood elevation is approximately 83.0 feet as per the FEMA Insurance Rate Map for Fort Bend County, Texas Community Panel No. 4815700140L, dated April 2, 2014. The 100-Year Flood Plain, north of the detention pond,

CONSTRUCTION ACCESS

STABILIZED  
CONSTRUCTION ADDRESS  
 REINFORCED FILTER FABRIC BARRIER

FORT BEND COUNTY AUD No. 134-E  
FORT BEND COUNTY, TEXAS

**JIC JONES CARTER**  
 4030 Barclay Street, Suite 100, Oakland, CA 94612 • 415/777-3131  
**UTILITIES TO SERVE HARVEST GREEN  
 COMMERCIAL RESERVE C-4**

**STORM WATER POLLUTION  
 PREVENTION PLAN I**

**CITY OF HOUSTON**  
DEPARTMENT OF PUBLIC WORKS AND FINANCE

[illegible]

FILE NO. \_\_\_\_\_  
JOS. NO. 55848-COM-02  
DATE NOVEMBER 2006  
OFA BY: PJA  
BRI. BY: AS  
SCALE: 1"=100'

FOR CITY OF HOUSTON, TEX.  
SEALED  
56978

24 OF 28



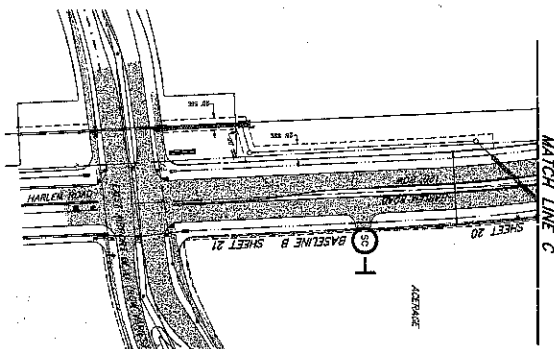
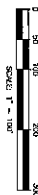

- [illegible]

[illegible]

Note: The 100-Year base flood elevation is approximately 83.0 feet as per the FEMA Insurance Rate Map for Fort Belvoir National Training Center, dated April 2, 2014. The subject tract is within Unshaded Zone "X". Shaded Zone "X" is defined as areas within the 500-Year Flood Plain.

Federal Emergency Management Agency's Flood Insurance Rate Maps dated April 2, 2014, the subject tract is within Unshaded Zone "X".

Shaded Zone "X" is defined as areas within the 500-Year Flood Plain.

NOTE: ALL ELEVATIONS SHOWN WERE DERIVED FROM GPS/TRIP OBSERVATIONS AND UTILIZED GROUND.

STABILIZED  
CONSTRUCTION ACCESS

 STABILIZED CORN FRACTURE ACCESS

 REINFORCED FILTER FABRIC BARRIER

APPROVED: M. J. [Signature]  
DEVELOPMENT COORDINATOR

DATE: 11/15/16

DATE: 10/22/10

[illegible]

FORT BEND COUNTY MUD No. 134-E  
FORT BEND COUNTY, TEXAS

**JONES CARTER**

UTILITIES TO SERVE HARVEST GREEN  
COMMERCIAL RESERVE C-4

## STORM WATER POLLUTION

NOTES: CITY SIGNATURES VALID FOR ONE YEAR ONLY

CITY OF HOUSTON  
DEPARTMENT OF PUBLIC WORKS AND ENGINEERING

11-10-12

16-11-10-15

FOR LIST OF POSSIBLE USES ONLY

FILE NO. \_\_\_\_\_  
DATE 05/22/2006  
BY SP-10/MS/MS

560

STATE 1-1998

07

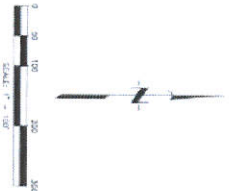
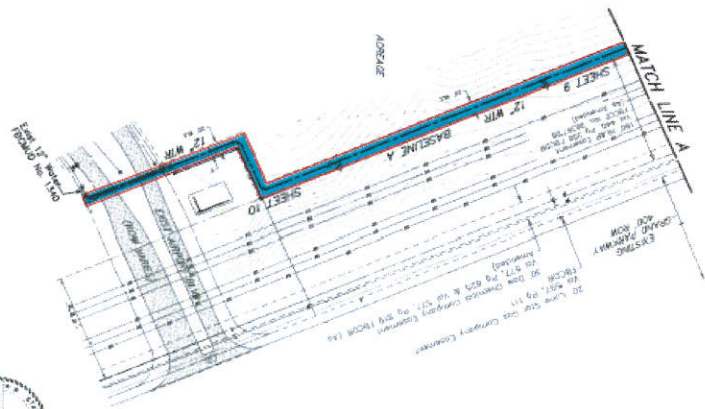

[illegible]

**100-Year Flood Risk**  
According to MCE, the 4819701-02 of The Federal Emergency Management Agency's National Flood Insurance Program (NFIP) for the insurance file with attached rate 1, 250,000 was subject to a 100-year flood risk. The subject zone is within unshaded zone 1A. Shaded zone 1A is different to areas within the 100-year flood plain.

**Note:** The 100-year beam flood elevation is approximately 8.0m above the datum. The insurance file for the 100-year flood risk, first Community Rating, No. 4819701-02, dated April 2, 2014, the 100-year Flood Protection SLO, is contained in the channel mouth of the dewater pond.

NOTE: ALL LOCATIONS SHOWN WERE DERIVED FROM GPS/RTK OBSERVATIONS AND WERE CORRECTED.

**Waterline** Not to be included in this project

|   |           |                |
|---|-----------|----------------|
| APPROVED: <i>M. J. Carter</i><br>ENGINEER-IN-CHARGE   |           | DATE: 12/16/13 |
| PROJECT: FORD BRAND COUNTY MUD NO. 134-E<br>LOCATION: FORD BRAND COUNTY TEXAS   |           |                |
| NO. 1234  | REVISIONS | NOT            |
| JC JONES CARTER<br>"We are proud to serve the community."<br>UTILITIES TO SERVE HANSTON GREEN<br>COMMERCIAL RESERVE C-4<br>GENERAL CONSTRUCTION LAYOUT<br>WATER AND<br>SANITARY SEWER |           |                |
| DATE: 12/16/13<br>DRAWN BY: J. JONES<br>CHECKED BY: J. JONES<br>SCALE: 1" = 40'   |           |                |
| CITY OF HOUSTON<br>DEPARTMENT OF PUBLIC WORKS<br>1500 WEST 19TH STREET<br>HOUSTON, TEXAS 77008  |           |                |
| FOR CITY OF HOUSTON USE ONLY<br>56878   |           |                |

### Work Beyond the Shoulder

1. The signs illustrated in this figure are not required if the work space is behind a barrier, more than 0.6 meters (2 feet) behind the curb, or 4.5 meters (15 feet) or more from the edge of any roadway.
2. The ROAD WORK AHEAD sign may be replaced with other appropriate signs, such as the SHOULDER WORK sign. The SHOULDER WORK sign may be used for work adjacent to the shoulder.
3. If the work space is in the median of a divided highway, an advance warning sign should also be placed on the left side of the directional roadway.
4. For short-term, short-duration, or mobile operation, all signs and channelizing devices may be eliminated if a vehicle with an activated flashing or revolving light is used.



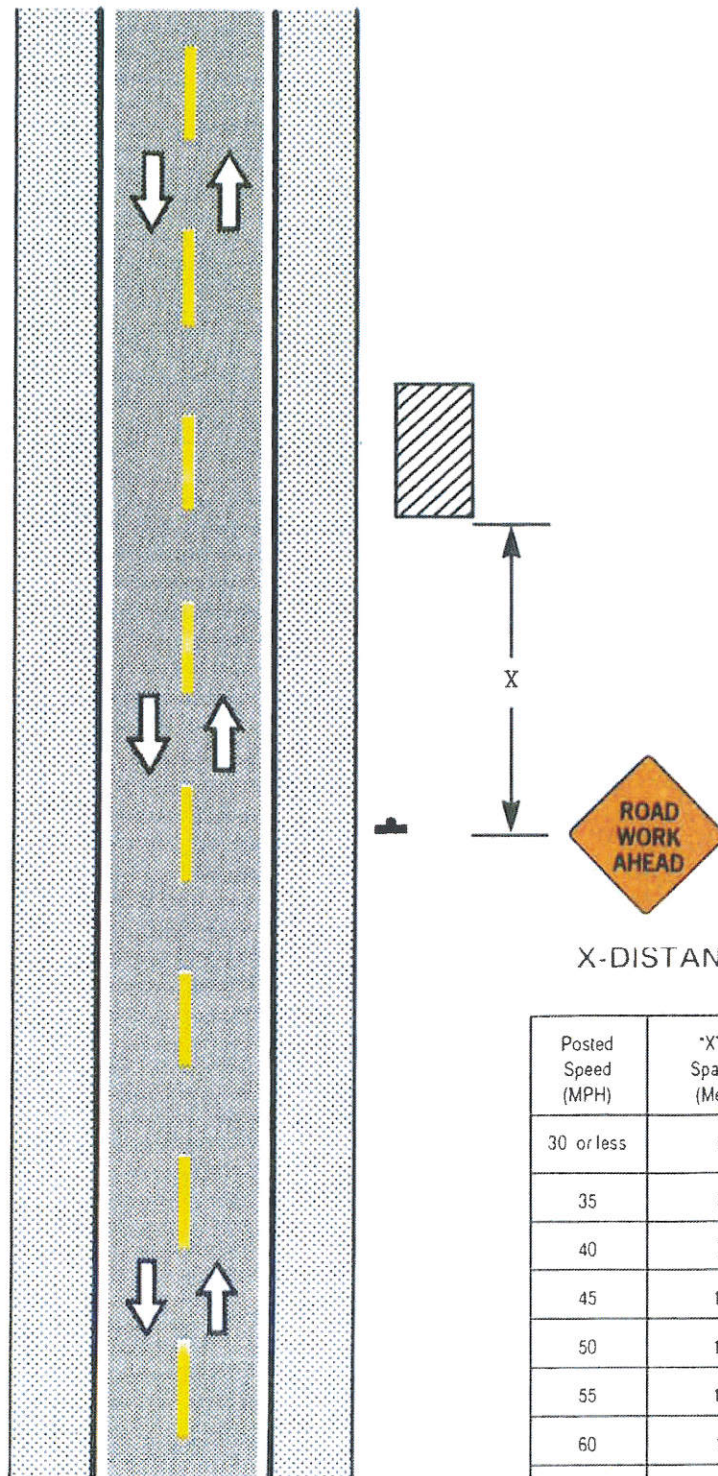

Figure TA-1. Work beyond the shoulder.