



REVIEW BY FORT BEND COUNTY COMMISSIONERS COURT

Fort Bend County Engineering Department
301 Jackson Suite 401
Richmond, Texas 77469
281.633.7500
Permits@fortbendcountytexas.gov

Right of Way Permit
 Commercial Driveway Permit
Permit No: 2017-13527

Applicant: Blackstone Construction, Inc/The Interfield Group

Job Location Site: 21690 FM 1093, Richmond, TX 77407

Bond No. 100700000 **Date of Bond:** 4/27/2017 **Amount:** \$15,000.00

The above applicant came to make use of certain Fort Bend County property subject to, "The Order Regulating the Laying, Construction, Maintenance, and Repair of Buried Cables, Conduits, and Pole Lines, In, Under, Across or Along Roads, Streets, Highways, and Drainage Ditches in Fort Bend County, Texas, Under the Jurisdiction of the Commissioners Court of Fort Bend County, Texas," as passed by the Commissioners Court of Fort Bend County, Texas, of the Minutes of the Commissioners Court of Fort Bend County, Texas, to the extent that such order is not inconsistent with Chapter 181, Vernon's Texas Statutes and Codes Annotated.

Notes:

1. Evidence of review by the Commissioners Court must be kept on the job site and failure to do so constitutes grounds for job shutdown.
2. Written notices are required:
 - a. 48 hours in advance of construction start up, and
 - b. When construction is completed and ready for final inspection, submit notification to Permit Administrator thru MyGovernmentOnline.org portal.
3. This permit expires one (1) year from date of permit if construction has not commenced.

On this 9th day of May, 2017, Upon Motion of Commissioner Meyers, seconded by Commissioner Morales, duly put and carried, it is ORDERED, ADJUDGED AND DECREED that said notice of said above purpose is hereby acknowledged by the Commissioners Court of Fort Bend County, Texas, and that said notice be placed on record according to the regulation order thereof.

Signature
By: Chandy O. Ay
County Engineer

Presented to Commissioners Court and approved.
Date Recorded 5-15-2017 Comm. Court No. 11H

N/A
By: _____
Drainage District Engineer/Manager

Clerk of Commissioners Court
By: Aronda Walters
Deputy

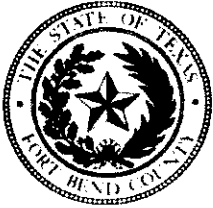

**PERMIT APPLICATION REVIEW FORM FOR
CABLE, CONDUIT, AND POLE LINE ACTIVITY
IN FORT BEND COUNTY**

**Fort Bend County
Engineering Department**
301 Jackson Suite 401
Richmond, Texas 77469
281.633.7500
Permits@fortbendcountytexas.gov

- Right of Way Permit
 Commercial Driveway Permit

Permit No: 2017-13527

The following "Notice of Proposed Cable, Conduit, and/or Pole Line activity in Fort Bend County" and accompanying attachments have been reviewed and the notice conforms to appropriate regulations set by Commissioner's Court of Fort Bend County, Texas.

(1) COMPLETE APPLICATION FORM:

- a. Name of road, street, and/or drainage ditch affected.
 b. Vicinity map showing course of directions
 c. Plans and specifications

(2) BOND:

- County Attorney, approval when applicable.
- Perpetual bond currently posted. Bond No: _____ Amount: _____
- Performance bond submitted. Bond No: XXXXXXXXXX Amount: \$15,000.00
- Cashier's Check Check No: _____ Amount: _____

(3) DRAINAGE DISTRICT APPROVAL (WHEN APPLICABLE):

Drainage District Approval

Date

We have reviewed this project and agree it meets minimum requirements.

Charley O. Ay

Permit Administrator

5/2/17

Date

This bond is payable at the County Courthouse in the County of Fort Bend and State of Texas.

It is understood that at any time Fort Bend County deems itself insecure under this bond, it may require further and/or additional bonds of the principal.

EXECUTED this 27 day of April, 2017.

BLACKSTONE CONSTRUCTION INC.

PRINCIPAL

[Handwritten Signature]
BY _____

Travelers Casualty and Surety Company of America

SURETY

[Handwritten Signature]
BY **Joseph L. Nespor**

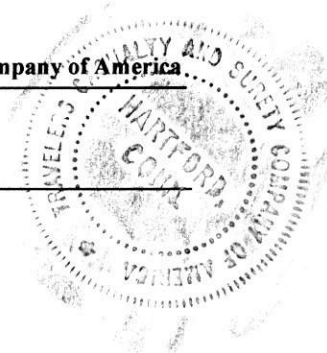



POWER OF ATTORNEY

Farmington Casualty Company
Fidelity and Guaranty Insurance Company
Fidelity and Guaranty Insurance Underwriters, Inc.
St. Paul Fire and Marine Insurance Company
St. Paul Guardian Insurance Company

St. Paul Mercury Insurance Company
Travelers Casualty and Surety Company
Travelers Casualty and Surety Company of America
United States Fidelity and Guaranty Company

Surety Bond No. [Redacted]

Principal: BLACKSTONE CONSTRUCTION INC.
9225 KATY FREEWAY SUITE 104 HOUSTON, TX 77024

Obligee: County Judge of Fort Bend County
301 Jackson St., Suite 401 Department of Engineering
RICHMOND, TX 77469

KNOW ALL MEN BY THESE PRESENTS: That Farmington Casualty Company, St. Paul Fire and Marine Insurance Company, St. Paul Guardian Insurance Company, St. Paul Mercury Insurance Company, Travelers Casualty and Surety Company, Travelers Casualty and Surety Company of America, and United States Fidelity and Guaranty Company, are corporations duly organized under the laws of the State of Connecticut, that Fidelity and Guaranty Insurance Company is a corporation duly organized under the laws of the State of Iowa, and that Fidelity and Guaranty Insurance Underwriters, Inc. is a corporation duly organized under the laws of the State of Wisconsin (herein collectively called the "Companies"), and that the Companies do hereby make, constitute and appoint Joseph L. Nespor, of the City of Hartford, State of CT, their true and lawful Attorney(s)-in-Fact, to sign, execute, seal and acknowledge the surety bond referenced above.

IN WITNESS WHEREOF, the Companies have caused this instrument to be signed and their corporate seals to be hereto affixed, this 7th day of July, 2016.

Farmington Casualty Company
Fidelity and Guaranty Insurance Company
Fidelity and Guaranty Insurance Underwriters, Inc.
St. Paul Fire and Marine Insurance Company
St. Paul Guardian Insurance Company

St. Paul Mercury Insurance Company
Travelers Casualty and Surety Company
Travelers Casualty and Surety Company of America
United States Fidelity and Guaranty Company



State of Connecticut

City of Hartford ss.

By: [Signature]
Robert L. Raney, Senior Vice President

On this the 7th day of July, 2016, before me personally appeared Robert L. Raney, who acknowledged himself to be the Senior Vice President of Farmington Casualty Company, Fidelity and Guaranty Insurance Company, Fidelity and Guaranty Insurance Underwriters, Inc., St. Paul Fire and Marine Insurance Company, St. Paul Guardian Insurance Company, St. Paul Mercury Insurance Company, Travelers Casualty and Surety Company, Travelers Casualty and Surety Company of America, and United States Fidelity and Guaranty Company, and that he, as such, being authorized so to do, executed the foregoing instrument for the purposes therein contained by signing on behalf of the corporations by himself as a duly authorized officer.

In Witness Whereof, I hereunto set my hand and official seal.

My Commission expires the 30th day of June, 2021.



[Signature]
Marie C. Tetreault, Notary Public

This Power of Attorney is granted under and by the authority of the following resolutions adopted by the Boards of Directors of Farmington Casualty Company, Fidelity and Guaranty Insurance Company, Fidelity and Guaranty Insurance Underwriters, Inc., St. Paul Fire and Marine Insurance Company, St. Paul Guardian Insurance Company, St. Paul Mercury Insurance Company, Travelers Casualty and Surety Company, Travelers Casualty and Surety Company of America, and United States Fidelity and Guaranty Company, which resolutions are now in full force and effect, reading as follows:

RESOLVED, that the Chairman, the President, any Vice Chairman, any Executive Vice President, any Senior Vice President, any Vice President, any Second Vice President, the Treasurer, any Assistant Treasurer, the Corporate Secretary or any Assistant Secretary may appoint Attorneys-in-Fact and Agents to act for and on behalf of the Company and may give such appointee such authority as his or her certificate of authority may prescribe to sign with the Company's name and seal with the Company's seal bonds, recognizances, contracts of indemnity, and other writings obligatory in the nature of a bond, recognizance, or conditional undertaking, and any of said officers or the Board of Directors at any time may remove any such appointee and revoke the power given him or her; and it is

FURTHER RESOLVED, that the Chairman, the President, any Vice Chairman, any Executive Vice President, any Senior Vice President or any Vice President may delegate all or any part of the foregoing authority to one or more officers or employees of this Company, provided that each such delegation is in writing and a copy thereof is filed in the office of the Secretary; and it is

FURTHER RESOLVED, that any bond, recognizance, contract of indemnity, or writing obligatory in the nature of a bond, recognizance, or conditional undertaking shall be valid and binding upon the Company when (a) signed by the President, any Vice Chairman, any Executive Vice President, any Senior Vice President or any Vice President, the Treasurer, any Assistant Treasurer, the Corporate Secretary or any Assistant Secretary and duly attested and sealed with the Company's seal by a Secretary or Assistant Secretary; or (b) duly executed (under seal, if required) by one or more Attorneys-in-Fact and Agents pursuant to the power prescribed in his or her certificate or their certificates of authority or by one or more Company officers pursuant to a written delegation of authority; and it is

FURTHER RESOLVED, that the signature of each of the following officers: President, any Executive Vice President, any Senior Vice President, any Vice President, any Assistant Vice President, any Secretary, any Assistant Secretary, and the seal of the Company may be affixed by facsimile to any Power of Attorney or to any certificate relating thereto appointing Resident Vice Presidents, Resident Assistant Secretaries or Attorneys-in-Fact for purposes only of executing and attesting bonds and undertakings and other writings obligatory in the nature thereof, and any such Power of Attorney or certificate bearing such facsimile signature or facsimile seal shall be valid and binding upon the Company and any such power so executed and certified by such facsimile signature and facsimile seal shall be valid and binding on the Company in the future with respect to any bond or understanding to which it is attached.

I, Kevin E. Hughes, the undersigned, Assistant Secretary, of Farmington Casualty Company, Fidelity and Guaranty Insurance Company, Fidelity and Guaranty Insurance Underwriters, Inc., St. Paul Fire and Marine Insurance Company, St. Paul Guardian Insurance Company, St. Paul Mercury Insurance Company, Travelers Casualty and Surety Company, Travelers Casualty and Surety Company of America, and United States Fidelity and Guaranty Company do hereby certify that the above and foregoing is a true and correct copy of the Power of Attorney executed by said Companies, which is in full force and effect and has not been revoked.

IN TESTIMONY WHEREOF, I have hereunto set my hand and affixed the seals of said Companies this 27 day of April, 2017.

Kevin E. Hughes, Assistant Secretary

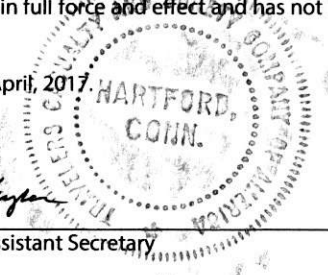

To verify the authenticity of this Power of Attorney, call 1-800-421-3880 or contact us at www.travelersbond.com. Please refer to the above-named individuals and the details of the bond to which the power is attached.

FILED AND RECORDED
OFFICIAL PUBLIC RECORDS

Laura Richard



Laura Richard, County Clerk
Fort Bend County, Texas

May 12, 2017 02:54:38 PM

FEE: \$0.00 PG1
BOND

2017051643

24SEVEN PROPOSED RETAIL CENTER / GAS STATION

21690 FM 1093 RICHMOND, TX 77407

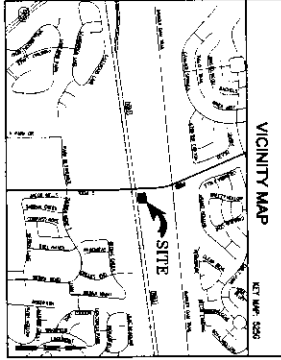

INDEX OF DRAWINGS

- 010 CIVIL SITE PLAN
- 011 SITE GRADING & FINISHED FLOOR
- 012 SITE UTILITIES PLAN
- 013 SPECIAL LIGHT POLLUTION MITIGATION PLAN
- 014 SPECIAL LIGHT PLAN
- 015 SPECIAL LIGHT REPORT
- 016 LEFT & RIGHT TURN LAYOUT
- 017-018 INTERIOR FINISHES (SEE SHEETS 1000)
- 1000 TRAFFIC CONTROL PLAN

ONE CALL NOTIFICATION SYSTEM
CALL BEFORE YOU DIG !!!
 (713) 223-4567 (IN HOUSTON)
 (NEW STATEWIDE NUMBER OUTSIDE HOUSTON)
 1-800-345-6005



THIS DRAWING CONTAINS INFORMATION THAT IS UNCLASSIFIED AND IS BEING RELEASED TO THE PUBLIC IN FULL.
 DATE: 10/27/16
 THESE DRAWINGS ARE NOT TO BE USED FOR CONSTRUCTION UNTIL THE COMMENCER IN WRITING FROM THE ARCHITECT.
 APPROVED: *[Signature]*
 DESIGNATED REPRESENTATIVE
 NAME: INTERFIELD

<p>OWNER 24 SEVEN 10701 W. BELLEVILLE, SUITE 115 HOUSTON, TX 77069 TEL. (281) 561-5135 FAX. (281) 456-7899</p>	<p>PROJECT 24 SEVEN PROPOSED RETAIL CENTER / GAS STATION 21690 FM 1093 RICHMOND, TX 77407 PROJECT# 15026.00</p>	<p>INTERFIELD engineering architecture 401 STUDERWOOD, SUITE 300 TEL. (713) 780-0600 HOUSTON, TEXAS 77007 TX. REG. NO. F-501 WWW.INTERFIELD.NET</p> 	<p>SURVEYOR ADVANCE SURVEYING, INC. 10216 HOP WAY SUITE 6-1 HOUSTON, TX 77069 PHONE: 281-530-2939 OFFICE FAX: 281-530-5464</p>	<p>ARCHITECT INTERFIELD ENGINEERING / ARCHITECTURE 401 STUDERWOOD SUITE 300 HOUSTON, TX 77007 OFFICE PHONE(CELL): 713-760-0600 WWW.INTERFIELD.NET</p>
---	---	--	--	--

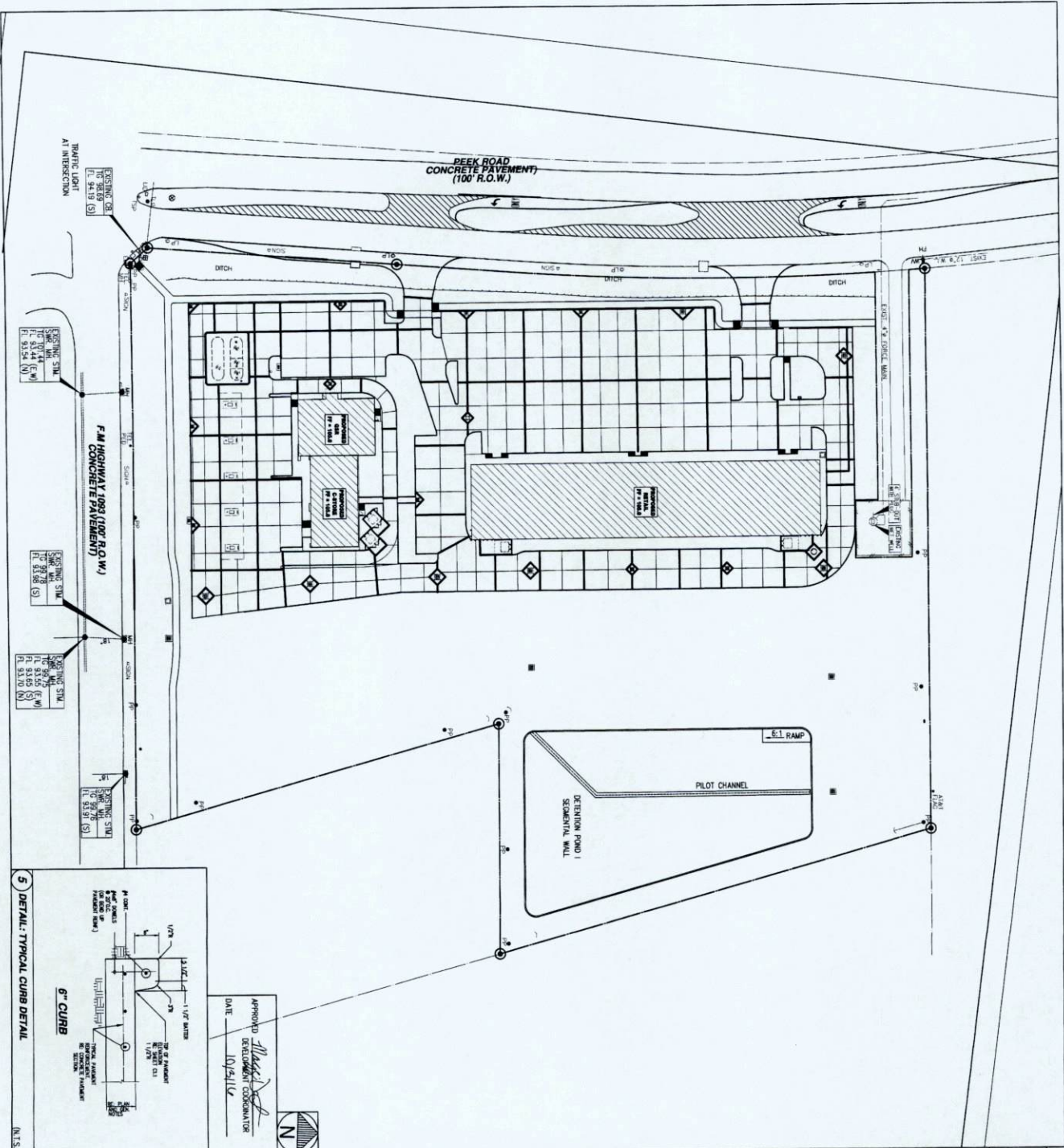

LEGEND

PROPERTY LINE
 EXPANSION JOINT
 CONCRETE JOINT
 CATCH BASIN (CB)

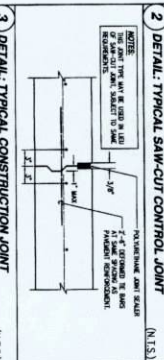
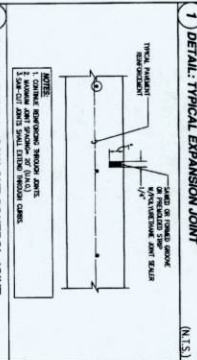
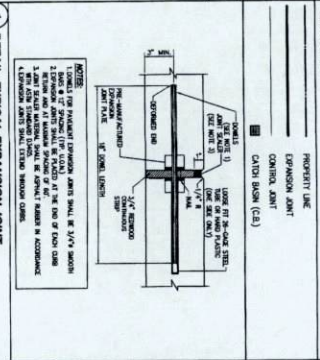

3 SOILS REPORT NOTE

PROJECT NO. 015-338 DATE: JUNE 11, 2015
 PREPARED BY: JAM SOIL TESTING, LLC

CONTRACTOR SHALL REVIEW & SIGN APPROVAL TABLE W/ THE CONTENTS OF REFERENCED SOILS REPORT WHICH WILL BE CONSIDERED AN INTEGRAL PART OF THE CONTRACT DOCUMENTS. CONTRACTOR SHALL BE RESPONSIBLE FOR THE RESPONSIBILITY OF THE CONTRACTOR.

SITE PREPARATION AND FILL:

- REMOVE ALL WEEDS, TREE ROOTS, ORGANIC TOPSOIL AND ANY UNSUBSTRATE MATERIAL FROM THE CONSTRUCTION AREA. A SOIL TEST AND ASSAY SHALL BE PERFORMED TO DETERMINE THE NUTRIENT CONTENT OF THE SOIL. THE SOIL SHALL BE AMENDED WITH NUTRIENTS AS NECESSARY TO MEET THE REQUIREMENTS OF THE CONTRACTOR.
- EXPANSION JOINTS SHOULD BE BROKE-OUT WITH A 1-1/2" SQUARE OR OTHER EQUIVALENT SQUARE COMPONENT AS APPROVED BY THE ENGINEER.

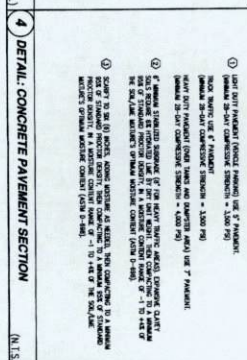
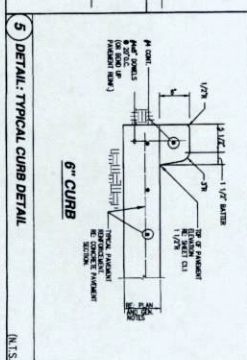

ISSUE HISTORY		REVISIONS	
DATE	ISSUED FOR	DATE	DESCRIPTION
04/26/16	PERMIT		
05/05/16	PERMIT		
06/17/16	PERMIT		
06/22/16	PERMIT		
09/19/16	PERMIT		
09/22/16	PERMIT		

INTERFIELD
 engineering | architecture

401 STUBBWOOD, SUITE 300 TEL: (713) 780-0608
 HOUSTON, TEXAS 77007 TX. REG. NO. F-5811
 WWW.INTERFIELD.NET

DATE: 06/19/15
 DRAWN BY: SK
 PROJECT # 15026.00

ASPERU
 PROPOSED RETAIL
 CENTER/IGAS STATION
 21869 FM 1093
 RICHMOND, TX 77407
 SITE PAVING PLAN

SCALE: 1" = 40'
 0 40 80 FT
 9/12/15

SEAL: 19120
 REGISTERED PROFESSIONAL ENGINEER
 STATE OF TEXAS

SHEET C1.4 OF 13

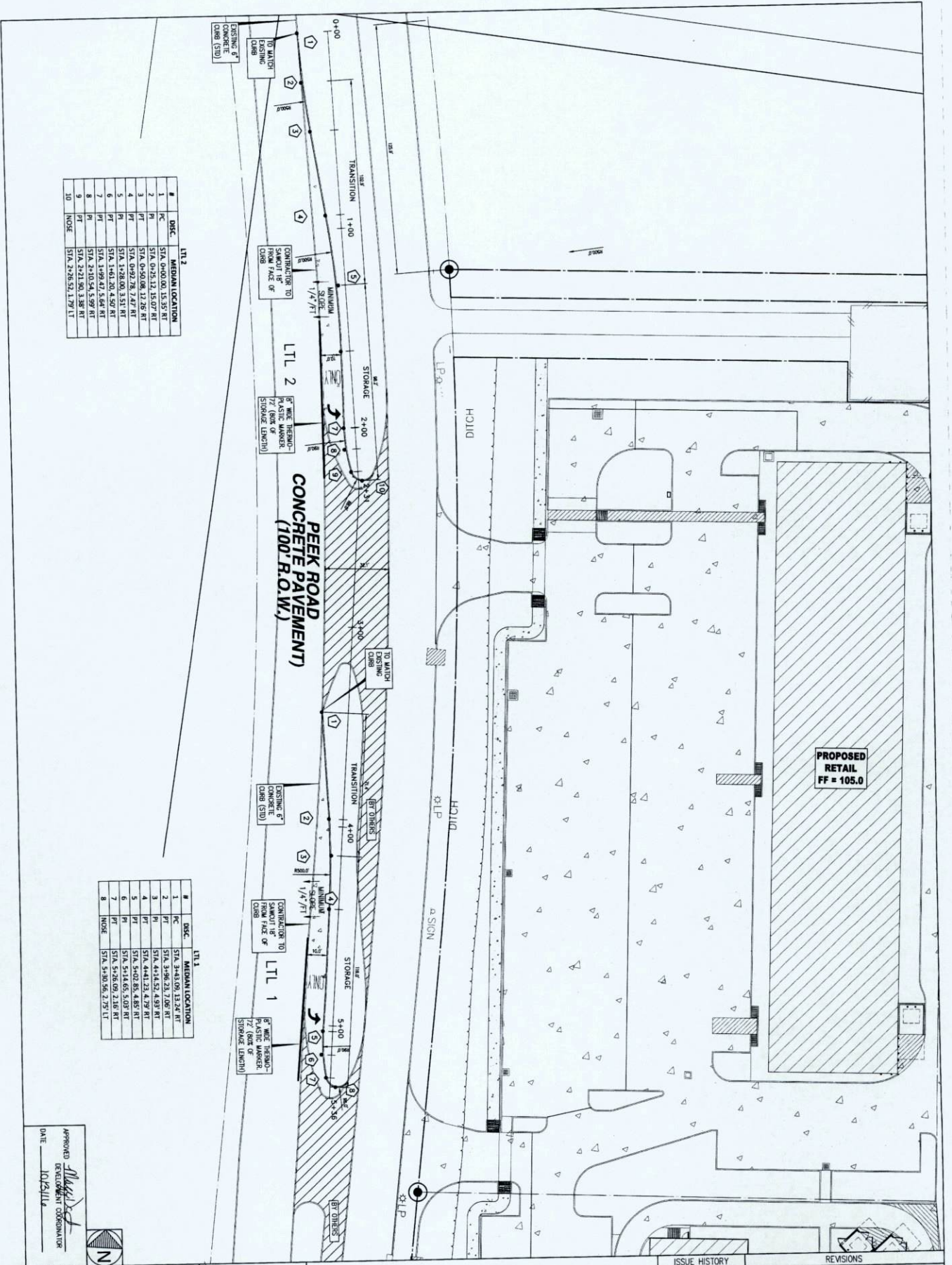

LTL 3

#	DESC.	MEDIUM LOCATION
1	PC	STA. 0+00.00, 13.35 RT
2	PT	STA. 0+25.12, 13.07 RT
3	PT	STA. 0+50.08, 12.26 RT
4	PT	STA. 0+92.78, 7.47 RT
5	PT	STA. 1+28.00, 3.51 RT
6	PT	STA. 1+61.20, 4.50 RT
7	PT	STA. 1+99.42, 5.64 RT
8	PT	STA. 2+10.54, 5.99 RT
9	PT	STA. 2+21.90, 3.38 RT
10	NOSE	STA. 2+26.52, 1.79 LT

LTL 1

#	DESC.	MEDIUM LOCATION
1	PC	STA. 3+43.09, 13.24 RT
2	PT	STA. 3+96.23, 7.08 RT
3	PT	STA. 4+14.52, 4.93 RT
4	PT	STA. 4+41.23, 4.79 RT
5	PT	STA. 5+02.85, 4.85 RT
6	PT	STA. 5+14.65, 5.03 RT
7	PT	STA. 5+26.09, 2.18 RT
8	NOSE	STA. 5+30.56, 2.73 LT

APPROVED: *[Signature]*
 DEVELOPMENT COORDINATOR
 DATE: 10/23/14

PROJECT # 150076.00
 DATE: 06/10/15
 DRAWN BY: RB
 CHECKED BY: JES

24SEVEN PROPOSED RETAIL CENTER/GAS STATION 21600 FM 1093 (NICHOLSON) TX 77067 LEFT TURN LANE

SHEET C1.6 OF 13



INTERFIELD
 engineering | architecture
 401 STUDEWOOD, SUITE 300 TEL. (713) 780-0609
 HOUSTON, TEXAS 77007 TX. REG. NO. F-561
 WWW.INTERFIELD.NET

ISSUE HISTORY			REVISIONS	
DATE	ISSUED FOR	DATE	DATE	DESCRIPTION
04/26/16	PERMIT			
05/05/16	PERMIT			
06/10/16	PERMIT			
08/29/16	PERMIT			
09/19/16	PERMIT			
09/23/16	PERMIT			

DISCLAIMER:
The use of this standard is governed by the "Texas Engineering Practice Act". No warranty of any kind is made by TxDOT for any purpose whatsoever. TxDOT assumes no responsibility for the conversion of this standard to other formats or for incorrect results or damages resulting from its use.

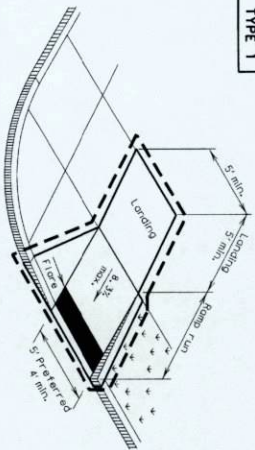

TYPE 1

PERPENDICULAR CURB RAMP

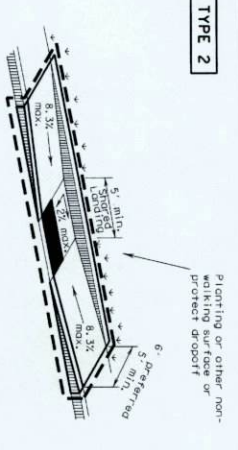

TYPE 2

PARALLEL CURB RAMP
(Use only where water will not pond in the landing.)

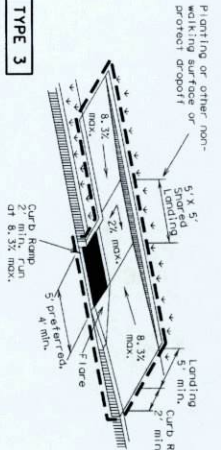

TYPE 3

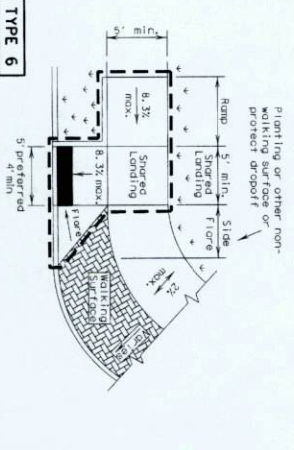

TYPE 6

COMBINATION CURB RAMPS

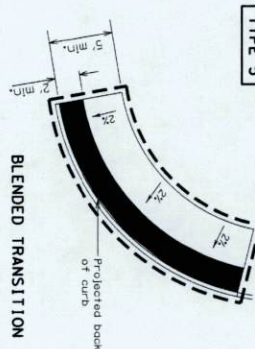

TYPE 5

BLENDED TRANSITION

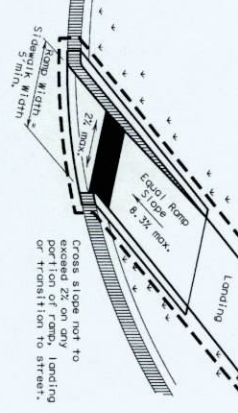

TYPE 7

DIRECTIONAL RAMPS WITHIN RADIUS
(Sidewalk set back from curb)

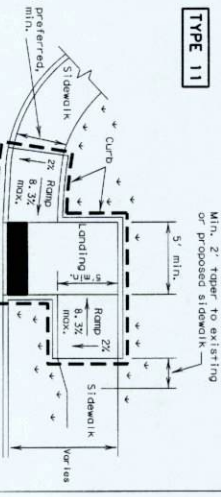

TYPE 11

OFFSET PARALLEL CURB RAMP

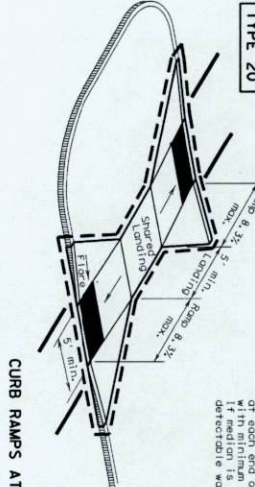

TYPE 20

CURB RAMPS AT MEDIAN ISLANDS

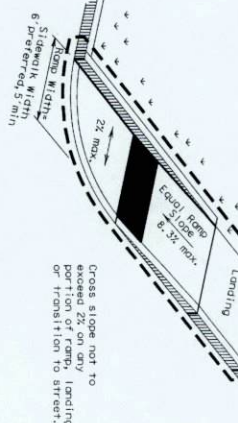

TYPE 10

DIRECTIONAL RAMPS WITHIN RADIUS
(Sidewalk adjacent to curb)

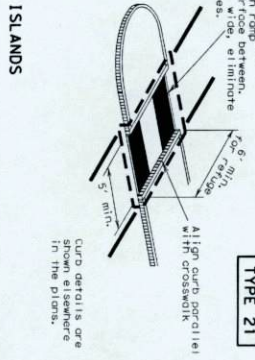

TYPE 21

CURB RAMPS AT MEDIAN ISLANDS

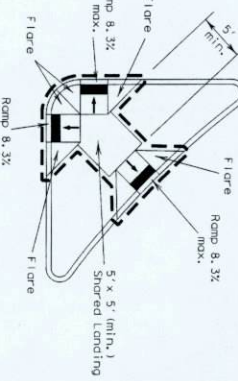

TYPE 22

COMBINATION ISLAND RAMPS

NOTES / LEGEND:
See General Notes on sheet 2 of 4 for more information.
X X X Denotes planting or non-walking surface not part of pedestrian circulation path.
--- Ramp Limits of Payment
■ Detectable Warning Surface

Texas Department of Transportation		Design Standard	
PEDESTRIAN FACILITIES			
CURB RAMPS			
PED-12A			
FILED: 06/13/2012	BY: [Signature]	DATE: 06/13/2012	BY: [Signature]
PROJECT: [Blank]	DATE: [Blank]	BY: [Blank]	DATE: [Blank]
DATE: [Blank]	BY: [Blank]	DATE: [Blank]	BY: [Blank]

10/5/12

DISCLAIMER: This standard is governed by the "Texas Engineering Practice Act". No warranty of any kind is made by TxDOT for any purpose whatsoever. TxDOT assumes no responsibility for the conversion of this standard to other formats or for incorrect results or damages resulting from its use.

GENERAL NOTES

- Curb Ramps**
1. Install a curb ramp or blended transition at each pedestrian street crossing.
 2. All slopes shown are maximum allowable. Lesser slopes that will still drain properly should be used. Adjust curb ramp length or grade of approach sidewalks as directed.
 3. The minimum sidewalk width is 5'. Where the sidewalk is adjacent to the back of curb, a 6' sidewalk width is desirable. Where a 5' sidewalk is provided due to site constraints, sidewalk width may be reduced to 4' at the street. A 5' x 5' passing area of 10' x 10' may be provided to exceed 200' or required.
 4. Landings shall be 5' x 5' minimum with a maximum 2% slope in any direction.
 5. Maneuvering space at the bottom of curb ramps shall be a minimum of 4' x 4' wholly contained within the crosswalk and wholly outside the parallel vehicular travel path.
 6. Maximum allowable cross slope on sidewalk and curb ramp surfaces is 2%.
 7. Provide flared sides where the pedestrian circulation path crosses the curb ramp. Flared sides shall be sloped at 10% maximum, measured normally to the curb. Flared curbs may be used only where pedestrian travel is not normally obstructed, or either because the adjacent surface is planted, substantially obstructed, or otherwise protected.
 8. Additional information on curb ramp location, design, light reflective value and materials may be found in the current edition of the Texas Accessibility Standards (TAS) and 16 TAC 68.102.
 9. To serve as a pedestrian refuge area, the median should be a minimum of 6' wide, measured from back of curbs. Medians should be designed to provide accessible passage over or through them.
 10. Small channelization islands, which do not provide a minimum 5' x 5' landing at the top of curb ramps, shall be cut through level with the surface of the street.
 11. Crosswalk dimensions, crosswalk markings and stop bar locations shall be as shown elsewhere in the plans. At intersections where crosswalk markings are not required, curb ramps shall align with theoretical crosswalks unless otherwise directed.
 12. Handrails are not required on curb ramps. Provide curb ramps wherever an accessible route crosses (perforates) a curb.
 13. Curb ramps and landings shall be constructed and paid for in accordance with Item 531 "Sidewalks".
 14. Place concrete at a minimum depth of 5" for ramps, flares and landings, unless otherwise directed.
 15. Provide a smooth transition where the curb ramps connect to the street.
 16. Curbs shown on sheet 1 within the limits of pavement are considered part of the curb ramp for payment, whether it is concrete curb, gutter, or combined curb and gutter.
 17. Existing features that comply with TAS may remain in place unless otherwise shown on the plans.
- Detectable Warning Material**
18. Curb ramps must contain a detectable warning surface that consists of raised triangular or rectangular units complying with Section 705 of the TAS. The surface must contrast markedly with adjoining surfaces, including side flares. Furnish and install an approved cast-in-place dark brown or dark red detectable warning surface material adjacent to uncolored concrete, unless specified elsewhere in the plans.
 19. Detectable Warning Materials must meet TxDOT Departmental Materials Specification DMS 4350 and be listed on the Material Producer List. Install products in accordance with manufacturer's specifications.
 20. Detectable warning surfaces must be slip resistant and not allow water to accumulate.
 21. Detectable warning surfaces shall be a minimum of 24" in depth in the direction of pedestrian travel and extend the full width of the curb ramp or landing where the pedestrian access route enters the street.
 22. Detectable warning surfaces shall be located so that the edge nearest the curb line is at the back of curb. Align the rows of domes to be perpendicular to the grade break between the ramp run and the street. Detectable warning surfaces may be curved along the corner radius.
 23. Staked areas on Sheet 1 of 4 indicate the approximate location for the detectable warning surface for each curb ramp type.

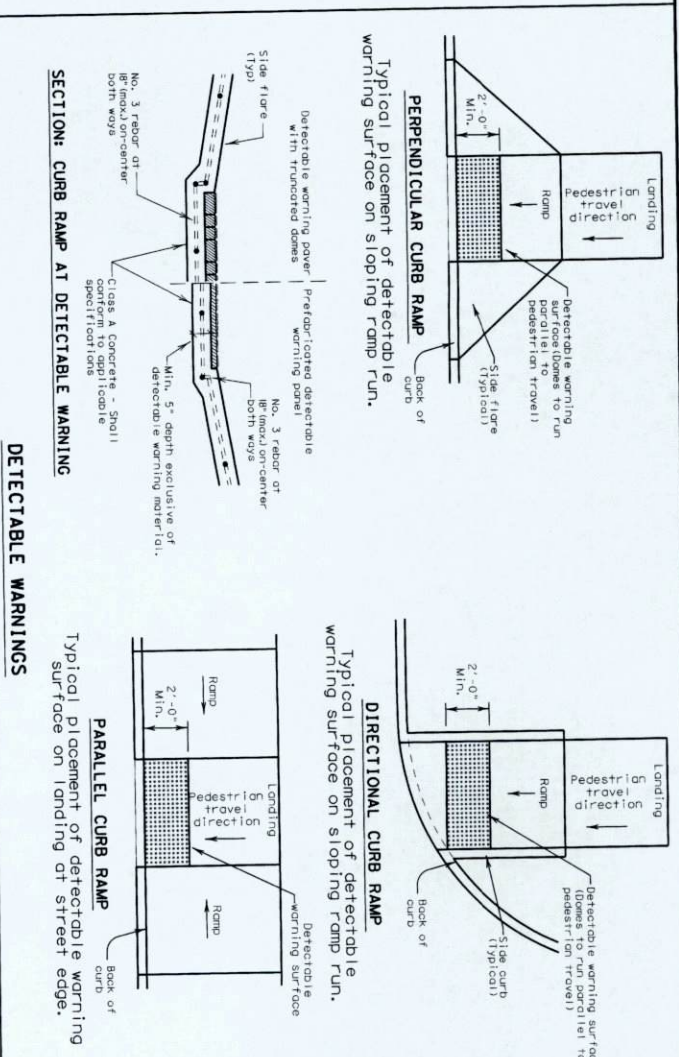

- Detectable Warning Powers**
24. Furnish detectable warning power units meeting all requirements of ASTM C-936, C-33. Lay in a two by two unit basket weave pattern or as directed.
 25. Lay full-size units first followed by closure units consisting of at least 25 percent of a full unit. Cut detectable warning power units using a power saw.
- Sidewalks**
26. Provide clear ground space or operable parts, including pedestrian push buttons. Operable parts shall be placed within one or more reach ranges specified in TAS 308.
 27. Place traffic signal or illumination poles, ground boxes, controller boxes, signs, drainage facilities and other items so as not to obstruct the pedestrian access route or clear ground space.
 28. Street grades and cross slopes shall be as shown elsewhere in the plans.
 29. Changes in level greater than 1/4 inch are not permitted.
 30. The least possible grade should be used to maximize accessibility. The running slope of sidewalks and crosswalks within the public right of way may follow the grade of the parallel roadway, where a continuous grade greater than 5% must be provided to protect pedestrians from potentially hazardous conditions. If provided, handrails shall comply with TAS 505.
 31. Handrail extensions shall not protrude into the usable landing area or into intersecting pedestrian routes.
 32. Parallels and turnouts shall be constructed and paid for in accordance with Item 531 in accordance with Item, "Sidewalks".
 33. Sidewalk details are shown elsewhere in the plans.

TEXAS Department of Transportation

Design Division

PEDESTRIAN FACILITIES

CURB RAMPS

PED-12A

SHEET 2 OF 4

TITLE: PED-12A	DATE: 10/13/16	BY: [Signature]	CHECKED: [Signature]
DESIGNED BY: [Signature]	DATE: 10/13/16	CHECKED BY: [Signature]	DATE: 10/13/16
PROJECT NO.:	DATE:	BY:	CHECKED:
SCALE:	DATE:	BY:	CHECKED:

DISCLAIMER:
 The use of this standard is governed by the "Texas Engineering Practice Act". No warranty of any kind is made by TxDOT for any purpose whatsoever. TxDOT assumes no responsibility for the conversion of this standard to other formats or for incorrect results or damages resulting from its use.

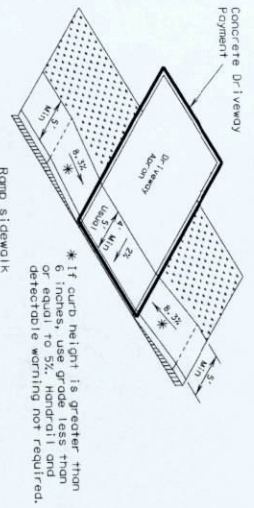
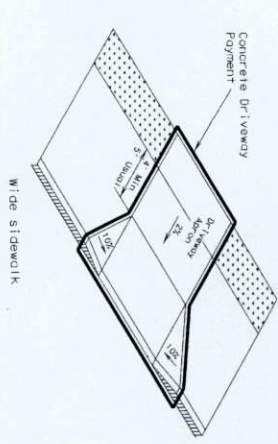
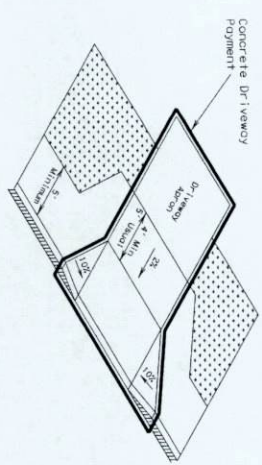
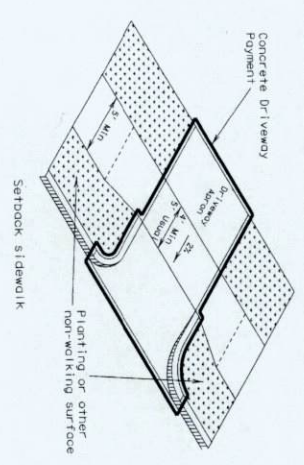

SIDEWALK TREATMENT AT DRIVEWAYS

* If curb height is greater than 4 inches, a 5' wide apron is required to 5% horizontal and detectable warning not required.

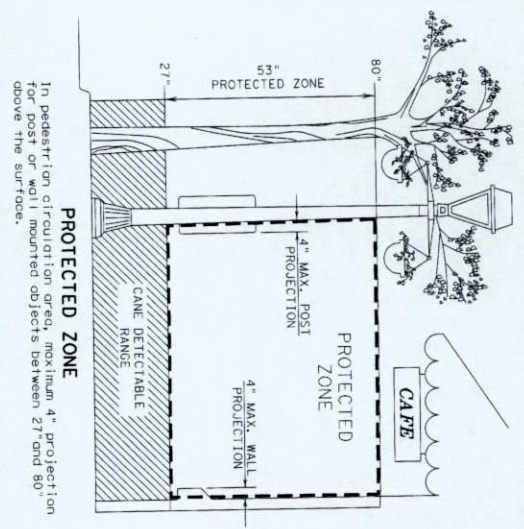

PROTECTED ZONE
 In pedestrian circulation area, maximum 4" projection from face of wall mounted objects between 27" and 80" above the surface.

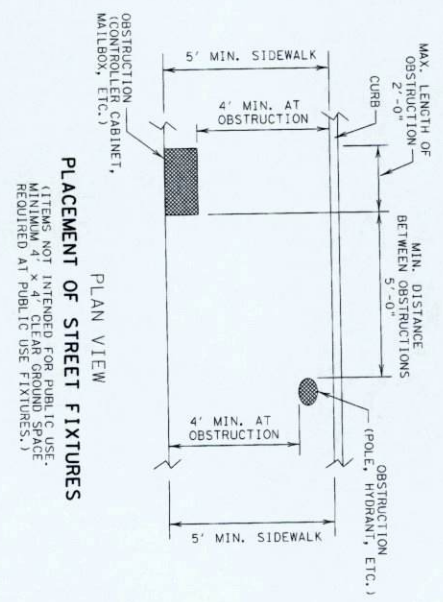

PLAN VIEW
 (ITEMS NOT INTENDED FOR PUBLIC USE WITHIN THE PUBLIC RIGHT OF WAY ARE REQUIRED AT PUBLIC USE FIXTURES.)

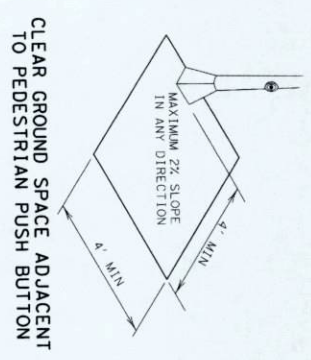

CLEAR GROUND SPACE ADJACENT TO PEDESTRIAN PUSH BUTTON

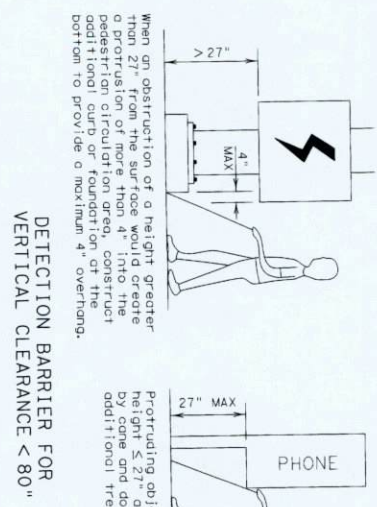

DETECTION BARRIER FOR VERTICAL CLEARANCE < 80"

Texas Department of Transportation
Design Division Standard

PEDESTRIAN FACILITIES
CURB RAMPS

PED-12A

SHEET 3 OF 4

FILE: ped12a.dgn	DATE: 06/13/12	BY: [Signature]	CHECKED: [Signature]
PROJECT: [Blank]	DATE: [Blank]	BY: [Blank]	CHECKED: [Blank]
VP: June 13, 2012	DATE: [Blank]	BY: [Blank]	CHECKED: [Blank]

Magy 10/31/12

DISCLAIMER: The use of this standard is governed by the "Texas Engineering Practice Act". No warranty of any kind is made by TxDOT for any purpose whatsoever. TxDOT assumes no responsibility for the conversion of this standard to other formats or for incorrect results or damages resulting from its use.

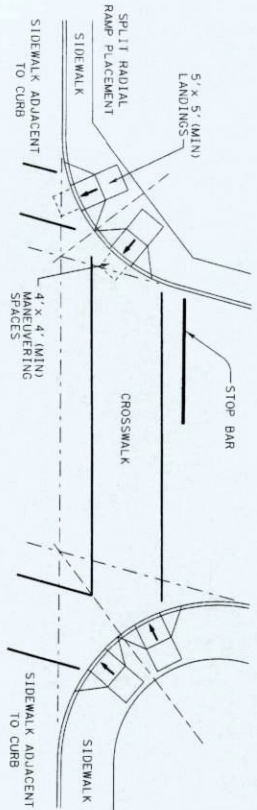

SKewed INTERSECTION WITH "LARGE" RADIUS

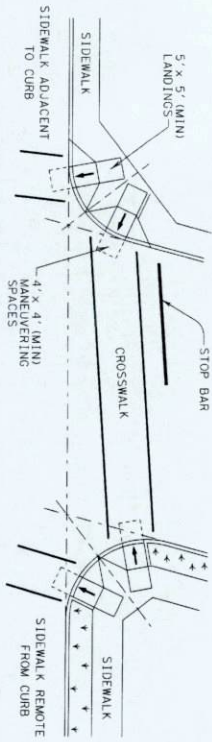

SKewed INTERSECTION WITH "SMALL" RADIUS

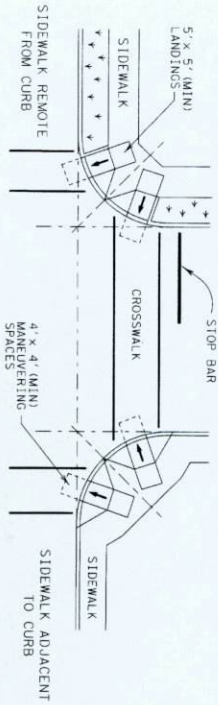

NORMAL INTERSECTION WITH "SMALL" RADIUS

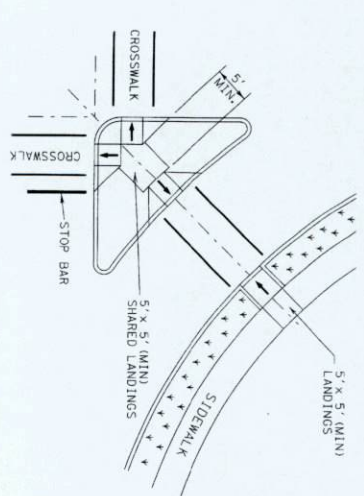

AT INTERSECTION
W/FREE RIGHT TURN & ISLAND

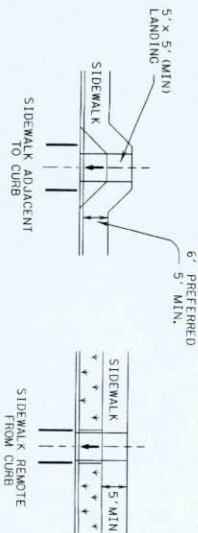

MID-BLOCK PLACEMENT
PERPENDICULAR RAMPS

TYPICAL CROSSING LAYOUTS

SHEET 4 OF 4

**PEDESTRIAN FACILITIES
CURB RAMPS**

PED-12A

FILED	DATE	BY	SCALE	DATE	BY
10/10/12	10/10/12	10/10/12	10/10/12	10/10/12	10/10/12
10/10/12	10/10/12	10/10/12	10/10/12	10/10/12	10/10/12

Texas Department of Transportation
 Design Division
 Standard

10/10/12
 10/10/12

DISCLAIMER: The use of this standard is governed by the "Texas Engineering Practice Act". No warranty of any kind is made by TxDOT for any purpose whatsoever. TxDOT assumes no responsibility for the conversion of this standard to other formats or for incorrect results or damages resulting from its use.

DATE: FILE:

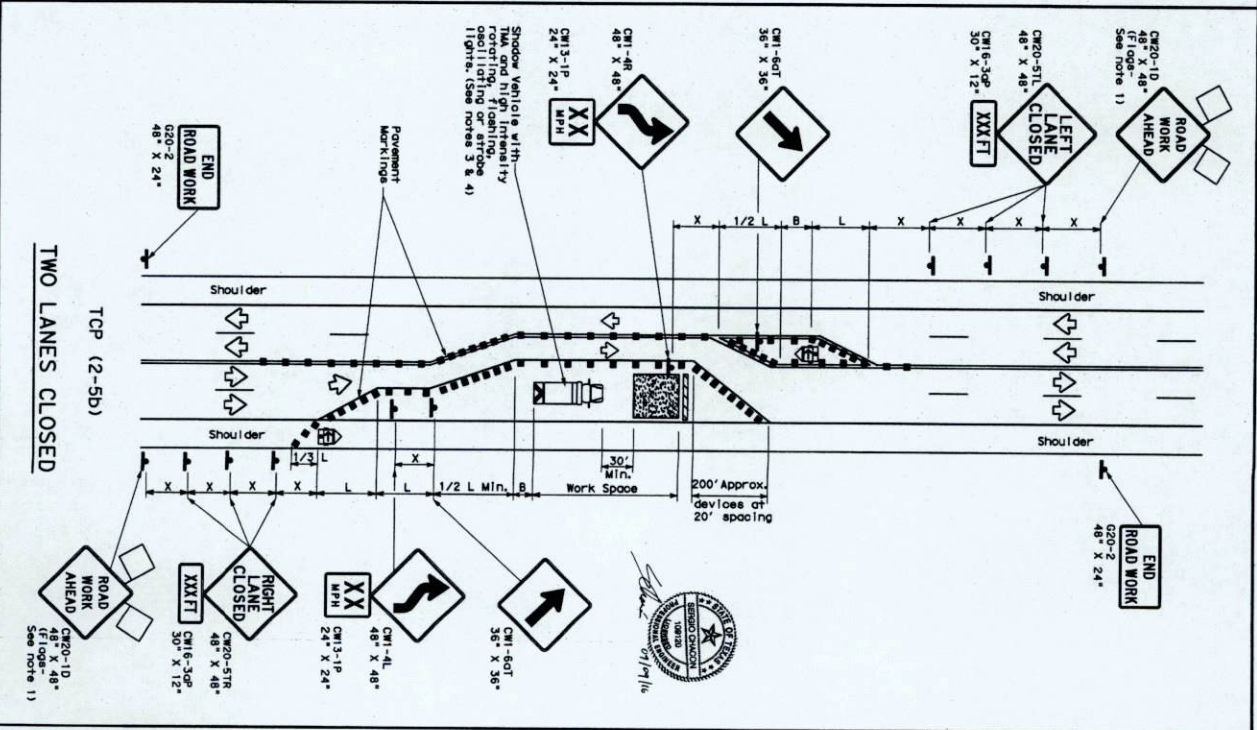
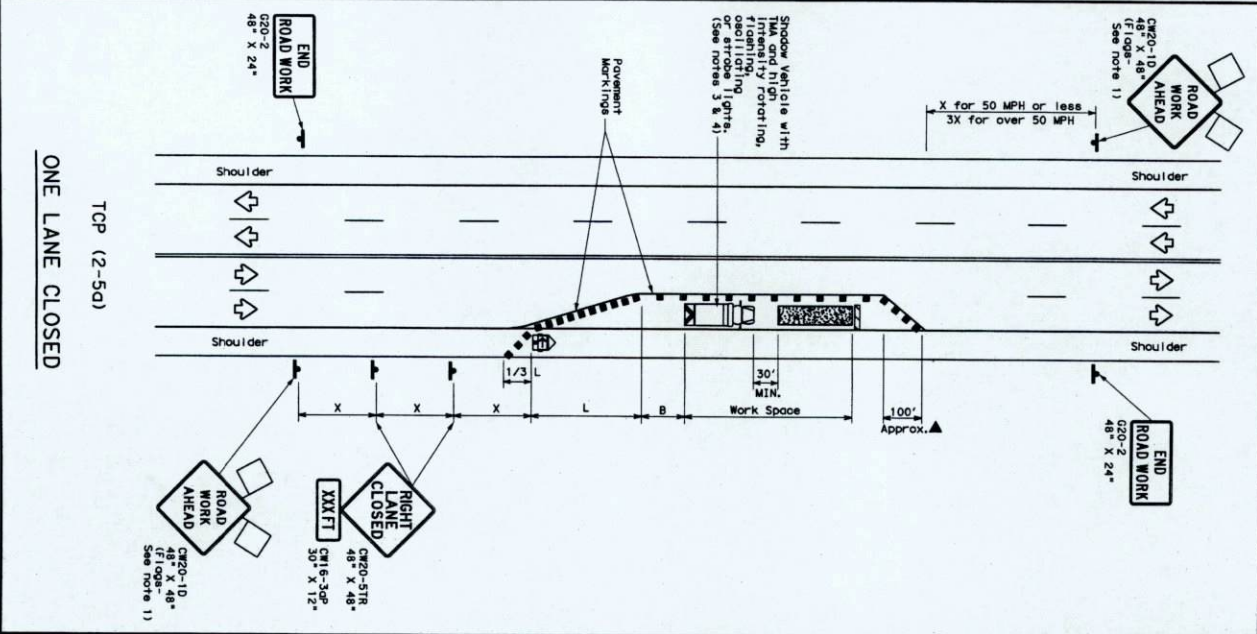

LEGEND

	Type 3 Barricade		Channelizing Device
	Truck Mounted Attenuator (TMA)		Truck Mounted Arrow Board
	Portable Changeable Message Sign (PCMS)		Traffic Flow
	Flag		Flagpole

GENERAL NOTES

- Flags attached to signs where shown, are required.
- All traffic control devices illustrated are REQUIRED, except those denoted with the triangle symbol may be omitted when stated elsewhere in the plan, or for routine maintenance work, when approved by the Engineer.
- A shadow vehicle with a TMA should be used anytime it can be used without unduly offsetting the taper. In cases of one or more spurs, if workers are no longer present but road or work conditions require the traffic control to remain in place, Type 3 Barricades or other channelizing devices may be substituted for the Shadow Vehicle and TMA. Additional Shadow Vehicles with TMAs may be positioned in each direction in order to protect a wider work space, next to those shown. The downstream taper is optional. When used, it should be 100 feet approximately per lane, with channelizing device spaced at 20 feet.

TCP (2-5a)

6. If this TCP is used for a left lane closure, C20-51L, LEFT LANE CLOSED signs shall be used and channelizing devices shall be placed on the centerline to protect the work space from opposing traffic, with the arrow board placed in the closed lane near the end of the merging taper.

TCP (2-5b)

7. Conflicting pavement markings shall be removed for long-term projects.

TYPICAL USAGE

MOBILE	SHORT DURATION	SHORT TERM STATIONARY	INTERMEDIATE TERM STATIONARY	LONG TERM STATIONARY

TABLE 1

Portaled Sign	Device	Minimum Taper Length	Minimum Channelizing Device Spacing	Minimum Sign Spacing	Minimum Buffer Space	Suggested Spacing	
30	MS ²	150'	185'	180'	30'	120'	90'
35	MS ²	205'	225'	245'	35'	70'	160'
40	MS ²	265'	295'	320'	40'	80'	240'
45	MS ²	450'	495'	540'	45'	90'	320'
50	MS ²	500'	550'	600'	50'	100'	400'
55	MS ²	550'	600'	660'	55'	110'	500'
60	MS ²	600'	660'	720'	60'	120'	600'
65	MS ²	650'	715'	780'	65'	130'	700'
70	MS ²	700'	770'	840'	70'	140'	800'
75	MS ²	750'	825'	900'	75'	150'	900'

* Conventional Roads Only
 ** Taper lengths have been rounded off.
 L=Length of Taper (FT) W=Width of Offset (FT) S=Suggested Speed (MPH)

TRAFFIC CONTROL PLAN
 LONG TERM LANE CLOSURES
 MULTILANE CONVENTIONAL RDS.
 TCP (2-5) - 12

Texas Department of Transportation
 Traffic Operations Division

DATE: 8-25-11
 FILE: 1-97-4-93