



**REVIEW BY FORT BEND COUNTY  
COMMISSIONERS COURT**

**Fort Bend County  
Engineering Department**  
301 Jackson Suite 401  
Richmond, Texas 77469  
281.633.7500  
Permits@fortbendcountytexas.gov

☒ Right of Way Permit  
☐ Commercial Driveway Permit

Permit No: 2017-13450

**Applicant:** CenterPoint Energy

**Job Location Site:** Gaston Road, Katy, TX 77494

**Bond No.:** 00-000-117 **Date of Bond:** 4/28/1988 **Amount:** \$50,000.00

The above applicant came to make use of certain Fort Bend County property subject to, "The Order Regulating the Laying, Construction, Maintenance, and Repair of Buried Cables, Conduits, and Pole Lines, In, Under, Across or Along Roads, Streets, Highways, and Drainage Ditches in Fort Bend County, Texas, Under the Jurisdiction of the Commissioners Court of Fort Bend County, Texas," as passed by the Commissioners Court of Fort Bend County, Texas, of the Minutes of the Commissioners Court of Fort Bend County, Texas, to the extent that such order is not inconsistent with Chapter 181, Vernon's Texas Statutes and Codes Annotated.

**Notes:**

1. Evidence of review by the Commissioners Court must be kept on the job site and failure to do so constitutes grounds for job shutdown.
2. Written notices are required:
  - a. 48 hours in advance of construction start up, and
  - b. When construction is completed and ready for final inspection, submit notification to Permit Administrator thru MyGovernmentOnline.org portal.
3. This permit expires one (1) year from date of permit if construction has not commenced.

On this 2nd day of May, 2017, Upon Motion of Commissioner Mayer, seconded by Commissioner Patterson, duly put and carried, it is ORDERED, ADJUDGED AND DECREED that said notice of said above purpose is hereby acknowledged by the Commissioners Court of Fort Bend County, Texas, and that said notice be placed on record according to the regulation order thereof.

**Signature**

Presented to Commissioners Court and approved.

By: Chandy O. Ay

Date Recorded 5-8-2017 Comm. Court No. 9M

for County Engineer

Clerk of Commissioners Court

N/A

By: \_\_\_\_\_

By: Sandra Wilho

Drainage District Engineer/Manager

Deputy

4/25/17  
Date

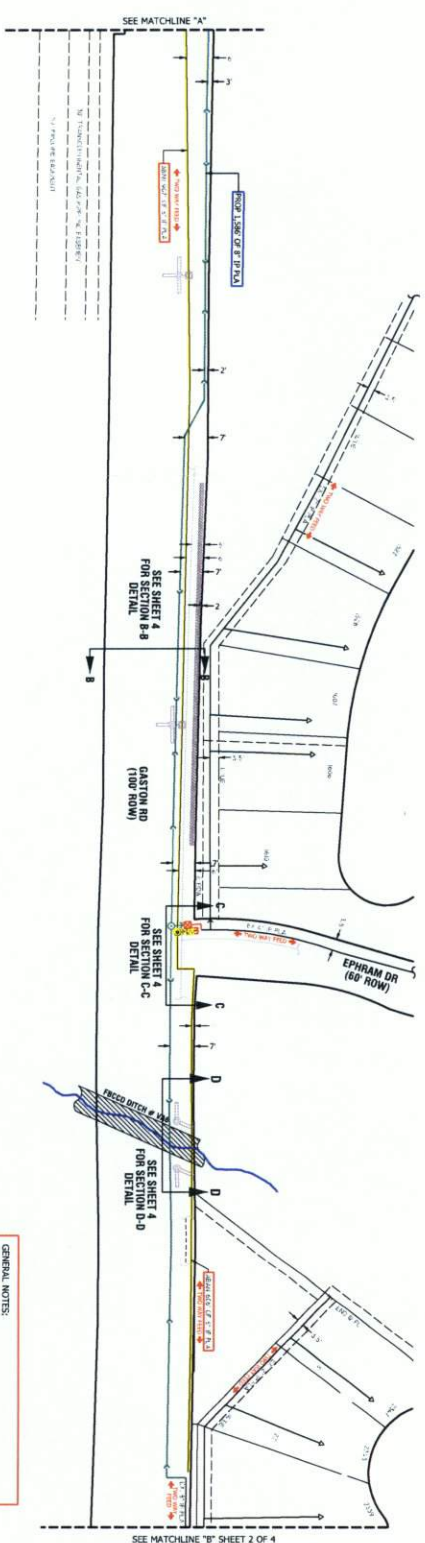
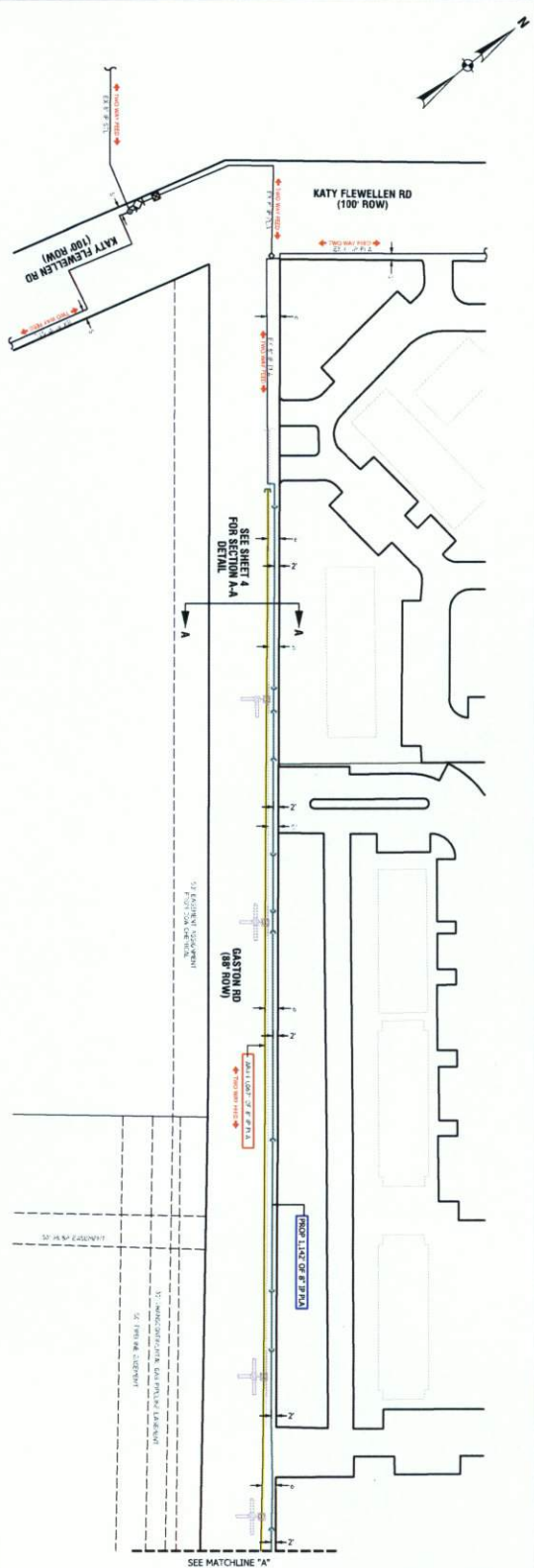

- GENERAL NOTES:**
1. FIELD LOCATE AND VERIFY ALL EXISTING FEEDS, MAINS AND SERVICES.
  2. USES GAUGES TO MONITOR AND MAINTAIN FIELDS AND PRESSURE.
  3. PRESSURE IS UNDER 60 PSIG.
  4. CONTACT FIRM 5070 (713) 207-4417 FOR ADDITIONAL WORK ORDERS AND/OR ANY NECESSARY FIELD CHANGE.

# **FORT BEND COUNTY PERMIT**

## **LEGEND AND NOTES**

ITEM NO.	DESCRIPTION	QUANTITY	UNIT
1	12" DIA. WATER MAIN	1.00	LINEAL FEET
2	12" DIA. WATER MAIN	1.00	LINEAL FEET
3	12" DIA. WATER MAIN	1.00	LINEAL FEET
4	12" DIA. WATER MAIN	1.00	LINEAL FEET
5	12" DIA. WATER MAIN	1.00	LINEAL FEET
6	12" DIA. WATER MAIN	1.00	LINEAL FEET
7	12" DIA. WATER MAIN	1.00	LINEAL FEET
8	12" DIA. WATER MAIN	1.00	LINEAL FEET
9	12" DIA. WATER MAIN	1.00	LINEAL FEET
10	12" DIA. WATER MAIN	1.00	LINEAL FEET
11	12" DIA. WATER MAIN	1.00	LINEAL FEET
12	12" DIA. WATER MAIN	1.00	LINEAL FEET
13	12" DIA. WATER MAIN	1.00	LINEAL FEET
14	12" DIA. WATER MAIN	1.00	LINEAL FEET
15	12" DIA. WATER MAIN	1.00	LINEAL FEET
16	12" DIA. WATER MAIN	1.00	LINEAL FEET
17	12" DIA. WATER MAIN	1.00	LINEAL FEET
18	12" DIA. WATER MAIN	1.00	LINEAL FEET
19	12" DIA. WATER MAIN	1.00	LINEAL FEET
20	12" DIA. WATER MAIN	1.00	LINEAL FEET
21	12" DIA. WATER MAIN	1.00	LINEAL FEET
22	12" DIA. WATER MAIN	1.00	LINEAL FEET
23	12" DIA. WATER MAIN	1.00	LINEAL FEET
24	12" DIA. WATER MAIN	1.00	LINEAL FEET
25	12" DIA. WATER MAIN	1.00	LINEAL FEET
26	12" DIA. WATER MAIN	1.00	LINEAL FEET
27	12" DIA. WATER MAIN	1.00	LINEAL FEET
28	12" DIA. WATER MAIN	1.00	LINEAL FEET
29	12" DIA. WATER MAIN	1.00	LINEAL FEET
30	12" DIA. WATER MAIN	1.00	LINEAL FEET
31	12" DIA. WATER MAIN	1.00	LINEAL FEET
32	12" DIA. WATER MAIN	1.00	LINEAL FEET
33	12" DIA. WATER MAIN	1.00	LINEAL FEET
34	12" DIA. WATER MAIN	1.00	LINEAL FEET
35	12" DIA. WATER MAIN	1.00	LINEAL FEET
36	12" DIA. WATER MAIN	1.00	LINEAL FEET
37	12" DIA. WATER MAIN	1.00	LINEAL FEET
38	12" DIA. WATER MAIN	1.00	LINEAL FEET
39	12" DIA. WATER MAIN	1.00	LINEAL FEET
40	12" DIA. WATER MAIN	1.00	LINEAL FEET
41	12" DIA. WATER MAIN	1.00	LINEAL FEET
42	12" DIA. WATER MAIN	1.00	LINEAL FEET
43	12" DIA. WATER MAIN	1.00	LINEAL FEET
44	12" DIA. WATER MAIN	1.00	LINEAL FEET
45	12" DIA. WATER MAIN	1.00	LINEAL FEET
46	12" DIA. WATER MAIN	1.00	LINEAL FEET
47	12" DIA. WATER MAIN	1.00	LINEAL FEET
48	12" DIA. WATER MAIN	1.00	LINEAL FEET
49	12" DIA. WATER MAIN	1.00	LINEAL FEET
50	12" DIA. WATER MAIN	1.00	LINEAL FEET
51	12" DIA. WATER MAIN	1.00	LINEAL FEET
52	12" DIA. WATER MAIN	1.00	LINEAL FEET
53	12" DIA. WATER MAIN	1.00	LINEAL FEET
54	12" DIA. WATER MAIN	1.00	LINEAL FEET
55	12" DIA. WATER MAIN	1.00	LINEAL FEET
56	12" DIA. WATER MAIN	1.00	LINEAL FEET
57	12" DIA. WATER MAIN	1.00	LINEAL FEET
58	12" DIA. WATER MAIN	1.00	LINEAL FEET
59	12" DIA. WATER MAIN	1.00	LINEAL FEET
60	12" DIA. WATER MAIN	1.00	LINEAL FEET
61	12" DIA. WATER MAIN	1.00	LINEAL FEET
62	12" DIA. WATER MAIN	1.00	LINEAL FEET
63	12" DIA. WATER MAIN	1.00	LINEAL FEET
64	12" DIA. WATER MAIN	1.00	LINEAL FEET
65	12" DIA. WATER MAIN	1.00	LINEAL FEET
66	12" DIA. WATER MAIN	1.00	LINEAL FEET
67	12" DIA. WATER MAIN	1.00	LINEAL FEET
68	12" DIA. WATER MAIN	1.00	LINEAL FEET
69	12" DIA. WATER MAIN	1.00	LINEAL FEET
70	12" DIA. WATER MAIN	1.00	LINEAL FEET
71	12" DIA. WATER MAIN	1.00	LINEAL FEET
72	12" DIA. WATER MAIN	1.00	LINEAL FEET
73	12" DIA. WATER MAIN	1.00	LINEAL FEET
74	12" DIA. WATER MAIN	1.00	LINEAL FEET
75	12" DIA. WATER MAIN	1.00	LINEAL FEET
76	12" DIA. WATER MAIN	1.00	LINEAL FEET
77	12" DIA. WATER MAIN	1.00	LINEAL FEET
78	12" DIA. WATER MAIN	1.00	LINEAL FEET
79	12" DIA. WATER MAIN	1.00	LINEAL FEET
80	12" DIA. WATER MAIN	1.00	LINEAL FEET
81	12" DIA. WATER MAIN	1.00	LINEAL FEET
82	12" DIA. WATER MAIN	1.00	LINEAL FEET
83	12" DIA. WATER MAIN	1.00	LINEAL FEET
84	12" DIA. WATER MAIN	1.00	LINEAL FEET
85	12" DIA. WATER MAIN	1.00	LINEAL FEET
86	12" DIA. WATER MAIN	1.00	LINEAL FEET
87	12" DIA. WATER MAIN	1.00	LINEAL FEET
88	12" DIA. WATER MAIN	1.00	LINEAL FEET
89	12" DIA. WATER MAIN	1.00	LINEAL FEET
90	12" DIA. WATER MAIN	1.00	LINEAL FEET
91	12" DIA. WATER MAIN	1.00	LINEAL FEET
92	12" DIA. WATER MAIN	1.00	LINEAL FEET
93	12" DIA. WATER MAIN	1.00	LINEAL FEET
94	12" DIA. WATER MAIN	1.00	LINEAL FEET
95	12" DIA. WATER MAIN	1.00	LINEAL FEET
96	12" DIA. WATER MAIN	1.00	LINEAL FEET
97	12" DIA. WATER MAIN	1.00	LINEAL FEET
98	12" DIA. WATER MAIN	1.00	LINEAL FEET
99	12" DIA. WATER MAIN	1.00	LINEAL FEET
100	12" DIA. WATER MAIN	1.00	LINEAL FEET

**CenterPoint Energy**

ED3-17199

**NOTIFICATION: INDUSTRY**

**GASTON RD BETWEEN KATY FLEWELLEN RD AND GREENBUSH RD, KATY, TEXAS**

DATE: 10/1/2023

TIME: 10:00 AM

LOCATION: 100' ROW

PROJECT: 100' ROW

PERMIT: 100' ROW

ISSUED: 10/1/2023

REVISION: 10/1/2023

10/1/2023









**DATE:**  
**FILE:**

**TCP(2-1)-12**

[illegible]