

STANDARD UTILITY AGREEMENT

U-0027A: Seaway Crude Pipeline Company LLC
 County: Fort Bend
 Highway: FM 1093 Westpark Extension Phase II

This Agreement by and between the County of Fort Bend, Texas, ("**County**"), and Seaway Crude Pipeline Company LLC, ("**Utility**"), acting by and through its duly authorized representative, shall be effective on the date of approval and execution by and on behalf of the **County**

WHEREAS, the **County** has deemed it necessary to make certain highway improvements as designated by the **County** and approved by the Federal Highway Administration within the limits of the highway as indicated above;

WHEREAS, the proposed highway improvements will necessitate the adjustment, removal, and/or relocation of certain facilities of **Utility** as indicated in the following statement of work: The scope of this project are to sandblast, inspect (visual & NDE), recoat and extend the 36" split casing pipe on 30" Crude P/L, LID # S1. Work will be done in 3 phases following the work sequence of Fort Bend Contractor. This is to accommodate the proposed Westpark Tollway Extension Phase II project by Fort Bend Co.; and more specifically shown in **Utility's** Plans and Specifications, Estimated Costs, and Schedule which are attached hereto as Exhibits "A," "B" and "C."

WHEREAS, Subchapter E of Chapter 203 of the Texas Transportation Code regarding the relocation of utilities does not apply to this Project, but the County wishes to negotiate in good faith and enter into agreements with all affected utility companies for the participation in the costs of the adjustment, removal, and/or relocation of certain facilities as authorized under such subchapter.

WHEREAS, the **County**, upon receipt of evidence it deems sufficient, acknowledges **Utility's** interest in certain lands and/or facilities and determined it is appropriate to enter an agreement with **Utility** to govern the terms for participation in the costs of the adjustment, removal, and relocation of certain of its facilities located upon the lands as indicated in the statement of work above.

NOW, THEREFORE, BE IT AGREED:

The **County** will pay to **Utility** forty-four percent (44%) of the documented actual costs incurred for relocation of the utility in adjustment, removal, and/or relocation of **Utility's** facilities up to the amount said costs may be eligible for **County** participation.

All conduct under this agreement, including but not limited to the adjustment, removal and relocation of the facility, the development and reimbursement of costs, any environmental requirements, and retention of records will be in accordance with all applicable federal and state laws, rules and regulations, including, without limitation, the Federal Uniform Relocation Assistance and Real Property Acquisition Policies Act, 42 U.S.C. §§ 4601, et seq., the National Environmental Policy Act, 42 U.S.C. §§ 4231, et seq., the Utility Relocations, Adjustments, and Reimbursements provisions of 23 CFR 645, Subpart A, and with the Utility Accommodation provisions of 23 CFR 645, Subpart B. **Utility** shall supply, upon request by the **County**, proof of compliance with the aforementioned laws, rules and regulations prior to the commencement of construction.

The **Utility** agrees to develop relocation or adjustment costs by accumulating actual direct and related indirect costs in accordance with a work order accounting procedure prescribed by **County**, or may, with the **County's** approval, accumulate actual direct and related indirect costs in accordance with an established accounting procedure developed by **Utility**. Bills for work hereunder will be submitted to **County** not later than 90 days after completion of the work.

When requested, the **County** will make intermediate payments at not less than monthly intervals to **Utility** when properly billed and such payments will not exceed 90 percent (90%) of the eligible cost as shown in each such billing. Intermediate payments shall not be construed as final payment for any items included in the intermediate

payment

 Initial

Fort Bend County

3/3/17
 Date

EL
 Initial

Enterprise Products

2/27/2017
 Date

Upon execution of this agreement by both parties hereto, the **County** will, by written notice, authorize the **Utility** to perform such work diligently, and to conclude said adjustment, removal, or relocation by the stated completion date. The completion date shall be extended for delays caused by events outside **Utility's** control, including an event of Force Majeure, which shall include a strike, war or act of war (whether an actual declaration of war is made or not), insurrection, riot, act of public enemy, accident, fire, flood or other act of God, sabotage, or other events, interference by the **County** or any other party with **Utility's** ability to proceed with the relocation, or any other event in which **Utility** has exercised all due care in the prevention thereof so that the causes or other events are beyond the control and without the fault or negligence of **Utility**.

The **County** will, upon satisfactory completion of the relocation or adjustment and upon receipt of final billing prepared in an approved form and manner, make payment in the amount of 90 percent (90%) of the eligible costs as shown in the final billing prior to audit and after such audit shall make an additional final payment totaling the reimbursement amount found eligible for **County** reimbursement.

Unless an item below is stricken and initialed by the **County** and **Utility**, this agreement in its entirety consists of the following:

1. Standard Utility Agreement;
2. Plans & Specifications (Attachment "A");
3. Utility Construction Cost Estimate (Attachment "B");
4. Utility's Schedule of Work and Estimated Date of Completion (Attachment "C").

All attachments are included herein as if fully set forth. In the event it is determined that a substantial change from the statement of work contained in this agreement is required, reimbursement therefore shall be limited to costs covered by a modification or amendment of this agreement or a written change or extra work order approved by the **County and Utility**.

This agreement is subject to cancellation by the **County** at any time up to the date that work under this agreement has been authorized and that such cancellation will not create any liability on the part of the **County**. However, the **County** will review and reimburse the **Utility** for eligible costs incurred by the **Utility** in preparation of this Agreement.

The State Auditor may conduct an audit or investigation of any entity receiving funds from the **County** directly under this contract or indirectly through a subcontract under this contract. Acceptance of funds directly under this contract or indirectly through a subcontract under this contract acts as acceptance of the authority of the State Auditor, under the direction of the Legislative Audit Committee, to conduct an audit or investigation in connection with those funds. An entity that is the subject of an audit or investigation must provide the state auditor with access to any information the state auditor considers relevant to the investigation or audit.

The **Utility** by execution of this agreement does not waive any of the rights which **Utility** may have within the limits of the law.

It is expressly understood that the **Utility** conducts the adjustment, removal, or relocation at its own risk, and that Fort Bend County, Texas makes no warranties or representations regarding the existence or location of utilities currently within its right of way.

The signatories to this agreement warrant that each has the authority to enter into this agreement on behalf of the party represented.

REMAINDER OF PAGE LEFT BLANK

Initial
3/3/17
Date
Fort Bend County

Initial
2/27/2017
Date
Enterprise Products

UTILITY

Utility: Seaway Crude Pipeline Company LLC
Name of Utility

By: 
Authorized Signature

Gloria Keeter
Print or Type Name

Title: Agent and Attorney-in-Fact

Date: 2/27/2017

REMAINDER OF PAGE LEFT BLANK
SIGNATURES CONTAINED ON NEXT PAGE

 3/3/17
Initial *Date*
Fort Bend County

 2/27/2017
Initial *Date*
Enterprise Products

EXECUTION RECOMMENDED:

COUNTY

By:

Robert E. Hebert
Robert E. Hebert, County Judge

Date:

3/14/2017

ATTEST:

By:

Laura Richard
Laura Richard, County Clerk



APPROVED:

By:

Richard W. Stolleis
Richard W. Stolleis, P.E., County Engineer

APPROVED AS TO LEGAL FORM:

By:

Marcus D. Spencer
Marcus D. Spencer, First Assistant County Attorney

AUDITOR'S CERTIFICATE

I hereby certify that funds are available in the amount of \$ 481,993.34 to accomplish and pay the obligation of Fort Bend County under this contract.

Robert Ed Sturdivant, County Auditor

Robert Ed Sturdivant

fw
Initial
Fort Bend County

3/3/17
Date

GW
Initial
Enterprise Products

2/27/2017
Date

Exhibit A

Plans & Specifications

(8 Pages that Follow)

FWB 3/3/17
Initial Date
Fort Bend County

GUK 2/27/2017
Initial Date
Enterprise Products

9832 PH.2

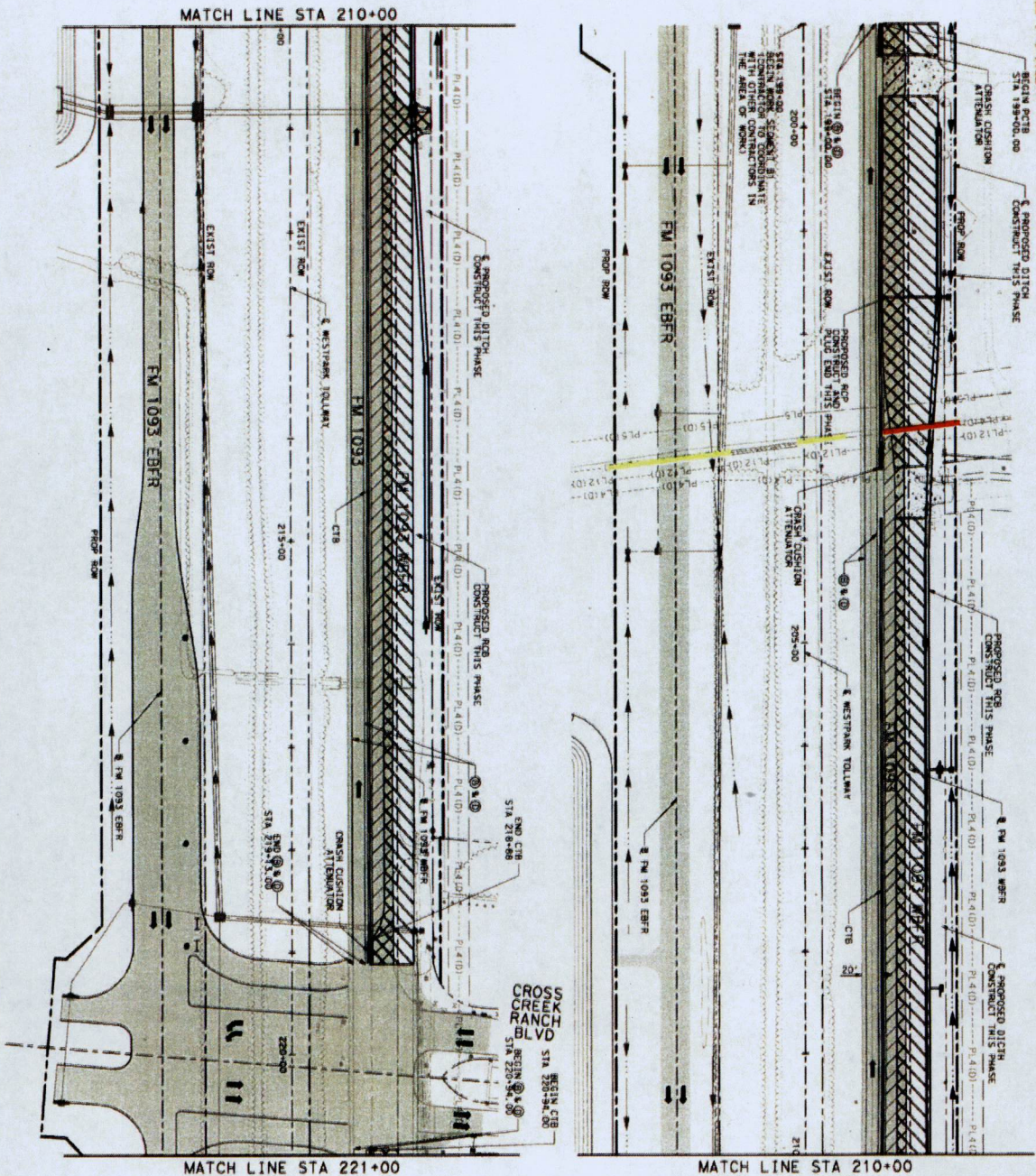

LEGEND

- ▨ PROPOSED CONSTRUCTION THIS PHASE
- ▨ TOPGRAPH CONSTRUCTION THIS PHASE
- ▨ FAST-TRACK PAVEMENT
- ▨ EXIST PAVEMENT/COMPLETED PAVEMENT
- ▨ DIRECTION OF TRAFFIC (PROPOSED)
- ▨ DIRECTION OF TRAFFIC (EXISTING)
- ▨ BARRELS OR DUMPS
- ▨ PORTABLE SIGNS/LAMPS BOARD
- ▨ TYPE III BARRICADES
- ▨ PORTABLE CEMENTUM W/FLEXIBLE SUPPORT
- ▨ DEL. WEATHER POST
- ▨ CHANNELIZING DEVICES
- ▨ TYP. PAVEMENT MARKING SIGNS
- ▨ TEMP. PAVEMENT STRIPING
- ▨ CTB
- ▨ LOW PROFILE CONCRETE BARRIER (L/POB)
- ▨ CTB ATTENUATOR (RECT) (1)
- ① WK 2N PAV MARK (READY) (4" X 7) (RT) (BRN)
- ② WK 2N PAV MARK (READY) (4" X 7) (RT) (SLD)
- ③ WK 2N PAV MARK (READY) (4" X 7) (BR) (BRN)
- ④ WK 2N PAV MARK (READY) (4" X 7) (BR) (SLD)
- ⑤ WK 2N PAV MARK (READY) (2" X 1) (BR) (SLD)
- ⑥ WK 2N PAV MARK (READY) (2" X 1) (BR) (SLD)
- ⑦ WK 2N PAV MARK (READY) (2" X 1) (BR) (BRN)
- ⑧ WK 2N PAV MARK (READY) (2" X 1) (BR) (SLD)
- ⑨ WK 2N PAV MARK (READY) (2" X 1) (BR) (SLD)
- ⑩ WK 2N PAV MARK (READY) (2" X 1) (BR) (SLD)
- ⑪ WK 2N PAV MARK (READY) (2" X 1) (BR) (SLD)
- ⑫ WK 2N PAV MARK (READY) (2" X 1) (BR) (SLD)
- ⑬ WK 2N PAV MARK (READY) (2" X 1) (BR) (SLD)
- ⑭ WK 2N PAV MARK (READY) (2" X 1) (BR) (SLD)
- ⑮ WK 2N PAV MARK (READY) (2" X 1) (BR) (SLD)
- ⑯ WK 2N PAV MARK (READY) (2" X 1) (BR) (SLD)
- ⑰ WK 2N PAV MARK (READY) (2" X 1) (BR) (SLD)
- ⑱ WK 2N PAV MARK (READY) (2" X 1) (BR) (SLD)
- ⑲ WK 2N PAV MARK (READY) (2" X 1) (BR) (SLD)
- ⑳ WK 2N PAV MARK (READY) (2" X 1) (BR) (SLD)
- ㉑ WK 2N PAV MARK (READY) (2" X 1) (BR) (SLD)
- ㉒ WK 2N PAV MARK (READY) (2" X 1) (BR) (SLD)
- ㉓ WK 2N PAV MARK (READY) (2" X 1) (BR) (SLD)
- ㉔ WK 2N PAV MARK (READY) (2" X 1) (BR) (SLD)
- ㉕ WK 2N PAV MARK (READY) (2" X 1) (BR) (SLD)
- ㉖ WK 2N PAV MARK (READY) (2" X 1) (BR) (SLD)
- ㉗ WK 2N PAV MARK (READY) (2" X 1) (BR) (SLD)
- ㉘ WK 2N PAV MARK (READY) (2" X 1) (BR) (SLD)
- ㉙ WK 2N PAV MARK (READY) (2" X 1) (BR) (SLD)
- ㉚ WK 2N PAV MARK (READY) (2" X 1) (BR) (SLD)
- ㉛ WK 2N PAV MARK (READY) (2" X 1) (BR) (SLD)
- ㉜ WK 2N PAV MARK (READY) (2" X 1) (BR) (SLD)
- ㉝ WK 2N PAV MARK (READY) (2" X 1) (BR) (SLD)
- ㉞ WK 2N PAV MARK (READY) (2" X 1) (BR) (SLD)
- ㉟ WK 2N PAV MARK (READY) (2" X 1) (BR) (SLD)
- ㊱ WK 2N PAV MARK (READY) (2" X 1) (BR) (SLD)
- ㊲ WK 2N PAV MARK (READY) (2" X 1) (BR) (SLD)
- ㊳ WK 2N PAV MARK (READY) (2" X 1) (BR) (SLD)
- ㊴ WK 2N PAV MARK (READY) (2" X 1) (BR) (SLD)
- ㊵ WK 2N PAV MARK (READY) (2" X 1) (BR) (SLD)
- ㊶ WK 2N PAV MARK (READY) (2" X 1) (BR) (SLD)
- ㊷ WK 2N PAV MARK (READY) (2" X 1) (BR) (SLD)
- ㊸ WK 2N PAV MARK (READY) (2" X 1) (BR) (SLD)
- ㊹ WK 2N PAV MARK (READY) (2" X 1) (BR) (SLD)
- ㊺ WK 2N PAV MARK (READY) (2" X 1) (BR) (SLD)
- ㊻ WK 2N PAV MARK (READY) (2" X 1) (BR) (SLD)
- ㊼ WK 2N PAV MARK (READY) (2" X 1) (BR) (SLD)
- ㊽ WK 2N PAV MARK (READY) (2" X 1) (BR) (SLD)
- ㊾ WK 2N PAV MARK (READY) (2" X 1) (BR) (SLD)
- ㊿ WK 2N PAV MARK (READY) (2" X 1) (BR) (SLD)

NOTES:

1. CONTRACTOR TO MAINTAIN ACCESS TO ALL SIDEWALKS AND DRIVEWAYS AT ALL TIMES UNLESS OTHERWISE APPROVED.
2. FAST-TRACK PAVEMENT TO BE CONSTRUCTED IN PHASES AS SHOWN.
3. SEE AMERICANS AND CONSTRUCTION STANDARDS FOR CHANNELIZING DEVICE SPACING.

SCALE: 1"=100'

0 25 50 100 200

THIS DOCUMENT IS RELEASED FOR THE USE OF THE GENERAL PUBLIC FOR BIDDING OR PERMIT PURPOSES

MARSH A. ROBERT
1005 SUBMITTAL
05/20/2016

DANNENBAUM
ENGINEERING CORPORATION
THE WESTPORT TOLLWAY, WESTPORT, TEXAS 75783-1600
Texas Department of Transportation

FM 1093 WESTPARK EXTENSION
TRAFFIC CONTROL PLAN
PHASE 2
STA 199+00 TO STA 221+00
SHEET 1 OF 6

DESIGNED BY:	DRAMA BY:
CHECKED BY:	CHECKED BY:
DATE:	DATE:
SCALE:	SHEET NO.:
DATE:	DATE:

9832 PH. 2A

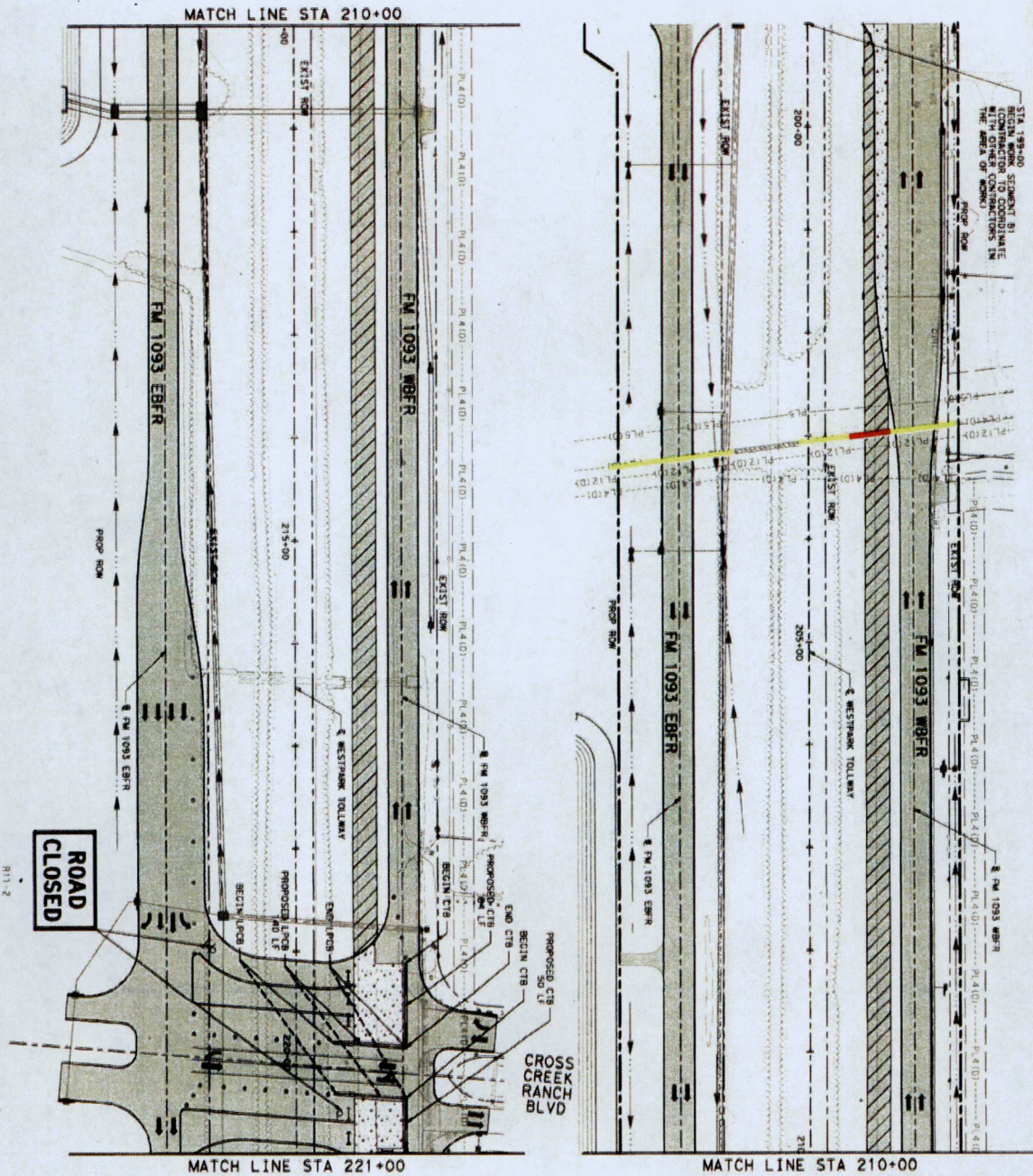

MATCH LINE STA 210+00 (top) / MATCH LINE STA 221+00 (bottom)

LEGEND

- TEMPORARY CONSTRUCTION TRAFFIC PAVEMENT
- FAST-TRACK PAVEMENT
- DEVELOPMENT OF EXISTING PAVEMENT
- EXISTING PAVEMENT/COMPLETED PAVEMENT
- DIRECTION OF TRAFFIC (PROPOSED)
- DIRECTION OF TRAFFIC (EXISTING)
- BARRIERS OR DUMPS
- PORTABLE SIGNS/LAMBS BOARD
- TYPE III BARRIERS
- PORTABLE CHEROKEE W/EXTENSIBLE SUPPORT
- DELIMITER POST
- CHANNELIZING DEVICES
- TEMP ROUND BOUNDED SIGNS
- TRIP PAVEMENT STRIPING
- CTR
- LOW PORTABLE CONCRETE BARRIER (LPCB)
- CTR ATTENUATOR (CBAT)
- 1. MK 2H PAV MARK (RENOV) (4" X 11" (8)X3)
- 2. MK 2H PAV MARK (RENOV) (4" X 11" (8)X3)
- 3. MK 2H PAV MARK (RENOV) (4" X 11" (8)X3)
- 4. MK 2H PAV MARK (RENOV) (4" X 11" (8)X3)
- 5. MK 2H PAV MARK (RENOV) (4" X 11" (8)X3)
- 6. MK 2H PAV MARK (RENOV) (4" X 11" (8)X3)
- 7. MK 2H PAV MARK (RENOV) (4" X 11" (8)X3)
- 8. MK 2H PAV MARK (RENOV) (4" X 11" (8)X3)
- 9. MK 2H PAV MARK (RENOV) (4" X 11" (8)X3)
- 10. MK 2H PAV MARK (RENOV) (4" X 11" (8)X3)
- 11. MK 2H PAV MARK (RENOV) (4" X 11" (8)X3)
- 12. MK 2H PAV MARK (RENOV) (4" X 11" (8)X3)
- 13. MK 2H PAV MARK (RENOV) (4" X 11" (8)X3)
- 14. MK 2H PAV MARK (RENOV) (4" X 11" (8)X3)
- 15. MK 2H PAV MARK (RENOV) (4" X 11" (8)X3)
- 16. MK 2H PAV MARK (RENOV) (4" X 11" (8)X3)
- 17. MK 2H PAV MARK (RENOV) (4" X 11" (8)X3)
- 18. MK 2H PAV MARK (RENOV) (4" X 11" (8)X3)
- 19. MK 2H PAV MARK (RENOV) (4" X 11" (8)X3)
- 20. MK 2H PAV MARK (RENOV) (4" X 11" (8)X3)
- 21. MK 2H PAV MARK (RENOV) (4" X 11" (8)X3)
- 22. MK 2H PAV MARK (RENOV) (4" X 11" (8)X3)
- 23. MK 2H PAV MARK (RENOV) (4" X 11" (8)X3)
- 24. MK 2H PAV MARK (RENOV) (4" X 11" (8)X3)
- 25. MK 2H PAV MARK (RENOV) (4" X 11" (8)X3)
- 26. MK 2H PAV MARK (RENOV) (4" X 11" (8)X3)
- 27. MK 2H PAV MARK (RENOV) (4" X 11" (8)X3)
- 28. MK 2H PAV MARK (RENOV) (4" X 11" (8)X3)
- 29. MK 2H PAV MARK (RENOV) (4" X 11" (8)X3)
- 30. MK 2H PAV MARK (RENOV) (4" X 11" (8)X3)
- 31. MK 2H PAV MARK (RENOV) (4" X 11" (8)X3)
- 32. MK 2H PAV MARK (RENOV) (4" X 11" (8)X3)
- 33. MK 2H PAV MARK (RENOV) (4" X 11" (8)X3)
- 34. MK 2H PAV MARK (RENOV) (4" X 11" (8)X3)
- 35. MK 2H PAV MARK (RENOV) (4" X 11" (8)X3)
- 36. MK 2H PAV MARK (RENOV) (4" X 11" (8)X3)
- 37. MK 2H PAV MARK (RENOV) (4" X 11" (8)X3)
- 38. MK 2H PAV MARK (RENOV) (4" X 11" (8)X3)
- 39. MK 2H PAV MARK (RENOV) (4" X 11" (8)X3)
- 40. MK 2H PAV MARK (RENOV) (4" X 11" (8)X3)
- 41. MK 2H PAV MARK (RENOV) (4" X 11" (8)X3)
- 42. MK 2H PAV MARK (RENOV) (4" X 11" (8)X3)
- 43. MK 2H PAV MARK (RENOV) (4" X 11" (8)X3)
- 44. MK 2H PAV MARK (RENOV) (4" X 11" (8)X3)
- 45. MK 2H PAV MARK (RENOV) (4" X 11" (8)X3)
- 46. MK 2H PAV MARK (RENOV) (4" X 11" (8)X3)
- 47. MK 2H PAV MARK (RENOV) (4" X 11" (8)X3)
- 48. MK 2H PAV MARK (RENOV) (4" X 11" (8)X3)
- 49. MK 2H PAV MARK (RENOV) (4" X 11" (8)X3)
- 50. MK 2H PAV MARK (RENOV) (4" X 11" (8)X3)
- 51. MK 2H PAV MARK (RENOV) (4" X 11" (8)X3)
- 52. MK 2H PAV MARK (RENOV) (4" X 11" (8)X3)
- 53. MK 2H PAV MARK (RENOV) (4" X 11" (8)X3)
- 54. MK 2H PAV MARK (RENOV) (4" X 11" (8)X3)
- 55. MK 2H PAV MARK (RENOV) (4" X 11" (8)X3)
- 56. MK 2H PAV MARK (RENOV) (4" X 11" (8)X3)
- 57. MK 2H PAV MARK (RENOV) (4" X 11" (8)X3)
- 58. MK 2H PAV MARK (RENOV) (4" X 11" (8)X3)
- 59. MK 2H PAV MARK (RENOV) (4" X 11" (8)X3)
- 60. MK 2H PAV MARK (RENOV) (4" X 11" (8)X3)
- 61. MK 2H PAV MARK (RENOV) (4" X 11" (8)X3)
- 62. MK 2H PAV MARK (RENOV) (4" X 11" (8)X3)
- 63. MK 2H PAV MARK (RENOV) (4" X 11" (8)X3)
- 64. MK 2H PAV MARK (RENOV) (4" X 11" (8)X3)
- 65. MK 2H PAV MARK (RENOV) (4" X 11" (8)X3)
- 66. MK 2H PAV MARK (RENOV) (4" X 11" (8)X3)
- 67. MK 2H PAV MARK (RENOV) (4" X 11" (8)X3)
- 68. MK 2H PAV MARK (RENOV) (4" X 11" (8)X3)
- 69. MK 2H PAV MARK (RENOV) (4" X 11" (8)X3)
- 70. MK 2H PAV MARK (RENOV) (4" X 11" (8)X3)
- 71. MK 2H PAV MARK (RENOV) (4" X 11" (8)X3)
- 72. MK 2H PAV MARK (RENOV) (4" X 11" (8)X3)
- 73. MK 2H PAV MARK (RENOV) (4" X 11" (8)X3)
- 74. MK 2H PAV MARK (RENOV) (4" X 11" (8)X3)
- 75. MK 2H PAV MARK (RENOV) (4" X 11" (8)X3)
- 76. MK 2H PAV MARK (RENOV) (4" X 11" (8)X3)
- 77. MK 2H PAV MARK (RENOV) (4" X 11" (8)X3)
- 78. MK 2H PAV MARK (RENOV) (4" X 11" (8)X3)
- 79. MK 2H PAV MARK (RENOV) (4" X 11" (8)X3)
- 80. MK 2H PAV MARK (RENOV) (4" X 11" (8)X3)
- 81. MK 2H PAV MARK (RENOV) (4" X 11" (8)X3)
- 82. MK 2H PAV MARK (RENOV) (4" X 11" (8)X3)
- 83. MK 2H PAV MARK (RENOV) (4" X 11" (8)X3)
- 84. MK 2H PAV MARK (RENOV) (4" X 11" (8)X3)
- 85. MK 2H PAV MARK (RENOV) (4" X 11" (8)X3)
- 86. MK 2H PAV MARK (RENOV) (4" X 11" (8)X3)
- 87. MK 2H PAV MARK (RENOV) (4" X 11" (8)X3)
- 88. MK 2H PAV MARK (RENOV) (4" X 11" (8)X3)
- 89. MK 2H PAV MARK (RENOV) (4" X 11" (8)X3)
- 90. MK 2H PAV MARK (RENOV) (4" X 11" (8)X3)
- 91. MK 2H PAV MARK (RENOV) (4" X 11" (8)X3)
- 92. MK 2H PAV MARK (RENOV) (4" X 11" (8)X3)
- 93. MK 2H PAV MARK (RENOV) (4" X 11" (8)X3)
- 94. MK 2H PAV MARK (RENOV) (4" X 11" (8)X3)
- 95. MK 2H PAV MARK (RENOV) (4" X 11" (8)X3)
- 96. MK 2H PAV MARK (RENOV) (4" X 11" (8)X3)
- 97. MK 2H PAV MARK (RENOV) (4" X 11" (8)X3)
- 98. MK 2H PAV MARK (RENOV) (4" X 11" (8)X3)
- 99. MK 2H PAV MARK (RENOV) (4" X 11" (8)X3)
- 100. MK 2H PAV MARK (RENOV) (4" X 11" (8)X3)

NOTES:
1. CONTRACTOR TO MAINTAIN ACCESS TO ALL SIDEWALKS AND DRIVEWAYS AT ALL TIMES UNLESS OTHERWISE APPROVED.
2. FAST-TRACK PAVEMENT TO BE CONSTRUCTED BETWEEN 18:00 PM AND 5:00 AM.
3. SEE BARRIERS AND CONSTRUCTION STANDARDS FOR CHANNELIZING DEVICE SPECIFICS.

SCALE: 1"=100'

0 25 50 100 200

DATE BY DESCRIPTION

THIS DOCUMENT IS RELEASED FOR INFORMATION PURPOSES AND IS NOT TO BE USED FOR CONSTRUCTION, BIDDING, OR PERMIT PURPOSES.

WACH A. HORGANI
P. E. 86002
1002 S. WASHINGTON
DALLAS, TX 75201

DANNENBAUM
ENGINEERING CORPORATION
200 WEST FARMER AVENUE, SUITE 1000
DALLAS, TEXAS 75241

Texas Department of Transportation

FM 1093 WESTPARK EXTENSION
TRAFFIC CONTROL PLAN
PHASE 2A
STA 199+00 TO STA 221+00
SHEET 1 OF 6

DESIGNED BY: [] DRAWN BY: []
CHECKED BY: [] DATE: []
CONTRACT NO.: [] SHEET NO.: []
PROJECT NO.: [] DATE: []

Exhibit A3

FILE: G:\180-4593-02 Westpark04 DOW UTILITIES CROSSINGS WP Plan04.dwg
DATE: 10/7/2006

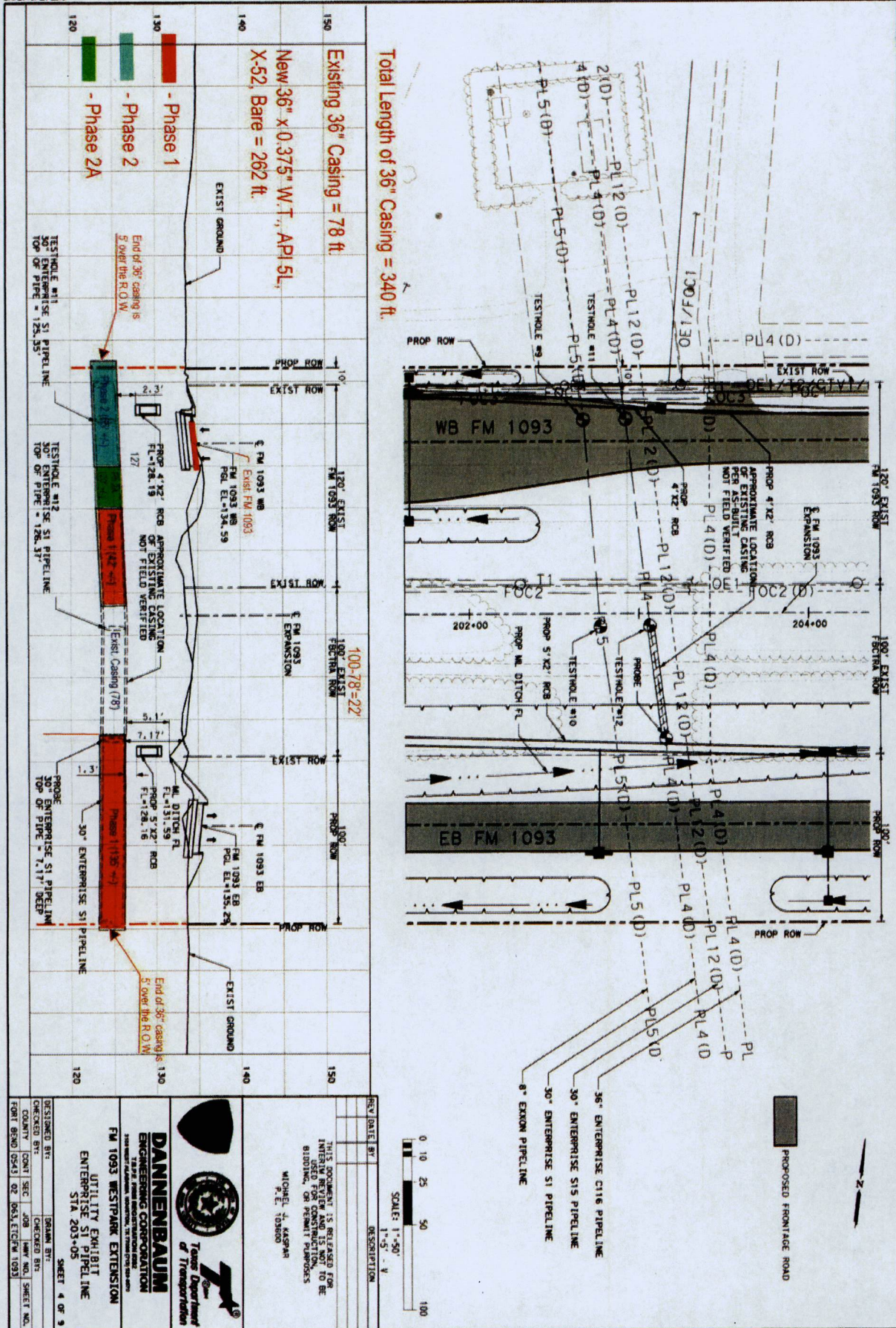

Total Length of 36" Casing = 340 ft.

Existing 36" Casing = 78 ft.
New 36" x 0.375" W.T., API 5L,
X-52, Bare = 262 ft.

End of 36" casing is 5' over the R.O.W.

End of 36" casing is 5' over the R.O.W.

End of 36" casing is 5' over the R.O.W.



REV DATE BY DESCRIPTION

THIS DOCUMENT IS RELEASED FOR
INFORMATION PURPOSES ONLY. IT IS
NOT TO BE USED FOR CONSTRUCTION,
BIDDING, OR PERMIT PURPOSES.

MICHAEL J. ANSPAR
P.E. 10980



DANNENBAUM
ENGINEERING CORPORATION
2800 West Loop South, Suite 200, Houston, TX 77058
UTILITY EXHIBIT
ENTERSPRISE S1 PIPELINE
STA 203+05
SHEET 4 OF 9

DESIGNED BY	DRAMA BY
CHECKED BY	CHECKED BY
COUNTY	DATE
FORM 850 (2-93)	02 06/16/2006

LINK-SEAL, DHB END SEAL, OR COMPANY APPROVED OR EQUIVALENT SEE NOTE #6
 CASING END SEAL DETAIL (W/LINK-SEAL SHOWN)

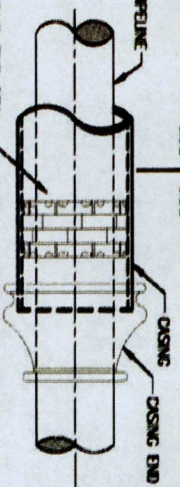

NOMINAL SIZE - INCHES

PIPELINE DIAMETER	2"	3"	4"	5"	6"	8"	10"	12"	14"	16"	18"	20"	22"	24"	26"	30"	36"	42"	48"	54"	60"	
CASING DIAMETER	6"	8"	8"	10"	10"	12"	16"	16"	18"	20"	24"	24"	26"	30"	30"	36"	42"	42"	48"	54"	54"	
MIN. CASING THICKNESS (INCHES)	.189"																					
MIN. CASING THICKNESS (P/INCH)	.003"																					
VENT DIAMETER	2"										3"										4"	

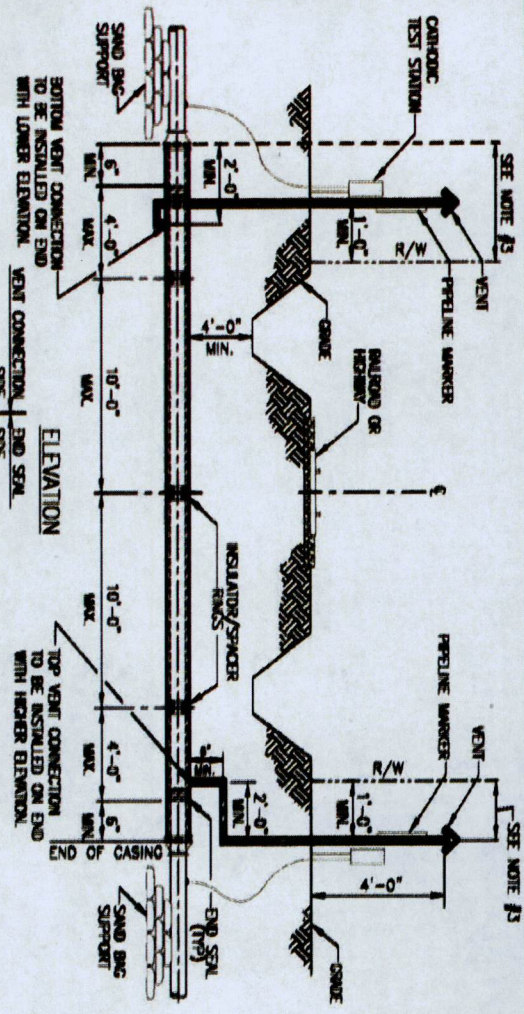

NOTES

- THIS CROSSING SHALL BE DESIGNED AND CONSTRUCTED IN ACCORDANCE WITH THE FOLLOWING CODES:
 - 49 CFR 192 - TRANSPORTATION OF NATURAL AND OTHER GAS BY PIPELINE - MINIMUM FEDERAL SAFETY STANDARDS
 - 49 CFR 195 - TRANSPORTATION OF HAZARDOUS LIQUIDS BY PIPELINE
 - AWS/ASME B31.4 - PIPELINE TRANSPORTATION SYSTEMS FOR LIQUID HYDROCARBONS AND OTHER LIQUIDS
 - AWS/ASME B31.8 - GAS TRANSMISSION AND DISTRIBUTION PIPING SYSTEMS
 - API RP 1102 - STEEL PIPELINES CROSSING RAILROADS AND HIGHWAYS
- FOLLOW HIGHWAY AND RAILROAD SPECIFICATIONS FOR SPECIFIC DEPTH AND LENGTH.
- CONSULT OPERATIONS TO DETERMINE THE LENGTH OF CASING TO EXTEND BEYOND THE R/W EDGES.
- CUT FULL BORE HOLE FOR VENT PIPE AND WELD TO CASING PRIOR TO INSERTING THE CARRIER PIPE.
- INSULATORS SHALL BE INSTALLED OVER SPECIFIED PROTECTIVE COATING ON CARRIER PIPE.
- LINK-SEAL, DHB END SEAL, OR COMPANY APPROVED EQUIV. SHALL BE INSTALLED ON EACH END OF THE CASING. END SEAL SHALL NOT BE UTILIZED AT ANY OTHER LOCATION OF THE PIPE TO ALLOW THE ANNULUS OF THE PIPE TO BE MAX. FILLED.
- THE INTERIOR OF THE CASING SHALL BE CLEAN AND DRY PRIOR TO THE INSTALLATION OF THE END SEALS.
- CASING SHALL BE INSTALLED DRY WITHOUT COATING.
- ALL BELOW GROUND VENT PIPE TO BE COATED PER COMPANY SPECIFICATION, STD.7002 "PROTECTIVE COATINGS - BELOW GROUND STEEL SURFACES - FIELD APPLIED". ABOVE GROUND POSITION TO BE PAINTED IN ACCORDANCE WITH COMPANY SPECIFICATION STD.7001 "PROTECTIVE COATINGS - ABOVE GROUND STEEL SURFACES".
- INSTALL CASING VENT WITH 12" x 9" WRAPPING SEAL ON EACH END OF CASING.
- CASING VENT LINES TO BE ELECTRICALLY ISOLATED FROM CARRIER PIPE AND INSTALLED SO THEY CANNOT CONTACT CARRIER PIPE AFTER SETTLING.
- INSTALL CATHODIC TEST STATION AT EACH VENT IN ACCORDANCE WITH COMPANY SPECIFICATION STD.7006 "CATHODIC PROTECTION - GENERAL".
- SAND BAG SUPPORT SHALL BE PLACED ON UNDISTURBED SOIL UNDER THE PIPELINE TO AVOID SINKING WHEN BACKFILLED.
- THE COMPLETED ASSEMBLY SHALL BE TESTED FOR ELECTRICAL INSULATION.
- ALL ABOVE INFORMATION MUST BE SUBMITTED AND APPROVED BY THE REGULATING AUTHORITIES PRIOR TO INSTALLATION.
- REFER TO THE FOLLOWING STANDARDS FOR ADDITIONAL REQUIREMENTS:
 - STD-C01-2521 - PIPELINE UNDERCROSSING FOR ROADS AND HIGHWAYS (CROSS)
 - STD-C01-2522 - PIPELINE UNDERCROSSING FOR SINGLE TRACK RAILROAD (CROSS)
 - STD-C01-2523 - PIPELINE UNDERCROSSING FOR MULTIPLE TRACK RAILROAD (CROSS)
 - STD-C01-2524 - CASING INSULATORS
 - STD-F01-4100 - CASING VENT
 - STD-F01-4118 - CASING VENT INSTALLATION, CONCRETE COATED CARRIER PIPE
 - STD-S01-1101 - PIPELINE MARKER

THIS PROJECT IS BEING DESIGNED AND CONSTRUCTED IN ACCORDANCE WITH THE FOLLOWING CODES AND STANDARDS: 49 CFR 192, 49 CFR 195, AWS/ASME B31.4, AWS/ASME B31.8, API RP 1102, AND COMPANY SPECIFICATIONS.

DESIGNED BY: [Signature]

CHECKED BY: [Signature]

DATE: [Date]

PROJECT NO: [Number]

SCALE: [Scale]

APPROVED BY: [Signature]

DATE: [Date]

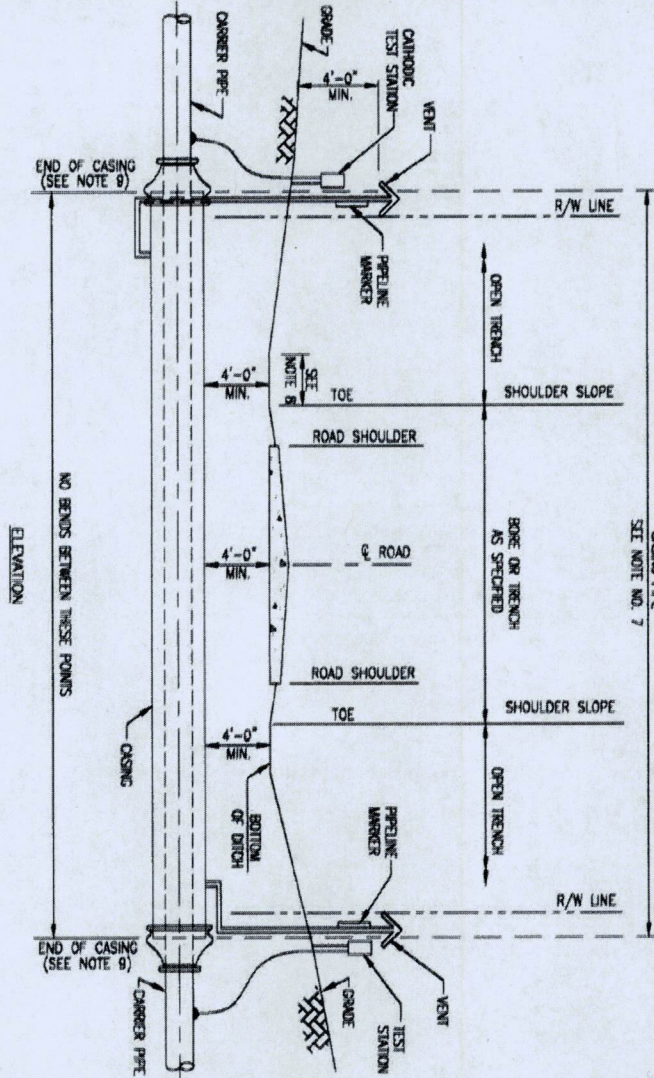

THIS WORKING DRAWING IS THE PROPERTY OF ENTEGRIS. IT IS TO BE USED ONLY FOR THE PROJECT AND LOCATION SPECIFICALLY IDENTIFIED HEREON. IT IS NOT TO BE REPRODUCED, COPIED, REPRODUCED, OR TRANSMITTED IN ANY FORM OR BY ANY MEANS, ELECTRONIC OR MECHANICAL, INCLUDING PHOTOCOPYING, RECORDING, OR BY ANY INFORMATION STORAGE AND RETRIEVAL SYSTEM, WITHOUT THE WRITTEN PERMISSION OF ENTEGRIS.		PERELINE UNDERCROSSING	
NO.	DESCRIPTION	DATE	BY
1	ISSUED FOR PERELINE UNDERCROSSING	11/11/03	WJ
2	REVISED PERELINE UNDERCROSSING	11/11/03	WJ
3	REVISED PERELINE UNDERCROSSING	11/11/03	WJ
4	REVISED PERELINE UNDERCROSSING	11/11/03	WJ
5	REVISED PERELINE UNDERCROSSING	11/11/03	WJ
6	REVISED PERELINE UNDERCROSSING	11/11/03	WJ
7	REVISED PERELINE UNDERCROSSING	11/11/03	WJ
8	REVISED PERELINE UNDERCROSSING	11/11/03	WJ
9	REVISED PERELINE UNDERCROSSING	11/11/03	WJ
10	REVISED PERELINE UNDERCROSSING	11/11/03	WJ
11	REVISED PERELINE UNDERCROSSING	11/11/03	WJ
12	REVISED PERELINE UNDERCROSSING	11/11/03	WJ
13	REVISED PERELINE UNDERCROSSING	11/11/03	WJ
14	REVISED PERELINE UNDERCROSSING	11/11/03	WJ
15	REVISED PERELINE UNDERCROSSING	11/11/03	WJ
16	REVISED PERELINE UNDERCROSSING	11/11/03	WJ
17	REVISED PERELINE UNDERCROSSING	11/11/03	WJ
18	REVISED PERELINE UNDERCROSSING	11/11/03	WJ
19	REVISED PERELINE UNDERCROSSING	11/11/03	WJ
20	REVISED PERELINE UNDERCROSSING	11/11/03	WJ
21	REVISED PERELINE UNDERCROSSING	11/11/03	WJ
22	REVISED PERELINE UNDERCROSSING	11/11/03	WJ
23	REVISED PERELINE UNDERCROSSING	11/11/03	WJ
24	REVISED PERELINE UNDERCROSSING	11/11/03	WJ
25	REVISED PERELINE UNDERCROSSING	11/11/03	WJ
26	REVISED PERELINE UNDERCROSSING	11/11/03	WJ
27	REVISED PERELINE UNDERCROSSING	11/11/03	WJ
28	REVISED PERELINE UNDERCROSSING	11/11/03	WJ
29	REVISED PERELINE UNDERCROSSING	11/11/03	WJ
30	REVISED PERELINE UNDERCROSSING	11/11/03	WJ
31	REVISED PERELINE UNDERCROSSING	11/11/03	WJ
32	REVISED PERELINE UNDERCROSSING	11/11/03	WJ
33	REVISED PERELINE UNDERCROSSING	11/11/03	WJ
34	REVISED PERELINE UNDERCROSSING	11/11/03	WJ
35	REVISED PERELINE UNDERCROSSING	11/11/03	WJ
36	REVISED PERELINE UNDERCROSSING	11/11/03	WJ
37	REVISED PERELINE UNDERCROSSING	11/11/03	WJ
38	REVISED PERELINE UNDERCROSSING	11/11/03	WJ
39	REVISED PERELINE UNDERCROSSING	11/11/03	WJ
40	REVISED PERELINE UNDERCROSSING	11/11/03	WJ
41	REVISED PERELINE UNDERCROSSING	11/11/03	WJ
42	REVISED PERELINE UNDERCROSSING	11/11/03	WJ
43	REVISED PERELINE UNDERCROSSING	11/11/03	WJ
44	REVISED PERELINE UNDERCROSSING	11/11/03	WJ
45	REVISED PERELINE UNDERCROSSING	11/11/03	WJ
46	REVISED PERELINE UNDERCROSSING	11/11/03	WJ
47	REVISED PERELINE UNDERCROSSING	11/11/03	WJ
48	REVISED PERELINE UNDERCROSSING	11/11/03	WJ
49	REVISED PERELINE UNDERCROSSING	11/11/03	WJ
50	REVISED PERELINE UNDERCROSSING	11/11/03	WJ
51	REVISED PERELINE UNDERCROSSING	11/11/03	WJ
52	REVISED PERELINE UNDERCROSSING	11/11/03	WJ
53	REVISED PERELINE UNDERCROSSING	11/11/03	WJ
54	REVISED PERELINE UNDERCROSSING	11/11/03	WJ
55	REVISED PERELINE UNDERCROSSING	11/11/03	WJ
56	REVISED PERELINE UNDERCROSSING	11/11/03	WJ
57	REVISED PERELINE UNDERCROSSING	11/11/03	WJ
58	REVISED PERELINE UNDERCROSSING	11/11/03	WJ
59	REVISED PERELINE UNDERCROSSING	11/11/03	WJ
60	REVISED PERELINE UNDERCROSSING	11/11/03	WJ
61	REVISED PERELINE UNDERCROSSING	11/11/03	WJ
62	REVISED PERELINE UNDERCROSSING	11/11/03	WJ
63	REVISED PERELINE UNDERCROSSING	11/11/03	WJ
64	REVISED PERELINE UNDERCROSSING	11/11/03	WJ
65	REVISED PERELINE UNDERCROSSING	11/11/03	WJ
66	REVISED PERELINE UNDERCROSSING	11/11/03	WJ
67	REVISED PERELINE UNDERCROSSING	11/11/03	WJ
68	REVISED PERELINE UNDERCROSSING	11/11/03	WJ
69	REVISED PERELINE UNDERCROSSING	11/11/03	WJ
70	REVISED PERELINE UNDERCROSSING	11/11/03	WJ
71	REVISED PERELINE UNDERCROSSING	11/11/03	WJ
72	REVISED PERELINE UNDERCROSSING	11/11/03	WJ
73	REVISED PERELINE UNDERCROSSING	11/11/03	WJ
74	REVISED PERELINE UNDERCROSSING	11/11/03	WJ
75	REVISED PERELINE UNDERCROSSING	11/11/03	WJ
76	REVISED PERELINE UNDERCROSSING	11/11/03	WJ
77	REVISED PERELINE UNDERCROSSING	11/11/03	WJ
78	REVISED PERELINE UNDERCROSSING	11/11/03	WJ
79	REVISED PERELINE UNDERCROSSING	11/11/03	WJ
80	REVISED PERELINE UNDERCROSSING	11/11/03	WJ
81	REVISED PERELINE UNDERCROSSING	11/11/03	WJ
82	REVISED PERELINE UNDERCROSSING	11/11/03	WJ
83	REVISED PERELINE UNDERCROSSING	11/11/03	WJ
84	REVISED PERELINE UNDERCROSSING	11/11/03	WJ
85	REVISED PERELINE UNDERCROSSING	11/11/03	WJ
86	REVISED PERELINE UNDERCROSSING	11/11/03	WJ
87	REVISED PERELINE UNDERCROSSING	11/11/03	WJ
88	REVISED PERELINE UNDERCROSSING	11/11/03	WJ
89	REVISED PERELINE UNDERCROSSING	11/11/03	WJ
90	REVISED PERELINE UNDERCROSSING	11/11/03	WJ
91	REVISED PERELINE UNDERCROSSING	11/11/03	WJ
92	REVISED PERELINE UNDERCROSSING	11/11/03	WJ
93	REVISED PERELINE UNDERCROSSING	11/11/03	WJ
94	REVISED PERELINE UNDERCROSSING	11/11/03	WJ
95	REVISED PERELINE UNDERCROSSING	11/11/03	WJ
96	REVISED PERELINE UNDERCROSSING	11/11/03	WJ
97	REVISED PERELINE UNDERCROSSING	11/11/03	WJ
98	REVISED PERELINE UNDERCROSSING	11/11/03	WJ
99	REVISED PERELINE UNDERCROSSING	11/11/03	WJ
100	REVISED PERELINE UNDERCROSSING	11/11/03	WJ

- NOTES:
- THIS CROSSING SHALL BE DESIGNED AND CONSTRUCTED IN ACCORDANCE WITH THE FOLLOWING CODES:
 - 49 CFR 192 - TRANSPORTATION OF NATURAL GAS BY PIPELINE, MINIMUM FEDERAL SAFETY STANDARDS
 - 49 CFR 195 - TRANSPORTATION OF HAZARDOUS LIQUIDS BY PIPELINE
 - AAS/ASME B31.4 - PIPELINE TRANSPORTATION SYSTEMS FOR LIQUID HYDROCARBONS AND OTHER LIQUIDS
 - AAS/ASME B31.8 - GAS TRANSMISSION AND DISTRIBUTION PIPELINE SYSTEMS
 - AAS 1102 - STEEL PIPELINES CROSSING RAILROADS AND HIGHWAYS
 - CASED PIPELINE CROSSINGS ARE NOT PREFERRED AND ARE ONLY TO BE USED WHEN:
 - REQUIRED BY REGULATION OR THE PROPERTY OWNER.
 - DEMAND NECESSARY DUE TO ROCKY TERRAIN, WIDE CROSSING, ETC.
 - CONTRACTOR TO INSTALL PERELINE UNDER ALL PUBLIC ROADS AS SHOWN ON THIS DRAWING OR AS SHOWN ON APPROVED CONSTRUCTION DRAWINGS.
 - ALL Voids DEVELOPED BY BORING UNDER SURFACE OF ROAD BED SHALL BE REPAIRED AS FOLLOWS:
 - VOIDS DEVELOPED UNDER ROAD SURFACE ROADS (BIT, MATERIAL AND CONCRETE) SHALL BE FILLED BY PRESSURE GROUTING. GROUT SHALL CONSIST OF A SAND-CEMENT SLURRY OF AT LEAST 2 SACKS OF CEMENT PER CUBIC YARD
 - VOIDS DEVELOPED UNDER NON-HARD SURFACE (GRAVEL, CRUSHED ROCK OR DIRT) SHALL BE FILLED BY REMOVAL OF ROAD BED AND SPOILING WITH SUITABLE MATERIAL PROBABLY PARTED IN 6 LAYERS TO DENSITY OF SUPERCOMPACT UNDISBURSED EARTH AND REPLACING SURFACE MATERIAL TO ORIGINAL CONDITION.
 - CONTRACTOR SHALL BE RESPONSIBLE FOR ANY DAMAGE TO ROADS AND SHALL REPAIR IT TO HIS ORIGINAL CONDITION.
 - THE PERELINE SHOULD CROSS AS NEAR TO RIGHT ANGLES AS POSSIBLE. IN NO CASE SHOULD IT BE LESS THAN 30 DEGREES.
 - FOR ROADS NOT HAVING A DRAINAGE DITCH, THE MINIMUM COVER FROM THE TOP OF THE ROAD TO ROAD BED OR THE LOWEST ELEVATION WITHIN THE R/W SHALL BE 4'-0" OR AS SPECIFIED BY THE PERMITTING AUTHORITIES.
 - DIMENSIONS OF SOIL COVER ARE MINIMUM REQUIREMENTS AND WILL REQUIRE THE USE OF PROPER ENGINEERING AND DESIGN REVIEW.
 - CASING PIPE SHALL EXTEND A MINIMUM OF 2' BEYOND TOE OF SLOPE OR 3' BEYOND BOTTOM OF THE DRAINAGE DITCH, WHICHEVER IS GREATER.
 - CASING PIPE SHALL BE INSTALLED AS REQUIRED BY THE PERMIT, OR AS A MINIMUM, EXTEND FROM R/W TO R/W.
 - CASING PIPE TO BE COATED PER COMPANY STD-7002 "PROTECTIVE COATINGS - BELOW GROUND STEEL SURFACES - FIELD APPLIED" AND STD-7003 "PROTECTIVE COATINGS - BELOW GROUND STEEL SURFACES - PLANT APPLIED FUSION-BONDED EPOXY AND ABRASION-RESISTANT OVERLAY".
 - REFER TO THE FOLLOWING STANDARDS FOR ADDITIONAL REQUIREMENTS:
 - STD-C01-7520 - CASING AND INSULATION INSTALLATION FOR UNDERCROSSING HIGHWAY AND RAILROAD
 - STD-C01-7524 - CASING INSULATORS
 - STD-S01-1101 - PERELINE MARKERS
 - STD-P01-1100 - CASING VENT



Enbridge
Products
STD-C01-324-03

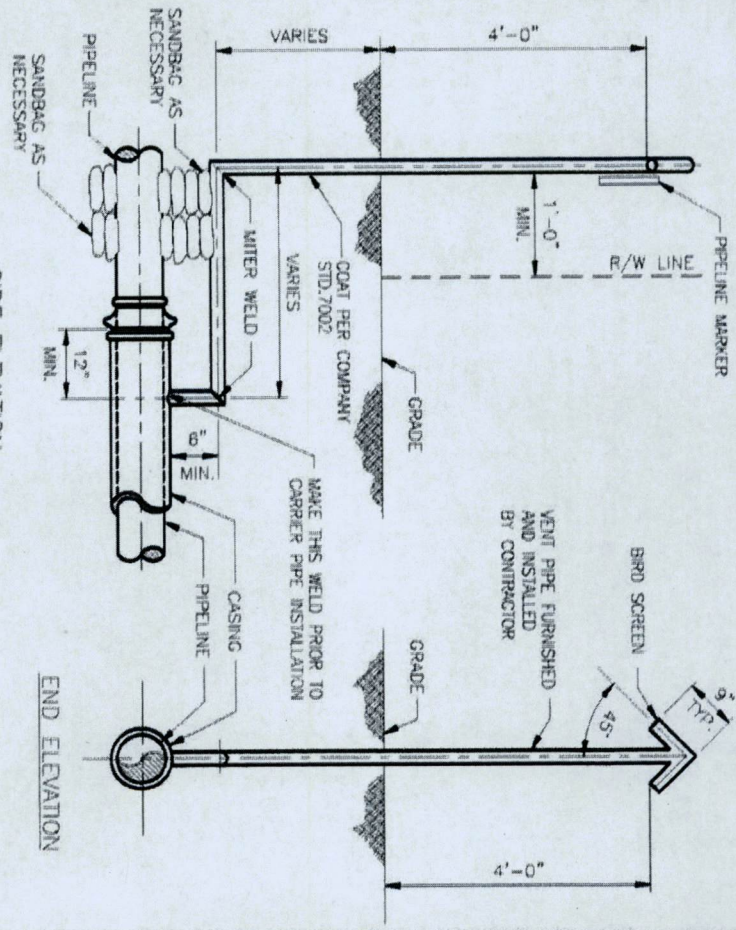

NOTES:

1. VENT PIPE MATERIAL TO BE THE SAME AS THE CASING.
2. VENT SHALL BE A MINIMUM 1'-0" OUTSIDE R/W LINE OR MATCH END OF CASING, WHICHEVER IS GREATER.
3. ALL MATERIALS TO BE FURNISHED BY CONTRACTOR EXCEPT PIPELINE MARKER, UNLESS OTHERWISE NOTED ON CONSTRUCTION DRAWINGS OR CONTRACT DOCUMENTS.
4. ALL MATERIALS EXCEPT PIPELINE MARKER TO BE INSTALLED BY CONTRACTOR.
5. WHEN CASING EXTENDS AT LEAST 12" OUTSIDE R/W LINE, DOUBLE MITERS IN VENT ARE NOT REQUIRED.
6. ALL VENT PIPE TO BE COATED WITH COMPANY SPECIFICATION STD.7001 "PROTECTIVE COATINGS - ABOVE GROUND STEEL SURFACES" AND STD.7002 "PROTECTIVE COATING - BELOW GROUND STEEL SURFACES - FIELD APPLIED".
7. REFER TO PREPUNG CASING AND INSULATOR STANDARD, SEE DWG. STD-C10T-2520.
8. REFER TO PRELINE MARKER STANDARD, SEE DWG. STD-SADT-1101.

SIDE ELEVATION

END ELEVATION

CASING DIAMETER	VENT DIAMETER
6" THRU 16"	2"
18" THRU 26"	3"
30" THRU 54"	4"

THIS DOCUMENT CONTAINS GENERAL DESIGN INFORMATION. ADDITIONAL ENGINEERING IS REQUIRED TO ENSURE THAT THE FINAL DESIGN MEETS OR EXCEEDS ALL APPLICABLE CODES, STANDARDS, REGULATIONS, AND COMPANY REQUIREMENTS.

NO.	DESCRIPTION	DATE	BY	CHKD.	REV.	REVISION
1	ISSUED FOR PERMIT	11/11/11
2
3
4
5
6
7
8
9
10



ENERGETIC PRODUCTS
 10000 W. 100th Ave., Suite 100
 Denver, CO 80231
 TEL: 303.440.1000
 FAX: 303.440.1001
 WWW: WWW.ENERGETICPRODUCTS.COM
 STD-4037-4289-01

Exhibit B

Construction Cost Estimate

(2 Pages That Follow)

FWB 3/3/17
Initial Date
Fort Bend County

GLK 2/27/2017
Initial Date
Enterprise Products

Exhibit B1

Encroachment Project - Budget Estimate

Project Title: Fort Bend Co., Westpark Tollway - 30" LID # S1 Casing Extension

Proj. ID: DB #9832
AFE No.:

Location: Fort Bend Co., TX

Scope: The scope of this project are to sandblast, inspect (visual & NDE), recoat and extend the 36" split casing pipe on 30" Crude P/L, LID # S1. Work will be done in 3 phases following the work sequence of Fort Bend Contractor. This is to accommodate the proposed Westpark Tollway Extension Phase II project by Fort Bend Co.

Date: 10/04/16

Revised: 02/07/17

Owner: Seaway Crude P/L Co., LLC

By: J. Sibal

Operator: Enterprise Crude Pipeline Company, LLC.

Checked: R. Choiniere

CODE	DESCRIPTION	QUANTITY	UNIT	UNIT COST	AMOUNT	SUB- TOTAL
ENGINEERING/SURVEY COST						
905	Outside Engineering					\$3,600
	Encroachment Engr. Review	24	hours	\$150	\$3,600	
	Project Engineer	0	hrs	165	\$0	
	Designer/Technician	0	hrs	100	\$0	
	Project Services	0	hrs	75	\$0	
	3 man Survey crew	0	days	3,000	\$0	
INSPECTION COST						
907	Inspection-misc.					\$127,200
	Site Inspector	54	days	\$1,100	\$59,400	
	Site Inspector - COR	48	days	\$1,100	\$52,800	
	NDE Inspection	1	ls	\$15,000	\$15,000	
	Environmental Inspection					
GENERAL EQUIPMENT & MATERIALS						
934	Protective Coating - misc. (Included in Code 987)			\$0		
935	Line Pipe			\$0		
	Piping Bends			\$0		
	Valves			\$0		
	Fittings			\$0		
PROFESSIONAL SERVICES, LAND, PERMITS,LEGAL & EHS						
951	Land Costs					\$15,000
	P/L ROW Costs					
	Land Damages -					
	Temp. Work Space / Access	1	ea	\$15,000	\$15,000	
953	ROW Acquisition Services					\$10,800
964	Legal & Prof Services	24	hours	\$450	\$10,800	
	Permits			\$0		
965	Environmental Mitigation					\$960
	Environmental Scientist	8	hours	\$120	\$960	
971	Insurance Premiums					
INTERNAL COST						
908	Salaries & Wages - ST					\$29,040
	Project Manager	180	hours	\$140	\$25,200	
	Manager	0	hours	\$170	\$0	
	Safety Coordinator	8	hours	\$90	\$720	
	Environmental Scientist	8	hours	\$120	\$960	
	Sr. Land Representative	24	hours	\$90	\$2,160	
983	Maint/Opr Dept. Assistance					\$9,360
	O&M Supervisor	24	hours	\$100	\$2,400	
	Corrosion Tech.	24	hours	\$65	\$1,560	
	Pipeline Tech.	60	hours	\$90	\$5,400	
985	Office Costs & Travel					\$1,000
	Travel and Office Expenses	1	ls	\$1,000	\$1,000	

Exhibit B2

Encroachment Project - Budget Estimate

Project Title: Fort Bend Co., Westpark Tollway - 30' LID # S1 Casing Extension

Proj. ID: DB #9832
AFE No.:

Location: Fort Bend Co., TX

Scope: The scope of this project are to sandblast, inspect (visual & NDE), recoat and extend the 36" split casing pipe on 30" Crude P/L, LID # S1. Work will be done in 3 phases following the work sequence of Fort Bend Contractor. This is to accommodate the proposed Westpark Tollway Extension Phase II project by Fort Bend Co.

Date: 10/04/16

Revised: 02/07/17

Owner: Seaway Crude P/L Co., LLC

By: J. Sibal

Operator: Enterprise Crude Pipeline Company, LLC.

Checked: R. Choiniere

CODE	DESCRIPTION	QUANTITY	UNIT	UNIT COST	AMOUNT	SUB- TOTAL
987	<p style="text-align: center;">CONST CONTRACTS COST</p> <p>Construction contracts-misc.</p> <p>Sand blast, inspect and recoat 282 ft. section of 30" Crude P/L, LID #S1 across FM 1093. Supply & install 262 ft. x 36" x 0.375" W.T., API 5L, Gr. B, Bare split casing pipe, insulators and end seals. This project is divided into 3 phases and cost for 3 mobilizations were included.</p> <p>DHB Link Seal (Labor and Materials)</p> <p>Inhibitive Wax Fill</p> <p>Timber Mats</p> <p>Cathodic Protection Install</p> <p>Test Lead for Cathodic Protection</p>	1	ea.	\$550,000	\$550,000	\$669,000
		1	ea.	\$10,000	\$10,000	
		1	ea.	\$80,000	\$80,000	
		100	ea.	\$275	\$27,500	
		1	ls	\$1,500	\$1,500	
	SUB - TOTAL					\$865,960
988	CONTINGENCY	10%				\$86,596.00
989	CONSTS. OVERHEAD	15%				\$142,883
	Grand Total					\$1,095,439

- Notes:** Estimate is based on the following:
1. Fair to good weather without contingency for weather delays.
 2. Casing pipes were melted and rolled in USA.
 3. Three mobilization per TxDOT work sequence.
 4. Environmental desktop and permitting is covered by Fort Bend Co.
 5. Buy America requirement does not apply to this project per direction of Fort Bend - Michael Kaspar on Feb. 6, 2017.

Cost Sharing		
Seaway Crude P/L Co., LLC	56.0%	\$613,446.06
Fort Bend Co.	44.0%	\$481,993.34
Total	100.0%	\$1,095,439.40

Exhibit C

Schedule of Work and Estimated Dates of Completion.

(As Shown Below)

Construction Schedule:

Begin Construction:

Phase I:

Begin Construction: April 3, 2017 (Depend upon how soon Fort Bend will approve the agreement)

Complete Construction: April 21, 2017

Phase II:

Begin Construction: Will follow the construction sequence of Fort Bend contractor.

Complete Construction: 2 Weeks

Phase IIa:

Begin Construction: Will follow the construction sequence of Fort Bend contractor.

Complete Construction: 2-3 Weeks after mobilization

Initial Date
Fort Bend County 3/3/17

Initial Date
Enterprise Products 2/27/2017

Attachment "F"

Eligibility Ratio

TX DOT UA Number:
ROW VSJ:
County: Fort Bend
Highway: Westpark Tollway
Limits:

Subject: 30" Seaway Pipeline LID S1

Texas Transportation Code Section 203.092 provides that Utility reimbursement for facility relocation is dependent upon whether the relocation costs are eligible for TXDOT participation. Pursuant to current TXDOT participation is 32.3% of all eligible cost.

Existing ROW width associated to this project: 220 ft. – 78 ft. (ROW with Existing Casing) = 142 ft.

Prop. ROW Width = 110 ft.

Total of existing and proposed ROW Width: 142 + 110 = 252 ft.

Eligibility Ratio for Reimbursement = $110/252 = 44\%$ (Cost to Fort Bend Co.)

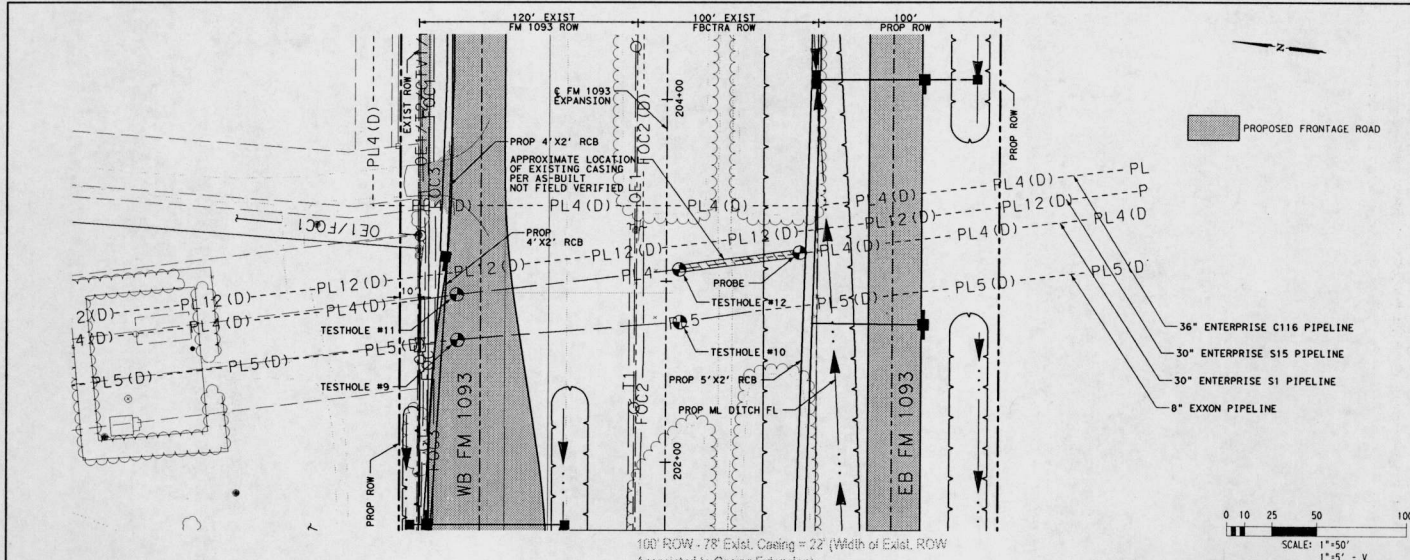

100' ROW - 78' Exist. Casing = 22' (Width of Exist. ROW Associated to Casing Extension)

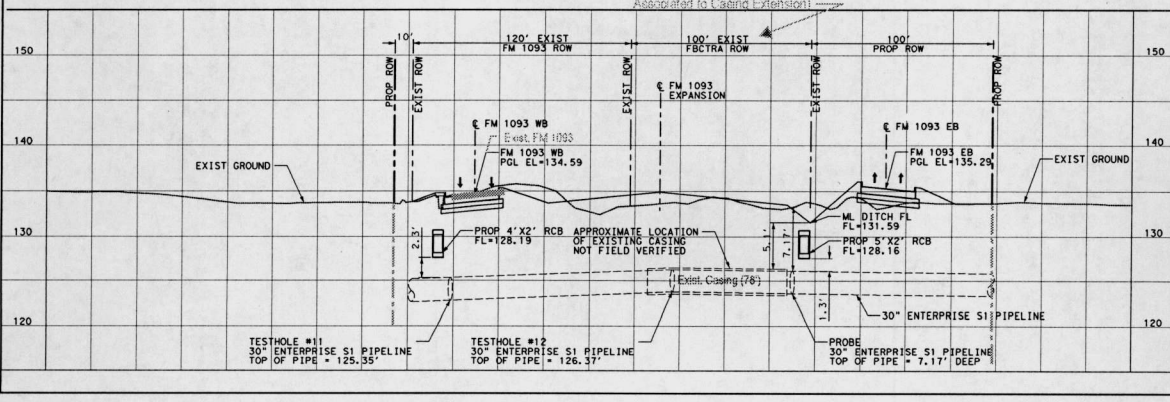

REV	DATE	BY	DESCRIPTION

THIS DOCUMENT IS RELEASED FOR INTERIM REVIEW AND IS NOT TO BE USED FOR CONSTRUCTION, BIDDING, OR PERMIT PURPOSES

MICHAEL J. KASPAR
P.E. 103600

DANNENBAUM
ENGINEERING CORPORATION
P.L.L.C. FIRM REGISTRATION #882
2100 WEST ALABAMA HOUSTON, TX 77005 (713) 551-8070

FM 1093 WESTPARK EXTENSION
UTILITY EXHIBIT
ENTERPRISE S1 PIPELINE
STA 203+05

DESIGNED BY: _____ DRAWN BY: _____
CHECKED BY: _____ CHECKED BY: _____
COUNTY: _____ CONT: _____ SEC: _____ JOB: _____ HWY NO.: _____ SHEET NO.: _____
FORT BEND 0543 02 063,ETCFM 1093

SHEET 4 OF 9

FILE: 05/09/2005 09:52:42 W:\mof\04\DWG\UTL\ETCFM1093\WB\WB.dwg
 DATE: 02/22/2006

FORT BEND COUNTY, TE S
 ENOCH LATHAM, JR.
 A-50

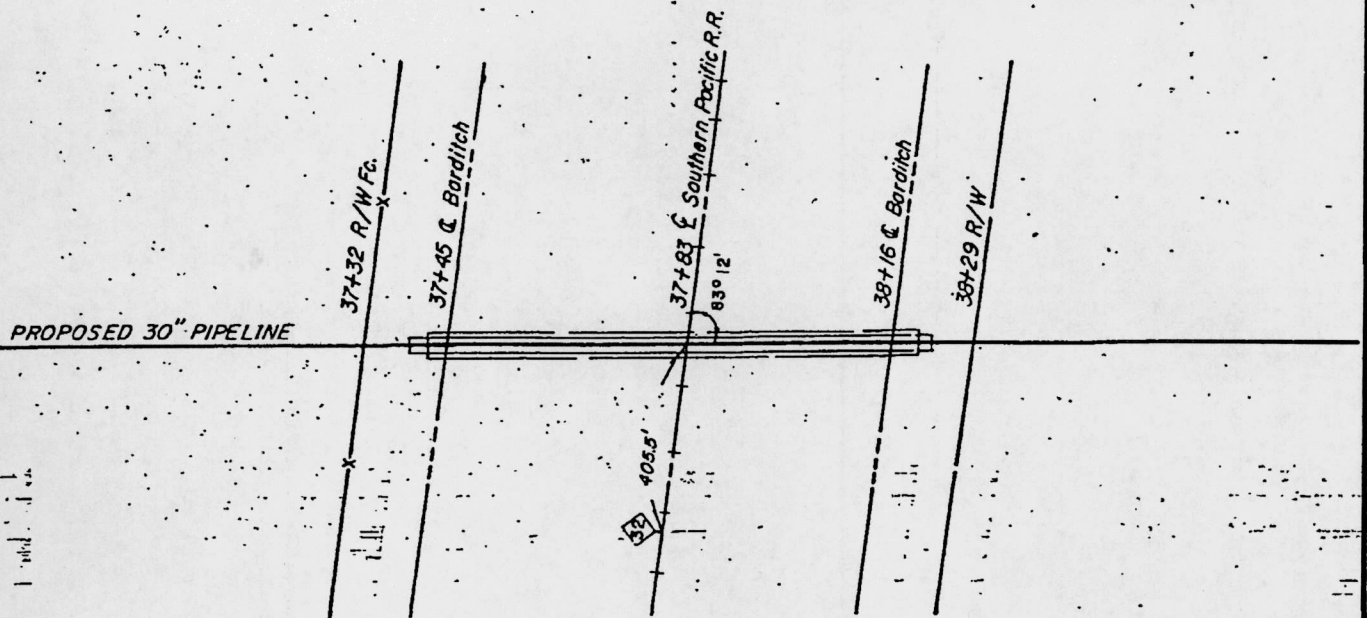
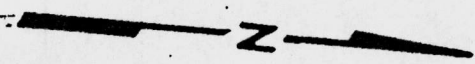

PLAN
 SCALE 1"=30'

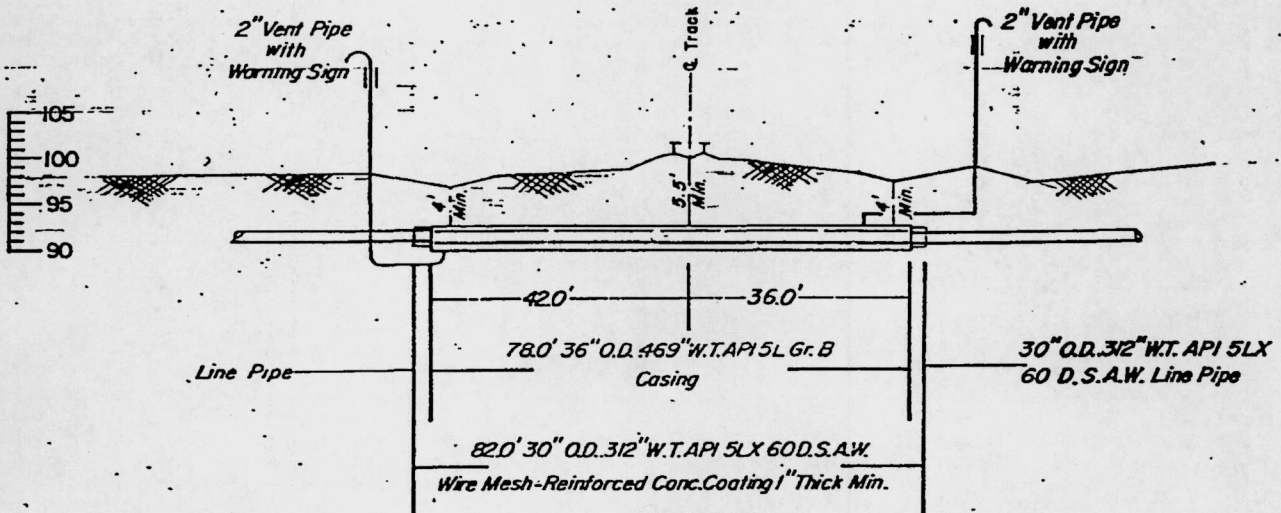

PROFILE
 SCALE HORIZ. 1"=30'
 VERT. 1"=20'

NO.	REVISION	BY	DATE	CHKD	APP'D
SEAWAY PIPELINE INC.					
BARTLESVILLE, OKLAHOMA					
PROPOSED 30" PIPE LINE					
CROSSING					
SOUTHERN PACIFIC R.R.					
FOR BIDS					AFE NO.
FOR APPR					FILE CODE
FOR CONST.					SCALE <i>SHOWN</i>
DESIGN					UNLESS OTHERWISE NOTED
DRAWN 12-8-74	B.J.S.				DWG NO. 1-22-22
CHECKED 3-12-75	K.H.				SH NO. 1B-T-3
APP'D					

CERTIFICATE OF INTERESTED PARTIES

FORM 1295

1 of 1

Complete Nos. 1 - 4 and 6 if there are interested parties.
Complete Nos. 1, 2, 3, 5, and 6 if there are no interested parties.

OFFICE USE ONLY CERTIFICATION OF FILING

1 Name of business entity filing form, and the city, state and country of the business entity's place of business.

Seaway Crude Pipeline Company LLC
Houston, TX United States

Certificate Number:
2017-166908

Date Filed:
02/14/2017

2 Name of governmental entity or state agency that is a party to the contract for which the form is being filed.

Fort Bend County, Texas

Date Acknowledged:

3 Provide the identification number used by the governmental entity or state agency to track or identify the contract, and provide a description of the services, goods, or other property to be provided under the contract.

23381-02/14/2017
Utility relocation regarding FM 1093/Westpark, Mobility Bond Project No. 748

4	Name of Interested Party	City, State, Country (place of business)	Nature of interest (check applicable)	
			Controlling	Intermediary
	See Exhibit A	Houston, TX United States	X	

5 Check only if there is NO Interested Party.

6 AFFIDAVIT I swear, or affirm, under penalty of perjury, that the above disclosure is true and correct.

Signature of authorized agent of contracting business entity

AFFIX NOTARY STAMP / SEAL ABOVE

Sworn to and subscribed before me, by the said _____, this the _____ day of _____, 20_____, to certify which, witness my hand and seal of office.

Signature of officer administering oath Printed name of officer administering oath Title of officer administering oath

CERTIFICATE OF INTERESTED PARTIES

FORM 1295

1 of 1

Complete Nos. 1 - 4 and 6 if there are interested parties.
 Complete Nos. 1, 2, 3, 5, and 6 if there are no interested parties.

OFFICE USE ONLY CERTIFICATION OF FILING

1 Name of business entity filing form, and the city, state and country of the business entity's place of business.
 Seaway Crude Pipeline Company LLC
 Houston, TX United States

Certificate Number:
 2017-166908

Date Filed:
 02/14/2017

2 Name of governmental entity or state agency that is a party to the contract for which the form is being filed.
 Fort Bend County, Texas

Date Acknowledged:
 03/14/2017

3 Provide the identification number used by the governmental entity or state agency to track or identify the contract, and provide a description of the services, goods, or other property to be provided under the contract.
 23381-02/14/2017
 Utility relocation regarding FM 1093/Westpark, Mobility Bond Project No. 748

4	Name of Interested Party	City, State, Country (place of business)	Nature of interest (check applicable)	
			Controlling	Intermediary
	See Exhibit A	Houston, TX United States	X	

5 Check only if there is NO Interested Party.

6 AFFIDAVIT I swear, or affirm, under penalty of perjury, that the above disclosure is true and correct.

 Signature of authorized agent of contracting business entity

AFFIX NOTARY STAMP / SEAL ABOVE

Sworn to and subscribed before me, by the said _____, this the _____ day of _____, 20_____, to certify which, witness my hand and seal of office.

 Signature of officer administering oath Printed name of officer administering oath Title of officer administering oath

CERTIFICATE OF INTERESTED PARTIES

FORM 1295

1 of 1

Complete Nos. 1 - 4 and 6 if there are interested parties.
Complete Nos. 1, 2, 3, 5, and 6 if there are no interested parties.

**OFFICE USE ONLY
CERTIFICATION OF FILING**

1 Name of business entity filing form, and the city, state and country of the business entity's place of business.
Seaway Crude Pipeline Company LLC
Houston, TX United States

Certificate Number:
2017-166908

Date Filed:
02/14/2017

2 Name of governmental entity or state agency that is a party to the contract for which the form is being filed.
Fort Bend County, Texas

Date Acknowledged:

3 Provide the identification number used by the governmental entity or state agency to track or identify the contract, and provide a description of the services, goods, or other property to be provided under the contract.
23381-02/14/2017
Utility relocation regarding FM 1093/Westpark, Mobility Bond Project No. 748

4	Name of Interested Party	City, State, Country (place of business)	Nature of interest (check applicable)	
			Controlling	Intermediary
	See Exhibit A	Houston, TX United States	X	

5 Check only if there is NO Interested Party.

6 AFFIDAVIT I swear, or affirm, under penalty of perjury, that the above disclosure is true and correct.

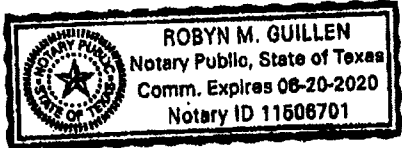

Wendi S. Bickett
Signature of authorized agent of contracting business entity

AFFIX NOTARY STAMP / SEAL ABOVE

Sworn to and subscribed before me, by the said Wendi S. Bickett, this the 14th day of February, 2017, to certify which, witness my hand and seal of office.

[Signature] Signature of officer administering oath
Robyn Guillen Printed name of officer administering oath
Legal Asst Title of officer administering oath

EXHIBIT A

Enterprise Products Partners L.P. is a publicly traded Delaware limited partnership, the common units of which are listed on the New York Stock Exchange ("NYSE") under the ticker symbol EPD.

- Seaway Crude Pipeline Company LLC is 50% owned by Enterprise Seaway L.P. (as a member) and 50% owned by Enbridge Holdings (Seaway) L.L.C. (as a member);
- Enterprise Seaway L.P. is 99.99% owned by Enterprise Crude GP LLC (as its General Partner) and .01% owned by Enterprise Products Operating LLC;
- Enterprise Products Operating LLC is 99.999% owned by Enterprise Products Partners L.P. and 0.001% owned by Enterprise Products OLPGP, Inc. (its Sole Manager);
- Enterprise Products OLPGP, Inc. is 100% owned by Enterprise Products Partners L.P.