



**REVIEW BY FORT BEND COUNTY
COMMISSIONERS COURT**

**Fort Bend County
Engineering Department**
301 Jackson Suite 401
Richmond, Texas 77469
281.633.7500
Permits@fortbendcountytexas.gov

Right of Way Permit
 Commercial Driveway Permit
Permit No: 2017-11418

Applicant: PS Light Wave, Inc

Job Location Site: Harlem Road, Richmond, TX 77406

Bond No. **Date of Bond:** 12/13/2016 **Amount:** \$50,000.00

The above applicant came to make use of certain Fort Bend County property subject to, "The Order Regulating the Laying, Construction, Maintenance, and Repair of Buried Cables, Conduits, and Pole Lines, In, Under, Across or Along Roads, Streets, Highways, and Drainage Ditches in Fort Bend County, Texas, Under the Jurisdiction of the Commissioners Court of Fort Bend County, Texas," as passed by the Commissioners Court of Fort Bend County, Texas, of the Minutes of the Commissioners Court of Fort Bend County, Texas, to the extent that such order is not inconsistent with Chapter 181, Vernon's Texas Statutes and Codes Annotated.

Notes:

1. Evidence of review by the Commissioners Court must be kept on the job site and failure to do so constitutes grounds for job shutdown.
2. Written notices are required:
 - a. 48 hours in advance of construction start up, and
 - b. When construction is completed and ready for final inspection, submit notification to Permit Administrator thru MyGovernmentOnline.org portal.
3. This permit expires one (1) year from date of permit if construction has not commenced.

On this 7th day of February, 2017, Upon Motion of Commissioner Meyers, seconded by Commissioner Patterson, duly put and carried, it is ORDERED, ADJUDGED AND DECREED that said notice of said above purpose is hereby acknowledged by the Commissioners Court of Fort Bend County, Texas, and that said notice be placed on record according to the regulation order thereof.

Signature

Presented to Commissioners Court and approved.

By: Charles O. Ay
for County Engineer

Date Recorded 2-14-17 Comm. Court No. 150

Clerk of Commissioners Court

By: N/A
Drainage District Engineer/Manager

By: Ronda Wilho
Deputy



**PERMIT APPLICATION REVIEW FORM FOR
CABLE, CONDUIT, AND POLE LINE ACTIVITY
IN FORT BEND COUNTY**

**Fort Bend County
Engineering Department**
301 Jackson Suite 401
Richmond, Texas 77469
281.633.7500
Permits@fortbendcountytx.gov

- Right of Way Permit
 Commercial Driveway Permit

Permit No: 2017-11418

The following "Notice of Proposed Cable, Conduit, and/or Pole Line activity in Fort Bend County" and accompanying attachments have been reviewed and the notice conforms to appropriate regulations set by Commissioner's Court of Fort Bend County, Texas.

(1) COMPLETE APPLICATION FORM:

- a. Name of road, street, and/or drainage ditch affected.
 b. Vicinity map showing course of directions
 c. Plans and specifications

(2) BOND:

- County Attorney, approval when applicable.
- Perpetual bond currently posted. Bond No: [REDACTED] Amount: \$50,000.00
- Performance bond submitted. Bond No: _____ Amount: _____
- Cashier's Check Check No: _____ Amount: _____

(3) DRAINAGE DISTRICT APPROVAL (WHEN APPLICABLE):

Drainage District Approval

Date

We have reviewed this project and agree it meets minimum requirements.

Charley O. Ay

Permit Administrator

11/31/17

Date

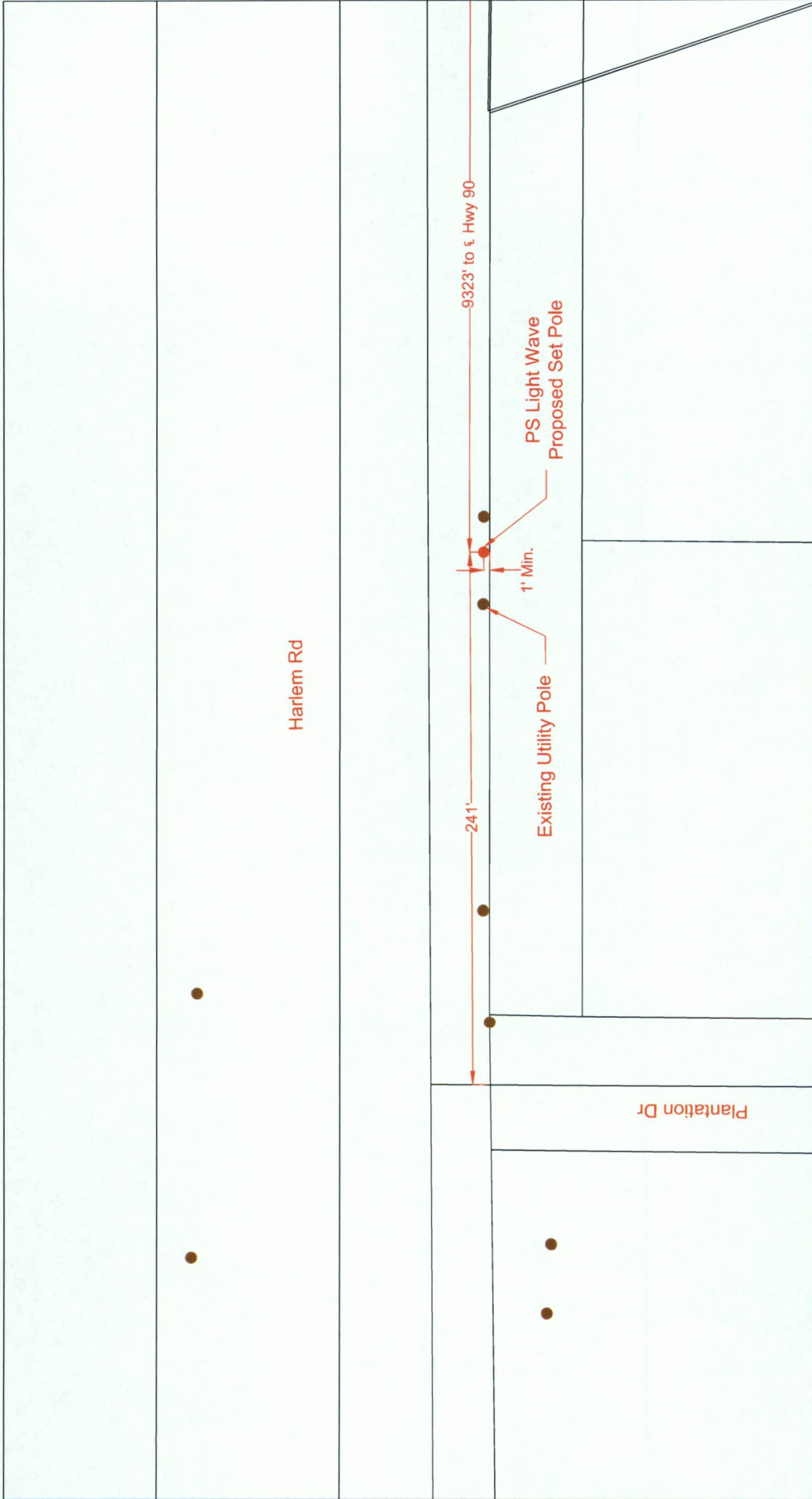

LEGEND 		 SCALE: 1"=40' PAGE: 1 OF: 3		 PROPRIETARY INFORMATION - PROPERTY OF PS LIGHTWAVE REVISION#1: Rev#1 REVISION#2: Rev#2 REVISION#3: Rev#3 REVISION#4: Rev#4		CUSTOMER ID: JOB# 0616-660 CUSTOMER: Notice Of Proposed Utility Installation ADDRESS: Harlem Rd CITY/ZIP: Richmond, TX 77406 COUNTY: Fort Bend # OF FLOORS: DWG#: JOB#: 0616-660 DRAWN BY: P.E. DATE: 01/09/17 APPROVED BY:	
-------------------	--	---------------------------------------	--	--	--	--	--



LEGEND	
UG	3(1") HDPE W/ F.O. CABLE
UG	3(1.25") HDPE W/ F.O. CABLE
UG	1(2") HDPE W/ F.O. CABLE
UG	1(4") HDPE W/ 3(1.25") HDPE
UG	FLEX INNERDUCT
AIR	AERIAL FIBER OPTIC CABLE
CAT5	CAT5 CABLE
---	PROPOSED CONDUIT
---	EXISTING CONDUIT
---	1.25" EMT
---	R/W
---	EDGE-OF-PAVEMENT
---	FENCE
---	RACK LOCATION
●	PSLW SET POLE
●	EXISTING SET POLE
●	EXISTING UTILITY POLE
□	PROPOSED PSLW VAULT (24"x36"x24")
□	EXISTING VAULT
□	PULLBOX
★	MDF LOCATION

SCALE: 1"=40'	DATE: Rev#1 Date
PAGE: 2	DATE: Rev#2 Date
OF: 3	DATE: Rev#3 Date
	DATE: Rev#4 Date

PROPRIETARY INFORMATION - PROPERTY OF PSLIGHTWAVE	
REVISION#1: Rev#1	DATE: Rev#1 Date
REVISION#2: Rev#2	DATE: Rev#2 Date
REVISION#3: Rev#3	DATE: Rev#3 Date
REVISION#4: Rev#4	DATE: Rev#4 Date

CUSTOMER ID:	JOB# 0616-660
CUSTOMER:	Noice Of Proposed Utility Installation
ADDRESS:	Harlem Rd
CITY/ZIP:	Richmond, TX 77406
COUNTY:	Fort Bend
DWG#:	
# OF FLOORS:	
JOB#:	0616-660
KEY MAP:	566 L
DRAWN BY:	P.E.
DATE:	07/09/17
APPROVED BY:	

General Notes:

- 1) Surface to be restored to its original condition in compliance with Fort Bend County Standards.
- 2) Contractors shall provide and install traffic control devices in conformance with part VI of Texas manual on Uniform Traffic Control Devices (TMUTCD-Latest Edition with Revisions) during construction.
- 3) No Lanes shall be blocked 7am-9am and 4pm-6:30pm Monday thru Friday.

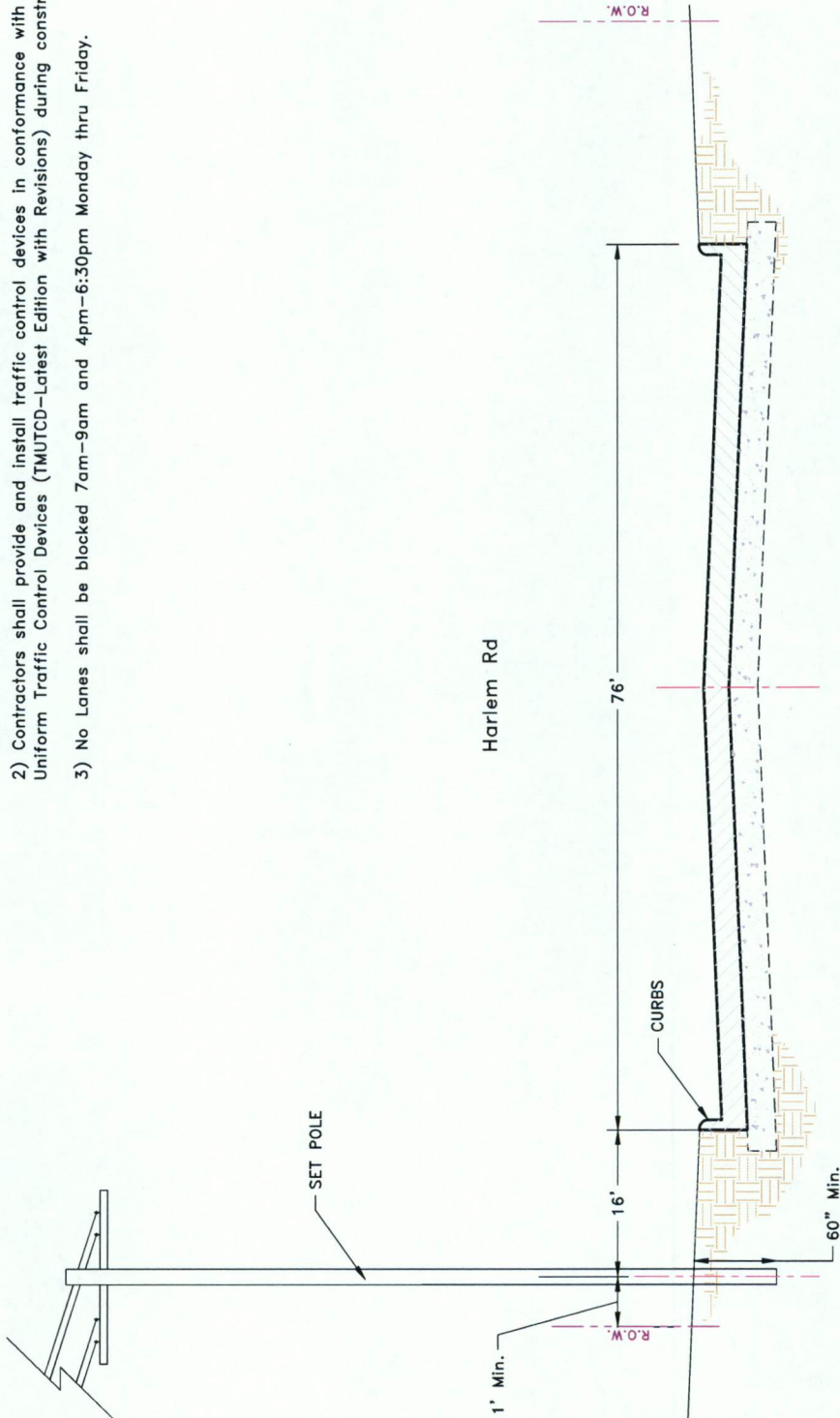

		Job# 0616-660 Description: Notice Of Proposed Utility Installation ADDRESS: Harlem Rd CITY/ZIP: Richmond, TX 77406 COUNTY: Fort Bend # OF FLOORS: DWG#: TENANTS: JOB#: 0616-660 WOF: 89813 DRAWN BY: PE DATE: 01/10/17 APPROVED BY:	
SCALE: N.I.S. PAGE: 3 OF: 3	REVISION#1: Rev#1 DATE: Rev#1 Date REVISION#2: Rev#2 DATE: Rev#2 Date REVISION#3: Rev#3 DATE: Rev#3 Date REVISION#4: Rev#4 DATE: Rev#4 Date	PSLW SET POLE EXISTING SET POLE EXISTING UTILITY POLE PROPOSED PSLW VAULT (24"x36"x24") EXISTING VAULT PULLBOX MDF LOCATION	PROPOSED CONDUIT EXISTING CONDUIT 1.25" EMT RIGHT-OF-WAY EDGE-OF-PAVEMENT FENCE RACK LOCATION
3(1") PVC W/ F.O. CABLE 3(1.25") PVC W/ F.O. CABLE 1(2") PVC W/ F.O. CABLE 1(4") HDPE W/ 3(1.25")PVC FLEX INNERDUCT AERIAL FIBER OPTIC CABLE CAT5 CABLE	LEGEND PROPOSED CONDUIT EXISTING CONDUIT 1.25" EMT RIGHT-OF-WAY EDGE-OF-PAVEMENT FENCE RACK LOCATION	PSLW SET POLE EXISTING SET POLE EXISTING UTILITY POLE PROPOSED PSLW VAULT (24"x36"x24") EXISTING VAULT PULLBOX MDF LOCATION	PROPOSED CONDUIT EXISTING CONDUIT 1.25" EMT RIGHT-OF-WAY EDGE-OF-PAVEMENT FENCE RACK LOCATION