

**REVIEW BY FORT BEND COUNTY  
COMMISSIONERS COURT**

15P  
**Fort Bend County  
Engineering Department**  
301 Jackson Suite 401  
Richmond, Texas 77469  
281.633.7500  
Permits@fortbendcountytexas.gov

Right of Way Permit  
 Commercial Driveway Permit  
Permit No: 2017-11288

**Applicant:** Crown Castle NG Central LLC/Shift Companies

**Job Location Site:** 5431 1/2 Falcon Landing Boulevard, Katy, TX 77494

**Bond No.**                      **Date of Bond:** 5/12/2014 **Amount:** \$50,000.00

The above applicant came to make use of certain Fort Bend County property subject to, "The Order Regulating the Laying, Construction, Maintenance, and Repair of Buried Cables, Conduits, and Pole Lines, In, Under, Across or Along Roads, Streets, Highways, and Drainage Ditches in Fort Bend County, Texas, Under the Jurisdiction of the Commissioners Court of Fort Bend County, Texas," as passed by the Commissioners Court of Fort Bend County, Texas, of the Minutes of the Commissioners Court of Fort Bend County, Texas, to the extent that such order is not inconsistent with Chapter 181, Vernon's Texas Statutes and Codes Annotated.

**Notes:**

1. Evidence of review by the Commissioners Court must be kept on the job site and failure to do so constitutes grounds for job shutdown.
2. Written notices are required:
  - a. 48 hours in advance of construction start up, and
  - b. When construction is completed and ready for final inspection, submit notification to Permit Administrator thru MyGovernmentOnline.org portal.
3. This permit expires one (1) year from date of permit if construction has not commenced.

On this 24th day of January, 2017, Upon Motion of Commissioner Meyers, seconded by Commissioner Patterson, duly put and carried, it is ORDERED, ADJUDGED AND DECREED that said notice of said above purpose is hereby acknowledged by the Commissioners Court of Fort Bend County, Texas, and that said notice be placed on record according to the regulation order thereof.

**Signature**

By: Charles O. Ay  
for County Engineer

By: N/A  
Drainage District Engineer/Manager

Presented to Commissioners Court and approved.

Date Recorded 2-14-17 Comm. Court No. 15P

Clerk of Commissioners Court  
By: Andy Wilho  
Deputy

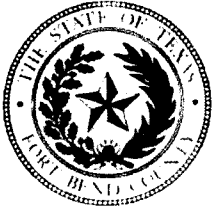

**PERMIT APPLICATION REVIEW FORM FOR  
CABLE, CONDUIT, AND POLE LINE ACTIVITY  
IN FORT BEND COUNTY**

**Fort Bend County  
Engineering Department**  
301 Jackson Suite 401  
Richmond, Texas 77469  
281.633.7500  
Permits@fortbendcountytexas.gov

- Right of Way Permit
- Commercial Driveway Permit

Permit No: 2017-11288

The following "Notice of Proposed Cable, Conduit, and/or Pole Line activity in Fort Bend County" and accompanying attachments have been reviewed and the notice conforms to appropriate regulations set by Commissioner's Court of Fort Bend County, Texas.

**(1) COMPLETE APPLICATION FORM:**

- a. Name of road, street, and/or drainage ditch affected.
- b. Vicinity map showing course of directions
- c. Plans and specifications

**(2) BOND:**

- County Attorney, approval when applicable.
- Perpetual bond currently posted.      Bond No                           Amount: \$50,000.00
- Performance bond submitted.      Bond No:                           Amount:
- Cashier's Check      Check No:                           Amount:

**(3) DRAINAGE DISTRICT APPROVAL (WHEN APPLICABLE):**

\_\_\_\_\_  
Drainage District Approval

\_\_\_\_\_  
Date

**We have reviewed this project and agree it meets minimum requirements.**

*Charles O. Ay*  
\_\_\_\_\_  
Permit Administrator

*1/17/17*  
\_\_\_\_\_  
Date







**SUBJECT POLE:** CCR-43  
**SIS COORDINATES:**  
**LAT:** 29.7184  
**LONG:** -98.82786  
**POLE TYPE:** BLACK RECREATIVE SURMARE POLE  
**UPPER ANTENNA HAO CENTER:** 33 - 0' A.P.G.  
**LOWER ANTENNA HAO CENTER:** 30 - 0' A.P.G.  
**APPROVED:** *[Signature]*  
 Development Coordinator  
**DATE:** 11/16

**CROWN CASTLE**  
 900 E. JOHN CARPENTER Fwy.  
 WACO, TX 76798

RECORD DRAWINGS ISSUE DATE: 10-18-16

**SHIFT**  
 Shift Companies, LLC  
 12010 W. WINDYBROOK DR.  
 SUITE 100  
 WACO, TX 76798

THIS DRAWING IS COPY-RIGHTED AND IS THE PROPERTY OF SHIFT COMPANIES, LLC. IT IS PRODUCED SOLELY FOR USE BY THE INDICATED CLIENT AND IS NOT TO BE REPRODUCED OR TRANSMITTED IN ANY FORM OR BY ANY MEANS, ELECTRONIC OR MECHANICAL, INCLUDING PHOTOCOPYING, RECORDING, OR BY ANY INFORMATION SYSTEMS WITHOUT THE WRITTEN PERMISSION OF THE OWNER.

RELEASE DATE	SUBMITTAL
8/13/15	1ST CITY SUBMITTAL
11/18/15	2ND CITY SUBMITTAL

REVISIONS	NO.	DATE	COMMENTS

**PROJECT NAME:** CINCO RANCH EXPANSION  
**NODE ADDRESS:** NODE #CCR-43  
 FRY RD AND FROSTFIELD LN

**POLE AREA:** CINCO RANCH - HIGOW  
**SHIFT JOB NUMBER:** 150802  
**CHECKED BY:** EM  
**SHEET TITLE:** AERIAL

**SHEET NUMBER:** 4 OF 14  
**SCALE:** 1" = 24' 0" 1" = 10' 11"



SITE PHOTO (EXISTING) N.T.S.

NODE AERIAL PLAN

**CROWN CASTLE**  
 800 E. JOHN CARPENTER Pkwy  
 Irving, TX 75039

**SHIFT**  
 Shift Companies, LLC  
 10000 W. LAKOTA AVE  
 SUITE 100  
 IRVING, TX 75039

RECORD CHANGING ISSUE DATE: 11/14/16

**SHIFT**  
 Shift Companies, LLC  
 10000 W. LAKOTA AVE  
 SUITE 100  
 IRVING, TX 75039

THIS DRAWING IS COPYRIGHTED AND IS THE PROPERTY OF SHIFT COMPANIES, LLC. IT IS PROVIDED SOLELY FOR USE BY THE CLIENT AND NOT TO BE REPRODUCED OR TRANSMITTED IN ANY FORM OR BY ANY MEANS, ELECTRONIC OR MECHANICAL, INCLUDING PHOTOCOPYING, RECORDING, OR BY ANY INFORMATION CONTAINED IN THIS DOCUMENT WITHOUT THE WRITTEN PERMISSION OF THE OWNER.

RELEASE DATE: 10/15/16  
 1ST CITY SUBMITTAL: 10/15/16  
 2ND CITY SUBMITTAL: 10/15/16

REVISIONS  
 NO. DATE COMMENT  
 1 10/15/16 CITY COMMENTS

PROJECT NAME: CINCO RANCH EXPANSION  
 NODE ADDRESS: NODE #:CCR-43  
 FRY RD AND FROSTFIELD LN

PROJECT NUMBER: 1506002  
 SHEET TITLE: SITE PLAN, EQUIPMENT AND ANTENNA PLAN  
 SHEET NUMBER: A1.1  
 PAGE: 5 OF 14

SCALE: 1" = 20'-0"

**SUBJECT POLE: CCR-43**

**GPS COORDINATES:**  
 LAT: 29.71884  
 LONG: -96.82096

**POLE TYPE:** BLACK RECTANGULAR SILUMINE POLE  
**UPPER ANTENNA HAZ CENTER:** 30' - 7" A.F.G.  
**LOWER ANTENNA HAZ CENTER:** 30' - 7" A.F.G.

**SUBJECT POLE IS LOCATED IN:** FORT BEND COUNTY, TX

APPROVED: [Signature]  
 DATE: 11/11/16  
 Development Coordinator

- GENERAL NOTES**
- EXISTING PROPOSED EQUIPMENT REQUIREMENT A NATURAL EARTH COLOR OR AS APPROVED BY CITY.
  - CONTRACTOR TO FIELD LOCATE EXIST UNDERGROUND UTILITIES.
  - EXISTING LANDSCAPE AND DECORATIVE FEATURES TO BE MAINTAINED OR RECREATED AS A RESULT OF CONSTRUCTION SHALL BE DISTURBED OR DESTROYED AS A RESULT OF CONSTRUCTION SHALL BE.
  - CONTRACTOR TO MAKE LOCATE BRIGATION PRIOR TO EXCAVATION.
  - IF SITE PLANS A DEMONSTRATE REPRESENTATION ONLY, VERIFY ALL DIMENSIONS AND PROPERTY LINE INFORMATION WITH LOCAL SURVEYORS.
  - EXISTING UTILITIES SHOWN ON PLANS ARE APPROXIMATE ONLY. VERIFY LOCAL UTILITIES.



**KEYNOTE LEGEND**

KEYNOTE	DESCRIPTION	DETAIL
E01	PROPOSED POWER METER INDICATED TO EQUIPMENT CABINET (FOR THE TET FASE, AND DISCONNECT)	18D1.1
L01	PROPOSED NEW METAL SILUMINE POLE	2D1.1 & 6D1.2
L02	PROPOSED CHOWN CASTLE 2 U.S. POWER (THROUGH APPROXIMATE LOCATION, 1.5)	2D1.1 & 6D1.2
A01	PROPOSED CHOWN CASTLE 2 U.S. CONDUIT	
A02	PROPOSED CHOWN CASTLE 2 U.S. PWR CONDUIT BY	
A03	PROPOSED CHOWN CASTLE 2 U.S. PWR CONDUIT BY	
A04	PROPOSED CHOWN CASTLE 2 U.S. PWR CONDUIT BY	
A05	PROPOSED CHOWN CASTLE 2 U.S. PWR CONDUIT BY	
A06	PROPOSED CHOWN CASTLE 2 U.S. PWR CONDUIT BY	
A07	PROPOSED CHOWN CASTLE 2 U.S. PWR CONDUIT BY	
A08	PROPOSED CHOWN CASTLE 2 U.S. PWR CONDUIT BY	
A09	PROPOSED CHOWN CASTLE 2 U.S. PWR CONDUIT BY	
A10	PROPOSED CHOWN CASTLE 2 U.S. PWR CONDUIT BY	
A11	PROPOSED CHOWN CASTLE 2 U.S. PWR CONDUIT BY	
A12	PROPOSED CHOWN CASTLE 2 U.S. PWR CONDUIT BY	
A13	PROPOSED CHOWN CASTLE 2 U.S. PWR CONDUIT BY	
A14	PROPOSED CHOWN CASTLE 2 U.S. PWR CONDUIT BY	
A15	PROPOSED CHOWN CASTLE 2 U.S. PWR CONDUIT BY	
A16	PROPOSED CHOWN CASTLE 2 U.S. PWR CONDUIT BY	
A17	PROPOSED CHOWN CASTLE 2 U.S. PWR CONDUIT BY	
A18	PROPOSED CHOWN CASTLE 2 U.S. PWR CONDUIT BY	
A19	PROPOSED CHOWN CASTLE 2 U.S. PWR CONDUIT BY	
A20	PROPOSED CHOWN CASTLE 2 U.S. PWR CONDUIT BY	

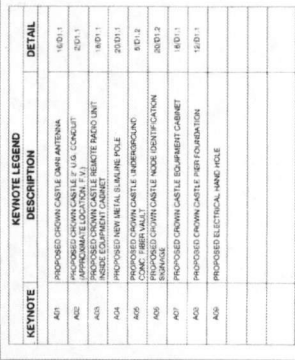

**NOTES:**

- ANY DAMAGE TO EXISTING CURB, DRIVEWAY AND SIDEWALKS SHALL BE REPAIRED BY CONTRACTOR.
- EXISTING VEGETATION DAMAGED IN CONSTRUCTION TO BE REPLACED BY SAME SPECIES.

CALL TWO WORKING DAYS BEFORE YOU DIG  
 UNDERGROUND SERVICE ALERT OF TEXAS  
 1-800-545-6005





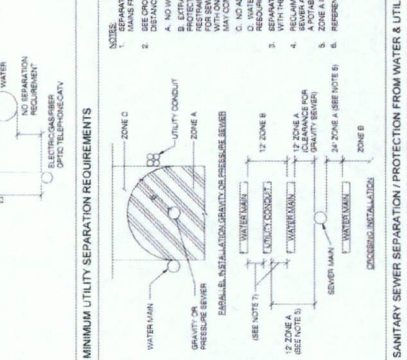
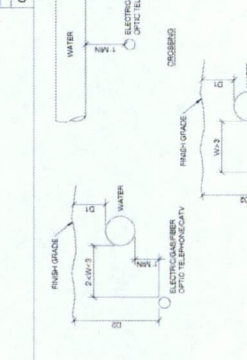
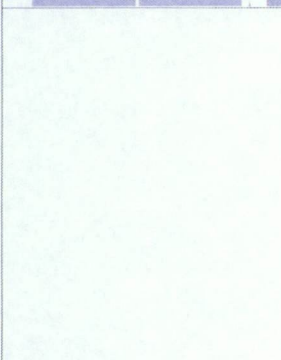
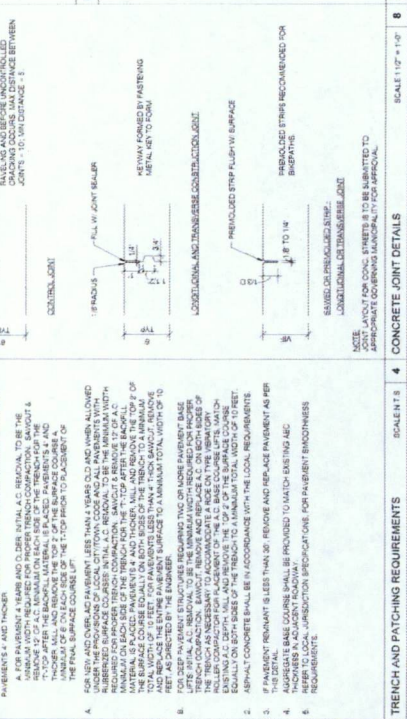
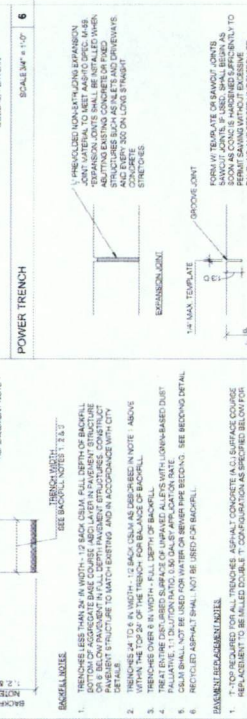
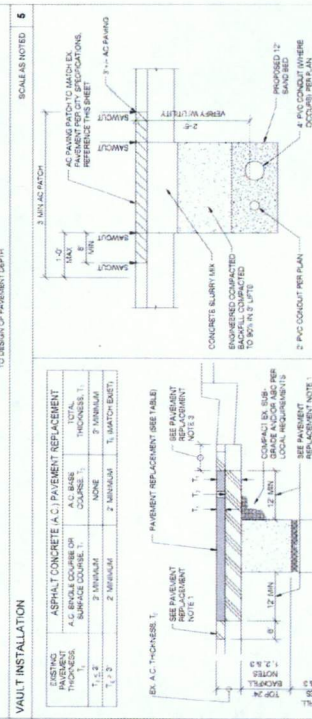
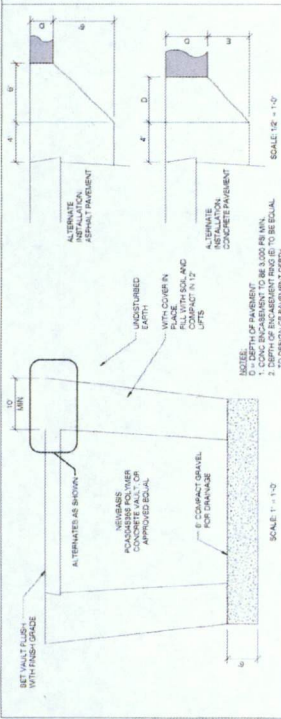



RECORD DRAWING ISSUE DATE: 10/14/15



THIS DRAWING IS CONSIDERED VOID IF NOT PRODUCED IN FULLY PRINTED FORM. IT IS THE PROPERTY OF ONE COMPANIES, LLC AND IS NOT TO BE REPRODUCED OR COPIED IN ANY MANNER WITHOUT THE WRITTEN PERMISSION OF THE OWNER.

RELEASE DATE	SUBMITTAL
10/14/15	1ST CITY SUBMITTAL
10/14/15	2ND CITY SUBMITTAL

REVISIONS NO.	DATE	COMMENT
10/14/15	10/14/15	CITY COMMENTS

PROJECT NAME  
**CINCO RANCH EXPANSION**

NODE ADDRESS  
**NODE #CCR-43**  
**FRY RD AND**  
**FROSTFIELD LN**

HUB AREA  
**CINCO RANCH - HCGW**

SHEET NUMBER  
**150802**

CHECKED BY: CM

DATE: 10/14/15

SHEET TITLE  
**ELECTRICAL PLANS**

SHEET NUMBER  
**E1.0**

PAGE  
**9 OF 14**

PLAN CHECK #

FOOT SCALE: 1" = 20'-0" (1" = 10'-0")

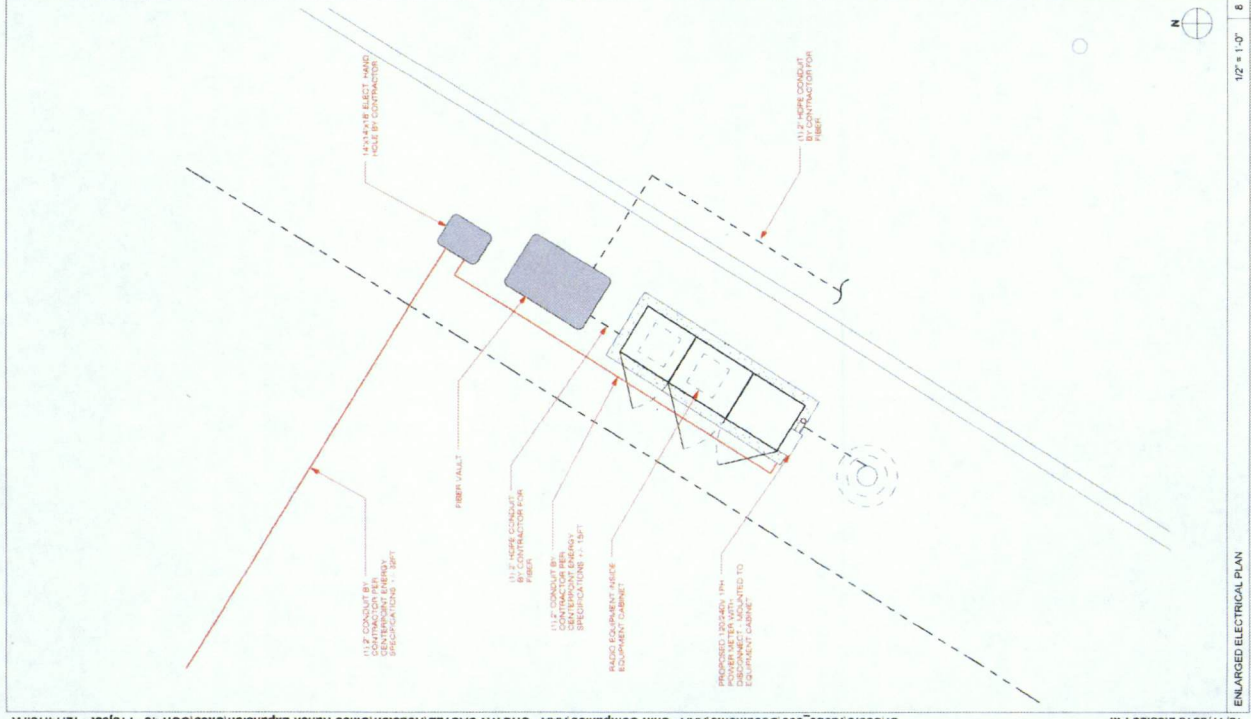
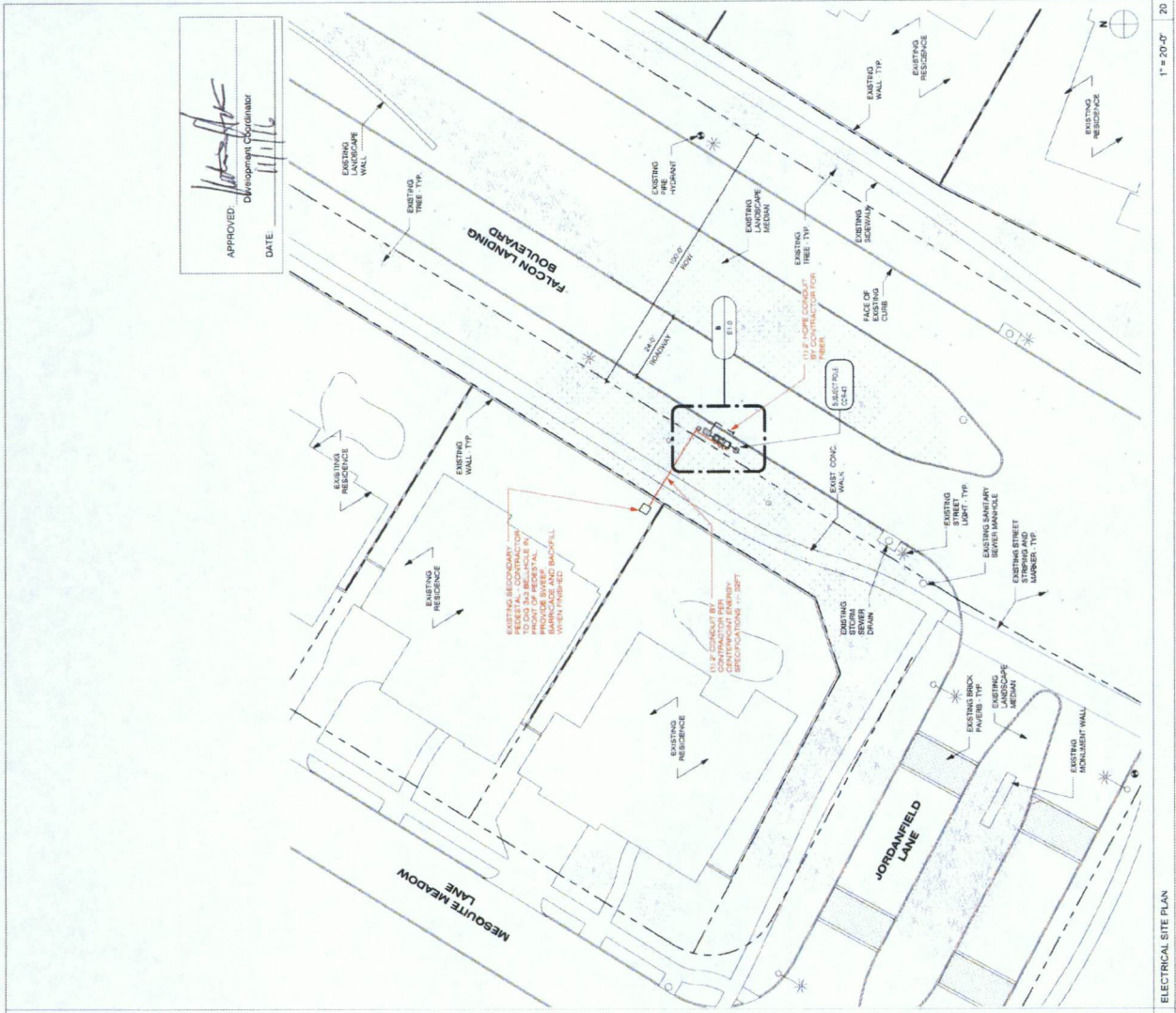



# SHIFT

November 28, 2016

Carmen Escobar, CFM  
Permit Administrator  
Fort Bend County Engineering  
301 Jackson St, Richmond, TX 77469

**RE: Cinco Ranch Traffic Control Plan  
- Shift Project #160614**

Carmen,

Per our conversation on the phone, the work we are doing in the ROW will not require any road closures. There is no TCP required, the contractor will take adequate measure to ensure they are not impeding the public way.

Please let me know if you need anything else.

Thank you,



Chris Myers  
Principal  
SHIFT Companies