



**REVIEW BY FORT BEND COUNTY
COMMISSIONERS COURT**

**Fort Bend County
Engineering Department**
301 Jackson Suite 401
Richmond, Texas 77469
281.633.7500
Permits@fortbendcountytexas.gov

- Right of Way Permit
- Commercial Driveway Permit

Permit No: 2017-11256

Applicant: VCC, LLC

Job Location Site: 8008 W Grand Parkway S, Richmond, TX 77047

Bond No. **Date of Bond:** 1/9/2017 **Amount:** \$5,000.00

The above applicant came to make use of certain Fort Bend County property subject to, "The Order Regulating the Laying, Construction, Maintenance, and Repair of Buried Cables, Conduits, and Pole Lines, In, Under, Across or Along Roads, Streets, Highways, and Drainage Ditches in Fort Bend County, Texas, Under the Jurisdiction of the Commissioners Court of Fort Bend County, Texas," as passed by the Commissioners Court of Fort Bend County, Texas, of the Minutes of the Commissioners Court of Fort Bend County, Texas, to the extent that such order is not inconsistent with Chapter 181, Vernon's Texas Statutes and Codes Annotated.

Notes:

1. Evidence of review by the Commissioners Court must be kept on the job site and failure to do so constitutes grounds for job shutdown.
2. Written notices are required:
 - a. 48 hours in advance of construction start up, and
 - b. When construction is completed and ready for final inspection, submit notification to Permit Administrator thru MyGovernmentOnline.org portal.
3. This permit expires one (1) year from date of permit if construction has not commenced.

On this 7th day of February, 2017, Upon Motion of Commissioner Meyers, seconded by Commissioner Patterson, duly put and carried, it is ORDERED, ADJUDGED AND DECREED that said notice of said above purpose is hereby acknowledged by the Commissioners Court of Fort Bend County, Texas, and that said notice be placed on record according to the regulation order thereof.

Signature

By: Charles O. Ay
for County Engineer

By: N/A
Drainage District Engineer/Manager

Presented to Commissioners Court and approved.

Date Recorded 2-14-17 Comm. Court No. 15CC

Clerk of Commissioners Court
By: Ronda Wilho
Deputy



**PERMIT APPLICATION REVIEW FORM FOR
CABLE, CONDUIT, AND POLE LINE ACTIVITY
IN FORT BEND COUNTY**

**Fort Bend County
Engineering Department**
301 Jackson Suite 401
Richmond, Texas 77469
281.633.7500
Permits@fortbendcountytexas.gov

- Right of Way Permit
 Commercial Driveway Permit

Permit No: 2017-11256

The following "Notice of Proposed Cable, Conduit, and/or Pole Line activity in Fort Bend County" and accompanying attachments have been reviewed and the notice conforms to appropriate regulations set by Commissioner's Court of Fort Bend County, Texas.

(1) COMPLETE APPLICATION FORM:

- a. Name of road, street, and/or drainage ditch affected.
 b. Vicinity map showing course of directions
 c. Plans and specifications

(2) BOND:

- County Attorney, approval when applicable.
- Perpetual bond currently posted. Bond No: _____ Amount: _____
- Performance bond submitted. Bond No: [REDACTED] Amount: \$5,000.00
- Cashier's Check Check No: _____ Amount: _____

(3) DRAINAGE DISTRICT APPROVAL (WHEN APPLICABLE):

Drainage District Approval

Date

We have reviewed this project and agree it meets minimum requirements.

Charles O. Ay

Permit Administrator

1/31/17

Date

44



**PERFORMANCE BOND COVERING ALL CABLE, CONDUIT AND/OR POLE LINE
ACTIVITY IN, UNDER, ACROSS OR ALONG FORT BEND COUNTY ROAD, COMMERCIAL
DRIVEWAY AND MEDIAN OPENINGS OR MODIFICATIONS**
AUTHORIZED

BOND NO. [REDACTED]
THE STATE OF TEXAS §

COUNTY OF FORT BEND § KNOW ALL MEN BY THESE PRESENTS:

THAT WE, VCC, LLC whose address is 600 East Las Colinas Blvd, Suite 1225, Irving, TX 75039 Texas, hereinafter called the Principal, And Travelers Casualty and Surety Company of America, a Corporation existing under and by virtue of the laws of the state of Connecticut and authorized to do an indemnifying business in the state of Texas, and whose principal office is located at One Tower Square, Hartford, CT 06183, whose officer residing in the State of Texas, authorized to accept service in all suits and actions brought whining said state is CT Corporation System and Whose address is 350 N St Paul St, Suite 2900, Dallas, TX 75201, hereinafter called the Surety, and held and firmly bound unto, Robert e. Hebert, County Judge of Fort Bend County, Texas, or his successors in office, in the full sum of FIVE THOUSAND AND NO/100 Dollars (\$ 5,000.00) current, lawful money of the United States of America, to be paid to said Robert E. Hebert, County Judge of Fort Bend County, Texas, or his successors in office, to which payment well and truly to be made and done, we, the undersigned, bind ourselves and each of us, our heirs, executors, administrators, successors, assigns, and legal representatives, jointly and severally, by these presents.

THE CONDITION OF THIS BOND IS SUCH THAT, WHEREAS, the above bounden principal contemplates laying, constructing, maintaining and/or repairing one or more cables, conduits, and/or pole lines in, under, across and/or along roads, streets and highways, commercial driveway and median openings or modifications in the County of Fort Bend, and the State of Texas, under the jurisdiction of the Commissioners' Court of Fort Bend County, Texas, pursuant to the Commissioners' Court order adopted on the 1st day of December, A.D. 1980, recorded in Volume 13, of the Commissioners' Court Minutes of Fort Bend County, Texas, regulating same, which Commissioners' Court order is hereby referred to and made a part hereof for all purposes as though fully set out herein;

AND WHEREAS, the principal desires to provide Fort Bend County with a performance bond covering all such cable, conduit and/or pole line activity, commercial driveway and median openings or modifications;

NOW, THEREFORE, if the above bounden principal shall faithfully perform all its cable, conduit and/or pole line activity (including, but not limited to the laying, construction, maintenance and/or repair of cables, conduits and/or pole lines) in, under, across and/or along roads, streets and highways, commercial driveway and median openings or modifications in the County of Fort Bend and State of Texas, under the jurisdiction of the Commissioners Court of Fort Bend County, Texas, pursuant to and in accordance with minimum requirements and conditions of the above mentioned Commissioners' Court order set forth and specified to be by said principal done and performed, at the time and in the manner therein specified, and shall pay over and make good and reimburse Fort Bend County, all loss and damages which Fort Bend County may sustain by reason of any failure or default on the part of said principal, then this obligation shall be null and void, otherwise to remain in full force and effect.

This bond is payable at the County Courthouse in the County of Fort Bend and State of Texas.

It is understood that at any time Fort Bend County deems itself insecure under this bond, it may require further and/or additional bonds of the principal.

EXECUTED this 9th day of January, 2017.

VCC, LLC
PRINCIPAL

BY Bradley N. Davis, CFO/Sec/Treas

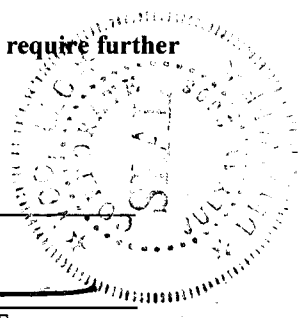

Travelers Casualty and Surety Company of America
SURETY

BY Kevin M. Neidert, Attorney-In-Fact

CCM 2-7-17 #15CC
Fort Bend County Clerk
Return Admin Serv Coord RAC

IMPORTANT NOTICE

To obtain information or make a complaint:

You may call Travelers Casualty and Surety Company of America and its affiliates' toll-free telephone number for information or to make a complaint at:

1-800-328-2189

You may contact the Texas Department of Insurance to obtain information on companies, coverages, rights or complaints at:

1-800-252-3439

You may write the Texas Department of Insurance:

P. O. Box 149104
Austin, TX 78714-9104
Fax: (512) 475-1771
Web: <http://www.tdi.state.tx.us>
E-mail: ConsumerProtection@tdi.state.tx.us

PREMIUM OR CLAIM DISPUTES:

Should you have a dispute concerning your premium or about a claim you should contact your Agent or Travelers first. If the dispute is not resolved, you may contact the Texas Department of Insurance.

ATTACH THIS NOTICE TO YOUR BOND:

This notice is for information only and does not become a part or condition of the attached document and is given to comply with Texas legal and regulatory requirements.



POWER OF ATTORNEY

Farmington Casualty Company
Fidelity and Guaranty Insurance Company
Fidelity and Guaranty Insurance Underwriters, Inc.
St. Paul Fire and Marine Insurance Company
St. Paul Guardian Insurance Company

St. Paul Mercury Insurance Company
Travelers Casualty and Surety Company
Travelers Casualty and Surety Company of America
United States Fidelity and Guaranty Company

Attorney-In Fact No. 226756

Certificate No. 006902878

KNOW ALL MEN BY THESE PRESENTS: That Farmington Casualty Company, St. Paul Fire and Marine Insurance Company, St. Paul Guardian Insurance Company, St. Paul Mercury Insurance Company, Travelers Casualty and Surety Company, Travelers Casualty and Surety Company of America, and United States Fidelity and Guaranty Company are corporations duly organized under the laws of the State of Connecticut, that Fidelity and Guaranty Insurance Company is a corporation duly organized under the laws of the State of Iowa, and that Fidelity and Guaranty Insurance Underwriters, Inc., is a corporation duly organized under the laws of the State of Wisconsin (herein collectively called the "Companies"). and that the Companies do hereby make, constitute and appoint

Betsy J. Holmes, Brian K. Hughes, Karen A. Maynard, Kevin M. Neidert, Michael L. Angel, Michael S. Brickner, P.D. Yates III, P.D. Yates Jr., Daniel Yates, Alan R. Yates, Gary Spuller, Marie M. Hartley, Robert N. Reynolds, Dana D. Rutledge, Jeffery J. Blanton, Michael B. Dawson, and W. Barry Dawson

of the City of Atlanta, State of Georgia, their true and lawful Attorney(s)-in-Fact, each in their separate capacity if more than one is named above, to sign, execute, seal and acknowledge any and all bonds, recognizances, conditional undertakings and other writings obligatory in the nature thereof on behalf of the Companies in their business of guaranteeing the fidelity of persons, guaranteeing the performance of contracts and executing or guaranteeing bonds and undertakings required or permitted in any actions or proceedings allowed by law.

IN WITNESS WHEREOF, the Companies have caused this instrument to be signed and their corporate seals to be hereto affixed, this 21st day of July, 2016.

Farmington Casualty Company
Fidelity and Guaranty Insurance Company
Fidelity and Guaranty Insurance Underwriters, Inc.
St. Paul Fire and Marine Insurance Company
St. Paul Guardian Insurance Company

St. Paul Mercury Insurance Company
Travelers Casualty and Surety Company
Travelers Casualty and Surety Company of America
United States Fidelity and Guaranty Company

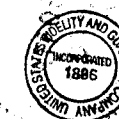

State of Connecticut
City of Hartford ss.

By: [Signature]
Robert L. Raney, Senior Vice President

On this the 21st day of July, 2016, before me personally appeared Robert L. Raney, who acknowledged himself to be the Senior Vice President of Farmington Casualty Company, Fidelity and Guaranty Insurance Company, Fidelity and Guaranty Insurance Underwriters, Inc., St. Paul Fire and Marine Insurance Company, St. Paul Guardian Insurance Company, St. Paul Mercury Insurance Company, Travelers Casualty and Surety Company, Travelers Casualty and Surety Company of America, and United States Fidelity and Guaranty Company, and that he, as such, being authorized so to do, executed the foregoing instrument for the purposes therein contained by signing on behalf of the corporations by himself as a duly authorized officer.

In Witness Whereof, I hereunto set my hand and official seal. My Commission expires the 30th day of June, 2021.



[Signature]
Marie C. Tetreault, Notary Public

This Power of Attorney is granted under and by the authority of the following resolutions adopted by the Boards of Directors of Farmington Casualty Company, Fidelity and Guaranty Insurance Company, Fidelity and Guaranty Insurance Underwriters, Inc., St. Paul Fire and Marine Insurance Company, St. Paul Guardian Insurance Company, St. Paul Mercury Insurance Company, Travelers Casualty and Surety Company, Travelers Casualty and Surety Company of America, and United States Fidelity and Guaranty Company, which resolutions are now in full force and effect, reading as follows:

RESOLVED, that the Chairman, the President, any Vice Chairman, any Executive Vice President, any Senior Vice President, any Vice President, any Second Vice President, the Treasurer, any Assistant Treasurer, the Corporate Secretary or any Assistant Secretary may appoint Attorneys-in-Fact and Agents to act for and on behalf of the Company and may give such appointee such authority as his or her certificate of authority may prescribe to sign with the Company's name and seal with the Company's seal bonds, recognizances, contracts of indemnity, and other writings obligatory in the nature of a bond, recognizance, or conditional undertaking, and any of said officers or the Board of Directors at any time may remove any such appointee and revoke the power given him or her; and it is

FURTHER RESOLVED, that the Chairman, the President, any Vice Chairman, any Executive Vice President, any Senior Vice President or any Vice President may delegate all or any part of the foregoing authority to one or more officers or employees of this Company, provided that each such delegation is in writing and a copy thereof is filed in the office of the Secretary; and it is

FURTHER RESOLVED, that any bond, recognizance, contract of indemnity, or writing obligatory in the nature of a bond, recognizance, or conditional undertaking shall be valid and binding upon the Company when (a) signed by the President, any Vice Chairman, any Executive Vice President, any Senior Vice President or any Vice President, any Second Vice President, the Treasurer, any Assistant Treasurer, the Corporate Secretary or any Assistant Secretary and duly attested and sealed with the Company's seal by a Secretary or Assistant Secretary; or (b) duly executed (under seal, if required) by one or more Attorneys-in-Fact and Agents pursuant to the power prescribed in his or her certificate or their certificates of authority or by one or more Company officers pursuant to a written delegation of authority; and it is

FURTHER RESOLVED, that the signature of each of the following officers: President, any Executive Vice President, any Senior Vice President, any Vice President, any Assistant Vice President, any Secretary, any Assistant Secretary, and the seal of the Company may be affixed by facsimile to any Power of Attorney or to any certificate relating thereto appointing Resident Vice Presidents, Resident Assistant Secretaries or Attorneys-in-Fact for purposes only of executing and attesting bonds and undertakings and other writings obligatory in the nature thereof, and any such Power of Attorney or certificate bearing such facsimile signature or facsimile seal shall be valid and binding upon the Company and any such power so executed and certified by such facsimile signature and facsimile seal shall be valid and binding on the Company in the future with respect to any bond or understanding to which it is attached.

I, Kevin E. Hughes, the undersigned, Assistant Secretary, of Farmington Casualty Company, Fidelity and Guaranty Insurance Company, Fidelity and Guaranty Insurance Underwriters, Inc., St. Paul Fire and Marine Insurance Company, St. Paul Guardian Insurance Company, St. Paul Mercury Insurance Company, Travelers Casualty and Surety Company, Travelers Casualty and Surety Company of America, and United States Fidelity and Guaranty Company do hereby certify that the above and foregoing is a true and correct copy of the Power of Attorney executed by said Companies, which is in full force and effect and has not been revoked.

IN TESTIMONY WHEREOF, I have hereunto set my hand and affixed the seals of said Companies this 9th day of January, 20 17.

Kevin E. Hughes, Assistant Secretary



To verify the authenticity of this Power of Attorney, call 1-800-421-3880 or contact us at www.travelersbond.com. Please refer to the Attorney-In-Fact number, the above-named individuals and the details of the bond to which the power is attached.

FILED AND RECORDED
OFFICIAL PUBLIC RECORDS

Laura Richard



Laura Richard, County Clerk
Fort Bend County, Texas

February 09, 2017 01:25:17 PM

FEE: \$0.00 RMM
BOND

2017014686

CIVIL SITE DEVELOPMENT PLANS

FOR

PUBLIC STORAGE

GRAND PARKWAY

8008 W GRAND PARKWAY S.
RICHMOND, TX 77407

KEY MAP: 528W
ZIP CODE: 77407

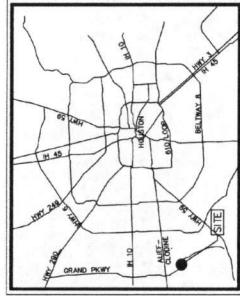

KEY MAP
N.T.S.



LOCATION MAP
N.T.S.

SHEET NO.	DESCRIPTION
00.0	CIVIL ENGINEERING (KIMLEY-HORN AND ASSOCIATES, INC.)
00.0	COVER SHEET
00.1	ALTA SURVEY
00.2	PLAT
00.3	GENERAL NOTES
00.4	EROSION CONTROL PLAN
00.5	EROSION CONTROL DETAILS
00.6	GRASSING PLAN
00.7	DRAINAGE AREA MAP
00.8	STORM SEWER PLAN
00.9	UTILITY PLAN
01.0	CONSTRUCTION DETAILS (1 OF 3)
01.1	CONSTRUCTION DETAILS (2 OF 3)
01.2	CONSTRUCTION DETAILS (3 OF 3)



10/12/16
Kimley-Horn & Associates, Inc.



Know what's below.
Call before you dig.

CAUTION!
EXISTING UNDERGROUND UTILITIES IN THE AREA SHALL BE THE RESPONSIBILITY OF THE CONTRACTOR. THE CONTRACTOR IS RESPONSIBLE FOR DETERMINING THE HORIZONTAL AND VERTICAL LOCATION OF ALL EXISTING UTILITIES. THE CONTRACTOR SHALL BE RESPONSIBLE FOR ANY REPAIRS TO EXISTING UTILITIES DUE TO DAMAGE INCURRED DURING CONSTRUCTION. CONTRACTOR SHALL BE RESPONSIBLE FOR ANY DISCREPANCIES ON THE PLANS.

THE LOCATION OF EXISTING UNDERGROUND UTILITIES ARE SHOWN ON THESE PLANS. THE CONTRACTOR SHALL DETERMINE THE EXACT LOCATION OF ALL EXISTING UTILITIES. THE CONTRACTOR SHALL BE FULLY RESPONSIBLE FOR ANY AND ALL DAMAGES TO EXISTING UTILITIES. THE CONTRACTOR SHALL MAINTAIN AND PRESERVE ANY AND ALL UNDERGROUND UTILITIES.

FLOODPLAIN INFORMATION

THIS PROPERTY LIES IN ZONE "X" UNSHADED AREAS DETERMINED TO BE OUTSIDE THE 0.2% ANNUAL FLOODPLAIN ACCORDING TO THE MOST RECENT OFFICIAL FEDERAL FLOOD INSURANCE RATE MAP, COMMUNITY PANEL NUMBER 48103AH01A, DATED APRIL 2, 2014.

BENCHMARK NOTES

BENCHMARK: ELEVATIONS SHOWN HEREON ARE BASED ON THE FORT BEND COUNTY BENCHMARK AT THE INTERSECTION OF GRAND PARKWAY AND COLLEGE DRIVE. BENCHMARK ELEVATION = 86.47 FEET (NAVD 1988, 2007 ADJ).

TRM-A

A 6" RIB CUT #8 CONCRETE OR 1" C" JACKET LOCATED ON THE SOUTH CURB LINE OF 8008 W GRAND PARKWAY APPROXIMATELY 175 FEET WEST OF THE INTERSECTION OF THE SUBJECT TRACT. ELEVATION = 86.47 FEET (NAVD 1988, 2007 ADJ)

STATE OF TEXAS
COUNTY OF FORT BEND
DATE: 10/12/16
APPROVED: [Signature]
DATE: 10/12/16

C0.0

DEVELOPER:
PUBLIC STORAGE
701 WESTERN AVENUE
HOUSTON, TEXAS 77002
CONTACT: DAN MATULLA
(713) 891-2669

SURVEYOR:
KIMLEY-HORN & ASSOCIATES, INC.
3000 WILCREST DR., SUITE 210
HOUSTON, TEXAS 77042
(713) 883-0327

PREPARED BY:
Kimley-Horn
12012 Wilshire Blvd., Suite 500
Houston, Texas 77042
Tel. No. (281) 597-3000
Fax No. (281) 597-3022
CONTACT: BARBETH CANNON, E.I.T.

PUBLIC STORAGE
GRAND PARKWAY

EROSION CONTROL PLAN

CHKD BY: ZAR
DESIGNED BY: KMC
SCALE: AS SHOWN
DATE: SEPT 2016
PROJECT NO: 06319605
PROJECT NAME: KHA PROJECT



Kimley-Horn
2018 KIMLEY-HORN AND ASSOCIATES, INC.
12017 WICKHURST LANE, SUITE 500, HOUSTON, TX 77079
PHONE: 281-597-9300
FAX: 281-597-9300
WWW.KIMLEY-HORN.COM
REG. NO. 12453
EXPIRES: 08/11/2011

NO.	REVISIONS	DATE	BY
1	APPROVAL NO. 1	09/28/16	KMC
2	APPROVAL NO. 2	09/28/16	KMC

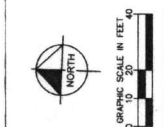

LEGEND	
	EXISTING GROUND ELEVATION
	EXISTING CONCRETE ELEVATION
EROSION CONTROL DETAILS	
	18" FENCE INLET PROTECTION
	FILTER SACK INLET PROTECTION
	CURB INLET PROTECTION
	36" FENCE
	CONSTRUCTION ENTRANCE
	CONCRETE WALKOUT
	PROJECTED FLOW DIRECTION
	FILTER DAM

EROSION CONTROL SCHEDULING AND REQUIREMENTS

CONSTRUCTION ENTRANCE MAT AND PROTECTION SHALL BE INSTALLED PRIOR TO THE INITIATION OF ROUGH GRADING. AS NEEDED, MEASURES SHALL BE TAKEN TO MAINTAIN EXISTING VEGETATION AND TO BE MAINTAINED AS NECESSARY DURING CONSTRUCTION. PROTECTION SHALL BE INSTALLED AS NECESSARY TO PROTECT EXISTING CONSTRUCTION SYSTEMS.

I. ROUGH GRADING
ALL PRIOR EROSION CONTROL MEASURES SHALL BE MAINTAINED AS NECESSARY DURING PAVING AND THROUGHOUT THE TEMPORARY STABILIZATION PERIOD. REFERENCE LANDSCAPE PLANS FOR ALL TEMPORARY STABILIZATION MEASURES TO BE REMOVED AT THE TIME OF FINAL STABILIZATION. FINAL STABILIZATION HAS BEEN ACHIEVED.

II. UTILITY INSTALLATION
ALL PRIOR EROSION CONTROL MEASURES SHALL BE MAINTAINED AS NECESSARY DURING PAVING AND THROUGHOUT THE TEMPORARY STABILIZATION PERIOD. REFERENCE LANDSCAPE PLANS FOR ALL TEMPORARY STABILIZATION MEASURES TO BE REMOVED AT THE TIME OF FINAL STABILIZATION. FINAL STABILIZATION HAS BEEN ACHIEVED.

III. PAVING
ALL PRIOR EROSION CONTROL MEASURES SHALL BE MAINTAINED AS NECESSARY DURING PAVING AND THROUGHOUT THE TEMPORARY STABILIZATION PERIOD. REFERENCE LANDSCAPE PLANS FOR ALL TEMPORARY STABILIZATION MEASURES TO BE REMOVED AT THE TIME OF FINAL STABILIZATION. FINAL STABILIZATION HAS BEEN ACHIEVED.

IV. FINAL GRADING
ALL PRIOR EROSION CONTROL MEASURES SHALL BE MAINTAINED AS NECESSARY DURING PAVING AND THROUGHOUT THE TEMPORARY STABILIZATION PERIOD. REFERENCE LANDSCAPE PLANS FOR ALL TEMPORARY STABILIZATION MEASURES TO BE REMOVED AT THE TIME OF FINAL STABILIZATION. FINAL STABILIZATION HAS BEEN ACHIEVED.

CONTRACTOR SHALL PROVIDE COPIES OF THE CONSTRUCTION SITE EROSION CONTROL PLAN TO THE LOCAL AND STATE AUTHORITIES PRIOR TO COMMENCEMENT OF CONSTRUCTION. UTILITIES AT THE SITE SHALL BE IDENTIFIED AND PROTECTED PRIOR TO CONSTRUCTION. CONSTRUCTION SHALL BE IN ACCORDANCE WITH STORM WATER POLLUTION PREVENTION PLAN (SWPPP).

REFERENCE BENCHMARK
ELEVATION REFERENCE MARK: 20160608 AT HARBOR ROAD AND COORNE STREET, NEAR PAGE 508. ELEVATION: 98.47 (NAD 83, 2011 ADJUSTMENT)

TEMPORARY BENCHMARKS
BENCHM. IN CONCRETE ON A 4" INLET LOCATED ON THE SOUTH CURBLINE OF STATE HIGHWAY 98. ELEVATION: 98.47 (NAD 83, 2011 ADJUSTMENT)

CAUTION!
EXISTING UNDERGROUND UTILITIES IN THE AREA CONTRACTOR IS RESPONSIBLE FOR DETERMINING THE HORIZONTAL AND VERTICAL LOCATION OF UTILITIES PRIOR TO CONSTRUCTION. ANY REPAIRS TO EXISTING UTILITIES DUE TO DAMAGE INCURRED DURING CONSTRUCTION, CONTRACTOR SHALL BE RESPONSIBLE FOR ANY DISCREPANCIES ON THE PLANS.

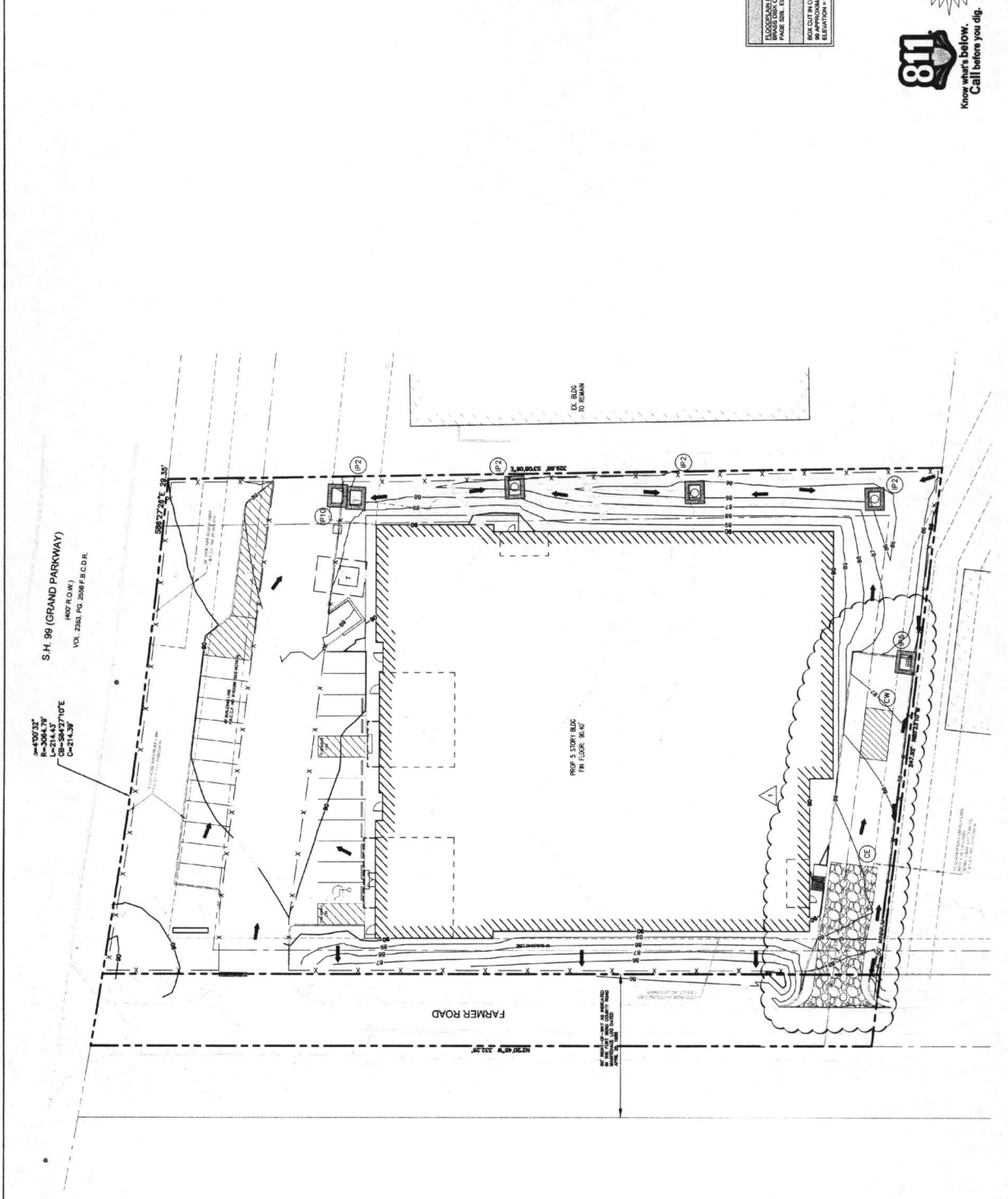

S.H. 98 (GRAND PARKWAY)
4607 P.O.W.
VOL. 2361 PG. 2508 F.B.C.D.R.

4+00.32'
R=304.79'
CB=284.2710'E
C=214.30'

FARMER ROAD

PROP. 5 STORY BLDG.
FIN. FLOOR: 98.40'

APPROVED: *Messinger*
DATE: 10/16/16

NO.	REVISIONS	DATE	BY
1	ADDITIONAL NO. 2	09/28/16	KWK
2		09/16/16	KWK

Kimley»Horn
 12012 WICKHURST LANE, SUITE 500, HOUSTON, TX 77029
 281-416-1300
 WWW.KIMLEY-HORN.COM
 TITLE: FIRM: DISTRICT: F: 928



CHECKED BY	ZAR
DRAWN BY	ZAR
DESIGNED BY	KWK
SCALE	AS SHOWN
SHEET	2016
DATE	09/28/16
K-H PROJECT	066319605

DIMENSION CONTROL AND PAVING PLAN

PUBLIC STORAGE GRAND PARKWAY

SHEET NUMBER
C3.0

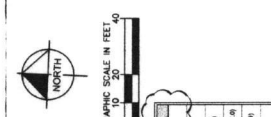

ITEM NO.	DESCRIPTION
1	PROPOSED LIGHT DUTY CONCRETE PAVEMENT (SEE C7.2)
2	PROPOSED MEDIUM DUTY CONCRETE PAVEMENT (SEE C7.3)
3	PROPOSED HEAVY DUTY CONCRETE PAVEMENT (SEE C7.4)
4	PROPOSED CONCRETE SIDEWALK
5	EXISTING PAVEMENT TO REMAIN
6	CURB TRANSITION
7	PARKING COUNT
8	PROPOSED SANITARY

- GENERAL NOTES**
1. DIMENSIONS ARE TO FACE OF CURB UNLESS OTHERWISE NOTED.
 2. ALL FINISHES UNLESS OTHERWISE NOTED.
 3. REFER TO ARCHITECTURAL PLANS FOR EXISTING UTILITIES AND ELECTRICAL PLANS PRIOR TO PAVING.
 4. REFER TO ARCHITECTURAL PLANS FOR EXISTING BUILDING DIMENSIONS.
 5. ALL DIMENSIONS ARE TO FACE UNLESS OTHERWISE SPECIFIED.
 6. REFER TO ARCHITECTURAL PLANS FOR EXISTING SANITARY AND ELECTRICAL PLANS PRIOR TO CONSTRUCTION.
 7. ALL DIMENSIONS ARE TO FACE UNLESS OTHERWISE SPECIFIED.
 8. REFER TO ARCHITECTURAL PLANS FOR EXISTING SANITARY AND ELECTRICAL PLANS PRIOR TO CONSTRUCTION.
 9. REFER TO ARCHITECTURAL PLANS FOR EXISTING SANITARY AND ELECTRICAL PLANS PRIOR TO CONSTRUCTION.
 10. REFER TO ARCHITECTURAL PLANS FOR EXISTING SANITARY AND ELECTRICAL PLANS PRIOR TO CONSTRUCTION.
 11. REFER TO ARCHITECTURAL PLANS FOR EXISTING SANITARY AND ELECTRICAL PLANS PRIOR TO CONSTRUCTION.
 12. REFER TO ARCHITECTURAL PLANS FOR EXISTING SANITARY AND ELECTRICAL PLANS PRIOR TO CONSTRUCTION.
 13. REFER TO ARCHITECTURAL PLANS FOR EXISTING SANITARY AND ELECTRICAL PLANS PRIOR TO CONSTRUCTION.
 14. REFER TO ARCHITECTURAL PLANS FOR EXISTING SANITARY AND ELECTRICAL PLANS PRIOR TO CONSTRUCTION.
 15. REFER TO ARCHITECTURAL PLANS FOR EXISTING SANITARY AND ELECTRICAL PLANS PRIOR TO CONSTRUCTION.

PROPOSED PAVING	ACCESSIBLE	STANDARD SPACE	TOTAL
1	1	21	22

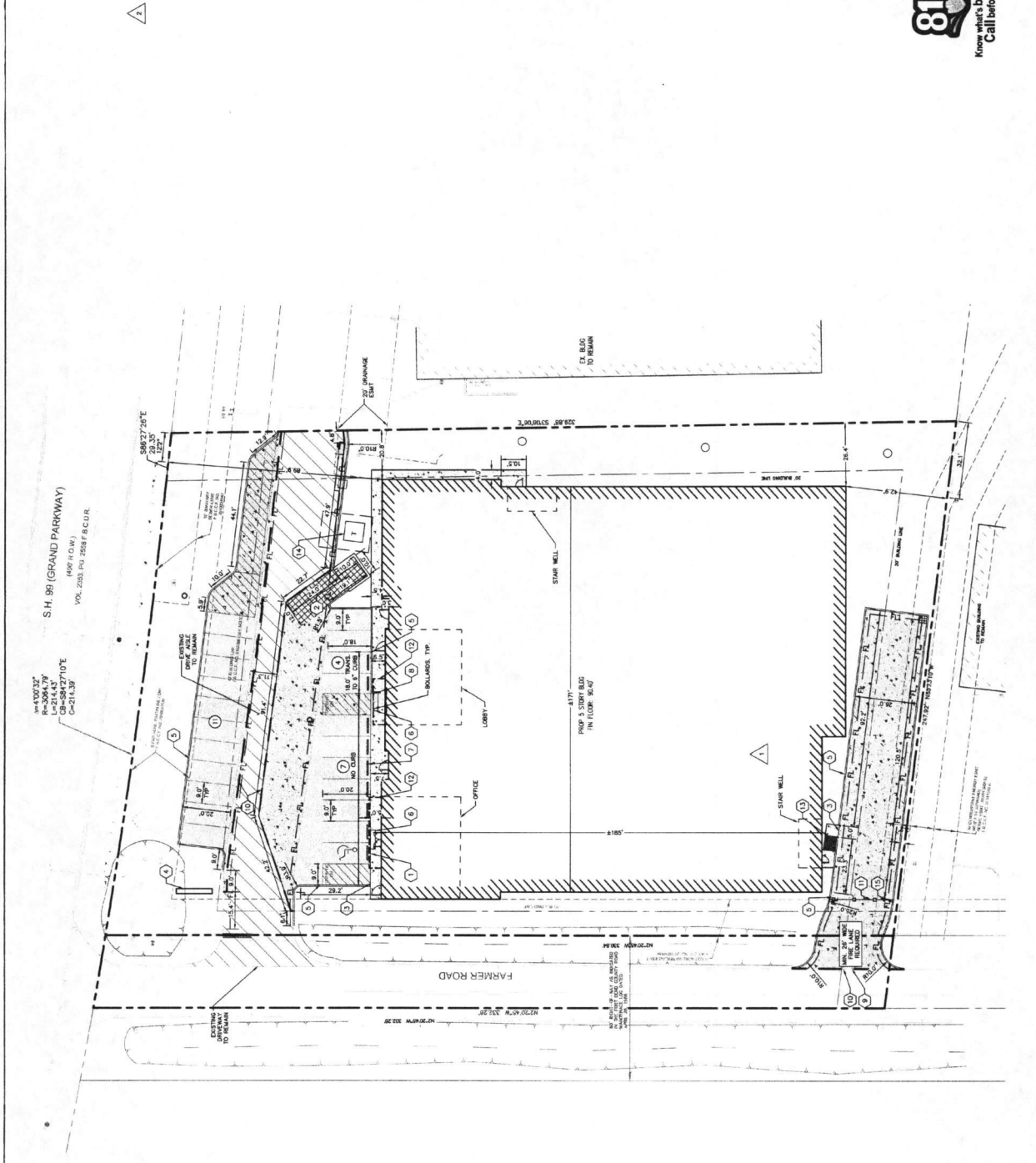

CAUTION!
 EXISTING UNDERGROUND UTILITIES IN THE AREA. CONTRACTOR IS RESPONSIBLE FOR DETERMINING THE HORIZONTAL AND VERTICAL LOCATION OF ALL UTILITIES PRIOR TO CONSTRUCTION. ANY REPAIRS TO EXISTING UTILITIES DUE TO DAMAGE INCURRED DURING CONSTRUCTION, CONTRACTOR SHALL BE RESPONSIBLE FOR ANY DISCREPANCIES ON THE PLANS.



APPROVED: *Michael J. ...*
 DATE: 10/14/16

NO.	REVISIONS
1	ADDITIONAL NO. 1
2	ADDITIONAL NO. 2
DATE	09/29/16
BY	KMK

12012 WOODCHURCH LANE, SUITE 500, HOUSTON, TX 77079
 © 2016 KIMLEY-HORN AND ASSOCIATES, INC.
Kimley-Horn
 TYPE: GRADING PLAN
 PROJECT: KMA PROJECT

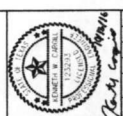

DATE: 06/31/2016
 DATE: SEPT 2016
 SCALE: AS SHOWN
 CHECKED BY: KMK
 DRAWN BY: KMK
 GRADING PLAN

SHEET NUMBER: C4.0
 PROJECT: PUBLIC STORAGE GRAND PARKWAY

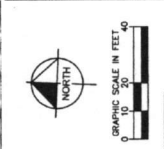

LEGEND	
PROPOSED CONTOURS	---
EXISTING CONTOURS	---
PROPOSED SPOT ELEVATIONS	-(ELEVATION)
MATCH EXISTING GRADE	---(ELEVATION)
TOP OF GATE INLET	□
PROPOSED STORM SEWER GRATE	□
INLET POINT/GRATE CHANGE	□
DIRECTION OF FLOW	→
PROP. RETAINMENT WALL	▬
8" DROP IN SIDEWALK	▬
EARTHEN SWALE 6:0% SLOPE MIN	▬
CONCRETE SWALE 6:0% SLOPE MIN	▬
8" ADA RAMP	▬

- GRADING NOTES**
- ALL SPOT ELEVATIONS ARE TO TOP OF FINISHED PAVED OR CONCRETE SURFACE.
 - ALL SPOT ELEVATIONS ARE TO TOP OF FINISHED PAVED OR CONCRETE SURFACE UNLESS OTHERWISE NOTED.
 - ALL SPOT ELEVATIONS ARE TO TOP OF FINISHED PAVED OR CONCRETE SURFACE UNLESS OTHERWISE NOTED.
 - ALL SPOT ELEVATIONS ARE TO TOP OF FINISHED PAVED OR CONCRETE SURFACE UNLESS OTHERWISE NOTED.
 - ALL SPOT ELEVATIONS ARE TO TOP OF FINISHED PAVED OR CONCRETE SURFACE UNLESS OTHERWISE NOTED.
 - ALL SPOT ELEVATIONS ARE TO TOP OF FINISHED PAVED OR CONCRETE SURFACE UNLESS OTHERWISE NOTED.
 - ALL SPOT ELEVATIONS ARE TO TOP OF FINISHED PAVED OR CONCRETE SURFACE UNLESS OTHERWISE NOTED.
 - ALL SPOT ELEVATIONS ARE TO TOP OF FINISHED PAVED OR CONCRETE SURFACE UNLESS OTHERWISE NOTED.

S.H. 99 (GRAND PARKWAY)
 (400' R.O.W.)
 VOL. 2016 PLS. 799A & 812A

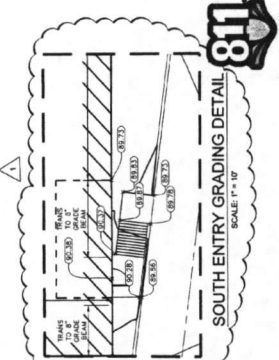
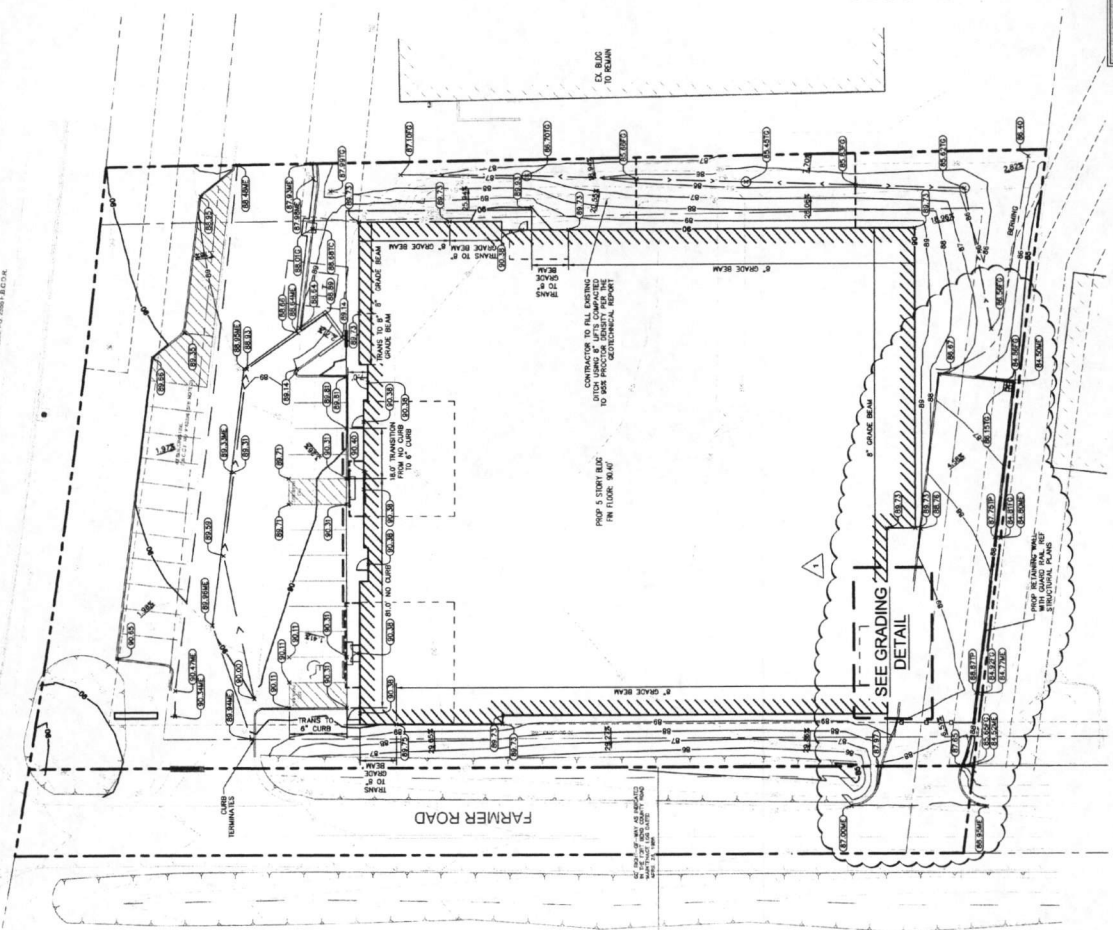

CAUTION!!
 EXISTING UNDERGROUND UTILITIES IN THE AREA OF THIS PROJECT ARE NOT SHOWN ON THIS PLAN. THE CONTRACTOR SHALL BE RESPONSIBLE FOR DETERMINING THE LOCATION AND DEPTH OF ALL UTILITIES PRIOR TO CONSTRUCTION. THE CONTRACTOR SHALL BE RESPONSIBLE FOR ANY REPAIRS TO EXISTING UTILITIES DUE TO DAMAGE INCURRED DURING CONSTRUCTION. THE CONTRACTOR SHALL NOTIFY THE ENGINEER OF ANY DISCREPANCIES ON THE PLANS.

APPROVED: *[Signature]*
 DATE: 10/16/16

811
 Know what's below. Call before you dig.

REFERENCE BENCHMARK: 100.00
 ELEVATION: 100.00
 BENCH MARK: 100.00
 ELEVATION: 100.00
 BENCH MARK: 100.00
 ELEVATION: 100.00

Station	Elevation	Slope		Velocity	Time	Distance	Flow		Volume	Notes
		Top	Bottom				Area	Rate		
1+00	85.00	0.00	0.00	0.00	0.00	0.00	0.00	0.00	0.00	
1+10	85.00	0.00	0.00	0.00	0.00	0.00	0.00	0.00	0.00	
1+20	85.00	0.00	0.00	0.00	0.00	0.00	0.00	0.00	0.00	
1+30	85.00	0.00	0.00	0.00	0.00	0.00	0.00	0.00	0.00	
1+40	85.00	0.00	0.00	0.00	0.00	0.00	0.00	0.00	0.00	
1+50	85.00	0.00	0.00	0.00	0.00	0.00	0.00	0.00	0.00	
1+60	85.00	0.00	0.00	0.00	0.00	0.00	0.00	0.00	0.00	
1+70	85.00	0.00	0.00	0.00	0.00	0.00	0.00	0.00	0.00	
1+80	85.00	0.00	0.00	0.00	0.00	0.00	0.00	0.00	0.00	
1+90	85.00	0.00	0.00	0.00	0.00	0.00	0.00	0.00	0.00	
2+00	85.00	0.00	0.00	0.00	0.00	0.00	0.00	0.00	0.00	

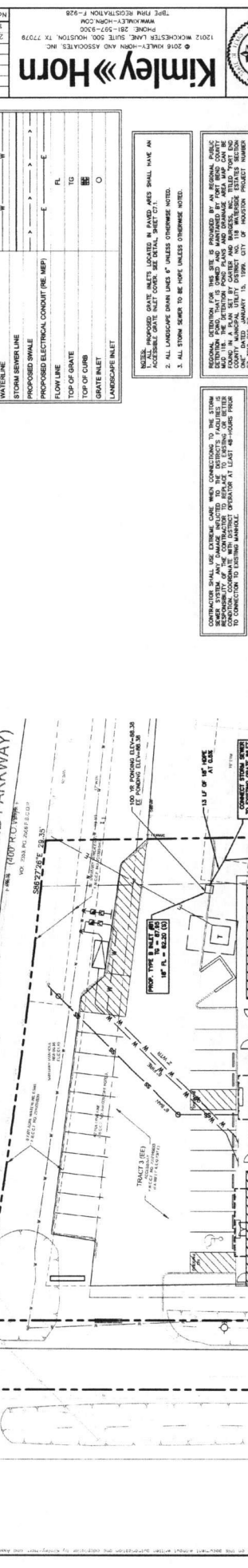

100 INLET PONDING CALCULATIONS

Station	Flow (MGD)	Velocity (ft/s)	Time (min)	Distance (ft)	Volume (MG)	Notes
1+00	0.00	0.00	0.00	0.00	0.00	
1+10	0.00	0.00	0.00	0.00	0.00	
1+20	0.00	0.00	0.00	0.00	0.00	
1+30	0.00	0.00	0.00	0.00	0.00	
1+40	0.00	0.00	0.00	0.00	0.00	
1+50	0.00	0.00	0.00	0.00	0.00	
1+60	0.00	0.00	0.00	0.00	0.00	
1+70	0.00	0.00	0.00	0.00	0.00	
1+80	0.00	0.00	0.00	0.00	0.00	
1+90	0.00	0.00	0.00	0.00	0.00	
2+00	0.00	0.00	0.00	0.00	0.00	

100 INLET PONDING CALCULATIONS

Station	Flow (MGD)	Velocity (ft/s)	Time (min)	Distance (ft)	Volume (MG)	Notes
1+00	0.00	0.00	0.00	0.00	0.00	
1+10	0.00	0.00	0.00	0.00	0.00	
1+20	0.00	0.00	0.00	0.00	0.00	
1+30	0.00	0.00	0.00	0.00	0.00	
1+40	0.00	0.00	0.00	0.00	0.00	
1+50	0.00	0.00	0.00	0.00	0.00	
1+60	0.00	0.00	0.00	0.00	0.00	
1+70	0.00	0.00	0.00	0.00	0.00	
1+80	0.00	0.00	0.00	0.00	0.00	
1+90	0.00	0.00	0.00	0.00	0.00	
2+00	0.00	0.00	0.00	0.00	0.00	

PROJECT: PUBLIC STORAGE GRAND PARKWAY

DESIGNED BY: M&E

CHECKED BY: M&E

DATE: 09/28/16

PROJECT: PUBLIC STORAGE GRAND PARKWAY

DESIGNED BY: M&E

CHECKED BY: M&E

DATE: 09/28/16

GRAPHIC SCALE IN FEET

0 10 20 30 40 50

LEGEND

- SANITARY SEWER LINE
- WATERLINE
- STORM SEWER LINE
- PROPOSED SWALE
- PROPOSED ELECTRICAL CONDUIT (PER MEP)
- FLOW LINE
- TOP OF CURB
- GRATE INLET
- LANDSCAPE INLET

NOTES:

1. ALL LANDSCAPE GRATE INLETS SHALL HAVE AN ACCESSIBLE GRATE INLET COVER, SEE DETAIL SHEET 07.1.
2. ALL LANDSCAPE GRATE INLETS SHALL HAVE AN ACCESSIBLE GRATE INLET COVER, SEE DETAIL SHEET 07.1.
3. ALL STORM SEWER TO BE IMPROVED UNLESS OTHERWISE NOTED.

PERSONAL SERVICES FOR THIS SITE: PROVIDED BY AN INDIVIDUAL OR ENTITY THAT IS OWNED AND MANAGED BY PORT BEND COUNTY. THE SERVICES ARE PROVIDED BY THE INDIVIDUAL OR ENTITY THAT IS OWNED AND MANAGED BY PORT BEND COUNTY. THE SERVICES ARE PROVIDED BY THE INDIVIDUAL OR ENTITY THAT IS OWNED AND MANAGED BY PORT BEND COUNTY. THE SERVICES ARE PROVIDED BY THE INDIVIDUAL OR ENTITY THAT IS OWNED AND MANAGED BY PORT BEND COUNTY.

100 INLET PONDING CALCULATIONS

Station	Flow (MGD)	Velocity (ft/s)	Time (min)	Distance (ft)	Volume (MG)	Notes
1+00	0.00	0.00	0.00	0.00	0.00	
1+10	0.00	0.00	0.00	0.00	0.00	
1+20	0.00	0.00	0.00	0.00	0.00	
1+30	0.00	0.00	0.00	0.00	0.00	
1+40	0.00	0.00	0.00	0.00	0.00	
1+50	0.00	0.00	0.00	0.00	0.00	
1+60	0.00	0.00	0.00	0.00	0.00	
1+70	0.00	0.00	0.00	0.00	0.00	
1+80	0.00	0.00	0.00	0.00	0.00	
1+90	0.00	0.00	0.00	0.00	0.00	
2+00	0.00	0.00	0.00	0.00	0.00	

CONTRACTOR SHALL CONDUCT ALL WORK UNDER THE SUPERVISION OF A REGISTERED PROFESSIONAL ENGINEER. THE ENGINEER SHALL BE RESPONSIBLE FOR THE DESIGN AND CONSTRUCTION OF THE PROJECT. THE ENGINEER SHALL BE RESPONSIBLE FOR THE DESIGN AND CONSTRUCTION OF THE PROJECT. THE ENGINEER SHALL BE RESPONSIBLE FOR THE DESIGN AND CONSTRUCTION OF THE PROJECT.

CAUTION!

EXISTING UNDERGROUND UTILITIES IN THE AREA OF THIS PROJECT ARE NOT SHOWN ON THESE PLANS. THE CONTRACTOR IS RESPONSIBLE FOR DETERMINING THE HORIZONTAL AND VERTICAL LOCATION OF ALL EXISTING UTILITIES. THE CONTRACTOR SHALL BE RESPONSIBLE FOR ANY REPAIRS TO EXISTING UTILITIES DUE TO DAMAGE INCURRED DURING CONSTRUCTION. THE CONTRACTOR SHALL BE RESPONSIBLE FOR ANY DISCREPANCIES ON THE PLANS.

811

Know what's below. Call before you dig.

APPROVED: [Signature]

DATE: 10/26/16

NO.	REVISIONS	DATE
1	ADDITIONAL NO. 2	09/28/16
2	ADDITIONAL NO. 1	05/19/16
BY		

Kimley-Horn

2012 WICKLIFFE AVENUE, SUITE 500, HOUSTON, TX 77078
 281-416-8200
 WWW.KIMLEY-HORN.COM



PROJECT NO. 06539605
 SHEET 2016
 SCALE AS SHOWN
 DESIGNED BY KAC
 DRAWN BY ZAR
 CHECKED BY MBR

UTILITY PLAN

**PUBLIC STORAGE
 GRAND PARKWAY**

SHEET NUMBER
C6.0



GRAPHIC SCALE IN FEET
 0 10 20 40

LEGEND

PROPERTY LINE
PROPOSED WATER LINE
PROPOSED SANITARY SEWER LINE
EXISTING SANITARY SEWER LINE

- GENERAL NOTES**
1. PROVIDE BACKFLOW PROTECTION ON SEWER AND FIRE SERVICE PER PLUMBING CODE.
 2. FIRE SERVICE LINE MUST BE INSTALLED BY LICENSED CONTRACTOR.
 3. REFER TO MEP PLANS FOR UTILITY CONNECTIONS AT BUILDING.
 4. CONTRACTOR TO VERIFY ELEVATIONS AND LOCATIONS OF THE EXISTING UTILITIES PRIOR TO CONSTRUCTION.
 5. CONTRACTOR TO VERIFY ALL EXISTING SANITARY SEWER RIGHTS PRIOR TO ANY CONSTRUCTION.
 6. CONTRACTOR SHALL CONTACT FINANCIAL UTILITY COMPANIES AND PROVIDE ALL CONTACT REQUIRED TO SERVICE BUREAU.
 7. FINANCIAL UTILITY COMPANIES TO PROVIDE LOCATION OF EXISTING SANITARY SEWER MAINS TO CONTRACTOR.
 8. CONTRACTOR SHALL VERIFY ALL EXISTING SANITARY SEWER MAINS PRIOR TO ANY CONSTRUCTION.
 9. CONTRACTOR SHALL VERIFY ALL EXISTING SANITARY SEWER MAINS PRIOR TO ANY CONSTRUCTION.
 10. THE CONTRACTOR SHALL BE RESPONSIBLE FOR INSTALLING THE BACKFLOW PREVENTER. THESE PREVENTERS SHALL BE INSTALLED AT THE POINT OF ENTRY TO THE BUILDING AND AT ALL OTHER LOCATIONS AS SHOWN ON THESE PLANS.
 11. LOCAL AND DISTRICT ORDINANCES REQUIRE THAT COMMERCIAL UTILITY CONSTRUCTION AND SHALL IMPACT ALL WATER AND SANITARY SEWER.
 12. ALL UTILITY CONNECTIONS SHALL BE MADE TO THE DISTRICT OPERATOR.
 13. THE CONTRACTOR SHALL BE RESPONSIBLE FOR OBTAINING ALL NECESSARY PERMITS FROM THE DISTRICT OPERATOR.
 14. THE CONTRACTOR SHALL BE RESPONSIBLE FOR OBTAINING ALL NECESSARY PERMITS FROM THE DISTRICT OPERATOR.

- MUD DISTRICT NOTES**
1. ALL LINE WORK IS THE RESPONSIBILITY OF THE ORIGINAL CONTRACTOR.
 2. CALL THE DISTRICT OPERATOR AT 281-416-8200 FOR ALL TAP COSTS.
 3. CONTRACTOR TO VERIFY ALL EXISTING SANITARY SEWER MAINS PRIOR TO ANY CONSTRUCTION.
 4. ENGINEER OF RECORD TO SIZE METERS AND BACKFLOW PREVENTION DEVICES.
 5. PORTLAND CEMENT AND NO. 10 APPROVAL TO BE OBTAINED PRIOR TO ANY CONNECTIONS OF FIRE, STORM SEWER, AND WATER SERVICES.
 6. SANITARY SEWER PIPE AND SIZES SHALL BE SCHEDULE 40 PVC.
 7. SANITARY SEWER PIPE AND SIZES SHALL BE SCHEDULE 40 PVC.
 8. SANITARY SEWER PIPE AND SIZES SHALL BE SCHEDULE 40 PVC.
 9. SANITARY SEWER PIPE AND SIZES SHALL BE SCHEDULE 40 PVC.
 10. SANITARY SEWER PIPE AND SIZES SHALL BE SCHEDULE 40 PVC.
 11. SANITARY SEWER PIPE AND SIZES SHALL BE SCHEDULE 40 PVC.
 12. SANITARY SEWER PIPE AND SIZES SHALL BE SCHEDULE 40 PVC.
 13. SANITARY SEWER PIPE AND SIZES SHALL BE SCHEDULE 40 PVC.
 14. SANITARY SEWER PIPE AND SIZES SHALL BE SCHEDULE 40 PVC.
 15. SANITARY SEWER PIPE AND SIZES SHALL BE SCHEDULE 40 PVC.
 16. SANITARY SEWER PIPE AND SIZES SHALL BE SCHEDULE 40 PVC.
 17. SANITARY SEWER PIPE AND SIZES SHALL BE SCHEDULE 40 PVC.
 18. SANITARY SEWER PIPE AND SIZES SHALL BE SCHEDULE 40 PVC.
 19. SANITARY SEWER PIPE AND SIZES SHALL BE SCHEDULE 40 PVC.
 20. SANITARY SEWER PIPE AND SIZES SHALL BE SCHEDULE 40 PVC.

- WATER SERVICE NOTES**
1. 12" CPVC (BY FIELD NO. 11)
 2. 12" CPVC (BY FIELD NO. 11)
 3. 12" CPVC (BY FIELD NO. 11)
 4. 12" CPVC (BY FIELD NO. 11)
 5. 12" CPVC (BY FIELD NO. 11)
 6. 12" CPVC (BY FIELD NO. 11)
 7. 12" CPVC (BY FIELD NO. 11)
 8. 12" CPVC (BY FIELD NO. 11)
 9. 12" CPVC (BY FIELD NO. 11)
 10. 12" CPVC (BY FIELD NO. 11)
 11. 12" CPVC (BY FIELD NO. 11)
 12. 12" CPVC (BY FIELD NO. 11)
 13. 12" CPVC (BY FIELD NO. 11)
 14. 12" CPVC (BY FIELD NO. 11)
 15. 12" CPVC (BY FIELD NO. 11)
 16. 12" CPVC (BY FIELD NO. 11)
 17. 12" CPVC (BY FIELD NO. 11)
 18. 12" CPVC (BY FIELD NO. 11)
 19. 12" CPVC (BY FIELD NO. 11)
 20. 12" CPVC (BY FIELD NO. 11)

- SEWER SERVICE NOTES**
1. 12" CPVC (BY FIELD NO. 11)
 2. 12" CPVC (BY FIELD NO. 11)
 3. 12" CPVC (BY FIELD NO. 11)
 4. 12" CPVC (BY FIELD NO. 11)
 5. 12" CPVC (BY FIELD NO. 11)
 6. 12" CPVC (BY FIELD NO. 11)
 7. 12" CPVC (BY FIELD NO. 11)
 8. 12" CPVC (BY FIELD NO. 11)
 9. 12" CPVC (BY FIELD NO. 11)
 10. 12" CPVC (BY FIELD NO. 11)
 11. 12" CPVC (BY FIELD NO. 11)
 12. 12" CPVC (BY FIELD NO. 11)
 13. 12" CPVC (BY FIELD NO. 11)
 14. 12" CPVC (BY FIELD NO. 11)
 15. 12" CPVC (BY FIELD NO. 11)
 16. 12" CPVC (BY FIELD NO. 11)
 17. 12" CPVC (BY FIELD NO. 11)
 18. 12" CPVC (BY FIELD NO. 11)
 19. 12" CPVC (BY FIELD NO. 11)
 20. 12" CPVC (BY FIELD NO. 11)

- SEWER SERVICE NOTES**
1. 12" CPVC (BY FIELD NO. 11)
 2. 12" CPVC (BY FIELD NO. 11)
 3. 12" CPVC (BY FIELD NO. 11)
 4. 12" CPVC (BY FIELD NO. 11)
 5. 12" CPVC (BY FIELD NO. 11)
 6. 12" CPVC (BY FIELD NO. 11)
 7. 12" CPVC (BY FIELD NO. 11)
 8. 12" CPVC (BY FIELD NO. 11)
 9. 12" CPVC (BY FIELD NO. 11)
 10. 12" CPVC (BY FIELD NO. 11)
 11. 12" CPVC (BY FIELD NO. 11)
 12. 12" CPVC (BY FIELD NO. 11)
 13. 12" CPVC (BY FIELD NO. 11)
 14. 12" CPVC (BY FIELD NO. 11)
 15. 12" CPVC (BY FIELD NO. 11)
 16. 12" CPVC (BY FIELD NO. 11)
 17. 12" CPVC (BY FIELD NO. 11)
 18. 12" CPVC (BY FIELD NO. 11)
 19. 12" CPVC (BY FIELD NO. 11)
 20. 12" CPVC (BY FIELD NO. 11)

- SEWER SERVICE NOTES**
1. 12" CPVC (BY FIELD NO. 11)
 2. 12" CPVC (BY FIELD NO. 11)
 3. 12" CPVC (BY FIELD NO. 11)
 4. 12" CPVC (BY FIELD NO. 11)
 5. 12" CPVC (BY FIELD NO. 11)
 6. 12" CPVC (BY FIELD NO. 11)
 7. 12" CPVC (BY FIELD NO. 11)
 8. 12" CPVC (BY FIELD NO. 11)
 9. 12" CPVC (BY FIELD NO. 11)
 10. 12" CPVC (BY FIELD NO. 11)
 11. 12" CPVC (BY FIELD NO. 11)
 12. 12" CPVC (BY FIELD NO. 11)
 13. 12" CPVC (BY FIELD NO. 11)
 14. 12" CPVC (BY FIELD NO. 11)
 15. 12" CPVC (BY FIELD NO. 11)
 16. 12" CPVC (BY FIELD NO. 11)
 17. 12" CPVC (BY FIELD NO. 11)
 18. 12" CPVC (BY FIELD NO. 11)
 19. 12" CPVC (BY FIELD NO. 11)
 20. 12" CPVC (BY FIELD NO. 11)

CAUTION!

EXISTING UNDERGROUND UTILITIES IN THE AREA CONTRACTOR IS RESPONSIBLE FOR DETERMINING THE HORIZONTAL AND VERTICAL LOCATION OF ALL UTILITIES. THE CONTRACTOR SHALL BE RESPONSIBLE FOR ANY REPAIRS TO EXISTING UTILITIES DUE TO DAMAGE INCURRED DURING CONSTRUCTION. CONTRACTOR SHALL BE RESPONSIBLE FOR ANY DISCREPANCIES ON THE PLANS.



APPROVED: *Allyson*
 DEVELOPER
 DATE: 10/24/16

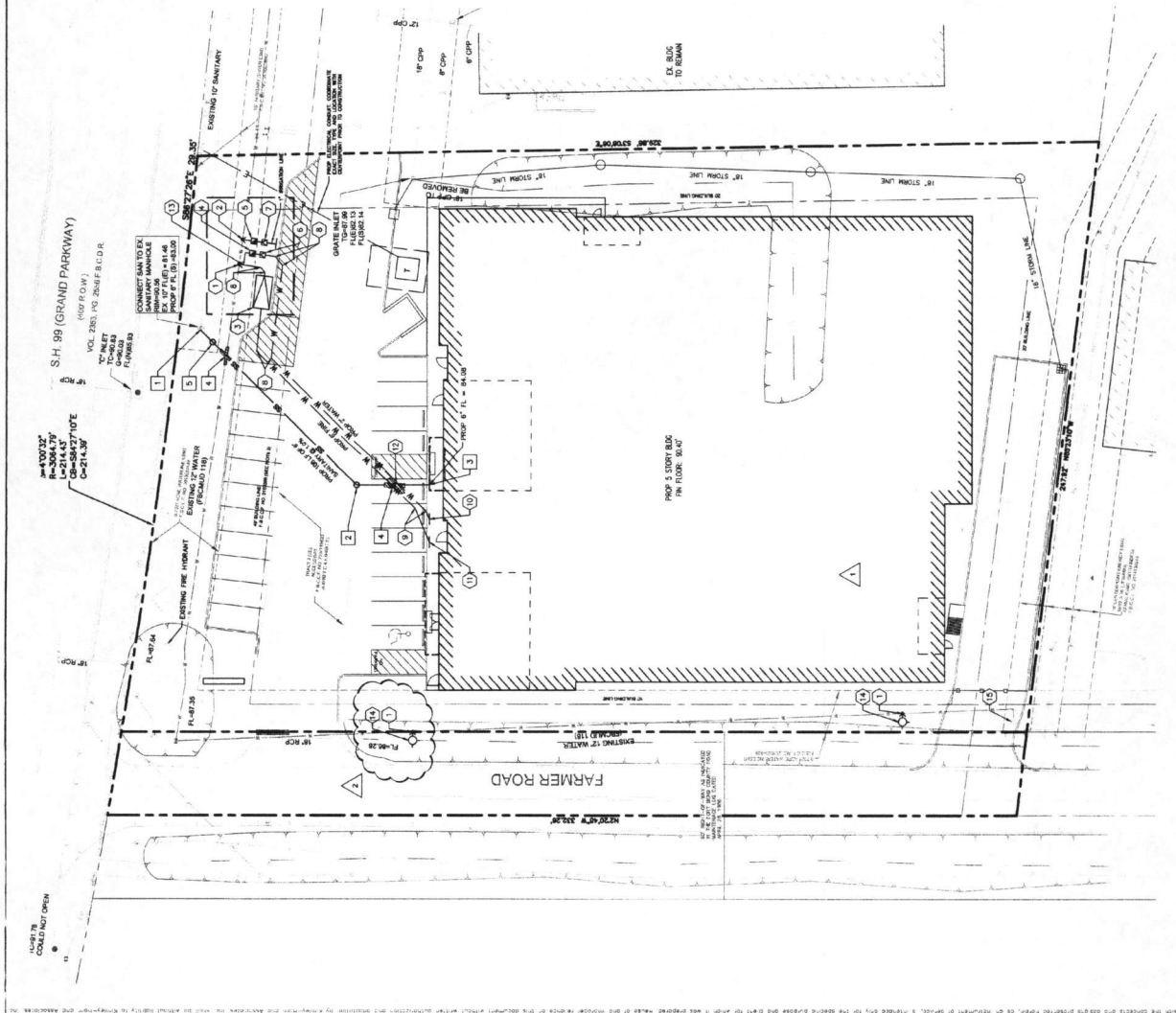

WATER CONNECTION DETAIL

SCALE: 1/4" = 1'-0"

CONTRACTOR TO VERIFY ALL EXISTING SANITARY SEWER MAINS PRIOR TO ANY CONSTRUCTION. CONTRACTOR SHALL CONTACT FINANCIAL UTILITY COMPANIES AND PROVIDE ALL CONTACT REQUIRED TO SERVICE BUREAU.

NO.	REVISIONS
1	ADDENDUM NO. 1
2	ADDENDUM NO. 2
DATE	09/26/16

Kimley-Horn
 12012 WICKSTEYER LANE, SUITE 500, HOUSTON, TX 77079
 PHONE: (713) 499-8900
 FIRM REGISTRATION # 2-928



DATE: SEPT 2016
 DRAWN BY: ZAK
 CHECKED BY: WJK
 SCALE: AS SHOWN
 EXPIRES: SEPT 2016
 PROJECT: KHA-PROJECT

CONSTRUCTION DETAILS
 (1 OF 3)
 PUBLIC STORAGE
 GRAND PARKWAY
 SHEET NUMBER
 C7.0

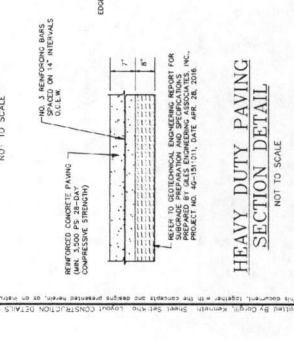
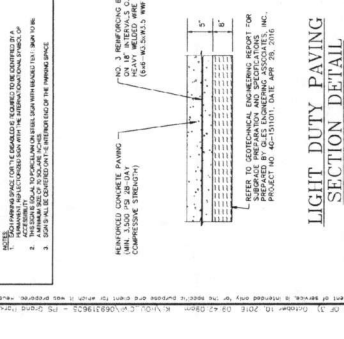
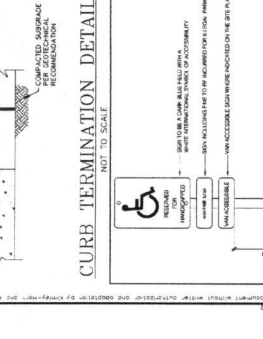
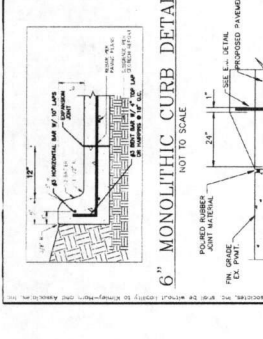
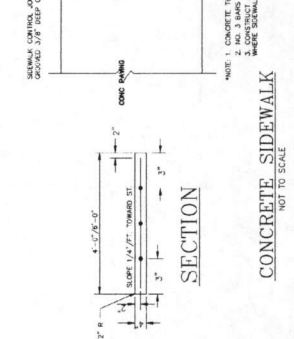
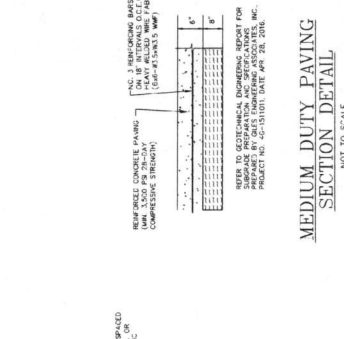
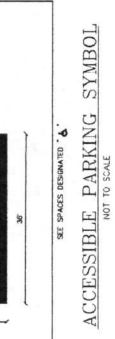
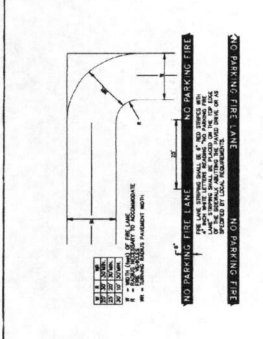
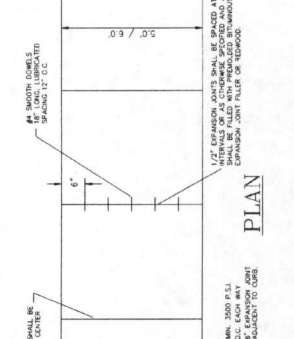
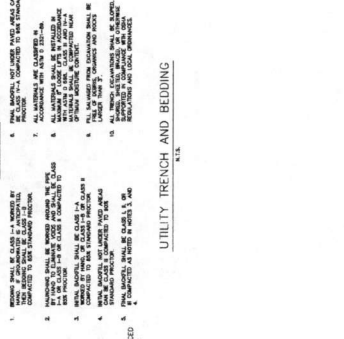
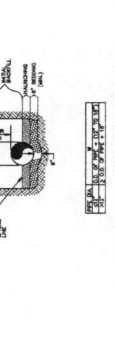
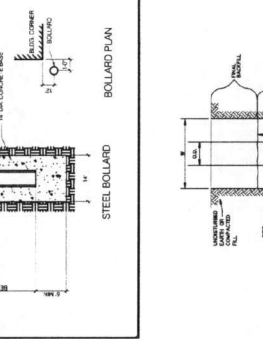
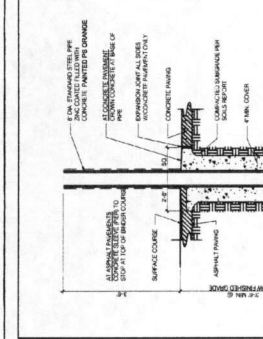
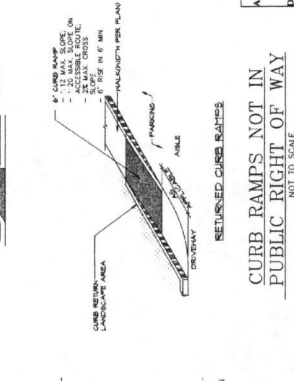
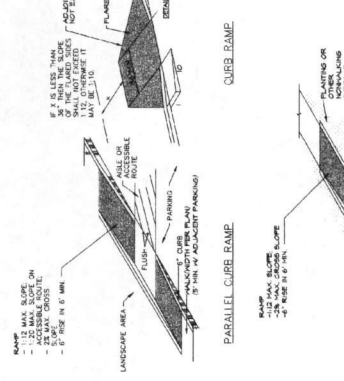
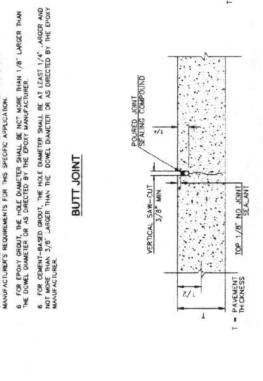
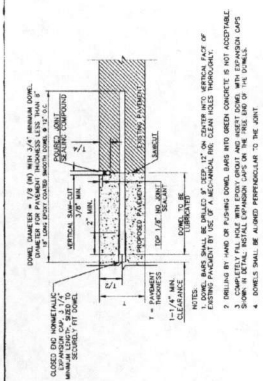
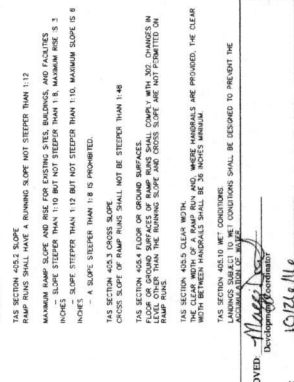
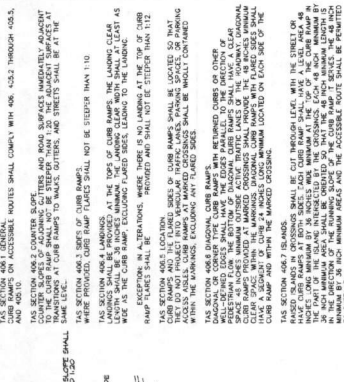
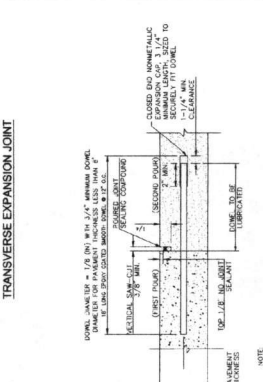
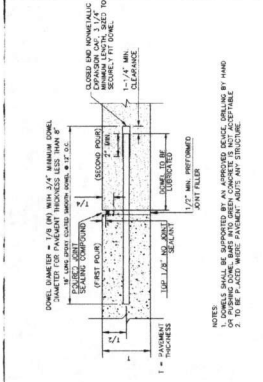

APPROVED: *Alage*
 DEVELOPER/OWNER
 DATE: 10/26/16

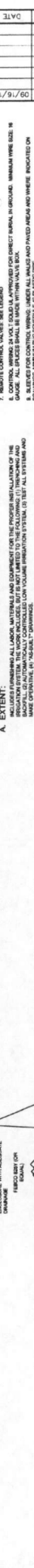

RPZ ASSEMBLY BACKFLOW PREVENTER
 N.T.S.



LINE FLUSHING VALVE
 N.T.S.



SLEEVE DETAIL
 N.T.S.



PIPE AND WIRE TRENCHING
 N.T.S.



ICZ 101 DRIP CONTROL ZONE KIT
 N.T.S.



AIRVACUUM RELIEF
 N.T.S.



BUBBLER ASSEMBLY
 N.T.S.

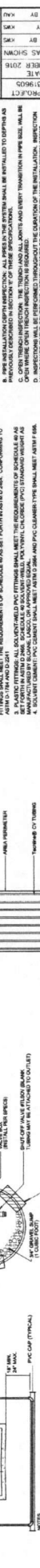

HUNTER I-CORE METAL CONTROLLER
 N.T.S.

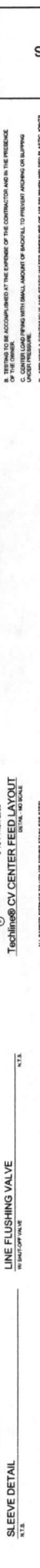

Tee-Line® CV CENTER FEED LAYOUT
 N.T.S.

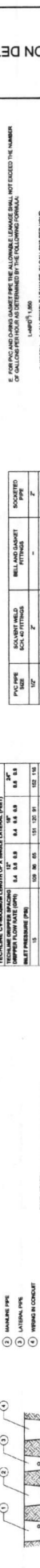

MP ROTATOR SPRINKLER
 N.T.S.

SLEEVE SCHEDULE

PIPE SIZE	SOLVENT WELD POLYETHYLENE	WELL AND JACKET	ROBUSTED
1/2"	1/2"	1/2"	1/2"
3/4"	3/4"	3/4"	3/4"
1"	1"	1"	1"
1 1/4"	1 1/4"	1 1/4"	1 1/4"
1 1/2"	1 1/2"	1 1/2"	1 1/2"
2"	2"	2"	2"
2 1/2"	2 1/2"	2 1/2"	2 1/2"
3"	3"	3"	3"
3 1/2"	3 1/2"	3 1/2"	3 1/2"
4"	4"	4"	4"
4 1/2"	4 1/2"	4 1/2"	4 1/2"
5"	5"	5"	5"
5 1/2"	5 1/2"	5 1/2"	5 1/2"
6"	6"	6"	6"
6 1/2"	6 1/2"	6 1/2"	6 1/2"
7"	7"	7"	7"
7 1/2"	7 1/2"	7 1/2"	7 1/2"
8"	8"	8"	8"
8 1/2"	8 1/2"	8 1/2"	8 1/2"
9"	9"	9"	9"
9 1/2"	9 1/2"	9 1/2"	9 1/2"
10"	10"	10"	10"
10 1/2"	10 1/2"	10 1/2"	10 1/2"
11"	11"	11"	11"
11 1/2"	11 1/2"	11 1/2"	11 1/2"
12"	12"	12"	12"
12 1/2"	12 1/2"	12 1/2"	12 1/2"
13"	13"	13"	13"
13 1/2"	13 1/2"	13 1/2"	13 1/2"
14"	14"	14"	14"
14 1/2"	14 1/2"	14 1/2"	14 1/2"
15"	15"	15"	15"
15 1/2"	15 1/2"	15 1/2"	15 1/2"
16"	16"	16"	16"
16 1/2"	16 1/2"	16 1/2"	16 1/2"
17"	17"	17"	17"
17 1/2"	17 1/2"	17 1/2"	17 1/2"
18"	18"	18"	18"
18 1/2"	18 1/2"	18 1/2"	18 1/2"
19"	19"	19"	19"
19 1/2"	19 1/2"	19 1/2"	19 1/2"
20"	20"	20"	20"
20 1/2"	20 1/2"	20 1/2"	20 1/2"
21"	21"	21"	21"
21 1/2"	21 1/2"	21 1/2"	21 1/2"
22"	22"	22"	22"
22 1/2"	22 1/2"	22 1/2"	22 1/2"
23"	23"	23"	23"
23 1/2"	23 1/2"	23 1/2"	23 1/2"
24"	24"	24"	24"
24 1/2"	24 1/2"	24 1/2"	24 1/2"
25"	25"	25"	25"
25 1/2"	25 1/2"	25 1/2"	25 1/2"
26"	26"	26"	26"
26 1/2"	26 1/2"	26 1/2"	26 1/2"
27"	27"	27"	27"
27 1/2"	27 1/2"	27 1/2"	27 1/2"
28"	28"	28"	28"
28 1/2"	28 1/2"	28 1/2"	28 1/2"
29"	29"	29"	29"
29 1/2"	29 1/2"	29 1/2"	29 1/2"
30"	30"	30"	30"
30 1/2"	30 1/2"	30 1/2"	30 1/2"
31"	31"	31"	31"
31 1/2"	31 1/2"	31 1/2"	31 1/2"
32"	32"	32"	32"
32 1/2"	32 1/2"	32 1/2"	32 1/2"
33"	33"	33"	33"
33 1/2"	33 1/2"	33 1/2"	33 1/2"
34"	34"	34"	34"
34 1/2"	34 1/2"	34 1/2"	34 1/2"
35"	35"	35"	35"
35 1/2"	35 1/2"	35 1/2"	35 1/2"
36"	36"	36"	36"
36 1/2"	36 1/2"	36 1/2"	36 1/2"
37"	37"	37"	37"
37 1/2"	37 1/2"	37 1/2"	37 1/2"
38"	38"	38"	38"
38 1/2"	38 1/2"	38 1/2"	38 1/2"
39"	39"	39"	39"
39 1/2"	39 1/2"	39 1/2"	39 1/2"
40"	40"	40"	40"
40 1/2"	40 1/2"	40 1/2"	40 1/2"
41"	41"	41"	41"
41 1/2"	41 1/2"	41 1/2"	41 1/2"
42"	42"	42"	42"
42 1/2"	42 1/2"	42 1/2"	42 1/2"
43"	43"	43"	43"
43 1/2"	43 1/2"	43 1/2"	43 1/2"
44"	44"	44"	44"
44 1/2"	44 1/2"	44 1/2"	44 1/2"
45"	45"	45"	45"
45 1/2"	45 1/2"	45 1/2"	45 1/2"
46"	46"	46"	46"
46 1/2"	46 1/2"	46 1/2"	46 1/2"
47"	47"	47"	47"
47 1/2"	47 1/2"	47 1/2"	47 1/2"
48"	48"	48"	48"
48 1/2"	48 1/2"	48 1/2"	48 1/2"
49"	49"	49"	49"
49 1/2"	49 1/2"	49 1/2"	49 1/2"
50"	50"	50"	50"



Tee-Line® CV CENTER FEED LAYOUT
 N.T.S.



Tee-Line® CV CENTER FEED LAYOUT
 N.T.S.



Tee-Line® CV CENTER FEED LAYOUT
 N.T.S.

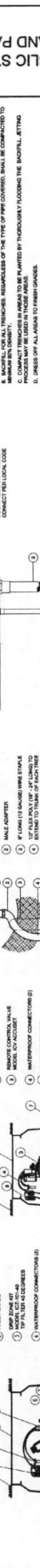

Tee-Line® CV CENTER FEED LAYOUT
 N.T.S.

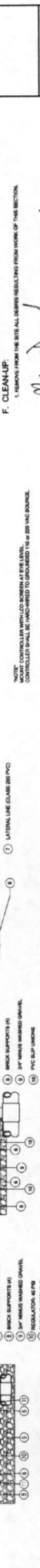

Tee-Line® CV CENTER FEED LAYOUT
 N.T.S.

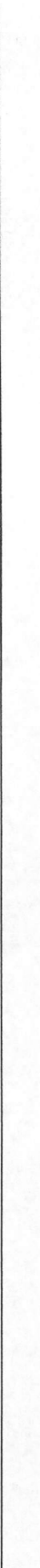

Tee-Line® CV CENTER FEED LAYOUT
 N.T.S.



Tee-Line® CV CENTER FEED LAYOUT
 N.T.S.

GENERAL IRRIGATION NOTES

A. EXTENT: THE CONTRACTOR SHALL PROVIDE MATERIALS AND LABOR NECESSARY FOR THE PROPER INSTALLATION OF THE IRRIGATION SYSTEM AS SHOWN ON THE WORKSHEETS. THE WORK SHALL BE LIMITED TO THE FOLLOWING: (1) TRENCHING AND INSTALLATION OF ALL IRRIGATION PIPING AND FITTINGS; (2) INSTALLATION OF ALL IRRIGATION VALVES, CONTROLLERS, AND OTHER EQUIPMENT; (3) TESTING AND COMMISSIONING OF THE IRRIGATION SYSTEM. THE CONTRACTOR SHALL BE RESPONSIBLE FOR OBTAINING ALL NECESSARY PERMITS AND APPROVALS FROM THE APPROPRIATE AGENCIES.

B. GENERAL: THE CONTRACTOR SHALL BE RESPONSIBLE FOR OBTAINING ALL NECESSARY PERMITS AND APPROVALS FROM THE APPROPRIATE AGENCIES. THE CONTRACTOR SHALL BE RESPONSIBLE FOR OBTAINING ALL NECESSARY PERMITS AND APPROVALS FROM THE APPROPRIATE AGENCIES. THE CONTRACTOR SHALL BE RESPONSIBLE FOR OBTAINING ALL NECESSARY PERMITS AND APPROVALS FROM THE APPROPRIATE AGENCIES.

C. MATERIALS: ALL MATERIALS SHALL BE OF THE HIGHEST QUALITY AND SHALL BE SUBJECT TO INSPECTION AND TESTING BY THE CONTRACTOR. THE CONTRACTOR SHALL BE RESPONSIBLE FOR OBTAINING ALL NECESSARY PERMITS AND APPROVALS FROM THE APPROPRIATE AGENCIES.

D. WORKMANSHIP: THE CONTRACTOR SHALL BE RESPONSIBLE FOR THE PROPER INSTALLATION AND WORKMANSHIP OF THE IRRIGATION SYSTEM. THE CONTRACTOR SHALL BE RESPONSIBLE FOR OBTAINING ALL NECESSARY PERMITS AND APPROVALS FROM THE APPROPRIATE AGENCIES.

E. INSTALLATION: THE CONTRACTOR SHALL BE RESPONSIBLE FOR THE PROPER INSTALLATION AND WORKMANSHIP OF THE IRRIGATION SYSTEM. THE CONTRACTOR SHALL BE RESPONSIBLE FOR OBTAINING ALL NECESSARY PERMITS AND APPROVALS FROM THE APPROPRIATE AGENCIES.

F. CLEANUP: THE CONTRACTOR SHALL BE RESPONSIBLE FOR THE PROPER CLEANUP AND REMOVAL OF ALL DEBRIS AND WASTE MATERIALS FROM THE PROJECT SITE. THE CONTRACTOR SHALL BE RESPONSIBLE FOR OBTAINING ALL NECESSARY PERMITS AND APPROVALS FROM THE APPROPRIATE AGENCIES.

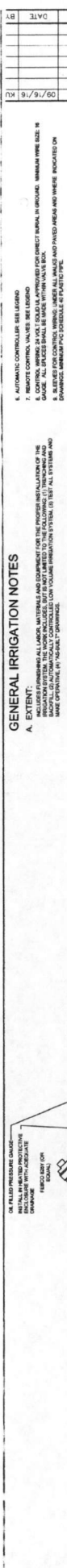

Tee-Line® CV CENTER FEED LAYOUT
 N.T.S.



Tee-Line® CV CENTER FEED LAYOUT
 N.T.S.



Tee-Line® CV CENTER FEED LAYOUT
 N.T.S.



Tee-Line® CV CENTER FEED LAYOUT
 N.T.S.



Tee-Line® CV CENTER FEED LAYOUT
 N.T.S.



Tee-Line® CV CENTER FEED LAYOUT
 N.T.S.

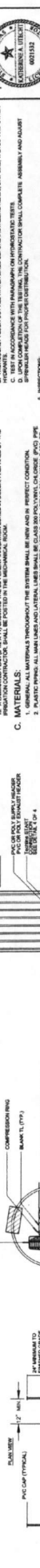

Tee-Line® CV CENTER FEED LAYOUT
 N.T.S.



Tee-Line® CV CENTER FEED LAYOUT
 N.T.S.

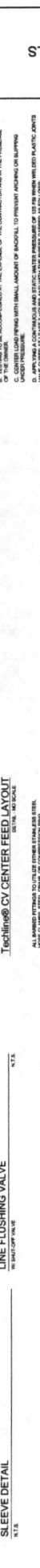

Tee-Line® CV CENTER FEED LAYOUT
 N.T.S.

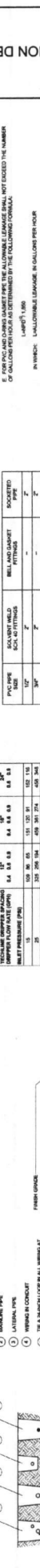

Tee-Line® CV CENTER FEED LAYOUT
 N.T.S.



Tee-Line® CV CENTER FEED LAYOUT
 N.T.S.



Tee-Line® CV CENTER FEED LAYOUT
 N.T.S.

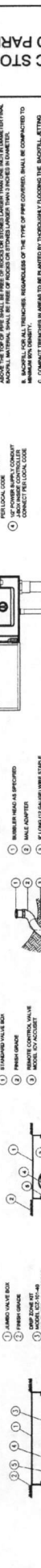

Tee-Line® CV CENTER FEED LAYOUT
 N.T.S.

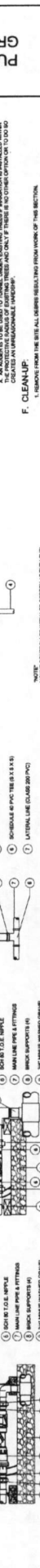

Tee-Line® CV CENTER FEED LAYOUT
 N.T.S.



Tee-Line® CV CENTER FEED LAYOUT
 N.T.S.



Tee-Line® CV CENTER FEED LAYOUT
 N.T.S.

GENERAL IRRIGATION NOTES

A. EXTENT: THE CONTRACTOR SHALL PROVIDE MATERIALS AND LABOR NECESSARY FOR THE PROPER INSTALLATION OF THE IRRIGATION SYSTEM AS SHOWN ON THE WORKSHEETS. THE WORK SHALL BE LIMITED TO THE FOLLOWING: (1) TRENCHING AND INSTALLATION OF ALL IRRIGATION PIPING AND FITTINGS; (2) INSTALLATION OF ALL IRRIGATION VALVES, CONTROLLERS, AND OTHER EQUIPMENT; (3) TESTING AND COMMISSIONING OF THE IRRIGATION SYSTEM. THE CONTRACTOR SHALL BE RESPONSIBLE FOR OBTAINING ALL NECESSARY PERMITS AND APPROVALS FROM THE APPROPRIATE AGENCIES.

B. GENERAL: THE CONTRACTOR SHALL BE RESPONSIBLE FOR OBTAINING ALL NECESSARY PERMITS AND APPROVALS FROM THE APPROPRIATE AGENCIES. THE CONTRACTOR SHALL BE RESPONSIBLE FOR OBTAINING ALL NECESSARY PERMITS AND APPROVALS FROM THE APPROPRIATE AGENCIES. THE CONTRACTOR SHALL BE RESPONSIBLE FOR OBTAINING ALL NECESSARY PERMITS AND APPROVALS FROM THE APPROPRIATE AGENCIES.

C. MATERIALS: ALL MATERIALS SHALL BE OF THE HIGHEST QUALITY AND SHALL BE SUBJECT TO INSPECTION AND TESTING BY THE CONTRACTOR. THE CONTRACTOR SHALL BE RESPONSIBLE FOR OBTAINING ALL NECESSARY PERMITS AND APPROVALS FROM THE APPROPRIATE AGENCIES.

D. WORKMANSHIP: THE CONTRACTOR SHALL BE RESPONSIBLE FOR THE PROPER INSTALLATION AND WORKMANSHIP OF THE IRRIGATION SYSTEM. THE CONTRACTOR SHALL BE RESPONSIBLE FOR OBTAINING ALL NECESSARY PERMITS AND APPROVALS FROM THE APPROPRIATE AGENCIES.

E. INSTALLATION: THE CONTRACTOR SHALL BE RESPONSIBLE FOR THE PROPER INSTALLATION AND WORKMANSHIP OF THE IRRIGATION SYSTEM. THE CONTRACTOR SHALL BE RESPONSIBLE FOR OBTAINING ALL NECESSARY PERMITS AND APPROVALS FROM THE APPROPRIATE AGENCIES.

F. CLEANUP: THE CONTRACTOR SHALL BE RESPONSIBLE FOR THE PROPER CLEANUP AND REMOVAL OF ALL DEBRIS AND WASTE MATERIALS FROM THE PROJECT SITE. THE CONTRACTOR SHALL BE RESPONSIBLE FOR OBTAINING ALL NECESSARY PERMITS AND APPROVALS FROM THE APPROPRIATE AGENCIES.

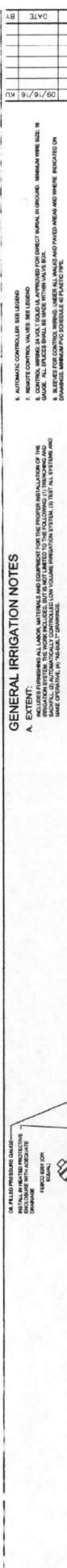

Tee-Line® CV CENTER FEED LAYOUT
 N.T.S.



Tee-Line® CV CENTER FEED LAYOUT
 N.T.S.



Tee-Line® CV CENTER FEED LAYOUT
 N.T.S.



Tee-Line® CV CENTER FEED LAYOUT
 N.T.S.



Tee-Line® CV CENTER FEED LAYOUT
 N.T.S.



Tee-Line® CV CENTER FEED LAYOUT
 N.T.S.



Tee-Line® CV CENTER FEED LAYOUT
 N.T.S.



Tee-Line® CV CENTER FEED LAYOUT
 N.T.S.

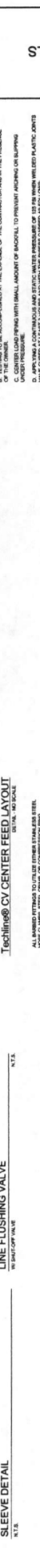

Tee-Line® CV CENTER FEED LAYOUT
 N.T.S.

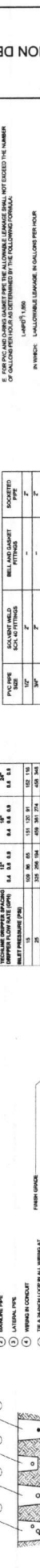

Tee-Line® CV CENTER FEED LAYOUT
 N.T.S.



Tee-Line® CV CENTER FEED LAYOUT
 N.T.S.



Tee-Line® CV CENTER FEED LAYOUT
 N.T.S.

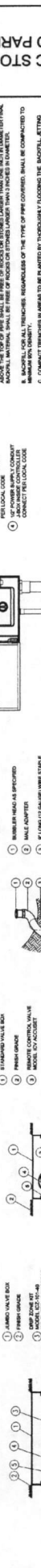

Tee-Line® CV CENTER FEED LAYOUT
 N.T.S.

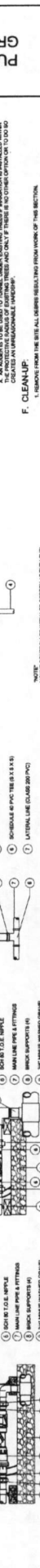

Tee-Line® CV CENTER FEED LAYOUT
 N.T.S.



Tee-Line® CV CENTER FEED LAYOUT
 N.T.S.



Tee-Line® CV CENTER FEED LAYOUT
 N.T.S.

NO.	REVISIONS	DATE
1	ADDITIONAL NO. 1	09/15/16

15012 WICKENBURG LANE, SUITE 200, HOUSTON, TX 77079
 WWW.KIMLEY-HORN.COM
 PHONE: 281-297-8300
 FAX: 281-297-8300
Kimley-Horn



KHA PROJECT
 09/13/2016
 DATE
 SCALE AS SHOWN
 DESIGNED BY RCP
 CHECKED BY RCP
 DRAWN BY RCP
 PROJECT NO. 15012

LANDSCAPE PLANS

PUBLIC STORAGE GRAND PARKWAY

SHEET NUMBER
1.10

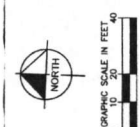

CODE	CITY	BOTANICAL NAME	COMMON NAME	CODE	GAUGE	SIZE	MATURE SIZE	REMARKS
Q1	2	CARYALLANDESSIS	PECAN	B & B	4" CAL.	6-10' H X 5'-6" W	10' H X 10' W	SINGLE LEADER, FULL AND MATCHING
U1	3	LAGERSTROEMIA INDOCA	CRAPPE MYRTLE	B & B	1-1/2" CAL.	6-8' H X 3'-4" W	25' H X 15' W	MULTI STEM SYSTEM, FULL AND MATCHING
U2	3	LOQUETUM JAPONICUM	WAX LEAF LOGANSTRUM	B & B	1-1/2" CAL.	6-8' H X 3'-4" W	10' H X 6' W	MULTI STEM SYSTEM, FULL AND MATCHING
QV1	11	QUERCUS VIRGINIANA	SOUTHERN LIVE OAK	B & B	4" CAL.	5-10' H X 5'-8" W	50' H X 50' W	SINGLE LEADER, FULL AND MATCHING
R1	10A	RHAMNULFERS INDOCA	INDIAN HAWTHORN	CODE	SPACING	SIZE	REMARKS	
					10.0 CAL. 30' O.C.	24" H X 24" W	4' H X 4' W	FULL AND MATCHING, WINDY SPECIES, PREVIOUSLY DEVELOPMENT
DO			DECOMPOSED GRANITE					SEE DET. L SHEET L2.0

LANDSCAPE REGULATIONS - ARCHITECTURAL CONTROL GUIDELINES FOR WATERSEIDE ESTATES PROJ.

REQ.	PROV.
LANDSCAPE SETBACKS ARE REQUIRED ALONG MAJOR STREETS AND ALONG THE CURB TO THE REAR OF THE LANDSCAPE EASEMENT IF NOT CONSISTENT WITH EXISTING LANDSCAPED THROUGHFARE PER ILLUSTRATION A-5.	YES
LANDSCAPE SETBACKS ALONG MINOR STREETS ARE MIN. OF 10'.	YES
A LANDSCAPE BUFFER OF NO LESS THAN 4' WIDE MUST BE PROVIDED ADJACENT TO ALL SIDEWAYS AND DRIVEWAYS PRESENTED AS PART OF A COORDINATED DEVELOPMENT PER ILLUSTRATION A-12.	YES
NO BUFFER OF NO LESS THAN 4' WIDE MUST BE PROVIDED ADJACENT TO PROPERTY LINES ADJOINING EXISTING OR PROPOSED COMMERCIAL PER ILLUSTRATION A-11.	YES
DISTANCE BETWEEN LANDSCAPE TREEWELLS SHALL BE A MINIMUM OF 10' FROM A TREE.	YES
LANDSCAPE EASEMENTS SHALL BE SCREENED FROM VIEW BY PLANTING PLACED OUTSIDE THE LANDSCAPE EASEMENT.	YES

NOTE: TREES ARE NOT PROVIDED DUE TO SITE CONSTRAINTS AND PREVIOUS CONVERSATIONS WITH A.R.C.

PLANTING SHALL BE IN ACCORDANCE WITH THE LANDSCAPE SETBACKS AND SCREENING REQUIREMENTS.

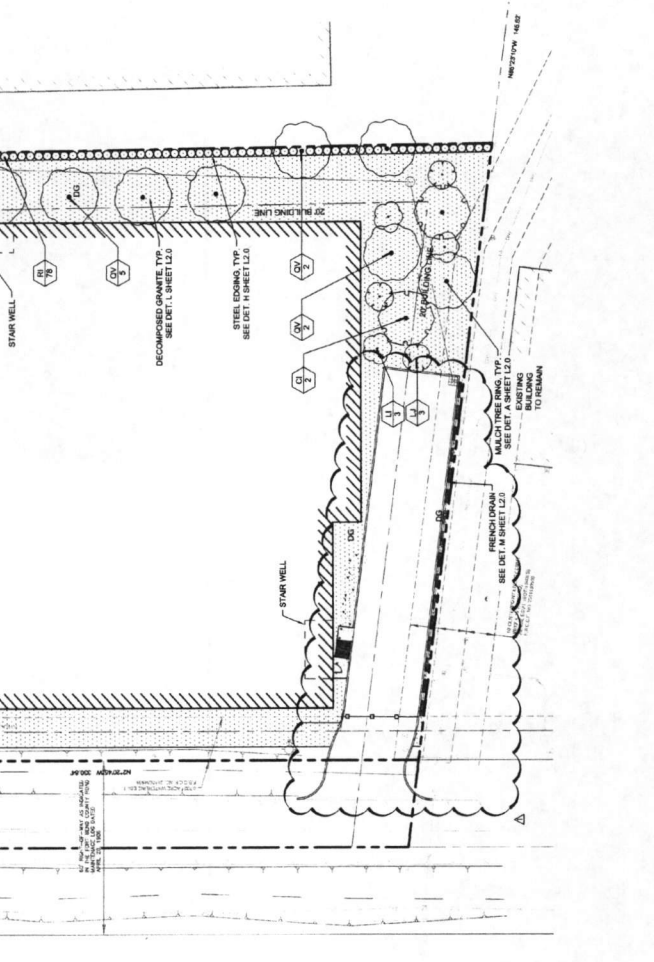

CONTRACTOR TO REPAIR DISTURBED AREA WITH SOIL TO MATCH EXISTING.

EXISTING DISTURBED AREA TO REMAIN TO REMAIN.

EXISTING DISTURBED AREA TO REMAIN TO REMAIN.

EXISTING DISTURBED AREA TO REMAIN TO REMAIN.

EXISTING DISTURBED AREA TO REMAIN TO REMAIN.

CAUTION!
 EXISTING UNDERGROUND UTILITIES IN THE AREA CONTRACTOR IS RESPONSIBLE FOR DETERMINING THE HORIZONTAL AND VERTICAL LOCATION OF CONTRACTOR SHALL BE RESPONSIBLE FOR ANY REPAIRS TO EXISTING UTILITIES DUE TO DAMAGE INCURRED BY CONTRACTOR. CONTRACTOR SHALL NOTIFY THE ENGINEER OF ANY DISCREPANCIES ON THE PLANS.



Know what's below.
 Call before you dig.

DATE
 03/27/16
 FORT BEND COUNTY DEVELOPMENT COORDINATOR

Mary D. ...

DATE	REVISIONS

12012 WOODCHURCH LANE, SUITE 500, HOUSTON, TX 77079
 © 2016 KIMLEY-HORN AND ASSOCIATES, INC.
 WMA 01617-1-HORN-CORP
 TIRE TRAIL REGISTRATION # 2-928

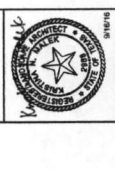

PROJECT NO.	08-191605
DATE	SEP 2016
SCALE	AS SHOWN
DESIGNED BY	WPC
DRAWN BY	WPC
CHECKED BY	KHA

LANDSCAPE SPECIFICATIONS

PUBLIC STORAGE GRAND PARKWAY

SHEET NUMBER **L3.0**

DATE **10/26/16**

FORT BEND COUNTY DEVELOPMENT COORDINATOR

GENERAL LANDSCAPE SPECIFICATIONS AND NOTES

A. SCOPE OF WORK
 1. TRANSPORT, UNLOAD, STORE, FURNISH, AND MAINTAIN ALL MATERIALS, EQUIPMENT, TOOLS, AND SUPPLIES NECESSARY FOR THE COMPLETION OF THE LANDSCAPE WORK SHOWN ON THE DRAWINGS. AS INDICATED IN THE PLANT LIST, THE CONTRACTOR SHALL BE RESPONSIBLE FOR THE PROTECTION OF EXISTING UTILITIES AND THE MAINTENANCE AND WATERING OF ALL CONTRACT PLANTING AREAS.

B. PROTECTION OF EXISTING UTILITIES
 1. ALL EXISTING UTILITIES SHALL BE PROTECTED AND MAINTAINED THROUGHOUT THE CONSTRUCTION PERIOD. THE CONTRACTOR SHALL BE RESPONSIBLE FOR THE PROTECTION OF EXISTING UTILITIES AND THE MAINTENANCE AND WATERING OF ALL CONTRACT PLANTING AREAS. DAMAGE TO EXISTING UTILITIES SHALL BE REPAIRED OR REPLACED TO THE SATISFACTION OF THE OWNER. AT NO TIME SHALL THE CONTRACTOR BE RESPONSIBLE FOR THE PROTECTION OF EXISTING UTILITIES.

C. PROTECTION OF EXISTING PLANT MATERIALS
 1. THE CONTRACTOR SHALL BE RESPONSIBLE FOR THE PROTECTION OF ALL EXISTING PLANT MATERIALS, TREES, AND SHRUBS. THE CONTRACTOR SHALL BE RESPONSIBLE FOR THE PROTECTION OF EXISTING PLANT MATERIALS AND THE MAINTENANCE AND WATERING OF ALL CONTRACT PLANTING AREAS. DAMAGE TO EXISTING PLANT MATERIALS SHALL BE REPAIRED OR REPLACED TO THE SATISFACTION OF THE OWNER. AT NO TIME SHALL THE CONTRACTOR BE RESPONSIBLE FOR THE PROTECTION OF EXISTING PLANT MATERIALS.

D. MATERIALS
 1. GENERAL
 MATERIALS LISTED BELOW SHALL BE SUBMITTED FOR APPROVAL UPON SUBMITTALS. ALL MATERIALS SHALL BE OF THE HIGHEST QUALITY AND SHALL BE SUBMITTED TO THE OWNER FOR APPROVAL. THE CONTRACTOR SHALL BE RESPONSIBLE FOR THE PROTECTION OF EXISTING UTILITIES AND THE MAINTENANCE AND WATERING OF ALL CONTRACT PLANTING AREAS. DAMAGE TO EXISTING UTILITIES SHALL BE REPAIRED OR REPLACED TO THE SATISFACTION OF THE OWNER. AT NO TIME SHALL THE CONTRACTOR BE RESPONSIBLE FOR THE PROTECTION OF EXISTING UTILITIES.

2. SOIL MIXTURE SHALL BE AS SPECIFIED IN SECTION E OF THESE SPECIFICATIONS.
 3. TREES AND SHRUBS SHALL BE SET STRAIGHT AT AN ELEVATION THAT, AFTER PLANTING, THE TOP OF THE TRUNK SHALL BE IN THE CENTER OF THE PIT. PLANTING SOIL MIXTURE SHALL BE EMPLOYED THOROUGHLY TAMPED AROUND THE HILL AND SETTLED BY WATER AFTER PLANTING.
 4. PROTECTION OF PAIRS (IF APPLICABLE) ONLY A MAXIMUM OF FIVE (5) FEET FROM THE TRUNK SHALL BE BRANCHED AFTER THE HILL OF FRONDS HAS BEEN REMOVED. BRANCHED FRONDS SHALL BE BRANCHED AFTER THE HILL OF FRONDS HAS BEEN REMOVED. BRANCHED FRONDS SHALL BE BRANCHED AFTER THE HILL OF FRONDS HAS BEEN REMOVED. BRANCHED FRONDS SHALL BE BRANCHED AFTER THE HILL OF FRONDS HAS BEEN REMOVED.
 5. EXCAVATION OF PITS SHALL BE PERFORMED USING EXTREME CARE TO AVOID UNDERMINING EXISTING UTILITIES. EXCAVATION SHALL BE PERFORMED USING EXTREME CARE TO AVOID UNDERMINING EXISTING UTILITIES. EXCAVATION SHALL BE PERFORMED USING EXTREME CARE TO AVOID UNDERMINING EXISTING UTILITIES. EXCAVATION SHALL BE PERFORMED USING EXTREME CARE TO AVOID UNDERMINING EXISTING UTILITIES.
 6. PLANTING MATERIALS SHALL BE HEALTHY, VIGOROUS, WELL-ROOTED PLANTS. PLANTING MATERIALS SHALL BE HEALTHY, VIGOROUS, WELL-ROOTED PLANTS. PLANTING MATERIALS SHALL BE HEALTHY, VIGOROUS, WELL-ROOTED PLANTS. PLANTING MATERIALS SHALL BE HEALTHY, VIGOROUS, WELL-ROOTED PLANTS.
 7. MEASUREMENTS SHALL BE TAKEN AT THE POINT OF PLANTING. MEASUREMENTS SHALL BE TAKEN AT THE POINT OF PLANTING. MEASUREMENTS SHALL BE TAKEN AT THE POINT OF PLANTING. MEASUREMENTS SHALL BE TAKEN AT THE POINT OF PLANTING.
 8. PLANTING MATERIALS SHALL BE SUBMITTED TO THE OWNER FOR APPROVAL. PLANTING MATERIALS SHALL BE SUBMITTED TO THE OWNER FOR APPROVAL. PLANTING MATERIALS SHALL BE SUBMITTED TO THE OWNER FOR APPROVAL. PLANTING MATERIALS SHALL BE SUBMITTED TO THE OWNER FOR APPROVAL.
 9. PLANTING MATERIALS SHALL BE SUBMITTED TO THE OWNER FOR APPROVAL. PLANTING MATERIALS SHALL BE SUBMITTED TO THE OWNER FOR APPROVAL. PLANTING MATERIALS SHALL BE SUBMITTED TO THE OWNER FOR APPROVAL. PLANTING MATERIALS SHALL BE SUBMITTED TO THE OWNER FOR APPROVAL.
 10. PLANTING MATERIALS SHALL BE SUBMITTED TO THE OWNER FOR APPROVAL. PLANTING MATERIALS SHALL BE SUBMITTED TO THE OWNER FOR APPROVAL. PLANTING MATERIALS SHALL BE SUBMITTED TO THE OWNER FOR APPROVAL. PLANTING MATERIALS SHALL BE SUBMITTED TO THE OWNER FOR APPROVAL.

11. PLANTING MATERIALS SHALL BE SUBMITTED TO THE OWNER FOR APPROVAL. PLANTING MATERIALS SHALL BE SUBMITTED TO THE OWNER FOR APPROVAL. PLANTING MATERIALS SHALL BE SUBMITTED TO THE OWNER FOR APPROVAL. PLANTING MATERIALS SHALL BE SUBMITTED TO THE OWNER FOR APPROVAL.
 12. PLANTING MATERIALS SHALL BE SUBMITTED TO THE OWNER FOR APPROVAL. PLANTING MATERIALS SHALL BE SUBMITTED TO THE OWNER FOR APPROVAL. PLANTING MATERIALS SHALL BE SUBMITTED TO THE OWNER FOR APPROVAL. PLANTING MATERIALS SHALL BE SUBMITTED TO THE OWNER FOR APPROVAL.
 13. PLANTING MATERIALS SHALL BE SUBMITTED TO THE OWNER FOR APPROVAL. PLANTING MATERIALS SHALL BE SUBMITTED TO THE OWNER FOR APPROVAL. PLANTING MATERIALS SHALL BE SUBMITTED TO THE OWNER FOR APPROVAL. PLANTING MATERIALS SHALL BE SUBMITTED TO THE OWNER FOR APPROVAL.
 14. PLANTING MATERIALS SHALL BE SUBMITTED TO THE OWNER FOR APPROVAL. PLANTING MATERIALS SHALL BE SUBMITTED TO THE OWNER FOR APPROVAL. PLANTING MATERIALS SHALL BE SUBMITTED TO THE OWNER FOR APPROVAL. PLANTING MATERIALS SHALL BE SUBMITTED TO THE OWNER FOR APPROVAL.
 15. PLANTING MATERIALS SHALL BE SUBMITTED TO THE OWNER FOR APPROVAL. PLANTING MATERIALS SHALL BE SUBMITTED TO THE OWNER FOR APPROVAL. PLANTING MATERIALS SHALL BE SUBMITTED TO THE OWNER FOR APPROVAL. PLANTING MATERIALS SHALL BE SUBMITTED TO THE OWNER FOR APPROVAL.
 16. PLANTING MATERIALS SHALL BE SUBMITTED TO THE OWNER FOR APPROVAL. PLANTING MATERIALS SHALL BE SUBMITTED TO THE OWNER FOR APPROVAL. PLANTING MATERIALS SHALL BE SUBMITTED TO THE OWNER FOR APPROVAL. PLANTING MATERIALS SHALL BE SUBMITTED TO THE OWNER FOR APPROVAL.
 17. PLANTING MATERIALS SHALL BE SUBMITTED TO THE OWNER FOR APPROVAL. PLANTING MATERIALS SHALL BE SUBMITTED TO THE OWNER FOR APPROVAL. PLANTING MATERIALS SHALL BE SUBMITTED TO THE OWNER FOR APPROVAL. PLANTING MATERIALS SHALL BE SUBMITTED TO THE OWNER FOR APPROVAL.
 18. PLANTING MATERIALS SHALL BE SUBMITTED TO THE OWNER FOR APPROVAL. PLANTING MATERIALS SHALL BE SUBMITTED TO THE OWNER FOR APPROVAL. PLANTING MATERIALS SHALL BE SUBMITTED TO THE OWNER FOR APPROVAL. PLANTING MATERIALS SHALL BE SUBMITTED TO THE OWNER FOR APPROVAL.
 19. PLANTING MATERIALS SHALL BE SUBMITTED TO THE OWNER FOR APPROVAL. PLANTING MATERIALS SHALL BE SUBMITTED TO THE OWNER FOR APPROVAL. PLANTING MATERIALS SHALL BE SUBMITTED TO THE OWNER FOR APPROVAL. PLANTING MATERIALS SHALL BE SUBMITTED TO THE OWNER FOR APPROVAL.
 20. PLANTING MATERIALS SHALL BE SUBMITTED TO THE OWNER FOR APPROVAL. PLANTING MATERIALS SHALL BE SUBMITTED TO THE OWNER FOR APPROVAL. PLANTING MATERIALS SHALL BE SUBMITTED TO THE OWNER FOR APPROVAL. PLANTING MATERIALS SHALL BE SUBMITTED TO THE OWNER FOR APPROVAL.

21. PLANTING MATERIALS SHALL BE SUBMITTED TO THE OWNER FOR APPROVAL. PLANTING MATERIALS SHALL BE SUBMITTED TO THE OWNER FOR APPROVAL. PLANTING MATERIALS SHALL BE SUBMITTED TO THE OWNER FOR APPROVAL. PLANTING MATERIALS SHALL BE SUBMITTED TO THE OWNER FOR APPROVAL.
 22. PLANTING MATERIALS SHALL BE SUBMITTED TO THE OWNER FOR APPROVAL. PLANTING MATERIALS SHALL BE SUBMITTED TO THE OWNER FOR APPROVAL. PLANTING MATERIALS SHALL BE SUBMITTED TO THE OWNER FOR APPROVAL. PLANTING MATERIALS SHALL BE SUBMITTED TO THE OWNER FOR APPROVAL.
 23. PLANTING MATERIALS SHALL BE SUBMITTED TO THE OWNER FOR APPROVAL. PLANTING MATERIALS SHALL BE SUBMITTED TO THE OWNER FOR APPROVAL. PLANTING MATERIALS SHALL BE SUBMITTED TO THE OWNER FOR APPROVAL. PLANTING MATERIALS SHALL BE SUBMITTED TO THE OWNER FOR APPROVAL.
 24. PLANTING MATERIALS SHALL BE SUBMITTED TO THE OWNER FOR APPROVAL. PLANTING MATERIALS SHALL BE SUBMITTED TO THE OWNER FOR APPROVAL. PLANTING MATERIALS SHALL BE SUBMITTED TO THE OWNER FOR APPROVAL. PLANTING MATERIALS SHALL BE SUBMITTED TO THE OWNER FOR APPROVAL.
 25. PLANTING MATERIALS SHALL BE SUBMITTED TO THE OWNER FOR APPROVAL. PLANTING MATERIALS SHALL BE SUBMITTED TO THE OWNER FOR APPROVAL. PLANTING MATERIALS SHALL BE SUBMITTED TO THE OWNER FOR APPROVAL. PLANTING MATERIALS SHALL BE SUBMITTED TO THE OWNER FOR APPROVAL.
 26. PLANTING MATERIALS SHALL BE SUBMITTED TO THE OWNER FOR APPROVAL. PLANTING MATERIALS SHALL BE SUBMITTED TO THE OWNER FOR APPROVAL. PLANTING MATERIALS SHALL BE SUBMITTED TO THE OWNER FOR APPROVAL. PLANTING MATERIALS SHALL BE SUBMITTED TO THE OWNER FOR APPROVAL.
 27. PLANTING MATERIALS SHALL BE SUBMITTED TO THE OWNER FOR APPROVAL. PLANTING MATERIALS SHALL BE SUBMITTED TO THE OWNER FOR APPROVAL. PLANTING MATERIALS SHALL BE SUBMITTED TO THE OWNER FOR APPROVAL. PLANTING MATERIALS SHALL BE SUBMITTED TO THE OWNER FOR APPROVAL.
 28. PLANTING MATERIALS SHALL BE SUBMITTED TO THE OWNER FOR APPROVAL. PLANTING MATERIALS SHALL BE SUBMITTED TO THE OWNER FOR APPROVAL. PLANTING MATERIALS SHALL BE SUBMITTED TO THE OWNER FOR APPROVAL. PLANTING MATERIALS SHALL BE SUBMITTED TO THE OWNER FOR APPROVAL.
 29. PLANTING MATERIALS SHALL BE SUBMITTED TO THE OWNER FOR APPROVAL. PLANTING MATERIALS SHALL BE SUBMITTED TO THE OWNER FOR APPROVAL. PLANTING MATERIALS SHALL BE SUBMITTED TO THE OWNER FOR APPROVAL. PLANTING MATERIALS SHALL BE SUBMITTED TO THE OWNER FOR APPROVAL.
 30. PLANTING MATERIALS SHALL BE SUBMITTED TO THE OWNER FOR APPROVAL. PLANTING MATERIALS SHALL BE SUBMITTED TO THE OWNER FOR APPROVAL. PLANTING MATERIALS SHALL BE SUBMITTED TO THE OWNER FOR APPROVAL. PLANTING MATERIALS SHALL BE SUBMITTED TO THE OWNER FOR APPROVAL.

31. PLANTING MATERIALS SHALL BE SUBMITTED TO THE OWNER FOR APPROVAL. PLANTING MATERIALS SHALL BE SUBMITTED TO THE OWNER FOR APPROVAL. PLANTING MATERIALS SHALL BE SUBMITTED TO THE OWNER FOR APPROVAL. PLANTING MATERIALS SHALL BE SUBMITTED TO THE OWNER FOR APPROVAL.
 32. PLANTING MATERIALS SHALL BE SUBMITTED TO THE OWNER FOR APPROVAL. PLANTING MATERIALS SHALL BE SUBMITTED TO THE OWNER FOR APPROVAL. PLANTING MATERIALS SHALL BE SUBMITTED TO THE OWNER FOR APPROVAL. PLANTING MATERIALS SHALL BE SUBMITTED TO THE OWNER FOR APPROVAL.
 33. PLANTING MATERIALS SHALL BE SUBMITTED TO THE OWNER FOR APPROVAL. PLANTING MATERIALS SHALL BE SUBMITTED TO THE OWNER FOR APPROVAL. PLANTING MATERIALS SHALL BE SUBMITTED TO THE OWNER FOR APPROVAL. PLANTING MATERIALS SHALL BE SUBMITTED TO THE OWNER FOR APPROVAL.
 34. PLANTING MATERIALS SHALL BE SUBMITTED TO THE OWNER FOR APPROVAL. PLANTING MATERIALS SHALL BE SUBMITTED TO THE OWNER FOR APPROVAL. PLANTING MATERIALS SHALL BE SUBMITTED TO THE OWNER FOR APPROVAL. PLANTING MATERIALS SHALL BE SUBMITTED TO THE OWNER FOR APPROVAL.
 35. PLANTING MATERIALS SHALL BE SUBMITTED TO THE OWNER FOR APPROVAL. PLANTING MATERIALS SHALL BE SUBMITTED TO THE OWNER FOR APPROVAL. PLANTING MATERIALS SHALL BE SUBMITTED TO THE OWNER FOR APPROVAL. PLANTING MATERIALS SHALL BE SUBMITTED TO THE OWNER FOR APPROVAL.

TRAFFIC CONTROL PLAN FOR DRIVEWAY CONSTRUCTION

EXISTING POSTED SPEED LIMIT = 45 MPH (FARMER ROAD)
 EXISTING POSTED SPEED LIMIT = 45 MPH (SH 99 FRONTAGE ROAD)

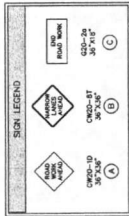
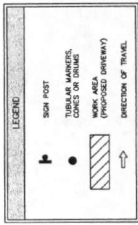
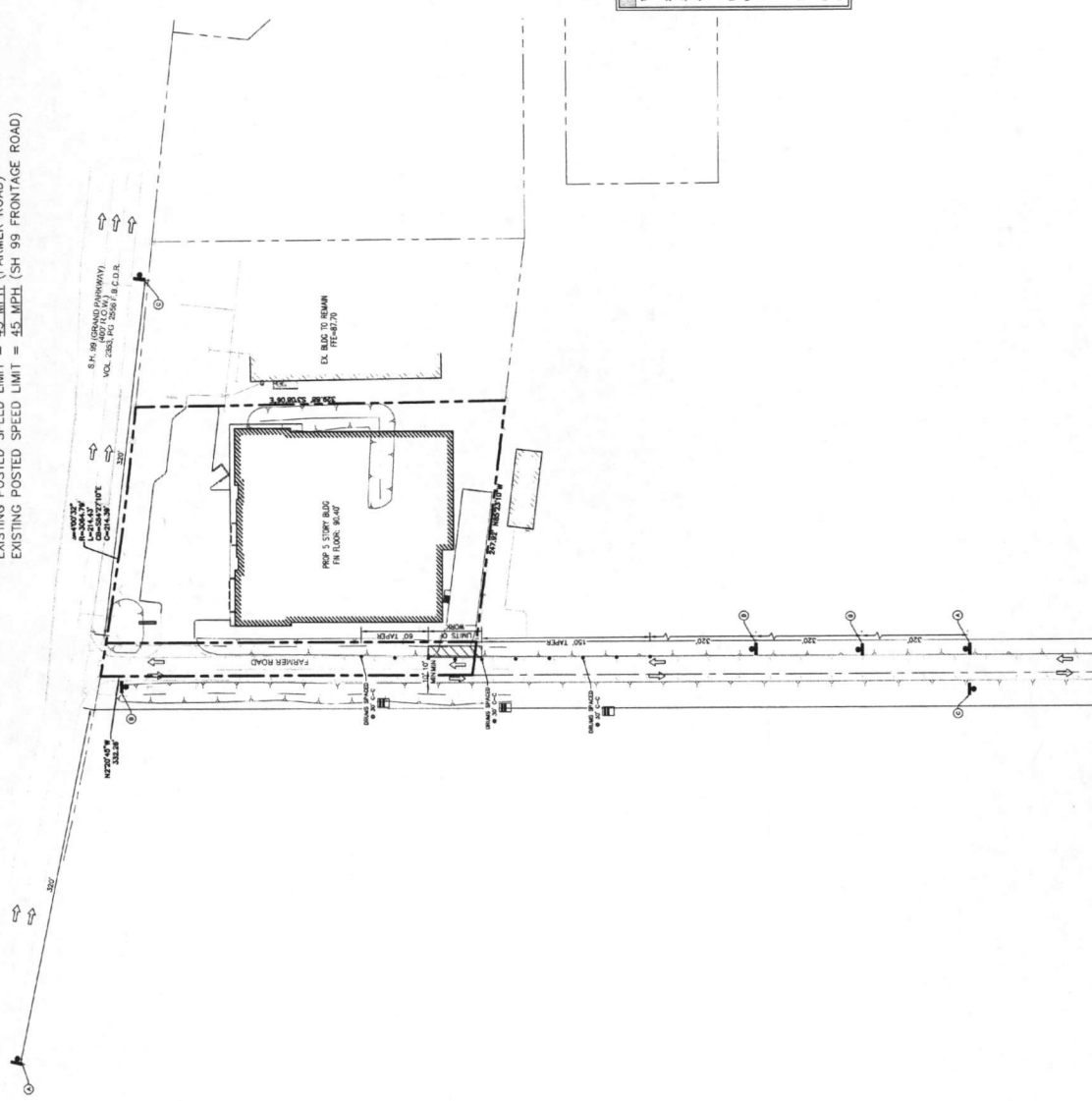
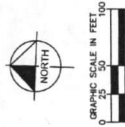

- TRAFFIC CONTROL PLAN NOTES**
- CONTRACTOR SHALL MAINTAIN THE SAME LEVEL OF PERFORMANCE WITH PART "A" OF THE TEXAS MANUAL ON UNIFORM TRAFFIC CONTROL DEVICES (TMUD)-LATEST EDITION WITH RELEVANT COUNTY CONSTRUCTION.
 - DUO TO TRAFFIC CONSTRAINTS, LANES SHALL BE CLOSED AT ALL TIMES DURING CONSTRUCTION WHICH WILL BE 24/7 TO OPERATE THE CONSTRUCTION.
 - OFF DUTY POLICE OFFICERS/PLANNERS ARE REQUIRED TO DIRECT TRAFFIC WHEN LANES ARE CLOSED.
 - CONTRACTOR SHALL COVER THE EXCAVATION WITH STEEL PLATES INCHOSED PROPERLY DURING NON-WORKING HOURS AND ALLOW NORMAL TRAFFIC FLOW OF CONSTRUCTION TRAFFIC TO PROCEED UNIMPACTED. THE CONTRACTOR SHALL MAINTAIN A MINIMUM OF 10 FEET CLEARANCE FROM THE EXCAVATION DURING NON-WORKING HOURS.
 - APPROVED COPIES OF "TRAFFIC CONTROL PLANS" SHALL BE AVAILABLE FOR INSPECTION AT ALL TIMES.
 - IF THE CONTRACTOR CHOOSES TO USE A DIFFERENT METHOD OF TRAFFIC CONTROL PLAN DURING THE CONSTRUCTION THAN WHAT IS OUTLINED IN THE MANUAL, THE CONTRACTOR SHALL SUBMIT AN ALTERNATE PLAN TO THE TRAFFIC SECTION OF THE TEXAS DEPARTMENT OF TRANSPORTATION (TxDOT) FOR APPROVAL. THE WORK SHALL BE IN ACCORDANCE WITH THE APPROVED PLAN.
 - THESE PLANS SHALL BE DRAWN TO SCALE ON REPRODUCTION PLAYS AND SEALED BY A LICENSED ENGINEER IN THE STATE OF TEXAS. PLANS WILL BECOME A PART OF THE CONTRACT DRAWINGS.
 - APPROVED COPIES OF THESE PLANS SHALL BE SUBMITTED TO THE TRAFFIC SECTION OF THE TEXAS DEPARTMENT OF TRANSPORTATION (TxDOT) PRIOR TO THE START OF CONSTRUCTION.
 - ANY EXISTING SIGNING OR STRIPING THAT IS IN CONFLICT WITH PROPOSED SIGNING OR STRIPING SHOWN ON THESE PLANS SHALL BE REMOVED.
 - THE CONTRACTOR SHALL PROVIDE ELECTRONIC MESSAGE BOARDS 1 WEEK PRIOR TO LANE CLOSURES IN ORDER TO NOTIFY THE PUBLIC.

Kimley-Horn
 11700 KATY FREEWAY, SUITE 800, HOUSTON, TX 77079
 PHONE: 281-551-2000
 WWW.KIMLEY-HORN.COM
 TYPE FIRM REGISTRATION F-828



PROJECT NO. 2017-001
 SCALE AS SHOWN
 DATE JAN 2017
 DESIGNED BY KRM
 DRAWN BY AB KRM
 CHECKED BY MRS
 TRAFFIC CONTROL PLAN

PUBLIC STORAGE
 GRAND PARKWAY
 SHEET NUMBER C3.1

APPROVED: _____
 Development Coordinator
 DATE: _____