

COUNTY JUDGE
Fort Bend County, Texas

Robert E. Hebert
County Judge

January 23, 2017

(281) 341-8608
Fax (281) 341-8609

Mr. Quincy Allen, P.E.
District Engineer, Houston District
Texas Department of Transportation
P.O. Box 1386
Houston, TX 77251-1386

Subject: ***Sponsorship
Public Road Connection (Right Turn Lane) at FM1093 Eastbound Frontage
Road at Grand Landing Blvd. within Grand Vista Lakes Development on behalf
of D. R. Horton***

Dear Mr. Allen:

Fort Bend County has received and reviewed a request from Jones & Carter, Inc. for Fort Bend County to sponsor a Texas Department of Transportation project on behalf of Grand Vista Development Company for a public road connection (right turn lane), at FM1093 Eastbound Frontage Road at Grand Landing Blvd. within the Grand Vista Lakes Development, at no cost to the County.

The request was approved by Fort Bend County Commissioners Court at our meeting on January 24, 2017. We request that a permit for the right turn lane be issued with Fort Bend County as sponsor for this project.

If there are any questions or need for additional information, please call Maggie Dalton, in our Engineering Department at telephone 281-633-7515.

Sincerely,
A handwritten signature in black ink, appearing to read "Robert E. Hebert", is written over the word "Sincerely,".

Robert E. Hebert
Fort Bend County Judge

Enclosures: Resolution
 Drawing

Copy: Mr. Adriana a. Teran, EIT, Jones & Carter, Inc.
 File

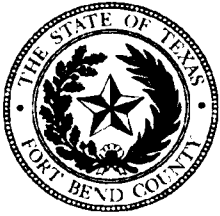

Fort Bend County Engineering
FORT BEND COUNTY, TEXAS

Richard W. Stolleis, P.E.
County Engineer

January 17, 2017

Judge Robert E. Hebert
Fort Bend County Judge
301 Jackson Street, Suite 719
Richmond, Texas 77406-0148

Re: *Public Road Connection (Right Turn Lane) at FM1093 Eastbound Frontage Road at Grand Landing Blvd. within Grand Vista Lakes Development on behalf of D. R. Horton -Sponsorship*

Honorable Judge Hebert:

Fort Bend County Engineering Department has received and reviewed a request (letters attached) from Jones & Carter, Inc., Inc. for Fort Bend County to sponsor a project for a public road connection (right turn lane), at FM1093 Eastbound Frontage Road at Grand Landing Blvd. within Grand Vista Lakes Development. The right turn lane will improve traffic flow along FM1093.

Any and all cost involved with the project will be borne by D. R. Horton Development. There will be no cost to Fort Bend County.

The Texas Department of Transportation request that an agency, such as Fort Bend County, act as a sponsor for the project. This means that the permit for the work will be issued in the name of Fort Bend County and the County accepts responsibility for the terms and conditions of the permit.

We recommend acceptance of the sponsorship and request that this item be placed on the 1/24/2017 Commissioner's Court agenda. We have prepared a letter to Texas Department of Transportation, for the County Judges' signature.

If there are any questions please do not hesitate to call.

Sincerely,

Maggie Dalton
Development Coordinator

Attachment: Scope of Work

cc: Mr. Roy Cordes, Jr. FBC Attorney
Commissioner Grady Prestage, Pct. 2
File

301 Jackson St., Suite 401, Richmond, TX 77469
Phone 281-633-7500

THE STATE OF TEXAS §

COUNTY OF FORT BEND §

**RESOLUTION TO SPONSOR A PROJECT FOR A PUBLIC ROAD CONNECTION
(RIGHT TURN LANE) AT FM1093 EASTBOUND FRONTAGE ROAD
AT GRAND LANDING BLVD. WITHIN GRAND VISTA LAKES DEVELOPMENT
ON BEHALF OF D. R. HORTON**

On this 24 day of January, 2017, the Commissioners Court, sitting as the governing body of Fort Bend County, Texas, at a regular meeting, upon motion of Commissioner Meyers, seconded by Commissioner Morales, duly put and carried;

WHEREAS, the proposed sponsorship project includes the installation of a public road connection (Right Turn Lane) at FM1093 Eastbound Frontage Road at Grand Landing Blvd. within the Grand Vista Lakes Development.

WHEREAS, the funding for such sponsorship of the project is to be provided through sources other than Fort Bend County.

NOW, THEREFORE, BE IT RESOLVED that Fort Bend County expresses its support and sponsorship of such project with the Texas Department of Transportation to cause such improvements to be made at FM1093 Eastbound Frontage Road at Grand Landing Blvd. within the Grand Vista Lakes Development.

FORT BEND COUNTY

By: _____

Robert E. Hebert, County Judge

ATTEST:

Laura Richard

Laura Richard, County Clerk

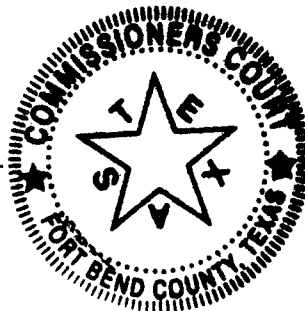



JONES | CARTER

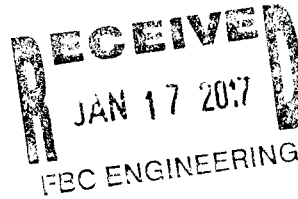

January 17, 2017

6330 West Loop South, Suite 150
Bellaire, Texas 77401
Tel: 713.777.5337
Fax: 713.777.5976
www.jonescarter.com

Honorable Robert E. Hebert
Fort Bend County Judge
301 Jackson Street, Suite 719
Richmond, Texas 77469

Re: Request for Sponsorship Letter
Proposed Street Tie-in at Eastbound FM 1093 Frontage Road
Grand Landing Boulevard for Grand Vista Lakes Development Phase 1
Fort Bend County, Texas
Jones & Carter, Inc. Job No. 14910-0004-00

Dear Judge Hebert:

Jones|Carter is preparing the street tie-in permit application to submit to the Texas Department of Transportation (TxDOT) for the proposed street tie-in of Grand Landing Boulevard at Eastbound FM 1093 Frontage Road. At the tie-in, Grand Landing Boulevard will be a right in/right out only, concrete paved roadway with a median, and curb and gutter drainage system. D.R. Horton-Texas, Ltd., the developer for the Grand Vista Lakes Development, will fund the cost of construction. There will be no expense to Fort Bend County. The attached construction plan drawings were prepared in accordance with TxDOT's street tie-in permit requirements.

As part of the permit application process, TxDOT is requiring a sponsorship letter from Fort Bend County. I am requesting Fort Bend County's sponsorship of this project and a sponsorship letter to include with the TxDOT permit application package.

Please contact me if you need further information or have any questions.

Sincerely,

Adriana A. Teran, E.I.T.

AAT/dch

K:\14910\14910-0004-00 Grand Vista Phase 1 Preliminary Engineer\Project Management\Deliverables
Attachments

CONSTRUCTION OF RIGHT TURN LANE ON FM 1093 EASTBOUND FRONTAGE ROAD IN FORT BEND COUNTY, TEXAS FOR DR HORTON

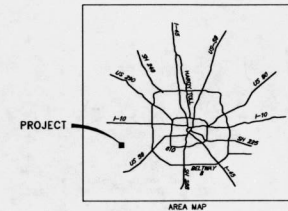

INDEX OF DRAWINGS

<u>SHEET</u>	<u>TITLE</u>
1	COVER SHEET & INDEX
2	TYPICAL CROSS SECTIONS EXISTING & PROPOSED
<u>PLAN & PROFILE</u>	
3	F.M. 1093 STA 893+00 TO 897+20
4	F.M. 1093 STA 897+20 TO 901+60
5	GRAND LANDING BLVD STA 22+82 TO 24+00
6	STORM SEWER LATERALS
<u>TITLE</u>	
6	STORM SEWER LATERALS
7	DRAINAGE CALCULATIONS
8	STORM WATER POLLUTION PREVENTION PLAN
9	TxDOT BARRICADE AND CONSTRUCTION GENERAL NOTES & REQUIREMENTS - BC(1)-14
10	TxDOT BARRICADE AND CONSTRUCTION PROJECT LIMIT - BC(2)-14
11	TxDOT BARRICADE AND CONSTRUCTION WORK ZONE SPEED LIMIT - BC(3)-14
12	TxDOT BARRICADE AND CONSTRUCTION TEMPORARY SIGN NOTES - BC(4)-14
13	TxDOT BARRICADE AND CONSTRUCTION TYPICAL SIGN SUPPORT - BC(5)-14
14	TxDOT BARRICADE AND CONSTRUCTION PORTABLE CHANGEABLE MESSAGE SIGN - BC(6)-14
15	TxDOT BARRICADE AND CONSTRUCTION ARROW PANEL, REFLECTORS, WARNING LIGHTS & ATTENUATOR - BC(7)-14
16	TxDOT BARRICADE AND CONSTRUCTION CHANNELIZING DEVICES - BC(8)-14
17	TxDOT BARRICADE AND CONSTRUCTION CHANNELIZING DEVICES - BC(9)-14
18	TxDOT BARRICADE AND CONSTRUCTION CHANNELIZING DEVICES - BC(10)-14
19	TxDOT BARRICADE AND CONSTRUCTION PAVEMENT MARKING - BC(11)-14
20	TxDOT BARRICADE AND CONSTRUCTION PAVEMENT MARKING PATTERNS - BC(12)-14
21	TxDOT TYPICAL STANDARD PAVEMENT MARKINGS - PM(1)-12
22	TxDOT POSITION GUIDANCE USING RAISED MARKERS REFLECTORIZED PROFILE MARKINGS - PM(2)-12
23	TxDOT PAVEMENT MARKINGS FOR TWO-WAY LEFT TURN LANES DIVIDED HIGHWAYS AND RURAL LEFT TURN BAYS - PM(3)-12
24	TxDOT TRAFFIC CONTROL PLAN ON MULTILANE CONVENTIONAL ROADS - TCP(2-4)-12
25	TEMPORARY EROSION, SEDIMENT AND WATER POLLUTION CONTROL MEASURES FEC & VERTICAL TRACKING - EC(1)-16
26	TEMPORARY EROSION, SEDIMENT AND WATER POLLUTION CONTROL MEASURES CONSTRUCTION EXITS - EC(6)-16
27	TxDOT STORM WATER POLLUTION PREVENTION PLAN SW3P - STD G-1
28	TxDOT FERTILIZER, SEED, SOD, STRAW, COMPOST, AND WATER - STD G-1
29	TxDOT CURB INLET TYPE C (WITH OR WITHOUT EXTENSION) - HIL-C
30	TxDOT CONCRETE CURB AND CURB AND GUTTER - CCGG-12
31.-32.	TxDOT CONTINUOUSLY REINFORCED CONCRETE PAVEMENT - ONE LAYER STEEL BAR PLACEMENT T-7 TO 13 INCHES SHEET 1 & SHEET 2
33.	TxDOT GUTTER DEPRESSION DETAILS FOR CURB INLETS - GD
34.-35.	TxDOT EXCAVATION AND BACKFILL DIAGRAMS - E&BD SHEET 1 & SHEET 2
36.	TxDOT MISCELLANEOUS SEWER DETAILS - MSD

FM 1093
EASTBOUND
RIGHT TURN
LANE

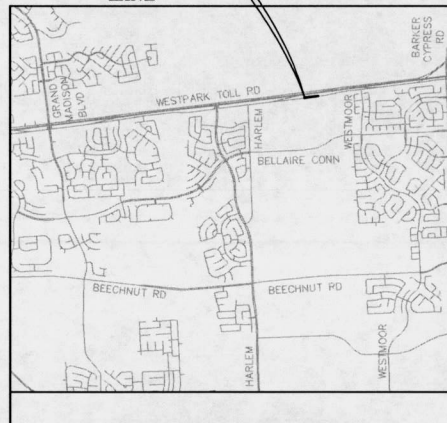

VICINITY MAP

Scale: 1" = 1 Mile

JANUARY 2017



JONES | CARTER
Texas Board of Professional Engineers Registration F-439
6330 West Loop South, Suite 150 • Bellaire, TX 77401 • 713.777.5337

DIG-TESS NOTIFICATION SYSTEM
CALL BEFORE YOU DIG!!!
www.digteess.org/
Texas0811 or 1-800-DIG-TESS
1-800-344-6377

RECEIVED
JAN 17 2017
FBC ENGINEERING



FM 1093 RIGHT TURN LANE FOR DR HORTON

JONES | CARTER
BELLARE, TEXAS

SHEET No.
1
OF 36

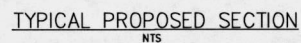
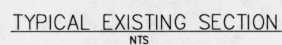

K:\14810\14810-0000-00 FM 1083 Right Turn Lane Grand Vista Lake\2 Design Phase\CAD\0 FM 1083 Right Turn Lane.dwg Jan 17, 2017 - 3:46pm dcl

BENCHMARK

ELEVATIONS SHOWN HEREON ARE BASED ON HARRIS COUNTY FLOODPLAIN REFERENCE MARK RM No. 210450, ELEVATION=88.41, NAVD 88, 2001 ADJUSTMENT. MONUMENT IS A BRASS DISC LOCATED IN THE CENTER OF THE HEADWALL ON THE WEST SIDE OF HARLEM ROAD, APPROXIMATELY 0.5 MILE SOUTH FROM THE INTERSECTION OF HARLEM ROAD AND FM 1093.

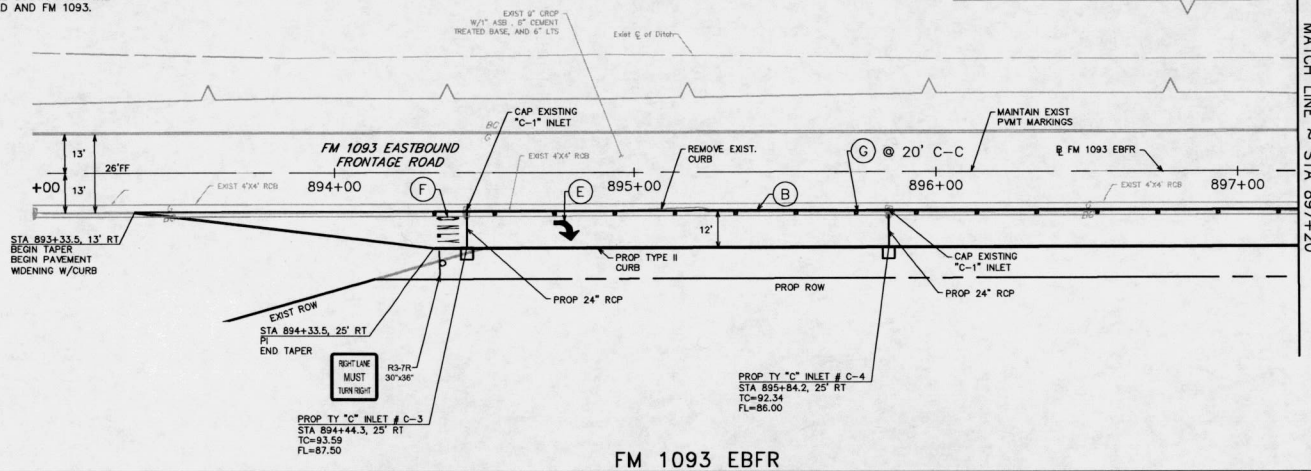

MATCH LINE ~ STA 897+20

PROPOSED PAVING LEGEND

- (A) REFL PAV MRK TY I (Y) (4 IN) (SLD)
- (B) REFL PAV MRK TY I (W) (8 IN) (SLD)
- (C) REFL PAV MRK TY I (Y) (24 IN) (SLD)
- (D) REFL PAV MRK TY I (W) (24 IN) (SLD)
- (E) REFL PAV MRK TY I (W) (ARROW)
- (F) REFL PAV MRK TY I (W) (WORD)
- (G) REFL PAV MRK TY I-C-R
- (H) REFL PAV MRK TY II-A-A

NOTE

- CONTRACTOR SHALL USE CARE TO MAKE AN OPENING IN THE WALL OF THE EXISTING INLET. THE OPENING SHALL NOT BE MORE THAN 3", NOR LESS THAN 1" GREATER IN DIAMETER THAN THE OUTSIDE DIAMETER OF THE PROPOSED PIPE. THE PROPOSED PIPE SHALL NOT PROTRUDE MORE THAN 3" PAST THE INSIDE FACE OF THE INLET WALL. FILL ENTIRE VOID AROUND THE PIPE WITH NON-SHRINK WATER PROOF GROUT. BACK FILL EXCAVATION AROUND EXISTING INLET WITH CEMENT STABILIZED SAND.
- CONTRACTOR SHALL DOWEL INTO THE SIDE OF EXISTING PAVEMENT W/ #6 REBARS AT 24" C-C AS PER TxDOT STANDARD CROP(1)-13.
- CONTROL POINT SHALL BE INLET CENTER AT FACE OF CURB.

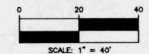
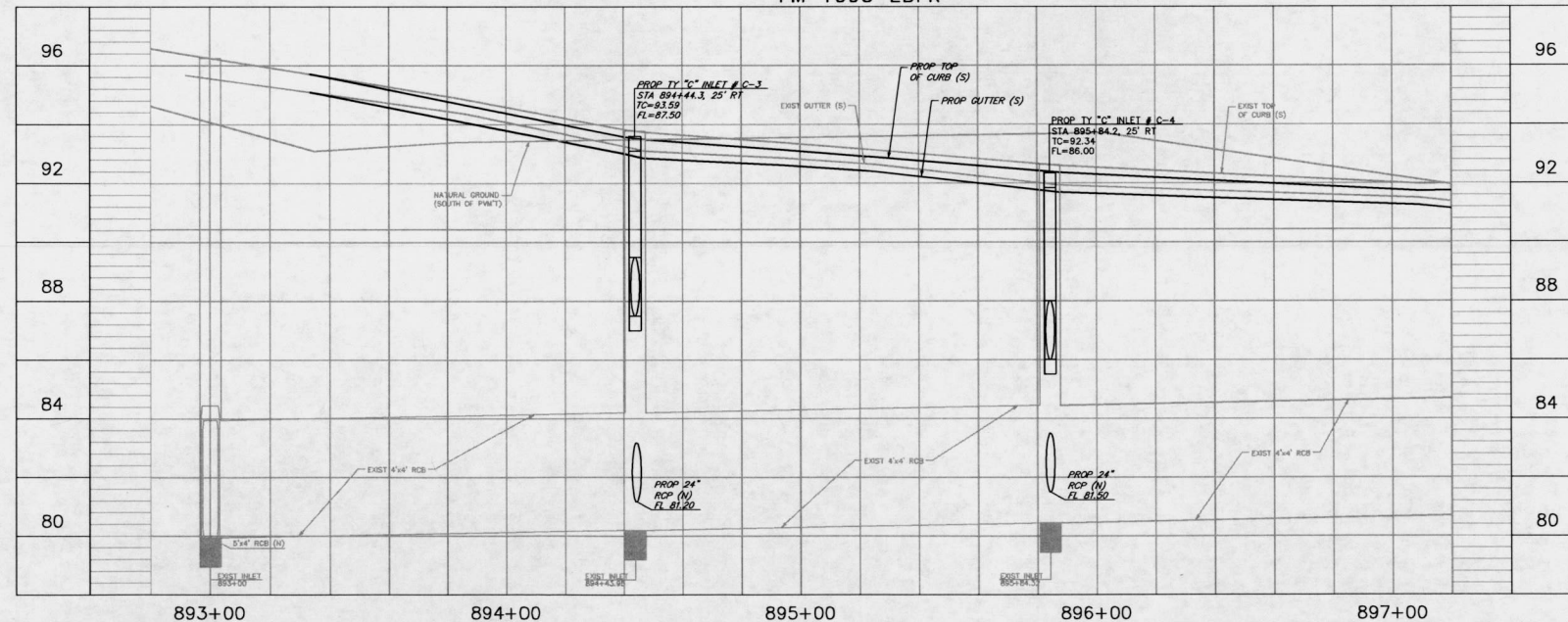

NO.	DATE	REVISIONS	APP.

DR. HORTON
FORT BEND COUNTY, TEXAS

RIGHT TURN LANE ON FM 1093 EBFR
PLAN & PROFILE
FM 1093 EBFR
STA 893+00 TO 897+20

J.C. JONES & CARTER
Texas Board of Professional Engineers Registration: 6439
6100 West Loop South, Suite 150 • Houston, TX 77057 • 713.777.8387

SCALE: 1"=40' H. 1"=4' V. DGN. BY: DAL
DATE: JANUARY 2017 DWN. BY: BEW
JOB NO. 14810-0000-00 DWG. NO.
SUBMITTED: SURV. BY:
F.B. NO.

 SHEET NO. 3 OF 30

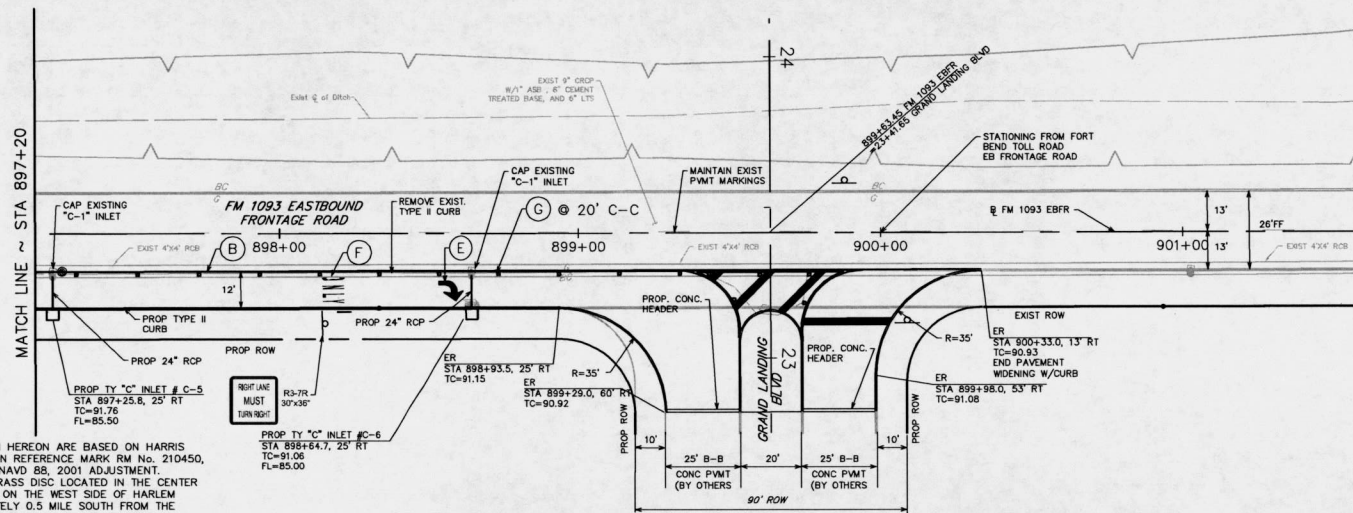

BENCHMARK

ELEVATIONS SHOWN HEREON ARE BASED ON HARRIS COUNTY FLOODPLAIN REFERENCE MARK RM No. 210450, ELEVATION=88.41, NAVD 88, 2001 ADJUSTMENT. MONUMENT IS A BRASS DISC LOCATED IN THE CENTER OF THE HEADWALL ON THE WEST SIDE OF HARLEM ROAD, APPROXIMATELY 0.5 MILE SOUTH FROM THE INTERSECTION OF HARLEM ROAD AND FM 1093.

PROPOSED PAVING LEGEND

- (A) REFL PAV MRK TY I (Y) (4 IN) (SLD)
- (B) REFL PAV MRK TY I (W) (8 IN) (SLD)
- (C) REFL PAV MRK TY I (Y) (24 IN) (SLD)
- (D) REFL PAV MRK TY I (W) (24 IN) (SLD)
- (E) REFL PAV MRK TY I (W) (ARROW)
- (F) REFL PAV MRK TY I (W) (WORD)
- (G) REFL PAV MRK TY I-C-R
- (H) REFL PAV MRK TY II-A-A

NOTE

- CONTRACTOR SHALL USE CARE TO MAKE AN OPENING IN THE WALL OF THE EXISTING INLET. THE OPENING SHALL NOT BE MORE THAN 3" NOR LESS THAN 1" GREATER IN DIAMETER THAN THE OUTSIDE DIAMETER OF THE PROPOSED PIPE. THE PROPOSED PIPE SHALL NOT PROTRUDE MORE THAN 3" PAST THE INSIDE FACE OF THE INLET WALL. FILL ENTIRE VOID AROUND THE PIPE WITH NON-SHRINK WATER PROOF GROUT. BACK FILL EXCAVATION AROUND EXISTING INLET WITH CEMENT STABILIZED SAND.
- CONTRACTOR SHALL DOWEL INTO THE SIDE OF EXISTING PAVEMENT W/ #6 REBARS AT 24" C-C AS PER TxDOT STANDARD CRCP(1)-13.
- CONTROL POINT SHALL BE INLET CENTER AT FACE OF CURB.

FM 1093 EBFR

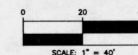
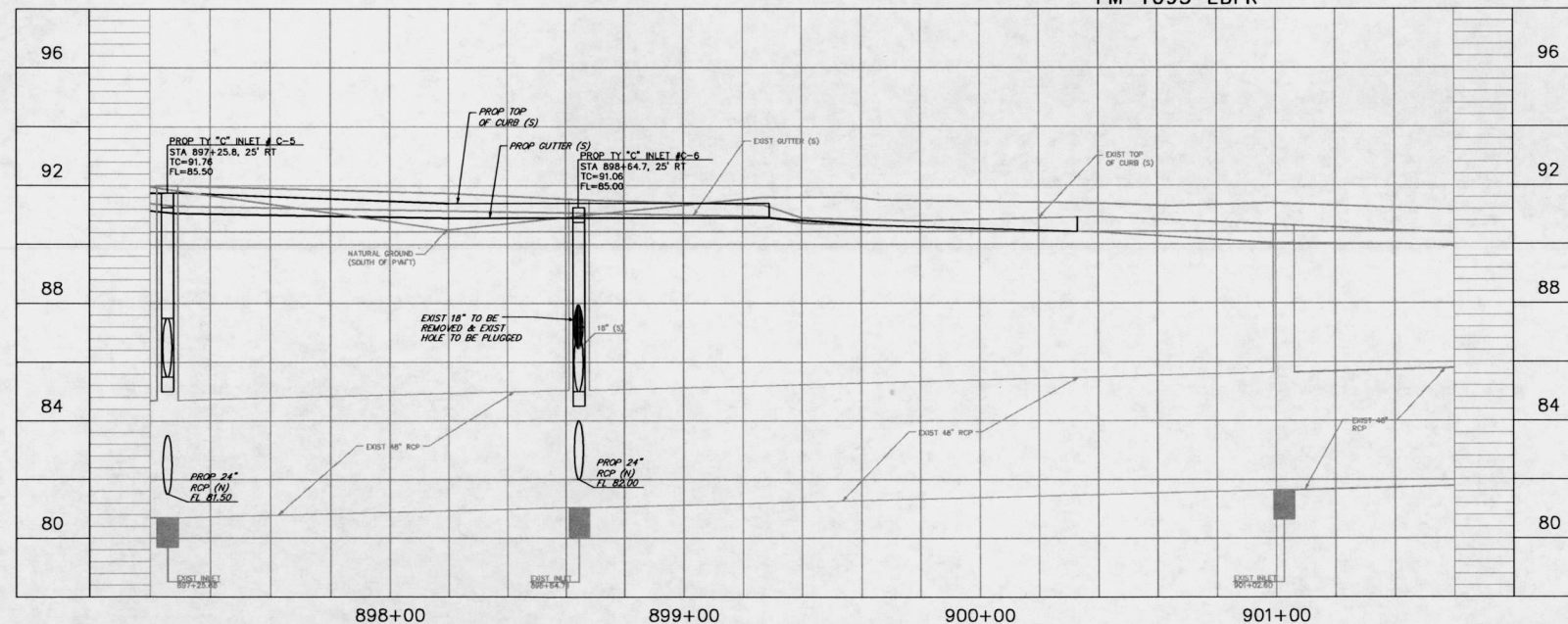

NO.	DATE	REVISIONS	APP.
DR HORTON FORT BEND COUNTY, TEXAS			
RIGHT TURN LANE ON FM 1093 EBFR			
PLAN & PROFILE FM 1093 EBFR STA 897+20 TO 901+60			
J.C. JONES CARTER Texas Board of Professional Engineers Registration # 4339 6330 West Loop South, Suite 150 • Dallas, TX 75201 • 713.777.5557			
SCALE: 1"=40' H. 1"=4' V.		DWN. BY: JAL	
DATE: JANUARY 2017		DWN. BY: BEW	
JOB NO. 14910-0000-00		DWG. NO.	
SUBMITTED:		SURV. BY:	
		F.B. NO.	

SHEET NO.
4
OF 36

ELEVATIONS SHOWN HEREON ARE BASED ON HARRIS COUNTY FLOODPLAIN REFERENCE MARK RM No. 210450, ELEVATION=88.41, NAVD 88, 2001 ADJUSTMENT. MONUMENT IS A BRASS DISC LOCATED IN THE CENTER OF THE HEADWALL ON THE WEST SIDE OF HARLEM ROAD, APPROXIMATELY 0.5 MILE SOUTH FROM THE INTERSECTION OF HARLEM ROAD AND FM 1093.



(A) REFL PAV MRK TY I (Y) (4 IN) (SLD)
(B) REFL PAV MRK TY I (W) (8 IN) (SLD)
(C) REFL PAV MRK TY I (Y) (24 IN) (SLD)
(D) REFL PAV MRK TY I (W) (24 IN) (SLD)
(E) REFL PAV MRK TY I (W) (ARROW)
(F) REFL PAV MRK TY I (W) (WORD)
(G) REFL PAV MRK TY I-C-R
(H) REFL PAV MRK TY II-A-A

1. CONTRACTOR SHALL USE CARE TO MAKE AN OPENING IN THE WALL OF THE EXISTING INLET. THE OPENING SHALL NOT BE MORE THAN 3", NOR LESS THAN 1" GREATER IN DIAMETER THAN THE OUTSIDE DIAMETER OF THE EXPOSED PIPE. THE PROVIDED PIPE SHALL NOT PROTRUDE MORE THAN 3" PAST THE INSIDE FACE OF THE INLET WALL. FILL ENTIRE VOID AROUND THE PIPE WITH NON-SHRINK WATER PROOF GROUT. BACK FILL EXCAVATION AROUND EXISTING INLET WITH CEMENT STABILIZED SAND.
2. CONTRACTOR SHALL DOWEL INTO THE SIDE OF EXISTING PAVEMENT W/ #6 REBARS AT 24" C-C as per TxDOT STANDARD CRCP(1)-13.
3. CONTROL POINT SHALL BE INLET CENTER AT FACE OF CURB.

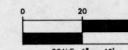

NO DATE REVISIONS A

DR HORTON
FORT BEND COUNTY, TEXAS

RIGHT TURN LANE ON FM 1093 EBRF

PLAN & PROFILE
GRAND LANDING BLVD
STA 22+82 TO 24+00

JONES CARTE

Texas Road of Professional Engineering Registration
1-630 West Loop South, Suite 150 • Dallas, TX 75203 • 713-737-7771

SCALE: 1"=40' H., 1"=6' V. DON. BY: DSA

DATE: JANUARY, 2017 DWG. NO.: NEW

JOB NO. 14810-0000-00 SURV. BY:

SUBMITTED: F.B. NO.

[Signature], P.E.
1/7/2017

SHEET NO.
5 OF 5