

REVIEW BY FORT BEND COUNTY COMMISSIONERS COURT

On this 11th day of October, 2016, Commissioners Court came on to be heard and reviewed the accompanying notice of Drymalla Construction Company, Inc. Job Location 3830 Harvest Corner Drive, Richmond, TX 77406 Date 6/18/1999 Bond No. 80866498, Permit No. 2016-9055 to make use of certain Fort Bend County property subject to, "A Revised Order Regulating the Laying, Construction, Maintenance, and Repair of Buried Cables, Conduits, and Pole Lines, In, Under, Across or Along Roads, Streets, Highways, and Drainage Ditches in Fort Bend County, Texas, Under the Jurisdiction of the Commissioners Court of Fort Bend County, Texas," as passed by the Commissioners Court of Fort Bend County, Texas the 3rd day of August, 1987, recorded in Volume _____ of the Minutes of the Commissioners Court of Fort Bend County, Texas, to the extent that such order is not inconsistent with Article 1436a, Vernon's Texas Civil Statutes. Upon Motion of Commissioner Meyers, seconded by Commissioner Patterson, duly put and carried, it is ORDERED, ADJUDGED AND DECREED that said notice of said above purpose is hereby acknowledged by the Commissioners Court of Fort Bend County, Texas, and that said notice be placed on record according to the regulation order thereof.

Notes:

1. Evidence of review by the Commissioners Court must be kept on the job site and failure to do so constitutes grounds for job shutdown.
2. Written notices are required:
 - a. 48 hours in advance of construction start up, and
 - b. when construction is completed and ready for final inspection
 Mail notices to: Permit Administrator
 Fort Bend County Engineering
 301 Jackson Street
 Richmond, Texas 77469
 281-633-7500
3. This permit expires one (1) year from date of permit if construction has not commenced.

By: _____

for Charles O. [Signature]
County Engineer

Presented to Commissioners Court and approved.

Recorded in Volume
10-11-16 15J
Minutes of Commissioners Court

By: _____

N/A

Drainage District Engineer/Manager

Clerk of Commissioners Court

By: _____

[Signature]
Deputy



11 University Place, Suite 1000
 Houston, TX 77058
 Telephone: 281-410-1100
 Fax: 281-410-1109
 www.pbk.com

CONSTRUCTION PLANS FOR FORT BEND INDEPENDENT SCHOOL DISTRICT NEW ELEMENTARY SCHOOL #49 (BP06) AT HARVEST GREEN

3830 HARVEST CORNER DRIVE
 RICHMOND, TEXAS 77406

CONSTRUCTION OF NEW ELEMENTARY SCHOOL #49
 (BP06) AT HARVEST GREEN
 FORT BEND I.S.D.
 3830 Harvest Corner Drive, Richmond, Texas 77406
 ISSUE FOR CONSTRUCTION

Sheet Number	Sheet Title
C0.00	COVER
C0.01	GENERAL NOTES AND LEGENDS
C1.01	TOPOGRAPHIC SURVEY
C2.01	CIVIL SITE AND DIMENSIONAL CONTROL PLAN
C2.02	FIRE APPARATUS ACCESS PLAN
C2.03	EROSION CONTROL PLAN
C3.01	WATER AND SANITARY SEWER PLAN (1 OF 2)
C3.02	UTILITY CONNECTIONS IN ROW & OUTFALL
C4.01	STORM SEWER PLAN (1 OF 2)
C4.02	STORM SEWER PLAN (2 OF 2)
C5.01	GRADING PLAN
C6.01	DRAINAGE AREA PLAN
C6.02	STORM SEWER CALCULATIONS
C7.01	PAVING DETAILS
C7.02	WATER LINE DETAILS
C7.03	SANITARY SEWER DETAILS
C7.04	STORM SEWER DETAILS
C7.05	EROSION CONTROL DETAILS
C7.06	GRADING NOTES AND DETAILS
C7.07	MISC CIVIL DETAILS

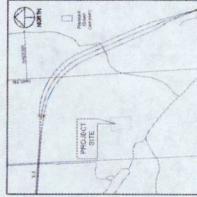
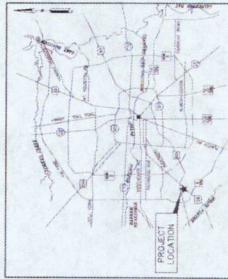

ONE RING COUNTY TEXAS
 VICINITY MAP
 SHEET MAP 5668



OWNER	FORT BEND INDEPENDENT SCHOOL DISTRICT
DATE	11/14/11
DRAWN BY	09/02/2011
CHECKED BY	TR
REVISIONS	TR
DATE	
DESCRIPTION	
BY	
DATE	
APPROVED BY	
DATE	

FORT BEND COUNTY ENGINEER
 ENGINEER: *Richard W. Stollers, P.E.* 7/12/11
 FOR: RICHARD W. STOLLERS, P.E.
 THESE SIGNATURES ARE VOID IF CONSTRUCTION HAS NOT COMMENCED IN (1) YEAR FROM DATE OF APPROVAL
 APPROVED: *Richard W. Stollers*
 DEVELOPMENT COORDINATOR
 DATE: 7/12/11

NOTIFICATION OF PRE-CONSTRUCTION MEETING AND ALL PERMITS ACTIVITIES
 EMAIL: CONSTRUCTION@FORTBENDCOUNTYTX.GOV

ONE CALL NOTIFICATION SYSTEM
 CALL BEFORE YOU DIG!!!
 (713) 424-4247 (IN HOUSTON)
 (800) 544-6688 (NEW STATEWIDE NUMBER OUTSIDE HOUSTON)

FORT BEND INDEPENDENT SCHOOL DISTRICT
 PROJECT LOCATION
 DATE: 04/12/11
 SHEET: 01 OF 07
 SCALE: AS SHOWN

COVER

C0.00

11 Commerce Plaza, Suite 1000
 Houston, TX 77004
 Tel: 281-440-1100
 Fax: 281-440-1101
 TX Reg. P-3309
 Professional Seal

**CONSTRUCTION OF NEW ELEMENTARY SCHOOL #49
 (BP06) AT HARVEST GREEN
 FORT BEND I.S.D.**
 3830 Harvest Corner Drive, Richmond, Texas 77406
ISSUE FOR CONSTRUCTION

DATE: 05/20/16
 PROJECT NUMBER: 15147
 SHEET NUMBER: 02/02/16
 CHECKED BY: TTY
 DESIGNED BY: JTY

PROJECT	CONSTRUCTION OF NEW ELEMENTARY SCHOOL #49
DATE	05/20/16
PROJECT NUMBER	15147
CHECKED BY	TTY
DESIGNED BY	JTY
PROJECT LOCATION	3830 HARVEST CORNER DRIVE, RICHMOND, TEXAS 77406
DATE	05/20/16
PROJECT NUMBER	15147
CHECKED BY	TTY
DESIGNED BY	JTY

ISSUE FOR CONSTRUCTION
 FIRE APPARATUS
 ACCESS PLAN
C2.02

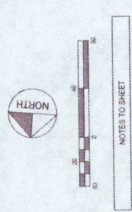

NOTES TO SHEET

1. FIRE LANE: A CLEAR, UNOBSTRUCTED PATH FOR FIRE APPARATUS TO ACCESS A BUILDING OR OTHER STRUCTURE. FIRE LANES SHALL BE MAINTAINED AT ALL TIMES AND SHALL BE KEPT FREE OF OBSTRUCTIONS, INCLUDING BUT NOT LIMITED TO, TREES, BUSHES, AND OTHER VEGETATION. FIRE LANES SHALL BE KEPT CLEAR OF OBSTRUCTIONS AT ALL TIMES AND SHALL BE KEPT FREE OF OBSTRUCTIONS, INCLUDING BUT NOT LIMITED TO, TREES, BUSHES, AND OTHER VEGETATION.

2. FIRE LANE: A CLEAR, UNOBSTRUCTED PATH FOR FIRE APPARATUS TO ACCESS A BUILDING OR OTHER STRUCTURE. FIRE LANES SHALL BE MAINTAINED AT ALL TIMES AND SHALL BE KEPT FREE OF OBSTRUCTIONS, INCLUDING BUT NOT LIMITED TO, TREES, BUSHES, AND OTHER VEGETATION. FIRE LANES SHALL BE KEPT CLEAR OF OBSTRUCTIONS AT ALL TIMES AND SHALL BE KEPT FREE OF OBSTRUCTIONS, INCLUDING BUT NOT LIMITED TO, TREES, BUSHES, AND OTHER VEGETATION.

LEGEND

--- FIRE LANE

--- EXISTING DRAINAGE CHANNEL

WATER DISTRIBUTION SYSTEM NOTES

1. CONNECT TO EXISTING WATER MAINS. CONTRACTOR SHALL VERIFY LOCATION AND DEPTH OF EXISTING MAINS PRIOR TO CONSTRUCTION. CONTRACTOR SHALL VERIFY LOCATION AND DEPTH OF EXISTING MAINS PRIOR TO CONSTRUCTION.

2. CONTRACTOR SHALL VERIFY LOCATION AND DEPTH OF EXISTING MAINS PRIOR TO CONSTRUCTION. CONTRACTOR SHALL VERIFY LOCATION AND DEPTH OF EXISTING MAINS PRIOR TO CONSTRUCTION.

3. CONTRACTOR SHALL VERIFY LOCATION AND DEPTH OF EXISTING MAINS PRIOR TO CONSTRUCTION. CONTRACTOR SHALL VERIFY LOCATION AND DEPTH OF EXISTING MAINS PRIOR TO CONSTRUCTION.

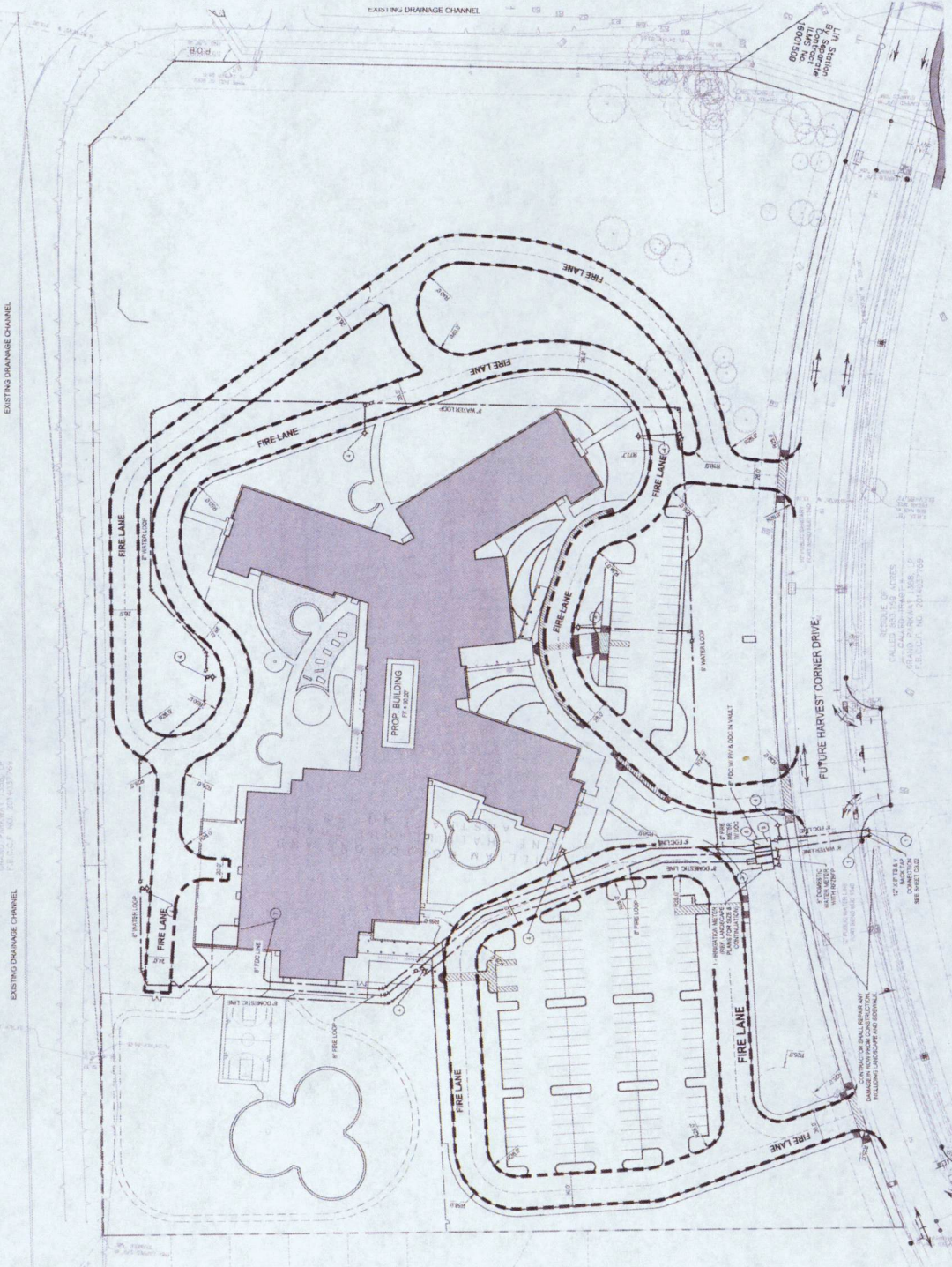

APPROVED: *Michael D. ...*
 DEVELOPMENT COORDINATOR
 DATE: 7/15/16



11 Greenway Blvd., Suite 400
Houston, TX 77066
713-961-4811
TX Reg. # 0209
Professional Engineer

**CONSTRUCTION OF NEW ELEMENTARY SCHOOL #49
(BP06) AT HARVEST GREEN
FORT BEND I.S.D.**
3830 Harvest Corner Drive, Richmond, Texas 77406
ISSUE FOR CONSTRUCTION



PROJECT NUMBER	15147
DATE	08/20/2018
DRAWN BY	TPP
CHECKED BY	TPP
REVISION	DATE
1	08/20/2018
2	08/20/2018
3	08/20/2018
4	08/20/2018
5	08/20/2018
6	08/20/2018
7	08/20/2018
8	08/20/2018
9	08/20/2018
10	08/20/2018
11	08/20/2018
12	08/20/2018
13	08/20/2018
14	08/20/2018
15	08/20/2018
16	08/20/2018
17	08/20/2018
18	08/20/2018
19	08/20/2018
20	08/20/2018
21	08/20/2018
22	08/20/2018
23	08/20/2018
24	08/20/2018
25	08/20/2018
26	08/20/2018
27	08/20/2018
28	08/20/2018
29	08/20/2018
30	08/20/2018
31	08/20/2018
32	08/20/2018
33	08/20/2018
34	08/20/2018
35	08/20/2018
36	08/20/2018
37	08/20/2018
38	08/20/2018
39	08/20/2018
40	08/20/2018
41	08/20/2018
42	08/20/2018
43	08/20/2018
44	08/20/2018
45	08/20/2018
46	08/20/2018
47	08/20/2018
48	08/20/2018
49	08/20/2018
50	08/20/2018
51	08/20/2018
52	08/20/2018
53	08/20/2018
54	08/20/2018
55	08/20/2018
56	08/20/2018
57	08/20/2018
58	08/20/2018
59	08/20/2018
60	08/20/2018
61	08/20/2018
62	08/20/2018
63	08/20/2018
64	08/20/2018
65	08/20/2018
66	08/20/2018
67	08/20/2018
68	08/20/2018
69	08/20/2018
70	08/20/2018
71	08/20/2018
72	08/20/2018
73	08/20/2018
74	08/20/2018
75	08/20/2018
76	08/20/2018
77	08/20/2018
78	08/20/2018
79	08/20/2018
80	08/20/2018
81	08/20/2018
82	08/20/2018
83	08/20/2018
84	08/20/2018
85	08/20/2018
86	08/20/2018
87	08/20/2018
88	08/20/2018
89	08/20/2018
90	08/20/2018
91	08/20/2018
92	08/20/2018
93	08/20/2018
94	08/20/2018
95	08/20/2018
96	08/20/2018
97	08/20/2018
98	08/20/2018
99	08/20/2018
100	08/20/2018

EROSION CONTROL
PLAN
C2.03

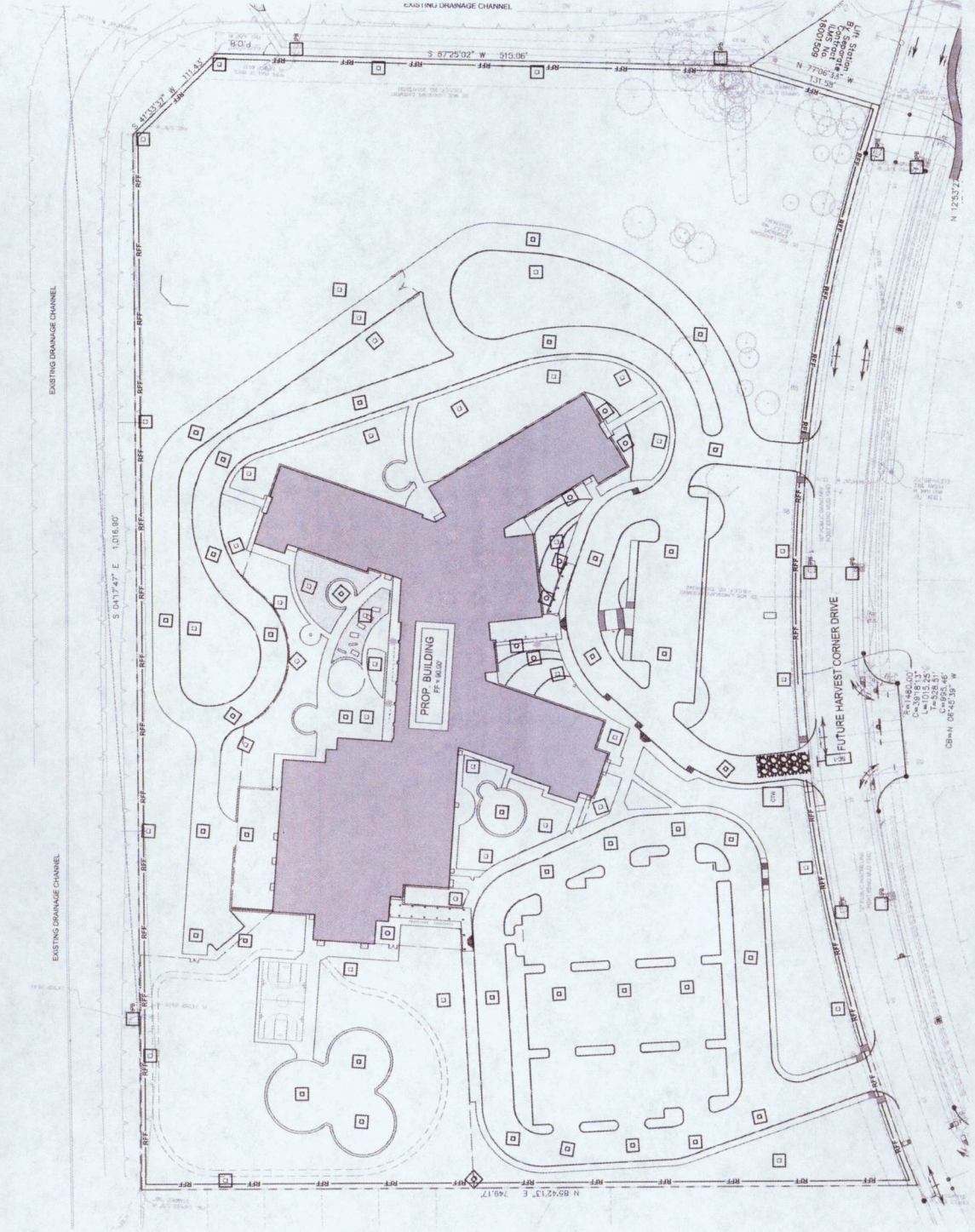
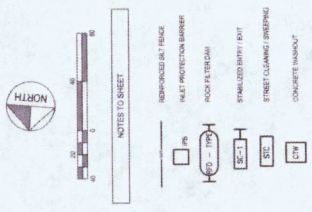

APPROVED: *M. Green*
DEVELOPMENT COORDINATOR
DATE: 7/23/18



11 Chisholm Plaza, 25th Floor
 Houston, TX 77004
 713-961-4311 F
 713-961-4310 P
 TX State EITP
 License # 5209

CONSTRUCTION OF NEW ELEMENTARY SCHOOL #49
 (BP06) AT HARVEST GREEN
 FORT BEND I.S.D.
 3830 Harvest Corner Drive, Richmond, Texas 77406
 ISSUE FOR CONSTRUCTION



PROJECT NO.	09220018
DATE	12/15/18
DESIGNED BY	TR
CHECKED BY	TR
ISSUED FOR	CONSTRUCTION

STORM SEWER PLAN
 (2 OF 2)

C4.02



- NOTES TO SHEET
- STORM SEWER SYSTEM NOTES
1. CONNECT TO EXISTING STORM SEWER SYSTEM. VERIFY EXISTING SYSTEM LOCATION, DEPTH, AND SIZE OF EXISTING SYSTEM FROM RECORD DRAWINGS. VERIFY EXISTING SYSTEM LOCATION AND DEPTH BY FIELD SURVEY. VERIFY EXISTING SYSTEM LOCATION AND DEPTH BY FIELD SURVEY. VERIFY EXISTING SYSTEM LOCATION AND DEPTH BY FIELD SURVEY.
 2. APPROXIMATE LOCATION OF INTERMITTENT DRAIN BASIN (IDB) SHALL BE DETERMINED BY FIELD SURVEY. VERIFY EXISTING SYSTEM LOCATION AND DEPTH BY FIELD SURVEY. VERIFY EXISTING SYSTEM LOCATION AND DEPTH BY FIELD SURVEY.
 3. APPROXIMATE LOCATION OF INTERMITTENT DRAIN BASIN (IDB) SHALL BE DETERMINED BY FIELD SURVEY. VERIFY EXISTING SYSTEM LOCATION AND DEPTH BY FIELD SURVEY. VERIFY EXISTING SYSTEM LOCATION AND DEPTH BY FIELD SURVEY.
 4. APPROXIMATE LOCATION OF INTERMITTENT DRAIN BASIN (IDB) SHALL BE DETERMINED BY FIELD SURVEY. VERIFY EXISTING SYSTEM LOCATION AND DEPTH BY FIELD SURVEY. VERIFY EXISTING SYSTEM LOCATION AND DEPTH BY FIELD SURVEY.

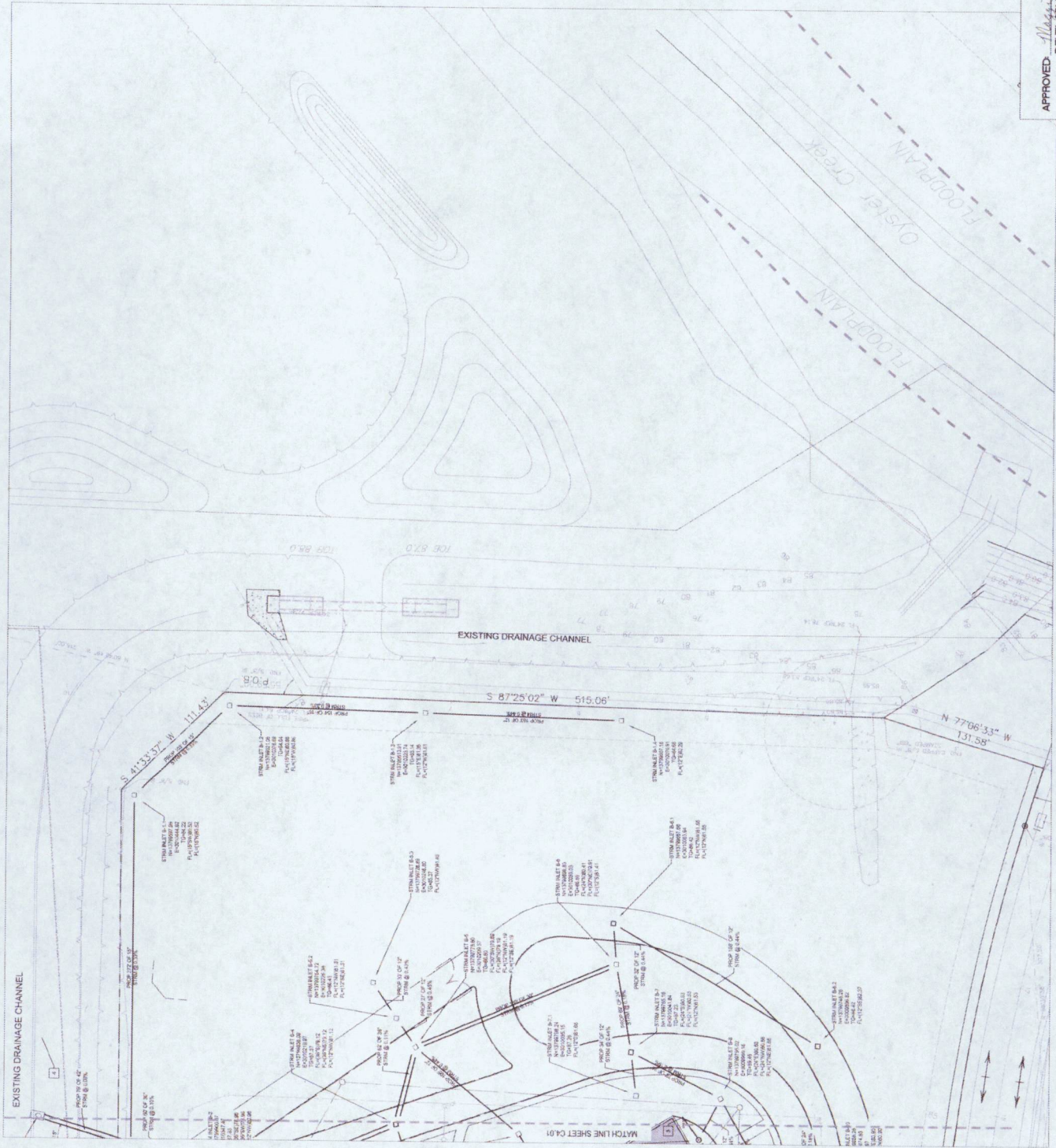

APPROVED: *David J. ...*
 DEVELOPMENT COORDINATOR
 DATE: 7/12/21/18



11 Gateway Plaza, 22nd Floor
 Houston, Texas 77006
 281-416-7000
 281-416-7001
 281-416-7002
 281-416-7003
 281-416-7004

CONSTRUCTION OF NEW ELEMENTARY SCHOOL #49
 (P06) AT HARVEST GREEN
 FORT BEND I.S.D.
 3830 Harvest Corner Drive, Richmond, Texas 77406
 ISSUE FOR CONSTRUCTION



PROJECT NUMBER	15147	
DATE	05/20/18	
DESIGNED BY	TTT	
CHECKED BY	TTT	
REVISION	TTT	
NO.	DESCRIPTION	DATE
1	ISSUE FOR CONSTRUCTION	05/20/18
2	ISSUE FOR CONSTRUCTION	05/20/18
3	ISSUE FOR CONSTRUCTION	05/20/18
4	ISSUE FOR CONSTRUCTION	05/20/18
5	ISSUE FOR CONSTRUCTION	05/20/18

ISSUE FOR CONSTRUCTION
GRADING PLAN
C5.01

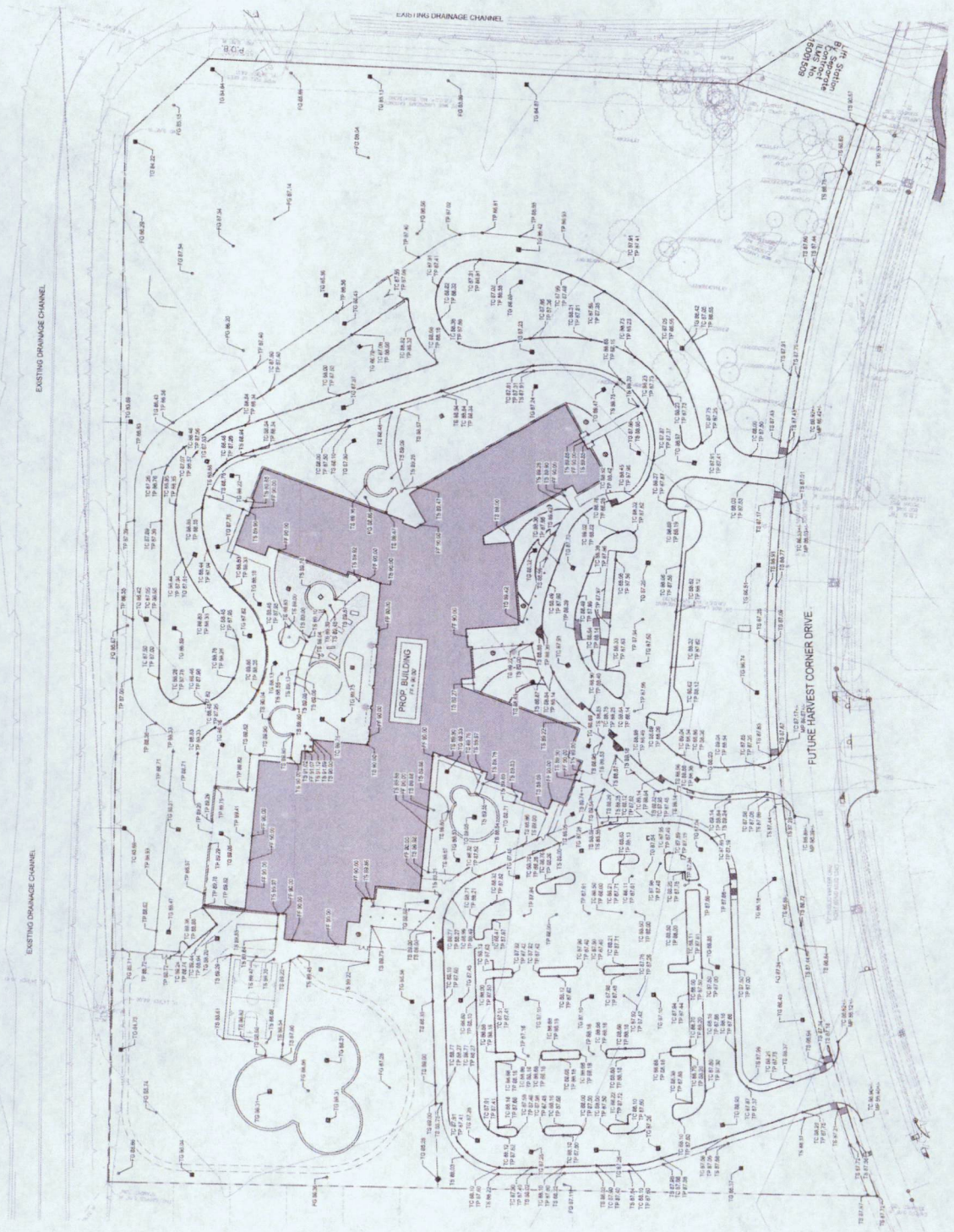
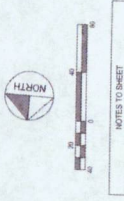

APPROVED: *Melissa D. [Signature]*
 DEVELOPMENT COORDINATOR
 DATE: 7/28/18



11 Claymore Plaza, 2nd Floor
 Dallas, TX 75208
 714-941-4411 F
 714-941-4411 C
 714-941-4411 R
 714-941-4411 T

CONSTRUCTION OF NEW ELEMENTARY SCHOOL #49
 (BP06) AT HARVEST GREEN
 FORT BEND I.S.D.
 3830 Harvest Corner Drive, Richmond, Texas 77406
 ISSUE FOR CONSTRUCTION



CLIENT	FORBES
PROJECT NUMBER	15147
DATE	05/20/2016
DESIGNED BY	TT
CHECKED BY	TT
DATE	05/20/2016
ISSUE FOR CONSTRUCTION	

DRAINAGE AREA PLAN

C6.01

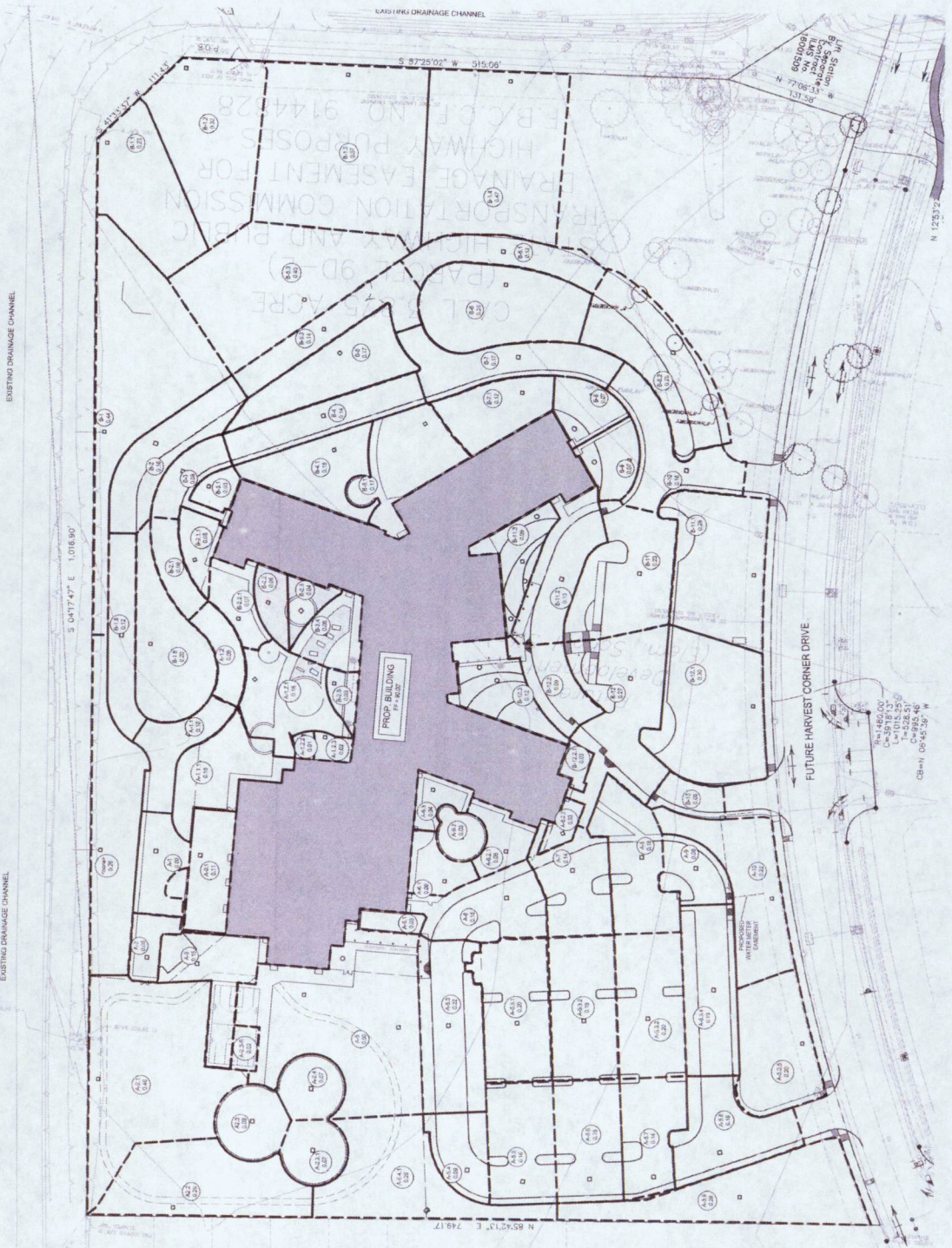
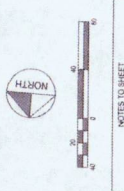

APPROVED: *M. J. [Signature]*
 DEVELOPMENT COORDINATOR
 DATE: 7/28/16



DATE	DATE END	
PROJECT NUMBER	PROJECT APPROVED	
DATE	15147	
OWNER	USD002016	
OWNER'S PROJECT NUMBER	0000000000	
PROJECT BY	TY	
REVISION	TY	
NO.	DESCRIPTION	DATE
1	ISSUE FOR CONSTRUCTION	05/20/16
2		
3		
4		
5		
6		
7		
8		
9		
10		
11		
12		

APPROVED: *M. J. Bennett*
 DEVELOPMENT COORDINATOR
 DATE: 7/25/16

<p>1 NORMAL BEDDING AND FILL FOR SANITARY SEWER LINES SHALL BE 12 INCH PERCENT FINE SANDY SILT. ALL BEDDING AND FILL SHALL BE COMPACTED TO 95 PERCENT OF STANDARD PROCTOR DENSITY. THE COMPACTED BEDDING SHALL BE EXTENDED TO THE FULL WIDTH OF THE PIPE AND SHALL BE 4 INCHES DEEPER THAN THE FULL WIDTH OF THE PIPE. ALL BEDDING AND FILL SHALL BE COMPACTED TO 95 PERCENT OF STANDARD PROCTOR DENSITY. THE COMPACTED BEDDING SHALL BE EXTENDED TO THE FULL WIDTH OF THE PIPE AND SHALL BE 4 INCHES DEEPER THAN THE FULL WIDTH OF THE PIPE. ALL BEDDING AND FILL SHALL BE COMPACTED TO 95 PERCENT OF STANDARD PROCTOR DENSITY. THE COMPACTED BEDDING SHALL BE EXTENDED TO THE FULL WIDTH OF THE PIPE AND SHALL BE 4 INCHES DEEPER THAN THE FULL WIDTH OF THE PIPE.</p>		<p>1 SANITARY SEWER BEDDING & BACKFILL</p>	<p>7</p>
<p>2 SANITARY SEWER MANHOLE</p>		<p>2 SANITARY SEWER MANHOLE</p>	<p>8</p>
<p>3 SANITARY SEWER CLEAN OUT</p>		<p>3 SANITARY SEWER CLEAN OUT</p>	<p>9</p>

1. NORMAL BEDDING AND FILL FOR SANITARY SEWER LINES SHALL BE 12 INCH PERCENT FINE SANDY SILT. ALL BEDDING AND FILL SHALL BE COMPACTED TO 95 PERCENT OF STANDARD PROCTOR DENSITY. THE COMPACTED BEDDING SHALL BE EXTENDED TO THE FULL WIDTH OF THE PIPE AND SHALL BE 4 INCHES DEEPER THAN THE FULL WIDTH OF THE PIPE. ALL BEDDING AND FILL SHALL BE COMPACTED TO 95 PERCENT OF STANDARD PROCTOR DENSITY. THE COMPACTED BEDDING SHALL BE EXTENDED TO THE FULL WIDTH OF THE PIPE AND SHALL BE 4 INCHES DEEPER THAN THE FULL WIDTH OF THE PIPE.

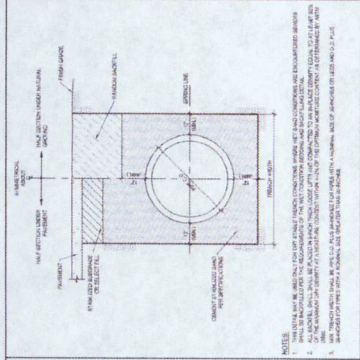

1 SANITARY SEWER BEDDING & BACKFILL

7

2 SANITARY SEWER MANHOLE

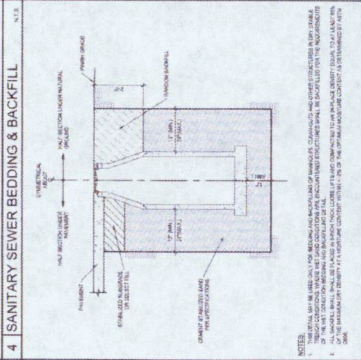

2 SANITARY SEWER MANHOLE

8

3 SANITARY SEWER CLEAN OUT

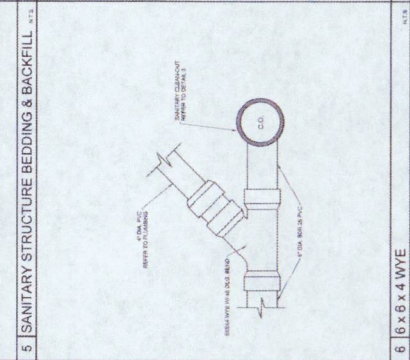

3 SANITARY SEWER CLEAN OUT

9

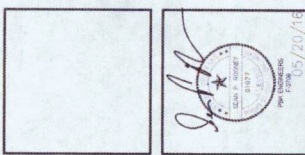

PROJECT	PROJECT NAME	PROJECT NO.
DATE	DATE	DATE
CREATED BY	BY	DATE
REVISION	DESCRIPTION	DATE
1	ISSUE FOR CONSTRUCTION	05/20/16
2	ISSUE FOR CONSTRUCTION	05/20/16
3	ISSUE FOR CONSTRUCTION	05/20/16

APPROVED: *M. Sorek*
DEVELOPMENT COORDINATOR
DATE: 7/18/16

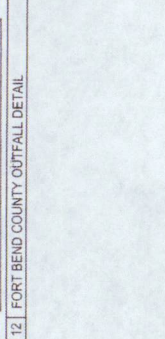
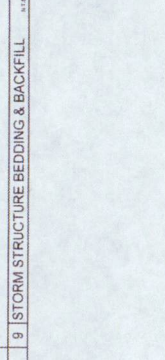
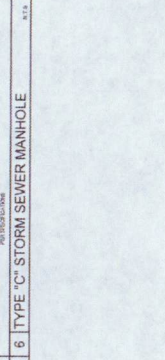
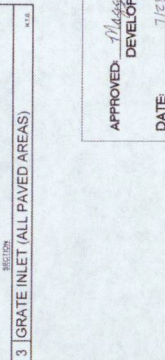
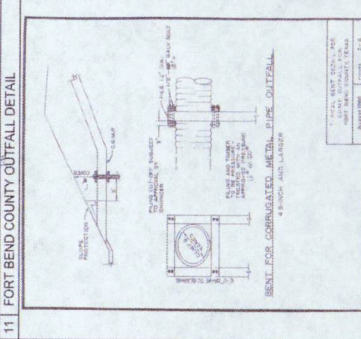
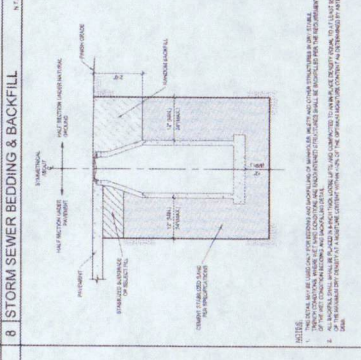
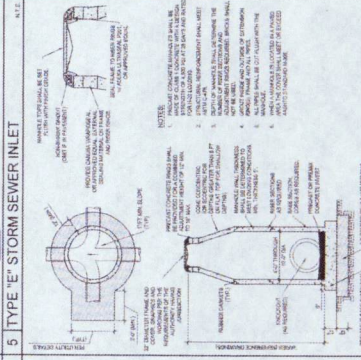
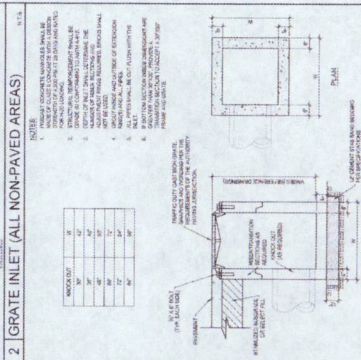
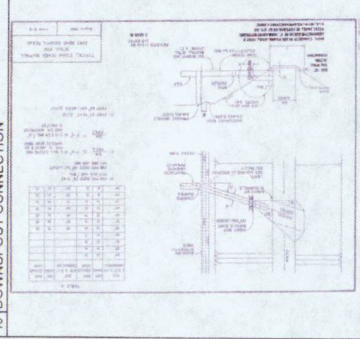
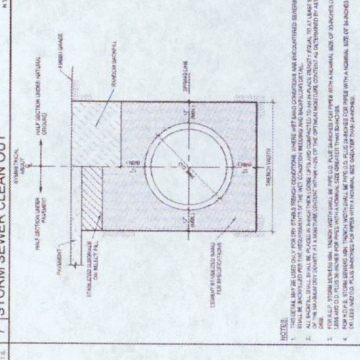
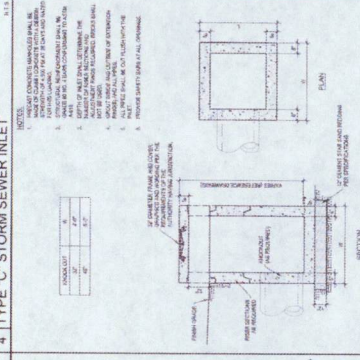
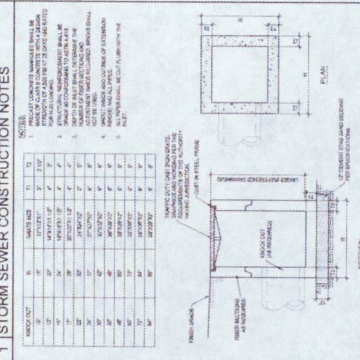
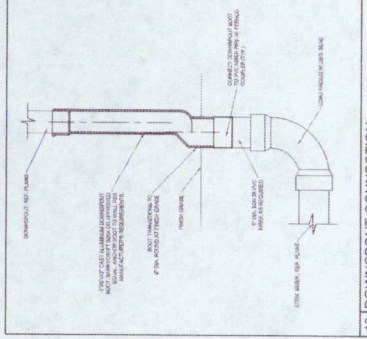
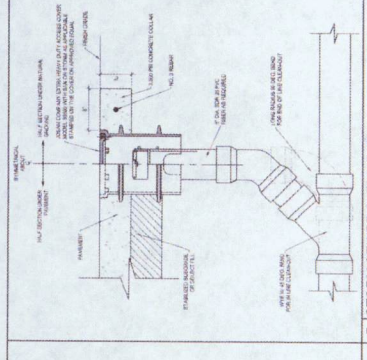
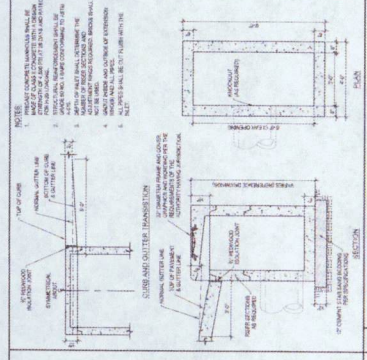
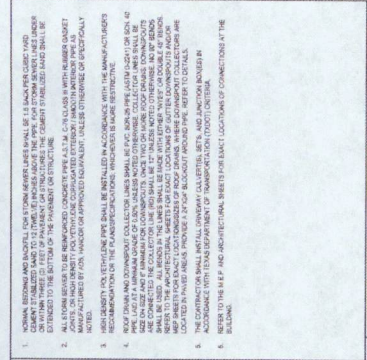



OWNER	INDEPENDENT SCHOOL DISTRICT	
PROJECT NUMBER	15147	
DATE	05/20/2016	
DRAWN BY	TT	
CHECKED BY	TT	
REVISIONS	TT	
NO.	DESCRIPTION	DATE
1	ISSUE FOR CONSTRUCTION	

ISSUE FOR CONSTRUCTION

GRADING NOTES AND
 DETAILS

C7.06

10	7	4 SOD PLACEMENT	1 GRADING CONSTRUCTION NOTES
11	8	5	2 TYPICAL GRADING AT BUILDING
12	9	6	3 TYPICAL PAVING AT DOORS

1. THE CONTRACTOR SHALL SHOW THE EXISTING AND PROPOSED GRADING ON ALL PLANS AND ELEVATIONS. THE CONTRACTOR SHALL MAINTAIN THE EXISTING GRADING UNLESS OTHERWISE SPECIFIED BY THE GRADING NOTES. THE TOP OF SOD SHALL BE NOTED THROUGHOUT THE PLAN.

2. AT ALL CORNERS, THE GRADING SHALL BE AT A MAXIMUM OF 2% AWAY FROM FLOORWAY FOR A MINIMUM OF 10 FEET TO THE EXISTING GRADE OR TO THE TOP OF CURB OR FINISH GRADE.

3. AT ALL CORNERS, THE GRADING SHALL BE AT A MAXIMUM OF 2% AWAY FROM FLOORWAY FOR A MINIMUM OF 10 FEET TO THE EXISTING GRADE OR TO THE TOP OF CURB OR FINISH GRADE.

4. ALL EXISTING GRADING SHALL BE MAINTAINED UNLESS OTHERWISE SPECIFIED BY THE GRADING NOTES. THESE ASSOCIATED COSTS SHALL BE AT THE EXPENSE OF THE CONTRACTOR.

5. THE CONTRACTOR SHALL MAINTAIN THE EXISTING GRADING UNLESS OTHERWISE SPECIFIED BY THE GRADING NOTES.

6. THE CONTRACTOR SHALL MAINTAIN THE EXISTING GRADING UNLESS OTHERWISE SPECIFIED BY THE GRADING NOTES.

7. GRADE SLICES SHALL BE BACKFILLED TO TOP OF CURB INVOID. MANHOLE IS GRADE UP TO CENTER OF ISLAND TO PROVIDE ADEQUATE SWEEP FLOW OVER TOP OF CURB.

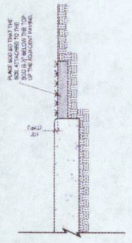

NOTE:
 1. SOD SHALL BE PLACED TO MATCH DRAINAGE.
 2. SOD SHALL BE MAINTAINED UNLESS OTHERWISE SPECIFIED BY THE GRADING NOTES.

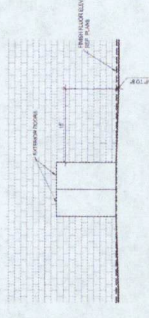
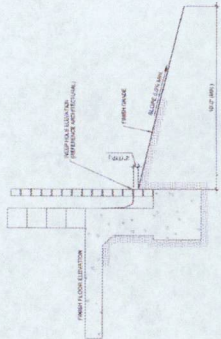

NOTES:
 1. THE CONTRACTOR SHALL MAINTAIN THE EXISTING GRADING UNLESS OTHERWISE SPECIFIED BY THE GRADING NOTES.
 2. THE CONTRACTOR SHALL MAINTAIN THE EXISTING GRADING UNLESS OTHERWISE SPECIFIED BY THE GRADING NOTES.
 3. THE CONTRACTOR SHALL MAINTAIN THE EXISTING GRADING UNLESS OTHERWISE SPECIFIED BY THE GRADING NOTES.

APPROVED: *Jeffery A. Smith*
 DEVELOPMENT COORDINATOR
 DATE: 7/2/2016



PROJECT NUMBER	15147	
DATE	05/20/16	
DRAWN BY	TY	
CHECKED BY	TY	
REVISION	TY	
NO.	DESCRIPTION	DATE
1	ISSUE FOR CONSTRUCTION	05/20/16
2	ISSUE FOR CONSTRUCTION	05/20/16
3	ISSUE FOR CONSTRUCTION	05/20/16

ISSUE FOR CONSTRUCTION

MISC. CIVIL DETAILS

C7.07

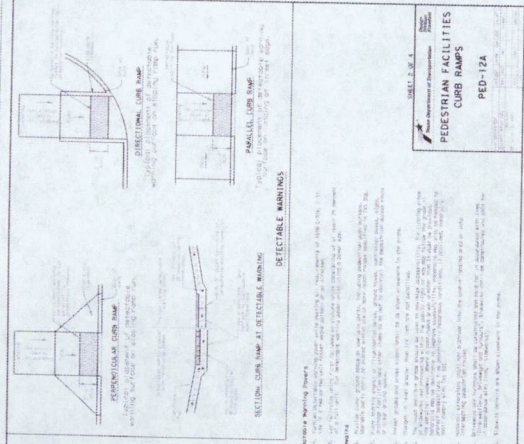

DETECTABLE WARNING

1. The detectable warning shall be installed on the curb ramp at the intersection of the curb ramp and the street.

2. The detectable warning shall be installed on the curb ramp at the intersection of the curb ramp and the sidewalk.

3. The detectable warning shall be installed on the curb ramp at the intersection of the curb ramp and the driveway.

4. The detectable warning shall be installed on the curb ramp at the intersection of the curb ramp and the ramp.

5. The detectable warning shall be installed on the curb ramp at the intersection of the curb ramp and the ramp.

6. The detectable warning shall be installed on the curb ramp at the intersection of the curb ramp and the ramp.

7. The detectable warning shall be installed on the curb ramp at the intersection of the curb ramp and the ramp.

8. The detectable warning shall be installed on the curb ramp at the intersection of the curb ramp and the ramp.

9. The detectable warning shall be installed on the curb ramp at the intersection of the curb ramp and the ramp.

10. The detectable warning shall be installed on the curb ramp at the intersection of the curb ramp and the ramp.

11. The detectable warning shall be installed on the curb ramp at the intersection of the curb ramp and the ramp.

12. The detectable warning shall be installed on the curb ramp at the intersection of the curb ramp and the ramp.

13. The detectable warning shall be installed on the curb ramp at the intersection of the curb ramp and the ramp.

14. The detectable warning shall be installed on the curb ramp at the intersection of the curb ramp and the ramp.

15. The detectable warning shall be installed on the curb ramp at the intersection of the curb ramp and the ramp.

16. The detectable warning shall be installed on the curb ramp at the intersection of the curb ramp and the ramp.

17. The detectable warning shall be installed on the curb ramp at the intersection of the curb ramp and the ramp.

18. The detectable warning shall be installed on the curb ramp at the intersection of the curb ramp and the ramp.

19. The detectable warning shall be installed on the curb ramp at the intersection of the curb ramp and the ramp.

20. The detectable warning shall be installed on the curb ramp at the intersection of the curb ramp and the ramp.

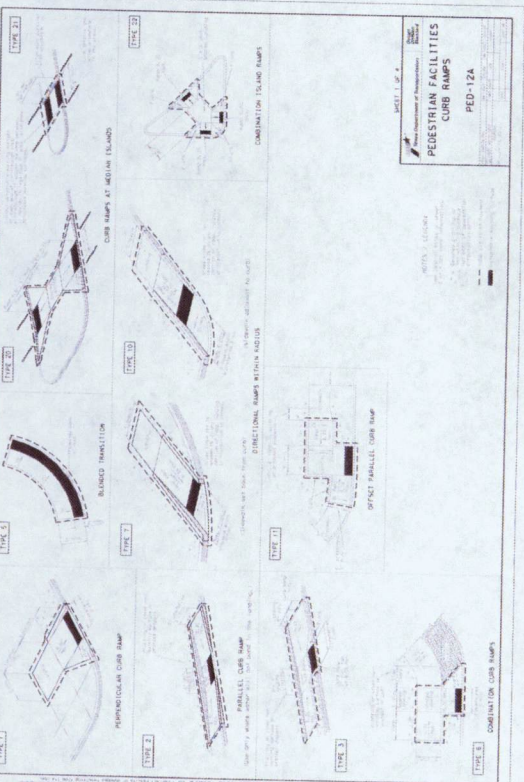

DETECTABLE WARNING

1. The detectable warning shall be installed on the curb ramp at the intersection of the curb ramp and the street.

2. The detectable warning shall be installed on the curb ramp at the intersection of the curb ramp and the sidewalk.

3. The detectable warning shall be installed on the curb ramp at the intersection of the curb ramp and the driveway.

4. The detectable warning shall be installed on the curb ramp at the intersection of the curb ramp and the ramp.

5. The detectable warning shall be installed on the curb ramp at the intersection of the curb ramp and the ramp.

6. The detectable warning shall be installed on the curb ramp at the intersection of the curb ramp and the ramp.

7. The detectable warning shall be installed on the curb ramp at the intersection of the curb ramp and the ramp.

8. The detectable warning shall be installed on the curb ramp at the intersection of the curb ramp and the ramp.

9. The detectable warning shall be installed on the curb ramp at the intersection of the curb ramp and the ramp.

10. The detectable warning shall be installed on the curb ramp at the intersection of the curb ramp and the ramp.

11. The detectable warning shall be installed on the curb ramp at the intersection of the curb ramp and the ramp.

12. The detectable warning shall be installed on the curb ramp at the intersection of the curb ramp and the ramp.

13. The detectable warning shall be installed on the curb ramp at the intersection of the curb ramp and the ramp.

14. The detectable warning shall be installed on the curb ramp at the intersection of the curb ramp and the ramp.

15. The detectable warning shall be installed on the curb ramp at the intersection of the curb ramp and the ramp.

16. The detectable warning shall be installed on the curb ramp at the intersection of the curb ramp and the ramp.

17. The detectable warning shall be installed on the curb ramp at the intersection of the curb ramp and the ramp.

18. The detectable warning shall be installed on the curb ramp at the intersection of the curb ramp and the ramp.

19. The detectable warning shall be installed on the curb ramp at the intersection of the curb ramp and the ramp.

20. The detectable warning shall be installed on the curb ramp at the intersection of the curb ramp and the ramp.

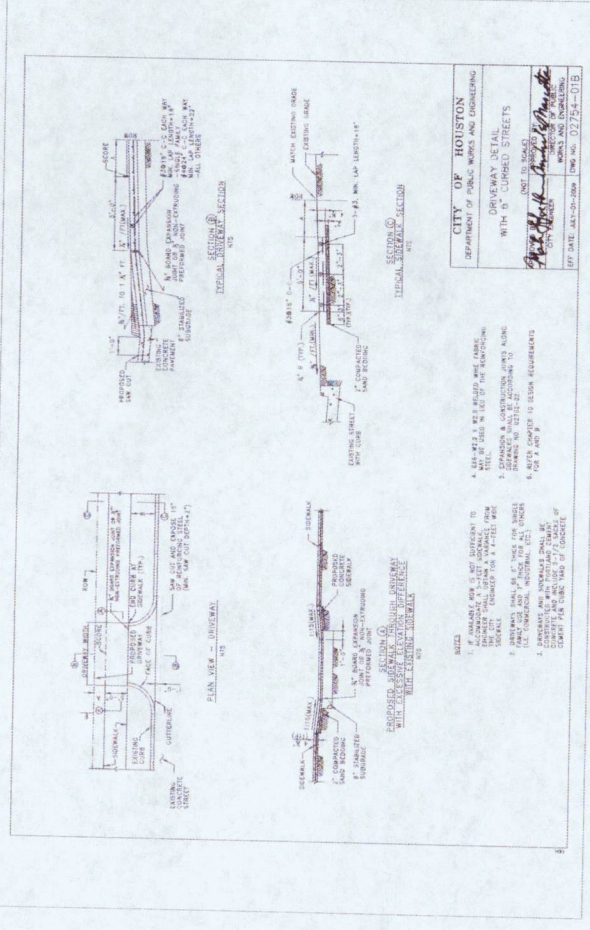

PEDESTRIAN FACILITIES CURB RAMP PED-12A

1. IF AVAILABLE USE A SET DIFFERENCE TO INDICATE THE CURB RAMP. IF NOT AVAILABLE, USE A SET DIFFERENCE TO INDICATE THE CURB RAMP.

2. EXPANSION AND CONTRACTION JOINTS SHALL BE INSTALLED AT THE INTERSECTION OF THE CURB RAMP AND THE STREET.

3. EXPANSION AND CONTRACTION JOINTS SHALL BE INSTALLED AT THE INTERSECTION OF THE CURB RAMP AND THE RAMP.

4. EXPANSION AND CONTRACTION JOINTS SHALL BE INSTALLED AT THE INTERSECTION OF THE CURB RAMP AND THE RAMP.

5. EXPANSION AND CONTRACTION JOINTS SHALL BE INSTALLED AT THE INTERSECTION OF THE CURB RAMP AND THE RAMP.

6. EXPANSION AND CONTRACTION JOINTS SHALL BE INSTALLED AT THE INTERSECTION OF THE CURB RAMP AND THE RAMP.

7. EXPANSION AND CONTRACTION JOINTS SHALL BE INSTALLED AT THE INTERSECTION OF THE CURB RAMP AND THE RAMP.

8. EXPANSION AND CONTRACTION JOINTS SHALL BE INSTALLED AT THE INTERSECTION OF THE CURB RAMP AND THE RAMP.

9. EXPANSION AND CONTRACTION JOINTS SHALL BE INSTALLED AT THE INTERSECTION OF THE CURB RAMP AND THE RAMP.

10. EXPANSION AND CONTRACTION JOINTS SHALL BE INSTALLED AT THE INTERSECTION OF THE CURB RAMP AND THE RAMP.

11. EXPANSION AND CONTRACTION JOINTS SHALL BE INSTALLED AT THE INTERSECTION OF THE CURB RAMP AND THE RAMP.

12. EXPANSION AND CONTRACTION JOINTS SHALL BE INSTALLED AT THE INTERSECTION OF THE CURB RAMP AND THE RAMP.

13. EXPANSION AND CONTRACTION JOINTS SHALL BE INSTALLED AT THE INTERSECTION OF THE CURB RAMP AND THE RAMP.

14. EXPANSION AND CONTRACTION JOINTS SHALL BE INSTALLED AT THE INTERSECTION OF THE CURB RAMP AND THE RAMP.

15. EXPANSION AND CONTRACTION JOINTS SHALL BE INSTALLED AT THE INTERSECTION OF THE CURB RAMP AND THE RAMP.

16. EXPANSION AND CONTRACTION JOINTS SHALL BE INSTALLED AT THE INTERSECTION OF THE CURB RAMP AND THE RAMP.

17. EXPANSION AND CONTRACTION JOINTS SHALL BE INSTALLED AT THE INTERSECTION OF THE CURB RAMP AND THE RAMP.

18. EXPANSION AND CONTRACTION JOINTS SHALL BE INSTALLED AT THE INTERSECTION OF THE CURB RAMP AND THE RAMP.

19. EXPANSION AND CONTRACTION JOINTS SHALL BE INSTALLED AT THE INTERSECTION OF THE CURB RAMP AND THE RAMP.

20. EXPANSION AND CONTRACTION JOINTS SHALL BE INSTALLED AT THE INTERSECTION OF THE CURB RAMP AND THE RAMP.

APPROVED: *Missy J. [Signature]*
 DEVELOPMENT COORDINATOR

DATE: 7/28/16