



Fort Bend County Engineering
FORT BEND COUNTY, TEXAS

Richard W. Stolleis, P.E.
County Engineer

September 19, 2016

Commissioner Richard Morrison
Fort Bend County Precinct 1
1517 Eugene Heimann Circle, Suite 300
Richmond, Texas 77469

RE: Mobility Project: Approval of Temporary Road Closure of: Edgewood Drive, 9th St., and 10th St. at FM359 at US 90A/UP RR, #0543-02-055

Dear Commissioner:

Fort Bend County Engineering is requesting approval for a temporary road closure of the intersection of Edgewood Drive, 9th St., and 10th St. at US 90A, pursuant to Section 251.011 of the Texas Transportation Code, during construction. The closure date is September 28, 2016 and to the end of the project. The closure is regarding the TxDOT project FM 359: at US 90A/UP RR, #0543-02-055. Maps depicting the area, and detour routes are attached.

If this meets your approval, we will place it on the September 27th agenda.

Sincerely,

Rick J. Staigle, PE, PTOE
First Assistant County Engineer

RJS/mjs

Attachment: Maps

cc: Mr. Tyler Bassinger, P.E., Zachry Tyler.Bassinger@Zachrycorp.com
File

September 19, 2016



Control: 0543-02-055
FM 359: at US 90A/UP RR
Fort Bend County

Mr. Richard Stolleis, P.E.
County Engineer
Fort Bend County Engineering Department
1124 Blume Road
Rosenberg, Texas 77471

Dear Mr. Stolleis:

The Contractor on this construction job, Zachry Corporation, has requested complete closures along US 90A at the intersections of Edgewood Dr., 9th and 10th to minimize the construction time and impact to the travelling public. These intersection closures will take place over a single weekend (per intersection) and will be constructed with fast track concrete pavement. Attached for your use are the proposed detour layouts for each intersection closure.

Please designate your approval by signing below and returning to us as soon as possible. We appreciate your consideration in this matter. If you have any questions, or need additional information, please contact Robert S. Bissett, P.E. at (281) 238-7903.

Sincerely,

Grady B. Mapes, PE
Fort Bend Area Engineer
Houston District

RSB:
Attachments

Approval Granted _____
Richard Stolleis, P.E.
County Engineer, Fort Bend County

Date: _____

LEGEND:

— SIGN

— TYPE III BARRICADE

NOTES:

1. DETOUR FOR USE WHEN CONSTRUCTING FAST TRACK PAVEMENT AT THE INTERSECTION OF US 90A AND EASTBOUND MAINLANES AND EDGEWOOD DR.
2. PORTABLE CHANGEABLE MESSAGE SIGN "1", TO BE PLACED TWO (2) WEEKS PRIOR TO CLOSURE.
3. 9TH AND 10TH TO REMAIN OPEN WHILE THE CLOSURE AT EDGEWOOD DR. IS IN EFFECT.
4. FOR SIGN SPACING, REFER TO BC STANDARDS.
5. TYPE III BARRICADES TO BE PLACED ACROSS ENTIRE ROADWAY.
6. PROVIDE FLASHING WARNING LIGHTS ON ALL WARNING SIGNS AND BARRICADES.

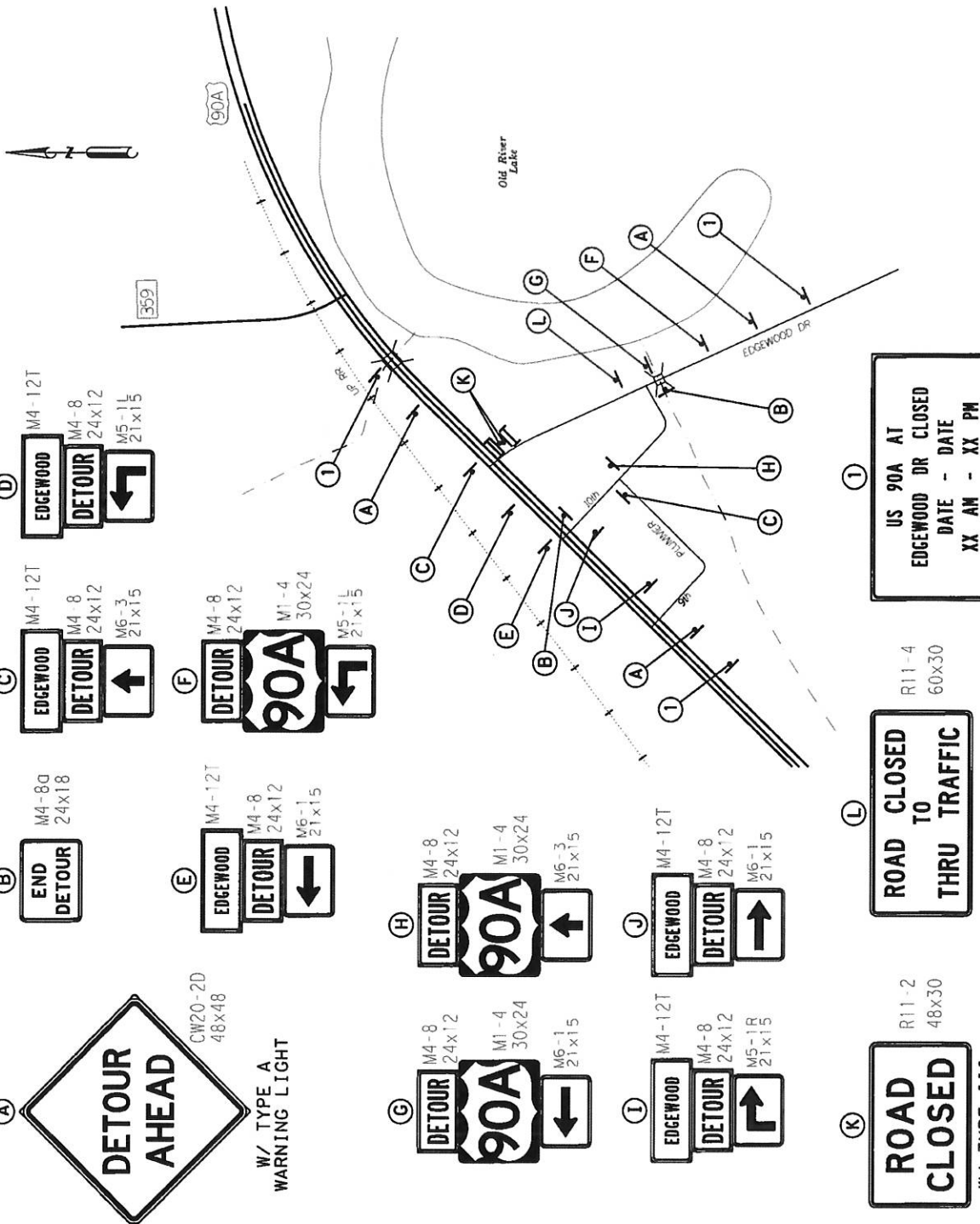

US 90A AT
EDGEWOOD DR CLOSED
DATE - DATE
XX AM - XX PM

ROAD CLOSED
TO
THRU TRAFFIC

ROAD CLOSED
W/ TYPE III
BARRICADES

R11-4
60x30

R11-2
48x30





Robert S. Bissett, Jr.
08/19/2016

DETOUR LAYOUT
US 90A CLOSURE
AT EDGEWOOD DR.

CONT	SECT	JOB	HIGHWAY
0543	02	055	FH 359
DIST	COUNTY	SHEET NO.	
HOU	FORT BEND	219C	

© 2014 Texas Department of Transportation
SHEET 1 OF 1
SCALE: 1"=600'

LEGEND:
 SIGN
 TYPE III BARRICADE

NOTES:

1. DETOUR FOR USE WHEN CONSTRUCTING FAST BELT OR FAST LANE ON THE US 90A EASTBOUND MAINLANE AND 9TH. TO BE REPLACED TWO (2) WEEKS PRIOR TO CLOSURE.
2. PORTABLE CHANGEABLE MESSAGE SIGN "1", TO BE PLACED AT 9TH AND 90A.
3. EDGEWOOD DR. AND 10TH TO REMAIN OPEN WHILE THE CLOSURE AT 9TH IS IN EFFECT.
4. FOR SIGN SPACING, REFER TO BC STANDARDS.
5. TYPE III BARRICADES TO BE PLACED ACROSS ENTIRE ROADWAY.
6. PROVIDE FLASHING WARNING LIGHTS ON ALL WARNING SIGNS AND BARRICADES.



Robert S. Bissett, Jr.
 089192016

DETOUR LAYOUT
US 90A CLOSURE
AT 9TH



© 2016 Texas Department of Transportation
 SCALE: 1"=600'

CONT	SECT	JOB	HIGHWAY	SHEET NO.
0543	02	055	FM 359	
			COUNTY	
			DIST	
			FORT BEND	219E
			NO.	

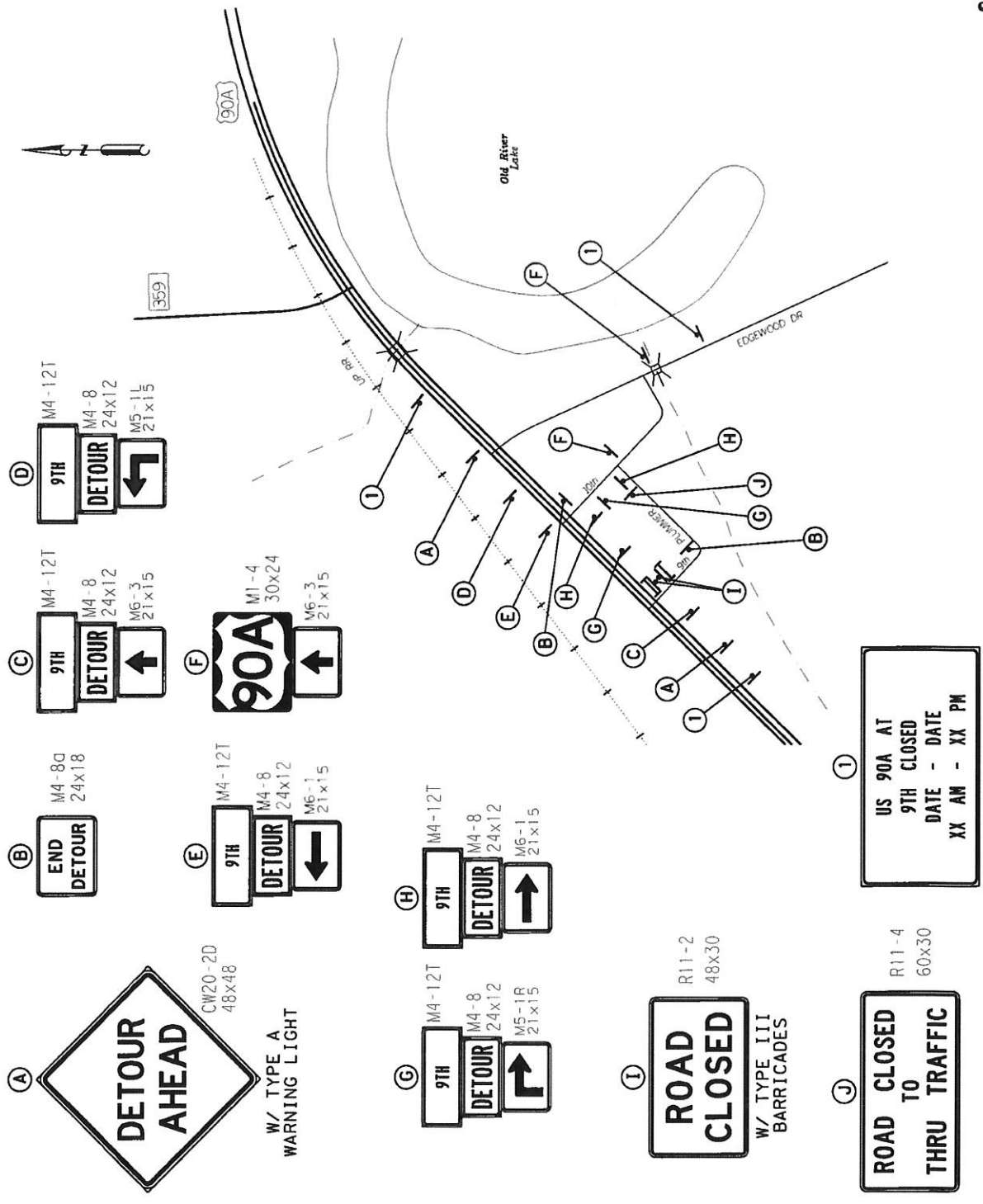

(D) M4-12T
 9TH
 DETOUR
 M4-8 24x12
 M5-1L 21x15

(C) M4-12T
 9TH
 DETOUR
 M4-8 24x12
 M6-3 21x15

(F) M1-4 30x24
 90A
 M6-3 21x15

(B) M4-8G 24x18
 END
 DETOUR

(E) M4-12T
 9TH
 DETOUR
 M4-8 24x12
 M6-1 21x15

(A) CW20-2D 48x48
 DETOUR
 AHEAD
 W/ TYPE A
 WARNING LIGHT

(H) M4-12T
 9TH
 DETOUR
 M4-8 24x12
 M6-1 21x15

(G) M4-12T
 9TH
 DETOUR
 M4-8 24x12
 M5-1R 21x15

(I) R11-2 48x30
 ROAD
 CLOSED
 W/ TYPE III
 BARRICADES

(1) US 90A AT
 9TH CLOSED
 DATE - DATE
 XX AM - XX PM

(J) R11-4 60x30
 ROAD CLOSED
 TO
 THRU TRAFFIC