

REVIEW BY FORT BEND COUNTY COMMISSIONERS COURT

On this 13th day of September, 2016, Commissioners Court came on to be heard and reviewed the accompanying notice of Windstream Sugar Land, Inc. Job Location 10161 Grand Parkway South, Richmond, TX 77407 Date 6/23/2009 Bond No. K08097604, Permit No. 2016-8911 to make use of certain Fort Bend County property subject to, "A Revised Order Regulating the Laying, Construction, Maintenance, and Repair of Buried Cables, Conduits, and Pole Lines, In, Under, Across or Along Roads, Streets, Highways, and Drainage Ditches in Fort Bend County, Texas, Under the Jurisdiction of the Commissioners Court of Fort Bend County, Texas," as passed by the Commissioners Court of Fort Bend County, Texas the 3rd day of August, 1987, recorded in Volume _____ of the Minutes of the Commissioners Court of Fort Bend County, Texas, to the extent that such order is not inconsistent with Article 1436a, Vernon's Texas Civil Statutes. Upon Motion of Commissioner Meyers, seconded by Commissioner Patterson, duly put and carried, it is ORDERED, ADJUDGED AND DECREED that said notice of said above purpose is hereby acknowledged by the Commissioners Court of Fort Bend County, Texas, and that said notice be placed on record according to the regulation order thereof.

Notes:

1. Evidence of review by the Commissioners Court must be kept on the job site and failure to do so constitutes grounds for job shutdown.
2. Written notices are required:
 - a. 48 hours in advance of construction start up, and
 - b. when construction is completed and ready for final inspection
 Mail notices to: Permit Administrator
 Fort Bend County Engineering
 301 Jackson Street
 Richmond, Texas 77469
 281-633-7500
3. This permit expires one (1) year from date of permit if construction has not commenced.

By: Charles O. A1
 ja County Engineer

By: N/A
 Drainage District Engineer/Manager

Presented to Commissioners Court and approved.

Recorded in Volume 9-13-16 13F
 Minutes of Commissioners Court

Clerk of Commissioners Court
 By: Ronda Willis
 Deputy

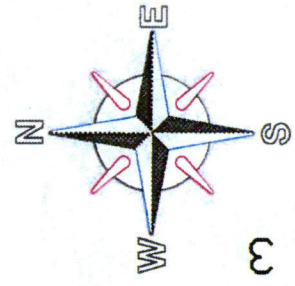

SEE DWG 3

W BELLFORT

W BELLFORT
 HH#2
 BHF(36X60X36)T
 HO1(B)>24<=48-48
 UOML-4
 BM2
 HOU(48)-1

SEE DWG 5

USE EXISTING CONDUIT
 TO CO

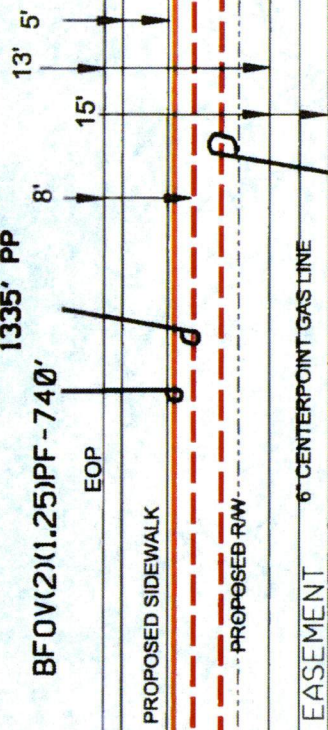

BF0241-3ISM
 A, 1-20
 CLF5, 33-36
 1335' PP

BF0V(2)(1.25)PF-740'

BF0481-3ISM
 TXxcf.1-48
 850' PP

BF0121-3ISM
 TXxcf.47-48
 A, 3-12
 670' PP

HEB
 10161 GRAND PARKWAY SOUTH
 TXxcf. 47-48
 A, 3-12
 PM21F
 VOML
 HO1(B)-2
 BM2

BF0481-3ISM
 TXxcf.1-46
 A, 47-48
 950' PP

UO 48
 CLF5, 1-48

CUSTOMER OWNED CONDUIT

LANDSCAPE

NOTE: FIBER CABLES
 OTHER
 OMITTED FOR CLARITY

WORK ORDER NUMBER:	720962225
DATE:	8/5/16
REVISION #:	1
REVISION DATE:	8/5/16
SHEET:	2
EXCHANGE:	SUGAR LAND
DISTRICT:	SOUTH
ENGINEER:	BRIAN HILL
PHONE NUMBER:	281-498-5328
CUT SHEET REQUIRED:	NO
PERMIT REQUIRED:	NO
MOP REQUIRED:	NO
JOINT WORK REQUIRED:	NO
JOB DESCRIPTION:	



SEE DWG 6

FDP - 12 FIBER WALL MOUNT PANEL

HEB

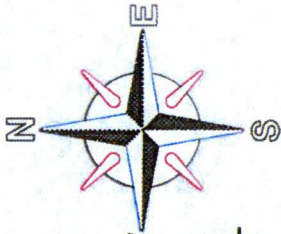

BF0241-3ISM
A, 1-20
CLF5, 33-36
1335' PP

STA 03+18
STA 02+50

STA 02+18
BM61(2)F - 32'

BF0V(2)(1.25)PF - 740'
13'

BF0481-3ISM
TXCCF, 1-48
850' PP

PROPOSED SIDEWALK

PROPOSED RW

15' POWER EASEMENT

6" CENTERPOINT GAS LINE

25' LANDSCAPE

SEE DWG 4

SEE DWG 2

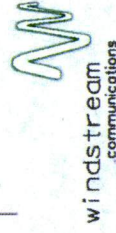

WORK ORDER NUMBER:	720962225
DATE:	8/5/16
REVISION #:	1
REVISION DATE:	8/5/16
SHEET:	3
EXCHANGE:	SUGAR LAND
DISTRICT:	SOUTH
ENGINEER:	BRIAN HILL
PHONE NUMBER:	281-498-9328
CUT SHEET REQUIRED:	NO
PERMIT REQUIRED:	NO
MOP REQUIRED:	NO
JOINT WORK REQUIRED:	NO
JOB DESCRIPTION:	

HEB

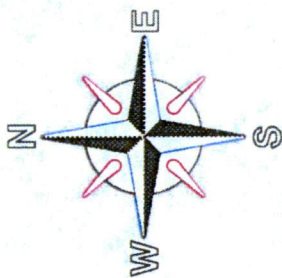

FUTURE FIBER



WORK ORDER NUMBER:	720962225
DATE:	8/13/16
REVISION #:	1
REVISION DATE:	8/13/16
SHEET	4
EXCHANGE	SUGAR LAND
DISTRICT	SOUTH
ENGINEER	BRIAN HILL
PHONE NUMBER	281-498-9328
CUT SHEET REQUIRED	NO
PERMIT REQUIRED	NO
MDP REQUIRED	NO
JOINT WORK REQUIRED	NO
JOB DESCRIPTION:	

W BELLFORT

CLOUSTON AVE

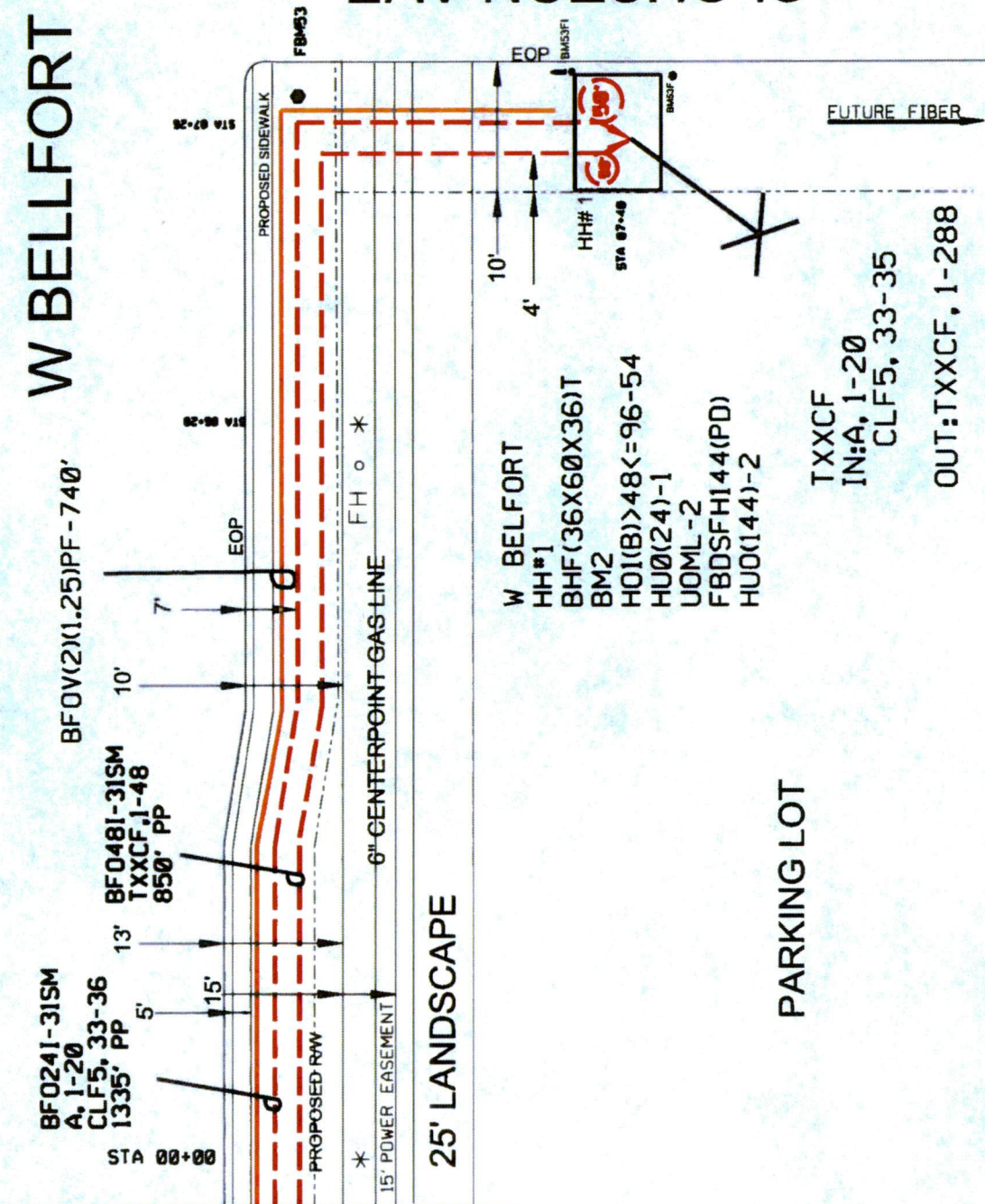

BFO241-3ISM
A, 1-20
CLF5, 33-36
1335' PP

STA 00+00

BFOV(2)(1.25)PF-740'

BFO481-3ISM
TXxcf, 1-48
850' PP

6" CENTERPOINT GAS LINE

25' LANDSCAPE

PARKING LOT

- W BELLFORT
- HH#1
- BHF(36X60X36)T
- BM2
- HO1(B)>48<=96-54
- HU0(24)-1
- UOML-2
- FBDSFH144(PD)
- HU0(144)-2

TXxcf
IN:A, 1-20
CLF5, 33-35
OUT:TXxcf, 1-288

SEE DWG 3

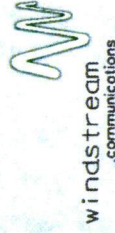
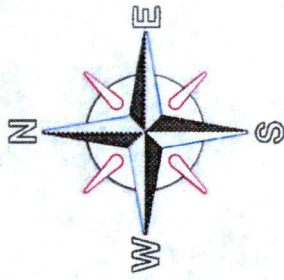

WORK ORDER NUMBER:	720962225
DATE:	8/5/16
REVISION #:	1
REVISION DATE:	8/5/16
SHEET:	5
EXCHANGE:	SUGAR LAND
DISTRICT:	SOUTH
ENGINEER:	BRIAN HILL
PHONE NUMBER:	281-498-3328
CUT SHEET REQUIRED:	NO
PERMIT REQUIRED:	NO
MOP REQUIRED:	NO
JOINT WORK REQUIRED:	NO
JOB DESCRIPTION:	

HARLEM RD/MA09TA1148
IN:CLF5,27-28
IN:A,3-24
OUT:MA09,1-300

TO REMOTE

HARLEM RD

HARLEM RD/42 50-3

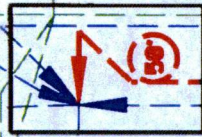

UO 24
 FBISDF2,23-24
 FBISDF2,31-36
 A,9-24

UO 48
 FBISDF4,1-48

UO 48
 CLF5,1-26
 A,27-28
 CLF5,29-32
 (CLF5,33-36)A,33-36
 CLF5,37-48

CO 12
 FBISDF2,31-32
 A,3-4
 FBISDF4,47-48
 FBISDF2,35-36
 A,9-10
 FBISDF4,45-46

CO 72
 FBISDF4,1-44
 A,45-72

CO 48
 CLF5,1-32
 (CLF5,33-36)A,33-36
 CLF5,37-44
 A,45-48

H01(B)K=12-4
 WHBFO
 UOML-1
 BM2
 HOU(48)-1

BF0241-3ISM
 A,1-20
 CLF5,33-36
 1335' PP

PULL FIBER IN
 EXISTING CONDUIT

CO 12
 FBISDF2,31-36
 FBISDF2,23-24
 A,9-12

UO 48
 CLF5,1-48

SEE DWG 2

SEE DWG 2

UO 48
CLF5,1-48

NOTE: FIBER CABLES
OTHER THAN CLF5,
OMITTED FOR CLARITY

BF0481-3ISM
TXxcf,1-46
A,47-48
950' PP

USE
EXISTING CONDUIT

HARLEM RD



314 87-28

UOML-1
BM2
HOU(48)-1

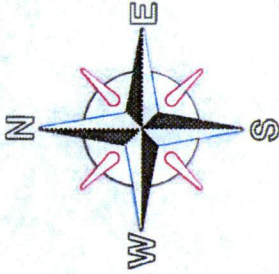

windstream
communications

WORK ORDER NUMBER:	728962225
DATE:	8/5/16
REVISION #:	1
REVISION DATE:	8/5/16
SHEET	6
EXCHANGE	SUGAR LAND
DISTRICT	SOUTH
ENGINEER	BRIAN HILL
PHONE NUMBER	281-499-9328
CUT SHEET REQUIRED	NO
PERMIT REQUIRED	NO
MDP REQUIRED	NO
JOINT WORK REQUIRED	NO
JOB DESCRIPTION:	

WORK LOCATION

GRAND PARKWAY

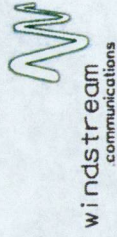
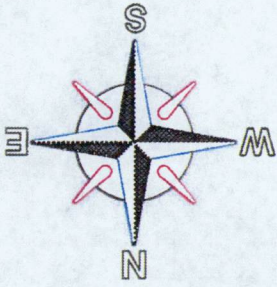

WORK ORDER NUMBER:	720962225
DATE:	8/5/16
REVISION #:	1
REVISION DATE:	8/6/16
SHEET	1
EXCHANGE	SUGAR LAND
DISTRICT	SOUTH
ENGINEER	BRIAN HILL
PHONE NUMBER	281-498-9328
CUT SHEET REQUIRED	NO
PERMIT REQUIRED	NO
MOP REQUIRED	NO
JOINT WORK REQUIRED	NO
JOB DESCRIPTION	

