

REVIEW BY FORT BEND COUNTY COMMISSIONERS COURT

On this 13th day of September, 2016, Commissioners Court came on to be heard and reviewed the accompanying notice of Cadence McShane Construction Company, LLC
 Job Location 18702 Beechnut Street, Richmond, TX 77407
 Date 8/25/2017 Bond No. 268008146, Permit No. 2016-8975 to make use of certain Fort Bend County property subject to, "A Revised Order Regulating the Laying, Construction, Maintenance, and Repair of Buried Cables, Conduits, and Pole Lines, In, Under, Across or Along Roads, Streets, Highways, and Drainage Ditches in Fort Bend County, Texas, Under the Jurisdiction of the Commissioners Court of Fort Bend County, Texas," as passed by the Commissioners Court of Fort Bend County, Texas the 3rd day of August, 1987, recorded in Volume _____ of the Minutes of the Commissioners Court of Fort Bend County, Texas, to the extent that such order is not inconsistent with Article 1436a, Vernon's Texas Civil Statutes. Upon Motion of Commissioner Meyers, seconded by Commissioner Palteron, duly put and carried, it is ORDERED, ADJUDGED AND DECREED that said notice of said above purpose is hereby acknowledged by the Commissioners Court of Fort Bend County, Texas, and that said notice be placed on record according to the regulation order thereof.

Notes:

1. Evidence of review by the Commissioners Court must be kept on the job site and failure to do so constitutes grounds for job shutdown.
2. Written notices are required:
 - a. 48 hours in advance of construction start up, and
 - b. when construction is completed and ready for final inspection
 Mail notices to: Permit Administrator
 Fort Bend County Engineering
 301 Jackson Street
 Richmond, Texas 77469
 281-633-7500
3. This permit expires one (1) year from date of permit if construction has not commenced.

By: Charles O. Loy
 109 County Engineer

By: N/A
 Drainage District Engineer/Manager

Presented to Commissioners Court and approved.
 Recorded in Volume 9-13-16 13C
 Minutes of Commissioners Court

Clerk of Commissioners Court
 By: Amanda Wilho
 Deputy

County of Fort Bend
Engineering Department

301 Jackson Street
Richmond, Texas 77469

Phone: (281) 633-7500

**Permit Application Review Form For
Cable, Conduit, and Pole Line Activity
In Fort Bend County**

Permit No. 2016-8975

The following "Notice of Proposed Cable, Conduit, and/or Pole Line activity in Fort Bend County" and accompanying attachments have been reviewed and the notice conforms to appropriate regulations set by Commissioner's Court of Fort Bend County, Texas.

<u> </u>	<u> </u>	<u> </u>	<u> </u>	<u> </u>	<u> </u>
X	(1) Complete Application Form:				
		X	a. Name of road, street, and/or drainage ditch affected.		
		X	b. Vicinity map showing course of directions		
		X	c. Plans and specifications		
X	(2) Bond:				
			District Attorney, approval when applicable.		
			Perpetual bond currently posted.		
			No:		
			Amount:		
		X	Performance bond submitted.		
			No: 268008146		
			Amount: \$20,000.00		
			Cashier's Check		
			No:		
			Amount:		
			(3) Verbal permission given for emergencies, to start construction before approved in Commissioner's Court.		
			Precinct Engineer Acknowledgment		Date
			Precinct Commissioner Acknowledgment		Date
			(4)		
			Drainage District Approval when applicable		
			We have reviewed this project and agree it meets minimum requirements.		

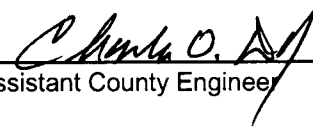
Assistant County Engineer

9/7/16
Date

**PERFORMANCE BOND COVERING ALL CABLE, CONDUIT AND/OR POLE LINE
ACTIVITY IN, UNDER, ACROSS OR ALONG FORT BEND COUNTY ROAD
AUTHORIZED**

BOND NO. 268008146

THE STATE OF TEXAS

§

KNOW ALL MEN BY THESE PRESENTS:

COUNTY OF FORT BEND

§

THAT WE, Cadence McShane Construction Company, LLC whose address is 11757 Katy Fwy #675, Houston, TX 77079 Texas, hereinafter called the Principal, And Liberty Mutual Insurance Company, a Corporation existing under and by virtue of the laws of the state of MA and authorized to do an indemnifying business in the state of Texas, and whose principal office is located at 175 Berkeley Street, Boston, MA 02116, whose officer residing in the State of Texas, authorized to accept service in all suits and actions brought whining said state is Jessica Rosser and Whose address is 5151 Belt Line Rd, Dallas, TX 75254, hereinafter called the Surety, and held and firmly bound unto, Robert e. Hebert, County Judge of Fort Bend County, Texas, or his successors in office, in the full sum of Twenty Thousand and 00/100 Dollars (\$ 20,000.00) current, lawful money of the United Stated of America, to be paid to said Robert E. Hebert, County Judge of Fort Bend County, Texas, or his successors in office, to which payment well and truly to be made and done, we, the undersigned, bind ourselves and each of us, our heirs, executors, administrators, successors, assigns, and legal representatives, jointly and severally, by these presents.

THE CONDITION OF THIS BOND IS SUCH THAT, WHEREAS, the above bounden principal contemplates laying, constructing, maintaining and/or repairing one or more cables, conduits, and/or pole lines in, under, across and/or along roads, streets and highways, commercial driveway and median openings or modifications in the County of Fort Bend, and the State of Texas, under the jurisdiction of the Commissioners' Court of Fort Bend County, Texas, pursuant to the Commissioners' Court order adopted on the 1st day of December, A.D. 1980, recorded in Volume 13, of the Commissioners' Court Minutes of Fort Bend County, Texas, regulating same, which Commissioners' Court order is hereby referred to and made a part hereof for all purposes as though fully set out herein;

AND WHEREAS, the principal desires to provide Fort Bend County with a performance bond covering all such cable, conduit and/or pole line activity, commercial driveway and median openings or modifications;

NOW, THEREFORE, if the above bounden principal shall faithfully perform all its cable, conduit and/or pole line activity (including, but not limited to the laying, construction, maintenance and/or repair of cables, conduits and/or pole lines) in, under, across and/or along roads, streets and highways, commercial driveway and median openings or modifications in the County of Fort Bend and State of Texas, under the jurisdiction of the Commissioners Court of Fort Bend County, Texas, pursuant to and in accordance with minimum requirements and conditions of the above mentioned Commissioners' Court order set forth and specified to be by said principal done and performed, at the time and in the manner therein specified, and shall pay over and make good and reimburse Fort Bend County, all loss and damages which Fort Bend County may sustain by reason of any failure or default on the part of said principal, then this obligation shall be null and void, otherwise to remain in full force and effect.

This bond is payable at the County Courthouse in the County of Fort Bend and State of Texas.

It is understood that at any time Fort Bend County deems itself insecure under this bond, it may require further and/or additional bonds of the principal.

EXECUTED this 25th day of August, 2016.

Cadence McShane Construction Company, LLC

PRINCIPAL

BY

Liberty Mutual Insurance Company

SURETY

Robert T. Pearson

BY Robert T. Pearson, Attorney-In-Fact

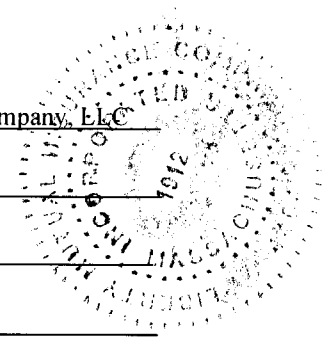

ACKNOWLEDGEMENT OF PRINCIPAL – IF A CORPORATION

STATE OF} SS
COUNTY OF.....}

On this..... day of....., before me personally appeared to be known, who, being by me duly sworn, did depose and say; that he/she resides at, that he/she is the of the corporation described in and which executed the within insurance instrument; that he/she knows the seal of said corporation; that the seal affixed to said instrument is such corporate seal; that is was so affixed by the Board of Directors of said corporation; and that he/she signed his/her name thereto by like order.

ACKNOWLEDGEMENT FOR PRINCIPAL, IF LIMITED LIABILITY COMPANY

STATE OF} SS
COUNTY OF.....}

On this 26th day of August 2016 before me personally appeared Gobby ROSE to me known and known to me to be the Vice President of Cadence McShane Construction, a Limited Liability Company, described in and who executed the foregoing insurance instrument and acknowledged to me that he/she executed the foregoing insurance instrument and acknowledged to me that he/she executed the same as and for the act and deed of said Limited Liability Company

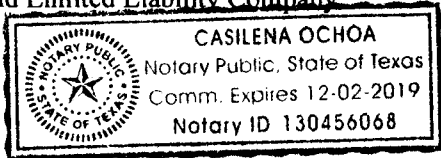

Casilena Ochoa

ACKNOWLEDGMENT OF SURETY COMPANY

STATE OF New York} SS
COUNTY OF Nassau.....}

On this August 25, 2016, before me personally came Robert T. Pearson to me known, who, being by me duly sworn, did depose and say; that he/she resides in Nassau County, State of New York at he/she is the Attorney-In-Fact of the Liberty Mutual Insurance Company the corporation described in which executed the above instrument; that he/she knows the seal of said corporation; that the seal affixed to said instrument is such corporate seal; that is was so affixed by order of the Board of Directors of said corporation; and that he/she signed his/her name thereto by like order; and the affiant did further depose and say that the Superintendent of Insurance of the State of New York, has, pursuant to Section 1111 of the Insurance Law of the State of New York, issued to Liberty Mutual Insurance Company (Surety) his/her certificate of qualification evidencing the qualification of said Company and its sufficiency under any law of the State of New York as surety and guarantor, and the propriety of accepting and approving it as such; and that such certificate has not been revoked.

GRACE ACKERSON
Notary Public-State of New York
No. 01AC8111590
Qualified in Nassau County
Commission Expires 6/14/2020

[Signature]
Notary Public

NY acknowledgment

THIS POWER OF ATTORNEY IS NOT VALID UNLESS IT IS PRINTED ON RED BACKGROUND.

This Power of Attorney limits the acts of those named herein, and they have no authority to bind the Company except in the manner and to the extent herein stated.

Certificate No. 7343436

American Fire and Casualty Company
The Ohio Casualty Insurance Company

Liberty Mutual Insurance Company
West American Insurance Company

POWER OF ATTORNEY

KNOWN ALL PERSONS BY THESE PRESENTS: That American Fire & Casualty Company and The Ohio Casualty Insurance Company are corporations duly organized under the laws of the State of New Hampshire, that Liberty Mutual Insurance Company is a corporation duly organized under the laws of the State of Massachusetts, and West American Insurance Company is a corporation duly organized under the laws of the State of Indiana (herein collectively called the "Companies"), pursuant to and by authority herein set forth, does hereby name, constitute and appoint, Camille Maitland; Colette R. Chisholm; Desiree Cardlin; George O. Brewster; Gerard S. Macholz; Lee Ferrucci; Mia Woo-Warren; Nelly Renchiwicz; Peter F. Jones; Rita Sagistano; Robert T. Pearson; Susan Lupski; Thomas Bean; Vincent A. Walsh

all of the city of Uniondale, state of NY each individually if there be more than one named, its true and lawful attorney-in-fact to make, execute, seal, acknowledge and deliver, for and on its behalf as surety and as its act and deed, any and all undertakings, bonds, recognizances and other surety obligations, in pursuance of these presents and shall be as binding upon the Companies as if they have been duly signed by the president and attested by the secretary of the Companies in their own proper persons.

IN WITNESS WHEREOF, this Power of Attorney has been subscribed by an authorized officer or official of the Companies and the corporate seals of the Companies have been affixed thereto this 26th day of April, 2016.

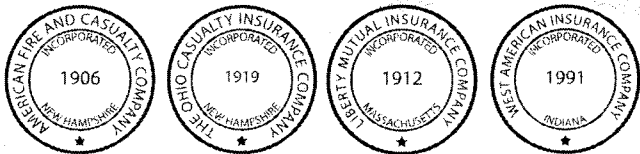

American Fire and Casualty Company
The Ohio Casualty Insurance Company
Liberty Mutual Insurance Company
West American Insurance Company

By: David M. Carey
David M. Carey, Assistant Secretary

STATE OF PENNSYLVANIA ss
COUNTY OF MONTGOMERY

On this 26th day of April, 2016, before me personally appeared David M. Carey, who acknowledged himself to be the Assistant Secretary of American Fire and Casualty Company, Liberty Mutual Insurance Company, The Ohio Casualty Insurance Company, and West American Insurance Company, and that he, as such, being authorized so to do, execute the foregoing instrument for the purposes therein contained by signing on behalf of the corporations by himself as a duly authorized officer.

IN WITNESS WHEREOF, I have hereunto subscribed my name and affixed my notarial seal at Plymouth Meeting, Pennsylvania, on the day and year first above written.



COMMONWEALTH OF PENNSYLVANIA
Notarial Seal
Teresa Pastella, Notary Public
Plymouth Twp., Montgomery County
My Commission Expires March 28, 2017
Member, Pennsylvania Association of Notaries

By: Teresa Pastella
Teresa Pastella, Notary Public

This Power of Attorney is made and executed pursuant to and by authority of the following By-laws and Authorizations of American Fire and Casualty Company, The Ohio Casualty Insurance Company, Liberty Mutual Insurance Company, and West American Insurance Company which resolutions are now in full force and effect reading as follows:

ARTICLE IV – OFFICERS – Section 12. Power of Attorney. Any officer or other official of the Corporation authorized for that purpose in writing by the Chairman or the President, and subject to such limitation as the Chairman or the President may prescribe, shall appoint such attorneys-in-fact, as may be necessary to act in behalf of the Corporation to make, execute, seal, acknowledge and deliver as surety any and all undertakings, bonds, recognizances and other surety obligations. Such attorneys-in-fact, subject to the limitations set forth in their respective powers of attorney, shall have full power to bind the Corporation by their signature and execution of any such instruments and to attach thereto the seal of the Corporation. When so executed, such instruments shall be as binding as if signed by the President and attested to by the Secretary. Any power or authority granted to any representative or attorney-in-fact under the provisions of this article may be revoked at any time by the Board, the Chairman, the President or by the officer or officers granting such power or authority.

ARTICLE XIII – Execution of Contracts – SECTION 5. Surety Bonds and Undertakings. Any officer of the Company authorized for that purpose in writing by the chairman or the president, and subject to such limitations as the chairman or the president may prescribe, shall appoint such attorneys-in-fact, as may be necessary to act in behalf of the Company to make, execute, seal, acknowledge and deliver as surety any and all undertakings, bonds, recognizances and other surety obligations. Such attorneys-in-fact subject to the limitations set forth in their respective powers of attorney, shall have full power to bind the Company by their signature and execution of any such instruments and to attach thereto the seal of the Company. When so executed such instruments shall be as binding as if signed by the president and attested by the secretary.

Certificate of Designation – The President of the Company, acting pursuant to the Bylaws of the Company, authorizes David M. Carey, Assistant Secretary to appoint such attorneys-in-fact as may be necessary to act on behalf of the Company to make, execute, seal, acknowledge and deliver as surety any and all undertakings, bonds, recognizances and other surety obligations.

Authorization – By unanimous consent of the Company's Board of Directors, the Company consents that facsimile or mechanically reproduced signature of any assistant secretary of the Company, wherever appearing upon a certified copy of any power of attorney issued by the Company in connection with surety bonds, shall be valid and binding upon the Company with the same force and effect as though manually affixed.

I, Gregory W. Davenport, the undersigned, Assistant Secretary, of American Fire and Casualty Company, The Ohio Casualty Insurance Company, Liberty Mutual Insurance Company, and West American Insurance Company do hereby certify that the original power of attorney of which the foregoing is a full, true and correct copy of the Power of Attorney executed by said Companies, is in full force and effect and has not been revoked.

IN TESTIMONY WHEREOF, I have hereunto set my hand and affixed the seals of said Companies this 26th day of April, 2016.

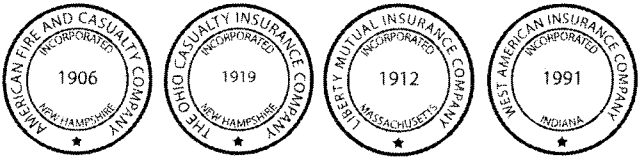

AUG 25 2016
By: Gregory W. Davenport
Gregory W. Davenport, Assistant Secretary

Not valid for mortgage, note, loan, letter of credit, currency rate, interest rate or residual value guarantees.

To confirm the validity of this Power of Attorney call 1-610-832-8240 between 9:00 am and 4:30 pm EST on any business day.



LIBERTY MUTUAL FIRE INSURANCE COMPANY
FINANCIAL STATEMENT — DECEMBER 31, 2015

Assets		Liabilities	
Cash and Bank Deposits.....	\$ 62,585,459	Unearned Premiums.....	\$1,052,883,251
*Bonds — U.S Government.....	498,222,200	Reserve for Claims and Claims Expense.....	2,706,742,189
*Other Bonds.....	3,029,457,678	Funds Held Under Reinsurance Treaties.....	0
*Stocks.....	412,472,088	Reserve for Dividends to Policyholders.....	0
Real Estate.....	0	Additional Statutory Reserve.....	0
Agents' Balances or Uncollected Premiums.....	637,046,294	Reserve for Commissions, Taxes and Other Liabilities.....	<u>319,155,723</u>
Accrued Interest and Rents.....	30,269,520	Total.....	\$ 4,078,781,163
Other Admitted Assets.....	<u>807,718,887</u>	Special Surplus Funds.....	\$ 10,862,551
Total Admitted Assets.....	<u>\$ 5,477,772,126</u>	Capital Stock.....	10,000,000
		Paid in Surplus.....	511,250,000
		Unassigned Surplus.....	866,878,413
		Surplus to Policyholders.....	<u>1,398,990,964</u>
		Total Liabilities and Surplus.....	<u>\$5,477,772,127</u>



* Bonds are stated at amortized or investment value; Stocks at Association Market Values.
 The foregoing financial information is taken from Liberty Mutual Fire Insurance Company's financial statement filed with the state of Wisconsin Department of Insurance.

I, TIM MIKOLAJEWSKI, Assistant Secretary of Liberty Mutual Fire Insurance Company, do hereby certify that the foregoing is a true, and correct statement of the Assets and Liabilities of said Corporation, as of December 31, 2015, to the best of my knowledge and belief.

IN WITNESS WHEREOF, I have hereunto set my hand and affixed the seal of said Corporation at Seattle, Washington, this 15th day of March, 2016.

TAMIKOLAJEWSKI

 Assistant Secretary



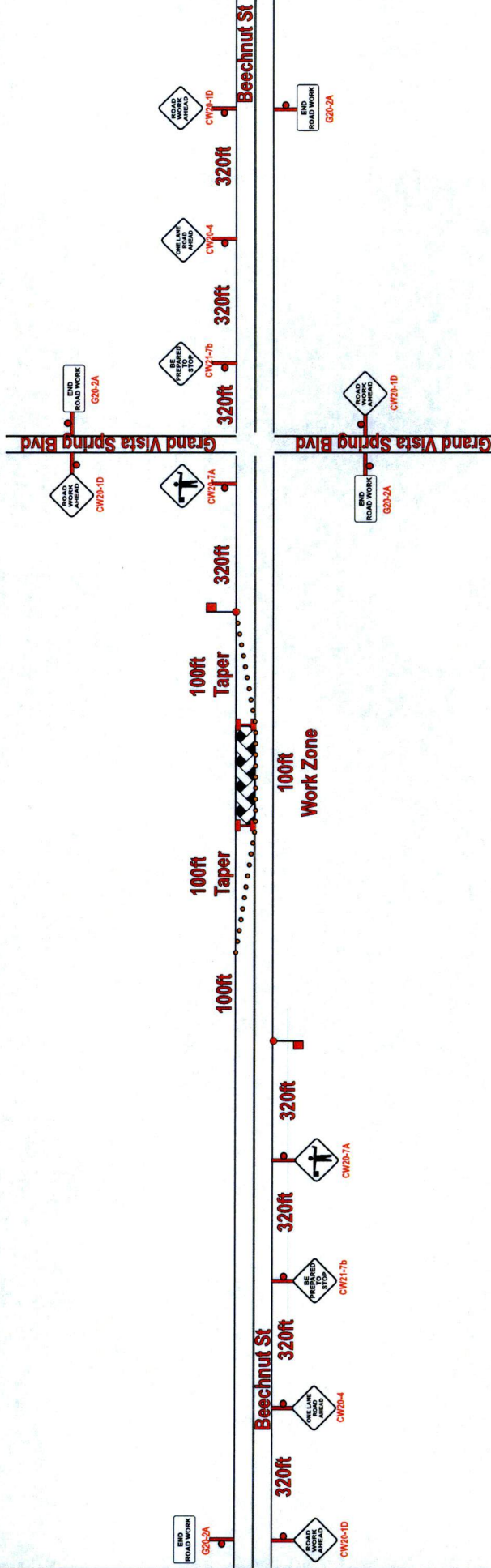
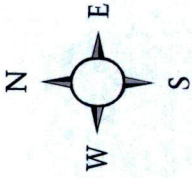

CITY

Richmond

CONTRACTOR

Cadence McShane

JOB NAME

Elementary School No. 50



DATE

08/17/16

Traffic Control Plans (TCP's) are included with Buyers Barricades rental agreements. Traffic Control Plans issued without rental agreement will be charged to the customer.

NOTES

Devices Spaced on 35ft Centers

	Type III
	Navigator

SALESMAN/EXECUTIVE

Rebekah Matamoros

TCP DESIGNER

Michael Cooper

THIS PLAN IS FOR ILLUSTRATIVE PURPOSES ONLY AND IS NOT INTENDED TO RELIEVE THE CONTRACTOR OF HIS RESPONSIBILITY TO TRAFFIC AND IS PROPERTY OF BUYERS BARRICADES, INC.



BUYERS
EST. 1984
BARRICADES
817.535.3939

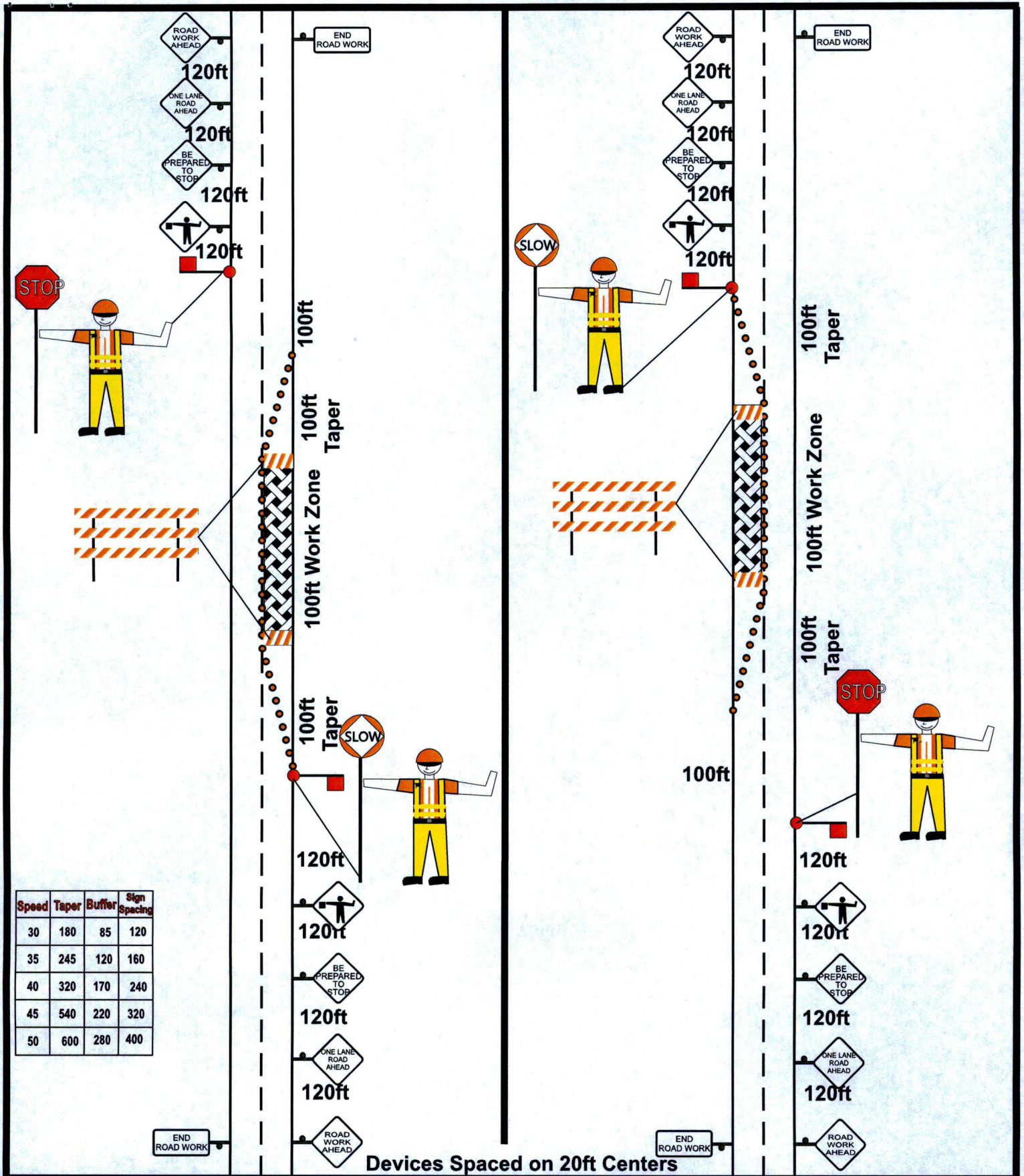

SALESMAN/EXECUTIVE
Blake Tuggle

TCP DESIGNER
Martin Taylor

THIS PLAN IS FOR ILLUSTRATIVE PURPOSES ONLY AND IS NOT INTENDED TO RELIEVE THE CONTRACTOR FROM THE REQUIREMENTS OF THE CONTRACT DOCUMENTS AND HIS RESPONSIBILITY TO TRAFFIC AND IS PROPERTY OF BUYERS BARRICADES, INC.

NOTES

CITY **Richmond**
 CONTRACTOR **Cadence McShane**
 JOB NAME **Elementary School No. 50**
 DATE **08/18/16**

Traffic Control Plans (TCP's) are included with Buyers Barricades rental agreements. Traffic Control Plans issued without rental agreement will be charged to the customer.

BUYERS
 EST. BARRICADES 1984
 817.535.3939

FORT BEND INDEPENDENT SCHOOL DISTRICT PROPOSED PRIVATE SANITARY SEWER, WATER LINE, STORM SEWER, AND GRADING TO SERVE GRAND VISTA ELEMENTARY SCHOOL

GRAND VISTA SPRINGS BLVD AT BEECHNUT RD
RICHMOND, TX 77407

JUNE 2016

BOARD OF TRUSTEES

GRAYLE JAMES PRESIDENT
DAVE ROSENTHAL VICE PRESIDENT
KRISTIN TASSON SECRETARY
ACDIE HELWIGER MEMBER
JANSON BURDINE MEMBER
JIM RICE MEMBER
CHARLES E. DUPRE, E.G.D. SUPERINTENDENT



ERDOUSE & SPARKS, INC.
Professional Engineers
10000 Katy Freeway, Suite 4000
Houston, Texas 77058
Tel: 281.341.8000
Fax: 281.341.8000

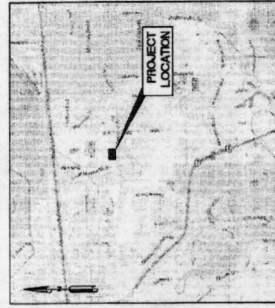
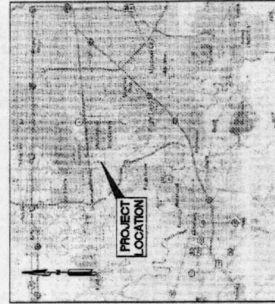

LOCATION MAP
N.T.S.
KEY MAP No. 2390 & 5268
ZIP CODE 77407

INDEX

SHEET NO.	DESCRIPTION
C1.0	COVER SHEET
C2.0	GENERAL NOTES
C3.0	TOPOGRAPHIC SURVEY
C4.0	SITE PLAN
C5.1	GRADING PLAN - SHEET 1 of 2
C5.2	GRADING PLAN - SHEET 2 of 2
C6.0	JOINT LAYOUT PLAN
C6.1	STORM SEWER PLAN - SHEET 1 of 2
C6.2	STORM SEWER PLAN - SHEET 2 of 2
C7.0	DRAINAGE AREA MAP - SHEET 1 of 3
C7.1	DRAINAGE AREA MAP - SHEET 2 of 3
C7.2	DRAINAGE AREA CALCULATIONS - SHEET 3 of 3
C8.1	WATER AND SANITARY SEWER PLAN - SHEET 1 of 2
C8.2	WATER AND SANITARY SEWER PLAN - SHEET 2 of 2
C8.3	STORM WATER POLLUTION PREVENTION PLAN
C9.0	PAVING DETAILS
C9.1	WATER DETAILS
C9.2	SANITARY SEWER DETAILS
C9.3	STORM SEWER DETAILS
C10.4	STORM WATER POLLUTION PREVENTION PLAN DETAILS
C10.5	TWOOT PFD 75A DETAILS

DATE: 06/02/2016 10:46:00 AM
DRAWN BY: J. DUPRE
CHECKED BY: J. DUPRE
APPROVED BY: J. DUPRE
DATE: 06/02/2016 10:46:00 AM

NOTIFICATION OF PRE-CONSTRUCTION MEETING AND ALL FINING ACTIVITIES:
DATE: 06/02/2016 10:46:00 AM

GENERAL CONSTRUCTION NOTES

- 1. THE CONTRACTOR SHALL COMPLY WITH THE CONSTRUCTION SCHEDULE WITH THE OWNER'S APPROVED PROJECT PROGRAM... 2. THE CONTRACTOR SHALL COMPLY WITH THE CONSTRUCTION SCHEDULE WITH THE OWNER'S APPROVED PROJECT PROGRAM...

PRIVATE UTILITY NOTES

- 1. THE CONTRACTOR SHALL BE RESPONSIBLE FOR THE LOCATION AND DEPTH OF ALL PRIVATE UTILITIES... 2. THE CONTRACTOR SHALL BE RESPONSIBLE FOR THE LOCATION AND DEPTH OF ALL PRIVATE UTILITIES...

STORM SEWER CONSTRUCTION NOTES

- 1. ON SITE STORM SEWER 18" AND LARGER SHALL BE COMPLETED FIRST... 2. ON SITE STORM SEWER 18" AND LARGER SHALL BE COMPLETED FIRST...

- 36. THE CONTRACTOR SHALL BE RESPONSIBLE FOR THE LOCATION AND DEPTH OF ALL PRIVATE UTILITIES... 37. THE CONTRACTOR SHALL BE RESPONSIBLE FOR THE LOCATION AND DEPTH OF ALL PRIVATE UTILITIES...

- 38. THE CONTRACTOR SHALL BE RESPONSIBLE FOR THE LOCATION AND DEPTH OF ALL PRIVATE UTILITIES... 39. THE CONTRACTOR SHALL BE RESPONSIBLE FOR THE LOCATION AND DEPTH OF ALL PRIVATE UTILITIES...

- 40. THE CONTRACTOR SHALL BE RESPONSIBLE FOR THE LOCATION AND DEPTH OF ALL PRIVATE UTILITIES... 41. THE CONTRACTOR SHALL BE RESPONSIBLE FOR THE LOCATION AND DEPTH OF ALL PRIVATE UTILITIES...

WATER LINE CONSTRUCTION NOTES

- 1. CONTRACTOR SHALL BE RESPONSIBLE FOR THE LOCATION AND DEPTH OF ALL PRIVATE UTILITIES... 2. CONTRACTOR SHALL BE RESPONSIBLE FOR THE LOCATION AND DEPTH OF ALL PRIVATE UTILITIES...

WATER LINE CONSTRUCTION NOTES

- 3. CONTRACTOR SHALL BE RESPONSIBLE FOR THE LOCATION AND DEPTH OF ALL PRIVATE UTILITIES... 4. CONTRACTOR SHALL BE RESPONSIBLE FOR THE LOCATION AND DEPTH OF ALL PRIVATE UTILITIES...

GENERAL NOTES

- 1. THE CONTRACTOR SHALL BE RESPONSIBLE FOR THE LOCATION AND DEPTH OF ALL PRIVATE UTILITIES... 2. THE CONTRACTOR SHALL BE RESPONSIBLE FOR THE LOCATION AND DEPTH OF ALL PRIVATE UTILITIES...

CONSTRUCTION - GENERAL NOTES

- 1. THE CONTRACTOR SHALL BE RESPONSIBLE FOR THE LOCATION AND DEPTH OF ALL PRIVATE UTILITIES... 2. THE CONTRACTOR SHALL BE RESPONSIBLE FOR THE LOCATION AND DEPTH OF ALL PRIVATE UTILITIES...

CONSTRUCTION - GENERAL NOTES

- 3. THE CONTRACTOR SHALL BE RESPONSIBLE FOR THE LOCATION AND DEPTH OF ALL PRIVATE UTILITIES... 4. THE CONTRACTOR SHALL BE RESPONSIBLE FOR THE LOCATION AND DEPTH OF ALL PRIVATE UTILITIES...

CONSTRUCTION - GENERAL NOTES

- 5. THE CONTRACTOR SHALL BE RESPONSIBLE FOR THE LOCATION AND DEPTH OF ALL PRIVATE UTILITIES... 6. THE CONTRACTOR SHALL BE RESPONSIBLE FOR THE LOCATION AND DEPTH OF ALL PRIVATE UTILITIES...

GENERAL NOTES table with columns for Sheet No., Date, and other project details.

Huckabee logo and project information for Grand Vista Elementary School.

Seal of Fort Bend County, Texas, with project name and location.

Seal of Fort Bend County, Texas, with project name and location.

Seal of Fort Bend County, Texas, with project name and location.

FORT BEND COUNTY SERRANILE BRIDGE
 APPROVED: *[Signature]*
 FORT BEND COUNTY
 DEVELOPMENT COORDINATOR

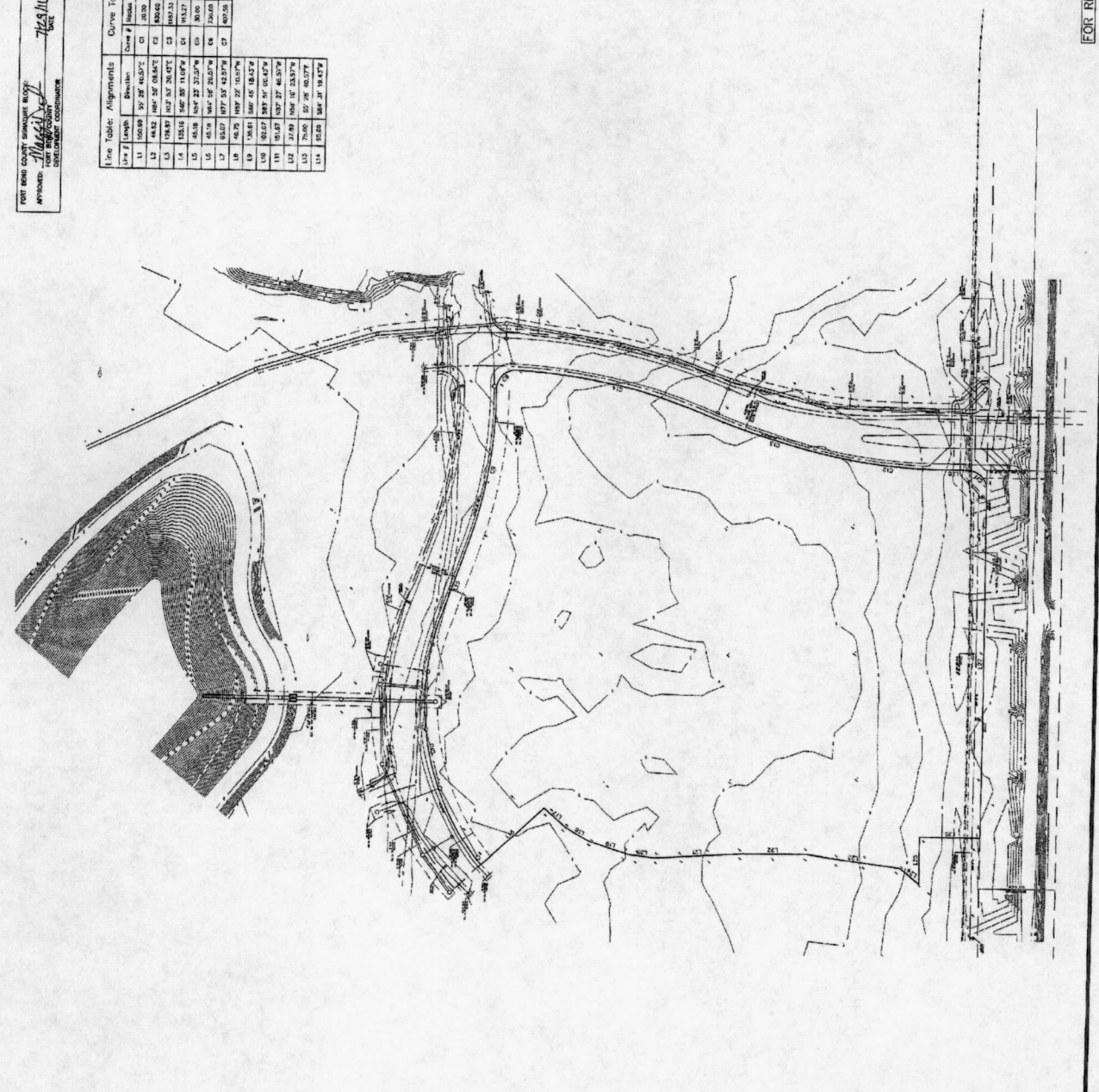

Line #	Length	Direction	Curve #	Station	Length	Curve #	Station	Curve #	Station	Curve #	Station
L1	150.00	S 72° 44.57' E	C1	0+00.00	48.50	C1	0+48.50	C2	0+48.50	C2	0+97.00
L2	44.82	N 88° 58' 08.86" E	C2	0+97.00	108.88	C2	205.88	C3	205.88	C3	314.76
L3	174.87	S 12° 31' 36.47" E	C3	314.76	204.85	C3	519.61	C4	519.61	C4	724.46
L4	123.55	S 68° 28' 11.89" W	C4	724.46	84.84	C4	809.30	C5	809.30	C5	994.14
L5	45.18	N 54° 22' 37.07" W	C5	994.14	184.25	C5	1178.39	C6	1178.39	C6	1362.64
L6	65.07	N 87° 57' 42.97" W	C6	1362.64	104.56	C6	1467.20	C7	1467.20	C7	1571.76
L7	46.75	N 89° 27' 01.17" W		1571.76							
L8	150.61	S 68° 45' 18.57" E		1722.37							
L9	62.07	S 89° 07' 05.47" E		1884.44							
L10	151.97	N 82° 27' 46.97" W		2036.41							
L11	27.89	N 56° 15' 33.97" E		2064.30							
L12	75.00	S 57° 59' 00.27" E		2140.30							
L13	25.00	S 57° 59' 00.27" E		2165.30							
L14	55.00	S 68° 37' 18.47" E		2220.30							

1 03/10/16 Addendum 02
 2 09/17/16 Addendum 04 - Dist. Settings/
 3 09/21/16 Fort Bend County Drainage District Comment Response
 4 09/21/16 Fort Bend County Drainage District Comment Response

PROJECT
 GRAND VISTA ELEMENTARY SCHOOL
 FOR
 FORT BEND ISD
 RICHMOND, TEXAS

Huckabee
 OVERALL
 TOPOGRAPHIC
 SURVEY
 SHEET No.
 1427-0005
 SHEET No.
 22/16
 C.3.0

FOR REFERENCE ONLY

13 At 2015 5:08PM
 R:\Projects\191006_Serranile\1427-0005-00 FBSD ELEM 50'Cont\13-SURVEYING
 huckabee\k-f\topo\mg X-17.dwg

APPROVED: *Hughes* FOR FORT BEND COUNTY DEVELOPMENT COORDINATOR

7/23/16 SHEET

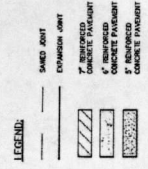
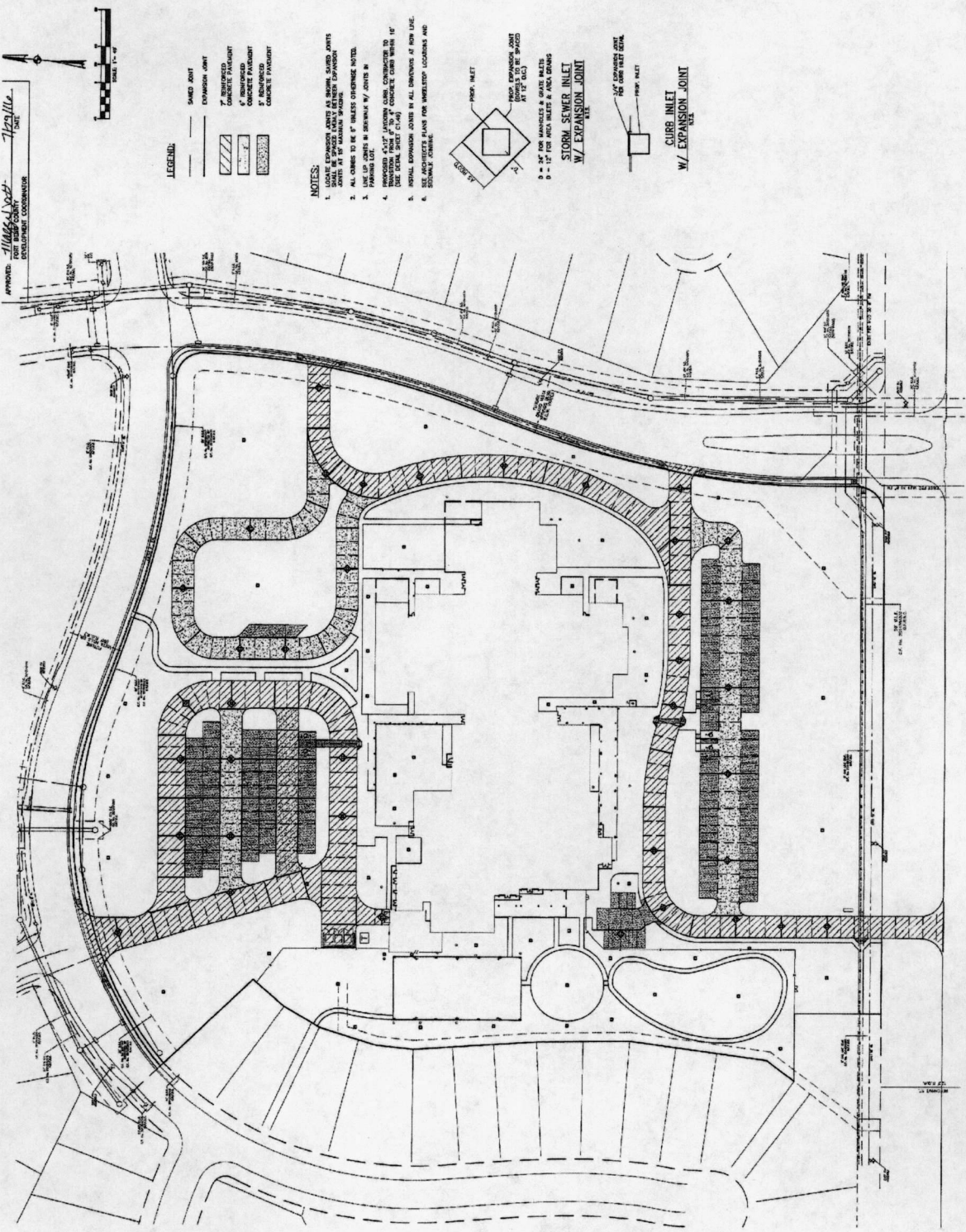

- NOTES:**
1. LOCATE EXPANSION JOINTS AT BOUNDARY JOINTS SHALL BE SPACED UNLESS OTHERWISE SPECIFIED.
 2. ALL CHANGES TO BE 2" UNLESS OTHERWISE NOTED.
 3. USE UP JOINTS IN DRIVEWAY W/ JOINTS IN PARKING LOT.
 4. EXPANSION JOINTS SHALL BE LOCATED TO PROVIDE A MINIMUM OF 10' CLEARANCE TO THE SIDE OF THE JOINT (SEE DETAIL SHEET C1-6A).
 5. MINIMAL EXPANSION JOINTS IN ALL DIMENSIONS AT ROW LINE.
 6. SEE DETAIL SHEET C1-6A FOR JOINT LOCATIONS AND SPACING.

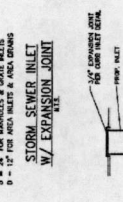
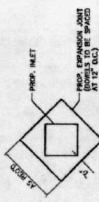

FOR
GRAND VISTA ELEMENTARY SCHOOL
FORT BEND ISD
RICHMOND, TEXAS

Project:



JOINT LAYOUT PLAN

Sheet No.	C5.2
Scale	1" = 10'
Date	7/23/16

Revision / Date	Description
1 03/10/16	Addressed 02
2 05/11/16	Fort Bend Address
3 05/11/16	Fort Bend County Comment Response
4 05/21/16	Fort Bend County Drainage District Comment Response

18 JUL 2016 9:07AM Every
F:\PROJECTS\CORPUS CHRISTI\FRD\160716\160716-00-RSD DMW SCHM/C&S STMS
Inches X=12, Y=12, Z=12, Units=Feet, X-Units=Inches, Y-Units=Inches, Z-Units=Inches, X-Title=

<p>SEAL OF THE STATE OF TEXAS OFFICE OF THE ATTORNEY GENERAL 66-343-10 JULY 15, 2016 JULIE ROBERTSON</p>	<p>Huckabee REGISTERED PROFESSIONAL ENGINEER NO. 16169 EXPIRES 12/31/17</p>	<p>STORM SEWER PLAN SHEET NO. DATE BY S.C. 10000000 Sheet No. CC.0 2/22/16</p>
--	---	--

PROJECT

FOR
GRAND VISTA ELEMENTARY SCHOOL
FOR
FORT BEND ISD
RICHMOND, TEXAS

Revision / Date

4	06/21/16	Fort Bend County Drainage District Comment Response
3	05/17/16	Addendum 02 - Cost Savings/ Addendum 04 - Fort Bend County Comment Response
2	04/12/16	03/10/16
1	03/10/16	

APPROVED: *J. Mackey*
ENGINEER IN CHARGE
DATE: 7/29/16

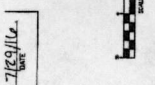

- LEGEND:**
- PROPOSED MANHOLE
 - PROPOSED MANHOLE W/ GROUND TOP
 - PROPOSED MANHOLE/COMP. INLET
 - PROPOSED INCOMING INLET
 - DIRECTION OF FLOW
 - FLOOR LINE
 - PROPOSED C/O
 - PROPOSED C/O
1. 12" DIA. 12" DIA. 12" DIA. 12" DIA. 12" DIA.
 2. 18" DIA. 18" DIA. 18" DIA. 18" DIA. 18" DIA.
 3. 24" DIA. 24" DIA. 24" DIA. 24" DIA. 24" DIA.
 4. 30" DIA. 30" DIA. 30" DIA. 30" DIA. 30" DIA.
 5. 36" DIA. 36" DIA. 36" DIA. 36" DIA. 36" DIA.
 6. 42" DIA. 42" DIA. 42" DIA. 42" DIA. 42" DIA.
 7. 48" DIA. 48" DIA. 48" DIA. 48" DIA. 48" DIA.
 8. 54" DIA. 54" DIA. 54" DIA. 54" DIA. 54" DIA.
 9. 60" DIA. 60" DIA. 60" DIA. 60" DIA. 60" DIA.
 10. 66" DIA. 66" DIA. 66" DIA. 66" DIA. 66" DIA.

GENERAL NOTES:

- ALL MANHOLES UTILIZED SHALL BE SET BACK TO THE CENTERLINE OF THE ROADWAY UNLESS OTHERWISE SHOWN IN THE PLAN. ALL UTILITY LOCATIONS SHALL BE SET BACK TO THE CENTERLINE OF THE ROADWAY UNLESS OTHERWISE SHOWN IN THE PLAN.
- CONSTRUCTION TO VERIFY ALL UNDERGROUND UTILITIES IN THE FIELD PRIOR TO CONSTRUCTION.
- CONSTRUCTION SHALL BE IN ACCORDANCE WITH THE SPECIFICATIONS TO THE STANDARD SPECIFICATIONS FOR ROADWAY CONSTRUCTION, LATEST EDITION, AS APPLICABLE TO THE STATE OF TEXAS, AS AMENDED TO BE FULLY RESPONSIBLE TO THE CONTRACTOR. THE CONTRACTOR SHALL BE RESPONSIBLE FOR VERIFYING ALL UTILITY LOCATIONS AND PRESERVE THESE UNDISTURBED UTILITIES. EXACTLY LOCATE AND PRESERVE THESE UNDISTURBED UTILITIES. ALL UTILITIES SHALL BE SET BACK TO THE CENTERLINE OF THE ROADWAY UNLESS OTHERWISE SHOWN IN THE PLAN.
- ALL UTILITY LOCATIONS SHALL BE SET BACK TO THE CENTERLINE OF THE ROADWAY UNLESS OTHERWISE SHOWN IN THE PLAN.

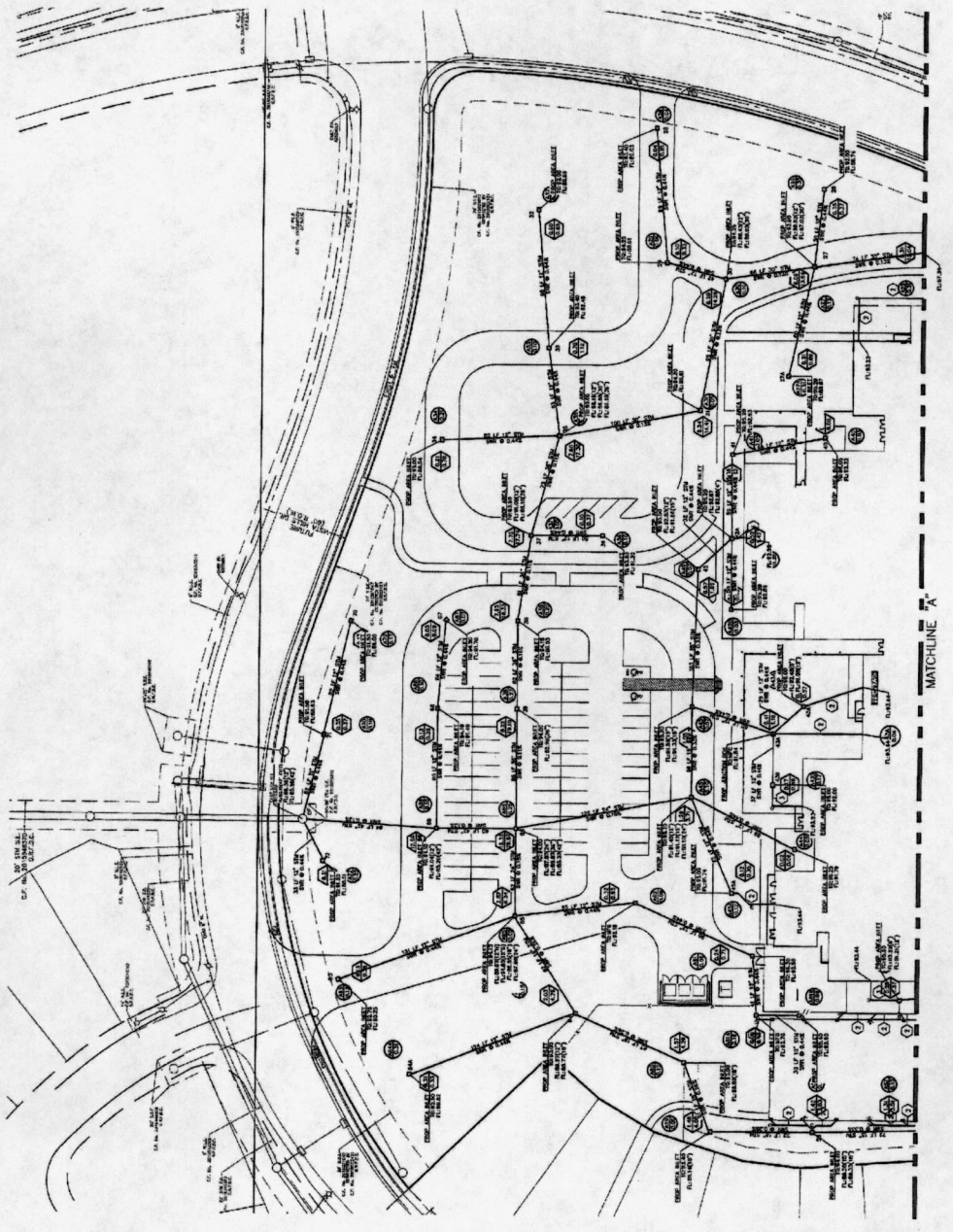

FORT BEND COUNTY SIGNATURE BLOCK:
 APPROVED: FORT BEND COUNTY
 DEVELOPMENT COORDINATOR

DATE _____

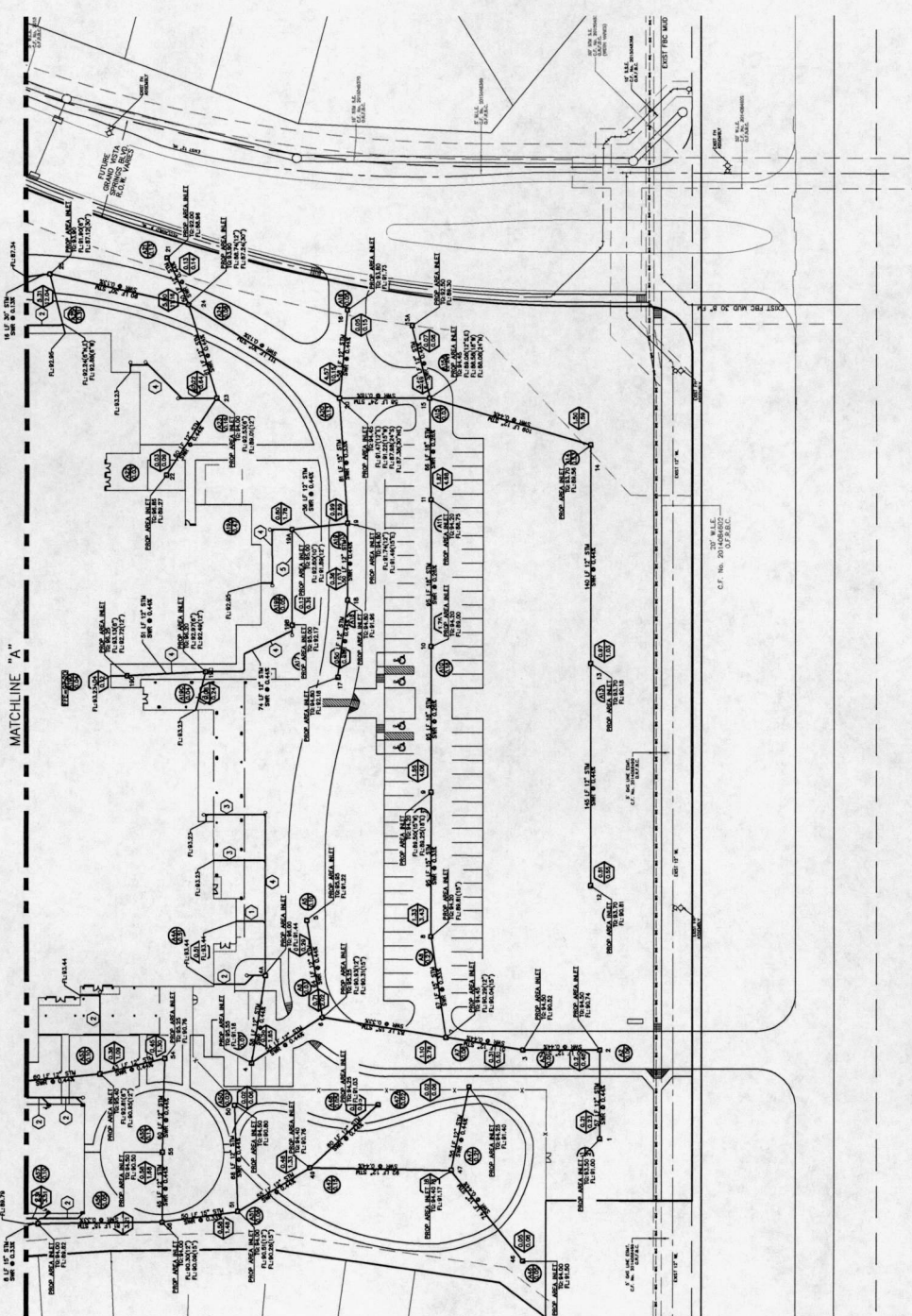

- LEGEND:**
- PROPOSED MANHOLE
 - PROPOSED MANHOLE W/PAVTE TOP
 - PROPOSED DRAIN/CURB INLET
 - PROPOSED WALKWAY INLET
 - DIRECTION OF FLOW
 - FLOW LINE
 - PROPOSED CLEANOUT
 - C.O.
 - ① PROP. 4" STN. SW. @ 1.000' MIN.
 - ② PROP. 6" STN. SW. @ 1.000' MIN.
 - ③ PROP. 8" STN. SW. @ 1.000' MIN.
 - ④ PROP. 10" STN. SW. @ 1.000' MIN.
 - ⑤ PROP. 12" STN. SW. @ 1.000' MIN.
 - ⑥ PROP. 15" STN. SW. @ 1.000' MIN.
 - ⑦ PROP. 18" STN. SW. @ 1.000' MIN.

GENERAL NOTES:

- ALL EXISTING UNDERGROUND UTILITIES SHOWN ARE NOT GUARANTEED TO BE ACCURATE. VERIFY ALL UTILITIES PRIOR TO CONSTRUCTION.
- VERIFY ALL UTILITIES PRIOR TO CONSTRUCTION.
- THE LOCATION OF ALL UTILITIES PRESENTED ON THESE DRAWINGS SHALL BE VERIFIED BY THE CONTRACTOR PRIOR TO CONSTRUCTION. ALL UTILITIES NOT SHOWN ON THESE DRAWINGS SHALL BE EXACTLY LOCATED AND PRESERVED BY THE CONTRACTOR. ALL UTILITIES NOT SHOWN ON THESE DRAWINGS SHALL BE EXACTLY LOCATED AND PRESERVED BY THE CONTRACTOR. ALL UTILITIES NOT SHOWN ON THESE DRAWINGS SHALL BE EXACTLY LOCATED AND PRESERVED BY THE CONTRACTOR.
- ALL UTILITIES SHALL BE PROTECTED BY A MINIMUM 18" CONCRETE PAVEMENT FINISHED SURFACE SHALL BE MAINTAINED AT ALL TIMES.

Revision / Date	Description
1 03/10/16	Adendum 02
2 05/11/16	Adendum 04 - Cost Savings/
3 05/11/16	Fort Bend County Comments Response
4 06/21/16	Fort Bend County Comments Response

Project: **GRAND VISTA ELEMENTARY SCHOOL FOR FORT BEND ISD RICHMOND, TEXAS**



Sheet No.	C6.1
Project No.	15-04-16
Revision	05/11/16
Drawn By	
Checked By	
Approved By	

10 Aug 2016 3:32PM 105794
 P:\Projects\15000\15000-Huckabee-487-0009-00-FBISD-Edm-50\CH\CS-5TM.dwg
 Includes: Mxv(A), X-TB.dwg, X-TB.dwg, X-Site.dwg, c7.dwg, 00.dwg, X-LIT.dwg

10 Aug 2016 2:33PM 10357
 F:\Projects\BROCK_SF\Huckabee\422-009-00 FISD Elem 50\CW\07 DAM.dwg
 Includes Xref(s): X-18.dwg; X-top.dwg; X-UT.dwg; X-Site.dwg

FORT BEND COUNTY SIGNATURE BLOCK:
 APPROVED: FORT BEND COUNTY
 DEVELOPMENT COORDINATOR

DATE _____

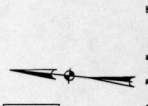

LEGEND:

AREA (NO.)
 AREA (A0)

CUMULATIVE (A0)
 CUMULATIVE (CPS)

SYSTEM AREA
 SUB-SYSTEM AREA

DIRECTION OF 100% EXTREME EVENT FLOW
 POHONG DEPTH IN STREET
 (0.50)

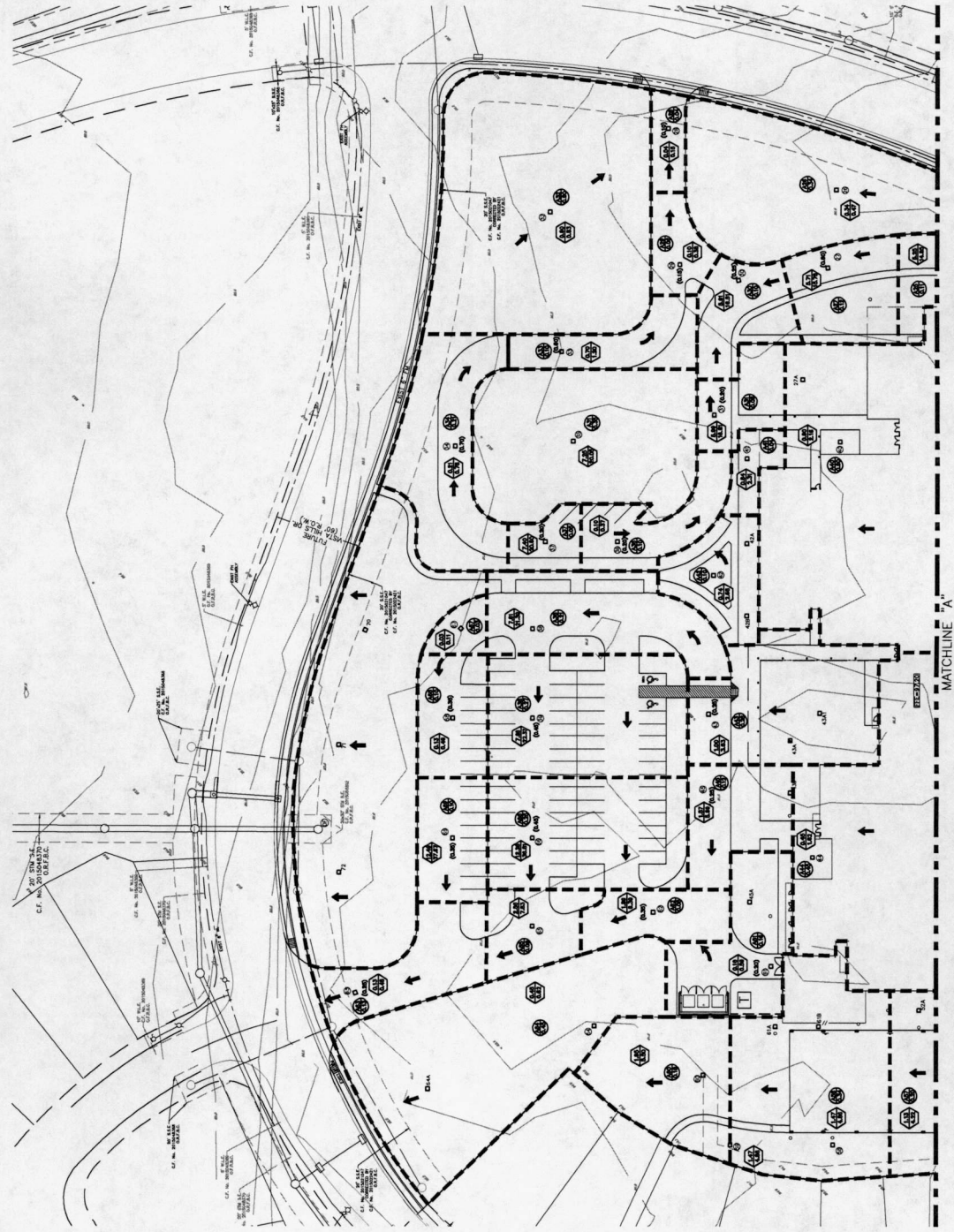

Revision / Date 4 06/21/16 Fort Bend County Comment Responses 3 05/11/16 Fort Bend County Comment Responses 2 04/12/16 Address-Bid Addendum 03/10/16 Address-Bid Addendum 02 Fort Bend County Prequal District Comment Responses		Project: GRAND VISTA ELEMENTARY SCHOOL FOR FORT BEND ISD RICHMOND, TEXAS			DRAINAGE AREA MAP (1 OF 2) Date: 5/24/16 Sheet No: C7.0 Scale: 1" = 30'-0"
---	--	--	--	--	--

13 AT 2016 01884 10/17/16
 HENDERSON ENGINEERING, INC. 10/17/16
 10/17/16 10/17/16 10/17/16 10/17/16

FOR FURTHER INFORMATION
 CONTACT THE ENGINEER

DATE: 10/17/16

Revision / Date
 4 09/21/16 Fort Bend County Drainage District Comment Responses
 3 03/09/16 Addendum 02
 2 06/17/16 Final Design
 1 03/09/16 Addressed 02

Project: GRAND VISTA ELEMENTARY SCHOOL FOR FORT BEND ISD RICHMOND, TEXAS



DESIGN AREA
 DRAWN (2 OF 2)
 SHEET NO. C7.1
 DATE 10/17/16

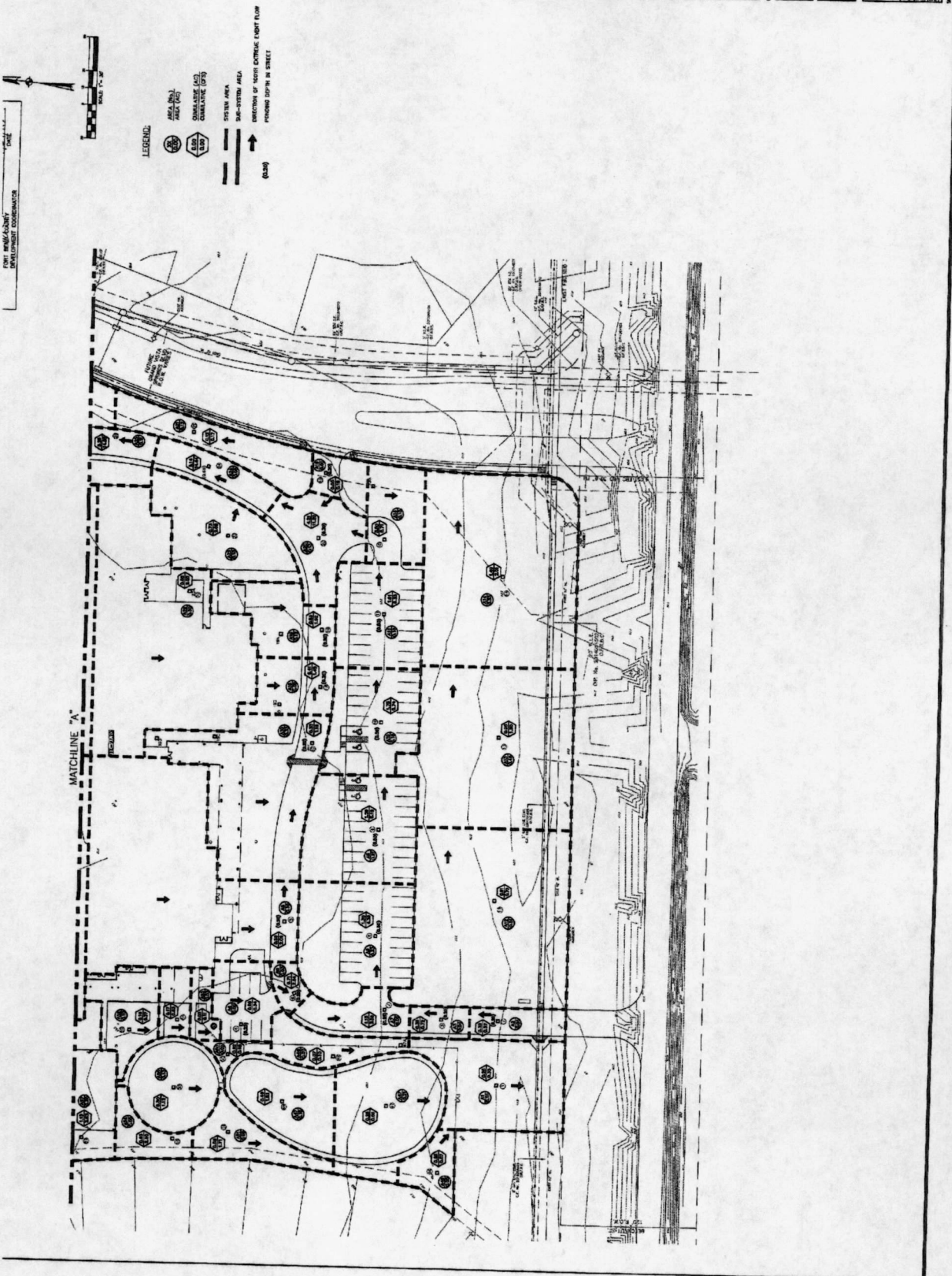

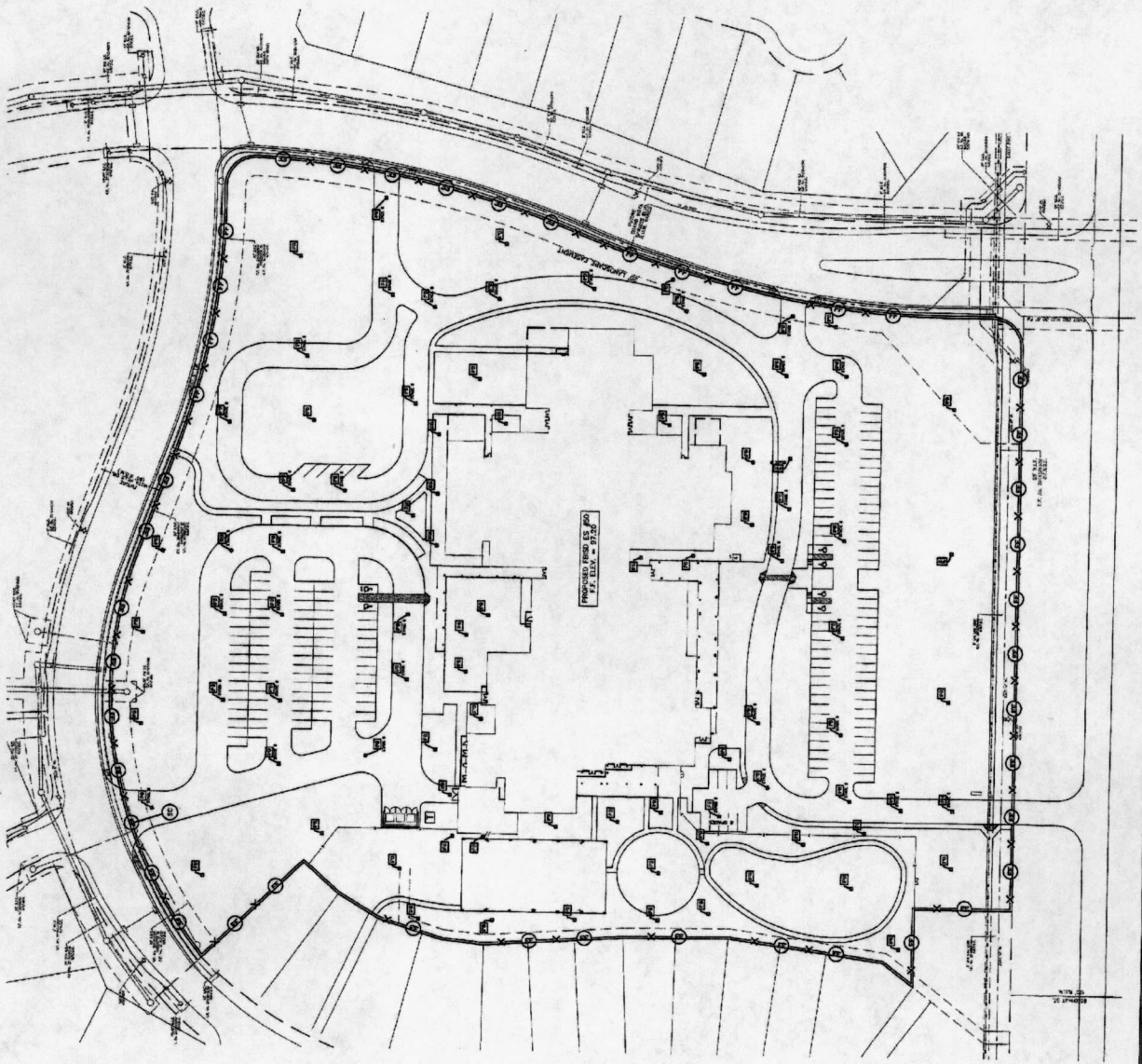

SHPP - CONSTRUCTION NOTES

1. GENERAL: ALL WORK SHALL BE DONE IN ACCORDANCE WITH THE LATEST EDITIONS OF THE SPECIFICATIONS FOR CONSTRUCTION OF BUILDINGS AND THE SPECIFICATIONS FOR STRUCTURAL STEEL ERECTED IN ACCORDANCE WITH THE AISC 13TH EDITION. ALL MATERIALS SHALL BE OF THE BEST QUALITY AVAILABLE AND SHALL BE SUBJECT TO INSPECTION AND TESTING BY THE OWNER'S REPRESENTATIVE.
2. FOUNDATION: ALL FOUNDATIONS SHALL BE CONSTRUCTED ON UNDISTURBED SOIL. ALL FOUNDATIONS SHALL BE SUBJECT TO INSPECTION AND TESTING BY THE OWNER'S REPRESENTATIVE.
3. CONCRETE: ALL CONCRETE SHALL BE OF THE BEST QUALITY AVAILABLE AND SHALL BE SUBJECT TO INSPECTION AND TESTING BY THE OWNER'S REPRESENTATIVE.
4. MASONRY: ALL MASONRY SHALL BE OF THE BEST QUALITY AVAILABLE AND SHALL BE SUBJECT TO INSPECTION AND TESTING BY THE OWNER'S REPRESENTATIVE.
5. STEEL: ALL STEEL SHALL BE OF THE BEST QUALITY AVAILABLE AND SHALL BE SUBJECT TO INSPECTION AND TESTING BY THE OWNER'S REPRESENTATIVE.
6. PAINTS AND COATINGS: ALL PAINTS AND COATINGS SHALL BE OF THE BEST QUALITY AVAILABLE AND SHALL BE SUBJECT TO INSPECTION AND TESTING BY THE OWNER'S REPRESENTATIVE.
7. MECHANICAL, ELECTRICAL AND PLUMBING: ALL MECHANICAL, ELECTRICAL AND PLUMBING SHALL BE OF THE BEST QUALITY AVAILABLE AND SHALL BE SUBJECT TO INSPECTION AND TESTING BY THE OWNER'S REPRESENTATIVE.
8. ROOFING: ALL ROOFING SHALL BE OF THE BEST QUALITY AVAILABLE AND SHALL BE SUBJECT TO INSPECTION AND TESTING BY THE OWNER'S REPRESENTATIVE.
9. FINISHES: ALL FINISHES SHALL BE OF THE BEST QUALITY AVAILABLE AND SHALL BE SUBJECT TO INSPECTION AND TESTING BY THE OWNER'S REPRESENTATIVE.
10. SCHEDULE: ALL WORK SHALL BE COMPLETED WITHIN THE SCHEDULED TIME FRAME.
11. SAFETY: ALL WORK SHALL BE DONE IN ACCORDANCE WITH ALL APPLICABLE SAFETY REGULATIONS.
12. QUALITY CONTROL: ALL WORK SHALL BE SUBJECT TO INSPECTION AND TESTING BY THE OWNER'S REPRESENTATIVE.
13. PROTECTION: ALL EXISTING UTILITIES SHALL BE PROTECTED AND MAINTAINED THROUGHOUT CONSTRUCTION.

- LEGEND:**
- PROPOSED RILEY
 - PROPOSED RILEY (SEE NOTES)
 - PROPOSED STRAP RAIL (FENCE)
 - STABILIZED CONSTRUCTION JACKETS
 - RILEY PROTECTION BARRIER (SEE RILEY/NOTES IN PARAGRAPH)
 - CONCRETE WORKOUT PIT

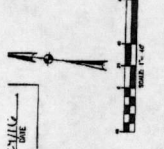

APPROVED: *[Signature]*
 PROJECT MANAGER
 DEVELOPMENT CONSULTANT

<p>Huckabee ARCHITECTS</p>		<p>Project: FOR GRAND VISTA ELEMENTARY SCHOOL FORT BEND ISD RICHMOND, TEXAS</p>
<p>SWPPP PLAN Sheet No. C9.0</p>		<p>Revision / Date 4. 06/27/16 Fort Bend County Community District Comment Response 3. 06/17/16 Addendum 04 - Cost Savings/ Fort-Bid Addendum 2. 04/12/16 Addendum 03 1. 03/10/16</p>

APPROVED: *Allegretto* DATE: 7/29/11
 PROJECT: FORT BEND COUNTY
 ENGINEER: ALLEGRETTO CONSULTANTS

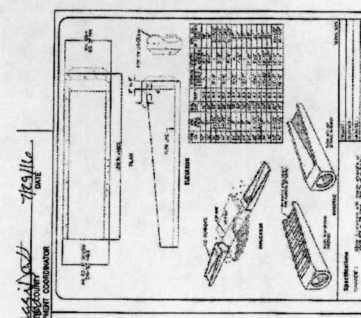

CONCRETE CURB
 NOTES:
 1. CURB SHALL BE 12" WIDE AT TOP AND 12" WIDE AT BOTTOM.
 2. CURB SHALL BE 1/2" HIGH AT TOP AND 1/2" HIGH AT BOTTOM.
 3. CURB SHALL BE 1/2" WIDE AT TOP AND 1/2" WIDE AT BOTTOM.

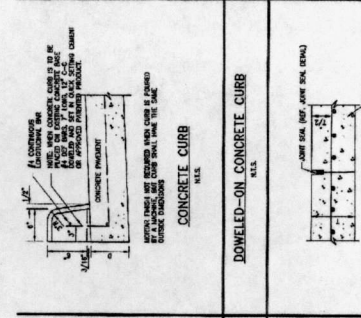

DOWELED-ON CONCRETE CURB
 NOTES:
 1. CURB SHALL BE 12" WIDE AT TOP AND 12" WIDE AT BOTTOM.
 2. CURB SHALL BE 1/2" HIGH AT TOP AND 1/2" HIGH AT BOTTOM.
 3. CURB SHALL BE 1/2" WIDE AT TOP AND 1/2" WIDE AT BOTTOM.

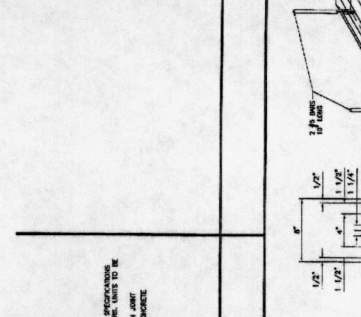

SAWED JOINT
 NOTES:
 1. JOINT SHALL BE 1/2" WIDE AT TOP AND 1/2" WIDE AT BOTTOM.
 2. JOINT SHALL BE 1/2" HIGH AT TOP AND 1/2" HIGH AT BOTTOM.
 3. JOINT SHALL BE 1/2" WIDE AT TOP AND 1/2" WIDE AT BOTTOM.

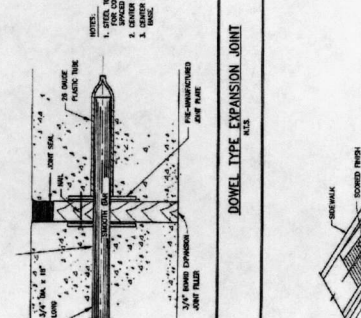

DOWEL TYPE EXPANSION JOINT
 NOTES:
 1. JOINT SHALL BE 12" WIDE AT TOP AND 12" WIDE AT BOTTOM.
 2. JOINT SHALL BE 1/2" HIGH AT TOP AND 1/2" HIGH AT BOTTOM.
 3. JOINT SHALL BE 1/2" WIDE AT TOP AND 1/2" WIDE AT BOTTOM.

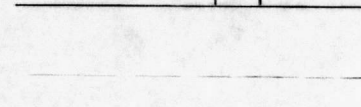

DIRECTIONAL CURB RAMP
 NOTES:
 1. RAMP SHALL BE 12" WIDE AT TOP AND 12" WIDE AT BOTTOM.
 2. RAMP SHALL BE 1/2" HIGH AT TOP AND 1/2" HIGH AT BOTTOM.
 3. RAMP SHALL BE 1/2" WIDE AT TOP AND 1/2" WIDE AT BOTTOM.

FOR FORT BEND COUNTY
 RICHMOND, TEXAS
 PROJECT: GRAND VISTA ELEMENTARY SCHOOL

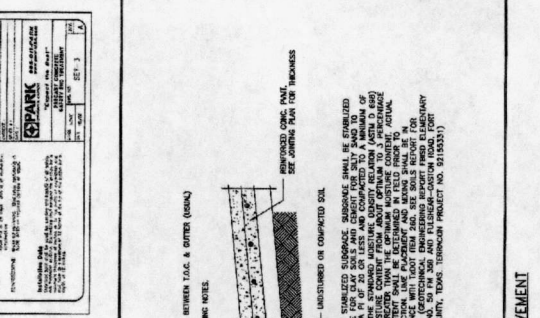

TYPICAL CONCRETE SIDEWALK
 NOTES:
 1. SIDEWALK SHALL BE 12" WIDE AT TOP AND 12" WIDE AT BOTTOM.
 2. SIDEWALK SHALL BE 1/2" HIGH AT TOP AND 1/2" HIGH AT BOTTOM.
 3. SIDEWALK SHALL BE 1/2" WIDE AT TOP AND 1/2" WIDE AT BOTTOM.

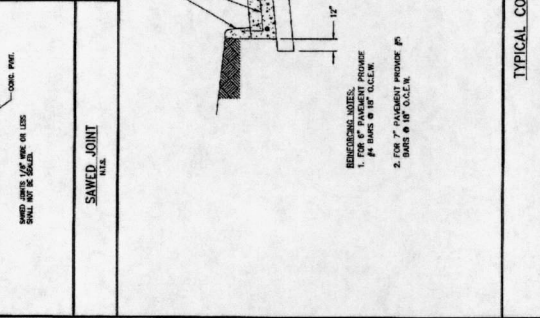

TYPICAL CONCRETE WHEEL STOP
 NOTES:
 1. WHEEL STOP SHALL BE 12" WIDE AT TOP AND 12" WIDE AT BOTTOM.
 2. WHEEL STOP SHALL BE 1/2" HIGH AT TOP AND 1/2" HIGH AT BOTTOM.
 3. WHEEL STOP SHALL BE 1/2" WIDE AT TOP AND 1/2" WIDE AT BOTTOM.

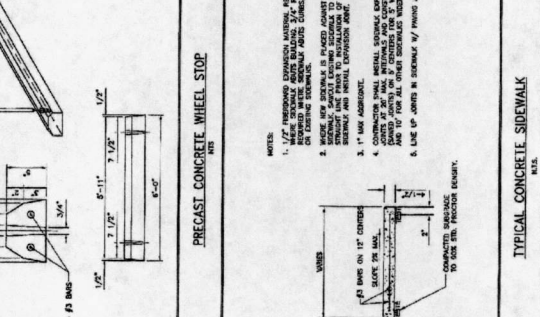

STANDARD CONCRETE PAVING HEADER
 NOTES:
 1. HEADER SHALL BE 12" WIDE AT TOP AND 12" WIDE AT BOTTOM.
 2. HEADER SHALL BE 1/2" HIGH AT TOP AND 1/2" HIGH AT BOTTOM.
 3. HEADER SHALL BE 1/2" WIDE AT TOP AND 1/2" WIDE AT BOTTOM.

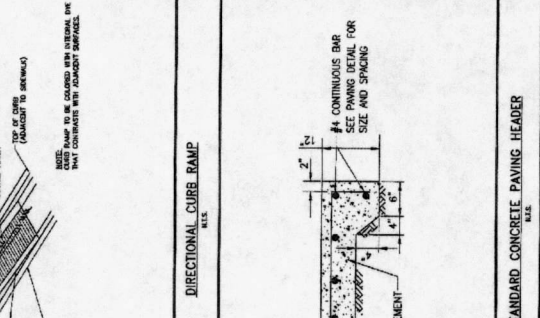

HANDICAPPED PARKING SIGN
 NOTES:
 1. SIGN SHALL BE 12" WIDE AT TOP AND 12" WIDE AT BOTTOM.
 2. SIGN SHALL BE 1/2" HIGH AT TOP AND 1/2" HIGH AT BOTTOM.
 3. SIGN SHALL BE 1/2" WIDE AT TOP AND 1/2" WIDE AT BOTTOM.

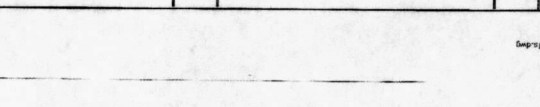

CONCRETE PAVEMENT
 NOTES:
 1. PAVEMENT SHALL BE 12" WIDE AT TOP AND 12" WIDE AT BOTTOM.
 2. PAVEMENT SHALL BE 1/2" HIGH AT TOP AND 1/2" HIGH AT BOTTOM.
 3. PAVEMENT SHALL BE 1/2" WIDE AT TOP AND 1/2" WIDE AT BOTTOM.

FOR FORT BEND COUNTY
 RICHMOND, TEXAS
 PROJECT: GRAND VISTA ELEMENTARY SCHOOL

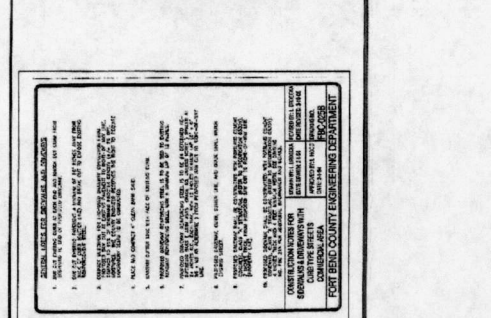

TYPICAL CONCRETE PAVEMENT
 NOTES:
 1. PAVEMENT SHALL BE 12" WIDE AT TOP AND 12" WIDE AT BOTTOM.
 2. PAVEMENT SHALL BE 1/2" HIGH AT TOP AND 1/2" HIGH AT BOTTOM.
 3. PAVEMENT SHALL BE 1/2" WIDE AT TOP AND 1/2" WIDE AT BOTTOM.

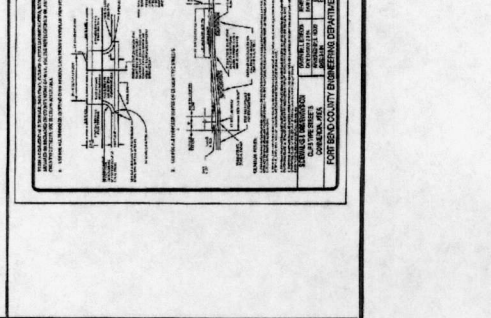

CONCRETE CURB
 NOTES:
 1. CURB SHALL BE 12" WIDE AT TOP AND 12" WIDE AT BOTTOM.
 2. CURB SHALL BE 1/2" HIGH AT TOP AND 1/2" HIGH AT BOTTOM.
 3. CURB SHALL BE 1/2" WIDE AT TOP AND 1/2" WIDE AT BOTTOM.

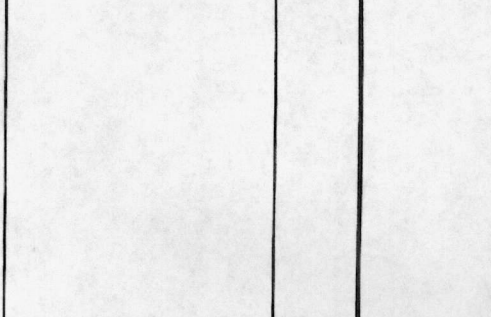

DOWELED-ON CONCRETE CURB
 NOTES:
 1. CURB SHALL BE 12" WIDE AT TOP AND 12" WIDE AT BOTTOM.
 2. CURB SHALL BE 1/2" HIGH AT TOP AND 1/2" HIGH AT BOTTOM.
 3. CURB SHALL BE 1/2" WIDE AT TOP AND 1/2" WIDE AT BOTTOM.

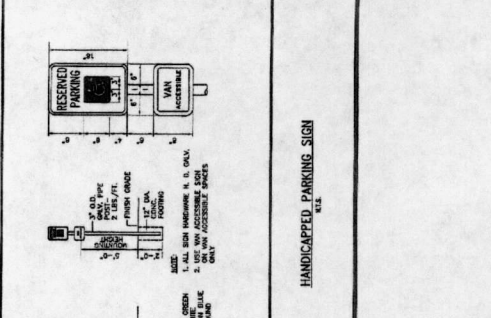

SAWED JOINT
 NOTES:
 1. JOINT SHALL BE 1/2" WIDE AT TOP AND 1/2" WIDE AT BOTTOM.
 2. JOINT SHALL BE 1/2" HIGH AT TOP AND 1/2" HIGH AT BOTTOM.
 3. JOINT SHALL BE 1/2" WIDE AT TOP AND 1/2" WIDE AT BOTTOM.

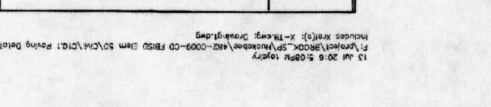

DOWEL TYPE EXPANSION JOINT
 NOTES:
 1. JOINT SHALL BE 12" WIDE AT TOP AND 12" WIDE AT BOTTOM.
 2. JOINT SHALL BE 1/2" HIGH AT TOP AND 1/2" HIGH AT BOTTOM.
 3. JOINT SHALL BE 1/2" WIDE AT TOP AND 1/2" WIDE AT BOTTOM.

FOR FORT BEND COUNTY
 RICHMOND, TEXAS
 PROJECT: GRAND VISTA ELEMENTARY SCHOOL



TYPICAL CONCRETE SIDEWALK
 NOTES:
 1. SIDEWALK SHALL BE 12" WIDE AT TOP AND 12" WIDE AT BOTTOM.
 2. SIDEWALK SHALL BE 1/2" HIGH AT TOP AND 1/2" HIGH AT BOTTOM.
 3. SIDEWALK SHALL BE 1/2" WIDE AT TOP AND 1/2" WIDE AT BOTTOM.



TYPICAL CONCRETE WHEEL STOP
 NOTES:
 1. WHEEL STOP SHALL BE 12" WIDE AT TOP AND 12" WIDE AT BOTTOM.
 2. WHEEL STOP SHALL BE 1/2" HIGH AT TOP AND 1/2" HIGH AT BOTTOM.
 3. WHEEL STOP SHALL BE 1/2" WIDE AT TOP AND 1/2" WIDE AT BOTTOM.



STANDARD CONCRETE PAVING HEADER
 NOTES:
 1. HEADER SHALL BE 12" WIDE AT TOP AND 12" WIDE AT BOTTOM.
 2. HEADER SHALL BE 1/2" HIGH AT TOP AND 1/2" HIGH AT BOTTOM.
 3. HEADER SHALL BE 1/2" WIDE AT TOP AND 1/2" WIDE AT BOTTOM.



HANDICAPPED PARKING SIGN
 NOTES:
 1. SIGN SHALL BE 12" WIDE AT TOP AND 12" WIDE AT BOTTOM.
 2. SIGN SHALL BE 1/2" HIGH AT TOP AND 1/2" HIGH AT BOTTOM.
 3. SIGN SHALL BE 1/2" WIDE AT TOP AND 1/2" WIDE AT BOTTOM.



CONCRETE PAVEMENT
 NOTES:
 1. PAVEMENT SHALL BE 12" WIDE AT TOP AND 12" WIDE AT BOTTOM.
 2. PAVEMENT SHALL BE 1/2" HIGH AT TOP AND 1/2" HIGH AT BOTTOM.
 3. PAVEMENT SHALL BE 1/2" WIDE AT TOP AND 1/2" WIDE AT BOTTOM.

FOR FORT BEND COUNTY
 RICHMOND, TEXAS
 PROJECT: GRAND VISTA ELEMENTARY SCHOOL

WATER DETAILS

Sheet No.	17 of 21
Sheet No.	C10.1
Drawn by	SPK
Checked by	SPK
Scale	AS SHOWN



FOR
 GRAND VISTA ELEMENTARY SCHOOL
 FORT BEND ISD
 FORT BEND, TEXAS

1 03/19/16
 2 04/12/16
 3 05/17/16
 4 06/21/16

Revision / Date

1 Addendum 02
 2 Addendum 04 - Cost Savings/
 3 Addendum 04 - Cost Savings/
 4 Fort Bend County Prologs District Comment Responses

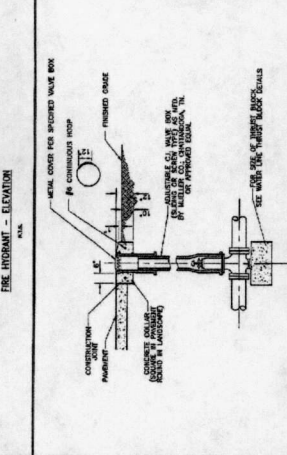
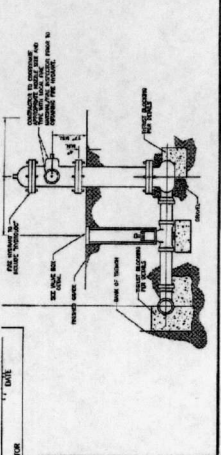

VALVE BOX
 N.E.L.

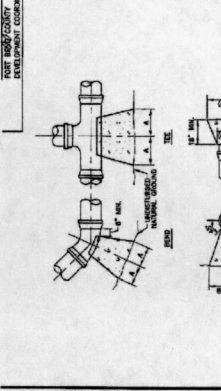

SIZE	8" RIBS	10" RIBS	12" RIBS	14" RIBS	16" RIBS	18" RIBS	20" RIBS	22" RIBS	24" RIBS	26" RIBS	28" RIBS	30" RIBS
2 1/2"	12"	12"	12"	12"	12"	12"	12"	12"	12"	12"	12"	12"
3"	12"	12"	12"	12"	12"	12"	12"	12"	12"	12"	12"	12"
4"	12"	12"	12"	12"	12"	12"	12"	12"	12"	12"	12"	12"
6"	12"	12"	12"	12"	12"	12"	12"	12"	12"	12"	12"	12"
8"	12"	12"	12"	12"	12"	12"	12"	12"	12"	12"	12"	12"
10"	12"	12"	12"	12"	12"	12"	12"	12"	12"	12"	12"	12"
12"	12"	12"	12"	12"	12"	12"	12"	12"	12"	12"	12"	12"
14"	12"	12"	12"	12"	12"	12"	12"	12"	12"	12"	12"	12"
16"	12"	12"	12"	12"	12"	12"	12"	12"	12"	12"	12"	12"
18"	12"	12"	12"	12"	12"	12"	12"	12"	12"	12"	12"	12"
20"	12"	12"	12"	12"	12"	12"	12"	12"	12"	12"	12"	12"
22"	12"	12"	12"	12"	12"	12"	12"	12"	12"	12"	12"	12"
24"	12"	12"	12"	12"	12"	12"	12"	12"	12"	12"	12"	12"
26"	12"	12"	12"	12"	12"	12"	12"	12"	12"	12"	12"	12"
28"	12"	12"	12"	12"	12"	12"	12"	12"	12"	12"	12"	12"
30"	12"	12"	12"	12"	12"	12"	12"	12"	12"	12"	12"	12"

ALL CONCRETE SHALL BE MIN. 3000 P.S.I.

WATER LINE THRUST BLOCK
 N.E.L.

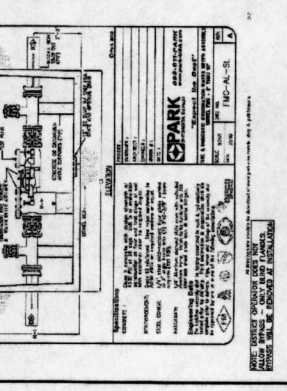
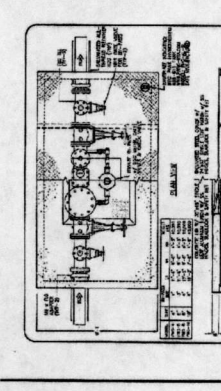

DOMESTIC WATER METER ASSEMBLY
 N.E.L.

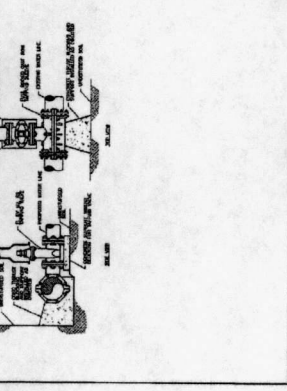
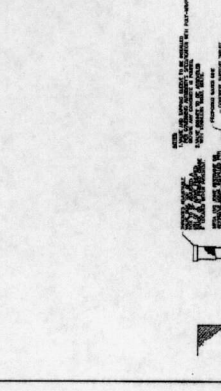

TAPPING SLEEVE AND VALVE
 N.E.L.

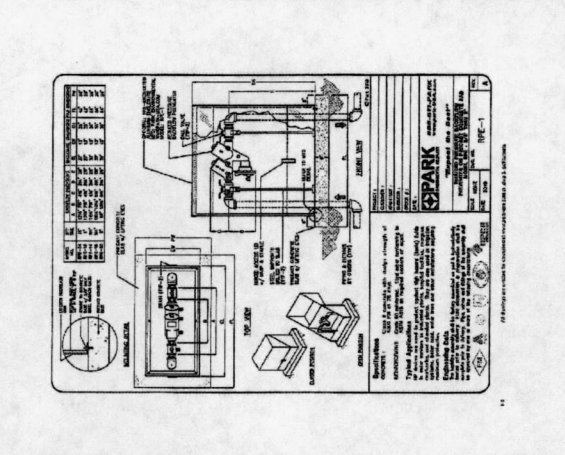

IRRIGATION BACKFLOW PREVENTER
 N.E.L.

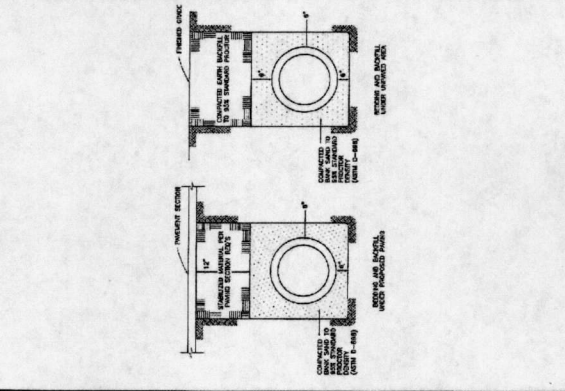

WATER LINE TRENCH
 N.E.L.

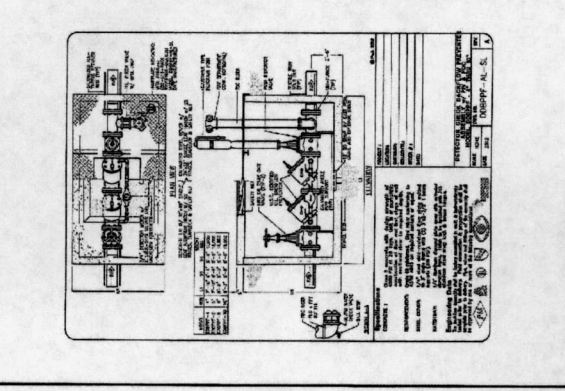

BACKFLOW PREVENTER W/ PIV & FDC
 N.E.L.

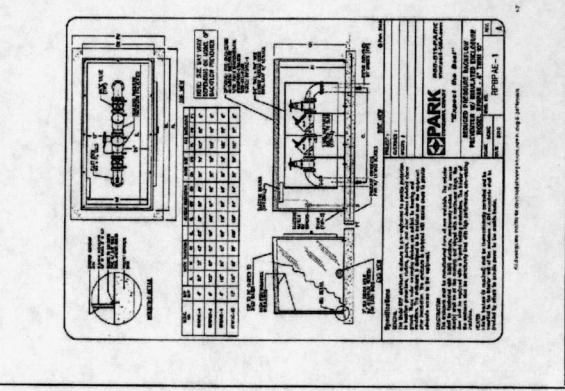

DOMESTIC BACKFLOW PREVENTER
 N.E.L.

APPROVED: *M. J. ...*
 COUNTY ENGINEER
 FORT BEND COUNTY
 DATE: 05/22/16

CONTRACTOR IS RESPONSIBLE FOR THE PROTECTION AND MAINTENANCE OF ALL UTILITIES, PUBLIC AND PRIVATE, AND FOR THE PROTECTION OF ALL ADJACENT PROPERTIES. THE CONTRACTOR SHALL BE RESPONSIBLE FOR THE PROTECTION OF ALL ADJACENT PROPERTIES, INCLUDING BUT NOT LIMITED TO, UTILITIES, PUBLIC AND PRIVATE, AND FOR THE PROTECTION OF ALL ADJACENT PROPERTIES. THE CONTRACTOR SHALL BE RESPONSIBLE FOR THE PROTECTION OF ALL ADJACENT PROPERTIES, INCLUDING BUT NOT LIMITED TO, UTILITIES, PUBLIC AND PRIVATE, AND FOR THE PROTECTION OF ALL ADJACENT PROPERTIES.

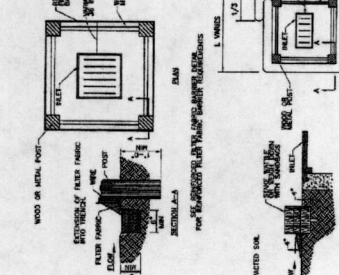
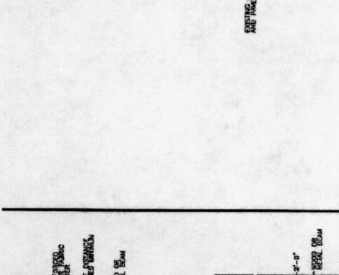
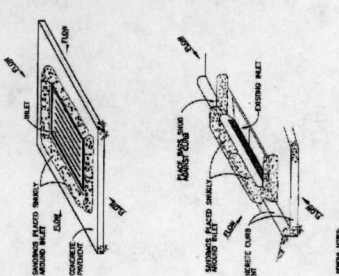
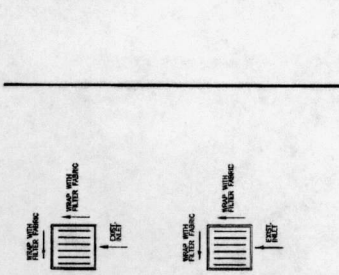

REVISION / DATE
 1 03/10/16
 2 05/17/16
 3 04/12/16
 4 05/22/16
 Fort Bend County Engineering Department
 Address: 02 - 0281
 Fort Bend County, Texas
 Project: GRAND VISTA ELEMENTARY SCHOOL FOR FORT BEND ISD, RICHMOND, TEXAS

GENERAL NOTES:
 1. FORT A NEW TRUCK WASH OUT AREA SHALL BE PROVIDED FOR THE PROJECT.
 2. THE CONCRETE SHALL BE 4000 PSI STRENGTH WITH 4% FIBER REINFORCEMENT.
 3. THE CONCRETE SHALL BE 4000 PSI STRENGTH WITH 4% FIBER REINFORCEMENT.
 4. THE CONCRETE SHALL BE 4000 PSI STRENGTH WITH 4% FIBER REINFORCEMENT.
 5. THE CONCRETE SHALL BE 4000 PSI STRENGTH WITH 4% FIBER REINFORCEMENT.

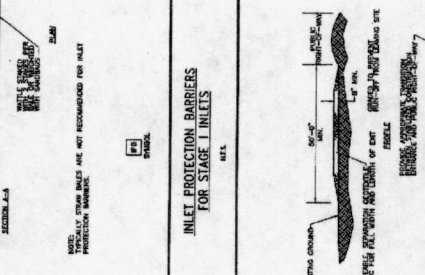
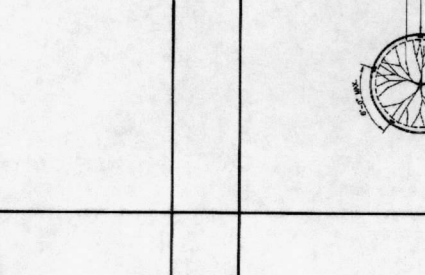
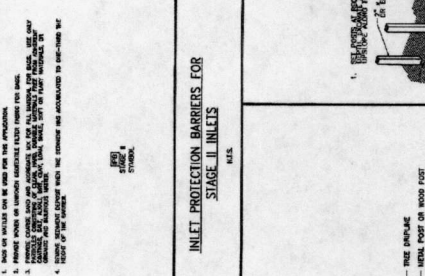
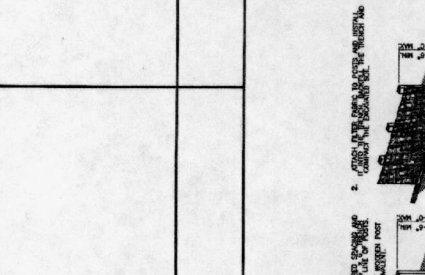

CONCRETE TRUCK WASH OUT AREA
 SEE PLAN

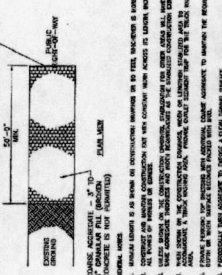
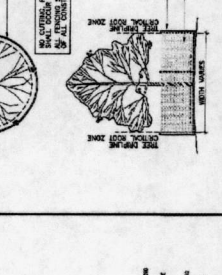
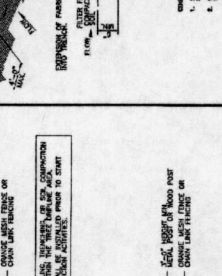
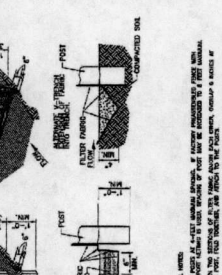

CONCRETE TRUCK WASH OUT AREA
 SEE PLAN

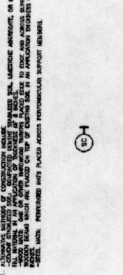
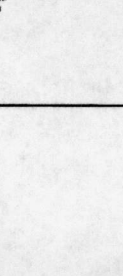
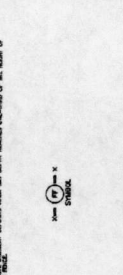

SHIPPED DETAILS
 SHEET NO. C10.4
 DATE: 5/22/16
 SHEET 20 OF 21

CONCRETE TRUCK WASH OUT AREA
 SEE PLAN

