

**REVIEW BY FORT BEND COUNTY COMMISSIONERS COURT**

On this 24th day of May, 2016, Commissioners Court came on to be heard and reviewed the accompanying notice of Byers Engineering / AT & T Texas Job Location 8802 Greatwood Pkwy. Sugar Land, TX 77479 Date 5/5/2016 Bond No. CH1-001686693-01, Permit No. 2016-6968 to make use of certain Fort Bend County property subject to, "A Revised Order Regulating the Laying, Construction, Maintenance, and Repair of Buried Cables, Conduits, and Pole Lines, In, Under, Across or Along Roads, Streets, Highways, and Drainage Ditches in Fort Bend County, Texas, Under the Jurisdiction of the Commissioners Court of Fort Bend County, Texas," as passed by the Commissioners Court of Fort Bend County, Texas the 3rd day of August, 1987, recorded in Volume \_\_\_\_\_ of the Minutes of the Commissioners Court of Fort Bend County, Texas, to the extent that such order is not inconsistent with Article 1436a, Vernon's Texas Civil Statutes. Upon Motion of Commissioner Meyers, seconded by Commissioner Patterson, duly put and carried, it is ORDERED, ADJUDGED AND DECREED that said notice of said above purpose is hereby acknowledged by the Commissioners Court of Fort Bend County, Texas, and that said notice be placed on record according to the regulation order thereof.

Notes:

1. Evidence of review by the Commissioners Court must be kept on the job site and failure to do so constitutes grounds for job shutdown.
2. Written notices are required:
  - a. 48 hours in advance of construction start up, and
  - b. when construction is completed and ready for final inspection

Mail notices to: Permit Administrator  
Fort Bend County Engineering  
301 Jackson Street  
Richmond, Texas 77469  
281-633-7500

3. This permit expires one (1) year from date of permit if construction has not commenced.

By: Charles A. Dy  
for County Engineer

Presented to Commissioners Court and approved.  
Recorded in Volume 5-24-16 13H  
Minutes of Commissioners Court

By: N/A  
Drainage District Engineer/Manager

Clerk of Commissioners Court  
By: Frank White  
Deputy



SEE PRINT 3

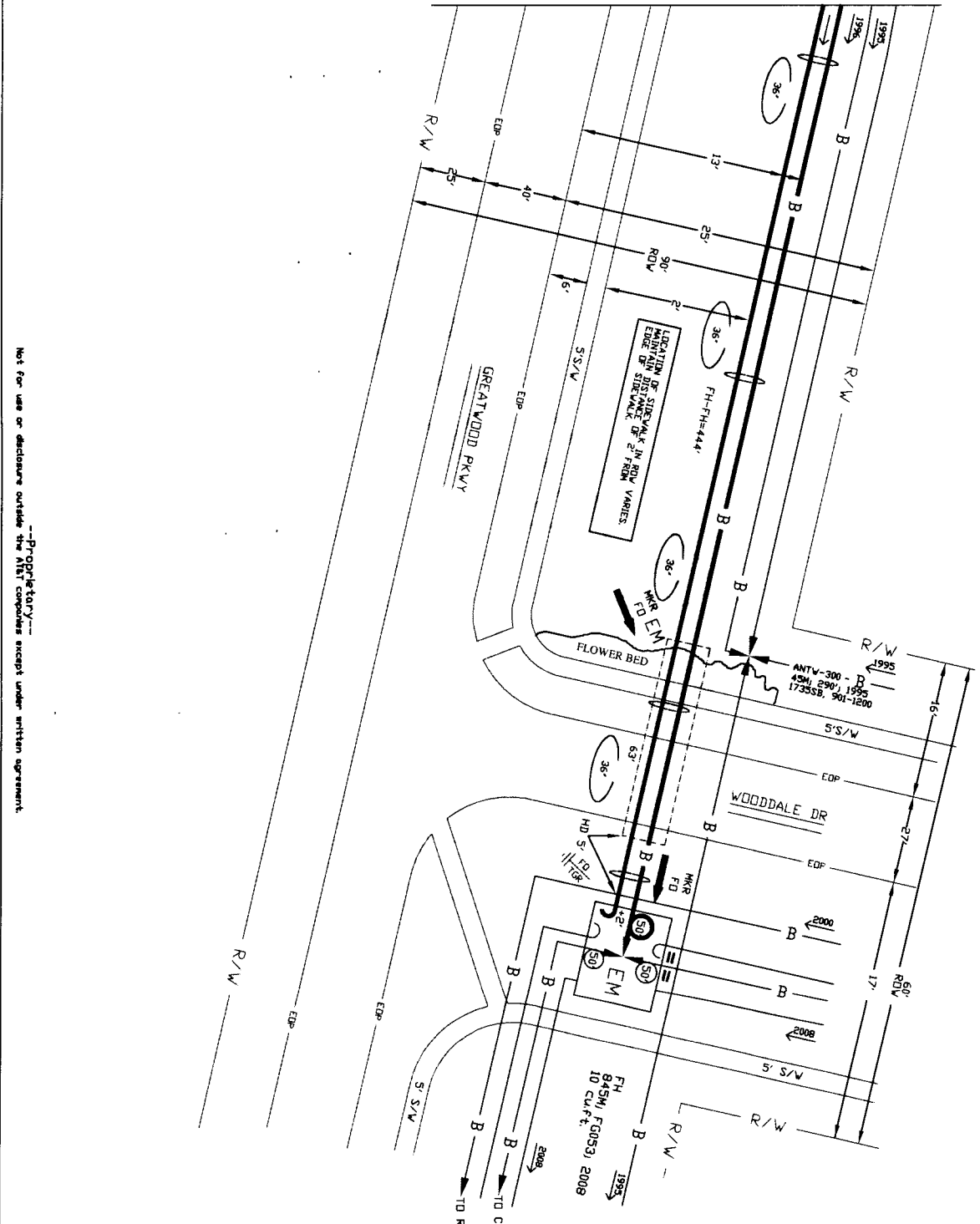

Not for use or disclosure outside the A/E/C companies except under written agreement.

SPECIAL CIRCUITS		N
FORWARDED PERMIT REQUIRED		N
OPERATING RANGE OF JOB STEPS		
TASK	TO	
MFRG P&E:		
RZ 0	CZ 0	TRANSMISSION ZONE TAPER CODE 200E
CAUTION HIGH VOLTAGE BURIED Y		
KV 1.20 APPX. N		
HIGHWAY PERMIT NO.		
UTILITY CO. ENR. - CENTER POINT		
REP NAME		
REP TEL NO. 013 201-2222		
POLE CONTACTS (+) 0 (-) 0		
UTILITY CO.		
REP NAME		
REP TEL NO.		
POLE CONTACTS (+) 0 (-) 0		
PROJECT NO. 8802		
TOT PRINTS 9		
PRINT NO. 2		
NPA/NNX: 201-545 PRT: 281545		
EXCH. SMITHS LAKE		
TAX DIST. F0653		
GEO. LOC. W09545		
ENGR. NB		
DRAWING		
TELEPHONE NO. (281) 561-4688		
REC. REF. 240-270-24-4		
MAP REF. 6070		
SCALE NONE		
ISSUE DATE		
PROJ. TITLE 8802 GREATWOOD PKWY FIBER AS		
REV. NUMBER		
DATE REV.		

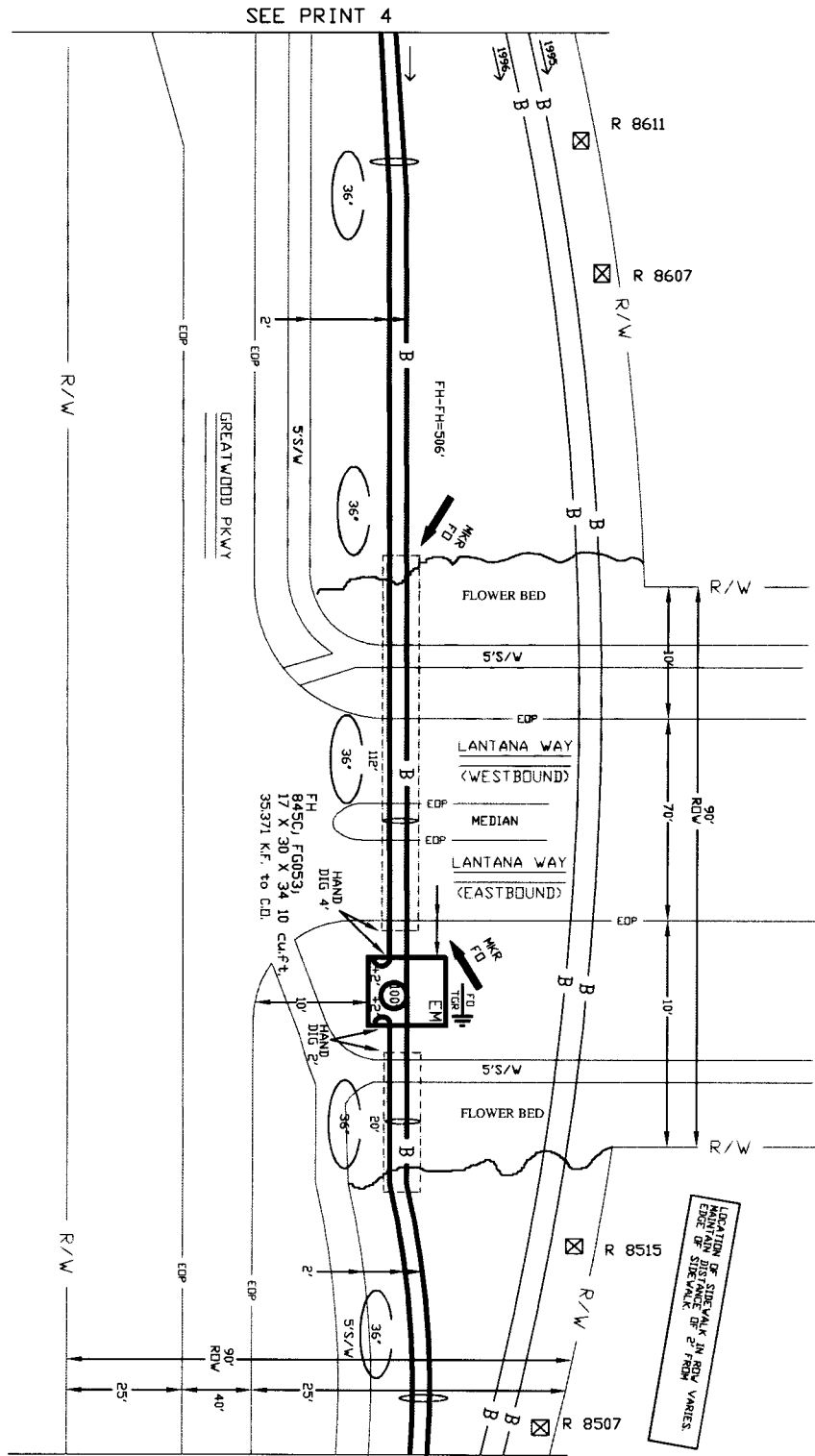

SEE PRINT 4

SEE PRINT 2 TO CO

Not for use or disclosure outside the A/E/C contract except under written agreement.

SPECIAL CIRCUITS N 6203 FORWARDED N PERMIT N REQUIRED N			
OPERATING RANGE OF JOB STEPS TASK _____ TO _____			
MFRG REC: _____			
TRANSMISSION ZONE RZ 0 CZ 0 TAPER CODE 200R			
CAUTION HIGH VOLTAGE BURIED 1			
HIGHWAY PERMIT NO. _____			
UTILITY CO. ENT - CENTER POINT REP NAME REP TEL NO. 713 201-2222 POLE CONTACTS (+)0 (-)0			
UTILITY CO. REP NAME REP TEL NO. POLE CONTACTS (+)0 (-)0			
PROJECT NO. A000710			
TOT. PRINTS 9 NPA/NNX: 201-545 PRT:201545 EXCH. SMITHS LAKE TAX DIST. F0653 GEO. LOC. W09545		PRINT NO. 3 PRT:201545 DRAWING	
ENGR. NO. _____ TELEPHONE NO. (281) 561-4688 REC. REF. 240-270-24-4 MAP REF. 6070 SCALE NINE ISSUE DATE _____ PROJ. TITLE 8802 GREATWOOD PKWY FIBER ASB REV. NUMBER _____ DATE REV. _____			

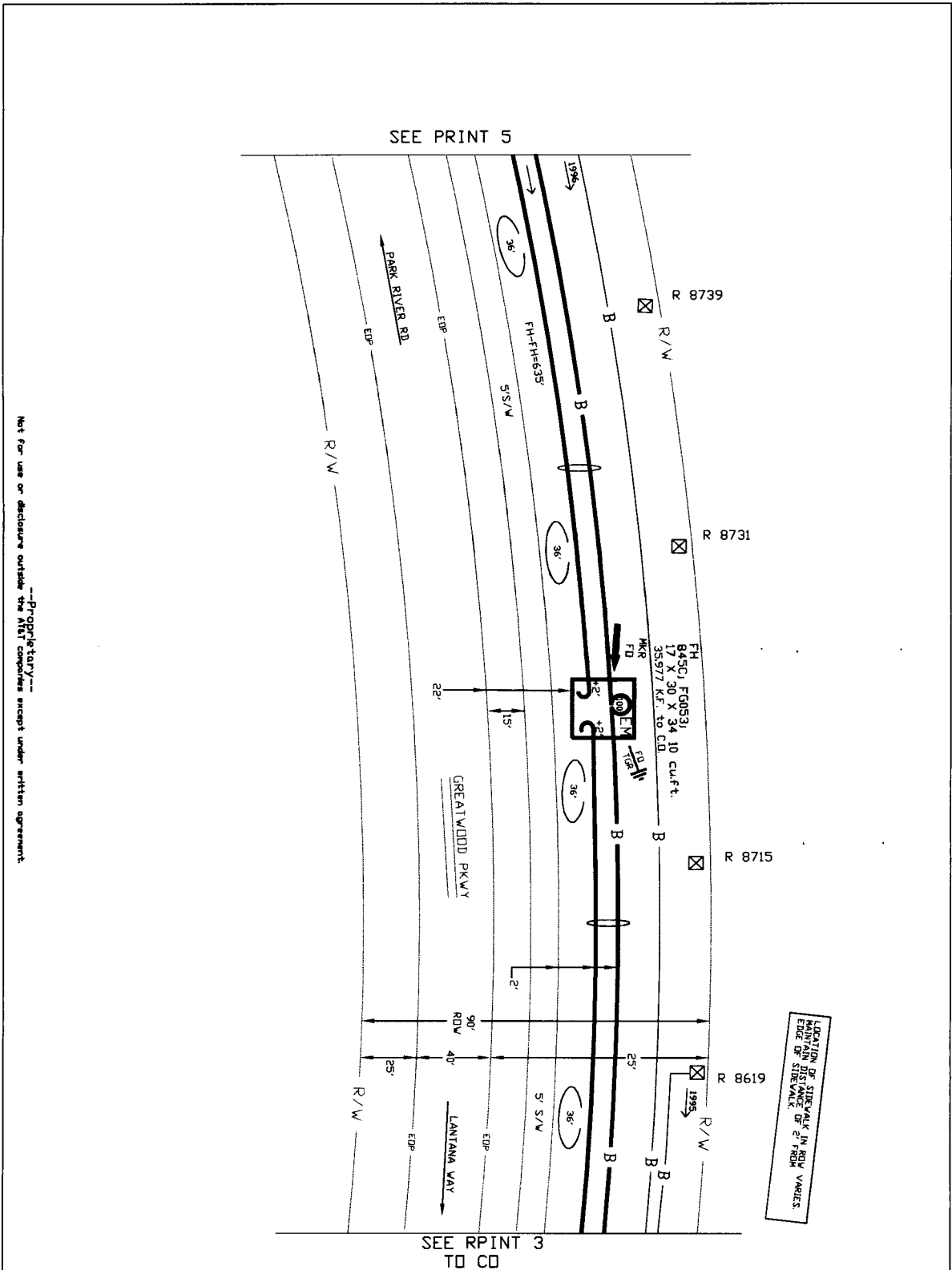

SEE PRINT 5

SEE PRINT 3 TO CD

SPECIAL CIRCUITS N 6203 FORWARDED N PERMIT REQUIRED Y		NORTH ARROW 	
OPERATING RANGE OF JOB STEPS TASK _____ TO _____			
MFRIC REC. TRANSMISSION ZONE RZ 0 C2 0 TAPER CODE 330R2 CAUTION HIGH VOLTAGE BURIED Y KV 1.20 APRIL 8 HIGHWAY PERMIT NO.			
UTILITY CO. ENF. CENTER POINT REP NAME REP TEL NO. 010 20-2222 POLE CONTACTS (+) 0 (-) 0			
UTILITY CO. REP NAME REP TEL NO. POLE CONTACTS (+) 0 (-) 0			
PROJECT NO. 8802 PROJECT NO. 8802			
TOT. PRINTS 9 NPA/NNX: 281-545 EXCH. SMITHS LAKE TAX DIST. FE653 GEO. LOC. W95345 ENGR. NB TELEPHONE NO. (281) 561-4688 REC. REF. 240-270-25-3 MAP REF. 6079 SCALE NONE ISSUE DATE PROJ. TITLE 8802 GREATWOOD PKWY TIER 2 REV. NUMBER DATE REV.		PRINT NO. 4 PRT: 281545 DRAWING	

Not for use or disclosure outside the MITI companies except under written agreement.

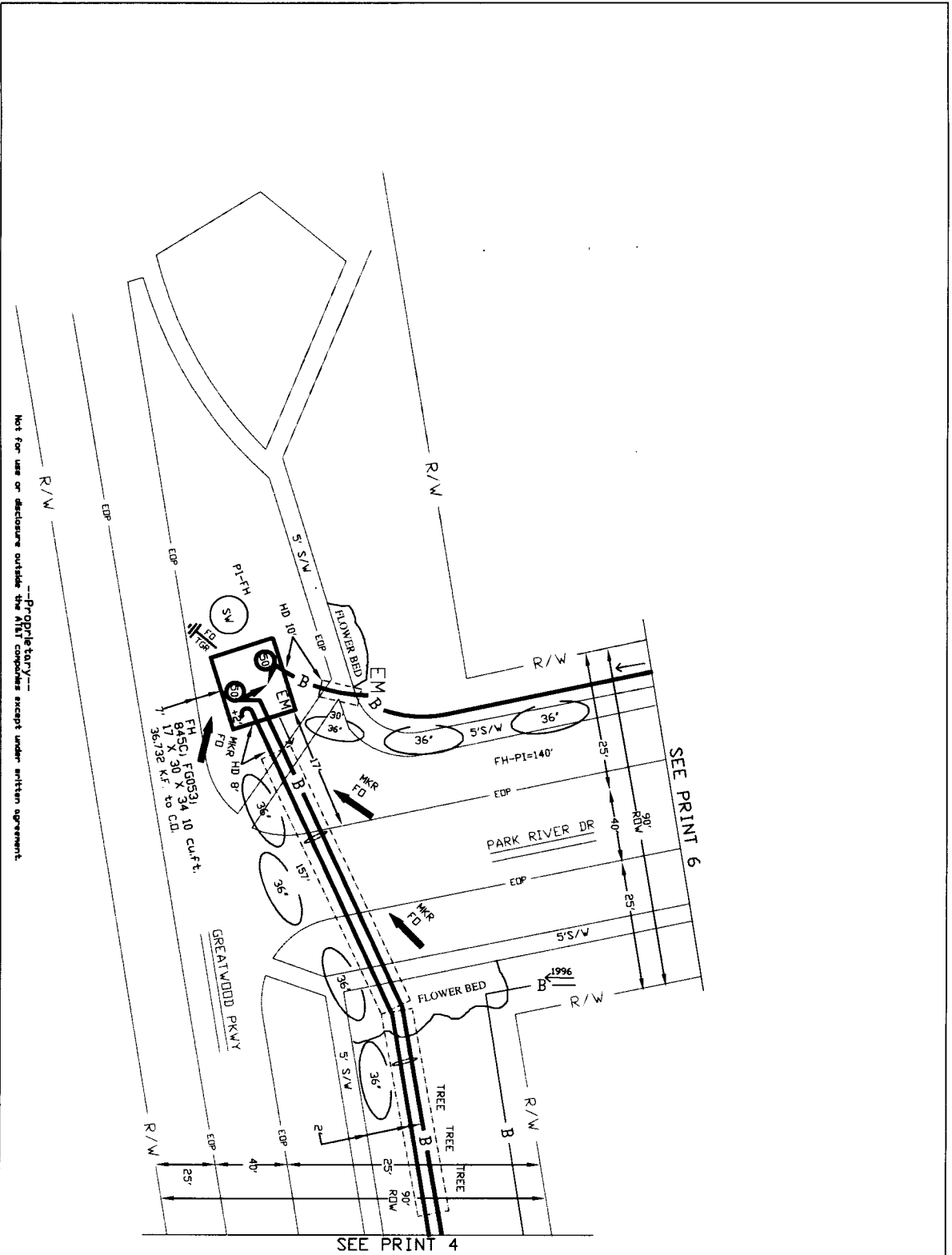

SPECIAL CIRCUITS N		 NORTH ARROW
6203 FORWARDED N		
PERMIT REQUIRED N		
OPERATING RANGE OF JOB STEPS TASK _____ TO _____		
MFRG. REC.		
RZ 0	TRANSMISSION ZONE CZ 0	TAPER CODE 230R2
CAUTION HIGH VOLTAGE BARRIED Y		
KV 120 APPL. N		
HIGHWAY PERMIT NO.		
UTILITY CO. ENT. - CENTER POINT REP. NAME REP. TEL. NO. 010 20-2222 POLE CONTACTS (+)0 (-)0		
UTILITY CO. REP. NAME REP. TEL. NO. POLE CONTACTS (+)0 (-)0		
PROJECT NO. A000110		
TOT PRINTS 9		PRINT NO. 5
NPA/NNX: 281-545		PRT: 281545
EXCH. SMITHS LAKE		
TAX DIST. FIDB3		
GEO. LOC. W99345		
ENGR. NB DRAWMNC		
TELEPHONE NO. (281) 561-4688		
REC. REF. 240-210-53-3		
MAP REF. 607D		
SCALE NINE		
ISSUE DATE		
PROJ. TITLE 8802 GREATWOOD PKWY FIBER ASSE		
REV. NUMBER		
DATE REV.		

Not for use or disclosure outside the Hill Companies except under written agreement.

8802 GREATWOOD PKWY  
 GREATWOOD COMMUNITY  
 ASSOCIATION

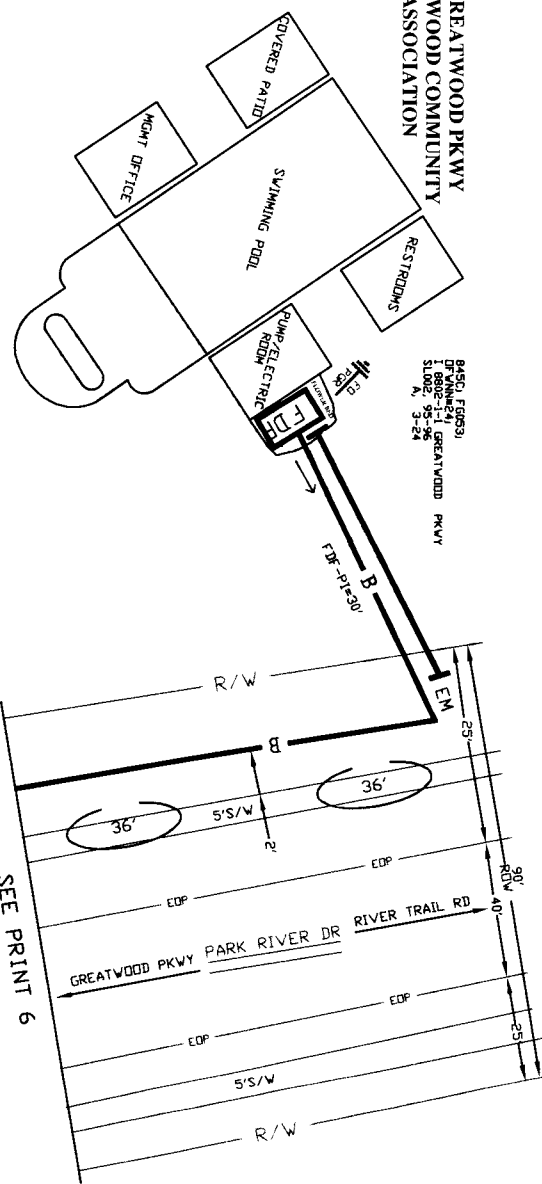

BASED: E0953  
 PLOT: 1-1-1  
 I: 8802-1-1-36  
 S: 1002-95-36  
 N: 3-24

SEE PRINT 6

---Proprietary---  
 Not for use or disclosure outside the A/E/C companies except under written agreement.

SPECIAL CIRCUITS	N
6203 FORWARDED	N
PERMIT REQUIRED	Y

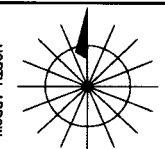

NORTH ARROW

OPERATING RANGE OF JOB STEPS  
 TASK \_\_\_\_\_ TO \_\_\_\_\_

MTRC 845  
 TRANSMISSION ZONE  
 RZ 0 CZ 0 TAPER CODE 2392

CAUTION HIGH VOLTAGE  
 BURIED 1

HIGHWAY PERMIT NO.

UTILITY CO GEN - CENTER POINT  
 REP NAME  
 REP TEL NO. (713) 201-2222  
 POLE CONTACTS (+) 0 (-) 0

UTILITY CO  
 REP NAME  
 REP TEL NO.  
 POLE CONTACTS (+) 0 (-) 0

UTILITY CO  
 REP NAME  
 REP TEL NO.  
 POLE CONTACTS (+) 0 (-) 0

PROJECT NO. A00271W

TOT. PRINTS 9 PRINT NO. 6  
 NPA/NNX: 281-345 PRT: 281545  
 EXCH. SMITHSLAKE  
 TAX DIST. F0653  
 GEO. LOC. W89545  
 ENGR. #8 DRAWING  
 TELEPHONE NO. (281) 561-6088  
 REC. REF. 240-270-24-4  
 MAP REF. 6070  
 SCALE N/A  
 ISSUE DATE  
 PROJ. TITLE 8802 GREATWOOD PKWY FIBER AS  
 REV. NUMBER  
 DATE REV.