

REVIEW BY FORT BEND COUNTY COMMISSIONERS COURT

On this 26th day of April, 2016, Commissioners Court came on to be heard and reviewed the accompanying notice of All City Permits / Lonnie Lischka Company, LP
 Job Location FBC MUD #132, Houston, TX 77406
 Date 4/7/2016 Bond No. LPM9210918, Permit No. 2016-6495 to make use of certain Fort Bend County property subject to, "A Revised Order Regulating the Laying, Construction, Maintenance, and Repair of Buried Cables, Conduits, and Pole Lines, In, Under, Across or Along Roads, Streets, Highways, and Drainage Ditches in Fort Bend County, Texas, Under the Jurisdiction of the Commissioners Court of Fort Bend County, Texas," as passed by the Commissioners Court of Fort Bend County, Texas the 3rd day of August, 1987, recorded in Volume _____ of the Minutes of the Commissioners Court of Fort Bend County, Texas, to the extent that such order is not inconsistent with Article 1436a, Vernon's Texas Civil Statutes. Upon Motion of Commissioner Meyers, seconded by Commissioner Patterson, duly put and carried, it is ORDERED, ADJUDGED AND DECREED that said notice of said above purpose is hereby acknowledged by the Commissioners Court of Fort Bend County, Texas, and that said notice be placed on record according to the regulation order thereof.

Notes:

1. Evidence of review by the Commissioners Court must be kept on the job site and failure to do so constitutes grounds for job shutdown.
2. Written notices are required:
 - a. 48 hours in advance of construction start up, and
 - b. when construction is completed and ready for final inspection
 Mail notices to: Permit Administrator
 Fort Bend County Engineering
 301 Jackson Street
 Richmond, Texas 77469
 281-633-7500
3. This permit expires one (1) year from date of permit if construction has not commenced.

By: Charles O. Day
 for County Engineer

Presented to Commissioners Court and approved.

Recorded in Volume 4-26-16 13Y
 Minutes of Commissioners Court

By: Mark Vaylor
 Drainage District Engineer/Manager

Clerk of Commissioners Court

By: Archie Willis
 Deputy

CONSTRUCTION PLANS FOR DETENTION POND PHASE 1 IMPROVEMENTS

FOR SENDERO

LOCATED IN

FORT BEND COUNTY MUD No. 132
FORT BEND COUNTY, TEXAS

L O C C + I O R M G P

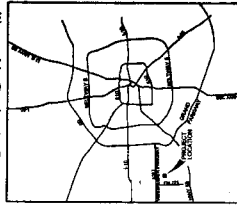

LANDMARK FILE
SEP 0008 77409

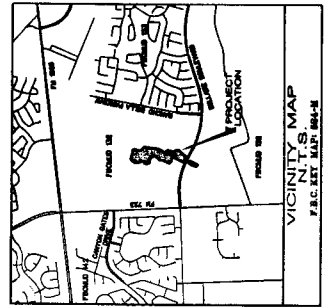

INDEX OF DRAWINGS

SHEET NO. DESCRIPTION

1. COVER SHEET
2. GENERAL SPECIFICATIONS & CONSTRUCTION NOTES
3. LAYOUT SHEETS
4. OVERALL MEASURES LAYOUT
5. FROM CALCULATIONS
6. DETENTION POND #1 CONCRETE LAYOUT
7. DETENTION POND #2 CONCRETE LAYOUT
8. DETENTION POND #3 CONCRETE LAYOUT
9. OVERALL FILL AND GRASSING LAYOUT
10. DETENTION POND #1 CONCRETE LAYOUT
11. TEMPORARY CHANGES IMPROVEMENTS
12. PAVE AND FINISH DETAILS
13. TRAFFIC CONTROL PLAN
14. TRAFFIC CONTROL PLAN #1
15. TRAFFIC CONTROL PLAN #2
16. TRAFFIC CONTROL PLAN #3
17. TRAFFIC CONTROL PLAN #4
18. TRAFFIC CONTROL PLAN #5
19. TRAFFIC CONTROL PLAN #6
20. TRAFFIC CONTROL PLAN #7
21. TRAFFIC CONTROL PLAN #8
22. TRAFFIC CONTROL PLAN #9
23. TRAFFIC CONTROL PLAN #10
24. TRAFFIC CONTROL PLAN #11
25. TRAFFIC CONTROL PLAN #12
26. TRAFFIC CONTROL PLAN #13
27. TRAFFIC CONTROL PLAN #14
28. TRAFFIC CONTROL PLAN #15
29. TRAFFIC CONTROL PLAN #16
30. TRAFFIC CONTROL PLAN #17
31. TRAFFIC CONTROL PLAN #18
32. TRAFFIC CONTROL PLAN #19
33. TRAFFIC CONTROL PLAN #20
34. TRAFFIC CONTROL PLAN #21
35. TRAFFIC CONTROL PLAN #22
36. TRAFFIC CONTROL PLAN #23
37. TRAFFIC CONTROL PLAN #24
38. TRAFFIC CONTROL PLAN #25
39. TRAFFIC CONTROL PLAN #26
40. TRAFFIC CONTROL PLAN #27
41. TRAFFIC CONTROL PLAN #28
42. TRAFFIC CONTROL PLAN #29
43. TRAFFIC CONTROL PLAN #30
44. TRAFFIC CONTROL PLAN #31
45. TRAFFIC CONTROL PLAN #32
46. TRAFFIC CONTROL PLAN #33
47. TRAFFIC CONTROL PLAN #34
48. TRAFFIC CONTROL PLAN #35
49. TRAFFIC CONTROL PLAN #36
50. TRAFFIC CONTROL PLAN #37
51. TRAFFIC CONTROL PLAN #38
52. TRAFFIC CONTROL PLAN #39
53. TRAFFIC CONTROL PLAN #40
54. TRAFFIC CONTROL PLAN #41
55. TRAFFIC CONTROL PLAN #42
56. TRAFFIC CONTROL PLAN #43
57. TRAFFIC CONTROL PLAN #44
58. TRAFFIC CONTROL PLAN #45
59. TRAFFIC CONTROL PLAN #46
60. TRAFFIC CONTROL PLAN #47
61. TRAFFIC CONTROL PLAN #48
62. TRAFFIC CONTROL PLAN #49
63. TRAFFIC CONTROL PLAN #50
64. TRAFFIC CONTROL PLAN #51
65. TRAFFIC CONTROL PLAN #52
66. TRAFFIC CONTROL PLAN #53
67. TRAFFIC CONTROL PLAN #54
68. TRAFFIC CONTROL PLAN #55
69. TRAFFIC CONTROL PLAN #56
70. TRAFFIC CONTROL PLAN #57
71. TRAFFIC CONTROL PLAN #58
72. TRAFFIC CONTROL PLAN #59
73. TRAFFIC CONTROL PLAN #60
74. TRAFFIC CONTROL PLAN #61
75. TRAFFIC CONTROL PLAN #62
76. TRAFFIC CONTROL PLAN #63
77. TRAFFIC CONTROL PLAN #64
78. TRAFFIC CONTROL PLAN #65
79. TRAFFIC CONTROL PLAN #66
80. TRAFFIC CONTROL PLAN #67
81. TRAFFIC CONTROL PLAN #68
82. TRAFFIC CONTROL PLAN #69
83. TRAFFIC CONTROL PLAN #70
84. TRAFFIC CONTROL PLAN #71
85. TRAFFIC CONTROL PLAN #72
86. TRAFFIC CONTROL PLAN #73
87. TRAFFIC CONTROL PLAN #74
88. TRAFFIC CONTROL PLAN #75
89. TRAFFIC CONTROL PLAN #76
90. TRAFFIC CONTROL PLAN #77
91. TRAFFIC CONTROL PLAN #78
92. TRAFFIC CONTROL PLAN #79
93. TRAFFIC CONTROL PLAN #80
94. TRAFFIC CONTROL PLAN #81
95. TRAFFIC CONTROL PLAN #82
96. TRAFFIC CONTROL PLAN #83
97. TRAFFIC CONTROL PLAN #84
98. TRAFFIC CONTROL PLAN #85
99. TRAFFIC CONTROL PLAN #86
100. TRAFFIC CONTROL PLAN #87
101. TRAFFIC CONTROL PLAN #88
102. TRAFFIC CONTROL PLAN #89
103. TRAFFIC CONTROL PLAN #90
104. TRAFFIC CONTROL PLAN #91
105. TRAFFIC CONTROL PLAN #92
106. TRAFFIC CONTROL PLAN #93
107. TRAFFIC CONTROL PLAN #94
108. TRAFFIC CONTROL PLAN #95
109. TRAFFIC CONTROL PLAN #96
110. TRAFFIC CONTROL PLAN #97
111. TRAFFIC CONTROL PLAN #98
112. TRAFFIC CONTROL PLAN #99
113. TRAFFIC CONTROL PLAN #100

ALL WARNINGS ARE BASED ON THE TEXAS STATE PLANS COMMENTS USED SYSTEM. WITHOUT CERTAIN DATE.
PRIOR TO THE CONSTRUCTION OF THESE FACILITIES CHECKED ON BY THE DISTRICT.
THE DISTRICT OF THE ENGINEER WILL GIVE WRITING NOTICE BY MEMORANDUM ON
CONSTRUCTION OF THESE FACILITIES. THE DATE WHEN CONSTRUCTION WILL BE COMPLETED
NOTWITHSTANDING THE DATE WHEN CONSTRUCTION WILL BE COMPLETED.

FORT BEND COUNTY
ENGINEER: *[Signature]* 12/11/15
DATE: 12/11/15
THESE SIGNATURES ARE VOID IF CONSTRUCTION HAS NOT
COMMENCED IN ONE (1) YEAR FROM DATE OF APPROVAL.
APPROVED: *[Signature]*
DATE: 12/11/15

THIS CITY SIGNATURES VALID FOR ONE YEAR ONLY
WITH DATE OF SIGNATURES.



SURVEYED BY: COSTELLO, INC.
FB NO. 1

CITY OF HOUSTON
DEPARTMENT OF PUBLIC WORKS AND ENGINEERING
10/29/2015

FOR CITY OF HOUSTON USE ONLY
CITY ENGINEER

FOR CITY OF HOUSTON USE ONLY
CITY ENGINEER

FOR CITY OF HOUSTON USE ONLY
CITY ENGINEER

FOR CITY OF HOUSTON USE ONLY
CITY ENGINEER

FOR CITY OF HOUSTON USE ONLY
CITY ENGINEER

FOR CITY OF HOUSTON USE ONLY
CITY ENGINEER

FOR CITY OF HOUSTON USE ONLY
CITY ENGINEER

FOR CITY OF HOUSTON USE ONLY
CITY ENGINEER

FOR CITY OF HOUSTON USE ONLY
CITY ENGINEER

FOR CITY OF HOUSTON USE ONLY
CITY ENGINEER

FOR CITY OF HOUSTON USE ONLY
CITY ENGINEER

FOR CITY OF HOUSTON USE ONLY
CITY ENGINEER

FOR CITY OF HOUSTON USE ONLY
CITY ENGINEER

FOR CITY OF HOUSTON USE ONLY
CITY ENGINEER

FOR THE DISTRICT OF HOUSTON
CITY ENGINEER
DATE: OCTOBER 2015



FOR CONTROL SEE SHEET 2
FOR GRADING OF ENTIRE SITE
SEE OVERALL FILL & GRADING
SHEET 9

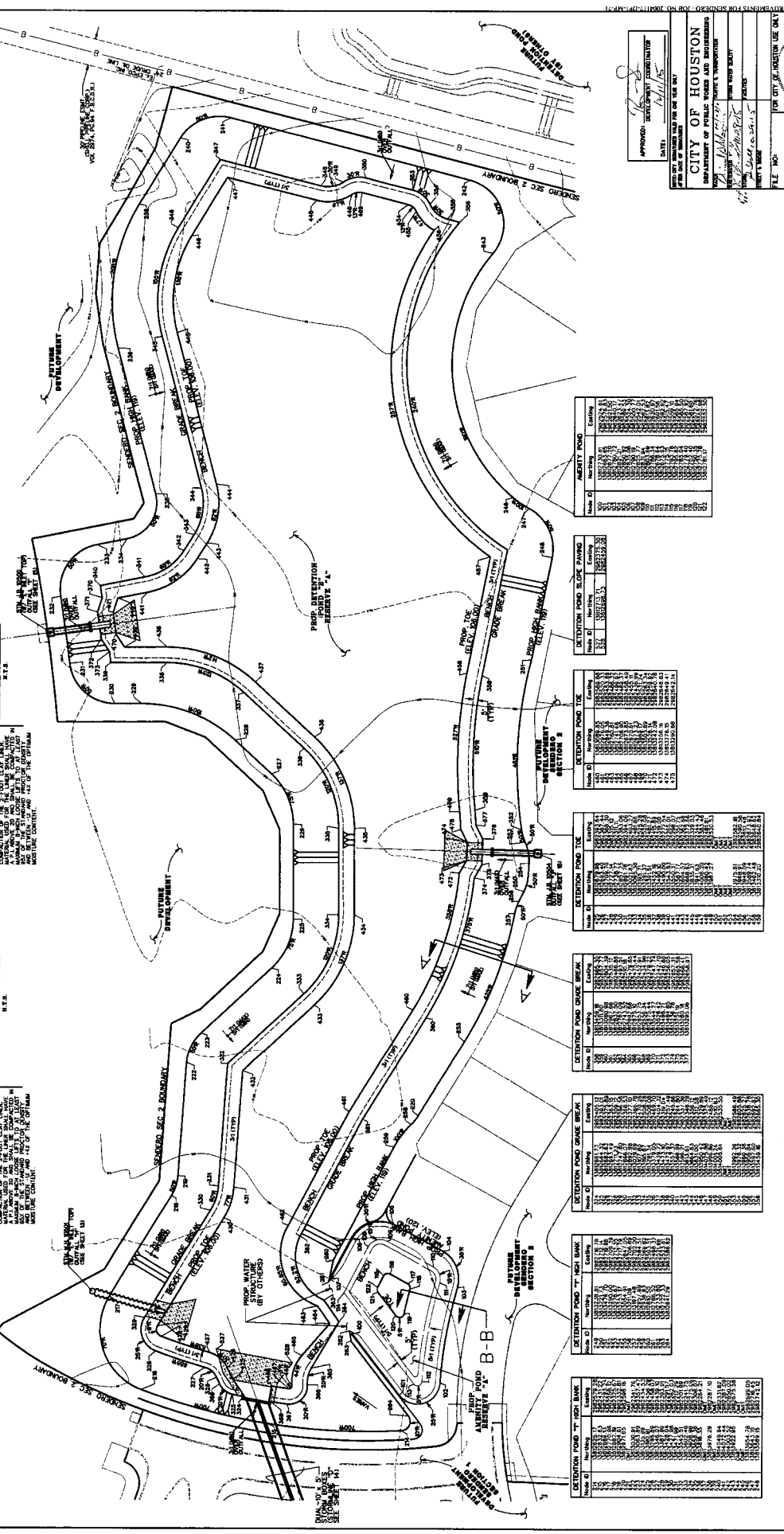
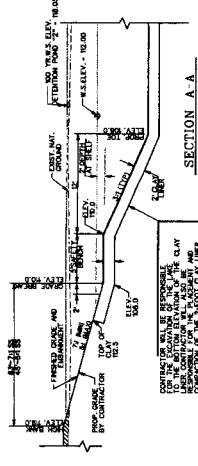
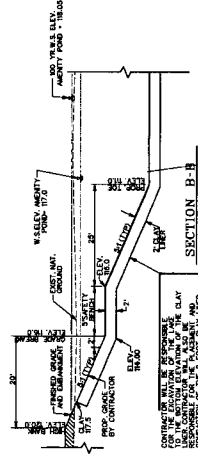
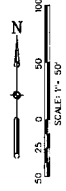

Area ID	Area Name	Existing	Proposed
DETENTION POND #1	DETENTION POND #1	EXISTING	EXISTING
DETENTION POND #2	DETENTION POND #2	EXISTING	EXISTING
DETENTION POND #3	DETENTION POND #3	EXISTING	EXISTING
DETENTION POND #4	DETENTION POND #4	EXISTING	EXISTING
DETENTION POND #5	DETENTION POND #5	EXISTING	EXISTING
DETENTION POND #6	DETENTION POND #6	EXISTING	EXISTING
EMBANKMENT DEVELOPMENT	EMBANKMENT DEVELOPMENT	EXISTING	EXISTING
PROTECTIVE STRIP	PROTECTIVE STRIP	EXISTING	EXISTING

APPROVED: *[Signature]*
DATE: 10/28/15

CITY OF HOUSTON
DEPARTMENT OF PUBLIC WORKS AND ENGINEERING
1500 WESTHOUSINGWAY
HOUSTON, TEXAS 77002

FILE NO.:
DRAWING SCALE: 1" = 50'
SHEET NO.: 7 OF 26

FORT BEND COUNTY MUD 132
SENDERO DETENTION PHASE I

DETENTION POND #2
COORDINATE LAYOUT

Engineering and Surveying
9990 Richmond Avenue, Suite 400 N
Houston, Texas 77042
(713) 783-7867 (713) 783-8600, Fax
18PCE FIRM REG. No. 296468
18PES FIRM REG. No. 106468

RESUBMITTED BY: *[Signature]*
DESIGN CHECKED BY: *[Signature]*
DRAWN BY: *[Signature]*
LOGO CHECKED BY: *[Signature]*
SURVEY CHECKED BY: *[Signature]*
DATE: 10/28/15

REVISION



FOR CONTROL SEE SHEET 2
 FOR GRADING OF ENTIRE SITE,
 SEE OVERALL GRADING LAYOUT
 SHEET 9
 EXISTING CONTOURS INDICATED ON
 THIS SHEET ARE PRIOR TO
 CLEANING & STRIPPING.

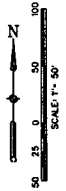

CAUTION!!
 EXISTING UNDERGROUND
 GAS PIPELINE

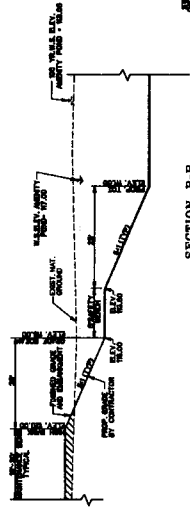

SECTION A-A
 1/2" = 1'-0"

ITEM NO.	DESCRIPTION	QUANTITY	UNIT
1	CONCRETE WALL	11,400	LINEAL FEET
2	GRAVEL	10,000	CY
3	SAND	10,000	CY

SECTION B-B
 1/2" = 1'-0"

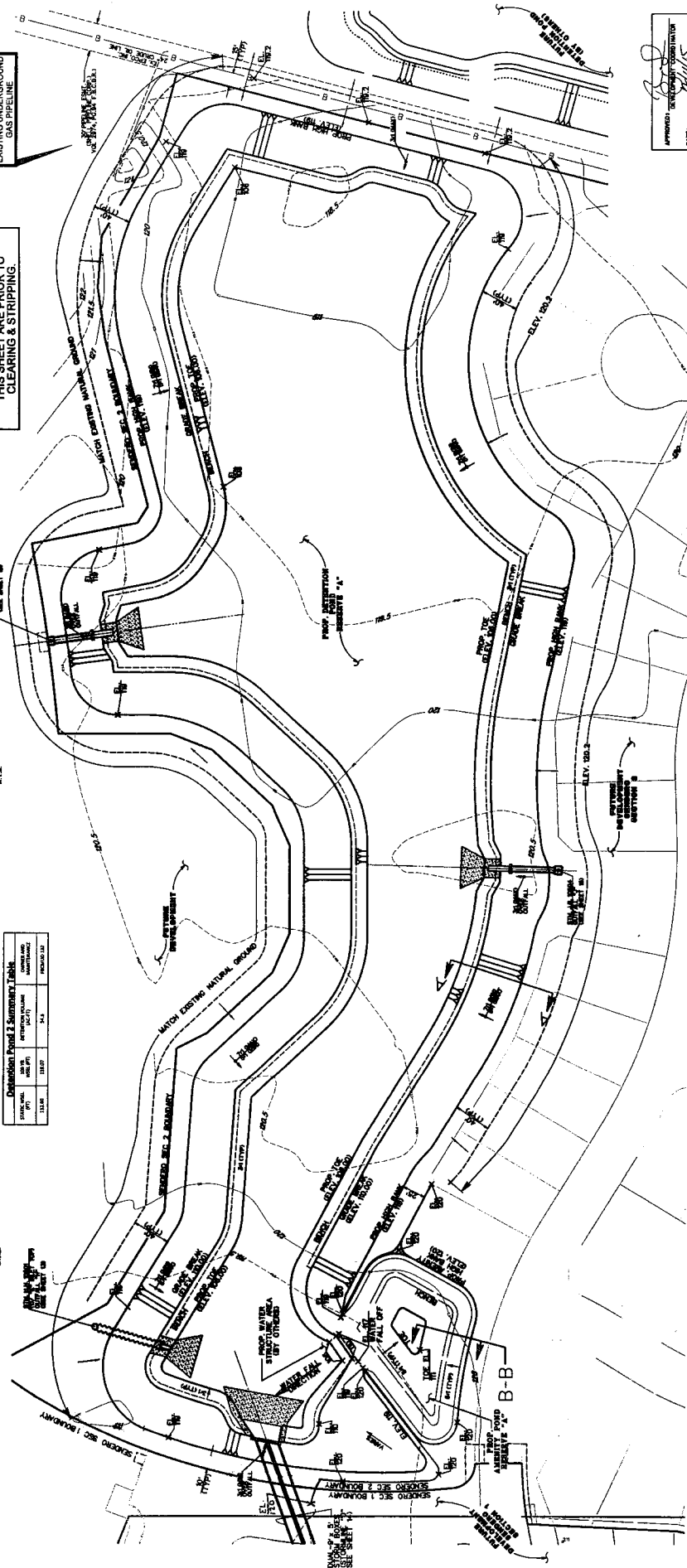

APPROVED: *[Signature]*
 DATE: 11/15/11
 TITLE: CIVIL ENGINEER

CITY OF HOUSTON
 DEPARTMENT OF PUBLIC WORKS AND ENGINEERING

PROJECT NO. 1111111111
 SHEET NO. 8 OF 26

DATE: 11/15/11
 TITLE: CIVIL ENGINEER

FOR CITY APPROVAL USE ONLY

54991
 CITY OF HOUSTON

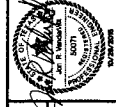

**FORT BEND COUNTY MUD 112
 SENDERO DETENTION PHASE 1
 DETENTION POND #2
 GRADING LAYOUT**

Engineering and Surveying
 9990 Richmond Avenue, Suite 400 N
 Houston, Texas 77056
 (713) 782-7781 (713) 782-5564, Fax
 (713) 782-7781 (713) 782-5564, Fax
 TSPS FIRM REG. NO. 20046



NO.	REVISION	DATE	BY

DESIGNED BY: JRC
 CHECKED BY: JRC
 SURVEY CHECKED BY: JRC
 DATE: 10/26/11
 CIVIL ENGINEER

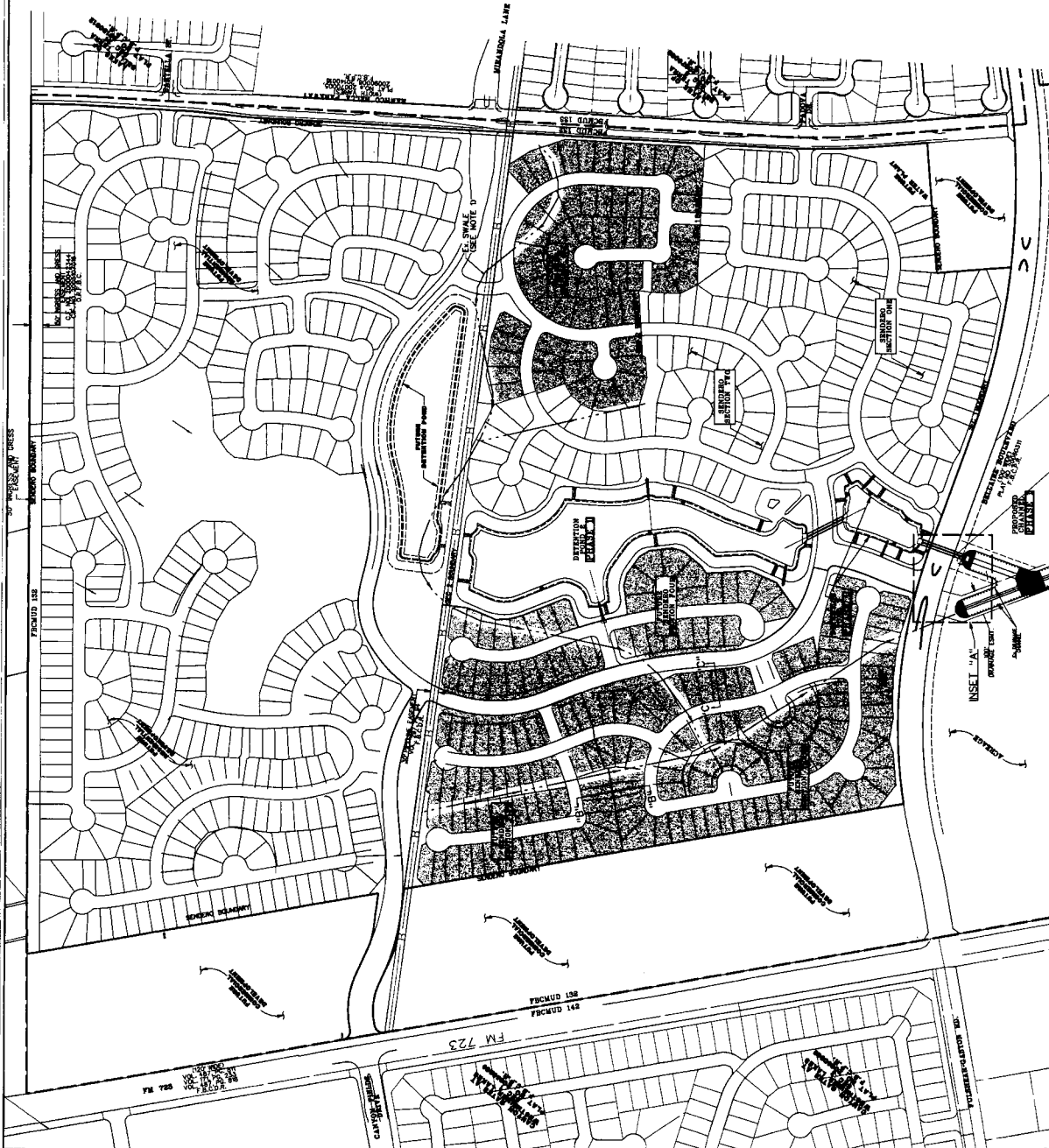

PORT BEND COUNTY MUD 132
 1. CONTAINMENT SHALL BE MAINTAINED AT ALL TIMES TO PREVENT FLOODING OF ADJACENT AREAS.
 2. ALL CONSTRUCTION SHALL BE IN ACCORDANCE WITH THE LATEST EDITIONS OF THE TEXAS CONSTRUCTION CODES AND REGULATIONS.
 3. ALL CONSTRUCTION SHALL BE IN ACCORDANCE WITH THE LATEST EDITIONS OF THE TEXAS CONSTRUCTION CODES AND REGULATIONS.
 4. ALL CONSTRUCTION SHALL BE IN ACCORDANCE WITH THE LATEST EDITIONS OF THE TEXAS CONSTRUCTION CODES AND REGULATIONS.
 5. ALL CONSTRUCTION SHALL BE IN ACCORDANCE WITH THE LATEST EDITIONS OF THE TEXAS CONSTRUCTION CODES AND REGULATIONS.

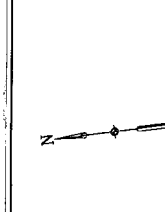

- LEGEND**
- EXISTING CONTOUR
 - EXISTING GROUND SPOT
 - EXISTING GAS LINE
 - FINISHED GRADE ELEVATION
 - FLOW DIRECTION
 - MATCH EXISTING ELEVATION
 - PROPOSED GENERAL FILL AREA

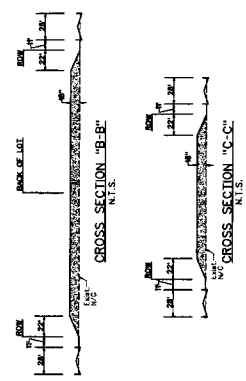
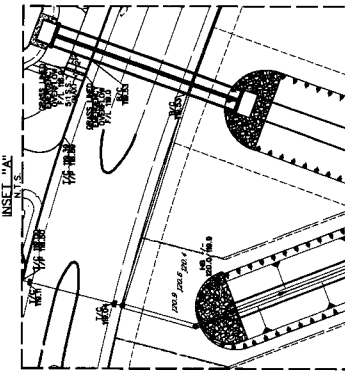

APPROVED: *[Signature]*
 DATE: 12/22/15
 PROJECT NO.: 15-231-C
 CITY OF HOUSTON
 DEPARTMENT OF PUBLIC WORKS AND ENGINEERING
 PLANNING SCALE: 1" = 200'
 SHEET NO. 9 OF 26

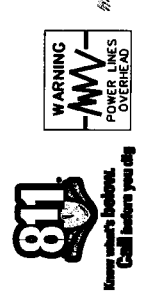

Costello
 Engineering and Surveying
 9690 Richmond Avenue, Suite 450 N
 (713) 783-7788 / (713) 783-3550, Fax
 TBP'S FIRM REG. NO. 360
 TBP'S FIRM REG. NO. 00466

DESIGNED BY: *[Signature]*
 DRAWN BY: *[Signature]*
 CHECKED BY: *[Signature]*
 DATE: 12/22/15

FOR BEND COUNTY MUD 132
 SENDERO DETENTION PHASE 1
 OVERALL FILL & GRADING LAYOUT

WARNING
 -MW-
 POWER LINES
 OVERHEAD

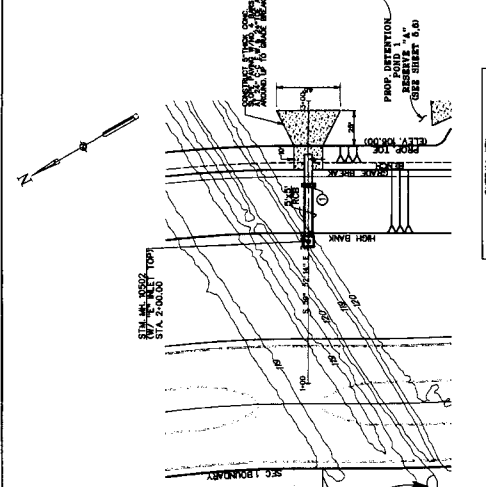
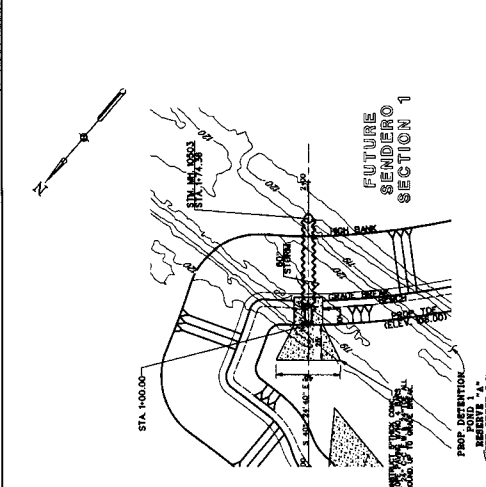
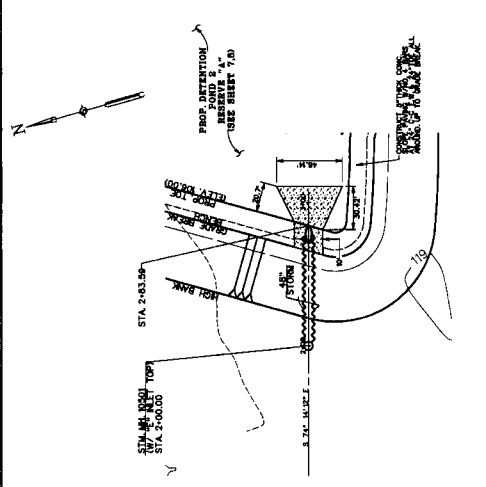

PT. NO.	STATION	OFFSET	ELEVATION
1	2+38.38	10.00	106.00



OUTFALL "F"

OUTFALL "G"

OUTFALL "H"

CONTRACTOR TO FIELD VERIFY LOCATION AND ELEVATION OF EXISTING UTILITIES PRIOR TO STARTING CONSTRUCTION

STATION	DESCRIPTION
126	
122	
118	
114	
110	
106	
102	
98	
94	
90	

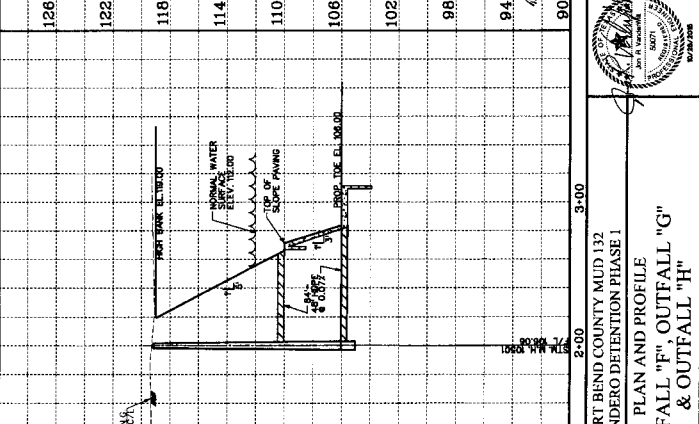

SCALE: 1" = 40' HORIZ.
 1" = 4' VERT.

CURVE DATA

APPROVED: [Signature] PROJECT SUPERVISOR

CITY OF HOUSTON
 DEPARTMENT OF PUBLIC WORKS & ENGINEERING

FOR CITY, INDUSTRIAL USE ONLY

DRAWING SCALE
 HORIZ 1" = 40'
 VERT 1" = 4'

SHEET NO. 13 OF 26

Fort Bend County MUD 132
 SENDERO DETENTION PHASE I
 PLAN AND PROFILE
 OUTFALL "F", OUTFALL "G"
 & OUTFALL "H"

Costello
 Engineering and Surveying
 9690 Richmond Avenue, Suite 450 N
 (713) 783-7788 (713) 783-8580, Fax
 TBP&S FIRM REG. NO. 280
 TBP&S FIRM REG. NO. 100486

DESIGNED BY: [Signature]
 DRAWN BY: [Signature]
 CHECKED BY: [Signature]
 SURVEY CHECKED BY: [Signature]
 DATE: 10-10-17

NO.	REVISION	DATE	BY

PORT BEND COUNTY MUD 132

RD WK HEAD C420-10	END RD WK C420-26	RIGHT LANE ENDS C420-08R	LEFT LANE ENDS C420-08L	RD WK NEXT 1/2 MI C420-18L	RD WK NEXT MI C420-18R	DRAINS C420-06	TRAFFIC CONTROL C420-07	LANE ENDS MERGE RIGHT C420-28R	LANE ENDS MERGE LEFT C420-28L	RETAINING WALL C420-09	RETAINING WALL C420-09	RIGHT TURN C420-4R	LEFT TURN C420-4L	35 MPH C420-1

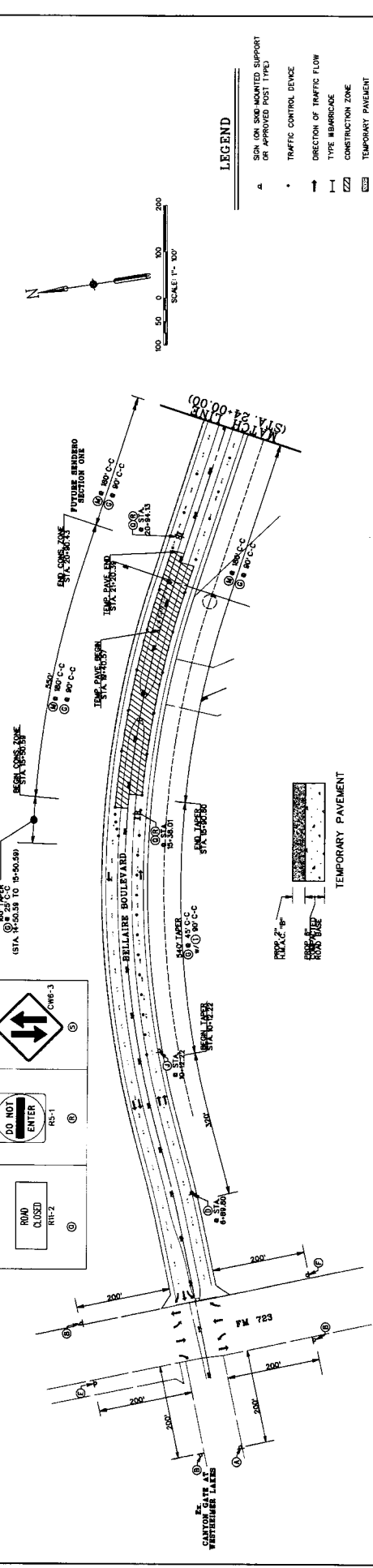

GENERAL NOTES FOR TRAFFIC MARKING

- THE CONTRACTOR SHALL MAINTAIN TRAFFIC CONTROL, SIGNAGE, AND BARRIAGES ON THESE BARRIAGES CONSTITUTE MINIMUM REQUIREMENTS. THE CONTRACTOR SHALL MAINTAIN TRAFFIC CONTROL, SIGNAGE, AND BARRIAGES THROUGHOUT THE PROJECT. THE CONTRACTOR SHALL MAINTAIN TRAFFIC CONTROL, SIGNAGE, AND BARRIAGES THROUGHOUT THE PROJECT.
- CONTRACTOR SHALL MAINTAIN TRAFFIC CONTROL, SIGNAGE, AND BARRIAGES THROUGHOUT THE PROJECT. THE CONTRACTOR SHALL MAINTAIN TRAFFIC CONTROL, SIGNAGE, AND BARRIAGES THROUGHOUT THE PROJECT.
- CONTRACTOR SHALL MAINTAIN TRAFFIC CONTROL, SIGNAGE, AND BARRIAGES THROUGHOUT THE PROJECT. THE CONTRACTOR SHALL MAINTAIN TRAFFIC CONTROL, SIGNAGE, AND BARRIAGES THROUGHOUT THE PROJECT.
- CONTRACTOR SHALL MAINTAIN TRAFFIC CONTROL, SIGNAGE, AND BARRIAGES THROUGHOUT THE PROJECT. THE CONTRACTOR SHALL MAINTAIN TRAFFIC CONTROL, SIGNAGE, AND BARRIAGES THROUGHOUT THE PROJECT.
- CONTRACTOR SHALL MAINTAIN TRAFFIC CONTROL, SIGNAGE, AND BARRIAGES THROUGHOUT THE PROJECT. THE CONTRACTOR SHALL MAINTAIN TRAFFIC CONTROL, SIGNAGE, AND BARRIAGES THROUGHOUT THE PROJECT.
- CONTRACTOR SHALL MAINTAIN TRAFFIC CONTROL, SIGNAGE, AND BARRIAGES THROUGHOUT THE PROJECT. THE CONTRACTOR SHALL MAINTAIN TRAFFIC CONTROL, SIGNAGE, AND BARRIAGES THROUGHOUT THE PROJECT.
- CONTRACTOR SHALL MAINTAIN TRAFFIC CONTROL, SIGNAGE, AND BARRIAGES THROUGHOUT THE PROJECT. THE CONTRACTOR SHALL MAINTAIN TRAFFIC CONTROL, SIGNAGE, AND BARRIAGES THROUGHOUT THE PROJECT.
- CONTRACTOR SHALL MAINTAIN TRAFFIC CONTROL, SIGNAGE, AND BARRIAGES THROUGHOUT THE PROJECT. THE CONTRACTOR SHALL MAINTAIN TRAFFIC CONTROL, SIGNAGE, AND BARRIAGES THROUGHOUT THE PROJECT.
- CONTRACTOR SHALL MAINTAIN TRAFFIC CONTROL, SIGNAGE, AND BARRIAGES THROUGHOUT THE PROJECT. THE CONTRACTOR SHALL MAINTAIN TRAFFIC CONTROL, SIGNAGE, AND BARRIAGES THROUGHOUT THE PROJECT.
- CONTRACTOR SHALL MAINTAIN TRAFFIC CONTROL, SIGNAGE, AND BARRIAGES THROUGHOUT THE PROJECT. THE CONTRACTOR SHALL MAINTAIN TRAFFIC CONTROL, SIGNAGE, AND BARRIAGES THROUGHOUT THE PROJECT.
- CONTRACTOR SHALL MAINTAIN TRAFFIC CONTROL, SIGNAGE, AND BARRIAGES THROUGHOUT THE PROJECT. THE CONTRACTOR SHALL MAINTAIN TRAFFIC CONTROL, SIGNAGE, AND BARRIAGES THROUGHOUT THE PROJECT.
- CONTRACTOR SHALL MAINTAIN TRAFFIC CONTROL, SIGNAGE, AND BARRIAGES THROUGHOUT THE PROJECT. THE CONTRACTOR SHALL MAINTAIN TRAFFIC CONTROL, SIGNAGE, AND BARRIAGES THROUGHOUT THE PROJECT.
- CONTRACTOR SHALL MAINTAIN TRAFFIC CONTROL, SIGNAGE, AND BARRIAGES THROUGHOUT THE PROJECT. THE CONTRACTOR SHALL MAINTAIN TRAFFIC CONTROL, SIGNAGE, AND BARRIAGES THROUGHOUT THE PROJECT.
- CONTRACTOR SHALL MAINTAIN TRAFFIC CONTROL, SIGNAGE, AND BARRIAGES THROUGHOUT THE PROJECT. THE CONTRACTOR SHALL MAINTAIN TRAFFIC CONTROL, SIGNAGE, AND BARRIAGES THROUGHOUT THE PROJECT.
- CONTRACTOR SHALL MAINTAIN TRAFFIC CONTROL, SIGNAGE, AND BARRIAGES THROUGHOUT THE PROJECT. THE CONTRACTOR SHALL MAINTAIN TRAFFIC CONTROL, SIGNAGE, AND BARRIAGES THROUGHOUT THE PROJECT.

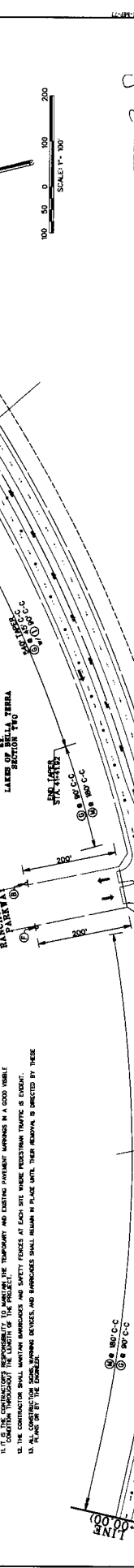

LEGEND

- ▲ SIGN OR SIGN MOUNTED SUPPORT OR APPROVED POST TYPE
- TRAFFIC CONTROL DEVICE
- DIRECTION OF TRAFFIC FLOW
- TYPE MARKING
- ▨ CONSTRUCTION ZONE
- ▭ TEMPORARY PAVEMENT

SCALE 1" = 100'

SCALE 1" = 200'

SCALE 1" = 400'

SCALE 1" = 800'

SCALE 1" = 1600'

CITY OF HOUSTON
 DEPARTMENT OF PUBLIC WORKS AND MAINTENANCE
 PROJECT: BELLAIR BOULEVARD
 DRAWING NO: 54901
 SHEET NO: 16 of 26

Costello
 Engineering and Surveying
 9990 Richmond Avenue, Suite 450 N
 Houston, Texas 77042
 (713) 782-7788 (713) 782-5860, Fax
 18500 FRM RES. NO. 108466

TRAFFIC CONTROL PHASE I

FORT BEND COUNTY MUD 132 SENDERO DETENTION PHASE I

ROAD WORK AHEAD W20-10	END ROAD WORK W20-20	RIGHT LANE ENDS W20-20	LEFT LANE ENDS W20-20	ROAD WORK NEXT MILE W20-30	ROAD WORK NEXT 1/2 MILE W20-30	DRUMS W20-30	CURVE AHEAD W20-30	LANE ENDS MERGE RIGHT W20-30	LANE ENDS MERGE LEFT W20-30	REMOVE WHEEL BARRELS W20-30	REMOVE WHEEL BARRELS W20-30	RIGHT TURN W20-30	LEFT TURN W20-30	35 M.P.H. W20-30

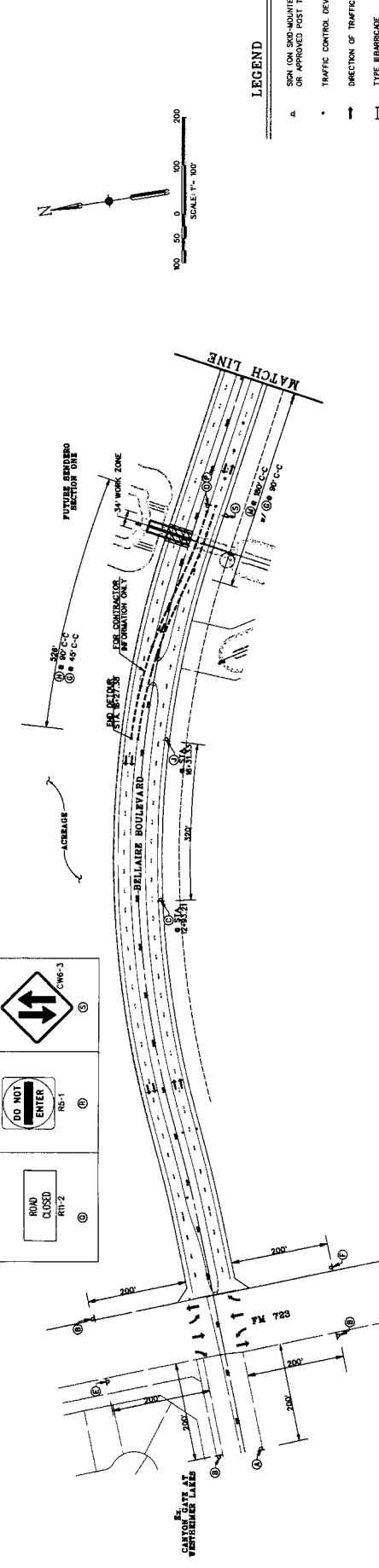

LEGEND

FOR USE ON UNADJUSTED SUPPORT OR APPROVED TEST TYPES

- TRAFFIC CONTROL DEVICE
- DIRECTION OF TRAFFIC FLOW
- TYPE BARRICADE
- CONSTRUCTION ZONE

GENERAL NOTES FOR TRAFFIC MARKING

- THE CONTRACTOR SHALL CONTROL ROAD CLOSURES AND BARRICADES ON THESE DRAWINGS CONSTITUTE MINIMUM REQUIREMENTS. THE CONTRACTOR SHALL BE RESPONSIBLE FOR THE SAFETY OF THE ROADWAY AND THE CONSTRUCTION ZONE. SAFETY AND MARKING SHALL BE ADJUSTED TO FIT THE FIELD CONDITIONS.
- CONTRACTOR SHALL MAINTAIN TRAFFIC CONTROL DEVICES AND BARRICADES AT ALL TIMES DURING CONSTRUCTION.
- CONTRACTOR SHALL MAINTAIN TRAFFIC CONTROL DEVICES AND BARRICADES AT ALL TIMES DURING CONSTRUCTION.
- CONTRACTOR SHALL MAINTAIN TRAFFIC CONTROL DEVICES AND BARRICADES AT ALL TIMES DURING CONSTRUCTION.
- CONTRACTOR SHALL MAINTAIN TRAFFIC CONTROL DEVICES AND BARRICADES AT ALL TIMES DURING CONSTRUCTION.
- CONTRACTOR SHALL MAINTAIN TRAFFIC CONTROL DEVICES AND BARRICADES AT ALL TIMES DURING CONSTRUCTION.
- CONTRACTOR SHALL MAINTAIN TRAFFIC CONTROL DEVICES AND BARRICADES AT ALL TIMES DURING CONSTRUCTION.
- CONTRACTOR SHALL MAINTAIN TRAFFIC CONTROL DEVICES AND BARRICADES AT ALL TIMES DURING CONSTRUCTION.
- CONTRACTOR SHALL MAINTAIN TRAFFIC CONTROL DEVICES AND BARRICADES AT ALL TIMES DURING CONSTRUCTION.
- CONTRACTOR SHALL MAINTAIN TRAFFIC CONTROL DEVICES AND BARRICADES AT ALL TIMES DURING CONSTRUCTION.
- CONTRACTOR SHALL MAINTAIN TRAFFIC CONTROL DEVICES AND BARRICADES AT ALL TIMES DURING CONSTRUCTION.
- CONTRACTOR SHALL MAINTAIN TRAFFIC CONTROL DEVICES AND BARRICADES AT ALL TIMES DURING CONSTRUCTION.
- CONTRACTOR SHALL MAINTAIN TRAFFIC CONTROL DEVICES AND BARRICADES AT ALL TIMES DURING CONSTRUCTION.
- CONTRACTOR SHALL MAINTAIN TRAFFIC CONTROL DEVICES AND BARRICADES AT ALL TIMES DURING CONSTRUCTION.
- CONTRACTOR SHALL MAINTAIN TRAFFIC CONTROL DEVICES AND BARRICADES AT ALL TIMES DURING CONSTRUCTION.

CITY OF HOUSTON
 DEPARTMENT OF PUBLIC WORKS AND ENGINEERING
 PROJECT NO. 1102-2020-0001
 DRAWING NO. 1102-2020-0001-001
 SHEET NO. 18 OF 26

FOR CITY OF HOUSTON USE ONLY

DESIGNED BY: [Signature]
 DRAWN BY: [Signature]
 CHECKED BY: [Signature]
 DATE: 10-22-15

Costello
 Engineering and Surveying
 9990 Richmond Avenue, Suite 450 N
 Houston, Texas 77042
 (713) 782-7788 (713) 782-5888 Fax
 LICENSE NO. 10000
 TSPS FRM REG. NO. 10000

TRAFFIC CONTROL PHASE 2b

FORT BEND COUNTY MUD 132 SENDERO DETENTION PHASE I

APPROVED: [Signature]
 DATE: 10-22-15

SCALE: 1" = 100'

SCALE: 1" = 100'

FOR FORT BEND COUNTY MUD 132

APPROVED: *[Signature]*
 DATE: 10/25/11
 TITLE: PROJECT COORDINATOR

CITY OF HOUSTON
 DEPARTMENT OF PUBLIC WORKS AND ENGINEERING

FILE NO. 10-285
 DRAWING SCALE 1" = 50'
 SHEET NO. 21 OF 26

FOR CITY OF HOUSTON USE ONLY



- NOTES:**
1. PLACE FILTER FABRIC SILT FENCE 4'-5 FEET AROUND ALL INLETS.
 2. ALL SILT STOCKPILES OF SIGNIFICANT SIZE SHALL BE ENCOMPASSED BY SILT FENCING.
 3. ALL PROPOSED SNALES TO BE CONSTRUCTED BY THE CONTRACTOR FOR MAINTAINING THE ENTIRE SNALE JUST UPSTREAM OF THE OUTFALL LOCATION.
 4. A VEHICLE WASH-DOWN AREA FOR THE PROJECT MAY BE LOCATED BY THE CONTRACTOR IN USE IN THE STREAM TO BE PROTECTED. THE LOCATION OF THE WASH-DOWN IS AT THE CONTRACTOR'S OPTION.
 5. THE CONTRACTOR SHALL BE RESPONSIBLE FOR MAINTAINING ALL SUMP FEATURES INDICATED ON THIS PLAN.
 6. ESTABLISH THE SUMP AREA'S DURING CONSTRUCTION TO COMPLETION TO CONTINUE WITHIN 14 DAYS.
 7. UPON PROJECT COMPLETION AND FINAL STABILIZATION, ALL SILT FENCE SHALL BE REMOVED AND DISPOSED OF.

POLLUTION PREVENTION PLAN
LEGEND

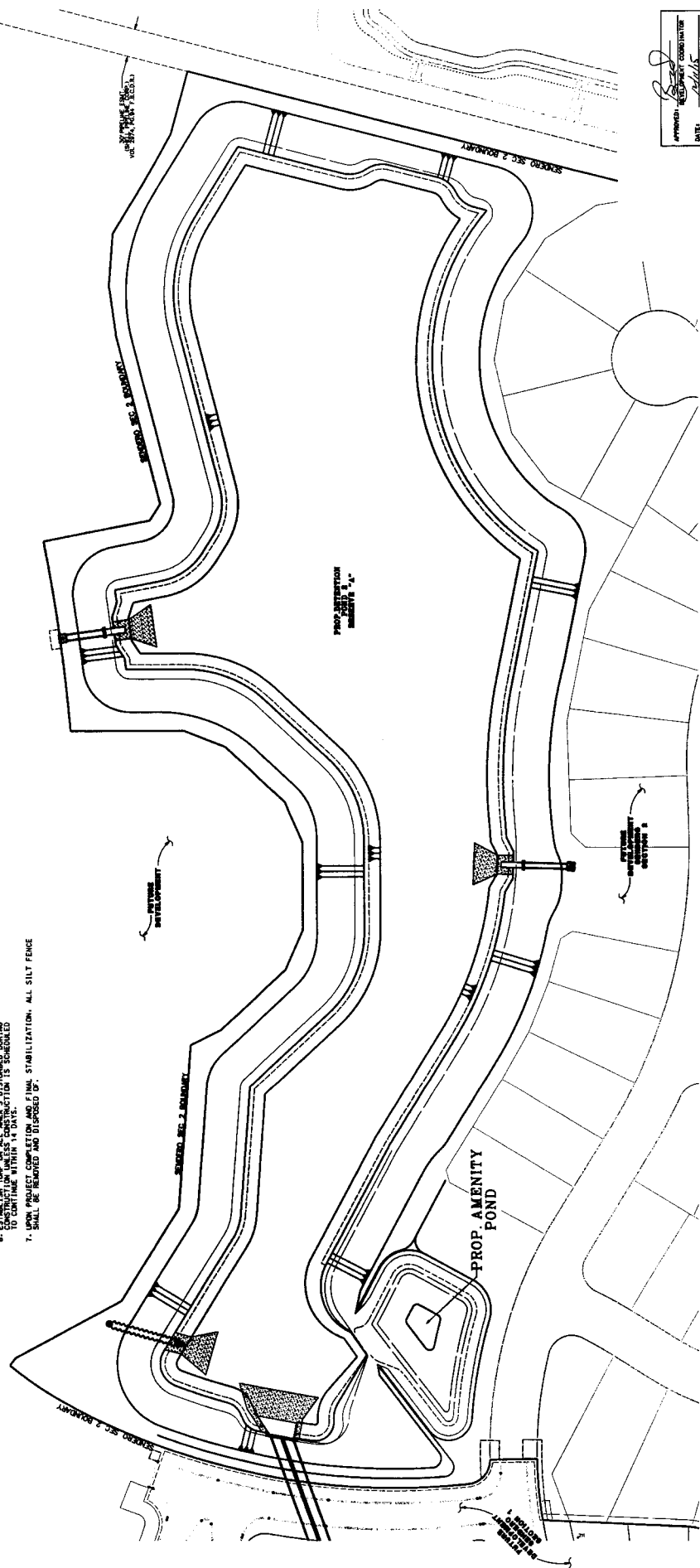
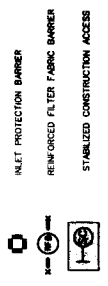

FORT BEND COUNTY MUD 132
SENDERO DETENTION PHASE 1
POLLUTION PREVENTION LAYOUT
DETECTION POND 2

Engineering and Surveying
 9900 Richmond Avenue, Suite 460 N
 Houston, TX 77036
 (713) 763-7799 Fax (713) 763-5660
 TEXAS FIRM REG. NO. 990
 TERPUS FIRM REG. NO. 100466



DESIGNED BY:	MC
DRAWN BY:	MC
CHECKED BY:	MC
DATE:	10-25-11

NO.	DATE	BY	REVISION

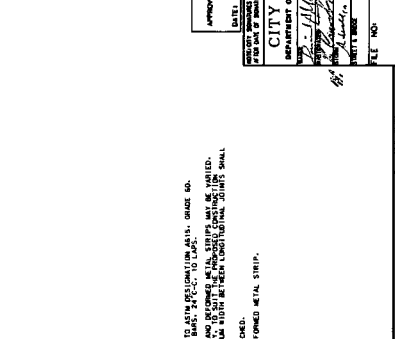
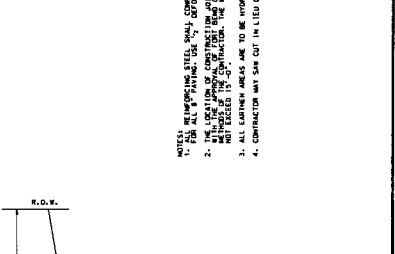
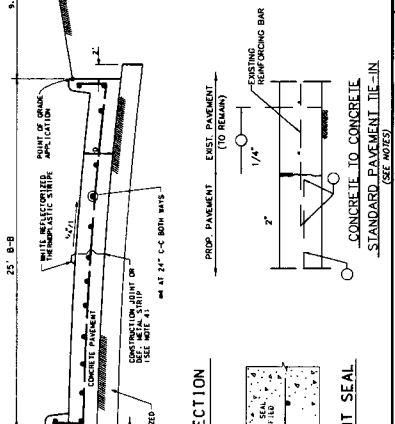
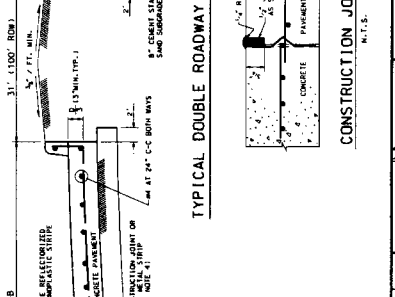
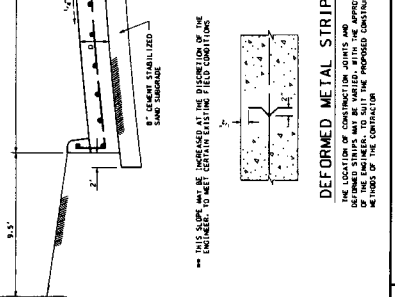
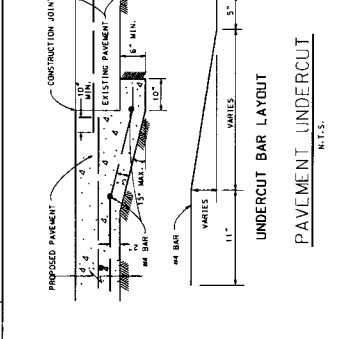
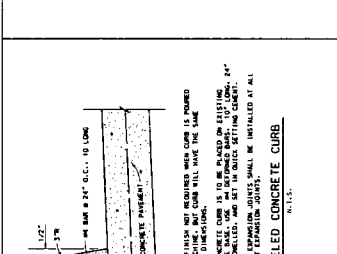
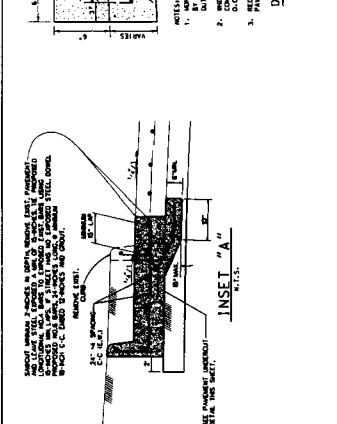
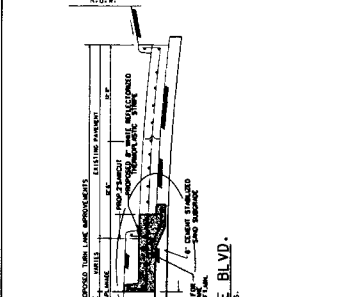
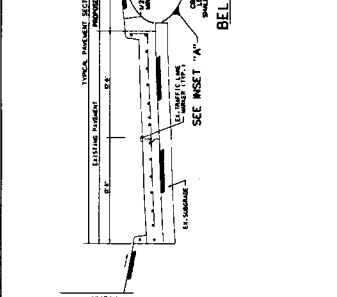
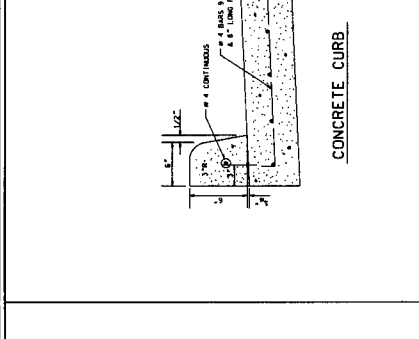
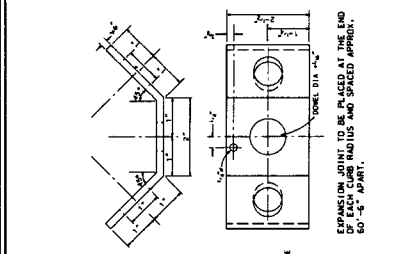
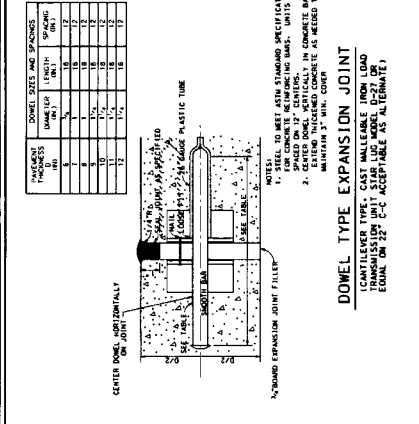
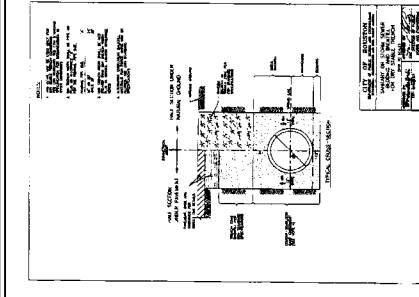
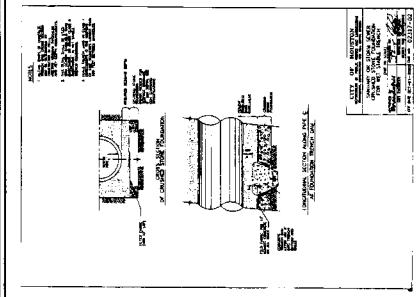

NO.	REVISION	DATE	BY

DESIGNED BY: *[Signature]*
 DESIGN CHECKED BY: *[Signature]*
 DRAWN BY: *[Signature]*
 GOOD CHECKED BY: *[Signature]*
 SHEET CHECKED BY: *[Signature]*
 QUANTITY BY: *[Signature]*

Costello
 Engineers and Surveyors
 8800 Richmond Avenue, Suite 460 N
 Houston, Texas 77042
 (713) 783-7788 (713) 783-3880 Fax
 TBP&S FIRM REG. NO. 280
 TBP&S FIRM REG. NO. 100486

FORT BEND COUNTY MUD 132
 SENDERO DETENTION PHASE I
BEDDING AND PAVING DETAILS

CITY OF HOUSTON
 DEPARTMENT OF PUBLIC WORKS AND ENGINEERING
 PROJECT NO. 132-0000000000
 SHEET NO. 22 OF 26

APPROVED: *[Signature]*
 DATE: *[Date]*

FOR CITY OF HOUSTON USE ONLY

PROJECT NO. 132-0000000000
 SHEET NO. 22 OF 26

NOTES:
 1. ALL REINFORCING STEEL SHALL CONFORM TO ASTM SPECIFICATION A615, GRADE 60.
 2. ALL REINFORCING STEEL SHALL BE PLACED AT THE END OF EACH CURB RADIUS AND SPACED APPROX. 60"-8" APART.
 3. ALL CURB RADIUS SHALL BE ROUNDED AT THE END OF EACH CURB RADIUS AND SPACED APPROX. 60"-8" APART.
 4. CONSTRUCTION SHALL BE IN ACCORDANCE WITH THE STANDARD SPECIFICATIONS FOR ROAD AND BRIDGE CONSTRUCTION, TEXAS EDITION, 2005.

NOTES:
 1. ALL REINFORCING STEEL SHALL CONFORM TO ASTM SPECIFICATION A615, GRADE 60.
 2. ALL REINFORCING STEEL SHALL BE PLACED AT THE END OF EACH CURB RADIUS AND SPACED APPROX. 60"-8" APART.
 3. ALL CURB RADIUS SHALL BE ROUNDED AT THE END OF EACH CURB RADIUS AND SPACED APPROX. 60"-8" APART.
 4. CONSTRUCTION SHALL BE IN ACCORDANCE WITH THE STANDARD SPECIFICATIONS FOR ROAD AND BRIDGE CONSTRUCTION, TEXAS EDITION, 2005.

NOTES:
 1. ALL REINFORCING STEEL SHALL CONFORM TO ASTM SPECIFICATION A615, GRADE 60.
 2. ALL REINFORCING STEEL SHALL BE PLACED AT THE END OF EACH CURB RADIUS AND SPACED APPROX. 60"-8" APART.
 3. ALL CURB RADIUS SHALL BE ROUNDED AT THE END OF EACH CURB RADIUS AND SPACED APPROX. 60"-8" APART.
 4. CONSTRUCTION SHALL BE IN ACCORDANCE WITH THE STANDARD SPECIFICATIONS FOR ROAD AND BRIDGE CONSTRUCTION, TEXAS EDITION, 2005.

NOTES:
 1. ALL REINFORCING STEEL SHALL CONFORM TO ASTM SPECIFICATION A615, GRADE 60.
 2. ALL REINFORCING STEEL SHALL BE PLACED AT THE END OF EACH CURB RADIUS AND SPACED APPROX. 60"-8" APART.
 3. ALL CURB RADIUS SHALL BE ROUNDED AT THE END OF EACH CURB RADIUS AND SPACED APPROX. 60"-8" APART.
 4. CONSTRUCTION SHALL BE IN ACCORDANCE WITH THE STANDARD SPECIFICATIONS FOR ROAD AND BRIDGE CONSTRUCTION, TEXAS EDITION, 2005.

TABLE OF DIMENSIONS & REINFORCING STEEL

SECTION	DESCRIPTION	REINFORCING STEEL
SECTION A-A	INSIDE ELEVATION	...
SECTION B-B	CORNER DETAILS	...
SECTION C-C	LEADING AND TERMINAL	...
SECTION D-D	PLAN	...

REINFORCING CALCULATIONS:

GENERAL NOTES:

1. CONCRETE SHALL BE 4000 PSI STRENGTH WITH 3% AIR ENTRAINMENT.
2. REINFORCING SHALL BE #4 EPOXY COATED BARS.
3. ALL REINFORCING SHALL BE DEVELOPED AND ANCHORED AS SHOWN.
4. ALL CORNERS SHALL BE REINFORCED WITH #4 BARS.
5. ALL WALLS SHALL BE FINISHED WITH 1/2" GYPSUM BOARD AND PAINT.
6. ALL WALLS SHALL BE FINISHED WITH 1/2" GYPSUM BOARD AND PAINT.
7. ALL WALLS SHALL BE FINISHED WITH 1/2" GYPSUM BOARD AND PAINT.
8. ALL WALLS SHALL BE FINISHED WITH 1/2" GYPSUM BOARD AND PAINT.
9. ALL WALLS SHALL BE FINISHED WITH 1/2" GYPSUM BOARD AND PAINT.
10. ALL WALLS SHALL BE FINISHED WITH 1/2" GYPSUM BOARD AND PAINT.

CONCRETE WINGWALLS WITH FLARED WINGS FOR SKEWED BOX CULVERTS

F.W-5

TABLE OF DIMENSIONS & REINFORCING STEEL

SECTION	DESCRIPTION	REINFORCING STEEL
SECTION A-A	INSIDE ELEVATION	...
SECTION B-B	CORNER DETAILS	...
SECTION C-C	LEADING AND TERMINAL	...
SECTION D-D	PLAN	...

REINFORCING CALCULATIONS:

GENERAL NOTES:

1. CONCRETE SHALL BE 4000 PSI STRENGTH WITH 3% AIR ENTRAINMENT.
2. REINFORCING SHALL BE #4 EPOXY COATED BARS.
3. ALL REINFORCING SHALL BE DEVELOPED AND ANCHORED AS SHOWN.
4. ALL CORNERS SHALL BE REINFORCED WITH #4 BARS.
5. ALL WALLS SHALL BE FINISHED WITH 1/2" GYPSUM BOARD AND PAINT.
6. ALL WALLS SHALL BE FINISHED WITH 1/2" GYPSUM BOARD AND PAINT.
7. ALL WALLS SHALL BE FINISHED WITH 1/2" GYPSUM BOARD AND PAINT.
8. ALL WALLS SHALL BE FINISHED WITH 1/2" GYPSUM BOARD AND PAINT.
9. ALL WALLS SHALL BE FINISHED WITH 1/2" GYPSUM BOARD AND PAINT.
10. ALL WALLS SHALL BE FINISHED WITH 1/2" GYPSUM BOARD AND PAINT.

CONCRETE WINGWALLS WITH STRAIGHT WINGS FOR 0° SKEW BOX CULVERTS

SW-0

APPROVED: *[Signature]*
DATE: _____

CITY OF HOUSTON
DEPARTMENT OF PUBLIC WORKS AND ENGINEERING

FILE NO: _____
SCALE: N.T.S.
SHEET 24 of 26



**FORT BEND COUNTY MUD 132
SENDERO DETENTION PHASE 1
CONCRETE WINGWALLS FLARED AND
CONCRETE WINGWALLS STRAIGHT**

Engineers and Surveyors
8990 Richmond Avenue, Suite 450 N
Houston, Texas 77042
(713) 783-7198 (713) 783-3580, Fax
TBE FIRM REG. NO. 280
TBE FIRM REG. NO. 100486



DESIGNED BY: *[Signature]*
DRAWN BY: *[Signature]*
CHECKED BY: *[Signature]*
DATE: 10-20-15

REVISION	DATE	BY

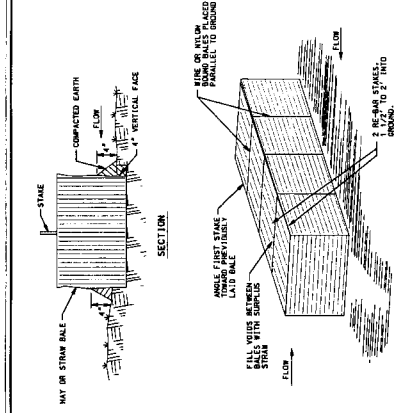

GENERAL NOTES:

1. BALES SHALL BE PLACED IN A ROW WITH LINES TIGHTLY ADJACENT TO THE ADJACENT BALE WITH THE LONG END OF THE BALE PARALLEL TO THE FLOW.
2. WHERE POSSIBLE EACH BALE SHALL BE EMBEDDED IN THE SOIL A MINIMUM OF 4 INCHES.
3. BALE TIES SHOULD BE FASTENED TO THE BALE WITH WIRE OR WILTON WIRE TIED ACROSS THE BALE.
4. MAINTENANCE WILL BE PERFORMED AS NEEDED.

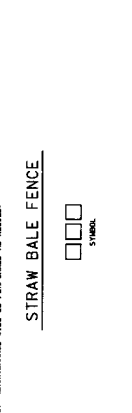

CONSTRUCTION NOTES:

1. 3\"/>

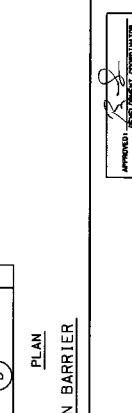

CONSTRUCTION NOTES:

1. SEE SECTION 01568 - REINFORCED FILTER FABRIC BARRIER.

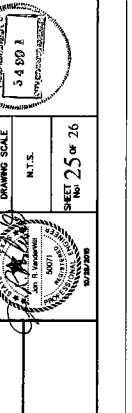

CONSTRUCTION NOTES:

1. SEE SECTION 01568 - REINFORCED FILTER FABRIC BARRIER.

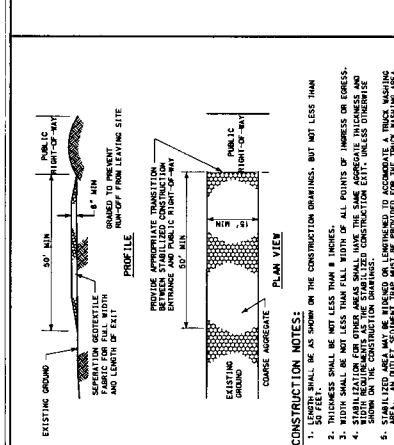

GENERAL NOTES:

1. BALES SHALL BE PLACED IN A ROW WITH LINES TIGHTLY ADJACENT TO THE ADJACENT BALE WITH THE LONG END OF THE BALE PARALLEL TO THE FLOW.
2. WHERE POSSIBLE EACH BALE SHALL BE EMBEDDED IN THE SOIL A MINIMUM OF 4 INCHES.
3. BALE TIES SHOULD BE FASTENED TO THE BALE WITH WIRE OR WILTON WIRE TIED ACROSS THE BALE.
4. MAINTENANCE WILL BE PERFORMED AS NEEDED.



CONSTRUCTION NOTES:

1. 3\"/>

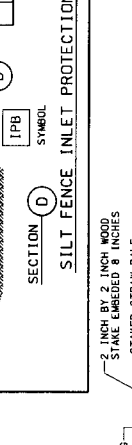

CONSTRUCTION NOTES:

1. SEE SECTION 01568 - REINFORCED FILTER FABRIC BARRIER.

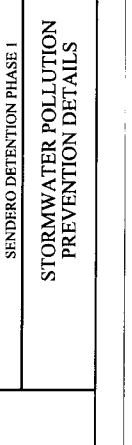

CONSTRUCTION NOTES:

1. SEE SECTION 01568 - REINFORCED FILTER FABRIC BARRIER.

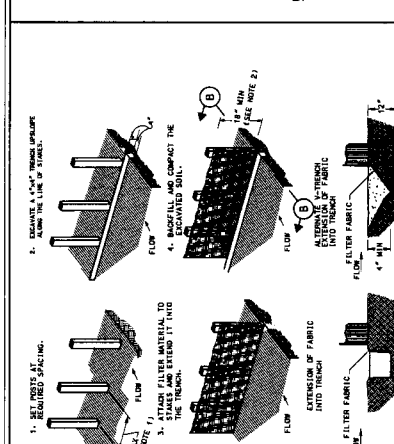

GENERAL NOTES:

1. BALES SHALL BE PLACED IN A ROW WITH LINES TIGHTLY ADJACENT TO THE ADJACENT BALE WITH THE LONG END OF THE BALE PARALLEL TO THE FLOW.
2. WHERE POSSIBLE EACH BALE SHALL BE EMBEDDED IN THE SOIL A MINIMUM OF 4 INCHES.
3. BALE TIES SHOULD BE FASTENED TO THE BALE WITH WIRE OR WILTON WIRE TIED ACROSS THE BALE.
4. MAINTENANCE WILL BE PERFORMED AS NEEDED.



CONSTRUCTION NOTES:

1. 3\"/>

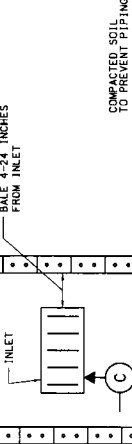

CONSTRUCTION NOTES:

1. SEE SECTION 01568 - REINFORCED FILTER FABRIC BARRIER.

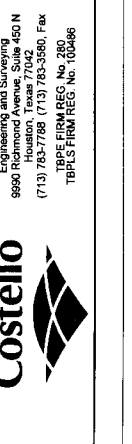

CONSTRUCTION NOTES:

1. SEE SECTION 01568 - REINFORCED FILTER FABRIC BARRIER.

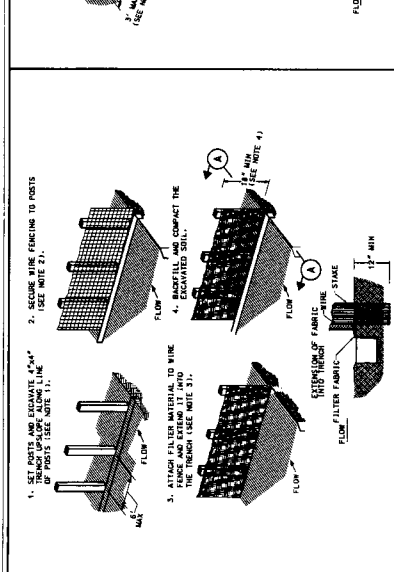

GENERAL NOTES:

1. BALES SHALL BE PLACED IN A ROW WITH LINES TIGHTLY ADJACENT TO THE ADJACENT BALE WITH THE LONG END OF THE BALE PARALLEL TO THE FLOW.
2. WHERE POSSIBLE EACH BALE SHALL BE EMBEDDED IN THE SOIL A MINIMUM OF 4 INCHES.
3. BALE TIES SHOULD BE FASTENED TO THE BALE WITH WIRE OR WILTON WIRE TIED ACROSS THE BALE.
4. MAINTENANCE WILL BE PERFORMED AS NEEDED.

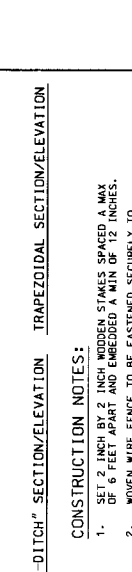

CONSTRUCTION NOTES:

1. 3\"/>



CONSTRUCTION NOTES:

1. SEE SECTION 01568 - REINFORCED FILTER FABRIC BARRIER.

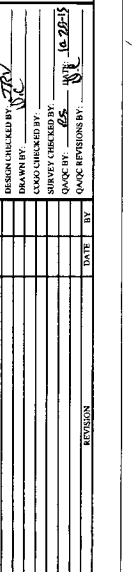

CONSTRUCTION NOTES:

1. SEE SECTION 01568 - REINFORCED FILTER FABRIC BARRIER.

