

## REVIEW BY FORT BEND COUNTY COMMISSIONERS COURT

On this 12th day of April, 2016, Commissioners Court came on to be heard and reviewed the accompanying notice of PRDG / Charles N. White Construction Company  
 Job Location 21700 Bellaire Boulevard, Richmond, TX 77407  
 Date 3/16/2016 Bond No. 8239-32-60, Permit No. 2016-6126 to make use of certain Fort Bend County property subject to, "A Revised Order Regulating the Laying, Construction, Maintenance, and Repair of Buried Cables, Conduits, and Pole Lines, In, Under, Across or Along Roads, Streets, Highways, and Drainage Ditches in Fort Bend County, Texas, Under the Jurisdiction of the Commissioners Court of Fort Bend County, Texas," as passed by the Commissioners Court of Fort Bend County, Texas the 3rd day of August, 1987, recorded in Volume \_\_\_\_\_ of the Minutes of the Commissioners Court of Fort Bend County, Texas, to the extent that such order is not inconsistent with Article 1436a, Vernon's Texas Civil Statutes. Upon Motion of Commissioner Meyers, seconded by Commissioner Morrison, duly put and carried, it is ORDERED, ADJUDGED AND DECREED that said notice of said above purpose is hereby acknowledged by the Commissioners Court of Fort Bend County, Texas, and that said notice be placed on record according to the regulation order thereof.

### Notes:

1. Evidence of review by the Commissioners Court must be kept on the job site and failure to do so constitutes grounds for job shutdown.
2. Written notices are required:
  - a. 48 hours in advance of construction start up, and
  - b. when construction is completed and ready for final inspection
 Mail notices to: Permit Administrator  
 Fort Bend County Engineering  
 301 Jackson Street  
 Richmond, Texas 77469  
 281-633-7500
3. This permit expires one (1) year from date of permit if construction has not commenced.

By: Charles O. Meyers  
 County Engineer

Presented to Commissioners Court and approved.

Recorded in Volume 4-12-16 9H  
 Minutes of Commissioners Court

By: N/A  
 Drainage District Engineer/Manager

Clerk of Commissioners Court

By: Ronda Wilks  
 Deputy



**BELLAIRE BOULEVARD**  
 (20' PUBLIC ROW)  
 (FC# 2007005 F&CP#)

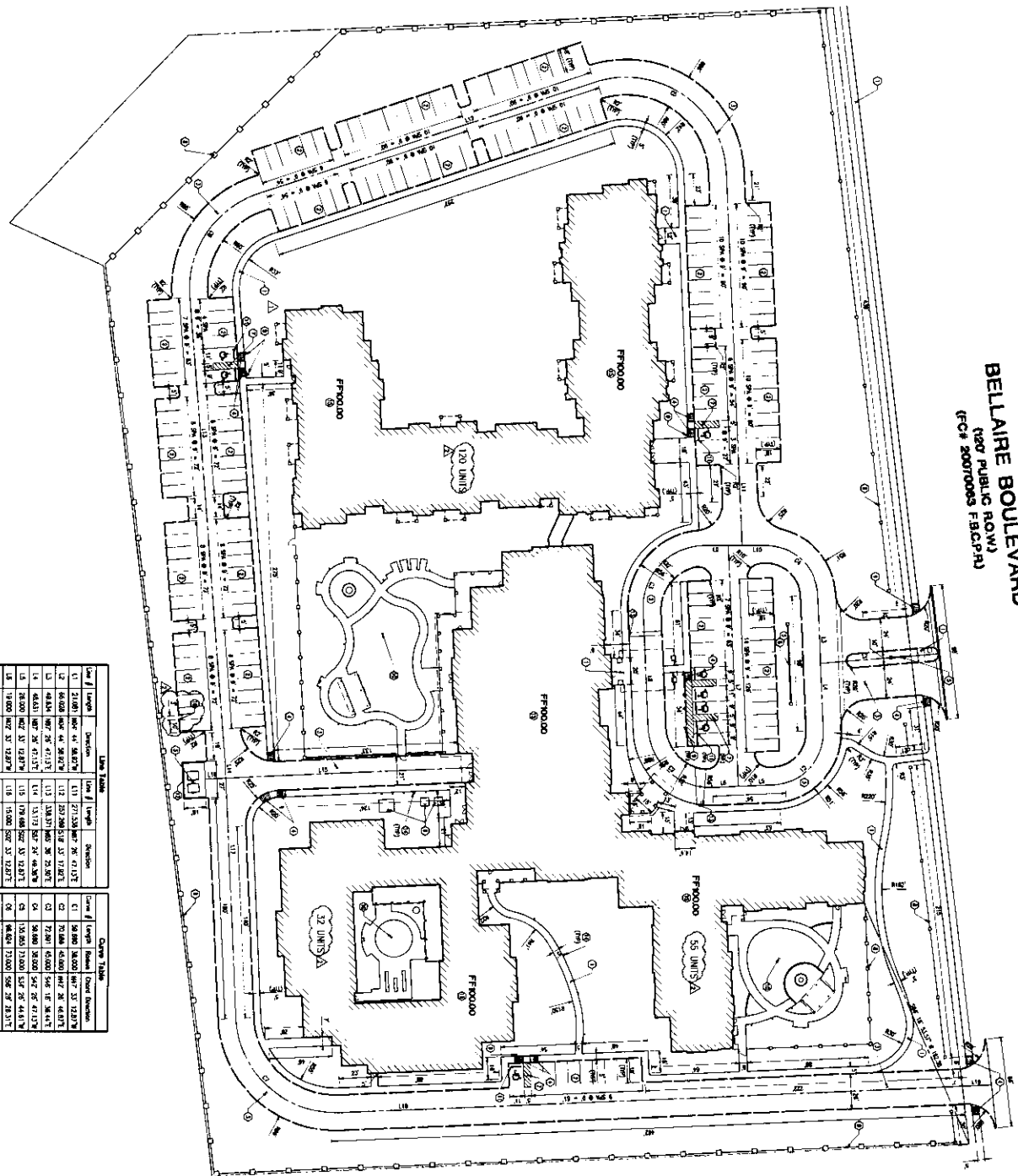

LINE TABLE			CHANG TABLE		
Line #	Length	Description	Line #	Length	Description
11	21.00	HWY 61 30.00'W	111	271.25	HWY 26 47.13'E
12	46.00	HWY 44 30.00'W	112	202.26	HWY 26 57.70'E
13	46.00	HWY 26 47.13'E	113	138.37	HWY 26 20.90'E
14	46.00	HWY 26 47.13'E	114	131.17	HWY 26 48.90'E
15	28.00	HWY 26 47.13'E	115	179.68	HWY 26 47.13'E
16	17.00	HWY 26 47.13'E	116	15.00	HWY 26 47.13'E
17	17.00	HWY 26 47.13'E	117	118.05	HWY 26 48.90'E
18	46.00	HWY 26 47.13'E	118	142.49	HWY 26 47.13'E
19	46.00	HWY 26 47.13'E	119	21.98	HWY 26 47.13'E
120	42.00	HWY 26 47.13'E			

- CONSTRUCTION NOTES**
- 1. CONCRETE FINISH
  - 2. CONCRETE FINISH
  - 3. CONCRETE FINISH
  - 4. CONCRETE FINISH
  - 5. CONCRETE FINISH
  - 6. CONCRETE FINISH
  - 7. CONCRETE FINISH
  - 8. CONCRETE FINISH
  - 9. CONCRETE FINISH
  - 10. CONCRETE FINISH
  - 11. CONCRETE FINISH
  - 12. CONCRETE FINISH
  - 13. CONCRETE FINISH
  - 14. CONCRETE FINISH
  - 15. CONCRETE FINISH
  - 16. CONCRETE FINISH
  - 17. CONCRETE FINISH
  - 18. CONCRETE FINISH
  - 19. CONCRETE FINISH
  - 20. CONCRETE FINISH
  - 21. CONCRETE FINISH
  - 22. CONCRETE FINISH
  - 23. CONCRETE FINISH
  - 24. CONCRETE FINISH
  - 25. CONCRETE FINISH
  - 26. CONCRETE FINISH
  - 27. CONCRETE FINISH
  - 28. CONCRETE FINISH
  - 29. CONCRETE FINISH
  - 30. CONCRETE FINISH
  - 31. CONCRETE FINISH
  - 32. CONCRETE FINISH
  - 33. CONCRETE FINISH
  - 34. CONCRETE FINISH
  - 35. CONCRETE FINISH
  - 36. CONCRETE FINISH
  - 37. CONCRETE FINISH
  - 38. CONCRETE FINISH
  - 39. CONCRETE FINISH
  - 40. CONCRETE FINISH
  - 41. CONCRETE FINISH
  - 42. CONCRETE FINISH
  - 43. CONCRETE FINISH
  - 44. CONCRETE FINISH
  - 45. CONCRETE FINISH
  - 46. CONCRETE FINISH
  - 47. CONCRETE FINISH
  - 48. CONCRETE FINISH
  - 49. CONCRETE FINISH
  - 50. CONCRETE FINISH

**LEGEND**

EXISTING

PROPOSED

CONSTRUCTION NOTES

SCALE: 1" = 30'

DATE: 01/15/2015

PROJECT: THE DELANEY AT PARKWAY LAKES

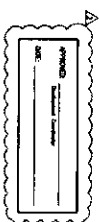

**THE DELANEY AT PARKWAY LAKES**  
 CIVIL SITE LAYOUT PLAN  
 C2.0

**ISSUED FOR CONSTRUCTION**  
 JANUARY 29, 2015

**THE DELANEY AT PARKWAY LAKES**  
 21700 BELLAIRE BOULEVARD  
 RICHMOND, TX 77407  
 PRDG PROJECT# 14040

**WALTER P MOORE**  
 ARCHITECT

**LCS DEVELOPMENT**

**PRDG**

# THE DELANEY™ AT PARKWAY LAKES

## KATY, TX

SEPTEMBER 29, 2015  
 PROJECT # 14040  
 ISSUED FOR PERMIT

<b>FACILITY</b>	<b>OWNER</b>	<b>DEVELOPER</b>	<b>ARCHITECT</b>	<b>INTERIOR DESIGN</b>	<b>STRUCTURAL</b>	<b>MEP</b>	<b>CIVIL</b>	<b>LANDSCAPE</b>	<b>KITCHEN</b>	<b>LOW VOLTAGE</b>
THE DELANEY AT PARKWAY LAKES 40117A	LETT CONCRETE SERVICES 40117A	LETT DEVELOPMENT 40117A	LETT 40117A	LETT 40117A	LETT 40117A	LETT 40117A	LETT 40117A	LETT 40117A	LETT 40117A	LETT 40117A

**BUILDING DATA**

PROJECT NAME: THE DELANEY AT PARKWAY LAKES  
 PROJECT ADDRESS: 21700 BELLAIRE BOULEVARD, RICHMOND, TX 77407  
 PROJECT PHONE: (713) 991-1111  
 PROJECT FAX: (713) 991-1112  
 PROJECT EMAIL: info@delaney.com  
 PROJECT WEBSITE: www.delaney.com  
 PROJECT START DATE: 08/01/15  
 PROJECT END DATE: 01/31/16  
 PROJECT STATUS: UNDER CONSTRUCTION

**UNIT ACCESSIBILITY**

UNIT ACCESSIBILITY: ALL UNITS SHALL BE ACCESSIBLE TO THE PUBLIC AND TO THE HANDICAPPED. ALL UNITS SHALL BE ACCESSIBLE TO THE PUBLIC AND TO THE HANDICAPPED. ALL UNITS SHALL BE ACCESSIBLE TO THE PUBLIC AND TO THE HANDICAPPED.

**CODE SUMMARY**

INTERNATIONAL RESIDENTIAL CODE BOOK (IRC) 2012  
 INTERNATIONAL BUILDING CODE (IBC) 2012  
 INTERNATIONAL MECHANICAL AND ELECTRICAL PLUMBING CODE (IMC) 2012  
 INTERNATIONAL FIRE CODE (IFC) 2012  
 INTERNATIONAL ENERGY EFFICIENCY CODE (IECC) 2012  
 INTERNATIONAL PLUMBING AND MECHANICAL CODE (IPMC) 2012  
 INTERNATIONAL ELECTRICAL CODE (IEC) 2012  
 INTERNATIONAL FIRE AND SAFETY CODE (IFSC) 2012  
 INTERNATIONAL SMOKE CONTROL CODE (ISCC) 2012  
 INTERNATIONAL SAFETY CODE (ISC) 2012  
 INTERNATIONAL SIGNAGE CODE (ISNC) 2012  
 INTERNATIONAL SOUND AND VIBRATION CODE (ISVC) 2012  
 INTERNATIONAL TRANSPORTATION CODE (ITC) 2012  
 INTERNATIONAL WIND-BURNING AND COLLAPSE PREVENTION CODE (IWBC) 2012  
 INTERNATIONAL WOOD PRESERVATION CODE (IWPC) 2012  
 INTERNATIONAL ZONING CODE (IZC) 2012  
 INTERNATIONAL GREEN BUILDING CODE (IGBC) 2012  
 INTERNATIONAL GREEN CONSTRUCTION CODE (IGCC) 2012  
 INTERNATIONAL GREEN LEASE CODE (IGLC) 2012  
 INTERNATIONAL GREEN MARKETING CODE (IGMC) 2012  
 INTERNATIONAL GREEN OPERATIONS CODE (IGOC) 2012  
 INTERNATIONAL GREEN REPAIR AND MAINTENANCE CODE (IGRMC) 2012  
 INTERNATIONAL GREEN RETIREMENT CODE (IGRC) 2012  
 INTERNATIONAL GREEN SUSTAINABILITY CODE (IGSC) 2012  
 INTERNATIONAL GREEN TECHNOLOGY CODE (IGTC) 2012  
 INTERNATIONAL GREEN TRAINING CODE (IGTRC) 2012  
 INTERNATIONAL GREEN WORKING CONDITIONS CODE (IGWCC) 2012  
 INTERNATIONAL GREEN WORKING PRACTICES CODE (IGWPC) 2012  
 INTERNATIONAL GREEN WORKING SAFETY CODE (IGWSC) 2012  
 INTERNATIONAL GREEN WORKING WELLNESS CODE (IGWWC) 2012  
 INTERNATIONAL GREEN WORKING WISDOM CODE (IGWWC) 2012  
 INTERNATIONAL GREEN WORKING WISDOM CODE (IGWWC) 2012

**DRAWING NUMBER KEY**

1. GENERAL  
 2. EXTERIOR  
 3. INTERIOR  
 4. MECHANICAL  
 5. ELECTRICAL  
 6. PLUMBING  
 7. CIVIL  
 8. LANDSCAPE  
 9. KITCHEN  
 10. LOW VOLTAGE

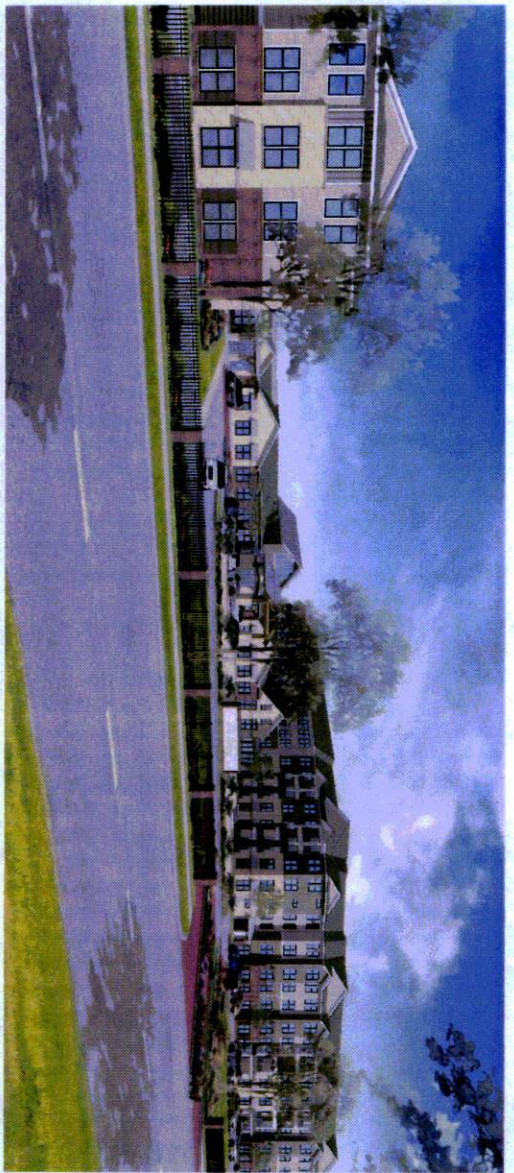

CONTRACT NO.	DESCRIPTION	DATE	BY	FOR
14040-01	PERMITTING	08/01/15	LETT	LETT
14040-02	FOUNDATION	08/01/15	LETT	LETT
14040-03	FOUNDATION	08/01/15	LETT	LETT
14040-04	FOUNDATION	08/01/15	LETT	LETT
14040-05	FOUNDATION	08/01/15	LETT	LETT
14040-06	FOUNDATION	08/01/15	LETT	LETT
14040-07	FOUNDATION	08/01/15	LETT	LETT
14040-08	FOUNDATION	08/01/15	LETT	LETT
14040-09	FOUNDATION	08/01/15	LETT	LETT
14040-10	FOUNDATION	08/01/15	LETT	LETT
14040-11	FOUNDATION	08/01/15	LETT	LETT
14040-12	FOUNDATION	08/01/15	LETT	LETT
14040-13	FOUNDATION	08/01/15	LETT	LETT
14040-14	FOUNDATION	08/01/15	LETT	LETT
14040-15	FOUNDATION	08/01/15	LETT	LETT
14040-16	FOUNDATION	08/01/15	LETT	LETT
14040-17	FOUNDATION	08/01/15	LETT	LETT
14040-18	FOUNDATION	08/01/15	LETT	LETT
14040-19	FOUNDATION	08/01/15	LETT	LETT
14040-20	FOUNDATION	08/01/15	LETT	LETT
14040-21	FOUNDATION	08/01/15	LETT	LETT
14040-22	FOUNDATION	08/01/15	LETT	LETT
14040-23	FOUNDATION	08/01/15	LETT	LETT
14040-24	FOUNDATION	08/01/15	LETT	LETT
14040-25	FOUNDATION	08/01/15	LETT	LETT
14040-26	FOUNDATION	08/01/15	LETT	LETT
14040-27	FOUNDATION	08/01/15	LETT	LETT
14040-28	FOUNDATION	08/01/15	LETT	LETT
14040-29	FOUNDATION	08/01/15	LETT	LETT
14040-30	FOUNDATION	08/01/15	LETT	LETT
14040-31	FOUNDATION	08/01/15	LETT	LETT
14040-32	FOUNDATION	08/01/15	LETT	LETT
14040-33	FOUNDATION	08/01/15	LETT	LETT
14040-34	FOUNDATION	08/01/15	LETT	LETT
14040-35	FOUNDATION	08/01/15	LETT	LETT
14040-36	FOUNDATION	08/01/15	LETT	LETT
14040-37	FOUNDATION	08/01/15	LETT	LETT
14040-38	FOUNDATION	08/01/15	LETT	LETT
14040-39	FOUNDATION	08/01/15	LETT	LETT
14040-40	FOUNDATION	08/01/15	LETT	LETT
14040-41	FOUNDATION	08/01/15	LETT	LETT
14040-42	FOUNDATION	08/01/15	LETT	LETT
14040-43	FOUNDATION	08/01/15	LETT	LETT
14040-44	FOUNDATION	08/01/15	LETT	LETT
14040-45	FOUNDATION	08/01/15	LETT	LETT
14040-46	FOUNDATION	08/01/15	LETT	LETT
14040-47	FOUNDATION	08/01/15	LETT	LETT
14040-48	FOUNDATION	08/01/15	LETT	LETT
14040-49	FOUNDATION	08/01/15	LETT	LETT
14040-50	FOUNDATION	08/01/15	LETT	LETT
14040-51	FOUNDATION	08/01/15	LETT	LETT
14040-52	FOUNDATION	08/01/15	LETT	LETT
14040-53	FOUNDATION	08/01/15	LETT	LETT
14040-54	FOUNDATION	08/01/15	LETT	LETT
14040-55	FOUNDATION	08/01/15	LETT	LETT
14040-56	FOUNDATION	08/01/15	LETT	LETT
14040-57	FOUNDATION	08/01/15	LETT	LETT
14040-58	FOUNDATION	08/01/15	LETT	LETT
14040-59	FOUNDATION	08/01/15	LETT	LETT
14040-60	FOUNDATION	08/01/15	LETT	LETT
14040-61	FOUNDATION	08/01/15	LETT	LETT
14040-62	FOUNDATION	08/01/15	LETT	LETT
14040-63	FOUNDATION	08/01/15	LETT	LETT
14040-64	FOUNDATION	08/01/15	LETT	LETT
14040-65	FOUNDATION	08/01/15	LETT	LETT
14040-66	FOUNDATION	08/01/15	LETT	LETT
14040-67	FOUNDATION	08/01/15	LETT	LETT
14040-68	FOUNDATION	08/01/15	LETT	LETT
14040-69	FOUNDATION	08/01/15	LETT	LETT
14040-70	FOUNDATION	08/01/15	LETT	LETT
14040-71	FOUNDATION	08/01/15	LETT	LETT
14040-72	FOUNDATION	08/01/15	LETT	LETT
14040-73	FOUNDATION	08/01/15	LETT	LETT
14040-74	FOUNDATION	08/01/15	LETT	LETT
14040-75	FOUNDATION	08/01/15	LETT	LETT
14040-76	FOUNDATION	08/01/15	LETT	LETT
14040-77	FOUNDATION	08/01/15	LETT	LETT
14040-78	FOUNDATION	08/01/15	LETT	LETT
14040-79	FOUNDATION	08/01/15	LETT	LETT
14040-80	FOUNDATION	08/01/15	LETT	LETT
14040-81	FOUNDATION	08/01/15	LETT	LETT
14040-82	FOUNDATION	08/01/15	LETT	LETT
14040-83	FOUNDATION	08/01/15	LETT	LETT
14040-84	FOUNDATION	08/01/15	LETT	LETT
14040-85	FOUNDATION	08/01/15	LETT	LETT
14040-86	FOUNDATION	08/01/15	LETT	LETT
14040-87	FOUNDATION	08/01/15	LETT	LETT
14040-88	FOUNDATION	08/01/15	LETT	LETT
14040-89	FOUNDATION	08/01/15	LETT	LETT
14040-90	FOUNDATION	08/01/15	LETT	LETT
14040-91	FOUNDATION	08/01/15	LETT	LETT
14040-92	FOUNDATION	08/01/15	LETT	LETT
14040-93	FOUNDATION	08/01/15	LETT	LETT
14040-94	FOUNDATION	08/01/15	LETT	LETT
14040-95	FOUNDATION	08/01/15	LETT	LETT
14040-96	FOUNDATION	08/01/15	LETT	LETT
14040-97	FOUNDATION	08/01/15	LETT	LETT
14040-98	FOUNDATION	08/01/15	LETT	LETT
14040-99	FOUNDATION	08/01/15	LETT	LETT
14040-100	FOUNDATION	08/01/15	LETT	LETT

APPROVED: *[Signature]* DATE: 09/15/15

FOR: SCOTT BRIDGES - CIVIL ENGINEER

PROJECT: THE DELANEY AT PARKWAY LAKES

DATE: 09/15/15

PROJECT: THE DELANEY AT PARKWAY LAKES

DATE: 09/15/15



**BELLAIRE BOULEVARD**  
 (25' PUBLIC ROW)  
 (FC# 20070055 F&CP)

REVISIONS TO THIS PLAN SHALL BE INDICATED BY A CIRCLED NUMBER AND A LETTER. ALL CHANGES SHALL BE MADE TO THE ORIGINAL PLAN AND THIS PLAN SHALL BE REVISED TO REFLECT SUCH CHANGES.

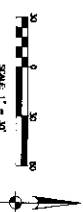

**LEGEND**

SYMBOL	DESCRIPTION
(1)	DEMOLITION BOUNDARY
(2)	EXISTING CONCRETE FOUNDATION
(3)	EXISTING CONCRETE SLAB
(4)	EXISTING CONCRETE WALL
(5)	EXISTING CONCRETE COLUMN
(6)	EXISTING CONCRETE BEAM
(7)	EXISTING CONCRETE JOIST
(8)	EXISTING CONCRETE GIRDER
(9)	EXISTING CONCRETE SLAB ON GIRDERS
(10)	EXISTING CONCRETE SLAB ON BEAMS
(11)	EXISTING CONCRETE SLAB ON WALLS
(12)	EXISTING CONCRETE SLAB ON PILES
(13)	EXISTING CONCRETE SLAB ON GRAVEL
(14)	EXISTING CONCRETE SLAB ON GRAVEL WITH CURB
(15)	EXISTING CONCRETE SLAB ON GRAVEL WITH CURB AND SIDEWALK
(16)	EXISTING CONCRETE SLAB ON GRAVEL WITH CURB AND SIDEWALK AND DRIVEWAY
(17)	EXISTING CONCRETE SLAB ON GRAVEL WITH CURB AND SIDEWALK AND DRIVEWAY AND PORCH
(18)	EXISTING CONCRETE SLAB ON GRAVEL WITH CURB AND SIDEWALK AND DRIVEWAY AND PORCH AND PATIO
(19)	EXISTING CONCRETE SLAB ON GRAVEL WITH CURB AND SIDEWALK AND DRIVEWAY AND PORCH AND PATIO AND DECK
(20)	EXISTING CONCRETE SLAB ON GRAVEL WITH CURB AND SIDEWALK AND DRIVEWAY AND PORCH AND PATIO AND DECK AND STAIRS
(21)	EXISTING CONCRETE SLAB ON GRAVEL WITH CURB AND SIDEWALK AND DRIVEWAY AND PORCH AND PATIO AND DECK AND STAIRS AND RAMP
(22)	EXISTING CONCRETE SLAB ON GRAVEL WITH CURB AND SIDEWALK AND DRIVEWAY AND PORCH AND PATIO AND DECK AND STAIRS AND RAMP AND BALCONY
(23)	EXISTING CONCRETE SLAB ON GRAVEL WITH CURB AND SIDEWALK AND DRIVEWAY AND PORCH AND PATIO AND DECK AND STAIRS AND RAMP AND BALCONY AND TERRACE
(24)	EXISTING CONCRETE SLAB ON GRAVEL WITH CURB AND SIDEWALK AND DRIVEWAY AND PORCH AND PATIO AND DECK AND STAIRS AND RAMP AND BALCONY AND TERRACE AND PORCH
(25)	EXISTING CONCRETE SLAB ON GRAVEL WITH CURB AND SIDEWALK AND DRIVEWAY AND PORCH AND PATIO AND DECK AND STAIRS AND RAMP AND BALCONY AND TERRACE AND PORCH AND PATIO
(26)	EXISTING CONCRETE SLAB ON GRAVEL WITH CURB AND SIDEWALK AND DRIVEWAY AND PORCH AND PATIO AND DECK AND STAIRS AND RAMP AND BALCONY AND TERRACE AND PORCH AND PATIO AND DRIVEWAY
(27)	EXISTING CONCRETE SLAB ON GRAVEL WITH CURB AND SIDEWALK AND DRIVEWAY AND PORCH AND PATIO AND DECK AND STAIRS AND RAMP AND BALCONY AND TERRACE AND PORCH AND PATIO AND DRIVEWAY AND PORCH
(28)	EXISTING CONCRETE SLAB ON GRAVEL WITH CURB AND SIDEWALK AND DRIVEWAY AND PORCH AND PATIO AND DECK AND STAIRS AND RAMP AND BALCONY AND TERRACE AND PORCH AND PATIO AND DRIVEWAY AND PORCH AND PATIO
(29)	EXISTING CONCRETE SLAB ON GRAVEL WITH CURB AND SIDEWALK AND DRIVEWAY AND PORCH AND PATIO AND DECK AND STAIRS AND RAMP AND BALCONY AND TERRACE AND PORCH AND PATIO AND DRIVEWAY AND PORCH AND PATIO AND DRIVEWAY
(30)	EXISTING CONCRETE SLAB ON GRAVEL WITH CURB AND SIDEWALK AND DRIVEWAY AND PORCH AND PATIO AND DECK AND STAIRS AND RAMP AND BALCONY AND TERRACE AND PORCH AND PATIO AND DRIVEWAY AND PORCH AND PATIO AND DRIVEWAY AND PORCH

**CONSTRUCTION NOTES**

1. ALL EXISTING CONCRETE FOUNDATION, 20-30" THICK, SHALL BE DEMOLISHED AND REINFORCED WITH 4" REBAR.
2. ALL EXISTING CONCRETE SLAB SHALL BE DEMOLISHED AND REINFORCED WITH 4" REBAR.
3. ALL EXISTING CONCRETE WALL SHALL BE DEMOLISHED AND REINFORCED WITH 4" REBAR.
4. ALL EXISTING CONCRETE COLUMN SHALL BE DEMOLISHED AND REINFORCED WITH 4" REBAR.
5. ALL EXISTING CONCRETE BEAM SHALL BE DEMOLISHED AND REINFORCED WITH 4" REBAR.
6. ALL EXISTING CONCRETE JOIST SHALL BE DEMOLISHED AND REINFORCED WITH 4" REBAR.
7. ALL EXISTING CONCRETE GIRDER SHALL BE DEMOLISHED AND REINFORCED WITH 4" REBAR.
8. ALL EXISTING CONCRETE SLAB ON GIRDERS SHALL BE DEMOLISHED AND REINFORCED WITH 4" REBAR.
9. ALL EXISTING CONCRETE SLAB ON BEAMS SHALL BE DEMOLISHED AND REINFORCED WITH 4" REBAR.
10. ALL EXISTING CONCRETE SLAB ON WALLS SHALL BE DEMOLISHED AND REINFORCED WITH 4" REBAR.
11. ALL EXISTING CONCRETE SLAB ON PILES SHALL BE DEMOLISHED AND REINFORCED WITH 4" REBAR.
12. ALL EXISTING CONCRETE SLAB ON GRAVEL SHALL BE DEMOLISHED AND REINFORCED WITH 4" REBAR.
13. ALL EXISTING CONCRETE SLAB ON GRAVEL WITH CURB SHALL BE DEMOLISHED AND REINFORCED WITH 4" REBAR.
14. ALL EXISTING CONCRETE SLAB ON GRAVEL WITH CURB AND SIDEWALK SHALL BE DEMOLISHED AND REINFORCED WITH 4" REBAR.
15. ALL EXISTING CONCRETE SLAB ON GRAVEL WITH CURB AND SIDEWALK AND DRIVEWAY SHALL BE DEMOLISHED AND REINFORCED WITH 4" REBAR.
16. ALL EXISTING CONCRETE SLAB ON GRAVEL WITH CURB AND SIDEWALK AND DRIVEWAY AND PORCH SHALL BE DEMOLISHED AND REINFORCED WITH 4" REBAR.
17. ALL EXISTING CONCRETE SLAB ON GRAVEL WITH CURB AND SIDEWALK AND DRIVEWAY AND PORCH AND PATIO SHALL BE DEMOLISHED AND REINFORCED WITH 4" REBAR.
18. ALL EXISTING CONCRETE SLAB ON GRAVEL WITH CURB AND SIDEWALK AND DRIVEWAY AND PORCH AND PATIO AND DECK SHALL BE DEMOLISHED AND REINFORCED WITH 4" REBAR.
19. ALL EXISTING CONCRETE SLAB ON GRAVEL WITH CURB AND SIDEWALK AND DRIVEWAY AND PORCH AND PATIO AND DECK AND STAIRS SHALL BE DEMOLISHED AND REINFORCED WITH 4" REBAR.
20. ALL EXISTING CONCRETE SLAB ON GRAVEL WITH CURB AND SIDEWALK AND DRIVEWAY AND PORCH AND PATIO AND DECK AND STAIRS AND RAMP SHALL BE DEMOLISHED AND REINFORCED WITH 4" REBAR.
21. ALL EXISTING CONCRETE SLAB ON GRAVEL WITH CURB AND SIDEWALK AND DRIVEWAY AND PORCH AND PATIO AND DECK AND STAIRS AND RAMP AND BALCONY SHALL BE DEMOLISHED AND REINFORCED WITH 4" REBAR.
22. ALL EXISTING CONCRETE SLAB ON GRAVEL WITH CURB AND SIDEWALK AND DRIVEWAY AND PORCH AND PATIO AND DECK AND STAIRS AND RAMP AND BALCONY AND TERRACE SHALL BE DEMOLISHED AND REINFORCED WITH 4" REBAR.
23. ALL EXISTING CONCRETE SLAB ON GRAVEL WITH CURB AND SIDEWALK AND DRIVEWAY AND PORCH AND PATIO AND DECK AND STAIRS AND RAMP AND BALCONY AND TERRACE AND PORCH SHALL BE DEMOLISHED AND REINFORCED WITH 4" REBAR.
24. ALL EXISTING CONCRETE SLAB ON GRAVEL WITH CURB AND SIDEWALK AND DRIVEWAY AND PORCH AND PATIO AND DECK AND STAIRS AND RAMP AND BALCONY AND TERRACE AND PORCH AND PATIO SHALL BE DEMOLISHED AND REINFORCED WITH 4" REBAR.
25. ALL EXISTING CONCRETE SLAB ON GRAVEL WITH CURB AND SIDEWALK AND DRIVEWAY AND PORCH AND PATIO AND DECK AND STAIRS AND RAMP AND BALCONY AND TERRACE AND PORCH AND PATIO AND DRIVEWAY SHALL BE DEMOLISHED AND REINFORCED WITH 4" REBAR.
26. ALL EXISTING CONCRETE SLAB ON GRAVEL WITH CURB AND SIDEWALK AND DRIVEWAY AND PORCH AND PATIO AND DECK AND STAIRS AND RAMP AND BALCONY AND TERRACE AND PORCH AND PATIO AND DRIVEWAY AND PORCH SHALL BE DEMOLISHED AND REINFORCED WITH 4" REBAR.
27. ALL EXISTING CONCRETE SLAB ON GRAVEL WITH CURB AND SIDEWALK AND DRIVEWAY AND PORCH AND PATIO AND DECK AND STAIRS AND RAMP AND BALCONY AND TERRACE AND PORCH AND PATIO AND DRIVEWAY AND PORCH AND PATIO SHALL BE DEMOLISHED AND REINFORCED WITH 4" REBAR.
28. ALL EXISTING CONCRETE SLAB ON GRAVEL WITH CURB AND SIDEWALK AND DRIVEWAY AND PORCH AND PATIO AND DECK AND STAIRS AND RAMP AND BALCONY AND TERRACE AND PORCH AND PATIO AND DRIVEWAY AND PORCH AND PATIO AND DRIVEWAY SHALL BE DEMOLISHED AND REINFORCED WITH 4" REBAR.
29. ALL EXISTING CONCRETE SLAB ON GRAVEL WITH CURB AND SIDEWALK AND DRIVEWAY AND PORCH AND PATIO AND DECK AND STAIRS AND RAMP AND BALCONY AND TERRACE AND PORCH AND PATIO AND DRIVEWAY AND PORCH AND PATIO AND DRIVEWAY AND PORCH SHALL BE DEMOLISHED AND REINFORCED WITH 4" REBAR.
30. ALL EXISTING CONCRETE SLAB ON GRAVEL WITH CURB AND SIDEWALK AND DRIVEWAY AND PORCH AND PATIO AND DECK AND STAIRS AND RAMP AND BALCONY AND TERRACE AND PORCH AND PATIO AND DRIVEWAY AND PORCH AND PATIO AND DRIVEWAY AND PORCH SHALL BE DEMOLISHED AND REINFORCED WITH 4" REBAR.

APPROVED: *[Signature]*  
 DATE: 9/20/15

**THE CIVIL SITE DEMOLITION PLAN**  
 C-1.0  
 09/20/2015

**ISSUED FOR PERMIT**  
 SEPTEMBER 20, 2015

**THE DELANEY AT PARKWAY LAKES**  
 21700 BELLAIRE BOULEVARD  
 RICHMOND, TX 77407  
 PRDG PROJECT# 14040

**WALTER P. MOORE**  
 LSS DEVELOPMENT

**PRDG**  
 PROJECT MANAGEMENT



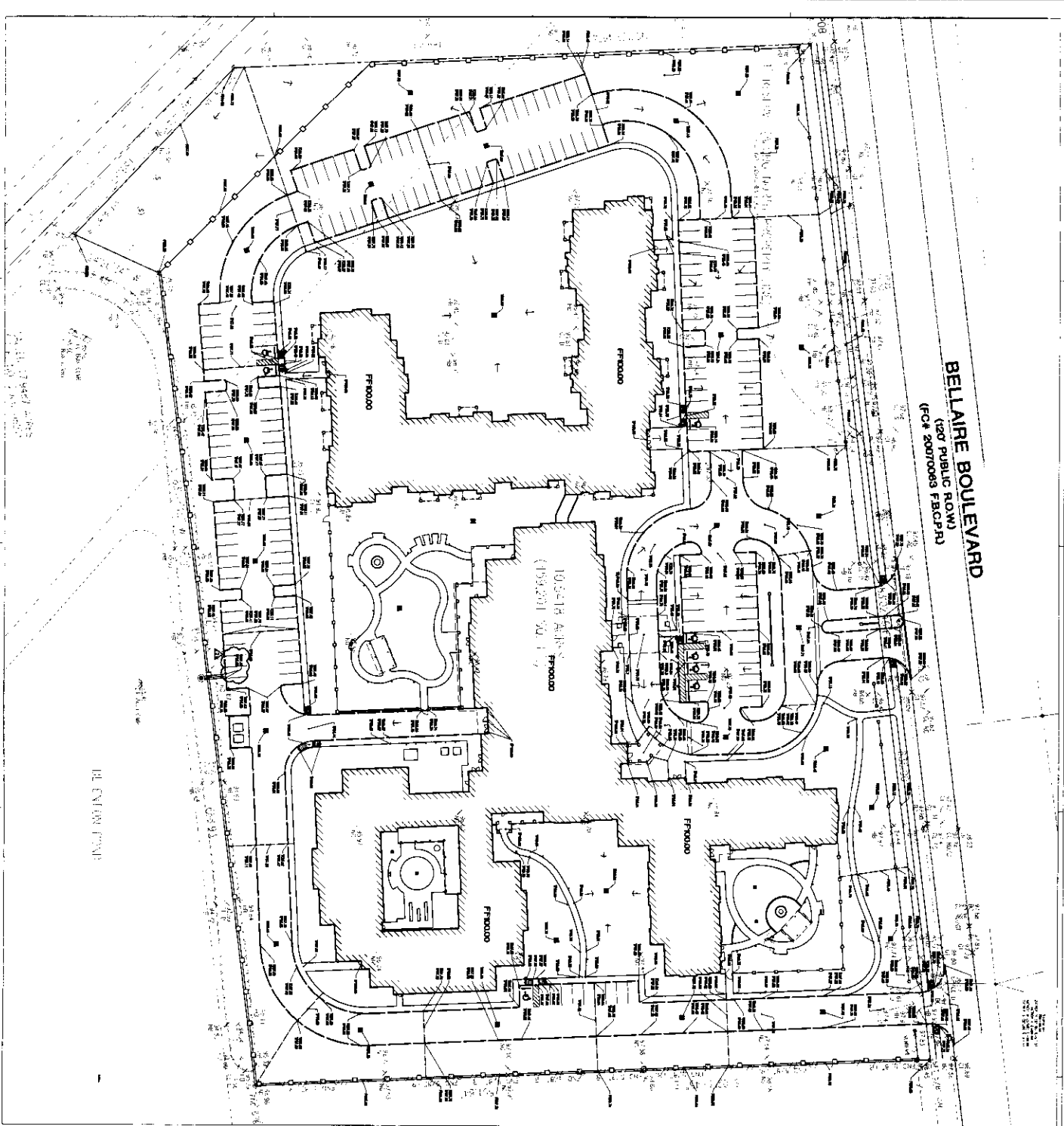

**LEGEND**

DESCRIPTION	SYMBOL	REMARKS
Edge of Footprint	(Symbol)	
Lot Line	(Symbol)	
Proposed Street	(Symbol)	
Proposed Drive	(Symbol)	
Proposed Walkway	(Symbol)	
Proposed Sidewalk	(Symbol)	
Proposed Stormwater Management	(Symbol)	
Proposed Landscaping	(Symbol)	
Proposed Utility	(Symbol)	
Proposed Elevation	(Symbol)	
Proposed Area	(Symbol)	
Proposed Feature	(Symbol)	
Proposed Detail	(Symbol)	
Proposed Note	(Symbol)	
Proposed Section	(Symbol)	
Proposed Title	(Symbol)	
Proposed Reference	(Symbol)	
Proposed Index	(Symbol)	
Proposed Detail	(Symbol)	
Proposed Note	(Symbol)	
Proposed Section	(Symbol)	
Proposed Title	(Symbol)	
Proposed Reference	(Symbol)	
Proposed Index	(Symbol)	

**CONSTRUCTION NOTES**

- FOR SHOTS SPREAD LANDSCAPE NOTES RE: LANDSCAPE PLAN

SCALE: 1" = 30'

**ISSUED FOR PERMIT**

SEPTEMBER 29, 2011

**THE DELANEY™ AT PARKWAY LAKES**

21700 BELLAIRE BOULEVARD  
RICHMOND, TX 77407

PRDG PROJECT# 14040

**WALTER P. MOORE**

REGISTERED PROFESSIONAL ENGINEER  
STATE OF TEXAS  
LICENSE NO. 12108  
EXPIRES 09/30/2015

**LDS DEVELOPMENT**

10000 W. 10TH STREET  
SUITE 100  
DALLAS, TX 75243  
TEL: 972.382.1100  
WWW.LDSDEVELOPMENT.COM

**C3.0**

CIVIL SITE GRADING PLAN

THE DELANEY™ AT PARKWAY LAKES

21700 BELLAIRE BOULEVARD  
RICHMOND, TX 77407

**PI108**











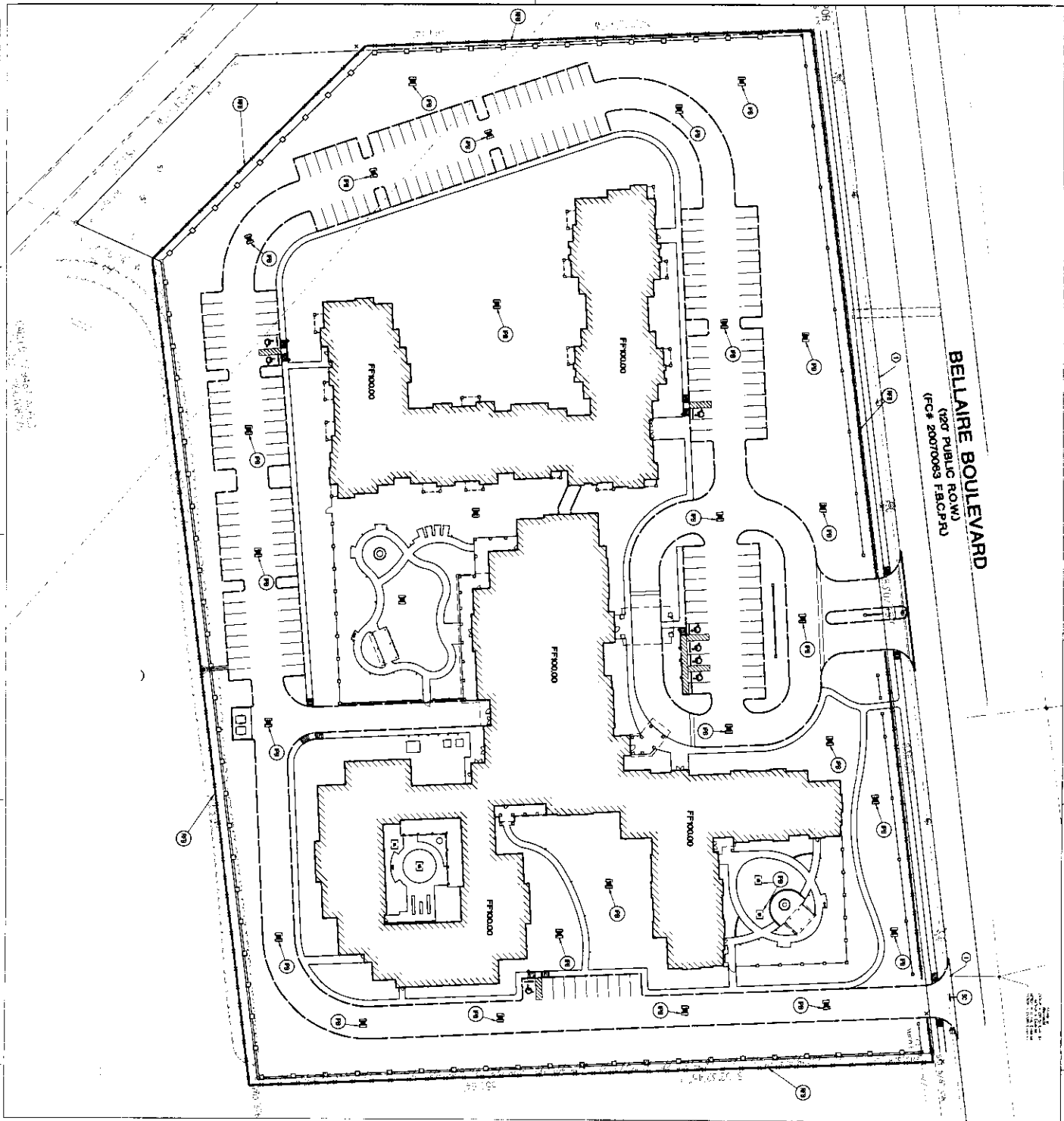

**BELLAIRE BOULEVARD**  
 (20' PUBLIC ROW)  
 (FC# 2007005 F&CP#)

**NOTES:**  
 1. SEE PLAN FOR ALL NOTES.  
 2. SEE PLAN FOR ALL NOTES.  
 3. SEE PLAN FOR ALL NOTES.

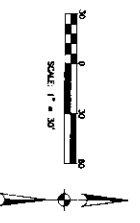

**LEGEND**

SYMBOL	DESCRIPTION
(1)	1. ALL AFFICED AREAS SHALL BE PROTECTED
(2)	2. SEWERAGE AND DESIGN CONTROL SHALL BE
(3)	3. SEE PLAN FOR ALL NOTES
(4)	4. SEE PLAN FOR ALL NOTES
(5)	5. SEE PLAN FOR ALL NOTES
(6)	6. SEE PLAN FOR ALL NOTES
(7)	7. SEE PLAN FOR ALL NOTES
(8)	8. SEE PLAN FOR ALL NOTES
(9)	9. SEE PLAN FOR ALL NOTES
(10)	10. SEE PLAN FOR ALL NOTES
(11)	11. SEE PLAN FOR ALL NOTES
(12)	12. SEE PLAN FOR ALL NOTES
(13)	13. SEE PLAN FOR ALL NOTES
(14)	14. SEE PLAN FOR ALL NOTES
(15)	15. SEE PLAN FOR ALL NOTES
(16)	16. SEE PLAN FOR ALL NOTES
(17)	17. SEE PLAN FOR ALL NOTES
(18)	18. SEE PLAN FOR ALL NOTES
(19)	19. SEE PLAN FOR ALL NOTES
(20)	20. SEE PLAN FOR ALL NOTES
(21)	21. SEE PLAN FOR ALL NOTES
(22)	22. SEE PLAN FOR ALL NOTES
(23)	23. SEE PLAN FOR ALL NOTES
(24)	24. SEE PLAN FOR ALL NOTES
(25)	25. SEE PLAN FOR ALL NOTES
(26)	26. SEE PLAN FOR ALL NOTES
(27)	27. SEE PLAN FOR ALL NOTES
(28)	28. SEE PLAN FOR ALL NOTES
(29)	29. SEE PLAN FOR ALL NOTES
(30)	30. SEE PLAN FOR ALL NOTES
(31)	31. SEE PLAN FOR ALL NOTES
(32)	32. SEE PLAN FOR ALL NOTES
(33)	33. SEE PLAN FOR ALL NOTES
(34)	34. SEE PLAN FOR ALL NOTES
(35)	35. SEE PLAN FOR ALL NOTES
(36)	36. SEE PLAN FOR ALL NOTES
(37)	37. SEE PLAN FOR ALL NOTES
(38)	38. SEE PLAN FOR ALL NOTES
(39)	39. SEE PLAN FOR ALL NOTES
(40)	40. SEE PLAN FOR ALL NOTES
(41)	41. SEE PLAN FOR ALL NOTES
(42)	42. SEE PLAN FOR ALL NOTES
(43)	43. SEE PLAN FOR ALL NOTES
(44)	44. SEE PLAN FOR ALL NOTES
(45)	45. SEE PLAN FOR ALL NOTES
(46)	46. SEE PLAN FOR ALL NOTES
(47)	47. SEE PLAN FOR ALL NOTES
(48)	48. SEE PLAN FOR ALL NOTES
(49)	49. SEE PLAN FOR ALL NOTES
(50)	50. SEE PLAN FOR ALL NOTES

**CONSTRUCTION NOTES**

- (1) NET PAVEMENT BINDER
- (2) REINFORCED FIBER FABRIC
- (3) STABILIZED COMBINATION DET
- (4) CURB W/LET FUNCTION BARRIS

**NOTES**

1. ALL AFFICED AREAS SHALL BE PROTECTED
2. SEWERAGE AND DESIGN CONTROL SHALL BE
3. SEE PLAN FOR ALL NOTES
4. SEE PLAN FOR ALL NOTES

APPROVAL:   
 DATE: 09/28/10

**WALTER P. MOORE**  
 CIVIL SITE  
 SMPPP  
 C6.0

**THE DELANEY™ AT  
 PARKWAY LAKES**  
 21700 BELLAIRES BOULEVARD  
 RICHMOND, TX 77407  
 PRDG PROJECT# 14040

**ISSUED FOR  
 PERMIT**  
 SEPTEMBER 28, 2010



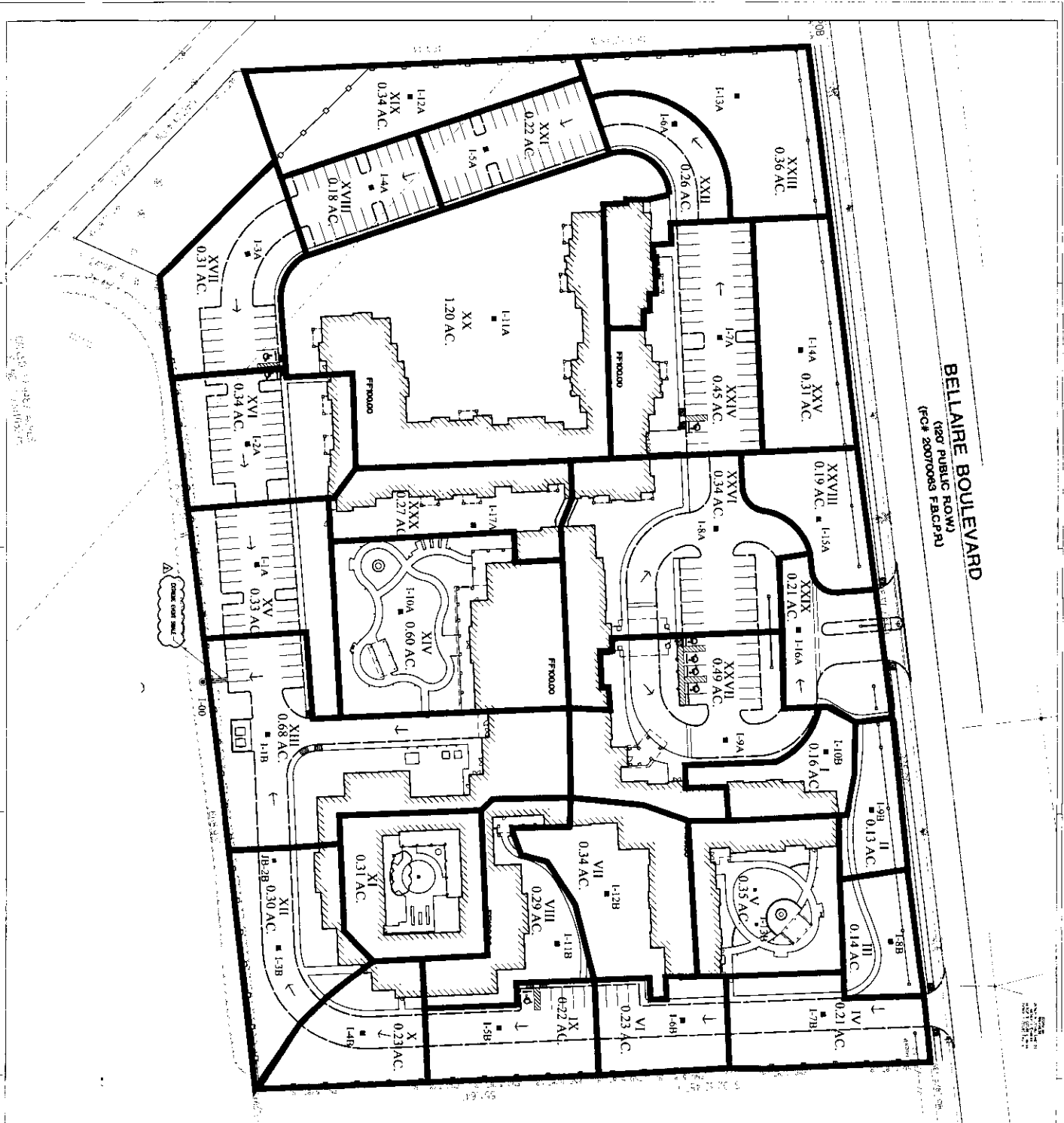

**BELLAIRE BOULEVARD**  
 (20' PUBLIC ROW)  
 (FCH 20070005 FCHPDR)

**LEGEND**

**EXISTING**

- Centerline of Roadway
- Edge of Pavement
- Centerline of Utility
- Centerline of Storm Sewer
- Centerline of Sewer
- Centerline of Gas
- Centerline of Water
- Centerline of Telephone
- Centerline of Cable
- Centerline of Electric
- Centerline of Gas
- Centerline of Water
- Centerline of Telephone
- Centerline of Cable
- Centerline of Electric

**PROPOSED**

- Proposed Building Footprint
- Proposed Parking
- Proposed Driveway
- Proposed Storm Sewer
- Proposed Sewer
- Proposed Gas
- Proposed Water
- Proposed Telephone
- Proposed Cable
- Proposed Electric

**NOTES**

1. See Sheet P-1400-00-02
2. See Sheet P-1400-00-03
3. See Sheet P-1400-00-04
4. See Sheet P-1400-00-05
5. See Sheet P-1400-00-06
6. See Sheet P-1400-00-07
7. See Sheet P-1400-00-08
8. See Sheet P-1400-00-09
9. See Sheet P-1400-00-10
10. See Sheet P-1400-00-11
11. See Sheet P-1400-00-12
12. See Sheet P-1400-00-13
13. See Sheet P-1400-00-14
14. See Sheet P-1400-00-15
15. See Sheet P-1400-00-16
16. See Sheet P-1400-00-17
17. See Sheet P-1400-00-18
18. See Sheet P-1400-00-19
19. See Sheet P-1400-00-20
20. See Sheet P-1400-00-21
21. See Sheet P-1400-00-22
22. See Sheet P-1400-00-23
23. See Sheet P-1400-00-24
24. See Sheet P-1400-00-25
25. See Sheet P-1400-00-26
26. See Sheet P-1400-00-27
27. See Sheet P-1400-00-28
28. See Sheet P-1400-00-29
29. See Sheet P-1400-00-30
30. See Sheet P-1400-00-31
31. See Sheet P-1400-00-32
32. See Sheet P-1400-00-33
33. See Sheet P-1400-00-34
34. See Sheet P-1400-00-35
35. See Sheet P-1400-00-36
36. See Sheet P-1400-00-37
37. See Sheet P-1400-00-38
38. See Sheet P-1400-00-39
39. See Sheet P-1400-00-40
40. See Sheet P-1400-00-41
41. See Sheet P-1400-00-42
42. See Sheet P-1400-00-43
43. See Sheet P-1400-00-44
44. See Sheet P-1400-00-45
45. See Sheet P-1400-00-46
46. See Sheet P-1400-00-47
47. See Sheet P-1400-00-48
48. See Sheet P-1400-00-49
49. See Sheet P-1400-00-50
50. See Sheet P-1400-00-51
51. See Sheet P-1400-00-52
52. See Sheet P-1400-00-53
53. See Sheet P-1400-00-54
54. See Sheet P-1400-00-55
55. See Sheet P-1400-00-56
56. See Sheet P-1400-00-57
57. See Sheet P-1400-00-58
58. See Sheet P-1400-00-59
59. See Sheet P-1400-00-60
60. See Sheet P-1400-00-61
61. See Sheet P-1400-00-62
62. See Sheet P-1400-00-63
63. See Sheet P-1400-00-64
64. See Sheet P-1400-00-65
65. See Sheet P-1400-00-66
66. See Sheet P-1400-00-67
67. See Sheet P-1400-00-68
68. See Sheet P-1400-00-69
69. See Sheet P-1400-00-70
70. See Sheet P-1400-00-71
71. See Sheet P-1400-00-72
72. See Sheet P-1400-00-73
73. See Sheet P-1400-00-74
74. See Sheet P-1400-00-75
75. See Sheet P-1400-00-76
76. See Sheet P-1400-00-77
77. See Sheet P-1400-00-78
78. See Sheet P-1400-00-79
79. See Sheet P-1400-00-80
80. See Sheet P-1400-00-81
81. See Sheet P-1400-00-82
82. See Sheet P-1400-00-83
83. See Sheet P-1400-00-84
84. See Sheet P-1400-00-85
85. See Sheet P-1400-00-86
86. See Sheet P-1400-00-87
87. See Sheet P-1400-00-88
88. See Sheet P-1400-00-89
89. See Sheet P-1400-00-90
90. See Sheet P-1400-00-91
91. See Sheet P-1400-00-92
92. See Sheet P-1400-00-93
93. See Sheet P-1400-00-94
94. See Sheet P-1400-00-95
95. See Sheet P-1400-00-96
96. See Sheet P-1400-00-97
97. See Sheet P-1400-00-98
98. See Sheet P-1400-00-99
99. See Sheet P-1400-00-100

**THE DELANEY AT PARKWAY LAKES**

21700 BELLAIRE BOULEVARD  
 RICHMOND, TX 77407

PRDG PROJECT# 14040

**ISSUED FOR PERMIT**

SEPTEMBER 29, 2015

**WALTER P. MOORE**

REGISTERED PROFESSIONAL ENGINEER  
 STATE OF TEXAS  
 NO. 123456

**LOGS DEVELOPMENT**

4100 W. LOOP SOUTH  
 SUITE 1000  
 HOUSTON, TX 77056

**THE CIVIL SITE DRAINAGE MAP**

Scale: 1" = 100'

**C7.0**

NOTE:  
 1. ALL ELEVATIONS ARE IN FEET UNLESS OTHERWISE NOTED.  
 2. ALL DISTANCES ARE IN FEET UNLESS OTHERWISE NOTED.  
 3. ALL ANGLES ARE IN DEGREES UNLESS OTHERWISE NOTED.

LINE NO.	LINE TYPE	LINE LENGTH (FT)	LINE AREA (ACRES)	SUM OF AREA (ACRES)	C/A	SUM OF C/A	INTENSITY (IN/HR)	VOLUME (CU FT)	DEPTH (IN)	REACH (FEET)	REACH (FEET)	WATER SCOPE (%)	MANHOLE NO.	DESIGN FLOW (MGD)	FALL (FT)	FLOWLINE ELEVATION (FEET)	DOWNSTREAM ELEVATION (FEET)	V/S	ACTUAL V (FT/S)	PROPOSED GRADIENT (%)	CHANGE IN HEAD (FEET)	ELEVATION OF HYDRAULIC GRADIENT (FEET)	ELEVATION OF GROUND (FEET)	
1-100	1-100	6941	0.16	0.16	0.13	0.13	3.81	22.24	0.36	60.5	10	0.36	0.013	1.00	3.01	96.00	95.66	0.30	2.66	0.508	0.308	96.00	97.06	96.82
1-101	1-101	5803	0.13	0.29	0.26	0.23	3.58	22.63	0.60	108.2	10	0.56	0.013	3.01	0.81	95.66	94.60	0.42	3.02	0.500	0.608	95.66	97.06	96.30
1-102	1-102	5806	0.14	0.42	0.41	0.34	3.53	23.23	0.42	92	10	0.36	0.013	3.01	0.46	95.08	94.60	0.53	3.38	0.500	0.459	95.08	96.80	96.06
1-103	1-103	14246	0.33	0.35	0.28	0.22	3.81	22.24	0.39	92	12	0.50	0.013	3.51	0.50	95.25	94.70	0.68	3.82	0.600	0.502	95.15	96.80	96.38
1-104	1-104	4234	0.21	0.86	0.17	0.79	3.50	23.64	0.54	115.3	15	0.40	0.013	3.33	0.46	94.80	94.13	0.78	3.86	0.400	0.461	94.80	96.13	95.81
1-105	1-105	9997	0.23	1.22	0.18	0.96	3.46	24.18	0.70	150	18	0.30	0.013	3.32	0.53	94.13	93.61	0.78	3.59	0.300	0.525	94.13	95.81	95.48
1-106	1-106	14889	0.34	0.34	0.27	0.27	3.53	23.28	0.28	57.2	10	0.70	0.013	3.36	0.25	94.20	94.20	0.43	3.41	0.701	0.401	94.20	96.00	95.75
1-107	1-107	12688	0.29	0.83	0.23	0.50	3.51	23.57	0.36	84	12	0.65	0.013	3.66	0.25	94.20	93.65	0.57	3.85	0.600	0.546	94.16	95.61	95.46
1-108	1-108	8211	0.22	2.07	0.18	1.88	3.42	24.06	0.47	111.7	14	0.35	0.013	3.52	0.36	93.61	93.22	1.12	3.88	0.300	0.361	93.61	95.22	94.86
1-109	1-109	15008	0.23	2.31	0.19	1.95	3.35	24.54	0.58	99.7	13	0.40	0.013	3.26	0.36	93.22	92.68	1.18	4.27	0.400	0.392	93.22	94.42	94.44
1-110	1-110	15016	0.23	2.51	0.24	2.06	3.26	24.73	0.58	71.1	24	0.20	0.013	3.22	0.14	92.68	92.68	1.27	3.48	0.200	0.142	92.68	94.68	94.25
1-111	1-111	15016	0.24	2.82	0.23	2.33	3.25	25.02	0.48	72.3	24	0.20	0.013	3.22	0.21	92.68	92.68	1.32	3.85	0.200	0.205	92.68	94.68	94.25
1-112	1-112	15016	0.24	2.89	0.24	2.06	3.20	25.30	0.17	80.9	24	1.30	0.013	7.20	0.98	92.68	92.68	0.90	6.89	1.000	0.805	92.68	94.25	94.25
1-113	1-113	21385	0.48	0.48	0.39	0.30	3.48	23.82	0.48	172	12	0.48	0.013	3.14	0.63	92.68	92.92	0.53	3.22	0.400	0.505	92.72	95.80	95.31
1-114	1-114	9115	0.21	0.21	0.17	0.17	3.48	22.58	0.57	105.6	8	0.35	0.013	3.00	0.80	92.72	92.92	0.36	3.10	0.150	0.600	92.72	95.80	95.31
1-115	1-115	8215	0.18	0.19	0.15	0.15	3.59	22.47	0.42	64.3	8	0.00	0.013	3.46	0.84	92.72	92.92	0.32	3.89	1.000	0.643	92.72	95.80	95.31
1-116	1-116	28845	0.61	1.50	0.46	1.20	3.49	23.52	0.75	155.6	18	0.28	0.013	3.15	0.44	92.92	92.48	0.97	3.46	0.280	0.404	92.80	94.31	93.34
1-117	1-117	13208	0.31	0.31	0.24	0.24	3.54	23.12	0.30	68.9	8	1.00	0.013	3.46	0.67	92.48	93.18	0.42	3.78	1.001	0.670	93.13	94.46	93.35
1-118	1-118	18773	0.45	2.28	0.36	1.81	3.44	24.57	0.70	178.5	18	0.40	0.013	3.26	0.71	92.48	91.77	1.15	4.27	0.400	0.274	92.48	93.74	93.15
1-119	1-119	18773	0.36	0.36	0.29	0.29	3.52	23.37	0.31	58.9	12	0.50	0.013	3.21	0.28	92.20	92.32	0.44	3.04	0.500	0.279	92.32	93.74	93.15
1-120	1-120	18773	0.36	0.36	0.29	0.29	3.52	23.37	0.31	58.9	12	0.50	0.013	3.21	0.28	92.20	92.32	0.44	3.04	0.500	0.279	92.32	93.74	93.15
1-121	1-121	18773	0.36	0.36	0.29	0.29	3.52	23.37	0.31	58.9	12	0.50	0.013	3.21	0.28	92.20	92.32	0.44	3.04	0.500	0.279	92.32	93.74	93.15
1-122	1-122	18773	0.36	0.36	0.29	0.29	3.52	23.37	0.31	58.9	12	0.50	0.013	3.21	0.28	92.20	92.32	0.44	3.04	0.500	0.279	92.32	93.74	93.15
1-123	1-123	18773	0.36	0.36	0.29	0.29	3.52	23.37	0.31	58.9	12	0.50	0.013	3.21	0.28	92.20	92.32	0.44	3.04	0.500	0.279	92.32	93.74	93.15
1-124	1-124	18773	0.36	0.36	0.29	0.29	3.52	23.37	0.31	58.9	12	0.50	0.013	3.21	0.28	92.20	92.32	0.44	3.04	0.500	0.279	92.32	93.74	93.15
1-125	1-125	18773	0.36	0.36	0.29	0.29	3.52	23.37	0.31	58.9	12	0.50	0.013	3.21	0.28	92.20	92.32	0.44	3.04	0.500	0.279	92.32	93.74	93.15
1-126	1-126	18773	0.36	0.36	0.29	0.29	3.52	23.37	0.31	58.9	12	0.50	0.013	3.21	0.28	92.20	92.32	0.44	3.04	0.500	0.279	92.32	93.74	93.15
1-127	1-127	18773	0.36	0.36	0.29	0.29	3.52	23.37	0.31	58.9	12	0.50	0.013	3.21	0.28	92.20	92.32	0.44	3.04	0.500	0.279	92.32	93.74	93.15
1-128	1-128	18773	0.36	0.36	0.29	0.29	3.52	23.37	0.31	58.9	12	0.50	0.013	3.21	0.28	92.20	92.32	0.44	3.04	0.500	0.279	92.32	93.74	93.15
1-129	1-129	18773	0.36	0.36	0.29	0.29	3.52	23.37	0.31	58.9	12	0.50	0.013	3.21	0.28	92.20	92.32	0.44	3.04	0.500	0.279	92.32	93.74	93.15
1-130	1-130	18773	0.36	0.36	0.29	0.29	3.52	23.37	0.31	58.9	12	0.50	0.013	3.21	0.28	92.20	92.32	0.44	3.04	0.500	0.279	92.32	93.74	93.15
1-131	1-131	18773	0.36	0.36	0.29	0.29	3.52	23.37	0.31	58.9	12	0.50	0.013	3.21	0.28	92.20	92.32	0.44	3.04	0.500	0.279	92.32	93.74	93.15
1-132	1-132	18773	0.36	0.36	0.29	0.29	3.52	23.37	0.31	58.9	12	0.50	0.013	3.21	0.28	92.20	92.32	0.44	3.04	0.500	0.279	92.32	93.74	93.15
1-133	1-133	18773	0.36	0.36	0.29	0.29	3.52	23.37	0.31	58.9	12	0.50	0.013	3.21	0.28	92.20	92.32	0.44	3.04	0.500	0.279	92.32	93.74	93.15
1-134	1-134	18773	0.36	0.36	0.29	0.29	3.52	23.37	0.31	58.9	12	0.50	0.013	3.21	0.28	92.20	92.32	0.44	3.04	0.500	0.279	92.32	93.74	93.15
1-135	1-135	18773	0.36	0.36	0.29	0.29	3.52	23.37	0.31	58.9	12	0.50	0.013	3.21	0.28	92.20	92.32	0.44	3.04	0.500	0.279	92.32	93.74	93.15
1-136	1-136	18773	0.36	0.36	0.29	0.29	3.52	23.37	0.31	58.9	12	0.50	0.013	3.21	0.28	92.20	92.32	0.44	3.04	0.500	0.279	92.32	93.74	93.15
1-137	1-137	18773	0.36	0.36	0.29	0.29	3.52	23.37	0.31	58.9	12	0.50	0.013	3.21	0.28	92.20	92.32	0.44	3.04	0.500	0.279	92.32	93.74	93.15
1-138	1-138	18773	0.36	0.36	0.29	0.29	3.52	23.37	0.31	58.9	12	0.50	0.013	3.21	0.28	92.20	92.32	0.44	3.04	0.500	0.279	92.32	93.74	93.15
1-139	1-139	18773	0.36	0.36	0.29	0.29	3.52	23.37	0.31	58.9	12	0.50	0.013	3.21	0.28	92.20	92.32	0.44	3.04	0.500	0.279	92.32	93.74	93.15
1-140	1-140	18773	0.36	0.36	0.29	0.29	3.52	23.37	0.31	58.9	12	0.50	0.013	3.21	0.28	92.20	92.32	0.44	3.04	0.500	0.279	92.32	93.74	93.15
1-141	1-141	18773	0.36	0.36	0.29	0.29	3.52	23.37	0.31	58.9	12	0.50	0.013	3.21	0.28	92.20	92.32	0.44	3.04	0.500	0.279	92.32	93.74	93.15
1-142	1-142	18773	0.36	0.36	0.29	0.29	3.52	23.37	0.31	58.9	12	0.50	0.013	3.21	0.28	92.20	92.32	0.44	3.04	0.500	0.279	92.32	93.74	93.15
1-143	1-143	18773	0.36	0.36	0.29	0.29	3.52	23.37	0.31	58.9	12	0.50	0.013	3.21	0.28	92.20	92.32	0.44	3.04	0.500	0.279	92.32	93.74	93.15
1-144	1-144	18773	0.36	0.36	0.29	0.29	3.52	23.37	0.31	58.9	12	0.50	0.013											

**PERFORMANCE BOND COVERING ALL CABLE, CONDUIT AND/OR POLE LINE  
ACTIVITY IN, UNDER, ACROSS OR ALONG FORT BEND COUNTY ROAD**

AUTHORIZED

BOND NO 8239-32-60

THE STATE OF TEXAS

§

KNOW ALL MEN BY THESE PRESENTS:

COUNTY OF FORT BEND

§

THAT WE, Charles N. White Construction Company whose address is 2705 Bee Cave Road, Suite 250, Austin, TX 78746 Texas, hereinafter called the Principal, and Federal Insurance Company, a Corporation existing under and by virtue of the laws of the state of Indiana and authorized to do an indemnifying business in the state of Texas, and whose principal office is located at 15 Mountain View Road, Warren, NJ 07059, whose officer residing in the State of Texas, authorized to accept service in all suits and actions brought whining said state is John Lenheiser and Whose address is 2001 Bryan Street, Suite 3400, Dallas, TX 75201, hereinafter called the Surety, and held and firmly bound unto, Robert e. Hebert, County Judge of Fort Bend County, Texas, or his successors in office, in the full sum of Seven Thousand and No/100---- Dollars (\$7,000.00--- ) current, lawful money of the United States of America, to be paid to said Robert E. Hebert, County Judge of Fort Bend County, Texas, or his successors in office, to which payment well and truly to be made and done, we, the undersigned, bind ourselves and each of us, our heirs, executors, administrators, successors, assigns, and legal representatives, jointly and severally, by these presents.

THE CONDITION OF THIS BOND IS SUCH THAT, WHEREAS, the above bounden principal contemplates laying, constructing, maintaining and/or repairing one or more cables, conduits, and/or pole lines in, under, across and/or along roads, streets and highways, commercial driveway and median openings or modifications in the County of Fort Bend, and the State of Texas, under the jurisdiction of the Commissioners' Court of Fort Bend County, Texas, pursuant to the Commissioners' Court order adopted on the 1st day of December, A.D. 1980, recorded in Volume 13, of the Commissioners' Court Minutes of Fort Bend County, Texas, regulating same, which Commissioners' Court order is hereby referred to and made a part hereof for all purposes as though fully set out herein;

AND WHEREAS, the principal desires to provide Fort Bend County with a performance bond covering all such cable, conduit and/or pole line activity, commercial driveway and median openings or modifications;

NOW, THEREFORE, if the above bounden principal shall faithfully perform all its cable, conduit and/or pole line activity (including, but not limited to the laying, construction, maintenance and/or repair of cables, conduits and/or pole lines) in, under, across and/or along roads, streets and highways, commercial driveway and median openings or modifications in the County of Fort Bend and State of Texas, under the jurisdiction of the Commissioners Court of Fort Bend County, Texas, pursuant to and in accordance with minimum requirements and conditions of the above mentioned Commissioners' Court order set forth and specified to be by said principal done and performed, at the time and in the manner therein specified, and shall pay over and make good and reimburse Fort Bend County, all loss and damages which Fort Bend County may sustain by reason of any failure or default on the part of said principal, then this obligation shall be null and void, otherwise to remain in full force and effect.

This bond is payable at the County Courthouse in the County of Fort Bend and State of Texas.

It is understood that at any time Fort Bend County deems itself insecure under this bond, it may require further and/or additional bonds of the principal.

EXECUTED this 11th day of March, 2016.

Charles N. White Construction Company

PRINCIPAL

BY

Federal Insurance Company

SURETY

BY William D. Baldwin, Attorney in Fact



**Chubb  
Surety**

**POWER  
OF  
ATTORNEY**

**Federal Insurance Company  
Vigilant Insurance Company  
Pacific Indemnity Company**

**Attn: Surety Department  
15 Mountain View Road  
Warren, NJ 07059**

Know All by These Presents, That **FEDERAL INSURANCE COMPANY**, an Indiana corporation, **VIGILANT INSURANCE COMPANY**, a New York corporation, and **PACIFIC INDEMNITY COMPANY**, a Wisconsin corporation, do each hereby constitute and appoint **Blaine Allen, Brent Baldwin, Brock Baldwin, William D. Baldwin, Brady K. Cox and Michael B. Hill of Dallas, Texas**-----

each as their true and lawful Attorney-in-Fact to execute under such designation in their names and to affix their corporate seals to and deliver for and on their behalf as surety thereon or otherwise, bonds and undertakings and other writings obligatory in the nature thereof (other than bail bonds) given or executed in the course of business, and any instruments amending or altering the same, and consents to the modification or alteration of any instrument referred to in said bonds or obligations.  
In Witness Whereof, said **FEDERAL INSURANCE COMPANY, VIGILANT INSURANCE COMPANY, and PACIFIC INDEMNITY COMPANY** have each executed and attested these presents and affixed their corporate seals on this **14<sup>th</sup>** day of **July, 2014**.

Dawn M. Chloros, Assistant Secretary

David B. Norris, Jr., Vice President



STATE OF NEW JERSEY

ss.

County of Somerset

On this **14<sup>th</sup>** day of **July, 2014** before me, a Notary Public of New Jersey, personally came Dawn M. Chloros, to me known to be Assistant Secretary of **FEDERAL INSURANCE COMPANY, VIGILANT INSURANCE COMPANY, and PACIFIC INDEMNITY COMPANY**, the companies which executed the foregoing Power of Attorney, and the said Dawn M. Chloros, being by me duly sworn, did depose and say that she is Assistant Secretary of **FEDERAL INSURANCE COMPANY, VIGILANT INSURANCE COMPANY, and PACIFIC INDEMNITY COMPANY** and knows the corporate seals thereof, that the seals affixed to the foregoing Power of Attorney are such corporate seals and were thereto affixed by authority of the By-Laws of said Companies; and that she signed said Power of Attorney as Assistant Secretary of said Companies by like authority; and that she is acquainted with David B. Norris, Jr., and knows him to be Vice President of said Companies; and that the signature of David B. Norris, Jr., subscribed to said Power of Attorney is in the genuine handwriting of David B. Norris, Jr., and was thereto subscribed by authority of said By-Laws and in deponent's presence.

Notarial Seal



**KATHERINE J. ADELAAR  
NOTARY PUBLIC OF NEW JERSEY  
No. 2316685  
Commission Expires July 16, 2019**

  
Notary Public

**CERTIFICATION**

Extract from the By-Laws of **FEDERAL INSURANCE COMPANY, VIGILANT INSURANCE COMPANY, and PACIFIC INDEMNITY COMPANY**:

"All powers of attorney for and on behalf of the Company may and shall be executed in the name and on behalf of the Company, either by the Chairman or the President or a Vice President or an Assistant Vice President, jointly with the Secretary or an Assistant Secretary, under their respective designations. The signature of such officers may be engraved, printed or lithographed. The signature of each of the following officers: Chairman, President, any Vice President, any Assistant Vice President, any Secretary, any Assistant Secretary and the seal of the Company may be affixed by facsimile to any power of attorney or to any certificate relating thereto appointing Assistant Secretaries or Attorneys-in-Fact for purposes only of executing and attesting bonds and undertakings and other writings obligatory in the nature thereof, and any such power of attorney or certificate bearing such facsimile signature or facsimile seal shall be valid and binding upon the Company and any such power so executed and certified by such facsimile signature and facsimile seal shall be valid and binding upon the Company with respect to any bond or undertaking to which it is attached."

I, Dawn M. Chloros, Assistant Secretary of **FEDERAL INSURANCE COMPANY, VIGILANT INSURANCE COMPANY, and PACIFIC INDEMNITY COMPANY** (the "Companies") do hereby certify that

- (i) the foregoing extract of the By-Laws of the Companies is true and correct,
- (ii) the Companies are duly licensed and authorized to transact surety business in all 50 of the United States of America and the District of Columbia and are authorized by the U.S. Treasury Department; further, Federal and Vigilant are licensed in the U.S. Virgin Islands, and Federal is licensed in American Samoa, Guam, Puerto Rico, and each of the Provinces of Canada except Prince Edward Island; and
- (iii) the foregoing Power of Attorney is true, correct and in full force and effect.

Given under my hand and seals of said Companies at Warren, NJ this **11th** day of **March, 2016**

  
Dawn M. Chloros, Assistant Secretary

IN THE EVENT YOU WISH TO NOTIFY US OF A CLAIM, VERIFY THE AUTHENTICITY OF THIS BOND OR NOTIFY US OF ANY OTHER MATTER, PLEASE CONTACT US AT ADDRESS LISTED ABOVE, OR BY Telephone (908) 903-3493 Fax (908) 903-3656 e-mail: surety@chubb.com