

**REVIEW BY FORT BEND COUNTY COMMISSIONERS COURT**

On this 22nd day of March, 2016, Commissioners Court came on to be heard and reviewed the accompanying notice of AT&T Texas

Job Location Farmer Rd, Richmond, TX 77406

Date 3/1/2016 Bond No. CH1-001686693-01, Permit No. 2016-5747 to make use of certain Fort Bend County property subject to, "A Revised Order Regulating the Laying, Construction, Maintenance, and Repair of Buried Cables, Conduits, and Pole Lines, In, Under, Across or Along Roads, Streets, Highways, and Drainage Ditches in Fort Bend County, Texas, Under the Jurisdiction of the Commissioners Court of Fort Bend County, Texas," as passed by the Commissioners Court of Fort Bend County, Texas the 3rd day of August, 1987, recorded in Volume \_\_\_\_\_ of the Minutes of the Commissioners Court of Fort Bend County, Texas, to the extent that such order is not inconsistent with Article 1436a, Vernon's Texas Civil Statutes. Upon Motion of Commissioner Meyus, seconded by Commissioner Patterson, duly put and carried, it is ORDERED, ADJUDGED AND DECREED that said notice of said above purpose is hereby acknowledged by the Commissioners Court of Fort Bend County, Texas, and that said notice be placed on record according to the regulation order thereof.

Notes:

1. Evidence of review by the Commissioners Court must be kept on the job site and failure to do so constitutes grounds for job shutdown.
2. Written notices are required:
  - a. 48 hours in advance of construction start up, and
  - b. when construction is completed and ready for final inspection

Mail notices to: Permit Administrator  
Fort Bend County Engineering  
301 Jackson Street  
Richmond, Texas 77469  
281-633-7500

3. This permit expires one (1) year from date of permit if construction has not commenced.

By: Charles O. Ay  
for County Engineer

Presented to Commissioners Court and approved.

Recorded in Volume 3-22-16 144  
Minutes of Commissioners Court

By: Mark Vah  
Drainage District Engineer/Manager

Clerk of Commissioners Court

By: Jinda Willis  
Deputy





TYPICAL ROAD BORE

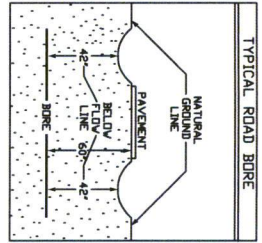

LEGEND

- B — PROPOSED BURIED FIBER
- B — EXISTING BURIED CABLE
- EDP — EDGE OF PAVEMENT/CONCRETE
- R/W — RIGHT OF WAY
- X — POWER POLE
- ⊠ — EXISTING PEDESTAL

FORT BEND COUNTY NOTIFICATION

ALTI CONTACT:  
 MIKE BRIGGS/SAFARI  
 281-341-4312

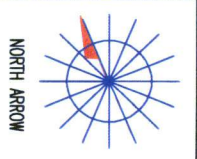

SPECIAL CIRCUITS N  
 6203 FORWARDED N  
 PERMIT REQUIRED N

OPERATING RANGE OF JOB STEPS  
 TASK \_\_\_\_\_ TO \_\_\_\_\_

MFR

TRANSMISSION ZONE  
 RZ 0 C2 0 TAPER CODE 16385

CAUTION HIGH VOLTAGE BURIED  
 KV 120

HIGHWAY PERMIT NO.

Utility CO: CN - CENTER POINT

REP NAME: REP TEL NO. POLE CONTACTS (+) (-)

Utility CO: REP NAME: REP TEL NO. POLE CONTACTS (+) (-)

Utility CO: REP NAME: REP TEL NO. POLE CONTACTS (+) (-)

PROJECT NO: A004K1

TOT. PRINTS: 42 PRINT NO. 28

NPA/NNX: 28-222 PRT: 28222

EXCH: 803-403E

TAX DIST: F0075

GEO LOC: V89322

ENGR: DRANNIV

TELEPHONE NO: (281) 341-4312

REG. REF: 232-280-34

MAP REF: 566E

SCALE: NONE

ISSUE DATE

PROJ TITLE: RT5206 D1 FBR RJT

REV. NUMBER

DATE REV.

Not for use or disclosure outside the ALTI companies except under written agreement.

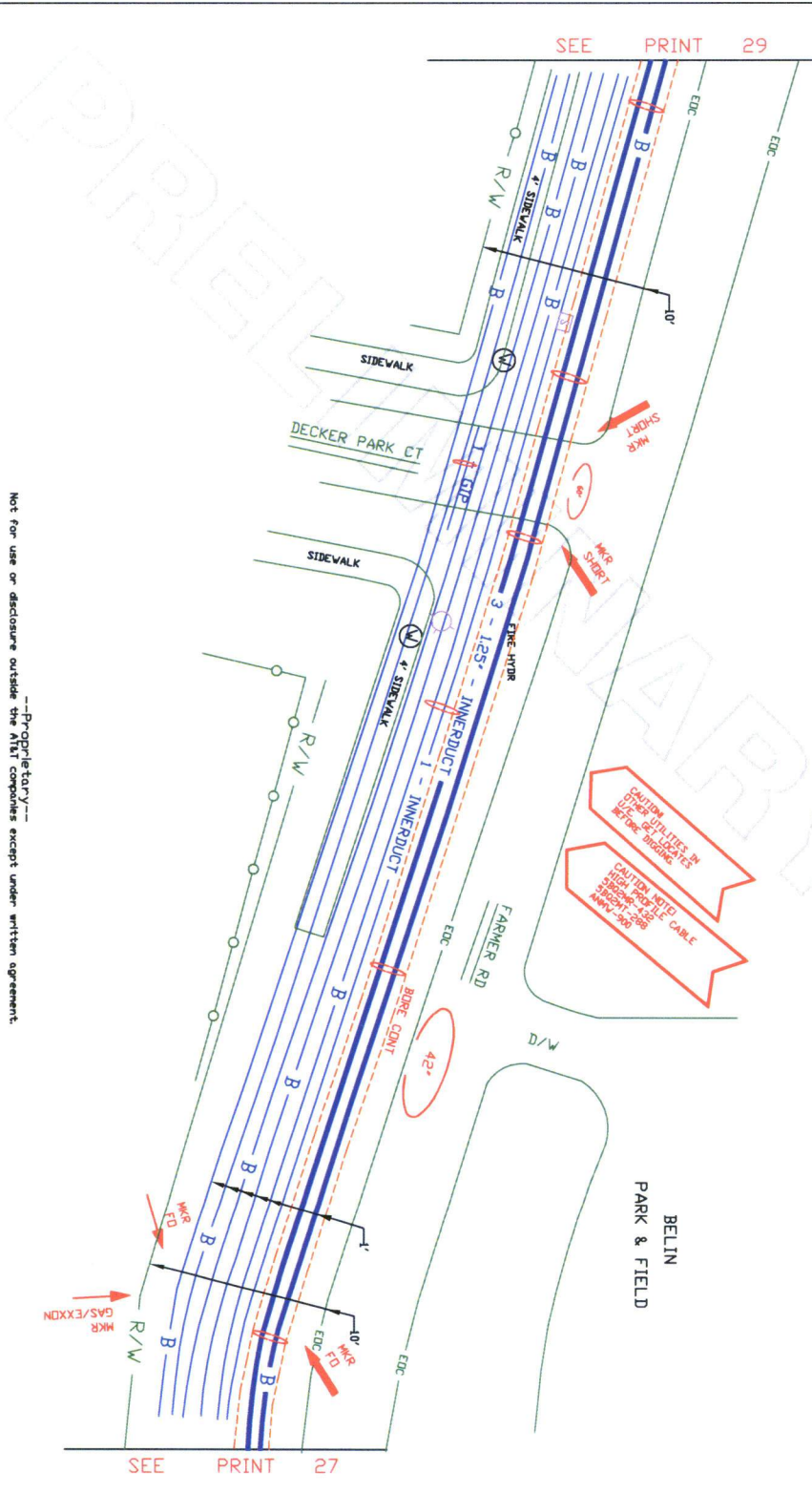

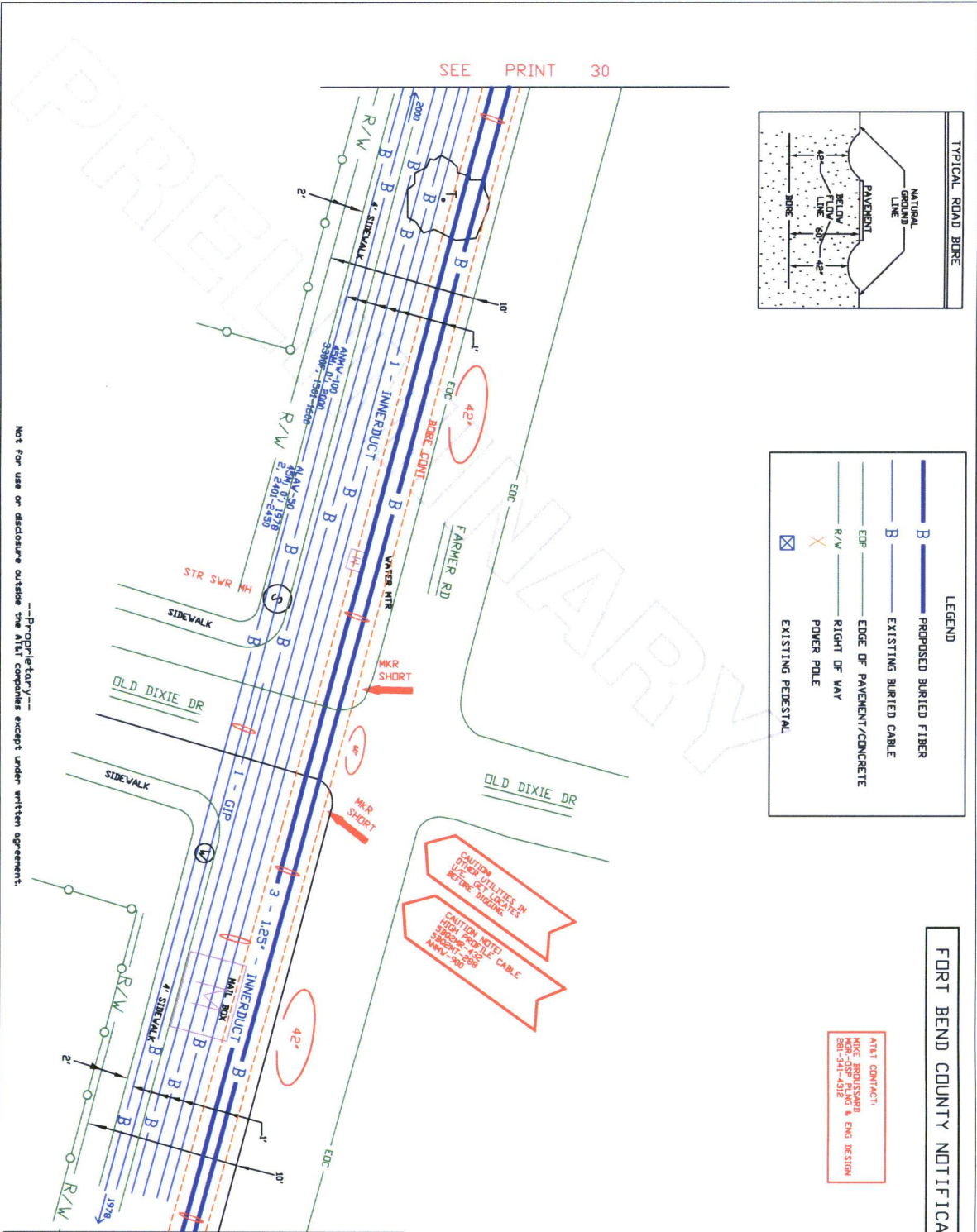

SEE PRINT 30

SEE PRINT 28

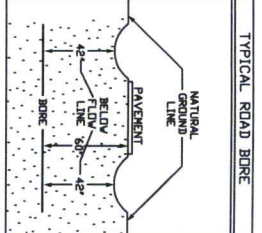

**LEGEND**

	PROPOSED BURIED FIBER
	EXISTING BURIED CABLE
	EDGE OF PAVEMENT/CONCRETE
	EDGE OF PAVEMENT/CONCRETE
	RIGHT OF WAY
	POWER POLE
	EXISTING PEDESTAL

**FORT BEND COUNTY NOTIFICATION**

AT&T CONTACT:  
MIGUE RODRIGUEZ  
PH: 341-4312

CAUTION  
CHECK UTILITIES IN  
METER DIGGING

CAUTION (SEE NOTE)  
HIGH VOLTAGE  
CABLE  
3300V  
ANNA-200

Not for use or disclosure outside the AT&T companies except under written agreement.

SPECIAL CIRCUITS	N	
6203 FORWARDED PERMIT REQUIRED	N	
OPERATING RANGE OF JOB STEPS	TASK _____ TO _____	
MFR:	TRANSMISSION ZONE	
RZ 1	CZ 0	TAPER CODE 16345
CAUTION HIGH VOLTAGE BURIED		
HIGHWAY PERMIT NO.		
UTILITY CO	CONF - CENTER POINT	
REP NAME		
REP TEL NO.		
POLE CONTACTS (+)	(-)	
UTILITY CO		
REP NAME		
REP TEL NO.		
POLE CONTACTS (+)	(-)	
UTILITY CO		
REP NAME		
REP TEL NO.		
POLE CONTACTS (+)	(-)	
<b>PROJECT NO A000401</b>		
TOT PRINTS 42	PRINT NO. 29	
NPA/NNX: 28-232	PRT: 201232	
EXCH: RICH-HDSE		
TAX DST: F6075		
GEO LOC: V89232		
ENGR. NO:	DRAWN BY	
TELEPHONE NO. (281) 341-4312		
REC. REF: 232-280-34		
MAP REF: 566E		
SCALE: N/A		
ISSUE DATE		
PROJ TITLE: 075206 D.I TRM R/L		
REV. NUMBER		
DATE REV.		

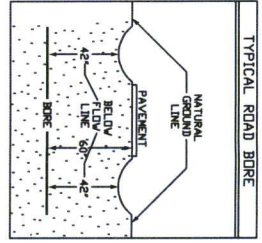

**LEGEND**

- B — PROPOSED BURIED FIBER
- B — EXISTING BURIED CABLE
- B — EDGE OF PAVEMENT/CONCRETE
- B — R/W
- B — EDP
- B — RIGHT OF WAY
- B — POWER PILE
- B — EXISTING PEDESTAL

**FORT BEND COUNTY NOTIFICATION**

ATTN CONTACT:  
 MIKE BROUSSARD  
 HIGH-VOLT PLNG & ENG DESIGN  
 681-341-4202

SPECIAL CIRCUITS N N  
 6203 FORWARDED N  
 PERMIT N N  
 REQUIRED N N

OPERATING RANGE OF JOBS STEPS  
 TASK \_\_\_\_\_ TO \_\_\_\_\_

MARC TRANSMISSION ZONE  
 RZ 0 CZ 0 TAPER CODE 16345

CAUTION HIGH VOLTAGE BURIED N  
 RY 120V PERM 1

UTILITY CO. EXN - CENTER POINT  
 REP NAME  
 REP TEL NO.  
 POLE CONTACTS (+) 0 (-) 0

UTILITY CO.  
 REP NAME  
 REP TEL NO.  
 POLE CONTACTS (+) 0 (-) 0

UTILITY CO.  
 REP NAME  
 REP TEL NO.  
 POLE CONTACTS (+) 0 (-) 0

PROJECT NO. ADVANCE

TOT PRINTS 42 PRINT NO. 30  
 NPA/NNX: 28-222 PRT: 28222  
 EXCH. RICH-RDSE  
 TAX DIST. F0075  
 GEO LOC. V09232  
 ENGR. NB DRAWN LV  
 TELEPHONE NO. (281) 341-4312  
 REC. REF. 232-280-34  
 MAP REF. 566E  
 SCALE NONE  
 ISSUE DATE  
 PROJ. TITLE RT3206 DLT FRM RJF  
 REV. NUMBER  
 DATE REV.

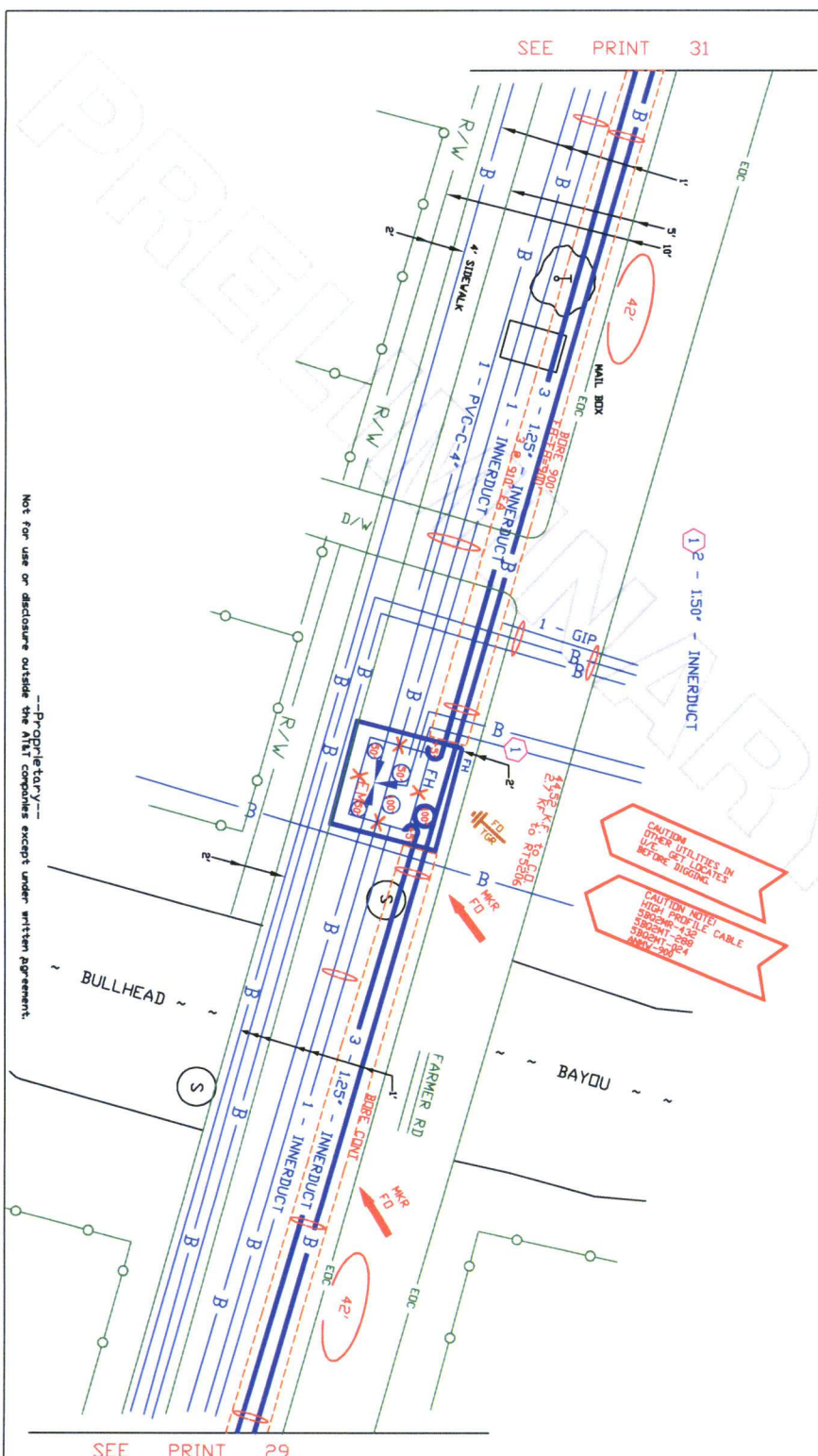

Not for use or disclosure outside the Attn companies except under written agreement.  
 --Proprietary--

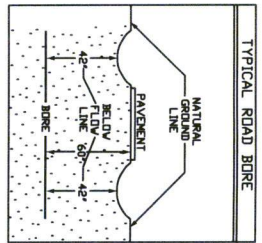
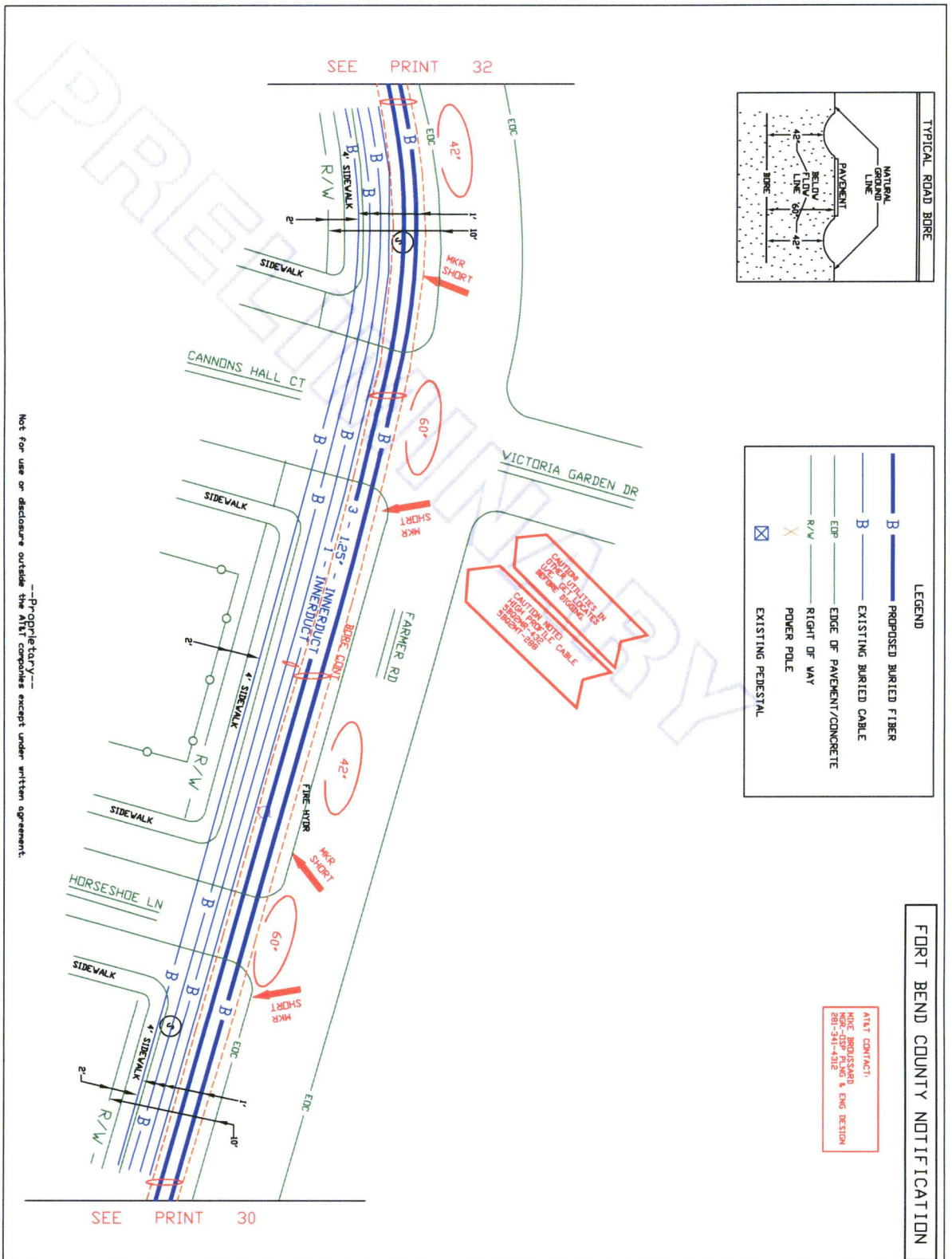

**LEGEND**

- B — PROPOSED BURIED FIBER
- B — EXISTING BURIED CABLE
- EDP — EDGE OF PAVEMENT/CONCRETE
- R/W — RIGHT OF WAY
- X — POWER POLE
- ☒ — EXISTING PEDESTAL

**FORT BEND COUNTY NOTIFICATION**

AT&T CONTRACT:  
 MDCB 8903583AB  
 MGR: GSP R/KMG & ENG DESIGN  
 890-341-4312

CAUTION: OPEN UTILITIES IN HIGH VOLTAGE AREA. SEE SHEET 5502-1-308

Not for use or disclosure outside the AT&T companies except under written agreement.

SPECIAL CIRCUITS 6203 FORWARDED PERMIT REQUIRED N N N		
OPERATING RANGE OF JOB STEPS TASK _____ TO _____ MFR:		
TRANSMISSION ZONE RZ 1 CZ 0 TAPER CODE 6385 CAUTION HIGH VOLTAGE R/V 200 MFR 1		
HIGHWAY PERMIT NO.		
Utility CO: ENVI - CONIER PDMT REP NAME: _____ REP TEL NO.: _____ POLE CONTACTS (+) 0 (-) 0		
Utility CO: REP NAME: _____ REP TEL NO.: _____ POLE CONTACTS (+) 0 (-) 0		
Utility CO: REP NAME: _____ REP TEL NO.: _____ POLE CONTACTS (+) 0 (-) 0		
<b>PROJECT NO 890341</b>		
TOT PRINTS 42 PRINT NO. 31 NPA/NNX: 28122 PRT: 28222 EXCH: RICH-HOUSE TAX DIST: F0705 GEO LOC: V89232 ENGR: MB DRAWN: JV TELEPHONE NO: (281) 341-4312 REC. REF: 232-280-34 MAP REF: 5666 SCALE: NONE ISSUE DATE: _____ PROJ TITLE: RT2036 DLT FRM RJF DATE REV: _____		

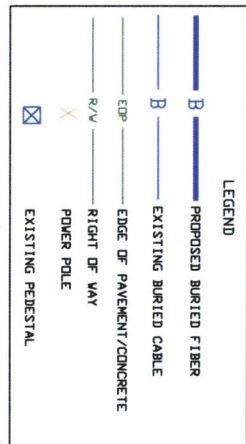
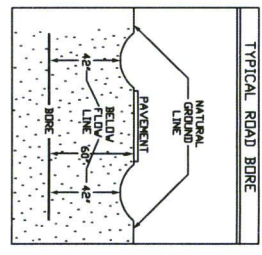

**FORT BEND COUNTY NOTIFICATION**

ATTN CONTACT:  
 MIKE BRUSSARD  
 MGR - CIP PLNG & ENG DESIGN  
 501-541-4262

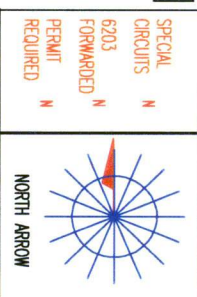

SPECIAL CIRCUITS N  
 6203 FORMWARDED N  
 PERMIT N  
 REQUIRED N

OPERATING RANGE OF JOB STEPS  
 TASK \_\_\_\_\_ TO \_\_\_\_\_

MTRC  
 TRANSMISSION ZONE  
 RZ 0 CZ 0 TAPER CODE 18885

CAUTION HIGH VOLTAGE BURIED

UTILITY CO EXN - CENTER POWER

REP NAME  
 REP TEL NO.  
 POLE CONTACTS (+) 0 (-) 0

UTILITY CO  
 REP NAME  
 REP TEL NO.  
 POLE CONTACTS (+) 0 (-) 0

UTILITY CO  
 REP NAME  
 REP TEL NO.  
 POLE CONTACTS (+) 0 (-) 0

PROJECT NO A00AKL  
 TOT PRINTS 42 PRINT NO. 32  
 NPA/NNX: 28122 PRT:28222  
 EXCH. RICH-HOSE  
 TAX DIST. F004  
 GEO LOC. V89232  
 ENGR. MB DRAWN/IV  
 TELEPHONE NO. (281) 341-4312  
 REC. REF. 232-281-34  
 MAP REF. 5666  
 SCALE NONE  
 ISSUE DATE  
 PROJ TITLE RT3206 DLT FR RLF  
 REV. NUMBER  
 DATE REV.

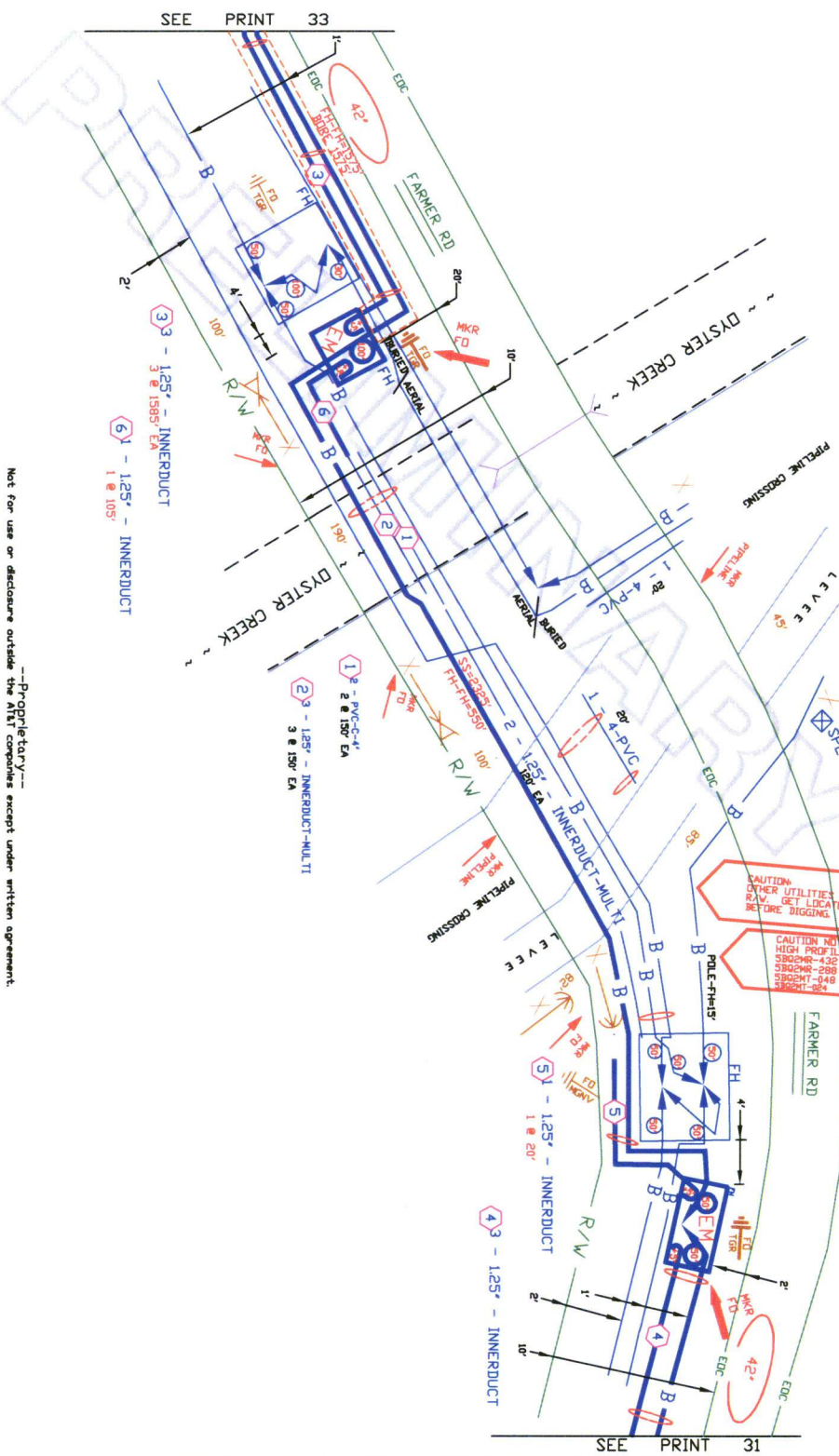

Not for use or disclosure outside the AITL companies except under written agreement.

---Proprietary---

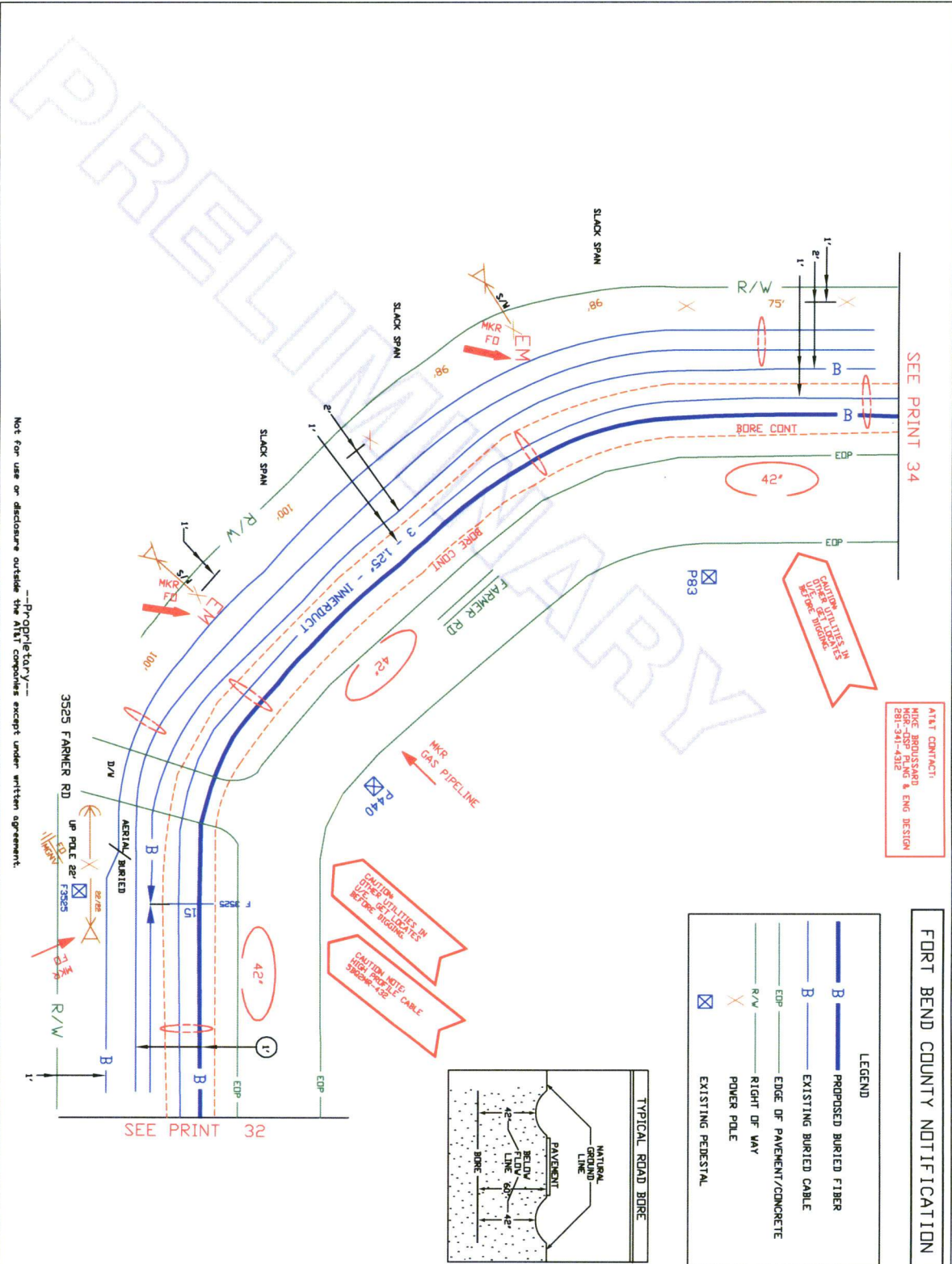

AT&T CONTRACT  
 HIGGINS BRUNSON  
 HIGGINS BRUNSON & ASSOCIATES  
 281-341-4312  
 ENG DESIGN

**FORT BEND COUNTY NOTIFICATION**

**LEGEND**

	PROPOSED BURIED FIBER
	EXISTING BURIED CABLE
	EDGE OF PAVEMENT/CONCRETE
	RIGHT OF WAY
	POWER POLE
	EXISTING PEDESTAL

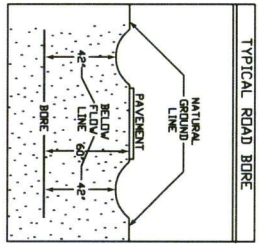

SPECIAL CIRCUITS	N	
FORWARDED PERMIT REQUIRED	N	
OPERATING RANGE OF JOB STEPS	TASK	TO
MFR:		
TRANSMISSION ZONE	RZ 0	CZ 0
CAUTION HIGH VOLTAGE BURIED	KV 13.80	APRAL 1
HIGHWAY PERMIT NO.		
UTILITY CO	ENI - CENTER POINT	
REP NAME		
REP TEL NO.		
POLE CONTRACTS (+)	0	(-) 0
UTILITY CO		
REP NAME		
REP TEL NO.		
POLE CONTRACTS (+)	0	(-) 0
PROJECT NO	ADDKXCL	
TOT PRINTS	42	PRINT NO. 33
NPA/NMX:	281-222	PRI: 281-222
EXCH:	RICH-RDCE	
TAX DIST:	F0004	
GEO LOC:	W89232	
ENGR. NO.		DRAWN BY
TELEPHONE NO. (281)	341-4312	
REC. REF.	22-280-34	
MAP REF.	566E	
SCALE	NONE	
ISSUE DATE		
PROJ TITLE	R15206 0.1 FWP RL	
REV. NUMBER		
DATE REV.		



Not for use or disclosure outside the AT&T companies except under written agreement.

**PRELIMINARY**

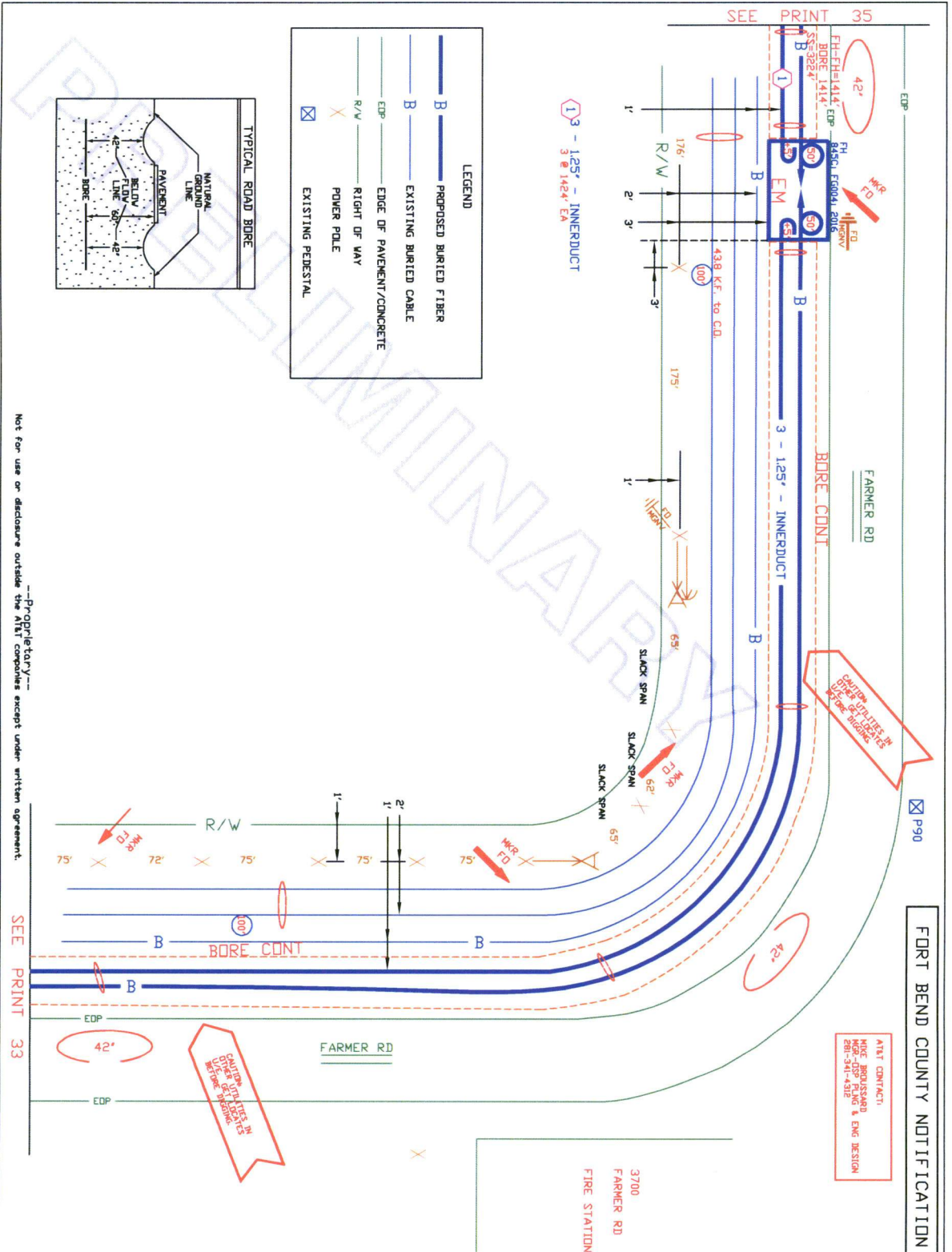

**FORT BEND COUNTY NOTIFICATION**

ATTN CONTACT:  
 HOE BOUSSABAD  
 HIGH-VOLTAGE & ENG DESIGN  
 800-341-4326

SPECIAL CIRCUITS  
 6203  
 FORWARDED PERMIT REQUIRED

OPERATING RANGE OF JOB STEPS  
 TASK \_\_\_\_\_ TO \_\_\_\_\_

MFR: \_\_\_\_\_

RZ 0 TRANSMISSION ZONE  
 CZ 0 TAPER CODE 16366

KV 00 CAUTION, HIGH VOLTAGE BURIED  
 MFRAL

HIGHWAY PERMIT NO. \_\_\_\_\_

Utility CO  
 REP NAME  
 REP TEL NO.  
 POLE CONTACTS (+) 0 (-) 0

Utility CO  
 REP NAME  
 REP TEL NO.  
 POLE CONTACTS (+) 0 (-) 0

PROJECT NO A00AKKL

TOT. PRINTS 42 PRINT NO. 34  
 NPA/NNX: 281-22 PRT: 281222  
 EXCH. RICH-RDCE  
 TAX DIST. F0004  
 GEO LOC. V89232  
 ENGR. 08 DRAWN/DV  
 TELEPHONE NO. (281) 341-4312  
 REC. REF. 222-280-34#  
 MAP REF.  
 SCALE NME  
 ISSUE DATE  
 PROJ. TITLE R15206 Q1.T.FWR.RLF  
 REV. NUMBER  
 DATE REV.

Not for use or disclosure outside the AT&T companies except under written agreement.

SEE PRINT 33

SEE PRINT 35

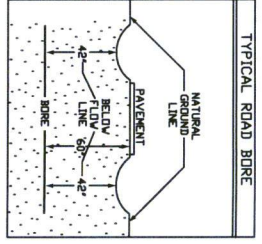

**LEGEND**

	PROPOSED BURIED FIBER
	EXISTING BURIED CABLE
	EDGE OF PAVEMENT/CONCRETE
	EDP
	R/W
	RIGHT OF WAY
	POWER POLE
	EXISTING PEDESTAL

**FORT BEND COUNTY NOTIFICATION**

AT&T CONTACT:  
 HITE BERGSSAARD  
 281-341-4312

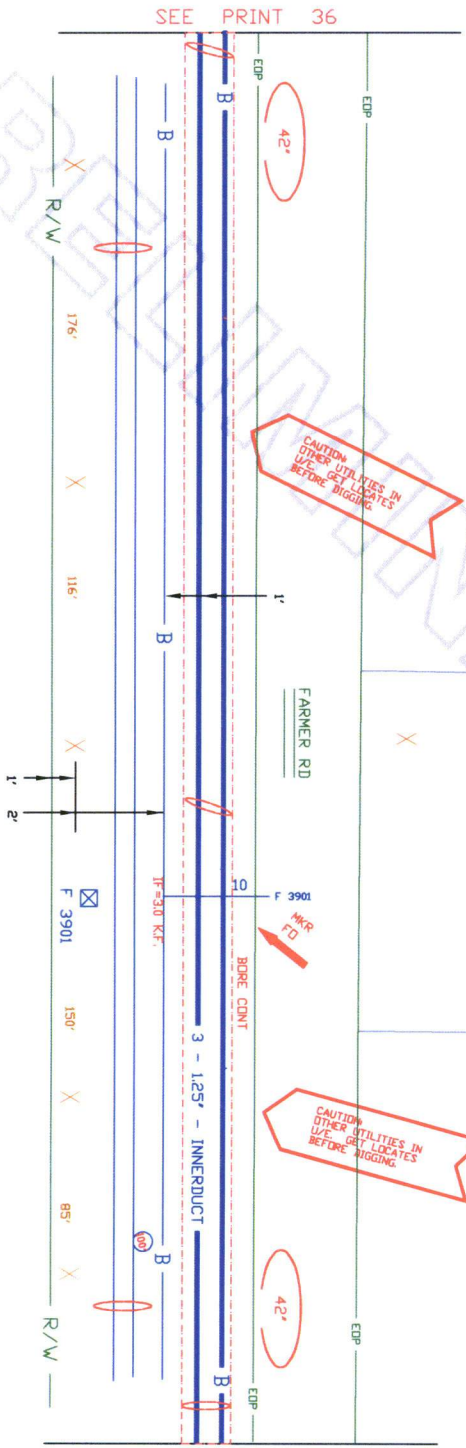

Not for use or disclosure outside the AT&T companies except under written agreement.

SPECIAL CIRCUITS N  
 6203 FORWARDED N  
 PERMIT N  
 REQUIRED N

OPERATING RANGE OF JOB STEPS  
 TASK \_\_\_\_\_ TO \_\_\_\_\_

MFR:

TRANSMISSION ZONE  
 RZ 0 CZ 0 TAPER CODE 13365

CAUTION HIGH VOLTAGE  
 BURIED

UTILITY CO: ENI - CENTER POINT  
 REP NAME: \_\_\_\_\_  
 REP TEL NO: \_\_\_\_\_  
 POLE CONTRACTS (+) 0 (-) 0

UTILITY CO: \_\_\_\_\_  
 REP NAME: \_\_\_\_\_  
 REP TEL NO: \_\_\_\_\_  
 POLE CONTRACTS (+) 0 (-) 0

PROJECT NO: A00041

TOT PRINTS: 42 PRINT NO. 35  
 NPA/NNX: 28-22 PRI: 20122  
 EXCH: RICH-RDSE  
 TAX DIST: F0004  
 GEO LOC: V09222  
 ENGR: MB DRAWN: JV  
 TELEPHONE NO: (281) 341-4312  
 REC. REF: 232-280-34  
 MAP REF: 566E  
 SCALE: NONE  
 ISSUE DATE: \_\_\_\_\_  
 PROJ TITLE: 075306 DLT FRM RLF  
 REV. NUMBER: \_\_\_\_\_  
 DATE REV.:



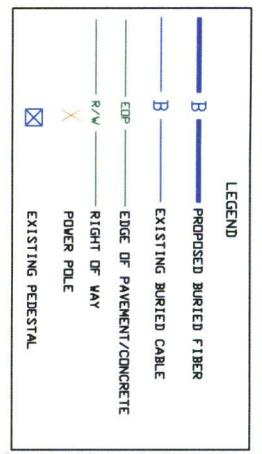
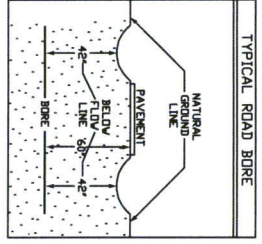

**FORT BEND COUNTY NOTIFICATION**

AT&T CONTACT:  
 HIGGINS/STASARD  
 HIGGINS/STASARD  
 281-341-4312

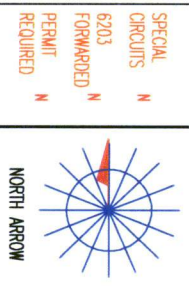

SPECIAL CIRCUITS N

6203 FORWARDED N

PERMIT REQUIRED N

OPERATING RANGE OF JOB STEPS

TASK \_\_\_\_\_ TO \_\_\_\_\_

MFR/C

RZ 0 TRANSMISSION ZONE

CZ 0 TAPER CODE 18365

KV/CM CAUTION HIGH VOLTAGE BURIED

HIGHWAY PERMIT NO.

Utility CO (311) - CENTER POINT

REP NAME

REP TEL NO.

POLE CONTACTS (+) 0 (-) 0

Utility CO

REP NAME

REP TEL NO.

POLE CONTACTS (+) 0 (-) 0

Utility CO

REP NAME

REP TEL NO.

POLE CONTACTS (+) 0 (-) 0

PROJECT NO A00AKL

TOT PRINTS 42 PRINT NO. 36

NPA/NNX: 281-222 PRT: 281222

EXCH. 803-HDCE

TAX DIST. F004

GEO LOC. V89222

ENGR. NH DRAWN/DV

TELEPHONE NO. (281) 341-4312

REC. REF. 232-200-35

MAP REF. 5664

SCALE NONE

ISSUE DATE

PROJ. TITLE RT5206 O.L.T.F.W. R.F.

REV. NUMBER

DATE REV.

Not for use or disclosure outside the AT&T companies except under written agreement.

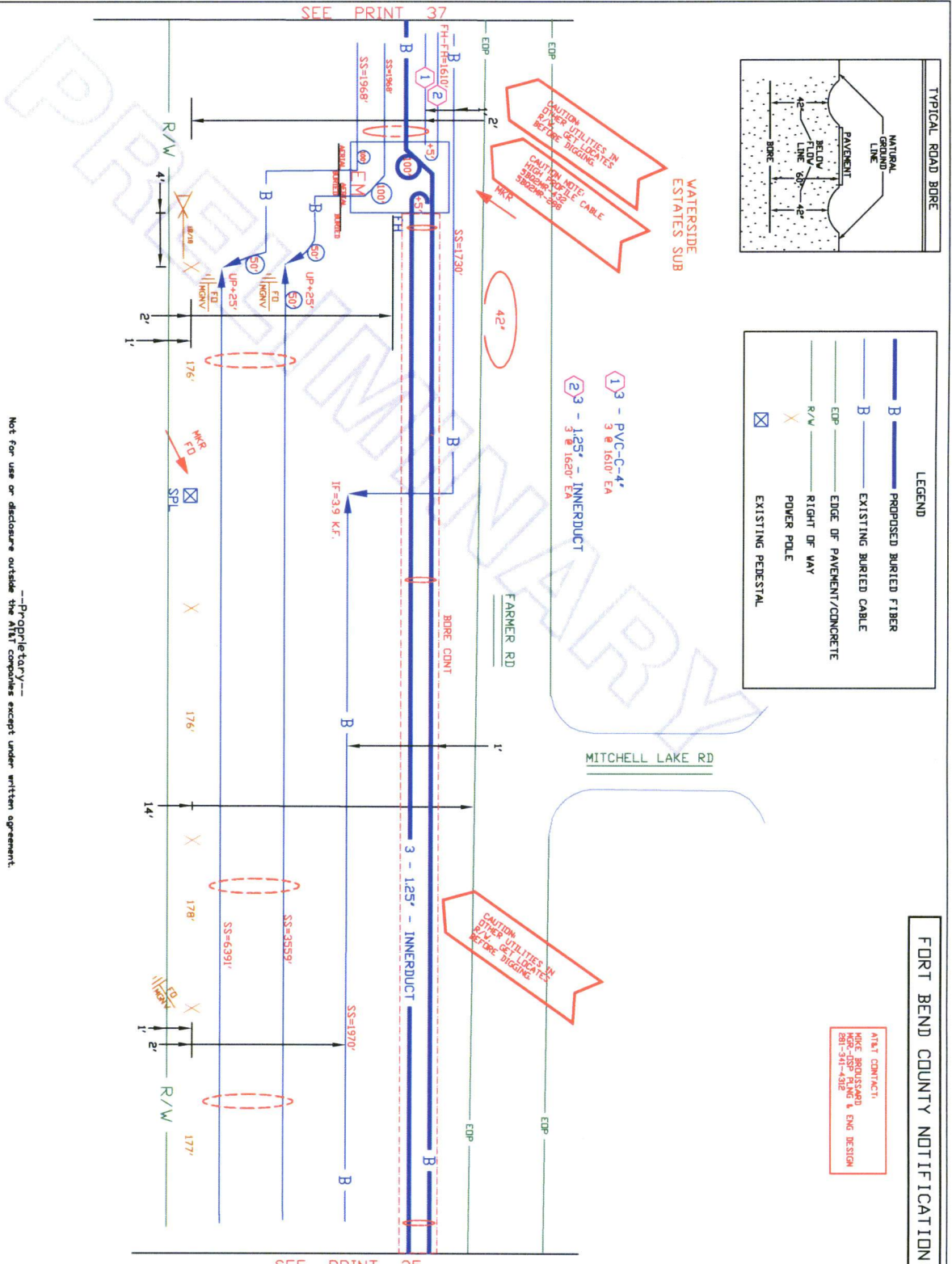

SEE PRINT 37

SEE PRINT 35

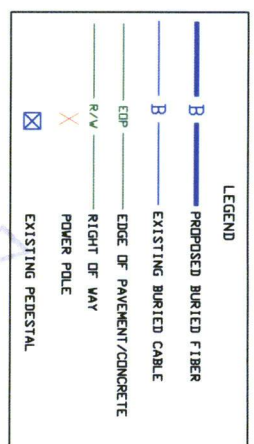
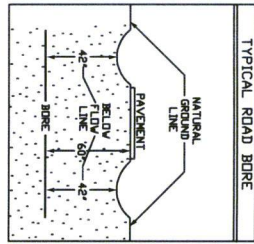

**FORT BEND COUNTY NOTIFICATION**

ATTN CONTACT:  
 HICE BROSSARD  
 HIR-OSP PLNG & ENG DESIGN  
 281-341-4312

CAUTION NOTE:  
 OTHER UTILITIES IN  
 THIS PRINT FILE  
 58026R-432  
 58026R-268

CAUTION NOTE:  
 OTHER UTILITIES IN  
 THIS PRINT FILE  
 58026R-432  
 58026R-268

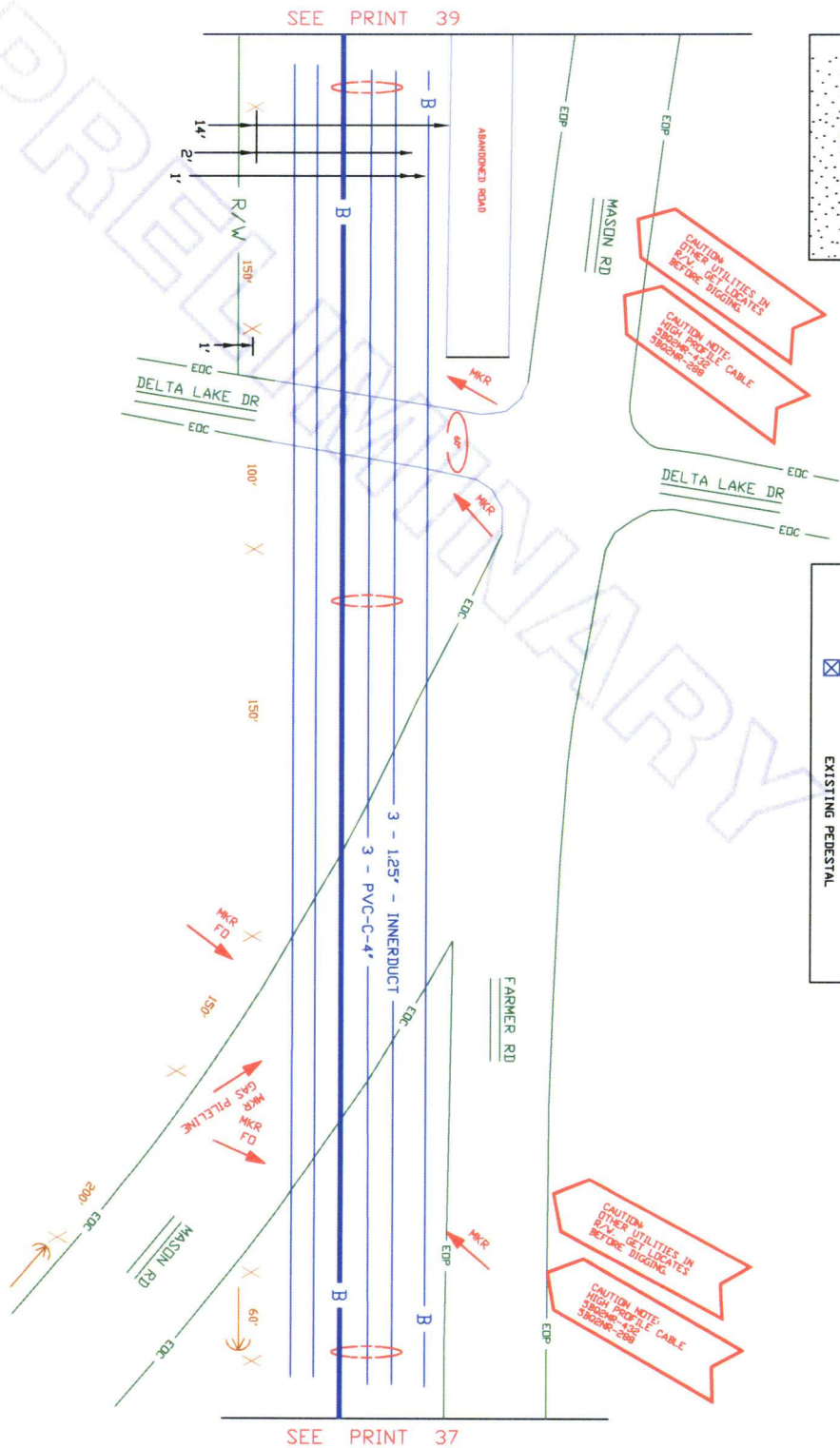

SEE PRINT 39

SEE PRINT 37

Not for use or disclosure outside the A/E/T companies except under written agreement.

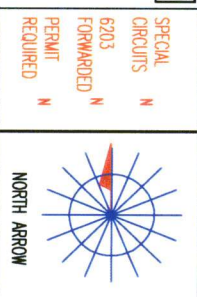

SPECIAL CIRCUITS	N
FORWARDED PERMIT REQUIRED	N

OPERATING RANGE OF JOB STEPS  
 TASK \_\_\_\_\_ TO \_\_\_\_\_

MFRZ TRANSMISSION ZONE  
 RZ 0 CZ 0 TAPER CODE 13305

CAUTION HIGH VOLTAGE  
 BURIED N

UTILITY CO DENT - CONDUIT PRINT  
 REP NAME  
 REP TEL NO.  
 POLE CONTACTS (+) 0 (-) 0

UTILITY CO  
 REP NAME  
 REP TEL NO.  
 POLE CONTACTS (+) 0 (-) 0

UTILITY CO  
 REP NAME  
 REP TEL NO.  
 POLE CONTACTS (+) 0 (-) 0

PROJECT NO A00AKKL

TOI PRINTS 42 PRINT NO. 38  
 NPA/ANNX: 281-232 PRT:288232  
 EXCH: RICH-RD05  
 TAX DIST: F0004  
 GEO LOC: V89232  
 ENGR: HB DRAWN/DIV  
 TELEPHONE NO. (281) 341-4312  
 REC. REF: 232-288-35  
 MAP REF: 5664  
 SCALE NDE  
 ISSUE DATE  
 PROJ TITLE R15206 Q1 T FR R/F  
 REV. NUMBER  
 DATE REV.



**LEGEND**

	PROPOSED BURIED FIBER
	EXISTING BURIED CABLE
	EDGE OF PAVEMENT/CONCRETE
	RIGHT OF WAY
	POWER POLE
	EXISTING PEDESTAL

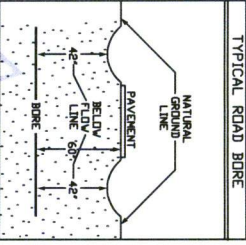

**FORT BEND COUNTY NOTIFICATION**

AT&T CONTRACT:  
HIGH PRESSURE  
281-341-4312 & ENG DESIGN

SPECIAL CIRCUMSTANCES: N  
6203 FORWARDED: N  
PERMIT REQUIRED: N

OPERATING RANGE OF JOB STEPS  
TASK \_\_\_\_\_ TO \_\_\_\_\_

MFR: \_\_\_\_\_

TRANSMISSION ZONE  
RZ 0 CZ 0 TAPER CODE 15345

CAUTION HIGH VOLTAGE BURIED

UTILITY CO: CENTEX POINT  
REP NAME: \_\_\_\_\_  
REP TEL NO: \_\_\_\_\_  
POLE CONTRACTS (+) 0 (-) 0

UTILITY CO: \_\_\_\_\_  
REP NAME: \_\_\_\_\_  
REP TEL NO: \_\_\_\_\_  
POLE CONTRACTS (+) 0 (-) 0

PROJECT NO: A00AKKL

TOT PRINTS: 42 PRINT NO: 40  
NPA/NNX: 281-22 PRI: 281232  
EXCH: RICH-RDCE  
TAX DIST: F0004  
GEO LOC: W89232  
ENGR: RB DRAWN BY: \_\_\_\_\_  
TELEPHONE NO: (281) 341-4312  
REC. REF: 281-280-37-3  
MAP REF: 534W  
SCALE: NTK  
ISSUE DATE: \_\_\_\_\_  
PROJ TITLE: R15206 DLT FR R/F  
REV. NUMBER: \_\_\_\_\_  
DATE REV.:

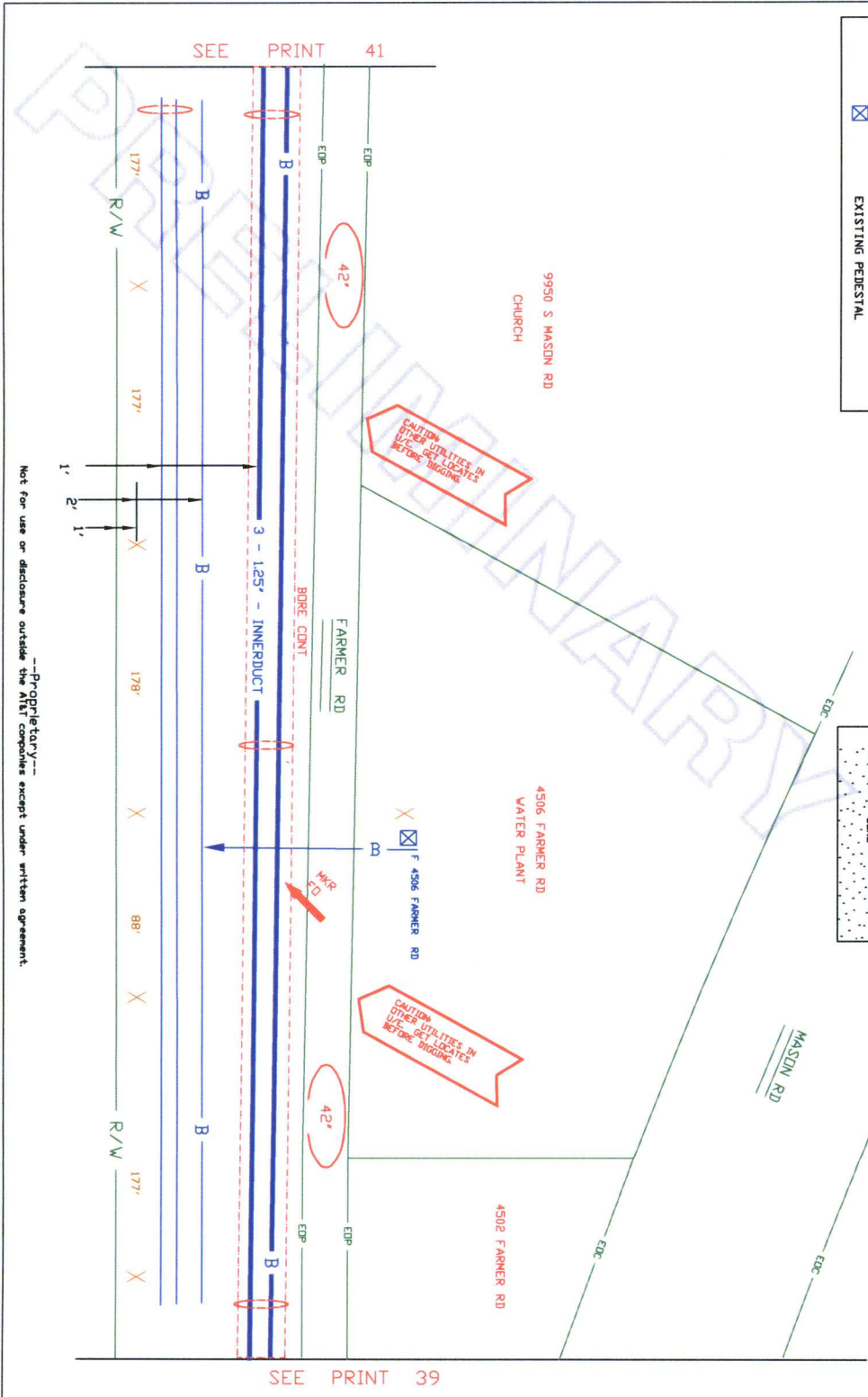

Not for use or disclosure outside the AT&T companies except under written agreement.

SPECIAL CIRCUMSTANCES: N	
6203 FORWARDED: N	
PERMIT REQUIRED: N	
OPERATING RANGE OF JOB STEPS TASK _____ TO _____	
MFR: _____	
TRANSMISSION ZONE RZ 0 CZ 0 TAPER CODE 15345	
CAUTION HIGH VOLTAGE BURIED	
UTILITY CO: CENTEX POINT REP NAME: _____ REP TEL NO: _____ POLE CONTRACTS (+) 0 (-) 0	
UTILITY CO: _____ REP NAME: _____ REP TEL NO: _____ POLE CONTRACTS (+) 0 (-) 0	
PROJECT NO: A00AKKL	
TOT PRINTS: 42 PRINT NO: 40	
NPA/NNX: 281-22 PRI: 281232	
EXCH: RICH-RDCE	
TAX DIST: F0004	
GEO LOC: W89232	
ENGR: RB DRAWN BY: _____	
TELEPHONE NO: (281) 341-4312	
REC. REF: 281-280-37-3	
MAP REF: 534W	
SCALE: NTK	
ISSUE DATE: _____	
PROJ TITLE: R15206 DLT FR R/F	
REV. NUMBER: _____	
DATE REV.:	

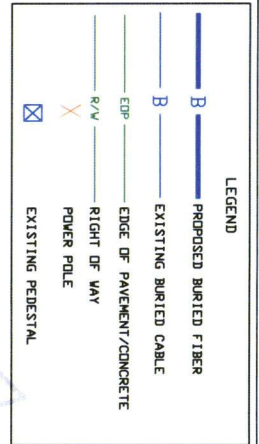
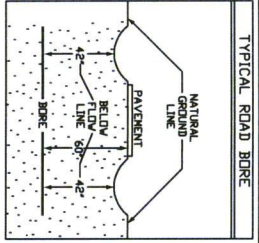

**FORT BEND COUNTY NOTIFICATION**

AT&T CONTACT:  
 NINE BRONKHORST  
 HIGHWAY PLANT & ENG DESIGN  
 881-341-4312

CAUTION OTHER UTILITIES IN USE. LOCATES BEFORE DIGGING.

CAUTION OTHER UTILITIES IN USE. LOCATES BEFORE DIGGING.

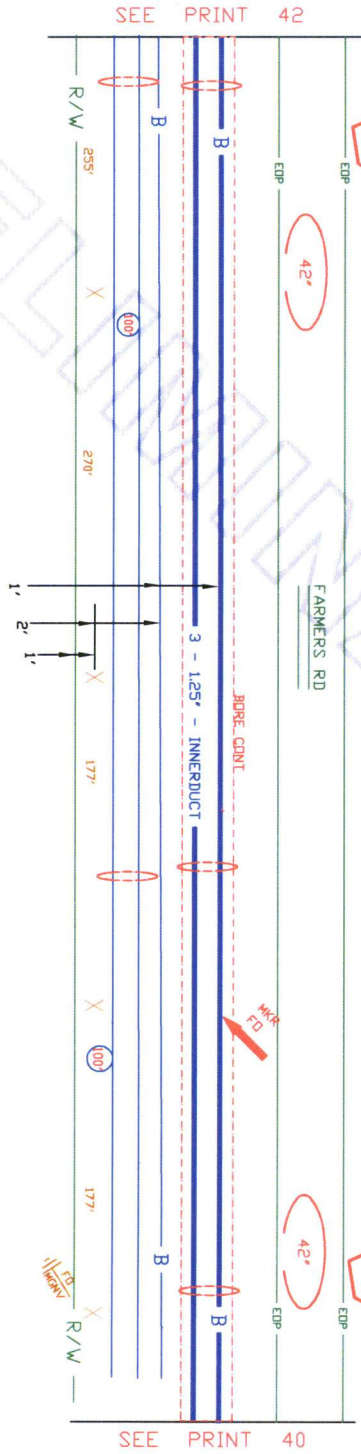

SPECIAL CIRCUITS N  
 6203 FORWARDED N  
 PERMIT N  
 REQUIRED N

OPERATING RANGE OF JOB STEPS  
 TASK \_\_\_\_\_ TO \_\_\_\_\_

MFR:

TRANSMISSION ZONE  
 RZ 0 CZ 0 TAPER CODE 15365

CAUTION HIGH VOLTAGE  
 KV 13.80 KEWL 7 BURIED 1

HIGHWAY PERMIT NO.

UTILITY CO ENI - CENTER POINT  
 REP NAME  
 REP TEL NO.  
 POLE CONTRACTS (+) 0 (-) 0

UTILITY CO  
 REP NAME  
 REP TEL NO.  
 POLE CONTRACTS (+) 0 (-) 0

PROJECT NO A00AKGL

TOT PRINTS 42 PRINT NO. 41  
 NPA/NNX: 281-222 PRI: 281222  
 EXCH. RICH-RDCE  
 TAX DIST. F0004  
 GEO LOC. W89222  
 ENGR. NB DRAWN/TW  
 TELEPHONE NO. (281) 341-4312  
 REC. REF. 222-280-37-3  
 MAP REF. 326W  
 SCALE NINE  
 ISSUE DATE  
 PROJ TITLE RT5206 Q.I.T FRW PLF  
 REV. NUMBER  
 DATE REV.

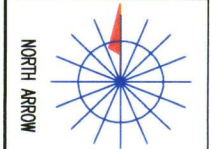

Not for use or disclosure outside the AT&T companies except under written agreement.

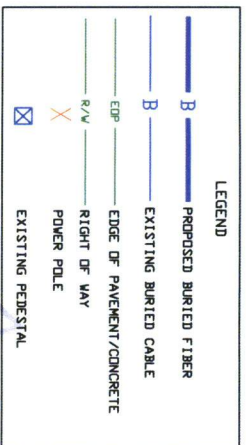
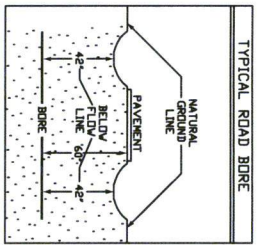

**FORT BEND COUNTY NOTIFICATION**

AT&T CONTRACT:  
 HINE BROADBAND  
 HINE-050-00000000 & ENG DESIGN  
 281-341-4312

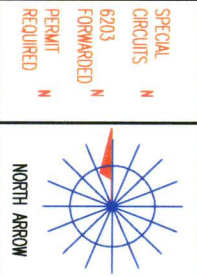

SPECIAL CIRCUITS N  
 6203 N  
 FORWARDED N  
 PERMIT N  
 REQUIRED N

OPERATING RANGE OF JOB STEPS  
 TASK TO

MFRZ TRANSMISSION ZONE  
 CZ 0 TAPER CODE 16365

CAUTION HIGH VOLTAGE  
 BURIED

UTILITY CO. CENTER POINT  
 REP NAME  
 REP TEL NO.  
 POLE CONTRACTS (+) 0 (-) 0

UTILITY CO.  
 REP NAME  
 REP TEL NO.  
 POLE CONTRACTS (+) 0 (-) 0

UTILITY CO.  
 REP NAME  
 REP TEL NO.  
 POLE CONTRACTS (+) 0 (-) 0

PROJECT NO. A00AKGL  
 TOT. PRINTS 42 PRINT NO. 42  
 NPA/NNX: 281-232 PRT: 281232  
 EXCH. RICH-RDCE  
 TAX DIST. F6004  
 GEO. LOC. 809232  
 ENGR. HB DRAWN/DW  
 TELEPHONE NO. (281) 341-4312  
 REC. REF. 232-280-37-4  
 MAP REF. 5257  
 SCALE N/E  
 ISSUE DATE  
 PROJ. TITLE 815206 DLT FR. RT  
 REV. NUMBER  
 DATE REV.

SEE PRINT 41

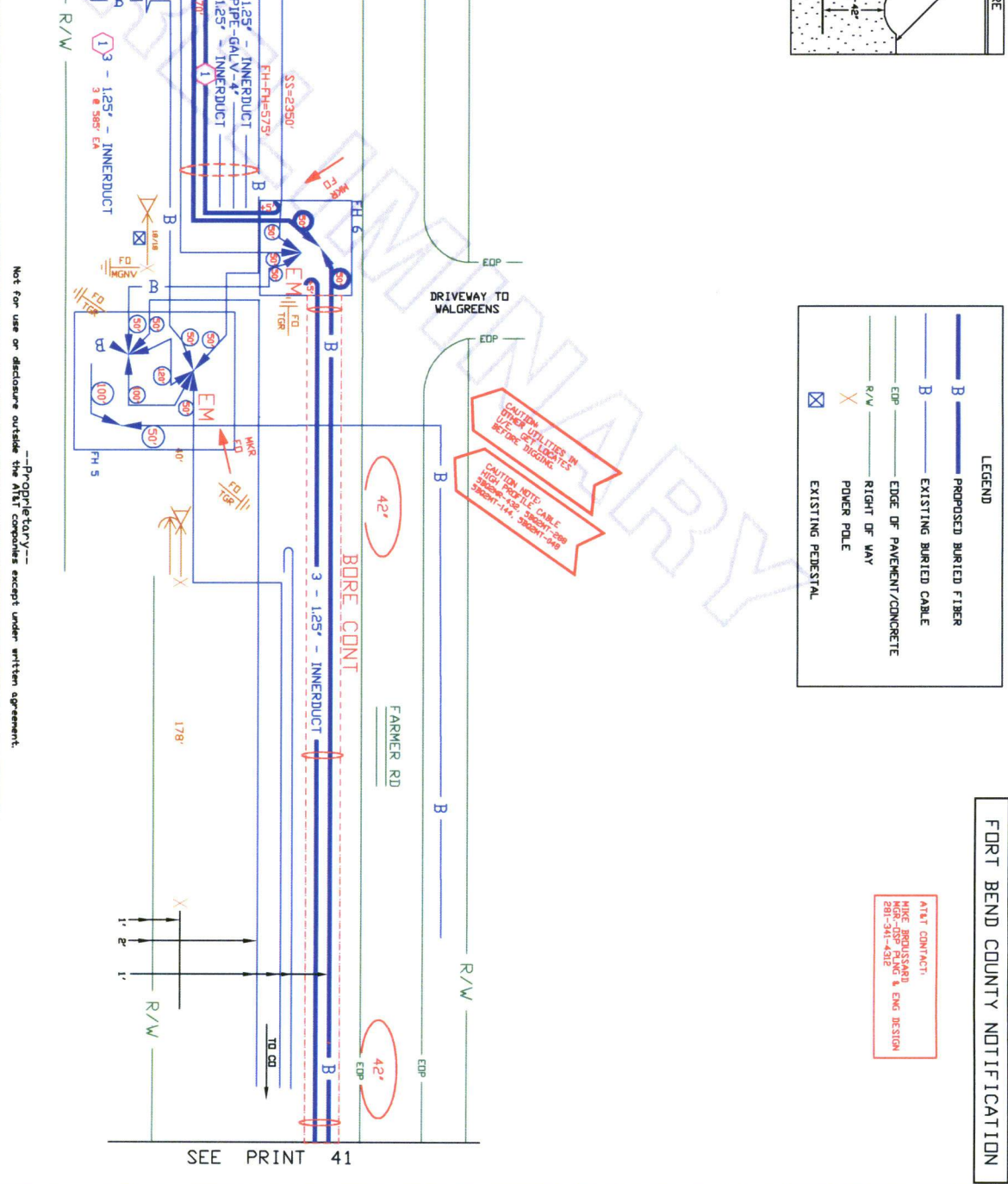

Not for use or disclosure outside the AT&T companies except under written agreement. --Proprietary--