

REVIEW BY FORT BEND COUNTY COMMISSIONERS COURT

On this 8th day of March, 2016, Commissioners Court came on to be heard and reviewed the accompanying notice of LECON, Inc.

Job Location 2534 Windswept Drive, Richmond, TX 77406

Date 2/22/2016 Bond No. no bond required, Permit No. 2016-5638 to make use of certain Fort Bend County property subject to, "A Revised Order Regulating the Laying, Construction, Maintenance, and Repair of Buried Cables, Conduits, and Pole Lines, In, Under, Across or Along Roads, Streets, Highways, and Drainage Ditches in Fort Bend County, Texas, Under the Jurisdiction of the Commissioners Court of Fort Bend County, Texas," as passed by the Commissioners Court of Fort Bend County, Texas the 3rd day of August, 1987, recorded in Volume _____ of the Minutes of the Commissioners Court of Fort Bend County, Texas, to the extent that such order is not inconsistent with Article 1436a, Vernon's Texas Civil Statutes. Upon Motion of Commissioner Meyers, seconded by Commissioner Patterson, duly put and carried, it is ORDERED, ADJUDGED AND DECREED that said notice of said above purpose is hereby acknowledged by the Commissioners Court of Fort Bend County, Texas, and that said notice be placed on record according to the regulation order thereof.

Notes:

1. Evidence of review by the Commissioners Court must be kept on the job site and failure to do so constitutes grounds for job shutdown.
2. Written notices are required:
 - a. 48 hours in advance of construction start up, and
 - b. when construction is completed and ready for final inspection
 Mail notices to: Permit Administrator
 Fort Bend County Engineering
 301 Jackson Street
 Richmond, Texas 77469
 281-633-7500
3. This permit expires one (1) year from date of permit if construction has not commenced.

By: Charles O. Ad
for County Engineer

Presented to Commissioners Court and approved.
Recorded in Volume 3-08-16 12K
Minutes of Commissioners Court

By: N/A
Drainage District Engineer/Manager

Clerk of Commissioners Court
By: Ronda Willes
Deputy

County of Fort Bend

Engineering Department

301 Jackson Street
Richmond, Texas 77469

Johnny Ortega
Permit Administrator

Phone: (281) 633-7500

Permit Application Review Form For Cable, Conduit, and Pole Line Activity In Fort Bend County

Permit No. 2016-5638

The following "Notice of Proposed Cable, Conduit, and/or Pole Line activity in Fort Bend County" and accompanying attachments have been reviewed and the notice conforms to appropriate regulations set by Commissioner's Court of Fort Bend County, Texas.

- (1) Complete Application Form:
- a. Name of road, street, and/or drainage ditch affected.
 - b. Vicinity map showing course of directions
 - c. Plans and specifications
- (2) Bond:
- District Attorney, approval when applicable.
Perpetual bond currently posted.
- No: _____
Amount: _____
- Performance bond submitted.
- No: no bond required
Amount: _____
- Cashier's Check

- No: _____
Amount: _____
- (3) Verbal permission given for emergencies, to start construction before approved in Commissioner's Court.

Precinct Engineer Acknowledgment

Date

Precinct Commissioner Acknowledgment

Date

(4)

Drainage District Approval when applicable

We have reviewed this project and agree it meets minimum requirements.

 CFM

Johnny Ortega CFM/Permit Administrator



Date

CONSTRUCTION OF THE GROVE 4 & 5 DRAINAGE IMPROVEMENTS IN FORT BEND COUNTY, TEXAS FOR PECAN GROVE MUNICIPAL UTILITY DISTRICT

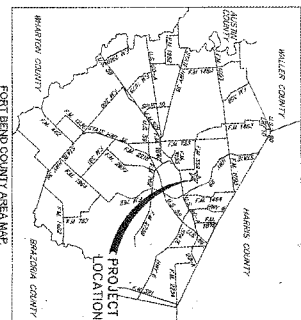

INDEX OF DRAWINGS

SHEET No.	TITLE	
1	COVER SHEET & INDEX	
2	PROJECT OVERALL & PREVENTION PREVENTION DETAILS	
3	CONSTRUCTION NOTES	
PLAN & PROFILE OUTFALL WATER		
4	PLAN & PROFILE BASELINE A	STA. 1+00 - 3+00
5	PLAN & PROFILE BASELINE B	STA. 1+00 - 3+50
6	PLAN & PROFILE BASELINE C	STA. 1+00 - 2+50
7	PLAN & PROFILE BASELINE D	STA. 1+00 - 5+00
8	PLAN & PROFILE BASELINE E	STA. 0+00 - 10+00
9	PLAN & PROFILE BASELINE F	STA. 10+00 - 17+00
10	PLAN & PROFILE BASELINE G	STA. 0+00 - 10+00
11	PLAN & PROFILE BASELINE H	STA. 10+00 - 20+00
12	PLAN & PROFILE BASELINE I	STA. 20+00 - 30+00
13	PLAN & PROFILE BASELINE J	STA. 40+00 - 48+00
14	PLAN & PROFILE BASELINE K	STA. 0+00 - 8+50
15	PLAN & PROFILE BASELINE L	STA. 0+00 - 74+00
16	PLAN & PROFILE BASELINE M	
PROJECT DETAILS		
18	MISCELLANEOUS DETAILS - STORM SEWER	
19	CITY OF RICHMOND STANDARD CONSTRUCTION DETAILS - WATER I	
20	CITY OF RICHMOND STANDARD CONSTRUCTION DETAILS - WATER II	
21	CITY OF RICHMOND STANDARD CONSTRUCTION DETAILS - PAVING I	
22	CITY OF RICHMOND STANDARD CONSTRUCTION DETAILS - PAVING II	
23	TRAFFIC CONTROL PLAN	
24		

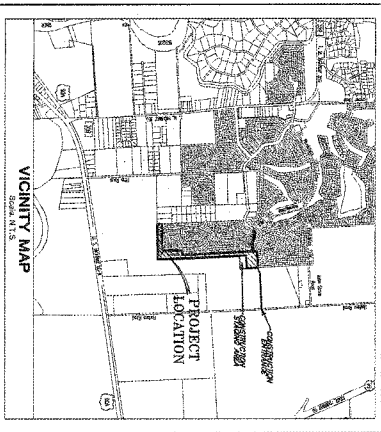

CALL BEFORE YOU DIG!!
 ONE STOP
 UTILITY CENTER
 1309 JESSIE
 TEASDALE
 HOUSTON, TEXAS 77055



REGISTERED
 NOT FOR CONSTRUCTION

DATE: 11/18/14
 SIGNATURE: [Signature]

CONTRACTOR: [Signature]

NOTES:
 These plans were prepared to meet or exceed the specifications and requirements of City of Richmond and Fort Bend County as currently amended. Approval by Fort Bend County will be deemed void if construction has not begun within one year of approval date.
 Construction will be monitored under the supervision of a licensed professional engineer of JONES & CARTER, INC.
 Contractor shall notify Fort Bend County Engineering Department at least 48 hours prior to commencement of construction at construction@fortbendcountytx.gov.

KEY MAP PAGE 589 PANEL P01

JONES & CARTER, INC. PROJECT NUMBER 00034-0368-01
 NOVEMBER 2014

JONES & CARTER, INC.
 ENGINEERS-PLANNERS-SURVEYORS
 6415 Broadway Blvd. Houston, Texas 77057 (281) 242-2000

PECAN GROVE MUNICIPAL UTILITY DISTRICT
 DATE: 11-17-14

DATE: 12/2/14
 THESE SIGNATURES ARE VALID FOR CONSTRUCTION
 DATE OF APPROVAL: 11/17/14

APPROVED BY: [Signatures]
 DATE: 11/17/14
 CITY OF RICHMOND, TEXAS

NOTE: Approval Void After One Year From Date Signed. If Construction Has Not Begun.

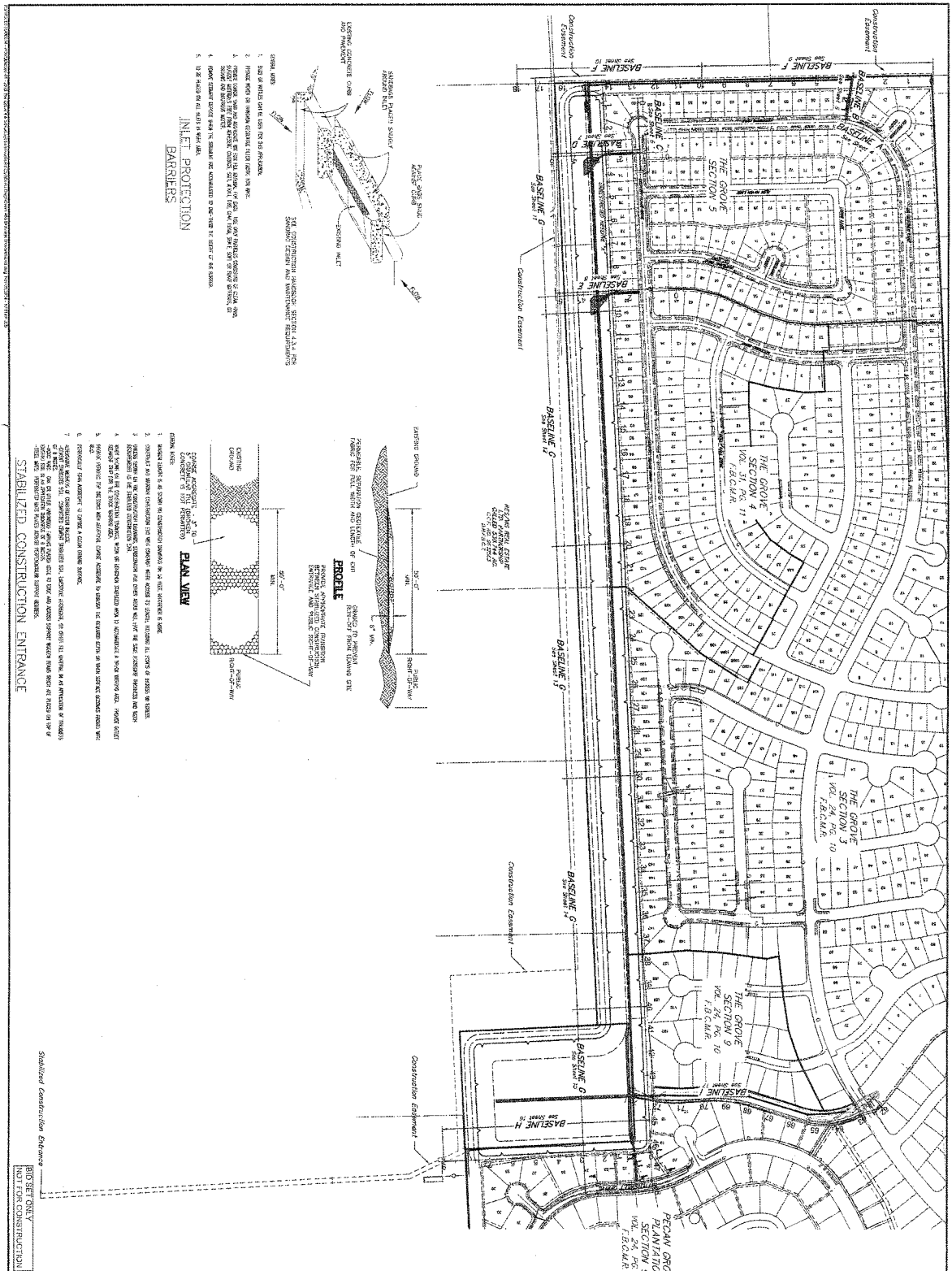

NOTES:

1. THIS PLAN IS A PRELIMINARY PLAN AND IS SUBJECT TO THE APPROVAL OF THE CITY OF FORT BEND COUNTY, TEXAS.
2. THE CITY OF FORT BEND COUNTY, TEXAS, HAS REVIEWED THIS PLAN AND HAS DETERMINED THAT IT IS IN SUBSTANTIAL COMPLIANCE WITH THE SUBDIVISION MAP ACT, CHAPTER 212, TEXAS GOVERNMENT CODE.
3. THE CITY OF FORT BEND COUNTY, TEXAS, HAS REVIEWED THIS PLAN AND HAS DETERMINED THAT IT IS IN SUBSTANTIAL COMPLIANCE WITH THE SUBDIVISION MAP ACT, CHAPTER 212, TEXAS GOVERNMENT CODE.
4. THE CITY OF FORT BEND COUNTY, TEXAS, HAS REVIEWED THIS PLAN AND HAS DETERMINED THAT IT IS IN SUBSTANTIAL COMPLIANCE WITH THE SUBDIVISION MAP ACT, CHAPTER 212, TEXAS GOVERNMENT CODE.
5. THE CITY OF FORT BEND COUNTY, TEXAS, HAS REVIEWED THIS PLAN AND HAS DETERMINED THAT IT IS IN SUBSTANTIAL COMPLIANCE WITH THE SUBDIVISION MAP ACT, CHAPTER 212, TEXAS GOVERNMENT CODE.
6. THE CITY OF FORT BEND COUNTY, TEXAS, HAS REVIEWED THIS PLAN AND HAS DETERMINED THAT IT IS IN SUBSTANTIAL COMPLIANCE WITH THE SUBDIVISION MAP ACT, CHAPTER 212, TEXAS GOVERNMENT CODE.
7. THE CITY OF FORT BEND COUNTY, TEXAS, HAS REVIEWED THIS PLAN AND HAS DETERMINED THAT IT IS IN SUBSTANTIAL COMPLIANCE WITH THE SUBDIVISION MAP ACT, CHAPTER 212, TEXAS GOVERNMENT CODE.
8. THE CITY OF FORT BEND COUNTY, TEXAS, HAS REVIEWED THIS PLAN AND HAS DETERMINED THAT IT IS IN SUBSTANTIAL COMPLIANCE WITH THE SUBDIVISION MAP ACT, CHAPTER 212, TEXAS GOVERNMENT CODE.
9. THE CITY OF FORT BEND COUNTY, TEXAS, HAS REVIEWED THIS PLAN AND HAS DETERMINED THAT IT IS IN SUBSTANTIAL COMPLIANCE WITH THE SUBDIVISION MAP ACT, CHAPTER 212, TEXAS GOVERNMENT CODE.
10. THE CITY OF FORT BEND COUNTY, TEXAS, HAS REVIEWED THIS PLAN AND HAS DETERMINED THAT IT IS IN SUBSTANTIAL COMPLIANCE WITH THE SUBDIVISION MAP ACT, CHAPTER 212, TEXAS GOVERNMENT CODE.

STABILIZED CONSTRUCTION ENTRANCE

INLET PROTECTION BARRIERS

PRIVATE UTILITY LINES SHOWN

APPROVED: [Signature]

DATE: 12/19

PROJECT OVERALL & POLLUTION PREVENTION DETAILS

JC JONES & CARTER, INC.
 ENGINEERS-PLANNERS-ARCHITECTS
 10100 WEST 29TH AVENUE, SUITE 100
 FORT WORTH, TEXAS 76177
 PHONE: 817-336-1100 FAX: 817-336-1101
 WWW: WWW.JCJONESANDCARTER.COM

THE GROVE & S
 DRAINAGE IMPROVEMENTS
 POLLUTION PREVENTION
 DETAILS

PECAN GROVE MUNICIPAL UTILITY DISTRICT
 FORT BEND COUNTY, TEXAS

STABILIZED CONSTRUCTION ENTRANCE

SECTION 2

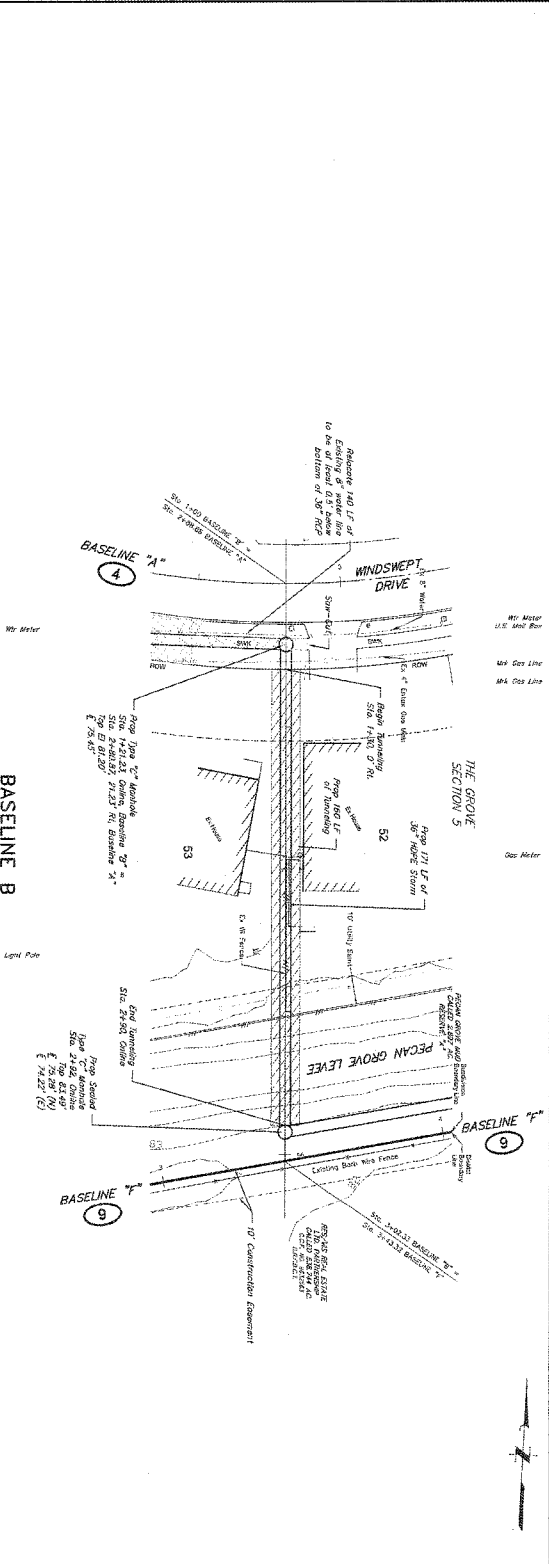
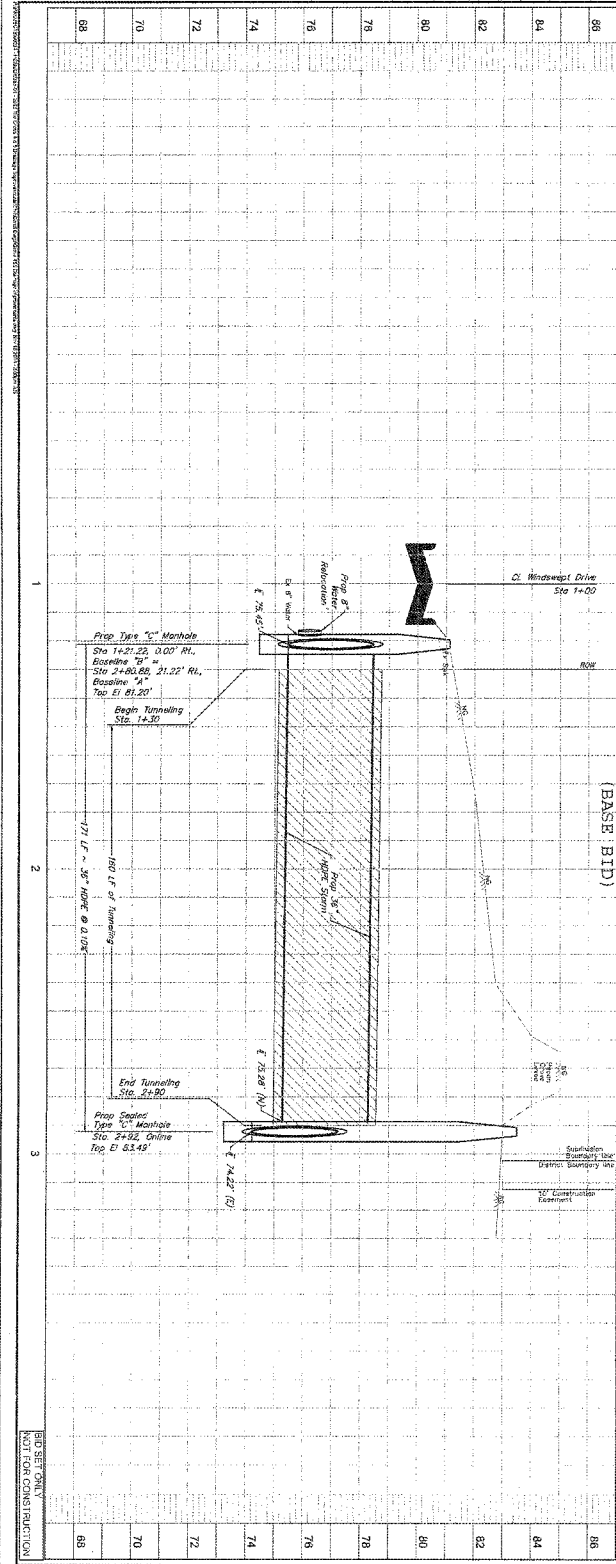

REVISIONS

NOTES:

- 1. ALL WORK SHALL BE IN ACCORDANCE WITH THE LATEST EDITIONS OF THE STANDARD SPECIFICATIONS FOR HIGHWAY CONSTRUCTION, TEXAS, AND THE STANDARD SPECIFICATIONS FOR WATER SUPPLY SYSTEMS, TEXAS.
- 2. THE CONTRACTOR SHALL BE RESPONSIBLE FOR OBTAINING ALL NECESSARY PERMITS FROM THE APPROPRIATE AGENCIES.
- 3. THE CONTRACTOR SHALL MAINTAIN ACCESS TO ALL ADJACENT PROPERTIES AT ALL TIMES.
- 4. THE CONTRACTOR SHALL BE RESPONSIBLE FOR PROTECTING ALL EXISTING UTILITIES AND STRUCTURES.
- 5. THE CONTRACTOR SHALL MAINTAIN ADEQUATE DRAINAGE THROUGHOUT THE PROJECT.
- 6. THE CONTRACTOR SHALL BE RESPONSIBLE FOR OBTAINING ALL NECESSARY PERMITS FROM THE APPROPRIATE AGENCIES.
- 7. THE CONTRACTOR SHALL MAINTAIN ACCESS TO ALL ADJACENT PROPERTIES AT ALL TIMES.
- 8. THE CONTRACTOR SHALL BE RESPONSIBLE FOR PROTECTING ALL EXISTING UTILITIES AND STRUCTURES.
- 9. THE CONTRACTOR SHALL MAINTAIN ADEQUATE DRAINAGE THROUGHOUT THE PROJECT.

DATE: 12/14/14

APPROVED: [Signature]

PROJECT: PRIVATE UTILITY LINES SHOWN

THE GROVE # 2 & 5 DRAINAGE IMPROVEMENTS PLAN & PROFILE BASELINE B STA 1+00 - 3+50

J. JONES & ASSOCIATES, INC.
 10000 N. LOOP WEST, SUITE 1000, DALLAS, TEXAS 75243
 PHONE: (214) 343-1111 FAX: (214) 343-1112
 WWW: WWW.JJONESANDASSOCIATES.COM

CLIENT: THE GROVE # 2 & 5 DRAINAGE IMPROVEMENTS DISTRICT
 10000 N. LOOP WEST, SUITE 1000, DALLAS, TEXAS 75243
 PHONE: (214) 343-1111 FAX: (214) 343-1112
 WWW: WWW.JJONESANDASSOCIATES.COM

DESIGNER: J. JONES & ASSOCIATES, INC.
CHECKED: J. JONES & ASSOCIATES, INC.
DATE: 12/14/14

SCALE: 1" = 20'

PROJECT NO.: 14-0000-0000-00

DATE: 12/14/14

PROJECT: PRIVATE UTILITY LINES SHOWN

THE GROVE # 2 & 5 DRAINAGE IMPROVEMENTS PLAN & PROFILE BASELINE B STA 1+00 - 3+50

J. JONES & ASSOCIATES, INC.
 10000 N. LOOP WEST, SUITE 1000, DALLAS, TEXAS 75243
 PHONE: (214) 343-1111 FAX: (214) 343-1112
 WWW: WWW.JJONESANDASSOCIATES.COM

64
66
68
70
72
74
76
78
80
82
84

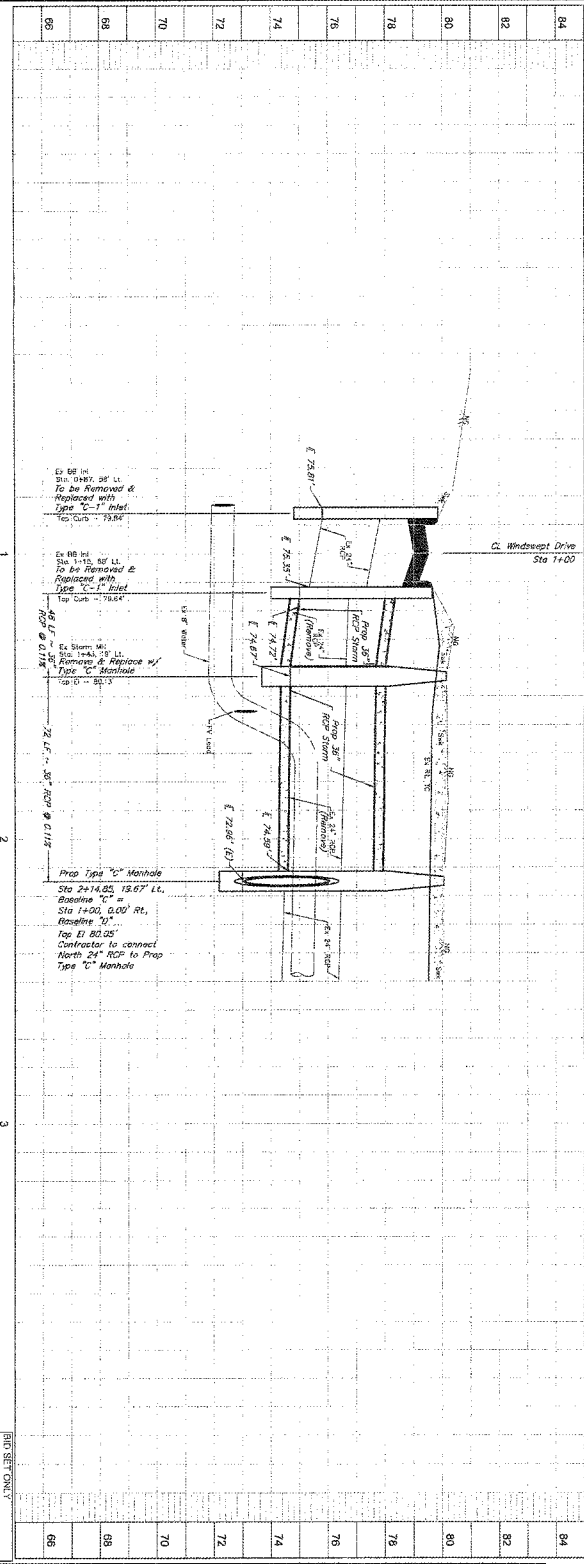

64
66
68
70
72
74
76
78
80
82
84

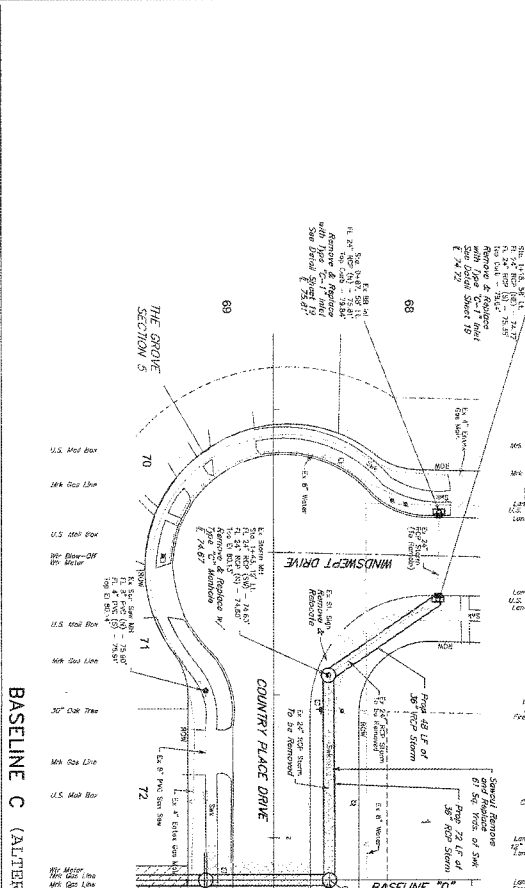

64
66
68
70
72
74
76
78
80
82
84

DATE: 12/19/14
APPROVED: [Signature]
PROJECT: PRIVATE UTILITY LINES SHOWING
PLAN & PROFILE
BASELINE C
SIA 1+00 - 2+50

NOT FOR CONSTRUCTION

JE JONES & CARROLL
REGISTERED PROFESSIONAL ENGINEERS
1000 W. BROADWAY, SUITE 200
DALLAS, TEXAS 75203
PHONE: 214.241.1111
FAX: 214.241.1112
WWW.JEJONESANDCARROLL.COM

THE GROVE A.S. & S.
DRAINAGE IMPROVEMENTS
PLAN & PROFILE
BASELINE C
SIA 1+00 - 2+50

PCMAN GROVE MUNICIPAL UTILITY DISTRICT
PO BOX 60000, TEXAS

REVISIONS:
NO. 1: AS SHOWN ON SHEET 18
NO. 2: AS SHOWN ON SHEET 19
NO. 3: AS SHOWN ON SHEET 20
NO. 4: AS SHOWN ON SHEET 21
NO. 5: AS SHOWN ON SHEET 22
NO. 6: AS SHOWN ON SHEET 23
NO. 7: AS SHOWN ON SHEET 24
NO. 8: AS SHOWN ON SHEET 25
NO. 9: AS SHOWN ON SHEET 26
NO. 10: AS SHOWN ON SHEET 27
NO. 11: AS SHOWN ON SHEET 28
NO. 12: AS SHOWN ON SHEET 29
NO. 13: AS SHOWN ON SHEET 30
NO. 14: AS SHOWN ON SHEET 31
NO. 15: AS SHOWN ON SHEET 32
NO. 16: AS SHOWN ON SHEET 33
NO. 17: AS SHOWN ON SHEET 34
NO. 18: AS SHOWN ON SHEET 35
NO. 19: AS SHOWN ON SHEET 36
NO. 20: AS SHOWN ON SHEET 37
NO. 21: AS SHOWN ON SHEET 38
NO. 22: AS SHOWN ON SHEET 39
NO. 23: AS SHOWN ON SHEET 40
NO. 24: AS SHOWN ON SHEET 41
NO. 25: AS SHOWN ON SHEET 42
NO. 26: AS SHOWN ON SHEET 43
NO. 27: AS SHOWN ON SHEET 44
NO. 28: AS SHOWN ON SHEET 45
NO. 29: AS SHOWN ON SHEET 46
NO. 30: AS SHOWN ON SHEET 47
NO. 31: AS SHOWN ON SHEET 48
NO. 32: AS SHOWN ON SHEET 49
NO. 33: AS SHOWN ON SHEET 50
NO. 34: AS SHOWN ON SHEET 51
NO. 35: AS SHOWN ON SHEET 52
NO. 36: AS SHOWN ON SHEET 53
NO. 37: AS SHOWN ON SHEET 54
NO. 38: AS SHOWN ON SHEET 55
NO. 39: AS SHOWN ON SHEET 56
NO. 40: AS SHOWN ON SHEET 57
NO. 41: AS SHOWN ON SHEET 58
NO. 42: AS SHOWN ON SHEET 59
NO. 43: AS SHOWN ON SHEET 60
NO. 44: AS SHOWN ON SHEET 61
NO. 45: AS SHOWN ON SHEET 62
NO. 46: AS SHOWN ON SHEET 63
NO. 47: AS SHOWN ON SHEET 64
NO. 48: AS SHOWN ON SHEET 65
NO. 49: AS SHOWN ON SHEET 66
NO. 50: AS SHOWN ON SHEET 67
NO. 51: AS SHOWN ON SHEET 68
NO. 52: AS SHOWN ON SHEET 69
NO. 53: AS SHOWN ON SHEET 70
NO. 54: AS SHOWN ON SHEET 71
NO. 55: AS SHOWN ON SHEET 72
NO. 56: AS SHOWN ON SHEET 73
NO. 57: AS SHOWN ON SHEET 74
NO. 58: AS SHOWN ON SHEET 75
NO. 59: AS SHOWN ON SHEET 76
NO. 60: AS SHOWN ON SHEET 77
NO. 61: AS SHOWN ON SHEET 78
NO. 62: AS SHOWN ON SHEET 79
NO. 63: AS SHOWN ON SHEET 80
NO. 64: AS SHOWN ON SHEET 81
NO. 65: AS SHOWN ON SHEET 82
NO. 66: AS SHOWN ON SHEET 83
NO. 67: AS SHOWN ON SHEET 84
NO. 68: AS SHOWN ON SHEET 85
NO. 69: AS SHOWN ON SHEET 86
NO. 70: AS SHOWN ON SHEET 87
NO. 71: AS SHOWN ON SHEET 88
NO. 72: AS SHOWN ON SHEET 89
NO. 73: AS SHOWN ON SHEET 90
NO. 74: AS SHOWN ON SHEET 91
NO. 75: AS SHOWN ON SHEET 92
NO. 76: AS SHOWN ON SHEET 93
NO. 77: AS SHOWN ON SHEET 94
NO. 78: AS SHOWN ON SHEET 95
NO. 79: AS SHOWN ON SHEET 96
NO. 80: AS SHOWN ON SHEET 97
NO. 81: AS SHOWN ON SHEET 98
NO. 82: AS SHOWN ON SHEET 99
NO. 83: AS SHOWN ON SHEET 100

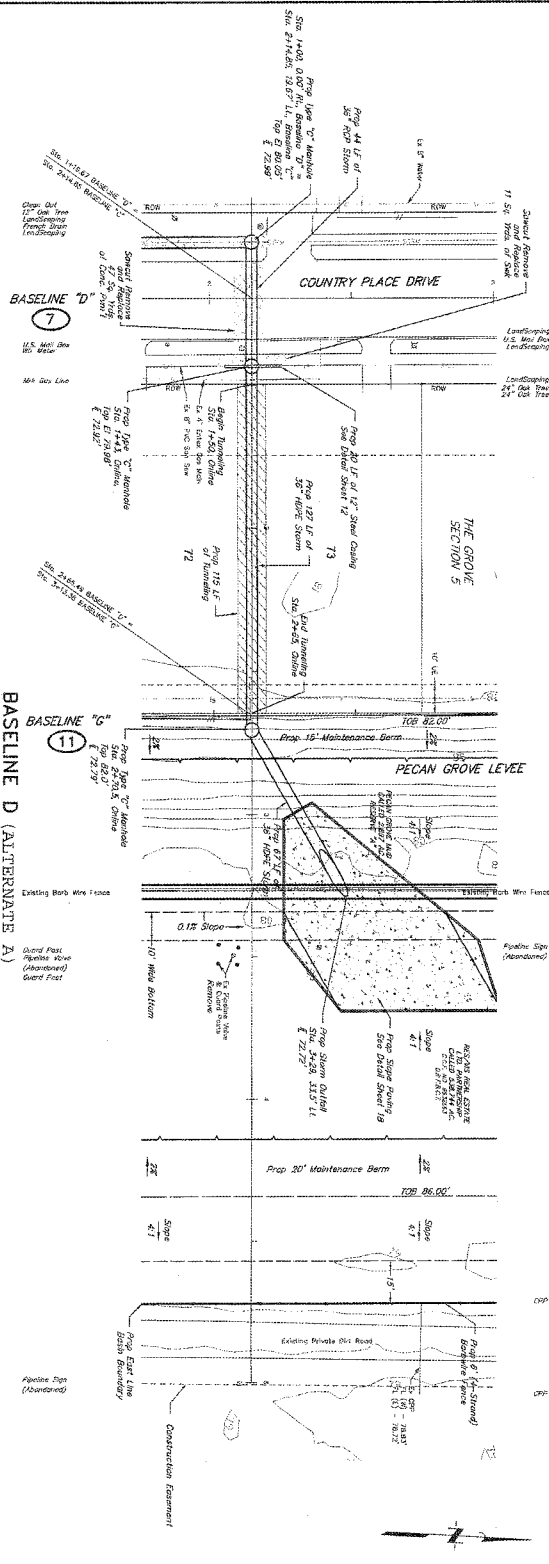
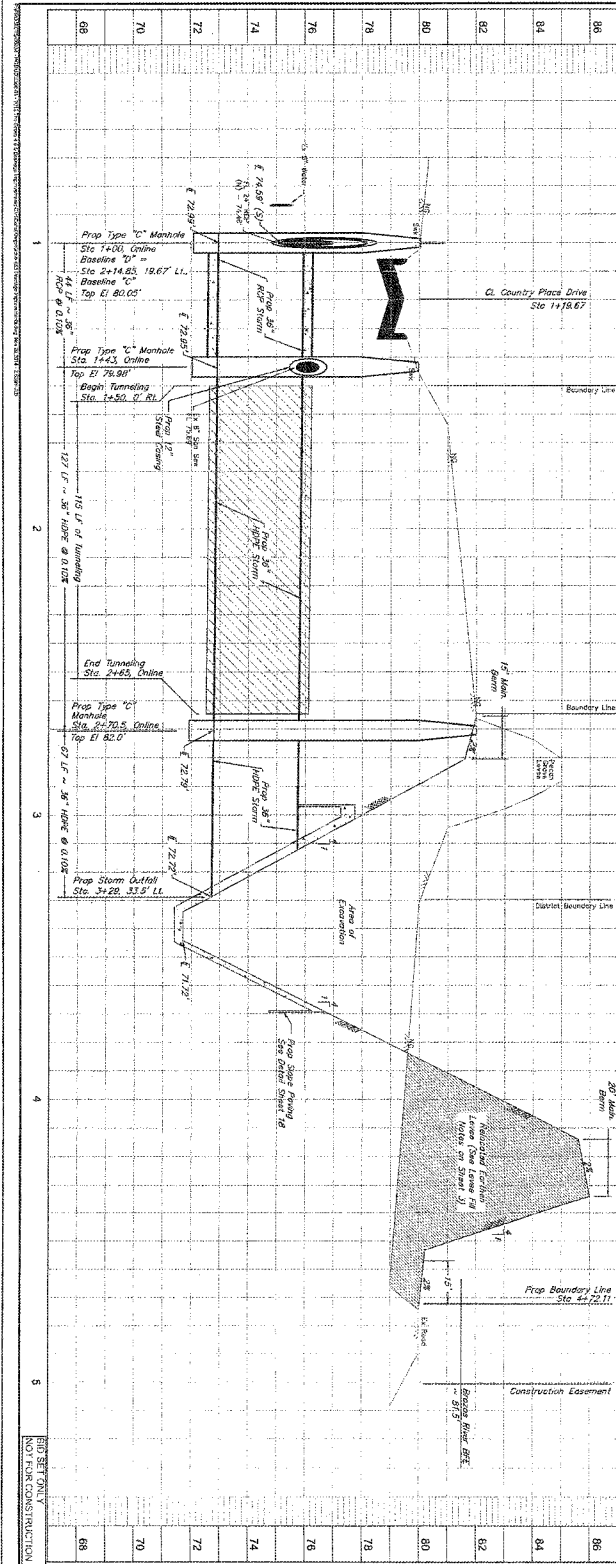

NO.	DATE	DESCRIPTION
1	12/18/18	AS BUILT
2		
3		
4		
5		

PRIVATE UTILITY LINES SHOWN
 1. SHOWN AS BUILT
 2. SHOWN AS PROPOSED
 3. SHOWN AS EXISTING
 4. SHOWN AS REMOVED
 5. SHOWN AS TO BE RELOCATED
 6. SHOWN AS TO BE DELETED
 7. SHOWN AS TO BE ADDED
 8. SHOWN AS TO BE CHANGED
 9. SHOWN AS TO BE MAINTAINED
 10. SHOWN AS TO BE REPAIRED
 11. SHOWN AS TO BE REPLACED
 12. SHOWN AS TO BE UPGRADED
 13. SHOWN AS TO BE DOWNGRADED
 14. SHOWN AS TO BE ABANDONED
 15. SHOWN AS TO BE RESTORED
 16. SHOWN AS TO BE PRESERVED
 17. SHOWN AS TO BE PROTECTED
 18. SHOWN AS TO BE ENHANCED
 19. SHOWN AS TO BE MONITORED
 20. SHOWN AS TO BE MAINTAINED
 21. SHOWN AS TO BE REPAIRED
 22. SHOWN AS TO BE REPLACED
 23. SHOWN AS TO BE UPGRADED
 24. SHOWN AS TO BE DOWNGRADED
 25. SHOWN AS TO BE ABANDONED
 26. SHOWN AS TO BE RESTORED
 27. SHOWN AS TO BE PRESERVED
 28. SHOWN AS TO BE PROTECTED
 29. SHOWN AS TO BE ENHANCED
 30. SHOWN AS TO BE MONITORED

THE GROVE 4 & 5
IMPROVEMENTS
PLAN & PROFILE
BASELINE D
STA 1+00 - 5+00

J.P. JONES & CARTER, INC.
 ENGINEERS & ARCHITECTS
 1000 N. W. 10th St., Suite 100
 Ft. Lauderdale, FL 33304
 PHONE: (954) 561-1111
 FAX: (954) 561-1112
 WWW: www.jpjones.com

DATE: 12/18/18
 APPROVED: [Signature]
 AUTHORIZED REPRESENTATIVE

NOTES:
 1. ALL DIMENSIONS ARE IN FEET AND DECIMALS THEREOF.
 2. ALL DIMENSIONS ARE TO CENTERLINE UNLESS OTHERWISE NOTED.
 3. ALL DIMENSIONS ARE TO FACE UNLESS OTHERWISE NOTED.
 4. ALL DIMENSIONS ARE TO CENTERLINE UNLESS OTHERWISE NOTED.
 5. ALL DIMENSIONS ARE TO FACE UNLESS OTHERWISE NOTED.
 6. ALL DIMENSIONS ARE TO CENTERLINE UNLESS OTHERWISE NOTED.
 7. ALL DIMENSIONS ARE TO FACE UNLESS OTHERWISE NOTED.
 8. ALL DIMENSIONS ARE TO CENTERLINE UNLESS OTHERWISE NOTED.
 9. ALL DIMENSIONS ARE TO FACE UNLESS OTHERWISE NOTED.
 10. ALL DIMENSIONS ARE TO CENTERLINE UNLESS OTHERWISE NOTED.
 11. ALL DIMENSIONS ARE TO FACE UNLESS OTHERWISE NOTED.
 12. ALL DIMENSIONS ARE TO CENTERLINE UNLESS OTHERWISE NOTED.
 13. ALL DIMENSIONS ARE TO FACE UNLESS OTHERWISE NOTED.
 14. ALL DIMENSIONS ARE TO CENTERLINE UNLESS OTHERWISE NOTED.
 15. ALL DIMENSIONS ARE TO FACE UNLESS OTHERWISE NOTED.
 16. ALL DIMENSIONS ARE TO CENTERLINE UNLESS OTHERWISE NOTED.
 17. ALL DIMENSIONS ARE TO FACE UNLESS OTHERWISE NOTED.
 18. ALL DIMENSIONS ARE TO CENTERLINE UNLESS OTHERWISE NOTED.
 19. ALL DIMENSIONS ARE TO FACE UNLESS OTHERWISE NOTED.
 20. ALL DIMENSIONS ARE TO CENTERLINE UNLESS OTHERWISE NOTED.
 21. ALL DIMENSIONS ARE TO FACE UNLESS OTHERWISE NOTED.
 22. ALL DIMENSIONS ARE TO CENTERLINE UNLESS OTHERWISE NOTED.
 23. ALL DIMENSIONS ARE TO FACE UNLESS OTHERWISE NOTED.
 24. ALL DIMENSIONS ARE TO CENTERLINE UNLESS OTHERWISE NOTED.
 25. ALL DIMENSIONS ARE TO FACE UNLESS OTHERWISE NOTED.
 26. ALL DIMENSIONS ARE TO CENTERLINE UNLESS OTHERWISE NOTED.
 27. ALL DIMENSIONS ARE TO FACE UNLESS OTHERWISE NOTED.
 28. ALL DIMENSIONS ARE TO CENTERLINE UNLESS OTHERWISE NOTED.
 29. ALL DIMENSIONS ARE TO FACE UNLESS OTHERWISE NOTED.
 30. ALL DIMENSIONS ARE TO CENTERLINE UNLESS OTHERWISE NOTED.



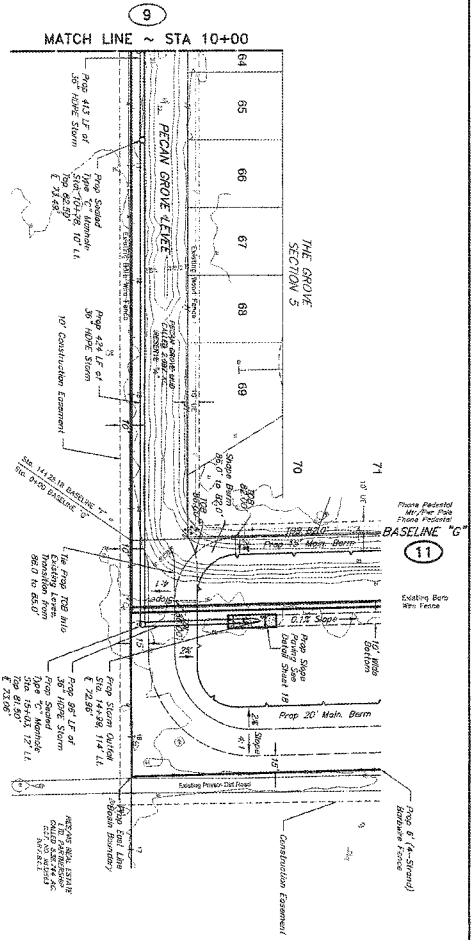

BASELINE F (BASE B/D)

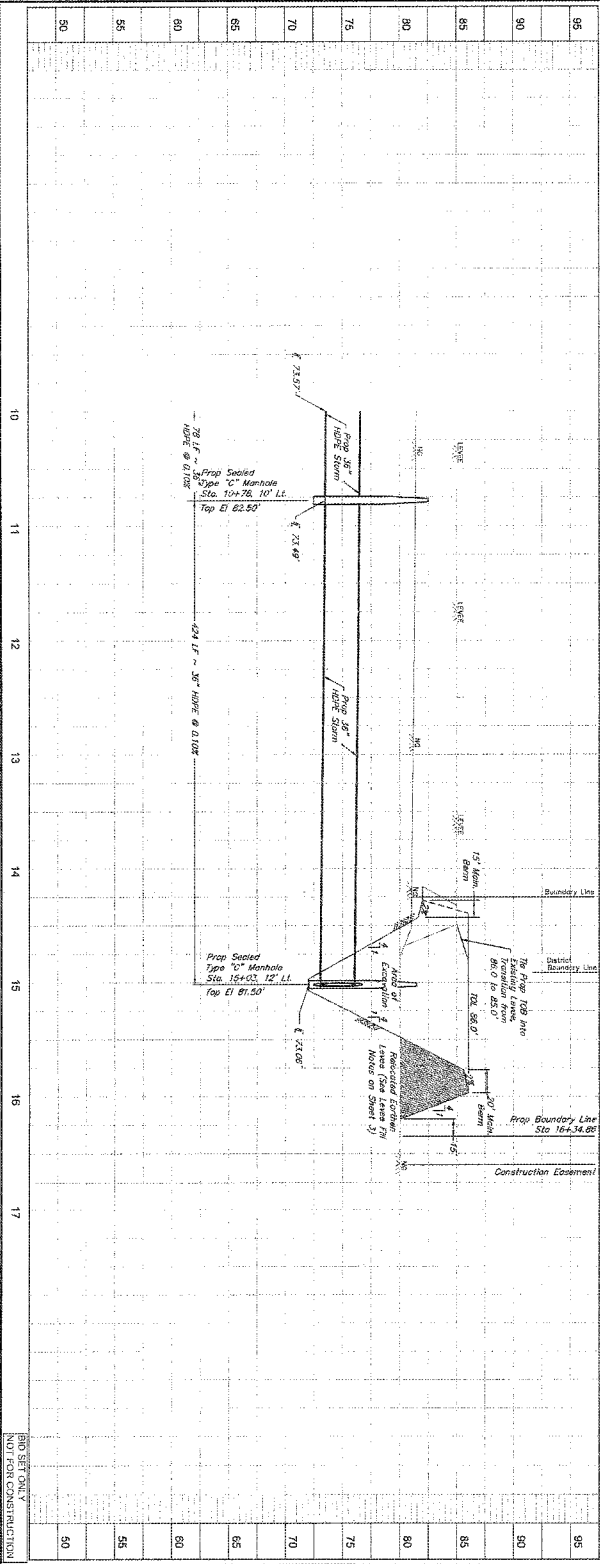

REVISIONS

NO.	DATE	DESCRIPTION

PROJECT INFORMATION

PROJECT: PRIVATE UTILITY LINES SCOPIN
 CLIENT: FORT BEND COUNTY, TEXAS
 LOCATION: PECAN GROVE MANIPUL UTILITY DISTRICT
 SHEET NO.: 10 OF 20

DESIGNER
 J.C. JONES & ASSOCIATES
 ENGINEERS, PLUMBERS, AND CONTRACTORS
 10000 FORT BEND COUNTY ROAD 100
 FORT BEND COUNTY, TEXAS 77450

DATE: 12/21/14

APPROVER: [Signature]

SCALE: 1" = 10'

NOT FOR CONSTRUCTION

THE GROVE
SECTION 4
VOL. 37, PG. 11
F.B.C.M.A.

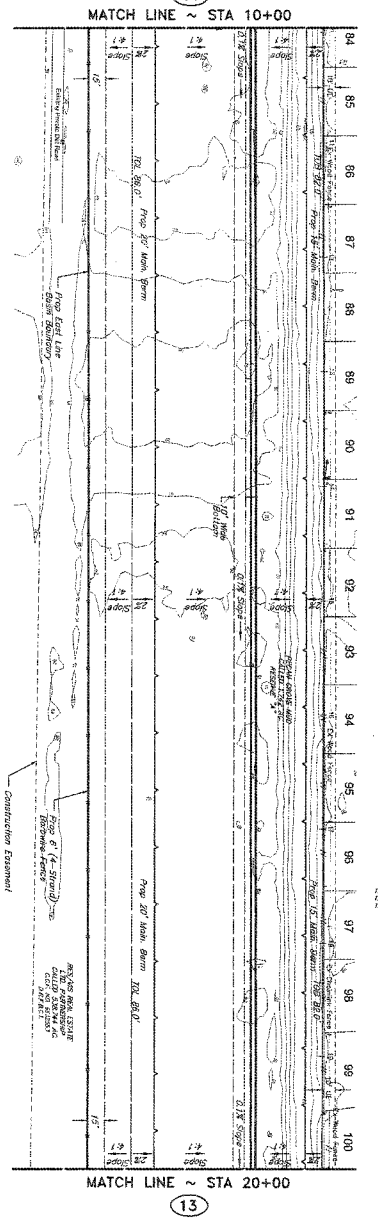

BASELINE G (BASE BID)

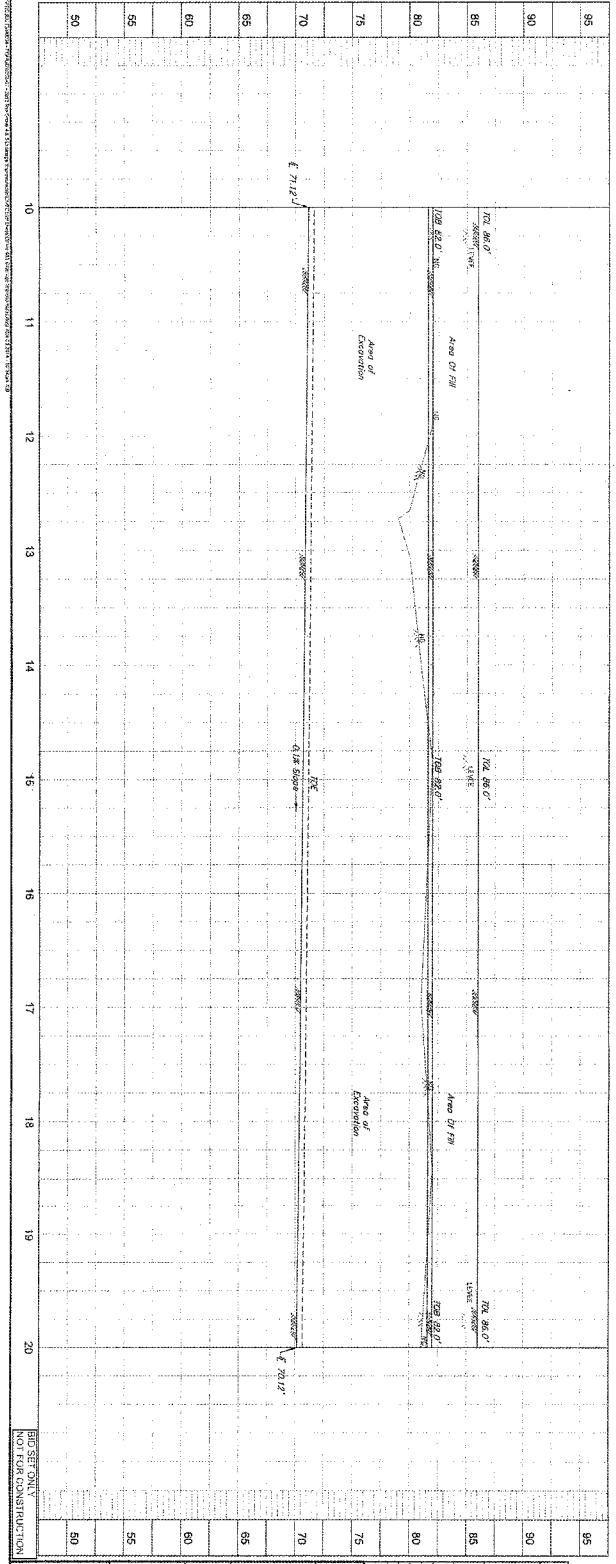

REVISIONS
NO. DATE BY
1 12/14/14 JCS

THE GROVE
SECTION 4
VOL. 37, PG. 11
F.B.C.M.A.

DATE: 12/14/14
APPROVED: [Signature]
SUPERVISOR/ENGINEER

SCALE: 1" = 20'
VERTICAL SCALE: 1" = 10'

PRIVATE UTILITY LINES SHOWN
AS LOCATED BY FIELD SURVEY

PCAN GROVE MUNICIPAL UTILITY DISTRICT
FARRI NEWBERRY, TEXAS

THE GROVE A & E
DRAINAGE IMPROVEMENTS
BASELINE G
STA 10+00 TO 20+00

J.C. JONES & CARTER, INC.
ENGINEERS-PLANNERS-ARCHITECTS

DATE: 12/14/14
DRAWN BY: JCS
CHECKED BY: JCS

BID SECTION 12
NOT FOR CONSTRUCTION

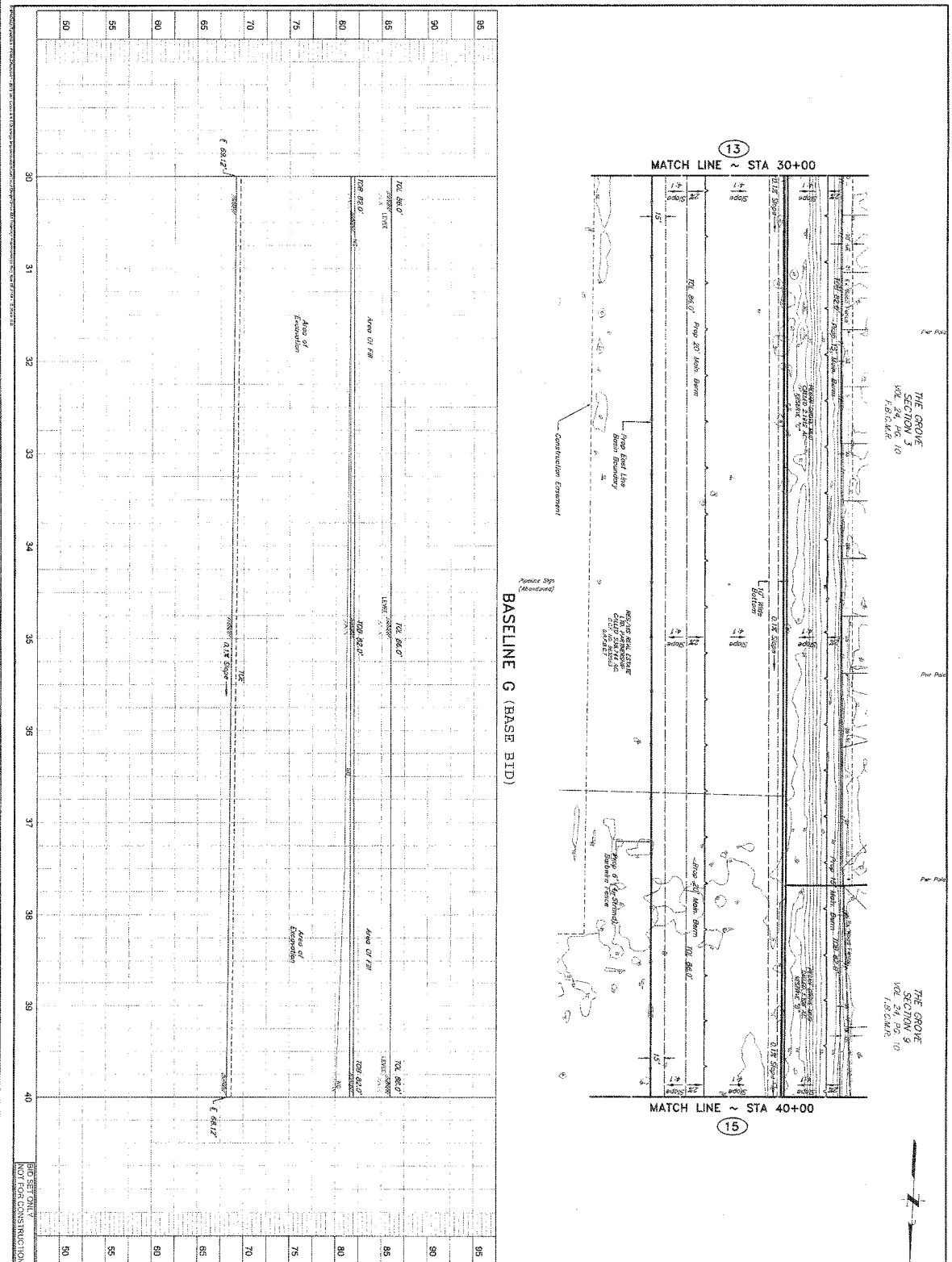

THE GROVE
SECTION 3
VOL. 24, PG. 10
1.81 C.A.R.

THE GROVE
SECTION 9
VOL. 24, PG. 10
1.81 C.A.R.

BASELINE G (BASE BID)

BID SET ONLY
NOT FOR CONSTRUCTION

REVISIONS

NO.	DATE	DESCRIPTION
1	10/21/14	ISSUED FOR BIDDING

SCALE

VERTICAL: 1" = 10'

HORIZONTAL: 1" = 40'

NOTE

1. ALL CONSTRUCTION SHALL BE IN ACCORDANCE WITH THE LATEST EDITION OF THE STANDARD SPECIFICATIONS FOR PUBLIC WORKS, TEXAS, 2011 EDITION, LATEST REVISIONS.

2. THE CONTRACTOR SHALL BE RESPONSIBLE FOR OBTAINING ALL NECESSARY PERMITS AND APPROVALS FROM THE APPROPRIATE AGENCIES.

3. THE CONTRACTOR SHALL MAINTAIN ACCESS TO ALL ADJACENT PROPERTIES AND UTILITIES AT ALL TIMES.

4. THE CONTRACTOR SHALL BE RESPONSIBLE FOR PROTECTING ALL EXISTING UTILITIES AND STRUCTURES.

5. THE CONTRACTOR SHALL MAINTAIN ADEQUATE DRAINAGE AND EROSION CONTROL MEASURES THROUGHOUT CONSTRUCTION.

APPROVED

DATE: 10/21/14

PROJECT INFORMATION

PROJECT: PRIVATE UTILITY LINES SECTION

LOCATION: THE GROVE, FORT BEND COUNTY, TEXAS

DATE: 10/21/14

THE GROVE, FORT BEND COUNTY, TEXAS

PRIVATE UTILITY LINES SECTION

PLAN & PROFILE

BASELINE G (BASE BID)

STA 30+00 - 40+00



J.C. JONES & ASSOCIATES, INC.
ENGINEERS-PLANNERS-ARCHITECTS

DATE: 10/21/14
DRAWN BY: JCS
CHECKED BY: JCS

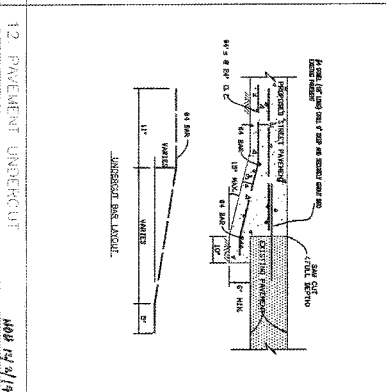
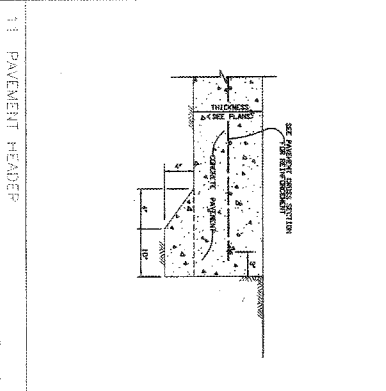
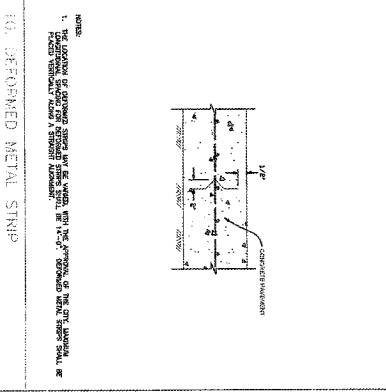
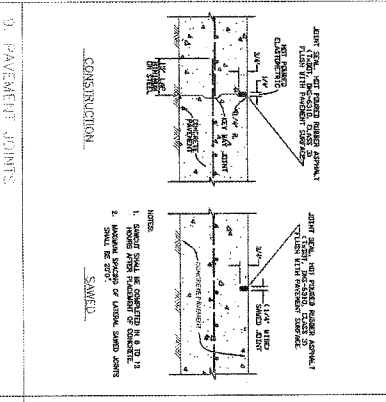
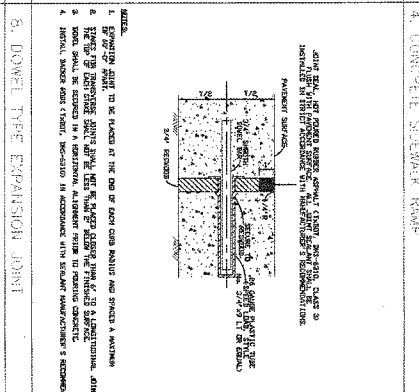
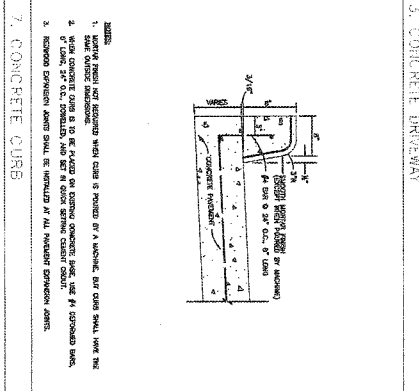
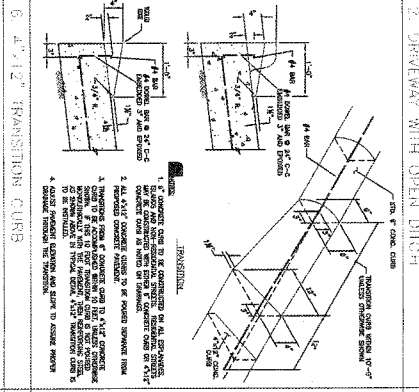
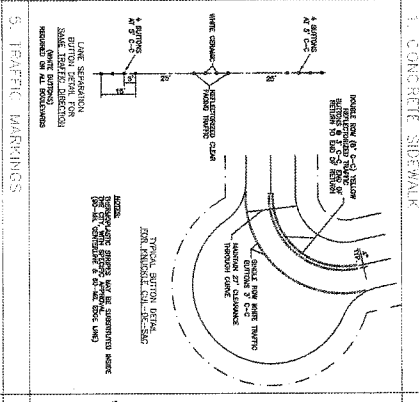
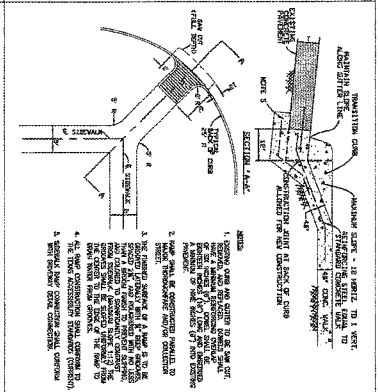
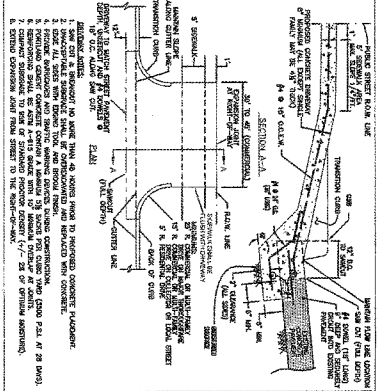
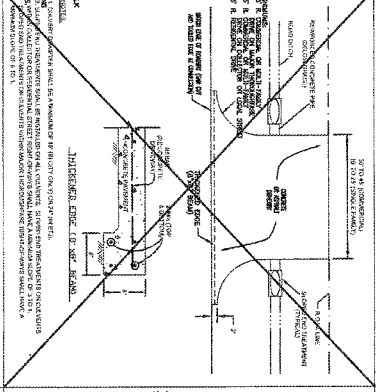
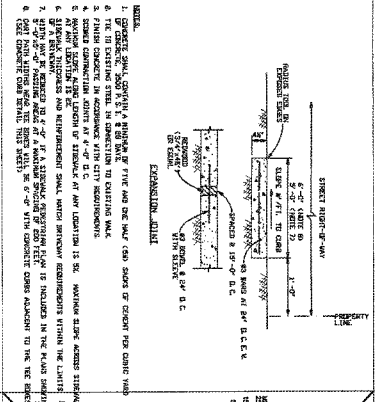

PROBATION

CONSTRUCTION

DATE OF PREPARATION

SCALE

STANDARD CONSTRUCTION DETAILS

PAVING 1

JONES & CARTER

ENGINEERS & ARCHITECTS

1111 1/2 STREET, SUITE 100, HOUSTON, TEXAS 77002

PHONE: 713-621-1111

FAX: 713-621-1112

WWW.JONESANDCARTER.COM

22

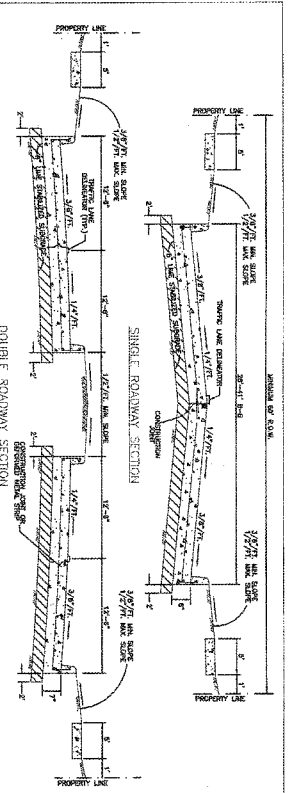

1. ALL IMPROVED STREETS SHALL CONFORM TO 20'-0\"/>
- 2. THE CURB SHALL BE CONCRETE, 12\"/>
- 3. THE GUTTER SHALL BE CONCRETE, 12\"/>
- 4. THE SLOPE BETWEEN PAVEMENT AND THE SIDEWALK/PROWALK USE MAY BE OTHERWISE, WITH APPROVAL FROM THE CITY.

1. STANDARD CONCRETE CURB AND GUTTER STREET CROSS-SECTIONS

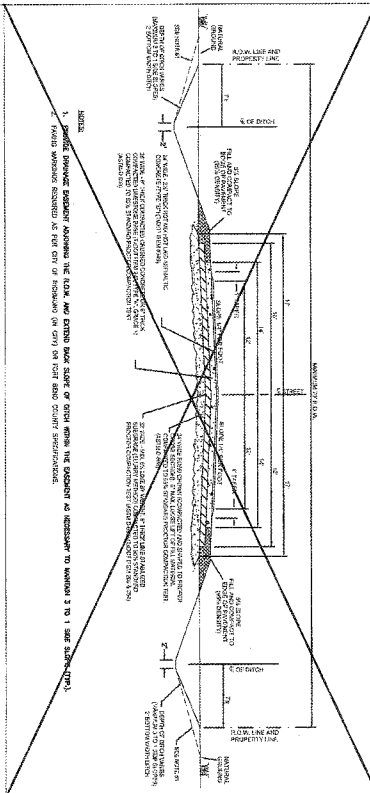

2. STANDARD ASPHALT PAVEMENT WITH OPEN DITCH CROSS-SECTION

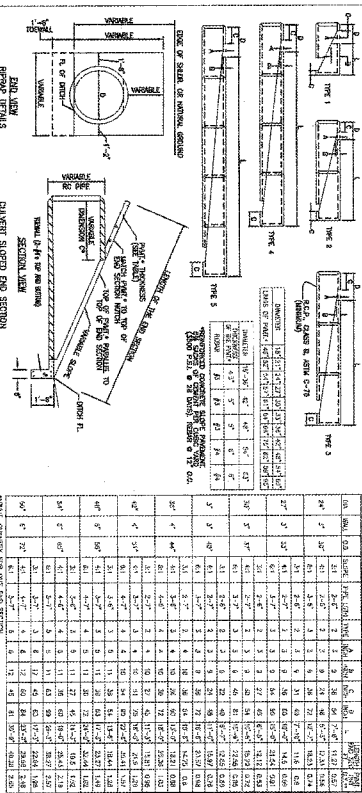

5. SLOPED END TREATMENT

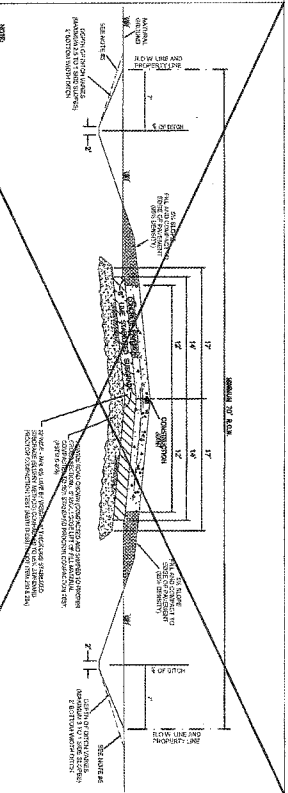

1. ALL IMPROVED STREETS SHALL CONFORM TO 20'-0\"/>
- 2. THE CURB SHALL BE CONCRETE, 12\"/>
- 3. THE GUTTER SHALL BE CONCRETE, 12\"/>
- 4. THE SLOPE BETWEEN PAVEMENT AND THE SIDEWALK/PROWALK USE MAY BE OTHERWISE, WITH APPROVAL FROM THE CITY.

2. STANDARD CONCRETE CURB AND GUTTER STREET CROSS-SECTION

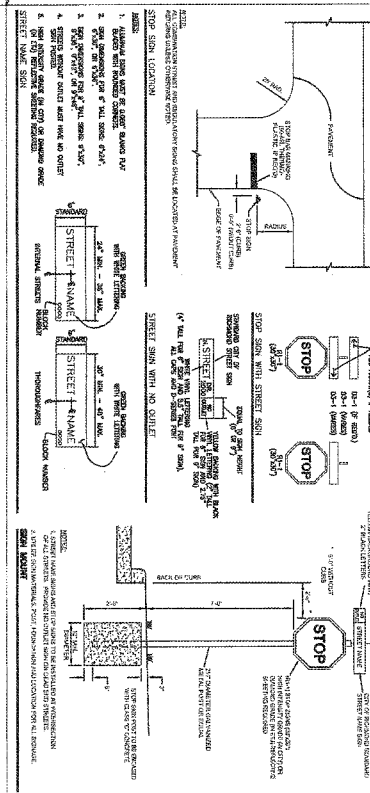

4. TRAFFIC STORAGE

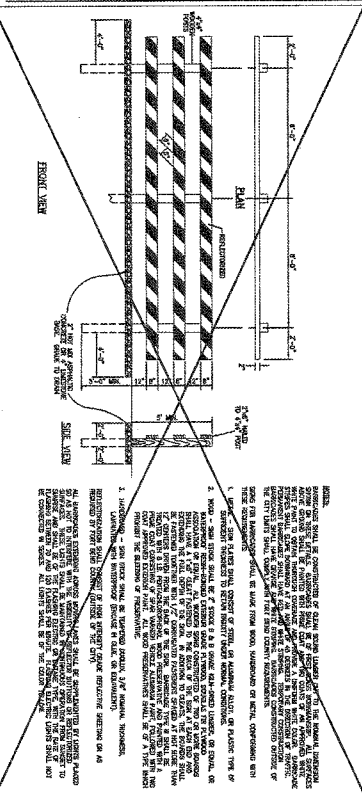

5. TYPE III BARRICADE

APPROVED FOR THE CITY OF RICHMOND

CITY OF RICHMOND

APPROVAL

DATE: _____

SCALE: 1\"/>

DESIGNED BY: _____

CHECKED BY: _____

DRAWN BY: _____

DATE: _____

23

ROBERT OWEN
NO. 1501 CONSTRUCTION

JONES & CARTER
INCORPORATED
1000 N. 10TH ST.
RICHMOND, VA 23222

CITY OF RICHMOND
PAVING II

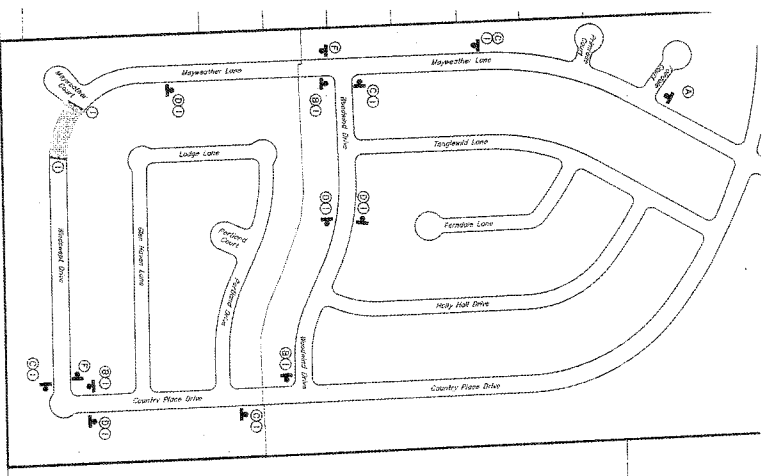

Traffic Control for Closure of Meadowlark Drive

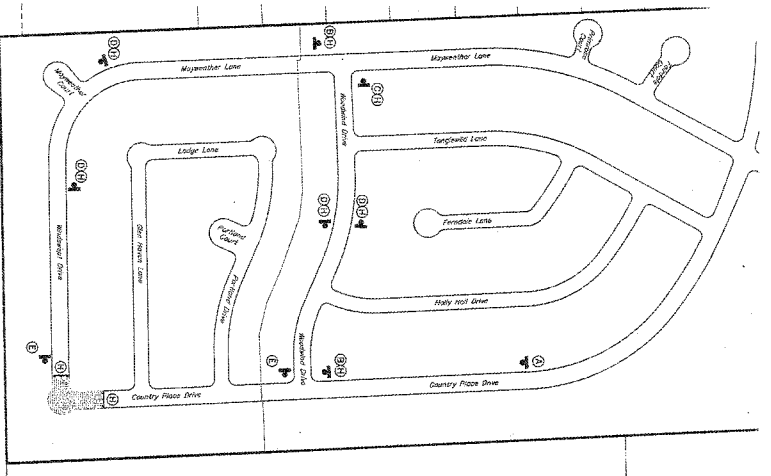

Traffic Control for Closure of Meadowlark Drive & Country Place Drive

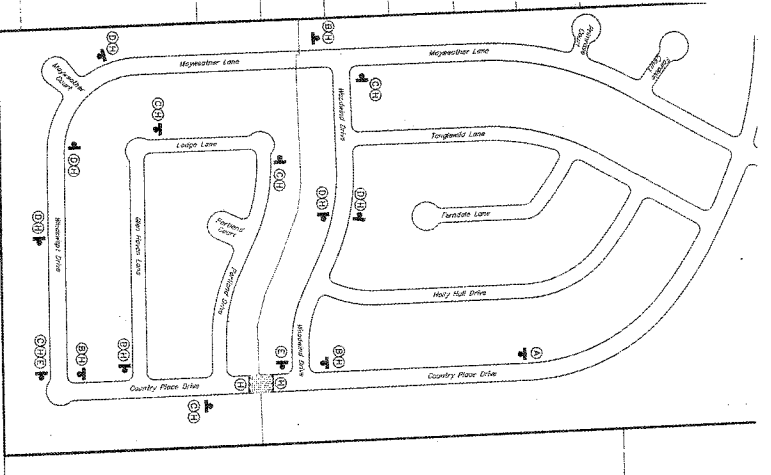

Traffic Control for Closure of Country Place Drive

TRAFFIC CONTROL CONSTRUCTION SEQUENCE

1	ROAD CLOSED	2	TRAFFIC CONTROL
3	ROAD CLOSED	4	TRAFFIC CONTROL
5	ROAD CLOSED	6	TRAFFIC CONTROL
7	ROAD CLOSED	8	TRAFFIC CONTROL
9	ROAD CLOSED	10	TRAFFIC CONTROL

TRAFFIC CONTROL LEGEND

1. ROAD CLOSED
 2. TRAFFIC CONTROL
 3. ROAD CLOSED
 4. TRAFFIC CONTROL
 5. ROAD CLOSED
 6. TRAFFIC CONTROL
 7. ROAD CLOSED
 8. TRAFFIC CONTROL
 9. ROAD CLOSED
 10. TRAFFIC CONTROL

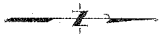

APPROVED: *[Signature]*
 DATE: 1/11/14
 SUBMITTING CONTRACTOR

PRIVATE UTILITIES SECTION
 DIVISION OF PUBLIC WORKS
 FORT BEND COUNTY, TEXAS

THE GROVE 4 & 5
 DRAINAGE IMPROVEMENTS
 TRAFFIC CONTROL PLAN

NO.	DATE	REVISIONS

J. JONES & CARTER, INC.
 REGISTERED PROFESSIONAL ENGINEERS
 10000 WEST 10TH STREET, SUITE 100
 FORT WORTH, TEXAS 76132
 PHONE: 817-335-1111
 FAX: 817-335-1112
 LICENSE NO. 10000



NOT FOR CONSTRUCTION