

REVIEW BY FORT BEND COUNTY COMMISSIONERS COURT

On this 1st day of March, 2016, Commissioners Court came on to be heard and reviewed the accompanying notice of Jier LLC / Comcast of Houston, LLC
 Job Location 2713 Katy Flewellen Rd, Katy, TX 77494
 Date 2/17/2016 Bond No. 104865058, Permit No. 2016-5527 to make use of certain Fort Bend County property subject to, "A Revised Order Regulating the Laying, Construction, Maintenance, and Repair of Buried Cables, Conduits, and Pole Lines, In, Under, Across or Along Roads, Streets, Highways, and Drainage Ditches in Fort Bend County, Texas, Under the Jurisdiction of the Commissioners Court of Fort Bend County, Texas," as passed by the Commissioners Court of Fort Bend County, Texas the 3rd day of August, 1987, recorded in Volume _____ of the Minutes of the Commissioners Court of Fort Bend County, Texas, to the extent that such order is not inconsistent with Article 1436a, Vernon's Texas Civil Statutes. Upon Motion of Commissioner Meyer, seconded by Commissioner Pattison, duly put and carried, it is ORDERED, ADJUDGED AND DECREED that said notice of said above purpose is hereby acknowledged by the Commissioners Court of Fort Bend County, Texas, and that said notice be placed on record according to the regulation order thereof.

Notes:

1. Evidence of review by the Commissioners Court must be kept on the job site and failure to do so constitutes grounds for job shutdown.
2. Written notices are required:
 - a. 48 hours in advance of construction start up, and
 - b. when construction is completed and ready for final inspection
 Mail notices to: Permit Administrator
 Fort Bend County Engineering
 301 Jackson Street
 Richmond, Texas 77469
 281-633-7500
3. This permit expires one (1) year from date of permit if construction has not commenced.

By: Charles O. Day
 for County Engineer

Presented to Commissioners Court and approved.

Recorded in Volume 3-01-16 110
 Minutes of Commissioners Court

By: N/A
 Drainage District Engineer/Manager

Clerk of Commissioners Court

By: Ronda Wilkes
 Deputy



SHEET INDEX	
1	COVER SHEET
2	PLAN AND SECTION SHEET
3	TRAFFIC CONTROL PLAN

PROPOSED CONDUIT ALIGNMENT ALONG KATY-FLEWELLEN ROAD
NORTH OF WILLOW LANE FOR APPROX. 186 FEET.

PROJECT
LOCATION

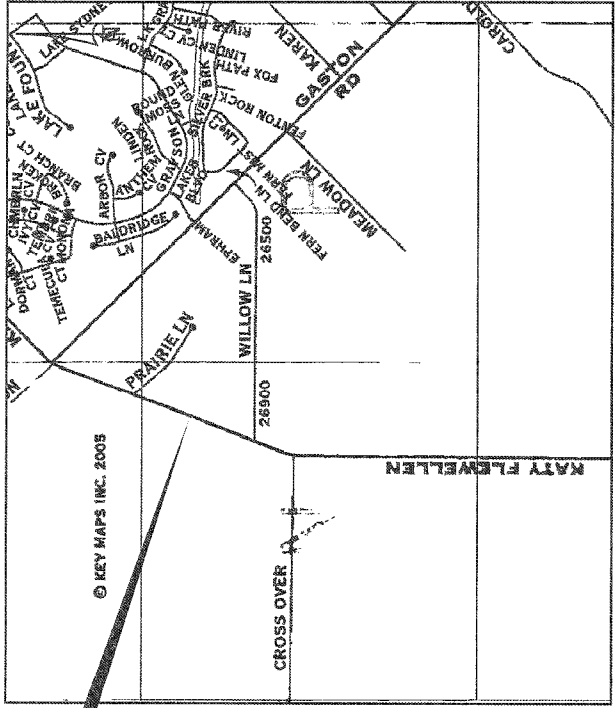

VICINITY MAP
KEY MAP NO. 484-N

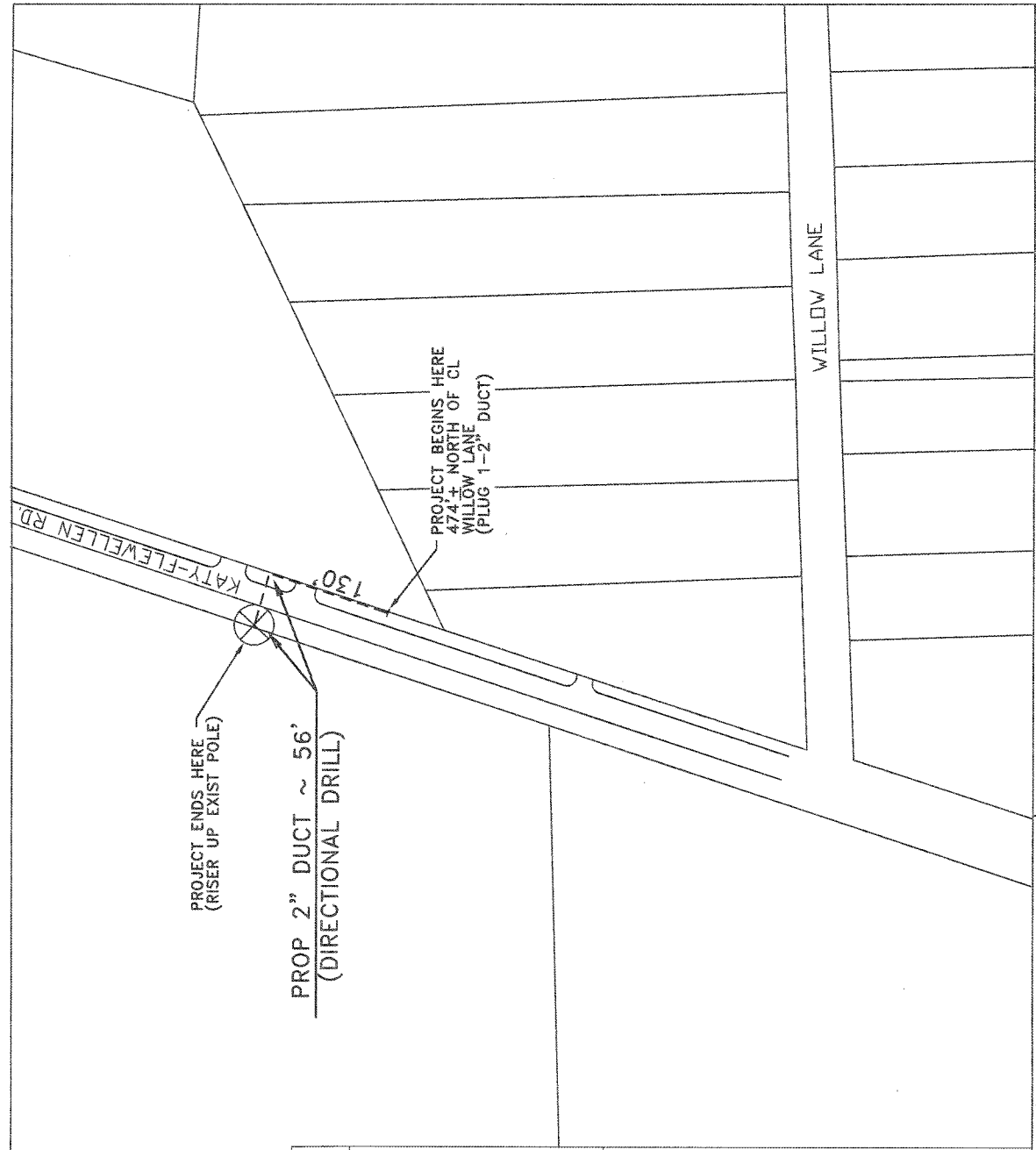

DESIGNED BY: JER, LLC
 DRAWN BY: CSH
 DWG. NO. JT-30033-3715 -- CARDIFF-VZW -- KATY-FLEWELLEN
 SHEET NO. 2 OF 3

LAMBERT: 425883
 DATE: 02/02/2016
 KEY MAP NO. 484-N
 SCALE: NTS

NOTE: CONTRACTOR SHALL BORE ALL DRIVEWAYS.

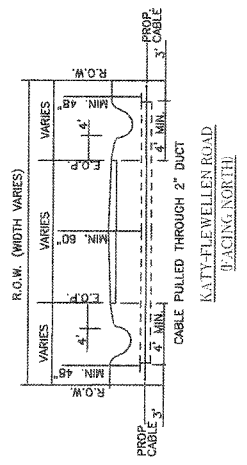

- NOTES :
1. THE CONTRACTOR SHALL CONTACT TEXAS ONE CALL SYSTEM AT 1-800-245-4949 MIN. 48 HOURS BEFORE DIGGING.
 2. THE CONTRACTOR SHALL DETERMINE THE EXACT LOCATION OF ALL UNDERGROUND FACILITIES BEFORE COMMENCING WORK AND AGREE TO BE FULLY RESPONSIBLE FOR ALL DAMAGES CAUSED BY HIS FAILURE TO EXACTLY LOCATE AND PRESERVE ALL UNDERGROUND FACILITIES.
 3. NO MORE TRENCH OPENED AT ONE TIME THAN CAN BE BACKFILLED AND COMPACTED IN 10" LIFTS AT THE END OF EACH DAY. (NO TRENCH LEFT OPENED OVERNIGHT)
 4. ALL EXCESS EXCAVATION TO BE REMOVED FROM THE ROAD RIGHT-OF-WAY AT THE END OF EACH DAY.
 5. DITCHES TO BE OPENED AT THE END OF EACH DAY TO ASSURE ADEQUATE DRAINAGE.
 6. ROAD MUST BE KEPT OPEN TO TRAFFIC AND CONTRACTOR MUST PROVIDE ADEQUATE FLAGMEN, SIGNALS, ETC., TO PROVIDE COMPLETE SAFETY TO THE PUBLIC.
 7. IF IT BECOMES NECESSARY FOR EQUIPMENT TO OPERATE ON A PORTION OF THE PAVEMENT, PRECAUTIONS MUST BE TAKEN TO PREVENT ANY DAMAGE WHATSOEVER TO THE PAVEMENT.
 8. CONDITION OF ROAD UPON COMPLETION OF JOB SHALL BE AS GOOD OR BETTER THAN PRIOR TO STARTING.
 9. CONTRACTOR SHALL COMPLY WITH ALL APPLICABLE NATIONAL ELECTRICAL SAFETY CODE (NEC) REQUIREMENTS, CENTERPOINT ENERGY ELECTRIC POLE ATTACHMENT GUIDELINES & PROCEDURES AND ALL APPLICABLE LOCAL REQUIREMENTS AND REGULATIONS FOR PLACEMENT OF AERIAL CABLE FACILITIES. 18" MIN. VERTICAL CLEARANCE.

COMCAST SHALL INSTALL A 1"-2" CONDUIT ALONG THE EAST ROW OF KATY-FLEWELLEN ROAD FROM 474 LF NORTH OF CL WILLOW LANE, NORTH FOR 130' TURNING EAST TO CROSS KATY-FLEWELLEN ROAD FOR A TOTAL DISTANCE OF 166 LF

Comcast
 7033 AIRPORT BLVD.
 HOUSTON, TX 77061-3912

