

**REVIEW BY FORT BEND COUNTY COMMISSIONERS COURT**

On this 5th day of January, 2016, Commissioners Court came on to be heard and reviewed the accompanying notice of Hurtado Construction  
Job Location Trails at Seabourne Park Section 3, Rosenberg, TX 77471  
 Date 12/7/2015 Bond No. 58S207278, Permit No. 2015-4448 to make use of certain Fort Bend County property subject to, "A Revised Order Regulating the Laying, Construction, Maintenance, and Repair of Buried Cables, Conduits, and Pole Lines, In, Under, Across or Along Roads, Streets, Highways, and Drainage Ditches in Fort Bend County, Texas, Under the Jurisdiction of the Commissioners Court of Fort Bend County, Texas," as passed by the Commissioners Court of Fort Bend County, Texas the 3rd day of August, 1987, recorded in Volume \_\_\_\_\_ of the Minutes of the Commissioners Court of Fort Bend County, Texas, to the extent that such order is not inconsistent with Article 1436a, Vernon's Texas Civil Statutes. Upon Motion of Commissioner Morris, seconded by Commissioner Patterson, duly put and carried, it is ORDERED, ADJUDGED AND DECREED that said notice of said above purpose is hereby acknowledged by the Commissioners Court of Fort Bend County, Texas, and that said notice be placed on record according to the regulation order thereof.

Notes:

1. Evidence of review by the Commissioners Court must be kept on the job site and failure to do so constitutes grounds for job shutdown.
2. Written notices are required:
  - a. 48 hours in advance of construction start up, and
  - b. when construction is completed and ready for final inspection
 Mail notices to: Permit Administrator  
 Fort Bend County Engineering  
 301 Jackson Street  
 Richmond, Texas 77469  
 281-633-7500
3. This permit expires one (1) year from date of permit if construction has not commenced.

By: Rick J. Stagle, PE, PTOE  
 Fort Bend County Engineer

Presented to Commissioners Court and approved.  
 Recorded in Volume 1-05-14  
 Minutes of Commissioners Court

By: Mark Vayb  
 Drainage District Engineer/Manager

Clerk of Commissioners Court  
 By: Aronda Willis  
 Deputy

# County of Fort Bend

Engineering Department

301 Jackson Street  
Richmond, Texas 77469

Johnny Ortega  
Permit Administrator

Phone: (281) 633-7500

## Permit Application Review Form For Cable, Conduit, and Pole Line Activity In Fort Bend County

Permit No. 2015-4448

The following "Notice of Proposed Cable, Conduit, and/or Pole Line activity in Fort Bend County" and accompanying attachments have been reviewed and the notice conforms to appropriate regulations set by Commissioner's Court of Fort Bend County, Texas.

- (1) Complete Application Form:
- a. Name of road, street, and/or drainage ditch affected.
  - b. Vicinity map showing course of directions
  - c. Plans and specifications
- (2) Bond:
- District Attorney, approval when applicable.  
Perpetual bond currently posted.
- No: \_\_\_\_\_  
Amount: \_\_\_\_\_
- Performance bond submitted.
- No: 58S207278  
Amount: \$10,000.00  
Cashier's Check
- No: \_\_\_\_\_  
Amount: \_\_\_\_\_
- (3) Verbal permission given for emergencies, to start construction before approved in Commissioner's Court.

\_\_\_\_\_  
Precinct Engineer Acknowledgment

\_\_\_\_\_  
Date

\_\_\_\_\_  
Precinct Commissioner Acknowledgment

\_\_\_\_\_  
Date

(4)

\_\_\_\_\_  
Drainage District Approval when applicable

**We have reviewed this project and agree it meets minimum requirements.**

 CFM  
\_\_\_\_\_  
Johnny Ortega CFM/Permit Administrator

  
\_\_\_\_\_  
Date



- 1. UNITS SPECIFICALLY LISTED IN THIS SECTION SHALL BE USED FOR THE CONTRACT. UNITS NOT SPECIFICALLY LISTED IN THIS SECTION SHALL BE USED FOR THE CONTRACT. UNITS NOT SPECIFICALLY LISTED IN THIS SECTION SHALL BE USED FOR THE CONTRACT.

WATER LINE CONSTRUCTION NOTES

- 1. ALL WATER MAINS SHALL BE 18" DIA. OR LARGER UNLESS OTHERWISE SPECIFIED. ALL WATER MAINS SHALL BE 18" DIA. OR LARGER UNLESS OTHERWISE SPECIFIED. ALL WATER MAINS SHALL BE 18" DIA. OR LARGER UNLESS OTHERWISE SPECIFIED.

SEWER CONSTRUCTION NOTES

- 1. ALL SEWER MAINS SHALL BE 18" DIA. OR LARGER UNLESS OTHERWISE SPECIFIED. ALL SEWER MAINS SHALL BE 18" DIA. OR LARGER UNLESS OTHERWISE SPECIFIED. ALL SEWER MAINS SHALL BE 18" DIA. OR LARGER UNLESS OTHERWISE SPECIFIED.

STORM SEWER CONSTRUCTION NOTES

- 1. ALL STORM SEWER MAINS SHALL BE 24" DIA. OR LARGER UNLESS OTHERWISE SPECIFIED. ALL STORM SEWER MAINS SHALL BE 24" DIA. OR LARGER UNLESS OTHERWISE SPECIFIED. ALL STORM SEWER MAINS SHALL BE 24" DIA. OR LARGER UNLESS OTHERWISE SPECIFIED.

PAVING CONSTRUCTION NOTES

- 1. ALL PAVING SHALL BE ACCORDING TO THE CITY OF ROSENBERG SPECIFICATIONS. ALL PAVING SHALL BE ACCORDING TO THE CITY OF ROSENBERG SPECIFICATIONS. ALL PAVING SHALL BE ACCORDING TO THE CITY OF ROSENBERG SPECIFICATIONS.

CEMENTERET ENERGY NOTES

- 1. ALL CEMENTERET ENERGY SHALL BE ACCORDING TO THE CITY OF ROSENBERG SPECIFICATIONS. ALL CEMENTERET ENERGY SHALL BE ACCORDING TO THE CITY OF ROSENBERG SPECIFICATIONS. ALL CEMENTERET ENERGY SHALL BE ACCORDING TO THE CITY OF ROSENBERG SPECIFICATIONS.

WATER UTILITY CONSTRUCTION NOTES

- 1. ALL WATER UTILITY CONSTRUCTION SHALL BE ACCORDING TO THE CITY OF ROSENBERG SPECIFICATIONS. ALL WATER UTILITY CONSTRUCTION SHALL BE ACCORDING TO THE CITY OF ROSENBERG SPECIFICATIONS. ALL WATER UTILITY CONSTRUCTION SHALL BE ACCORDING TO THE CITY OF ROSENBERG SPECIFICATIONS.

SEWER UTILITY CONSTRUCTION NOTES

- 1. ALL SEWER UTILITY CONSTRUCTION SHALL BE ACCORDING TO THE CITY OF ROSENBERG SPECIFICATIONS. ALL SEWER UTILITY CONSTRUCTION SHALL BE ACCORDING TO THE CITY OF ROSENBERG SPECIFICATIONS. ALL SEWER UTILITY CONSTRUCTION SHALL BE ACCORDING TO THE CITY OF ROSENBERG SPECIFICATIONS.

STORM UTILITY CONSTRUCTION NOTES

- 1. ALL STORM UTILITY CONSTRUCTION SHALL BE ACCORDING TO THE CITY OF ROSENBERG SPECIFICATIONS. ALL STORM UTILITY CONSTRUCTION SHALL BE ACCORDING TO THE CITY OF ROSENBERG SPECIFICATIONS. ALL STORM UTILITY CONSTRUCTION SHALL BE ACCORDING TO THE CITY OF ROSENBERG SPECIFICATIONS.

PAPE-DAWSON ENGINEERS logo and contact information: 93278 ROSENBERG, TEXAS 75080. P. 714.428.2600. F. 714.428.2601. WWW.PAPE-DAWSON.COM

CITY OF ROSENBERG logo and address: 1000 WEST 10TH STREET, ROSENBERG, TEXAS 75080. TEL: 714.428.2600. FAX: 714.428.2601. WWW.CITYOFROSENBERG.COM

CONSTRUCTION NOTES title block with project name: THE TRAILS AT SEABOURNE PARKE SECTION THREE, CITY OF ROSENBERG, TEXAS.

DATE: 08/06/2014, DRAWN BY: J. WILSON, CHECKED BY: J. WILSON, APPR. BY: J. WILSON, SHEET NO: 2 OF 27.



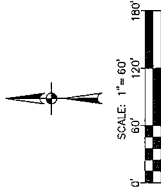
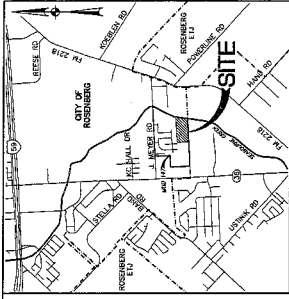

- LEGEND**
- EXISTING 1/4\"/>

- (A) RESTRICTED RESERVE "A"  
(RESTRICTED TO LANDSCAPE OR  
GRASS) PHASE 1 (REVISED 11/17/17)  
0.01 AC  
3/0/23.5/20/1
- (B) RESTRICTED RESERVE "B"  
(RESTRICTED TO URNANAGE  
LANDSCAPE) PHASE 2 (REVISED 11/17/17)  
4.13 AC  
3/0/23.5/20/1

LOI HOMES - TEXAS, LLC  
PORTION OF 87.141 ACRES  
CF NO. 2014051923 FECCOPR

FORT BEND COUNTY MUNICIPAL  
DECLARATION FOND EASEMENT  
CF NO. 2014010109  
FECCOPR

# FINAL FLAT THE TRAILS AT SEABOURNE PARKE SECTION THREE

A SUBDIVISION OF 24.68 ACRES  
LOCATED IN THE O.M. STONE 1/3 LEASE SURVEY, ABSTRACT 312  
CITY OF ROSENBERG, TEXAS  
(FORT BEND COUNTY MUNICIPAL UTILITY DISTRICT NO. 147)

97 LOTS 2 RESERVES 3 BLOCKS  
SCALE: 1" = 60' DATE: SEPTEMBER 17 2015

LOI HOMES-TEXAS, LLC, A TEXAS LIMITED LIABILITY COMPANY  
JACK LIPAR  
FOUNDRY PARTNERS, L.P.  
1450 JAY WALKER'S PARK, SUITE 430  
THE WOODLANDS, TEXAS 77380  
TEL: 281.364.2004

PAPE-DAWSON ENGINEERS  
11000 WEST 11TH STREET, SUITE 100  
HOUSTON, TEXAS 77036  
TEL: 281.416.1100

WAYNE L. REA, II &  
JOHN A. PFLUGER  
105216 ACRES  
CF NO. 2014051923 FECCOPR

THEODORE JANCAK  
51.76 ACRES  
CF NO. 2014051923 FECCOPR

**PAPE-DAWSON ENGINEERS**  
HOUSTON, TEXAS 77036  
TEL: 281.416.1100

105216 ACRES | HOUSTON, TEXAS 77036 | PHONE: 713.682.8200  
SUITE 100 | FAX: 713.682.8200  
STATE BOARD OF PROFESSIONAL LAND SURVEYORS REG. NO. 104349A  
SHEET NO. 4 of 27

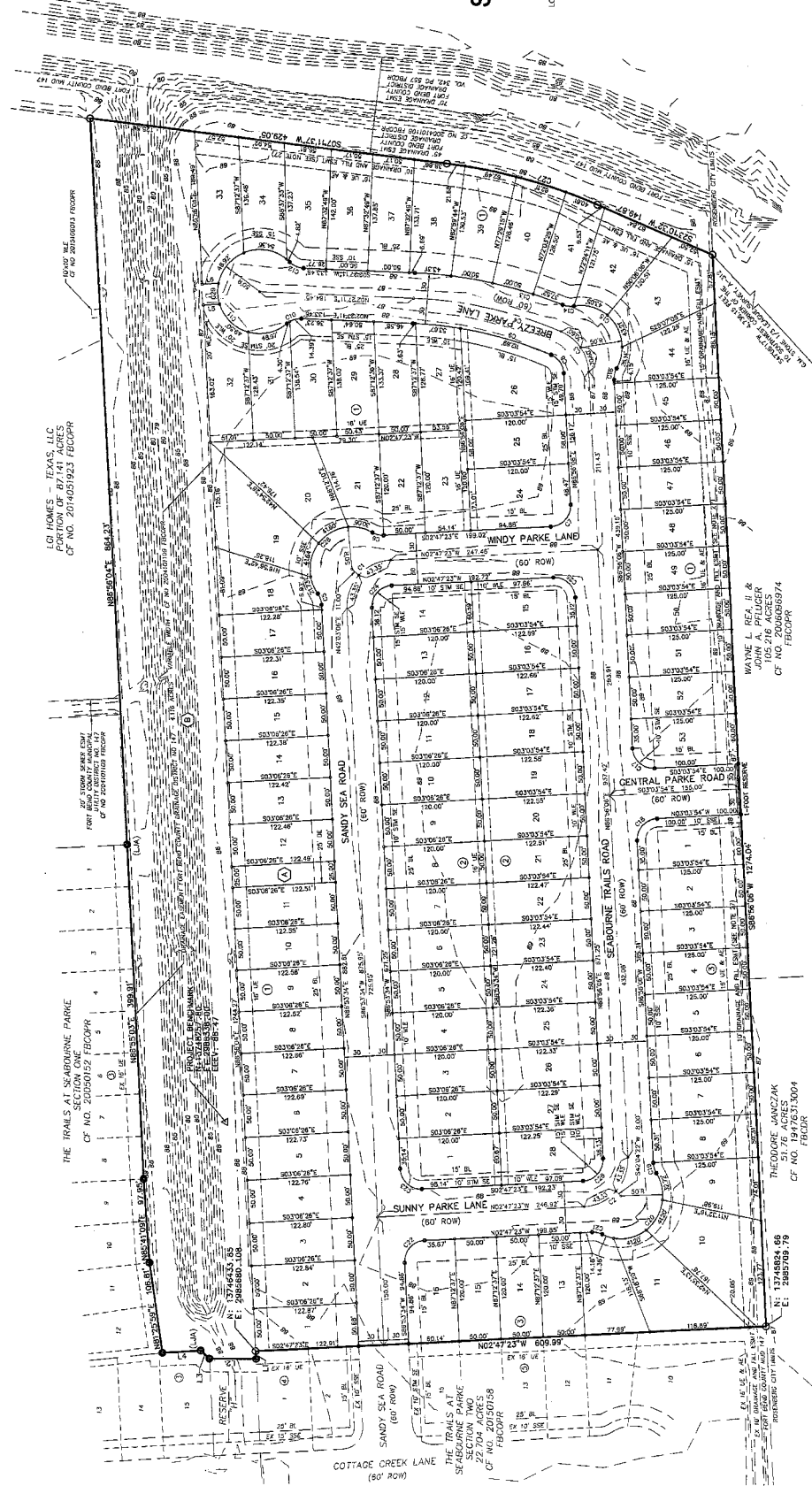

LOI HOMES - TEXAS, LLC  
PORTION OF 87.141 ACRES  
CF NO. 2014051923 FECCOPR

THE TRAILS AT SEABOURNE PARKE  
SECTION ONE  
CF NO. 20090152 FECCOPR

THE TRAILS AT  
SECTION TWO  
22.704 ACRES  
CF NO. 20150158  
FECCOPR

LOI HOMES - TEXAS, LLC  
PORTION OF 87.141 ACRES  
CF NO. 2014051923 FECCOPR

THEODORE JANCAK  
51.76 ACRES  
CF NO. 2014051923 FECCOPR

THEODORE JANCAK  
51.76 ACRES  
CF NO. 2014051923 FECCOPR

THIS DOCUMENT IS THE PROPERTY OF PAPE-DAWSON ENGINEERS. IT IS TO BE USED ONLY FOR THE PROJECT AND SITE SPECIFICALLY IDENTIFIED HEREIN. ANY OTHER USE IS PROHIBITED. PAPE-DAWSON ENGINEERS, INC. IS NOT RESPONSIBLE FOR ANY ERRORS OR OMISSIONS. THE USER ASSUMES ALL LIABILITY FOR ANY SUCH ERRORS OR OMISSIONS. THE USER SHALL INDEMNIFY AND HOLD PAPE-DAWSON ENGINEERS, INC. HARMLESS FROM ANY AND ALL SUCH CLAIMS, DAMAGES, LOSSES, AND EXPENSES, INCLUDING REASONABLE ATTORNEY'S FEES AND COSTS, THAT MAY BE ASSERTED AGAINST PAPE-DAWSON ENGINEERS, INC. BY ANY THIRD PARTY. THIS AGREEMENT SHALL BE GOVERNED BY THE LAWS OF THE STATE OF TEXAS. THE USER'S ACCEPTANCE OF THIS DOCUMENT SHALL CONSTITUTE ACCEPTANCE OF THESE TERMS AND CONDITIONS.



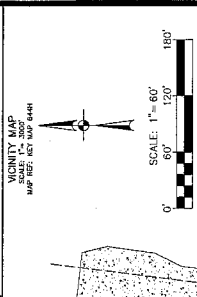
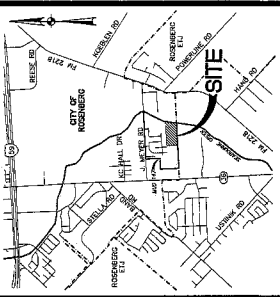

**NOTICE:** THIS PLAN IS PREPARED BY THE ENGINEER AND CONTRACTOR AND IS NOT TO BE USED FOR ANY OTHER PROJECT WITHOUT THE WRITTEN CONSENT OF THE ENGINEER AND CONTRACTOR.

**Pape-Dawson Engineers**  
 2033 ROSENBERG AVE. SUITE 100, ROSENBERG, TEXAS 77471  
 P.O. BOX 1000, ROSENBERG, TEXAS 77471  
 PHONE: 281-340-1100 FAX: 281-340-1101  
 WWW.PAPE-DAWSON.COM

NO.	DATE	REVISION	BY
1	10/16/15	ISSUE FOR PERMIT	AE

**THE TRAILS AT SEABOURNE PARKE SECTION THREE**  
 CITY OF ROSENBERG, TEXAS

**SANITARY SEWER LAYOUT**

**CITY OF ROSENBERG**  
 DEPARTMENT OF PUBLIC WORKS AND ENGINEERING

SHRINK SCALE: 1"=60'  
 SHEET NO: 6 OF 27

**LEGEND**

	PLAT BOUNDARY		RESTRICTED RESERVE
	EXISTING SEWER		BLOCK NUMBER
	EXISTING OVERHEAD ELECTRICAL LINE		SHEET REFERENCE NUMBER
	PROPOSED SANITARY SEWER		STREET NAME CHANGE
	EXISTING SANITARY SEWER SYSTEM		PROPOSED PEDESTRIAN RAMP
	PROPOSED WATER LINE		EXISTING PEDESTRIAN RAMP
	EXISTING WATER LINE SYSTEM		WATER LINE
	PROPOSED STORM SEWER		SANITARY SEWER
	EXISTING STORM SEWER		15' WALK
	6" SANITARY SEWER		15' WALK
	8" SANITARY SEWER		15' WALK
	12" SANITARY SEWER		15' WALK
	15" SANITARY SEWER		15' WALK
	18" SANITARY SEWER		15' WALK
	24" SANITARY SEWER		15' WALK
	30" SANITARY SEWER		15' WALK
	36" SANITARY SEWER		15' WALK
	42" SANITARY SEWER		15' WALK
	48" SANITARY SEWER		15' WALK
	54" SANITARY SEWER		15' WALK
	60" SANITARY SEWER		15' WALK
	72" SANITARY SEWER		15' WALK
	84" SANITARY SEWER		15' WALK
	96" SANITARY SEWER		15' WALK
	108" SANITARY SEWER		15' WALK
	120" SANITARY SEWER		15' WALK
	144" SANITARY SEWER		15' WALK
	180" SANITARY SEWER		15' WALK
	216" SANITARY SEWER		15' WALK
	252" SANITARY SEWER		15' WALK
	288" SANITARY SEWER		15' WALK
	324" SANITARY SEWER		15' WALK
	360" SANITARY SEWER		15' WALK
	432" SANITARY SEWER		15' WALK
	504" SANITARY SEWER		15' WALK
	576" SANITARY SEWER		15' WALK
	648" SANITARY SEWER		15' WALK
	720" SANITARY SEWER		15' WALK
	792" SANITARY SEWER		15' WALK
	864" SANITARY SEWER		15' WALK
	936" SANITARY SEWER		15' WALK
	1008" SANITARY SEWER		15' WALK
	1080" SANITARY SEWER		15' WALK
	1152" SANITARY SEWER		15' WALK
	1224" SANITARY SEWER		15' WALK
	1296" SANITARY SEWER		15' WALK
	1368" SANITARY SEWER		15' WALK
	1440" SANITARY SEWER		15' WALK
	1512" SANITARY SEWER		15' WALK
	1584" SANITARY SEWER		15' WALK
	1656" SANITARY SEWER		15' WALK
	1728" SANITARY SEWER		15' WALK
	1800" SANITARY SEWER		15' WALK
	1872" SANITARY SEWER		15' WALK
	1944" SANITARY SEWER		15' WALK
	2016" SANITARY SEWER		15' WALK
	2088" SANITARY SEWER		15' WALK
	2160" SANITARY SEWER		15' WALK
	2232" SANITARY SEWER		15' WALK
	2304" SANITARY SEWER		15' WALK
	2376" SANITARY SEWER		15' WALK
	2448" SANITARY SEWER		15' WALK
	2520" SANITARY SEWER		15' WALK
	2592" SANITARY SEWER		15' WALK
	2664" SANITARY SEWER		15' WALK
	2736" SANITARY SEWER		15' WALK
	2808" SANITARY SEWER		15' WALK
	2880" SANITARY SEWER		15' WALK
	2952" SANITARY SEWER		15' WALK
	3024" SANITARY SEWER		15' WALK
	3096" SANITARY SEWER		15' WALK
	3168" SANITARY SEWER		15' WALK
	3240" SANITARY SEWER		15' WALK
	3312" SANITARY SEWER		15' WALK
	3384" SANITARY SEWER		15' WALK
	3456" SANITARY SEWER		15' WALK
	3528" SANITARY SEWER		15' WALK
	3600" SANITARY SEWER		15' WALK
	3672" SANITARY SEWER		15' WALK
	3744" SANITARY SEWER		15' WALK
	3816" SANITARY SEWER		15' WALK
	3888" SANITARY SEWER		15' WALK
	3960" SANITARY SEWER		15' WALK
	4032" SANITARY SEWER		15' WALK
	4104" SANITARY SEWER		15' WALK
	4176" SANITARY SEWER		15' WALK
	4248" SANITARY SEWER		15' WALK
	4320" SANITARY SEWER		15' WALK
	4392" SANITARY SEWER		15' WALK
	4464" SANITARY SEWER		15' WALK
	4536" SANITARY SEWER		15' WALK
	4608" SANITARY SEWER		15' WALK
	4680" SANITARY SEWER		15' WALK
	4752" SANITARY SEWER		15' WALK
	4824" SANITARY SEWER		15' WALK
	4896" SANITARY SEWER		15' WALK
	4968" SANITARY SEWER		15' WALK
	5040" SANITARY SEWER		15' WALK
	5112" SANITARY SEWER		15' WALK
	5184" SANITARY SEWER		15' WALK
	5256" SANITARY SEWER		15' WALK
	5328" SANITARY SEWER		15' WALK
	5400" SANITARY SEWER		15' WALK
	5472" SANITARY SEWER		15' WALK
	5544" SANITARY SEWER		15' WALK
	5616" SANITARY SEWER		15' WALK
	5688" SANITARY SEWER		15' WALK
	5760" SANITARY SEWER		15' WALK
	5832" SANITARY SEWER		15' WALK
	5904" SANITARY SEWER		15' WALK
	5976" SANITARY SEWER		15' WALK
	6048" SANITARY SEWER		15' WALK
	6120" SANITARY SEWER		15' WALK
	6192" SANITARY SEWER		15' WALK
	6264" SANITARY SEWER		15' WALK
	6336" SANITARY SEWER		15' WALK
	6408" SANITARY SEWER		15' WALK
	6480" SANITARY SEWER		15' WALK
	6552" SANITARY SEWER		15' WALK
	6624" SANITARY SEWER		15' WALK
	6696" SANITARY SEWER		15' WALK
	6768" SANITARY SEWER		15' WALK
	6840" SANITARY SEWER		15' WALK
	6912" SANITARY SEWER		15' WALK
	6984" SANITARY SEWER		15' WALK
	7056" SANITARY SEWER		15' WALK
	7128" SANITARY SEWER		15' WALK
	7200" SANITARY SEWER		15' WALK
	7272" SANITARY SEWER		15' WALK
	7344" SANITARY SEWER		15' WALK
	7416" SANITARY SEWER		15' WALK
	7488" SANITARY SEWER		15' WALK
	7560" SANITARY SEWER		15' WALK
	7632" SANITARY SEWER		15' WALK
	7704" SANITARY SEWER		15' WALK
	7776" SANITARY SEWER		15' WALK
	7848" SANITARY SEWER		15' WALK
	7920" SANITARY SEWER		15' WALK
	7992" SANITARY SEWER		15' WALK
	8064" SANITARY SEWER		15' WALK
	8136" SANITARY SEWER		15' WALK
	8208" SANITARY SEWER		15' WALK
	8280" SANITARY SEWER		15' WALK
	8352" SANITARY SEWER		15' WALK
	8424" SANITARY SEWER		15' WALK
	8496" SANITARY SEWER		15' WALK
	8568" SANITARY SEWER		15' WALK
	8640" SANITARY SEWER		15' WALK
	8712" SANITARY SEWER		15' WALK
	8784" SANITARY SEWER		15' WALK
	8856" SANITARY SEWER		15' WALK
	8928" SANITARY SEWER		15' WALK
	9000" SANITARY SEWER		15' WALK
	9072" SANITARY SEWER		15' WALK
	9144" SANITARY SEWER		15' WALK
	9216" SANITARY SEWER		15' WALK
	9288" SANITARY SEWER		15' WALK
	9360" SANITARY SEWER		15' WALK
	9432" SANITARY SEWER		15' WALK
	9504" SANITARY SEWER		15' WALK







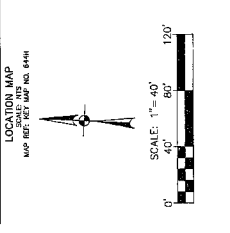
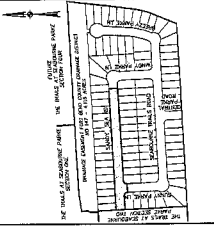

CONTRACTOR TO VERIFY ALL DIMENSIONS ON THE JOB. DIMENSIONS OF THIS PLAN SHALL BE GOVERNED BY THE FIELD SURVEY. THE CONTRACTOR SHALL BE RESPONSIBLE FOR OBTAINING ALL NECESSARY PERMITS FROM THE CITY OF ROSENBERG, TEXAS. THE CONTRACTOR SHALL BE RESPONSIBLE FOR OBTAINING ALL NECESSARY PERMITS FROM THE CITY OF ROSENBERG, TEXAS.

**PAPE-DAWSON ENGINEERS**  
 7714 GARDNER DRIVE, SUITE 100, ROSENBERG, TEXAS 77069  
 P.O. BOX 2000, ROSENBERG, TEXAS 77069  
 TEL: 281-282-2000 FAX: 281-282-2000 WWW.PAPE-DAWSON.COM

THE TRAILS AT SEABOURNE PARKE SECTION THREE  
 P&P - SANDY SEA ROAD  
 CITY OF ROSENBERG, TEXAS

CITY OF ROSENBERG  
 DEPARTMENT OF PUBLIC WORKS AND ENGINEERING

PROJECT NO. 10 OF 27  
 DRAWING SCALE: 1" = 40'  
 SHEET 1 OF 4

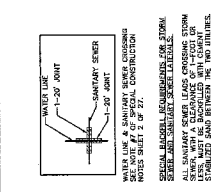

WATER METER SHALL BE SET ONE (1) FOOT INSIDE ROW OR IN ADJACENT WATER LINE EASEMENT.

CONTRACTOR TO TRANSFER CURB HEIGHT AT EACH INLET FROM EXISTING CONCRETE CURB TO TRANSITION TO NEW CONCRETE CURB. TRANSITION DETAIL ON SHEET 25 OF 27.

WATER LINE & SANITARY SEWER CROSSING UNDER SANDY SEA ROAD. ALL SANITARY SEWER LEADS CROSSING STORM SEWER MUST BE PROTECTED WITH CORROSION RESISTANT MATERIAL. ALL SANITARY SEWER LEADS CROSSING STORM SEWER MUST BE PROTECTED WITH CORROSION RESISTANT MATERIAL. ALL SANITARY SEWER LEADS CROSSING STORM SEWER MUST BE PROTECTED WITH CORROSION RESISTANT MATERIAL.

WATER SERVICE LEAD: 1. SINGLE SERVICE LEAD, 2. CONNECTION TO EXISTING WATER MAIN, 3. 2" x 1/2" W/ 1/2" VALVE BOXES.

CONTRACTOR TO VERIFY ALL DIMENSIONS ON THE JOB. DIMENSIONS OF THIS PLAN SHALL BE GOVERNED BY THE FIELD SURVEY. THE CONTRACTOR SHALL BE RESPONSIBLE FOR OBTAINING ALL NECESSARY PERMITS FROM THE CITY OF ROSENBERG, TEXAS.

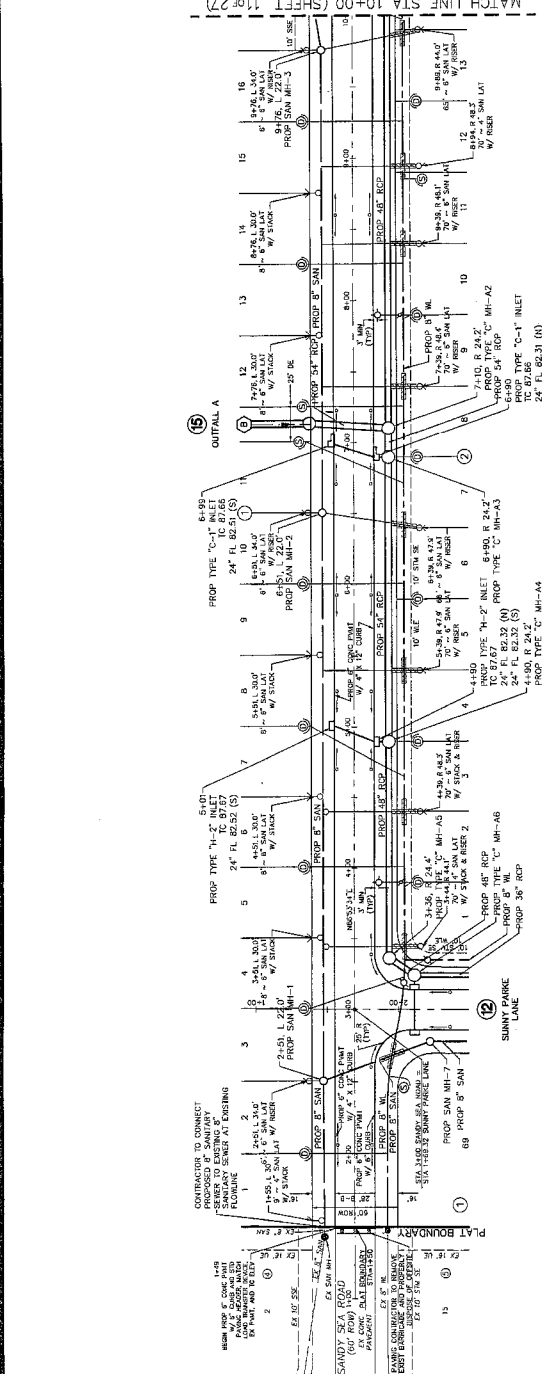

STATION	PIPE SIZE	PIPE TYPE	DEPTH	INVERT ELEVATION	OUTLET ELEVATION	MANHOLE ELEVATION	MANHOLE TYPE	MANHOLE SIZE	MANHOLE MATERIAL	MANHOLE SPACING	MANHOLE COMMENTS
1+00	12"	PROP 12" x 12" MANHOLE	1'-0"	77.82	77.82	77.82	PROP 12" x 12" MANHOLE	12"	CONCRETE	12'	PROP 12" x 12" MANHOLE
2+00	12"	PROP 12" x 12" MANHOLE	1'-0"	77.82	77.82	77.82	PROP 12" x 12" MANHOLE	12"	CONCRETE	12'	PROP 12" x 12" MANHOLE
3+00	12"	PROP 12" x 12" MANHOLE	1'-0"	77.82	77.82	77.82	PROP 12" x 12" MANHOLE	12"	CONCRETE	12'	PROP 12" x 12" MANHOLE
4+00	12"	PROP 12" x 12" MANHOLE	1'-0"	77.82	77.82	77.82	PROP 12" x 12" MANHOLE	12"	CONCRETE	12'	PROP 12" x 12" MANHOLE
5+00	12"	PROP 12" x 12" MANHOLE	1'-0"	77.82	77.82	77.82	PROP 12" x 12" MANHOLE	12"	CONCRETE	12'	PROP 12" x 12" MANHOLE
6+00	12"	PROP 12" x 12" MANHOLE	1'-0"	77.82	77.82	77.82	PROP 12" x 12" MANHOLE	12"	CONCRETE	12'	PROP 12" x 12" MANHOLE
7+00	12"	PROP 12" x 12" MANHOLE	1'-0"	77.82	77.82	77.82	PROP 12" x 12" MANHOLE	12"	CONCRETE	12'	PROP 12" x 12" MANHOLE
8+00	12"	PROP 12" x 12" MANHOLE	1'-0"	77.82	77.82	77.82	PROP 12" x 12" MANHOLE	12"	CONCRETE	12'	PROP 12" x 12" MANHOLE
9+00	12"	PROP 12" x 12" MANHOLE	1'-0"	77.82	77.82	77.82	PROP 12" x 12" MANHOLE	12"	CONCRETE	12'	PROP 12" x 12" MANHOLE
10+00	12"	PROP 12" x 12" MANHOLE	1'-0"	77.82	77.82	77.82	PROP 12" x 12" MANHOLE	12"	CONCRETE	12'	PROP 12" x 12" MANHOLE

CONTRACTOR TO VERIFY ALL DIMENSIONS ON THE JOB. DIMENSIONS OF THIS PLAN SHALL BE GOVERNED BY THE FIELD SURVEY. THE CONTRACTOR SHALL BE RESPONSIBLE FOR OBTAINING ALL NECESSARY PERMITS FROM THE CITY OF ROSENBERG, TEXAS.





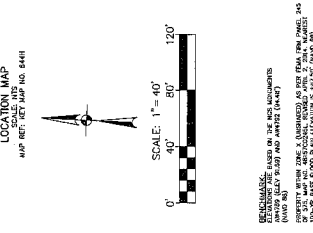
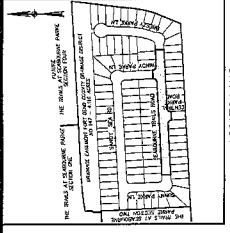

WATER SERVICE LAYOUT  
 MATCH LINE STA 14+00 (SHEET 14 OF 27)

NO.	DATE	REVISION
1		ISSUED FOR PERMITS

**PAPE-DAWSON ENGINEERS**  
 1000 BROADWAY, SUITE 200, HOUSTON, TEXAS 77002  
 PHONE: 713-621-1100 FAX: 713-621-1101  
 WWW.PAPE-DAWSON.COM

PROJECT: SEABOURNE TRAILS ROAD WATER MAIN  
 SHEET NO. 13 OF 27

CITY OF ROSENBERG  
 DEPARTMENT OF PUBLIC WORKS AND ENGINEERING

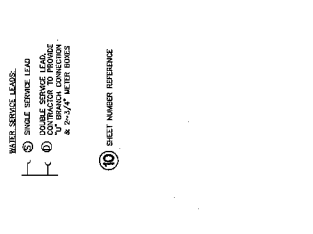
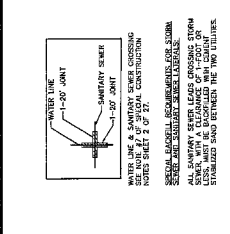

WATER MAIN SHALL BE SET ONE (1) FOOT INSIDE EACH INLET FROM 4" TO 6" BEGINNING TO EITHER END OF TRANSITION TO CURB. TRANSITION DETAIL ON SHEET 25 OF 27.

NO.	DATE	REVISION
1		ISSUED FOR PERMITS

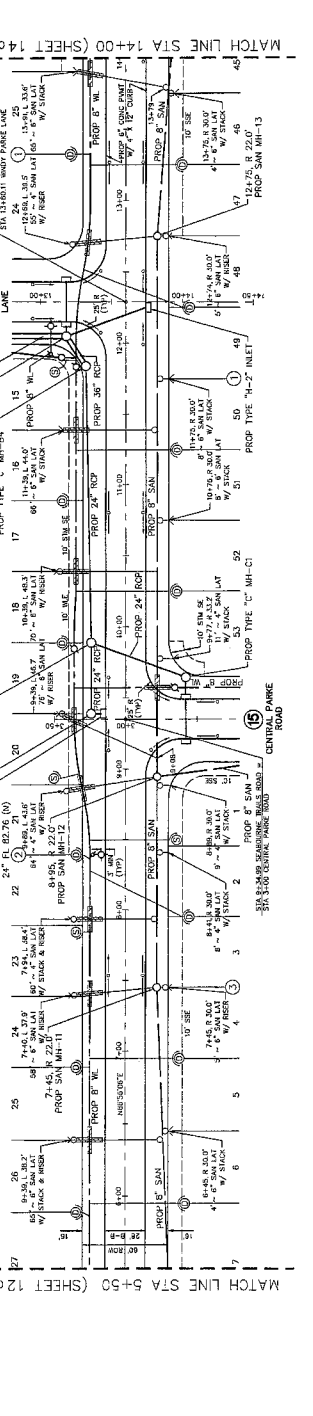
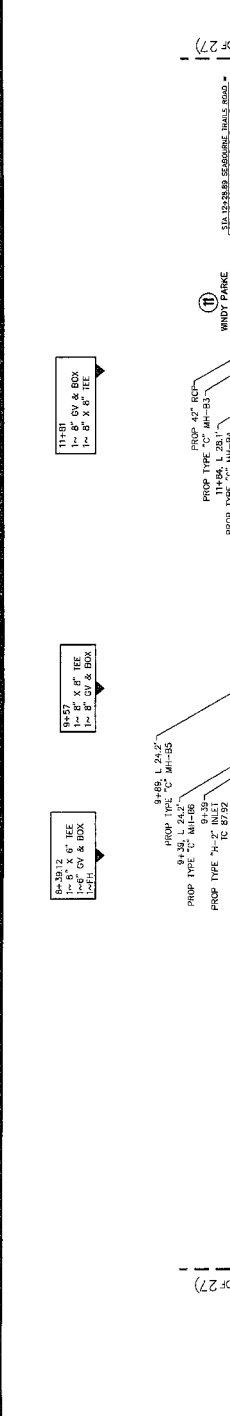

WATER MAIN SHALL BE SET ONE (1) FOOT INSIDE EACH INLET FROM 4" TO 6" BEGINNING TO EITHER END OF TRANSITION TO CURB. TRANSITION DETAIL ON SHEET 25 OF 27.

NO.	DATE	REVISION
1		ISSUED FOR PERMITS





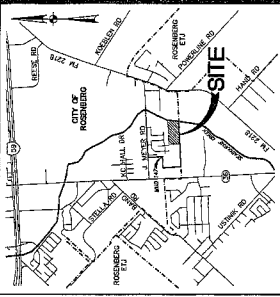

**VICINITY MAP**  
MAP REF: REC 400 844

SCALE: 1" = 60'  
0' 60' 120' 180'

**LEGEND:**  
 - X (with circle) - PROPOSED 6" x 6" SANDY SEA ROAD AT BACK OF CLUB  
 - (with circle) - STABILIZED CONSTRUCTION EXIT  
 - (with circle) - INLET PROTECTION  
 - (with circle) - IMPROVEMENT ON CONSTRUCTION PHASE  
 - (with circle) - ROCK FILTER DAM - TYPE 2  
 - (with circle) - CONCRETE TRUCK WASHOUT AREA

NO.	DATE	REVISION	BY	APP'D

**PAPE-DAWSON ENGINEERS**  
 4325 ROSBORN BLVD. SUITE 100, ROSBORN, TEXAS 75087  
 P: 774.622.2000 F: 774.622.2000 WWW.PAPE-DAWSON.COM

*Handwritten:* 4/16/17

LEI HOMES - TEXAS, LLC  
 87.141 ACRES  
 CF NO. 2014051923

**THE TRAILS AT SEABOURNE PARKE SECTION THREE**  
 CITY OF ROSENDORN, TEXAS

**STORM WATER POLLUTION PREVENTION PLAN**

**CITY OF ROSENBERG**  
 DEPARTMENT OF PUBLIC WORKS AND ENGINEERING

200410109  
 FBCOPR

**LEGEND**

- PLAT BOUNDARY
- EXISTING COUNTRY
- PROPOSED PAVEMENT W/CONC CURB
- EXISTING/PROPOSED PAVEMENT
- DRAIN INLET
- RESTRICTED RESERVE
- BLOCK NUMBER
- CD# TYPE IS SHOWN
- STREET NAME CHANGE

- CONTRACTOR IS RESPONSIBLE FOR COMPLYING WITH ALL APPLICABLE ENVIRONMENTAL REGULATIONS AND PERMITS.
- CONTRACTOR IS RESPONSIBLE FOR PROVIDING ADEQUATE MAINTENANCE SANITARY FACILITIES.
- CONTRACTOR SHALL MAINTAIN, REPAIR AND/OR REPLACE DAMAGED EROSION AND SEDIMENTATION CONTROL SYSTEMS THROUGHOUT THE DURATION OF THE PROJECT.
- CONTRACTOR SHALL MAINTAIN, REPAIR AND/OR REPLACE DAMAGED EROSION AND SEDIMENTATION CONTROL SYSTEMS THROUGHOUT THE DURATION OF THE PROJECT.
- SIX MONTHS, FERTILIZER AND OTHER POTENTIALLY TOXIC MATERIALS.
- CONTRACTOR SHALL LOCATE, LABEL AND/OR MARK STAKE AREAS FROM SURVEY WHEN STAKE MARKS ARE NOT AVAILABLE. CONTRACTOR SHALL USE ALUMINUM PINE STAKE, 1/2" DIA. OR STAKE AND FLAG TO IDENTIFY STAKE AREAS.
- CONTRACTOR SHALL MAINTAIN ACCESS TO ALL UTILITIES, WATER MAINS, AND ANY OTHER UTILITIES OR STRUCTURES ON THE PROJECT/CONSTRUCTION AREA AND THE ADJACENT AREAS.
- CONTAMINATED LOADS ARE A LEGALLY APPROVED METHOD.

- CONTRACTOR SHALL PROVIDE A STABILIZED CONSTRUCTION EXIT.
- CONTRACTOR SHALL MAINTAIN, REPAIR AND/OR REPLACE DAMAGED EROSION AND SEDIMENTATION CONTROL SYSTEMS THROUGHOUT THE DURATION OF THE PROJECT.
- CONTRACTOR SHALL MAINTAIN, REPAIR AND/OR REPLACE DAMAGED EROSION AND SEDIMENTATION CONTROL SYSTEMS THROUGHOUT THE DURATION OF THE PROJECT.
- CONTRACTOR SHALL MAINTAIN, REPAIR AND/OR REPLACE DAMAGED EROSION AND SEDIMENTATION CONTROL SYSTEMS THROUGHOUT THE DURATION OF THE PROJECT.
- CONTRACTOR SHALL MAINTAIN, REPAIR AND/OR REPLACE DAMAGED EROSION AND SEDIMENTATION CONTROL SYSTEMS THROUGHOUT THE DURATION OF THE PROJECT.
- CONTRACTOR SHALL MAINTAIN, REPAIR AND/OR REPLACE DAMAGED EROSION AND SEDIMENTATION CONTROL SYSTEMS THROUGHOUT THE DURATION OF THE PROJECT.
- CONTRACTOR SHALL MAINTAIN, REPAIR AND/OR REPLACE DAMAGED EROSION AND SEDIMENTATION CONTROL SYSTEMS THROUGHOUT THE DURATION OF THE PROJECT.
- CONTRACTOR SHALL MAINTAIN, REPAIR AND/OR REPLACE DAMAGED EROSION AND SEDIMENTATION CONTROL SYSTEMS THROUGHOUT THE DURATION OF THE PROJECT.
- CONTRACTOR SHALL MAINTAIN, REPAIR AND/OR REPLACE DAMAGED EROSION AND SEDIMENTATION CONTROL SYSTEMS THROUGHOUT THE DURATION OF THE PROJECT.
- CONTRACTOR SHALL MAINTAIN, REPAIR AND/OR REPLACE DAMAGED EROSION AND SEDIMENTATION CONTROL SYSTEMS THROUGHOUT THE DURATION OF THE PROJECT.

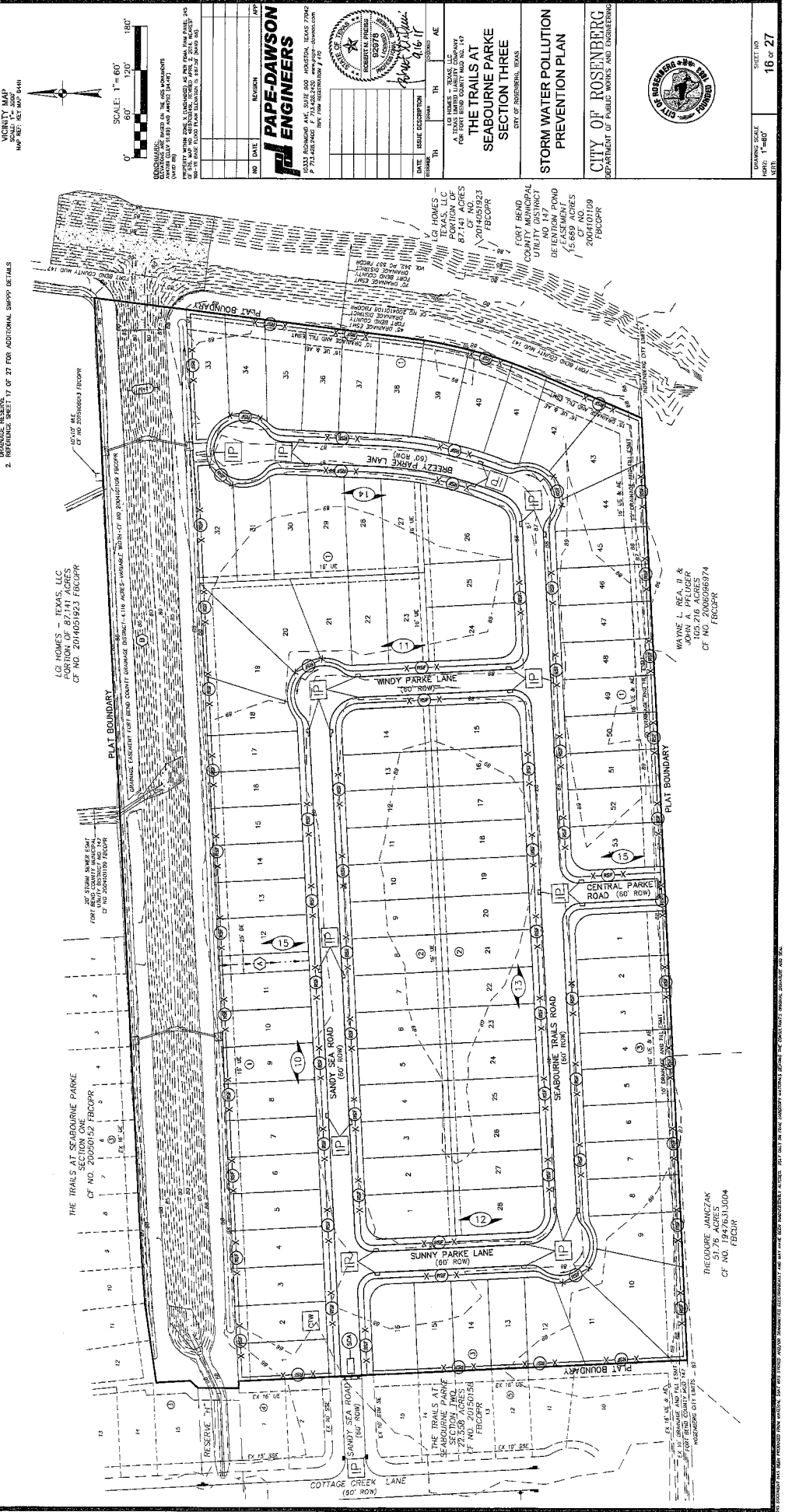

LEI HOMES - TEXAS, LLC  
 PORTION OF 87.141 ACRES  
 CF NO. 2014051923 FBCOPR

LEI HOMES - TEXAS, LLC  
 87.141 ACRES  
 CF NO. 2014051923 FBCOPR

FORT BEND COUNTY MUNICIPAL JUDICIAL DISTRICT  
 DEED BOOK NO. 147  
 PAGE 15, 16, 17, 18, 19, 20, 21, 22, 23, 24, 25, 26, 27, 28, 29, 30, 31, 32, 33, 34, 35, 36, 37, 38, 39, 40, 41, 42, 43, 44, 45, 46, 47, 48, 49, 50, 51, 52, 53, 54, 55, 56, 57, 58, 59, 60, 61, 62, 63, 64, 65, 66, 67, 68, 69, 70, 71, 72, 73, 74, 75, 76, 77, 78, 79, 80, 81, 82, 83, 84, 85, 86, 87, 88, 89, 90, 91, 92, 93, 94, 95, 96, 97, 98, 99, 100, 101, 102, 103, 104, 105, 106, 107, 108, 109, 110, 111, 112, 113, 114, 115, 116, 117, 118, 119, 120, 121, 122, 123, 124, 125, 126, 127, 128, 129, 130, 131, 132, 133, 134, 135, 136, 137, 138, 139, 140, 141, 142, 143, 144, 145, 146, 147, 148, 149, 150, 151, 152, 153, 154, 155, 156, 157, 158, 159, 160, 161, 162, 163, 164, 165, 166, 167, 168, 169, 170, 171, 172, 173, 174, 175, 176, 177, 178, 179, 180, 181, 182, 183, 184, 185, 186, 187, 188, 189, 190, 191, 192, 193, 194, 195, 196, 197, 198, 199, 200, 201, 202, 203, 204, 205, 206, 207, 208, 209, 210, 211, 212, 213, 214, 215, 216, 217, 218, 219, 220, 221, 222, 223, 224, 225, 226, 227, 228, 229, 230, 231, 232, 233, 234, 235, 236, 237, 238, 239, 240, 241, 242, 243, 244, 245, 246, 247, 248, 249, 250, 251, 252, 253, 254, 255, 256, 257, 258, 259, 260, 261, 262, 263, 264, 265, 266, 267, 268, 269, 270, 271, 272, 273, 274, 275, 276, 277, 278, 279, 280, 281, 282, 283, 284, 285, 286, 287, 288, 289, 290, 291, 292, 293, 294, 295, 296, 297, 298, 299, 300, 301, 302, 303, 304, 305, 306, 307, 308, 309, 310, 311, 312, 313, 314, 315, 316, 317, 318, 319, 320, 321, 322, 323, 324, 325, 326, 327, 328, 329, 330, 331, 332, 333, 334, 335, 336, 337, 338, 339, 340, 341, 342, 343, 344, 345, 346, 347, 348, 349, 350, 351, 352, 353, 354, 355, 356, 357, 358, 359, 360, 361, 362, 363, 364, 365, 366, 367, 368, 369, 370, 371, 372, 373, 374, 375, 376, 377, 378, 379, 380, 381, 382, 383, 384, 385, 386, 387, 388, 389, 390, 391, 392, 393, 394, 395, 396, 397, 398, 399, 400, 401, 402, 403, 404, 405, 406, 407, 408, 409, 410, 411, 412, 413, 414, 415, 416, 417, 418, 419, 420, 421, 422, 423, 424, 425, 426, 427, 428, 429, 430, 431, 432, 433, 434, 435, 436, 437, 438, 439, 440, 441, 442, 443, 444, 445, 446, 447, 448, 449, 450, 451, 452, 453, 454, 455, 456, 457, 458, 459, 460, 461, 462, 463, 464, 465, 466, 467, 468, 469, 470, 471, 472, 473, 474, 475, 476, 477, 478, 479, 480, 481, 482, 483, 484, 485, 486, 487, 488, 489, 490, 491, 492, 493, 494, 495, 496, 497, 498, 499, 500, 501, 502, 503, 504, 505, 506, 507, 508, 509, 510, 511, 512, 513, 514, 515, 516, 517, 518, 519, 520, 521, 522, 523, 524, 525, 526, 527, 528, 529, 530, 531, 532, 533, 534, 535, 536, 537, 538, 539, 540, 541, 542, 543, 544, 545, 546, 547, 548, 549, 550, 551, 552, 553, 554, 555, 556, 557, 558, 559, 560, 561, 562, 563, 564, 565, 566, 567, 568, 569, 570, 571, 572, 573, 574, 575, 576, 577, 578, 579, 580, 581, 582, 583, 584, 585, 586, 587, 588, 589, 590, 591, 592, 593, 594, 595, 596, 597, 598, 599, 600, 601, 602, 603, 604, 605, 606, 607, 608, 609, 610, 611, 612, 613, 614, 615, 616, 617, 618, 619, 620, 621, 622, 623, 624, 625, 626, 627, 628, 629, 630, 631, 632, 633, 634, 635, 636, 637, 638, 639, 640, 641, 642, 643, 644, 645, 646, 647, 648, 649, 650, 651, 652, 653, 654, 655, 656, 657, 658, 659, 660, 661, 662, 663, 664, 665, 666, 667, 668, 669, 670, 671, 672, 673, 674, 675, 676, 677, 678, 679, 680, 681, 682, 683, 684, 685, 686, 687, 688, 689, 690, 691, 692, 693, 694, 695, 696, 697, 698, 699, 700, 701, 702, 703, 704, 705, 706, 707, 708, 709, 710, 711, 712, 713, 714, 715, 716, 717, 718, 719, 720, 721, 722, 723, 724, 725, 726, 727, 728, 729, 730, 731, 732, 733, 734, 735, 736, 737, 738, 739, 740, 741, 742, 743, 744, 745, 746, 747, 748, 749, 750, 751, 752, 753, 754, 755, 756, 757, 758, 759, 760, 761, 762, 763, 764, 765, 766, 767, 768, 769, 770, 771, 772, 773, 774, 775, 776, 777, 778, 779, 780, 781, 782, 783, 784, 785, 786, 787, 788, 789, 790, 791, 792, 793, 794, 795, 796, 797, 798, 799, 800, 801, 802, 803, 804, 805, 806, 807, 808, 809, 810, 811, 812, 813, 814, 815, 816, 817, 818, 819, 820, 821, 822, 823, 824, 825, 826, 827, 828, 829, 830, 831, 832, 833, 834, 835, 836, 837, 838, 839, 840, 841, 842, 843, 844, 845, 846, 847, 848, 849, 850, 851, 852, 853, 854, 855, 856, 857, 858, 859, 860, 861, 862, 863, 864, 865, 866, 867, 868, 869, 870, 871, 872, 873, 874, 875, 876, 877, 878, 879, 880, 881, 882, 883, 884, 885, 886, 887, 888, 889, 890, 891, 892, 893, 894, 895, 896, 897, 898, 899, 900, 901, 902, 903, 904, 905, 906, 907, 908, 909, 910, 911, 912, 913, 914, 915, 916, 917, 918, 919, 920, 921, 922, 923, 924, 925, 926, 927, 928, 929, 930, 931, 932, 933, 934, 935, 936, 937, 938, 939, 940, 941, 942, 943, 944, 945, 946, 947, 948, 949, 950, 951, 952, 953, 954, 955, 956, 957, 958, 959, 960, 961, 962, 963, 964, 965, 966, 967, 968, 969, 970, 971, 972, 973, 974, 975, 976, 977, 978, 979, 980, 981, 982, 983, 984, 985, 986, 987, 988, 989, 990, 991, 992, 993, 994, 995, 996, 997, 998, 999, 1000

**PAPE-DAWSON ENGINEERS**  
 1400 BIRMINGHAM AVE. SUITE 500 INDUSTRIAL PARK ZONE  
 47102-1000 MOBILE, ALABAMA  
 PHONE (334) 833-7000 FAX (334) 833-7001  
 WWW.PAPE-DAWSON.COM

NO. DATE REVISION APP.  
 \_\_\_\_\_  
 \_\_\_\_\_  
 \_\_\_\_\_

REGISTERED PROFESSIONAL ENGINEER  
 STATE OF ALABAMA  
 LICENSE NO. 10000  
 EXPIRES 12/31/2024

DATE: 08/11/2023  
 SHEET NO. 17 OF 27

PROJECT: THE TRAILS AT SEABOURNE PARKE SECTION THREE  
 CITY OF ROSENBERG, TEXAS

STORM WATER POLLUTION PREVENTION PLAN DETAILS

CITY OF ROSENBERG  
 DEPARTMENT OF PUBLIC WORKS AND ENGINEERING

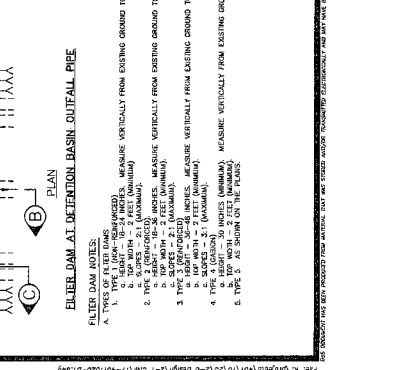
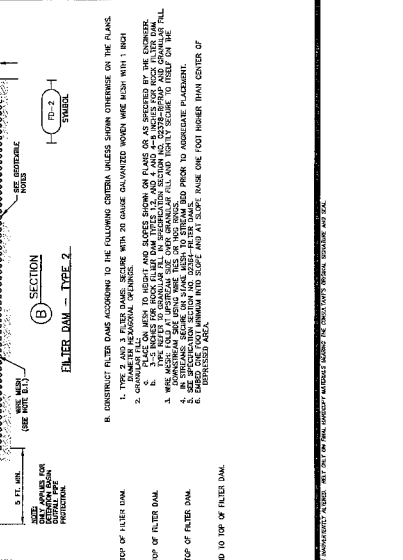
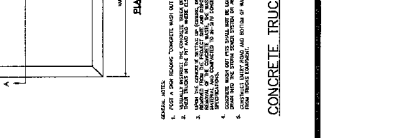
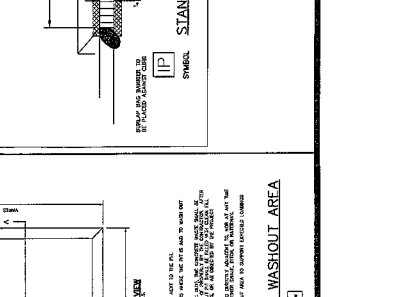
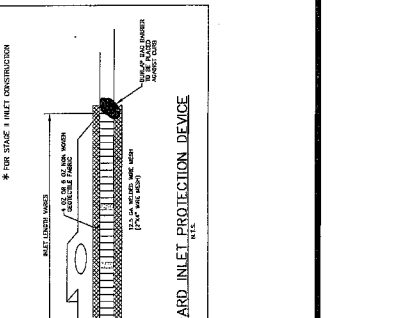
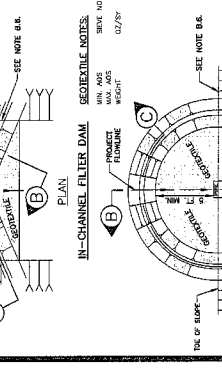
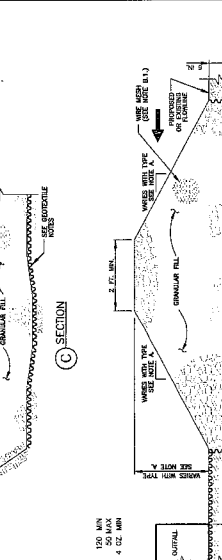
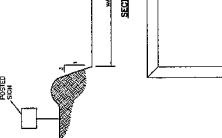
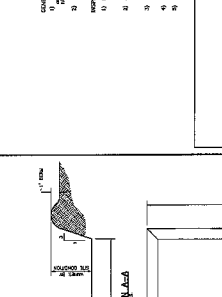
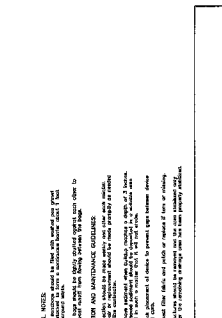
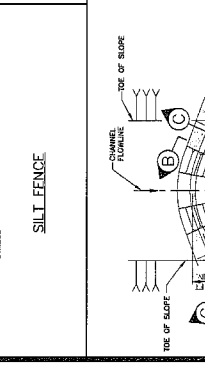
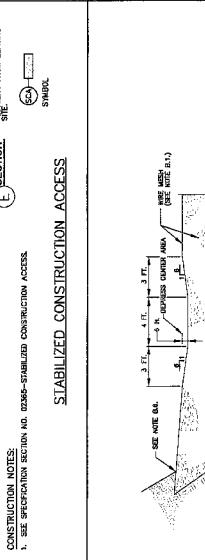
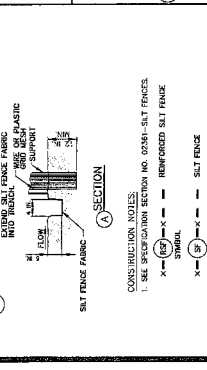
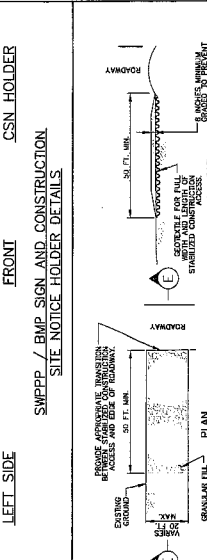
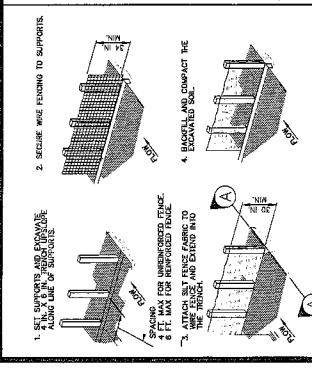
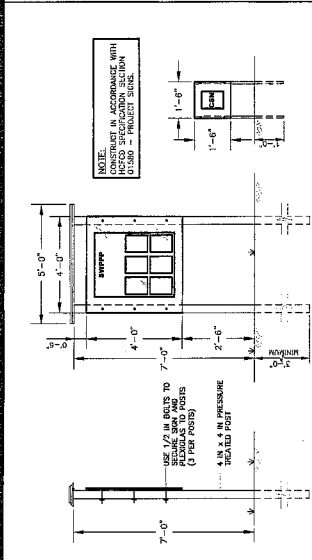
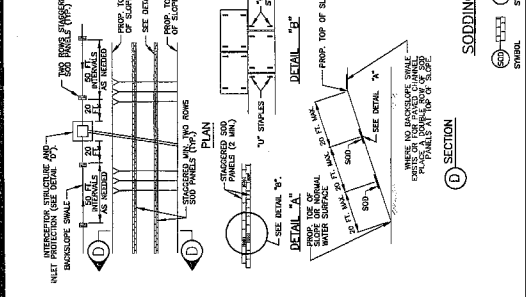
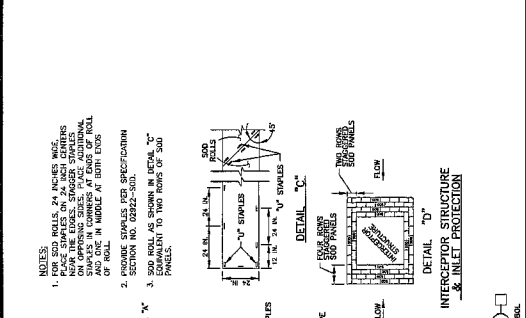

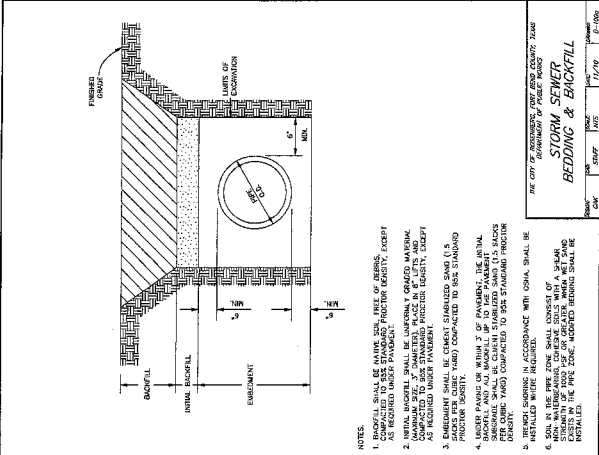

**NOTES:**

- BRICK FALL SHALL BE MAJOR SIZE PIPE OF BRICK COMPACTED TO AVOID STANDARD PROCTOR DENSITY, EXCEPT AS NOTED OTHERWISE.
- BRICK FALL SHALL BE MAJOR SIZE GRADED MATERIAL (MINIMUM SIZE 3/4" FINISHING GRADE IN 2' LOTS AND COMPACTED TO STANDARD PROCTOR DENSITY, EXCEPT AS NOTED UNDER PAVEMENT.)
- EMBANKMENT SHALL BE COURSE STABILIZED SAND (1.5 UNDER PAVEMENT OR WITHIN 3" OF PAVEMENT, THE REMAINING SAND SHALL BE COURSE STABILIZED SAND (1.5 SANDS DENSITY) AND COMPACTED TO AVOID STANDARD PROCTOR DENSITY.
- INTERVALS SPACING IN ACCORDANCE WITH OSHA, SHALL BE 4'.
- SIZE IN THE PIPE ZONE SHALL CONSIST OF NON-REINFORCED CONCRETE WITH A REINFORCED CONCRETE BEDDING SHALL BE SPECIFIED IN THE PIPE ZONE, INDICATED BEDDING SHALL BE SPECIFIED.

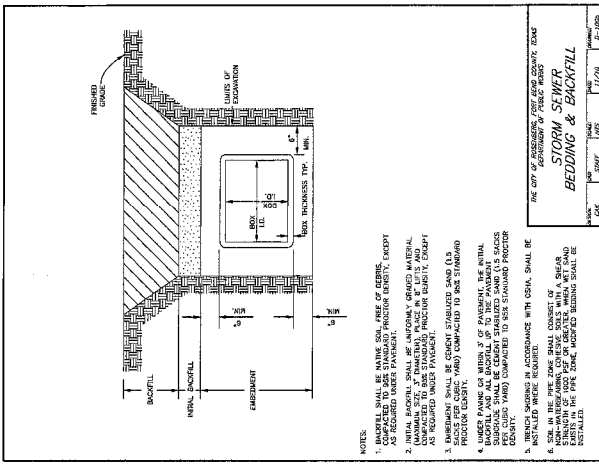

**NOTES:**

- BRICK FALL SHALL BE MAJOR SIZE PIPE OF BRICK COMPACTED TO AVOID STANDARD PROCTOR DENSITY, EXCEPT AS NOTED OTHERWISE.
- BRICK FALL SHALL BE MAJOR SIZE GRADED MATERIAL (MINIMUM SIZE 3/4" FINISHING GRADE IN 2' LOTS AND COMPACTED TO STANDARD PROCTOR DENSITY, EXCEPT AS NOTED UNDER PAVEMENT.)
- EMBANKMENT SHALL BE COURSE STABILIZED SAND (1.5 UNDER PAVEMENT OR WITHIN 3" OF PAVEMENT, THE REMAINING SAND SHALL BE COURSE STABILIZED SAND (1.5 SANDS DENSITY) AND COMPACTED TO AVOID STANDARD PROCTOR DENSITY.
- INTERVALS SPACING IN ACCORDANCE WITH OSHA, SHALL BE 4'.
- SIZE IN THE PIPE ZONE SHALL CONSIST OF NON-REINFORCED CONCRETE WITH A REINFORCED CONCRETE BEDDING SHALL BE SPECIFIED IN THE PIPE ZONE, INDICATED BEDDING SHALL BE SPECIFIED.

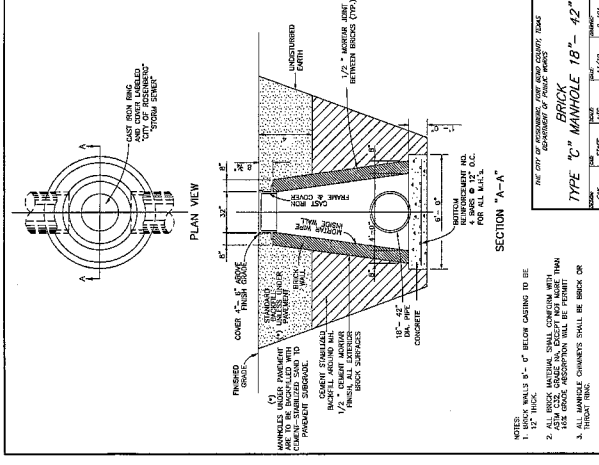

**NOTES:**

- BRICK FALL SHALL BE MAJOR SIZE PIPE OF BRICK COMPACTED TO AVOID STANDARD PROCTOR DENSITY, EXCEPT AS NOTED OTHERWISE.
- BRICK FALL SHALL BE MAJOR SIZE GRADED MATERIAL (MINIMUM SIZE 3/4" FINISHING GRADE IN 2' LOTS AND COMPACTED TO STANDARD PROCTOR DENSITY, EXCEPT AS NOTED UNDER PAVEMENT.)
- EMBANKMENT SHALL BE COURSE STABILIZED SAND (1.5 UNDER PAVEMENT OR WITHIN 3" OF PAVEMENT, THE REMAINING SAND SHALL BE COURSE STABILIZED SAND (1.5 SANDS DENSITY) AND COMPACTED TO AVOID STANDARD PROCTOR DENSITY.
- INTERVALS SPACING IN ACCORDANCE WITH OSHA, SHALL BE 4'.
- SIZE IN THE PIPE ZONE SHALL CONSIST OF NON-REINFORCED CONCRETE WITH A REINFORCED CONCRETE BEDDING SHALL BE SPECIFIED IN THE PIPE ZONE, INDICATED BEDDING SHALL BE SPECIFIED.

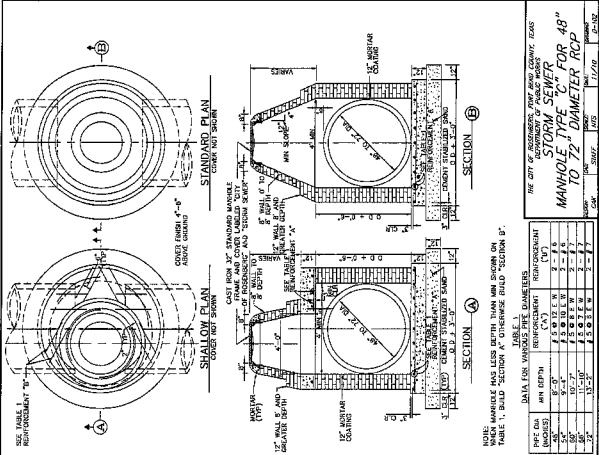

**NOTES:**

- BRICK FALL SHALL BE MAJOR SIZE PIPE OF BRICK COMPACTED TO AVOID STANDARD PROCTOR DENSITY, EXCEPT AS NOTED OTHERWISE.
- BRICK FALL SHALL BE MAJOR SIZE GRADED MATERIAL (MINIMUM SIZE 3/4" FINISHING GRADE IN 2' LOTS AND COMPACTED TO STANDARD PROCTOR DENSITY, EXCEPT AS NOTED UNDER PAVEMENT.)
- EMBANKMENT SHALL BE COURSE STABILIZED SAND (1.5 UNDER PAVEMENT OR WITHIN 3" OF PAVEMENT, THE REMAINING SAND SHALL BE COURSE STABILIZED SAND (1.5 SANDS DENSITY) AND COMPACTED TO AVOID STANDARD PROCTOR DENSITY.
- INTERVALS SPACING IN ACCORDANCE WITH OSHA, SHALL BE 4'.
- SIZE IN THE PIPE ZONE SHALL CONSIST OF NON-REINFORCED CONCRETE WITH A REINFORCED CONCRETE BEDDING SHALL BE SPECIFIED IN THE PIPE ZONE, INDICATED BEDDING SHALL BE SPECIFIED.

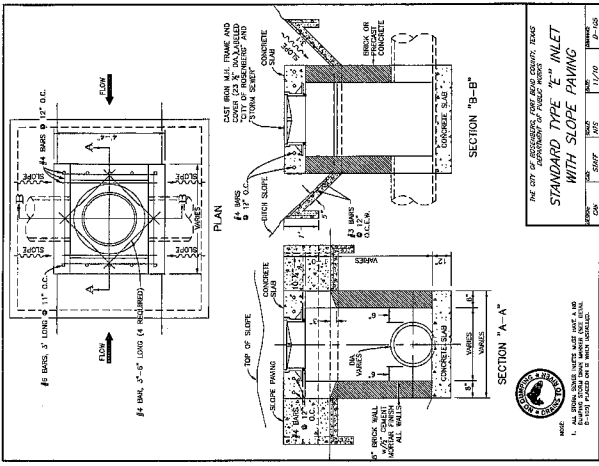

**NOTES:**

- BRICK FALL SHALL BE MAJOR SIZE PIPE OF BRICK COMPACTED TO AVOID STANDARD PROCTOR DENSITY, EXCEPT AS NOTED OTHERWISE.
- BRICK FALL SHALL BE MAJOR SIZE GRADED MATERIAL (MINIMUM SIZE 3/4" FINISHING GRADE IN 2' LOTS AND COMPACTED TO STANDARD PROCTOR DENSITY, EXCEPT AS NOTED UNDER PAVEMENT.)
- EMBANKMENT SHALL BE COURSE STABILIZED SAND (1.5 UNDER PAVEMENT OR WITHIN 3" OF PAVEMENT, THE REMAINING SAND SHALL BE COURSE STABILIZED SAND (1.5 SANDS DENSITY) AND COMPACTED TO AVOID STANDARD PROCTOR DENSITY.
- INTERVALS SPACING IN ACCORDANCE WITH OSHA, SHALL BE 4'.
- SIZE IN THE PIPE ZONE SHALL CONSIST OF NON-REINFORCED CONCRETE WITH A REINFORCED CONCRETE BEDDING SHALL BE SPECIFIED IN THE PIPE ZONE, INDICATED BEDDING SHALL BE SPECIFIED.

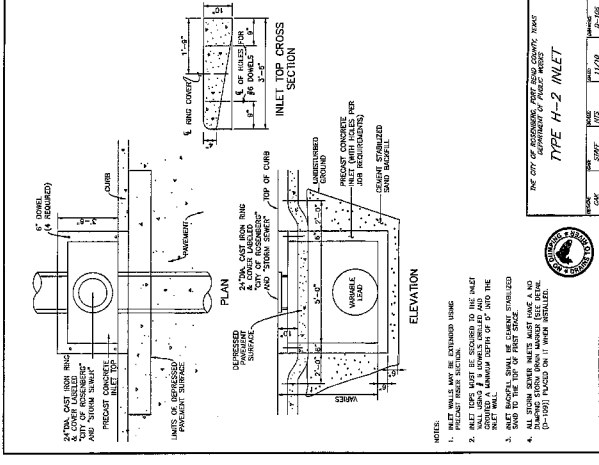

**NOTES:**

- BRICK FALL SHALL BE MAJOR SIZE PIPE OF BRICK COMPACTED TO AVOID STANDARD PROCTOR DENSITY, EXCEPT AS NOTED OTHERWISE.
- BRICK FALL SHALL BE MAJOR SIZE GRADED MATERIAL (MINIMUM SIZE 3/4" FINISHING GRADE IN 2' LOTS AND COMPACTED TO STANDARD PROCTOR DENSITY, EXCEPT AS NOTED UNDER PAVEMENT.)
- EMBANKMENT SHALL BE COURSE STABILIZED SAND (1.5 UNDER PAVEMENT OR WITHIN 3" OF PAVEMENT, THE REMAINING SAND SHALL BE COURSE STABILIZED SAND (1.5 SANDS DENSITY) AND COMPACTED TO AVOID STANDARD PROCTOR DENSITY.
- INTERVALS SPACING IN ACCORDANCE WITH OSHA, SHALL BE 4'.
- SIZE IN THE PIPE ZONE SHALL CONSIST OF NON-REINFORCED CONCRETE WITH A REINFORCED CONCRETE BEDDING SHALL BE SPECIFIED IN THE PIPE ZONE, INDICATED BEDDING SHALL BE SPECIFIED.

**PAPE-DAWSON ENGINEERS**

15333 ROSENBERG AVE. SUITE 800 HOUSTON, TEXAS 77058  
 P. 713.432.2400 FAX. 713.432.2401 WWW.PAPE-DAWSON.COM

REVISION NO. DATE DESCRIPTION

TH 11/17/10 1.000

DATE: 11/17/10

PROJECT: THE TRAILS AT SEABOURNE PARKE SECTION THREE CITY OF ROSENBERG, TEXAS

DESIGNED BY: [Signature]

CHECKED BY: [Signature]

SCALE: AS SHOWN

SHEET NO. 18 OF 27



**PAPE-DAWSON ENGINEERS**  
 3033 RICHMOND AVE. SUITE 800 HOUSTON, TEXAS 77042  
 P. 713.422.2222 F. 713.422.2222 WWW.PAPE-DAWSON.COM

NO. DATE REVISION APP

THE CITY OF HOUSTON, TEXAS  
 DEPARTMENT OF PUBLIC WORKS

THE TRAILS AT SEABOURNE PARKE SECTION THREE  
 CITY OF ROSENBERG, TEXAS

SANITARY SEWER DETAILS (SHEET 1 OF 1)

CITY OF ROSENBERG  
 DEPARTMENT OF PUBLIC WORKS AND ENGINEERING

SHOLET NO. 20 OF 27  
 DRAWING SCALE: 1" = 1'-0"

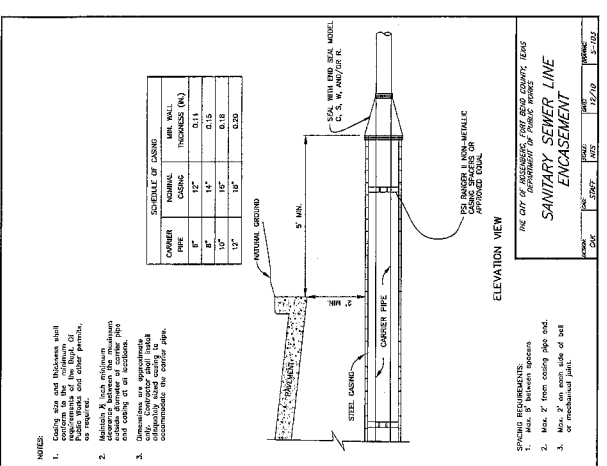
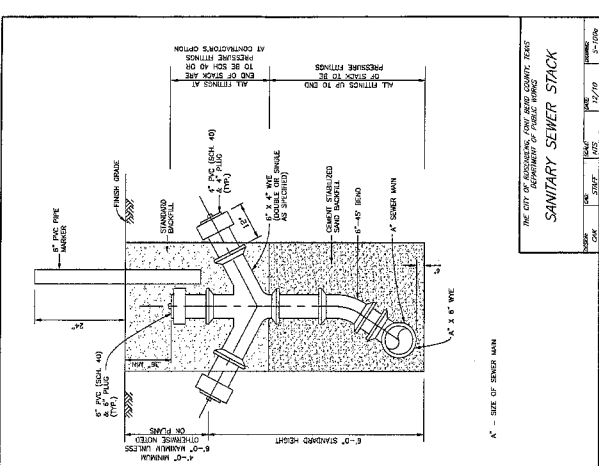
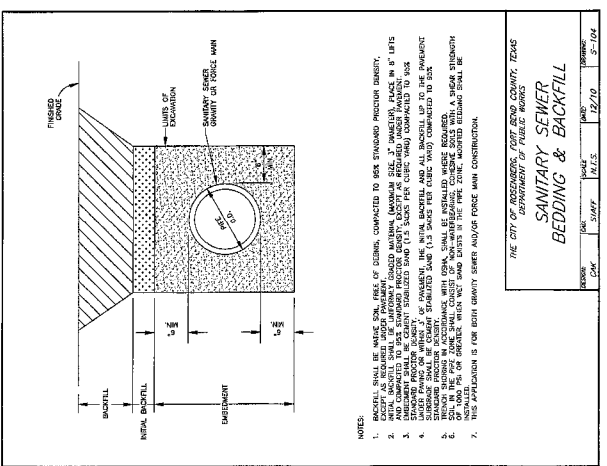
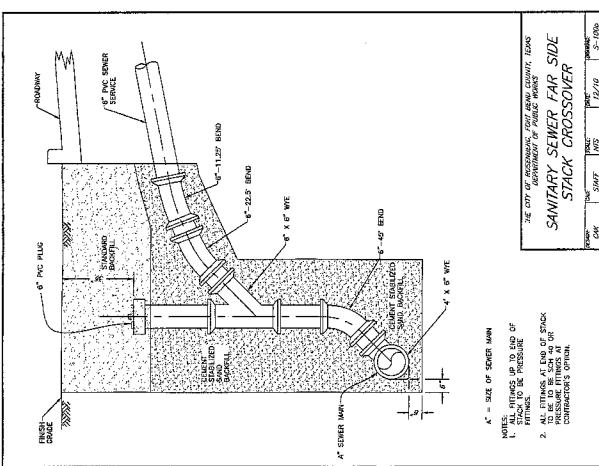
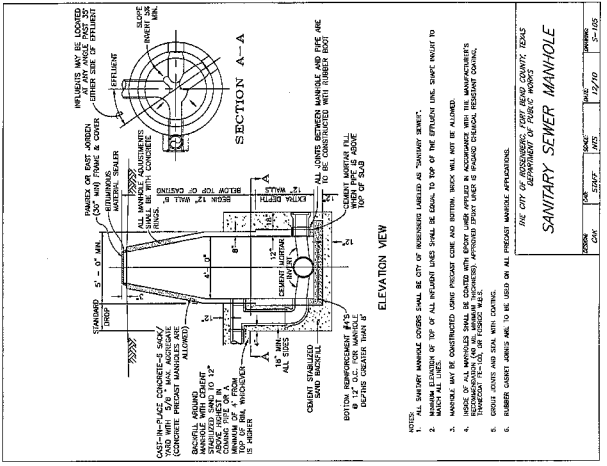
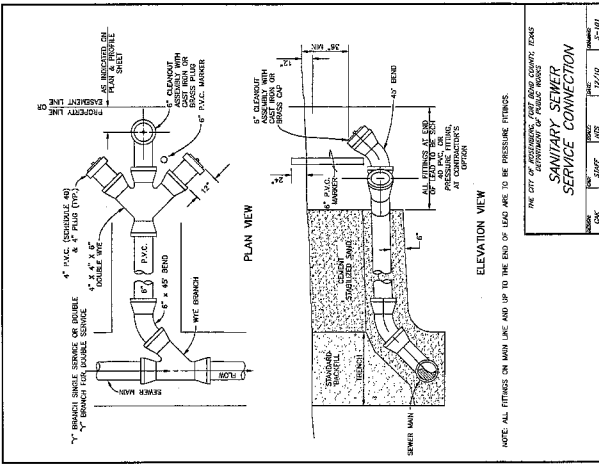

**PAPE-DAWSON ENGINEERS**  
 1433 ROCKWOOD AVE. SUITE 400 HOUSTON, TEXAS 77042  
 P. 713.862.2500 F. 713.862.2501 WWW.PAPE-DAWSON.COM

NO. DATE REVISION  
 \_\_\_\_\_  
 \_\_\_\_\_  
 \_\_\_\_\_

THE CITY OF HOUSTON, TEXAS  
 DEPARTMENT OF PUBLIC WORKS

**MAINCARD NO. 77**  
**BLOW-OFF HYDRANT**

NO. DATE REVISION  
 \_\_\_\_\_  
 \_\_\_\_\_  
 \_\_\_\_\_

DATE: 08/16/11  
 DRAWN: AE  
 CHECKED: AE  
 IN CHARGE: AE

**THE TRAILS AT SEABOURNE PARKE SECTION THREE**  
 CITY OF HOUSTON, TEXAS

**WATER LINE DETAILS (SHEET 1 OF 2)**

**CITY OF ROSENBERG**  
 DEPARTMENT OF PUBLIC WORKS AND ENGINEERING

DRAWING SCALE: NTS  
 SHEET NO: 21 OF 27

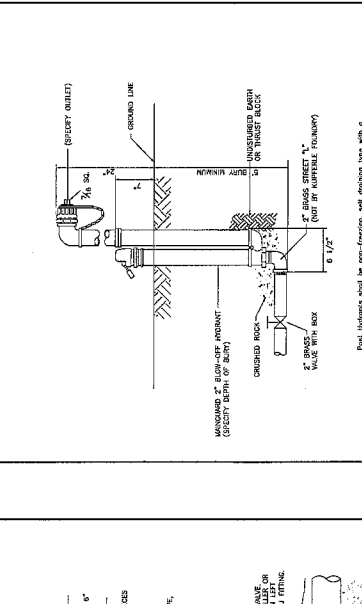

Notes:  
 1. PIPE-JAW GRD DR-18, 120 PSI WITH INTERNAL PVC JOINT, RESINUMI, OR APPROVED EQUAL.  
 2. FITTING-CASTLE IRON EIGHT LEAD AND COATED, MECHANICAL JOINT, METALLIC JOINT.  
 3. PHONE 2-3/8\"/>

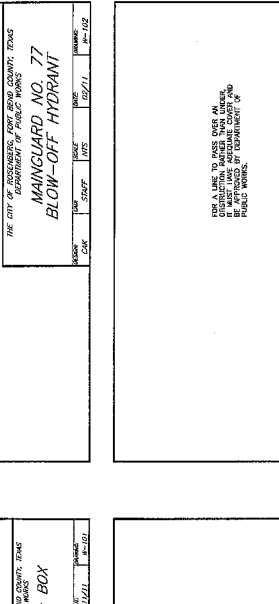

Notes:  
 1. PIPE-JAW GRD DR-18, 120 PSI WITH INTERNAL PVC JOINT, RESINUMI, OR APPROVED EQUAL.  
 2. FITTING-CASTLE IRON EIGHT LEAD AND COATED, MECHANICAL JOINT, METALLIC JOINT.  
 3. PHONE 2-3/8\"/>

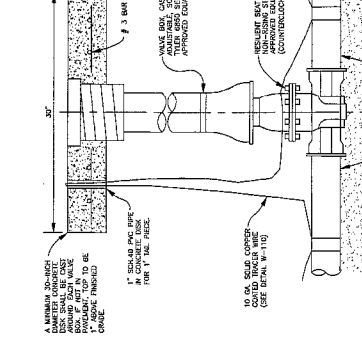

Notes:  
 1. MINIMUM 18\"/>

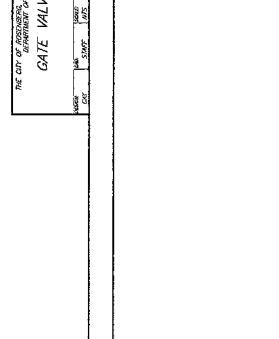

Notes:  
 1. MINIMUM 18\"/>

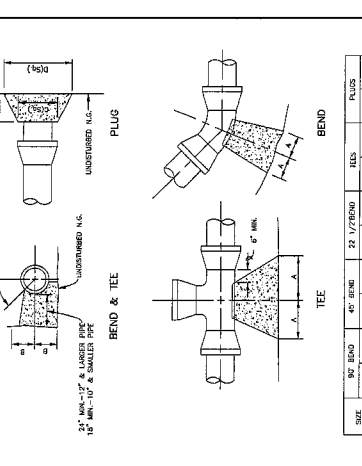

**THRUST BLOCKING DETAILS**

SIZE	90° BEND	45° BEND	22 1/2° BEND	TEES	PLUGS			
	A	B	A	B	A	B	C	D
2 1/2"	12"	7"	6"	6"	6"	6"	6"	14"
4"	14"	8"	7"	6"	6"	6"	6"	18"
6"	18"	10"	8"	10"	6"	6"	12"	24"
8"	22"	12"	12"	12"	8"	10"	12"	28"
10"	26"	14"	14"	14"	10"	12"	14"	32"
12"	30"	16"	16"	16"	12"	14"	16"	36"
14"	34"	18"	18"	18"	14"	16"	18"	40"
16"	38"	20"	20"	20"	16"	18"	20"	44"

NOTE:  
 1. Castings shall be cast in place and shall be 100% sand-cast in the absence of a permit. Castings shall be cast in place and shall be 100% sand-cast in the absence of a permit.  
 2. Installation of each plug shall be done in accordance with the manufacturer's instructions.  
 3. Castings shall be cast in place and shall be 100% sand-cast in the absence of a permit.

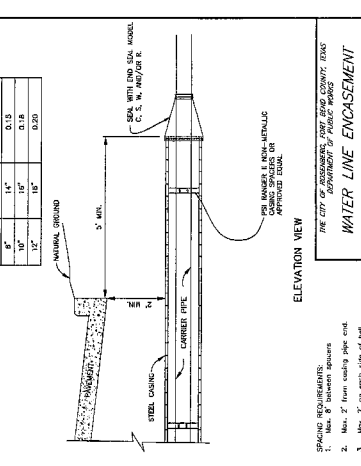

Notes:  
 1. Castings shall be cast in place and shall be 100% sand-cast in the absence of a permit.  
 2. Installation of each plug shall be done in accordance with the manufacturer's instructions.  
 3. Castings shall be cast in place and shall be 100% sand-cast in the absence of a permit.

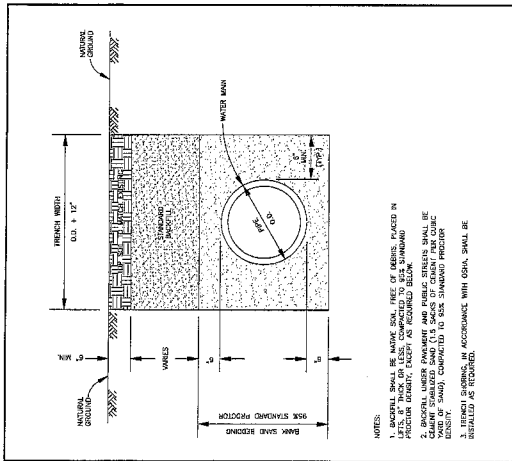

NO.	DATE	BY	CHK	APP	SCALE
1	02/11/11	[Redacted]	[Redacted]	[Redacted]	AS SHOWN

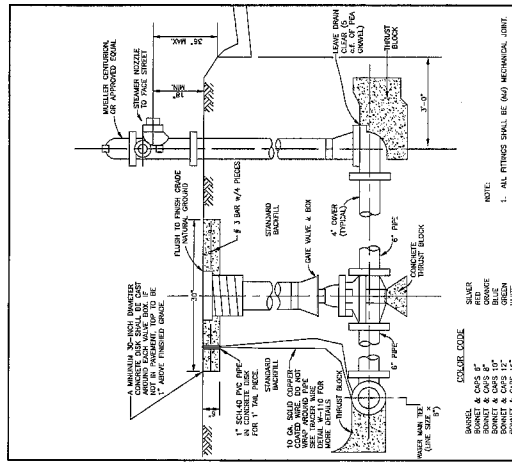

NO.	DATE	BY	CHK	APP	SCALE
1	11/11/11	[Redacted]	[Redacted]	[Redacted]	AS SHOWN

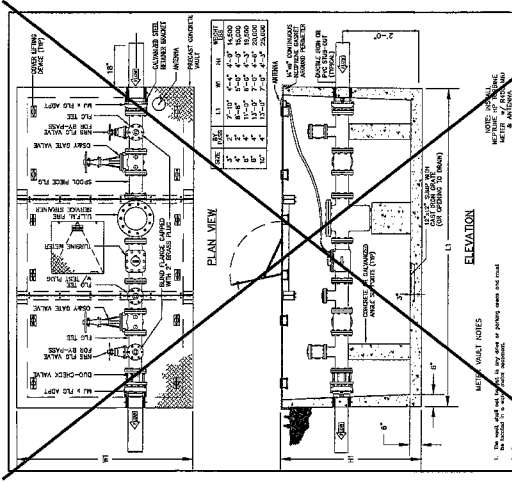

NO.	DATE	BY	CHK	APP	SCALE
1	02/11/11	[Redacted]	[Redacted]	[Redacted]	AS SHOWN

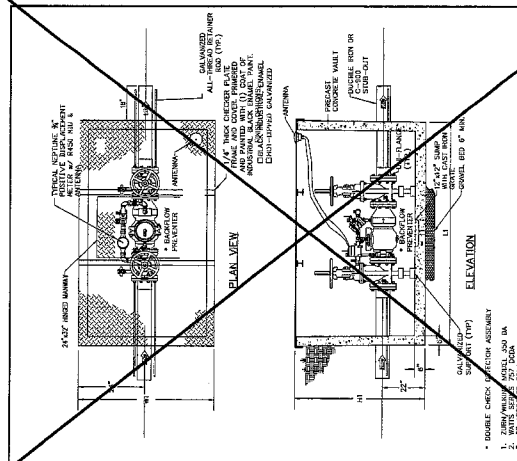

NO.	DATE	BY	CHK	APP	SCALE
1	11/11/11	[Redacted]	[Redacted]	[Redacted]	AS SHOWN

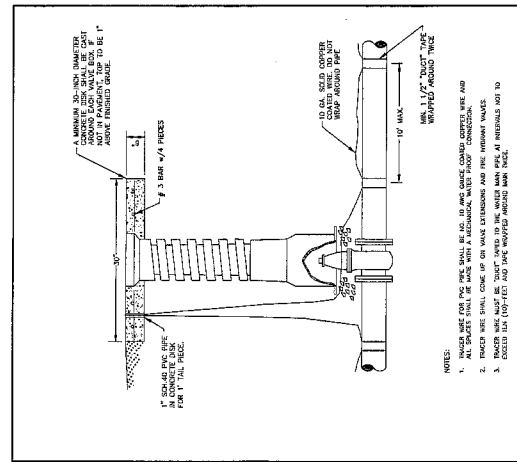

NO.	DATE	BY	CHK	APP	SCALE
1	02/11/11	[Redacted]	[Redacted]	[Redacted]	AS SHOWN

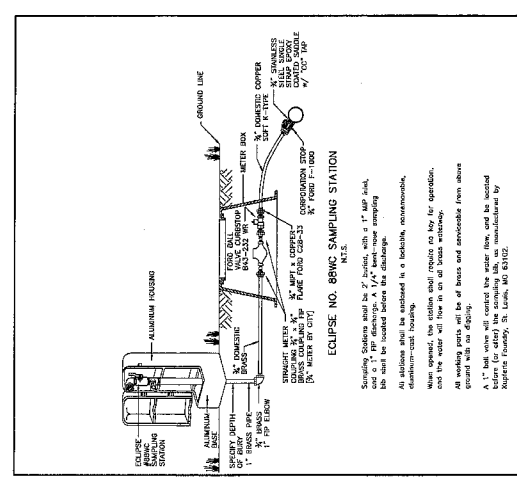

NO.	DATE	BY	CHK	APP	SCALE
1	02/11/11	[Redacted]	[Redacted]	[Redacted]	AS SHOWN

NO.	DATE	BY	CHK	APP	SCALE
1	02/11/11	[Redacted]	[Redacted]	[Redacted]	AS SHOWN

**PAPE-DAWSON ENGINEERS**  
3633 REDWOOD AVE. SUITE 600 HOUSTON, TEXAS 77062  
P. 713.682.8200 F. 713.682.8202 www.pape-dawson.com

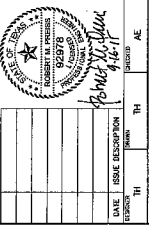

THE TRAILS AT SEABOURNE PARKE SECTION THREE  
CITY OF ROSENBERG, TEXAS

WATER LINE DETAILS (SHEET 2 OF 2)

CITY OF ROSENBERG DEPARTMENT OF PUBLIC WORKS AND ENGINEERING



DRAWING SCALE	AS SHOWN
DATE	02/11/11
DESIGNER	[Redacted]
CHECKER	[Redacted]
SCALE	AS SHOWN
DATE	02/11/11
DRAWN BY	[Redacted]
SCALE	AS SHOWN
DATE	02/11/11

**PAPE-DAWSON ENGINEERS**  
 6333 ROSENBERG AVE. SUITE 600 HOUSTON, TEXAS 77061  
 P. 713-462-9000 FAX. 713-462-9001  
 WWW.PAPE-DAWSON.COM

PROJ. NO. \_\_\_\_\_  
 SHEET NO. \_\_\_\_\_  
 DATE \_\_\_\_\_

REVISION  
 NO. DATE DESCRIPTION

DATE: 08/16/11  
 DRAWN: [Signature]  
 CHECKED: [Signature]  
 APPROVED: [Signature]

THE CITY OF HOUSTON, TEXAS  
 DEPARTMENT OF PUBLIC WORKS AND ENGINEERING

THE TRAILS AT SEABOURNE PARKE SECTION THREE  
 CITY OF HOUSTON, TEXAS

PAVING DETAILS  
 (SHEET 1 OF 3)

CITY OF ROSENBERG  
 DEPARTMENT OF PUBLIC WORKS AND ENGINEERING

HOUSTON SCALE: \_\_\_\_\_  
 DATE: \_\_\_\_\_  
 SHEET NO. 23 OF 27

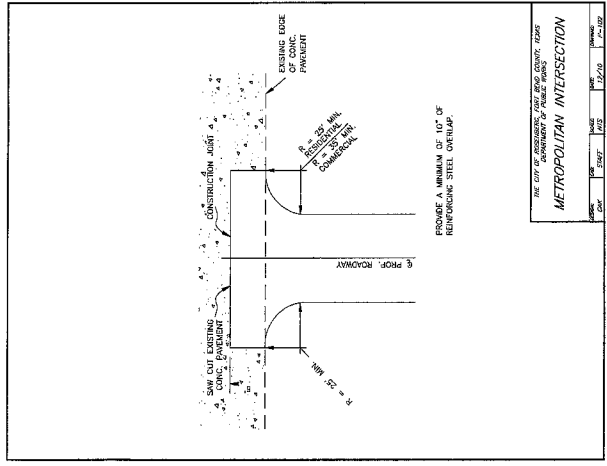
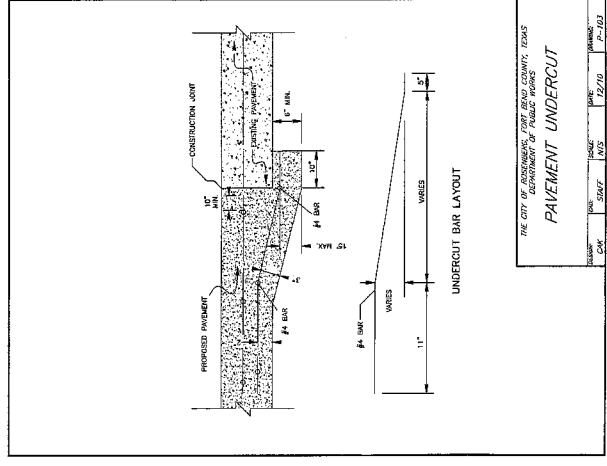
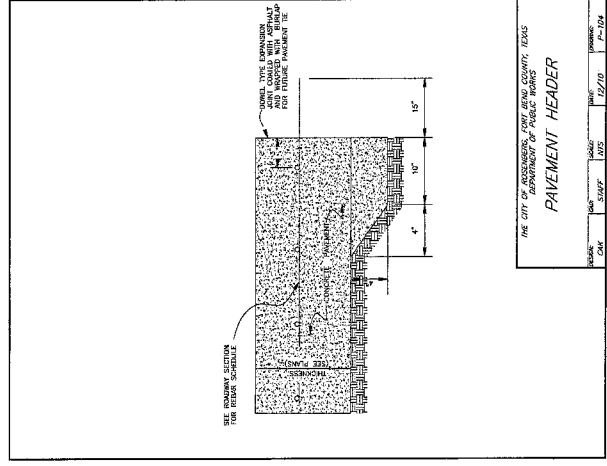
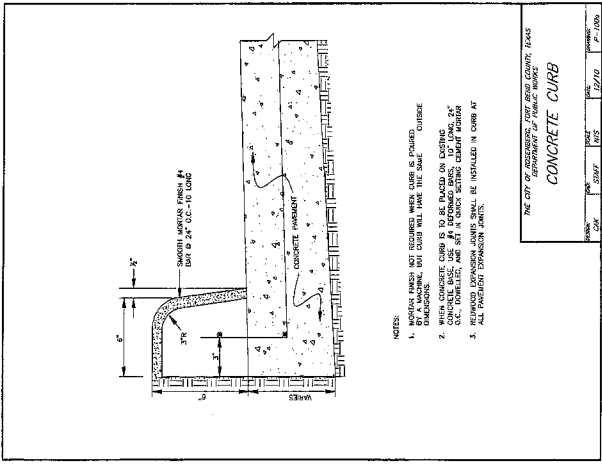
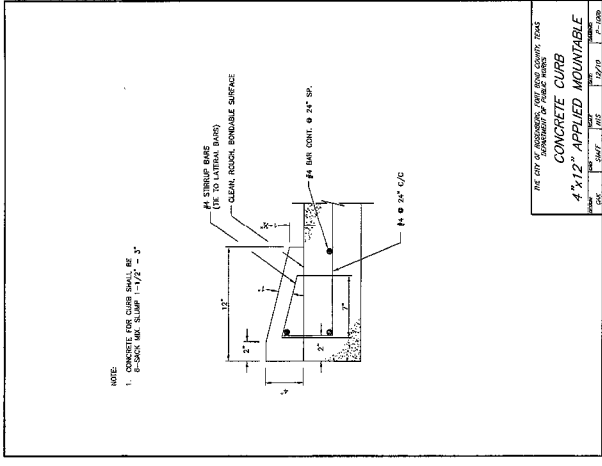
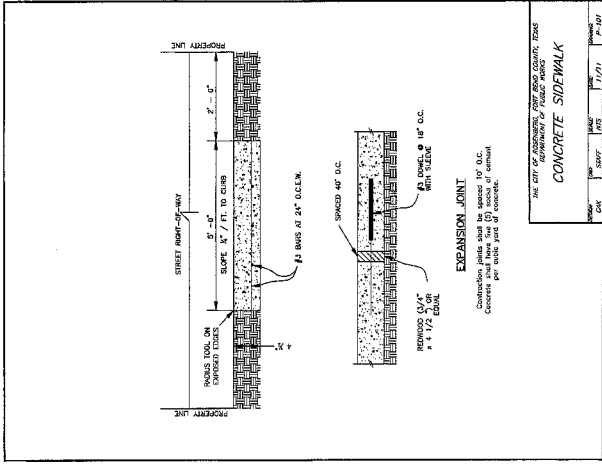

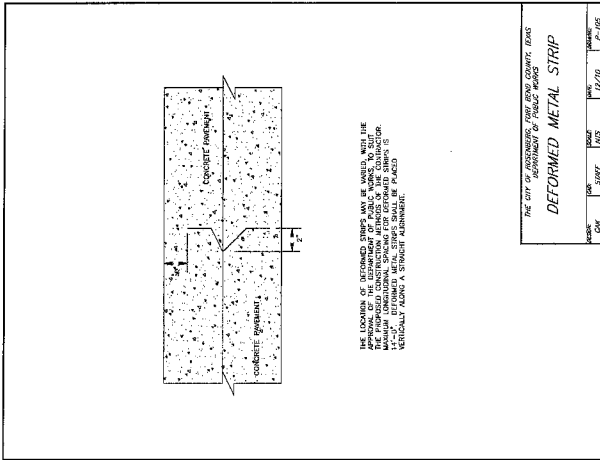

THE CITY OF ROSENBERG, DART ROAD COUNTY, TEXAS  
DEPARTMENT OF PUBLIC WORKS

MARK: CWP DATE: 12/17/10 DRAWN: P-108

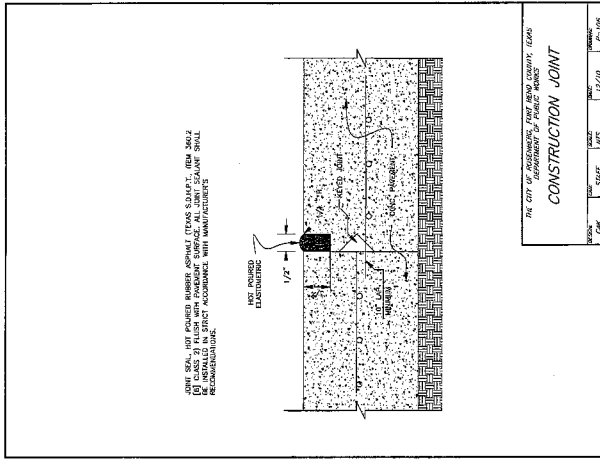

THE CITY OF ROSENBERG, DART ROAD COUNTY, TEXAS  
DEPARTMENT OF PUBLIC WORKS

MARK: CWP DATE: 12/17/10 DRAWN: P-108

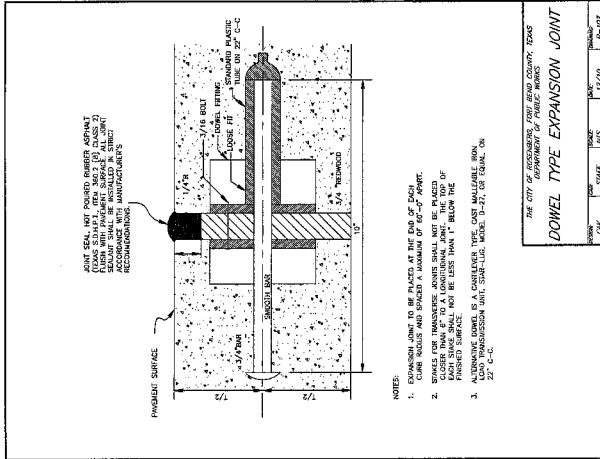

THE CITY OF ROSENBERG, DART ROAD COUNTY, TEXAS  
DEPARTMENT OF PUBLIC WORKS

MARK: CWP DATE: 12/17/10 DRAWN: P-108

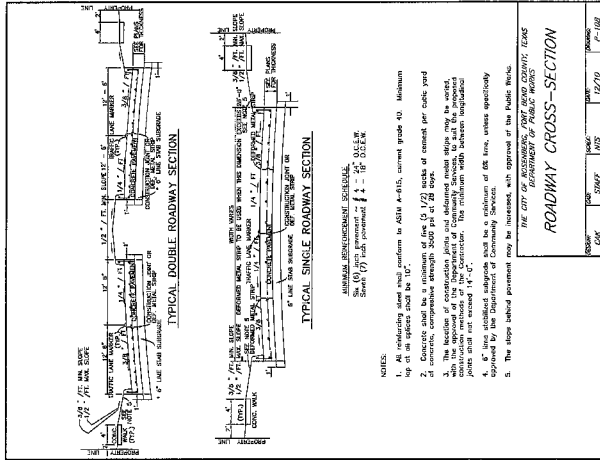

THE CITY OF ROSENBERG, DART ROAD COUNTY, TEXAS  
DEPARTMENT OF PUBLIC WORKS

MARK: CWP DATE: 12/17/10 DRAWN: P-108

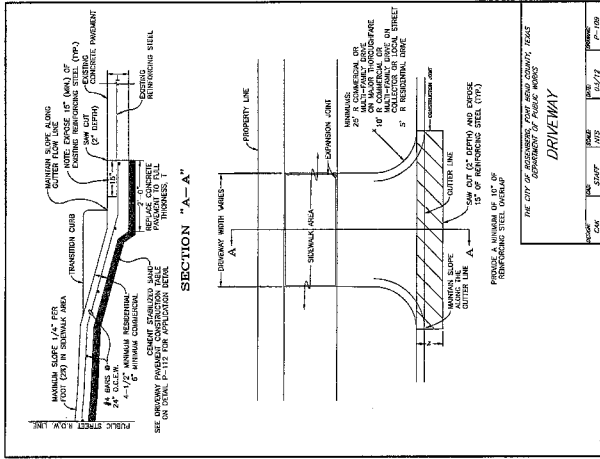

THE CITY OF ROSENBERG, DART ROAD COUNTY, TEXAS  
DEPARTMENT OF PUBLIC WORKS

MARK: CWP DATE: 12/17/10 DRAWN: P-108

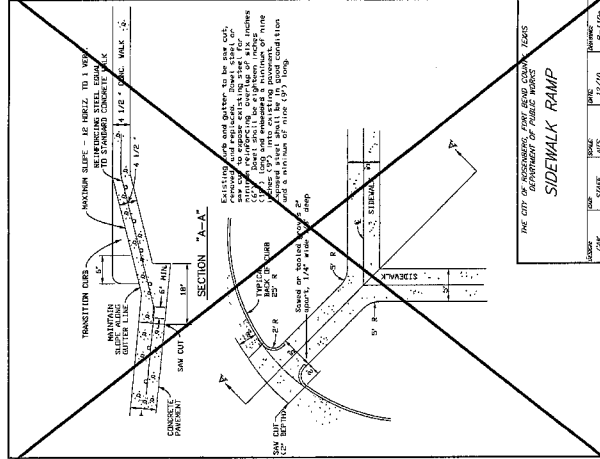

THE CITY OF ROSENBERG, DART ROAD COUNTY, TEXAS  
DEPARTMENT OF PUBLIC WORKS

MARK: CWP DATE: 12/17/10 DRAWN: P-108

NO. DATE REVISION

PAPE-DAWSON ENGINEERS

11111 BROADWAY, SUITE 300, HOUSTON, TEXAS 77040  
P. 713.462.8100 FAX: 713.462.8101 WWW.PAPE-DAWSON.COM

DATE: 12/17/10  
TIME: 10:00 AM  
PROJECT: THE TRAILS AT SEABOURNE PARKE SECTION THREE  
CITY OF ROSENBERG, TEXAS

PAVING DETAILS  
(SHEET 2 OF 3)

CITY OF ROSENBERG  
DEPARTMENT OF PUBLIC WORKS AND ENGINEERING

MARK: CWP DATE: 12/17/10 DRAWN: P-108

ENGINEERING SCALE: 1" = 10'-0"

SHEET NO: 24 OF 27







PERFORMANCE BOND COVERING ALL CABLE, CONDUIT AND/OR POLE LINE  
ACTIVITY IN, UNDER, ACROSS OR ALONG FORT BEND COUNTY ROAD

AUTHORIZED  
BOND NO. 58S207278

THE STATE OF TEXAS

§

KNOW ALL MEN BY THESE PRESENTS:

COUNTY OF FORT BEND

§

THAT WE, Hurtado Construction Company whose address is 2115 Center Street; Richmond, Texas, 77469 Texas, hereinafter called the Principal, And Liberty Mutual Insurance Company, a Corporation existing under and by virtue of the laws of the state of Massachusetts and authorized to do an indemnifying business in the state of Texas, and whose principal office is located at 175 Berkely Street; Boston, MA 02116, whose officer residing in the State of Texas, authorized to accept service in all suits and actions brought whining said state is Jeremy Mederios and Whose address is 8350 North Central Expressway, Suite 850, Dallas, TX 75206, hereinafter called the Surety, and held and firmly bound unto, Robert e. Hebert, County Judge of Fort Bend County, Texas, or his successors in office, in the full sum of Ten Thousand Dollars and 00/100 Dollars (\$ 10,000.00 ) current, lawful money of the United States of America, to be paid to said Robert E. Hebert, County Judge of Fort Bend County, Texas, or his successors in office, to which payment well and truly to be made and done, we, the undersigned, bind ourselves and each of us, our heirs, executors, administrators, successors, assigns, and legal representatives, jointly and severally, by these presents.

THE CONDITION OF THIS BOND IS SUCH THAT, WHEREAS, the above bounden principal contemplates laying, constructing, maintaining and/or repairing one or more cables, conduits, and/or pole lines in, under, across and/or along roads, streets and highways, commercial driveway and median openings or modifications in the County of Fort Bend, and the State of Texas, under the jurisdiction of the Commissioners' Court of Fort Bend County, Texas, pursuant to the Commissioners' Court order adopted on the 1st day of December, A.D. 1980, recorded in Volume 13, of the Commissioners' Court Minutes of Fort Bend County, Texas, regulating same, which Commissioners' Court order is hereby referred to and made a part hereof for all purposes as though fully set out herein;

AND WHEREAS, the principal desires to provide Fort Bend County with a performance bond covering all such cable, conduit and/or pole line activity, commercial driveway and median openings or modifications;

NOW, THEREFORE, if the above bounden principal shall faithfully perform all its cable, conduit and/or pole line activity (including, but not limited to the laying, construction, maintenance and/or repair of cables, conduits and/or pole lines) in, under, across and/or along roads, streets and highways, commercial driveway and median openings or modifications in the County of Fort Bend and State of Texas, under the jurisdiction of the Commissioners Court of Fort Bend County, Texas, pursuant to and in accordance with minimum requirements and conditions of the above mentioned Commissioners' Court order set forth and specified to be by said principal done and performed, at the time and in the manner therein specified, and shall pay over and make good and reimburse Fort Bend County, all loss and damages which Fort Bend County may sustain by reason of any failure or default on the part of said principal, then this obligation shall be null and void, otherwise to remain in full force and effect.

This bond is payable at the County Courthouse in the County of Fort Bend and State of Texas.

It is understood that at any time Fort Bend County deems itself insecure under this bond, it may require further and/or additional bonds of the principal.

EXECUTED this 2nd day of December, 20 15.

Hurtado Construction Company  
PRINCIPAL

BY [Signature]  
Liberty Mutual Insurance Company  
SURETY

BY [Signature] Attorney-in-Fact

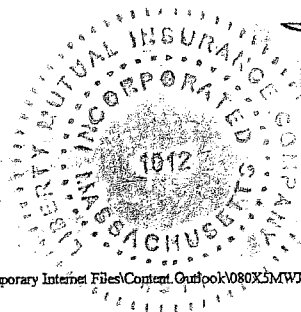

**THIS POWER OF ATTORNEY IS NOT VALID UNLESS IT IS PRINTED ON RED BACKGROUND.**

This Power of Attorney limits the acts of those named herein, and they have no authority to bind the Company except in the manner and to the extent herein stated.

Certificate No. 7089658

American Fire and Casualty Company  
The Ohio Casualty Insurance Company

Liberty Mutual Insurance Company  
West American Insurance Company

**POWER OF ATTORNEY**

KNOWN ALL PERSONS BY THESE PRESENTS: That American Fire & Casualty Company and The Ohio Casualty Insurance Company are corporations duly organized under the laws of the State of New Hampshire, that Liberty Mutual Insurance Company is a corporation duly organized under the laws of the State of Massachusetts, and West American Insurance Company is a corporation duly organized under the laws of the State of Indiana (herein collectively called the "Companies"), pursuant to and by authority herein set forth, does hereby name, constitute and appoint, Cynthia A. Peters; David A. Castillo; Jo Ann Parker; Judy M. Dold; Larry H. Senkel; Laura E. Sudduth; Mark H. Hilliard; Mary Ann Garcia

all of the city of Houston, state of TX each individually if there be more than one named, its true and lawful attorney-in-fact to make, execute, seal, acknowledge and deliver, for and on its behalf as surety and as its act and deed, any and all undertakings, bonds, recognizances and other surety obligations, in pursuance of these presents and shall be as binding upon the Companies as if they have been duly signed by the president and attested by the secretary of the Companies in their own proper persons.

IN WITNESS WHEREOF, this Power of Attorney has been subscribed by an authorized officer or official of the Companies and the corporate seals of the Companies have been affixed thereto this 19th day of August, 2015.

American Fire and Casualty Company  
The Ohio Casualty Insurance Company  
Liberty Mutual Insurance Company  
West American Insurance Company

By: David M. Carey  
David M. Carey, Assistant Secretary

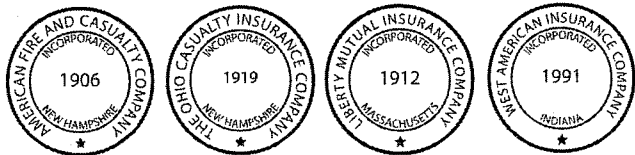

STATE OF PENNSYLVANIA ss  
COUNTY OF MONTGOMERY

On this 19th day of August, 2015, before me personally appeared David M. Carey, who acknowledged himself to be the Assistant Secretary of American Fire and Casualty Company, Liberty Mutual Insurance Company, The Ohio Casualty Insurance Company, and West American Insurance Company, and that he, as such, being authorized so to do, execute the foregoing instrument for the purposes therein contained by signing on behalf of the corporations by himself as a duly authorized officer.

IN WITNESS WHEREOF, I have hereunto subscribed my name and affixed my notarial seal at Plymouth Meeting, Pennsylvania, on the day and year first above written.



COMMONWEALTH OF PENNSYLVANIA  
Notarial Seal  
Teresa Pastella, Notary Public  
Plymouth Twp., Montgomery County  
My Commission Expires March 28, 2017  
Member, Pennsylvania Association of Notaries

By: Teresa Pastella  
Teresa Pastella, Notary Public

This Power of Attorney is made and executed pursuant to and by authority of the following By-laws and Authorizations of American Fire and Casualty Company, The Ohio Casualty Insurance Company, Liberty Mutual Insurance Company, and West American Insurance Company which resolutions are now in full force and effect reading as follows:

**ARTICLE IV - OFFICERS** - Section 12. Power of Attorney. Any officer or other official of the Corporation authorized for that purpose in writing by the Chairman or the President, and subject to such limitation as the Chairman or the President may prescribe, shall appoint such attorneys-in-fact, as may be necessary to act in behalf of the Corporation to make, execute, seal, acknowledge and deliver as surety any and all undertakings, bonds, recognizances and other surety obligations. Such attorneys-in-fact, subject to the limitations set forth in their respective powers of attorney, shall have full power to bind the Corporation by their signature and execution of any such instruments and to attach thereto the seal of the Corporation. When so executed, such instruments shall be as binding as if signed by the President and attested to by the Secretary. Any power or authority granted to any representative or attorney-in-fact under the provisions of this article may be revoked at any time by the Board, the Chairman, the President or by the officer or officers granting such power or authority.

**ARTICLE XIII - Execution of Contracts - SECTION 5. Surety Bonds and Undertakings.** Any officer of the Company authorized for that purpose in writing by the chairman or the president, and subject to such limitations as the chairman or the president may prescribe, shall appoint such attorneys-in-fact, as may be necessary to act in behalf of the Company to make, execute, seal, acknowledge and deliver as surety any and all undertakings, bonds, recognizances and other surety obligations. Such attorneys-in-fact subject to the limitations set forth in their respective powers of attorney, shall have full power to bind the Company by their signature and execution of any such instruments and to attach thereto the seal of the Company. When so executed such instruments shall be as binding as if signed by the president and attested by the secretary.

**Certificate of Designation** - The President of the Company, acting pursuant to the Bylaws of the Company, authorizes David M. Carey, Assistant Secretary to appoint such attorneys-in-fact as may be necessary to act on behalf of the Company to make, execute, seal, acknowledge and deliver as surety any and all undertakings, bonds, recognizances and other surety obligations.

**Authorization** - By unanimous consent of the Company's Board of Directors, the Company consents that facsimile or mechanically reproduced signature of any assistant secretary of the Company, wherever appearing upon a certified copy of any power of attorney issued by the Company in connection with surety bonds, shall be valid and binding upon the Company with the same force and effect as though manually affixed.

I, Gregory W. Davenport, the undersigned, Assistant Secretary, of American Fire and Casualty Company, The Ohio Casualty Insurance Company, Liberty Mutual Insurance Company, and West American Insurance Company do hereby certify that the original power of attorney of which the foregoing is a full, true and correct copy of the Power of Attorney executed by said Companies, is in full force and effect and has not been revoked.

IN TESTIMONY WHEREOF, I have hereunto set my hand and affixed the seals of said Companies this 2nd day of December, 2015.

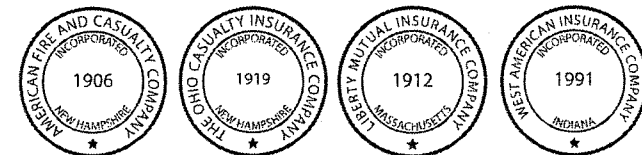

By: Gregory W. Davenport  
Gregory W. Davenport, Assistant Secretary

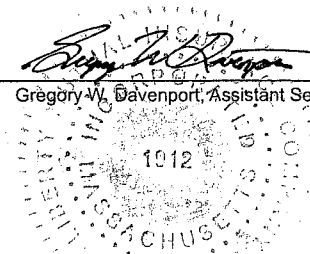

Not valid for mortgage, note, loan, letter of credit, currency rate, interest rate or residual value guarantees.

To confirm the validity of this Power of Attorney call 1-610-832-8240 between 9:00 am and 4:30 pm EST on any business day.



TEXAS  
IMPORTANT NOTICE

To obtain information or make a complaint:

You may call toll-free for information or to make a complaint at  
1-877-751-2641

You may also write to:

Interchange Corporate Center  
450 Plymouth Road, Suite 400  
Plymouth Meeting, PA 79462-8284

You may contact the Texas Department of Insurance to obtain information on companies, coverages, rights or complaints at  
1-800-252-3439

You may write the Texas Department of Insurance Consumer Protection (111-1A)  
P. O. Box 149091  
Austin, TX 78714-9091  
FAX: (512) 490-1007  
Web: <http://www.tdi.texas.gov>  
E-mail: [ConsumerProtection@tdi.texas.gov](mailto:ConsumerProtection@tdi.texas.gov)

PREMIUM OR CLAIM DISPUTES:

Should you have a dispute concerning your premium or about a claim you should first contact the agent or call 1-800-843-6446. If the dispute is not resolved, you may contact the Texas Department of Insurance.

ATTACH THIS NOTICE TO YOUR  
POLICY:

This notice is for information only and does not become a part or condition of the attached document.

TEXAS  
AVISO IMPORTANTE

Para obtener informacion o para someter una queja:

Usted puede llamar al numero de telefono gratis para informacion o para someter una queja al  
1-877-751-2641

Usted tambien puede escribir a:

Interchange Corporate Center  
450 Plymouth Road, Suite 400  
Plymouth Meeting, PA 79462-8284

Puede comunicarse con el Departamento de Seguros de Texas para obtener informacion acerca de companias, coberturas, derechos o quejas al  
1-800-252-3439

Puede escribir al Departamento de Seguros de Texas Consumer Protection (111-1A)  
P. O. Box 149091  
Austin, TX 78714-9091  
FAX # (512) 490-1007  
Web: <http://www.tdi.texas.gov>  
E-mail: [ConsumerProtection@tdi.texas.gov](mailto:ConsumerProtection@tdi.texas.gov)

DISPUTAS SOBRE PRIMAS O RECLAMOS:

Si tiene una disputa concerniente a su prima o a un reclamo, debe comunicarse con el agente o primero. Si no se resuelve la disputa, puede entonces comunicarse con el departamento (TDI)

UNA ESTE AVISO A SU POLIZA:

Este aviso es solo para proposito de informacion y no se convierte en parte o condicion del documento adjunto.