

169

REVIEW BY FORT BEND COUNTY COMMISSIONERS COURT

On this 24th day of November, 2015, Commissioners Court came on to be heard and reviewed the accompanying notice of United Engineers, Inc AT & T TEXAS / SWBT Job Location 23716 S.W. FRWY. / Rabbs Bayou, ROSENBERG, TX 77471 Date 11/10/2015 Bond No. CH1-001686693-01, Permit No. 2015-3847 to make use of certain Fort Bend County property subject to, "A Revised Order Regulating the Laying, Construction, Maintenance, and Repair of Buried Cables, Conduits, and Pole Lines, In, Under, Across or Along Roads, Streets, Highways, and Drainage Ditches in Fort Bend County, Texas, Under the Jurisdiction of the Commissioners Court of Fort Bend County, Texas," as passed by the Commissioners Court of Fort Bend County, Texas the 3rd day of August, 1987, recorded in Volume _____ of the Minutes of the Commissioners Court of Fort Bend County, Texas, to the extent that such order is not inconsistent with Article 1436a, Vernon's Texas Civil Statutes. Upon Motion of Commissioner Patterson, seconded by Commissioner Meuser, duly put and carried, it is ORDERED, ADJUDGED AND DECREED that said notice of said above purpose is hereby acknowledged by the Commissioners Court of Fort Bend County, Texas, and that said notice be placed on record according to the regulation order thereof.

Notes:

1. Evidence of review by the Commissioners Court must be kept on the job site and failure to do so constitutes grounds for job shutdown.
2. Written notices are required:
 - a. 48 hours in advance of construction start up, and
 - b. when construction is completed and ready for final inspection
 Mail notices to: Permit Administrator
 Fort Bend County Engineering
 301 Jackson Street
 Richmond, Texas 77469
 281-633-7500
3. This permit expires one (1) year from date of permit if construction has not commenced.

By: [Signature]
County Engineer

Presented to Commissioners Court and approved.
Recorded in Volume 11124115
Minutes of Commissioners Court

By: [Signature]
Drainage District Engineer/Manager

Clerk of Commissioners Court

By: [Signature]
Deputy

RENEE MICHULKA

RECEIVED

RECEIVED

NOV 25 2015

FBC DRAINAGE DIST.

- NOTE:**
- 101 CONDUIT SHEET INDEX
 - 102 PLAN & PROFILE SHEET
 - 103 PLAN & PROFILE SHEET
 - 104 PLAN & PROFILE SHEET
 - 105 PLAN & PROFILE SHEET
 - 106 PLAN & PROFILE SHEET
 - 107 GENERAL DETAILS & SPECIFICATIONS
 - 108 TYPICAL 3" x 6" PLAN
 - 109 TYPICAL 1200' TRAFFIC CONTROL PLAN

NOTE:
1. CONTRACTOR MUST OBTAIN A PERMIT FROM MR. JOHNNY ORTIZ, RICHMOND POLICE DEPARTMENT, 1001 WEST 10TH ST., RICHMOND, TEXAS 75104, PRIOR TO ANY WORK WITHIN THE RAMMO BAYOU LOOP-OF-WAY.

AT&T Texas/SWB

RICHMOND-ROSENBERG WEST UNIT RICH-ROSE '232' W8-9232

PROPOSED CONDUIT ALIGNMENT ALONG I.H. 69 FROM F.M. 762 TO WILLIAMS WAY RD. FOR APPROXIMATELY 1,315 FEET.

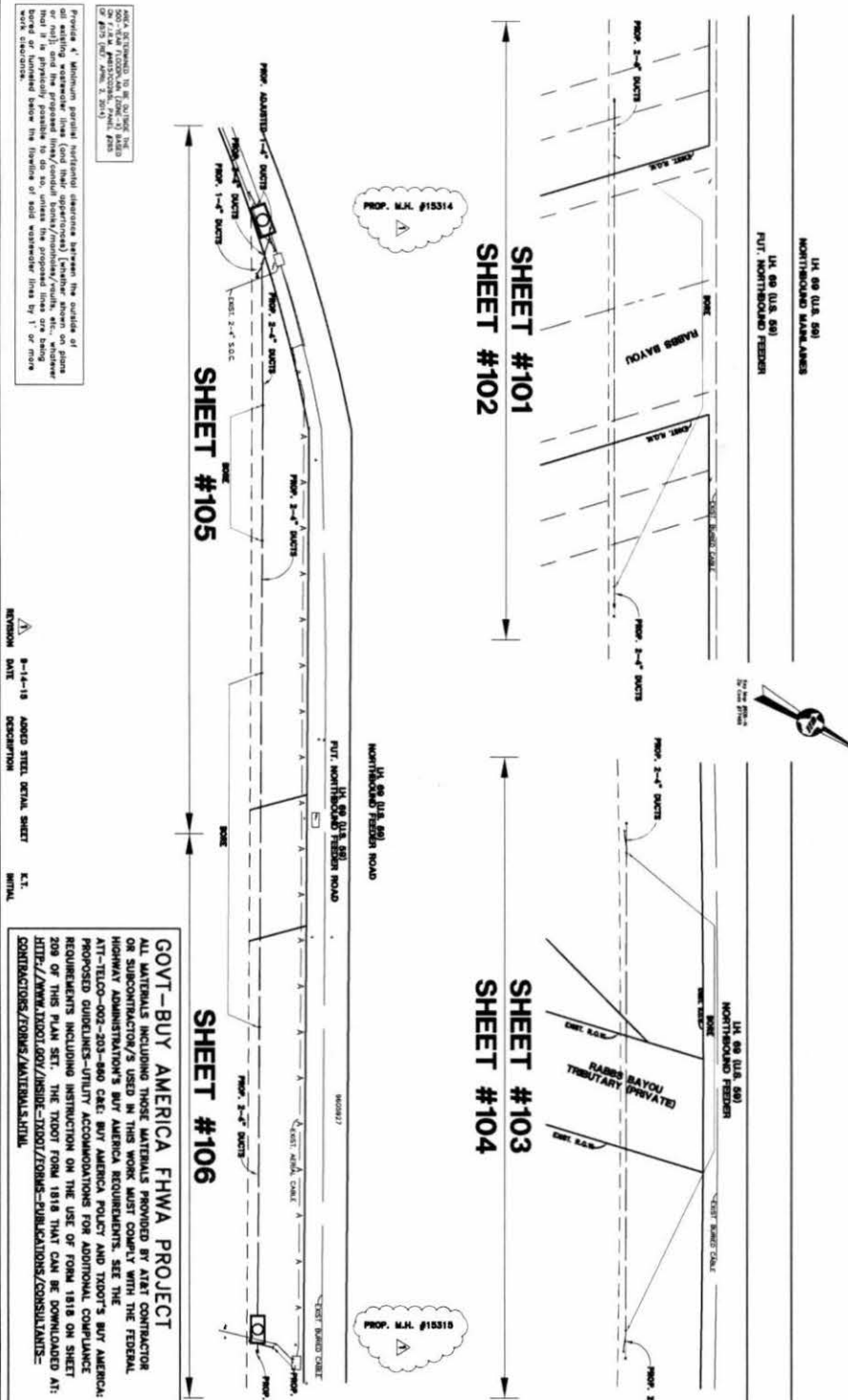

| | |
|---------------|----------|
| PROJECT NO. | 9605927 |
| DATE | 12/15/11 |
| NO. OF SHEETS | 12 |
| PROJECT NO. | W8-9232 |

United Engineers, Inc.
 ONE RICHMOND CENTER
 1001 WEST 10TH STREET
 RICHMOND, TEXAS 75104
 (713) 223-4527 (IN TEXAS)
 (713) 223-4527 (OUT OF TEXAS)
 FAX (713) 223-4527

PROJECT NO. 9605927
 SHEET NO. 100

CITY OF RICHMOND
 DEPARTMENT OF PUBLIC WORKS AND ENGINEERING

TRAVELO 811
 Call before you dig.
 ONE-CALL NOTIFICATION SERVICE
 CALL BEFORE YOU DIG
 (713) 223-4527 (IN TEXAS)
 (713) 223-4527 (OUT OF TEXAS)

GOVT-BUY AMERICA FHWA PROJECT
 ALL MATERIALS INCLUDING THOSE MATERIALS PROVIDED BY ALET CONTRACTOR OR SUBCONTRACTOR/S USED IN THIS WORK MUST COMPLY WITH THE FEDERAL HIGHWAY ADMINISTRATION'S BUY AMERICA REQUIREMENTS. SEE THE ATT-TELO-002-203-840 C&E; BUY AMERICA POLICY AND TxDOT'S BUY AMERICA REQUIREMENTS INCLUDING INSTRUCTIONS ON THE USE OF FORM 1818 ON SHEET 209 OF THIS PLAN SET. THE TxDOT FORM 1818 THAT CAN BE DOWNLOADED AT: [HTTP://WWW.TXDOT.GOV/INSIDE-TXDOT/FORMS-PUBLICATIONS/CONSULTANTS-CONTRACTORS/FORMS/MATERIALS.HTML](http://www.txdot.gov/inside-txdot/forms-publications/consultants-contractors/forms/materials.html)

REVISION DATE DESCRIPTION INITIAL

| | | |
|---------|--------------------------|------|
| 3-14-11 | ADDED STEEL DETAIL SHEET | K.T. |
|---------|--------------------------|------|

LOCATION MAP

VICINITY MAP

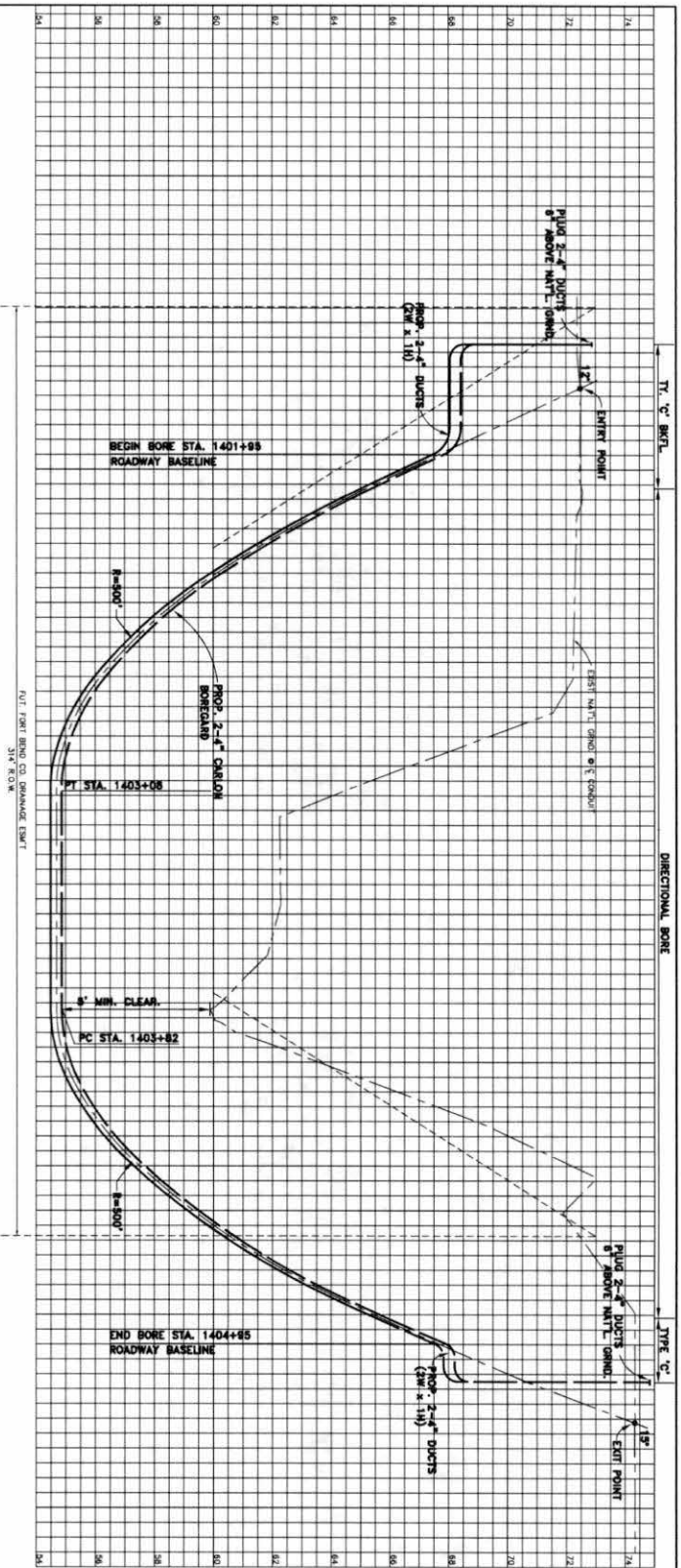

NOTE:
1. CONTRACTOR MUST OBTAIN A PERMIT FROM MR. JOHNNY CRITCHEL,
DIRECTOR OF TRANSPORTATION AND CONSTRUCTION, BEFORE
PROCEEDING WITH THE BORE. AVOID ROAD OF WA.

GOVT-BUY AMERICA FHWA PROJECT
(SEE SHEET 100)

| REGION | REVISION DATE | DESCRIPTION | INITIALS |
|--------|---------------|-------------|----------|
| | | | |



AT&T Texas/SWBT
IH 69 - NORTHWEST OF F.M. 762
FORT BEND COUNTY, TEXAS
CITY OF RICHMOND
 DEPARTMENT OF PUBLIC WORKS AND ENGINEERING

SCALE: PLAN 1" = 20' PROFILE 1" = 2'

DESIGNED BY: _____ DATE: _____
 CHECKED BY: _____ DATE: _____
 PROJECT: 9605927 SHEET: 102
 NO. W-89232 (S.S. RICHMOND, TEXAS) DATE: 7/2009

United Engineers, Inc. 481 # 2108-00

SEE PROFILE SHEET 104

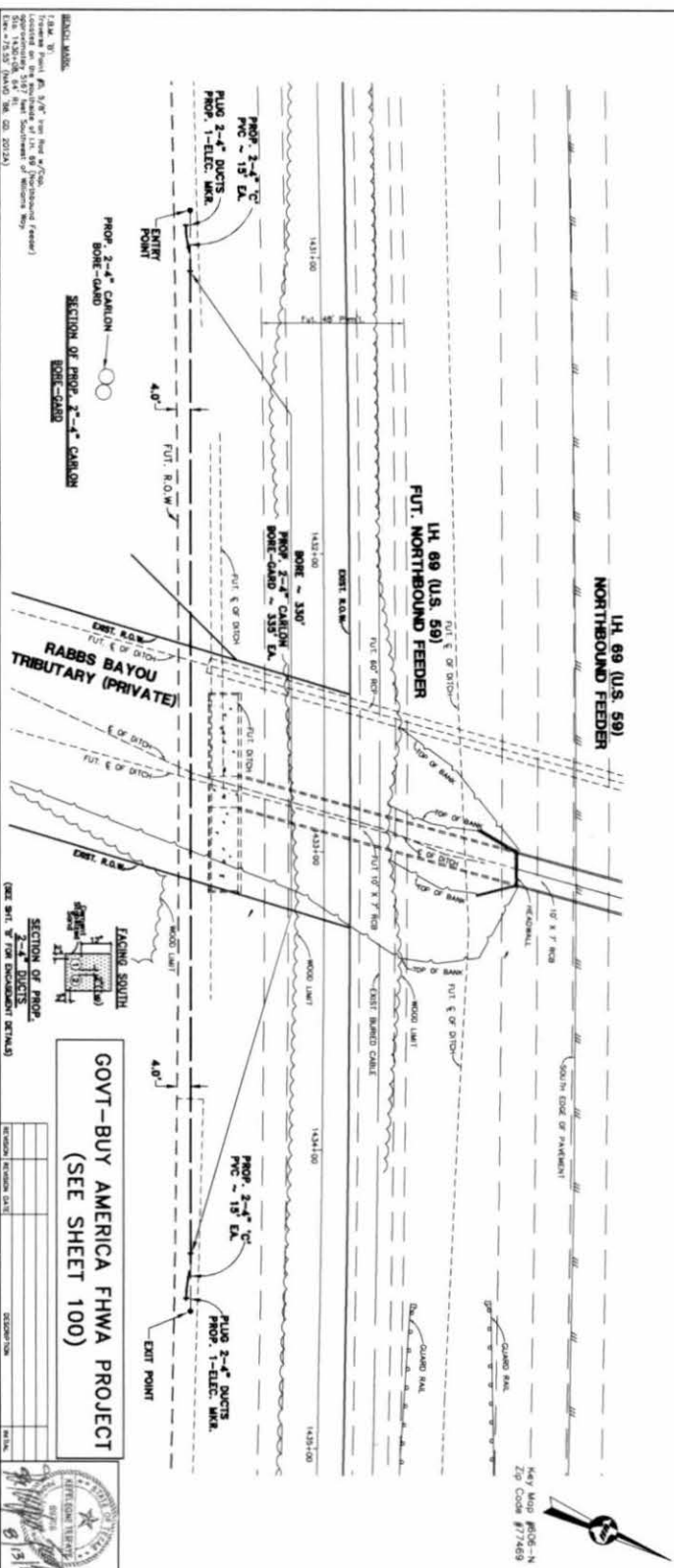

| ACTION CODE | TRENCH SUMMARY | IN. DIA. | DEPTH | LENGTH | BORE | REMARKS |
|-------------|----------------|----------|-------|--------|------|---------|
| PAC | TRENCH-2-4" C | 18" | 30' | | | |
| PAC | PVC-C-4" 2 | 330' | 30' | | | |
| PAC | TRENCH-3-4" C | 18" | 30' | | | |
| PAC | BORE-CARD-4" 2 | 18" | 30' | | | |
| PAC | TRENCH-2-4" C | 18" | 30' | | | |
| PAC | PVC-C-4" 2 | 330' | 30' | | | |

AT&T Texas/SWB
 NOTE: SCHEDULES VALID FOR ONE YEAR ONLY AFTER DATE OF SCHEDULES
LH 69 - NORTHWEST OF FM 762
 FORT BEND COUNTY, TEXAS
CITY OF RICHMOND
 DEPARTMENT OF PUBLIC WORKS AND ENGINEERING

APPROVED BY: _____ DATE: _____
 DESIGNED BY: _____ DATE: _____
 CHECKED BY: _____ DATE: _____
 PROJECT NO: 9803927 SHEET NO: 103
 DATE: 11/13/98
 CITY OF RICHMOND
 DEPARTMENT OF PUBLIC WORKS AND ENGINEERING
 1000 W. 99th St. Richmond, TX 77409
 (713) 620-4000 FAX: (713) 620-4001
 487 / 2-107-00

SECTION MARKS
 1.246 W. 99th St. 1/2" = 100' (Horizontal Feet)
 1.247 W. 99th St. 1/2" = 100' (Vertical Feet)
 1.248 W. 99th St. 1/2" = 100' (Horizontal Feet)
 1.249 W. 99th St. 1/2" = 100' (Vertical Feet)
 1.250 W. 99th St. 1/2" = 100' (Horizontal Feet)
 1.251 W. 99th St. 1/2" = 100' (Vertical Feet)
 1.252 W. 99th St. 1/2" = 100' (Horizontal Feet)
 1.253 W. 99th St. 1/2" = 100' (Vertical Feet)

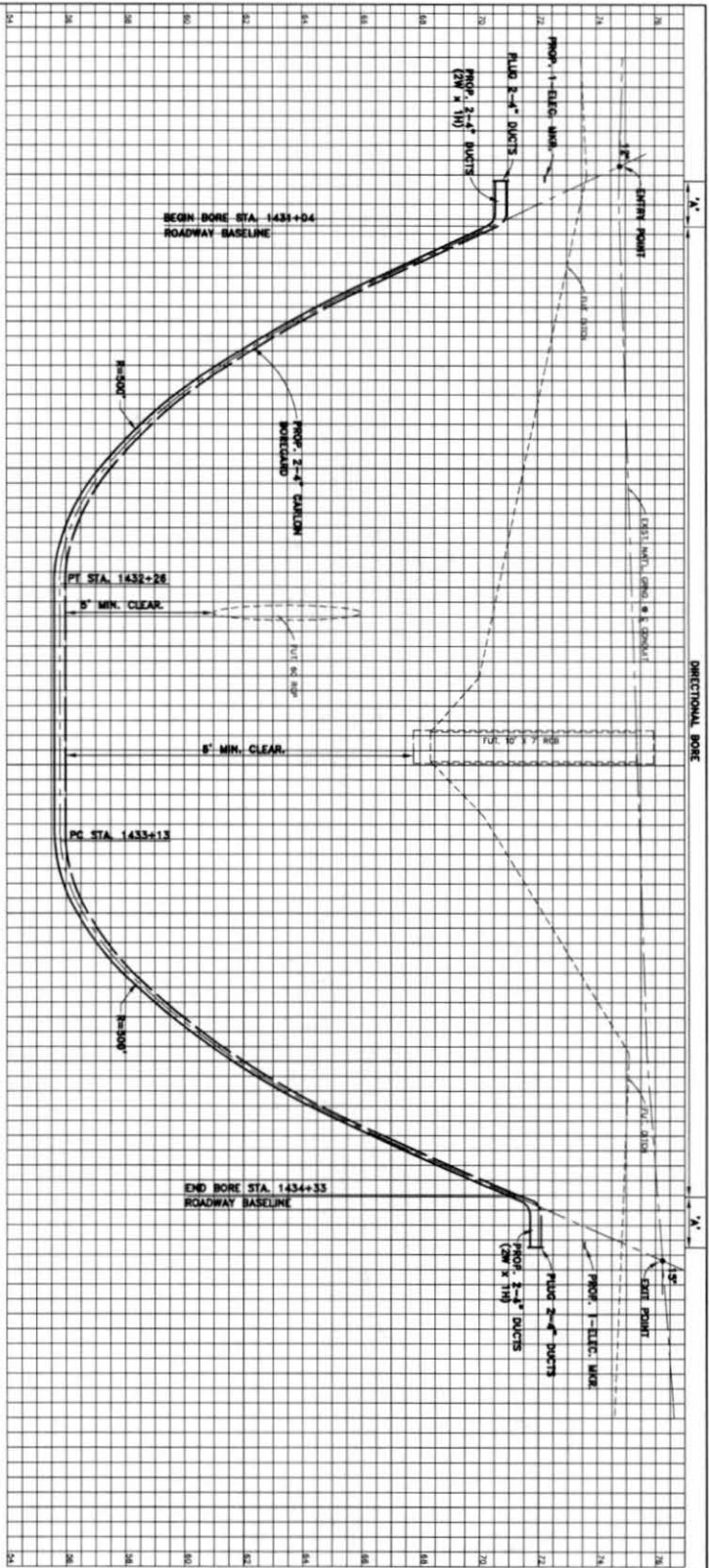

GOVT-BUY AMERICA FHWA PROJECT
(SEE SHEET 100)

| | | |
|----------|---------------|-------------|
| REVISION | REVISION DATE | DESCRIPTION |
| | | |
| | | |
| | | |



AT&T Texas/SWBT
 NOTE: DIMENSIONS VALID FOR ONE YEAR ONLY AFTER DATE OF SUBMITTAL
LH 69 - NORTHWEST OF FM 762
 FORT BEND COUNTY, TEXAS

CITY OF RICHMOND
 DEPARTMENT OF PUBLIC WORKS AND ENGINEERING

SCALE: HORIZ. 1" = 40' VERT. 1" = 4'

DESIGNED BY: _____
 CHECKED BY: _____
 DATE: 11/13/09

PROJECT NO: 9603927 SHEET NO: 104
 DATE: 11/13/09 DATE: 11/13/09

United Engineers, Inc. 407 2107-09

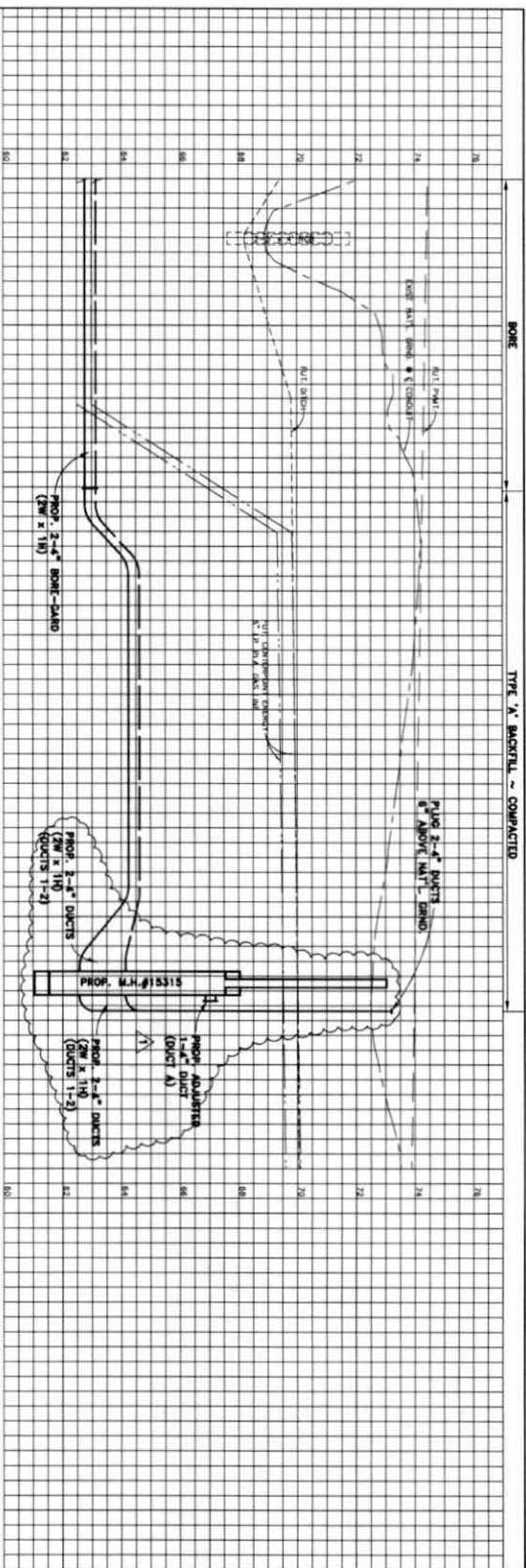

TYPE 'A' BACKFILL - COMPACTED

- 1) WARNING HIGH PROFILE CABLE
980231-048 Flow buried cable
- 2) WARNING HIGH PROFILE CABLE
980231-048 Flow buried cable
- 3) WARNING HIGH PROFILE CABLE
980231-024 Flow buried cable

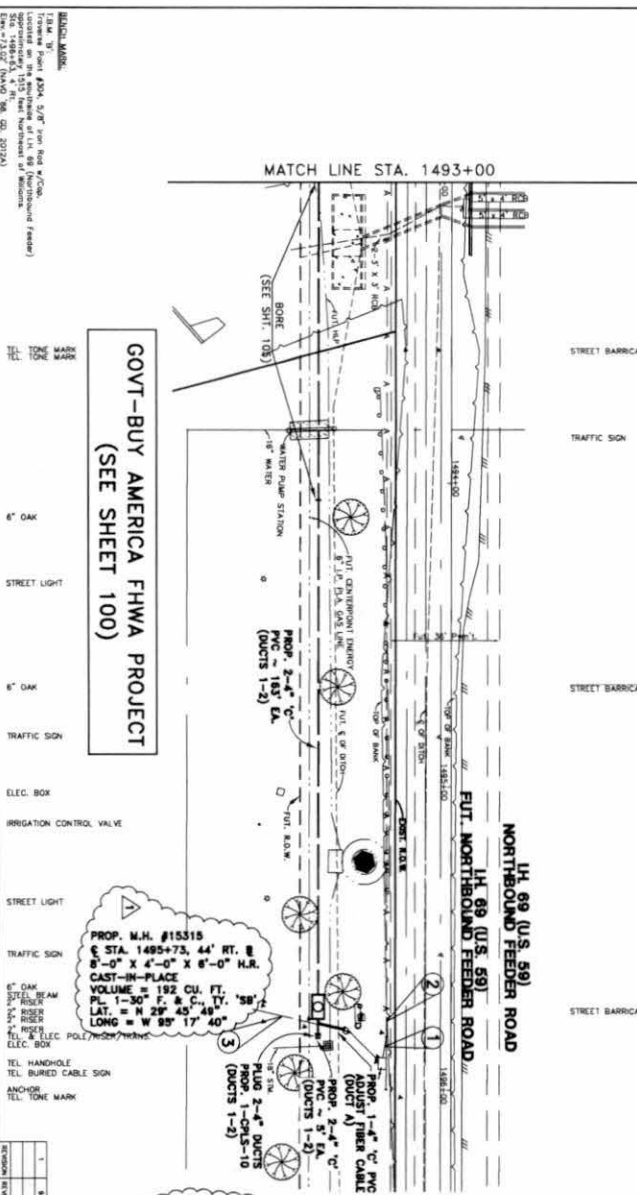

GOVT-BUY AMERICA FHWA PROJECT
(SEE SHEET 100)

- 4" OAK
- STREET LIGHT
- TRAFFIC SIGN
- ELEC. BOX
- IRRIGATION CONTROL VALVE
- STREET LIGHT
- TRAFFIC SIGN
- 1" OAK
- RISER BEAM
- RISER
- REG. & ELEC. POLE/POST/FRAME
- TEL. HANDHOLE
- TEL. BURIED CABLE SIGN
- ANCHOR
- TEL. TONE MARK

| NO. | DESCRIPTION | DATE |
|-----|-------------|---|
| 1 | 8-17-18 | Revised 8' x 4' x 4' O.D. CONDUIT TO 6' x 4' x 4' |
| 2 | 8-17-18 | Change 1-4\"/> |



AT&T Texas/SWBT
LH 69 AND WILLIAMS WAY
FORT BEND COUNTY, TEXAS
CITY OF RICHMOND
DEPARTMENT OF PUBLIC WORKS AND ENGINEERING

SCALE: PLAN 1" = 20' PROFILE 1" = 2'

DATE: 8/13/18

PROJECT NO: 980232

DATE: 8/13/18

PROJECT: LH 69

NO. 106

| NO. | TASK | AMOUNT | REMARKS |
|-----|-----------------|--------|---------|
| 1 | MANHOLE-SPECIAL | 1 | |
| 2 | TRENCH-2-4" | 183' | |
| 3 | TRENCH-1-4" | 10' | |
| 4 | TRENCH-1-4" | 10' | |
| 5 | TRENCH-2-4" | 5' | |
| 6 | TRENCH-2-4" | 10' | |

NOTE:
SEE SHIT. 201 FOR SELF INFLICTED CABLE
DAMAGE AVOIDANCE NOTE.

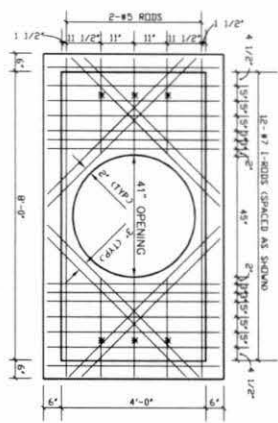

ROOF
SLAB THICKNESS = 1 1/2"

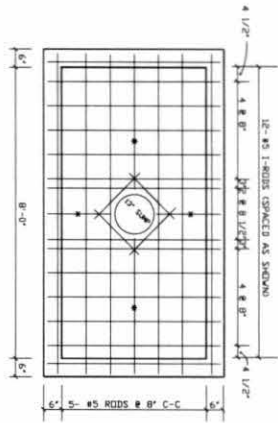

FLOOR
SLAB THICKNESS = 1 1/2"

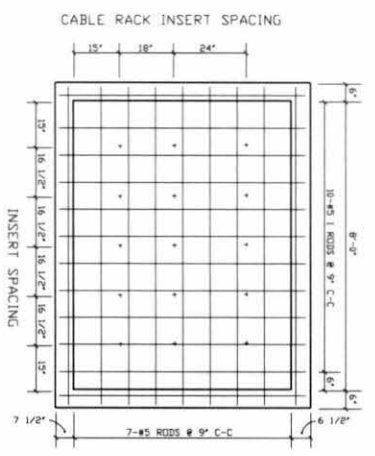

TYPICAL SIDEWALL
SLAB THICKNESS = 9"

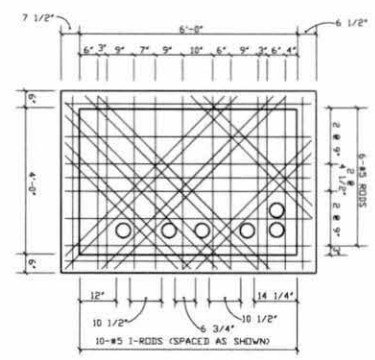

TYPICAL ENDWALL
SLAB THICKNESS = 6"

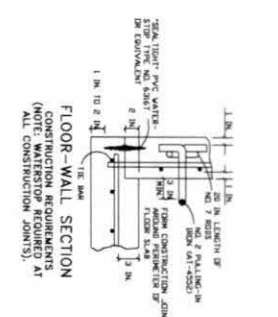

FLOOR-WALL SECTION
CONSTRUCTION REQUIREMENTS
(NOTE: WATERSTOP REQUIRED AT ALL CONSTRUCTION JOINTS).

- NOTES
- 1) REINFORCING ROD SPACING MAY BE COMBINED SIGHTLY TO AVOID CUTTING RODS UPON PULLING FORMS, CABLET SHEETS AND SUBSEQUENT RECT ENHANCED RODS TO INCHES C-C. NOT BE SPACED LESS THAN 3 INCHES.
 - 2) NUMBER 5 RODS ARE PLACED AT INTERIOR AND EXTERIOR WALL-JUNCTIONS TO PREVENT ENDS OF REINFORCING RODS TO THESE RODS AT ALL WALL-SIDE WALL-JUNCTIONS. THE ENDS SHOULD BE WELDED TO THE PARALLELING BAR LAYER.
 - 3) THE ENDS OF ALL RODS SHALL EXTEND TO SURFACE OF THE STRUCTURE EXCEPT RODS DISTRIBUTED TO THE WATERSTOP.
 - 4) SURFACE OF THE STRUCTURE EXCEPT RODS SIZE AS THE PARALLELING BAR LAYER.
 - 5) DIAGONAL STEEL SHALL BE NUMBER 3 ROD.
 - 6) ALL REINFORCING RODS SHALL BE WELDED TOGETHER AT ALL WALL-JUNCTIONS.
 - 7) YIELD STRENGTH FOR CONCRETE AND STEEL SHALL BE INDICATED NEAREST THE INCHES.
 - 8) YIELD STRENGTH FOR CONCRETE AND STEEL SHALL BE INDICATED NEAREST THE INCHES.
 - 9) YIELD STRENGTH FOR CONCRETE AND STEEL SHALL BE INDICATED NEAREST THE INCHES.
 - 10) YIELD STRENGTH FOR CONCRETE AND STEEL SHALL BE INDICATED NEAREST THE INCHES.
 - 11) YIELD STRENGTH FOR CONCRETE AND STEEL SHALL BE INDICATED NEAREST THE INCHES.
 - 12) YIELD STRENGTH FOR CONCRETE AND STEEL SHALL BE INDICATED NEAREST THE INCHES.
 - 13) YIELD STRENGTH FOR CONCRETE AND STEEL SHALL BE INDICATED NEAREST THE INCHES.
 - 14) YIELD STRENGTH FOR CONCRETE AND STEEL SHALL BE INDICATED NEAREST THE INCHES.
 - 15) YIELD STRENGTH FOR CONCRETE AND STEEL SHALL BE INDICATED NEAREST THE INCHES.
 - 16) YIELD STRENGTH FOR CONCRETE AND STEEL SHALL BE INDICATED NEAREST THE INCHES.
 - 17) YIELD STRENGTH FOR CONCRETE AND STEEL SHALL BE INDICATED NEAREST THE INCHES.
 - 18) YIELD STRENGTH FOR CONCRETE AND STEEL SHALL BE INDICATED NEAREST THE INCHES.
 - 19) YIELD STRENGTH FOR CONCRETE AND STEEL SHALL BE INDICATED NEAREST THE INCHES.
 - 20) YIELD STRENGTH FOR CONCRETE AND STEEL SHALL BE INDICATED NEAREST THE INCHES.
 - 21) YIELD STRENGTH FOR CONCRETE AND STEEL SHALL BE INDICATED NEAREST THE INCHES.
 - 22) YIELD STRENGTH FOR CONCRETE AND STEEL SHALL BE INDICATED NEAREST THE INCHES.
 - 23) YIELD STRENGTH FOR CONCRETE AND STEEL SHALL BE INDICATED NEAREST THE INCHES.
 - 24) YIELD STRENGTH FOR CONCRETE AND STEEL SHALL BE INDICATED NEAREST THE INCHES.
 - 25) YIELD STRENGTH FOR CONCRETE AND STEEL SHALL BE INDICATED NEAREST THE INCHES.
 - 26) YIELD STRENGTH FOR CONCRETE AND STEEL SHALL BE INDICATED NEAREST THE INCHES.
 - 27) YIELD STRENGTH FOR CONCRETE AND STEEL SHALL BE INDICATED NEAREST THE INCHES.
 - 28) YIELD STRENGTH FOR CONCRETE AND STEEL SHALL BE INDICATED NEAREST THE INCHES.
 - 29) YIELD STRENGTH FOR CONCRETE AND STEEL SHALL BE INDICATED NEAREST THE INCHES.
 - 30) YIELD STRENGTH FOR CONCRETE AND STEEL SHALL BE INDICATED NEAREST THE INCHES.
 - 31) YIELD STRENGTH FOR CONCRETE AND STEEL SHALL BE INDICATED NEAREST THE INCHES.
 - 32) YIELD STRENGTH FOR CONCRETE AND STEEL SHALL BE INDICATED NEAREST THE INCHES.
 - 33) YIELD STRENGTH FOR CONCRETE AND STEEL SHALL BE INDICATED NEAREST THE INCHES.
 - 34) YIELD STRENGTH FOR CONCRETE AND STEEL SHALL BE INDICATED NEAREST THE INCHES.
 - 35) YIELD STRENGTH FOR CONCRETE AND STEEL SHALL BE INDICATED NEAREST THE INCHES.
 - 36) YIELD STRENGTH FOR CONCRETE AND STEEL SHALL BE INDICATED NEAREST THE INCHES.
 - 37) YIELD STRENGTH FOR CONCRETE AND STEEL SHALL BE INDICATED NEAREST THE INCHES.
 - 38) YIELD STRENGTH FOR CONCRETE AND STEEL SHALL BE INDICATED NEAREST THE INCHES.
 - 39) YIELD STRENGTH FOR CONCRETE AND STEEL SHALL BE INDICATED NEAREST THE INCHES.
 - 40) YIELD STRENGTH FOR CONCRETE AND STEEL SHALL BE INDICATED NEAREST THE INCHES.
 - 41) YIELD STRENGTH FOR CONCRETE AND STEEL SHALL BE INDICATED NEAREST THE INCHES.
 - 42) YIELD STRENGTH FOR CONCRETE AND STEEL SHALL BE INDICATED NEAREST THE INCHES.
 - 43) YIELD STRENGTH FOR CONCRETE AND STEEL SHALL BE INDICATED NEAREST THE INCHES.
 - 44) YIELD STRENGTH FOR CONCRETE AND STEEL SHALL BE INDICATED NEAREST THE INCHES.
 - 45) YIELD STRENGTH FOR CONCRETE AND STEEL SHALL BE INDICATED NEAREST THE INCHES.
 - 46) YIELD STRENGTH FOR CONCRETE AND STEEL SHALL BE INDICATED NEAREST THE INCHES.
 - 47) YIELD STRENGTH FOR CONCRETE AND STEEL SHALL BE INDICATED NEAREST THE INCHES.
 - 48) YIELD STRENGTH FOR CONCRETE AND STEEL SHALL BE INDICATED NEAREST THE INCHES.
 - 49) YIELD STRENGTH FOR CONCRETE AND STEEL SHALL BE INDICATED NEAREST THE INCHES.
 - 50) YIELD STRENGTH FOR CONCRETE AND STEEL SHALL BE INDICATED NEAREST THE INCHES.
 - 51) YIELD STRENGTH FOR CONCRETE AND STEEL SHALL BE INDICATED NEAREST THE INCHES.
 - 52) YIELD STRENGTH FOR CONCRETE AND STEEL SHALL BE INDICATED NEAREST THE INCHES.
 - 53) YIELD STRENGTH FOR CONCRETE AND STEEL SHALL BE INDICATED NEAREST THE INCHES.
 - 54) YIELD STRENGTH FOR CONCRETE AND STEEL SHALL BE INDICATED NEAREST THE INCHES.
 - 55) YIELD STRENGTH FOR CONCRETE AND STEEL SHALL BE INDICATED NEAREST THE INCHES.
 - 56) YIELD STRENGTH FOR CONCRETE AND STEEL SHALL BE INDICATED NEAREST THE INCHES.
 - 57) YIELD STRENGTH FOR CONCRETE AND STEEL SHALL BE INDICATED NEAREST THE INCHES.
 - 58) YIELD STRENGTH FOR CONCRETE AND STEEL SHALL BE INDICATED NEAREST THE INCHES.
 - 59) YIELD STRENGTH FOR CONCRETE AND STEEL SHALL BE INDICATED NEAREST THE INCHES.
 - 60) YIELD STRENGTH FOR CONCRETE AND STEEL SHALL BE INDICATED NEAREST THE INCHES.
 - 61) YIELD STRENGTH FOR CONCRETE AND STEEL SHALL BE INDICATED NEAREST THE INCHES.
 - 62) YIELD STRENGTH FOR CONCRETE AND STEEL SHALL BE INDICATED NEAREST THE INCHES.
 - 63) YIELD STRENGTH FOR CONCRETE AND STEEL SHALL BE INDICATED NEAREST THE INCHES.
 - 64) YIELD STRENGTH FOR CONCRETE AND STEEL SHALL BE INDICATED NEAREST THE INCHES.
 - 65) YIELD STRENGTH FOR CONCRETE AND STEEL SHALL BE INDICATED NEAREST THE INCHES.
 - 66) YIELD STRENGTH FOR CONCRETE AND STEEL SHALL BE INDICATED NEAREST THE INCHES.
 - 67) YIELD STRENGTH FOR CONCRETE AND STEEL SHALL BE INDICATED NEAREST THE INCHES.
 - 68) YIELD STRENGTH FOR CONCRETE AND STEEL SHALL BE INDICATED NEAREST THE INCHES.
 - 69) YIELD STRENGTH FOR CONCRETE AND STEEL SHALL BE INDICATED NEAREST THE INCHES.
 - 70) YIELD STRENGTH FOR CONCRETE AND STEEL SHALL BE INDICATED NEAREST THE INCHES.
 - 71) YIELD STRENGTH FOR CONCRETE AND STEEL SHALL BE INDICATED NEAREST THE INCHES.
 - 72) YIELD STRENGTH FOR CONCRETE AND STEEL SHALL BE INDICATED NEAREST THE INCHES.
 - 73) YIELD STRENGTH FOR CONCRETE AND STEEL SHALL BE INDICATED NEAREST THE INCHES.
 - 74) YIELD STRENGTH FOR CONCRETE AND STEEL SHALL BE INDICATED NEAREST THE INCHES.
 - 75) YIELD STRENGTH FOR CONCRETE AND STEEL SHALL BE INDICATED NEAREST THE INCHES.
 - 76) YIELD STRENGTH FOR CONCRETE AND STEEL SHALL BE INDICATED NEAREST THE INCHES.
 - 77) YIELD STRENGTH FOR CONCRETE AND STEEL SHALL BE INDICATED NEAREST THE INCHES.
 - 78) YIELD STRENGTH FOR CONCRETE AND STEEL SHALL BE INDICATED NEAREST THE INCHES.
 - 79) YIELD STRENGTH FOR CONCRETE AND STEEL SHALL BE INDICATED NEAREST THE INCHES.
 - 80) YIELD STRENGTH FOR CONCRETE AND STEEL SHALL BE INDICATED NEAREST THE INCHES.
 - 81) YIELD STRENGTH FOR CONCRETE AND STEEL SHALL BE INDICATED NEAREST THE INCHES.
 - 82) YIELD STRENGTH FOR CONCRETE AND STEEL SHALL BE INDICATED NEAREST THE INCHES.
 - 83) YIELD STRENGTH FOR CONCRETE AND STEEL SHALL BE INDICATED NEAREST THE INCHES.
 - 84) YIELD STRENGTH FOR CONCRETE AND STEEL SHALL BE INDICATED NEAREST THE INCHES.
 - 85) YIELD STRENGTH FOR CONCRETE AND STEEL SHALL BE INDICATED NEAREST THE INCHES.
 - 86) YIELD STRENGTH FOR CONCRETE AND STEEL SHALL BE INDICATED NEAREST THE INCHES.
 - 87) YIELD STRENGTH FOR CONCRETE AND STEEL SHALL BE INDICATED NEAREST THE INCHES.
 - 88) YIELD STRENGTH FOR CONCRETE AND STEEL SHALL BE INDICATED NEAREST THE INCHES.
 - 89) YIELD STRENGTH FOR CONCRETE AND STEEL SHALL BE INDICATED NEAREST THE INCHES.
 - 90) YIELD STRENGTH FOR CONCRETE AND STEEL SHALL BE INDICATED NEAREST THE INCHES.
 - 91) YIELD STRENGTH FOR CONCRETE AND STEEL SHALL BE INDICATED NEAREST THE INCHES.
 - 92) YIELD STRENGTH FOR CONCRETE AND STEEL SHALL BE INDICATED NEAREST THE INCHES.
 - 93) YIELD STRENGTH FOR CONCRETE AND STEEL SHALL BE INDICATED NEAREST THE INCHES.
 - 94) YIELD STRENGTH FOR CONCRETE AND STEEL SHALL BE INDICATED NEAREST THE INCHES.
 - 95) YIELD STRENGTH FOR CONCRETE AND STEEL SHALL BE INDICATED NEAREST THE INCHES.
 - 96) YIELD STRENGTH FOR CONCRETE AND STEEL SHALL BE INDICATED NEAREST THE INCHES.
 - 97) YIELD STRENGTH FOR CONCRETE AND STEEL SHALL BE INDICATED NEAREST THE INCHES.
 - 98) YIELD STRENGTH FOR CONCRETE AND STEEL SHALL BE INDICATED NEAREST THE INCHES.
 - 99) YIELD STRENGTH FOR CONCRETE AND STEEL SHALL BE INDICATED NEAREST THE INCHES.
 - 100) YIELD STRENGTH FOR CONCRETE AND STEEL SHALL BE INDICATED NEAREST THE INCHES.

GOVT-BUY AMERICA FHWA PROJECT
(SEE SHEET 100)

M.H. #155314 & M.H. #155315
5' MIN. COVER
AT&T Texas/SWB
8'-0" X 4'-0" X 6'-0" HR.
FORT BEND COUNTY, TEXAS

SCALE: PLAN 1/2" = 1'

NOTE: SCHEDULED WALL FOR ONE YEAR ONLY AFTER DATE OF SUBMITTAL

REVISIONS

| | | |
|-----|---------|--------------------------|
| NO. | DATE | DESCRIPTION |
| 1 | 8-11-10 | Issue Steel Detail Sheet |
| 2 | | |
| 3 | | |
| 4 | | |
| 5 | | |

107

RECEIVED
NOV 25 2015
FBC DRAINAGE DIST.