

STATE OF TEXAS §
 §
COUNTY OF FORT BEND §

**AMENDMENT TO PROFESSIONAL ENGINEERING SERVICES AGREEMENT
PROJECT NO. 747 – WILLIAMS WAY
TO INCLUDE FRONT STREET IMPROVEMENTS UNDER PROJECT X-18**

THIS AMENDMENT, is made and entered into by and between Fort Bend County (hereinafter "County"), a body corporate and politic under the laws of the State of Texas, and Lippke, Cartwright & Roberts, Inc., (hereinafter "Engineer"), a company authorized to conduct business in the State of Texas.

WHEREAS, the parties executed and accepted that certain Professional Engineering Services Agreement on May 24, 2011, (hereinafter "Agreement") for the expansion of Front Street as a part of the Williams Way Project No. 747, located in Fort Bend County, Texas, under the 2007 Fort Bend County Mobility Programs, (hereinafter "Project"); and

WHEREAS, the parties desire to amend the agreement to include additional engineering services for the construction of a four-lane concrete boulevard between Wheaton Street and Loop 762 under the Front Street Improvements Project X-18, as described in Exhibit A, attached hereto and incorporated herein for all purposes.

NOW, THEREFORE, the parties do mutually agree as follows:

1. Engineer shall provide additional engineering services as described in Exhibit A for an amount not to exceed eighty-five thousand five hundred five dollars and no/100 (\$85,505.00).
2. The Maximum Compensation shall be increased to an amount not exceed three hundred forty-five thousand five hundred five dollars and no/100 (\$345,505.00) under the Agreement and this Amendment.
3. In no case shall the amount paid by County to Engineer under the Agreement or this Amendment exceed the Maximum Compensation without an approved change order.
4. The parties agree, the Agreement remained in full force and effect from May 24, 2011 to date, has not been modified or amended and, shall continue from Engineer's receipt of the Notice to Proceed from County and end no later than twenty-four (24) months thereafter.
5. If there is a conflict between this Amendment and the Agreement, the provisions of this Amendment shall prevail.

FORT BEND COUNTY

Robert E. Hebert
Robert E. Hebert, County Judge

LIPPKE, CARTWRIGHT & ROBERTS, INC.

Paul Lippke
Paul Lippke, President

9-1-2015

Date

Aug 26, 2015

Date

ATTEST:

Laura Richard
Laura Richard, County Clerk

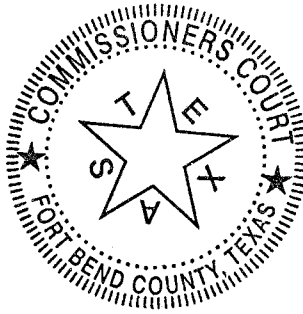

APPROVED:

Richard W. Stolleis
Richard W. Stolleis, P.E., County Engineer

AUDITOR'S CERTIFICATE

I hereby certify that funds are available in the amount of \$ 345,505.⁰⁰ to accomplish and pay the obligation of Fort Bend County, under this contract.

Robert Edward Sturdivant
Robert Edward Sturdivant, County Auditor

EXHIBIT A

**Front Street Improvements
Fort Bend County Project No. X-18
Lippke Cartwright & Roberts, Inc.**

**Contract Amendment Summary
August 2015**

Original Contract Amount:	\$260,000.00
Billed to Date:	\$156,216.00
Remaining Amount	\$103,784.00

Current Fee Request:	\$188,289.00
----------------------	--------------

Amendment Required:	\$84,505.00
----------------------------	--------------------

LCR FRONT STREET to FM 762 Fee Estimate August 18, 2015

HOURLY RATES

Worker	\$/Hr Bs	\$/Hr OHP
Principal	70.00	195.44
Eng	60.00	167.52
CAD	40.00	111.68

Color code of 3 Firms		
LCR Inc.	ASV CG	TEAM

A. Refresh survey, map ROW, and Signal Warrant.

						SUB	
1	Survey: Topo & ROW	TEAM Engineering & Mapping Service.					24,737
2	Geotech	GET					0
3	Warrant for signal	ASV Consulting Group.					4,150
SUBTOTAL						28,887	
Total PER closure and New ROW metes & bounds						28,887	

B. Detailed Design

		RESPONSIBLE PARTY					SUB
		PPL	ENG	CAD	LCR Inc.		
4	Typ Sections	1	12	20		4,439	
5	Traffic Control Plan	2	28	48		10,442	
6	Roadway P&Ps & Intersection	2	44	60		14,463	
7	Utilities adj plans	2	20	22		6,198	
8	Storm sewer PP	2	44	40		12,229	
9	SW3P		6	32		4,579	
10	Demo Plans	0	2	8		1,228	
11	Design new water, san, FM	2	48	60		15,133	
12	Electrical Duct Bank	1	8	20		3,769	
13	Driveway Adjustments w/ADA	1	24	54		10,247	
14	Ped Elements, Sidewalks	2	6	20		3,630	
15	Trees		2	2		558	
16	Geometrics	1	16	40		7,343	
17	Signs & Striping	1	20	32		7,120	
18	Standard Sheets		8	32		4,914	
19	Construction Cost Estimate	2	12	32		5,975	
19	Standard Specs, RICHMOND	0	8	8		2,234	
20	Standard Specs. TxDOT	0	8	8		2,234	
21	Reproductions, Direct Costs					1,000	
21-A	Mileage					1,000	
SUBTOTAL		19	316	538		118,734	LCR Inc.

SUBS

22	Traffic signal at Austin St.	ASV CG.				22,000	ASV CG
----	------------------------------	---------	--	--	--	--------	--------

Total Detailed Design						118,734	22,000
------------------------------	--	--	--	--	--	----------------	---------------

C. Bidding and Construction

		SUB	PPL	ENG	CAD	LCRUS	SUB
23	Prepare Project Manual		1	16	8		3,769
24	Attend Pre-bid w/CDs		0	4	2		893
25	Review Submittals		0	16	4		3,127
26	Address RFIs		2	10	12		3,406
27	Site Visits		1	16	4		3,322

SUBS

28	Traffic signal at Austin St.	ASV CG.				4,150	ASV CG
----	------------------------------	---------	--	--	--	-------	--------

Total Bidding and CPS						4	62	30	14,518	4,150	18,668
------------------------------	--	--	--	--	--	----------	-----------	-----------	---------------	--------------	---------------

GRAND TOTAL FEES						133,252	55,037	188,289
-------------------------	--	--	--	--	--	----------------	---------------	----------------

REVISED AUG. 18, 2015. BJM PE. CHANGES IN BURNT ORANGE.

BJM PE.
8-18-15.

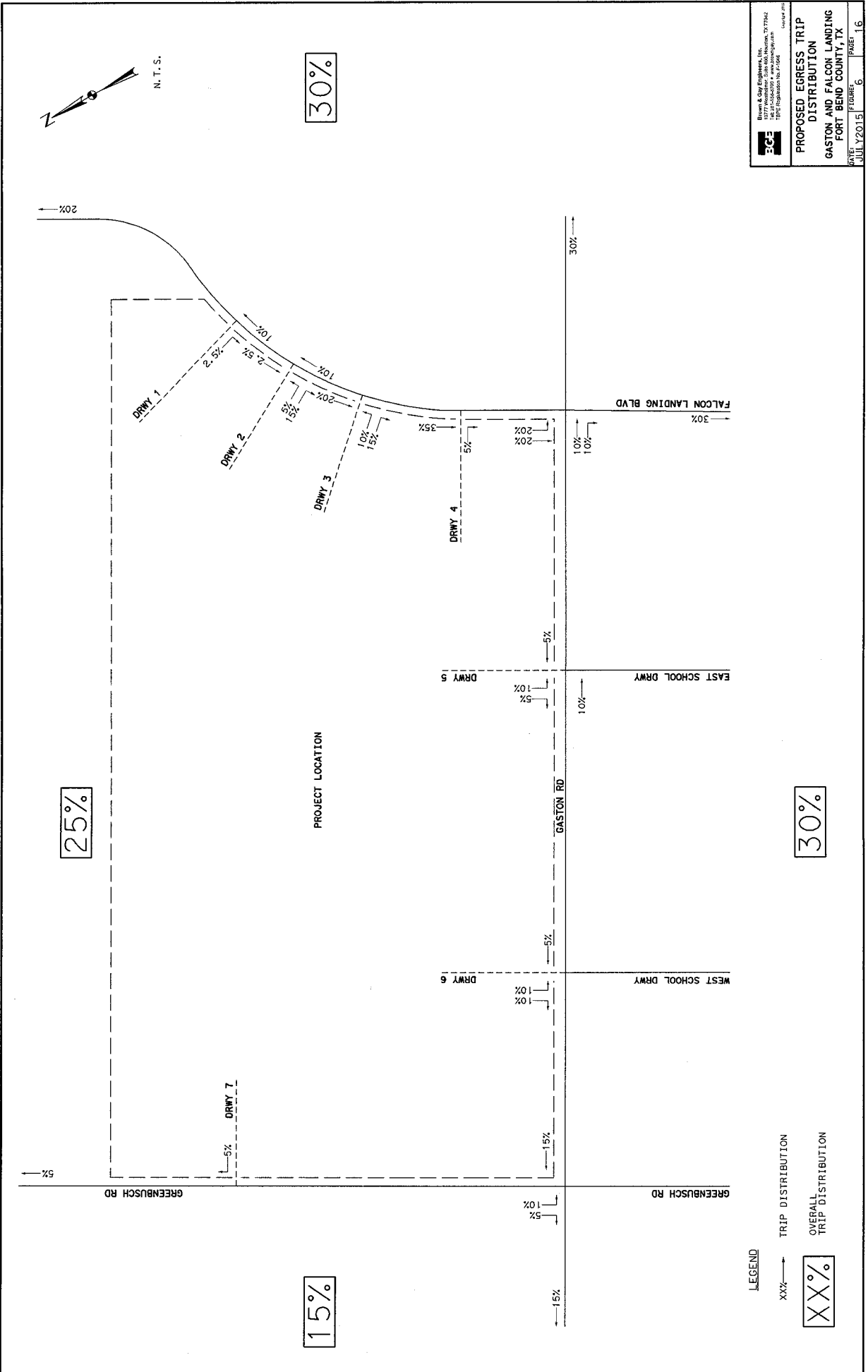

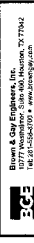
 EGRESS ENGINEERING, INC.
 14015 HUNTERS LANE, SUITE 200
 FORT WORTH, TEXAS 76134
 TEL: 817-412-0000 FAX: 817-412-0001
 WWW.EGRESSENGINEERING.COM

PROPOSED EGRESS TRIP DISTRIBUTION
 GASTON AND FALCON LANDING
 FORT BEND COUNTY, TX

DATE: JULY 2015 FIGURE: 6 SHEET: 16

LEGEND
 XXX% → TRIP DISTRIBUTION
 XXX% OVERALL TRIP DISTRIBUTION

...Figure 6-Trip Distribution Egress.dwg/23/2015 4:39:48 PM Traffic