



Fort Bend County Engineering
FORT BEND COUNTY, TEXAS

Richard W. Stolleis, P.E.
County Engineer

September 30, 2015

Mr. Michael Hobbs, PE
Interim Fort Bend Area Engineer, Houston District
Texas Department of Transportation
7600 Washington Avenue
Houston, Texas 77007

SUBJECT: Spur 10: US 59 to SH 36
Control: 0187-05-048

Dear Mr. Hobbs:

Please find enclosed a signed original letter of approval regarding the road closures and detours for the stated project, complete with approved Commissioners Court minutes.

If you have any questions or require additional information, please do not hesitate to contact me at 281-633-7506.

Sincerely,

Richard W. Stolleis, P.E.
County Engineer
Fort Bend County



125 EAST 11TH STREET | AUSTIN, TEXAS 78701-2483 | (512) 463-8580 | WWW.TXDOT.GOV

July 29, 2015

CONTACT: FTBAE

Control: 0187-05-048

Spur 10 FM 359: US 59 to SH 36
Fort Bend County



Mr. Richard Stolleis, P.E.
County Engineer
Fort Bend County Engineering Department
1124 Blume Road
Rosenberg, Texas 77471

Dear Mr. Stolleis:

Construction plans are being prepared by the Texas Department of Transportation (TxDOT) for the widening of Spur 10. This project consists of building Phase 2 which consists of constructing a 2-lane concrete facility with shoulders, a bridge at Cottonwood Creek, signing and pavement markings. This project is scheduled for letting in August 2016. Anticipated construction time for this project is approximately 18 to 24 months.

To expedite construction, permission is being requested from Fort Bend County for the following road closures:

- 1) Klosterhoff Road at Spur 10
- 2) Sims Road at Spur 10
- 3) Kunz Road at Spur 10
- 4) Band Road at Spur 10
- 5) Fenske Lane at Spur 10

Construction will utilize fast track concrete pavement to minimize the length of closure to 3-5 days at each intersection. Any two intersections will not be closed simultaneously.

We are aware that road closures will result in a certain amount of inconvenience to motorists using these roads. However, the safety of the traveling public is paramount to this contract and shall be so regarded by the construction contractor. The proposed closure will expedite construction, which in turn will result in less inconvenience to the traveling public reducing the exposure to construction work zone conditions.

Attached for your use are the detour layouts depicting the road closures and their proposed temporary detours.

Please designate your approval by signing below and returning to us as soon as possible. We

Mr. Richard Stolleis
July 29, 2015
Page 2

appreciate your consideration in this matter. If you have any questions, or need additional information, please contact Robert S. Bissett, P.E. at (281) 238-7903.

Sincerely,

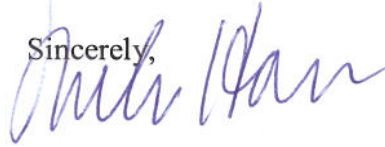

Michael Hobbs, PE
Interim Fort Bend Area Engineer
Houston District

RSB:
Attachments

Approval Granted

Richard Stolleis, P.E.
County Engineer, Fort Bend County

Date: 9/2/15

LEGEND:

- SIGN
 - TYPE III BARRICADE
1. MESSAGE BOARDS "H" TO BE IN PLACE TWO (2) WEEKS PRIOR TO CLOSING INTERSECTION OF KLOSTERHOFF RD AT SPUR 10.
 2. CLOSURE IS FOR A MAXIMUM OF FIVE (5) WORKING DAYS. THE AREA ENGINEER WILL HAVE FINAL APPROVAL OF THE SELECTED TIME FOR THE CLOSURE.
 3. FOR SIGN SPACING, REFER TO BC STANDARDS ENTIRE ROADWAY.
 4. TYPE III BARRICADES TO BE PLACED ACROSS ENTIRE ROADWAY.
 5. PROVIDE FLASHING WARNING LIGHTS ON ALL WARNING SIGNS AND BARRICADES.
 6. PRIOR TO OPENING TO TRAFFIC - PLACE WORK ZONE PAVEMENT MARKINGS.

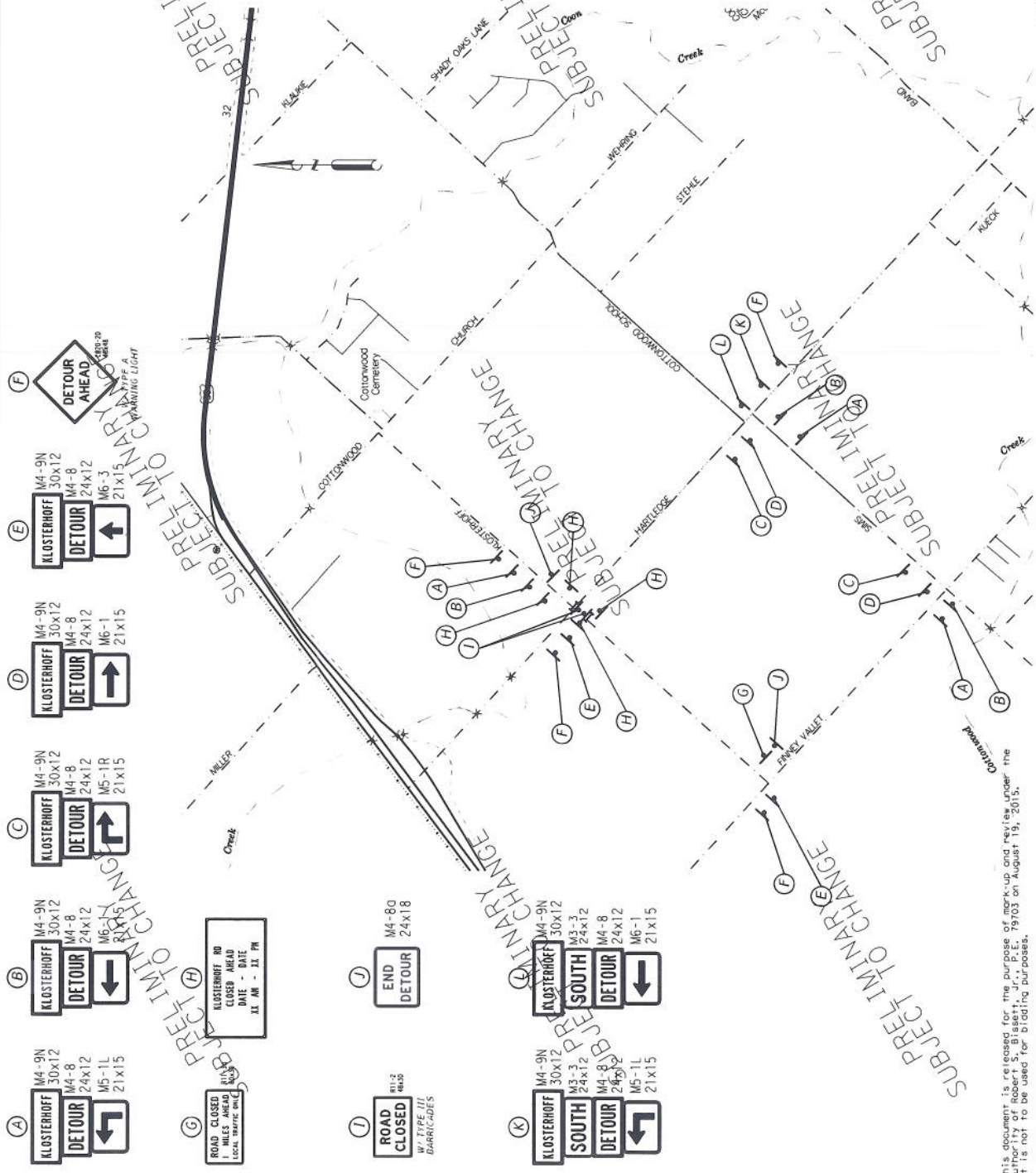

DETOUR LAYOUT
KLOSTERHOFF RD
AT SPUR 10 CLOSURE
PHASE 2



CONT	SECT	JOB	HIGHWAY
0187	05	048	SS 10
DIST	COUNTY		
HOU	FORT BEND		

SHEET 1 OF 1

SCALE: 1"=2000'

This document is released for the purpose of mark-up and review under the authority of Robert S. Bissett, Jr., P.E., 79703 on August 19, 2015. It is not to be used for bidding purposes.

LEGEND:

 SIGN

 TYPE III BARRICADE
 NOTES

1. MESSAGE BOARDS "T" TO BE IN PLACE TWO (2) WEEKS PRIOR TO CLOSING INTERSECTION OF SIMS ROAD AT SPUR 10.
2. CLOSURE IS FOR A MAXIMUM OF FIVE (5) WORKING DAYS. THE AREA ENGINEER WILL HAVE FINAL APPROVAL OF THE SELECTED TIME FOR THE CLOSURE.
3. FOR SIGN SPACING, REFER TO BC STANDARDS.
4. TYPE III BARRICADES TO BE PLACED ACROSS ENTIRE ROADWAY.
5. PROVIDE FLASHING WARNING LIGHTS ON ALL WARNING SIGNS AND BARRICADES.
6. PRIOR TO OPENING TO TRAFFIC, PLACE WORK ZONE PAVEMENT MARKINGS.

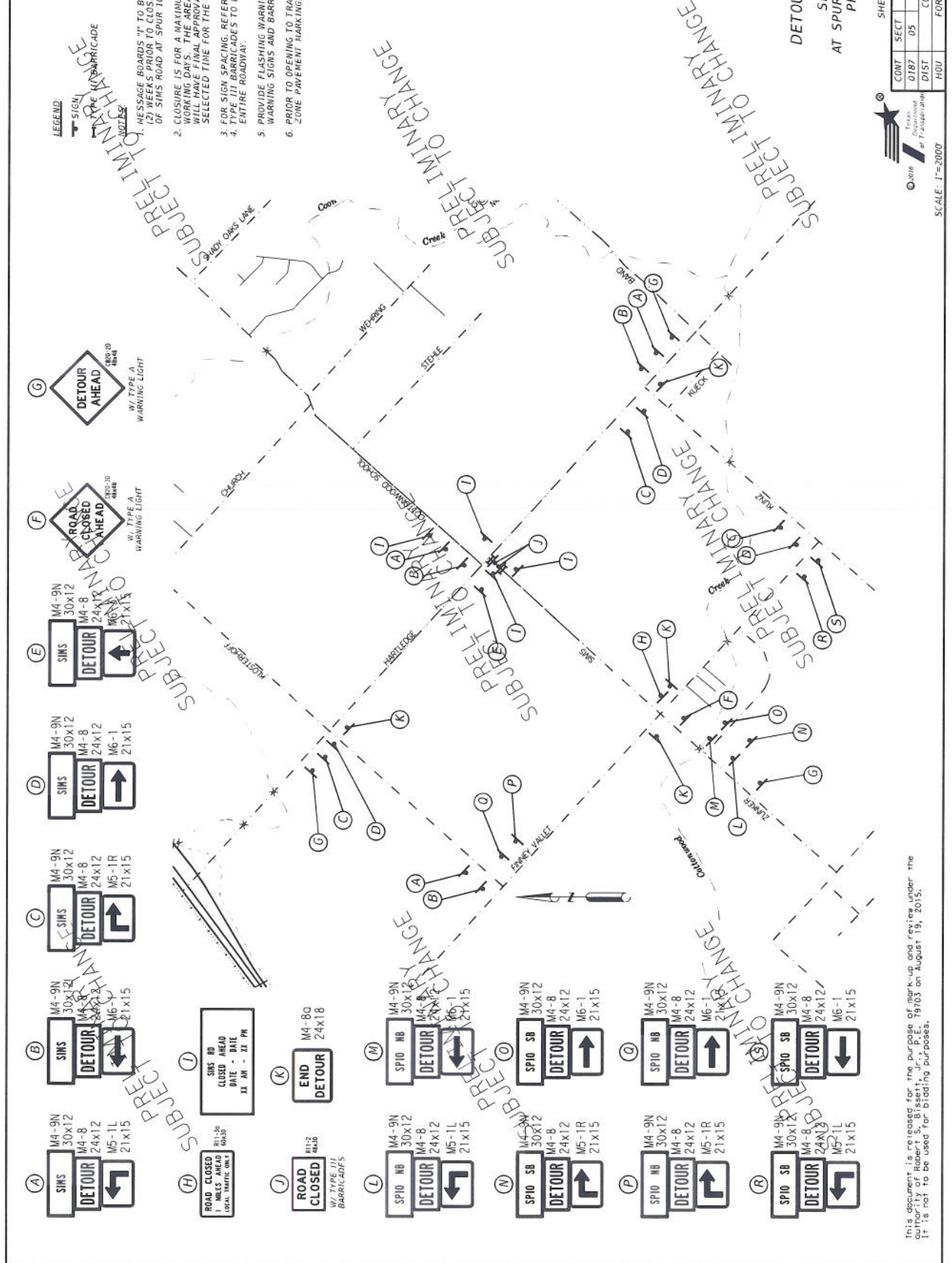
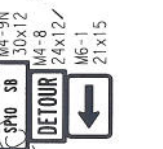
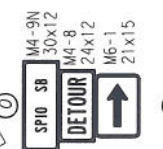

DETOUR LAYOUT
 SIMS RD
 AT SPUR 10 CLOSURE
 PHASE 2

SHEET 1 OF 1	
CONT	0187
SECT	05
JOB	048
HIGHWAY	SS 10
DIST	COUNTY
HOU	FORT BEND
SHEET NO.	2

This document is released for the purpose of mark-up and review under the authority of Robert S. Bissett, Jr., P.E., 79703 on August 19, 2015. It is not to be used for bidding purposes.

SCALE: 1"=200'

LEGEND:

— SIGN

— TYPE III BARRICADE

NOTES:

1. SPUR ROADS "L" TO BE IN PLACE TWO WEEKS PRIOR TO CLOSING INTERSECTION OF KUNZ ROAD AT SPUR TO.
2. CLOSURE IS FOR A MAXIMUM OF FIVE (5) WORKING DAYS. THE AREA ENGINEER WILL HAVE FINAL APPROVAL OF THE SELECTED TIME FOR THE CLOSURE.
3. FOR SIGN SPACING, REFER TO BC STANDARDS.
4. TYPE III BARRICADES TO BE PLACED ACROSS ENTIRE ROADWAY.
5. PROVIDE FLASHING WARNING LIGHTS ON ALL WARNING SIGNS AND BARRICADES.
6. PRIOR TO OPENING TO TRAFFIC - PLACE WORK ZONE PAVERMENT MARKINGS.

(A) M4-9N 30x12
 M4-8 24x12
 M5-1R 21x15
DETOUR

(B) M4-9N 30x12
 M4-8 24x12
 M6-1 21x15
DETOUR

(C) M4-9N 30x12
 M4-8 24x12
 M5-1L 21x15
DETOUR

(D) M4-9N 30x12
 M4-8 24x12
 M6-1 21x15
DETOUR

(E) M4-9N 30x12
 M4-8 24x12
 M5-1L 21x15
DETOUR

(F) M4-9N 30x12
 M4-8 24x12
 M6-1 21x15
DETOUR

(G) M4-9N 30x12
 M4-8 24x12
 M5-1R 21x15
DETOUR

(H) M4-9N 30x12
 M4-8 24x12
 M6-1 21x15
DETOUR

(I) M4-9N 30x12
 M4-8 24x12
 M6-3 21x15
DETOUR

(J) ROAD CLOSED AHEAD
 W/ TYPE A WARNING LIGHT

(L) KUNZ RD
 ROAD CLOSED
 DATE - DATE
 11 AM - 11 PM

(K) DETOUR AHEAD
 W/ TYPE A WARNING LIGHT

(M) END DETOUR
 W/ TYPE III BARRICADES

(N) ROAD CLOSED
 W/ TYPE III BARRICADES

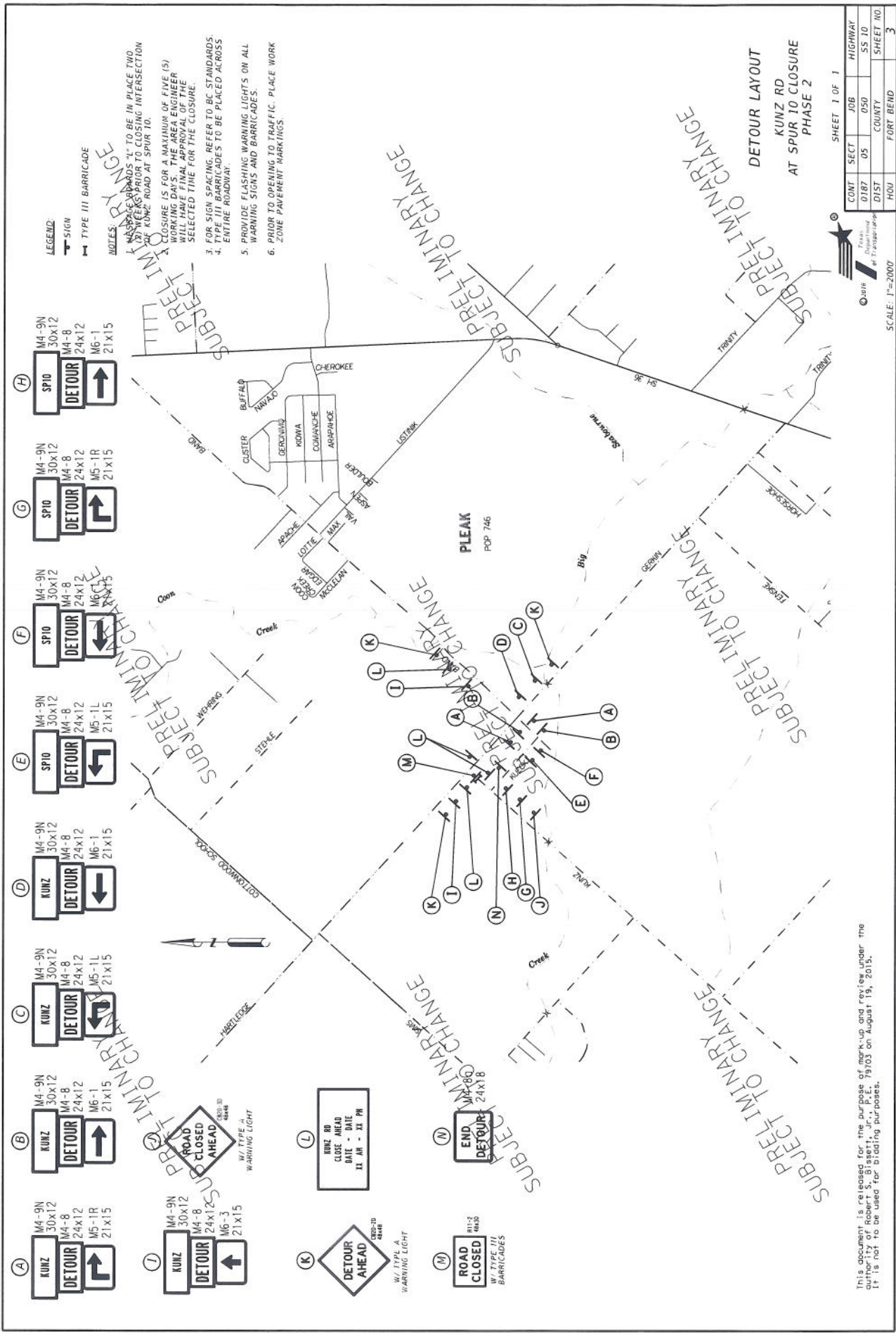

DETOUR LAYOUT
 KUNZ RD
 AT SPUR TO CLOSURE
 PHASE 2



COMT	SECT	JOB	HIGHWAY
0187	05	050	55 TO
DIST		COUNTY	SHEET NO
HOU		FORT BEND	3

This document is released for the purpose of mark-up and review under the authority of Robert S. Bissett, Jr., P.E., 7/9/03 on August 19, 2015. It is not to be used for bidding purposes.

LEGEND:

— SIGN

— TYPE III BARRICADE

1. MESSAGE BOARDS "M" TO BE IN PLACE TWO (2) WEEKS PRIOR TO CLOSING INTERSECTION OF FENSKE LANE AT SPUR 10.
2. CLOSURE IS FOR A MAXIMUM OF FIVE (5) WORKING DAYS. THE AREA ENGINEER WILL HAVE FINAL APPROVAL OF THE SELECTED TIME FOR THE CLOSURE.
3. FOR SIGN SPACING, REFER TO BC STANDARDS ENTIRE ROADWAY.
4. TYPE III BARRICADES TO BE PLACED ACROSS ENTIRE ROADWAY.
5. PROVIDE FLASHING WARNING LIGHTS ON ALL WARNING SIGNS AND BARRICADES.
6. PRIOR TO OPENING TO TRAFFIC, PLACE WORK ZONE PAVEMENT MARKINGS.

(A) FENSKE LN DETOUR 30x12 M4-9N, 24x12 M4-8, 21x15 M5-1R, M6-3

(B) FENSKE LN DETOUR 30x12 M4-9N, 24x12 M4-8, 21x15 M6-1

(C) FENSKE LN DETOUR 30x12 M4-9N, 24x12 M4-8, 21x15 M5-1L

(D) FENSKE LN DETOUR 30x12 M4-9N, 24x12 M4-8, 21x15 M6-1

(E) SP10 DETOUR 30x12 M4-9N, 24x12 M4-8, 21x15 M5-1L

(F) SP10 DETOUR 30x12 M4-9N, 24x12 M4-8, 21x15 M6-1

(G) SP10 DETOUR 30x12 M4-9N, 24x12 M4-8, 21x15 M5-1R

(H) SP10 DETOUR 30x12 M4-9N, 24x12 M4-8, 21x15 M6-1

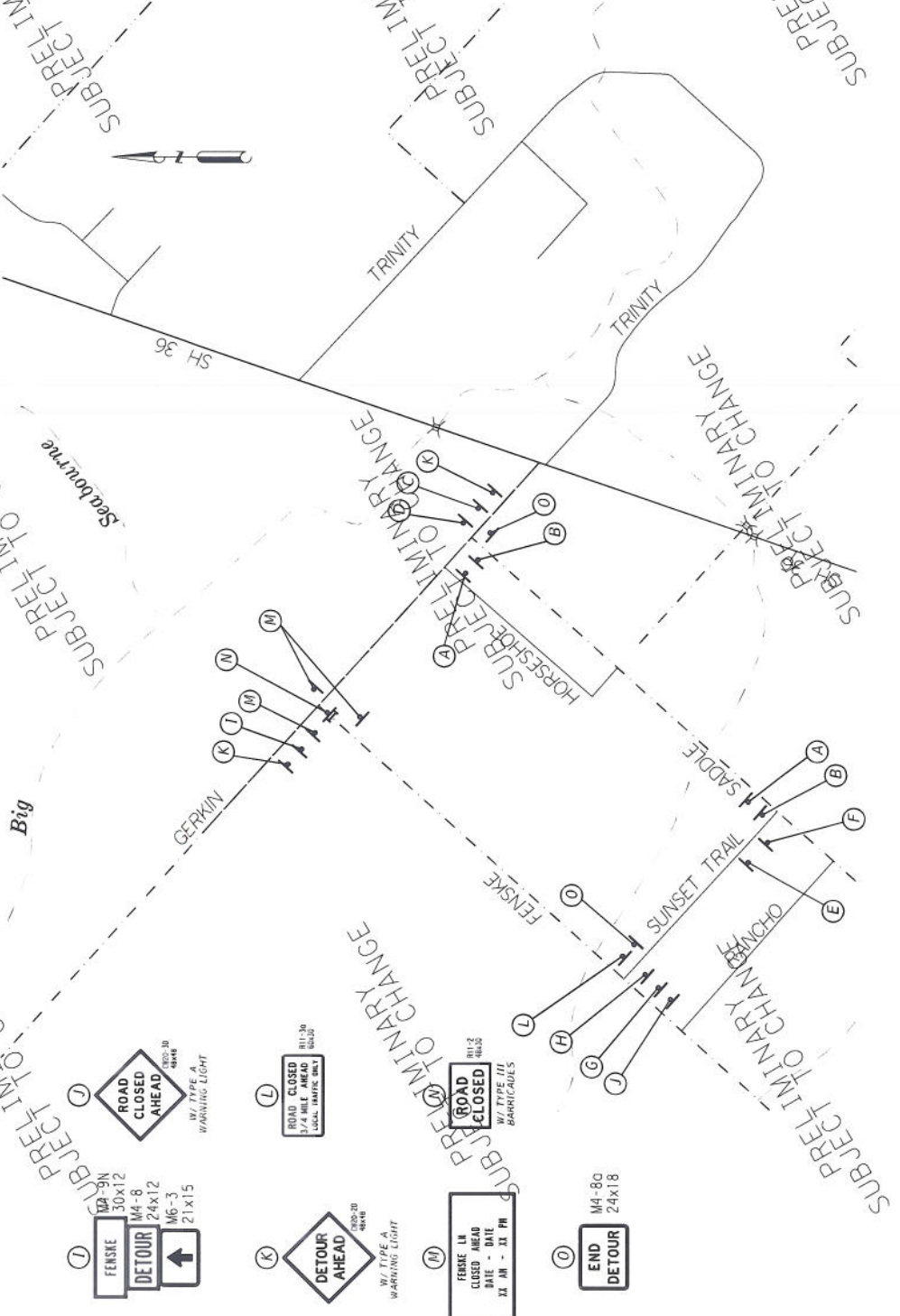

DETOUR LAYOUT
FENSKE LN
AT SPUR 10 CLOSURE
PHASE 2



CONT	SECT	JOB	HIGHWAY
0187	05	050	SS 10
DIST	COUNTY	SHEET NO.	SHEET NO.
			5

SCALE: P=1000'

This document is released for the purpose of mark-up and review under the authority of Robert S. Bessert, Jr., P.E. 19103 on August 19, 2015. It is not to be used for bidding purposes.