

REVIEW BY FORT BEND COUNTY COMMISSIONERS COURT

On this 23rd day of June, 2015, Commissioners Court came on to be heard and reviewed the accompanying notice of Lone Star Steel Supply
Job Location 8660 Fm 1464, Richmond, TX 77407
Date 6/4/2015 Bond No. 5200427, Permit No. 2015-570 to make use of certain Fort Bend County property subject to, "A Revised Order Regulating the Laying, Construction, Maintenance, and Repair of Buried Cables, Conduits, and Pole Lines, In, Under, Across or Along Roads, Streets, Highways, and Drainage Ditches in Fort Bend County, Texas, Under the Jurisdiction of the Commissioners Court of Fort Bend County, Texas," as passed by the Commissioners Court of Fort Bend County, Texas the 3rd day of August, 1987, recorded in Volume _____ of the Minutes of the Commissioners Court of Fort Bend County, Texas, to the extent that such order is not inconsistent with Article 1436a, Vernon's Texas Civil Statutes. Upon Motion of Commissioner Meyers, seconded by Commissioner Patterson, duly put and carried, it is ORDERED, ADJUDGED AND DECREED that said notice of said above purpose is hereby acknowledged by the Commissioners Court of Fort Bend County, Texas, and that said notice be placed on record according to the regulation order thereof.

Notes:

1. Evidence of review by the Commissioners Court must be kept on the job site and failure to do so constitutes grounds for job shutdown.
2. Written notices are required:
 - a. 48 hours in advance of construction start up, and
 - b. when construction is completed and ready for final inspection
 Mail notices to: Permit Administrator
Fort Bend County Engineering
301 Jackson Street
Richmond, Texas 77469
281-633-7500
3. This permit expires one (1) year from date of permit if construction has not commenced.

By: [Signature]
County Engineer
N/A

Presented to Commissioners Court and approved.
Recorded in Volume 6-23-15 11BB
Minutes of Commissioners Court

By: _____
Drainage District Engineer/Manager

Clerk of Commissioners Court
By: [Signature]
Deputy

County of Fort Bend
Engineering Department

301 Jackson Street
Richmond, Texas 77469

Johnny Ortega
Permit Administrator

Phone: (281) 633-7500

**Permit Application Review Form For
Cable, Conduit, and Pole Line Activity
In Fort Bend County**

Permit No. 2015-570

The following "Notice of Proposed Cable, Conduit, and/or Pole Line activity in Fort Bend County" and accompanying attachments have been reviewed and the notice conforms to appropriate regulations set by Commissioner's Court of Fort Bend County, Texas.

 X (1) Complete Application Form:

- X a. Name of road, street, and/or drainage ditch affected.
- X b. Vicinity map showing course of directions
- X c. Plans and specifications

 X (2) Bond:

District Attorney, approval when applicable.

 X Perpetual bond currently posted.

No: 5200427

Amount: \$50,000.00

 Performance bond submitted.

No:

Amount:

 Cashier's Check

No:

Amount:

 (3) Verbal permission given for emergencies, to start construction before approved in Commissioner's Court.

 Precinct Engineer Acknowledgment

 Date

 Precinct Commissioner Acknowledgment

 Date

 X (4)

Drainage District Approval when applicable

We have reviewed this project and agree it meets minimum requirements.

 Johnny Ortega CFM

Johnny Ortega CFM/Permit Administrator

 6-23-15

Date

**PERPETUAL BOND COVERING CABLE, CONDUIT AND/OR POLE LINE
ACTIVITY IN, UNDER, ACROSS OR ALONG FORT BEND COUNTY ROADS
(AUTHORIZED)**

BOND NO 5200427
THE STATE OF TEXAS §
COUNTY OF FORT BEND §

KNOW ALL MEN BY THESE PRESENTS:

THAT WE, Mark Scott DBA Lone Star Steel Supply whose address is 1318 McDonald St. Deer Park, TX 77536 as Principal, and SureTec Insurance Company, a Corporation existing under and by virtue of the laws of the State of Texas and authorized to do an indemnifying business in the State of Texas, and whose principal office is located at 1330 Post Oak Blvd., Suite 1100 Houston, TX 7, whose officer residing in the State of Texas, authorized to accept service in all suits and actions brought within said State is Steven D. Nelson and whose address is 9737 Great Hills Trail, Suite 320, Austin, TX 78759, hereinafter called the Surety, are held and firmly bound unto, Robert E. Hebert, County Judge of Fort Bend County, Texas, or his successors in office, in the full sum of Fifty Thousand Dollars (\$ 50,000.00) current, lawful money of the United States of America, to be paid to said Robert E. Hebert, County Judge of Fort Bend County, Texas, or his successors in office, to which payment well and truly to be made and done, we, the undersigned, bind ourselves and each of us, our heirs, executors, administrators, successors, assigns, and legal representatives, jointly and severally, by these presents.

THE CONDITION OF THIS BOND IS SUCH THAT, WHEREAS, the above bounden principal contemplates laying, constructing, maintaining and/or repairing one or more cables, conduits, and/or pole lines in, under, across and/or along roads, streets and highways in the County of Fort Bend, and the State of Texas, under the jurisdiction of the Commissioners' Court of Fort Bend County, Texas, pursuant to the Commissioners' Court order adopted on the 1st day of December, A.D. 1980, recorded in Volume 13, of the Commissioners' Court Minutes of Fort Bend County, Texas, regulating same, which Commissioners' Court order is hereby referred to and made a part hereof for all purposes as though fully set out herein.

AND WHEREAS, the principal desires to provide Fort Bend County with a perpetual bond covering all such cable, conduit and/or pole line activity;

NOW, THEREFORE, if the above bounden principal shall faithfully perform all its cable, conduit and/or pole line activity (including, but not limited to the laying, constructing, maintaining and/or repair of cables, conduits and/or pole lines) in, under, across and/or along roads, streets and highways in the County of Fort Bend and State of Texas, under the jurisdiction of the Commissioners Court of Fort Bend County, Texas, pursuant to and in accordance with minimum requirements and conditions of the above mentioned Commissioners' Court order set forth and specified to be by said principal done and performed, at the time and in the manner therein specified, and shall pay over and make good and reimburse Fort Bend County, all loss and damages which Fort Bend County may sustain by reason of any failure or default on the part of said principal, then this obligation shall be null and void otherwise to remain in full force and effect.

This bond is payable at the County Courthouse in the County of Fort Bend and State of Texas.

It is understood that at any time Fort Bend County deems itself insecure under this bond, it may require further and/or additional bonds of the principal.

EXECUTED this 22nd day of May, 2015 .

Mark Scott DBA Lone Star Steel Supply

PRINCIPAL

Mark Scott

BY

SureTec Insurance Company

SURETY

Rebecca Shay

BY

Rebecca Shay Attorney in Fact



CCM 6-23-15 # 1188
Fort Bend County Clerk
Return Admin Serv Coord

SureTec Insurance Company
THIS BOND RIDER CONTAINS IMPORTANT COVERAGE INFORMATION

Statutory Complaint Notice/Filing of Claims

To obtain information or make a complaint: You may call the Surety's toll free telephone number for information or to make a complaint or file a claim at: 1-866-732-0099. You may also write to the Surety at:

SureTec Insurance Company
9737 Great Hills Trail, Suite 320
Austin, Tx 78759

You may contact the Texas Department of Insurance to obtain information on companies, coverage, rights or complaints at 1-800-252-3439. You may write the Texas Department of Insurance at

PO Box 149104
Austin, TX 78714-9104
Fax#: 512-490-1007
Web: <http://www.tdi.state.tx.us>
Email: ConsumerProtection@tdi.texas.gov

PREMIUM OR CLAIM DISPUTES: Should you have a dispute concerning your premium or about a claim, you should contact the Surety first. If the dispute is not resolved, you may contact the Texas Department of Insurance.

SureTec Insurance Company

LIMITED POWER OF ATTORNEY

Know All Men by These Presents, That SURETEC INSURANCE COMPANY (the "Company"), a corporation duly organized and existing under the laws of the State of Texas, and having its principal office in Houston, Harris County, Texas, does by these presents make, constitute and appoint

Rebecca Shay

its true and lawful Attorney-in-fact, with full power and authority hereby conferred in its name, place and stead, to execute, acknowledge and deliver any and all bonds, recognizances, undertakings or other instruments or contracts of suretyship to include waivers to the conditions of contracts and consents of surety for:

Principal: Mark Scott DBA Lone Star Steel Supply
Obligee: Fort Bend County Judge
Amount: \$ 50,000.00

and to bind the Company thereby as fully and to the same extent as if such bond were signed by the President, sealed with the corporate seal of the Company and duly attested by its Secretary, hereby ratifying and confirming all that the said Attorney-in-Fact may do in the premises. Said appointment is made under and by authority of the following resolutions of the Board of Directors of the SureTec Insurance Company:

Be it Resolved, that the President, any Vice-President, any Assistant Vice-President, any Secretary or any Assistant Secretary shall be and is hereby vested with full power and authority to appoint any one or more suitable persons as Attorney(s)-in-Fact to represent and act for and on behalf of the Company subject to the following provisions:

Attorney-in-Fact may be given full power and authority for and in the name of and of behalf of the Company, to execute, acknowledge and deliver, any and all bonds, recognizances, contracts, agreements or indemnity and other conditional or obligatory undertakings and any and all notices and documents canceling or terminating the Company's liability thereunder, and any such instruments so executed by any such Attorney-in-Fact shall be binding upon the Company as if signed by the President and sealed and effected by the Corporate Secretary.

Be it Resolved, that the signature of any authorized officer and seal of the Company heretofore or hereafter affixed to any power of attorney or any certificate relating thereto by facsimile, and any power of attorney or certificate bearing facsimile signature or facsimile seal shall be valid and binding upon the Company with respect to any bond or undertaking to which it is attached. (Adopted at a meeting held on 20th of April, 1999.)

In Witness Whereof, SURETEC INSURANCE COMPANY has caused these presents to be signed by its President, and its corporate seal to be hereto affixed this 21st day of March, A.D. 2013.

SURETEC INSURANCE COMPANY

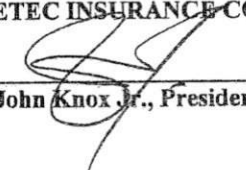
By: 
John Knox Jr., President

State of Texas SS:
County of Harris



On this 21st day of March, A.D. 2013 before me personally came John Knox Jr., to me known, who, being by me duly sworn, did depose and say, that he resides in Houston, Texas, that he is President of SURETEC INSURANCE COMPANY, the company described in and which executed the above instrument; that he knows the seal of said Company; that the seal affixed to said instrument is such corporate seal; that it was so affixed by order of the Board of Directors of said Company; and that he signed his name thereto by like order.

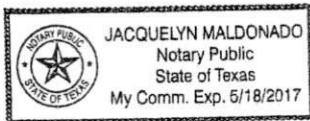

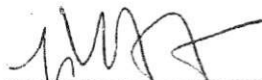

Jacquelyn Maldonado, Notary Public
My commission expires May 18, 2017

I, M. Brent Beaty, Assistant Secretary of SURETEC INSURANCE COMPANY, do hereby certify that the above and foregoing is a true and correct copy of a Power of Attorney, executed by said Company, which is still in full force and effect; and furthermore, the resolutions of the Board of Directors, set out in the Power of Attorney are in full force and effect.

Given under my hand and the seal of said Company at Houston, Texas this 28th day of May, 2015, A.D.

M. Brent Beaty, Assistant Secretary

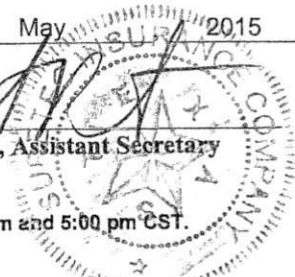
Any instrument issued in excess of the penalty stated above is totally void and without any validity.
For verification of the authority of this power you may call (713) 812-0800 any business day between 8:00 am and 5:00 pm CST.



2015-570

06/04/2015 01:00 PM

8660 Fm 1464

Applicant:
Lonestarsteelsupply
Mark Scott

Paid By: Applicant

Lonestarsteelsupply
Mark Scott
1318 Mcdonald Deer Park, TX 77536

Permit Type

Type	Fee
Commercial Driveway Permit (\$150)	\$150.00
Commercial Driveway Permit (\$150)	\$150.00
Total	\$300.00

Payments

Payment ID	Payment Date	Payment Type	Description	Ref. Number	Amount
633780	06/04/2015	Check	COMMERCIAL DRIVEWAYS	1041	\$150.00
633780	06/04/2015	Check	COMMERCIAL DRIVEWAYS	1041	\$150.00
				Total	\$300.00

Discount Total (\$0.00)

Payment Amount \$300.00

Balance Due \$0.00

THIS IS NOT A PERMIT. This receipt does not authorize you to begin construction of your project.

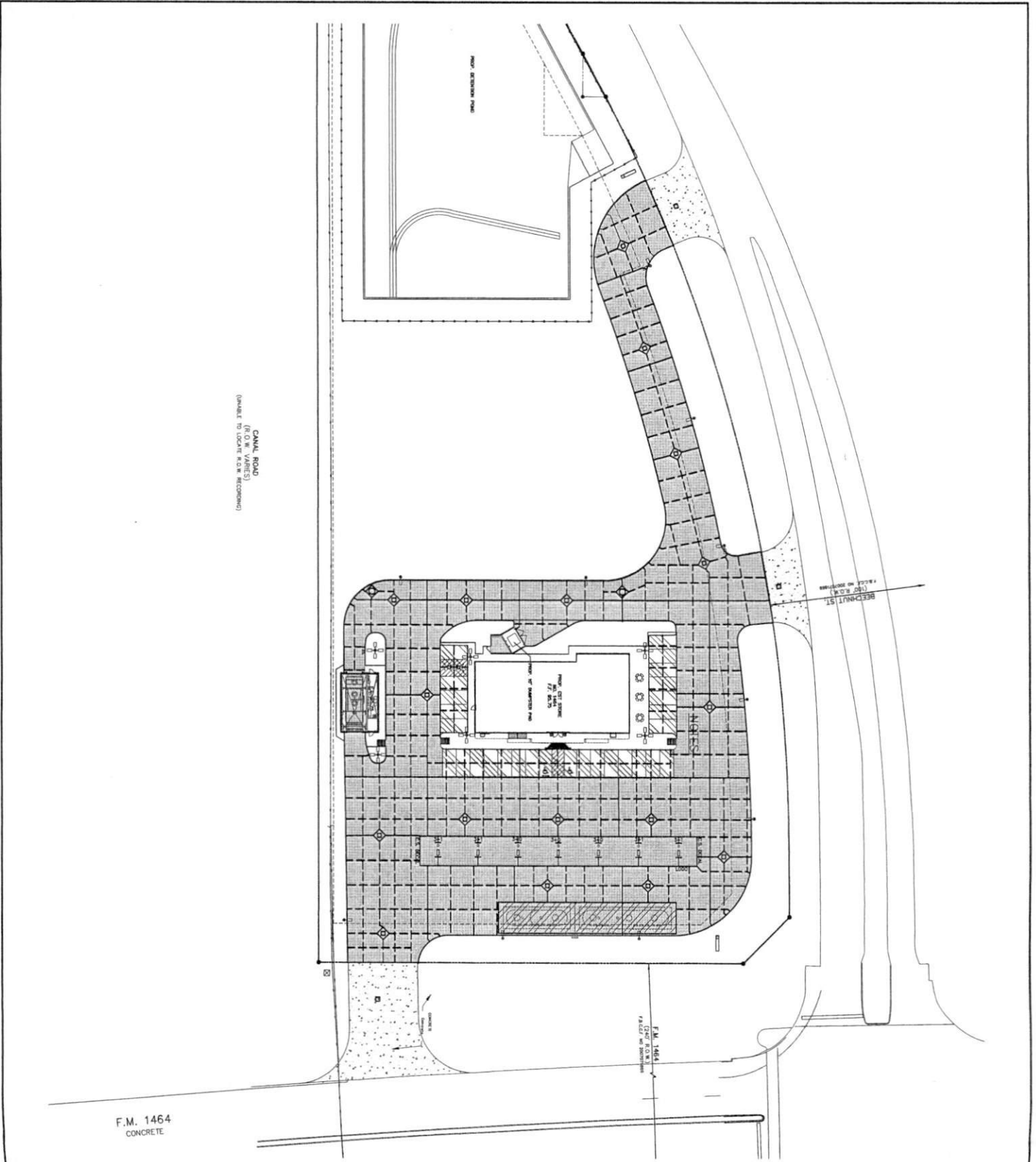

LEGEND:

- SAWED JOINT
- - - EXPANSION JOINT
- ▨ ASPHALT PAVING
- ▧ 5" REINFORCED CONCRETE PAVED SURFACE
- ▩ 6" REINFORCED CONCRETE PAVEMENT W/ STABILIZED SUBGRADE
- 6" REINFORCED CONCRETE PAVING



1. LOCATE EXPANSION JOINTS AS SHOWN. SAWED JOINTS SHALL BE SPACED EVENLY BETWEEN EXPANSION JOINTS AT 15' MAXIMUM SPACING.
2. ALL CURBS TO BE 6" UNLESS OTHERWISE NOTED.
3. LINE UP JOINTS IN SIDEWALK W/ JOINTS IN PARKING LOT.
4. INSTALL EXPANSION JOINTS IN ALL DRIVEWAYS AT ROW LINE.
5. SEE ARCHITECT'S PLANS FOR WHEELSTOP LOCATIONS AND SIDEWALK JOINTING.

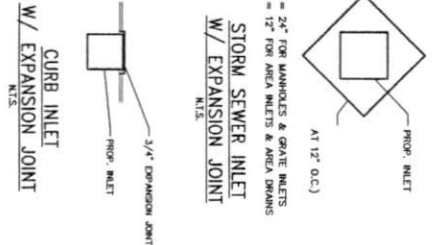

CURB INLET W/ EXPANSION JOINT

STORM SEWER INLET W/ EXPANSION JOINT

D = 24" FOR MANHOLES & GRATE INLETS
 D = 12" FOR AREA INLETS & AREA DRAINS

APPROVAL IS LIMITED TO THE PROJECT AND SITE SHOWN ON THESE PLANS. ANY CHANGES TO THE PROJECT OR SITE SHALL BE APPROVED BY THE ENGINEER. APPROVED: DEVELOPMENT COMMISSIONER

Brooks & Sparans, Inc.
 Consulting Engineers
 TEXAS REGISTERED ENGINEERING FIRM F-1880
 2100 AMW CSM PHONE (281) 298-8888
 SUITE 201-7940 FAX (281) 298-8888

FLOOD PLAN STATEMENT:
 BY GRAPHIC FLOODING ONLY, THIS PROPERTY IS NOT IN A FLOOD HAZARD ZONE. THE FLOOD INSURANCE RATE MAP OF THE UNITED STATES (FIRM NO. 4815707040L, WHICH BEARS AN EFFECTIVE DATE OF APRIL 2, 2014, AND DOES NOT INCLUDE A FLOOD HAZARD ZONE) HAS BEEN REVIEWED. NO FIELD SURVEYING WAS PERFORMED TO DETERMINE THIS ZONE AND AN ELEVATION CERTIFICATE WAS OBTAINED. THIS STATEMENT IS DETERMINED TO BE APPLICABLE FOR A VARIANCE FROM THE FEDERAL EMERGENCY MANAGEMENT AGENCY.

BENCHMARK (TS&P)
 HARRIS COUNTY FLOOD PLAN REFERENCE MARK
 LOCATION: EAST SIDEWALK OF NORTHBOND BRIDGE ON ADDRESS CLONNE ROAD, 0.2 MILES WEST OF 8660 F.M. 1464
 ELEV. = 86.60 FEET (R.O.)
 NAVD 1988, 2007 ADJUSTMENT

T.B.M. "A":
 DESCRIPTION: COTTON ON CONCRETE
 LOCATION: SOUTHWEST CORNER OF TRAIL CORNER, ON NORTHEAST CORNER OF PROPERTY
 ELEV. = 93.14 FEET

T.B.M. "B":
 DESCRIPTION: MAG NAIL
 LOCATION: RIGHT-OF-WAY LINE OF BENCHMUT STREET
 ELEV. = 93.31 FEET

T.B.M. "C":
 DESCRIPTION: RAILROAD SPICE IN POWER POLE
 LOCATION: SOUTH LINE OF PROPERTY & THE EAST LINE OF CANAL ROAD
 ELEV. = 92.98 FEET

BRONKS & SPARANS, INC.
 1-800-451-1880

 J.E. Bronks
 12/31/15

CORNER STORE NO. 1464
 CST BRANDS, INC.
 LOCATED AT
 8660 F.M. 1464,
 RICHMOND, TEXAS 77407

PAVEMENT JOINTING PLAN

NO.	DATE	REVISIONS	BY

DESIGNED BY: JMB
 CHECKED BY: JMB
 PROJECT NO.: 342-0289
 APPROVED BY: JMB
 JANUARY, 2015
 SCALE: SHEET 01 OF 22

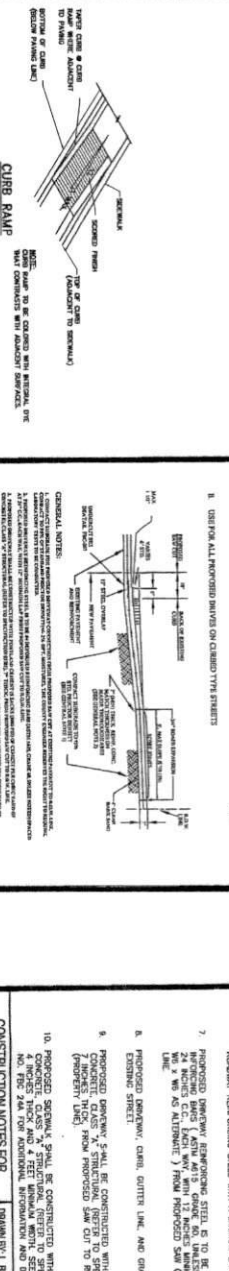
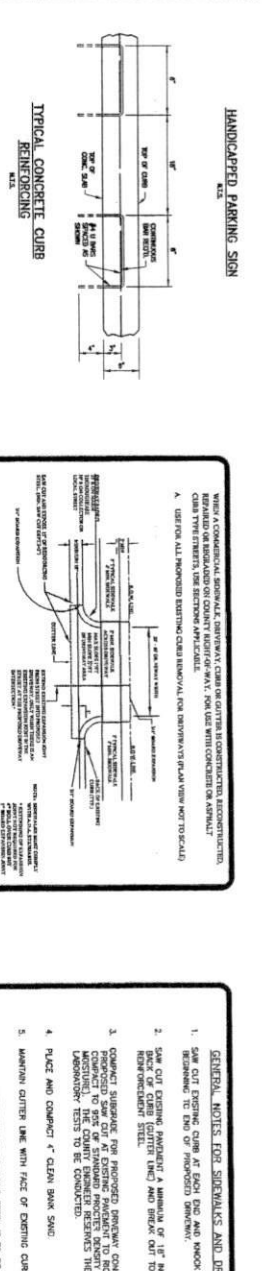
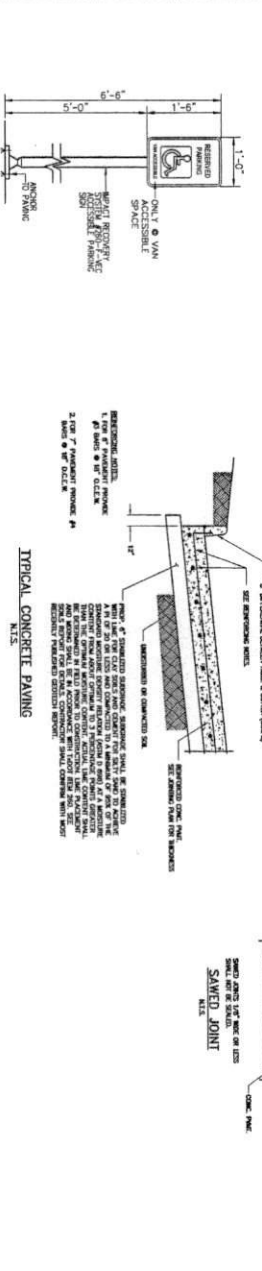
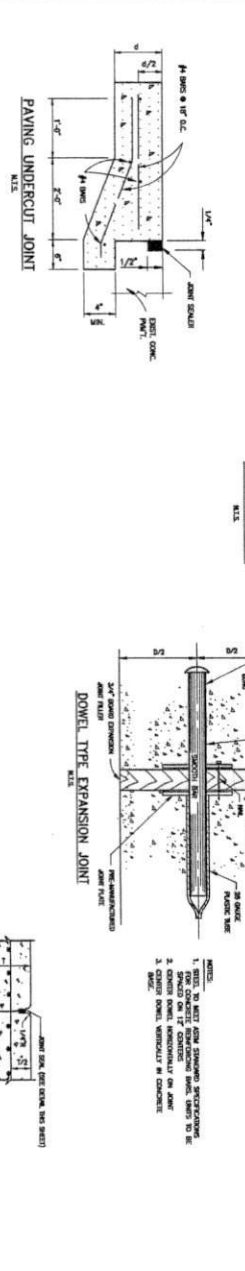
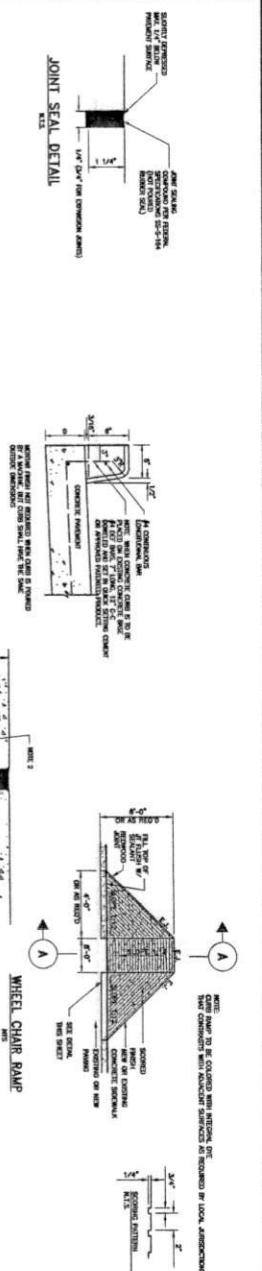

GENERAL NOTES FOR SIDEWALKS AND DRIVEWAYS

- USE A COMPENSATED GRANULAR SUBGRADE OR OTHER COMPENSATION RECOMMENDED BY THE SOILS ENGINEER OR COUNTY HEALTH DEPARTMENT. USE WITH CONCRETE OR ASPHALT CURB TYPE STRIP. USE SECTION 17-342289-DT1.
- USE FOR ALL IMPROVED EXISTING CURB REMOVAL FOR DRIVEWAYS FROM WEST TO EAST.
- USE FOR ALL IMPROVED EXISTING CURB REMOVAL FOR DRIVEWAYS FROM WEST TO EAST.
- USE FOR ALL IMPROVED EXISTING CURB REMOVAL FOR DRIVEWAYS FROM WEST TO EAST.

CONSTRUCTION NOTES FOR SIDEWALKS AND DRIVEWAYS ON CURB TYPE STRIPS

- USE FOR ALL IMPROVED EXISTING CURB REMOVAL FOR DRIVEWAYS FROM WEST TO EAST.
- USE FOR ALL IMPROVED EXISTING CURB REMOVAL FOR DRIVEWAYS FROM WEST TO EAST.
- USE FOR ALL IMPROVED EXISTING CURB REMOVAL FOR DRIVEWAYS FROM WEST TO EAST.
- USE FOR ALL IMPROVED EXISTING CURB REMOVAL FOR DRIVEWAYS FROM WEST TO EAST.

CONCRETE NOTES

CONCRETE SHALL BE PLACED AND COMPACTED TO THE PROPOSED FINISH SURFACE. CONCRETE SHALL BE CURED WITH PAPER AND WATER OR CURING COMPOUND. CONCRETE SHALL BE TESTED FOR STRENGTH AND CURING SHALL BE MAINTAINED FOR 7 DAYS. CONCRETE SHALL BE TESTED FOR STRENGTH AND CURING SHALL BE MAINTAINED FOR 7 DAYS.

APPROVED BY: L. BROOKS
 DATE: 1/14/15
APPROVED BY: L. BROOKS
 DATE: 1/14/15
APPROVED BY: L. BROOKS
 DATE: 1/14/15

FORT BEND COUNTY ENGINEERING DEPARTMENT
 FBC-025A

GENERAL NOTES FOR SIDEWALKS AND DRIVEWAYS

- USE A COMPENSATED GRANULAR SUBGRADE OR OTHER COMPENSATION RECOMMENDED BY THE SOILS ENGINEER OR COUNTY HEALTH DEPARTMENT. USE WITH CONCRETE OR ASPHALT CURB TYPE STRIP. USE SECTION 17-342289-DT1.
- USE FOR ALL IMPROVED EXISTING CURB REMOVAL FOR DRIVEWAYS FROM WEST TO EAST.
- USE FOR ALL IMPROVED EXISTING CURB REMOVAL FOR DRIVEWAYS FROM WEST TO EAST.
- USE FOR ALL IMPROVED EXISTING CURB REMOVAL FOR DRIVEWAYS FROM WEST TO EAST.

CONSTRUCTION NOTES FOR SIDEWALKS AND DRIVEWAYS ON CURB TYPE STRIPS

- USE FOR ALL IMPROVED EXISTING CURB REMOVAL FOR DRIVEWAYS FROM WEST TO EAST.
- USE FOR ALL IMPROVED EXISTING CURB REMOVAL FOR DRIVEWAYS FROM WEST TO EAST.
- USE FOR ALL IMPROVED EXISTING CURB REMOVAL FOR DRIVEWAYS FROM WEST TO EAST.
- USE FOR ALL IMPROVED EXISTING CURB REMOVAL FOR DRIVEWAYS FROM WEST TO EAST.

CONCRETE NOTES

CONCRETE SHALL BE PLACED AND COMPACTED TO THE PROPOSED FINISH SURFACE. CONCRETE SHALL BE CURED WITH PAPER AND WATER OR CURING COMPOUND. CONCRETE SHALL BE TESTED FOR STRENGTH AND CURING SHALL BE MAINTAINED FOR 7 DAYS. CONCRETE SHALL BE TESTED FOR STRENGTH AND CURING SHALL BE MAINTAINED FOR 7 DAYS.

APPROVED BY: L. BROOKS
 DATE: 1/14/15
APPROVED BY: L. BROOKS
 DATE: 1/14/15
APPROVED BY: L. BROOKS
 DATE: 1/14/15

FORT BEND COUNTY ENGINEERING DEPARTMENT
 FBC-025B

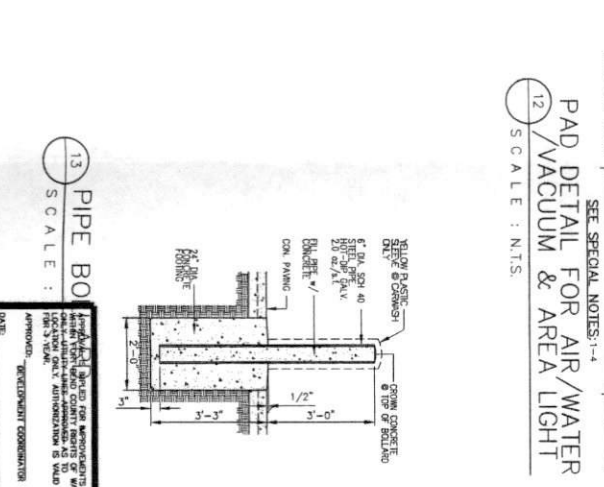
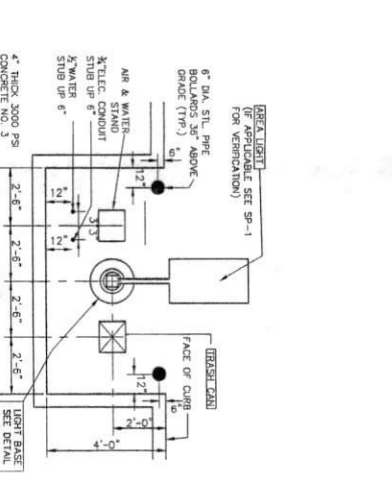
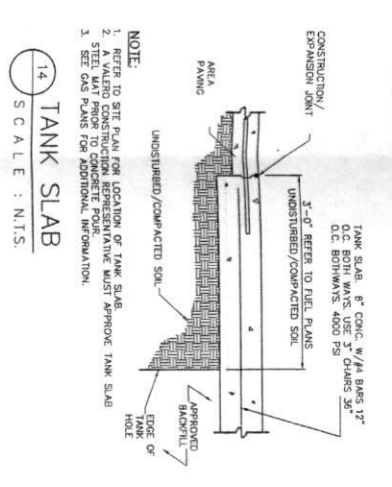

FLOOD PLAIN STATEMENT:
 BY GRAPHIC PLACING ONLY, THIS PROPERTY IS NOT IN A FLOOD PLAIN. THE FLOOD PLAIN MAP NO. 48153D0401, WHICH BEARS AN EFFECTIVE DATE OF 12/15/04, SHOWS THE PROPERTY IS NOT IN A FLOOD PLAIN. THE FLOOD PLAIN MAP NO. 48153D0401, WHICH BEARS AN EFFECTIVE DATE OF 12/15/04, SHOWS THE PROPERTY IS NOT IN A FLOOD PLAIN. THE FLOOD PLAIN MAP NO. 48153D0401, WHICH BEARS AN EFFECTIVE DATE OF 12/15/04, SHOWS THE PROPERTY IS NOT IN A FLOOD PLAIN.

BENCHMARK (TBM):
 HARRIS COUNTY FLOODPLAIN REFERENCE MARK
 LOCATION: EAST SIDEWALK OF NORTHBUILD BRIDGE ON ADDRESS GLODNE ROAD, 0.2 MILES EAST OF 66.69 FEET ELEVATION
 TBM NO. 1988, 2001 ADJUSTMENT
 TBM ELEVATION: 95.14 FEET

TBM '1':
 DESCRIPTION: 1/2" DIA. CONCRETE
 LOCATION: BASE OF TRAFFIC SIGNAL ON NORTHEAST CORNER OF PROPERTY.
 ELEVATION: 93.31 FEET

TBM '2':
 DESCRIPTION: 1/2" DIA. CONCRETE
 LOCATION: SOUTH LINE OF PROPERTY IN POWER POLE
 LOCATION: SOUTH LINE OF PROPERTY IN POWER POLE
 LOCATION: SOUTH LINE OF PROPERTY IN POWER POLE
 ELEVATION: 92.88 FEET

LOCATED AT
 8660 F.M. 1464,
 RICHMOND, TEXAS 77407

CORNER STORE
 NO. 1464

CST BRANDS, INC.

GORNER STORES

APPROVED BY: L. BROOKS
 DATE: 1/14/15

NO.	DATE	REVISIONS	BY
1	1/14/15	ISSUED FOR PERMITS	L. BROOKS
2	1/14/15	ISSUED FOR PERMITS	L. BROOKS
3	1/14/15	ISSUED FOR PERMITS	L. BROOKS
4	1/14/15	ISSUED FOR PERMITS	L. BROOKS
5	1/14/15	ISSUED FOR PERMITS	L. BROOKS
6	1/14/15	ISSUED FOR PERMITS	L. BROOKS
7	1/14/15	ISSUED FOR PERMITS	L. BROOKS
8	1/14/15	ISSUED FOR PERMITS	L. BROOKS
9	1/14/15	ISSUED FOR PERMITS	L. BROOKS
10	1/14/15	ISSUED FOR PERMITS	L. BROOKS
11	1/14/15	ISSUED FOR PERMITS	L. BROOKS
12	1/14/15	ISSUED FOR PERMITS	L. BROOKS
13	1/14/15	ISSUED FOR PERMITS	L. BROOKS
14	1/14/15	ISSUED FOR PERMITS	L. BROOKS
15	1/14/15	ISSUED FOR PERMITS	L. BROOKS
16	1/14/15	ISSUED FOR PERMITS	L. BROOKS
17	1/14/15	ISSUED FOR PERMITS	L. BROOKS
18	1/14/15	ISSUED FOR PERMITS	L. BROOKS
19	1/14/15	ISSUED FOR PERMITS	L. BROOKS
20	1/14/15	ISSUED FOR PERMITS	L. BROOKS
21	1/14/15	ISSUED FOR PERMITS	L. BROOKS
22	1/14/15	ISSUED FOR PERMITS	L. BROOKS

BEECHNUT ST
 PROPOSED DRIVEWAY CONSTRUCTION
 EXISTING POSTED SPEED LIMIT = 35 MPH

- LEGEND:**
- WORK ZONE
 - OPEN TO TRAFFIC
 - SMOOTH POST
 - TRAFFIC MARKERS, CONES OR BARRIERS
- NOTES:**
1. CONTRACTOR SHALL PROVIDE AND INSTALL SUFFICIENT TRAFFIC CONTROL DEVICES WITH PART V OF TEXAS MANUAL ON UNIFORM TRAFFIC CONTROL DEVICES (MUTCD) - LATEST EDITION WITH REVISIONS DURING CONSTRUCTION. NO LINES SHALL BE BLOCKED FROM 7 A.M. TO 5 P.M. AND 4 P.M. TO 6:30 P.M. MONDAY THRU FRIDAY.
 2. OFF DUTY POLICE OFFICERS/AGENTS ARE REQUIRED TO BE PRESENT AT ALL TIMES DURING NON-WORKING HOURS AND ALLOW NORMAL TRAFFIC FLOW.
 3. CONTRACTOR SHALL COVER THE EXCAVATION WITH SAFETY BARRIERS AND TRAFFIC CONTROL DEVICES DURING NON-WORKING HOURS AND ALLOW NORMAL TRAFFIC FLOW.
 4. APPROVED COPIES OF TRAFFIC CONTROL PLANS SHALL BE AVAILABLE FOR INSPECTION AT ALL TIMES.
 5. IF THE CONTRACTOR CHOOSES TO USE A DIFFERENT TRAFFIC CONTROL PLAN DURING THE CONSTRUCTION THAN WHAT IS OUTLINED IN THE CONTRACT DRAWINGS, THE CONTRACTOR SHALL SUBMIT AN ALTERNATE PLAN TO TRAFFIC SECTION OF HDPD FOR APPROVAL TEN WORKING DAYS PRIOR TO IMPLEMENTATION.
 6. THESE PLANS SHALL BE DRAWN TO SCALE ON REPRODUCTION MATING AND SEALED BY A PROFESSIONAL ENGINEER AND SHALL BE A PART OF THE CONTRACT DRAWING.

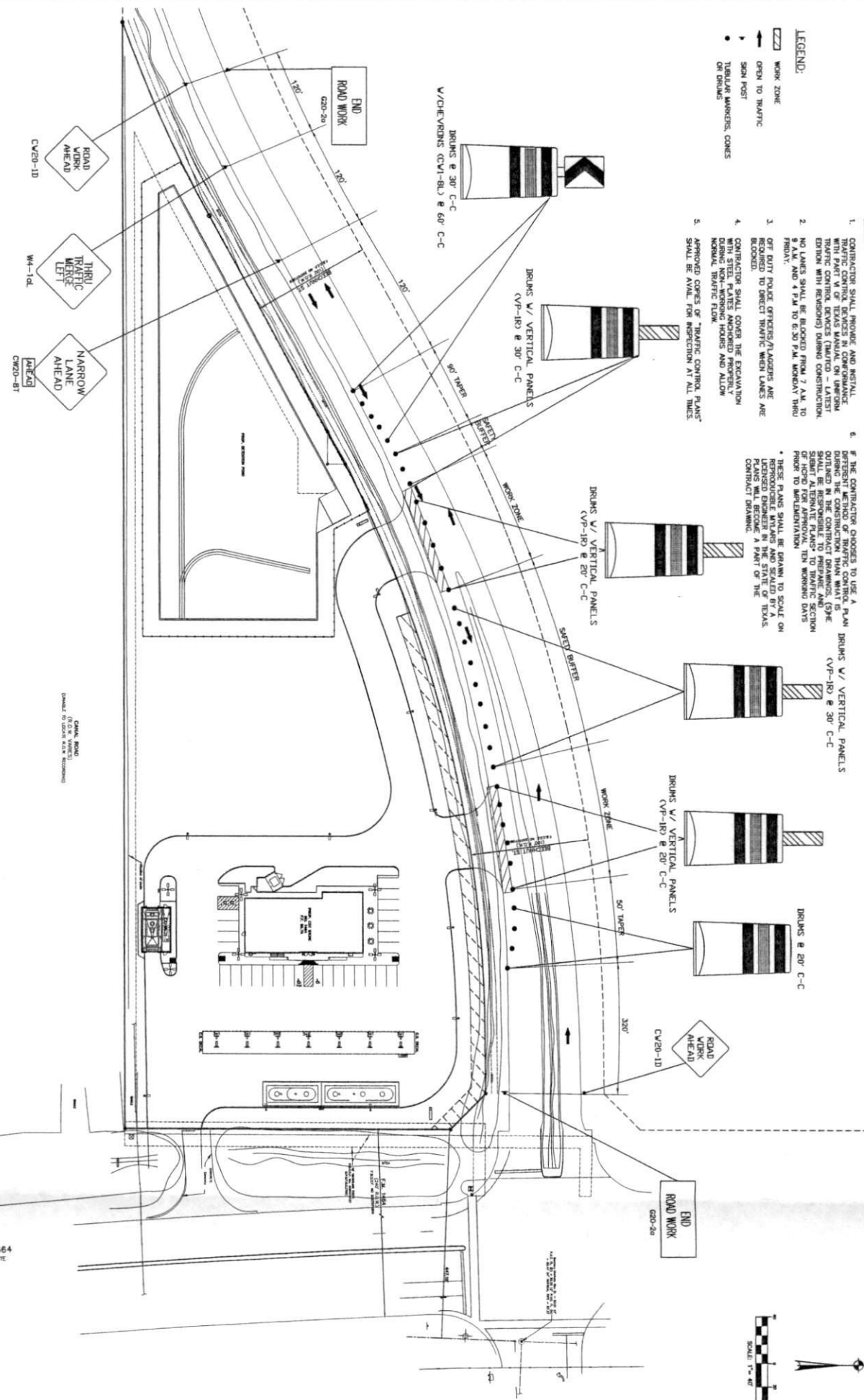

F.M. 1464
 CONCRETE

APPROVAL IS GRANTED FOR APPROXIMATELY 12 MONTHS FROM THE DATE OF THIS PLAN. ANY CHANGES TO THE LOCATION OR SCOPE OF THE PROJECT MUST BE APPROVED BY THE CITY ENGINEER PRIOR TO CONSTRUCTION.

DATE: _____
 APPROVED: _____
 DEVELOPMENT CONSULTANT

<p>BROOKS & SPARKS, INC. Consulting Engineers TEXAS REGISTERED ENGINEERING FIRM F-480 2100 FIVE STAR FIVE STAR DRIVE FORT WORTH, TEXAS 76104 PHONE (817) 293-8888 FAX (817) 293-8888</p>									
<p>FLOOD PLAN STATEMENT: BY GRAPHIC NOTING ONLY, THIS PROPERTY IS NOT IN A FLOOD HAZARD ZONE AS SHOWN ON THE 481570-0-01, WHICH BEARS AN EFFECTIVE DATE OF 12/15/2010. THE FLOOD HAZARD ZONE MAP IS A FIELD SURVEYING WAS PERFORMED TO DETERMINE THIS ZONE AND AN ELEVATION OF 86.00 FEET WAS DETERMINED AS THE DETERMINATION OR APPLY FOR A VARIANCE FROM THE FEDERAL EMERGENCY MANAGEMENT AGENCY.</p>									
<p>BENCHMARK (TS&P) HARRIS COUNTY FLOODPLAIN REFERENCE MARK LOCATION: EAST SIDEWALK OF NORTHBOND BRIDGE ON ADDRESS CLONNE ROAD, 0.2 MILES N.W. OF 1988, 200' ADJUSTMENT ELEV. = 86.69 FEET NAVD 1988, 200' ADJUSTMENT</p>									
<p>T.B.M. "A": DESCRIPTION: 6" x 6" CONCRETE LOCATION: BASE OF TRAFFIC SIGNAL ON NORTHEAST CORNER OF PROPERTY. ELEV. = 93.14 FEET</p>									
<p>T.B.M. "B": DESCRIPTION: MAG NAIL LOCATION: SOUTH SIDE OF RIGHT-OF-WAY LINE OF BEECHNUT STREET ELEV. = 93.33 FEET</p>									
<p>T.B.M. "C": DESCRIPTION: RAILROAD SPW IN POWER POLE LOCATION: SOUTH LINE OF PROPERTY & THE INTERSECTION OF BEECHNUT STREET ELEV. = 92.88 FEET</p>									
<p>BROOKS & SPARKS, INC. 1-800-392-7888</p> <p><i>John E. Sparks</i> 1/24/15</p> <p>REGISTERED PROFESSIONAL ENGINEER STATE OF TEXAS NUMBER 12423</p>									
<p>CORNER STORE NO. 1464</p> <p>LOCATED AT 8660 F.M. 1464, RICHMOND, TEXAS 77407</p>									
<p>TRAFFIC CONTROL PLAN BEECHNUT ST.</p>									
<p>REVISIONS:</p> <table border="1"> <thead> <tr> <th>NO.</th> <th>DATE</th> <th>DESCRIPTION</th> <th>BY</th> </tr> </thead> <tbody> <tr> <td> </td> <td> </td> <td> </td> <td> </td> </tr> </tbody> </table>		NO.	DATE	DESCRIPTION	BY				
NO.	DATE	DESCRIPTION	BY						
<p>DESIGNED BY: JDB CHECKED BY: JDB PROJECT NO.: 24-0289 DATE: JANUARY, 2015 SCALE: 1" = 40'</p>									

Forister, Clay

From: Hatcher, Nathan
Sent: Tuesday, March 24, 2015 7:13 AM
To: Construction
Subject: FW: Request for early work permit for CST Brands Store #1464

FYI - Jorge
Thank You

Nathan D Hatcher
Development Coordinator
Fort Bend County Engineering
301 Jackson Street 4th Floor
Richmond, Texas 77469
281-633-7515
Nathan.hatcher@fortbendcountytexas.gov

From: Meyers, Andy
Sent: Monday, March 23, 2015 4:07 PM
To: Glenn W. McDowell
Cc: Hatcher, Nathan
Subject: RE: Request for early work permit for CST Brands Store #1464

Fort Bend County has no objection to your early start.

Andy Meyers

Commissioner Pct. 3
832-338-1199 Cell
281-238-1400 Office

From: Glenn W. McDowell [<mailto:GlennM@brooksandsparks.com>]
Sent: Monday, March 23, 2015 4:00 PM
To: Meyers, Andy
Cc: Hatcher, Nathan
Subject: Request for early work permit for CST Brands Store #1464

Please see attached letter.

Glenn McDowell
Associate Principal
Brooks & Sparks, Inc.
21020 Park Row
Katy, Tx 77449
Tel (281) 578-9595
Fax (281) 578-9686

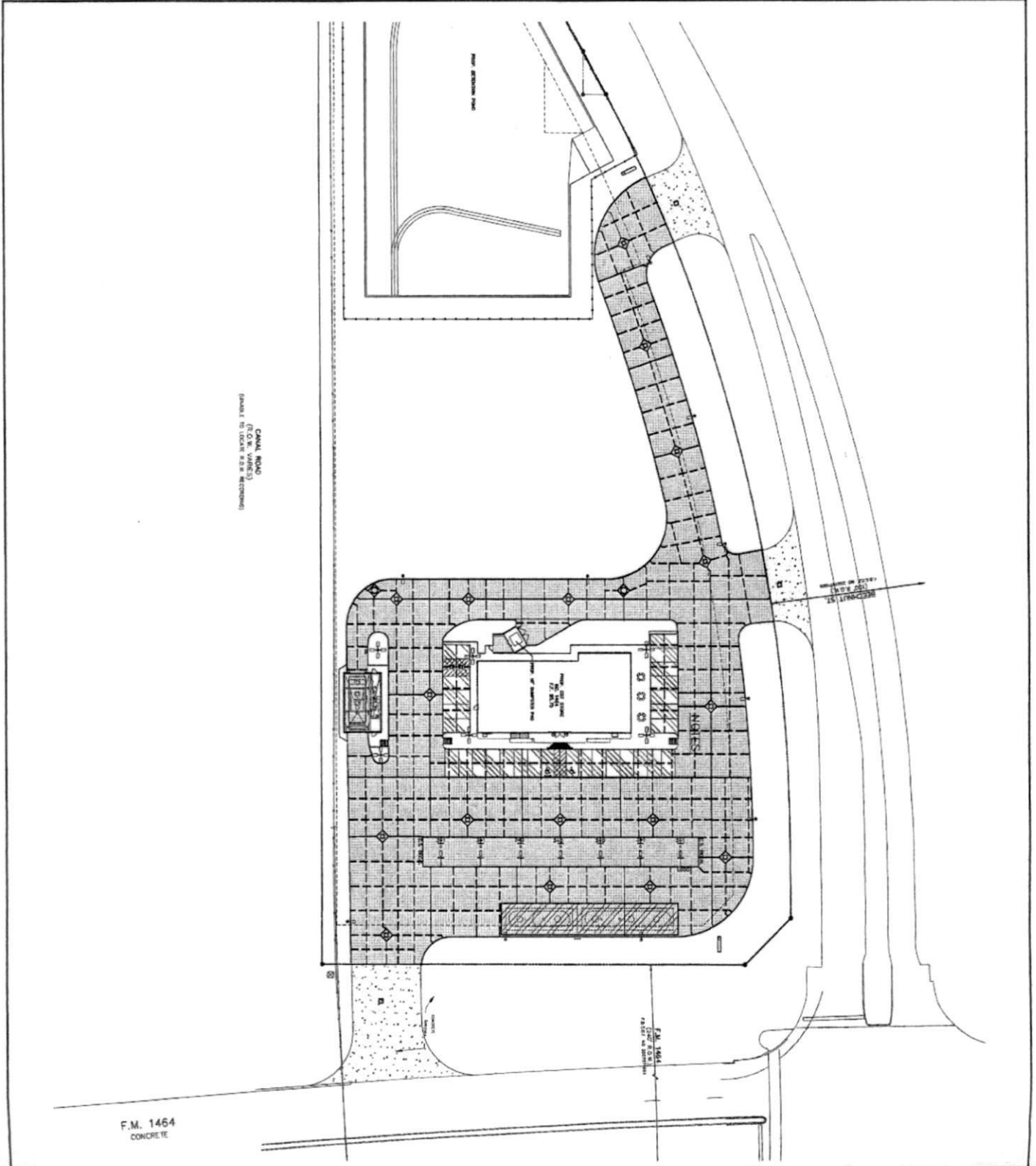

LEGEND:

- EXPANSION JOINT
- ASPHALT PAVING
- 5" REINFORCED CONCRETE PAVEMENT W/ STABILIZED CONCRETE PAVEMENT W/ STABILIZED SANDWICH
- 8" REINFORCED CONCRETE PAVING

SCALE: 1" = 40'

1. LOCATE EXPANSION JOINTS AS SHOWN. SAVED JOINTS SHALL BE SPACED EVENLY BETWEEN EXPANSION JOINTS AT 10' MAXIMUM SPACING.
2. ALL DIMS TO BE 6" UNLESS OTHERWISE NOTED.
3. LIFT UP JOINTS IN SCHEDULE W/ JOINTS IN PAVING LOT.
4. INSTALL EXPANSION JOINTS IN ALL DRIVEWAYS AT ROW LINE.
5. SEE ARCHITECT'S PLANS FOR WHEELSTOP LOCATIONS AND SCHEDULE JOINTING.

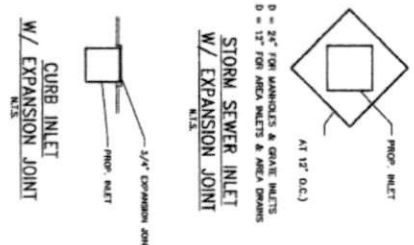

PERSONNEL & MATERIALS FOR APPROXIMATELY 10% OF THE PROJECT SHALL BE STORED ON-SITE AT ALL TIMES. THE CONTRACTOR SHALL MAINTAIN ACCESS TO ALL ADJACENT PROPERTIES AT ALL TIMES. APPROVED BY: [Signature]

DATE: [Blank]

DESIGNATION: [Blank]

BROOKS & SPARKS, INC.
 2700 WEST 10TH AVE
 AUSTIN, TX 78758
 PHONE: (512) 595-8888
 FAX: (512) 595-8888

FLOOD PLAN STATEMENT:
 BY DRAWING PLOTTING ONLY, THIS PROPERTY IS NOT BEING FLOODED. THE FLOODING HAZARD STATE MAP FROM MAP NO. 100-100-0000, WHICH SHOWS AN EFFECTIVE DATE OF 1988, IS BEING REFERENCED. THIS MAP IS A SPECIAL FLOOD HAZARD AREA. NO FLOOD SURVEYING WAS PERFORMED TO DETERMINE THE ACTUAL FLOODING HAZARD. CERTIFICATE MAY BE APPLIED TO VERIFY THE FLOODING HAZARD INFORMATION APPLICABLE TO THIS PROJECT.

BENCHMARK (TRAMP):
 HARRIS COUNTY FLOODPLAN REFERENCE MARK NO. 00085, LAST SURVEYED BY ADJACENT PROPERTY ON ADJACENT CORNER ROAD, 0.2 MILES NORTH OF BELLEVUE R.W.
 ELEV = 92.14 FEET
 DATE 1988, 2001 ADJUSTMENT

TABLE 'N1':
 OCCUPATION: OUT-OF-ROAD CONCRETE PAVING
 NORTH/EAST CORNER OF PROPERTY
 ELEV = 92.14 FEET

TABLE 'T1':
 OCCUPATION: WALKWAY
 NORTH/EAST CORNER OF PROPERTY
 ELEV = 92.14 FEET

TABLE 'C1':
 OCCUPATION: RAINFALL POND IN POWER POLE NORTH/EAST CORNER OF CANAL ROAD
 ELEV = 92.88 FEET

SEAL: [Signature]

REGISTERED PROFESSIONAL ENGINEER
 STATE OF TEXAS
 NO. 1464

CORNER STORE
 NO. 1464

LOCATED AT
 8660 F.M. 1464,
 RICHMOND, TEXAS 77407

PAVEMENT JOINTING PLAN

NO.	DATE	REVISIONS	BY

DESIGNED BY: [Blank]
 CHECKED BY: [Blank]
 DRAWN BY: [Blank]
 INCHES: 1/8" = 1'-0"

- NOTES TO SHEET**
1. CONTRACTOR SHALL LOCATE ALL EXISTING UTILITIES AND STRUCTURES PRIOR TO START OF CONSTRUCTION. CONTRACTOR SHALL VERIFY PROPOSED SITE PLANS DOES NOT COLLIDE WITH EXISTING UTILITIES AND EXISTING STRUCTURES.
 2. CONTRACTOR SHALL VERIFY EXISTING LIGHT STANDARDS LOCATIONS WITH CSI BRANDS, INC. LIGHT STANDARDS.
 3. CONTRACTOR SHALL REFER TO ARCHITECTURAL PLANS FOR EXACT PLACEMENT AND LAYOUT OF EXISTING LIGHT STANDARDS.
 4. CONTRACTOR SHALL REFER TO FUEL PLANS FOR EXACT LAYOUT OF FUEL PUMPS AND GASOLINE TANKS.
 5. CONTRACTOR SHALL REFER TO VERTICAL WALL PLANS FOR LAYOUT OF EXTENSION POND WALL.
 6. CONTRACTOR SHALL REFER TO TO GRADING PLAN FOR EXACT LIMITS OF 4' CURB AND 8' SIDEWALK OF EXISTING POWER POLE.
 7. CONTRACTOR SHALL COORDINATE WITH POWER COMPANY FOR RELOCATION AND/OR REMOVAL OF EXISTING POWER POLE.

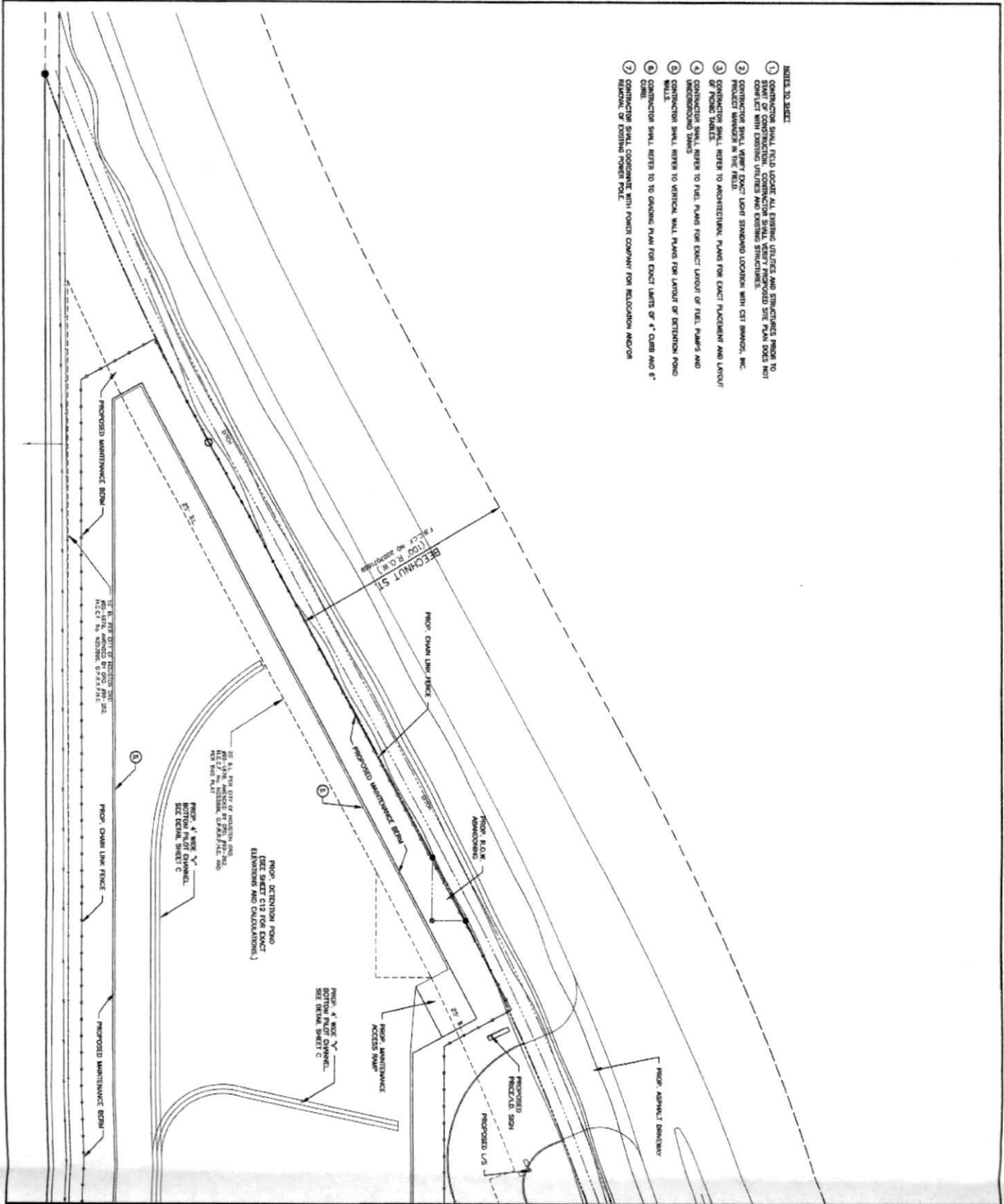

MATCH LINE "A" (SEE SHEET C4 FOR CONTINUATION)



APPROVAL IS LIMITED TO THE PROJECT AND SITE SHOWN HEREON. ANY CHANGES TO THE PROJECT OR SITE SHALL BE APPROVED BY THE ENGINEER. THE ENGINEER'S RESPONSIBILITY IS LIMITED TO THE DESIGN AND CONSTRUCTION OF THE PROJECT SHOWN HEREON.

DATE: _____
 PROJECT NO. 342-289

<p>BROOKS & SPARKS, INC. Consulting Engineers 1000 WEST 10TH STREET, SUITE 200 FORT WORTH, TEXAS 76102 TEL: 817.335.5555 FAX: 817.335.5555</p>		<p>FLOOD PLAIN STATEMENT: BY GRANTING PLATING ONLY, THIS PROPERTY LIES WITHIN ZONE "V" OF THE FLOOD INSURANCE RATE ACT (FIRTA) AND IS THEREFORE SUBJECT TO FLOODING. THE FLOOD INSURANCE RATE ACT (FIRTA) IS A FEDERAL LAW WHICH REQUIRES AN EFFECTIVE DATE OF APRIL 2, 2004, AND DOES NOT USE THE WORDS "FLOOD INSURANCE RATE ACT". THE FIELD SURVEYING WAS PERFORMED TO DETERMINE THE ZONE AND AN ELEVATION. THE DETERMINATION OF ANY FLOOD HAZARD FROM THE FEDERAL EMERGENCY MANAGEMENT AGENCY.</p>	
<p>RECORDING (TAXMAP) HARRIS COUNTY FLOODPLAIN REFERENCE MAP NO. 344555 LOCATION: EAST SIDE OF NORTHBOUND HOV-3 RAMP, I-30, AND DOES NOT USE THE WORDS "FLOOD INSURANCE RATE ACT". ELEV = 66.69 FEET HAV 1998 2007 ADJUSTMENT</p>		<p>TASK "A" DESCRIPTION: CIVIL ON CONCRETE LOCATION: BASE OF RAFTIC COLUMN ON ELEV = 81.14 FEET</p>	
<p>TASK "B" DESCRIPTION: 145' N.W. LOCATION: IN THE SOUTH NORTH-OF-WAY LINE ELEV = 81.31 FEET</p>		<p>TASK "C" DESCRIPTION: RAILROAD SWICH IN POWER POLE LOCATION: SOUTH LINE OF PROPERTY & THE ELEVATION OF THE SWICH IS 81.96 FEET</p>	
<p>PROJECT NO. 342-289 SHEET NO. 2 OF 2</p>			

LOCATED AT
 CORNER STORE
 NO. 1464
 RICHMOND, TEXAS 77407

GORNER STORE
 CST BRANDS, INC.

REGISTERED PROFESSIONAL ENGINEER
 STATE OF TEXAS
 NO. 1464
 J. L. BROOKS

2/2/15

NO. 1464	NO. 1464	NO. 1464	NO. 1464
DATE	DATE	DATE	DATE
PROJECT NO. 342-289	PROJECT NO. 342-289	PROJECT NO. 342-289	PROJECT NO. 342-289
SHEET NO. 2 OF 2	SHEET NO. 2 OF 2	SHEET NO. 2 OF 2	SHEET NO. 2 OF 2

