

REVIEW BY FORT BEND COUNTY COMMISSIONERS COURT

13cc

On this 27 day of MAY, 2014, Commissioners Court
came on to be heard and reviewed the accompanying notice
of AT & T TEXAS

Job Location SANDY RIDGE DRIVE, E. RIVERPARK DRIVE, SUMMIT CREEK

Dated 05/19/14 BOND No. CH1-001686693-01, Permit No. 84584
to make use of certain Fort Bend County property subject to, "A Revised Order
Regulating the Laying, Construction, Maintenance, and Repair of Buried Cables,
Conduits, and Pole Lines, In, Under, Across or Along Roads, Streets, Highways, and
Drainage Ditches in Fort Bend County, Texas, Under the Jurisdiction of the
Commissioners Court of Fort Bend County, Texas," as passed by the Commissioners
Court of Fort Bend County, Texas, date the 3rd day of August, 1987, recorded in
Volume _____ of the Minutes of the Commissioners Court of Fort Bend County,
Texas, to the extent that such order is not inconsistent with Article 1436a, Vernon's
Texas Civil Statutes. Upon Motion of Commissioner Meyers, seconded
by Commissioner Morrison, duly put and carried, it is ORDERED,
ADJUGED AND DECREED that said notice of said above purpose is hereby
acknowledged by the Commissioners Court of Fort Bend County, Texas, and that said
notice be placed on record according to the regulation order thereof.

Notes:

1. Evidence of review by the Commissioners Court must be kept on the job site and failure to do so constitutes grounds for job shutdown.
2. Written notices are required:
 - a. 48 hours in advance of construction start up, and
 - b. When construction is completed and ready for final inspection

Mail notices to: Permit Administrator
Fort Bend County Engineering
301 JACKSON STREET
RICHMOND, Texas 77469
281-633-7500

3. This permit expires one (1) year from date of permit if construction has not commenced.

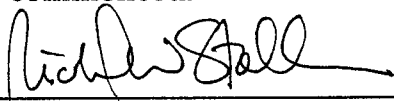
By 
County Engineer

By N/A
Drainage District Engineer/Manager

Presented to Commissioners Court
and approved.

Recorded in Volume 5-27-14
Minutes of Commissioners Court.

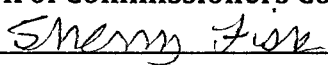
Clerk of Commissioners Court
By 
Deputy

COUNTY OF FORT BEND

Engineering Department

301 JACKSON STREET
RICHMOND, Texas 77469

Johnny Ortega
Permit Administrator

1124 Blume Road
Phone: (281) 633-7500

PERMIT APPLICATION REVIEW FORM FOR CABLE, CONDUIT, AND POLE LINE ACTIVITY IN FORT BEND COUNTY

PERMIT NO. 1584

The following "Notice of Proposed Cable, Conduit, and/or Pole Line activity in Fort Bend County" and accompanying attachments have been reviewed and the notice conforms to appropriate regulations set by Commissioner's Court of Fort Bend County, Texas.

- X (1) Complete Application Form.
- X a. Name of road, street, and/or drainage ditch affected.
- X b. Vicinity map showing course of direction.
- X c. Plans and specifications.
- X (2) Bond:
- X District Attorney, approval when applicable.
- X Perpetual bond currently posted.
- No. CH1-001686693-01
- Amount \$25,000.00
- Performance bond submitted.
- No.
- Amount
- Cashier's Check.
- No.
- Amount
- (3) Verbal permission given for emergencies, to start construction before approved in Commissioner's Court.
- Precinct Engineer Acknowledgment Date
- Precinct Commissioner Acknowledgment Date
- (4)
- Drainage District Approval when applicable

We have reviewed this project and agree it meets minimum requirements.

Johnny Ortega CFM / Permit Administrator
(REVISED 5/30/08)

05/19/2014
Date

NOTICE OF PROPOSED CABLE, CONDUIT AND/OR POLE LINE ACTIVITY
IN, UNDER, ACROSS OR ALONG ROADS, STREETS, HIGHWAYS AND DRAINAGE DITCHES
IN FORT BEND COUNTY

APPLICANT'S JOB NO. 9551415
PERMIT NO. 84544 PCT. NO. 3
BOND NO. CMC 021680693-01

FORMAL NOTICE IS HEREBY GIVEN THAT AT&T Texas
PROPOSES TO LAY, CONSTRUCT, MAINTAIN AND/OR REPAIR CABLE, CONDUIT AND/OR POLE LINE, IN, UNDER, ACROSS, OR
ALONG ROADS, STREETS, HIGHWAYS AND DRAINAGE DITCHES IN FORT BEND COUNTY, AS FOLLOWS:

IN, UNDER, OR ACROSS ROADS AND/OR DRAINAGE DITCHES

ROAD OR DITCH NAME	DISTANCE & DIRECTION FROM NEAREST INTERSECTION	LENGTH OF CROSSING	TYPE OF CONSTRUCTION			
			BORED	JACKED	DRIVEN	CASE
SANDY RIDGE DR	NORTH R/W TO SOUTH R/W	65'	X			

ALONG ROADS AND/OR DRAINAGE DITCHES

ROAD OR DITCH NAME	DISTANCE & DIRECTION FROM NEAREST INTERSECTION	TO	DISTANCE
E RIVERPARK DR	WEST R/W TO EAST R/W	SUMMIT CREEK	470'
SUMMIT CREEK	NORTH R/W	SANDY RIDGE LN	855'
SANDY RIDGE LN	NORTH R/W	5979 SANDY RIDGE LN	370'

GENERAL DESCRIPTION

SEE ATTACHMENTS.

THE LOCATION AND DESCRIPTION OF THE PROPOSED INSTALLATION AND APPURTENANCES IS MORE FULLY SHOWN ON THE ATTACHED DETAIL DRAWINGS. THE LAYING, CONSTRUCTION, MAINTENANCE AND/OR REPAIR OF THE PROPOSED INSTALLATION SHALL BE SUBJECT TO "A REVISED ORDER REGULATING THE LAYING, CONSTRUCTION, MAINTENANCE AND/OR REPAIR OF CABLES, CONDUITS, AND/OR POLE LINES, IN, UNDER, ACROSS, OR ALONG ROADS, STREETS, HIGHWAYS AND DRAINAGE DITCHES IN FORT BEND COUNTY, TEXAS, UNDER THE JURISDICTION OF THE COMMISSIONERS COURT OF FORT BEND COUNTY, TEXAS" AS PASSED BY COMMISSIONERS COURT OF FORT BEND COUNTY, TEXAS, DATED THE 3RD DAY OF AUGUST, 1987, RECORDED IN VOLUME 639 OF THE MINUTES OF THE COMMISSIONERS COURT OF FORT BEND COUNTY, TEXAS.

WRITTEN NOTICES ARE REQUIRED: 1) 48 HOURS IN ADVANCE OF START OF CONSTRUCTION AND 2) WHEN CONSTRUCTION IS COMPLETE AND READY FOR FINAL INSPECTION.

MAIL TO: PERMIT ADMINISTRATOR/FORT BEND COUNTY ENGINEERING
P.O. BOX 1449, ROSENBERG, TX 77471

VIOLATION OF REQUIREMENTS SHALL CONSTITUTE GROUNDS FOR JOB SHUT DOWN.

COMPANY NAME: AT&T Texas
AGENT AND/OR OWNER

(SIGNATURE)
NAME & TITLE: MIKE BROUSSARD, MGR OSP PLNG & ENG DESIGN
(PLEASE PRINT)

DATE: 5/09/2014

ADDRESS: 1110 LOUISE, 1ST FLOOR
(STREET/P.O.BOX)

ROSENBERG TEXAS 77471
CITY STATE ZIP

TELEPHONE NO: 281-341-4312

(ACCESSIBLE 24 HRS/DAY, 7 DAYS/WEEK)

LEGEND

B

PROPOSED BURIED CABLE

B

EXISTING BURIED CABLE

EDGE OF PAVEMENT/CONCRETE

R/V

RIGHT OF WAY

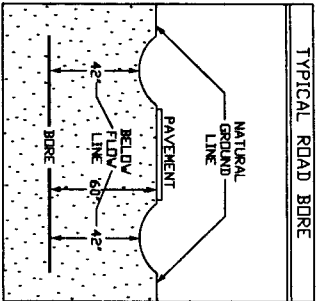

FORT BEND COUNTY NOTIFICATION

ALIT CONTACT:

MIKE BRUSSARD

MR. DIST. ENG. & ENG. DESIGN

EB-341-43E

SPECIAL CIRCUITS

N

6203

FORWARDED

N

PERMIT

N

REQUIRED

N

NORTH ARROW

OPERATING RANGE OF JOB STEPS

TASK

TO

MTRC

TRANSMISSION ZONE

RZ 0

CZ 0

TAPER CODE 1143P

CAUTION HIGH VOLTAGE

KV 13.00

AERIAL N

BURIED Y

HIGHWAY PERMIT NO.

UTILITY CO. CENT - CENTER POINT

REP NAME

REP TEL NO.

POLE CONTACTS (+) 0

(-) 0

UTILITY CO.

REP NAME

REP TEL NO.

POLE CONTACTS (+) 0

(-) 0

UTILITY CO.

REP NAME

REP TEL NO.

POLE CONTACTS (+) 0

(-) 0

PROJECT NO 9531415

TOT. PRINTS 8

PRINT NO. 7

NPA/NNX: 281-232

PRT: 281232

EXCH. RICH-ROSE

TAX DIST. F6009

GEO LOC. W89232

ENGR. MB

DRAWN JH

TELEPHONE NO. (281) 341-4312

REC. REF. 240-270-17*

MAP REF. 607F

SCALE NONE

ISSUE DATE

PROJ. TITLE PFP 10A1143P3 THRR

REV. NUMBER

DATE REV.

Not for use or disclosure outside the Alit companies except under written agreement.

--Proprietary--

TYPICAL ROAD BORE

A cross-sectional diagram of a typical road bore. The bore is represented by a horizontal cylinder with a total diameter of 60 inches. The top half of the bore is filled with gravel, indicated by a stippled pattern. The bottom half is empty. The bore is set into a road structure. The top of the road is labeled 'NATURAL GROUND LINE'. Below this is a layer labeled 'PAVEMENT'. The bore is positioned such that its top is 42 inches below the natural ground line. The bore has a diameter of 60 inches, with 42 inches of gravel on the left side and 42 inches of gravel on the right side. The bore is labeled 'BORE' at the bottom left and 'PAVEMENT' at the bottom right.

ALT CONTACT:
MIKE BROUSSARD
MGR.-DSP PLNG & ENG DESIGN
281-341-4312

A compass rose with 16 points. The North Arrow is a black arrow pointing towards the top right, indicating North is in that direction.

OPERATING RANGE OF JOB STEPS

TASK _____ TO _____

TRANSMISSION ZONE
RZ 0 CZ 0 TAPER CODE 1143P

CAUTION HIGH VOLTAGE
AERIAL N BURIED Y
KV 1300

Utility CO CENT - CENTER POINT

POLE CONTACTS (+)	(-)
0	0

Utility CO
REP NAME
REP TEL NO.
POLE CONTACTS (+) 0 (-) 0

Utility CO	REP NAME	REP TEL NO.	POLE CONTACTS (+)	(-)

PROJECT NO 9551415

TOT.PRINTS 8 PRINT NO.8

NPA/NNX: 281-33 PR1:28133

TAX DIST. FG009

GEO LOC. W89232

TELEPHONE NO. (281) 341-4312

REC. REF. 240-270-17

SCALE NONE

ISSUE DATE

REV. NUMBER

DATE REV.

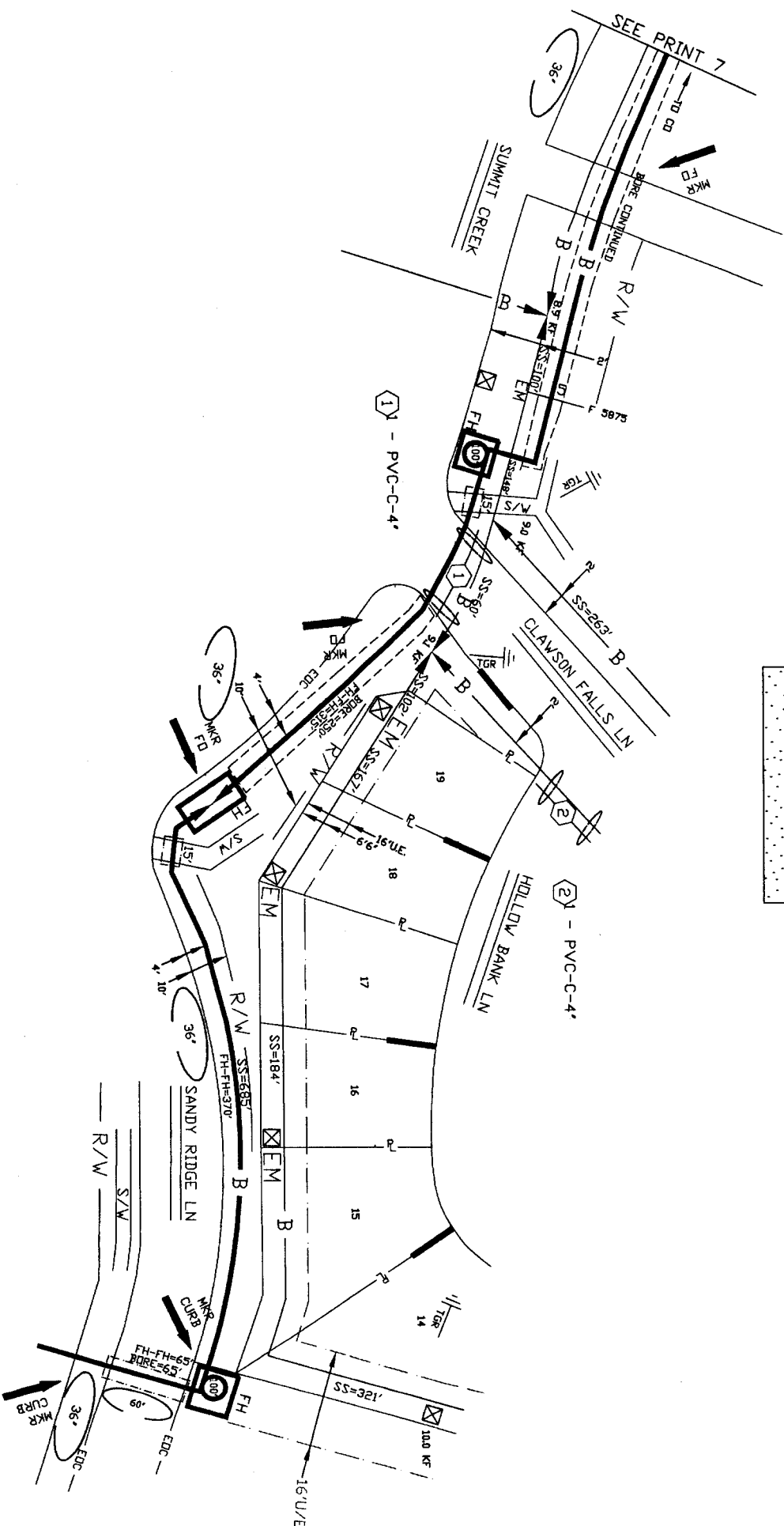

--Proprietary--
Not for use or disclosure outside the Aflac companies except under written agreement.

--Proprietary--