

12T

REVIEW BY FORT BEND COUNTY COMMISSIONERS COURT

On this 06 day of MAY, 2014, Commissioners Court
came on to be heard and reviewed the accompanying notice
of AT & T TEXAS

Job Location PRECINCT LINE ROAD

Dated 04/23/14 BOND No. CH1-001686693-01, Permit No. 84569
to make use of certain Fort Bend County property subject to, "A Revised Order
Regulating the Laying, Construction, Maintenance, and Repair of Buried Cables,
Conduits, and Pole Lines, In, Under, Across or Along Roads, Streets, Highways, and
Drainage Ditches in Fort Bend County, Texas, Under the Jurisdiction of the
Commissioners Court of Fort Bend County, Texas," as passed by the Commissioners
Court of Fort Bend County, Texas, date the 3rd day of August, 1987, recorded in
Volume _____ of the Minutes of the Commissioners Court of Fort Bend County,
Texas, to the extent that such order is not inconsistent with Article 1436a, Vernon's
Texas Civil Statutes. Upon Motion of Commissioner Prestage, seconded
by Commissioner Morrison, duly put and carried, it is ORDERED,
ADJUGED AND DECREED that said notice of said above purpose is hereby
acknowledged by the Commissioners Court of Fort Bend County, Texas, and that said
notice be placed on record according to the regulation order thereof.

Notes:

1. Evidence of review by the Commissioners Court must be kept on the job site
and failure to do so constitutes grounds for job shutdown.
2. Written notices are required:
 - a. 48 hours in advance of construction start up, and
 - b. When construction is completed and ready for final inspection

Mail notices to: Permit Administrator
Fort Bend County Engineering
301 JACKSON STREET
RICHMOND, Texas 77469
281-633-7500

3. This permit expires one (1) year from date of permit if construction has not
commenced.

By [Signature]
County Engineer

By N/A
Drainage District Engineer/Manager

Presented to Commissioners Court
and approved.

Recorded in Volume 5-6-14
Minutes of Commissioners Court.

Clerk of Commissioners Court
By [Signature]
Deputy

Engineering Department

1124 Blume Road
Phone: (281) 633-7500

PERMIT NO. 10-569

04/23/2014
Date

**NOTICE OF PROPOSED CABLE, CONDUIT AND/OR POLE LINE ACTIVITY
IN, UNDER, ACROSS OR ALONG ROADS, STREETS, HIGHWAYS AND DRAINAGE DITCHES
IN FORT BEND COUNTY**

APPLICANT'S JOB NO. _____
 PERMIT No. 84569 PCT. No. 3
 BOND No. CH1-001686693-01

Formal notice is hereby given that AT&T - Texas
 proposes to lay, construct, maintain and/or repair cable, conduit and/or pole line, in, under,
 across, or along roads, streets, highways and drainage ditches in Fort Bend County, as follows:

In, Under, or Across Roads and/or Drainage Ditches

Road or Ditch Name	: Distance & Direction From : Nearest Intersection	: Length of : Crossing	: Type of Construction Bored: Jacked: Driven: Cased

Along Roads and/or Drainage Ditches

Road or Ditch Name	: Distance & Direction From : Nearest Intersection	: To : 	: Distance
Precinct Line Road	25' North of F.M. 359	2330 Precinct Line Rd.	240 LF

General Description
ATI proposed fiber cable bore along the east R.O.W. of
Precinct Line Rd. going north from F.M. 359 approx. 240 LF.

The Location and description of the proposed installation and appurtenances is more fully shown on the attached detail drawings. The laying, construction, maintenance and/or repair of the proposed installation shall be subject to "A Revised Order Regulating the Laying, Construction, Maintenance and/or Repair of Cables, Conduits, and/or Pole Lines, In, Under, Across, or Along Roads, Streets, Highways and Drainage Ditches in Fort Bend County, Texas, Under the Jurisdiction of the Commissioners Court of Fort Bend County, Texas," as passed by Commissioners Court of Fort Bend County, Texas, dated the 3rd. day of August, 1987, recorded in Volume 639 of the Minutes of the Commissioners Court of Fort Bend County, Texas.

Written notices are required: 1) 48 hours in advance of start of construction and
 2) when construction is complete and ready for final inspection.

Mail to: Permit Administrator/Fort Bend County Engineering
 P.O. Box 1449, Rosenberg, TX 77471.

Violation of requirements shall constitute grounds for job shut down.

COMPANY NAME: Cobb Fendley & Assoc. Inc.
AGENT and/or OWNER
(Signature) 713-485-8098
 NAME & TITLE Mike Broussard - Mgr OSP Eng
(Please Print)
 DATE 4/17/14
 ADDRESS 1110 Louise St.
(Street/P.O. Box)
Rosenberg TX 77471
City State Zip
 TELEPHONE NO: 281-341-4289
(accessible 24 hrs/day, 7 days/week)

Does project comply with Fort Bend County Outdoor Lighting Ordinance? Yes (✓) No ()
--



SEE 525 MAP

565

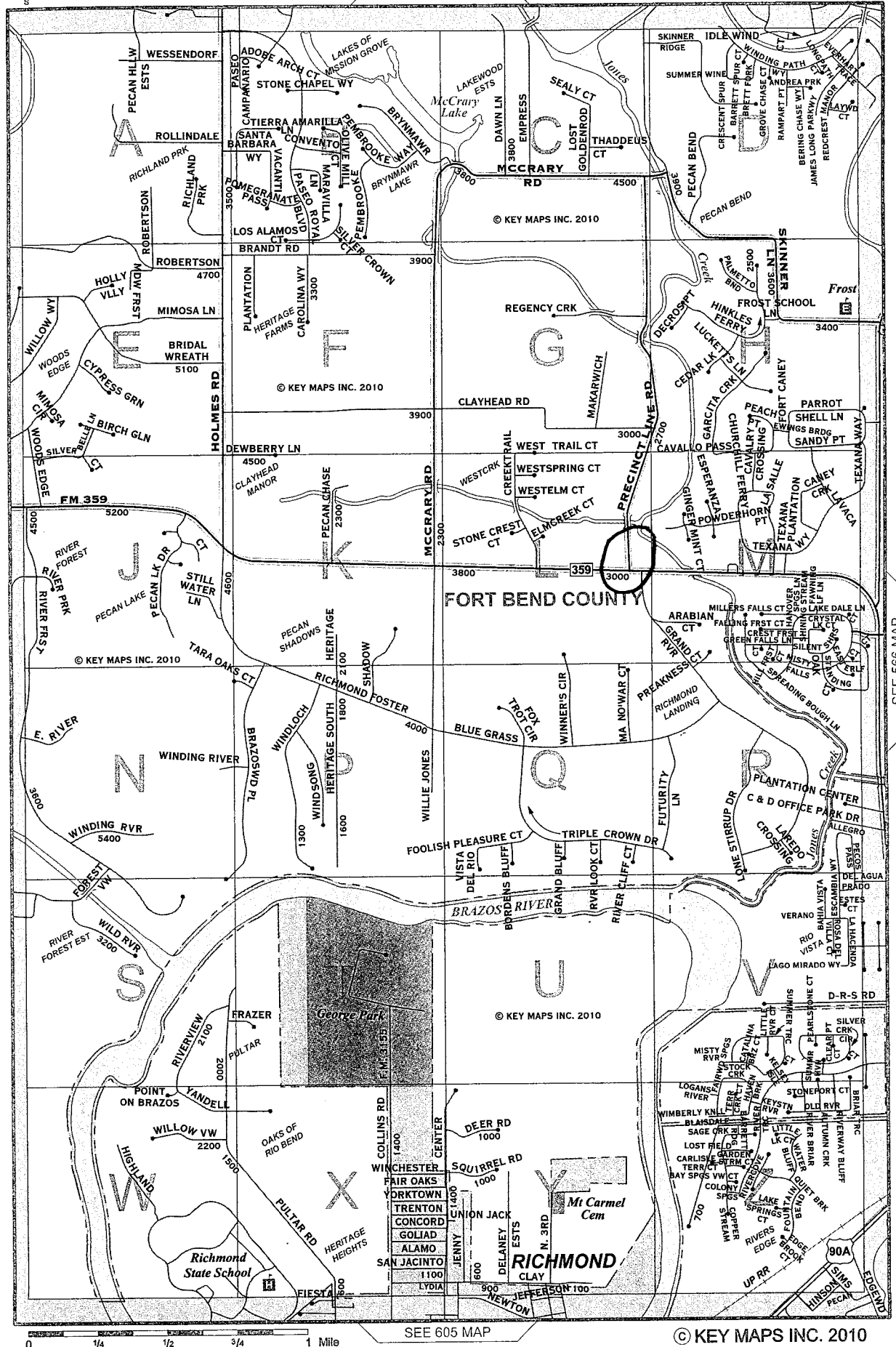

SEE 566 MAP

SEE 605 MAP

© KEY MAPS INC. 2010

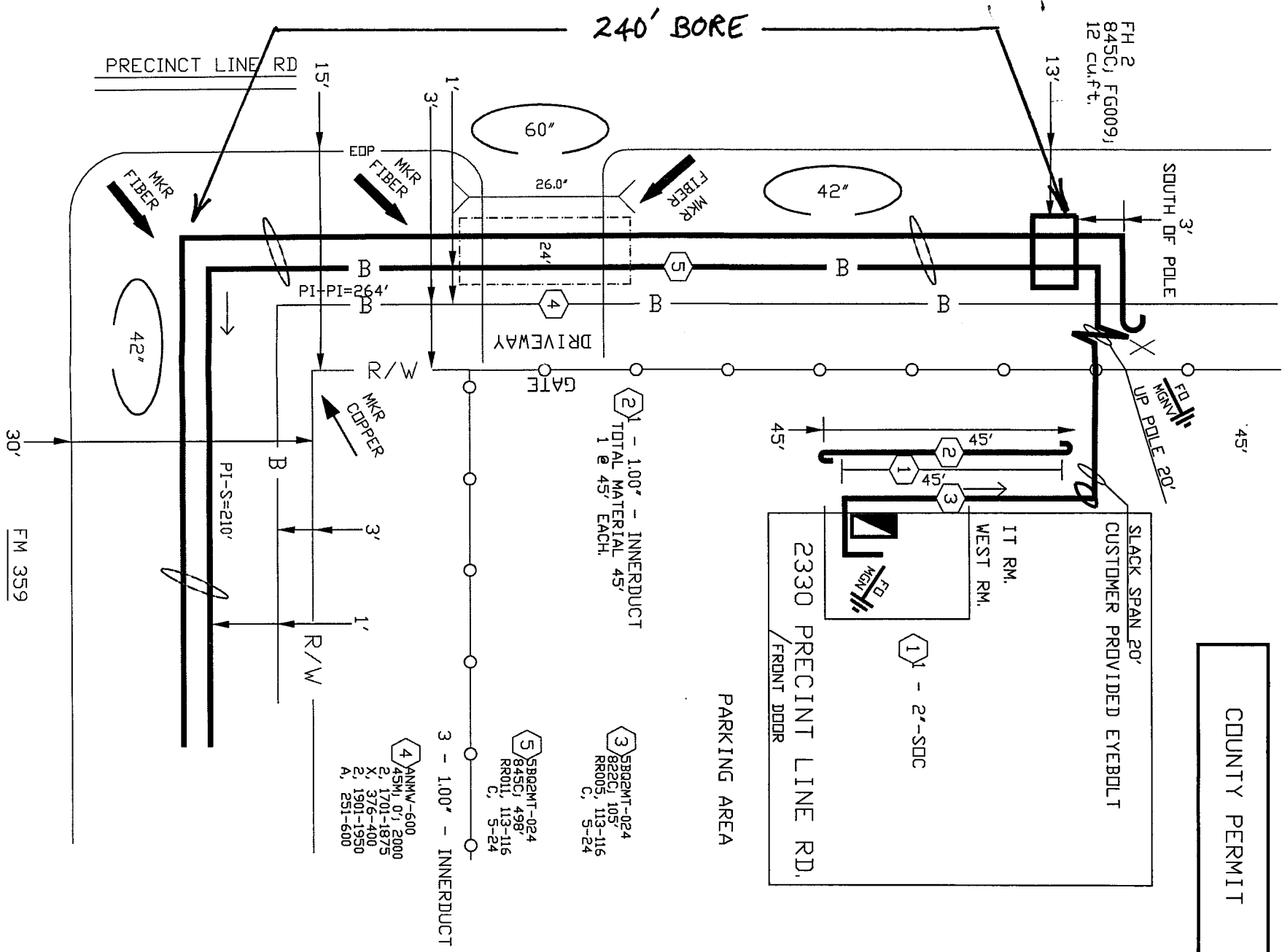
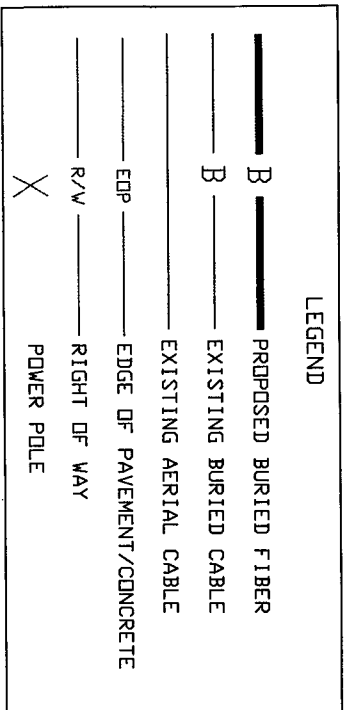

SPECIAL TRAFFIC REQUIREMENTS

- Contractor shall provide and install traffic control devices in conformance with part VI of the Texas Manual on Uniform Traffic Control Devices (Texas MUTCD, most recent edition with revisions)
- No lanes shall be closed during the hours of 5:30 AM to 7:00PM Monday thru Friday in Downtown, Midtown area.
- No lanes shall be closed during the hours of 7:00 AM to 9:00 AM and 4:00 PM to 6:00 PM Monday thru Friday.
- No work, and no lanes shall be closed in residential area from 7:00 PM to 7:00 AM.
- Lane closure time(s) shall be specified on the lane closure permit.
- Contractor shall maintain at least one lane of traffic in each direction during working hours.
- Contractor shall maintain traffic lane(s) according to traffic control plan(s) during working hours.
- Contractor shall cover open pavement excavations with anchored steel plates during non-working hours, and open lanes for normal traffic flow.
- An off-duty Uniformed Police Officer is required to direct traffic when lanes are blocked.
- If the contractor chooses to use a different method of "Traffic Control Plans" during the construction than what is outlined in the contract drawings, they shall be responsible to prepare and submit an alternate set of plans* to Plan Review Section for approval ten working days prior to implementation.
- In the event when no "Traffic Control Plans" exist as a part of contract drawings, contractor may prepare plans* and submit to Plan Review Section for approval ten working days prior to implementation.
- These plans shall be drawn to scale on reproducible mylars and sealed by a Licensed Engineer in the State of Texas. Plans will become a part of the contract drawings.
- Approved copies of Traffic Control Plans and lane/sidewalk closure permits shall be available for inspection at job site at all times. Contractor must secure "Lane/Sidewalk Closure Permits" from City's Traffic Management and Maintenance Branch before closing a lane/sidewalk. The request must be made at least three business days prior to the date for which the closure is sought. Note that working hours may be restricted or the request may be denied. Call 713-837-7280 for an application.
- Contractor will be responsible for replacing and maintaining pavement markings which include centerline, barrier lines, lane lines and raised pavement markings.
- This traffic control plan represents the minimum required by traffic conditions in the field.
- Contractor shall not block ingress or egress to private property at any time.
- Lanes shall be kept closed during pavement surface restoration and opened only after pavement is restored completely.

SPACING FOR CHANNELIZING DEVICES

- Plastic drums on merging taper @ 30' c-c with chevron sign @ 60' c-c and type 'C' warning light (for overnight closure)
 - Plastic drums on downstream taper @ 35' c-c
 - Plastic drums on radii @ 5' c-c
 - Plastic drums on tangent @ 35' c-c with vertical panel @ 70' c-c and type 'C' warning light @ 70' c-c (for overnight closure)
 - Plastic drums in front of construction zone @ 20' c-c with vertical panel @ 40' c-c and Type 'A' warning light @ 40' c-c (for overnight closure)
 - Concrete traffic barrier (CTB) or low profile concrete traffic barrier (lpctb) with reflectors @ 10' c-c if pavement drop is more than twelve inches (12")
- Note: Spacing shown on traffic control plans shall supersede the above spacings. Spacing may be adjusted to provide driveways, intersections and/or median openings.

NOTE: CONTRACTOR TO MAINTAIN ACCESS TO ADJACENT PROPERTIES AT ALL TIMES.

TYPICAL SIGN SPACING, TAPER LENGTHS, AND SUGGESTED SPACING OF CHANNELIZATION DEVICES

Posted Speed (mph)	Sign Spacing X	Min. Desirable Taper Length "L"			Suggested Maximum Spacing Of Device	
		10'	11'	12'	On a Taper	On a Tangent
30	120'	150'	185'	180'	30'	60'
35	160'	205'	225'	245'	35'	70'
40	240'	285'	320'	265'	40'	80'
45	320'	495'	540'	495'	45'	90'
50	400'	500'	550'	600'	50'	100'
55	500'	550'	605'	660'	55'	110'

LEGEND

- PLASTIC DRUM (See Spacing of Devices)
- OFF-DUTY UNIFORMED POLICE OFFICER
- TYPE III BARRICADE
- FLASHING ARROW PANEL
- TUBULAR MARKER

TYPICAL TRAFFIC CONTROL

PREPARED BY	SCALE	N.T.S.	ISSUE DATE
DRAWN BY	DATE		
PROJECT NO.	JOB-NO	REC-REF	SHEET
AREA-NO	CO.	CO.	D

NOTE: STRIPES SHOULD SLANT DOWNWARDS IN THE DIRECTION TOWARDS WHICH TRAFFIC IS DIRECTED.

