

14V

REVIEW BY FORT BEND COUNTY COMMISSIONERS COURT

On this 28 day of JANUARY, 2014, Commissioners Court
came on to be heard and reviewed the accompanying notice
of SC - STEEL CRETE, LLC

Job Location GRAND MISSION BOULEVARD, BEECHNUT STREET

Dated 01/09/14 Bond No. 5170104, Permit No. 84485
to make use of certain Fort Bend County property subject to, "A Revised Order
Regulating the Laying, Construction, Maintenance, and Repair of Buried Cables,
Conduits, and Pole Lines, In, Under, Across or Along Roads, Streets, Highways, and
Drainage Ditches in Fort Bend County, Texas, Under the Jurisdiction of the
Commissioners Court of Fort Bend County, Texas," as passed by the Commissioners
Court of Fort Bend County, Texas, date the 3rd day of August, 1987, recorded in
Volume _____ of the Minutes of the Commissioners Court of Fort Bend County,
Texas, to the extent that such order is not inconsistent with Article 1436a, Vernon's
Texas Civil Statutes. Upon Motion of Commissioner Meyer S, seconded
by Commissioner Prestage, duly put and carried, it is ORDERED,
ADJUGED AND DECREED that said notice of said above purpose is hereby
acknowledged by the Commissioners Court of Fort Bend County, Texas, and that said
notice be placed on record according to the regulation order thereof.

Notes:

1. Evidence of review by the Commissioners Court must be kept on the job site
and failure to do so constitutes grounds for job shutdown.
2. Written notices are required:
 - a. 48 hours in advance of construction start up, and
 - b. When construction is completed and ready for final inspection

Mail notices to: Permit Administrator
Fort Bend County Engineering
301 JACKSON STREET
RICHMOND, Texas 77469
281-633-7500

3. This permit expires one (1) year from date of permit if construction has not
commenced.

By

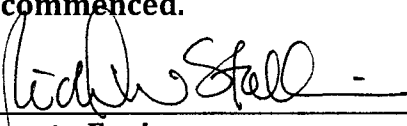
County Engineer

By

N/A

Drainage District Engineer/Manager

Presented to Commissioners Court
and approved.

Recorded in Volume 2-4-14
Minutes of Commissioners Court.

Clerk of Commissioners Court

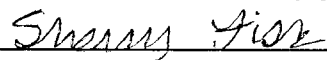
By 
Deputy

**PERFORMANCE BOND COVERING ALL CABLE, CONDUIT AND/OR POLE LINE
ACTIVITY IN, UNDER, ACROSS OR ALONG FORT BEND COUNTY ROADS**
AUTHORIZED

BOND NO 5170104

THE STATE OF TEXAS §

COUNTY OF FORT BEND §

KNOW ALL MEN BY THESE PRESENTS:

THAT WE, SC-Steel Crete, LLC whose address is 12651 Briar Forest, Suite 350 Houston, TX 77077, Texas, hereinafter called the Principal, and SureTec Insurance Company, a Corporation existing under and by virtue of the laws of the State of Texas and authorized to do an indemnifying business in the State of Texas, and whose principal office is located at 1330 Post Oak Blvd., Suite 1100 Houston, TX 77056, whose officer residing in the State of Texas, authorized to accept service in all suits and actions brought within said State is Steven D. Nelson and whose address is 9737 Great Hills Trail, Suite 320, Austin, TX 78759, hereinafter called the Surety, are held and firmly bound unto, **Robert E. Hebert, County Judge of Fort Bend County, Texas, or his successors in office, in the full sum of** Eight Thousand Dollars (\$ 8,000.00) current, lawful money of the United States of America, to be paid to said **Robert E. Hebert, County Judge of Fort Bend County, Texas, or his successors in office, to which payment well and truly to be made and done, we, the undersigned, bind ourselves and each of us, our heirs, executors, administrators, successors, assigns, and legal representatives, jointly and severally, by these presents.**

THE CONDITION OF THIS BOND IS SUCH THAT, WHEREAS, the above bounden principal contemplates laying, constructing, maintaining and/or repairing one or more cables, conduits, and/or pole lines in, under, across and/or along roads, streets and highways in the County of Fort Bend, and the State of Texas, under the jurisdiction of the Commissioners' Court of Fort Bend County, Texas, pursuant to the Commissioners' Court order adopted on the 1st day of December, A.D. 1980, recorded in Volume 13, of the Commissioners' Court Minutes of Fort Bend County, Texas, regulating same, which Commissioners' Court order is hereby referred to and made a part hereof for all purposes as though fully set out herein.

AND WHEREAS, the principal desires to provide Fort Bend County with a performance bond covering all such cable, conduit and/or pole line activity;

NOW, THEREFORE, if the above bounden principal shall faithfully perform all its cable, conduit and/or pole line activity (including, but not limited to the laying, construction, maintenance and/or repair of cables, conduits and/or pole lines) in, under, across and/or along roads, streets and highways in the County of Fort Bend and State of Texas, under the jurisdiction of the Commissioners Court of Fort Bend County, Texas, pursuant to and in accordance with minimum requirements and conditions of the above mentioned Commissioners' Court order set forth and specified to be by said principal done and performed, at the time and in the manner therein specified, and shall pay over and make good and reimburse Fort Bend County, all loss and damages which Fort Bend County may sustain by reason of any failure or default on the part of said principal, then this obligation shall be null and void otherwise to remain in full force and effect.

This bond is payable at the County Courthouse in the County of Fort Bend and State of Texas.

It is understood that at any time Fort Bend County deems itself insecure under this bond, it may require further and/or additional bonds of the principal.

EXECUTED this 14th **day of** October, 2013.

SC-Steel Crete, LLC

PRINCIPAL



BY

SureTec Insurance Company

SURETY



BY

Justin McQuain, Attorney in Fact

SureTec Insurance Company

LIMITED POWER OF ATTORNEY

Now All Men by These Presents, That SURETEC INSURANCE COMPANY (the "Company"), a corporation duly organized and existing under the laws of the State of Texas, and having its principal office in Houston, Harris County, Texas, does by these presents make, constitute and appoint

Justin McQuain

its true and lawful Attorney-in-fact, with full power and authority hereby conferred in its name, place and stead, to execute, acknowledge and deliver any and all bonds, recognizances, undertakings or other instruments or contracts of suretyship to include waivers to the conditions of contracts and consents of surety for:

Principal: SC-Steel Crete, LLC
Obligee: Fort Bend County Judge
Amount: \$ 8,000.00

and to bind the Company thereby as fully and to the same extent as if such bond were signed by the President, sealed with the corporate seal of the Company and duly attested by its Secretary, hereby ratifying and confirming all that the said Attorney-in-Fact may do in the premises. Said appointment is made under and by authority of the following resolutions of the Board of Directors of the SureTec Insurance Company:

Be it Resolved, that the President, any Vice-President, any Assistant Vice-President, any Secretary or any Assistant Secretary shall be and is hereby vested with full power and authority to appoint any one or more suitable persons as Attorney(s)-in-Fact to represent and act for and on behalf of the Company subject to the following provisions:

Attorney-in-Fact may be given full power and authority for and in the name of and of behalf of the Company, to execute, acknowledge and deliver, any and all bonds, recognizances, contracts, agreements or indemnity and other conditional or obligatory undertakings and any and all notices and documents canceling or terminating the Company's liability thereunder, and any such instruments so executed by any such Attorney-in-Fact shall be binding upon the Company as if signed by the President and sealed and effected by the Corporate Secretary.

Be it Resolved, that the signature of any authorized officer and seal of the Company heretofore or hereafter affixed to any power of attorney or any certificate relating thereto by facsimile, and any power of attorney or certificate bearing facsimile signature or facsimile seal shall be valid and binding upon the Company with respect to any bond or undertaking to which it is attached. (Adopted at a meeting held on 20th of April, 1999.)

Witness Whereof, SURETEC INSURANCE COMPANY has caused these presents to be signed by its President, and its corporate seal to be hereto affixed this 21st day of March, A.D. 2013.

SURETEC INSURANCE COMPANY

By: 
 John Knox Jr., President

State of Texas
 County of Harris

SS:



On this 21st day of March, A.D. 2013 before me personally came John Knox Jr., to me known, who, being by me duly sworn, did depose and say, that he resides in Houston, Texas, that he is President of SURETEC INSURANCE COMPANY, the company described in and which executed the above instrument; that he knows the seal of said Company; that the seal affixed to said instrument is such corporate seal; that it was so affixed by order of the Board of Directors of said Company; and that he signed his name thereto by like order.

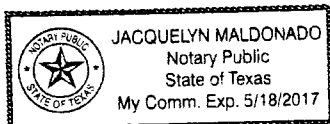

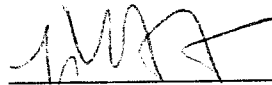

Jacquelyn Maldonado, Notary Public
 My commission expires May 18, 2017

I, M. Brent Beaty, Assistant Secretary of SURETEC INSURANCE COMPANY, do hereby certify that the above and foregoing is a true and correct copy of a Power of Attorney, executed by said Company, which is still in full force and effect; and furthermore, the resolutions of the Board of Directors, set out in the Power of Attorney are in full force and effect.

Given under my hand and the seal of said Company at Houston, Texas this 14th day of October, 2013, A.D.

 M. Brent Beaty, Assistant Secretary

Any instrument issued in excess of the penalty stated above is totally void and without any validity.
 For verification of the authority of this power you may call (713) 812-0800 any business day between 8:00 am and 5:00 pm CST.

SureTec Insurance Company

THIS BOND RIDER CONTAINS IMPORTANT COVERAGE INFORMATION

Statutory Complaint Notice

To obtain information or make a complaint: You may call the Surety's toll free telephone number for information or to make a complaint at: 1-866-732-0099. You may also write to the Surety at:

SureTec Insurance Company
9737 Great Hills Trail, Suite 320
Austin, Tx 78759

You may contact the Texas Department of Insurance to obtain information on companies, coverage, rights or complaints at 1-800-252-3439. You may write the Texas Department of Insurance at:

PO Box 149104
Austin, TX 78714-9104
Fax#: 512-475-1771
Web: <http://www.tdi.state.tx.us>
Email: ConsumerProtection@tdi.state.tx.us

PREMIUM OR CLAIM DISPUTES: Should you have a dispute concerning your premium or about a claim, you should contact the Surety first. If the dispute is not resolved, you may contact the Texas Department of Insurance.

Terrorism Risks Exclusion

The Bond to which this Rider is attached does not provide coverage for, and the surety shall not be liable for, losses caused by acts of terrorism, riot, civil insurrection, or acts of war.

Indemnity Agreement – Read Carefully.
Your signature creates legal consequences to you.

EACH OF THE UNDERSIGNED HEREBY affirms that the foregoing statements made and answers given are the truth and are made to induce the Surety to execute or procure the execution of any and all of the bonds. Applicant acknowledges and consents that credit checks will be made on both individuals and business(es) associated with this surety bond application, update or renewal or for any other legitimate business purpose. .

IN CONSIDERATION of the execution of the bond for which application is made, the undersigned (collectively, "Applicant") for themselves, their personal representatives, heirs, successors and assigns, hereby agree with, warrant and represent to, and bind themselves jointly and severally to, SureTec Insurance Company, SureTec Indemnity Company, and its co-sureties, re-insurers, and any other company which may execute a bond or bonds at the request of SureTec Insurance Company (individually and collectively called "Surety") as follows:

1. To pay Surety an annual premium in advance each year during which liability under the bond shall continue in force and until satisfactory evidence of termination of the Surety's liability is furnished to the Surety.
2. To indemnify Surety against all losses, liabilities, costs, damages, attorneys' and consultants' fees and expenses the Surety may incur or has incurred due to the execution and issuance of the bond on, before or after this date including any modifications, renewals or extensions of the bond or the enforcement of the terms of this indemnity agreement.
3. The Surety or its representatives shall have the right to examine the credit history, department of motor vehicle records, employment history, books and records of the undersigned or the assets covered by the bond, or the assets pledged as collateral for the bond.
4. The undersigned agree to waive notice of the execution of the bond, notice of any fact, knowledge or information affecting the undersigned's rights or liabilities under the bond that Surety may have or discover prior to or after execution of the bond.
5. The undersigned, upon written demand, shall deposit with Surety a sum of money requested by Surety to cover any claim, suit, expense or judgment that Surety may in its absolute discretion determine is necessary and the deposit shall be pledged as collateral security on any such bond or other bonds the Surety may have issued for the undersigned. The undersigned hereby irrevocably appoints Surety as their attorney in fact to execute any documents necessary to perfect Surety's security interests in any collateral submitted to Surety. Surety shall have the exclusive right to determine if any claim or suit shall be denied, paid, compromised, defended or appealed. An itemized statement of payments made by Surety shall be prima facie evidence of the obligation of undersigned due to Surety. The undersigned agree that it is their responsibility to defend their own interests.
6. Surety and undersigned agree that the place of performance of this agreement, including the promise to pay Surety, shall be in Harris County, Texas, and venue for any suit, arbitration, mediation or any other form of dispute resolution shall be in Harris County, Texas.
7. The rights and obligations of the undersigned are in addition to and cumulative of all other rights, liabilities and obligations under the laws of the State of Texas. The undersigned confirms that Surety shall have every right, defense or remedy including the rights of exoneration and subrogation.
8. Unless specified by law or stated in the bond that the bond cannot be cancelled, Surety may cancel bond by mailing a notice of cancellation in the U.S. mail to the Obligee and Principal at the last address provided to Surety and cancellation shall become effective thirty (30) days after the date of deposit with the United States Postal Service.

Regardless of the date of signature, this indemnity is effective as of the date of execution and renewal of the aforementioned bond(s) and is continuous until Surety is satisfactorily discharged from liability pursuant to the terms and conditions contained herein and in the bond(s).

Signed, sworn to and dated this 14th day of October, 2013.

SC-Steel Crete, LLC

X  _____
SC-Steel Crete, LLC
(Authorized Representative and Individually)

x  _____
(Authorized Representative and Individually)

X  _____
(Authorized Representative and Individually)

x  _____
(Authorized Representative and Individually)

COUNTY OF FORT BEND

Engineering Department

301 JACKSON STREET
RICHMOND, Texas 77469

Johnny Ortega
Permit Administrator

1124 Blume Road
Phone: (281) 633-7500

PERMIT APPLICATION REVIEW FORM FOR CABLE, CONDUIT, AND POLE LINE ACTIVITY IN FORT BEND COUNTY

PERMIT NO. 84485

The following "Notice of Proposed Cable, Conduit, and/or Pole Line activity in Fort Bend County" and accompanying attachments have been reviewed and the notice conforms to appropriate regulations set by Commissioner's Court of Fort Bend County, Texas.

X (1) Complete Application Form.

- X a. Name of road, street, and/or drainage ditch affected.
X b. Vicinity map showing course of direction.
X c. Plans and specifications.

X (2) Bond:

- District Attorney, approval when applicable.
 Perpetual bond currently posted.
No.
Amount
X Performance bond submitted.
No. 5170104
Amount \$5,000.00
 Cashier's Check.
No.
Amount

 (3) Verbal permission given for emergencies, to start construction before approved in Commissioner's Court.

 Precinct Engineer Acknowledgment

 Date

 Precinct Commissioner Acknowledgment

 Date

 (4)
Drainage District Approval when applicable

We have reviewed this project and agree it meets minimum requirements.

Johnny Ortega CFM/Permit Administrator
(REVISED 5/30/08)

01/09/2014
Date

**FORT BEND COUNTY ENGINEERING
PERMIT DEPARTMENT
CONSTRUCTION OF DRIVEWAYS AND CULVERTS ON COUNTY EASEMENTS AND RIGHT OF WAYS
COMMERCIAL PIPE PERMIT APPLICATION
P.O. BOX 1449 • 1124 BLUME ROAD
ROSENBERG, TX 77471
(Phone) 281-633-7502 or 7503 • (Fax) 281-342-7366**

APPLICANT INFORMATION

Application No. 84485

(County Use Only)

Applicant Name Sc - Steel Crest LLC
Applicant Mailing Address 12651 Briarforest Suite 350
City Houston State TX Zip 77077
Work Phone 281-741-1998 Daytime Phone 281-741-1998
Property Owner's Name Naveed Rehman Phone 832-275-5825
Property Owner's Mailing Address 9006 Painted Daisy Ln
City Katy State TX Zip 77494

LOCATION OF PROPERTY

Subdivision _____ Sec _____ Lot 1 Blk 1
Physical Address 8710 Grand Mission

(ATTACH A SITE MAP)

SITE USE

Driveway Curb & Gutter Section ☒ Driveway - Open Ditch Section _____
Culvert Only _____

DRIVEWAY REQUIREMENTS

Length 20' minimum and 40' maximum Number of drives 2
(See - Fort Bend County Procedures to be followed for Commercial Driveway, and Median Openings or Modifications)
Available on website www.co.fort-bend.tx.us

Does project comply with Fort Bend County Lighting Regulation Yes ☒ No ()
(See- Fort Bend County Outdoor Lighting Regulation on website www.co.fort-bend.tx.us)

- By signing and submitting this permit application, I am stating that I am the owner of this property and I am aware of and agree to abide by the Fort Bend County Regulations of Subdivisions and I am aware of Section 2, Item F in the Permits for the Construction of Driveways & Culverts on County Easements and Right of Ways in Fort Bend County, and am responsible to obtain all other required permits associated with the above mentioned property. Driveway and Pipe Permits shall provide that construction pursuant to the permit will be commenced within six months and be completed within nine months from the date of the permit and that fees collected for said permits shall not be refundable or transferable. I further understand the permit fee, in the form of CASH or PERSONAL CHECK or COMPANY CHECK or a CASHIERS CHECK or MONEY ORDER payable to FORT BEND COUNTY, must be attached.
- The undersigned applicant, agent or attorney hereby certifies to Commissioners' Court to be strictly bound to Commissioners' Court to construct the driveway and/or culvert in strict conformity with the plans, specifications, terms provisions and conditions of the permit and any other written material incorporated by reference in this application.
- Other permits may be required for development. Please contact the Fort Bend County Road & Bridge Department for pipe sizing or the Fort Bend County Health Department for information on On-Site Sewage Facility permits prior to planning construction.
- Failure to possess or obtain required permits will result in legal action against the property owner as allowed by law.

Signature of Applicant, Agent or Attorney

Date

Printed Name

PROPOSED WATER, SANITARY, DRAINAGE & PAVING CONSTRUCTION PLANS TO SERVE GRAND MISSION SQUARE

8710 GRAND MISSION BLVD
RICHMOND, TEXAS 77407
OCTOBER 2013

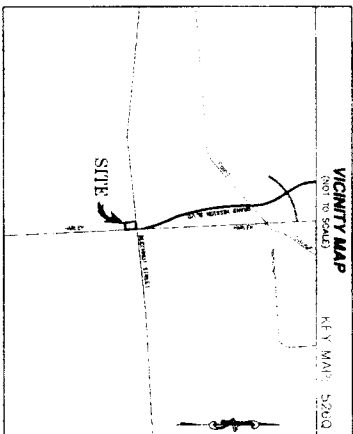

INDEX OF DRAWINGS	
COVER SHEET	SHEET NO.
SITE DRAINAGE PLAN	01
SITE PAVING & GRADING PLAN	02
SITE PAVING AND JOINT LAYOUT PLAN	03
STORM POLLUTION PREVENTION PLAN & DETAILS	04
SITE UTILITIES PLAN	05
CONSTRUCTION NOTES & DETAILS	06
1-DOOT CURB RAMP DETAILS	07
1-DOOT GENERAL NOTES & DETECTABLE WARNINGS	08
1-DOOT SIDEWALK DETAILS & GENERAL NOTES	09
1-DOOT INTERSECTION LAYOUTS	10

FOR LUBBOCK COUNTY ENGINEERING DEPARTMENT
APPROVED BY: *[Signature]* 10/8/13
DATE: 10/8/13

1205 GRAPE FOREST SUITE 300 HOUSTON, TX 77077
(713) 281-7411 FAX (713) 281-7411

COVER SHEET

GRAND MISSION SQUARE
8710 GRAND MISSION BLVD
RICHMOND, TEXAS 77407

PROJECT NO. 13-111
SHEET NO. 01 OF 10
DATE: 10/8/13
BY: [Signature]
CHECKED BY: [Signature]
DATE: 10/8/13

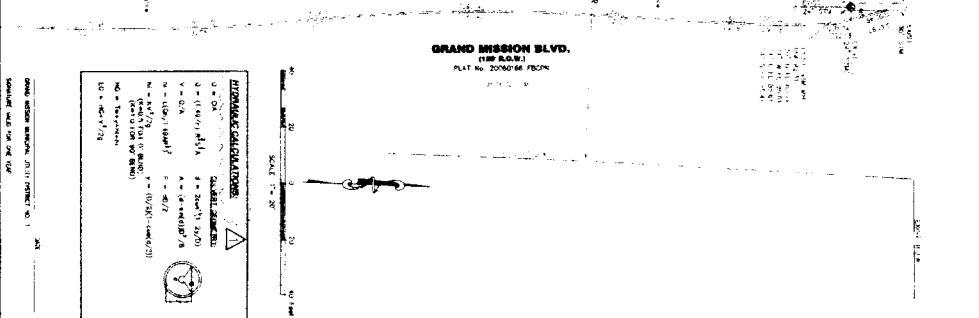
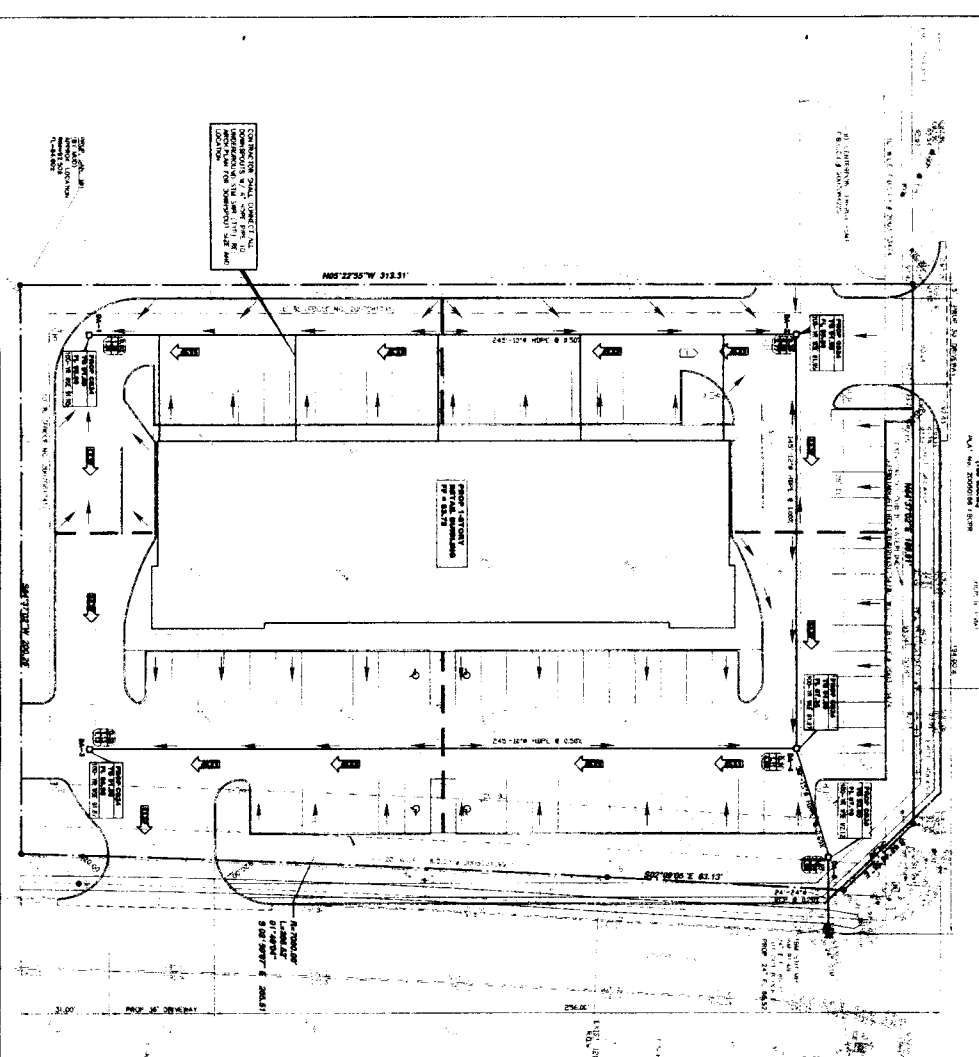
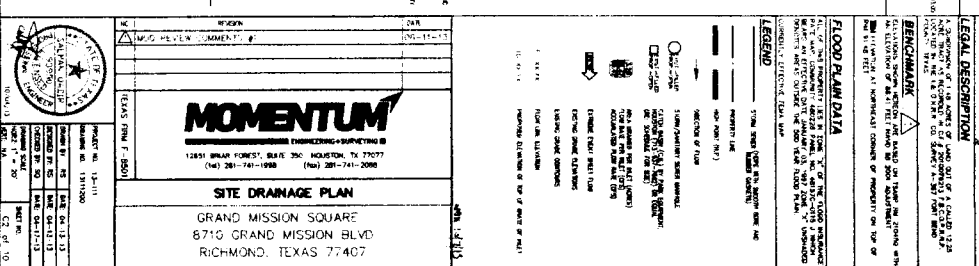
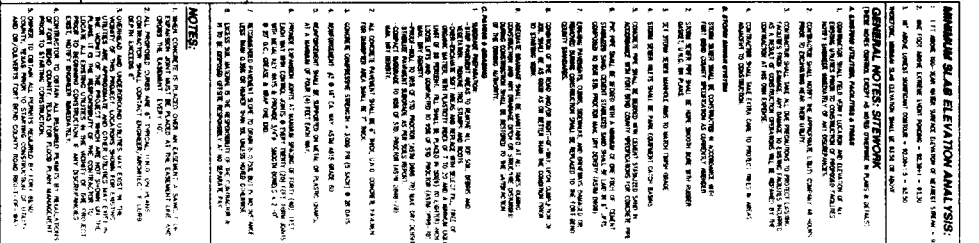
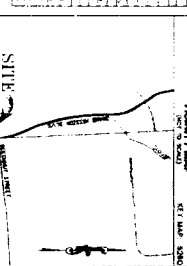
[illegible]

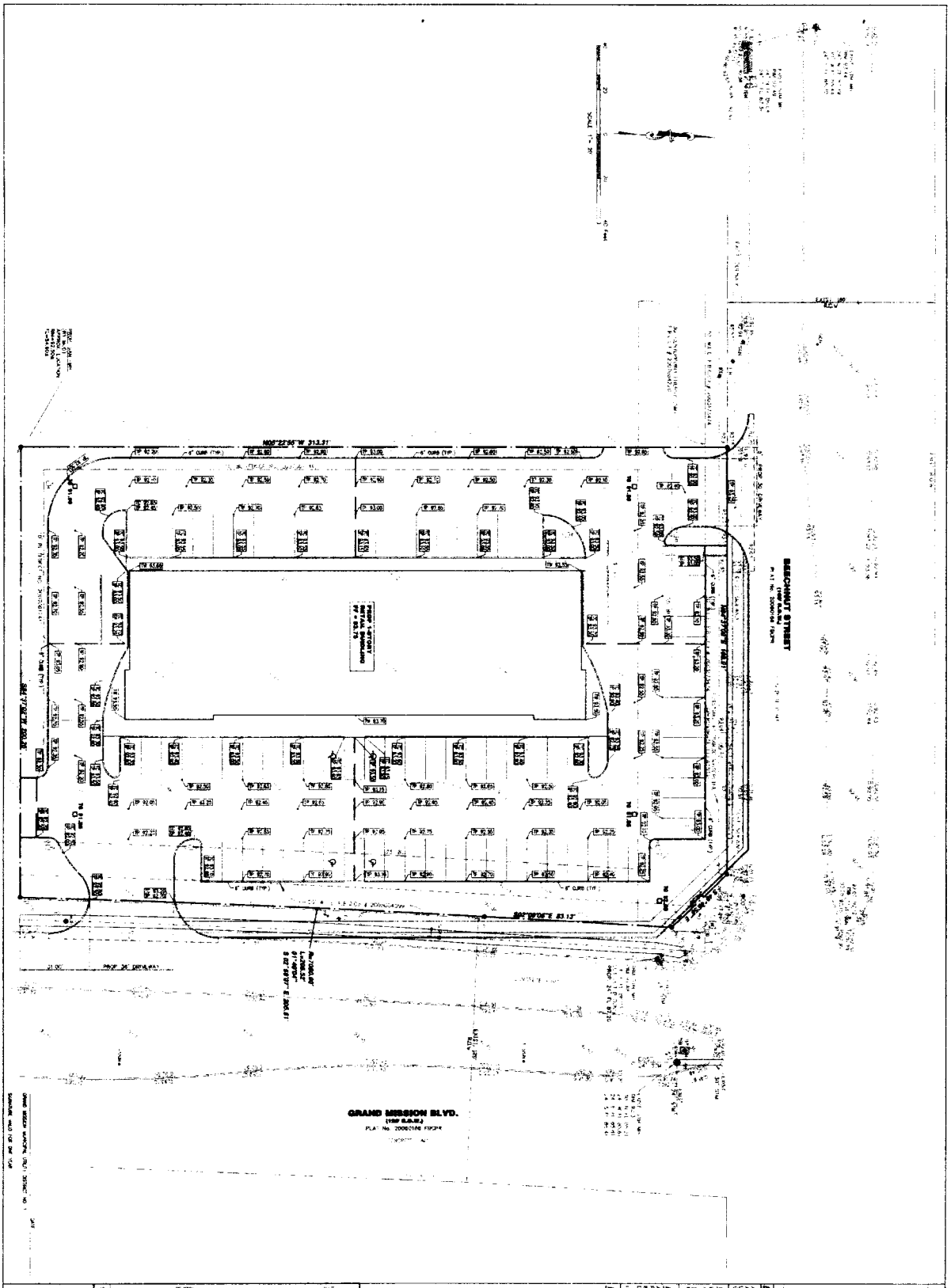

VICINITY MAP
SHEET NO. 2200

SITE

LEGAL DESCRIPTION

SECTION 10, T10N, R10E, S10E, CO. 10, TEXAS

ACROSS THE CORNER OF SECTION 10, T10N, R10E, S10E, CO. 10, TEXAS

BENCHMARK Δ

1. A BENCHMARK WAS FOUND IN THE SOUTHWEST CORNER OF SECTION 10, T10N, R10E, S10E, CO. 10, TEXAS, AT THE INTERSECTION OF SECTIONS 10 AND 11, T10N, R10E, S10E, CO. 10, TEXAS. THE BENCHMARK WAS FOUND AT AN ELEVATION OF 210.00 FEET ABOVE MEAN SEA LEVEL.

2. A BENCHMARK WAS FOUND IN THE SOUTHWEST CORNER OF SECTION 10, T10N, R10E, S10E, CO. 10, TEXAS, AT THE INTERSECTION OF SECTIONS 10 AND 11, T10N, R10E, S10E, CO. 10, TEXAS. THE BENCHMARK WAS FOUND AT AN ELEVATION OF 210.00 FEET ABOVE MEAN SEA LEVEL.

FLOOD PLAIN DATA

1. THE FLOOD PLAIN DATA WAS OBTAINED FROM THE TEXAS DEPARTMENT OF TRANSPORTATION, DIVISION OF HIGHWAYS, AT THE INTERSECTION OF SECTIONS 10 AND 11, T10N, R10E, S10E, CO. 10, TEXAS. THE FLOOD PLAIN DATA WAS OBTAINED AT AN ELEVATION OF 210.00 FEET ABOVE MEAN SEA LEVEL.

2. THE FLOOD PLAIN DATA WAS OBTAINED FROM THE TEXAS DEPARTMENT OF TRANSPORTATION, DIVISION OF HIGHWAYS, AT THE INTERSECTION OF SECTIONS 10 AND 11, T10N, R10E, S10E, CO. 10, TEXAS. THE FLOOD PLAIN DATA WAS OBTAINED AT AN ELEVATION OF 210.00 FEET ABOVE MEAN SEA LEVEL.

LEGEND

1. 1" = 1' SCALE

2. 1" = 1' SCALE

3. 1" = 1' SCALE

4. 1" = 1' SCALE

5. 1" = 1' SCALE

6. 1" = 1' SCALE

7. 1" = 1' SCALE

8. 1" = 1' SCALE

9. 1" = 1' SCALE

10. 1" = 1' SCALE

11. 1" = 1' SCALE

12. 1" = 1' SCALE

13. 1" = 1' SCALE

14. 1" = 1' SCALE

15. 1" = 1' SCALE

16. 1" = 1' SCALE

17. 1" = 1' SCALE

18. 1" = 1' SCALE

19. 1" = 1' SCALE

20. 1" = 1' SCALE

21. 1" = 1' SCALE

22. 1" = 1' SCALE

23. 1" = 1' SCALE

24. 1" = 1' SCALE

25. 1" = 1' SCALE

26. 1" = 1' SCALE

27. 1" = 1' SCALE

28. 1" = 1' SCALE

29. 1" = 1' SCALE

30. 1" = 1' SCALE

31. 1" = 1' SCALE

32. 1" = 1' SCALE

33. 1" = 1' SCALE

34. 1" = 1' SCALE

35. 1" = 1' SCALE

36. 1" = 1' SCALE

37. 1" = 1' SCALE

38. 1" = 1' SCALE

39. 1" = 1' SCALE

40. 1" = 1' SCALE

41. 1" = 1' SCALE

42. 1" = 1' SCALE

43. 1" = 1' SCALE

44. 1" = 1' SCALE

45. 1" = 1' SCALE

46. 1" = 1' SCALE

47. 1" = 1' SCALE

48. 1" = 1' SCALE

49. 1" = 1' SCALE

50. 1" = 1' SCALE

51. 1" = 1' SCALE

52. 1" = 1' SCALE

53. 1" = 1' SCALE

54. 1" = 1' SCALE

55. 1" = 1' SCALE

56. 1" = 1' SCALE

57. 1" = 1' SCALE

58. 1" = 1' SCALE

59. 1" = 1' SCALE

60. 1" = 1' SCALE

61. 1" = 1' SCALE

62. 1" = 1' SCALE

63. 1" = 1' SCALE

64. 1" = 1' SCALE

65. 1" = 1' SCALE

66. 1" = 1' SCALE

67. 1" = 1' SCALE

68. 1" = 1' SCALE

69. 1" = 1' SCALE

70. 1" = 1' SCALE

71. 1" = 1' SCALE

72. 1" = 1' SCALE

73. 1" = 1' SCALE

74. 1" = 1' SCALE

75. 1" = 1' SCALE

76. 1" = 1' SCALE

77. 1" = 1' SCALE

78. 1" = 1' SCALE

79. 1" = 1' SCALE

80. 1" = 1' SCALE

81. 1" = 1' SCALE

82. 1" = 1' SCALE

83. 1" = 1' SCALE

84. 1" = 1' SCALE

85. 1" = 1' SCALE

86. 1" = 1' SCALE

87. 1" = 1' SCALE

88. 1" = 1' SCALE

89. 1" = 1' SCALE

90. 1" = 1' SCALE

91. 1" = 1' SCALE

92. 1" = 1' SCALE

93. 1" = 1' SCALE

94. 1" = 1' SCALE

95. 1" = 1' SCALE

96. 1" = 1' SCALE

97. 1" = 1' SCALE

98. 1" = 1' SCALE

99. 1" = 1' SCALE

100. 1" = 1' SCALE

MOMENTUM

ENGINEERING & SURVEYING

8000 WEST FOREST, SUITE 500, HOUSTON, TX 77077

(713) 761-1000 FAX (713) 761-1001

SITE PAVING & GRADING PLAN

GRAND MISSION SQUARE

8710 GRAND MISSION BLVD

RICHMOND, TEXAS 77407

DATE: 12-11-13

BY: [Signature]

CHECKED BY: [Signature]

APPROVED BY: [Signature]

SCALE: 1" = 1' SCALE

SHEET NO. 1 OF 10

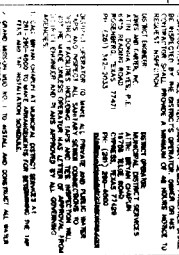

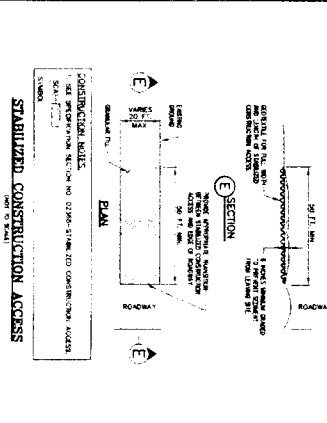
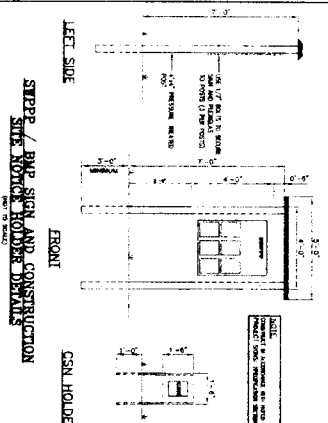
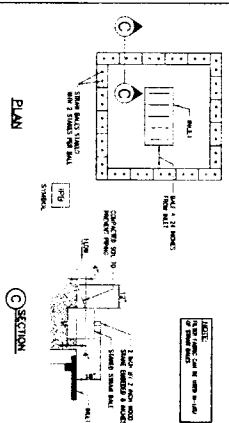
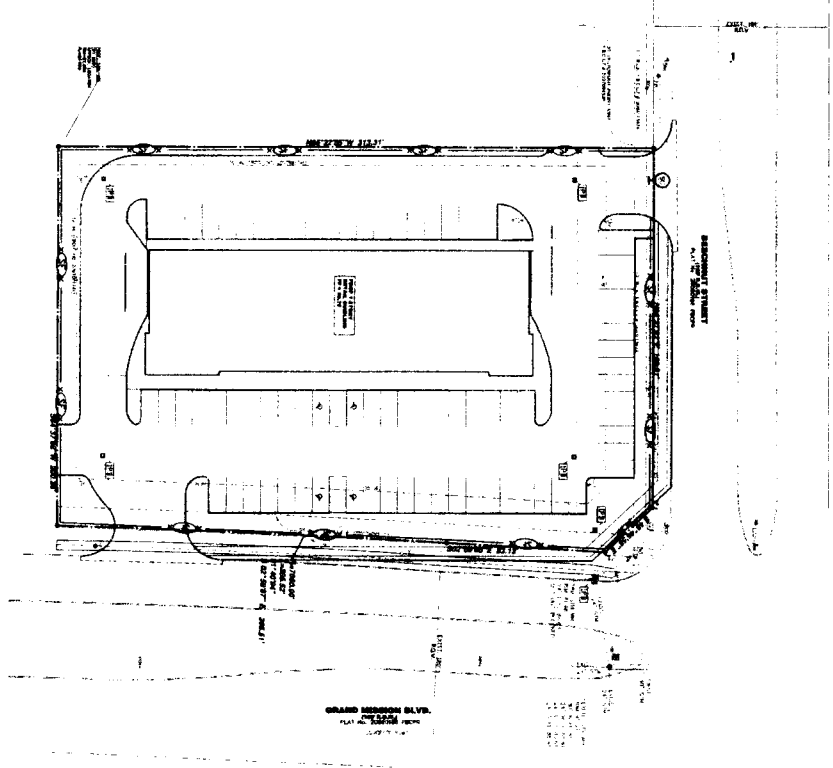
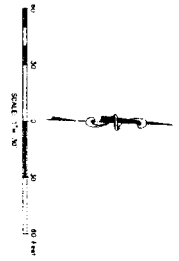

IMPORTANT NOTE: THESE DRAWINGS ARE PREPARED FOR THE USE OF THE CLIENT AND ARE NOT TO BE USED FOR ANY OTHER PURPOSE. THE CLIENT IS RESPONSIBLE FOR THE ACCURACY OF THE INFORMATION PROVIDED AND FOR THE RESULTS OF ANY CONSTRUCTION WORK BASED ON THESE DRAWINGS. THE CLIENT IS ALSO RESPONSIBLE FOR OBTAINING ALL NECESSARY PERMITS AND APPROVALS FROM THE APPROPRIATE AGENCIES. THE CLIENT IS ADVISED THAT THESE DRAWINGS ARE NOT TO BE USED FOR ANY OTHER PURPOSE AND THAT THE CLIENT IS RESPONSIBLE FOR THE RESULTS OF ANY CONSTRUCTION WORK BASED ON THESE DRAWINGS.

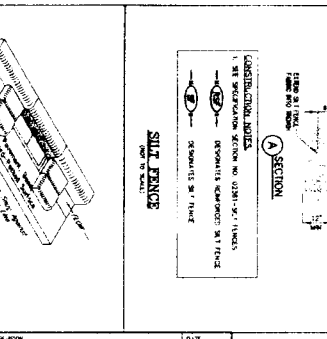
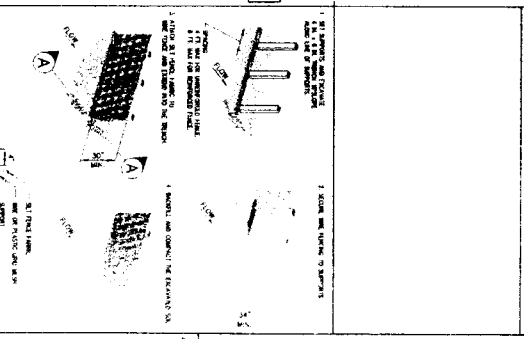

GENERAL NOTES:
1. ALL CONSTRUCTION SHALL BE IN ACCORDANCE WITH THE LATEST EDITIONS OF THE TEXAS CONSTRUCTION CODES AND STANDARDS.
2. ALL CONSTRUCTION SHALL BE IN ACCORDANCE WITH THE LATEST EDITIONS OF THE TEXAS CONSTRUCTION CODES AND STANDARDS.
3. ALL CONSTRUCTION SHALL BE IN ACCORDANCE WITH THE LATEST EDITIONS OF THE TEXAS CONSTRUCTION CODES AND STANDARDS.
4. ALL CONSTRUCTION SHALL BE IN ACCORDANCE WITH THE LATEST EDITIONS OF THE TEXAS CONSTRUCTION CODES AND STANDARDS.
5. ALL CONSTRUCTION SHALL BE IN ACCORDANCE WITH THE LATEST EDITIONS OF THE TEXAS CONSTRUCTION CODES AND STANDARDS.

STORM WATER POLLUTION PREVENTION NOTES:
1. THE CLIENT IS RESPONSIBLE FOR THE ACCURACY OF THE INFORMATION PROVIDED AND FOR THE RESULTS OF ANY CONSTRUCTION WORK BASED ON THESE DRAWINGS.
2. THE CLIENT IS ALSO RESPONSIBLE FOR OBTAINING ALL NECESSARY PERMITS AND APPROVALS FROM THE APPROPRIATE AGENCIES.
3. THE CLIENT IS ADVISED THAT THESE DRAWINGS ARE NOT TO BE USED FOR ANY OTHER PURPOSE AND THAT THE CLIENT IS RESPONSIBLE FOR THE RESULTS OF ANY CONSTRUCTION WORK BASED ON THESE DRAWINGS.
4. THE CLIENT IS RESPONSIBLE FOR THE ACCURACY OF THE INFORMATION PROVIDED AND FOR THE RESULTS OF ANY CONSTRUCTION WORK BASED ON THESE DRAWINGS.
5. THE CLIENT IS ALSO RESPONSIBLE FOR OBTAINING ALL NECESSARY PERMITS AND APPROVALS FROM THE APPROPRIATE AGENCIES.

PLAN LEGEND

1. 1/4" = 1' SCALE	2. 1/4" = 1' SCALE
3. 1/4" = 1' SCALE	4. 1/4" = 1' SCALE
5. 1/4" = 1' SCALE	6. 1/4" = 1' SCALE
7. 1/4" = 1' SCALE	8. 1/4" = 1' SCALE
9. 1/4" = 1' SCALE	10. 1/4" = 1' SCALE
11. 1/4" = 1' SCALE	12. 1/4" = 1' SCALE
13. 1/4" = 1' SCALE	14. 1/4" = 1' SCALE
15. 1/4" = 1' SCALE	16. 1/4" = 1' SCALE
17. 1/4" = 1' SCALE	18. 1/4" = 1' SCALE
19. 1/4" = 1' SCALE	20. 1/4" = 1' SCALE
21. 1/4" = 1' SCALE	22. 1/4" = 1' SCALE
23. 1/4" = 1' SCALE	24. 1/4" = 1' SCALE
25. 1/4" = 1' SCALE	26. 1/4" = 1' SCALE
27. 1/4" = 1' SCALE	28. 1/4" = 1' SCALE
29. 1/4" = 1' SCALE	30. 1/4" = 1' SCALE
31. 1/4" = 1' SCALE	32. 1/4" = 1' SCALE
33. 1/4" = 1' SCALE	34. 1/4" = 1' SCALE
35. 1/4" = 1' SCALE	36. 1/4" = 1' SCALE
37. 1/4" = 1' SCALE	38. 1/4" = 1' SCALE
39. 1/4" = 1' SCALE	40. 1/4" = 1' SCALE
41. 1/4" = 1' SCALE	42. 1/4" = 1' SCALE
43. 1/4" = 1' SCALE	44. 1/4" = 1' SCALE
45. 1/4" = 1' SCALE	46. 1/4" = 1' SCALE
47. 1/4" = 1' SCALE	48. 1/4" = 1' SCALE
49. 1/4" = 1' SCALE	50. 1/4" = 1' SCALE
51. 1/4" = 1' SCALE	52. 1/4" = 1' SCALE
53. 1/4" = 1' SCALE	54. 1/4" = 1' SCALE
55. 1/4" = 1' SCALE	56. 1/4" = 1' SCALE
57. 1/4" = 1' SCALE	58. 1/4" = 1' SCALE
59. 1/4" = 1' SCALE	60. 1/4" = 1' SCALE
61. 1/4" = 1' SCALE	62. 1/4" = 1' SCALE
63. 1/4" = 1' SCALE	64. 1/4" = 1' SCALE
65. 1/4" = 1' SCALE	66. 1/4" = 1' SCALE
67. 1/4" = 1' SCALE	68. 1/4" = 1' SCALE
69. 1/4" = 1' SCALE	70. 1/4" = 1' SCALE
71. 1/4" = 1' SCALE	72. 1/4" = 1' SCALE
73. 1/4" = 1' SCALE	74. 1/4" = 1' SCALE
75. 1/4" = 1' SCALE	76. 1/4" = 1' SCALE
77. 1/4" = 1' SCALE	78. 1/4" = 1' SCALE
79. 1/4" = 1' SCALE	80. 1/4" = 1' SCALE
81. 1/4" = 1' SCALE	82. 1/4" = 1' SCALE
83. 1/4" = 1' SCALE	84. 1/4" = 1' SCALE
85. 1/4" = 1' SCALE	86. 1/4" = 1' SCALE
87. 1/4" = 1' SCALE	88. 1/4" = 1' SCALE
89. 1/4" = 1' SCALE	90. 1/4" = 1' SCALE
91. 1/4" = 1' SCALE	92. 1/4" = 1' SCALE
93. 1/4" = 1' SCALE	94. 1/4" = 1' SCALE
95. 1/4" = 1' SCALE	96. 1/4" = 1' SCALE
97. 1/4" = 1' SCALE	98. 1/4" = 1' SCALE
99. 1/4" = 1' SCALE	100. 1/4" = 1' SCALE



MOMENTUM
ENGINEERING-DESIGN-BUILD

12801 BRIDGE FORT, SUITE 550 HOUSTON, TX 77077
PHONE: 281-414-1100 FAX: 281-414-1101
WWW.MOMENTUM-DESIGN.COM

STORM WATER POLLUTION PREVENTION PLAN

GRAND MISSION SQUARE
8710 GRAND MISSION BLVD
RICHMOND, TEXAS 77407

PROJECT NO. 15-111

DATE: 04-11-13

DESIGNED BY: JLD

CHECKED BY: JLD

DATE: 04-11-13

SCALE: 1/4" = 1'

FIG. NO. 1

PROJECT NO. 15-111

DATE: 04-11-13

DESIGNED BY: JLD

CHECKED BY: JLD

DATE: 04-11-13

SCALE: 1/4" = 1'

FIG. NO. 1

