

10 H

REVIEW BY FORT BEND COUNTY COMMISSIONERS COURT

On this 17 day of DECEMBER, 2013, Commissioners Court came on to be heard and reviewed the accompanying notice of CENTERPOINT ENTEX

Job Location MADDEN ROAD, WEST BELLFORT, WESTMOOR ROAD

Dated 12/09/13 Bond No. 22-022-417, Permit No. 84472 to make use of certain Fort Bend County property subject to, "A Revised Order Regulating the Laying, Construction, Maintenance, and Repair of Buried Cables, Conduits, and Pole Lines, In, Under, Across or Along Roads, Streets, Highways, and Drainage Ditches in Fort Bend County, Texas, Under the Jurisdiction of the Commissioners Court of Fort Bend County, Texas," as passed by the Commissioners Court of Fort Bend County, Texas, date the 3rd day of August, 1987, recorded in Volume _____ of the Minutes of the Commissioners Court of Fort Bend County, Texas, to the extent that such order is not inconsistent with Article 1436a, Vernon's Texas Civil Statutes. Upon Motion of Commissioner Meyers, seconded by Commissioner Patterson, duly put and carried, it is ORDERED, ADJUGED AND DECREED that said notice of said above purpose is hereby acknowledged by the Commissioners Court of Fort Bend County, Texas, and that said notice be placed on record according to the regulation order thereof.

Notes:

1. Evidence of review by the Commissioners Court must be kept on the job site and failure to do so constitutes grounds for job shutdown.
2. Written notices are required:
 - a. 48 hours in advance of construction start up, and
 - b. When construction is completed and ready for final inspection

Mail notices to: Permit Administrator
Fort Bend County Engineering
301 JACKSON STREET
RICHMOND, Texas 77469
281-633-7500

3. This permit expires one (1) year from date of permit if construction has not commenced.

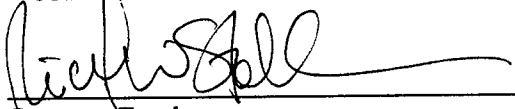
By 
County Engineer

By N/A
Drainage District Engineer/Manager

Presented to Commissioners Court and approved.

Recorded in Volume 12-17-13
Minutes of Commissioners Court.

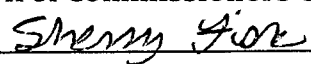
Clerk of Commissioners Court
By 
Deputy

COUNTY OF FORT BEND

Engineering Department

301 JACKSON STREET
RICHMOND, Texas 77469

Johnny Ortega
Permit Administrator

1124 Blume Road
Phone: (281) 633-7500

PERMIT APPLICATION REVIEW FORM FOR CABLE, CONDUIT, AND POLE LINE ACTIVITY IN FORT BEND COUNTY

PERMIT NO. 000072

The following "Notice of Proposed Cable, Conduit, and/or Pole Line activity in Fort Bend County" and accompanying attachments have been reviewed and the notice conforms to appropriate regulations set by Commissioner's Court of Fort Bend County, Texas.

- X (1) Complete Application Form.
- X a. Name of road, street, and/or drainage ditch affected.
- X b. Vicinity map showing course of direction.
- X c. Plans and specifications.

- X (2) Bond:
- District Attorney, approval when applicable.
- X Perpetual bond currently posted.
- No. 22-022-417
- Amount \$50,000.00
- Performance bond submitted.
- No.
- Amount
- Cashier's Check.
- No.
- Amount

- (3) Verbal permission given for emergencies, to start construction before approved in Commissioner's Court.

 Precinct Engineer Acknowledgment Date

 Precinct Commissioner Acknowledgment Date

- (4)
- Drainage District Approval when applicable

We have reviewed this project and agree it meets minimum requirements.

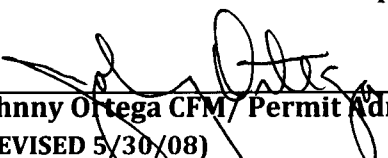
Johnny Ortega CFM/ Permit Administrator
(REVISED 5/30/08)

12/09/2013
Date

NOTICE OF PROPOSED CABLE, CONDUIT AND / OR POLE LINE ACTIVITY
IN, UNDER, ACROSS OR ALONG ROADS, STREETS, HIGHWAYS AND DRAINAGE DITCHES
IN FORT BEND COUNTY

APPLICANT'S JOB NO. WO #66694650, 66695883 & 66695876
PERMIT NO. 84972 PCT. NO. 9
BOND NO. 22-022-411

RUSH

Formal notice is hereby given that CENTERPOINT ENTEX
proposes to lay, construct, maintain and / or repair cable, conduit, and / or pole
line, in, under, across, or along roads, streets, highways and drainage
ditches in Fort Bend County, as follows:

In, Under, or Across Roads, and / or Drainage Ditches

Road or Ditch Name	Distance & Direction From Nearest Intersection	Length of Crossing	Type of Construction Bored: Jacked: Driven: Cased			
Madden Rd	3' WE row Binion Ln	50'	YES			
W Bellfort	3' EW row Westmoor Rd	80'	YES			

Along Roads and / or Drainage Ditches

Road or Ditch Name	Distance & Direction From Nearest intersection	To	Distance
Madden Rd	3' EW row FM 1464	3' EW Westmoor Rd	2,875'
Westmoor Rd	3' SN row Madden RD	3' SN row W Bellfort	2,570'

General Description

The location and description of the proposed installation and appurtenances is more fully shown on the attached detail drawings. The laying, construction, maintenance and / or repair of the proposed installation shall be subject to "A Revised Order Regulating the Laying, Construction, Maintenance and / or Repair of Cables, Conduits, and / or Pole Lines, In, Under, Across, or Along Roads, Streets, Highways and Drainage Ditches in Fort Bend County, Texas, Under the Jurisdiction of the Commissioners Court of Fort Bend County, Texas," as passed by Commissioners Court of Fort Bend County, Texas, dated the 3rd. day of August, 1987, recorded in Volume 639 of the Minutes of the Commissioners Court of Fort Bend County, Texas.

To serve: THIS IS SYSTEM IMPROVEMENT & FOR FUTURE DEVELOPMENT.

Written notices are required: 1) 48 hours in advance of start of construction and 2) when construction is complete and ready for final inspection.

Mail To: Permit Administrator / Fort Bend County Engineering
301 Jackson Street, Richmond, Texas, 77469-3108

Violation of requirements shall constitute grounds for job shut down.

COMPANY NAME: CenterPoint Entex
AGENT and / or OWNER
Ravinder Duggal
(Signature)

NAME & TITLE: RAVINDER DUGGAL
Advanced Engineering Coordinator
(Please Print)

DATE: December 05, 2013

ADDRESS: 1111 Louisiana – Ste. 2275 D
(Street / P.O. Box)
Houston Texas 77002
City State Zip

TELEPHONE NO: (713) 207-4621
(Accessible 24 hrs/day, 7 days/week)

GENERAL NOTES
1. FIELD VERIFY & LOCATE ALL EXISTING FEEDS, MAINS, & SERVICES.
2. MAINTAIN MIN. DEPTH OF 3' UNLESS OTHERWISE NOTED.
3. USE GAUGES TO MONITOR & MAINTAIN FEEDS, & PRESSURES.
4. CONTACT RAVINDER DUGGAL (713-207-4621) WITH ANY NECESSARY FIELD CHANGES.

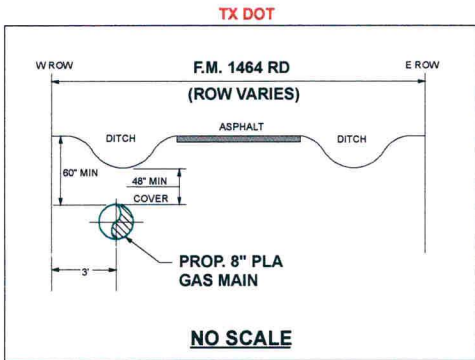
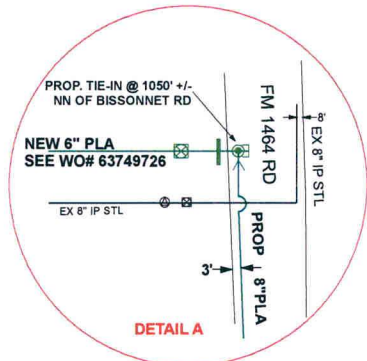

NOTIFY CNP ENGINEER RAVINDER DUGGAL @ 713-207-4621
48 HRS PRIOR TO CONSTRUCTION & CONTACT CNP
INSPECTOR WADE CODDMAN 713-545-9833 FOR CONSTRUCTION

BISSONNET BLVD
(100' ROW)

F.M. 1464 RD (200' ROW)

PROP. 4,065' OF 8" IP PLA

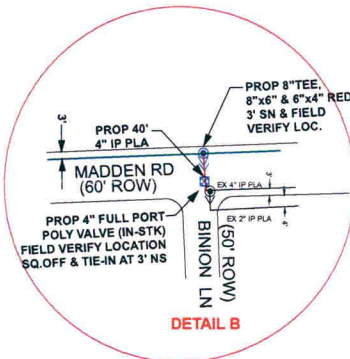
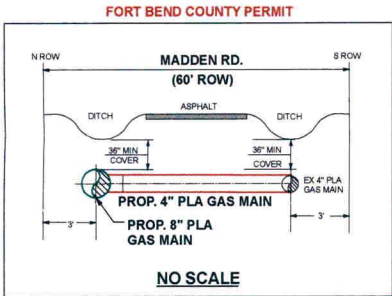

PROP. 2,875' OF 8" IP PLA

MADDEN RD (60' ROW)

← TWO WAY FEED →

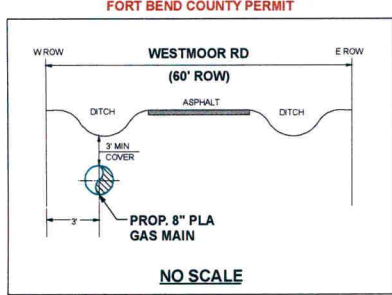

WESTMOOR RD (60' ROW)

PROP. 2,570' OF 8" IP PLA

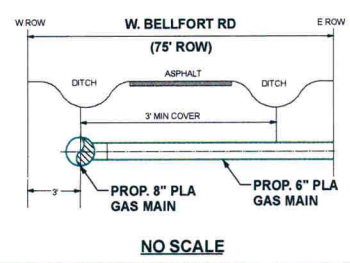
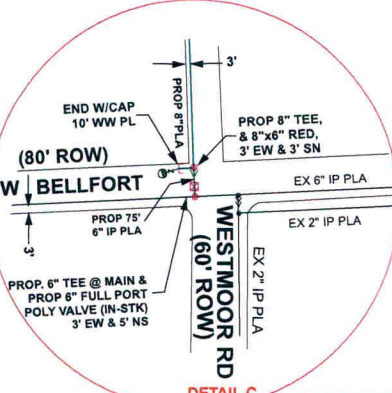

GASSTAKING			
JOB NO.:	BY:	DATE:	
ESMTS. DED. BY:	ESMT. DOCUMENTS:		
MONUMENTATION FND.:	PLAT DIST.:	CHK.:	D.
ESMTS. NEEDED AT:			
NON-STD. STAKING:	REASON:		

LOT NUMBER CHART			
MATERIAL#	SECTION	LOT NUMBER	MAIN FOOTAGE FUSION METHOD
	A		EF BF SF SDL
	B		EF BF SF SDL
	C		EF BF SF SDL
	D		EF BF SF SDL

CenterPoint
Energy

REGULATORY AND COMMERCIAL

PROJECT WCH
GCO: 22459

66694650

FACET

F30480880
F30510888
F30540882
F30510880
F30480878
F30510884
F30510882

OP MAP

C30480880
C30480872

KM

5278
528V
5282
527N

LAMBERT

4653A4
4653C3
4653C1
4653C2
4653A2

TC

30

SZ

099
505

SOG

08850
07801

LEGEND:

EXIST. MAIN
PROP. 8" IP PLA
WO #66694650
PROP. 8" IP PLA
WO #66695878
PROP. 4" IP PLA
WO #66695833

PROP. TEST STATION
PROP. 58 ANODE
PROP. 328 MAG. ANODE
PROP. LINE MARKER
PROP. LOC. TEST STA

GENERAL NOTES:

1. CRITERIA TO BE USED FOR TRACER WIRE SELECTION WHEN INSTALLING PLASTIC GAS LINES:
A. USE #14 TRACER WIRE FOR ALL RESIDENTIAL SERVICE LINES.
B. USE #14 TRACER WIRE FOR SHORT BORES UP TO 300' AND ALL OTHER NON-BORE INSTALLATIONS.
C. USE #10 TRACER WIRE WITH ALL BORES LONGER THAN 300'.
D. USE #6 TRACER WIRE AS NEEDED FOR LARGE BAYOU CROSSINGS AND OTHER EXTRAORDINARY SITUATIONS AND COMPLEX BORES. INSPECTOR APPROVAL REQUIRED PRIOR TO WORK.
2. TEST PRESSURE 100 PSIG

SYS. IMP. ALONG F.M. 1464, MADDEN RD. & WESTMOOR RD. & AT W. BELLFORT

PURPOSE:
TO IMPROVE PRESSURE & FUTURE IN DEV. SUGARLAND, FORT BEND COUNTY

DESIGNER:
PHONE:
DRAWN BY:
DESIGN DATE:

ESTIMATED COST:
CONTRIBUTION:
DATE NEEDED:

RECOMMENDED BY:
DATE:

APPROVED BY:
DATE:

APPROVED BY:
DATE:

APPROVED BY:
DATE:

SCALE: 1" = 240'
SHEET 1 OF 1

6/23/2013 10:19:43 AM Designer Express Design