

REVIEW BY FORT BEND COUNTY COMMISSIONERS COURT

On this 24 day of SEPTEMBER, 2013, Commissioners Court came on to be heard and reviewed the accompanying notice of CENTERPOINT ENTEX

Job Location BRIDAL WREATH DRIVE

Dated 09/09/13 Bond No. 22-022-417, Permit No. 84424 to make use of certain Fort Bend County property subject to, "A Revised Order Regulating the Laying, Construction, Maintenance, and Repair of Buried Cables, Conduits, and Pole Lines, In, Under, Across or Along Roads, Streets, Highways, and Drainage Ditches in Fort Bend County, Texas, Under the Jurisdiction of the Commissioners Court of Fort Bend County, Texas," as passed by the Commissioners Court of Fort Bend County, Texas, date the 3rd day of August, 1987, recorded in Volume _____ of the Minutes of the Commissioners Court of Fort Bend County, Texas, to the extent that such order is not inconsistent with Article 1436a, Vernon's Texas Civil Statutes. Upon Motion of Commissioner Meyers, seconded by Commissioner Patterson, duly put and carried, it is ORDERED, ADJUDGED AND DECREED that said notice of said above purpose is hereby acknowledged by the Commissioners Court of Fort Bend County, Texas, and that said notice be placed on record according to the regulation order thereof.

Notes:

1. Evidence of review by the Commissioners Court must be kept on the job site and failure to do so constitutes grounds for job shutdown.
2. Written notices are required:
 - a. 48 hours in advance of construction start up, and
 - b. When construction is completed and ready for final inspection

Mail notices to: Permit Administrator
Fort Bend County Engineering
P.O. Box 1449
Rosenberg, Texas 77471
281-633-7500

3. This permit expires one (1) year from date of permit if construction has not commenced.

By [Signature]
County Engineer

By N/A
Drainage District Engineer/Manager

Presented to Commissioners Court and approved.

Recorded in Volume 9-24-13
Minutes of Commissioners Court.

Clerk of Commissioners Court
By [Signature]
Deputy

COUNTY OF FORT BEND

Engineering Department

P.O. BOX 1449
Rosenberg, Texas 77471-1449

Johnny Ortega
Permit Administrator

1124 Blume Road
Phone: (281) 341-7500

PERMIT APPLICATION REVIEW FORM FOR CABLE, CONDUIT, AND POLE LINE ACTIVITY IN FORT BEND COUNTY

PERMIT NO. 002424

The following "Notice of Proposed Cable, Conduit, and/or Pole Line activity in Fort Bend County" and accompanying attachments have been reviewed and the notice conforms to appropriate regulations set by Commissioner's Court of Fort Bend County, Texas.

X (1) Complete Application Form.
X a. Name of road, street, and/or drainage ditch affected.
X b. Vicinity map showing course of direction.
X c. Plans and specifications.

X (2) Bond:
District Attorney, approval when applicable.
X Perpetual bond currently posted.
No. 22-022-417
Amount \$50,000.00
Performance bond submitted.
No. _____
Amount _____
Cashier's Check.
No. _____
Amount _____

_____ (3) Verbal permission given for emergencies, to start construction before approved in Commissioner's Court.

_____ Precinct Engineer Acknowledgment _____ Date _____

_____ Precinct Commissioner Acknowledgment _____ Date _____

_____ (4) _____
Drainage District Approval when applicable

We have reviewed this project and agree it meets minimum requirements.

Johnny Ortega CFM, Permit Administrator
(REVISED 5/30/08)

09/09/2013
Date

NOTICE OF PROPOSED CABLE, CONDUIT AND / OR POLE LINE ACTIVITY
IN, UNDER, ACROSS OR ALONG ROADS, STREETS, HIGHWAYS AND DRAINAGE DITCHES
IN FORT BEND COUNTY

APPLICANT'S JOB NO. WO #66799249
PERMIT NO. 84424 PCT. NO. 3
BOND NO. 22-022-417

Formal notice is hereby given that CENTERPOINT ENTEX
proposes to lay, construct, maintain and / or repair cable, conduit, and / or pole
line, in, under, across, or along roads, streets, highways and drainage
ditches in Fort Bend County, as follows:

In, Under, or Across Roads, and / or Drainage Ditches

Road or Ditch Name	Distance & Direction From Nearest Intersection	Length of Crossing	Type of Construction			
			Bored:	Jacked:	Driven:	Cased

Along Roads and / or Drainage Ditches

Road or Ditch Name	Distance & Direction From Nearest intersection	To	Distance
BRIDAL WREATH	986' WW HOMES RD	1129' WW HOMES RD	138'
DR		US HWY 90	

General Description

The location and description of the proposed installation and appurtenances is more fully shown on the attached detail drawings. The laying, construction, maintenance and / or repair of the proposed installation shall be subject to "A Revised Order Regulating the Laying, Construction, Maintenance and / or Repair of Cables, Conduits, and / or Pole Lines, In, Under, Across, or Along Roads, Streets, Highways and Drainage Ditches in Fort Bend County, Texas, Under the Jurisdiction of the Commissioners Court of Fort Bend County, Texas," as passed by Commissioners Court of Fort Bend County, Texas, dated the 3rd. day of August, 1987, recorded in Volume 639 of the Minutes of the Commissioners Court of Fort Bend County, Texas.

To serve: TO SEVRE RESIDENTIAL 4910 BRIDAL WREATH DR

Written notices are required: 1) 48 hours in advance of start of construction and 2) when construction is complete and ready for final inspection.

Mail To: Permit Administrator / Fort Bend County Engineering
P. O. Box 1449, Rosenberg, Texas 77471

Violation of requirements shall constitute grounds for job shut down.

COMPANY NAME: CenterPoint Entex
AGENT and / or OWNER
Ravinder Duggal
(Signature)

NAME & TITLE: RAVINDER DUGGAL
Advanced Engineering Coordinator
(Please Print)

DATE: SEPTEMBER 5, 2013

ADDRESS: 1111 Louisiana – Ste. 2275 D
(Street / P.O. Box)
Houston Texas 77002
City State Zip

TELEPHONE NO: (713) 207-4621
(Accessible 24 hrs/day, 7 days/week)

PROJECT WO# 66799916

FACET

F30210668
F30180670
F30210670
F30180668

OP MAP

O30120664

KM

565E

LAMBERT

4351B2
4451A1
4352D4
4452C3

TC

073

SZ

503

SOG

07601

LEGEND:

EXIST. MAIN

PROP. 2" IP PLA 138'

WO #66799249

PROP. 5# ANODE

GCO: #22601

NOTIFICATION: #1403012278

GENERAL NOTES:

- 1- CRITERIA TO BE USED FOR TRACER WIRE SELECTION WHEN INSTALLING PLASTIC GAS LINES:
A- USE #14 TRACER WIRE FOR ALL RESIDENTIAL SERVICE LINES.
B- USE #14 TRACER WIRE FOR SHORT BORES UP TO 300' AND ALL OTHER NON-BORE INSTALLATIONS.
C- USE #10 TRACER WIRE WITH ALL BORES LONGER THAN 300'.
D- USE #8 TRACER WIRE AS NEEDED FOR LARGE BAYOU CROSSINGS AND OTHER EXTRAORDINARY SITUATIONS AND COMPLEX BORES. INSPECTOR APPROVAL REQUIRED PRIOR TO WORK.
- 2- TEST PRESSURE 100 PSIG

4910 BRIDAL WREATH DR

PURPOSE:
TO SERVE ONE CUSTOMER IN
RICHMOND, FORT BEND COUNTY.

DESIGNER: RAVINDER DUGGAL
PHONE#: 713-207-4621
DRAWN BY: Becky Perez
DESIGN DATE: 8/28/2013

ESTIMATED COST:\$
CONTRIBUTION:\$
DATE NEEDED:

RECOMMENDED BY:

DATE:

APPROVED BY:

DATE:

SCALE: 1" = 120'
SHEET: 1 OF 1

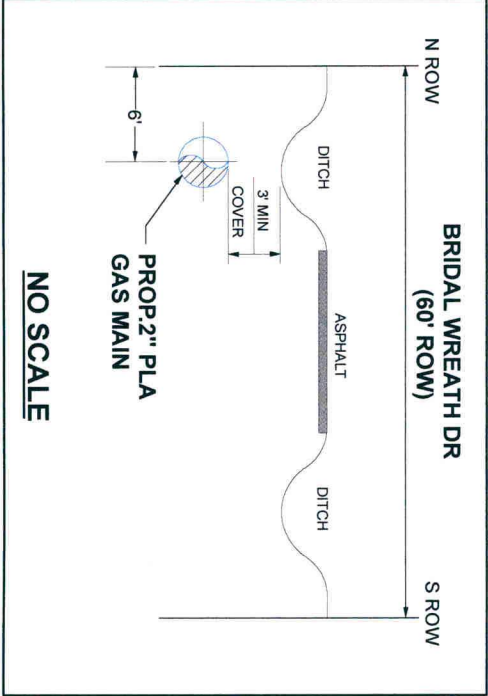
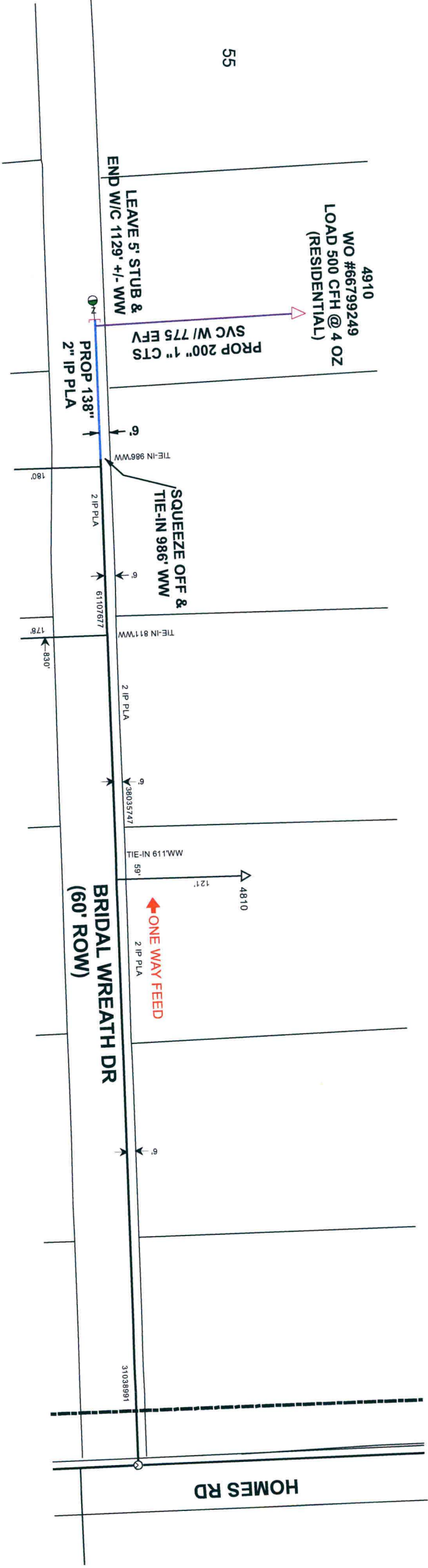

FORT BEND COUNTY PERMIT

- GENERAL NOTES**
1. FIELD VERIFY & LOCATE ALL EXISTING FEEDS, MAINS, & SERVICES.
 2. MAINTAIN MIN. DEPTH OF 3' UNLESS OTHERWISE NOTED.
 3. USE GAUGES TO MONITOR & MAINTAIN FEEDS, & PRESSURES.
 4. CONTACT RAVINDER DUGGAL (713-207-4621) WITH ANY NECESSARY FIELD CHANGES.

FOR QUESTIONS ABOUT THIS PROJECT CONTACT
CNP GSC ELDON ELLISTON 281-341-4936

LOT NUMBER CHART

LOT NUMBER CHART				
MATERIAL#	SECTION	LOT NUMBER	MAIN FOOTAGE	FUSION METHOD
	A			EF BF SF SDL
	B			EF BF SF SDL
	C			EF BF SF SDL
	D			EF BF SF SDL

GASSTAKING

JOB NO.: _____ BY: _____ DATE: _____
ESMTS. DED. BY: _____ ESMT. DOCUMENTS: _____
MONUMENTATION FND.: _____ PLAT DIST. CHK.=D. _____
ESMTS. NEEDED AT: _____
NON-STD. STAKING: _____ REASON: _____