

5E

FORT BEND COUNTY ENGINEERING

Fort Bend County, Texas

Richard W. Stolleis, P.E.
County Engineer

June 14, 2013

Commissioner W. A. "Andy" Meyers
Fort Bend County Precinct 3
22333 Grand Corner Drive
Katy, Texas 77494

RE: Traffic/Safety Study - Fort Bend ISD Hodges Bend Middle School

Dear Commissioner Meyers:

The Fort Bend County Engineering Department has received a request from the Associate Principal, Hodges Bend Middle School, requesting the following: (1). To install an unprotected crosswalk at the intersection of Hodges Bend Drive and April Falls Trail crossing April Falls Trail, and (2) to install "No Parking" signs on each side of Hodges Bend Drive.

The crosswalk will be added at the location requested. The crosswalk will be marked and signs will be installed to reflect an unprotected crosswalk.

The "No parking anytime" signs are already installed on both sides of Hodges Bend Drive. The Fort Bend County Engineering Department recommends these signs be replaced with "No Parking during school zone times" signs as there are single family residence on the east side of Hodges Bend Drive, and the signs should not restrict parking all the time.

Fort Bend County Engineering Department recommends acceptance of the traffic control plan as submitted. The public hearing date for acceptance of the plan is being scheduled. A copy of the traffic control plan is attached for your review. If you should have any questions, please give me a call.

Sincerely,

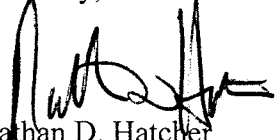

Nathan D. Hatcher
Assistant to County Engineer

NDH/mjs

cc: Judge Robert E. Hebert, County Judge
Marc Grant - FBC Road & Bridge
Marc Grant - Signage Department
Mr. Rick Gonzales, Associate Principal, Hodge Bend Middle School
File

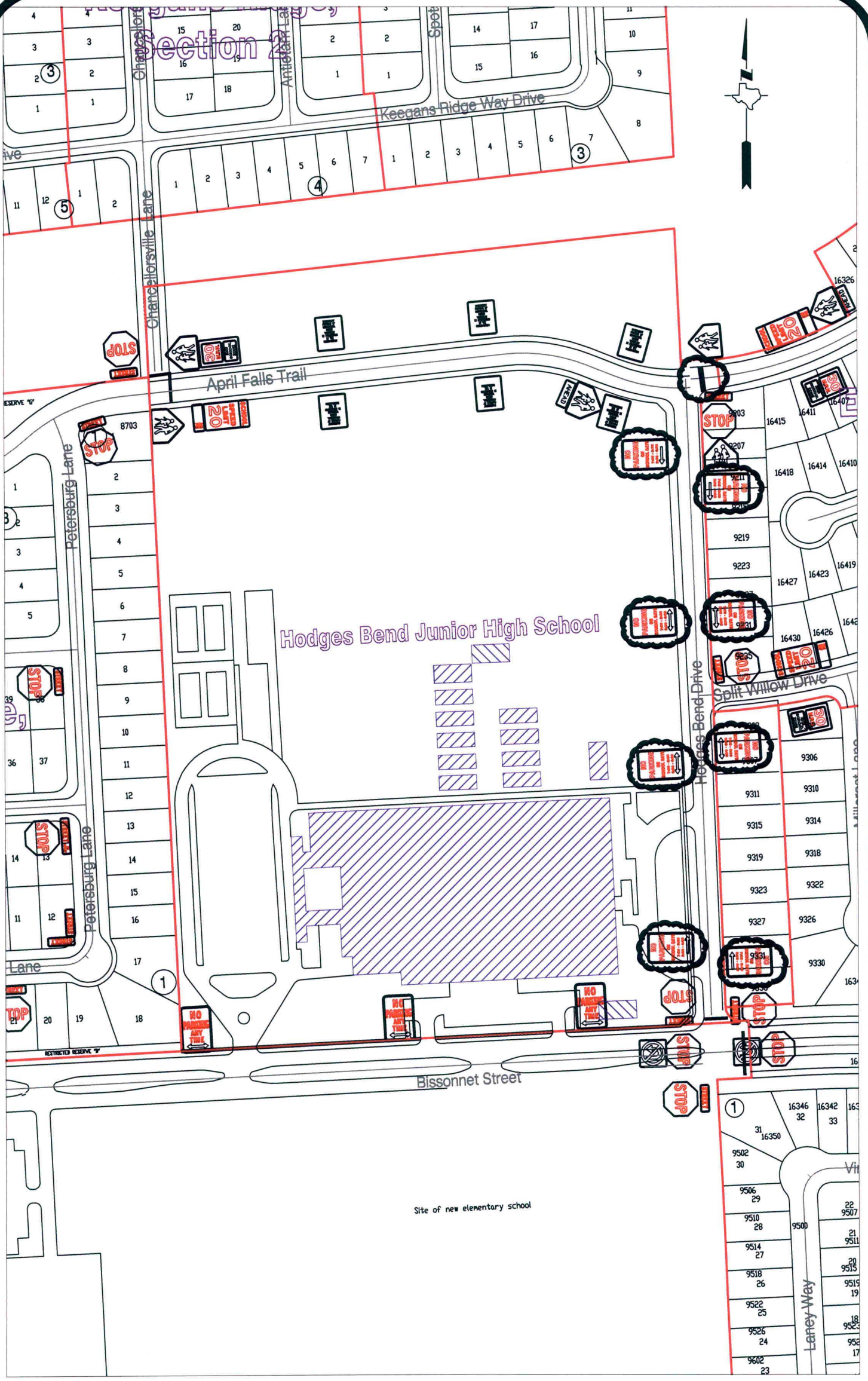

Note:
The purpose of this traffic control plan is to replace "No Parking" signs along Hodges Bend Drive east of Hodges Bend Middle School with "No Parking During School Zone Times" signs.

Drawn By: L. Brdecka
Date: 6-3-13
Approved By: Nathan Hatcher
Date: 6-3-13
Scale
1" = 200'-0"

**Hodges Bend Drive at
Hodges Bend Middle School
Control Map and
Traffic Sign Layout**
Fort Bend County Engineering Dept.
1124 Blume Road
Rosenberg, Texas 77471