

12F

REVIEW BY FORT BEND COUNTY COMMISSIONERS COURT

On this 07 day of MAY, 2013, Commissioners Court
came on to be heard and reviewed the accompanying notice
of AT & T TEXAS

Job Location WIMBERLY CANYON DRIVE, GRAND PARKWAY [STATE HIGHWAY 99]

Dated 04/23/13 Bond No. CH1-001686693-01, Permit No. 84350
to make use of certain Fort Bend County property subject to, "A Revised Order
Regulating the Laying, Construction, Maintenance, and Repair of Buried Cables,
Conduits, and Pole Lines, In, Under, Across or Along Roads, Streets, Highways, and
Drainage Ditches in Fort Bend County, Texas, Under the Jurisdiction of the
Commissioners Court of Fort Bend County, Texas," as passed by the Commissioners
Court of Fort Bend County, Texas, date the 3rd day of August, 1987, recorded in
Volume _____ of the Minutes of the Commissioners Court of Fort Bend County,
Texas, to the extent that such order is not inconsistent with Article 1436a, Vernon's
Texas Civil Statutes. Upon Motion of Commissioner Meyers, seconded
by Commissioner Paterson, duly put and carried, it is ORDERED,
ADJUGED AND DECREED that said notice of said above purpose is hereby
acknowledged by the Commissioners Court of Fort Bend County, Texas, and that said
notice be placed on record according to the regulation order thereof.

Notes:

1. Evidence of review by the Commissioners Court must be kept on the job site
and failure to do so constitutes grounds for job shutdown.
2. Written notices are required:
 - a. 48 hours in advance of construction start up, and
 - b. When construction is completed and ready for final inspection

Mail notices to: Permit Administrator
Fort Bend County Engineering
P.O. Box 1449
Rosenberg, Texas 77471
281-633-7500

3. This permit expires one (1) year from date of permit if construction has not
commenced.

By

County Engineer

By

Drainage District Engineer/Manager

Presented to Commissioners Court
and approved.

Recorded in Volume 5-7-13
Minutes of Commissioners Court.

Clerk of Commissioners Court

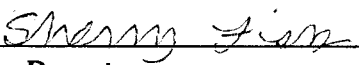
By 
Deputy

COUNTY OF FORT BEND

Engineering Department

P.O. BOX 1449
Rosenberg, Texas 77471-1449

Johnny Ortega
Permit Administrator

1124 Blume Road
Phone: (281) 341-7500

PERMIT APPLICATION REVIEW FORM FOR CABLE, CONDUIT, AND POLE LINE ACTIVITY IN FORT BEND COUNTY

PERMIT NO. 084250

The following "Notice of Proposed Cable, Conduit, and/or Pole Line activity in Fort Bend County" and accompanying attachments have been reviewed and the notice conforms to appropriate regulations set by Commissioner's Court of Fort Bend County, Texas.

X (1) Complete Application Form.
X a. Name of road, street, and/or drainage ditch affected.
X b. Vicinity map showing course of direction.
X c. Plans and specifications.

X (2) Bond:
District Attorney, approval when applicable.
X Perpetual bond currently posted.
No. CH1-001686693-01
Amount \$25,000.00
Performance bond submitted.
No. _____
Amount _____
Cashier's Check.
No. _____
Amount _____

_____ (3) Verbal permission given for emergencies, to start construction before approved in Commissioner's Court.

Precinct Engineer Acknowledgment Date

Precinct Commissioner Acknowledgment Date

_____ (4) _____
Drainage District Approval when applicable

We have reviewed this project and agree it meets minimum requirements.

Johnny Ortega CFM/ Permit Administrator
(REVISED 5/30/08)

04/23/2013
Date

NOTICE OF PROPOSED CABLE, CONDUIT AND/OR POLE LINE ACTIVITY
IN, UNDER, ACROSS OR ALONG ROADS, STREETS, HIGHWAYS AND DRAINAGE DITCHES
IN FORT BEND COUNTY

APPLICANT'S JOB NO. 9017076
PERMIT NO. 84350 PCT. NO. 161
BOND NO. CH1-001684693 01

FORMAL NOTICE IS HEREBY GIVEN THAT AT&T Texas
PROPOSES TO LAY, CONSTRUCT, MAINTAIN AND/OR REPAIR CABLE, CONDUIT AND/OR POLE LINE, IN, UNDER, ACROSS, OR
ALONG ROADS, STREETS, HIGHWAYS AND DRAINAGE DITCHES IN FORT BEND COUNTY, AS FOLLOWS:

IN, UNDER, OR ACROSS ROADS AND/OR DRAINAGE DITCHES

ROAD OR DITCH NAME	DISTANCE & DIRECTION FROM NEAREST INTERSECTION	LENGTH OF CROSSING	TYPE OF CONSTRUCTION			
			BORED	JACKED	DRIVEN	CASE

ALONG ROADS AND/OR DRAINAGE DITCHES

ROAD OR DITCH NAME	DISTANCE & DIRECTION FROM NEAREST INTERSECTION	TO	DISTANCE
GRAND PKWY	WEST R/W	WIMBERLY CANYON DR	70'
WIMBERLY CANYON DR	EAST R/W	5610 W RIVERPARK DR	1318'

GENERAL DESCRIPTION

SEE ATTACHMENTS.

THE LOCATION AND DESCRIPTION OF THE PROPOSED INSTALLATION AND APPURTENANCES IS MORE FULLY SHOWN ON THE ATTACHED DETAIL DRAWINGS. THE LAYING, CONSTRUCTION, MAINTENANCE AND/OR REPAIR OF THE PROPOSED INSTALLATION SHALL BE SUBJECT TO "A REVISED ORDER REGULATING THE LAYING, CONSTRUCTION, MAINTENANCE AND/OR REPAIR OF CABLES, CONDUITS, AND/OR POLE LINES, IN, UNDER, ACROSS, OR ALONG ROADS, STREETS, HIGHWAYS AND DRAINAGE DITCHES IN FORT BEND COUNTY, TEXAS, UNDER THE JURISDICTION OF THE COMMISSIONERS COURT OF FORT BEND COUNTY, TEXAS" AS PASSED BY COMMISSIONERS COURT OF FORT BEND COUNTY, TEXAS, DATED THE 3RD DAY OF AUGUST, 1987, RECORDED IN VOLUME 639 OF THE MINUTES OF THE COMMISSIONERS COURT OF FORT BEND COUNTY, TEXAS.

WRITTEN NOTICES ARE REQUIRED: 1) 48 HOURS IN ADVANCE OF START OF CONSTRUCTION AND 2) WHEN CONSTRUCTION IS COMPLETE AND READY FOR FINAL INSPECTION.

MAIL TO: PERMIT ADMINISTRATOR/FORT BEND COUNTY ENGINEERING
P.O. BOX 1449, ROSENBERG, TX 77471

VIOLATION OF REQUIREMENTS SHALL CONSTITUTE GROUNDS FOR JOB SHUT DOWN.

COMPANY NAME: AT&T Texas
AGENT AND/OR OWNER
Mike Broussard
(SIGNATURE)
NAME & TITLE: MIKE BROUSSARD, MGR DSP PLNG & ENG DESIGN
(PLEASE PRINT)
DATE: APRIL 11, 2013
ADDRESS: 1110 LOUISE, 1ST FLOOR
(STREET/P.O.BOX)
ROSENBERG Texas 77471
CITY STATE ZIP
TELEPHONE NO: 281-341-4312

(ACCESSIBLE 24 HRS/DAY, 7 DAYS/WEEK)

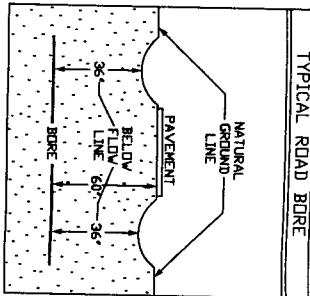

LEGEND

- B — PROPOSED BURIED CABLE
- B — EXISTING BURIED CABLE
- EDC — EXISTING AERIAL CABLE
- EDC — EDGE OF PAVEMENT/CONCRETE
- R/W — RIGHT OF WAY
- X — POWER POLE

FORT BEND COUNTY NOTIFICATION

AT&T CONTACT:
MIKE ROUSSARD
ENGINEERING & DESIGN
281-341-4312

SPECIAL CIRCUMSTANCES

6203
FORWARDED
PERMIT
REQUIRED

N

NORTH ARROW

OPERATING RANGE OF JOB STEPS

TASK — TO —

MFRC

TRANSMISSION ZONE

RZ 0 CZ 9 TAPER CODE 11A2

CAUTION HIGH VOLTAGE

KV 120 AERIAL Y BURIED N

HIGHWAY PERMIT NO.

UTILITY CO. CENT - CENTER POINT

REP NAME

REP TEL NO.

POLE CONTACTS (+) 0 (-) 0

UTILITY CO.

REP NAME

REP TEL NO.

POLE CONTACTS (+) 0 (-) 0

UTILITY CO.

REP NAME

REP TEL NO.

POLE CONTACTS (+) 0 (-) 0

PROJECT NO 9017076

TOT. PRINTS 26 PRINT NO. 25

NPA/NNX: 281-232 PRT: 281232

EXCH. RICH-ROSE

TAX DIST. FID009

GEO LOC. W89232

ENGR. MB DRAWNDY

TELEPHONE NO. (281) 341-4312

REC. REF. 232-270-77k

MAP REF. 607E

SCALE NONE

ISSUE DATE

PROJ TITLE 5610 V RIVER PARK DR FIBER/MLX

REV. NUMBER

DATE REV.

17310 W GRAND PARKWAY
BUILDING A

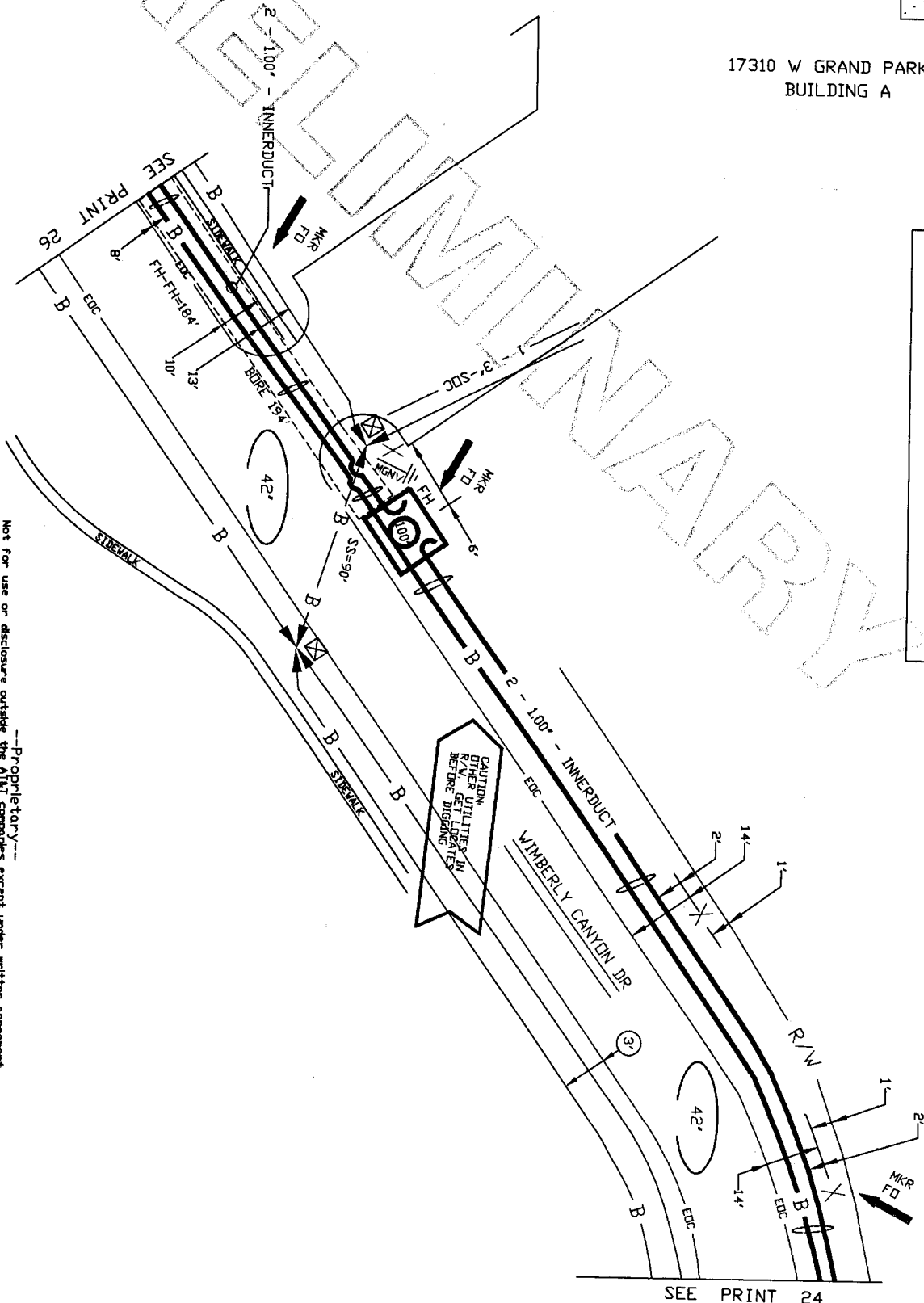

Not for use or disclosure outside the AT&T companies except under written agreement.

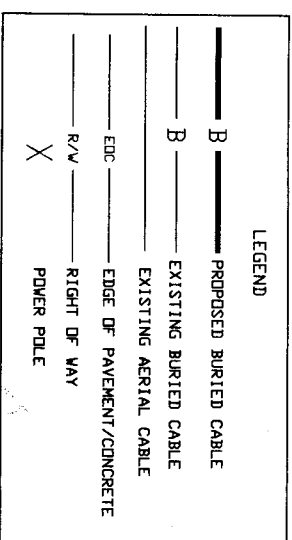

AT&T CONTACT:
MIKE BROUSSARD
MGR-DSP PLNG & ENG DESIGN
281-341-4312

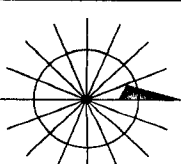

NORTH ARROW

TASK _____ TO _____

TRANSMISSION ZONE
CZ 9 TAPER CODE 114302
RZ 0

HIGHWAY PERMIT NO.

REP TEL NO.

	Pole Coniacs (+)	(-)
1	100	100
2	100	100
3	100	100
4	100	100
5	100	100
6	100	100
7	100	100
8	100	100
9	100	100
10	100	100
11	100	100
12	100	100
13	100	100
14	100	100
15	100	100
16	100	100
17	100	100
18	100	100
19	100	100
20	100	100
21	100	100
22	100	100
23	100	100
24	100	100
25	100	100
26	100	100
27	100	100
28	100	100
29	100	100
30	100	100
31	100	100
32	100	100
33	100	100
34	100	100
35	100	100
36	100	100
37	100	100
38	100	100
39	100	100
40	100	100
41	100	100
42	100	100
43	100	100
44	100	100
45	100	100
46	100	100
47	100	100
48	100	100
49	100	100
50	100	100
51	100	100
52	100	100
53	100	100
54	100	100
55	100	100
56	100	100
57	100	100
58	100	100
59	100	100
60	100	100
61	100	100
62	100	100
63	100	100
64	100	100
65	100	100
66	100	100
67	100	100
68	100	100
69	100	100
70	100	100
71	100	100
72	100	100
73	100	100
74	100	100
75	100	100
76	100	100
77	100	100
78	100	100
79	100	100
80	100	100
81	100	100
82	100	100
83	100	100
84	100	100
85	100	100
86	100	100
87	100	100
88	100	100
89	100	100
90	100	100
91	100	100
92	100	100
93	100	100
94	100	100
95	100	100
96	100	100
97	100	100
98	100	100
99	100	100
100	100	100

REP TEL NO.

UTILITY CO	
REP NAME	
REP TEL NO.	
POLE CONTACTS (+) 0	(-) 0

TOT.PRINTS 26 PRINT NO. 26

NPA/NNX: 281-232 PRT:281232

TAX DIST. FG009

ENGR. MR

REC. REF. 232-270-77*

SCALE NINE

PROJ TITLE 5610 W RIVER PARK DR FIBER/MIX

DATE REV.

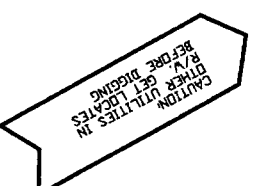

Not for use or disclosure outside the Afl companies except under written agreement

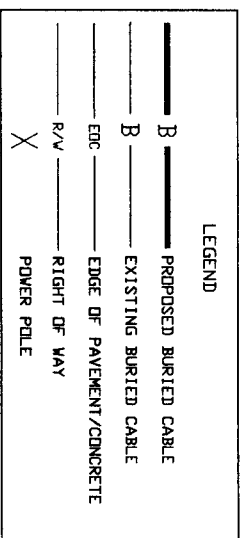

AT&T CONTACT:
MIKE BROUSSARD
MGR.-DSP PLNG & ENG DESIGN
281-341-4312



MFRC

CAUTION HIGH VOLTAGE
AERIAL Y BURIED N
KV 720

Utility CO CENT - CENTER POINT

Utility CO
REP NAME
REP TEL NO.

UTILITY CO	
REP NAME	
REP TEL NO.	
POLE CONTACTS (+)	(-) 0

TOT.PRINTS 26	PRINT NO.24
---------------	-------------

NPA/NNX: 281-232 PRT:281232

TAX DIST. FG009

ENGR. MB

TELEPHONE NO. (281) 341-4312

REC. REF. 232-270-778

MAP REF. 607E

SCALE NINE

ISSUE DATE

PROJ TITLE 5610 W RIVER PARK DR FIBER/MIX

DATE REV.

--Proprietary--
Not for use or disclosure outside the Alstom companies except under written agreement